

7/28/89



July 27, 1989
88-44-380-01-

Mr. L. Seto
Alameda County Health Care Services Agency
Department of Public Health
80 Swan Way, Room 200
Oakland, California 94621

Subject: ADDENDUM TO;
 July 11, 1989
 INTERIM SOIL SAMPLING REPORT AND RECOMMENDATIONS
 2724 Castro Valley Blvd.
 Castro Valley, California

Dear Mr. Seto:

The purpose of this addendum is to clarify our July 11th letter and to add information requested by you.

QUESTION - in the July 11 letter, we identified sidewall samples SW-4 and SW-5 as 'excavated sample locations', and it was not clear if they were taken at the floor of the excavation nor if they were in soils that were subsequently removed.

ANSWER - SW-4 and SW-5 were samples taken at a depth of approximately 12 feet in the sidewall of the excavation as it existed on June 12, 1989. Figure A shows the excavation at that date. SW-5 contained Tph-g of 2,300 ppm, therefore we decided to widen the excavation to the south and resample. Soils in the vicinity of SW-4 and SW-5 were removed to a depth of 12.5 feet. Figure B shows the excavation as it existed on July 5, 1989. The sidewall sample locations shown are at the current limit of excavation.

ADDITIONAL INFORMATION - Enclosed are copies of the lab analysis sheets and the chain of custody documents. I have also included an updated table that includes the results of the water sample collected July 6, 1989 from water standing in the bottom of the excavation.

Yours very truly,

CONVERSE ENVIRONMENTAL CONSULTANTS CALIFORNIA

A handwritten signature in cursive script, appearing to read "R. K. Mansfield".

Robert K. Mansfield
Project Manager
California Registered Geologist # 4529

TABLE 1

SOIL SAMPLES OF THE TANK PIT SIDEWALLS
Reporting units = ppm

location / date	tph-g	tph-d	B	T	E	X
SW-1 / 6-12	810	<10	2.7	15	5.0	31
SW-2 / 6-12	160	35	0.47	4.6	1.4	10
SW-3 / 6-12	400	110	1.3	6.8	2.6	17
SW-4 / 6-12	<10	<10	<.025	<.025	<.075	<.075
SW-5 / 6-12	2,300	38	29	160	32	200
SW-6 / 6-12	14	<10	0.055	0.09	0.11	0.46
SW-6A / 6-12	<10	<10	0.029	0.12	<.075	<.075
SW-7 / 6-12	<10	<10	0.061	0.14	0.19	<.075
SW-8 / 7-5	<10	NA	<.025	<.025	<.075	<.075
SW-9 / 7-5	11	NA	<.025	0.6	0.66	1.4
SW-10 / 7-5	18	NA	1.0	0.57	2.9	1.7
SW-11 / 7-5	71	NA	2.6	2.5	7.0	5.4

WATER SAMPLE IN THE EXCAVATION
Reporting units = ppm

location / date	tph-g	tph-d	B	T	E	X
Excavation pit 7/6	<.05	NA	<.0005	<.0005	<.0015	<.0015

NOTES:

1. NA = not analyzed.
2. All sidewall samples were collected from soils retrieved from the pit by either backhoe or excavator.
3. Soil from which samples SW-4 and SW-5 were taken have been excavated and removed.

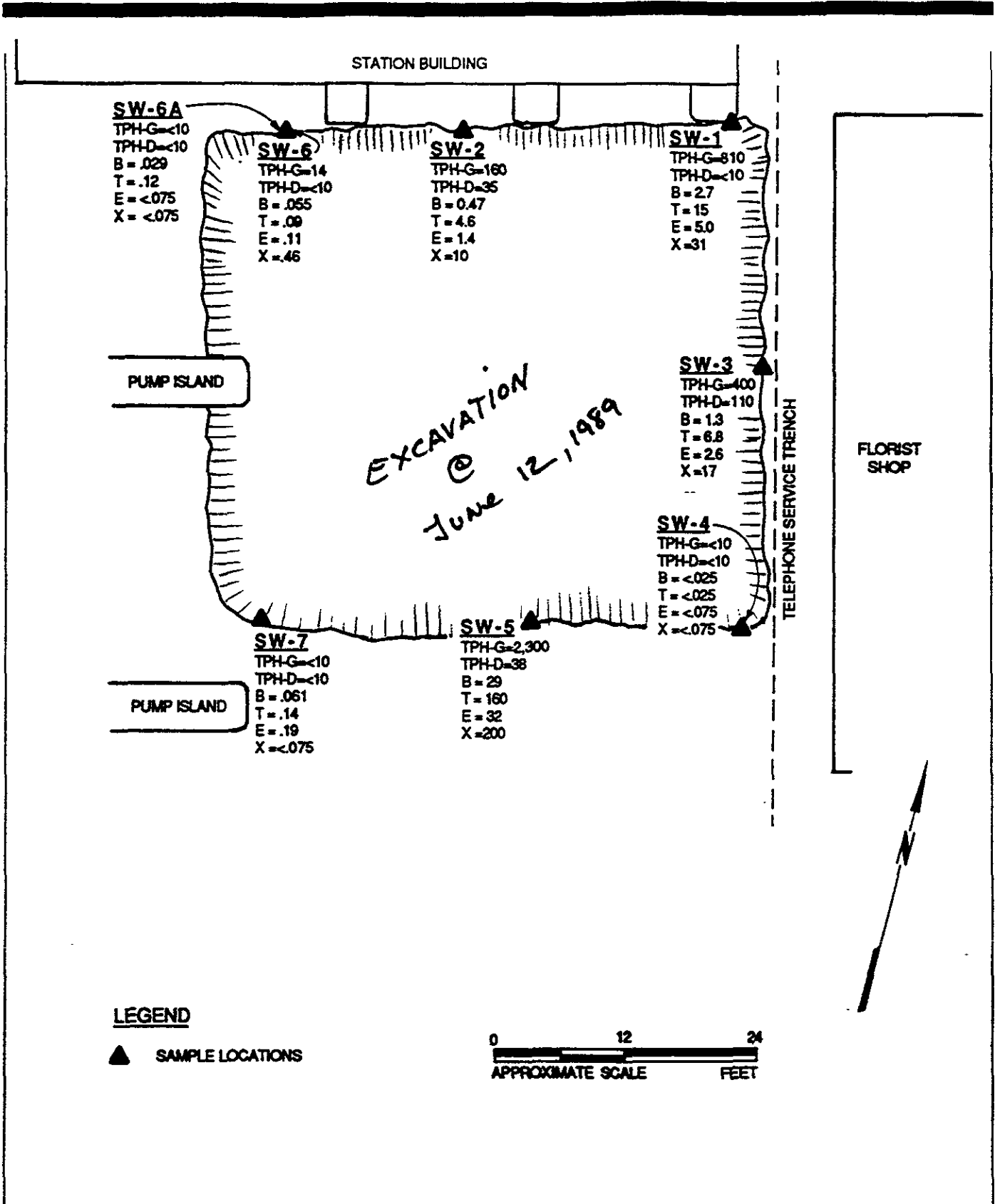

RESULTS MAP @ June 12, 1989

SHELL OIL COMPANY
2724 Castro Valley Boulevard
Castro Valley, California

Scale	Project No.
AS SHOWN	88-44-380-01
Prepared by	Date
CPB	7/20/89
Checked by	Drawing No.
RKM	A
Approved by	DWC



**Converse Environmental
Consultants California**

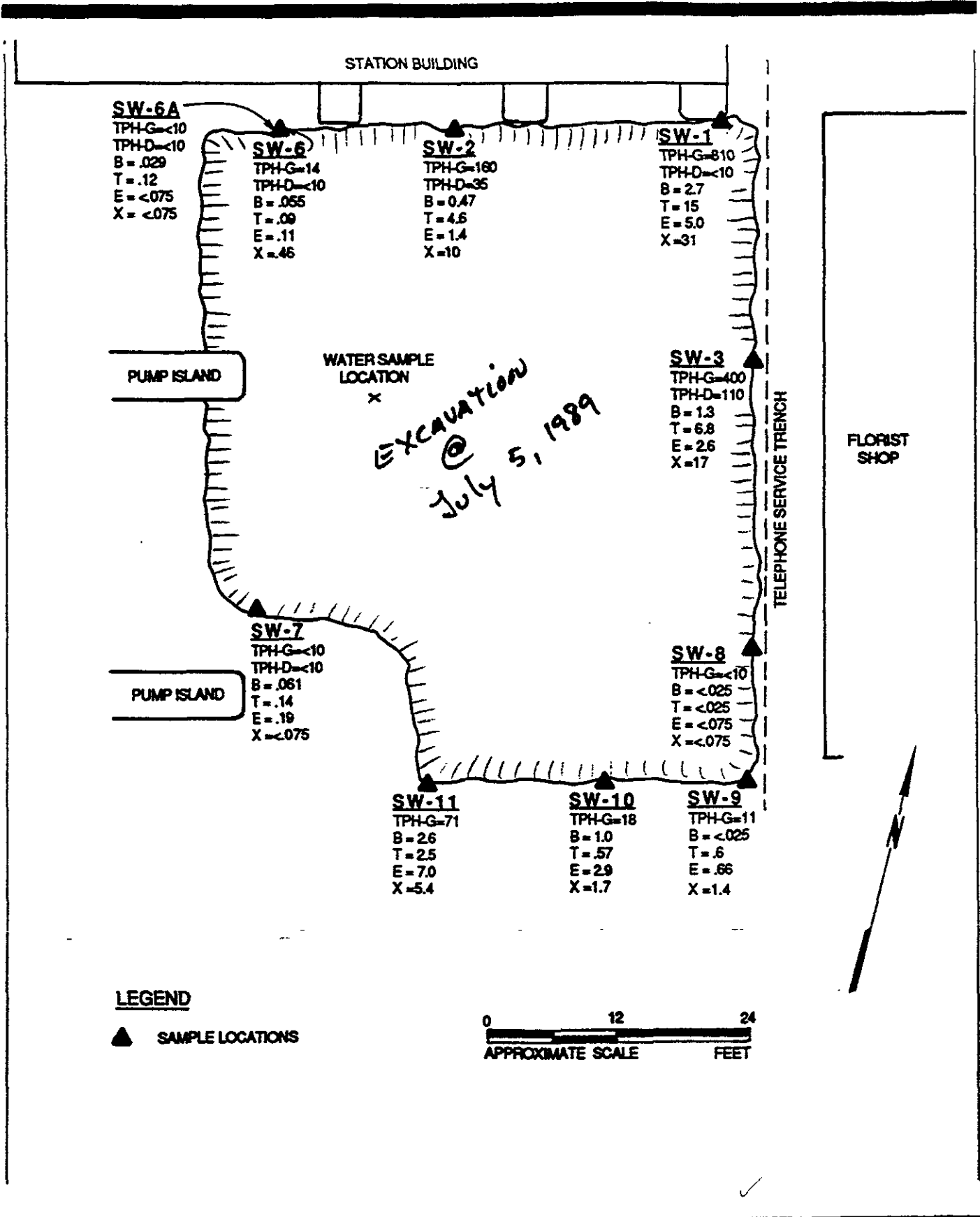

RESULTS MAP @ July 5, 1989

SHELL OIL COMPANY
2724 Castro Valley Boulevard
Castro Valley, California



Scale	Project No.
AS SHOWN	88-44-390-01
Prepared by	Date
CRB	7/20/89
Checked by	Drawing No.
RKM	B
Approved by	
DWC	



**Converse Environmental
Consultants California**

CHAIN OF CUSTODY RECORD

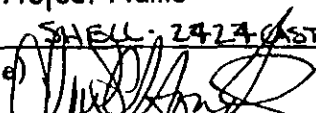
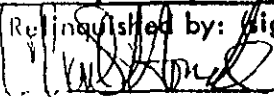
7049

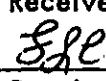
Project No. SM 41-380-01		Project Name SHELL - 2724 CASTRO VALLEY BLVD				Number of Containers 4 VOLS	TPH-GAS BTX					SHELL
Samplers: (signature) 												
Station No.	Date	Time	Comp.	Grab	Station Location						Remarks	
2724	7-6-81	11:00	✓		2724 CASTRO VALLEY BLVD	4	✓					STANDARD-TAT
Relinquished by: (signature) 		Date/Time 7-6-81 4:50pm	Received by: (signature) 		Relinquished by: (signature) 		Date/Time 7-18 10315	Received by: (signature) 				
Relinquished by: (signature)		Date/Time	Received by: (signature)		Relinquished by: (signature)		Date/Time	Received by: (signature)				
Relinquished by Courier: (signature)		Date/Time	Received by Mobile Lab: (signature)		Relinquished by Mobile Lab: (signature)		Date/Time	Received by Courier: (signature)				
Method of Shipment			Shipped by: (signature)		Courier from Airport: (signature) CVIA NCS		Received for Laboratory: (signature) K Temple		Date/Time 7/18/81 0210			



SAMPLE DESCRIPTION: Excav. Pit 07-06-89 1100
LAB NO.: (-30626)

<u>Parameter</u>	<u>Reporting Limit</u>	<u>Results</u>	<u>Units</u>
PETROLEUM HYDROCARBONS			
Volatile, as Gasoline DATE ANALYZED METHOD 8015/5030	0.05	ND 07-14-89	ppm
PURGEABLE AROMATICS			
Benzene	0.0005	ND	ppm
Ethylbenzene	0.0015	ND	ppm
Toluene	0.0005	ND	ppm
Xylenes, total METHOD 602	0.0015	ND	ppm



Converse Consultants

CHAIN OF CUSTODY RECORD

Project No. 88-44-380-01		Project Name 2724 CASTLE VALLEY			Number of Containers	TPH-9 / BTEX - 24hr TPH-9 / BTEX - 5 day TOC/G (SO3) - DTE grow Temperature					Remarks #6758
Samplers: (signature) N. Mansfield											
Station No.	Date	Time	Comp.	Grab	Station Location						
1	6-12			✓	SW-1	1	X	X	X		
				✓	SW-2	1	X	X	X		
				✓	SW-3	1	X	X	X		
				✓	SW-4	1	X	X	X		
				✓	SW-5	1	X	X	X		
				✓	SW-6	1	X	X	X		
				✓	SW-6A	1	X	X	X		
		✓	SW-7	1	X	X	X		Black soil Horizon		
Relinquished by: (signature) N. Mansfield		Date/Time 6-12-1992		Received by: (signature) Nicola Blout		Relinquished by: (signature) Nicola Blout		Date/Time 6-12-2-45		Received by: (signature) Fred Elrod	
Relinquished by: (signature)		Date/Time		Received by: (signature)		Relinquished by: (signature)		Date/Time		Received by: (signature)	
Relinquished by Courier: (signature)		Date/Time		Received by Mobile Lab: (signature)		Relinquished by Mobile Lab: (signature)		Date/Time		Received by Courier: (signature)	
Method of Shipment (via NCS)				Shipped by: (signature)		Courier from Airport: (signature)		Received for Laboratory: (signature) Alison Dow		Date/Time 6/13/89	



Parameter	Reporting Limit (ppm)	Descriptor, Lab No. and Results (ppm)				
		SW-1 06-12-89 (-29102)	SW-2 06-12-89 (-29103)	SW-3 06-12-89 (-29104)	SW-4 06-12-89 (-29105)	SW-5 06-12-89 (-29106)
Oil & Grease, total	50	ND	ND	ND	ND	ND
Oil & Grease, (non-polar)	100	ND	ND	ND	ND	ND
PETROLEUM HYDROCARBONS						
Volatile, as Gasoline	10	810	160	400	ND	2300
DATE ANALYZED		06-14-89	06-14-89	06-14-89	06-14-89	06-14-89
Extractable, as Motor Oil	10	ND	ND	ND	ND	ND
as Diesel Fuel	10	ND	35 ^a	110 ^a	ND	38 ^a
DATE ANALYZED		06-14-89	06-14-89	06-14-89	06-14-89	06-14-89
DATE EXTRACTED		06-13-89	06-13-89	06-13-89	06-13-89	06-13-89

Parameter	Reporting Limit (ppm)	Descriptor, Lab No. and Results (ppm)				
		SW-1 06-12-89 (-29102) ^b	SW-2 06-12-89 (-29103) ^c	SW-3 06-12-89 (-29104) ^c	SW-4 06-12-89 (-29105)	SW-5 06-12-89 (-29106) ^b
PURGEABLE AROMATICS						
Benzene	0.025	2.7	0.47	1.3	ND	29
Ethylbenzene	0.075	5.0	1.4	2.6	ND	32
Toluene	0.025	15	4.60	6.8	ND	160
Xylenes, total	0.075	31	10	17	ND	200

^aSample appears to contain lower boiling hydrocarbons not characteristic of diesel.

^bThe reporting limits for this sample are 50 times the listed reporting limits.

^cThe reporting limits for this sample are 10 times the listed reporting limits.



<u>Parameter</u>	<u>Reporting Limit (ppm)</u>	<u>Descriptor, Lab No. and Results (ppm)</u>		
		<u>(-29107)</u>	<u>(-29108)</u>	<u>(-29109)</u>
Oil & Grease, total	50	ND	ND	ND
Oil & Grease (non-polar)	100	ND	ND	ND
PETROLEUM HYDROCARBONS				
Volatile, as Gasoline DATE ANALYZED	10	14 06-14-89	ND 06-14-89	ND 06-14-89
Extractable, as Motor Oil soil	10	ND	ND	ND
as Diesel Fuel DATE ANALYZED	10	ND 06-14-89	ND 06-14-89	ND 06-14-89
DATE EXTRACTED		06-13-89	06-13-89	06-13-89

<u>Parameter</u>	<u>Reporting Limit (ppm)</u>	<u>Descriptor, Lab No. and Results (ppm)</u>		
		<u>(-29107)</u>	<u>(-29108)</u>	<u>(-29109)</u>
PURGEABLE AROMATICS				
Benzene	0.025	0.055	0.029	0.061
Ethylbenzene	0.075	0.11	ND	0.19
Toluene	0.025	0.090	0.12	0.14
Xylenes, total	0.075	0.46	ND	ND

CHAIN OF CUSTODY RECORD

Project No.		Project Name 2724 CASTRO Valley Blvd				Number of Containers	<div style="border: 1px solid black; padding: 5px; display: inline-block;"> (6999) </div>							
Samplers: (signature) <i>N. Humboldt</i>														
Station No.	Date	Time	Comp.	Grab	Station Location	<div style="border: 1px solid black; padding: 5px; display: inline-block; transform: rotate(-45deg);"> TPL-9 STEP </div>								
1	7.5	-		✓	SW-8 @ 12'	1	X							
"	"	-		✓	SW-9 @ 12'	1	X							
"	"	-		✓	SW-10 @ 12'	1	X							
"	"	-		✓	SW-11 @ 12'	1	X							
<p>NOTE: NEED RESULTS ASAP (24 HR TURN) !</p> <p>SAVE SAMPLES IN CASE PH needs to be run</p>														
Relinquished by: (signature) <i>N. Humboldt</i>		Date/Time 7.5 1530		Received by: (signature) <i>Nicola B...</i>		Relinquished by: (signature) <i>Nicola B...</i>		Date/Time 7.5 1535		Received by: (signature) <i>Tom Fodge</i>				
Relinquished by: (signature)		Date/Time 		Received by: (signature)		Relinquished by: (signature)		Date/Time 		Received by: (signature)				
Relinquished by Courier: (signature)		Date/Time 		Received by Mobile Lab: (signature)		Relinquished by Mobile Lab: (signature)		Date/Time 		Received by Courier: (signature)				
Method of Shipment <i>via NCS</i>				Shipped by: (signature)		Courier from Airport: (signature)		Received for Laboratory: (signature) <i>delia...</i>		Date/Time <i>7/6/19 06:30</i>				



Parameter	Reporting Limit (ppm)	Descriptor, Lab No. and Results (ppm)			
		SW 8 @ 12' 07-05-89	SW 9 @ 12' 07-05-89	SW 10 @ 12' 07-05-89	SW 11 @ 12' 07-05-89
PETROLEUM HYDROCARBONS					
Volatile, as Gasoline DATE ANALYZED	10	ND 07-06-89	11 07-06-89	18 07-06-89	71 07-06-89
PURGEABLE AROMATICS					
Benzene	0.025	ND	ND	1.0	2.6
Ethylbenzene	0.075	ND	0.60	0.57	2.5
Toluene	0.025	ND	0.66	2.9	7.0
Xylenes, total	0.075	ND	1.4	1.7	5.4