

ALAMEDA COUNTY  
HEALTH CARE SERVICES

AGENCY  
DAVID J. KEARS, Agency Director



ENVIRONMENTAL HEALTH SERVICES  
ENVIRONMENTAL PROTECTION (LOP)  
1131 Harbor Bay Parkway, Suite 250  
Alameda, CA 94502-6577  
(510) 567-6700  
FAX (510) 337-9335

REMEDIAL ACTION COMPLETION CERTIFICATION

February 13, 1997

Mr. Trevor Barnes  
3800 Mountain Blvd.  
Oakland, CA 94619

Re: Golden Gate Academy, 3800 Mountain Blvd., Oakland, CA 94619  
[STID 3669]

Dear Mr. Barnes,

This letter confirms the completion of site investigation and remedial action for the underground storage tank formerly located at the above described location. Thank you for your cooperation throughout this investigation. Your willingness and promptness in responding to our inquiries concerning the former underground storage tanks are greatly appreciated. Enclosed is the Case Closure Summary for the referenced site for your records.

Based on information in the above-referenced file and with the provision that the information provided to this agency was accurate and representative of site conditions, no further action related to the underground tank release is required.

This notice is issued pursuant to a regulation contained in Section 2721(e) of Title 23 of the California Code of Regulations.

Please contact our office if you have any questions regarding this matter.

Sincerely,

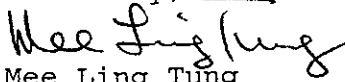
  
Mee Ling Tung

Director of Environmental Health Services

Attachment

c: Acting Chief, Hazardous Materials Division - files  
Juliet Shin, ACDEH  
Kevin Graves, RWQCB  
Lori Casias, SWRCB (w/ enclosure)  
Cheryl Gordon, SWRCB Cleanup Fund

**CASE CLOSURE SUMMARY**  
**Leaking Underground Fuel Storage Tank Program**

**I. AGENCY INFORMATION**

Date: January 10, 1997

Agency name: **Alameda County-HazMat** Address: **1131 Harbor Bay Pkwy.**  
 City/State/Zip: **Alameda, CA 94502** Phone: **(510) 567-6700**  
 Responsible staff person: **Juliet Shin** Title: **Senior HMS**

**II. CASE INFORMATION**

Site facility name: **Golden Gate Academy**  
 Site facility address: **3800 Mountain Blvd., Oakland, CA 94619**  
 RB LUSTIS Case No: **N/A** Local Case No./LOP Case No.: **3669**  
 URF filing date: **January 13, 1997** SWEEPS No: **N/A**

| <u>Responsible Parties:</u>                               | <u>Addresses:</u>                                 | <u>Phone Numbers:</u> |
|---|---|-----------------------|
| <b>Seventh Day Adventists</b>                             | <b>P.O. Box 23165<br/>Pleasant Hill, CA 94523</b> |                       |
| <b>Golden Gate Academy<br/>Contact: Mr. Trevor Barnes</b> | <b>3800 Mountain Blvd.<br/>Oakland, CA 94619</b>  | <b>(510) 531-0110</b> |

| <u>Tank No:</u> | <u>Size in gal.:</u> | <u>Contents:</u> | <u>Closed in-place or removed?:</u> | <u>Date:</u>    |
|-----------------|----------------------|------------------|-------------------------------------|-----------------|
| <b>1</b>        | <b>1,000</b>         | <b>gasoline</b>  | <b>removed</b>                      | <b>07/05/90</b> |

**III. RELEASE AND SITE CHARACTERIZATION INFORMATION**Cause and type of release: **Unknown**Site characterization complete? **YES**Date approved by oversight agency: **January 10, 1997**Monitoring Wells installed? **No**

Highest GW depth below ground surface: **According to the well logs for wells located within 0.5-mile radius of the site, the depth to groundwater at the site is roughly 7- to 10-feet below ground surface (bgs). According to Andreas Godfrey, Alameda County Public Works Agency, the geology in the area consists of soil down to ~10-feet below ground surface, and bedrock beneath the soil.**

## Leaking Underground Fuel Storage Tank Program

Flow direction: **Unknown**

Most sensitive current use: **residential/commercial**

Are drinking water wells affected? **No. No drinking water wells within 0.5 miles of the site.**

Aquifer name: **Unknown**

Is surface water affected? **NO**                      Nearest affected SW name: **None**

Off-site beneficial use impacts (addresses/locations): **None**

Report(s) on file? **YES**                      Where is report(s) filed? **Alameda County  
1131 Harbor Bay Pkwy.  
Alameda, CA 94502**

### Treatment and Disposal of Affected Material:

| <u>Material</u> | <u>Amount<br/>(include units)</u> | <u>Action (Treatment<br/>or Disposal w/destination)</u>                | <u>Date</u> |
|-----------------|-----------------------------------|--|-------------|
| Tank            | one                               | H&H Ship Service Co.<br>220 China Basin St.<br>San Francisco, CA 94107 | 07/05/90    |
| Rinsate         | 200 gallons                       | H&H Ship Service Co.   | 07/05/90    |

### III. RELEASE AND SITE CHARACTERIZATION INFORMATION (Continued)

#### Maximum Documented Contaminant Concentrations - - Before and After Cleanup

| Contaminant   | Soil (ppm)          |                    | Water (ppb) |       |
|---------------|---------------------|--------------------|-------------|-------|
|               | Before <sup>1</sup> | After <sup>2</sup> | Before      | After |
| TPH (Gas)     | 420                 | 2                  | NA          |       |
| TPH (Diesel)  | NA                  | NA                 | NA          |       |
| Benzene       | 0.17                | ND                 | NA          |       |
| Toluene       | ND                  | 0.01               | NA          |       |
| Total Xylenes | 0.68                | 0.14               | NA          |       |
| Ethylbenzene  | 0.61                | 0.03               | NA          |       |

NA- Not Analyzed

ND- Not Detected

1-Analytical results of soil sample SS#2, collected from ~10.3-feet below ground surface (bgs).

2-Analytical results of soil sample SS#3, collected from ~15-feet bgs subsequent to some soil overexcavation.

**Leaking Underground Fuel Storage Tank Program**

**Comments (Depth of Remediation, etc.):** (Also, see "Additional Comments" section.)

According to Minter & Fahy Construction Company, Inc.'s November 02, 1992 report, the tank pit was overexcavated down to ~15-feet bgs. It appears that a total of 20 to 25 cubic yards of soil was excavated from the tank pit. According to County files, this soil was spread on site.

**IV. CLOSURE**

Does completed corrective action protect existing beneficial uses per the Regional Board Basin Plan? **Undetermined**

Does completed corrective action protect potential beneficial uses per the Regional Board Basin Plan? **Undetermined**

Does corrective action protect public health for current land use? **YES**

Site management requirements: **If land use changes, or construction work involving exposure to underlying soil and/or groundwater takes place at the site, then the local regulatory agency should be notified and a risk assessment and a health & safety plan should be considered.**

Should corrective action be reviewed if land use changes? **YES**

List enforcement actions taken: **None**

**V. LOCAL AGENCY REPRESENTATIVE DATA**

Name: **Juliet Shin** Title: **Senior HMS**  
Signature:  Date: **1/13/97**

**Reviewed by**  
Name: **Eva Chu** Title: **Hazardous Materials Specialist**  
Signature:  Date: **1/13/97**

Name: **Thomas Peacock** Title: **Supervising HMS**  
Signature:  Date: **1-23-97**

**VI. RWQCB NOTIFICATION**

Date Submitted to RB:  
RWQCB Staff Name: **Kevin Graves**

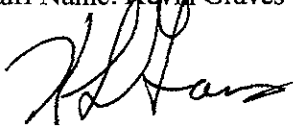

RB Response: **Approved**  
Title: **San. Engineering Asso.** Date:  
**2/4/97**

## Leaking Underground Fuel Storage Tank Program

### VII. ADDITIONAL COMMENTS, DATA, ETC.

The site occupies ~15 acres in the Oakland hills and is bordered by Holy Names College to the north, and open land to the east, west, and south. The site is currently used as a Seventh Day Adventist private elementary and secondary school. Houses are also located on the site to accommodate some of the school's employees (refer to Attachment 1 for regional map).

On July 05, 1990, one 1,000-gallon gasoline underground storage tank (UST) was removed from the site (refer to Attachments 2 and 3 for tank and sampling locations). Two soil samples, SS#1 and SS#2, were collected from beneath each end of the UST at ~12.5- and ~10.3-feet bgs. Slight petroleum odors were reported to be emanating from the tank pit soil. Samples SS#1 and SS#2 were analyzed for Total Petroleum Hydrocarbons as gasoline (TPHg) and benzene, toluene, ethylbenzene, and total xylenes (BTEX). The analysis of these samples identified up to 420 parts per million (ppm) TPHg, 0.17ppm benzene, 0.61ppm ethylbenzene, and 0.68ppm total xylenes (refer to Attachment 4 for analytical results). An unknown quantity of additional soil was overexcavated from the tank pit and one confirmatory soil sample, SS#3, was collected from the bottom of the excavation pit at ~15-feet bgs and analyzed for TPHg and BTEX. Analysis of this sample identified 2ppm TPHg, 0.01ppm toluene, 0.03ppm ethylbenzene, and 0.14ppm total xylenes. No benzene was identified above detection limits. There was no mention of groundwater being encountered in the tank pit at the time of the tank removal.

A total of 20 to 25 cubic yards of soil was excavated from the tank pit. A soil sample was collected from this stockpiled soil and analyzed for TPHg and BTEX. Analysis of this sample did not identify contaminants above detection limits.

This office is recommending that this case be closed based on the following rationale:

- o The extent of the observed soil contamination appears to be limited in extent based on the Non Detect levels identified in the excavated stockpiled soil, and the very low concentrations identified in post-excavation sample SS#3.
- o The contaminant constituent benzene is a carcinogen and is considered the Chemical of Concern (CoC) in gasoline (i.e., the driving chemical constituent in evaluating any potential human health risk). Based on the analytical results of Samples SS#1 and SS#3, it appears that no residual benzene remains in the former tank area. The low levels of benzene initially identified in Sample SS#2 appears to have been removed.
- o The levels of toluene, ethylbenzene, and total xylenes remaining in the soil at the site do not appear to pose a threat to human health for a residential site per the Tier 1 table of the American Society for Testing and Materials' Standard Guide for Risk-Based Corrective Action Applied at Petroleum Release Sites (E 1739-95).
- o According to groundwater well information obtained from the Alameda County Public Works Agency (Public Works), there are no drinking water wells located within 0.5 miles of the site (refer to Attachment 5).

# ATTACHMENTS

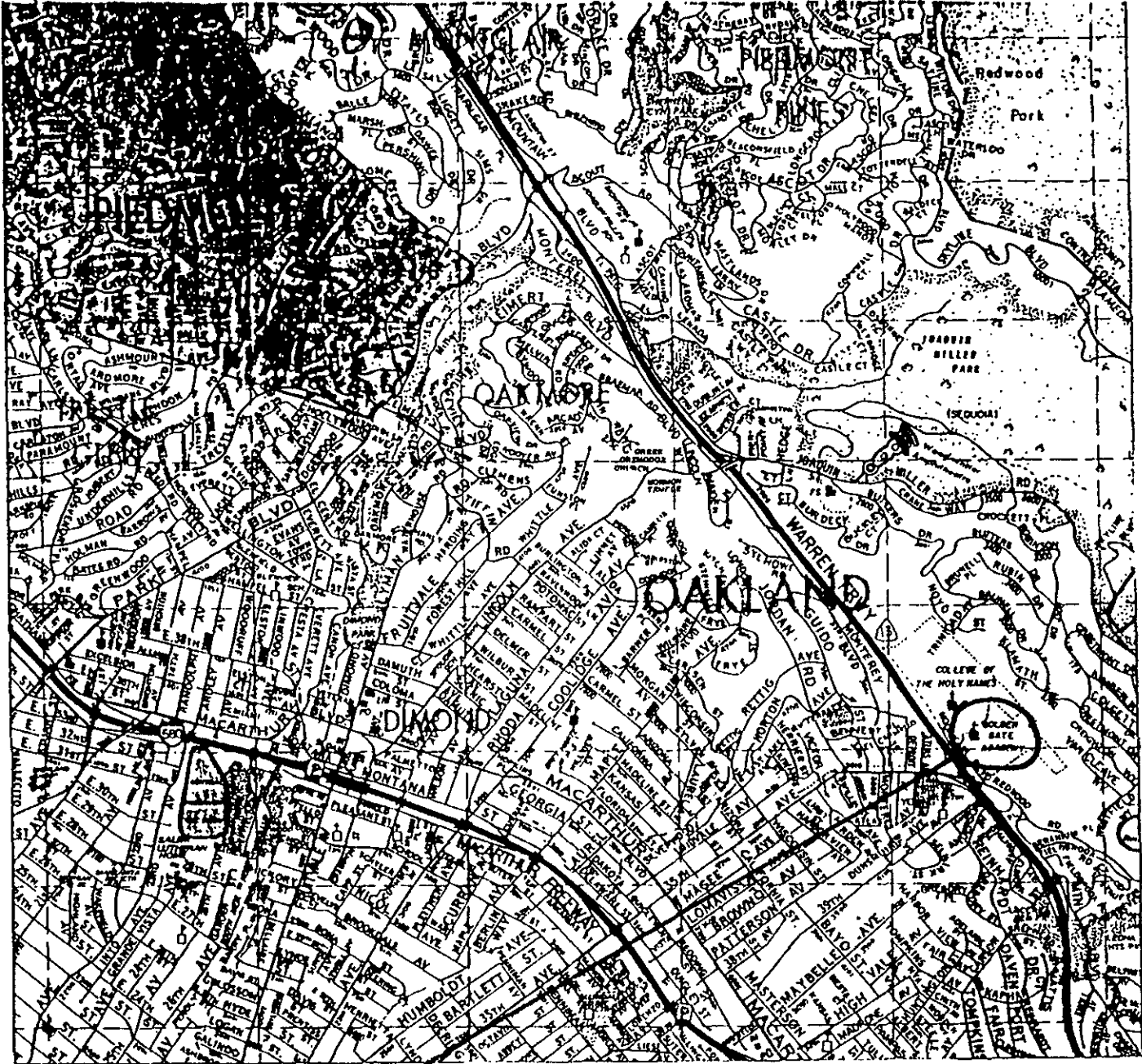

Location Map:

Golden Gate Academy  
3800 Mountain Blvd.  
Oakland, Ca. 94619

Tank Removal:

1-1,000 gallon tank

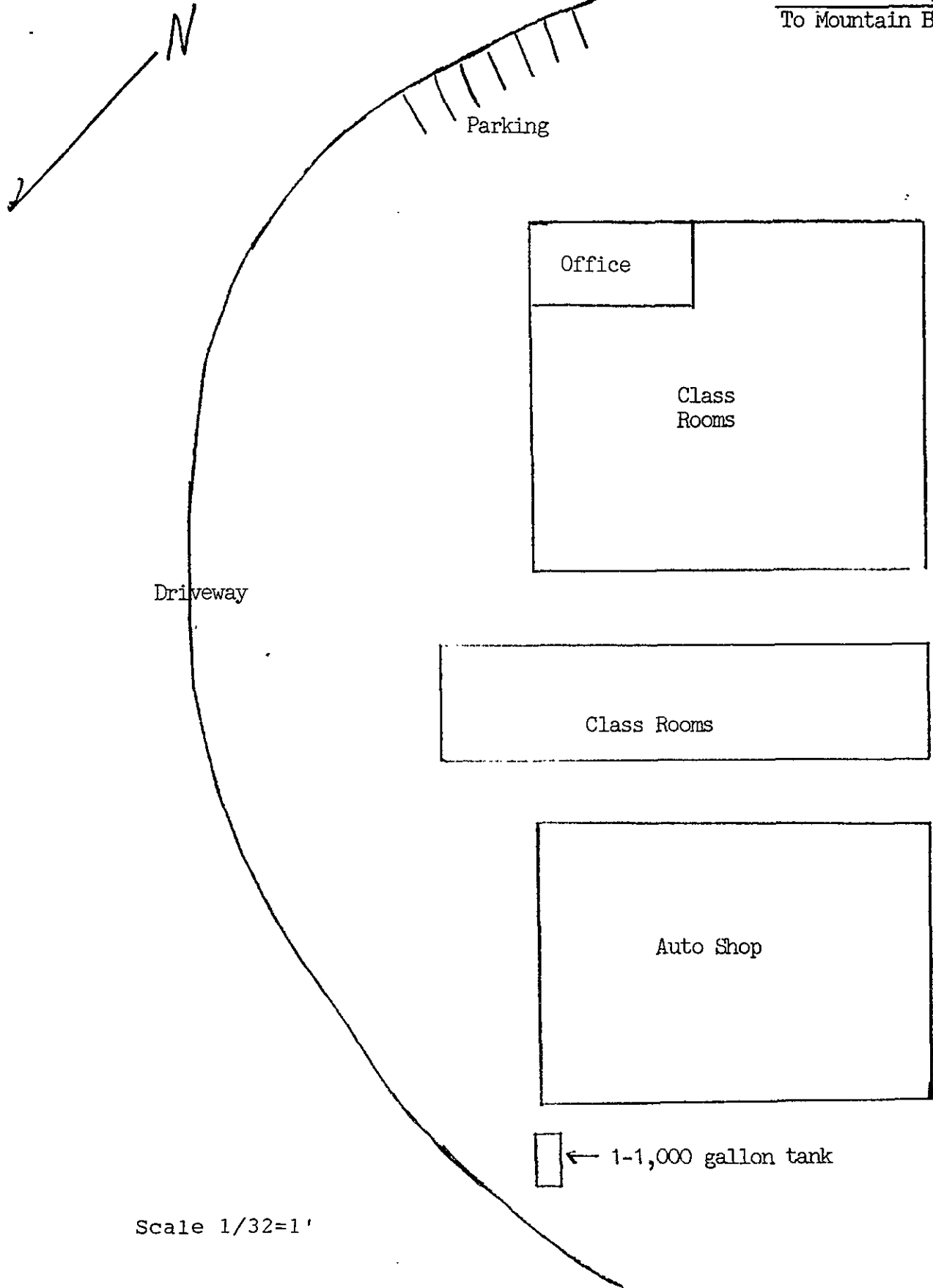

Scale 1/32=1'

Plot Plan:  
 Golden Gate Academy  
 3800 Mountain Blvd.  
 Oakland, Ca. 94619

Tank Removal:  
 1-1,000 gallon tank.



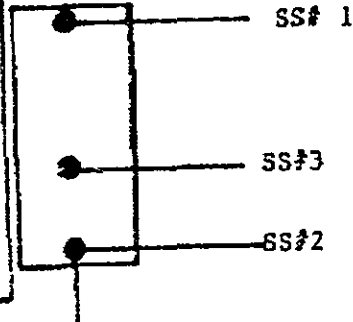
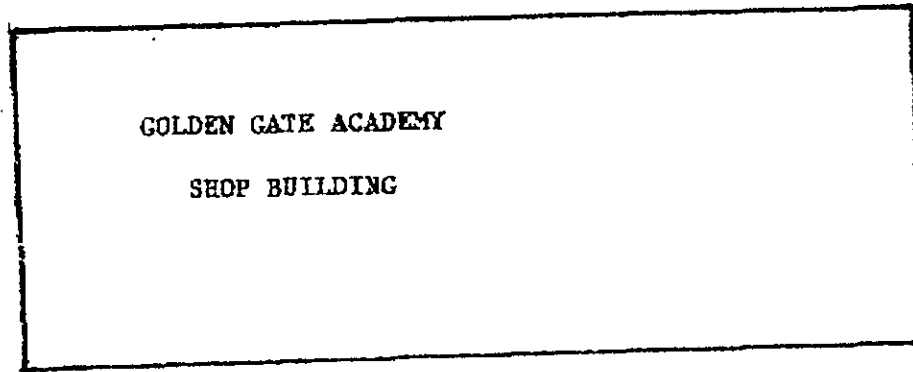

1000 GALLON GASOLINE TANK

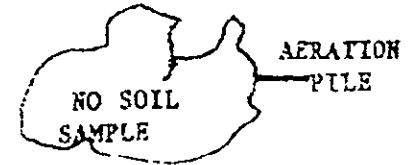
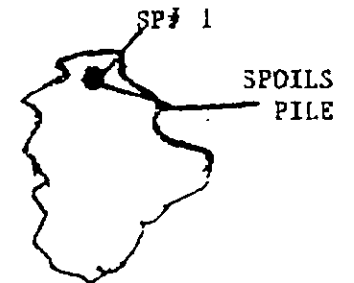

|  |                      |   |                     |                       |
|--|----------------------|---|---------------------|-----------------------|
| <p><b>SAMPLE DEPTH</b></p> <p>SS# -1 12'6"</p> <p>SS# -2 10'4"</p> <p>SS# -3 15"</p> <p>SP SOIL SAMPLE SURFACE</p> | <p><b>LEGEND</b></p> | <p>MINTER &amp; FAHY CONSTRUCTION COMPANY<br/>GOLDEN GATE ACADEMY - OAKLAND, CA</p> |                     |                       |
|  |                      | <p>SCALE:</p>   | <p>APPROVED BY:</p> | <p>DRAWN BY:</p>      |
|  |                      | <p>DATE: 7-11-90</p>  | <p>PLAN VIEW</p>    |                       |
|  |                      | <p><b>HAGEMAN-SCHANK, INC</b></p>   |                     | <p>DRAWING NUMBER</p> |





Client Number: SFB-566-0089.72  
 Project ID: 3800 Mountain Blvd.  
 Oakland, CA.  
 Work Order Number: CO-07-145

**Table 1**  
**ANALYTICAL RESULTS**  
 Aromatic Volatile Organics and  
 Total Petroleum Hydrocarbons as Gasoline in Soil  
 EPA Methods 5030, 8020, and Modified 8015<sup>a</sup>

| GTEL Sample Number         |                        | 01                   | 02       | 03       | 04       |
|----------------------------|------------------------|----------------------|----------|----------|----------|
| Client Identification      |                        | SS#1                 | SS#2     | SP#1     | SS#3     |
| Date Sampled               |                        | 07/05/90             | 07/05/90 | 07/05/90 | 07/05/90 |
| Date Extracted             |                        | 07/06/90             | 07/06/90 | 07/06/90 | 07/06/90 |
| Date Analyzed              |                        | 07/06/90             | 07/06/90 | 07/06/90 | 07/06/90 |
| Analyte                    | Detection Limit, mg/Kg | Concentration, mg/Kg |          |          |          |
|                            |                        | Benzene              | 0.005    | <0.005   | 0.17     |
| Toluene                    | 0.005                  | <0.005               | <0.005   | <0.005   | 0.01     |
| Ethylbenzene               | 0.005                  | 0.22                 | 0.61     | <0.005   | 0.03     |
| Xylene, total              | 0.015                  | 0.18                 | 0.68     | <0.015   | 0.14     |
| BTEX, total                | --                     | 0.4                  | 1.5      | --       | 0.18     |
| TPH as Gasoline            | 1                      | 100                  | 420      | 1        | 2        |
| Detection Limit Multiplier |                        | 1                    | 1        | 1        | 1        |

a. Test Methods for Evaluating Solid Waste, SW-846, Third Edition, Revision 0, US EPA November 1986. Modification for TPH as gasoline as per California State Water Resources Control Board LUFT Manual protocols, May 1988 revision.

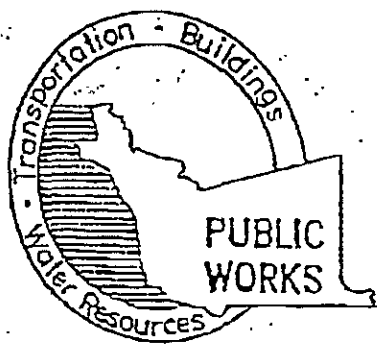

COUNTY OF ALAMEDA  
PUBLIC WORKS AGENCY  
951 Turner Court, Hayward, CA 94545  
(510) 670-5543

DATE: 1-7-97

No of Pages (including cover): 3

**FAX TRANSMITTAL**

|        |                    |
|--------|--------------------|
| T<br>O |                    |
|        | <u>Juliet Shin</u> |
|        |                    |
|        |                    |
| FAX:   |                    |

|                  |                        |
|------------------|------------------------|
| F<br>R<br>O<br>M |                        |
|                  | <u>Andreas Godfrey</u> |
|                  |                        |
|                  |                        |
| FAX:             |                        |

Should you have problems receiving this FAX transmittal, please call: \_\_\_\_\_

SUBJECT: Wells

**TRANSMITTING THE FOLLOWING:**

1/7/97

Mr. Godfrey stated that the geology of the area immediately around the site consists of soil from 0- to ~10' bgs + bedrock beneath the soil.

*Juliet Shin*

| Tr    | Section | Address             | Owner     | City | Drilldate | Totaldepth | Waterdepth | Diameter | Use  | Yield |
|-------|---------|---------------------|-----------|------|-----------|------------|------------|----------|------|-------|
| 1S/3W | 34N     | 4131 Gregory Street | Don Ender | OAK  | 10/89     | 0          | 0          | 6"       | BOR* | 0     |
| 1S/3W | 33G 1   | 4374 Norton Ave     | Zeber Zel | OAK  | 4/91      | 9          | 7          | 2"       | MON  | 0     |
| 1S/3W | 34M 1   | ANDERSON & ALISO    | PG&E      | OAK  | 8/76      | 120        | 0          | 0"       | CAT  | 0     |

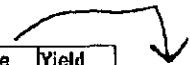
 Spring  
 Monitoring  
 Cathodic Protection

"0" means no data

Within a 1/2 mile there is one well  
 with a water depth - 7 feet to water

89928828  
 IN CASE OF AN EMERGENCY OR SPILL, CALL THE NATIONAL RESPONSE CENTER 1-800-424-9802; WITHIN CALIFORNIA CALL 1-800-852-7550  
 GENERATOR  
 TRANSPORTER  
 FACILITY

**UNIFORM HAZARDOUS WASTE MANIFEST**

3. Generator's Name and Mailing Address  
**GOLDEN GATE ACADEMY**  
 3800 Mountain Blvd., Oakland, CA 94619

4. Generator's Phone ((415) 531-0110

5. Transporter 1 Company Name  
**H & H Ship Service Company**

7. Transporter 2 Company Name

9. Designated Facility Name and Site Address  
**H & H Ship Service Company**  
 220 China Basin Street  
 San Francisco, CA 94107

J. Additional Descriptions for Materials Listed Above  
**FUEL, OIL AND WATER**

15. Special Handling Instructions and Additional Information  
**JOB #4891**  
**APPROPRIATE PROTECTIVE CLOTHING AND RESPIRATOR.**

16. GENERATOR'S CERTIFICATION: I hereby declare that the contents of this consignment are fully and accurately described above by proper shipping name and are classified, packed, marked, and labeled, and are in all respects in proper condition for transport by highway according to applicable international and national government regulations.  
 If I am a large quantity generator, I certify that I have a program in place to reduce the volume and toxicity of waste generated to the degree I have determined to be economically practicable and that I have selected the practicable method of treatment, storage, or disposal currently available to me which minimizes the present and future threat to human health and the environment; OR, if I am a small quantity generator, I have made a good faith effort to minimize my waste generation and select the best waste management method that is available to me and that I can afford.

17. Transporter 1 Acknowledgement of Receipt of Materials  
 Printed/Typed Name: **x RICHARD I. PETERSEN**  
 Signature: *x Richard I. Petersen*  
 Month Day Year: 10 7 05 90

18. Transporter 2 Acknowledgement of Receipt of Materials  
 Printed/Typed Name: **STEVE MESQUITE**  
 Signature: *Steve Mesquite*  
 Month Day Year: 10 7 05 90

18. Transporter 2 Acknowledgement of Receipt of Materials  
 Printed/Typed Name: \_\_\_\_\_  
 Signature: \_\_\_\_\_  
 Month Day Year: \_\_\_\_\_

19. Discrepancy Indication Space

20. Facility Owner or Operator Certification of receipt of hazardous materials covered by this manifest except as noted in item 19.  
 Printed/Typed Name: **PETER YIMBO**  
 Signature: *Peter O. Yimbo*  
 Month Day Year: 10 7 05 90

1. Generator's US EPA ID No. **C A C 0 0 0 2 9 1 6 6 5**  
 Manifest Document No. **0 0 0 0 1**  
 2. Page 1 of 1  
 Information in the shaded areas is not required by Federal law.  
 A. State Manifest Document Number **89928828**  
 B. State Generator's ID \_\_\_\_\_  
 C. State Transporter's ID **103566**  
 D. Transporter's Phone **(415) 543-4835**  
 E. State Transporter's ID \_\_\_\_\_  
 F. Transporter's Phone \_\_\_\_\_  
 G. State Facility's ID **C A D 0 0 4 7 7 1 1 6 8**  
 H. Facility's Phone **(415) 543-4835**

| 11. US DOT Description (including Proper Shipping Name, Hazard Class, and ID Number) | 12. Containers |       | 13. Total Quantity | 14. Unit Wt/Vol | Waste No.  |
|--|----------------|-------|--------------------|-----------------|--|
|  | No.            | Type  |                    |                 |  |
| a. <b>HAZARDOUS WASTE LIQUID, N.O.S. ORM-E NA 9189</b>                               | 0101           | TIT   | 200                | G               | State 241<br>EPA/Other _____<br>State _____<br>EPA/Other _____<br>State _____<br>EPA/Other _____ |
| b. _____   | _____          | _____ | _____              | _____           | State _____<br>EPA/Other _____<br>State _____<br>EPA/Other _____                                 |
| c. _____   | _____          | _____ | _____              | _____           | State _____<br>EPA/Other _____<br>State _____<br>EPA/Other _____                                 |
| d. _____   | _____          | _____ | _____              | _____           | State _____<br>EPA/Other _____<br>State _____<br>EPA/Other _____                                 |

K. Handling Codes for Wastes Listed Above  
 a. **01**  
 b. \_\_\_\_\_  
 c. \_\_\_\_\_  
 d. \_\_\_\_\_

Do Not Write Below This Line

**UNIFORM HAZARDOUS WASTE MANIFEST**

1. Generator's US EPA ID No. **C A C 0 0 0 2 9 1 6 6 5** Manifest Document No. **2**

2. Page 1 of 1 Information in the shaded areas is not required by Federal law.

3. Generator's Name and Mailing Address  
**GOLDEN GATE ACADEMY**  
**3800 Mountain Blvd., Oakland, CA 94619**

A. State Manifest Document Number  
**89928829**

4. Generator's Phone **(415) 531-0110**

B. State Generator's ID

5. Transporter 1 Company Name  
**H & H Ship Service Company**

6. US EPA ID Number  
**C A D 0 0 4 7 7 1 1 6 8**

C. State Transporter's ID **103767**  
 D. Transporter's Phone **(415) 543-4835**

7. Transporter 2 Company Name

8. US EPA ID Number

E. State Transporter's ID  
 F. Transporter's Phone

8. Designated Facility Name and Site Address  
**H & H Ship Service Company**  
**220 China Basin Street**  
**San Francisco, CA 94107**

10. US EPA ID Number  
**C A D 0 0 4 7 7 1 1 6 8**

G. State Facility's ID  
**C A D 0 0 4 7 7 1 1 6 8**

H. Facility's Phone  
**(415) 543-4835**

11. US DOT Description (Including Proper Shipping Name, Hazard Class, and ID Number)

12. Containers No. Type  
 13. Total Quantity  
 14. Unit Wt/Vol  
 Waste No. State **512**

a. **RESIDUE GASOLINE TANK**  
**NON-RCRA HAZARDOUS WASTE SOLID**

**0 0 1 T P 0 1 0 0 0 P**

b.

**1 1 5 1 6 1 B**

c. **RESIDUE Product Pipe**

d.

J. Additional Descriptions for Materials Listed Above  
**PUMPED OUT 1,000 gallon tank last containing gasoline. Tank inerted with dry ice for transport.**

K. Handling Codes for Wastes Listed Above  
 a. **01**  
 b.  
 c.  
 d.

15. Special Handling Instructions and Additional Information  
**JOB #4904**  
**APPROPRIATE PROTECTIVE CLOTHING AND RESPIRATOR.**

16. GENERATOR'S CERTIFICATION: I hereby declare that the contents of this consignment are fully and accurately described above by proper shipping name and are classified, packed, marked, and labeled, and are in all respects in proper condition for transport by highway according to applicable international and national government regulations.  
 If I am a large quantity generator, I certify that I have a program in place to reduce the volume and toxicity of waste generated to the degree I have determined to be economically practicable and that I have selected the practicable method of treatment, storage, or disposal currently available to me which minimizes the present and future threat to human health and the environment; OR, if I am a small quantity generator, I have made a good faith effort to minimize my waste generation and select the best waste management method that is available to me and that I can afford.

Printed/Typed Name **Kirk Kent** Signature *Kirk Kent* Month Day Year **0 7 0 5 9 0**

17. Transporter 1 Acknowledgement of Receipt of Materials  
 Printed/Typed Name **RAYMOND L. JIMENEZ** Signature *Raymond Jimenez* Month Day Year **0 7 0 5 9 0**

18. Transporter 2 Acknowledgement of Receipt of Materials  
 Printed/Typed Name Signature Month Day Year

19. Discrepancy Indication Space

20. Facility Owner or Operator Certification of receipt of hazardous materials covered by this manifest except as noted in Item 19.  
 Printed/Typed Name **Deborah Valey** Signature *Deborah Valey* Month Day Year **0 7 0 5 9 0**

Do Not Write Below This Line  
 White: ISS SENDS THIS COPY TO DOHS WITHIN 30 DAYS  
 To: P.O. Box 3000, Sacramento, CA 95812

89928829  
 IN CASE OF AN EMERGENCY OR SPILL, CALL THE NATIONAL RESPONSE CENTER 1-800-424-8802; WITHIN CALIFORNIA CALL 1-800-852-7550  
 GENERATOR

To: Juliet Shin

From: Joyce Y. Lee

Ref: Map of Golden Gate Academy

Fax 510 337-9335

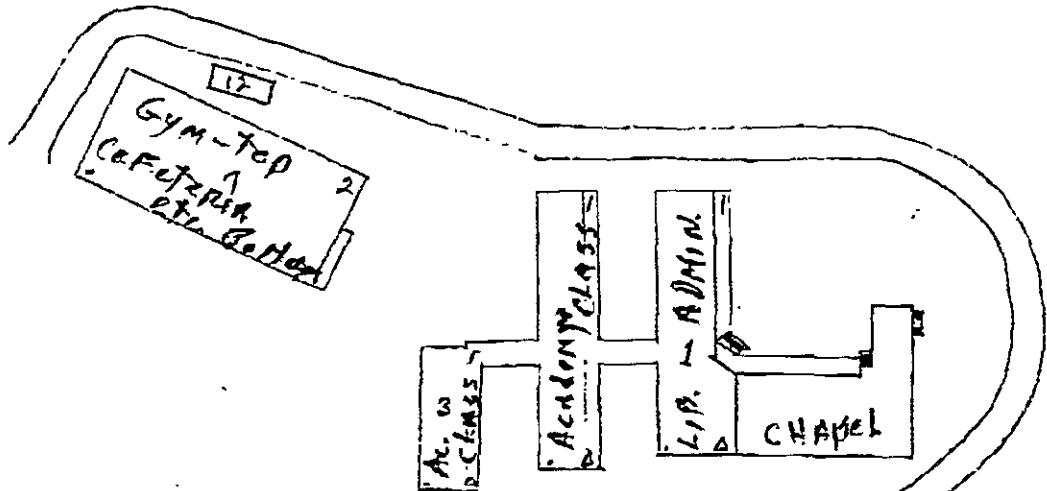
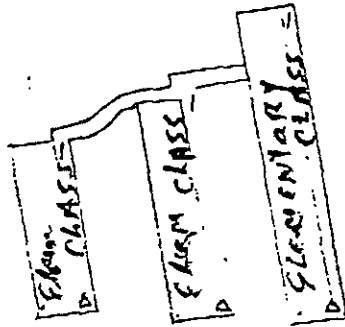

GOLDEN GATE ACADEMY  
 3800 MOUNTAIN BLVD  
 OAKLAND CALIFORNIA  
 NO SCALE

SURVEY 61-020

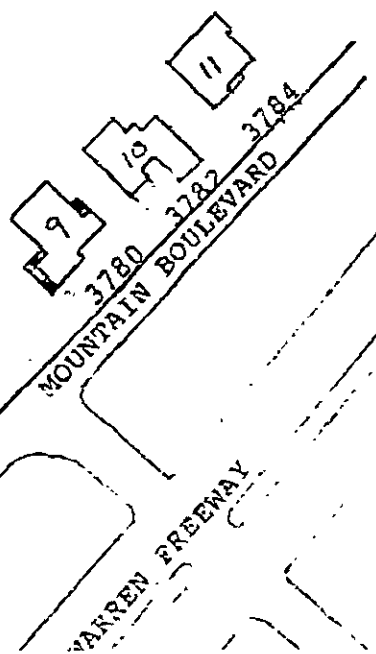

Revised 5-01 1.