

BSK & Associates

1181 Quarry Lane, Building 300 - Pleasanton, CA 94566

Tel: (510) 462-4000

Fax: (510) 462-6283

FACSIMILE TRANSMITTAL

DATE: August 20, 1996

TO: Juliet Shin

COMPANY: Alameda County Health Care Services

Phone (510) 567-6763

Facsimile (510) 337-9335

FROM: Khaled Rahman

PAGES: 2 Including Cover Sheet

Re: Joe Sio Chevrolet, 914-916 San Pablo Avenue, Albany, California

Comments:

Juliet,

Attached for your review is a site plan with three proposed geoprobe sampling locations. As discussed during our July 30, 1996 telephone conversation, the sampling locations are positioned (1) between well MW-1 and the building, (2) between well MW-1 and the southern property boundary, and (3) adjacent to well MW-2.

I am hoping to mark these locations for utility survey this week. Please give me a call with any comments at your earliest convenience.

Thank you,

Khaled 

If you do not receive all the indicated pages, please give us a call.

The information contained in this facsimile message may be confidential, proprietary and/or legally privileged information intended only for the use of the individual or entity named below. If the reader of this message is not the intended recipient, you are hereby notified that any copying, dissemination or distribution of confidential, proprietary or privileged information is strictly prohibited. If you have received this communication in error, please immediately notify the sender by telephone, and we will arrange for the return of the facsimile. Thank you.

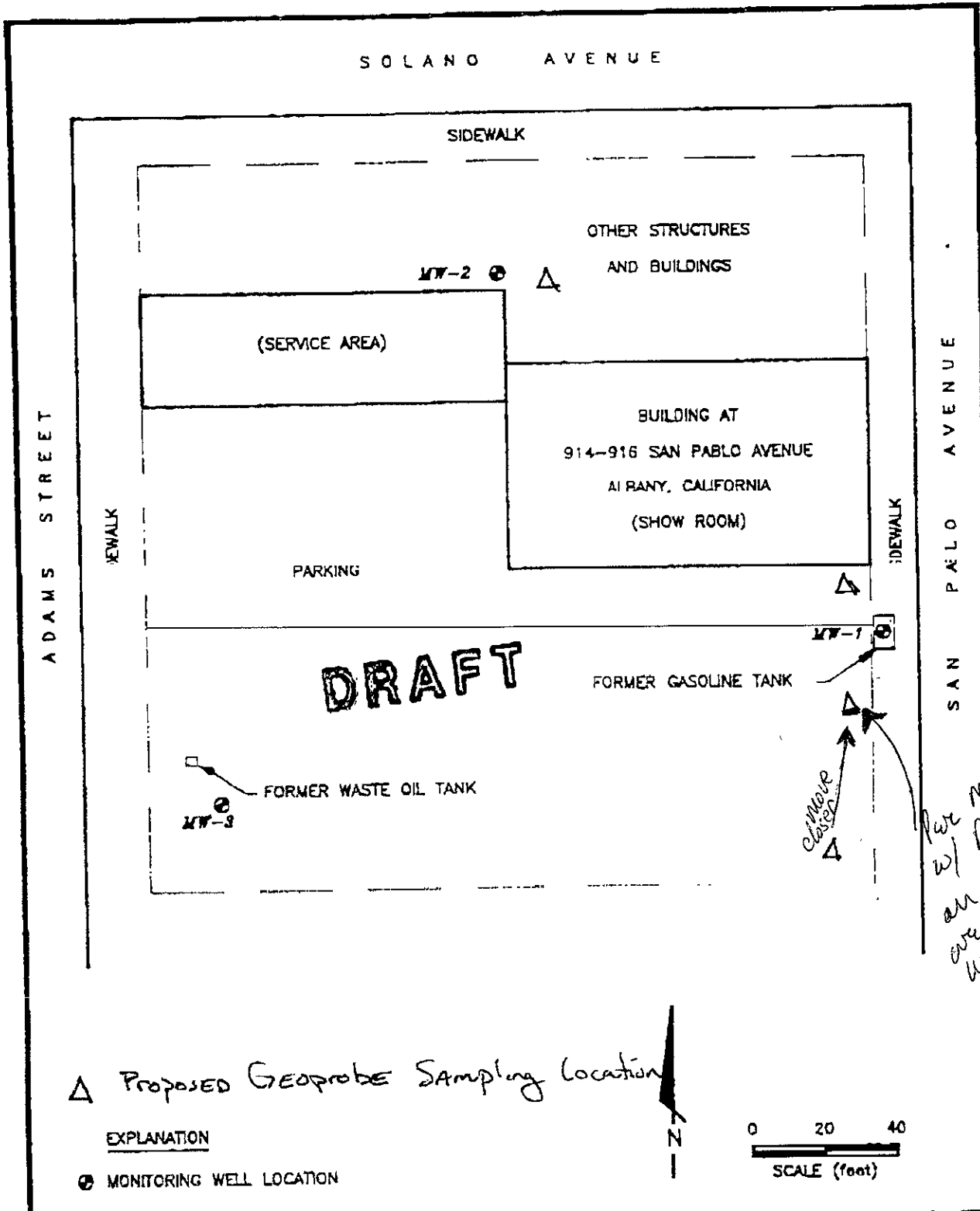

Per my conversation w/ Mr. Rahman on 8/22/96 this well location will be moved between 20 to 40' away from MW1 - gms

△ Proposed Geoprobe Sampling Location

EXPLANATION

⊙ MONITORING WELL LOCATION

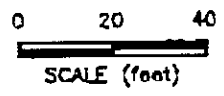

PHILIP ENVIRONMENTAL	SITE PLAN Joe Sio Chevrolet 914 - 916 San Pablo Avenue Albany, California	Figure 2	
	Reviewed By :	Date :	Project No. 12104 Drawn By: SWW Date: 3/12/93 Drawing No. ASI00102

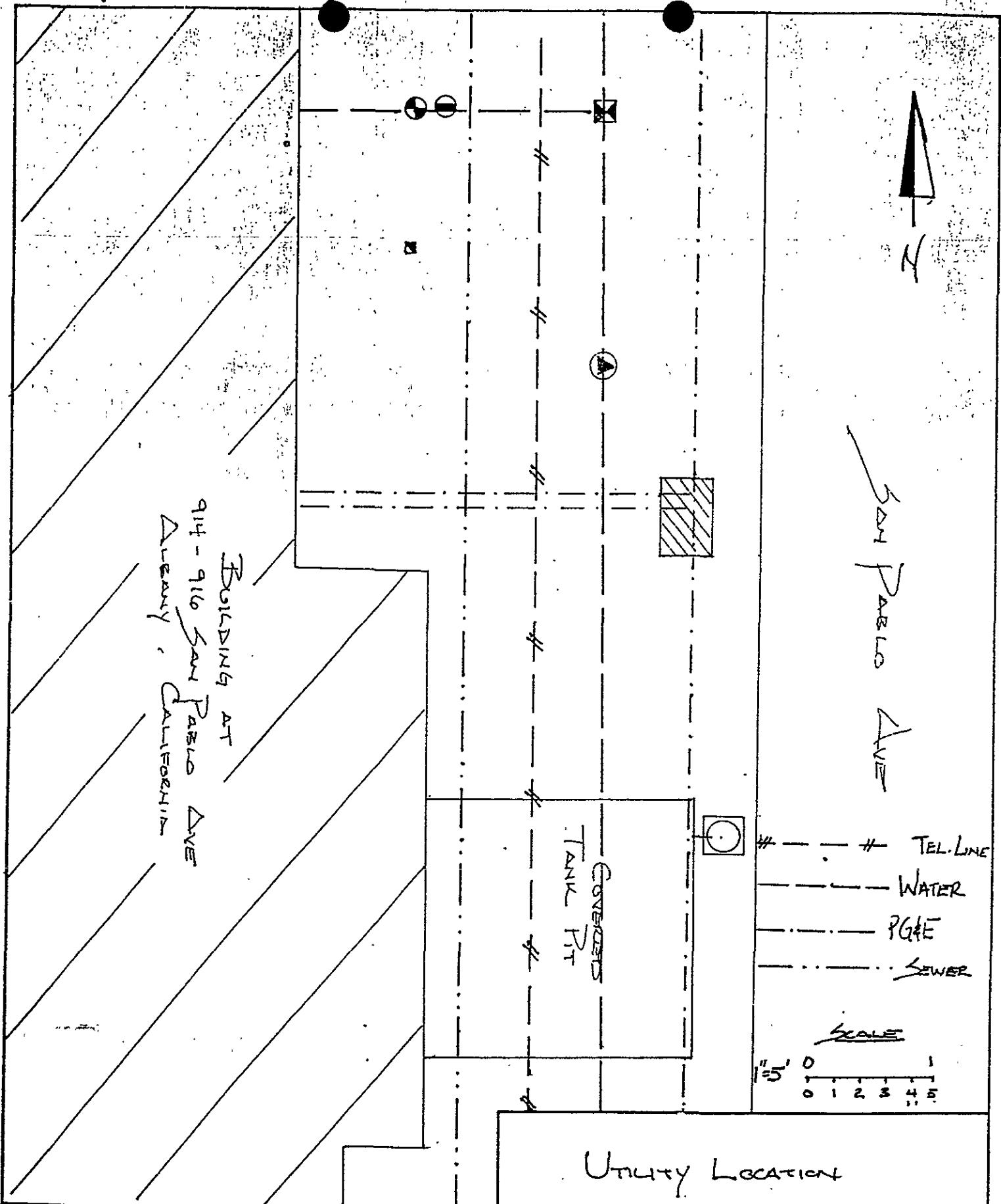

UTILITY LOCATION		PLATE 1
J. DIBBLE		
JOB NUMBER 9124	DATE 1-8-91	

ATT Aqua Terra Technologies
 Consulting Engineers
 & Scientists

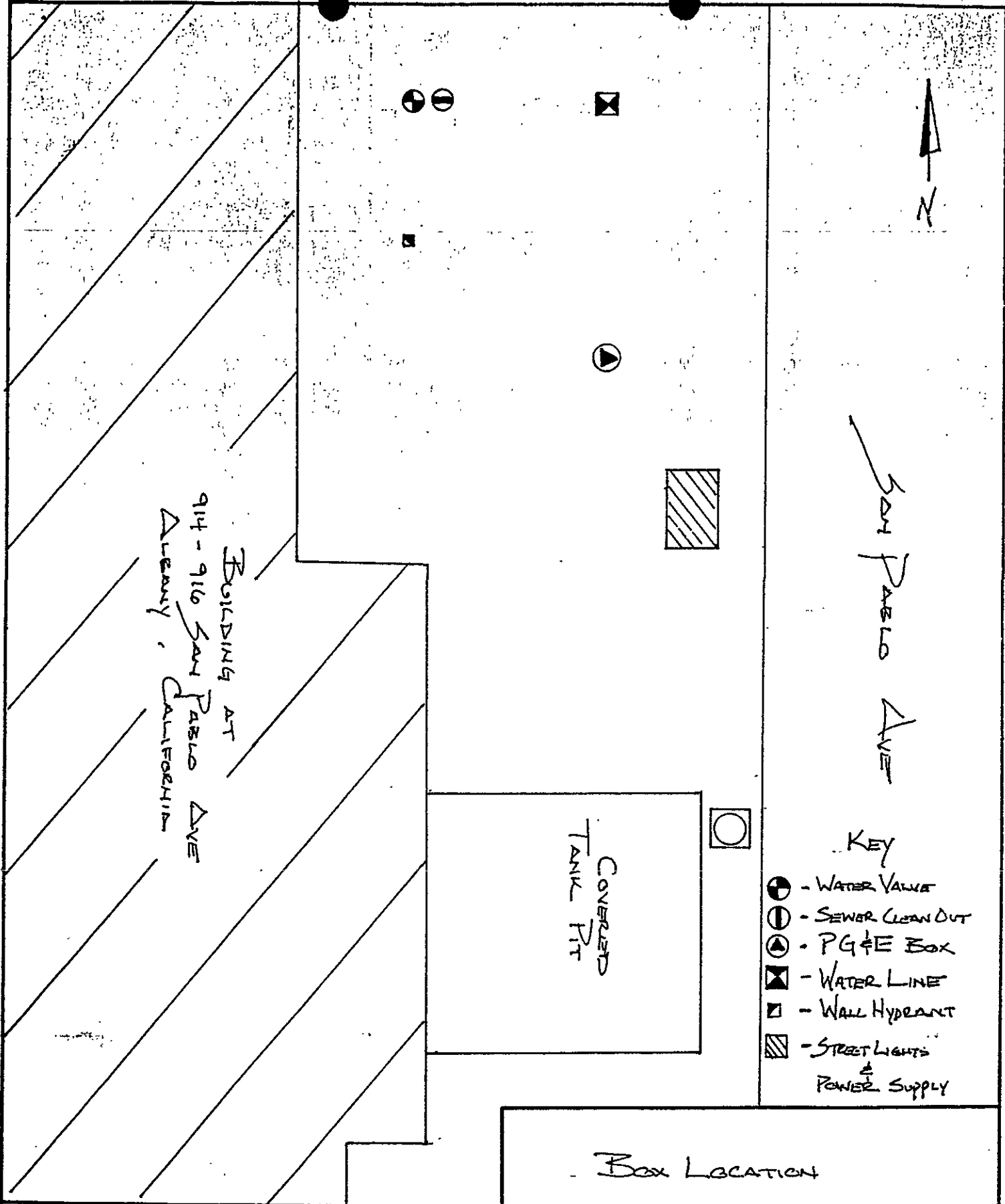

Key

- ⊕ - WATER VALVE
- ⊖ - SEWER CLEAN OUT
- ⊙ - PG&E BOX
- ⊠ - WATER LINE
- ⊡ - WALL HYDRANT
- ▨ - STREET LIGHTS & POWER SUPPLY

Box Location

ATT

Aqua Terra Technologies
Consulting Engineers
& Scientists

J. DIBBLE

JOB NUMBER

9124

DATE

1-8-91

PLATE

2