

**SCOTT CO.**

MECHANICAL CONTRACTORS  
1919 Market Street  
P.O. Box 12954  
Oakland, California 94604  
(415) 834-2333

Contractors License No. 184480

**TELECOPY COVER SHEET**

DATE: 12-19-91

COMPANY TO: Alameda County Environmental Health

ATTENTION: Susan Hargo

FROM: Michael Schwickerath - Staff

NUMBER OF PAGES BEING SENT (INCLUDING THIS COVER SHEET). 5

PLEASE CONTACT Michael AT (415 834-2333, EXT. 3455  
IF YOU HAVE ANY QUESTIONS.

SCOTT CO. FAX FOR 2014 MARKET STREET (THIS LOCATION) IS (415) 763-0106.

COMMENTS:



November 27, 1991  
Sample Log 3575

Paul Ferreira  
Scott Company  
1919 Market Street  
Oakland, CA 94607

Subject: Analytical Results for 3 Soil sample(s)  
Identified as: Coulter Steel  
Received: 11/26/91  
Purchase Order: 95332-50680-73-7001

Dear Mr. Ferreira:

Analysis of the sample(s) referenced above has been completed. This report is written to confirm results communicated on November 27, 1991 and describes procedures used to analyze the samples.

Sample(s) were received in brass sleeves that were sealed with PTFE sheets and plastic endcaps. Each sample was transported and received under documented chain of custody and stored at 4 degrees C until analysis was performed.

Sample(s) were analyzed using the following method(s):

"TPH as Diesel, Motor Oil, Jet/Kerosene" (Mod. 8015/Extraction)

Please refer to the following table(s) for summarized analytical results and contact us at 916-757-4650 if you have questions regarding procedures or results. The chain-of-custody document is enclosed.

Approved by:

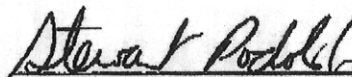
  
Stewart Podolsky  
Senior Chemist

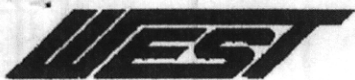

November 27, 1991  
Sample Log 3575

Table 1: TPH Results for 3 Soil Sample(s)  
From : Coulter Steel  
Received 11/26/91

--all concentrations are units of mg/kg--

Sample	Product ID and Conc.
S1	Diesel: 630 Motor Oil: <10
S4	Diesel: 670 Motor Oil: <10
Composite 1	Diesel: 1300 Motor Oil: <10
1A	
1B	
1C	
1D	
(Reporting Limit	10)

page 2

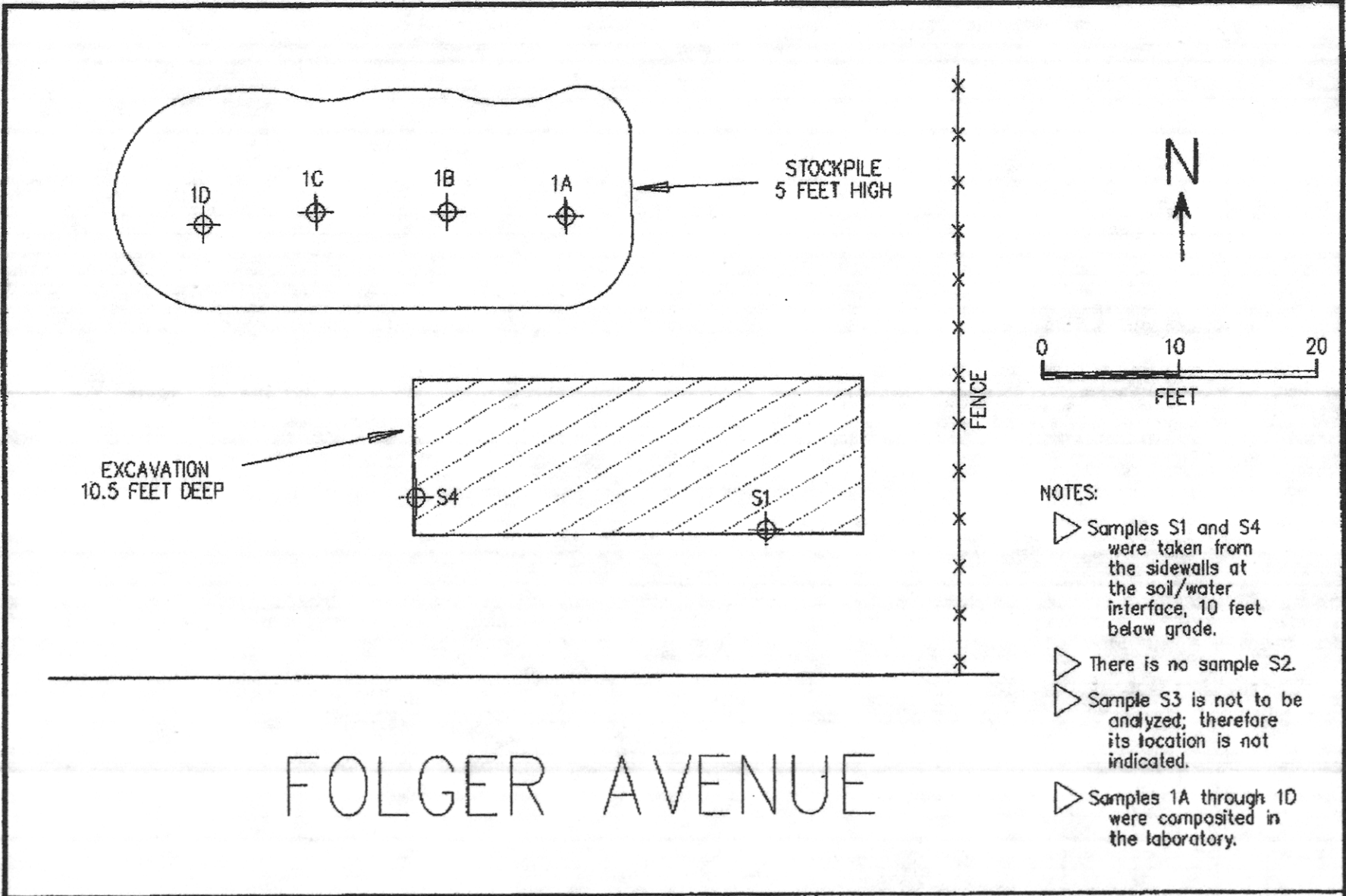

- NOTES:
- ▷ Samples S1 and S4 were taken from the sidewalls at the soil/water interface, 10 feet below grade.
  - ▷ There is no sample S2.
  - ▷ Sample S3 is not to be analyzed; therefore its location is not indicated.
  - ▷ Samples 1A through 1D were composited in the laboratory.

COULTER STEEL (SCOTT CO.) 722 FOLGER AVENUE BERKELEY, CALIFORNIA	Sample Log#: 3575 DATE: 11/26/1991	 Western Environmental Science & Technology 1046 Olive Drive #3, Davis, CA 95616 Phone: (916) 753-9500 Drawn by: TGT
	SCALE 1:120	



Western Environmental  
Science & Technology

1046 Olive Drive, Suite 3  
Davis, CA 95616

916-753-9500  
FAX #: 916-753-6091

### CHAIN-OF-CUSTODY RECORD AND ANALYSIS REQUEST

Project Manager: **Paul Ferreira** Phone #: **(510)834-2333**

Address: **Scott Co.** FAX #:

**1919 Market St., Oakland**

Project Number: **P.O.# 95332-50680-73-7001** Project Name: **Coulter Steel**

Project Location: **722 Folger Ave. Berkeley, CA** Sampler Signature: **Judy J. Supun**

#### ANALYSIS REQUEST

#### OTHER

#### SPECIAL HANDLING

Sample ID	Lab # (Lab use only)	# CONTAINERS	Volume/Amount	Matrix			Method Preserved					Sampling		BTEX (602/6020)	BTEX/TPH as Gasoline (602/6020/6015)	TPH as Diesel (8015 or 8270)	TPH as Jetfuel (8015 or 8270)	Total Oil & Grease (413.1)	Total Oil & Grease (413.2)	Total Petroleum Hydrocarbons (413.1)	EPA 601/6010	EPA 602/6020	EPA 608/6080	EPA 608/6080-PCBs Only	EPA 624/6240	EPA 625/6270	CAM - 17 Metals	Waste Extraction Test (WET)	EPA - Priority Pollutant Metals	LEAD(74207421/239.2)	ORGANIC LEAD					RUSH SERVICE (12 hr) or (24 hr)	EXPEDITED SERVICE (48 hr) or (1 wk)	VERBALS/FAX	SPECIAL DETECTION LIMITS (SPECIFY)	SPECIAL REPORTING REQUIREMENTS				
				WATER	SOIL	AIR	SLUDGE	OTHER	HCl	HNO <sub>3</sub>	ICE	NONE	OTHER																												DATE	TIME		
S1		1	---	X									11-26-91	15:45		X																												
<del>S3</del>		<del>1</del>	<del>---</del>	<del>X</del>												<del>X</del>																												
S4		1	---	X									↓	15:35		X																												
1A		1	---	X									11-26-91	16:13																														
1B		1	---	X									↓	16:11		X																												
1C		1	---	X									↓	16:10																														
1D		1	---	X									↓	16:08																														

Relinquished by: **Judy J. Supun** Date Time: **11-26-91 17:55** Received by: \_\_\_\_\_

Relinquished by: \_\_\_\_\_ Date Time: \_\_\_\_\_ Received by: \_\_\_\_\_

Relinquished by: \_\_\_\_\_ Date Time: **11/28/91 17:55** Received by Laboratory: \_\_\_\_\_

Remarks: **Composite Samples 1A, 1B, 1C, 1D**  
**48 hr TAT**  
**Sampling & Transport: 3.5 hrs.**

\*\* TOTAL PAGE.005 \*\*

DEC 19 '91 11:14 FROM SCOTT-COMPANY SERVICE PAGE.005



1046 Olive Drive, Suite 3  
Davis, CA 95616

916-753-9500  
FAX #: 916-753-6091  
LAB#: 916-757-4650

### CHAIN-OF-CUSTODY RECORD AND ANALYSIS REQUEST

Project Manager: Paul Ferreira Phone #: (510) 834-2333 <sup>13455</sup>

Company/Address: SCOTT CO. FAX #:  
1914 Market St.  
Oakland, CA.

Project Number: 95302-52630 P.O.#:  
Project Name: Coulter Steel

Project Location: Coulter Steel Sampler Signature: [Signature]  
322 Fulger Ave.  
Rockledge, CA.

#### ANALYSIS REQUEST

TAT

Sample ID	Sampling		Container				Method Preserved				Matrix		BTEX (602/8020)	BTEX/TPH as Gasoline (602/8020/8015)	TPH as Diesel/Oil (8015)	Total Oil & Grease (5520 B/E/F)	Total Oil & Grease IR (5520 B/E/F,C)	96 - Hour Fish Bioassay	EPA 601/8010	EPA 602/8020	EPA 615/8150	EPA 608/8080 - Pesticides	EPA 609/8090-PCBs	EPA 624/8240	EPA 625/8270	ORGANIC LEAD	Reactivity, Corrosivity, Ignitibility	CAM - 17 Metals	EPA - Priority Pollutant Metals	LEAD(7420/7421/239.2)	Cd, Cr, Pb, Zn, Ni	RUSH SERVICE (12 hr) or (24 hr)	EXPEDITED SERVICE (48 hr) or (1 wk)	STANDARD SERVICE (2WR)		
	DATE	TIME	VOA	SLEEVE	1L GLASS	1L PLASTIC	HCl	HNO3	ICE	NONE	WATER	SOIL																								
CS-1	12/19/91	12:40	X	X				X			X		X																							
CS-2	12/19/91	12:45	X	X				X			X		X																							
CS-3	12/19/91	12:50	X	X				X			X		X																							
CS-4	12/19/91	12:55	X	X				X			X		X																							
CS-5	12/19/91	13:00	X	X				X			X		X																							
CS-6	12/19/91	13:05	X	X				X			X		X																							
CS-7	12/19/91	13:10	X	X				X			X		X																							

W.E.T. (✓)  
TOTAL (✓)

Relinquished by:	Date Time	Received by:	Remarks: <u>W/OUT BTEX TO ALL</u> <u>Call for Rest of</u> <u>P.O.# on 12/20/91.</u>
Relinquished by	Date Time	Received by:	
Relinquished by <u>[Signature]</u>	Date Time <u>12/19/91/13:45</u>	Received by Laboratory <u>[Signature]</u>	
Bill To:			<u>SCOTT CO.</u>

TAT: 48 HRS  
L/T: 3 1/2 HRS.