

ALAMEDA COUNTY HEALTH CARE SERVICES AGENCY  
 DEPARTMENT OF ENVIRONMENTAL HEALTH  
 HAZARDOUS MATERIALS DIVISION  
 80 SWAN WAY, ROOM 200  
 OAKLAND, CA 94621  
 PHONE NO. 415/271-4320

STAMPED

ACCEPTED

DEPARTMENT OF ENVIRONMENTAL HEALTH  
 470 - 27th Street, Third Floor  
 Oakland, CA 94612  
 Telephone: (415) 874-7237

These plans have been reviewed and found to be acceptable and essentially meet the requirements of State and local health laws. Changes to your plans indicated by this Department are to assure compliance with State and local laws. The project proposed herein is now released for issuance of any required building permits for construction. One copy of these accepted plans must be on the job and available to all contractors and craftsmen involved with the removal.

Any change or alterations of these plans and specifications must be submitted to this Department and to the Fire and Building Inspection Department to determine if such changes meet the requirements of State and local laws. Notify this Department at least 48 hours prior to the following required inspections:

- \_\_\_\_\_ Removal of Tank and Piping
  - \_\_\_\_\_ Sampling
  - \_\_\_\_\_ Final Inspection
- Issuance of a permit to operate is dependent on compliance with accepted plans and all applicable laws and regulations.

THERE IS A FINANCIAL PENALTY FOR NOT OBTAINING THESE INSPECTIONS.

**UNDERGROUND TANK CLOSURE PLAN**

**\* \* \* Complete according to attached instructions \* \* \***

Project Specialist (print)

1. Business Name ALAMEDA UNIFIED SCHOOL DISTRICT CORPORATØN XX YARD  
 Business Owner ALAMEDA UNIFIED SCHOOL DISTRICT

2. Site Address 2615 EAGLE AVENUE  
 city ALAMEDA Zip 94501 Phone 748-4090

3. Mailing Address 2200 CENTRAL AVENUE  
 city ALAMEDA Zip 94501 Phone 748-4090

4. Land Owner ALAMEDA UNIFIED SCHOOL DISTRICT  
 Address 2200 CENTRAL AVE. ALAMEDA City, State CA zip 94501

5. Generator name under which tank will be manifested ALAMEDA UNIFIED SCHOOL DISTRICT

EPA I.D. No. under which tank will be manifested CAD 981666001

6. Contractor SEMCO  
Address 1741 LESLIE STREET,  
City SAN MATEO CAKIFORNIA 94402 Phone 572-8033  
License Type A,B,C-61/D-40 ID# 449864

7. Consultant N/A  
Address \_\_\_\_\_  
City \_\_\_\_\_ Phone \_\_\_\_\_

8. Contact Person for Investigation  
Name CHUCK KIPER Title VICE-PRESIDENT  
Phone 572-8033

9. Number of tanks being closed under this plan 1  
Length of piping being removed under this plan UNKNOWN  
Total number of tanks at facility 1

10. State Registered Hazardous Waste Transporters/Facilities (see instructions).

**\*\* Underground tanks are hazardous waste and must be handled \*\*  
as hazardous waste**

a) Product/Residual Sludge/Rinsate Transporter

Name ALLIED PETROLEUM EPA I.D. No. CAD98065675128  
Hauler License No. 1168 License Exp. Date 4/30/92  
Address P.O. BOX 193  
City HILMAR State CA Zip 95327

b) Product/Residual Sludge/Rinsate Disposal Site

Name REFINERIES SERVICES EPA I.D. No. CAD83166728  
Address 13331 WEST HWY, 33  
City PATTERSON State CA Zip 95363

c) Tank and Piping Transporter

Name RHT TRUCKING EPA I.D. No. CAD 082071501  
Hauler License No. 2753 License Exp. Date 4/30/92  
Address 1336 PAULINE  
city MODESTO State CA Zip 95351

d) Tank and Piping Disposal Site

Name ERICKSON, INC. EPA I.D. No. CAD 009466302  
Address 255 PARR BLVD.  
city RICHMOND State CA Zip (94801)

11. Experienced Sample Collector

Name CHUCK KIPER  
Company SEMCO  
Address 1741 LESLIE STREET  
city SAN MATEO State CA Zip 94402 Phone (415) 572-8033

12. Laboratory

Name SUPERIOR PRECISION ANALYTICAL  
Address 1555 BURKE UNIT I  
city SAN FRANCISCO State CA Zip 94124  
State Certification No. 1332 & 319

13. Have tanks or pipes leaked in the past? Yes [ ] No [ <sup>XX</sup> ]

If yes, describe. \_\_\_\_\_  
\_\_\_\_\_  
\_\_\_\_\_

14. Describe methods to be used for rendering tank inert  
**HIGH PRESSURE HOT WATER DETERGENT WASH**

20 LBS PER 1000 GALLONS DRY ICE

FINAL PURGE WITH AIR

Before tanks are pumped out and inerted, all associated piping must be flushed out into the tanks. All accessible associated piping must then be removed. Inaccessible piping must be plugged.

The Bay Area Air Quality Management District (771-6000), along with local Fire and Building Departments, must also be contacted for tank removal permits. Fire departments typically require the use of explosion proof combustible gas meters to verify tank inertness. It is the contractor's responsibility to bring a working combustible gas meter on site to verify tank inertness.

15. Tank History and Sampling Information

Tank		Material to be sampled (tank contents, soil, ground-water, etc.)	Location and Depth of Samples
Capacity	Use History (see instructions)		
500	GASOLINE	SOIL/WATER	2 FEET BELOW FILLEND OF TANK IN NATIVE SOIL  EVERY 20 FT OF PIPING IF APPLICABLE

One soil sample must be collected for every 20 feet of piping that is removed. A ground water sample must be collected should any ground water be present in the excavation.

Excavated/Stockpiled Soil	
Stockpiled Soil Volume (Estimated)  UNDETERMINED	Sampling Plan SAMPLES TAKEN FROM THE EXCAVATION WILL BE COLLECTED PLACED IN BRASS TUBES, SEALED WITH FOIL, TEFLON CAP TRANSPORTED TO A STATE CERTIFIED LAB UNDER CHAIN OF CUSTODY AND ANALYZED FOR THE CONSTITUENTS OF THE TANK <i>Identify how many samples would be taken per 100 cubic yard</i>

Stockpiled soil must be placed on bermed plastic and must be completely covered by plastic sheeting.

16. Chemical methods and associated detection limits to be used for analyzing samples

The Tri-Regional Board recommended minimum verification analyses and practical quantitation reporting limits should be followed. See attached Table 2.

Contaminant Sought	EPA, DHS, or Other Sample Preparation Method Number	EPA, DHS, or Other Analysis Method Number	Method Detection Limit
TPH G BTXE	GCFID (5030) 8020 OR 8240		
TPH/BTXE	8260		

17. Submit Site Health and Safety Plan (See Instructions)

18. Submit Worker's Compensation Certificate copy

Name of Insurer FAIRMONT INSURANCE COMPANY

19. Submit Plot Plan (See Instructions)

20. Enclose Deposit (See Instructions)

21. Report any leaks or contamination to this office within 5 days of discovery. The report shall be made on an Underground Storage Tank Unauthorized Leak/Contamination Site Report form. (see Instructions)

22. Submit a closure report to this office within 60 days of the tank removal. This report must contain all the information listed in item 22 of the instructions.

I declare that to the best of my knowledge and belief the statements and information provided above are correct and true.

I understand that information in addition to that provided above may be needed in order to obtain an approval from the Department of Environmental Health and that no work is to begin on this project until this plan is approved.

I understand that any changes in design, materials or equipment will void this plan if prior approval is not obtained.

I understand that all work performed during this project will be done in compliance with all applicable OSHA (Occupational Safety and Health Administration) requirements concerning personnel health and safety. I understand that site and worker safety are solely the responsibility of the property owner or his agent and that this responsibility is not shared nor assumed by the County of Alameda.

Once I have received my stamped, accepted closure plan, I will contact the project Hazardous Materials Specialist at least three working days in advance of site work to schedule the required inspections.

Signature of Contractor

Name (please type) CHUCK KIPER

Signature Chuck Kiper

Date 12/17/91

Signature of Site Owner or Operator

Name (please type) DONALD DIEL

Signature Donald Diel

Date 12/17/91

## INSTRUCTIONS

### General Instructions

- \* Three (3) copies of this plan plus attachments and deposit must be submitted to this Department.
- \* Any cutting into tanks requires local fire department approval.
- \* One complete copy of your approved plan must be at the construction site at all times; a copy of your approved plan must also be sent to the landowner.

### Item Specific Instructions

2. SITE ADDRESS  
Address at which closure is taking place.
5. EPA I.D. NO. under which the tanks will be manifested  
EPA I.D. numbers may be obtained from the State Department of Health Services, 916/324-1781.
6. CONTRACTOR  
Prime contractor for the project.
10. STATE REGISTERED HAZARDOUS WASTE TRANSPORTERS/FACILITIES
  - a) All residual liquids and sludges are to be removed from tanks before tanks are inerted.
  - c) Tanks must be hauled as hazardous waste.
  - d) This is the place where tanks will be taken for cleaning.
15. TANK HISTORY AND SAMPLING INFORMATION  
Use History - This information is essential and must be accurate. Include tank installation date, products stored in the tank, and the date when the tank was last used.  
  
Material to be sampled - e.g. water, oil, sludge, soil, etc.  
  
Location and depth of samples - e.g. beneath the tank a maximum of two feet below the native soil/backfill interface, side wall at the high water mark, etc.

17. SITE HEALTH AND SAFETY PLAN

A site specific Health and Safety plan must be submitted. We advocate the site health and safety plan include the following items, at a minimum:

- a) The name and responsibilities of the site health and safety officer;
- b) Identification of health and safety hazards of each work task. Include potential fire, explosion, physical, and chemical hazards;
- c) An outline of briefings to be held before work each day to appraise employees of site health and safety hazards;
- d) Frequency and types of air and personnel monitoring to be used - along with the environmental sampling techniques and instrumentation. Include instrumentation maintenance and calibration methods and frequencies;
- e) Specific personal protective equipment and procedures to be used by workers to protect themselves from the identified hazards. Also state the contaminant concentrations in air - or other conditions - which will trigger changes in work or work habits to ensure workers are not exposed to high levels of hazardous chemicals or to other unsafe conditions;
- f) Confined space entry procedures (if applicable);
- g) Decontamination procedures;
- h) Measures to be taken to secure the site, excavation and stockpiled soil during and after work hours (e.g. barricades, caution tape, fencing, trench plates, security guards, etc.);
- i) Spill containment and emergency/contingency plan. Be sure to include emergency phone numbers, the location of the phone nearest the site, and directions to the hospital nearest the site;
- j) Documentation that all site workers have received the appropriate OSHA approved trainings and participate in appropriate medical surveillance per 29 CFR 1910.120; and
- k) Page **for** employees to sign indicating they have read and will comply with the site health and safety plan.

The safety plan must be distributed to all employees and contractors working in hazardous waste operations on site. A **complete copy of the site health and safety plan along with any standard operating procedures shall be on site and accessible at all times.**



NOTE: These requirements are excerpts from 29 CFR Part 1910.120, Hazardous Waste Operations and Emergency Response; Final Rule, March 6, 1989. Safety plans of certain underground tank sites may need to meet the complete requirements of this Rule.

19. PLOT PLAN

The plan should consist of a scaled view of the facility at which the tank(s) are located and should include the following information:

- a) Scale;
- b) North Arrow;
- c) Property Lines;
- d) Location of all Structures;
- e) Location of all relevant existing equipment including tanks and piping to be removed and dispensers;
- f) Streets;
- g) Underground conduits, sewers, water lines, utilities;
- h) Existing wells (drinking, monitoring, etc.);
- i) Depth to ground water; and
- j) All existing tanks and piping in addition to the ones being pulled.

20. DEPOSIT

A deposit, payable to Alameda County for the amount indicated on the Alameda County Underground Storage Tank Fee Schedule, must accompany the plans.

21. Blank Unauthorized Leak/Contamination Site Report forms may be obtained in limited quantities from our office and from the San Francisco Bay Regional Water Quality Control Board (415/464-1255). Larger quantities may be obtained directly from the State Water Resources Control Board at (916) 739-2421.

22. TANK CLOSURE REPORT

The tank closure report should contain the following information:

- a) General description of the closure activities;
- b) Description of tank, fittings and piping conditions. Indicate tank size and former contents; note any corrosion, pitting, holes, etc.;

- c) Description of the excavation itself. Include the tank and excavation depth, a log of the stratigraphic units encountered within the excavation, a description of root holes or other potential contaminant pathways, the depth to any observed ground water, descriptions and locations of stained or odor-bearing soil, and descriptions of any observed free product or sheen;
- d) Description of sampling methods;
- e) Description of any remedial measures conducted at the time of tank removal;
- f) To-scale figures showing the excavation size and depth, nearby buildings, sample locations and depths, and tank and piping locations. Include a copy of the plot plan prepared for the Tank Closure Plan under item 19;
- g) Chain of custody records;
- h) Copies of signed laboratory reports;
- i) Copies of "TSDF to Generator" Manifests for all hazardous wastes hauled offsite (sludge, rinsate, tanks and piping, contaminated soil, etc.); and
- j) Tabulation of the volume and final destination of all non-manifested contaminated soil hauled offsite.

**TABLE #2**  
**RECOMMENDED MINIMUM VERIFICATION ANALYSES FOR**  
**UNDERGROUND TANK LEAKS**

<u>HYDROCARBON LEAK</u>	<u>SOIL ANALYSIS</u>	<u>WATER ANALYSIS</u>
Unknown Fuel	TPH G      GCFID(5030) TPH D      GCFID(3550) BTX&E      8020 or 8240 TPH AND BTX&E 8260	TPH G      GCFID(5030) TPH D      GCFID(3510) BTX&E      602, 624 or 8260
Leaded Gas	TPH G      GCFID(5030) BTX&E      8020 OR 8240 TPH AND BTX&E 8260 TOTAL LEAD AA -----Optional----- TEL          DHS-LUFT EDB          DHS-AB1803	TPH G      GCFID(5030) BTX&E      602 or 624 TOTAL LEAD AA  TEL          DHS-LUFT EDB          DHS-AB1803
Unleaded Gas	TPH G      GCFID(5030) BTX&E      8020 or 8240 TPH AND BTX&E 8260	TPH G      GCFID(5030) BTX&E      602, 624 or 8260
Diesel, Jet Fuel and Kerosene	TPH D      GCFID(3550) BTX&E      8020 or 8240 TPH AND BTX&E 8260	TPH D      GCFID(3510) BTX&E      602, 624 or 8260
Fuel/Heating Oil	TPH D      GCFID(3550) BTX&E      8020 or 8240 TPH AND BTX&E 8260	TPH D      GCFID(3510) BTX&E      602, 624 or 8260
Chlorinated Solvents	CL HC      8010 or 8240 BTX&E      8020 or 8240 CL HC AND BTX&E 8260	CL HC      601 or 624 BTX&E      602 or 624 CL HC AND BTX&E 8260
Non-chlorinated Solvents	TPH D      GCFID(3550) BTX&E      8020 or 8240 TPH AND BTX&E 8260	TPH D      GCFID(3510) BTX&E      602 or 624 TPH and BTX&E 8260
Waste and Used Oil or Unknown (All analyses must be completed and submitted)	TPH G      GCFID(5030) TPH D      GCFID(3550) TPH AND BTX&E 8260 O & G      5520 D & F BTX&E      8020 or 8240  CL HC      8010 or 8240	TPH G      GCFID(5030) TPH D      GCFID(3510)  O & G      5520 C & F BTX&E      602, 624 or 8260 CL HC      601 or 624
	ICAP or AA TO DETECT METALS: Cd, Cr, Pb, Zn, Ni METHOD 8270 FOR SOIL OR WATER TO DETECT: PCB* PCP* PNA CREOSOTE	PCB PCP PNA CREOSOTE

\* If found, analyze for dibenzofurans (PCBs) or dioxins (PCP)

Reference: Tri-Regional Board Staff Recommendations for Preliminary  
Evaluation and Investigation of Underground Tank Sites,  
10 August 1990

EXPLANATION FOR TABLE #2: MINIMUM VERIFICATION ANALYSIS

1. OTHER METHODOLOGIES are continually being developed and as methods are accepted by EPA or DHS, they also can be used.
2. For DRINKING WATER SOURCES, EPA recommends that the 500 series for volatile organics be used in preference to the 600 series because the detection limits are lower and the QA/QC is better.
3. APPROPRIATE STANDARDS for the materials stored in the tank are to be used for all analyses on Table #2. For instance, seasonally, there may be five different jet fuel mixtures to be considered.
4. To AVOID FALSE POSITIVE detection of benzene, benzene-free solvents are to be used.
5. TOTAL PETROLEUM HYDROCARBONS (TPH) as gasoline (G) and diesel (D) ranges (volatile and extractible, respectively) are to be analyzed and characterized by GC/FID with a fused capillary column and prepared by EPA method 5030 (purge and trap) for volatile hydrocarbons, or extracted by sonication using 3550 methodology for extractable hydrocarbons. Fused capillary columns are preferred to packed columns; a packed column may be used as a "first cut" with "dirty" samples or once the hydrocarbons have been characterized and proper QA/QC is followed.
6. TETRAETHYL LEAD (TEL) analysis may be required if total lead is detected unless the determination is made that the total lead concentration is geogenic (naturally occurring).
7. CHLORINATED HYDROCARBONS (CL HC) AND BENZENE, TOLUENE, XYLENE AND ETHYLBENZENE (BTX&E) are analyzed in soil by EPA methods 8010 and 8020 respectively, (or 8240) and in water, 601 and 602, respectively (or 624).
8. OIL AND GREASE (O & G) may be used when heavy, straight chain hydrocarbons may be present. Infrared analysis by method 418.1 may also be acceptable for O & G if proper standards are used. **Standard Methods" 17th Edition, 1989, has changed the 503 series to 5520.**
9. **PRACTICAL QUANTITATION REPORTING LIMITS are influenced by matrix problems and laboratory QA/QC procedures. Following are the Practical Quantitation Reporting Limits:**

	<u>SOIL PPM</u>	<u>WATER PPB</u>
TPH G	1.0	50.0
TPH D	1.0	50.0
BTX&E	0.005	0.5
O & G	50.0	5,000.0

Based upon a Regional Board survey of Department of Health Services Certified Laboratories, the Practical Quantitation Reporting Limits are attainable by a majority of laboratories with the exception of diesel fuel in soils. The Diesel Practical Quantitation Reporting Limits, shown by the survey, are:

ROUTINE	MODIFIED PROTOCOL
≤ 10 ppm (42%)	≤ 10 ppm (10%)
≤ 5 ppm (19%)	≤ 5 ppm (21%)
≤ 1 ppm (35%)	≤ 1 ppm (60%)

When the Practical Quantitation Reporting Limits are not achievable, an explanation of the problem is to be submitted on the laboratory data sheets.

- LABORATORY DATA SHEETS are to be signed and submitted and include the laboratory's assessment of the condition of the samples on receipt including temperature, suitable container type, air bubbles present/absent in VOA bottles, proper preservation, etc. The sheets are to include the dates sampled, submitted, prepared for analysis, and analyzed.
- IF PEAKS ARE FOUND, when running samples, that do not conform to the standard, laboratories are to report the peaks, including any unknown complex mixtures that elute at times varying from the standards. Recognizing that these mixtures may be contrary to the standard, they may not be readily identified; however, they are to be reported. At the discretion of the LIA or Regional Board the following information is to be contained in the laboratory report:

The relative retention time for the unknown peak(s) relative to the reference peak in the standard, copies of the chromatogram(s), the type of column used, initial temperature, temperature program is C/minute, and the final temperature.

- REPORTING LIMITS FOR TPH are: gasoline standard ≤ 20 carbon atoms, diesel and jet fuel (kerosene) standard ≤ 50 carbon atoms. It is not necessary to continue the chromatography beyond the limit, standard, or EPA/DHS method protocol (whichever time is greater).

#### EPILOGUE

ADDITIVES: Major oil companies are being encouraged or required by the federal government to reformulate gasoline as cleaner burning fuels to reduce air emissions. MTBE (Methyl-tertiary butyl ether), ETHANOL (ethyl alcohol), and other chemicals may be added to reformulate gasolines to increase the oxygen content in the fuel and thereby decrease undesirable emissions (about four percent with MTBE). MTBE and ethanol are, for practical purposes, soluble in water. The removal

Regional Board Staff Recommendations  
Preliminary Site Investigation

10 August 1990

from the water column will be difficult. Other compounds are being added by the oil companies for various purposes. The refinements for detection and analysis for all of these additives are still being worked out. If you have any questions about the methodology, please call your Regional Board representative.

S E M C O  
ENVIRONMENTAL CONTRACTORS & GENERAL ENGINEERING  
LICENSE # 449864 A, B, C-61/D-40  
1741 LESLIE STREET  
SAN MATEO, CALIFORNIA 94402  
(415) 572-8033

December 17, 1991

Alameda County  
Environmental Health  
80 Swan Way Suite # 200  
Oakland, CA 94621

Attn: Rob Weston:

Re: Addendum to Site Safety Plan for Alameda Unified School District

Dear Rob:

This letter is intended to serve as an addendum to the site safety plan submitted with the removal application for the tank at Alameda Unified School District's Corporation Yard.

With reference to our safety training, all of SEMCO's field employees have received their certificates of training as required by OSHA-SARA agencies, with refresher courses as needed.

In reference to medical monitoring, SEMCO requires all Class I truck drivers to have a mandatory physical once a year. SEMCO supplies health insurance to all employees, and administers random and mandatory drug and alcohol testing.

As for site hazards, SEMCO will supply barricades and barrier tape around the entire working area, with flagmen to divert the general population (if applicable) from the area. Under no circumstances will anyone be allowed into the work site without wearing a hard hat, and no one will enter the tank pit.

Once the tank has been removed from the excavation, binders will be secured to the tank and truck before the loading equipment is detached from the tank. The excavation will then be backfilled to grade, pending soil analysis, which normally takes 5 days. Once soil analysis are received and it is determined that the asphalt may be returned, it will be replaced.

If it is deemed necessary, SEMCO will provide a portable cyclone construction fence for the working area.

With reference to SEMCO'S workman's comp., the certificate is issued with SEMCO'S corporate office address in Modesto. SEMCO'S San Mateo office and employees are also covered under this certificate

If you have any further questions, please give me a call.

Sincerely,

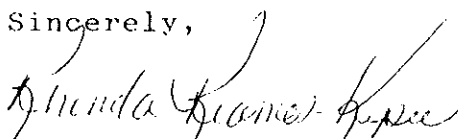
  
Rhonda Reames-Kiper  
Office Manager  
SEMCO-SAN MATEO

SITE SAFETY PLAN  
FOR  
UNDERGROUND STORAGE TANK REMOVAL/CLOSURE

JOB SITE ADDRESS: 2615 Eagle Avenue., Alameda

PREPARED BY: MILTON TIFFIN, ESTIMATOR

JAMES C. BATEMAN PETROLEUM SERVICES, INC.  
dba SEMCO



TABLE OF CONTENTS

PAGE NO.

TABLE OF CONTENTS.....	2
INTRODUCTION.....	3
1.0 HISTORY & SCOPE of WORK.....	4
2.0 HAZARDS SPECIAL PRECAUTIONS.....	5
3.0 JOBSITE VICINITY MAP.....	6
4.0 SITE MAP.....	7
5.0 PERSONNEL.....	8-9
6.0 EMERGENCY SERVICES.....	10
7.0 HOSPITAL ROUTE MAP.....	11
8.0 CONTINGENCY PLAN.....	12
9.0 SAFETY EQUIPMENT.....	13
10.0 SIGNATURES & ACKNOWLEDGMENTS .....	14

SEMCO has adopted the following Health & Safety Plan and procedures for the removal and/or closure of underground petroleum storage tanks and associated piping. The purpose of this plan is to provide health and safety guidelines to be adhered to while all work is in progress.

All personnel involved with the tank removal or associated activities will have an assigned responsibility. The outlined responsibilities will establish standards for personnel protective wear and safety procedures, and will provide for emergency actions which could arise during project operations.

## HISTORY & SCOPE OF WORK

### 1.0 History & Scope of Work:

#### 1.1 History:

#### 1.2 Scope of Work:

The tanks will be purged of all remaining residues, and these residues will be stored on site in a 55 gallon approved drum until they are hauled away or pumped out for disposal by a certified hazardous materials hauler.

The tanks will be inerted with a minimum of 15 lbs of dry ice per 1,000 gallons of tank capacity. More ice will be added if necessary to displace the oxygen in the tank to a concentration level below the OSHA approved lower explosive limit. When this level is obtained the tanks will be removed, and samples will be collected per the approved work plan.

#### 1.3 Responsibilities of Other Agencies if Present:

- a. The Environmental Health Department is responsible for approval and inspection of procedures, including tank removal, sample procurement and integrity of work plan.
- b. The Fire Department is responsible for inspections relative to safe procedures and conditions of the tank prior to removal.

## HAZARDS, SPECIAL PRECAUTIONS

## 2.0 Hazards, Special Precautions:

## 2.1 Special Precautions:

During the course of underground storage tank removal, workers could be exposed to petroleum hydrocarbon vapors, liquids, or other wastes. The following precautions will be observed by all individuals engaged in the tank removal activity.

## 2.1.1 Toxicity Considerations, Petroleum Substances:

All individuals should be aware of appropriate health precautions. When high concentrations of petroleum hydrocarbon vapors are inhaled, symptoms of intoxication may result. These symptoms, range from simple dizziness to unconsciousness. Care will be exercised to minimize exposure to these substances when they are present. Avoid skin contact with petroleum substances whenever possible. Use soap and water to remove any petroleum product that contacts skin.

## 2.1.2 Flammability and Combustibility Consideration:

Flammable and combustible vapors are likely to be present in the work area. Precautions will be taken to eliminate all potential sources of ignition, to prevent the discharge of static electricity during venting, and to prevent the accumulation of vapors.

## 2.1.3 Physical Considerations:

During the excavation of underground storage tanks, some physical hazards can be present, in the form of large holes, exposed piping, debris piles, and excavation equipment. All workers will be aware of these hazards and take all necessary actions to eliminate accidents, when left unattended the excavated area will be appropriately marked and barricaded at all times.

3.0 Jobsite Vicinity Map

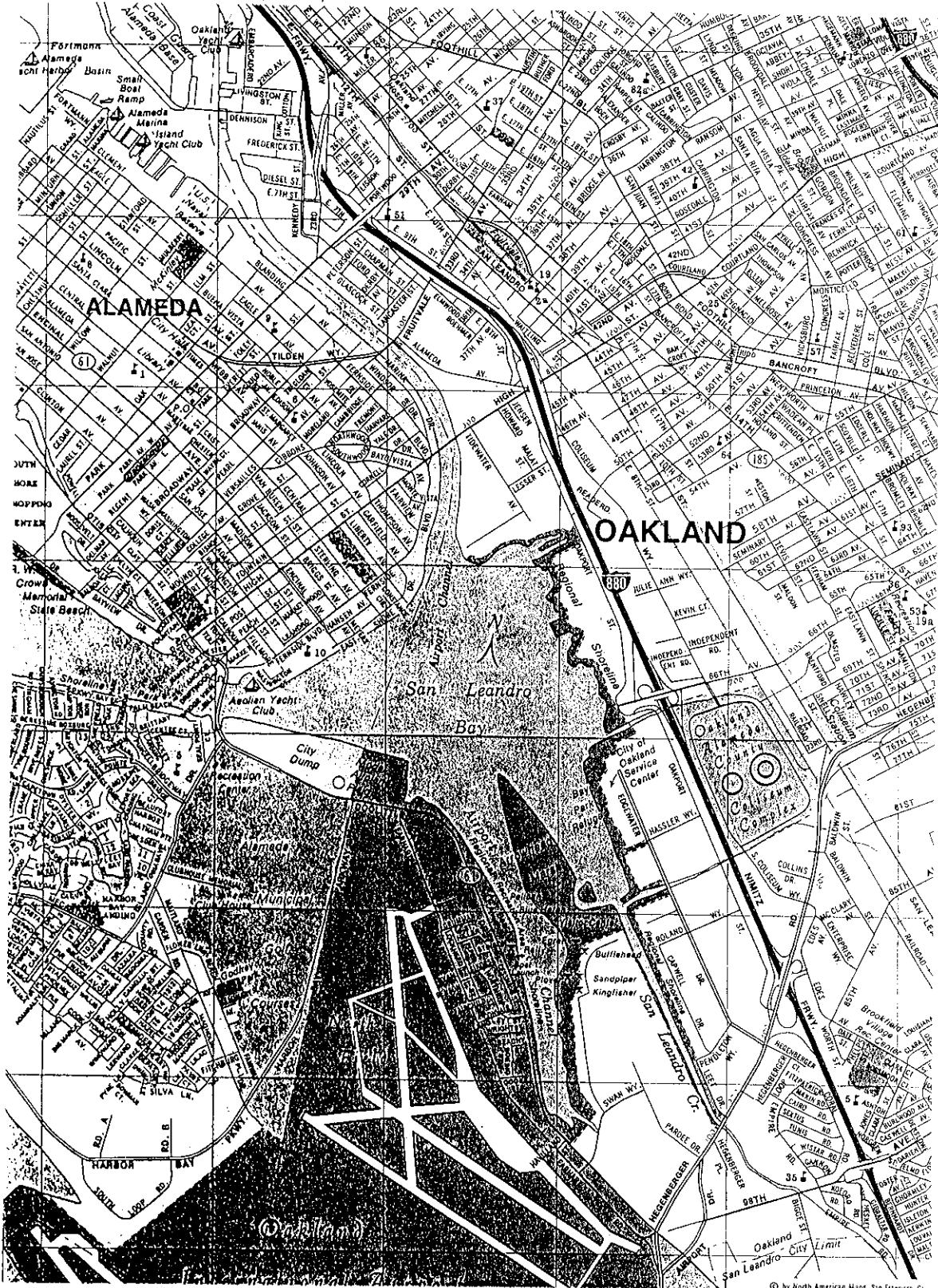

SITE MAP

4.0 Site Map

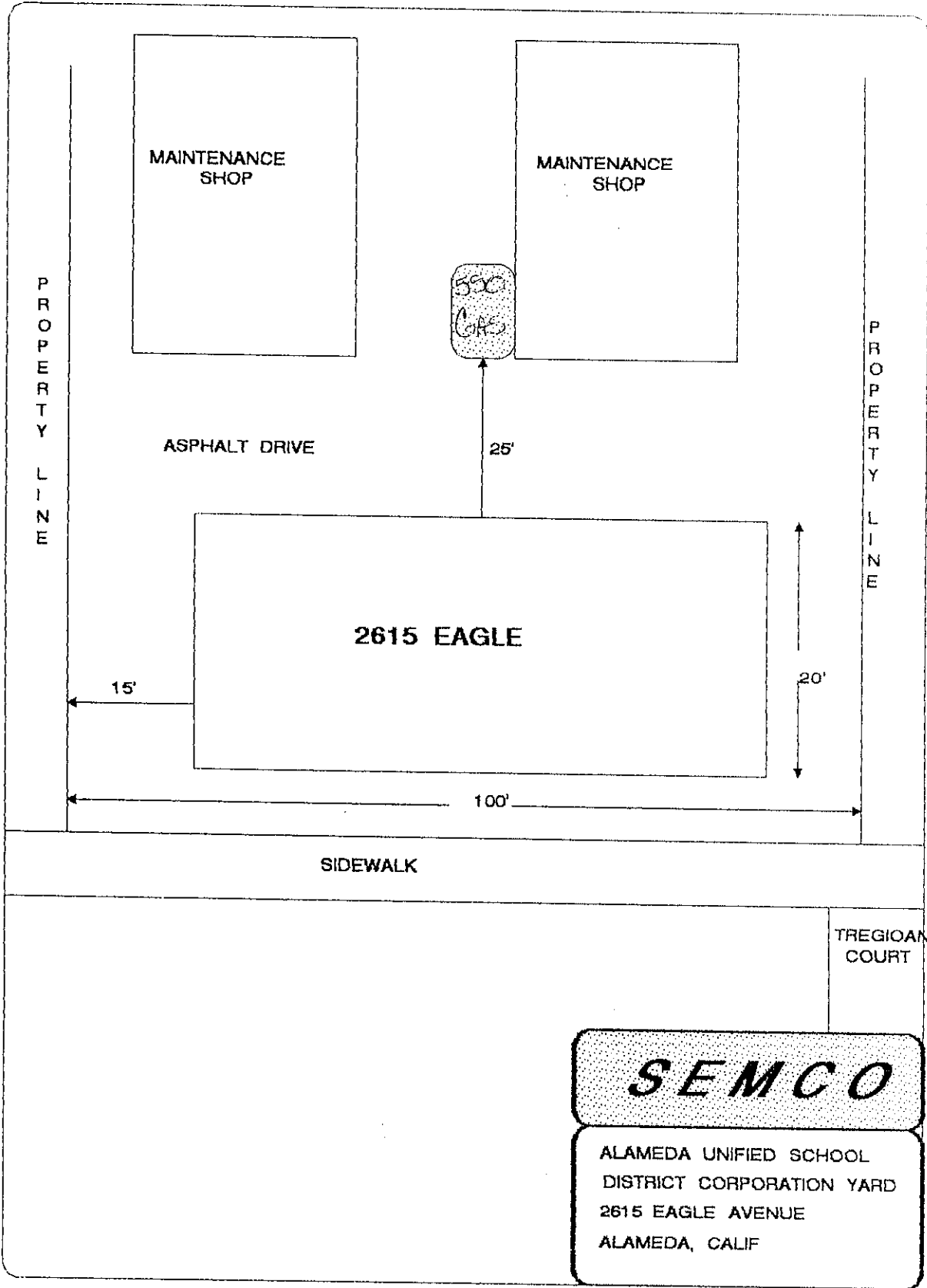

PERSONNEL

## 5.0 Personnel:

## SEMCO Employees

## 5.1 Project Manager

- Manages field operations.
- Ensures the Work Plan is completed on schedule.
- Briefs the field teams on their specific assignments.
- Participates in the preparation of the Site Safety Plan.
- Serves as a liaison with public officials.

## 5.2 Site Safety Officer

- Implements and enforces the SSP.
- Assures that all on-site personnel have received a copy of the SSP, have read it and understand it.
- Conducts frequent inspections of site conditions, facilities, equipment, and activities to determine if the SSP is adequate and being followed.
- Conducts daily "tailgate" meetings to explain the plan of work for the day, mention potential hazards of the site.
- Ensures that protective clothing and equipment are properly stored and maintained.
- Knows emergency procedures, excavation routes, and notifies local emergency services when necessary.
- Notifies the Health and Safety Manager of all accidents and injuries that occur on site.

## 5.3 On-Site Personnel:

- Are required to document their full understanding of the SSP before starting work by signing that they have read the SSP and understand it.
- Complies with the SSP.

PERSONNEL--Continued

- Notifies the SSO of unsafe conditions.
- On-site employees are held responsible to perform only those tasks for which they believe they are qualified and in their opinion are safe.

LEVEL D:      Safety Glasses      Steel Toe Shoes  
                  Hard Hats  
                  Uniform shirt/pants

LEVEL C:      Safety Glasses or Goggles w/side Shields  
                  Hard Hats  
                  Steel Toe Safety Shoes  
                  Half of Full Face Respirator with Organic  
                  Vapor Cartridges  
                  Tyvek or Poly-Coated Tyvek



## 6.0 Emergency Services

## 6.1 Persons to contact in case of emergency:

- a. PROJECT MANAGER  
Name: Chuck Kiper  
Phone: (415) 572-8033
- b. CLIENT CONTACT  
Name: Don Diel  
Phone: (415) 748-4090
- c. SITE CONTACT  
Name: Chuck Kiper  
Phone: (415) 572-8033
- d. SITE SAFETY OFFICER  
Name: Chuck Kiper  
Phone: (415) 572-8033
- e. ALTERNATE SITE SAFETY OFFICER  
Name: Terry Hamilton  
Phone: (209) 524-9653
- f. HEALTH & SAFETY COORDINATOR  
Name: Milton Tiffin  
Phone: (209) 524-9653

6.2 Hospitals In Area:  
Oakland Hospital  
Phone: (510) 532-3300

6.3 Emergency Routes  
See Hospital Route Map, Page 11

6.4 Ambulance Service:  
DIAL 911

6.5 Fire Prevention:  
Alameda Fire Department

6.6 Fire Department:  
DIAL 911

6.7 A First Aid Kit will be on site:

6.8 Barricades:  
Job site will be barricaded off and construction tape will be used around working area, when work area is left unattended.

6.9 Fire Extinguishers will be present on site:

HOSPITAL ROUTE MAP

7.0 Hospital Route Map

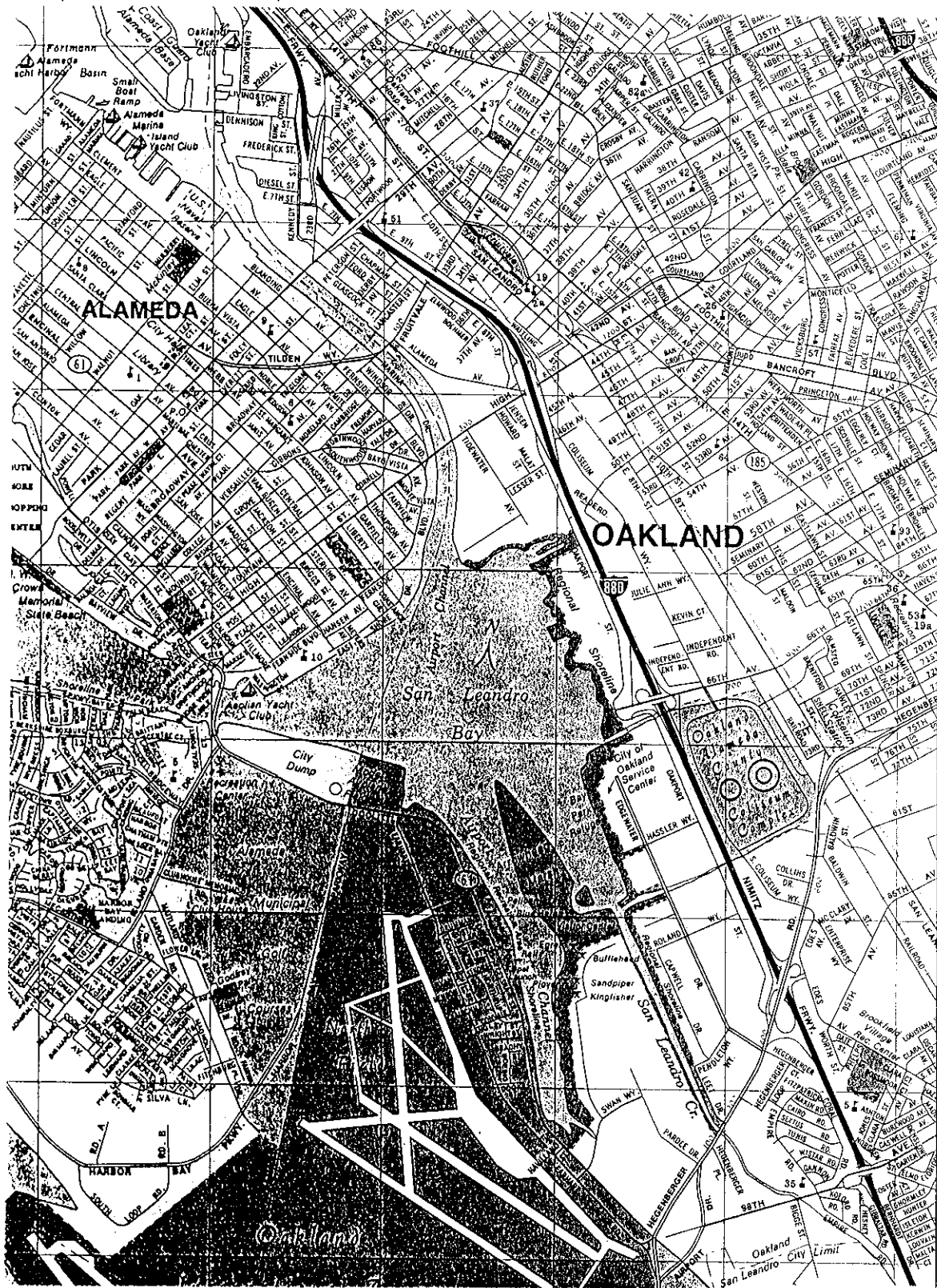

CONTINGENCY PLAN

8.0 Contingency Plan:

If an injury occurs, the following action will be taken:

- Medical attention for the injured person immediately.
- Notify the Site Safety Officer.
- Depending on the type and severity of the injury, SEMCO'S occupational physician will be notified.
- The injured person's personnel office will be notified.
- An incident report will be prepared. The Site Safety Officer will be responsible for its preparation and submittal to the Health and Safety Direction and corporate personnel office within 24 hours.
- The Site Safety Officer will assume charge during a medical emergency.
- EMERGENCY ROUTES--see Hospital Route Map, Page 11

SAFETY EQUIPMENT

9.0 Safety Equipment:

9.1 As a minimum, the following equipment will be on site:

LEL meter

OSHA-Approved First Aid Kit

40BC Fire Extinguisher

Half Face Respirator

with Organic Vapor

Cartridges

10.0 Signatures & Acknowledgments:

I acknowledge having read and understood the preceding Health & Safety Plan:

\_\_\_\_\_  
Signature                      Date

\_\_\_\_\_  
Signature                      Date

\_\_\_\_\_  
Signature                      Date

\_\_\_\_\_  
Signature                      Date

\_\_\_\_\_  
Signature                      Date

\_\_\_\_\_  
Signature                      Date

\_\_\_\_\_  
Signature                      Date

\_\_\_\_\_  
Signature                      Date

\_\_\_\_\_  
Signature                      Date

\_\_\_\_\_  
Signature                      Date

\_\_\_\_\_  
Signature                      Date

\_\_\_\_\_  
Signature                      Date

\_\_\_\_\_  
Signature                      Date

\_\_\_\_\_  
Signature                      Date

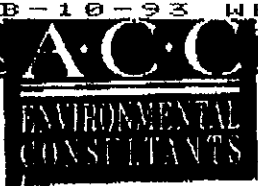

FACSIMILE TRANSMISSION COVER SHEET  
FAX TELEPHONE -- (510) 865-5731

Date: 2/10/93

Please deliver message to: Juliet Ohin

Re: Alameda School District - Eagle Avenue Maint. Yard

From: Misty Keltz

Total number of pages transmitted including this cover page: 2

Number dialed: \_\_\_\_\_ Time sent: \_\_\_\_\_

Sent by: \_\_\_\_\_

Message: Statement from Don Diel. Regarding tank removal and water in excavation.

Original to follow by:

- U.S. Mail
- Express Overnight Mail
- Courier
- No Hard Copy to Follow

If you do not receive total number of pages as indicated above,  
please call (510) 522-8188

**WORLD ENVIRONMENTAL CONSULTING**

---

286 Santa Clara Avenue  
Oakland, California 94610  
(510) 653-7580  
Fax 655-8980

2-4-93

RE: 550 GAL. TANK AT MAINTENENCE YARD, 2615 EAGLE AV.  
ALAMEDA, CA.

MR. SCOTT SEERY  
ALAMEDA COUNTY DEPT OF  
ENVIRONMENTAL HEALTH

MR. SEERY,

ONE UNDERGROUND STORAGE TANK WITH A CAPACITY OF 550 GALLONS  
AND USED FOR GASOLINE STORAGE WAS EXCAVATED AND REMOVED FROM  
THE SITE ON DECEMBER 30, 1991.  
THE TANK PULL WAS PERFORMED BY SEMCO, INC., LICENCE NO. 449864.

DURING THE EXCAVATION OF THE TANK, AT ABOUT THE SIX FEET LEVEL,  
WATER BEGAN TO APPEAR IN THE HOLE. THINKING THAT THIS MAY BE  
GOUND WATER, A SAMPLE WAS TAKEN.

THE BOTTOM OF THE TANK WAS AT ABOUT EIGHT FEET DEEP. BY THE  
TIME THAT THE TANK WAS REMOVED, IT BECAME APPARENT THAT THE  
WATER CAME FROM A SEEPAGE AT THE SIX FEET LEVEL, AND NOT FROM  
GROUNG WATER. THEREFORE THE SAMPLE WAS NOT ANALYZED.

IF THERE ARE ANY QUESTIONS, PLEASE CALL ME AT MY OFFICE:  
1-510-653-7580.

SIGNED,

A handwritten signature in dark ink, appearing to read 'Donald A. Diel', written over a horizontal line.

DONALD A. DIEL, PRESIDENT  
WEC

ALAMEDA COUNTY  
HEALTH CARE SERVICES

AGENCY  
DAVID J. KEARS, Agency Director



RAFAT A. SHAHID, Assistant Agency Director

DEPARTMENT OF ENVIRONMENTAL HEALTH  
Hazardous Materials Division  
80 Swan Way, Rm. 200  
Oakland, CA 94621  
(510) 271-4320

July 29, 1992

Donald Diel  
Alameda Unified School District  
2200 Central Ave.  
Alameda, CA 94501

STID 3940

RE: Soil sampling results from the tank removal at 2615 Eagle Avenue, Alameda, California

Dear Mr. Diel,

On December 30, 1991, a 500-gallon gasoline underground storage tank was removed from the above site by SEMCO. One soil sample was collected from 2 feet beneath the tank in native soil and one composite soil sample was collected from the excavated, stockpiled soil. Analysis of the soil sample collected from beneath the tank did not identify any contaminants above detection limits. However, analysis of the composite soil sample identified 770 parts per million (ppm) gasoline, 65 ppm total lead, and traces of benzene, toluene, ethylbenzene, and xylenes. Additionally, although an Alameda County Hazardous Materials Specialist indicated that there were no holes in the tank at the time of the removal, he did note that there was a strong odor coming from the soil.

According to the Regional Water Quality Control Board's **Staff Recommendations for the Initial Evaluation and Investigation of Underground Tanks**, if nondetectable results were observed in the native soil when obvious contamination was present in the backfill, an assessment of the site in accordance with the factors in **Table 3**, of the above guidelines, must be completed and submitted to the Regulatory Agencies for evaluation (Please refer to the attached copy of Table 3). Please provide all the information requested in Table 3 and submit it to this office **within 45 days** of the receipt of this letter.

Additionally, according to a letter from Chuck Kiper (SEMCO), dated July 24, 1992, he states that ground water was not present in the tank pit during the tank removal. However, the chain-of-custody indicates that initially two ground water samples, referred to as "Pit H20" in the chain-of-custody, were collected and requested to be analyzed. This request was apparently made void later, which is indicated by a line through this request and the word "void" on the chain-of-custody. If there was no ground water in the tank pit, then where did the water samples, noted on



Donald Diel  
RE: 2615 Eagle Avenue  
July 29, 1992  
Page 2 of 2

the chain-of-custody, come from? Please provide the information necessary to clarify this confusion. Additionally, if you, Mr. Diel, were out at the site at the time of the tank removal, it would be helpful if you could provide a personal testimony, in writing, as to whether you did or did not see ground water in the tank pit.

If you have any questions or comments, please contact Ms. Juliet Shin at (510) 271-4530.

Sincerely,

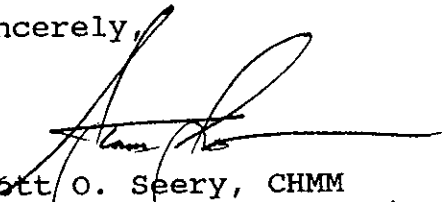

Scott O. Seery, CHMM  
Senior Hazardous Materials Specialist

cc: Richard Hiett, RWQCB

Robert La Grone, Alameda Fire Dept.

Chuck Kiper  
SEMCO  
1741 Leslie St.  
San Mateo, CA 94402

Edgar Howell-File (JS)

S E M C O  
ENVIRONMENTAL CONTRACTORS & GENERAL ENGINEERING  
1741 LESLIE STREET  
SAN MATEO, CALIFORNIA 94402

July 24, 1992

Juliette Chin  
County of Alameda  
Department of Environmental Health  
Hazardous Materials Division  
80 Swan Way, Room 200  
Oakland, California 94621

Re: 2615 Eagle Avenue, Alameda

Dear Juliette:

This letter is intended to answer the questions you had regarding the condition of the tank and the presence of ground water when the tank was removed for 2615 Eagle Avenue, Alameda.

When the tank was removed, there were no holes present. I believe that the reasons for the high levels were due to the fact that the piping from the old tank that was removed was still present. They were removed when we removed the tank.

With reference to groundwater, it was not present when the tank was removed.

If you have any further questions, please give me a call.

Sincerely,

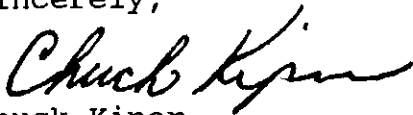

Chuck Kiper  
Vice-President  
SEMCO-SAN MATEO

CK/rrk

---

License # 449864  
A,B, C-61/D40  
Hazardous Substances Certification

(800) 831-2344  
(415) 572-8033  
(415) 572-9734 FAX

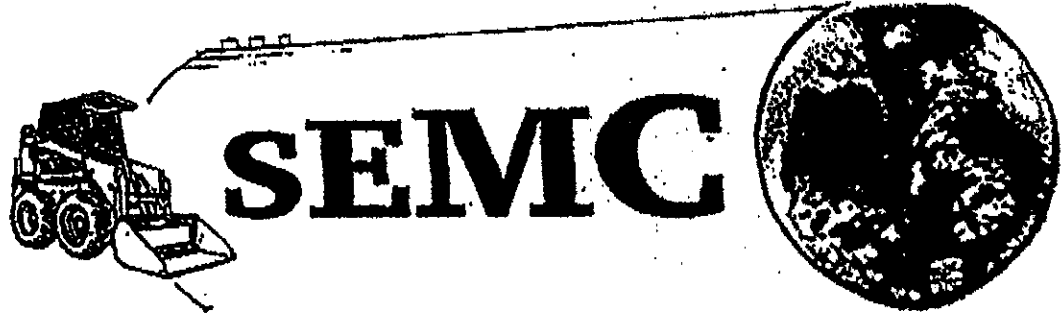

WORKING TO PRESERVE YOUR ENVIRONMENT

(415) 572-8033

FAX (415) 572-9734

(800) 831-2344

DATE: 7/14/92	TIME:
---------------	-------

FAX TO: Alameda County
ATTN: Juliette Chen

FAX NUMBER: 310-569-4757
# OF PAGES FOLLOWING COVER: 1

COMMENTS: Original to follow
------------------------------

SENDER: Shonda Kiser
----------------------

IF YOU DO NOT RECEIVE ALL PAGES, PLEASE CALL (415) 572-8033

S E M C O  
ENVIRONMENTAL CONTRACTORS & GENERAL ENGINEERING  
1741 LESLIE STREET  
SAN MATEO, CALIFORNIA 94402

May 4, 1992

Mr. Kevin Tinsley  
County of Alameda  
Department of Environmental Health  
Hazardous Materials Division  
80 Swan Way, Room 200  
Oakland, California 94621

Re: 2615 Eagle Avenue, Alameda  
Dirt Disposal

Dear Kevin:

This letter is intended to clarify the disposition of the soil that was generated from the tank removal at 2615 Eagle Avenue, Alameda.

When the tank was removed on December 30, 1991, the samples were collected from the excavation and the composite was run of the excavated spoils, which was accumulated to 3 cubic yards. When the analytical was run, the initial concentrations were high. The soil was left on site for a period of two and one-half months.

On March 13, 1992, when we were transporting the final load of soil from Alameda High School, the volatile level was checked with an OVM meter and the levels were almost non existent. The three cubic yards of soil was loaded and spread on top of the soil from the high school and transported to Mountain View Landfill for disposal. Due to the insignificant quantity, this action was reasonable and necessary to prevent remobilizing costs to the school district.

I have included the disposal register from the landfill and the analytical from the original tank removal.

If you have any further questions, please give me a call.

Sincerely,  
  
Chuck Kiper  
Vice-President  
SEMCO-SAN MATEO

---

License # 449864  
A,B, C-61/D40  
Hazardous Substances Certification

(800) 831-2344  
(415) 572-8033  
(415) 572-9734 FAX

# COPY CITY OF MOUNTAIN VIEW 1992

DIRT REGISTER

CONTACT PERSON: Scott 1-800-924-1634

## CONTAMINATED SOIL DELIVERY REGISTER

DATE	CONSULTANT	JOB SITE	TRUCKER	QUANTITY
	Semco	2200 Central Avenue Alameda Unified School District, Alameda	Rich Hamilton Trucking	200 CYDS
<b>TRUCK NUMBER</b>				
3-12-92		990 II 930 II 960 II 10-WHEELER - 980 II	6 LOADS 2 LOADS	120 cu yds 20 cu yds
3-13-92		930 II 960 II 990 II	5 LOADS	100 cu yds
	SMV -	6 5 II	11 LOADS = 220 yds 2 LOADS = 20 yds Total - 240 yds	(240 cu yds)
	10-wheeler	2	2 x 176 -	

/28/1992 15:49 FROM SEMCO MODESTO CA. DIV.

Sh by [Signature]



FAX TRANSMISSION

Date 13 APR 92  
To KEVIN TINSLEY  
FAX No. (510) 569 4757  
From TERRY DILL  
FAX No. ( )  
No. of Pages (including cover sheet) \_\_\_\_\_  
Sent By \_\_\_\_\_  
Telephone ( )

Comments:

white -env.health  
 yellow -facility  
 pink -files

ALAMEDA COUNTY, DEPARTMENT OF ENVIRONMENTAL HEALTH

80 Swan Way, #200  
 Oakland, CA 94621  
 (415) 271-4320

Hazardous Materials Division Inspection Form

Site ID# \_\_\_\_\_ Site Name Alameda School District Today's Date 4/9/92  
 Site Address 2200 Central Ave EPA ID# \_\_\_\_\_  
 City Alameda Zip 94501 Phone Don Diet 748-4090

MAX Amt. Stored > 500lbs/55g/200cf?  Y  N  
 Hazardous Waste generated per month? \_\_\_\_\_

Inspection Categories:

- I. Haz. Mat/Waste GENERATOR/TRANSPORTER
- II. Business Plans, Acute Hazardous Materials
- III. Underground Tanks

The marked items represent violations of the Calif. Administration Code (CAC) or the Health & Safety Code (HS&C)

I.A GENERATOR (Title 22)

Comments:

- \_\_\_ 1. Waste ID \* 66471
- \_\_\_ 2. EPA ID 66472
- \_\_\_ 3. > 90 days 66508
- \_\_\_ 4. Label dates 66508
- \_\_\_ 5. Biennial 66493
- Manifest \_\_\_ 6. Records 66492
- \_\_\_ 7. Correct 66484
- \_\_\_ 8. Copy sent 66492
- \_\_\_ 9. Exception 66484
- \_\_\_ 10. Copies Rec'd 66492
- Misc. \_\_\_ 11. Treatment 66371
- \_\_\_ 12. On-site Disp. (H.S.&C.) 26189.5
- \_\_\_ 13. Ex Haz. Waste 66570
- Prevention \_\_\_ 14. Communications 67121
- \_\_\_ 15. Aisle Space 67124
- \_\_\_ 16. Local Authority 67126
- \_\_\_ 17. Maintenance 67120
- \_\_\_ 18. Training 67105
- Compliance \_\_\_ 19. Prepared 67140
- \_\_\_ 20. Name List 67141
- \_\_\_ 21. Copies 67141
- \_\_\_ 22. Emg. Coord. Trng. 67144
- Containers, Tanks \_\_\_ 23. Condition 67241
- \_\_\_ 24. Compatibility 67242
- \_\_\_ 25. Maintenance 67243
- \_\_\_ 26. Inspection 67244
- \_\_\_ 27. Buffer Zone 67246
- \_\_\_ 28. Tank Inspection 67259
- \_\_\_ 29. Containment 67245
- \_\_\_ 30. Safe Storage 67261
- \_\_\_ 31. Freeboard 67257

On site consultation with Don Dietl and the environmental consultant representing the Alameda School District. This visit is regarding the tank removals at Alameda High School and the maintenance yard on Eagle ave.  
 Observed tank excavation sites and proposed soil boring locations. The old Gym is blocking potential boring sites. You need to submit a plan and site diagram of alternative boring locations for approval or recommendations from this office.  
 In addition, the closure report was missing manifest or receipt of contaminated spoil pile disposal. Provide a copy of your records within 30 days.

I.B TRANSPORTER (Title 22)

- \_\_\_ 32. Applic./Insurance 66428
- \_\_\_ 33. Comp. Cert./CHP Insp. 66448
- \_\_\_ 34. Containers 66465
- Manifest \_\_\_ 35. Vehicles 66465
- \_\_\_ 36. EPA ID #s 66531
- \_\_\_ 37. Correct 66541
- \_\_\_ 38. HW Delivery 66543
- \_\_\_ 39. Records 66544
- Control \_\_\_ 40. Name/ Covers 66545
- \_\_\_ 41. Recyclables 66800

Rev 6/88

Contact: Donald A. Dietl  
 Title: Hazardous Materials Manager Inspector: Kevin Jinsley  
 Signature: Donald A. Dietl Signature: Kevin Jinsley

DATE: 3-27-92  
TO : Local Oversight Program  
FROM: Kevin  
SUBJ: Transfer of Eligible Oversight Case

Site name: Alameda Unified School District  
Address: 2615 Eagle City Alameda Zip 94501  
Closure plan attached?  Y N DepRef remaining \$ 291.00  
DepRef Project # 1774 STID #(if any) 3940  
Number of Tanks: 1 removed?  Y N Date of removal 12-30-92  
Leak Report filed? Y  N Date of Discovery 12-31-92  
Samples received?  Y N Contamination: Soil in Spoil pile  
Petroleum  Y N Types: Avgas Jet leaded unleaded Diesel  
fuel oil waste oil kerosene solvents  
Monitoring wells on site none Monitoring schedule? Y  N  
LUFT category 1 2 3 \* H S C A R W G O  
Briefly describe the following:  
Preliminary Assessment None  
Remedial Action Waiting for report  
Post Remedial Action Monitoring \_\_\_\_\_  
Enforcement Action \_\_\_\_\_

Called Semco (Rhonda) about site. Asked for current  
status of site and manifest of spoil pile disposition.  
Rec'd rept. => 3/27/92. Called for manifest for disposal of spoil pile.  
See on-site visit Report of 4-9-92



# CITY OF MOUNTAIN VIEW 1992

DIRT REGISTER

CONTACT PERSON: *Scott 1-800 924-1634*

~~1.00~~  
~~for \$2,100.00 only 3/12/92~~  
 RE-Approved For \$6,000.00  
 NEW APPROVAL # 040729  
 VISA # 1-800-248-4553 3-12-92  
 12:45 PM

## CONTAMINATED SOIL DELIVERY REGISTER

DATE	CONSULTANT	JOB SITE	TRUCKER	QUANTITY
	<i>Servco</i>	<i>2200 Central Avenue, Alameda Unified School District, Alameda</i>	<i>Rich Hamilton Trucking</i>	<i>300 CYDS</i>
<b>TRUCK NUMBER</b>		<b>CLEAN DIRT LOADS</b>	<b>CONTAMINATED LOADS</b>	
<i>3-12-92</i>	<i>990</i>	<i>11</i>	<i>6 LOADS</i>	<i>120 cu yds</i>
	<i>930</i>	<i>11</i>		
	<i>960</i>	<i>11</i>		
	<i>900</i>	<i>11</i>		
	<i>10-WHEELER</i>		<i>2 LOADS</i>	<i>20 cu yds</i>
<i>3-13-92</i>	<i>930</i>	<i>11</i>	<i>5 LOADS</i>	<i>100 cu yds</i>
	<i>960</i>	<i>11</i>		
	<i>990</i>	<i>11</i>		
	<i>SMV -</i>			
	<i>6</i>			
	<i>5</i>			
	<i>11</i>	<i>11 X 302</i>	<i>\$ 3872</i>	
	<i>10-wheeler</i>	<i>2 X 176</i>	<i>352</i>	
			<i>\$ 4224</i>	

*Contaminated dirt loads are those with plastic, wood debris, or concrete/asphalt etc mixed with the dirt.*

*pl by invoice card*  
*4.*

04/14/92 17:28 415 962 8911

**S E M C O**  
1741 LESLIE STREET  
SAN MATEO, CA 94402

92 JAN -3 AM10:45

**DATE:** JANUARY 2, 1992

**TO:** ALAMEDA COUNTY ENVIRONMENTAL HEALTH  
80 SWAN WAY ROOM 200  
OAKLAND, CA 94621

**Please find enclosed the soil analysis for:**

ALAMEDA UNIFIED SCHOOL DISTRICT  
CORPORATION YARD  
2615 EAGLE AVENUE, ALAMEDA

**A final report containing manifests and sample locations will be forwarded to you after compilation of all receipts, documents and permits pertaining to this tank removal.**

**Sincerely,**

*Shonda Kypse*

WATER RESOURCES CONTROL BOARD  
DIVISION OF WATER QUALITY - UST CLEANUP PROGRAM  
SITE SPECIFIC QUARTERLY REPORT  
01/01/92 THROUGH 03/31/92

AGENCY # : 10000                      SOURCE OF FUNDS:                      SUBSTANCE:  
StID        : 3940  
SITE NAME: Alameda Unified School Distric                      DATE REPORTED :  
ADDRESS    : 2615 Eagle Ave.                                      DATE CONFIRMED:  
CITY/ZIP   : Alameda    94501                                      MULTIPLE RPs :

SITE STATUS  
-----

CASE TYPE:	CONTRACT STATUS:	EMERGENCY RESP:
RP SEARCH:		DATE COMPLETED:
PRELIMINARY ASMNT:	DATE UNDERWAY:	DATE COMPLETED:
REM INVESTIGATION:	DATE UNDERWAY:	DATE COMPLETED:
REMEDIAL ACTION:	DATE UNDERWAY:	DATE COMPLETED:
POST REMED ACT MON:	DATE UNDERWAY:	DATE COMPLETED:

ENFORCEMENT ACTION TYPE:	DATE ENFORCEMENT ACTION TAKEN:
LUFT FIELD MANUAL CONSID:	
CASE CLOSED:	DATE CASE CLOSED:
DATE EXCAVATION STARTED :	REMEDIAL ACTIONS TAKEN:

RESPONSIBLE PARTY INFORMATION  
-----

RP#1-CONTACT NAME:  
COMPANY NAME:  
ADDRESS:  
CITY/STATE:

---

white -env.health  
 yellow -facility  
 pink -files

# ALAMEDA COUNTY, DEPARTMENT OF ENVIRONMENTAL HEALTH

## Hazardous Materials Inspection Form

80 Swan Way, #200  
 Oakland, CA 94621  
 (415) 271-4320

II, III

Site ID # \_\_\_\_\_ Site Name Alameda Unified School Today's Date 12/30/91

### II.A BUSINESS PLANS (Title 19)

- \_\_\_ 1. Immediate Reporting 2703
- \_\_\_ 2. Bus. Plan Stds. 25503(b)
- \_\_\_ 3. RR Cars > 30 days 25503.7
- \_\_\_ 4. Inventory Information 25504(a)
- \_\_\_ 5. Inventory Complete 2730
- \_\_\_ 6. Emergency Response 25504(b)
- \_\_\_ 7. Training 25504(c)
- \_\_\_ 8. Deficiency 25505(a)
- \_\_\_ 9. Modification 25505(b)

Site Address 2615 Euclid Ave  
 City Alameda Zip 94501 Phone 748-4090

\_\_\_ MAX AMT stored > 500 lbs, 55 gal., 200 cft.?

### Inspection Categories:

- \_\_\_ I. Haz. Mat/Waste GENERATOR/TRANSPORTER
- \_\_\_ II. Business Plans, Acute Hazardous Materials
- III. Underground Tanks

\* Calif. Administration Code (CAC) or the Health & Safety Code (HS&C)

Comments: TANK CLOSED

500 gal tank removed, no visible  
holes in tank but holes from soils  
now tillered.  
Strong odor from hole; maybe perched water  
with water sample collected at 6-ft - not removed  
soil sample at 8'.  
compositing 3 fragments  
stock

### II.B ACUTELY HAZ. MATLS

- \_\_\_ 10. Registration Form Filed 25533(a)
- \_\_\_ 11. Form Complete 25533(b)
- \_\_\_ 12. RMPP Contents 25534(c)
- \_\_\_ 13. Implement Sch. Req'd? (Y/N)
- \_\_\_ 14. OffSite Conseq. Assess. 25524(c)
- \_\_\_ 15. Probable Risk Assessment 25534(d)
- \_\_\_ 16. Persons Responsible 25534(g)
- \_\_\_ 17. Certification 25534(i)
- \_\_\_ 18. Exemption Request? (Y/N) 25536(b)
- \_\_\_ 19. Trade Secret Requested? 25538

### III. UNDERGROUND TANKS (Title 23)

- |                               |  |
|-------------------------------|--|
| General                       | ___ 1. Permit Application 25284 (H&S)  |
|                               | ___ 2. Pipeline Leak Detection 25292 (H&S)   |
|                               | ___ 3. Records Maintenance 2712  |
|                               | ___ 4. Release Report 2651   |
|                               | ___ 5. Closure Plans 2670  |
| Monitoring for Existing Tanks | ___ 6. Method  |
|                               | 1) Monthly Test  |
|                               | 2) Daily Vadose<br>Semi-annual groundwater<br>One time soils                             |
|                               | 3) Daily Vadose<br>One time soils<br>Annual tank test                                    |
|                               | 4) Monthly Groundwater<br>One time soils   |
|                               | 5) Daily Inventory<br>Annual tank testing<br>Cont pipe leak det<br>Vadose/grndwater mon. |
|                               | 6) Daily Inventory<br>Annual tank testing<br>Cont pipe leak det                          |
|                               | 7) Weekly Tank Gauge<br>Annual tank testing  |
|                               | 8) Annual Tank Testing<br>Daily Inventory  |
|                               | 9) Other _____   |
| New Tanks                     | ___ 7. Precs Tank Test 2643<br>Date: _____   |
|                               | ___ 8. Inventory Rec. 2644   |
|                               | ___ 9. Soil Testing . 2646   |
|                               | ___ 10. Ground Water. 2647   |
|                               | ___ 11. Monitor Plan 2632  |
|                               | ___ 12. Access. Secure 2634  |
|                               | ___ 13. Plans Submit 2711<br>Date: _____   |
|                               | ___ 14. As Built 2635<br>Date: _____   |

Rev 8/88

Contact: Don Diel  
 Title: Asbestos Inmate  
 Signature: [Signature]

Inspector: Lawrence Miller  
 Signature: [Signature]

II, III

STATE OF CALIFORNIA  
STATE WATER RESOURCES CONTROL BOARD  
**UNDERGROUND STORAGE TANK PERMIT APPLICATION - FORM A**



COMPLETE THIS FORM FOR EACH FACILITY/SITE

<b>MARK ONLY ONE ITEM</b>	<input type="checkbox"/> 1 NEW PERMIT	<input type="checkbox"/> 3 RENEWAL PERMIT	<input type="checkbox"/> 5 CHANGE OF INFORMATION	<input checked="" type="checkbox"/> 7 PERMANENTLY CLOSED SITE
	<input type="checkbox"/> 2 INTERIM PERMIT	<input type="checkbox"/> 4 AMENDED PERMIT	<input type="checkbox"/> 6 TEMPORARY SITE CLOSURE	

**I. FACILITY/SITE INFORMATION & ADDRESS - (MUST BE COMPLETED)**

DBA OR FACILITY NAME <b>ALAMEDA UNIFIED SCHOOL DIST, CORP, YARD</b>		NAME OF OPERATOR		
ADDRESS <b>2615 EAGLE AVENUE</b>		NEAREST CROSS STREET		PARCEL # (OPTIONAL)
CITY NAME <b>ALAMEDA</b>		STATE <b>CA</b>	ZIP CODE <b>94501</b>	SITE PHONE # WITH AREA CODE <b>910-748-4000</b>
<input checked="" type="checkbox"/> BOX TO INDICATE <input type="checkbox"/> CORPORATION <input type="checkbox"/> INDIVIDUAL <input type="checkbox"/> PARTNERSHIP <input checked="" type="checkbox"/> LOCAL-AGENCY DISTRICTS <input type="checkbox"/> COUNTY-AGENCY <input type="checkbox"/> STATE-AGENCY <input type="checkbox"/> FEDERAL-AGENCY		TYPE OF BUSINESS <input type="checkbox"/> 1 GAS STATION <input type="checkbox"/> 2 DISTRIBUTOR <input type="checkbox"/> 3 FARM <input type="checkbox"/> 4 PROCESSOR <input checked="" type="checkbox"/> 5 OTHER		<input type="checkbox"/> IF INDIAN RESERVATION OR TRUST LANDS    # OF TANKS AT SITE <b>1</b> E. P. A. I. D. # (optional) <b>CAD981666001</b>

**EMERGENCY CONTACT PERSON (PRIMARY)**

**EMERGENCY CONTACT PERSON (SECONDARY) - optional**

DAYS: NAME (LAST, FIRST) <b>KIPER, CHUCK</b>		PHONE # WITH AREA CODE <b>415 572-8033</b>		DAYS: NAME (LAST, FIRST) <b>HAMILTON, TERRY</b>		PHONE # WITH AREA CODE <b>209 524-9653</b>	
NIGHTS: NAME (LAST, FIRST) <b>SAME</b>		PHONE # WITH AREA CODE		NIGHTS: NAME (LAST, FIRST) <b>SAME</b>		PHONE # WITH AREA CODE	

**II. PROPERTY OWNER INFORMATION - (MUST BE COMPLETED)**

NAME <b>ALAMEDA UNIFIED SCHOOL DISTRICT</b>		CARE OF ADDRESS INFORMATION		
MAILING OR STREET ADDRESS <b>2200 CENTRAL AVENUE</b>		<input checked="" type="checkbox"/> box to indicate <input type="checkbox"/> INDIVIDUAL <input checked="" type="checkbox"/> LOCAL-AGENCY <input type="checkbox"/> STATE-AGENCY <input type="checkbox"/> CORPORATION <input type="checkbox"/> PARTNERSHIP <input type="checkbox"/> COUNTY-AGENCY <input type="checkbox"/> FEDERAL-AGENCY		
CITY NAME <b>ALAMEDA</b>		STATE <b>CA</b>	ZIP CODE <b>94501</b>	PHONE # WITH AREA CODE <b>510-748-4000</b>

**III. TANK OWNER INFORMATION - (MUST BE COMPLETED)**

NAME OF OWNER <b>ALAMEDA UNIFIED SCHOOL DISTRICT</b>		CARE OF ADDRESS INFORMATION		
MAILING OR STREET ADDRESS <b>2200 CENTRAL AVENUE</b>		<input checked="" type="checkbox"/> box to indicate <input type="checkbox"/> INDIVIDUAL <input checked="" type="checkbox"/> LOCAL-AGENCY <input type="checkbox"/> STATE-AGENCY <input type="checkbox"/> CORPORATION <input type="checkbox"/> PARTNERSHIP <input type="checkbox"/> COUNTY-AGENCY <input type="checkbox"/> FEDERAL-AGENCY		
CITY NAME <b>ALAMEDA</b>		STATE <b>CA</b>	ZIP CODE <b>94501</b>	PHONE # WITH AREA CODE <b>510-748-4000</b>

**IV. BOARD OF EQUALIZATION UST STORAGE FEE ACCOUNT NUMBER - Call (916) 323-9555 if questions arise.**

TY (TK) HQ **4 4** - [ ] [ ] [ ] [ ] [ ] [ ]

**V. PETROLEUM UST FINANCIAL RESPONSIBILITY - (MUST BE COMPLETED) - IDENTIFY THE METHOD(S) USED**

<input checked="" type="checkbox"/> box to indicate	<input type="checkbox"/> 1 SELF-INSURED	<input type="checkbox"/> 2 GUARANTEE	<input type="checkbox"/> 3 INSURANCE	<input type="checkbox"/> 4 SURETY BOND
	<input type="checkbox"/> 5 LETTER OF CREDIT	<input type="checkbox"/> 6 EXEMPTION	<input checked="" type="checkbox"/> 99 OTHER	

**VI. LEGAL NOTIFICATION AND BILLING ADDRESS**    Legal notification and billing will be sent to the tank owner unless box I or II is checked.

CHECK ONE BOX INDICATING WHICH ABOVE ADDRESS SHOULD BE USED FOR LEGAL NOTIFICATIONS AND BILLING:    I.     II.     III.

THIS FORM HAS BEEN COMPLETED UNDER PENALTY OF PERJURY, AND TO THE BEST OF MY KNOWLEDGE, IS TRUE AND CORRECT

APPLICANT'S NAME (PRINTED & SIGNATURE) <b>RHONDA REAMES-KIPER</b>	APPLICANT'S TITLE <b>OFFICE MANAGER</b>	DATE MONTH/DAY/YEAR <b>12/17/91</b>
--	--	--

**LOCAL AGENCY USE ONLY**

COUNTY # [ ] [ ]	JURISDICTION # [ ] [ ] [ ]	FACILITY # [ ] [ ] [ ] [ ] [ ] [ ]
LOCATION CODE - OPTIONAL	CENSUS TRACT # - OPTIONAL	SUPVISOR - DISTRICT CODE - OPTIONAL

STATE OF CALIFORNIA  
STATE WATER RESOURCES CONTROL BOARD  
**UNDERGROUND STORAGE TANK PERMIT APPLICATION - FORM B**



COMPLETE A SEPARATE FORM FOR EACH TANK SYSTEM.

MARK ONLY ONE ITEM	<input type="checkbox"/> 1 NEW PERMIT	<input type="checkbox"/> 3 RENEWAL PERMIT	<input type="checkbox"/> 5 CHANGE OF INFORMATION	<input type="checkbox"/> 7 PERMANENTLY CLOSED ON SITE
	<input type="checkbox"/> 2 INTERIM PERMIT	<input type="checkbox"/> 4 AMENDED PERMIT	<input type="checkbox"/> 6 TEMPORARY TANK CLOSURE	<input checked="" type="checkbox"/> 8 TANK REMOVED

DBA OR FACILITY NAME WHERE TANK IS INSTALLED: ALAMEDA UNIFIED SCHOOL DISTRICT CORPORATION YARD

**I. TANK DESCRIPTION** COMPLETE ALL ITEMS -- SPECIFY IF UNKNOWN

A. OWNER'S TANK I.D.# <u>UNKNOWN</u>	B. MANUFACTURED BY: <u>UNKNOWN</u>
C. DATE INSTALLED (MO/DAY/YEAR) <u>UNKNOWN</u>	D. TANK CAPACITY IN GALLONS: <u>550</u>

**II. TANK CONTENTS** IF A-1 IS MARKED, COMPLETE ITEM C.

A. <input checked="" type="checkbox"/> 1 MOTOR VEHICLE FUEL <input type="checkbox"/> 2 PETROLEUM <input type="checkbox"/> 3 CHEMICAL PRODUCT	<input type="checkbox"/> 4 OIL <input type="checkbox"/> 80 EMPTY <input type="checkbox"/> 95 UNKNOWN	B. <input type="checkbox"/> 1 PRODUCT <input type="checkbox"/> 2 WASTE
C. <input checked="" type="checkbox"/> 1a REGULAR UNLEADED <input type="checkbox"/> 1b PREMIUM UNLEADED <input type="checkbox"/> 2 LEADED		
<input type="checkbox"/> 3 DIESEL <input type="checkbox"/> 4 GASAHOL <input type="checkbox"/> 5 JET FUEL <input type="checkbox"/> 99 OTHER (DESCRIBE IN ITEM D. BELOW)		
D. IF (A.1) IS NOT MARKED, ENTER NAME OF SUBSTANCE STORED _____ C. A. S. #: _____		

**III. TANK CONSTRUCTION** MARK ONE ITEM ONLY IN BOXES A, B, AND C, AND ALL THAT APPLIES IN BOX D AND E

A. TYPE OF SYSTEM <input type="checkbox"/> 1 DOUBLE WALL <input checked="" type="checkbox"/> 2 SINGLE WALL	<input type="checkbox"/> 3 SINGLE WALL WITH EXTERIOR LINER <input type="checkbox"/> 4 SECONDARY CONTAINMENT (VAULTED TANK)	<input type="checkbox"/> 95 UNKNOWN <input type="checkbox"/> 99 OTHER
B. TANK MATERIAL (Primary Tank) <input checked="" type="checkbox"/> 1 BARE STEEL <input type="checkbox"/> 5 CONCRETE <input type="checkbox"/> 9 BRONZE	<input type="checkbox"/> 2 STAINLESS STEEL <input type="checkbox"/> 6 POLYVINYL CHLORIDE <input type="checkbox"/> 10 GALVANIZED STEEL	<input type="checkbox"/> 3 FIBERGLASS <input type="checkbox"/> 7 ALUMINUM <input type="checkbox"/> 95 UNKNOWN <input type="checkbox"/> 99 OTHER
C. INTERIOR LINING <input type="checkbox"/> 1 RUBBER LINED <input type="checkbox"/> 5 GLASS LINING	<input type="checkbox"/> 2 ALKYD LINING <input type="checkbox"/> 6 UNLINED	<input type="checkbox"/> 3 EPOXY LINING <input checked="" type="checkbox"/> 95 UNKNOWN <input type="checkbox"/> 99 OTHER
IS LINING MATERIAL COMPATIBLE WITH 100% METHANOL? YES ___ NO ___		
D. CORROSION PROTECTION <input type="checkbox"/> 1 POLYETHYLENE WRAP <input type="checkbox"/> 5 CATHODIC PROTECTION	<input type="checkbox"/> 2 COATING <input type="checkbox"/> 91 NONE	<input type="checkbox"/> 3 VINYL WRAP <input checked="" type="checkbox"/> 95 UNKNOWN <input type="checkbox"/> 99 OTHER
E. SPILL AND OVERFILL SPILL CONTAINMENT INSTALLED (YEAR) <u>UNK</u> OVERFILL PREVENTION EQUIPMENT INSTALLED (YEAR) <u>UNK</u>		

**IV. PIPING INFORMATION** CIRCLE A IF ABOVE GROUND OR U IF UNDERGROUND, BOTH IF APPLICABLE

A. SYSTEM TYPE	A U 1 SUCTION	A U 2 PRESSURE	A U 3 GRAVITY	A U 99 OTHER
B. CONSTRUCTION	A U 1 SINGLE WALL	A U 2 DOUBLE WALL	A U 3 LINED TRENCH	A U 95 UNKNOWN A U 99 OTHER
C. MATERIAL AND CORROSION PROTECTION	A U 1 BARE STEEL	A U 2 STAINLESS STEEL	A U 3 POLYVINYL CHLORIDE (PVC)	A U 4 FIBERGLASS PIPE
	A U 5 ALUMINUM	A U 6 CONCRETE	A U 7 STEEL W/ COATING	A U 8 100% METHANOL COMPATIBLE W/FRP
	A U 9 GALVANIZED STEEL	A U 10 CATHODIC PROTECTION	A U 95 UNKNOWN	A U 99 OTHER
D. LEAK DETECTION	<input type="checkbox"/> 1 AUTOMATIC LINE LEAK DETECTOR	<input type="checkbox"/> 2 LINE TIGHTNESS TESTING	<input type="checkbox"/> 3 INTERSTITIAL MONITORING	<input type="checkbox"/> 99 OTHER <u>UNKNOWN</u>

**V. TANK LEAK DETECTION**

<input type="checkbox"/> 1 VISUAL CHECK	<input type="checkbox"/> 2 INVENTORY RECONCILIATION	<input type="checkbox"/> 3 VADOZE MONITORING	<input type="checkbox"/> 4 AUTOMATIC TANK GAUGING	<input type="checkbox"/> 5 GROUND WATER MONITORING
<input type="checkbox"/> 6 TANK TESTING	<input type="checkbox"/> 7 INTERSTITIAL MONITORING	<input type="checkbox"/> 91 NONE	<input checked="" type="checkbox"/> 95 UNKNOWN	<input type="checkbox"/> 99 OTHER

**VI. TANK CLOSURE INFORMATION**

1. ESTIMATED DATE LAST USED (MO/DAY/YR)	2. ESTIMATED QUANTITY OF SUBSTANCE REMAINING _____ GALLONS	3. WAS TANK FILLED WITH INERT MATERIAL? YES <input type="checkbox"/> NO <input type="checkbox"/>
---	--	--

THIS FORM HAS BEEN COMPLETED UNDER PENALTY OF PERJURY AND TO THE BEST OF MY KNOWLEDGE, IS TRUE AND CORRECT

APPLICANT'S NAME (PRINTED & SIGNATURE) RHONDA REAMES-KIPER DATE 12/17/91

**LOCAL AGENCY USE ONLY** THE STATE I.D. NUMBER IS COMPOSED OF THE FOUR NUMBERS BELOW

STATE I.D.#	COUNTY #	JURISDICTION #	FACILITY #	TANK #
PERMIT NUMBER	PERMIT APPROVED BY/DATE		PERMIT EXPIRATION DATE	

# ACORD. CERTIFICATE OF INSURANCE

ISSUE DATE (MM/DD/YY)

9/25/91

**PRODUCER**

R. L. Stewart Ins. Agency  
P.O. Box 1515  
Oakdale, Ca. 95361

THIS CERTIFICATE IS ISSUED AS A MATTER OF INFORMATION ONLY AND CONFERS NO RIGHTS UPON THE CERTIFICATE HOLDER. THIS CERTIFICATE DOES NOT AMEND, EXTEND OR ALTER THE COVERAGE AFFORDED BY THE POLICIES BELOW.

**COMPANIES AFFORDING COVERAGE**

**INSURED**

Semco  
431 W. Hatch Rd.  
Modesto, Ca. 95351

COMPANY LETTER **A** American Star Ins. Co.  
COMPANY LETTER **B** Fairmont Ins. Co.  
COMPANY LETTER **C**  
COMPANY LETTER **D**  
COMPANY LETTER **E**

**COVERAGES**

THIS IS TO CERTIFY THAT THE POLICIES OF INSURANCE LISTED BELOW HAVE BEEN ISSUED TO THE INSURED NAMED ABOVE FOR THE POLICY PERIOD INDICATED, NOTWITHSTANDING ANY REQUIREMENT, TERM OR CONDITION OF ANY CONTRACT OR OTHER DOCUMENT WITH RESPECT TO WHICH THIS CERTIFICATE MAY BE ISSUED OR MAY PERTAIN, THE INSURANCE AFFORDED BY THE POLICIES DESCRIBED HEREIN IS SUBJECT TO ALL THE TERMS, EXCLUSIONS AND CONDITIONS OF SUCH POLICIES. LIMITS SHOWN MAY HAVE BEEN REDUCED BY PAID CLAIMS.

CO LTR	TYPE OF INSURANCE	POLICY NUMBER	POLICY EFFECTIVE DATE (MM/DD/YY)	POLICY EXPIRATION DATE (MM/DD/YY)	LIMITS
A	GENERAL LIABILITY	AMS1-519725	10/1/91	10/1/92	GENERAL AGGREGATE \$ 1,000,000
	<input checked="" type="checkbox"/> COMMERCIAL GENERAL LIABILITY				PRODUCTS-COMP/OP AGG. \$ 1,000,000
	CLAIMS MADE <input checked="" type="checkbox"/> OCCUR.				PERSONAL & ADV. INJURY \$ 1,000,000
	OWNER'S & CONTRACTOR'S PROT.				EACH OCCURRENCE \$ 1,000,000
					FIRE DAMAGE (Any one fire) \$ 50,000
					MED. EXPENSE (Any one person) \$ 5,000
					COMBINED SINGLE LIMIT \$
A	AUTOMOBILE LIABILITY	WCP80480741	9/5/91	9/5/92	BODILY INJURY (Per person) \$
	ANY AUTO				BODILY INJURY (Per accident) \$
	ALL OWNED AUTOS				PROPERTY DAMAGE \$
	SCHEDULED AUTOS				EACH OCCURRENCE \$
	HIREN AUTOS				AGGREGATE \$
NON-OWNED AUTOS					
GARAGE LIABILITY					
B	EXCESS LIABILITY	WCP80480741	9/5/91	9/5/92	STATUTORY LIMITS
	UMBRELLA FORM				EACH ACCIDENT \$ 1,000,000
B	WORKER'S COMPENSATION	WCP80480741	9/5/91	9/5/92	DISEASE-POLICY LIMIT \$ 1,000,000
	AND				DISEASE-EACH EMPLOYEE \$ 1,000,000
	EMPLOYERS' LIABILITY				
OTHER					

DESCRIPTION OF OPERATIONS/LOCATIONS/VEHICLES/SPECIAL ITEMS **All California Operations**

**CERTIFICATE HOLDER**

County of Alameda  
80 Swan Way, Room 200  
Oakland, Ca. 95621

**CANCELLATION**

SHOULD ANY OF THE ABOVE DESCRIBED POLICIES BE CANCELLED BEFORE THE EXPIRATION DATE THEREOF, THE ISSUING COMPANY WILL ENDEAVOR TO MAIL 10 DAYS WRITTEN NOTICE TO THE CERTIFICATE HOLDER NAMED TO THE LEFT, BUT FAILURE TO MAIL SUCH NOTICE SHALL IMPOSE NO OBLIGATION OR LIABILITY OF ANY KIND UPON THE COMPANY, ITS AGENTS OR REPRESENTATIVES.

AUTHORIZED REPRESENTATIVE  
*Roger S. [Signature]*