

ASSESSOR'S MAP 74

Code Area Nos. 21-000

1045 Scale: 1" = 200'

(A) TR. 3645 96/38 (C) TR. 3713 96/40 (D) P.M. 2602 81/10 (E) P.M. 5510 184/3
 (B) SALE MAP NO. 10 OF SALT MARSH AND TIDE LANDS 17/30
 1336 1318 1335

Drawn: 04-17-78 UP Reviewed: 1-12-79 ad 8-2-89 pb
 6-24-79 hds 3-4-81 JT
 8-23-78 pbs 07/23304W
 1-1-81 OFB 2-16-96 RIG
 8-12-84 RB

Formerly: Rec. Pp. 1040, Rec. Pp. 1039, Rec. Pp. 1032

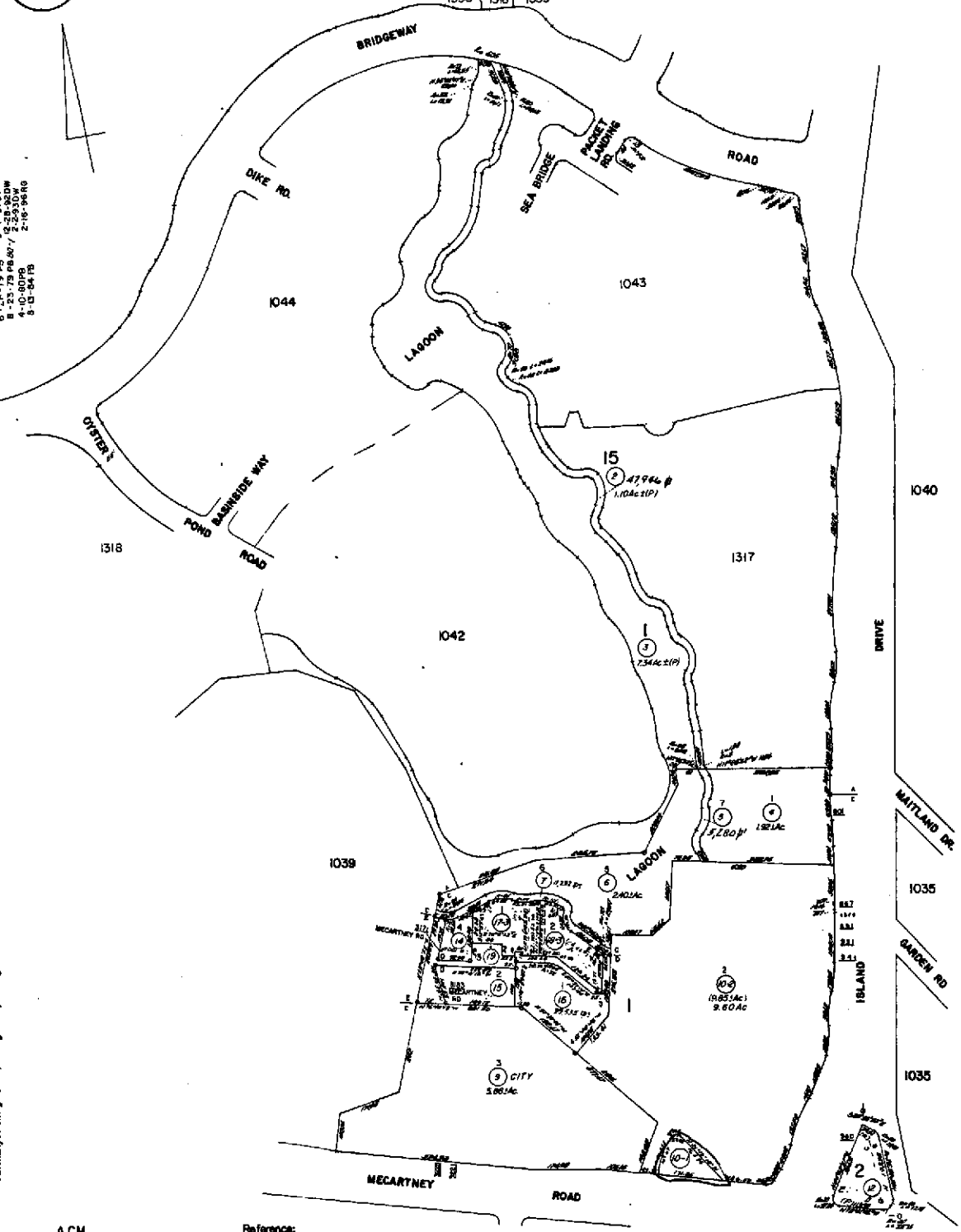

A.C.M.

Reference:

11/11
 1045
 1045



COUNTY OF ALAMEDA
Assessor's Office

Property Value System

History

Value

Transfer

[New Query](#)

Parcel Number: **74-1045-10-1** Inactive: **N** Lien Date: **01/01/2006** Owner: **HARBOR BAY LANDING LLC**
 Property Address: **3255 MECARTNEY RD , ALAMEDA, CA 94502-6922**

Current Mailing Address as of 11/03/2004: **HARBOR BAY LANDING LLC, c/o CHIEN PING LIM, P.O. BOX 117610 , BURLINGAME, CA 94011-7610**

[Economic Unit](#) | [Parcel History](#)

Mailing Name	Historical Mailing Address	Document Date	Document Number	Value From Trans Tax	Parcel Count	Use
HARBOR BAY LANDING LLC c/o CHIEN PING LIU	PO BOX 117610 , BURLINGAME, CA 94011-7610	09/14/2001	TRAN-97574		1	<u>3700</u>
HARBOR BAY LANDING LLC c/o CHIEN PING LIU	PO BOX 117610 , BURLINGAME, CA 94011-7610	05/30/2001	2001-181413		2	<u>3700</u>
CHANG MICHAEL C ETAL List Owners	PO BOX 117610 , BURLINGAME, CA 94011-7610	04/10/2001	2001-119963		2	<u>3700</u>
B B & K HARBOR BAY LANDING INC c/o RREEF MANAGEMENT CO	5934 GIBRALTAR DR , PLEASANTON, CA 94588-2764	08/26/1994	1994-288624		3	<u>3700</u>

All information on this site is to be assumed accurate for property assessment purposes only, and is based upon the Assessor's knowledge of each property. Caution is advised for use other than its intended purpose.

The Alameda County Intranet site is best viewed in Internet Explorer Version 5.5 or later.
 Click [here](#) for more information regarding supported browsers.

Copyright © 2001 Alameda County



COUNTY OF ALAMEDA
Assessor's Office
Property Value System

[Help](#)

[New Query](#)

[History](#)

[Value](#)

[Transfer](#)

[Map](#)

[Glossary](#)

Parcel Number: **74-1045-10-1** Inactive: **N** Lien Date: **01/01/2008** Owner: **HARBOR BAY LANDING LLC**

Property Address: **3255 MECARTNEY RD, ALAMEDA, CA 94502**

Current Mailing Address as of 11/03/2004: **HARBOR BAY LANDING LLC, c/o CHIEN PING LIM, P.O. BOX 117610, BURLINGAME, CA 94011-7610**

[Economic Unit](#) | [Parcel History](#)

Mailing Name		Historical Mailing Address	Document Date	Document Number	Value From Trans Tax	Parcel Count	Use
HARBOR BAY LANDING LLC c/o CHIEN PING LIU	List Owners	PO BOX 117610 , BURLINGAME, CA 94011-7610	09/14/2001	TRAN-97574		1	3700
HARBOR BAY LANDING LLC c/o CHIEN PING LIU	List Owners	PO BOX 117610 , BURLINGAME, CA 94011-7610	05/30/2001	2001-181413		2	3700
CHANG MICHAEL C ETAL	List Owners	PO BOX 117610 , BURLINGAME, CA 94011-7610	04/10/2001	2001-119963		2	3700
B B & K HARBOR BAY LANDING INC c/o RREEF MANAGEMENT CO	List Owners	5934 GIBRALTAR DR , PLEASANTON, CA 94588-2764	08/26/1994	1994-288624		3	3700

All information on this site is to be assumed accurate for property assessment purposes only, and is based upon the Assessor's knowledge of each property. Caution is advised for use other than its intended purpose.

The Alameda County Intranet site is best viewed in Internet Explorer Version 5.5 or later.
 Click [here](#) for more information regarding supported browsers.

Copyright © 2001 Alameda County