



Chevron

hop 467

Chevron U.S.A. Products Company
6001 Bollinger Canyon Rd. Bldg. L
P. O. Box 6004
San Ramon, CA 94583-0804

Site Assessment and
Remediation Group
Phone (510) 842-9500
Fax (510) 842-3370

Date: November 17, 1999
To: Distribution
Re: Groundwater Monitoring Report, 9-1026

The enclosed groundwater monitoring report has been properly reviewed by a Chevron authorized representative. Agency guidelines have been followed. Blaine Tech Services is authorized to distribute the report directly to interested parties.

If you have any questions, please call me at (510) 842-8695.

Sincerely,

Brett Hunter
Site Assessment and Remediation
Project Manager

99 NOV 29 PM 4: 56

ENVIRONMENTAL PROTECTION

BLAINE
TECH SERVICES INC.



1680 ROGERS AVENUE
SAN JOSE, CALIFORNIA 95112-1105
(408) 573-7771 FAX
(408) 573-0555 PHONE

November 17, 1999

Brett Hunter
Chevron U.S.A. Products Company
P.O. Box 6004
San Ramon, CA 94583-0904

3rd Quarter 1999 Monitoring at 9-1026

Third Quarter 1999 Groundwater Monitoring at
Former Chevron Service Station Number 9-1026
3701 Broadway.
Oakland, CA

Monitoring Performed on September 29, 1999

Groundwater Sampling Report 990929-P-2

This report covers the routine monitoring of groundwater wells at this Chevron facility. Blaine Tech Services, Inc.'s work at the site includes inspection, gauging, evacuation, purgewater containment, sample collection and sample handling in accordance with standard procedures that conform to Regional Water Quality Control Board requirements.

Routine field data collection includes depth to water, total well depth, thickness of any separate immiscible layer, water column volume, calculated volume of a three-case volume purge, elapsed evacuation time, total volume of water removed, and standard water parameter instrument readings. Sample material is collected, contained, stored, and transported to the laboratory in conformance with EPA standards. Purgewater is, likewise, collected and transported to McKittrick Waste Treatment Site for disposal.

Basic field information is presented alongside analytical values excerpted from the laboratory report in the cumulative table of **WELL DATA AND ANALYTICAL RESULTS**. The full analytical report for the most recent samples is located in the **Analytical Appendix**. The table also contains new groundwater elevation calculations taken from the computer plotted gradient

map which is located in the **Professional Engineering Appendix**.

At a minimum, Blaine Tech Services, Inc. field personnel are certified upon completion of a forty-hour Hazardous Materials and Emergency Response training course per 29 CFR 1910.120. Field personnel are also enrolled in annual eight hour refresher courses.

Blaine Tech Services, Inc. conducts sampling and documentation assignments of this type as an independent third party. In order to avoid compromising the objectivity necessary for the proper and disinterested performance of this work, Blaine Tech Services, Inc. concentrates on objective data collection and does not participate in the interpretation of analytical results, the definition of geological or hydrological conditions, the formulation of recommendations, or the marketing of remedial systems.

Please call if you have any questions.

Yours truly,

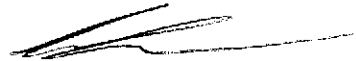

Scott Boor
Project Coordinator

SDB/jh

attachments: Professional Engineering Appendix
Cumulative Table of Well Data and Analytical Results
Analytical Appendix
Field Data Sheets

cc: Susan Hugo, Alameda County Health Care Services
W. Bruce Bercovich, Kay & Merkel
Greg Gurss, Gettler-Ryan, Inc.
Bette Owen, Chevron Products (w/o enclosure)

Professional Engineering Appendix

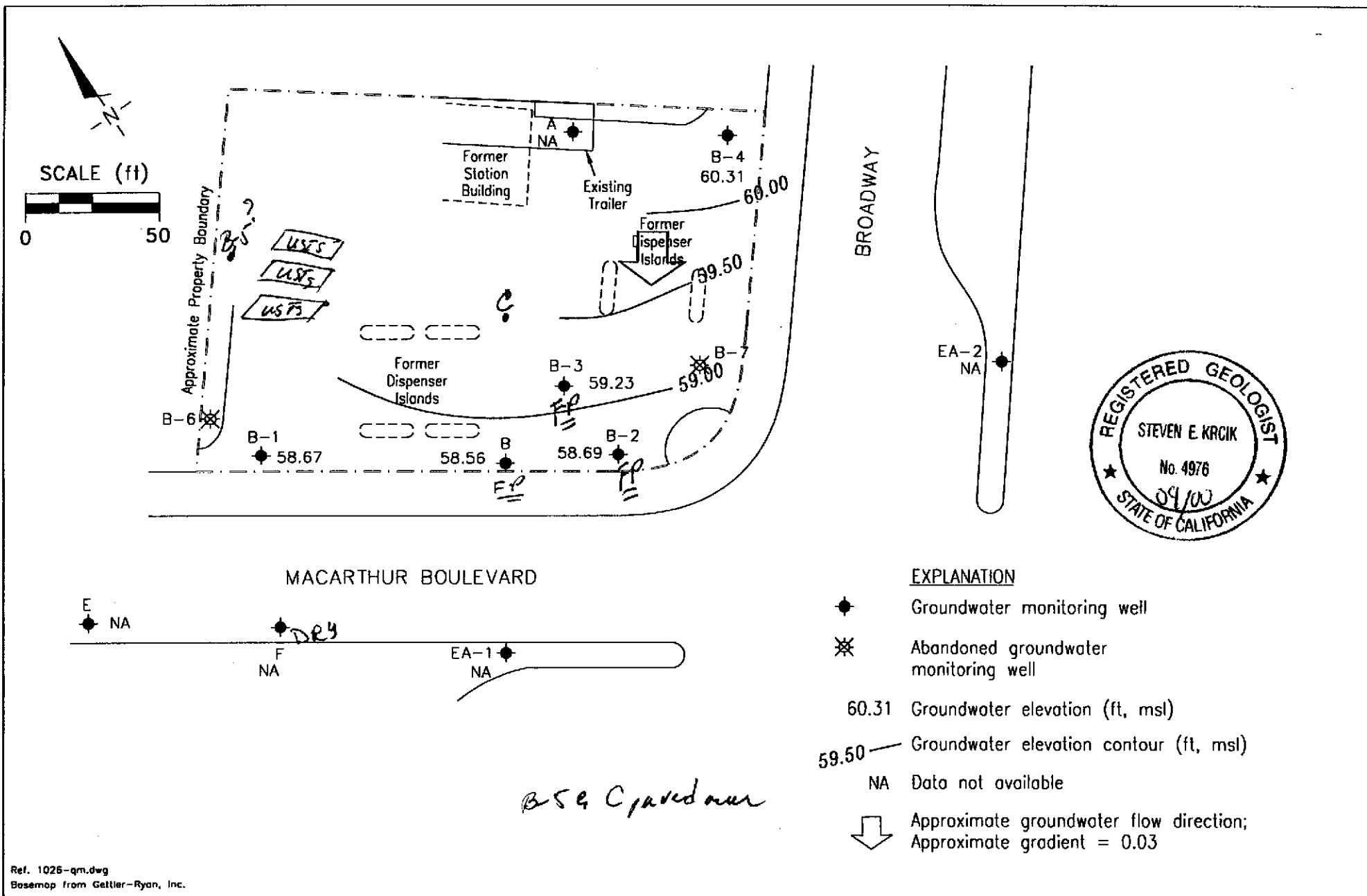

Ref. 1026-qm.dwg
Basemap from Gettler-Ryan, Inc.

PREPARED BY

RRM
engineering contracting firm

Chevron Station 9-1026
3701 Broadway
Oakland, California

GROUNDWATER ELEVATION CONTOUR MAP,
SEPTEMBER 29, 1999

FIGURE:
1
PROJECT:
DAC04

Table of Well Data and Analytical Results

Cumulative Table of Well Data and Analytical Results

Vertical Measurements are in feet.

Volumetric Measurements are in gallons.

Analytical results are in parts per billion (ppb).

DATE	Well Head Elev.	Ground Water Elev.	Depth To Water	SPH Thickness	SPH Removed	Total SPH Removed	Notes	TPH-Gasoline	Benzene	Toluene	Ethyl-Benzene	Xylene	MTBE
<i>A Screened 5-155</i>													
05/09/89	75.28	61.36	13.92	--	--	--	--	11,000	260	<2.0	94	230	--
08/09/89	75.28	59.66	15.62	--	--	--	--	12,000	370	<1.5	100	240	--
11/09/89	75.28	59.33	15.95	--	--	--	--	16,000	690	10	180	350	--
02/08/90	75.28	60.55	14.73	--	--	--	--	14,000	600	7.0	120	270	--
05/10/90	75.28	59.80	15.48	--	--	--	--	16,000	840	4.8	140	340	--
08/09/90	75.28	59.62	15.66	--	--	--	--	17,000	510	40	170	280	--
11/13/90	75.28	58.80	16.48	--	--	--	--	9000	570	3.1	86	170	--
03/27/91	75.28	--	--	--	--	--	--	8000	660	<5.0	110	250	--
04/05/91	75.28	62.06	13.22	--	--	--	--	--	--	--	--	--	--
06/19/91	75.28	59.91	15.37	--	--	--	--	8900	740	<3.0	120	280	--
08/21/91	75.28	59.29	15.99	--	--	--	--	6800	620	23	85	200	--
11/08/91	75.28	59.13	16.15	--	--	--	--	4000	640	<5.0	77	160	--
02/13/92	75.28	60.70	14.58	--	--	--	--	8000	860	<5.0	120	390	--
05/01/92	75.28	61.02	14.26	--	--	--	--	13,000	870	19	220	780	--
11/18/92	75.29	58.91	16.38	--	--	--	--	12,000	1500	83	360	530	--
03/19/93	75.29	63.13	12.16	--	--	--	--	14,000	820	6.1	180	420	--
06/10/93	75.29	61.04	14.25	--	--	--	--	9000	700	13	170	310	--
09/08/93	75.29	--	--	--	--	--	--	--	--	--	--	--	--
12/21/93	75.29	--	--	--	--	--	--	--	--	--	--	--	--
03/09/94	75.29	61.95	13.34	--	--	--	--	9600	860	21	200	390	--
09/21/94	75.29	--	--	--	--	--	Inaccessible	--	--	--	--	--	--
12/20/94	75.29	--	--	--	--	--	Inaccessible	--	--	--	--	--	--
03/28/95	75.29	--	--	--	--	--	Inaccessible	--	--	--	--	--	--
06/22/95	75.29	--	--	--	--	--	Inaccessible	--	--	--	--	--	--
09/21/95	75.29	--	--	--	--	--	Inaccessible	--	--	--	--	--	--
03/22/96	75.29	--	--	--	--	--	Inaccessible	--	--	--	--	--	--
09/25/96	75.29	--	--	--	--	--	Inaccessible	--	--	--	--	--	--
03/06/97	75.29	--	--	--	--	--	Inaccessible	--	--	--	--	--	--
09/12/97	75.29	60.73	14.56	--	--	--	--	2600	460	<10	70	11	67
04/02/98	75.29	66.54	8.75	--	--	--	--	1700*	130	1.7	44	42	<2.5
09/15/98	75.29	--	--	--	--	--	--	--	--	--	--	--	--
03/09/99	75.29	--	--	--	--	--	Inaccessible	--	--	--	--	--	--

*Chromatogram pattern indicated an unidentified hydrocarbon.

adjusted for fp: top of casing - depth to water + (0.8 x hydrocarbon thickness).
 Cumulative Table of Well Data and Analytical Results

Vertical Measurements are in feet.

Volumetric Measurements are in gallons.

Analytical results are in parts per billion (ppb).

DATE	Well Head Elev.	Ground Water Elev.	Depth To Water	SPH Thickness	SPH Removed	Total SPH Removed	Notes	TPH-Gasoline	Benzene	Toluene	Ethyl-Benzene	Xylene	MTBE
B	<i>EX-100 PROBE</i>	<i>2 inched 5-75.5</i>											
05/09/89	73.39	59.58	13.97	0.20	--	--							
08/09/89	73.39	57.86	15.69	0.20	--	--							
11/09/89	73.39	58.16	15.29	0.08	--	--	<i>poor surface water seals</i>						
02/08/90	73.39	58.93	14.46	--	--	--							
05/10/90	73.39	58.32	14.07	--	--	--							
08/09/90	73.39	58.27	15.12	--	--	--							
11/13/90	73.39	57.63	15.76	--	--	--							
04/05/91	73.39	60.01	13.38	--	--	--							
06/19/91	73.39	58.25	15.14	--	--	--		26,000	7100	370	430	1000	--
08/21/91	73.39	57.81	15.58	--	--	--		16,000	4900	270	390	640	--
11/08/91	73.39	57.68	15.71	--	--	--		11,000	2400	48	280	160	--
02/13/92	73.39	58.73	14.66	--	--	--		6800	2400	60	220	140	--
05/01/92	73.39	58.89	14.50	--	--	--	Sheen	16,000	6000	180	370	460	--
11/18/92	73.39	57.79	15.60	--	--	--		28,000	2200	150	920	4300	--
03/19/93	73.39	60.12	13.29	0.03	--	--							
06/10/93	73.39	59.11	14.30	0.03	--	--							
09/08/93	73.39	58.25	15.33	0.24	--	--							
12/21/93	73.39	58.76	14.73	0.12	--	--							
03/09/94	73.39	59.35	14.07	0.04	--	--							
09/21/94	73.39	57.91	15.50	0.02*	--	--							
12/20/94	73.39	59.88	13.75	0.12	--	--							
3/28/95	73.39	--	--	--	--	--							
06/22/95	73.39	58.92	14.56	0.11	1.000	1.000							
09/21/95	73.39	58.41	15.88	1.12	2.000	3.000							
03/22/96	73.39	61.19	13.02	1.02	2.000	5.000							
09/25/96	73.39	58.81	15.76	1.47	1.500	6.500							
03/06/97	73.39	59.95	14.30	1.08	2.000	8.500							
09/12/97	73.39	59.32	14.61	0.68	3.000	11.500							
04/02/98	73.39	61.04	12.50	0.19	3.000	14.500							
09/15/98	73.39	59.60	14.87	1.35	5.000	19.500							
03/09/99	73.39	60.41	13.41	0.54	0.132	19.632							
09/29/99	73.39	58.56	15.80	1.21	0.130	19.762							

*Approximate thickness; equipment not functioning properly.

Cumulative Table of Well Data and Analytical Results

Vertical Measurements are in feet.			Volumetric Measurements are in gallons.				Analytical results are in parts per billion (ppb).						
DATE	Well Head Elev.	Ground Water Elev.	Depth To Water	SPH Thickness	SPH Removed	Total SPH Removed	Notes	TPH-Gasoline	Benzene	Toluene	Ethyl-Benzene	Xylene	MTBE
B-1 <i>Revised 5 to 13.5 ft</i>													
05/09/89	71.77	59.19	12.58	--	--	--	--	16,000	2300	260	81	740	--
08/09/89	71.77	57.68	14.09	--	--	--	--	12,000	2600	340	100	870	--
11/09/89	71.77	57.71	14.06	--	--	--	--	17,000	340	140	110	760	--
02/08/90	71.77	59.12	12.65	--	--	--	--	5500	70	19	17	150	--
05/10/90	71.77	58.15	13.62	--	--	--	--	18,000	770	110	73	600	--
08/09/90	71.77	57.90	13.87	--	--	--	--	82,000	750	66	95	980	--
11/13/90	71.77	57.39	14.38	--	--	--	--	43,000	1300	120	74	760	--
03/27/91	71.77	--	--	--	--	--	--	18,000	580	92	94	770	--
04/05/91	71.77	60.04	11.73	--	--	--	--	--	--	--	--	--	--
06/19/91	71.77	58.21	13.56	--	--	--	--	21,000	910	56	96	810	--
08/21/91	71.77	57.87	13.90	--	--	--	--	50,000	2400	610	300	1800	--
11/08/91	71.77	57.72	14.05	--	--	--	--	<u>540,000</u>	3600	1500	1900	<u>5900</u>	--
02/13/92	71.77	59.09	12.68	--	--	--	--	20,000	500	100	150	920	--
05/01/92	71.77	58.85	12.92	--	--	--	Sheen	27,000	2800	200	310	1900	--
11/18/92	72.30	58.00	14.30	--	--	--	--	300	9.7	3.4	2.3	21	--
03/19/93	72.30	60.02	12.28	--	--	--	--	130	23	0.9	<0.5	5.6	--
06/10/93	72.30	59.26	13.04	--	--	--	--	170	21	1.1	0.8	6.6	--
09/08/93	72.30	58.46	13.88	0.05	--	--	--	--	--	--	--	--	--
12/21/93	72.30	58.77	13.53	--	--	--	--	<50	6.7	0.5	<0.5	1.2	--
03/09/94	72.30	59.65	12.65	--	--	--	--	1300	520	8.8	2.4	53	--
09/21/94	72.30	57.90	14.40	--	--	--	--	390	130	2.7	2.4	7.7	--
12/20/94	72.30	59.95	12.35	--	--	--	--	1600	520	9.9	8.9	34	--
03/28/95	72.30	61.54	10.76	--	--	--	--	160	38	2.1	1.4	5.4	--
06/22/95	72.30	59.70	12.60	--	--	--	--	340	73	3.1	2.4	7.5	--
09/21/95	72.30	58.65	13.65	--	--	--	--	140	19	1.0	1.2	6.1	--
03/22/96	72.30	61.36	10.94	--	--	--	--	200	<0.5	0.6	2.1	2.2	<5.0
09/25/96	72.30	58.54	13.76	--	--	--	--	690	5.4	1.2	1.6	6.8	<5.0
03/06/97	72.30	60.22	12.08	--	--	--	--	420	31	1.0	2.5	4.3	5.9
09/12/97	72.30	58.76	13.54	--	--	--	--	170	31	1.4	1.6	4.6	11
04/02/98	72.30	61.57	10.73	--	--	--	--	670*	91	4.2	8.7	17	<2.5
09/15/98	72.30	59.49	12.81	--	--	--	--	<50	1.5	<0.5	<0.5	<0.5	<10
03/09/99	72.30	60.69	11.61	--	--	--	--	1200	570	5.3	5.6	48	<25
09/29/99	72.30	58.67	13.63	--	--	--	--	<50	<0.5	<0.5	<0.5	<0.5	<2.5

*Chromatogram pattern indicated an unidentified hydrocarbon.

Cumulative Table of Well Data and Analytical Results

Vertical Measurements are in feet.

Volumetric Measurements are in gallons.

Analytical results are in parts per billion (ppb).

DATE	Well Head Elev.	Ground Water Elev.	Depth To Water	SPH Thickness	SPH Removed	Total SPH Removed	Notes	TPH-Gasoline	Benzene	Toluene	Ethyl-Benzene	Xylene	MTBE
B-2	<i>Screened fr. 5 - 16.5</i>												
05/09/89	74.51	59.93	14.58	--	--	--	--	170,000	30,000	8400	2300	12,000	--
08/09/89	74.51	58.45	16.06	--	--	--	--	60,000	29,000	8700	2400	12,000	--
11/09/89	74.51	57.56	16.95	--	--	--	--	110,000	32,000	5500	2800	12,000	--
02/08/90	74.51	58.95	15.56	--	--	--	--	67,000	28,000	5900	2300	11,000	--
05/10/90	74.51	58.57	15.94	--	--	--	--	69,000	24,000	4800	2000	11,000	--
08/09/90	74.51	58.54	15.97	--	--	--	--	100,000	33,000	4000	2100	12,000	--
11/13/90	74.51	57.81	16.70	--	--	--	--	110,000	33,000	4300	2900	13,000	--
03/27/91	74.51	--	--	--	--	--	--	160,000	26,000	3200	2600	15,000	--
04/05/91	74.51	60.31	14.20	--	--	--	--	--	--	--	--	--	--
06/19/91	74.51	58.68	15.83	--	--	--	--	100,000	22,000	2500	2000	11,000	--
08/21/91	74.51	58.20	16.31	--	--	--	--	80,000	28,000	2800	2400	12,000	--
11/08/91	74.51	57.91	16.60	--	--	--	--	94,000	29,000	1900	2200	11,000	--
02/13/92	74.51	58.58	15.93	--	--	--	--	280,000	34,000	2500	4600	23,000	--
05/01/92	74.51	59.57	14.94	--	--	--	Sheen	29,000	1700	300	1100	4300	--
11/18/92	74.52	57.81	16.71	--	--	--	--	26,000	11,000	170	870	950	--
03/19/93	74.52	60.46	14.06	--	--	--	--	110,000	28,000	1200	2200	12,000	--
06/10/93	74.52	59.64	14.88					140,000	15,000	930	1900	8800	--
09/08/93	74.52	58.52	16.03	0.04	--	--	--	--	--	--	--	--	--
12/21/93	74.52	58.91	15.61	--	--	--	--	980,000	21,000	30,000	9100	71,000	--
03/09/94	74.52	59.99	14.53	--	--	--	Sheen	110,000	23,000	920	1300	7800	--
9/21/94	74.52	--	--	--	--	--	Inaccessible	--	--	--	--	--	--
12/20/94	74.52	59.86	14.65	--	--	--	--	70,000	25,000	710	920	5300	--
03/28/95	74.52	62.22	12.30	--	--	--	--	76,000	20,000	920	1200	5200	--
06/22/95	74.52	60.30	14.22	--	--	--	--	89,000	21,000	38,000	1500	6800	--
09/21/95	74.52	58.72	15.80	--	--	--	--	84,000	24,000	2900	1800	9800	--
03/22/96	74.52	61.69	12.85	0.02	0.250	0.250	--	--	--	--	--	--	--
09/25/96	74.52	58.56	15.98	0.03	0.250	0.500	--	--	--	--	--	--	--
03/06/97	74.52	60.43	14.11	0.02	0.000	0.500	--	--	--	--	--	--	--
09/12/97	74.52	59.19	15.35	0.03	1.500	2.000	--	--	--	--	--	--	--
04/02/98	74.52	61.74	13.07	0.36	2.000	4.000	--	--	--	--	--	--	--
09/15/98	74.52	59.48	15.50	0.58	0.500	4.500	--	--	--	--	--	--	--
03/09/99	74.52	61.56	13.29	0.41	0.079	4.579	--	--	--	--	--	--	--
09/29/99	74.52	58.69	16.34	0.64	0.080	4.659	--	--	--	--	--	--	--

Cumulative Table of Well Data and Analytical Results

Vertical Measurements are in feet.

Volumetric Measurements are in gallons.

Analytical results are in parts per billion (ppb).

DATE	Well Head Elev.	Ground Water Elev.	Depth To Water	SPH Thickness	SPH Removed	Total SPH Removed	Notes	TPH-Gasoline	Benzene	Toluene	Ethyl-Benzene	Xylene	MTBE
B-3	<i>Well screened fr. 5-15.5 ft</i>												
05/09/89	74.12	60.01	14.02	--	--	--	--	70,000	12,000	9500	400	8900	--
08/09/89	74.12	58.74	15.38	--	--	--	--	--	--	--	--	--	--
11/09/89	74.12	58.61	15.55	0.05	--	--	--	--	--	--	--	--	--
02/08/90	74.12	59.44	14.68	<0.01	--	--	--	--	--	--	--	--	--
05/10/90	74.12	58.99	15.15	0.02	--	--	--	--	--	--	--	--	--
08/09/90	74.12	58.85	15.27	<0.01	--	--	--	--	--	--	--	--	--
11/13/90	74.12	58.13	16.04	0.06	--	--	--	--	--	--	--	--	--
04/05/91	74.12	60.82	13.30	<0.01	--	--	--	--	--	--	--	--	--
06/19/91	74.12	58.96	15.16	--	--	--	--	260,000	20,000	9000	2200	16,000	--
08/21/91	74.12	58.51	15.61	--	--	--	--	70,000	28,000	11,000	1800	11,000	--
11/08/91	74.12	58.35	15.77	--	--	--	--	150,000	29,000	9700	2200	13,000	--
02/13/92	74.12	59.24	14.88	--	--	--	--	100,000	27,000	9906	2000	11,000	--
05/01/92	74.12	59.93	14.20	0.01	--	--	--	--	--	--	--	--	--
11/18/92	74.13	58.47	15.68	0.03	--	--	--	--	--	--	--	--	--
03/19/93	74.13	61.24	13.75	1.08	--	--	--	--	--	--	--	--	--
06/10/93	74.13	60.04	14.79	0.87	--	--	--	--	--	--	--	--	--
09/08/93	74.13	58.81	15.38	0.08	--	--	--	--	--	--	--	--	--
12/21/93	74.13	59.39	14.74	--	--	--	--	1,100,000	18,000	29,000	8900	59,000	--
03/09/94	74.13	60.60	13.53	--	--	--	--	130,000	11,000	20,000	1700	15,000	--
09/21/94	74.13	58.45	15.70	0.02*	--	--	--	--	--	--	--	--	--
12/20/94	74.13	60.67	13.48	0.03	--	--	--	--	--	--	--	--	--
03/28/95	74.13	--	--	1.54	2.000	2.000	--	--	--	--	--	--	--
06/22/95	74.13	60.86	14.25	1.23	0.500	2.500	--	--	--	--	--	--	--
09/21/95	74.13	59.12	15.25	0.30	0.500	3.000	--	--	--	--	--	--	--
03/22/96	74.13	62.97	11.46	0.37	0.250	3.250	--	--	--	--	--	--	--
09/25/96	74.13	60.13	14.82	1.02	1.000	4.250	--	--	--	--	--	--	--
03/06/97	74.13	61.23	13.12	0.28	0.500	4.750	--	--	--	--	--	--	--
09/12/97	74.13	59.56	14.67	0.13	2.000	6.750	--	--	--	--	--	--	--
04/02/98	74.13	62.93	11.20	--	0.000	6.750	Sheen	160,000	27,000	26,000	2500	14,000	<500
09/15/98	74.13	60.12	14.05	0.05	0.500	7.250	--	--	--	--	--	--	--
03/09/99	74.13	62.77	11.41	0.06	0.053	7.303	--	--	--	--	--	--	--
09/29/99	74.13	59.23	15.00	0.13	0.070	7.373	--	--	--	--	--	--	--

*Approximate thickness; equipment not functioning properly.

Cumulative Table of Well Data and Analytical Results

Vertical Measurements are in feet.

Volumetric Measurements are in gallons.

Analytical results are in parts per billion (ppb).

DATE	Well Head Elev.	Ground Water Elev.	Depth To Water	SPH Thickness	SPH Removed	Total SPH Removed	Notes	TPH-Gasoline	Benzene	Toluene	Ethyl-Benzene	Xylene	MTBE
B-4 Screened fr. 5-17													
05/09/89	76.43	61.50	14.93	--	--	--	--	3600	840	34	120	200	--
08/09/89	76.43	59.78	16.65	--	--	--	--	<500	4200	130	370	260	--
11/09/89	76.43	--	--	--	--	--	--	5000	4200	83	400	250	--
02/08/90	76.43	59.44	16.99	--	--	--	--	14,000	6000	70	530	300	--
05/10/90	76.43	60.38	16.05	--	--	--	--	12,000	5400	130	460	320	--
08/09/90	76.43	59.94	16.49	--	--	--	--	16,000	7400	120	530	350	--
11/13/90	76.43	59.79	16.64	--	--	--	--	21,000	7000	100	550	320	--
03/27/91	76.43	59.01	17.42	--	--	--	--	17,000	8500	120	500	300	--
04/05/91	76.43	61.77	14.66	--	--	--	--	14,000	7700	75	610	210	--
06/19/91	76.43	59.95	16.48	--	--	--	--	16,000	7800	110	550	340	--
08/21/91	76.43	59.43	17.00	--	--	--	--	18,000	11,000	110	450	340	--
11/08/91	76.43	59.05	17.38	--	--	--	--	18,000	6800	98	500	620	--
02/13/92	76.43	60.01	16.42	--	--	--	--	15,000	9100	86	570	350	--
05/01/92	76.43	60.93	15.50	--	--	--	--	36,000	16,000	180	990	690	--
03/19/93	76.43	62.32	14.11	--	--	--	--	26,000	15,000	150	900	790	--
06/10/93	76.43	60.99	15.44	--	--	--	--	35,000	14,000	180	940	590	--
09/08/93	76.43	59.78	16.65	--	--	--	--	34,000	15,000	170	1100	870	--
12/21/93	76.43	59.98	16.45	--	--	--	--	30,000	12,000	74	610	340	--
03/09/94	76.43	61.55	14.88	--	--	--	--	37,000	15,000	140	1000	580	--
09/21/94	76.43	59.29	17.14	--	--	--	--	32,000	14,000	110	660	190	--
12/20/94	76.43	61.44	14.99	--	--	--	--	23,000	8400	97	640	530	--
03/28/95	76.43	65.10	11.33	--	--	--	--	27,000	9900	120	880	540	--
06/22/95	76.43	61.84	14.59	--	--	--	--	33,000	12,000	84	650	150	--
09/21/95	76.43	60.24	16.19	--	--	--	--	20,000	12,000	72	540	68	--
03/22/96	76.43	64.43	12.00	--	--	--	--	29,000	10,000	72	560	170	400
09/25/96	76.43	60.15	16.28	--	--	--	--	53,000	11,000	<50	160	74	<500
03/06/97	76.43	62.87	13.56	--	--	--	--	<5,000	17,000	<50	<50	<50	<500
09/12/97	76.43	60.41	16.02	--	--	--	--	7600	8100	65	520	38	300
04/02/98	76.43	64.58	11.85	--	--	--	--	28,000*	9700	59	760	220	<250
09/15/98	76.43	61.08	15.35	--	--	--	--	25,000	12,000	200	900	<200	<1000
03/09/99	76.43	64.11	12.32	--	--	--	--	21,000	11,000	<100	770	270	800
09/29/99	76.43	60.31	16.12	--	--	--	--	8610	9500	32.1	1160	88.2	260

*Chromatogram pattern indicated an unidentified hydrocarbon.

Cumulative Table of Well Data and Analytical Results

Vertical Measurements are in feet.			Volumetric Measurements are in gallons.				Analytical results are in parts per billion (ppb).						
DATE	Well Head Elev.	Ground Water Elev.	Depth To Water	SPH Thickness	SPH Removed	Total SPH Removed	Notes	TPH-Gasoline	Benzene	Toluene	Ethyl-Benzene	Xylene	MTBE
B-6													
05/09/89	72.66	60.55	12.11	--	--	--	--	26,000	120	110	250	1300	--
08/09/89	72.66	57.94	14.72	--	--	--	--	19,000	470	150	440	1400	--
11/09/89	72.66	58.81	13.85	--	--	--	--	13,000	70	36	36	440	--
02/08/90	72.66	64.93	7.73	--	--	--	--	2900	16	5.0	10	58	--
05/10/90	72.66	--	--	--	--	--	--	--	--	--	--	--	--
08/09/90	72.66	58.15	14.51	--	--	--	--	14,000	55	3.0	130	500	--
11/13/90	72.66	57.80	14.86	--	--	--	--	--	--	--	--	--	--
04/05/91	72.66	62.23	10.43	--	--	--	--	--	--	--	--	--	--
06/19/91	72.66	--	--	--	--	--	Abandoned	--	--	--	--	--	--
B-7													
05/09/89	75.40	60.67	14.73	--	--	--	--	210,000	13,000	19,000	2000	20,000	--
08/09/89	75.40	59.04	16.36	--	--	--	--	672,000	87,000	17,000	2700	30,000	--
11/09/89	75.40	58.76	16.64	--	--	--	--	150,000	7000	12,000	1800	16,000	--
02/08/90	75.40	59.71	15.69	--	--	--	--	41,000	2500	6900	1100	11,000	--
05/10/90	75.40	--	--	--	--	--	--	--	--	--	--	--	--
08/09/90	75.40	59.09	16.31	--	--	--	--	50,000	1100	3900	640	7200	--
11/13/90	75.40	58.31	17.09	--	--	--	--	--	--	--	--	--	--
04/05/91	75.40	61.04	14.36	--	--	--	--	--	--	--	--	--	--
06/19/91	75.40	--	--	--	--	--	Abandoned	--	--	--	--	--	--

Cumulative Table of Well Data and Analytical Results

Vertical Measurements are in feet.

Volumetric Measurements are in gallons.

Analytical results are in parts per billion (ppb).

DATE	Well	Ground	Depth	Total		Notes	TPH- Gasoline	Benzene	Toluene	Ethyl- Benzene	Xylene	MTBE
	Head Elev.	Water Elev.	To Water	SPH Thickness	SPH Removed							
E												
11/18/92	70.07	57.87	12.20	--	--	--	280	2.7	2.4	3.0	12	--
03/19/93	70.07	60.10	9.97	--	--	--	<50	<0.5	<0.5	<0.5	<1.5	--
06/10/93	70.07	59.09	10.98	--	--	--	<50	<0.5	<0.5	<0.5	<1.5	--
09/08/93	70.07	58.29	11.80	0.03	--	--	--	--	--	--	--	--
12/21/93	70.07	58.82	11.25	--	--	--	<50	<0.5	<0.5	<0.5	<0.5	--
03/09/94	70.07	59.40	10.67	--	--	--	<50	<0.5	0.7	<0.5	0.7	--
09/21/94	70.07	57.78	12.29	--	--	--	<50	2.5	<0.5	1.0	<0.5	--
12/20/94	70.07	54.54	15.53	--	--	--	<50	0.5	<0.5	<0.5	<0.5	--
03/28/95	70.07	61.62	8.45	--	--	--	<50	<0.5	<0.5	<0.5	<0.5	--
06/22/95	70.07	59.50	10.57	--	--	--	<50	<0.5	<0.5	<0.5	<0.5	--
09/21/95	70.07	58.48	11.59	--	--	--	<50	<0.5	<0.5	<0.5	<0.5	--
03/22/96	70.07	61.05	9.02	--	--	--	<50	<0.5	<0.5	<0.5	<0.5	<5.0
03/06/97	70.07	57.75	12.32	--	--	--	<50	<0.5	<0.5	<0.5	<0.5	<5.0
09/12/97	70.07	--	--	--	--	--	--	--	--	--	--	--
04/02/98	70.07	61.64	8.43	--	--	--	<50	<0.5	<0.5	<0.5	<0.5	<2.5
09/15/98	70.07	--	--	--	--	--	--	--	--	--	--	--
03/09/99	70.07	60.65	9.42	--	--	--	<50	<0.5	<0.5	<0.5	<0.5	<2.5

Cumulative Table of Well Data and Analytical Results

Vertical Measurements are in feet.

Volumetric Measurements are in gallons.

Analytical results are in parts per billion (ppb).

DATE	Well Head Elev.	Ground Water Elev.	Depth To Water	SPH Thickness	SPH Removed	Total SPH Removed	Notes	TPH-Gasoline	Benzene	Toluene	Ethyl-Benzene	Xylene	MTBE
<i>F Screened 10-19</i>													
05/09/89	72.01	53.31	18.70	--	--	--	--	<500	<0.5	<0.5	0.6	1.0	--
08/09/89	72.01	52.98	19.03	--	--	--	--	--	--	--	--	--	--
11/09/89	72.01	52.99	19.02	--	--	--	--	--	--	--	--	--	--
02/08/90	72.01	53.31	18.70	--	--	--	--	<50	0.4	<0.3	0.3	<0.6	--
05/10/90	72.01	53.03	18.98	--	--	--	--	--	--	--	--	--	--
08/09/90	72.01	53.06	18.95	--	--	--	--	--	--	--	--	--	--
11/13/90	72.01	52.91	19.10	--	--	--	--	--	--	--	--	--	--
03/27/91	72.01	--	--	--	--	--	--	64	<0.5	<0.5	<0.5	1.0	--
06/19/91	72.01	53.06	18.95	--	--	--	--	--	--	--	--	--	--
08/21/91	72.01	<52.07	>19.94	--	--	--	--	--	--	--	--	--	--
11/08/91	72.01	<52.07	>19.94	--	--	--	--	--	--	--	--	--	--
02/13/92	72.01	53.41	18.60	--	--	--	--	<50	<0.5	<0.5	<0.5	<0.5	--
05/01/92	72.01	--	Dry	--	--	--	--	--	--	--	--	--	--
11/18/92	71.72	56.87	14.85	--	--	--	--	<50	<0.5	<0.5	<0.5	<0.5	--
03/19/93	71.72	57.47	14.25	--	--	--	--	<50	<0.5	<0.5	<0.5	<1.5	--
06/10/93	71.72	57.80	13.92	--	--	--	--	<50	<0.5	<0.5	<0.5	<1.5	--
09/08/93	71.72	56.95	14.80	0.04	--	--	--	--	--	--	--	--	--
12/21/93	71.72	58.41	13.31	--	--	--	--	<50	<0.5	<0.5	<0.5	<0.5	--
03/09/94	71.72	58.73	12.99	--	--	--	--	<50	<0.5	<0.5	<0.5	<0.5	--
09/21/94	71.72	55.42	16.30	--	--	--	--	<50	<0.5	<0.5	<0.5	<0.5	--
12/20/94	71.72	59.15	12.57	--	--	--	--	<50	<0.5	<0.5	<0.5	<0.5	--
03/28/95	71.72	62.77	8.95	--	--	--	--	<50	<0.5	<0.5	<0.5	<0.5	--
06/22/95	71.72	57.95	13.77	--	--	--	--	<50	<0.5	<0.5	<0.5	<0.5	--
09/21/95	71.72	58.27	13.45	--	--	--	--	<50	<0.5	<0.5	<0.5	<0.5	--
03/22/96	71.72	60.56	11.16	--	--	--	--	<50	<0.5	<0.5	<0.5	<0.5	<5.0
03/06/97	71.72	60.34	11.38	--	--	--	--	<50	<0.5	<0.5	<0.5	<0.5	<5.0
09/12/97	71.72	--	--	--	--	--	--	--	--	--	--	--	--
04/02/98	71.72	58.60	13.12	--	--	--	--	<50	<0.5	<0.5	<0.5	<0.5	<2.5
09/15/98	71.72	--	--	--	--	--	--	--	--	--	--	--	--
03/09/99	71.72	58.05	13.67	--	--	--	--	<50	<0.5	<0.5	<0.5	<0.5	<2.5

Cumulative Table of Well Data and Analytical Results

Vertical Measurements are in feet.			Volumetric Measurements are in gallons.				Analytical results are in parts per billion (ppb).						
DATE	Well Head Elev.	Ground Water Elev.	Depth To Water	SPH Thickness	SPH Removed	Total SPH Removed	Notes	TPH-Gasoline	Benzene	Toluene	Ethyl-Benzene	Xylene	MTBE
EA-1	<i>Screened fr. 12 to 16 ft</i>												
05/09/89	73.94	59.38	14.56	--	--	--	--	<500	<0.5	<0.5	<0.5	<0.5	--
08/09/89	73.94	57.85	16.09	--	--	--	--	<500	<0.5	<0.5	<0.5	<0.5	--
11/09/89	73.94	58.10	15.84	--	--	--	--	<500	<0.5	<0.5	<0.5	<0.5	--
02/08/90	73.94	58.89	15.05	--	--	--	--	<50	<0.3	<0.3	<0.3	<0.6	--
05/10/90	73.94	58.29	15.65	--	--	--	--	<50	1.0	0.3	<0.3	<0.6	--
08/09/90	73.94	58.27	15.67	--	--	--	--	<50	<0.3	<0.3	<0.3	<0.6	--
11/13/90	73.94	57.62	16.32	--	--	--	--	<50	<0.4	<0.3	<0.3	<0.4	--
03/27/91	73.94	--	--	--	--	--	--	<50	0.7	0.5	<0.5	<0.5	--
04/05/91	73.94	59.91	14.03	--	--	--	--	--	--	--	--	--	--
06/19/91	73.94	58.38	15.56	--	--	--	--	<50	<0.5	<0.5	<0.5	<0.5	--
08/21/91	73.94	57.95	15.99	--	--	--	--	<50	<0.4	<0.3	<0.3	<0.4	--
11/08/91	73.94	57.81	16.13	--	--	--	--	<50	<0.5	<0.5	<0.5	<0.5	--
02/13/92	73.94	58.84	15.10	--	--	--	--	<50	<0.5	<0.5	<0.5	<0.5	--
05/01/92	73.94	55.14	18.80	--	--	--	--	<50	2.7	<0.5	<0.5	<0.5	--
11/18/92	71.85	55.88	15.97	--	--	--	--	<10	<0.3	<0.3	<0.3	<0.5	--
03/19/93	71.85	58.19	13.66	--	--	--	--	<50	<0.5	<0.5	<0.5	<1.5	--
06/10/93	71.85	57.14	14.71	--	--	--	--	<50	<0.5	<0.5	<0.5	<1.5	--
09/08/93	71.85	56.33	15.58	0.08	--	--	--	--	--	--	--	--	--
12/21/93	71.85	56.83	15.02	--	--	--	--	<50	<0.5	<0.5	<0.5	<0.5	--
03/09/94	71.85	57.47	14.38	--	--	--	--	<50	<0.5	1.0	<0.5	<0.5	--
09/21/94	71.85	55.73	16.12	--	--	--	--	<50	<0.5	<0.5	<0.5	<0.5	--
12/20/94	71.85	57.80	14.05	--	--	--	--	<50	<0.5	<0.5	<0.5	<0.5	--
03/28/95	71.85	59.80	12.05	--	--	--	--	<50	<0.5	<0.5	<0.5	<0.5	--
06/22/95	71.85	57.50	14.35	--	--	--	--	<50	2.0	<0.5	<0.5	<0.5	--
09/21/95	71.85	56.49	15.36	--	--	--	--	<50	<0.5	<0.5	<0.5	<0.5	--
03/22/96	71.85	59.14	12.71	--	--	--	--	<50	<0.5	<0.5	<0.5	<0.5	<5.0
03/06/97	71.85	57.97	13.88	--	--	--	--	<50	2.8	<0.5	<0.5	0.8	<5.0
09/12/97	71.85	--	--	--	--	--	--	--	--	--	--	--	--
04/02/98	71.85	59.16	12.69	--	--	--	--	<50	<0.5	<0.5	<0.5	<0.5	<2.5
09/15/98	71.85	--	--	--	--	--	--	--	--	--	--	--	--
03/09/99	71.85	58.85	13.00	--	--	--	--	<50	<0.5	<0.5	<0.5	<0.5	<2.5

Cumulative Table of Well Data and Analytical Results

Vertical Measurements are in feet.

Volumetric Measurements are in gallons.

Analytical results are in parts per billion (ppb).

DATE	Vertical Measurements are in feet.			Volumetric Measurements are in gallons.				Analytical results are in parts per billion (ppb).					
	Well Head Elev.	Ground Water Elev.	Depth To Water	SPH Thickness	SPH Removed	Total SPH Removed	Notes	TPH-Gasoline	Benzene	Toluene	Ethyl-Benzene	Xylene	MTBE
EA-2	<i>Screened fr. 10 to 17</i>												
05/09/89	75.24	59.29	15.95	--	--	--	--	760	<0.5	<0.5	1.1	<0.5	--
08/09/89	75.24	57.79	17.45	--	--	--	--	<500	<0.5	<0.5	<0.5	<0.5	--
11/09/89	75.24	57.83	17.41	--	--	--	--	<500	<0.5	1.0	<0.5	<0.5	--
02/08/90	75.24	58.67	16.57	--	--	--	--	190	<0.3	<0.3	<0.3	<0.6	--
05/10/90	75.24	58.12	17.12	--	--	--	--	<50	<0.3	<0.3	<0.3	<0.6	--
08/09/90	75.24	58.04	17.20	--	--	--	--	120	<0.3	<0.3	<0.3	<0.6	--
11/13/90	75.24	57.36	17.88	--	--	--	--	160	<0.4	1.0	<0.3	<0.4	--
03/27/91	75.24	--	--	--	--	--	--	110	<0.5	<0.5	<0.5	<0.5	--
04/05/91	75.24	59.70	15.54	--	--	--	--	--	--	--	--	--	--
06/19/91	75.24	58.17	17.07	--	--	--	--	<50	<0.5	<0.5	<0.5	<0.5	--
08/21/91	75.24	57.78	17.46	--	--	--	--	70	0.8	1.4	<0.3	<0.4	--
11/08/91	75.24	57.66	17.58	--	--	--	--	<50	<0.5	0.7	<0.5	<0.5	--
02/13/92	75.24	58.55	16.69	--	--	--	--	<50	<0.5	<0.5	<0.5	<0.5	--
05/01/92	75.24	59.08	16.16	--	--	--	--	340	<0.5	2.6	0.7	<0.5	--
11/18/92	76.24	58.63	17.61	--	--	--	--	450	<0.5	3.3	<0.5	0.8	--
03/19/93	76.24	61.24	15.00	--	--	--	--	450	<0.5	2.3	0.6	<1.5	--
06/10/93	76.24	60.16	16.08	--	--	--	--	250	<0.5	1.3	<0.5	<1.5	--
09/08/93	76.24	59.17	17.07	--	--	--	--	<50	<0.5	<0.5	<0.5	<1.5	--
12/21/93	76.24	59.64	16.60	--	--	--	--	170	<0.5	1.3	<0.5	<0.5	--
03/09/94	76.24	60.41	15.83	--	--	--	--	200	1.8	1.4	<0.5	<0.5	--
09/21/94	76.24	58.64	17.60	--	--	--	--	<50	<0.5	<0.5	<0.5	<0.5	--
12/20/94	76.24	60.71	15.53	--	--	--	--	950	31	15	1.7	<0.5	--
03/28/95	76.24	62.96	13.28	--	--	--	--	71	2.0	0.6	<0.5	<0.5	--
06/22/95	76.24	60.62	15.62	--	--	--	--	300	<0.5	3.7	<0.5	0.6	--
09/21/95	76.24	59.46	16.78	--	--	--	--	170	<0.5	<0.5	<0.5	<0.5	--
03/22/96	76.24	62.36	13.88	--	--	--	--	90	<0.5	<0.5	<0.5	<0.5	<5.0
03/06/97	76.24	61.18	15.06	--	--	--	--	<50	<0.5	<0.5	<0.5	<0.5	<5.0
09/12/97	76.24	--	--	--	--	--	--	--	--	--	--	--	--
04/02/98	76.24	62.51	13.73	--	--	--	--	230*	0.99	<0.5	<0.5	<0.5	<2.5
09/15/98	76.24	--	--	--	--	--	--	--	--	--	--	--	--
03/09/99	76.24	62.03	14.21	--	--	--	--	<50	<0.5	<0.5	<0.5	<0.5	<2.5

*Chromatogram pattern indicated an unidentified hydrocarbon.

Cumulative Table of Well Data and Analytical Results

Vertical Measurements are in feet.

Volumetric Measurements are in gallons.

Analytical results are in parts per billion (ppb).

DATE	Well Head Elev.	Ground Water Elev.	Depth To Water	SPH Thickness	SPH Removed	Total SPH Removed	Notes	TPH-Gasoline	Benzene	Toluene	Ethyl-Benzene	Xylene	MTBE
TRIP BLANK													
05/09/89	--	--	--	--	--	--	--	<500	<0.5	<0.5	<0.5	<0.5	--
08/09/89	--	--	--	--	--	--	--	<500	<0.5	<0.5	<0.5	<0.5	--
11/09/89	--	--	--	--	--	--	--	<500	<0.5	<0.5	<0.5	<0.5	--
02/08/90	--	--	--	--	--	--	--	<50	<0.3	<0.3	<0.3	<0.6	--
05/10/90	--	--	--	--	--	--	--	<50	<0.3	<0.3	<0.3	<0.6	--
08/09/90	--	--	--	--	--	--	--	<50	<0.3	<0.3	<0.3	<0.6	--
11/13/90	--	--	--	--	--	--	--	<50	<0.4	<0.3	<0.3	<0.4	--
03/27/91	--	--	--	--	--	--	--	<50	<0.5	<0.5	<0.5	<0.5	--
06/19/91	--	--	--	--	--	--	--	<50	<0.5	<0.5	<0.5	<0.5	--
08/21/91	--	--	--	--	--	--	--	<50	<0.4	<0.3	<0.3	<0.4	--
11/08/91	--	--	--	--	--	--	--	<50	<0.5	<0.5	<0.5	<0.5	--
02/13/92	--	--	--	--	--	--	--	<50	<0.5	<0.5	<0.5	<0.5	--
05/01/92	--	--	--	--	--	--	--	<50	<0.5	<0.5	<0.5	<0.5	--
11/18/92	--	--	--	--	--	--	--	<50	<0.5	<0.5	<0.5	<0.5	--
03/19/93	--	--	--	--	--	--	--	<50	<0.5	<0.5	<0.5	<1.5	--
06/10/93	--	--	--	--	--	--	--	<50	<0.5	<0.5	<0.5	<1.5	--
09/08/93	--	--	--	--	--	--	--	<50	<0.5	<0.5	<0.5	<1.5	--
12/21/93	--	--	--	--	--	--	--	<50	<0.5	<0.5	<0.5	<0.5	--
03/09/94	--	--	--	--	--	--	--	<50	<0.5	<0.5	<0.5	<0.5	--
09/21/94	--	--	--	--	--	--	--	<50	<0.5	<0.5	<0.5	<0.5	--
12/20/94	--	--	--	--	--	--	--	<50	<0.5	<0.5	<0.5	<0.5	--
03/28/95	--	--	--	--	--	--	--	<50	<0.5	<0.5	<0.5	<0.5	--
06/22/95	--	--	--	--	--	--	--	<50	<0.5	<0.5	<0.5	<0.5	--
09/21/95	--	--	--	--	--	--	--	<50	<0.5	<0.5	<0.5	<0.5	--
03/22/96	--	--	--	--	--	--	--	<50	<0.5	<0.5	<0.5	<0.5	<5.0
09/25/96	--	--	--	--	--	--	--	<50	<0.5	<0.5	<0.5	<0.5	<5.0
03/06/97	--	--	--	--	--	--	--	<50	<0.5	<0.5	<0.5	<0.5	<5.0
09/12/97	--	--	--	--	--	--	--	<50	<0.5	<0.5	<0.5	<0.5	<2.5

CONTINUED ON NEXT PAGE

Cumulative Table of Well Data and Analytical Results

Vertical Measurements are in feet.			Volumetric Measurements are in gallons.				Analytical results are in parts per billion (ppb).						
DATE	Well Head Elev.	Ground Water Elev.	Depth To Water	SPH Thickness	SPH Removed	Total SPH Removed	Notes	TPH-Gasoline	Benzene	Toluene	Ethyl-Benzene	Xylene	MTBE
TRIP BLANK (CONT'D)													
04/02/98	--	--	--	--	--	--	--	<50	<0.5	<0.5	<0.5	<0.5	<2.5
09/15/98	--	--	--	--	--	--	--	<50	<0.5	<0.5	<0.5	<0.5	<10
03/09/99	--	--	--	--	--	--	--	<50	<0.5	<0.5	<0.5	<0.5	<2.5
09/29/99	--	--	--	--	--	--	--	<50	<0.5	<0.5	<0.5	<0.5	<2.5

Notes:

Blaine Tech Services, Inc. began routine monitoring of the groundwater wells at this site on March 9, 1999.

Earlier field data and analytical results were drawn from the September 15, 1998 Gettler-Ryan, Inc. report.

Analytical results and groundwater data prior to 1995 were compiled from the quarterly groundwater monitoring reports prepared for Chevron by Sierra Environmental Services.

Analytical methods prior to September 21, 1994 are assumed to be 8015/8020.

When separate-phase hydrocarbons are present, ground water elevation is adjusted using the relation:

$$\text{Corrected ground water elevation} = \text{Top-of-casing elevation} - \text{depth to water} + (0.8 \times \text{hydrocarbon thickness}).$$

ABBREVIATIONS:

TPH = Total Petroleum Hydrocarbons

ND = Not detected at or above the minimum quantitation limit. See laboratory reports for minimum quantitation limits.

SPH = Separate-phase Hydrocarbons

MTBE = Methyl tertiary-butyl ether

Analytical Appendix



October 20, 1999

Scott Boor
Blaine Tech Services (Chev)
1680 Rogers Avenue
San Jose, CA 95112

RE: Chevron 9-1026/M909ACB

Dear Scott Boor

Enclosed are the results of analyses for sample(s) received by the laboratory on September 30, 1999. If you have any questions concerning this report, please feel free to contact me.

Sincerely,



Wendy Bonnes
Project Manager

CA ELAP Certificate Number 1210





Blaine Tech Services (Chev) 1680 Rogers Avenue San Jose, CA 95112	Project: Chevron 9-1026 3701 Broadway, Oakland Project Number: 990929-P2 Project Manager: Scott Boor	Sampled: 9/29/99 Received: 9/30/99 Reported: 10/20/99
---	--	---

ANALYTICAL REPORT FOR M909ACB

Sample Description	Laboratory Sample Number	Sample Matrix	Date Sampled
B-1	M909ACB-01	Water	9/29/99
B-4	M909ACB-02	Water	9/29/99
TB	M909ACB-03	Water	9/29/99





Blaine Tech Services (Chev) 1680 Rogers Avenue San Jose, CA 95112	Project: Chevron 9-1026 3701 Broadway, Oakland Project Number: 990929-P2 Project Manager: Scott Boor	Sampled: 9/29/99 Received: 9/30/99 Reported: 10/20/99
---	--	---

**Total Purgeable Hydrocarbons (C6-C12), BTEX and MTBE by DHS LUFT
Sequoia Analytical - Morgan Hill**

Analyte	Batch Number	Date Prepared	Date Analyzed	Surrogate Limits	Reporting Limit	Result	Units	Notes*
<u>B-1</u>				<u>M909ACB-01</u>			<u>Water</u>	
Purgeable Hydrocarbons	9100276	10/11/99	10/11/99		50.0	ND	ug/l	
Benzene	"	"	"		0.500	ND	"	
Toluene	"	"	"		0.500	ND	"	
Ethylbenzene	"	"	"		0.500	ND	"	
Xylenes (total)	"	"	"		0.500	ND	"	
Methyl tert-butyl ether	"	"	"		2.50	ND	"	
Surrogate: a,a,a-Trifluorotoluene	"	"	"	70.0-130		101	%	
<u>B-4</u>				<u>M909ACB-02</u>			<u>Water</u>	
Purgeable Hydrocarbons	9100276	10/11/99	10/11/99		2500	8610	ug/l	1
Benzene	"	"	10/12/99		100	9500	"	
Toluene	"	"	10/11/99		25.0	32.1	"	
Ethylbenzene	"	"	"		25.0	1160	"	
Xylenes (total)	"	"	"		25.0	88.2	"	
Methyl tert-butyl ether	"	"	"		125	260	"	
Surrogate: a,a,a-Trifluorotoluene	"	"	"	70.0-130		112	%	
<u>TB</u>				<u>M909ACB-03</u>			<u>Water</u>	
Purgeable Hydrocarbons	9100276	10/11/99	10/11/99		50.0	ND	ug/l	
Benzene	"	"	"		0.500	ND	"	
Toluene	"	"	"		0.500	ND	"	
Ethylbenzene	"	"	"		0.500	ND	"	
Xylenes (total)	"	"	"		0.500	ND	"	
Methyl tert-butyl ether	"	"	"		2.50	ND	"	
Surrogate: a,a,a-Trifluorotoluene	"	"	"	70.0-130		107	%	





Blaine Tech Services (Chev) 1680 Rogers Avenue San Jose, CA 95112	Project: Chevron 9-1026 3701 Broadway, Oakland Project Number: 990929-P2 Project Manager: Scott Boor	Sampled: 9/29/99 Received: 9/30/99 Reported: 10/20/99
---	--	---

**Total Purgeable Hydrocarbons (C6-C12), BTEX and MTBE by DHS LUFT/Quality Control
Sequoia Analytical - Morgan Hill**

Analyte	Date Analyzed	Spike Level	Sample Result	QC Result	Units	Reporting Limit Recov. Limits	Recov. %	RPD Limit	RPD %	Notes*
Batch: 9100276		Date Prepared: 10/11/99			Extraction Method: EPA 5030B [P/T]					
Blank		9100276-BLK1								
Purgeable Hydrocarbons	10/11/99			ND	ug/l	50.0				
Benzene	"			ND	"	0.500				
Toluene	"			ND	"	0.500				
Ethylbenzene	"			ND	"	0.500				
Xylenes (total)	"			ND	"	0.500				
Methyl tert-butyl ether	"			ND	"	2.50				
<i>Surrogate: a,a,a-Trifluorotoluene</i>	"	10.0		10.9	"	70.0-130	109			
LCS		9100276-BS1								
Benzene	10/11/99	10.0		11.0	ug/l	70.0-130	110			
Toluene	"	10.0		10.5	"	70.0-130	105			
Ethylbenzene	"	10.0		10.7	"	70.0-130	107			
Xylenes (total)	"	30.0		32.7	"	70.0-130	109			
<i>Surrogate: a,a,a-Trifluorotoluene</i>	"	10.0		10.2	"	70.0-130	102			
Matrix Spike		9100276-MS1	M909ACB-01							
Benzene	10/11/99	10.0	ND	9.52	ug/l	60.0-140	95.2			
Toluene	"	10.0	ND	9.98	"	60.0-140	99.8			
Ethylbenzene	"	10.0	ND	10.4	"	60.0-140	104			
Xylenes (total)	"	30.0	ND	31.0	"	60.0-140	103			
<i>Surrogate: a,a,a-Trifluorotoluene</i>	"	10.0		9.83	"	70.0-130	98.3			
Matrix Spike Dup		9100276-MSD1	M909ACB-01							
Benzene	10/11/99	10.0	ND	9.83	ug/l	60.0-140	98.3	25.0	3.20	
Toluene	"	10.0	ND	10.5	"	60.0-140	105	25.0	5.08	
Ethylbenzene	"	10.0	ND	10.9	"	60.0-140	109	25.0	4.69	
Xylenes (total)	"	30.0	ND	32.3	"	60.0-140	108	25.0	4.74	
<i>Surrogate: a,a,a-Trifluorotoluene</i>	"	10.0		9.67	"	70.0-130	96.7			





Blaine Tech Services (Chev) 1680 Rogers Avenue San Jose, CA 95112	Project: Chevron 9-1026 3701 Broadway, Oakland	Sampled: 9/29/99
	Project Number: 990929-P2	Received: 9/30/99
	Project Manager: Scott Boor	Reported: 10/20/99

Notes and Definitions

#	Note
1	Chromatogram Pattern: Gasoline C6-C12
DET	Analyte DETECTED
ND	Analyte NOT DETECTED at or above the reporting limit
NR	Not Reported
dry	Sample results reported on a dry weight basis
Recov.	Recovery
RPD	Relative Percent Difference



Fax copy of Lab Report and COC to Chevron Contact: Yes No

Chain-of-Custody-Record

Chevron Products Co.
 P.O. BOX 6004
 San Ramon, CA 94583
 FAX (925)842-8370

Chevron Facility Number 9-1026
 Facility Address 3701 Broadway, Oakland
 Consultant Project Number 990929-P2
 Consultant Name BLAINE TECH SERVICE, INC.
 Address 1680 ROGERS AVE., SAN JOSE
 Project Contact (Name) CHRISTINE LILLIE
 (Phone) 408-573-0555 (Fax Number) 408-573-7771

Chevron Contact (Name) PHIL BRIGGS
 (Phone) (925) 842-9136
 Laboratory Name SEQUOIA
 Laboratory Service Order 9144488 M909 ACB
 Laboratory Service Code ZZ02800
 Samples Collected by (Name) PAUL SAMMA
 Signature [Signature]

State Method: CA OR WA NW Series CO UT

Sample Number	Number of Containers	Matrix S = Soil W = Water C = Charcoal	Sample Preservation	Date/Time	State Method													Remarks	
					BTEX/MTBE+TPH GAS (8020 + 8015)	BTEX + TPH GAS (8020 + 8015)	TPH Diesel (8015)	Oxylenates (8260)	Purgeable Halocarbons (8010)	Purgeable Organics (8260)	Extractable Organics (8270)	Oil and Grease (8520)	Metals (ICAP or AA) Cd,Cr,Pb,Zn,Ni	BTEX (8020)	BTEX/MTBE/Naph. (8020)	TPH - HCD	TPH-D Extended	Lab Sample No.	
B-1	3	W		9/30 11:15	X														01
D-4	4			11:35	X														02
TS	2				X														03

Relinquished By (Signature) <u>[Signature]</u>	Organization <u>Blaine</u>	Date/Time <u>9/30 9:03</u>	Received By (Signature) <u>[Signature]</u>	Organization <u>Sequoia</u>	Date/Time <u>9/30/99</u>	Iced Y/N	Turn Around Time (Circle Choice) <input type="checkbox"/> 24 Hrs. <input type="checkbox"/> 48 Hrs. <input type="checkbox"/> 5 Days <input type="checkbox"/> 10 Days <input type="checkbox"/> As Contracted
Relinquished By (Signature) <u>[Signature]</u>	Organization	Date/Time <u>9/30/99</u>	Received By (Signature) <u>[Signature]</u>	Organization	Date/Time <u>9/28/99</u>	Iced Y/N	
Relinquished By (Signature)	Organization	Date/Time	Received For Laboratory By (Signature)	Organization	Date/Time	Iced Y/N	

LILLIE

Field Data Sheets

CHEVRON WELL MONITORING DATA SHEET

Project #: 990929-P2	Station #: 9-1026
Sampler: PA-1	Date: 9-29-99
Well I.D.: B	Well Diameter: 2 3 (4) 6 8
Total Well Depth:	Depth to Water: 15.80
Depth to Free Product: 14.59	Thickness of Free Product (feet): 1.21
Referenced to: PVC Grade	D.O. Meter (if req'd): YSI HACH

Well Diameter	Multiplier	Well Diameter	Multiplier
2"	0.16	5"	1.02
3"	0.37	6"	1.47
4"	0.65	Other	radius ² * 0.163

Purge Method: Bailer Disposable Bailer Middleburg Electric Submersible Extraction Pump Other: _____	Sampling Method: Bailer Disposable Bailer Extraction Port Other: _____
---	--

_____	X	_____	=	_____ Gals.
1 Case Volume (Gals.)		Specified Volumes		Calculated Volume

Time	Temp (°F)	pH	Cond.	Gals. Removed	Observations
					Ba: 1001 SPH APPROX
					500 mL

Did well dewater?	Yes <input checked="" type="checkbox"/>	No <input type="checkbox"/>	Gallons actually evacuated: _____
Sampling Time:	Sampling Date: _____		
Sample I.D.:	Laboratory: Sequoia CORE N. Creek Assoc. Labs		
Analyzed for: TPH-G BTEX MTBE TPH-D	Other: _____		
Duplicate I.D.:	Analyzed for: TPH-G BTEX MTBE TPH-D Other: _____		
D.O. (if req'd):	Pre-purge: _____	mg/L	Post-purge: _____ mg/L
O.R.P. (if req'd):	Pre-purge: _____	mV	Post-purge: _____ mV

CHEVRON WELL MONITORING DATA SHEET

Project #: <u>990929-P2</u>	Station #: <u>9-1026</u>
Sampler: <u>PAV1</u>	Date: <u>9-29-99</u>
Well I.D.: <u>B-1</u>	Well Diameter: 2 3 <u>4</u> 6 8
Total Well Depth: <u>33.05</u>	Depth to Water: <u>13.63</u>
Depth to Free Product:	Thickness of Free Product (feet):
Referenced to: <u>PVC</u> Grade	D.O. Meter (if req'd): YSI HACH

Well Diameter	Multiplier	Well Diameter	Multiplier
2"	0.16	5"	1.02
3"	0.37	6"	1.47
4"	0.65	Other	radius ² * 0.163

Purge Method: Bailer Sampling Method: Bailer
 Disposable Bailer Disposable Bailer
 Middleburg Extraction Port
 Electric Submersible Extraction Pump Other: _____
 Other: _____

<u>15</u>	X	<u>3</u>	=	<u>45</u>	Gals.
1 Case Volume (Gals.)		Specified Volumes		Calculated Volume	

Time	Temp (°F)	pH	Cond.	Gals. Removed	Observations
<u>11:06</u>	<u>73.4</u>	<u>6.7</u>	<u>1242</u>	<u>15</u>	
<u>11:08</u>	<u>72.8</u>	<u>6.7</u>	<u>1179</u>	<u>30</u>	
<u>11:10</u>	<u>72.4</u>	<u>6.6</u>	<u>1164</u>	<u>45</u>	

Did well dewater? Yes No Gallons actually evacuated: 45

Sampling Time: 11:15 Sampling Date: 9-29-99

Sample I.D.: B-1 Laboratory: Sequoia CORE N. Creek Assoc. Labs

Analyzed for: TPH-G BTEX MTBE TPH-D Other: _____

Duplicate I.D.: _____ Analyzed for: TPH-G BTEX MTBE TPH-D Other: _____

D.O. (if req'd):	Pre-purge:	mg/L	Post-purge:	mg/L
	O.R.P. (if req'd):	mV	Post-purge:	mV

CHEVRON WELL MONITORING DATA SHEET

Project #: 990929-P2	Station #: 9-1026
Sampler: PA-1	Date: 9-29-99
Well I.D.: B-2	Well Diameter: (2) 3 4 6 8
Total Well Depth:	Depth to Water: 16.34
Depth to Free Product: 15.75	Thickness of Free Product (feet): .64
Referenced to: PVC Grade	D.O. Meter (if req'd): YSI HACH

Well Diameter	Multiplier	Well Diameter	Multiplier
2"	0.16	5"	1.02
3"	0.37	6"	1.47
4"	0.65	Other	radius ² * 0.163

Purge Method: **Bailer**
 Disposable Bailer
 Middleburg
 Electric Submersible
 Extraction Pump
 Other: _____

Sampling Method: **Bailer**
 Disposable Bailer
 Extraction Port
 Other: _____

_____	X	_____	=	_____	Gals.
1 Case Volume (Gals.)		Specified Volumes		Calculated Volume	

Time	Temp (°F)	pH	Cond.	Gals. Removed	Observations
					Reiled SPH Approx
					300mL

Did well dewater? **Yes** No Gallons actually evacuated: _____

Sampling Time: _____ Sampling Date: _____

Sample I.D.: _____ Laboratory: **Sequoia CORE N. Creek Assoc. Labs**

Analyzed for: **TPH-G BTEX MTBE TPH-D** Other: _____

Duplicate I.D.: _____ Analyzed for: **TPH-G BTEX MTBE TPH-D** Other: _____

D.O. (if req'd):	Pre-purge:	mg/L	Post-purge:	mg/L
O.R.P. (if req'd):	Pre-purge:	mV	Post-purge:	mV

CHEVRON WELL MONITORING DATA SHEET

Project #: <u>990929-P2</u>	Station #: <u>9-1026</u>
Sampler: <u>PAV1</u>	Date: <u>9-29-99</u>
Well I.D.: <u>B-3</u>	Well Diameter: <u>(2)</u> 3 4 6 8
Total Well Depth:	Depth to Water: <u>16.34</u> 15.00
Depth to Free Product: <u>15.75</u> 14.87	Thickness of Free Product (feet): <u>64.13</u>
Referenced to: PVC Grade	D.O. Meter (if req'd): YSI HACH

Well Diameter	Multiplier	Well Diameter	Multiplier
2"	0.16	5"	1.02
3"	0.37	6"	1.47
4"	0.65	Other	radius ² * 0.163

Purge Method:

- Bailer
- Disposable Bailer
- Middleburg
- Electric Submersible
- Extraction Pump
- Other: _____

Sampling Method:

- Bailer
- Disposable Bailer
- Extraction Port
- Other: _____

_____	X	_____	=	_____
1 Case Volume (Gals.)		Specified Volumes		Gals. Calculated Volume

Time	Temp (°F)	pH	Cond.	Gals. Removed	Observations
					<u>Bailed SPH Approx</u>
					<u>250 mL</u>

Did well dewater?	Yes	No	Gallons actually evacuated:
Sampling Time:	_____		
Sample I.D.:	_____		
Analyzed for:	Laboratory: <u>Sequoia CORE N. Creek Assoc. Labs</u>		
Duplicate I.D.:	_____		
D.O. (if req'd):	Pre-purge:	_____ mg/L	Post-purge: _____ mg/L
O.R.P. (if req'd):	Pre-purge:	_____ mV	Post-purge: _____ mV

CHEVRON WELL MONITORING DATA SHEET

Project #: 990929-P2	Station #: 9-1026
Sampler: PA-1	Date: 9-29-99
Well I.D.: B-4	Well Diameter: (2) 3 4 6 8
Total Well Depth: 19.55	Depth to Water: 16.12
Depth to Free Product:	Thickness of Free Product (feet):
Referenced to: (PVC) Grade	D.O. Meter (if req'd): YSI HACH

Well Diameter	Multiplier	Well Diameter	Multiplier
2"	0.16	5"	1.02
3"	0.37	6"	1.47
4"	0.65	Other	radius ² * 0.163

Purge Method: Bailer
 Disposable Bailer
 Middleburg
 Electric Submersible
 Extraction Pump
 Other: _____

Sampling Method: Bailer
 Disposable Bailer
 Extraction Port
 Other: _____

1	x	3	=	3	Gals.
1 Case Volume (Gals.)		Specified Volumes		Calculated Volume	

Time	Temp (°F)	pH	Cond.	Gals. Removed	Observations
11:27	74.2	6.7	2962	1	
11:28	72.8	6.6	2743	2	
11:30	72.6	6.6	2729	3	

Did well dewater? Yes No Gallons actually evacuated: 3

Sampling Time: 11:35 Sampling Date: 9-29-99

Sample I.D.: ~~A~~ B-4 Laboratory: (Sequoia) CORE N. Creek Assoc. Labs

Analyzed for: TPH-G (BTEX) (MTBE) TPH-D Other:

Duplicate I.D.: Analyzed for: TPH-G BTEX MTBE TPH-D Other:

D.O. (if req'd):	Pre-purge:	mg/L	Post-purge:	mg/L
O.R.P. (if req'd):	Pre-purge:	mV	Post-purge:	mV