

ENVIRONMENTAL  
PROTECTION

00 APR 27 AM 8:58



**Chevron**

LOP 467

Chevron U.S.A. Products Company  
6001 Bollinger Canyon Rd. Bldg. L  
P. O. Box 6604  
San Ramon, CA 94583-0604

Site Assessment and  
Remediation Group  
Phone (510) 842-3530  
Fax (510) 842-3370

Date: April 24, 2000  
To: Distribution  
Re: Groundwater Monitoring Report

The enclosed groundwater monitoring report has been properly reviewed by a Chevron authorized representative. Agency guidelines have been followed. Elaine Tech Services is authorized to distribute the report directly to interested parties.

If you have any questions, please call me at (510) 842-3695.

Sincerely,

Bret Hunter  
Site Assessment and Remediation  
Project Manager

**BLAINE**  
TECH SERVICES, INC.

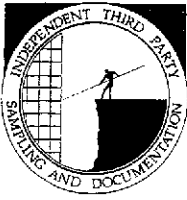

1680 ROGERS AVENUE  
SAN JOSE, CA 95112-1105  
(408) 573-7771 FAX  
(408) 573-0555 PHONE  
CONTRACTOR'S LICENSE #746684  
www.blainetech.com

April 21, 1999

Brett Hunter  
Chevron U.S.A. Products Company  
P.O. Box 6004  
San Ramon, CA 94583-0904

### 1st Quarter 2000 Monitoring at 9-1026

First Quarter 2000 Groundwater Monitoring at  
Former Chevron Service Station Number 9-1026  
3701 Broadway.  
Oakland, CA

Monitoring Performed on March 14, 2000

---

### Groundwater Sampling Report 000314-J-1

This report covers the routine monitoring of groundwater wells at this Chevron facility. Blaine Tech Services, Inc.'s work at the site includes inspection, gauging, evacuation, purgewater containment, sample collection and sample handling in accordance with standard procedures that conform to Regional Water Quality Control Board requirements.

Routine field data collection includes depth to water, total well depth, thickness of any separate immiscible layer, water column volume, calculated volume of a three-case volume purge, elapsed evacuation time, total volume of water removed, and standard water parameter instrument readings. Sample material is collected, contained, stored, and transported to the laboratory in conformance with EPA standards. Purgewater is, likewise, collected and transported to McKittrick Waste Treatment Site for disposal.

Basic field information is presented alongside analytical values excerpted from the laboratory report in the cumulative table of **WELL DATA AND ANALYTICAL RESULTS**. The full analytical report for the most recent samples is located in the **Analytical Appendix**. The table also contains new groundwater elevation calculations taken from the computer plotted gradient

map which is located in the **Professional Engineering Appendix**.

At a minimum, Blaine Tech Services, Inc. field personnel are certified upon completion of a forty-hour Hazardous Materials and Emergency Response training course per 29 CFR 1910.120. Field personnel are also enrolled in annual eight hour refresher courses.

Blaine Tech Services, Inc. conducts sampling and documentation assignments of this type as an independent third party. In order to avoid compromising the objectivity necessary for the proper and disinterested performance of this work, Blaine Tech Services, Inc. concentrates on objective data collection and does not participate in the interpretation of analytical results, the definition of geological or hydrological conditions, the formulation of recommendations, or the marketing of remedial systems.

Please call if you have any questions.

Yours truly,

A handwritten signature in black ink, appearing to read 'Scott Boor', with a long, sweeping horizontal stroke extending to the right.

Scott Boor  
Project Coordinator

SDB/ew

attachments: Professional Engineering Appendix  
Cumulative Table of Well Data and Analytical Results  
Analytical Appendix  
Field Data Sheets

Cc: Susan Hugo, Alameda County Health Care Services  
W. Bruce Bercovich, Kay & Merkel  
Greg Gurss, Gettler-Ryan, Inc.

# **Professional Engineering Appendix**

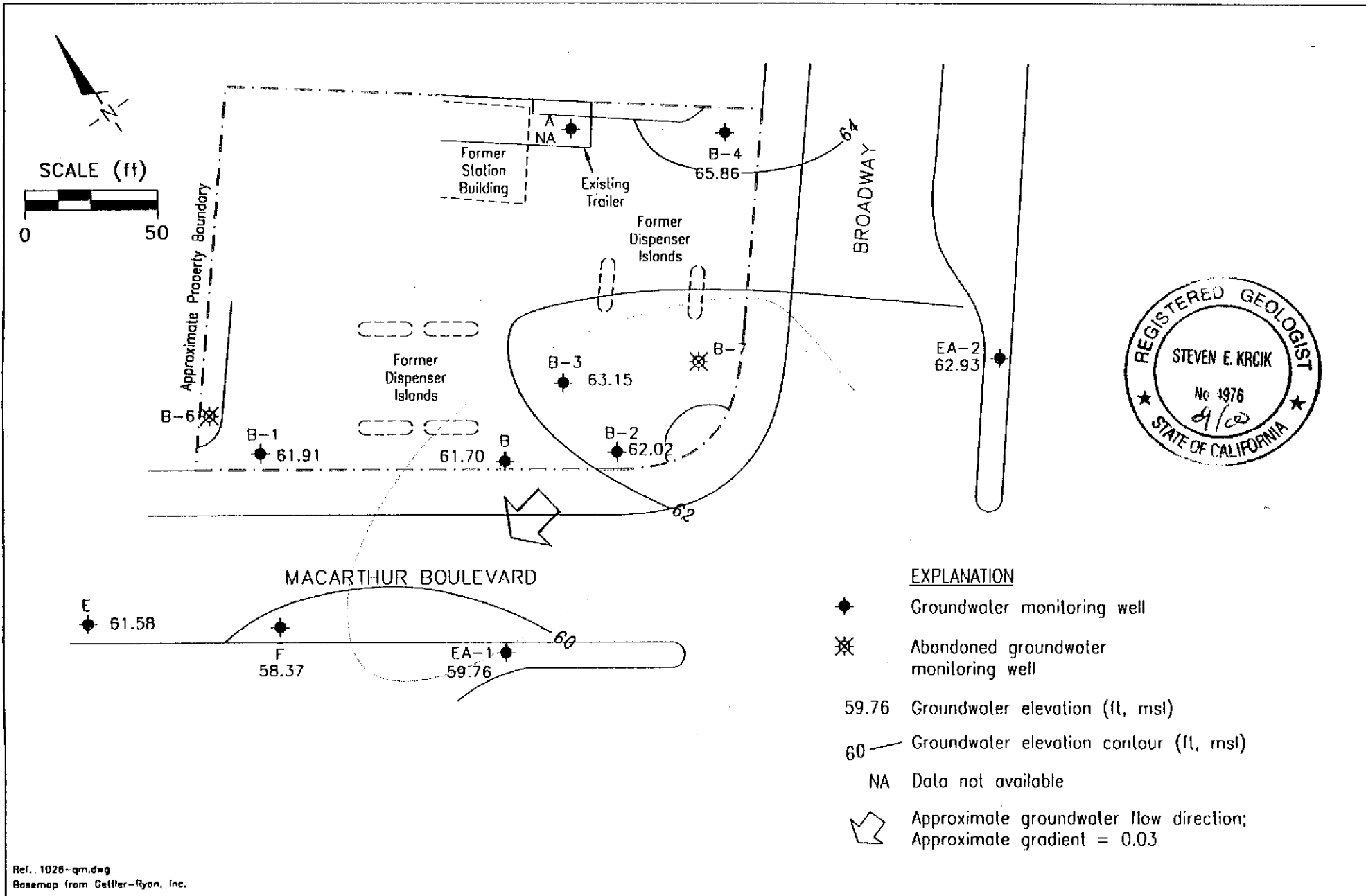

Ref. 1026-gm.dwg  
 Basemap from Geller-Ryan, Inc.

PREPARED BY

**RRM**  
 engineering contracting firm

**Chevron Station 9-1026**  
 3701 Broadway  
 Oakland, California

**GROUNDWATER ELEVATION CONTOUR MAP,**  
 MARCH 14, 2000

**FIGURE:**  
**1**  
**PROJECT:**  
 DAC04

# **Table of Well Data and Analytical Results**

## Cumulative Table of Well Data and Analytical Results

Vertical Measurements are in feet.

Volumetric Measurements are in gallons.

Analytical results are in parts per billion (ppb).

DATE	Well Head Elev.	Ground Water Elev.	Depth To Water	SPH Thickness	SPH Removed	Total SPH Removed	Notes	TPH-Gasoline	Benzene	Toluene	Ethyl-Benzene	Xylene	MTBE
<b>A</b>													
05/09/89	75.28	61.36	13.92	--	--	--	--	11,000	260	<2.0	94	230	--
08/09/89	75.28	59.66	15.62	--	--	--	--	12,000	370	<1.5	100	240	--
11/09/89	75.28	59.33	15.95	--	--	--	--	16,000	690	10	180	350	--
02/08/90	75.28	60.55	14.73	--	--	--	--	14,000	600	7.0	120	270	--
05/10/90	75.28	59.80	15.48	--	--	--	--	16,000	840	4.8	140	340	--
08/09/90	75.28	59.62	15.66	--	--	--	--	17,000	510	40	170	280	--
11/13/90	75.28	58.80	16.48	--	--	--	--	9000	570	3.1	86	170	--
03/27/91	75.28	--	--	--	--	--	--	8000	660	<5.0	110	250	--
04/05/91	75.28	62.06	13.22	--	--	--	--	--	--	--	--	--	--
06/19/91	75.28	59.91	15.37	--	--	--	--	8900	740	<3.0	120	280	--
08/21/91	75.28	59.29	15.99	--	--	--	--	6800	620	23	85	200	--
11/08/91	75.28	59.13	16.15	--	--	--	--	4000	640	<5.0	77	160	--
02/13/92	75.28	60.70	14.58	--	--	--	--	8000	860	<5.0	120	390	--
05/01/92	75.28	61.02	14.26	--	--	--	--	13,000	870	19	220	780	--
11/18/92	75.29	58.91	16.38	--	--	--	--	12,000	1500	83	360	530	--
03/19/93	75.29	63.13	12.16	--	--	--	--	14,000	820	6.1	180	420	--
06/10/93	75.29	61.04	14.25	--	--	--	--	9000	700	13	170	310	--
09/08/93	75.29	--	--	--	--	--	--	--	--	--	--	--	--
12/21/93	75.29	--	--	--	--	--	--	--	--	--	--	--	--
03/09/94	75.29	61.95	13.34	--	--	--	--	9600	860	21	200	390	--
09/21/94	75.29	--	--	--	--	--	Inaccessible	--	--	--	--	--	--
12/20/94	75.29	--	--	--	--	--	Inaccessible	--	--	--	--	--	--
03/28/95	75.29	--	--	--	--	--	Inaccessible	--	--	--	--	--	--
06/22/95	75.29	--	--	--	--	--	Inaccessible	--	--	--	--	--	--
09/21/95	75.29	--	--	--	--	--	Inaccessible	--	--	--	--	--	--
03/22/96	75.29	--	--	--	--	--	Inaccessible	--	--	--	--	--	--
09/25/96	75.29	--	--	--	--	--	Inaccessible	--	--	--	--	--	--
03/06/97	75.29	--	--	--	--	--	Inaccessible	--	--	--	--	--	--
09/12/97	75.29	60.73	14.56	--	--	--	--	2600	460	<10	70	11	67
04/02/98	75.29	66.54	8.75	--	--	--	--	1700*	130	1.7	44	42	<2.5
09/15/98	75.29	--	--	--	--	--	--	--	--	--	--	--	--
03/09/99	75.29	--	--	--	--	--	Inaccessible	--	--	--	--	--	--
03/14/00	75.29	--	--	--	--	--	Inaccessible	--	--	--	--	--	--

\*Chromatogram pattern indicated an unidentified hydrocarbon.

## Cumulative Table of Well Data and Analytical Results

Vertical Measurements are in feet.

Volumetric Measurements are in gallons.

Analytical results are in parts per billion (ppb).

DATE	Well	Ground	Depth	SPH		Total	Notes	TPH- Gasoline	Benzene	Toluene	Ethyl- Benzene	Xylene	MTBE
	Head Elev.	Water Elev.	To Water	Thickness	SPH Removed	SPH Removed							
<b>B</b>													
05/09/89	73.39	59.58	13.97	0.20	--	--	--	--	--	--	--	--	--
08/09/89	73.39	57.86	15.69	0.20	--	--	--	--	--	--	--	--	--
11/09/89	73.39	58.16	15.29	0.08	--	--	--	--	--	--	--	--	--
02/08/90	73.39	58.93	14.46	--	--	--	--	--	--	--	--	--	--
05/10/90	73.39	58.32	14.07	--	--	--	--	--	--	--	--	--	--
08/09/90	73.39	58.27	15.12	--	--	--	--	--	--	--	--	--	--
11/13/90	73.39	57.63	15.76	--	--	--	--	--	--	--	--	--	--
04/05/91	73.39	60.01	13.38	--	--	--	--	--	--	--	--	--	--
06/19/91	73.39	58.25	15.14	--	--	--	--	26,000	7100	370	430	1000	--
08/21/91	73.39	57.81	15.58	--	--	--	--	16,000	4900	270	390	640	--
11/08/91	73.39	57.68	15.71	--	--	--	--	11,000	2400	48	280	160	--
02/13/92	73.39	58.73	14.66	--	--	--	--	6800	2400	60	220	140	--
05/01/92	73.39	58.89	14.50	--	--	--	Sheen	16,000	6000	180	370	460	--
11/18/92	73.39	57.79	15.60	--	--	--	--	28,000	2200	150	920	4300	--
03/19/93	73.39	60.12	13.29	0.03	--	--	--	--	--	--	--	--	--
06/10/93	73.39	59.11	14.30	0.03	--	--	--	--	--	--	--	--	--
09/08/93	73.39	58.25	15.33	0.24	--	--	--	--	--	--	--	--	--
12/21/93	73.39	58.76	14.73	0.12	--	--	--	--	--	--	--	--	--
03/09/94	73.39	59.35	14.07	0.04	--	--	--	--	--	--	--	--	--
09/21/94	73.39	57.91	15.50	0.02*	--	--	--	--	--	--	--	--	--
12/20/94	73.39	59.88	13.75	0.12	--	--	--	--	--	--	--	--	--
3/28/95	73.39	--	--	--	--	--	--	--	--	--	--	--	--
06/22/95	73.39	58.92	14.56	0.11	1.000	1,000	--	--	--	--	--	--	--
09/21/95	73.39	58.41	15.88	1.12	2.000	3,000	--	--	--	--	--	--	--
03/22/96	73.39	61.19	13.02	1.02	2.000	5,000	--	--	--	--	--	--	--
09/25/96	73.39	58.81	15.76	1.47	1.500	6,500	--	--	--	--	--	--	--
03/06/97	73.39	59.95	14.30	1.08	2.000	8,500	--	--	--	--	--	--	--
09/12/97	73.39	59.32	14.61	0.68	3.000	11,500	--	--	--	--	--	--	--
04/02/98	73.39	61.04	12.50	0.19	3.000	14,500	--	--	--	--	--	--	--
09/15/98	73.39	59.60	14.87	1.35	5.000	19,500	--	--	--	--	--	--	--
03/09/99	73.39	60.41	13.41	0.54	0.132	19,632	--	--	--	--	--	--	--
09/29/99	73.39	58.56	15.80	1.21	0.130	19,762	--	--	--	--	--	--	--
03/14/00	73.39	61.70	12.80	1.39	0.400	20,162	--	--	--	--	--	--	--

\*Approximate thickness; equipment not functioning properly.



## Cumulative Table of Well Data and Analytical Results

Vertical Measurements are in feet.

Volumetric Measurements are in gallons.

Analytical results are in parts per billion (ppb).

DATE	Well	Ground	Depth	Total			Notes	TPH- Gasoline	Benzene	Toluene	Ethyl- Benzene	Xylene	MTBE
	Head Elev.	Water Elev.	To Water	SPH Thickness	SPH Removed	SPH Removed							
<b>B-1</b>													
05/09/89	71.77	59.19	12.58	--	--	--	--	16,000	2300	260	81	740	--
08/09/89	71.77	57.68	14.09	--	--	--	--	12,000	2600	340	100	870	--
11/09/89	71.77	57.71	14.06	--	--	--	--	17,000	340	140	110	760	--
02/08/90	71.77	59.12	12.65	--	--	--	--	5500	70	19	17	150	--
05/10/90	71.77	58.15	13.62	--	--	--	--	18,000	770	110	73	600	--
08/09/90	71.77	57.90	13.87	--	--	--	--	82,000	750	66	95	980	--
11/13/90	71.77	57.39	14.38	--	--	--	--	43,000	1300	120	74	760	--
03/27/91	71.77	--	--	--	--	--	--	18,000	580	92	94	770	--
04/05/91	71.77	60.04	11.73	--	--	--	--	--	--	--	--	--	--
06/19/91	71.77	58.21	13.56	--	--	--	--	21,000	910	56	96	810	--
08/21/91	71.77	57.87	13.90	--	--	--	--	50,000	2400	610	300	1800	--
11/08/91	71.77	57.72	14.05	--	--	--	--	540,000	3600	1500	1900	5900	--
02/13/92	71.77	59.09	12.68	--	--	--	--	20,000	500	100	150	920	--
05/01/92	71.77	58.85	12.92	--	--	--	Sheen	27,000	2800	200	310	1900	--
11/18/92	72.30	58.00	14.30	--	--	--	--	300	9.7	3.4	2.3	21	--
03/19/93	72.30	60.02	12.28	--	--	--	--	130	23	0.9	<0.5	5.6	--
06/10/93	72.30	59.26	13.04	--	--	--	--	170	21	1.1	0.8	6.6	--
09/08/93	72.30	58.46	13.88	0.05	--	--	--	--	--	--	--	--	--
12/21/93	72.30	58.77	13.53	--	--	--	--	<50	6.7	0.5	<0.5	1.2	--
03/09/94	72.30	59.65	12.65	--	--	--	--	1300	520	8.8	2.4	53	--
09/21/94	72.30	57.90	14.40	--	--	--	--	390	130	2.7	2.4	7.7	--
12/20/94	72.30	59.95	12.35	--	--	--	--	1600	520	9.9	8.9	34	--
03/28/95	72.30	61.54	10.76	--	--	--	--	160	38	2.1	1.4	5.4	--
06/22/95	72.30	59.70	12.60	--	--	--	--	340	73	3.1	2.4	7.5	--
09/21/95	72.30	58.65	13.65	--	--	--	--	140	19	1.0	1.2	6.1	--
03/22/96	72.30	61.36	10.94	--	--	--	--	200	<0.5	0.6	2.1	2.2	<5.0
09/25/96	72.30	58.54	13.76	--	--	--	--	690	5.4	1.2	1.6	6.8	<5.0
03/06/97	72.30	60.22	12.08	--	--	--	--	420	31	1.0	2.5	4.3	5.9
09/12/97	72.30	58.76	13.54	--	--	--	--	170	31	1.4	1.6	4.6	11
04/02/98	72.30	61.57	10.73	--	--	--	--	670*	91	4.2	8.7	17	<2.5
09/15/98	72.30	59.49	12.81	--	--	--	--	<50	1.5	<0.5	<0.5	<0.5	<10
03/09/99	72.30	60.69	11.61	--	--	--	--	1200	570	5.3	5.6	48	<25
09/29/99	72.30	58.67	13.63	--	--	--	--	<50	<0.5	<0.5	<0.5	<0.5	<2.5
03/14/00	72.30	61.91	10.39	--	--	--	--	225	78.5	1.49	1.88	4.17	<5.0

\*Chromatogram pattern indicated an unidentified hydrocarbon.

## Cumulative Table of Well Data and Analytical Results

Vertical Measurements are in feet.

Volumetric Measurements are in gallons.

Analytical results are in parts per billion (ppb).

DATE	Well	Ground	Depth	Total			Notes	TPH- Gasoline	Benzene	Toluene	Ethyl- Benzene	Xylene	MTBE
	Head Elev.	Water Elev.	To Water	SPH Thickness	SPH Removed	SPH Removed							
<b>B-2</b>													
05/09/89	74.51	59.93	14.58	--	--	--	--	170,000	30,000	8400	2300	12,000	--
08/09/89	74.51	58.45	16.06	--	--	--	--	60,000	29,000	8700	2400	12,000	--
11/09/89	74.51	57.56	16.95	--	--	--	--	110,000	32,000	5500	2800	12,000	--
02/08/90	74.51	58.95	15.56	--	--	--	--	67,000	28,000	5900	2300	11,000	--
05/10/90	74.51	58.57	15.94	--	--	--	--	69,000	24,000	4800	2000	11,000	--
08/09/90	74.51	58.54	15.97	--	--	--	--	100,000	33,000	4000	2100	12,000	--
11/13/90	74.51	57.81	16.70	--	--	--	--	110,000	33,000	4300	2900	13,000	--
03/27/91	74.51	--	--	--	--	--	--	160,000	26,000	3200	2600	15,000	--
04/05/91	74.51	60.31	14.20	--	--	--	--	--	--	--	--	--	--
06/19/91	74.51	58.68	15.83	--	--	--	--	100,000	22,000	2500	2000	11,000	--
08/21/91	74.51	58.20	16.31	--	--	--	--	80,000	28,000	2800	2400	12,000	--
11/08/91	74.51	57.91	16.60	--	--	--	--	94,000	29,000	1900	2200	11,000	--
02/13/92	74.51	58.58	15.93	--	--	--	--	280,000	34,000	2500	4600	23,000	--
05/01/92	74.51	59.57	14.94	--	--	--	Sheen	29,000	1700	300	1100	4300	--
11/18/92	74.52	57.81	16.71	--	--	--	--	26,000	11,000	170	870	950	--
03/19/93	74.52	60.46	14.06	--	--	--	--	110,000	28,000	1200	2200	12,000	--
06/10/93	74.52	59.64	14.88	--	--	--	--	140,000	15,000	930	1900	8800	--
09/08/93	74.52	58.52	16.03	0.04	--	--	--	--	--	--	--	--	--
12/21/93	74.52	58.91	15.61	--	--	--	--	980,000	21,000	30,000	9100	71,000	--
03/09/94	74.52	59.99	14.53	--	--	--	Sheen	110,000	23,000	920	1300	7800	--
9/21/94	74.52	--	--	--	--	--	Inaccessible	--	--	--	--	--	--
12/20/94	74.52	59.86	14.65	--	--	--	--	70,000	25,000	710	920	5300	--
03/28/95	74.52	62.22	12.30	--	--	--	--	76,000	20,000	920	1200	5200	--
06/22/95	74.52	60.30	14.22	--	--	--	--	89,000	21,000	38,000	1500	6800	--
09/21/95	74.52	58.72	15.80	--	--	--	--	84,000	24,000	2900	1800	9800	--
03/22/96	74.52	61.69	12.85	0.02	0.250	0.250	--	--	--	--	--	--	--
09/25/96	74.52	58.56	15.98	0.03	0.250	0.500	--	--	--	--	--	--	--
03/06/97	74.52	60.43	14.11	0.02	0.000	0.500	--	--	--	--	--	--	--
09/12/97	74.52	59.19	15.35	0.03	1.500	2.000	--	--	--	--	--	--	--
04/02/98	74.52	61.74	13.07	0.36	2.000	4.000	--	--	--	--	--	--	--
09/15/98	74.52	59.48	15.50	0.58	0.500	4.500	--	--	--	--	--	--	--
03/09/99	74.52	61.56	13.29	0.41	0.079	4.579	--	--	--	--	--	--	--
09/29/99	74.52	58.69	16.34	0.64	0.080	4.659	--	--	--	--	--	--	--
03/14/00	74.52	62.02	12.65	0.19	0.040	4.699	--	--	--	--	--	--	--

## Cumulative Table of Well Data and Analytical Results

Vertical Measurements are in feet.

Volumetric Measurements are in gallons.

Analytical results are in parts per billion (ppb).

DATE	Well	Ground	Depth	Total			Notes	TPH- Gasoline	Benzene	Toluene	Ethyl- Benzene	Xylene	MTBE
	Head Elev.	Water Elev.	To Water	SPH Thickness	SPH Removed	SPH Removed							
<b>B-3</b>													
05/09/89	74.12	60.01	14.02	--	--	--	--	70,000	12,000	9500	400	8900	--
08/09/89	74.12	58.74	15.38	--	--	--	--	--	--	--	--	--	--
11/09/89	74.12	58.61	15.55	0.05	--	--	--	--	--	--	--	--	--
02/08/90	74.12	59.44	14.68	<0.01	--	--	--	--	--	--	--	--	--
05/10/90	74.12	58.99	15.15	0.02	--	--	--	--	--	--	--	--	--
08/09/90	74.12	58.85	15.27	<0.01	--	--	--	--	--	--	--	--	--
11/13/90	74.12	58.13	16.04	0.06	--	--	--	--	--	--	--	--	--
04/05/91	74.12	60.82	13.30	<0.01	--	--	--	--	--	--	--	--	--
06/19/91	74.12	58.96	15.16	--	--	--	--	260,000	20,000	9000	2200	16,000	--
08/21/91	74.12	58.51	15.61	--	--	--	--	70,000	28,000	11,000	1800	11,000	--
11/08/91	74.12	58.35	15.77	--	--	--	--	150,000	29,000	9700	2200	13,000	--
02/13/92	74.12	59.24	14.88	--	--	--	--	100,000	27,000	9906	2000	11,000	--
05/01/92	74.12	59.93	14.20	0.01	--	--	--	--	--	--	--	--	--
11/18/92	74.13	58.47	15.68	0.03	--	--	--	--	--	--	--	--	--
03/19/93	74.13	61.24	13.75	1.08	--	--	--	--	--	--	--	--	--
06/10/93	74.13	60.04	14.79	0.87	--	--	--	--	--	--	--	--	--
09/08/93	74.13	58.81	15.38	0.08	--	--	--	--	--	--	--	--	--
12/21/93	74.13	59.39	14.74	--	--	--	--	1,100,000	18,000	29,000	8900	59,000	--
03/09/94	74.13	60.60	13.53	--	--	--	--	130,000	11,000	20,000	1700	15,000	--
09/21/94	74.13	58.45	15.70	0.02*	--	--	--	--	--	--	--	--	--
12/20/94	74.13	60.67	13.48	0.03	--	--	--	--	--	--	--	--	--
03/28/95	74.13	--	--	1.54	2.000	2.000	--	--	--	--	--	--	--
06/22/95	74.13	60.86	14.25	1.23	0.500	2.500	--	--	--	--	--	--	--
09/21/95	74.13	59.12	15.25	0.30	0.500	3.000	--	--	--	--	--	--	--
03/22/96	74.13	62.97	11.46	0.37	0.250	3.250	--	--	--	--	--	--	--
09/25/96	74.13	60.13	14.82	1.02	1.000	4.250	--	--	--	--	--	--	--
03/06/97	74.13	61.23	13.12	0.28	0.500	4.750	--	--	--	--	--	--	--
09/12/97	74.13	59.56	14.67	0.13	2.000	6.750	--	--	--	--	--	--	--
04/02/98	74.13	62.93	11.20	--	--	6.750	Sheen	160,000	27,000	26,000	2500	14,000	<500
09/15/98	74.13	60.12	14.05	0.05	0.500	7.250	--	--	--	--	--	--	--
03/09/99	74.13	62.77	11.41	0.06	0.053	7.303	--	--	--	--	--	--	--
09/29/99	74.13	59.23	15.00	0.13	0.070	7.373	--	--	--	--	--	--	--
03/14/00	74.13	63.15	10.98	--	--	7.373	--	177,000	15,000	22,000	2910	17,000	<1250

\*Approximate thickness; equipment not functioning properly.

\*\*Chromatogram pattern indicated an unidentified hydrocarbon.

## Cumulative Table of Well Data and Analytical Results

Vertical Measurements are in feet.

Volumetric Measurements are in gallons.

Analytical results are in parts per billion (ppb).

DATE	Well Head Elev.	Ground Water Elev.	Depth To Water	SPH Thickness	SPH Removed	Total SPH Removed	Notes	TPH-Gasoline	Benzene	Toluene	Ethyl-Benzene	Xylene	MTBE
<b>B-4</b>													
05/09/89	76.43	61.50	14.93	--	--	--	--	3600	840	34	120	200	--
08/09/89	76.43	59.78	16.65	--	--	--	--	<500	4200	130	370	260	--
11/09/89	76.43	--	--	--	--	--	--	5000	4200	83	400	250	--
02/08/90	76.43	59.44	16.99	--	--	--	--	14,000	6000	70	530	300	--
05/10/90	76.43	60.38	16.05	--	--	--	--	12,000	5400	130	460	320	--
08/09/90	76.43	59.94	16.49	--	--	--	--	16,000	7400	120	530	350	--
11/13/90	76.43	59.79	16.64	--	--	--	--	21,000	7000	100	550	320	--
03/27/91	76.43	59.01	17.42	--	--	--	--	17,000	8500	120	500	300	--
04/05/91	76.43	61.77	14.66	--	--	--	--	14,000	7700	75	610	210	--
06/19/91	76.43	59.95	16.48	--	--	--	--	16,000	7800	110	550	340	--
08/21/91	76.43	59.43	17.00	--	--	--	--	18,000	11,000	110	450	340	--
11/08/91	76.43	59.05	17.38	--	--	--	--	18,000	6800	98	500	620	--
02/13/92	76.43	60.01	16.42	--	--	--	--	15,000	9100	86	570	350	--
05/01/92	76.43	60.93	15.50	--	--	--	--	36,000	16,000	180	990	690	--
03/19/93	76.43	62.32	14.11	--	--	--	--	26,000	15,000	150	900	790	--
06/10/93	76.43	60.99	15.44	--	--	--	--	35,000	14,000	180	940	590	--
09/08/93	76.43	59.78	16.65	--	--	--	--	34,000	15,000	170	1100	870	--
12/21/93	76.43	59.98	16.45	--	--	--	--	30,000	12,000	74	610	340	--
03/09/94	76.43	61.55	14.88	--	--	--	--	37,000	15,000	140	1000	580	--
09/21/94	76.43	59.29	17.14	--	--	--	--	32,000	14,000	110	660	190	--
12/20/94	76.43	61.44	14.99	--	--	--	--	23,000	8400	97	640	530	--
03/28/95	76.43	65.10	11.33	--	--	--	--	27,000	9900	120	880	540	--
06/22/95	76.43	61.84	14.59	--	--	--	--	33,000	12,000	84	650	150	--
09/21/95	76.43	60.24	16.19	--	--	--	--	20,000	12,000	72	540	68	--
03/22/96	76.43	64.43	12.00	--	--	--	--	29,000	10,000	72	560	170	400
09/25/96	76.43	60.15	16.28	--	--	--	--	53,000	11,000	<50	160	74	<500
03/06/97	76.43	62.87	13.56	--	--	--	--	<5,000	17,000	<50	<50	<50	<500
09/12/97	76.43	60.41	16.02	--	--	--	--	7600	8100	65	520	38	300
04/02/98	76.43	64.58	11.85	--	--	--	--	28,000*	9700	59	760	220	<250
09/15/98	76.43	61.08	15.35	--	--	--	--	25,000	12,000	200	900	<200	<1000
03/09/99	76.43	64.11	12.32	--	--	--	--	21,000	11,000	<100	770	270	800
09/29/99	76.43	60.31	16.12	--	--	--	--	8610	9500	32.1	1160	88.2	260
03/14/00	76.43	65.86	10.57	--	--	--	--	29,100	11,000	223	1010	556	<500

\*Chromatogram pattern indicated an unidentified hydrocarbon.

## Cumulative Table of Well Data and Analytical Results

Vertical Measurements are in feet.			Volumetric Measurements are in gallons.				Analytical results are in parts per billion (ppb).						
DATE	Well Head Elev.	Ground Water Elev.	Depth To Water	SPH Thickness	SPH Removed	Total SPH Removed	Notes	TPH-Gasoline	Benzene	Toluene	Ethyl-Benzene	Xylene	MTBE
<b>B-6</b>													
05/09/89	72.66	60.55	12.11	--	--	--	--	26,000	120	110	250	1300	--
08/09/89	72.66	57.94	14.72	--	--	--	--	19,000	470	150	440	1400	--
11/09/89	72.66	58.81	13.85	--	--	--	--	13,000	70	36	36	440	--
02/08/90	72.66	64.93	7.73	--	--	--	--	2900	16	5.0	10	58	--
05/10/90	72.66	--	--	--	--	--	--	--	--	--	--	--	--
08/09/90	72.66	58.15	14.51	--	--	--	--	14,000	55	3.0	130	500	--
11/13/90	72.66	57.80	14.86	--	--	--	--	--	--	--	--	--	--
04/05/91	72.66	62.23	10.43	--	--	--	--	--	--	--	--	--	--
06/19/91	72.66	--	--	--	--	--	Abandoned	--	--	--	--	--	--
<b>B-7</b>													
05/09/89	75.40	60.67	14.73	--	--	--	--	210,000	13,000	19,000	2000	20,000	--
08/09/89	75.40	59.04	16.36	--	--	--	--	672,000	87,000	17,000	2700	30,000	--
11/09/89	75.40	58.76	16.64	--	--	--	--	150,000	7000	12,000	1800	16,000	--
02/08/90	75.40	59.71	15.69	--	--	--	--	41,000	2500	6900	1100	11,000	--
05/10/90	75.40	--	--	--	--	--	--	--	--	--	--	--	--
08/09/90	75.40	59.09	16.31	--	--	--	--	50,000	1100	3900	640	7200	--
11/13/90	75.40	58.31	17.09	--	--	--	--	--	--	--	--	--	--
04/05/91	75.40	61.04	14.36	--	--	--	--	--	--	--	--	--	--
06/19/91	75.40	--	--	--	--	--	Abandoned	--	--	--	--	--	--

## Cumulative Table of Well Data and Analytical Results

Vertical Measurements are in feet.

Volumetric Measurements are in gallons.

Analytical results are in parts per billion (ppb).

DATE	Well	Ground	Depth	Volumetric Measurements			Notes	Analytical results					
	Head Elev.	Water Elev.	To Water	SPH Thickness	SPH Removed	Total SPH Removed		TPH-Gasoline	Benzene	Toluene	Ethyl-Benzene	Xylene	MTBE
<b>E</b>													
11/18/92	70.07	57.87	12.20	--	--	--	--	280	2.7	2.4	3.0	12	--
03/19/93	70.07	60.10	9.97	--	--	--	--	<50	<0.5	<0.5	<0.5	<1.5	--
06/10/93	70.07	59.09	10.98	--	--	--	--	<50	<0.5	<0.5	<0.5	<1.5	--
09/08/93	70.07	58.29	11.80	0.03	--	--	--	--	--	--	--	--	--
12/21/93	70.07	58.82	11.25	--	--	--	--	<50	<0.5	<0.5	<0.5	<0.5	--
03/09/94	70.07	59.40	10.67	--	--	--	--	<50	<0.5	0.7	<0.5	0.7	--
09/21/94	70.07	57.78	12.29	--	--	--	--	<50	2.5	<0.5	1.0	<0.5	--
12/20/94	70.07	54.54	15.53	--	--	--	--	<50	0.5	<0.5	<0.5	<0.5	--
03/28/95	70.07	61.62	8.45	--	--	--	--	<50	<0.5	<0.5	<0.5	<0.5	--
06/22/95	70.07	59.50	10.57	--	--	--	--	<50	<0.5	<0.5	<0.5	<0.5	--
09/21/95	70.07	58.48	11.59	--	--	--	--	<50	<0.5	<0.5	<0.5	<0.5	--
03/22/96	70.07	61.05	9.02	--	--	--	--	<50	<0.5	<0.5	<0.5	<0.5	<5.0
03/06/97	70.07	57.75	12.32	--	--	--	--	<50	<0.5	<0.5	<0.5	<0.5	<5.0
09/12/97	70.07	--	--	--	--	--	--	--	--	--	--	--	--
04/02/98	70.07	61.64	8.43	--	--	--	--	<50	<0.5	<0.5	<0.5	<0.5	<2.5
09/15/98	70.07	--	--	--	--	--	--	--	--	--	--	--	--
03/09/99	70.07	60.65	9.42	--	--	--	--	<50	<0.5	<0.5	<0.5	<0.5	<2.5
03/14/00	70.07	61.58	8.49	--	--	--	--	<50	<0.5	<0.5	<0.5	<0.5	<2.5

## Cumulative Table of Well Data and Analytical Results

Vertical Measurements are in feet.

Volumetric Measurements are in gallons.

Analytical results are in parts per billion (ppb).

DATE	Well	Ground	Depth	Total			Notes	TPH- Gasoline	Benzene	Toluene	Ethyl- Benzene	Xylene	MTBE
	Head Elev.	Water Elev.	To Water	SPH Thickness	SPH Removed	SPH Removed							
<b>F</b>													
05/09/89	72.01	53.31	18.70	--	--	--	--	<500	<0.5	<0.5	0.6	1.0	--
08/09/89	72.01	52.98	19.03	--	--	--	--	--	--	--	--	--	--
11/09/89	72.01	52.99	19.02	--	--	--	--	--	--	--	--	--	--
02/08/90	72.01	53.31	18.70	--	--	--	--	<50	0.4	<0.3	0.3	<0.6	--
05/10/90	72.01	53.03	18.98	--	--	--	--	--	--	--	--	--	--
08/09/90	72.01	53.06	18.95	--	--	--	--	--	--	--	--	--	--
11/13/90	72.01	52.91	19.10	--	--	--	--	--	--	--	--	--	--
03/27/91	72.01	--	--	--	--	--	--	64	<0.5	<0.5	<0.5	1.0	--
06/19/91	72.01	53.06	18.95	--	--	--	--	--	--	--	--	--	--
08/21/91	72.01	<52.07	>19.94	--	--	--	--	--	--	--	--	--	--
11/08/91	72.01	<52.07	>19.94	--	--	--	--	--	--	--	--	--	--
02/13/92	72.01	53.41	18.60	--	--	--	--	<50	<0.5	<0.5	<0.5	<0.5	--
05/01/92	72.01	--	Dry	--	--	--	--	--	--	--	--	--	--
11/18/92	71.72	56.87	14.85	--	--	--	--	<50	<0.5	<0.5	<0.5	<0.5	--
03/19/93	71.72	57.47	14.25	--	--	--	--	<50	<0.5	<0.5	<0.5	<1.5	--
06/10/93	71.72	57.80	13.92	--	--	--	--	<50	<0.5	<0.5	<0.5	<1.5	--
09/08/93	71.72	56.95	14.80	0.04	--	--	--	--	--	--	--	--	--
12/21/93	71.72	58.41	13.31	--	--	--	--	<50	<0.5	<0.5	<0.5	<0.5	--
03/09/94	71.72	58.73	12.99	--	--	--	--	<50	<0.5	<0.5	<0.5	<0.5	--
09/21/94	71.72	55.42	16.30	--	--	--	--	<50	<0.5	<0.5	<0.5	<0.5	--
12/20/94	71.72	59.15	12.57	--	--	--	--	<50	<0.5	<0.5	<0.5	<0.5	--
03/28/95	71.72	62.77	8.95	--	--	--	--	<50	<0.5	<0.5	<0.5	<0.5	--
06/22/95	71.72	57.95	13.77	--	--	--	--	<50	<0.5	<0.5	<0.5	<0.5	--
09/21/95	71.72	58.27	13.45	--	--	--	--	<50	<0.5	<0.5	<0.5	<0.5	--
03/22/96	71.72	60.56	11.16	--	--	--	--	<50	<0.5	<0.5	<0.5	<0.5	<5.0
03/06/97	71.72	60.34	11.38	--	--	--	--	<50	<0.5	<0.5	<0.5	<0.5	<5.0
09/12/97	71.72	--	--	--	--	--	--	--	--	--	--	--	--
04/02/98	71.72	58.60	13.12	--	--	--	--	<50	<0.5	<0.5	<0.5	<0.5	<2.5
09/15/98	71.72	--	--	--	--	--	--	--	--	--	--	--	--
03/09/99	71.72	58.05	13.67	--	--	--	--	<50	<0.5	<0.5	<0.5	<0.5	<2.5
03/14/00	71.72	58.37	13.35	--	--	--	--	<50	<0.5	<0.5	<0.5	<0.5	<2.5

## Cumulative Table of Well Data and Analytical Results

Vertical Measurements are in feet.

Volumetric Measurements are in gallons.

Analytical results are in parts per billion (ppb).

DATE	Well	Ground	Depth	Total			Notes	TPH- Gasoline	Benzene	Toluene	Ethyl- Benzene	Xylene	MTBE
	Head Elev.	Water Elev.	To Water	SPH Thickness	SPH Removed	SPH Removed							
<b>EA-1</b>													
05/09/89	73.94	59.38	14.56	--	--	--	--	<500	<0.5	<0.5	<0.5	<0.5	--
08/09/89	73.94	57.85	16.09	--	--	--	--	<500	<0.5	<0.5	<0.5	<0.5	--
11/09/89	73.94	58.10	15.84	--	--	--	--	<500	<0.5	<0.5	<0.5	<0.5	--
02/08/90	73.94	58.89	15.05	--	--	--	--	<50	<0.3	<0.3	<0.3	<0.6	--
05/10/90	73.94	58.29	15.65	--	--	--	--	<50	1.0	0.3	<0.3	<0.6	--
08/09/90	73.94	58.27	15.67	--	--	--	--	<50	<0.3	<0.3	<0.3	<0.6	--
11/13/90	73.94	57.62	16.32	--	--	--	--	<50	<0.4	<0.3	<0.3	<0.4	--
03/27/91	73.94	--	--	--	--	--	--	<50	0.7	0.5	<0.5	<0.5	--
04/05/91	73.94	59.91	14.03	--	--	--	--	--	--	--	--	--	--
06/19/91	73.94	58.38	15.56	--	--	--	--	<50	<0.5	<0.5	<0.5	<0.5	--
08/21/91	73.94	57.95	15.99	--	--	--	--	<50	<0.4	<0.3	<0.3	<0.4	--
11/08/91	73.94	57.81	16.13	--	--	--	--	<50	<0.5	<0.5	<0.5	<0.5	--
02/13/92	73.94	58.84	15.10	--	--	--	--	<50	<0.5	<0.5	<0.5	<0.5	--
05/01/92	73.94	55.14	18.80	--	--	--	--	<50	2.7	<0.5	<0.5	<0.5	--
11/18/92	71.85	55.88	15.97	--	--	--	--	<10	<0.3	<0.3	<0.3	<0.5	--
03/19/93	71.85	58.19	13.66	--	--	--	--	<50	<0.5	<0.5	<0.5	<1.5	--
06/10/93	71.85	57.14	14.71	--	--	--	--	<50	<0.5	<0.5	<0.5	<1.5	--
09/08/93	71.85	56.33	15.58	0.08	--	--	--	--	--	--	--	--	--
12/21/93	71.85	56.83	15.02	--	--	--	--	<50	<0.5	<0.5	<0.5	<0.5	--
03/09/94	71.85	57.47	14.38	--	--	--	--	<50	<0.5	1.0	<0.5	<0.5	--
09/21/94	71.85	55.73	16.12	--	--	--	--	<50	<0.5	<0.5	<0.5	<0.5	--
12/20/94	71.85	57.80	14.05	--	--	--	--	<50	<0.5	<0.5	<0.5	<0.5	--
03/28/95	71.85	59.80	12.05	--	--	--	--	<50	<0.5	<0.5	<0.5	<0.5	--
06/22/95	71.85	57.50	14.35	--	--	--	--	<50	2.0	<0.5	<0.5	<0.5	--
09/21/95	71.85	56.49	15.36	--	--	--	--	<50	<0.5	<0.5	<0.5	<0.5	--
03/22/96	71.85	59.14	12.71	--	--	--	--	<50	<0.5	<0.5	<0.5	<0.5	<5.0
03/06/97	71.85	57.97	13.88	--	--	--	--	<50	2.8	<0.5	<0.5	0.8	<5.0
09/12/97	71.85	--	--	--	--	--	--	--	--	--	--	--	--
04/02/98	71.85	59.16	12.69	--	--	--	--	<50	<0.5	<0.5	<0.5	<0.5	<2.5
09/15/98	71.85	--	--	--	--	--	--	--	--	--	--	--	--
03/09/99	71.85	58.85	13.00	--	--	--	--	<50	<0.5	<0.5	<0.5	<0.5	<2.5
03/14/00	71.85	59.76	12.09	--	--	--	--	<50	<0.5	<0.5	<0.5	<0.5	6.65



## Cumulative Table of Well Data and Analytical Results

Vertical Measurements are in feet.

Volumetric Measurements are in gallons.

Analytical results are in parts per billion (ppb).

DATE	Well Head Elev.	Ground Water Elev.	Depth To Water	SPH Thickness	SPH Removed	Total SPH Removed	Notes	TPH-Gasoline	Benzene	Toluene	Ethyl-Benzene	Xylene	MTBE
<b>EA-2</b>													
05/09/89	75.24	59.29	15.95	--	--	--	--	760	<0.5	<0.5	1.1	<0.5	--
08/09/89	75.24	57.79	17.45	--	--	--	--	<500	<0.5	<0.5	<0.5	<0.5	--
11/09/89	75.24	57.83	17.41	--	--	--	--	<500	<0.5	1.0	<0.5	<0.5	--
02/08/90	75.24	58.67	16.57	--	--	--	--	190	<0.3	<0.3	<0.3	<0.6	--
05/10/90	75.24	58.12	17.12	--	--	--	--	<50	<0.3	<0.3	<0.3	<0.6	--
08/09/90	75.24	58.04	17.20	--	--	--	--	120	<0.3	<0.3	<0.3	<0.6	--
11/13/90	75.24	57.36	17.88	--	--	--	--	160	<0.4	1.0	<0.3	<0.4	--
03/27/91	75.24	--	--	--	--	--	--	110	<0.5	<0.5	<0.5	<0.5	--
04/05/91	75.24	59.70	15.54	--	--	--	--	--	--	--	--	--	--
06/19/91	75.24	58.17	17.07	--	--	--	--	<50	<0.5	<0.5	<0.5	<0.5	--
08/21/91	75.24	57.78	17.46	--	--	--	--	70	0.8	1.4	<0.3	<0.4	--
11/08/91	75.24	57.66	17.58	--	--	--	--	<50	<0.5	0.7	<0.5	<0.5	--
02/13/92	75.24	58.55	16.69	--	--	--	--	<50	<0.5	<0.5	<0.5	<0.5	--
05/01/92	75.24	59.08	16.16	--	--	--	--	340	<0.5	2.6	0.7	<0.5	--
11/18/92	76.24	58.63	17.61	--	--	--	--	450	<0.5	3.3	<0.5	0.8	--
03/19/93	76.24	61.24	15.00	--	--	--	--	450	<0.5	2.3	0.6	<1.5	--
06/10/93	76.24	60.16	16.08	--	--	--	--	250	<0.5	1.3	<0.5	<1.5	--
09/08/93	76.24	59.17	17.07	--	--	--	--	<50	<0.5	<0.5	<0.5	<1.5	--
12/21/93	76.24	59.64	16.60	--	--	--	--	170	<0.5	1.3	<0.5	<0.5	--
03/09/94	76.24	60.41	15.83	--	--	--	--	200	1.8	1.4	<0.5	<0.5	--
09/21/94	76.24	58.64	17.60	--	--	--	--	<50	<0.5	<0.5	<0.5	<0.5	--
12/20/94	76.24	60.71	15.53	--	--	--	--	950	31	15	1.7	<0.5	--
03/28/95	76.24	62.96	13.28	--	--	--	--	71	2.0	0.6	<0.5	<0.5	--
06/22/95	76.24	60.62	15.62	--	--	--	--	300	<0.5	3.7	<0.5	0.6	--
09/21/95	76.24	59.46	16.78	--	--	--	--	170	<0.5	<0.5	<0.5	<0.5	--
03/22/96	76.24	62.36	13.88	--	--	--	--	90	<0.5	<0.5	<0.5	<0.5	<5.0
03/06/97	76.24	61.18	15.06	--	--	--	--	<50	<0.5	<0.5	<0.5	<0.5	<5.0
09/12/97	76.24	--	--	--	--	--	--	--	--	--	--	--	--
04/02/98	76.24	62.51	13.73	--	--	--	--	230*	0.99	<0.5	<0.5	<0.5	<2.5
09/15/98	76.24	--	--	--	--	--	--	--	--	--	--	--	--
03/09/99	76.24	62.03	14.21	--	--	--	--	<50	<0.5	<0.5	<0.5	<0.5	<2.5
03/14/00	76.24	62.93	13.31	--	--	--	--	<50	<0.5	<0.5	<0.5	<0.5	<2.5

\*Chromatogram pattern indicated an unidentified hydrocarbon.

## Cumulative Table of Well Data and Analytical Results

Vertical Measurements are in feet.

Volumetric Measurements are in gallons.

Analytical results are in parts per billion (ppb).

DATE	Well Head Elev.	Ground Water Elev.	Depth To Water	SPH Thickness	SPH Removed	Total SPH Removed	Notes	TPH-Gasoline	Benzene	Toluene	Ethyl-Benzene	Xylene	MTBE
<b>TRIP BLANK</b>													
05/09/89	--	--	--	--	--	--	--	<500	<0.5	<0.5	<0.5	<0.5	--
08/09/89	--	--	--	--	--	--	--	<500	<0.5	<0.5	<0.5	<0.5	--
11/09/89	--	--	--	--	--	--	--	<500	<0.5	<0.5	<0.5	<0.5	--
02/08/90	--	--	--	--	--	--	--	<50	<0.3	<0.3	<0.3	<0.6	--
05/10/90	--	--	--	--	--	--	--	<50	<0.3	<0.3	<0.3	<0.6	--
08/09/90	--	--	--	--	--	--	--	<50	<0.3	<0.3	<0.3	<0.6	--
11/13/90	--	--	--	--	--	--	--	<50	<0.4	<0.3	<0.3	<0.4	--
03/27/91	--	--	--	--	--	--	--	<50	<0.5	<0.5	<0.5	<0.5	--
06/19/91	--	--	--	--	--	--	--	<50	<0.5	<0.5	<0.5	<0.5	--
08/21/91	--	--	--	--	--	--	--	<50	<0.4	<0.3	<0.3	<0.4	--
11/08/91	--	--	--	--	--	--	--	<50	<0.5	<0.5	<0.5	<0.5	--
02/13/92	--	--	--	--	--	--	--	<50	<0.5	<0.5	<0.5	<0.5	--
05/01/92	--	--	--	--	--	--	--	<50	<0.5	<0.5	<0.5	<0.5	--
11/18/92	--	--	--	--	--	--	--	<50	<0.5	<0.5	<0.5	<0.5	--
03/19/93	--	--	--	--	--	--	--	<50	<0.5	<0.5	<0.5	<1.5	--
06/10/93	--	--	--	--	--	--	--	<50	<0.5	<0.5	<0.5	<1.5	--
09/08/93	--	--	--	--	--	--	--	<50	<0.5	<0.5	<0.5	<1.5	--
12/21/93	--	--	--	--	--	--	--	<50	<0.5	<0.5	<0.5	<0.5	--
03/09/94	--	--	--	--	--	--	--	<50	<0.5	<0.5	<0.5	<0.5	--
09/21/94	--	--	--	--	--	--	--	<50	<0.5	<0.5	<0.5	<0.5	--
12/20/94	--	--	--	--	--	--	--	<50	<0.5	<0.5	<0.5	<0.5	--
03/28/95	--	--	--	--	--	--	--	<50	<0.5	<0.5	<0.5	<0.5	--
06/22/95	--	--	--	--	--	--	--	<50	<0.5	<0.5	<0.5	<0.5	--
09/21/95	--	--	--	--	--	--	--	<50	<0.5	<0.5	<0.5	<0.5	--
03/22/96	--	--	--	--	--	--	--	<50	<0.5	<0.5	<0.5	<0.5	<5.0
09/25/96	--	--	--	--	--	--	--	<50	<0.5	<0.5	<0.5	<0.5	<5.0
03/06/97	--	--	--	--	--	--	--	<50	<0.5	<0.5	<0.5	<0.5	<5.0
09/12/97	--	--	--	--	--	--	--	<50	<0.5	<0.5	<0.5	<0.5	<2.5

CONTINUED ON NEXT PAGE

## Cumulative Table of Well Data and Analytical Results

Vertical Measurements are in feet.

Volumetric Measurements are in gallons.

Analytical results are in parts per billion (ppb).

DATE	Well	Ground	Depth	Total			Notes	TPH- Gasoline	Benzene	Toluene	Ethyl- Benzene	Xylene	MTBE
	Head Elev.	Water Elev.	To Water	SPH Thickness	SPH Removed	SPH Removed							
<b>TRIP BLANK (CONT'D)</b>													
04/02/98	--	--	--	--	--	--	--	<50	<0.5	<0.5	<0.5	<0.5	<2.5
09/15/98	--	--	--	--	--	--	--	<50	<0.5	<0.5	<0.5	<0.5	<10
03/09/99	--	--	--	--	--	--	--	<50	<0.5	<0.5	<0.5	<0.5	<2.5
09/29/99	--	--	--	--	--	--	--	<50	<0.5	<0.5	<0.5	<0.5	<2.5
03/14/00	--	--	--	--	--	--	--	<50	<0.5	<0.5	<0.5	<0.5	<2.5

**Notes:**

Blaine Tech Services, Inc. began routine monitoring of the groundwater wells at this site on March 9, 1999.

Earlier field data and analytical results were drawn from the September 15, 1998 Gettler-Ryan, Inc. report.

Analytical results and groundwater data prior to 1995 were compiled from the quarterly groundwater monitoring reports prepared for Chevron by Sierra Environmental Services.

Analytical methods prior to September 21, 1994 are assumed to be 8015/8020.

When separate-phase hydrocarbons are present, ground water elevation is adjusted using the relation:

Corrected ground water elevation = Top-of-casing elevation - depth to water + (0.8 x hydrocarbon thickness).

**ABBREVIATIONS:**

TPH = Total Petroleum Hydrocarbons

ND = Not detected at or above the minimum quantitation limit. See laboratory reports for minimum quantitation limits.

SPH = Separate-phase Hydrocarbons

MTBE = Methyl tertiary-butyl ether

# Analytical Appendix



April 3, 2000

Scott Boor  
Blaine Tech Services (Chev)  
1680 Rogers Avenue  
San Jose, CA 95112

RE: Chevron 9-1026/MJC0628

Dear Scott Boor

Enclosed are the results of analyses for sample(s) received by the laboratory on March 15, 2000. If you have any questions concerning this report, please feel free to contact me.

Sincerely,

Wendy Bonnes  
Project Manager

CA ELAP Certificate Number 1210





Blaine Tech Services (Chev) 1680 Rogers Avenue San Jose, CA 95112	Project: Chevron 9-1026 (3701 Broadway, Oakland) Project Number: 000314-J1 Project Manager: Scott Boor	Sampled: 3/14/00 Received: 3/15/00 Reported: 4/3/00 13:55
---	--	---

### ANALYTICAL REPORT FOR SAMPLES:

Sample Description	Laboratory Sample Number	Sample Matrix	Date Sampled
B-1	MJC0628-01	Water	3/14/00
B-3	MJC0628-02	Water	3/14/00
B-4	MJC0628-03	Water	3/14/00
E	MJC0628-04	Water	3/14/00
F	MJC0628-05	Water	3/14/00
EA-1	MJC0628-06	Water	3/14/00
EA-2	MJC0628-07	Water	3/14/00
TB-	MJC0628-08	Water	3/14/00

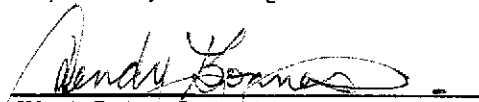
  
Wendy Bonnes, Project Manager





Blaine Tech Services (Chev) 1680 Rogers Avenue San Jose, CA 95112	Project: Chevron 9-1026 (3701 Broadway, Oakland) Project Number: 000314-J1 Project Manager: Scott Boor	Sampled: 3/14/00 Received: 3/15/00 Reported: 4/3/00 13:55
---	--	---

**Total Purgeable Hydrocarbons (C6-C12), BTEX and MTBE by DHS LUFT  
Sequoia Analytical - Morgan Hill**

Analyte	Batch Number	Date Prepared	Date Analyzed	Specific Method	Reporting Limit	Result	Units	Notes*
				<b><u>MJC0628-01</u></b>			<b><u>Water</u></b>	
<b>B-1</b>								
Purgeable Hydrocarbons	0C28001	3/28/00	3/28/00	DHS LUFT	100	<b>225</b>	ug/l	P-01
Benzene	"	"	"	DHS LUFT	1.00	<b>78.5</b>	"	
Toluene	"	"	"	DHS LUFT	1.00	<b>1.49</b>	"	
Ethylbenzene	"	"	"	DHS LUFT	1.00	<b>1.88</b>	"	
Xylenes (total)	"	"	"	DHS LUFT	1.00	<b>4.17</b>	"	
Methyl tert-butyl ether	"	"	"	DHS LUFT	5.00	ND	"	
Surrogate: a,a,a-Trifluorotoluene	"	"	"	70-130		92.0	%	
				<b><u>MJC0628-02</u></b>			<b><u>Water</u></b>	<b><u>H-05</u></b>
<b>B-3</b>								
Purgeable Hydrocarbons	0C29001	3/29/00	3/29/00	DHS LUFT	25000	<b>177000</b>	ug/l	P-01
Benzene	"	"	"	DHS LUFT	250	<b>15000</b>	"	
Toluene	"	"	"	DHS LUFT	250	<b>22000</b>	"	
Ethylbenzene	"	"	"	DHS LUFT	250	<b>2910</b>	"	
Xylenes (total)	"	"	"	DHS LUFT	250	<b>17000</b>	"	
Methyl tert-butyl ether	"	"	"	DHS LUFT	1250	ND	"	
Surrogate: a,a,a-Trifluorotoluene	"	"	"	70-130		89.6	%	
				<b><u>MJC0628-03</u></b>			<b><u>Water</u></b>	
<b>B-4</b>								
Purgeable Hydrocarbons	0C28001	3/28/00	3/28/00	DHS LUFT	10000	<b>29100</b>	ug/l	P-01
Benzene	"	"	"	DHS LUFT	100	<b>11000</b>	"	
Toluene	"	"	"	DHS LUFT	100	<b>223</b>	"	
Ethylbenzene	"	"	"	DHS LUFT	100	<b>1010</b>	"	
Xylenes (total)	"	"	"	DHS LUFT	100	<b>556</b>	"	
Methyl tert-butyl ether	"	"	"	DHS LUFT	500	ND	"	
Surrogate: a,a,a-Trifluorotoluene	"	"	"	70-130		96.5	%	
				<b><u>MJC0628-04</u></b>			<b><u>Water</u></b>	<b><u>H-05</u></b>
<b>E</b>								
Purgeable Hydrocarbons	0C29001	3/29/00	3/29/00	DHS LUFT	50.0	ND	ug/l	
Benzene	"	"	"	DHS LUFT	0.500	ND	"	
Toluene	"	"	"	DHS LUFT	0.500	ND	"	
Ethylbenzene	"	"	"	DHS LUFT	0.500	ND	"	
Xylenes (total)	"	"	"	DHS LUFT	0.500	ND	"	
Methyl tert-butyl ether	"	"	"	DHS LUFT	2.50	ND	"	
Surrogate: a,a,a-Trifluorotoluene	"	"	"	70-130		92.4	%	
				<b><u>MJC0628-05</u></b>			<b><u>Water</u></b>	<b><u>H-05a</u></b>
<b>F</b>								
Purgeable Hydrocarbons	0C29002	3/29/00	3/29/00	DHS LUFT	50.0	ND	ug/l	
Benzene	"	"	"	DHS LUFT	0.500	ND	"	





Blaine Tech Services (Chev) 1680 Rogers Avenue San Jose, CA 95112	Project: Chevron 9-1026 (3701 Broadway, Oakland) Project Number: 000314-J1 Project Manager: Scott Boor	Sampled: 3/14/00 Received: 3/15/00 Reported: 4/3/00 13:55
---	--	---

**Total Purgeable Hydrocarbons (C6-C12), BTEX and MTBE by DHS LUFT  
Sequoia Analytical - Morgan Hill**

Analyte	Batch Number	Date Prepared	Date Analyzed	Specific Method	Reporting Limit	Result	Units	Notes*
<b>F (continued)</b>				<b>MJC0628-05</b>			<b>Water</b>	<b>H-05a</b>
Toluene	0C29002	3/29/00	3/29/00	DHS LUFT	0.500	ND	ug/l	
Ethylbenzene	"	"	"	DHS LUFT	0.500	ND	"	
Xylenes (total)	"	"	"	DHS LUFT	0.500	ND	"	
Methyl tert-butyl ether	"	"	"	DHS LUFT	2.50	ND	"	
<i>Surrogate: a,a,a-Trifluorotoluene</i>	"	"	"	70-130		97.3	%	
<b>EA-1</b>				<b>MJC0628-06</b>			<b>Water</b>	<b>H-05</b>
Purgeable Hydrocarbons	0C30001	3/30/00	3/30/00	DHS LUFT	50.0	ND	ug/l	
Benzene	"	"	"	DHS LUFT	0.500	ND	"	
Toluene	"	"	"	DHS LUFT	0.500	ND	"	
Ethylbenzene	"	"	"	DHS LUFT	0.500	ND	"	
Xylenes (total)	"	"	"	DHS LUFT	0.500	ND	"	
<b>Methyl tert-butyl ether</b>	"	"	"	DHS LUFT	2.50	<b>6.65</b>	"	
<i>Surrogate: a,a,a-Trifluorotoluene</i>	"	"	"	70-130		90.4	%	
<b>EA-2</b>				<b>MJC0628-07</b>			<b>Water</b>	<b>H-05a</b>
Purgeable Hydrocarbons	0C29002	3/29/00	3/29/00	DHS LUFT	50.0	ND	ug/l	
Benzene	"	"	"	DHS LUFT	0.500	ND	"	
Toluene	"	"	"	DHS LUFT	0.500	ND	"	
Ethylbenzene	"	"	"	DHS LUFT	0.500	ND	"	
Xylenes (total)	"	"	"	DHS LUFT	0.500	ND	"	
Methyl tert-butyl ether	"	"	"	DHS LUFT	2.50	ND	"	
<i>Surrogate: a,a,a-Trifluorotoluene</i>	"	"	"	70-130		107	%	
<b>TB-</b>				<b>MJC0628-08</b>			<b>Water</b>	<b>H-05a</b>
Purgeable Hydrocarbons	0C29002	3/29/00	3/29/00	DHS LUFT	50.0	ND	ug/l	
Benzene	"	"	"	DHS LUFT	0.500	ND	"	
Toluene	"	"	"	DHS LUFT	0.500	ND	"	
Ethylbenzene	"	"	"	DHS LUFT	0.500	ND	"	
Xylenes (total)	"	"	"	DHS LUFT	0.500	ND	"	
Methyl tert-butyl ether	"	"	"	DHS LUFT	2.50	ND	"	
<i>Surrogate: a,a,a-Trifluorotoluene</i>	"	"	"	70-130		95.3	%	







Blaine Tech Services (Chev) 1680 Rogers Avenue San Jose, CA 95112	Project: Chevron 9-1026 (3701 Broadway, Oakland) Project Number: 000314-J1 Project Manager: Scott Boor	Sampled: 3/14/00 Received: 3/15/00 Reported: 4/3/00 13:55
---	--	---

**Total Purgeable Hydrocarbons (C6-C12), BTEX and MTBE by DHS LUFT/Quality Control**  
**Sequoia Analytical - Morgan Hill**

Analyte	Date Analyzed	Spike Level	Sample Result	QC Result	Reporting Limit Units	Recov. Limits	Recov. %	RPD Limit	RPD %	Notes*
---------	---------------	-------------	---------------	-----------	-----------------------	---------------	----------	-----------	-------	--------

**Batch: 0C28001**

**Date Prepared: 3/28/00**

**Extraction Method: EPA 5030B [P/T]**

**Blank**

**0C28001-BLK1**

Purgeable Hydrocarbons	3/28/00			ND	ug/l	50.0				
Benzene	"			ND	"	0.500				
Toluene	"			ND	"	0.500				
Ethylbenzene	"			ND	"	0.500				
Xylenes (total)	"			ND	"	0.500				
Methyl tert-butyl ether	"			ND	"	2.50				
Surrogate: <i>a,a,a</i> -Trifluorotoluene	"	10.0		9.26	"	70-130	92.6			

**LCS**

**0C28001-BS1**

Benzene	3/28/00	10.0		8.59	ug/l	70-130	85.9			
Toluene	"	10.0		8.65	"	70-130	86.5			
Ethylbenzene	"	10.0		8.81	"	70-130	88.1			
Xylenes (total)	"	30.0		26.9	"	70-130	89.7			
Surrogate: <i>a,a,a</i> -Trifluorotoluene	"	10.0		8.69	"	70-130	86.9			

**Matrix Spike**

**0C28001-MS1 MJC0645-02**

Benzene	3/29/00	10.0	ND	9.01	ug/l	60-140	90.1			
Toluene	"	10.0	ND	9.11	"	60-140	91.1			
Ethylbenzene	"	10.0	ND	9.17	"	60-140	91.7			
Xylenes (total)	"	30.0	ND	27.2	"	60-140	90.7			
Surrogate: <i>a,a,a</i> -Trifluorotoluene	"	10.0		9.13	"	70-130	91.3			

**Matrix Spike Dup**

**0C28001-MSD1 MJC0645-02**

Benzene	3/29/00	10.0	ND	9.11	ug/l	60-140	91.1	25	1.10	
Toluene	"	10.0	ND	8.13	"	60-140	81.3	25	11.4	
Ethylbenzene	"	10.0	ND	7.46	"	60-140	74.6	25	20.6	
Xylenes (total)	"	30.0	ND	26.8	"	60-140	89.3	25	1.48	
Surrogate: <i>a,a,a</i> -Trifluorotoluene	"	10.0		9.46	"	70-130	94.6			

**Batch: 0C29001**

**Date Prepared: 3/29/00**

**Extraction Method: EPA 5030B [P/T]**

**Blank**

**0C29001-BLK1**

Purgeable Hydrocarbons	3/29/00			ND	ug/l	50.0				
Benzene	"			ND	"	0.500				
Toluene	"			ND	"	0.500				
Ethylbenzene	"			ND	"	0.500				
Xylenes (total)	"			ND	"	0.500				
Methyl tert-butyl ether	"			ND	"	2.50				





Blaine Tech Services (Chev) 1680 Rogers Avenue San Jose, CA 95112	Project: Chevron 9-1026 (3701 Broadway, Oakland) Project Number: 000314-J1 Project Manager: Scott Boor	Sampled: 3/14/00 Received: 3/15/00 Reported: 4/3/00 13:55
---	--	---

**Total Purgeable Hydrocarbons (C6-C12), BTEX and MTBE by DHS LUFT/Quality Control**  
**Sequoia Analytical - Morgan Hill**

Analyte	Date Analyzed	Spike Level	Sample Result	QC Result	Units	Reporting Limit Recov. Limits	Recov. %	RPD Limit	RPD %	Notes*
<b>Blank (continued)</b>										
<b>0C29001-BLK1</b>										
Surrogate: a,a,a-Trifluorotoluene	3/29/00	10.0		9.24	ug/l	70-130	92.4			
<b>LCS</b>										
<b>0C29001-BS1</b>										
Purgeable Hydrocarbons	3/29/00	250		257	ug/l	70-130	103			
Surrogate: a,a,a-Trifluorotoluene	"	10.0		10.1	"	70-130	101			
<b>Matrix Spike</b>										
<b>0C29001-MS1 MJC0663-12</b>										
Purgeable Hydrocarbons	3/30/00	250	ND	259	ug/l	60-140	<b>104</b>			
Surrogate: a,a,a-Trifluorotoluene	"	10.0		10.0	"	70-130	100			
<b>Matrix Spike Dup</b>										
<b>0C29001-MSD1 MJC0663-12</b>										
Purgeable Hydrocarbons	3/30/00	250	ND	234	ug/l	60-140	<b>93.6</b>	25	<b>10.1</b>	
Surrogate: a,a,a-Trifluorotoluene	"	10.0		9.72	"	70-130	97.2			
<b>Batch: 0C29002</b>										
<b>Date Prepared: 3/29/00</b>										
<b>Extraction Method: EPA 5030B [P/T]</b>										
<b>Blank</b>										
<b>0C29002-BLK1</b>										
Purgeable Hydrocarbons	3/29/00			ND	ug/l		<b>50.0</b>			
Benzene	"			ND	"		<b>0.500</b>			
Toluene	"			ND	"		<b>0.500</b>			
Ethylbenzene	"			ND	"		<b>0.500</b>			
Xylenes (total)	"			ND	"		<b>0.500</b>			
Methyl tert-butyl ether	"			ND	"		<b>2.50</b>			
Surrogate: a,a,a-Trifluorotoluene	"	10.0		11.0	"	70-130	110			
<b>LCS</b>										
<b>0C29002-BS1</b>										
Purgeable Hydrocarbons	3/29/00	250		234	ug/l	70-130	93.6			
Surrogate: a,a,a-Trifluorotoluene	"	10.0		15.3	"	70-130	153			S-04
<b>Matrix Spike</b>										
<b>0C29002-MS1 MJC0663-07</b>										
Purgeable Hydrocarbons	3/29/00	250	ND	218	ug/l	60-140	<b>87.2</b>			
Surrogate: a,a,a-Trifluorotoluene	"	10.0		11.3	"	70-130	113			
<b>Matrix Spike Dup</b>										
<b>0C29002-MSD1 MJC0663-07</b>										
Purgeable Hydrocarbons	3/29/00	250	ND	252	ug/l	60-140	<b>101</b>	25	<b>14.5</b>	
Surrogate: a,a,a-Trifluorotoluene	"	10.0		12.8	"	70-130	128			





Blaine Tech Services (Chev) 1680 Rogers Avenue San Jose, CA 95112	Project: Chevron 9-1026 (3701 Broadway, Oakland) Project Number: 000314-J1 Project Manager: Scott Boor	Sampled: 3/14/00 Received: 3/15/00 Reported: 4/3/00 13:55
---	--	---

**Total Purgeable Hydrocarbons (C6-C12), BTEX and MTBE by DHS LUFT/Quality Control  
Sequoia Analytical - Morgan Hill**

Analyte	Date Analyzed	Spike Level	Sample Result	QC Result	Units	Reporting Limit Recov. Limits	Recov. %	RPD Limit	RPD %	Notes*
<b>Batch: 0C30001</b>		<b>Date Prepared: 3/30/00</b>			<b>Extraction Method: EPA 5030B [P/T]</b>					
<b>Blank</b>		<b>0C30001-BLK1</b>								
Purgeable Hydrocarbons	3/30/00			ND	ug/l	50.0				
Benzene	"			ND	"	0.500				
Toluene	"			ND	"	0.500				
Ethylbenzene	"			ND	"	0.500				
Xylenes (total)	"			ND	"	0.500				
Methyl tert-butyl ether	"			ND	"	2.50				
Surrogate: <i>a,a,a</i> -Trifluorotoluene	"	10.0		9.21	"	70-130	92.1			
<b>LCS</b>		<b>0C30001-BS1</b>								
Benzene	3/30/00	10.0		8.90	ug/l	70-130	89.0			
Toluene	"	10.0		9.11	"	70-130	91.1			
Ethylbenzene	"	10.0		9.11	"	70-130	91.1			
Xylenes (total)	"	30.0		27.7	"	70-130	92.3			
Surrogate: <i>a,a,a</i> -Trifluorotoluene	"	10.0		9.35	"	70-130	93.5			
<b>Matrix Spike</b>		<b>0C30001-MS1</b>		<b>MJC0643-02</b>						
Benzene	3/30/00	10.0	ND	9.56	ug/l	60-140	95.6			
Toluene	"	10.0	ND	9.40	"	60-140	94.0			
Ethylbenzene	"	10.0	ND	9.19	"	60-140	91.9			
Xylenes (total)	"	30.0	ND	28.0	"	60-140	93.3			
Surrogate: <i>a,a,a</i> -Trifluorotoluene	"	10.0		9.29	"	70-130	92.9			
<b>Matrix Spike Dup</b>		<b>0C30001-MSD1</b>		<b>MJC0643-02</b>						
Benzene	3/30/00	10.0	ND	8.91	ug/l	60-140	89.1	25	7.04	
Toluene	"	10.0	ND	8.98	"	60-140	89.8	25	4.57	
Ethylbenzene	"	10.0	ND	9.11	"	60-140	91.1	25	0.874	
Xylenes (total)	"	30.0	ND	27.9	"	60-140	93.0	25	0.358	
Surrogate: <i>a,a,a</i> -Trifluorotoluene	"	10.0		8.71	"	70-130	87.1			





Blaine Tech Services (Chev) 1680 Rogers Avenue San Jose, CA 95112	Project: Chevron 9-1026 (3701 Broadway, Oakland) Project Number: 000314-J1 Project Manager: Scott Boor	Sampled: 3/14/00 Received: 3/15/00 Reported: 4/3/00 13:55
---	--	---

## Notes and Definitions

#	Note
---	------

H-05	The result for this analyte was generated out of hold time. It was originally run within hold-time, but due to instrument/QC problems, it had to be re-run. During the original run, the closing standard had failed.
H-05a	The result for this analyte was generated out of hold time. It was originally run within hold-time, but due to instrument/QC problems, it had to be re-run. During the original run, the closing standard had failed.
P-01	Chromatogram Pattern: Gasoline C6-C12
S-04	The surrogate recovery for this sample is outside of established control limits due to a sample matrix effect.
DET	Analyte DETECTED
ND	Analyte NOT DETECTED at or above the reporting limit
NR	Not Reported
dry	Sample results reported on a dry weight basis
Recov.	Recovery
RPD	Relative Percent Difference



# **Field Data Sheets**



**CHEVRON [REDACTED] WELL MONITORING DATA SHEET**

Project #: <u>000314-J1</u>	Station #: <u>9-1026</u>
Sampler: <u>Tosh</u>	Date: <u>3-14-00</u>
Well I.D.: <u>A</u>	Well Diameter: 2 3 <u>4</u> 6 8 <u>    </u>
Total Well Depth:	Depth to Water:
Depth to Free Product:	Thickness of Free Product (feet):
Referenced to: <u>PVC</u> Grade	D.O. Meter (if req'd): YSI HACH

Well Diameter	Multiplier	Well Diameter	Multiplier
2"	0.16	5"	1.02
3"	0.37	6"	1.47
4"	0.65	Other	radius <sup>2</sup> * 0.163

Purge Method: Bailer  
 Disposable Bailer  
 Middleburg  
 Electric Submersible  
 Extraction Pump  
 Other: \_\_\_\_\_

Sampling Method: Bailer  
Disposable Bailer  
 Extraction Port  
 Other: \_\_\_\_\_

_____	X	<u>3</u>	=	_____	Gals.
1 Case Volume (Gals.)		Specified Volumes		Calculated Volume	

Time	Temp (°F)	pH	Cond.	Turbidity	Gals. Removed	Observations
						* inaccessible - under trailer

Did well dewater? Yes  No  Gallons actually evacuated: \_\_\_\_\_

Sampling Time: \_\_\_\_\_ Sampling Date: \_\_\_\_\_

Sample I.D.: \_\_\_\_\_ Laboratory: Associated Other: Sequoia

Analyzed for: TPH-G BTEX MTBE TPH-D Other: \_\_\_\_\_

Duplicate I.D.: \_\_\_\_\_ Analyzed for: TPH-G BTEX MTBE TPH-D Other: \_\_\_\_\_

D.O. (if req'd):	Pre-purge:	mg/L	Post-purge:	mg/L
O.R.P. (if req'd):	Pre-purge:	mV	Post-purge:	mV

**CHEVRON [REDACTED] WELL MONITORING DATA SHEET**

Project #: <u>000314-J1</u>	Station #: <u>9-1026</u>
Sampler: <u>Tosh</u>	Date: <u>3-14-00</u>
Well I.D.: <u>B</u>	Well Diameter: 2 3 <u>(4)</u> 6 8
Total Well Depth: <u>—</u>	Depth to Water: <u>12.80</u>
Depth to Free Product: <u>11.41</u>	Thickness of Free Product (feet): <u>1.39</u>
Referenced to: <u>(PVC)</u> Grade	D.O. Meter (if req'd): YSI HACH

Well Diameter	Multiplier	Well Diameter	Multiplier
2"	0.16	5"	1.02
3"	0.37	6"	1.47
4"	0.65	Other	radius <sup>2</sup> * 0.163

Purge Method:  Bailer  
 Disposable Bailer ✓  
 Middleburg  
 Electric Submersible  
 Extraction Pump  
 Other: \_\_\_\_\_

Sampling Method:  Bailer  
 Disposable Bailer  
 Extraction Port  
 Other: \_\_\_\_\_

_____	X	<u>3</u>	=	_____ Gals.
1 Case Volume (Gals.)		Specified Volumes		Calculated Volume

Time	Temp (°F)	pH	Cond.	Turbidity	Gals. Removed	Observations

Did well dewater? Yes   No      Gallons actually evacuated: 1500 mL

Sampling Time: 1155      Sampling Date: 3-14-00

Sample I.D.: B      Laboratory: Associated      Other: CRTC

Analyzed for: (TPH-G) (BTEX) (MTBE) (TPH-D)      Other: Material ID

Duplicate I.D.: \_\_\_\_\_      Analyzed for: TPH-G BTEX MTBE TPH-D Other: \_\_\_\_\_

D.O. (if req'd):	Pre-purge:	mg/L	Post-purge:	mg/L
O.R.P. (if req'd):	Pre-purge:	mV	Post-purge:	mV



# CHEVRON XXXXXXXXXX WELL MONITORING DATA SHEET

Project #: <u>000314-J1</u>	Station #: <u>9-1026</u>
Sampler: <u>Josh</u>	Date: <u>3-14-00</u>
Well I.D.: <u>B-1</u>	Well Diameter: 2 3 <u>(4)</u> 6 8 <u>   </u>
Total Well Depth: <u>33.06</u>	Depth to Water: <u>10.39</u>
Depth to Free Product: <u>   </u>	Thickness of Free Product (feet): <u>   </u>
Referenced to: <u>(PVC)</u> Grade	D.O. Meter (if req'd): YSI HACH

Well Diameter	Multiplier	Well Diameter	Multiplier
2"	0.16	5"	1.02
3"	0.37	6"	1.47
4"	0.65	Other	radius <sup>2</sup> * 0.163

Purge Method:  Bailer                      Sampling Method:  Bailer  
 Disposable Bailer                       Disposable Bailer  
 Middleburg                                      Extraction Port  
 Electric Submersible                      Other: \_\_\_\_\_  
 Extraction Pump

Other: \_\_\_\_\_

<u>14.7</u>	X	<u>3</u>	=	<u>44.2</u>	Gals.
1 Case Volume (Gals.)		Specified Volumes		Calculated Volume	

Time	Temp (°F)	pH	Cond.	Turbidity	Gals. Removed	Observations
1102	69.2	7.2	874	}	15	
1105	69.3	6.9	936		30	
1109	69.6	7.0	995		45	

Did well dewater? Yes   No      Gallons actually evacuated: 45

Sampling Time: 1110      Sampling Date: 3-14-00

Sample I.D.: B-1      Laboratory: Associated      Other: Sequoia

Analyzed for:  TPH-G  BTEX  MTBE  TPH-D      Other: \_\_\_\_\_

Duplicate I.D.: \_\_\_\_\_      Analyzed for: TPH-G BTEX MTBE TPH-D      Other: \_\_\_\_\_

D.O. (if req'd):	Pre-purge:	mg/L	Post-purge:	mg/L
O.R.P. (if req'd):	Pre-purge:	mV	Post-purge:	mV

# CHEVRON XXXXXXXXXX WELL MONITORING DATA SHEET

Project #: 000314-J1	Station #: 9-102.6
Sampler: Josh	Date: 3-14-00
Well I.D.: B-2	Well Diameter: <u>2</u> 3 4 6 8
Total Well Depth: —	Depth to Water: 12.65
Depth to Free Product: 12.46	Thickness of Free Product (feet): 0.19
Referenced to: <u>PVC</u> Grade	D.O. Meter (if req'd): YSI HACH

Well Diameter	Multiplier	Well Diameter	Multiplier
2"	0.16	5"	1.02
3"	0.37	6"	1.47
4"	0.65	Other	radius <sup>2</sup> * 0.163

Purge Method: Bailer   
 Disposable Bailer  
 Middleburg  
 Electric Submersible  
 Extraction Pump

Sampling Method: Bailer  
Disposable Bailer  
 Extraction Port  
 Other: \_\_\_\_\_

Other: \_\_\_\_\_

_____	X	<u>3</u>	=	_____ Gals.
1 Case Volume (Gals.)		Specified Volumes		Calculated Volume

Time	Temp (°F)	pH	Cond.	Turbidity	Gals. Removed	Observations
						* Removed 150 ml SPH
						w/ dedicated Teflon bailer
						located in well

Did well dewater? Yes  No  Gallons actually evacuated: —

Sampling Time: 6:15 Sampling Date: 3-14-00

Sample I.D.: B-2 Laboratory: Associated Other: CRTC

Analyzed for: TPH-G BTEX MTBE TPH-D Other: Material ID

Duplicate I.D.: \_\_\_\_\_ Analyzed for: TPH-G BTEX MTBE TPH-D Other: \_\_\_\_\_

D.O. (if req'd):	Pre-purge:	mg/L	Post-purge:	mg/L
O.R.P. (if req'd):	Pre-purge:	mV	Post-purge:	mV

# CHEVRON XXXXXXXXXX WELL MONITORING DATA SHEET

Project #: <u>000314-J1</u>	Station #: <u>9-1026</u>
Sampler: <u>Josh</u>	Date: <u>3-14-00</u>
Well I.D.: <u>B-4</u>	Well Diameter: <u>(2)</u> 3 4 6 8 <u>    </u>
Total Well Depth: <u>19.56</u>	Depth to Water: <u>10.57</u>
Depth to Free Product: <u>    </u>	Thickness of Free Product (feet): <u>    </u>
Referenced to: <u>(PVC)</u> Grade	D.O. Meter (if req'd): YSI HACH

Well Diameter	Multiplier	Well Diameter	Multiplier
2"	0.16	5"	1.02
3"	0.37	6"	1.47
4"	0.65	Other	radius <sup>2</sup> * 0.163

Purge Method:  Bailer                      Sampling Method:  Bailer

Disposable Bailer   Middleburg                       Disposable Bailer

Electric Submersible                       Extraction Port

Extraction Pump                      Other:     

Other:     

<u>1.4</u>	X	<u>3</u>	=	<u>4.3</u>	Gals.
1 Case Volume (Gals.)		Specified Volumes		Calculated Volume	

Time	Temp (°F)	pH	Cond.	Turbidity	Gals. Removed	Observations
1122	65.5	6.9	2143	S	1.5	odor
1125	65.5	6.9	2229		3.0	
1128	65.5	6.9	2262		4.5	

Did well dewater? Yes  (No) Gallons actually evacuated: 4.5

Sampling Time: B-4 1130 Sampling Date: 3-14-00

Sample I.D.: B-4 Laboratory: Associated Other: Sequoia

Analyzed for: (TPH-G) (BTEX) (MTBE) TPH-D Other:     

Duplicate I.D.:      Analyzed for: TPH-G BTEX MTBE TPH-D Other:     

D.O. (if req'd):	Pre-purge:	mg/L	Post-purge:	mg/L
O.R.P. (if req'd):	Pre-purge:	mV	Post-purge:	mV

# CHEVRON ██████████ WELL MONITORING DATA SHEET

Project #: 000314-J1	Station #: 9-1026
Sampler: Josh	Date: 3-14-00
Well I.D.: E	Well Diameter: ② 3 4 6 8
Total Well Depth: 33.01	Depth to Water: <del>33.01</del> 8.49
Depth to Free Product:	Thickness of Free Product (feet):
Referenced to: PVC Grade	D.O. Meter (if req'd): YSI HACH

Well Diameter	Multiplier	Well Diameter	Multiplier
2"	0.16	5"	1.02
3"	0.37	6"	1.47
4"	0.65	Other	radius <sup>2</sup> * 0.163

Purge Method: Bailer  
 Disposable Bailer   
 Middleburg  
 Electric Submersible  
 Extraction Pump

Sampling Method: Bailer  
 Disposable Bailer   
 Extraction Port  
 Other: \_\_\_\_\_

Other: \_\_\_\_\_

3.9	x	3	=	11.7	Gals.
1 Case Volume (Gals.)		Specified Volumes		Calculated Volume	

Time	Temp (°F)	pH	Cond.	Turbidity	Gals. Removed	Observations
1016	66.1	7.2	1100	}	4	
1020	66.9	6.9	1171		8	
1027	66.9	6.9	1179		12	

Did well dewater? Yes  No  Gallons actually evacuated: 12

Sampling Time: 1030 Sampling Date: 3-14-06

Sample I.D.: E Laboratory: Associated Other: Sequoia

Analyzed for: TPH-G BTEX MTBE TPH-D Other:

Duplicate I.D.: Analyzed for: TPH-G BTEX MTBE TPH-D Other:

D.O. (if req'd):	Pre-purge:	mg/L	Post-purge:	mg/L
O.R.P. (if req'd):	Pre-purge:	mV	Post-purge:	mV

**CHEVRON [REDACTED] WELL MONITORING DATA SHEET**

Project #: <u>000314-J1</u>	Station #: <u>9-1026</u>
Sampler: <u>Tosh</u>	Date: <u>3-14-00</u>
Well I.D.: <u>F</u>	Well Diameter: <u>(2)</u> 3 4 6 8
Total Well Depth: <u>29.38</u>	Depth to Water: <u>13.35</u>
Depth to Free Product:	Thickness of Free Product (feet):
Referenced to: <u>(PVC)</u> Grade	D.O. Meter (if req'd): YSI HACH

Well Diameter	Multiplier	Well Diameter	Multiplier
2"	0.16	5"	1.02
3"	0.37	6"	1.47
4"	0.65	Other	radius <sup>2</sup> * 0.163

Purge Method: Bailer  
 Disposable Bailer   
 Middleburg  
 Electric Submersible  
 Extraction Pump

Sampling Method: Bailer  
(Disposable Bailer)  
 Extraction Port  
 Other: \_\_\_\_\_

Other: \_\_\_\_\_

<u>2.6</u>	x	<u>3</u>	=	<u>7.8</u>	Gals.
1 Case Volume (Gals.)		Specified Volumes		Calculated Volume	

Time	Temp (°F)	pH	Cond.	Turbidity	Gals. Removed	Observations
9:53	66.3	6.9	1162	S	3	
9:55	67.1	7.0	1167		6	
10:00	67.4	7.0	1186		8	

Did well dewater? Yes  (No) Gallons actually evacuated: 8

Sampling Time: 1005 Sampling Date: 3-14-00

Sample I.D.: F Laboratory: Associated Other: Sequoia

Analyzed for: (TPH-G) (BTEX) (MTBE) TPH-D Other:

Duplicate I.D.: Analyzed for: TPH-G BTEX MTBE TPH-D Other:

D.O. (if req'd):	Pre-purge:	mg/L	Post-purge:	mg/L
O.R.P. (if req'd):	Pre-purge:	mV	Post-purge:	mV

# CHEVRON XXXXXXXXXX WELL MONITORING DATA SHEET

Project #: <u>000314-J1</u>	Station #: <u>9-1026</u>
Sampler: <u>Josh</u>	Date: <u>3-14-00</u>
Well I.D.: <u>EM EA-1</u>	Well Diameter: 2 3 <u>(4)</u> 6 8 _____
Total Well Depth: <u>27.62</u>	Depth to Water: <u>12.09</u>
Depth to Free Product:	Thickness of Free Product (feet):
Referenced to: <u>PVC</u> Grade	D.O. Meter (if req'd): YSI HACH

Well Diameter	Multiplier	Well Diameter	Multiplier
2"	0.16	5"	1.02
3"	0.37	6"	1.47
4"	0.65	Other	radius <sup>2</sup> + 0.163

Purge Method:  Bailer  
 Disposable Bailer  
 Middleburg  
 Electric Submersible  
 Extraction Pump  
 Other: \_\_\_\_\_

Sampling Method:  Bailer  
 Disposable Bailer  
 Extraction Port  
 Other: \_\_\_\_\_

<u>10.1</u>	X	<u>3</u>	=	<u>30.3</u>	Gals.
1 Case Volume (Gals.)		Specified Volumes		Calculated Volume	

Time	Temp (°F)	pH	Cond.	Turbidity	Gals. Removed	Observations
934	65.9	6.9	1330	S	11	
936	67.5	6.9	1020		22	
938	68.5	6.8	923		31	

Did well dewater? Yes  No Gallons actually evacuated: 31

Sampling Time: 940 Sampling Date: 3-14-00

Sample I.D.: EA-1 Laboratory: Associated Other: Sequoia

Analyzed for: TPH-G BTEX MTBE TPH-D Other: \_\_\_\_\_

Duplicate I.D.: \_\_\_\_\_ Analyzed for: TPH-G BTEX MTBE TPH-D Other: \_\_\_\_\_

D.O. (if req'd):	Pre-purge:	mg/L	Post-purge:	mg/L
O.R.P. (if req'd):	Pre-purge:	mV	Post-purge:	mV

# CHEVRON ██████████ WELL MONITORING DATA SHEET

Project #: <u>000314-J1</u>	Station #: <u>9-1026</u>
Sampler: <u>Josh</u>	Date: <u>3-14-00</u>
Well I.D.: <u>EA-2</u>	Well Diameter: 2 3 <u>4</u> 6 8
Total Well Depth: <u>20.20</u>	Depth to Water: <u>13.31</u>
Depth to Free Product:	Thickness of Free Product (feet):
Referenced to: <u>PVC</u> Grade	D.O. Meter (if req'd): YSI HACH

Well Diameter	Multiplier	Well Diameter	Multiplier
2"	0.16	5"	1.02
3"	0.37	6"	1.47
4"	0.65	Other	radius <sup>2</sup> * 0.163

Purge Method: <input type="checkbox"/> Bailer <input type="checkbox"/> Disposable Bailer <input type="checkbox"/> Middleburg <input checked="" type="checkbox"/> Electric Submersible <input type="checkbox"/> Extraction Pump Other: _____	Sampling Method: <input type="checkbox"/> Bailer <input checked="" type="checkbox"/> Disposable Bailer <input type="checkbox"/> Extraction Port Other: _____
--	---

<u>11</u>	X	<u>3</u>	=	<u>33</u>	Gals.
1 Case Volume (Gals.)		Specified Volumes		Calculated Volume	

Time	Temp (°F)	pH	Cond.	Turbidity	Gals. Removed	Observations
1041	70.0	7.1	694	}	11	
1044	70.2	7.1	745		22	
1046	69.7	7.0	802		33	

Did well dewater? Yes <input type="checkbox"/> <input checked="" type="checkbox"/> No	Gallons actually evacuated: <u>33</u>
Sampling Time: <u>1050</u>	Sampling Date: <u>3-14-00</u>
Sample I.D.: <u>EA-2</u>	Laboratory: Associated Other: <u>Sequoia</u>
Analyzed for: <input checked="" type="checkbox"/> TPH-G <input checked="" type="checkbox"/> BTEX <input checked="" type="checkbox"/> MTBE <input type="checkbox"/> TPH-D Other:	
Duplicate I.D.:	Analyzed for: TPH-G BTEX MTBE TPH-D Other:
D.O. (if req'd):	Pre-purge: <input type="text"/> mg/L Post-purge: <input type="text"/> mg/L
O.R.P. (if req'd):	Pre-purge: <input type="text"/> mV Post-purge: <input type="text"/> mV