

RECEIVED

11:42 am, Jun 17, 2009

Alameda County
Environmental Health

TRANSMITTAL

TO: Ms. Tina Berry
UNOCAL Corporation
Post Office Box 5155
San Ramon, California 94583
Phone No. (510) 277 - 2321
Fax No. (510) 277 - 2309

DATE: November 6, 1995
PROJECT: No. 1136.01
SUBJECT: Unocal No. 5367
Treatment System

FROM: Scott Listar
Gettler-Ryan Inc.
6747 Sierra Court, Suite J
Dublin, California 94568
Phone No. (510) 551-7555 ext 219

FILE #	5367	SS	<input checked="" type="checkbox"/>	BP	<input type="checkbox"/>
RPT	QM	TRANSMITTAL	<input type="checkbox"/>	<input type="checkbox"/>	<input type="checkbox"/>
1	2	3	4	5	6
<input type="checkbox"/>	<input type="checkbox"/>	<input type="checkbox"/>	<input type="checkbox"/>	<input checked="" type="checkbox"/>	<input type="checkbox"/>

WE ARE SENDING YOU:

PAGES/COPIES	DATED/SUBMITTED	DESCRIPTION
1	11/2/95	Site Safety Plan - Unocal Station No. 5367
1		Tags/Invoice for Equipment Delivery Unocal SS 5760

- NOTES:**
- 1). I will be contacting the Building Department Tuesday to follow up on the status of the construction permits. The construction start date is scheduled for 11/13/95 unless building permits have not been obtained by Friday the 10th.
 - 2). A copy of the Health & Safety Plan has been sent to Pacific Environmental Group for their records. *PSI?*
 - 3). I have requested a copy of the "owner supplied" equipment from SoilTherm so GR can order the balance of materials required for the installation.

THESE ARE TRANSMITTED as checked below:

- | | | |
|------------------------------------------------------------|-------------------------------------------------|-------------------------------------------------------------|
| <input checked="" type="checkbox"/> For review and comment | <input type="checkbox"/> Approved as submitted | <input type="checkbox"/> Resubmit _ copies for approval |
| <input checked="" type="checkbox"/> As requested | <input type="checkbox"/> Approved as noted | <input checked="" type="checkbox"/> copies for distribution |
| <input type="checkbox"/> For price quotation | <input type="checkbox"/> Return for corrections | <input checked="" type="checkbox"/> For your files |

*11/13/95 Lm Scott Listar
re. chap. (JB)*

NOV 08 1995



GETTLER-RYAN INC.

SITE SAFETY PLAN, JOB 1136.01

GENERAL INFORMATION:

SITE: Company: Unocal Service Station #5367
 Location: 500 Bancroft Avenue
 City: San Leandro, California

PLAN PREPARED BY: Barry McCoy, Gettler-Ryan Inc. DATE: 10/23/95

OBJECTIVES: To provide a plan for the safe completion of the site work.
 This plan supplements the requirements of the Gettler-Ryan
 Inc. Health and Safety Plan.

PROPOSED DATE OF SITE
WORK: 11/6/95

DOCUMENTATION/
SUMMARY: Hazardous material may be present, caution is advised.
 Site work includes installation of soil vapor and
 groundwater treatment systems including a fence and
 sewer connection. Site has known gasoline
 contamination.

SITE/WASTE CHARACTERISTICS:

WASTE TYPE(S):	Liquid	Solid	Gas
CHARACTERISTIC(S):	Volatile	Flammable	Toxic

FACILITY DESCRIPTION: Gasoline service station with underground utilities.

STATUS: Active

HAZARD EVALUATION

PARAMETER:

TLV 300 ppm THC

HEALTH: ingestion, inhalation, absorption

LEL 10% Gastechtor max.

**SPECIAL PRECAUTIONS
AND COMMENTS:**

Correct safety procedures must be followed, per Gettler-Ryan Inc. Health and Safety Plan.

SITE SAFETY WORKPLAN

**PERIMETER
ESTABLISHMENT:**

Use barricades and flagging to restrict access to work areas.

PERSONAL PROTECTION:

Level of Protection EPA Level D
Modifications: Nitrile gloves, hard hats.
Surveillance Equipment and Material: Gastech

SITE ENTRY PROCEDURES:

None

**DECONTAMINATION
PROCEDURES:**

Personnel: Wash thoroughly with detergent solution and water.

Equipment: Steam clean if necessary

FIRST AID:

As applicable

WORK LIMITATIONS:

(Time of day, weather, heat/cold stress): None

**PROJECT-DERIVED
MATERIAL DISPOSAL:**

Concrete to be removed and recycled other materials to remain on site until classified for proper disposal.

TEAM COMPOSITION:

Bob Herron - Job Foreman, Site Safety Officer
1 Laborer
1 Field Technician from Environmental Consultant
See Subcontractor List

EMERGENCY INFORMATION

LOCAL RESOURCES: Ambulance/Hospital Dial 911
 Police/Sheriff/Hwy. Patrol Dial 911
 Fire Department Dial 911

SITE RESOURCES: Water Supply
 Telephone
 Visqueen
 Fire Extinguisher
 First Aid Kit
 Sorbant Pads

EMERGENCY CONTACT: Gettler-Ryan Inc. (510) 551-7555
 Project Manager, Scott Listar extension 219
 Safety Manager, Barry McCoy extension 253
 Unocal Engineer, ~~Nick Nickerson~~ (510) 277-2321

Chg. this →

EMERGENCY ROUTES: Unocal Constr. Eng. *Tina Berry*
 Nearest emergency hospital is: *Nickerson 277 2*

**EDEN MEDICAL CENTER
20103 Lake Chabot Road
Castro Valley, CA**

(510) 537-1234

MAP ATTACHED

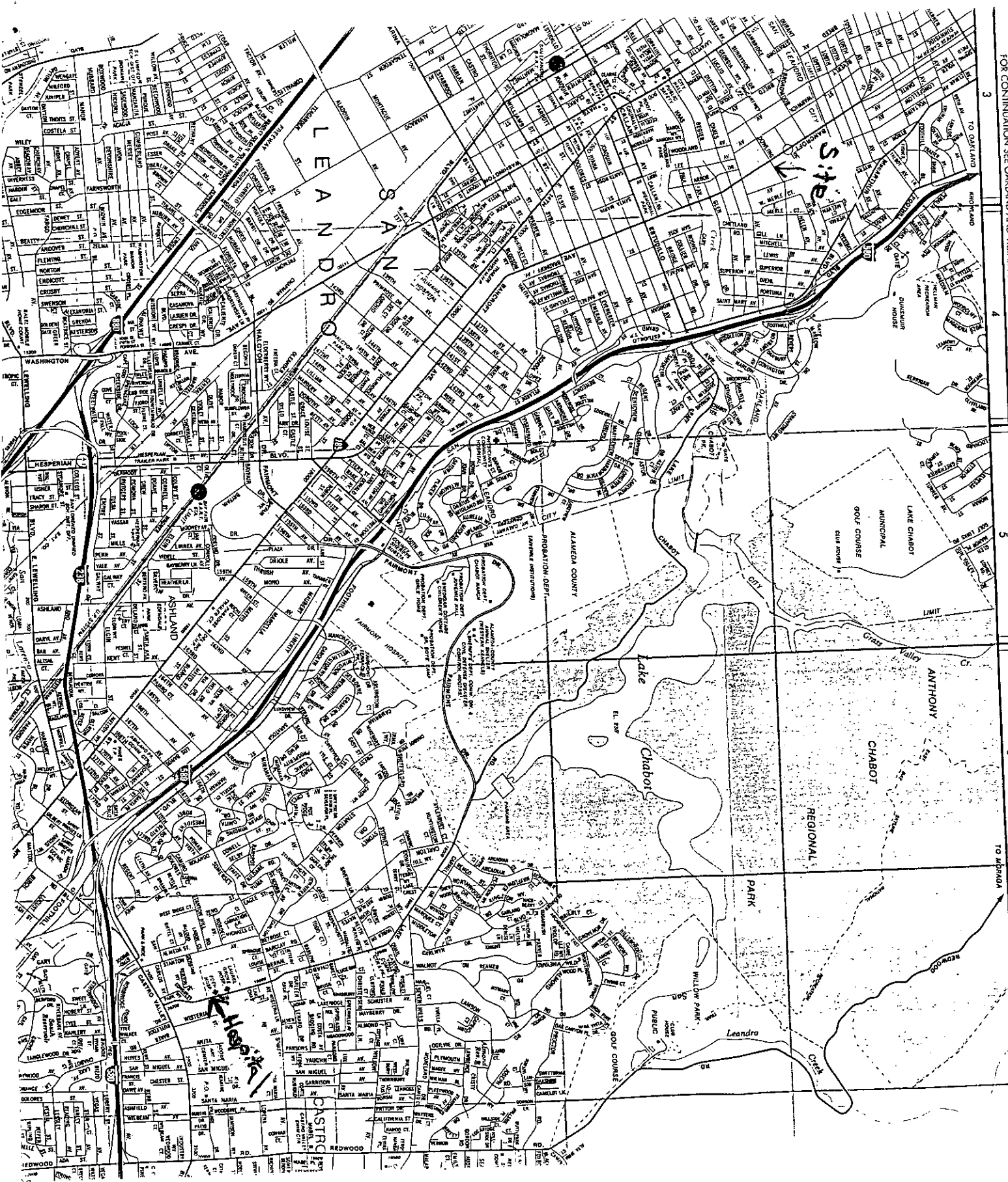

3

4

5

6

7

TO ALBANY

TO OAKLAND

TO OAKLAND

TO OAKLAND

TO OAKLAND

TO OAKLAND

TO OAKLAND

TO OAKLAND

TO OAKLAND

Site

SAN LEANDRO

Highway

Lake Chabot

Lake Chabot

Leandro

CHABOT

REGIONAL

PARK

WILLOW PARK

PROBATION DEPT.

ALAMEDA COUNTY

CONTRA COSTA COUNTY

ANTHONY

CHABOT

REGIONAL

PARK

WILLOW PARK

LEANDRO

ASHLAND

CASTRO

LEANDRO

LEANDRO

LEANDRO

LEANDRO

LEANDRO

LEANDRO

LEANDRO

LEANDRO

LEANDRO

LEANDRO

LEANDRO

LEANDRO

LEANDRO

LEANDRO

LEANDRO

LEANDRO

LEANDRO

LEANDRO

LEANDRO

LEANDRO

LEANDRO

LEANDRO

LEANDRO

LEANDRO

LEANDRO

LEANDRO

LEANDRO

LEANDRO

LEANDRO

LEANDRO

LEANDRO

LEANDRO

LEANDRO

LEANDRO

LEANDRO

LEANDRO

LEANDRO

LEANDRO

LEANDRO

LEANDRO

LEANDRO

LEANDRO

LEANDRO

LEANDRO

LEANDRO

LEANDRO

LEANDRO

LEANDRO

LEANDRO

LEANDRO

LEANDRO

LEANDRO

LEANDRO

LEANDRO

LEANDRO

LEANDRO

LEANDRO

LEANDRO

LEANDRO

LEANDRO

LEANDRO

LEANDRO

LEANDRO

LEANDRO

LEANDRO

LEANDRO

LEANDRO

LEANDRO

LEANDRO

LEANDRO

LEANDRO

LEANDRO

LEANDRO

LEANDRO

LEANDRO

LEANDRO

LEANDRO

LEANDRO

LEANDRO

LEANDRO

LEANDRO

LEANDRO

LEANDRO

LEANDRO

LEANDRO

LEANDRO

LEANDRO

LEANDRO

LEANDRO

LEANDRO

LEANDRO

LEANDRO

LEANDRO

LEANDRO

LEANDRO

LEANDRO

LEANDRO

LEANDRO

LEANDRO

LEANDRO

LEANDRO

LEANDRO

LEANDRO

LEANDRO

LEANDRO

LEANDRO

LEANDRO

LEANDRO

LEANDRO

LEANDRO

LEANDRO

LEANDRO

LEANDRO

LEANDRO

LEANDRO

LEANDRO

LEANDRO

LEANDRO

LEANDRO

LEANDRO

LEANDRO

LEANDRO

LEANDRO

LEANDRO

LEANDRO

LEANDRO

LEANDRO

LEANDRO

LEANDRO

LEANDRO

LEANDRO

LEANDRO

LEANDRO

LEANDRO

LEANDRO

LEANDRO

LEANDRO

LEANDRO

LEANDRO

LEANDRO

LEANDRO

LEANDRO

LEANDRO

LEANDRO

LEANDRO

LEANDRO

LEANDRO

LEANDRO

LEANDRO

LEANDRO

LEANDRO

LEANDRO

LEANDRO

LEANDRO

LEANDRO

LEANDRO

LEANDRO

LEANDRO

LEANDRO

LEANDRO

LEANDRO

LEANDRO

LEANDRO

LEANDRO

LEANDRO

LEANDRO

LEANDRO

LEANDRO

LEANDRO

LEANDRO

LEANDRO

LEANDRO

LEANDRO

LEANDRO

LEANDRO

LEANDRO

LEANDRO

LEANDRO

LEANDRO

LEANDRO

LEANDRO

LEANDRO

LEANDRO

LEANDRO

LEANDRO

LEANDRO

LEANDRO

LEANDRO

LEANDRO

LEANDRO

LEANDRO

LEANDRO

LEANDRO

LEANDRO

LEANDRO

LEANDRO

LEANDRO

LEANDRO

LEANDRO

LEANDRO

LEANDRO

LEANDRO

LEANDRO

LEANDRO

LEANDRO

LEANDRO

LEANDRO

LEANDRO

LEANDRO

LEANDRO

LEANDRO

LEANDRO

LEANDRO

LEANDRO

LEANDRO

LEANDRO

LEANDRO

LEANDRO

LEANDRO

LEANDRO

LEANDRO

LEANDRO

LEANDRO

LEANDRO

LEANDRO

LEANDRO

LEANDRO

LEANDRO

LEANDRO

LEANDRO

LEANDRO

LEANDRO

LEANDRO

LEANDRO

LEANDRO

LEANDRO

LEANDRO

LEANDRO

LEANDRO

LEANDRO

LEANDRO

LEANDRO

LEANDRO

LEANDRO

LEANDRO

LEANDRO

LEANDRO

LEANDRO

LEANDRO

LEANDRO

LEANDRO

LEANDRO

LEANDRO

LEANDRO

LEANDRO

LEANDRO

LEANDRO

LEANDRO

LEANDRO

LEANDRO

LEANDRO

LEANDRO

LEANDRO

LEANDRO

LEANDRO

LEANDRO

LEANDRO

LEANDRO

LEANDRO

LEANDRO

LEANDRO

LEANDRO

LEANDRO

LEANDRO

LEANDRO

LEANDRO

LEANDRO

LEANDRO

LEANDRO

LEANDRO

LEANDRO

LEANDRO

LEANDRO

LEANDRO

LEANDRO

LEANDRO

LEANDRO

LEANDRO

LEANDRO

LEANDRO

LEANDRO

LEANDRO

LEANDRO

LEANDRO

LEANDRO

LEANDRO

LEANDRO

LEANDRO

LEANDRO

LEANDRO

LEANDRO

LEANDRO