

Rec'd Dec 4, 2000



3164 Gold Camp Drive
Suite 200
Rancho Cordova, CA 95670-6021
U.S.A.
916/638-2085
FAX: 916/638-8385

November 17, 2000

Re-instate QMR of MW-4 for NGBE
Consider MW between MW-10 and MW-2

Ms. Eva Chu
Alameda County
Environmental Health Department
470 27th Street, Room 322
Oakland, CA 94612

Subject: *Quarterly Ground Water Monitoring and
Remediation System Status Report, Third Quarter 2000*
Beacon Station No. 721
44 Lewelling Boulevard
San Lorenzo, California
Delta Project No. D193-936

Dear Ms. Chu:

This report describes quarterly ground water monitoring and remediation system activities conducted during the **Third Quarter 2000**. The interpretations contained in this report represent our professional opinions and are based, in part, on information supplied by the client. These opinions are based on currently available information and are arrived at in accordance with currently accepted hydrogeologic and engineering practices at this time and location. Other than this, no warranty is implied or intended.

If you have any questions concerning this project, please contact Michael Berrington at (916) 536-2616.

DELTA ENVIRONMENTAL CONSULTANTS, INC.

Trevor L. Atkinson
Project Engineer

Michael A. Berrington
Project Manager

Steven W. Meeks, P.E.
California Registered Civil Engineer No. C057461



TLA (LRP025.936.DOC)

cc: Mr. Joe Aldridge – Ultramar Inc.
Mr. Steven Ritchie – California Regional Water Quality Control Board, San Francisco Bay Region

STATUS OF GROUND WATER MONITORING

Delta Environmental Consultants, Inc. (Delta) has been authorized by Ultramar Inc. to perform quarterly ground water monitoring and remediation system oversight for the subject site. This report describes quarterly ground water monitoring and remediation system status for the **Third Quarter 2000**.

Cumulative ground water sampling information is summarized in Table 1. A site location map, site detail map, ground water elevation map and benzene concentration map are shown on Figures 1 through 4, respectively.

Work Performed during the Third Quarter 2000:

- Performed ground water sampling on **September 6, 2000**

THIRD QUARTER 2000 GROUND WATER MONITORING RESULTS:

Monitoring Well	Date	Depth to Groundwater (feet)	Ground Water Elevation (ft amsl)	Benzene (µg/L)	Toluene (µg/L)	Ethyl-benzene (µg/L)	Total Xylenes (µg/L)	TPH as gasoline (µg/L)	MTBE [8260] (µg/L)
MW-1	09/06/00	16.30	27.37	1.8	<1.0	2.3	<1.0	340	870
MW-2	09/06/00	15.54	27.55	<50	<50	<50	<50	<5,000	46,000
MW-3	09/06/00	15.26	27.84	88	4.4	14	23	640	120
MW-4	09/06/00	17.11	27.55	NS	NS	NS	NS	NS	NS
MW-5	09/06/00	16.02	27.77	NS	NS	NS	NS	NS	NS
MW-6	09/06/00	14.78	27.69	NS	NS	NS	NS	NS	NS
MW-7	09/06/00	14.12	27.42	NS	NS	NS	NS	NS	NS
MW-8	09/06/00	15.10	27.16	NS	NS	NS	NS	NS	NS
MW-9	09/06/00	17.80	27.14	NS	NS	NS	NS	NS	NS
MW-10	09/06/00	15.36	26.98	<2.0	12	24	27	4,800	300
MW-11	09/06/00	18.36	26.64	NS	NS	NS	NS	NS	NS
RW-1	09/06/00	14.72	28.45	<0.5	<0.5	<0.5	<0.5	<50	11

µg/L = micrograms per liter; NS = Not Sampled; ft amsl = feet above mean sea level

STATUS OF REMEDIATION SYSTEM

Operation and maintenance is performed bi-monthly on a remediation system consisting of ground water treatment, soil vapor extraction (SVE) and air sparging components. Details of system performance and cumulative totals are tabulated in Tables 2 through 4. A process flow diagram showing details of the system is shown as Figure 5.

Operation & Maintenance Site Visits:

- Operation and maintenance site visits were conducted for the **Third Quarter 2000** on:
 - **September 13, 2000**

Ground Water Extraction System Performance:

- The Ground Water Treatment System did not operate during the **Third Quarter 2000**.
- During the **Third Quarter 2000**, the ground water system processed **Zero** gallons. As of **June 20, 2000**, the ground water system has processed approximately **189,652** gallons.
- During the **Third Quarter 2000**, the Ground Water Treatment System was turned off. The system will be restarted after repairs have been made to the system.

Soil Vapor Extraction System Performance:

- The SVE system did not operate during the **Third Quarter 2000**.
- During the **Third Quarter 2000**, the SVE system removed **Zero** pounds of vapor equivalent gasoline. As of **June 8, 2000**, the SVE system has removed approximately **3.1** pounds (**0.5** gallons) of vapor equivalent gasoline.
- During the **Third Quarter 2000** site visits, the SVE system was turned off. The system will be restarted after repairs have been made to the system.

Air Sparging System Performance:

- The Air Sparging system did not operate during the **Third Quarter 2000**.

CONCLUSIONS/RECOMMENDATIONS

Delta recommends continued operation of the remediation system and quarterly ground water monitoring.

Enclosures:

- Enclosure A: Site Background Information
- Enclosure B: Ground Water Sampling Information
- Enclosure C: Copy of Groundwater Sampling Frequency Letter
- Enclosure D: Ground Water Monitoring Analytical Results

When will Remediation system be placed back into operation?

TABLE 1

GROUND WATER MONITORING DATA

Beacon Station No. 721
44 Lewelling Boulevard
San Lorenzo, California

Monitoring Well	Date	Top of Riser Elevation (ft)	Depth to Water (ft)	Ground Water Elevation (ft)	Benzene (µg/L)	Toluene (µg/L)	Ethyl-benzene (µg/L)	Total Xylenes (µg/L)	TPH as gasoline (µg/L)	MTBE (µg/L)	Comments
MW-1	02/18/92	43.67	16.42	27.25	NS	NS	NS	NS	NS	NS	
	05/14/92		17.28	26.39	NS	NS	NS	NS	NS	NS	
	05/15/92		NM	NC	2,000	47	1,200	400	41,000	NA	
	08/27/92		19.48	24.19	NS	NS	NS	NS	NS	NS	
	08/28/92		NM	NC	3,800	54	850	970	110,000	NA	
	11/19/92		20.57	23.10	200	<5.0	90	140	3,600	NA	
	02/03/93		15.91	27.76	180	22	79	130	3,000	NA	
	06/23/93		16.21	27.46	2,400	74	650	510	12,000	NA	No free product or sheen
	09/22/93		17.85	25.82	3,000	290	1,100	1,200	23,000	NA	No free product or sheen
	01/24/94		17.91	25.76	2,400	280	1,100	1,700	18,000	NA	
	04/07/94		16.94	26.73	4,200	820	1,600	2,100	20,000	NA	No free product or sheen
	06/07/94		17.20	26.47	1,800	510	1,100	1,600	26,000	NA	No free product or sheen
	09/28/94		18.73	24.94	1,700	210	970	870	18,000	NA	No free product or sheen
	12/14/94		17.56	26.11	4,400	2,400	2,300	4,300	31,000	NA	Product sheen
	03/15/95		14.92	28.75	830	310	840	1,200	17,000	NA	Product sheen
	06/13/95		15.38	28.29	1,300	99	1,500	1,100	22,000	NA	No free product or sheen
	09/28/95		16.75	26.92	580	<25	780	410	8,800	NA	No free product or sheen
	12/28/95		17.28	26.39	4.9	<1.3	<1.3	290	4,800	74	No free product or sheen
	01/30/96		NM	NC	17	7.1	20	45	1,500	63	Not measured
	03/12/96		14.13	29.54	<0.5	<0.5	<0.5	<0.5	110	44	No free product or sheen
	06/11/96		14.90	28.77	48	0.9	37	26	600	75	No free product or sheen
	10/02/96		16.31	27.36	16	<0.5	6	0.92	210	11	No free product or sheen
	01/28/97		12.99	30.68	<0.5	<0.5	<0.5	<0.5	150	160	No free product or sheen
	05/20/97		15.28	28.39	<2.5	<2.5	<2.5	<2.5	680	640	No free product or sheen
	08/18/97		16.74	26.93	<2.5	<2.5	<2.5	<2.5	<250	540	No free product or sheen
	09/29/97		NM	NC	NS	NS	NS	NS	NS	NS	Not measured
	11/05/97		17.45	26.22	2.8	<2.5	<2.5	<2.5	<250	400/390 ^b	No free product or sheen
	03/31/98		12.47	31.20	260	13	110	150	3,300	7,900	No free product or sheen
	05/26/98		13.69	29.98	NS	NS	NS	NS	NS	NS	No free product or sheen

TABLE 1

GROUND WATER MONITORING DATA

Beacon Station No. 721
44 Lewelling Boulevard
San Lorenzo, California

Monitoring Well	Date	Top of Riser Elevation (ft)	Depth to Water (ft)	Ground Water Elevation (ft)	Benzene (µg/L)	Toluene (µg/L)	Ethyl-benzene (µg/L)	Total Xylenes (µg/L)	TPH as gasoline (µg/L)	MTBE (µg/L)	Comments
MW-1	05/28/98	43.67	NM	NC	120	<10	39	55	7,800	9,300	No free product or sheen
(Cont.)	08/19/98		14.58	29.09	12	<2.5	6.0 ^c	3.8 ^c	<250 ^c	2,200	No free product or sheen
	11/17/98		15.39	28.28	8.3	<2.5	9.2	7.6	860	4,200	No free product or sheen
	02/18/99		13.52	30.15	2.7	<2.5	<2.5	3.9	310	4,200	No free product or sheen
	06/24/99		15.02	28.65	10	<2.5	12	6.5	860	3,400	No free product or sheen
	08/30/99		15.87	27.80	2.0	<0.5	3.9	2.0	140	2,800	No free product or sheen
	11/09/99		16.65	27.02	<0.5	<0.5	3.1	2.0	170	1,500	No free product or sheen
	03/22/00		13.96	29.71	2.8	<2.0	3.6	<2.0	<200	1,200	No free product or sheen
	06/12/00		15.23	28.44	1.3	<1.0	<1.0	<1.0	190	640	No free product or sheen
	09/06/00		16.30	27.37	1.8	<1.0	2.3	<1.0	340	870	No free product or sheen

TABLE 1

GROUND WATER MONITORING DATA

Beacon Station No. 721
44 Lewelling Boulevard
San Lorenzo, California

Monitoring Well	Date	Top of Riser Elevation (ft)	Depth to Water (ft)	Ground Water Elevation (ft)	Benzene (µg/L)	Toluene (µg/L)	Ethyl-benzene (µg/L)	Total Xylenes (µg/L)	TPH as gasoline (µg/L)	MTBE (µg/L)	Comments
MW-2	02/18/92	43.09	16.65	26.44	<0.5	<0.5	1.9	<0.5	1,600	NA	
	05/14/92		16.64	26.45	1.2	1	1.3	<0.5	740	NA	
	08/27/92		16.61	26.28	6.5	1.1	0.6	<0.5	1,400	NA	
	11/19/92		19.91	23.18	<0.5	<0.5	2.7	<0.5	360	NA	
	02/03/93		15.23	27.86	1.2	1.6	4.5	6.4	590	NA	
	06/23/93		15.55	27.54	<0.5	<0.5	0.52	0.5	160	NA	No free product or sheen
	09/22/93		17.22	25.87	<0.5	0.59	1.2	0.59	290	NA	No free product or sheen
	01/24/94		17.20	25.89	<0.5	<0.5	0.68	<0.5	330	NA	
	04/07/94		16.26	26.83	<0.5	<0.5	<0.5	4.4	490	NA	No free product or sheen
	06/07/94		16.46	26.63	<0.5	<0.5	1.5	<0.5	550	NA	No free product or sheen
	09/28/94		18.06	25.03	<0.5	<0.5	<0.5	<0.5	190	NA	No free product or sheen
	12/14/94		16.86	26.23	7.2	0.84	<0.5	<0.5	1,400	NA	No free product or sheen
	03/15/95		14.08	29.01	39	<0.5	0.53	<0.5	730	NA	No free product or sheen
	06/13/95		14.67	28.42	8.3	<0.5	<0.5	<0.5	750 ^a	NA	No free product or sheen
	09/28/95		16.07	27.02	<0.5	<0.5	<0.5	<0.5	670 ^a	NA	No free product or sheen
	12/28/95		16.46	26.63	9.5	<5.0	<5.0	5.2	3,100	4,600	No free product or sheen
	03/12/96		13.11	29.98	<1.3	<1.3	<1.3	<1.3	710	3,200	No free product or sheen
	06/11/96		14.14	28.95	1.6	<1.3	<1.3	<1.3	1,900 ^a	5,100	No free product or sheen
	10/02/96		15.71	27.38	<2.5	<2.5	<2.5	<2.5	2,800	7,900	No free product or sheen
	01/28/97		12.05	31.04	<0.5	<0.5	<0.5	<0.5	130	210	No free product or sheen
	05/20/97		14.65	28.44	120	16	<2.5	4.0	1,400	390	No free product or sheen
	08/18/97		16.00	27.09	<2.5	<2.5	<2.5	<2.5	<250	2,000	No free product or sheen
	09/29/97		NM	NC	NS	NS	NS	NS	NS	NS	Not measured
	11/05/97		16.75	26.34	<2.5	<2.5	<2.5	<2.5	<250	2,900/2,900 ^b	No free product or sheen
	03/31/98		11.54	31.55	<0.5	<0.5	<0.5	<0.5	<10,000	85,000	No free product or sheen
	05/26/98		12.78	30.31	NS	NS	NS	NS	NS	NS	No free product or sheen
	05/28/98		NM	NC	<500	<500	<500	<500	<50,000	97,000	No free product or sheen
	08/19/98		14.40	28.69	<0.5	<0.5	<0.5	<0.5	210	22,000	No free product or sheen
	11/17/98		15.18	27.91	<0.5	<0.5	<0.5	<0.5	<50	17,000	No free product or sheen

TABLE 1

GROUND WATER MONITORING DATA

Beacon Station No. 721
44 Lewelling Boulevard
San Lorenzo, California

Monitoring Well	Date	Top of Riser Elevation (ft)	Depth to Water (ft)	Ground Water Elevation (ft)	Benzene (µg/L)	Toluene (µg/L)	Ethyl-benzene (µg/L)	Total Xylenes (µg/L)	TPH as gasoline (µg/L)	MTBE (µg/L)	Comments
MW-2	02/18/99	43.09	14.07	29.02	<0.5	<0.5	<0.5	<0.5	<50	13,000	No free product or sheen
(Cont.)	06/24/99		14.70	28.39	<15	<0.5	<0.5	<0.5	180	39,000	No free product or sheen
	08/30/99		15.46	27.63	<25	<25	<25	<25	<2,500	18,000	No free product or sheen
	11/09/99		16.03	27.06	<5.0	<5.0	<5.0	<5.0	<500	14,000	No free product or sheen
	03/22/00		13.05	30.04	<5.0	<5.0	<5.0	<5.0	<500	54,000	No free product or sheen
	06/12/00		14.50	28.59	<20	<20	<20	<20	<2,000	53,000	No free product or sheen
	09/06/00		15.54	27.55	<50	<50	<50	<50	<5,000	46,000	No free product or sheen

TABLE 1

GROUND WATER MONITORING DATA

Beacon Station No. 721
44 Lewelling Boulevard
San Lorenzo, California

Monitoring Well	Date	Top of Riser Elevation (ft)	Depth to Water (ft)	Ground Water Elevation (ft)	Benzene (µg/L)	Toluene (µg/L)	Ethyl-benzene (µg/L)	Total Xylenes (µg/L)	TPH as gasoline (µg/L)	MTBE (µg/L)	Comments
MW-3	02/18/92	43.10	16.89	26.21	NS	NS	NS	NS	NS	NS	
	05/14/92		16.60	26.50	NS	NS	NS	NS	NS	NS	
	05/15/92		NM	NC	6,300	5,900	1,700	6,100	160,000	NA	
	08/27/92		18.96	24.14	NS	NS	NS	NS	NS	NS	
	08/28/92		NM	NC	2,500	40,000	6,700	44,000	1,300,000	NA	
	11/18/92		20.38	23.01	NS	NS	NS	NS	NS	NS	
	11/19/92		NM	NC	NS	NS	NS	NS	NS	NS	
	02/03/93		15.43	27.67	7,200	11,000	2,900	13,000	82,000	NA	
	06/23/93		15.67	27.43	3,200	5,300	2,500	9,100	61,000	NA	Product sheen
	09/22/93		17.20	25.90	12,000	14,000	3,900	18,000	94,000	NA	No free product or sheen
	01/24/94		17.35	25.75	14,000	17,000	4,200	14,000	110,000	NA	
	04/07/94		14.48	28.62	6,500	1,800	1,700	4,100	28,000	NA	No free product or sheen
	06/07/94		13.37	29.73	6,400	2,300	1,500	3,500	27,000	NA	Product sheen
	09/28/94		18.05	25.05	7,400	4,300	1,500	4,600	40,000	NA	No free product or sheen
	12/14/94		16.92	26.18	17,000	21,000	3,900	22,000	140,000	NA	Product sheen
	03/15/95		14.22	28.88	4,900	1,900	1,800	7,100	58,000	NA	Product sheen
	06/13/95		14.49	28.61	7,200	2,900	1,200	4,600	44,000	NA	Product sheen
	09/28/95		15.17	27.93	5,600	2,100	1,900	6,900	30,000	NA	No free product or sheen
	12/28/95		15.45	27.65	32	5.8	18	4,700	16,000	360	No free product or sheen
	01/30/96		NM	NC	850	800	190	1,700	8,700	430	Not measured
	03/12/96		11.35	31.75	48	64	5.3	630	2,400	97	No free product or sheen
	06/11/96		Dry	Dry	NS	NS	NS	NS	NS	NS	Dry
	10/02/96		Dry	Dry	NS	NS	NS	NS	NS	NS	Dry
	01/28/97		Dry	Dry	NS	NS	NS	NS	NS	NS	Dry
	05/20/97		Dry	Dry	NS	NS	NS	NS	NS	NS	Plugged at 14 feet
	07/10/97		NM	NC	<0.50	<0.50	<0.50	4.8	300	40	Not measured
	08/18/97		16.05	27.05	480	8.4	100	230	3,600	170	No free product or sheen
	09/29/97		NM	NC	740	8.6	160	240	3500	210	Not measured
	11/05/97		16.78	26.32	870	15	180	210	4,100	240/210 ^b	No free product or sheen

TABLE 1

GROUND WATER MONITORING DATA

Beacon Station No. 721
44 Lewelling Boulevard
San Lorenzo, California

Monitoring Well	Date	Top of Riser Elevation (ft)	Depth to Water (ft)	Ground Water Elevation (ft)	Benzene (µg/L)	Toluene (µg/L)	Ethyl-benzene (µg/L)	Total Xylenes (µg/L)	TPH as gasoline (µg/L)	MTBE (µg/L)	Comments
MW-3	03/31/98	43.10	11.55	31.55	1,800	600	410	1,400	12,000	510	No free product or sheen
(Cont.)	05/26/98		12.80	30.30	NS	NS	NS	NS	NS	NS	No free product or sheen
	05/28/98		NM	NC	1,500	400	280	870	6,500	480	No free product or sheen
	08/19/98		14.27	28.83	130	11	24	60	1,400	140	No free product or sheen
	11/17/98		15.11	27.99	48	3.5	9.9	14	510	120	No free product or sheen
	02/18/99		13.30	29.80	67	28	24	81	690	88	No free product or sheen
	06/24/99		14.44	28.66	27	21	8.6	32	540	61	No free product or sheen
	08/30/99		15.05	28.05	12	12	3.2	13	250	50	No free product or sheen
	11/09/99		15.72	27.38	9.8	5.3	3.4	10	230	48	No free product or sheen
	03/22/00		13.21	29.89	180	47	46	100	1,500	80	No free product or sheen
	06/12/00		14.31	28.79	100	6.2	20	25	920	76	No free product or sheen
	09/06/00		15.26	27.84	88	4.4	14	23	640	120	No free product or sheen

TABLE 1

GROUND WATER MONITORING DATA

Beacon Station No. 721
44 Lewelling Boulevard
San Lorenzo, California

Monitoring Well	Date	Top of Riser Elevation (ft)	Depth to Water (ft)	Ground Water Elevation (ft)	Benzene (µg/L)	Toluene (µg/L)	Ethyl-benzene (µg/L)	Total Xylenes (µg/L)	TPH as gasoline (µg/L)	MTBE (µg/L)	Comments
MW-4	02/18/92	44.66	18.51	26.15	<0.5	<0.5	12	21	5,100	NA	
	05/14/92		18.22	26.44	<0.5	5.6	1.8	2.2	4,600	NA	
	08/27/92		20.47	24.19	NS	NS	NS	NS	NS	NS	
	08/28/92		NM	NC	6.6	1.3	1.6	3.1	1,700	NA	
	11/19/92		21.58	23.08	<0.5	<0.5	<0.5	<0.5	400	NA	
	02/03/93		16.98	27.68	<0.5	<0.5	<0.5	<0.5	1,100	NA	
	06/23/93		17.23	27.43	<0.5	<0.5	<0.5	<0.5	120	NA	No free product or sheen
	09/22/93		18.83	25.83	<0.5	<0.5	<0.5	<0.5	110	NA	No free product or sheen
	01/24/94		18.86	25.80	<0.5	<0.5	<0.5	<0.5	260	NA	
	04/07/94		17.90	26.76	<0.5	<0.5	<0.5	<0.5	430	NA	No free product or sheen
	06/07/94		18.08	26.58	<0.5	<0.5	<0.5	<0.5	150	NA	No free product or sheen
	09/28/94		19.70	24.96	<0.5	<0.5	<0.5	<0.5	75	NA	No free product or sheen
	12/14/94		18.55	26.11	<0.5	<0.5	<0.5	<0.5	160	NA	No free product or sheen
	03/15/95		16.14	28.52	<0.5	<0.5	<0.5	<0.5	500	NA	No free product or sheen
	06/13/95		16.41	28.25	<0.5	<0.5	<0.5	<0.5	210 ^a	NA	No free product or sheen
	09/28/95		17.88	26.78	<0.5	<0.5	<0.5	<0.5	140 ^a	NA	No free product or sheen
	12/28/95		17.81	26.85	<0.5	<0.5	<0.5	<0.5	510 ^a	<5.0	No free product or sheen
	03/12/96		14.77	29.89	<0.5	<0.5	<0.5	<0.5	<50	<5.0	No free product or sheen
	06/11/96		15.88	28.78	<0.5	<0.5	<0.5	<0.5	50 ^a	<5.0	No free product or sheen
	10/02/96		17.40	27.26	<0.5	<0.5	<0.5	<0.5	<50	<5.0	No free product or sheen
	01/28/97		14.11	30.55	<0.5	<0.5	<0.5	<0.5	270 ^a	<5.0	No free product or sheen
	05/20/97		16.24	28.42	<0.5	<0.5	<0.5	<0.5	<50	<5.0	No free product or sheen
	08/18/97		17.59	27.07	<0.5	<0.5	<0.5	<0.5	<50	<5.0	No free product or sheen
	09/29/97		NM	NC	NS	NS	NS	NS	NS	NS	Not measured
	11/05/97		18.24	26.42	<0.5	<0.5	<0.5	<0.5	<50	<5.0/<0.5 ^b	No free product or sheen
	03/31/98		13.61	31.05	<0.5	<0.5	<0.5	<0.5	110	<5.0	No free product or sheen
	05/26/98		14.78	29.88	NS	NS	NS	NS	NS	NS	No free product or sheen
	05/28/98		NM	NC	<0.5	<0.5	<0.5	<0.5	94	<5.0	No free product or sheen
	08/19/98		16.15	28.51	<0.5 ^c	<0.5 ^c	<0.5 ^c	<0.5 ^c	120 ^c	46 ^c	No free product or sheen

TABLE 1

GROUND WATER MONITORING DATA

Beacon Station No. 721
44 Lewelling Boulevard
San Lorenzo, California

Monitoring Well	Date	Top of Riser Elevation (ft)	Depth to Water (ft)	Ground Water Elevation (ft)	Benzene (µg/L)	Toluene (µg/L)	Ethyl-benzene (µg/L)	Total Xylenes (µg/L)	TPH as gasoline (µg/L)	MTBE (µg/L)	Comments
MW-4	11/17/98	44.66	16.93	27.73	1.3	<0.5	<0.5	<0.5	<50	780	No free product or sheen
(Cont.)	02/18/99		15.30	29.36	8.2	<0.5	<0.5	<0.5	130	240	No free product or sheen
	06/24/99		16.35	28.31	<1.0	<0.5	<0.5	<0.5	<50	2,100	No free product or sheen
	08/30/99		17.12	27.54	NS	NS	NS	NS	NS	NS	Not sampled
	11/09/99		17.60	27.06	<0.5	<0.5	<0.5	<0.5	<50	2,500	No free product or sheen
	03/22/00		14.98	29.68	<0.5	<0.5	<0.5	<0.5	69	12,000	No free product or sheen
	06/12/00		16.26	28.40	<20	<20	<20	<20	<2,000	17,000	No free product or sheen
	09/06/00		17.11	27.55	NS	NS	NS	NS	NS	NS	Not sampled

TABLE 1

GROUND WATER MONITORING DATA

Beacon Station No. 721
44 Lewelling Boulevard
San Lorenzo, California

Monitoring Well	Date	Top of Riser Elevation (ft)	Depth to Water (ft)	Ground Water Elevation (ft)	Benzene (µg/L)	Toluene (µg/L)	Ethyl-benzene (µg/L)	Total Xylenes (µg/L)	TPH as gasoline (µg/L)	MTBE (µg/L)	Comments
MW-5	02/18/92	43.79	17.37	26.42	<0.5	<0.5	<0.5	<0.5	<50	NA	
	05/14/92		17.29	26.50	<0.5	<0.05	<0.5	<0.5	<50	NA	
	08/27/92		22.18	21.61	<0.5	<0.5	<0.5	<0.5	<50	NA	
	11/19/92		20.68	23.11	<0.5	<0.5	<0.5	<0.5	<50	NA	
	02/03/93		15.91	27.88	3.0	2.7	8.0	9.9	55	NA	
	06/23/93		16.24	27.55	<0.5	<0.5	<0.5	<0.5	<50	NA	No free product or sheen
	09/22/93		17.93	25.86	0.66	1.1	<0.5	0.6	<50	NA	No free product or sheen
	01/24/94		17.82	25.97	<0.5	<0.5	<0.5	<0.5	<50	NA	
	04/07/94		16.91	26.88	<0.5	<0.5	<0.5	<0.5	<50	NA	No free product or sheen
	06/07/94		17.10	26.69	<0.5	<0.5	<0.5	<0.5	<50	NA	No free product or sheen
	09/28/94		18.73	25.06	<0.5	<0.5	<0.5	<0.5	<50	NA	No free product or sheen
	12/14/94		17.53	26.26	<0.5	<0.5	<0.5	<0.5	<50	NA	No free product or sheen
	03/15/95		14.96	28.83	<0.5	<0.5	<0.5	<0.5	<50	NA	No free product or sheen
	06/13/95		15.30	28.49	<0.5	0.52	<0.5	<0.5	<50	NA	No free product or sheen
	09/28/95		16.74	27.05	<0.5	<0.5	<0.5	<0.5	<50	NA	No free product or sheen
	12/28/95		15.10	28.69	<0.5	<0.5	<0.5	<0.5	120	<5.0	No free product or sheen
	03/12/96		13.67	30.12	<0.5	<0.5	<0.5	<0.5	<50	9	No free product or sheen
	06/11/96		14.88	28.91	<0.5	<0.5	<0.5	<0.5	<50	<5.0	No free product or sheen
	10/02/96		16.42	27.37	<0.5	<0.5	<0.5	<0.5	<50	<5.0	No free product or sheen
	01/28/97		12.83	30.96	<0.5	<0.5	<0.5	<0.5	<50	<5.0	No free product or sheen
	05/20/97		15.33	28.46	<0.5	<0.5	<0.5	<0.5	<50	<5.0	No free product or sheen
	08/18/97		16.69	27.10	<0.5	<0.5	<0.5	<0.5	<50	<5.0	No free product or sheen
	09/29/97		NM	NC	NS	NS	NS	NS	NS	NS	Not measured
	11/05/97		17.37	26.42	<0.5	<0.5	<0.5	<0.5	<50	<5.0/<0.5 ^b	No free product or sheen
	03/31/98		12.40	31.39	<0.5	<0.5	<0.5	<0.5	<50	<5.0	No free product or sheen
	05/26/98		13.62	30.17	NS	NS	NS	NS	NS	NS	No free product or sheen
	05/28/98		NM	NC	<0.5	<0.5	<0.5	<0.5	<50	<5.0	No free product or sheen
	08/19/98		15.19	28.60	<0.5	<0.5	<0.5	<0.5	<50	7	No free product or sheen
	11/17/98		15.89	27.90	<0.5	<0.5	<0.5	<0.5	<50	6	No free product or sheen

TABLE 1

GROUND WATER MONITORING DATA

Beacon Station No. 721
44 Lewelling Boulevard
San Lorenzo, California

Monitoring Well	Date	Top of Riser Elevation (ft)	Depth to Water (ft)	Ground Water Elevation (ft)	Benzene (µg/L)	Toluene (µg/L)	Ethyl-benzene (µg/L)	Total Xylenes (µg/L)	TPH as gasoline (µg/L)	MTBE (µg/L)	Comments
MW-5	02/18/99	43.79	14.23	29.56	<0.5	<0.5	<0.5	<0.5	<50	<5.0	No free product or sheen
(Cont.)	06/24/99		15.29	28.50	NS	NS	NS	NS	NS	NS	Not sampled
	08/30/99		16.07	27.72	NS	NS	NS	NS	NS	NS	Not sampled
	11/09/99		16.61	27.18	NS	NS	NS	NS	NS	NS	Not sampled
	03/22/00		13.81	29.98	<0.5	<0.5	<0.5	<0.5	<50	<5.0	No free product or sheen
	06/12/00		15.08	28.71	NS	NS	NS	NS	NS	NS	Not sampled
	09/06/00		16.02	27.77	NS	NS	NS	NS	NS	NS	Not sampled

TABLE 1

GROUND WATER MONITORING DATA

Beacon Station No. 721
44 Lewelling Boulevard
San Lorenzo, California

Monitoring Well	Date	Top of Riser Elevation (ft)	Depth to Water (ft)	Ground Water Elevation (ft)	Benzene (µg/L)	Toluene (µg/L)	Ethyl-benzene (µg/L)	Total Xylenes (µg/L)	TPH as gasoline (µg/L)	MTBE (µg/L)	Comments
MW-6	02/18/92	42.47	15.87	26.60	4.8	<0.5	<0.5	<0.5	370	NA	
	05/14/92		16.04	26.43	<0.5	<0.5	<0.5	<0.5	120	NA	
	08/27/92		18.17	24.30	1.2	<0.5	<0.5	<0.5	<50	NA	
	11/19/92		19.30	23.17	1.3	<0.5	1	1.1	66	NA	
	02/03/93		14.60	27.87	1.9	2.6	23	12	100	NA	
	06/23/93		15.00	27.47	<0.5	<0.5	<0.5	<0.5	<50	NA	No free product or sheen
	09/22/93		16.66	25.81	2.2	3.8	0.53	2.7	81	NA	No free product or sheen
	01/24/94		16.52	25.95	<0.5	<0.5	<0.5	<0.5	98	NA	
	04/07/94		15.70	26.77	0.71	<0.5	<0.5	<0.5	150	NA	No free product or sheen
	06/07/94		15.88	26.59	<0.5	<0.5	<0.5	<0.5	180	NA	No free product or sheen
	09/28/94		17.51	24.96	<0.5	<0.5	<0.5	<0.5	100	NA	No free product or sheen
	12/14/94		16.27	26.20	<0.5	<0.5	<0.5	<0.5	140	NA	No free product or sheen
	03/15/95		13.52	28.95	<0.5	<0.5	<0.5	<0.5	110	NA	No free product or sheen
	06/13/95		13.96	28.51	<0.5	0.87	<0.5	<0.5	150 ^a	NA	No free product or sheen
	09/28/95		15.61	26.86	0.78	<0.5	<0.5	<0.5	<50	NA	No free product or sheen
	12/28/95		15.54	26.93	<0.5	<0.5	<0.5	6.3	410	70	No free product or sheen
	01/30/96		NM	NC	1.0	<0.5	<0.5	11	81	46	Not measured
	03/12/96		11.88	30.59	<0.5	<0.5	<0.5	<0.5	<50	7	No free product or sheen
	06/11/96		13.52	28.95	<0.5	<0.5	<0.5	<0.5	<50	<5.0	No free product or sheen
	10/02/96		15.10	27.37	<0.5	<0.5	<0.5	<0.5	<50	<5.0	No free product or sheen
	01/28/97		11.18	31.29	<0.5	<0.5	<0.5	<0.5	<50	<5.0	No free product or sheen
	05/20/97		14.00	28.47	<0.5	<0.5	<0.5	<0.5	<50	<5.0	No free product or sheen
	08/18/97		15.54	26.93	<0.5	<0.5	<0.5	<0.5	<50	<5.0	No free product or sheen
	09/29/97		NM	NC	NS	NS	NS	NS	NS	NS	Not measured
	11/05/97		16.25	26.22	<0.5	<0.5	<0.5	<0.5	<50	<5.0/2.8 ^b	No free product or sheen
	03/31/98		10.60	31.87	<0.5	<0.5	<0.5	<0.5	<50	<5.0	No free product or sheen
	05/26/98		12.01	30.46	NS	NS	NS	NS	NS	NS	No free product or sheen
	05/28/98		NM	NC	<0.5	<0.5	<0.5	<0.5	<50	<5.0	No free product or sheen
	08/19/98		13.60	28.87	<0.5	<0.5	<0.5	<0.5	<50	<5.0	No free product or sheen

TABLE 1

GROUND WATER MONITORING DATA

Beacon Station No. 721
 44 Lewelling Boulevard
 San Lorenzo, California

Monitoring Well	Date	Top of Riser Elevation (ft)	Depth to Water (ft)	Ground Water Elevation (ft)	Benzene (µg/L)	Toluene (µg/L)	Ethyl-benzene (µg/L)	Total Xylenes (µg/L)	TPH as gasoline (µg/L)	MTBE (µg/L)	Comments
MW-6	11/17/98	42.47	14.53	27.94	<0.5	<0.5	<0.5	<0.5	<50	<5.0	No free product or sheen
(Cont.)	02/18/99		12.39	30.08	<0.5	<0.5	<0.5	<0.5	<50	<5.0	No free product or sheen
	06/24/99		13.89	28.58	NS	NS	NS	NS	NS	NS	Not sampled
	08/30/99		14.75	27.72	NS	NS	NS	NS	NS	NS	Not sampled
	11/09/99		15.18	27.29	NS	NS	NS	NS	NS	NS	Not sampled
	03/22/00		12.30	30.17	<0.5	<0.5	<0.5	<0.5	<50	<5.0	No free product or sheen
	06/12/00		13.69	28.78	NS	NS	NS	NS	NS	NS	Not sampled
	09/06/00		14.78	27.69	NS	NS	NS	NS	NS	NS	Not sampled

TABLE 1

GROUND WATER MONITORING DATA

Beacon Station No. 721
44 Lewelling Boulevard
San Lorenzo, California

Monitoring Well	Date	Top of Riser Elevation (ft)	Depth to Water (ft)	Ground Water Elevation (ft)	Benzene (µg/L)	Toluene (µg/L)	Ethyl-benzene (µg/L)	Total Xylenes (µg/L)	TPH as gasoline (µg/L)	MTBE (µg/L)	Comments
MW-7	02/18/92	41.54	15.51	26.03	16	<0.5	10	16	670	NA	
	05/14/92		15.41	26.13	44	<0.5	38	88	1,500	NA	
	08/27/92		17.45	24.09	400	5.8	290	1,400	23,000	NA	
	11/19/92		18.54	23.00	29	<0.5	10	53	330	NA	
	02/03/93		14.10	27.44	200	<0.5	110	480	2,000	NA	
	06/23/93		14.33	27.21	20	<0.5	16	16	280	NA	No free product or sheen
	09/22/93		15.92	25.62	71	2.2	33	210	860	NA	No free product or sheen
	01/24/94		16.07	25.47	61	<1.3	10	160	900	NA	
	04/07/94		15.10	26.44	53	<0.5	7.1	49	630	NA	
	06/07/94		15.16	26.38	55	<0.5	14	24	730	NA	No free product or sheen
	09/28/94		16.82	24.72	21	<0.5	2.3	3.1	300	NA	No free product or sheen
	12/14/94		15.75	25.79	19	<0.5	3.3	32	430	NA	No free product or sheen
	03/15/95		14.00	27.54	0.88	<0.5	<0.5	<0.5	70	NA	No free product or sheen
	06/13/95		13.44	28.10	7.3	0.79	7.6	8.9	190	NA	No free product or sheen
	09/28/95		14.84	26.70	1.5	<0.5	1.2	0.84	60	NA	No free product or sheen
	12/28/95		14.55	26.99	<0.5	<0.5	0.91	0.69	60	10	No free product or sheen
	03/12/96		11.88	29.66	<0.5	<0.5	<0.5	<0.5	<50	11	No free product or sheen
	06/11/96		13.52	28.58	<0.5	<0.5	<0.5	<0.5	79	16	No free product or sheen
	10/02/96		14.50	27.04	<0.5	<0.5	<0.5	<0.5	<50	26	No free product or sheen
	01/28/97		11.08	30.46	<0.5	<0.5	<0.5	<0.5	<50	13	No free product or sheen
	05/20/97		13.46	28.08	<0.5	0.85	<0.5	<0.5	78	40	No free product or sheen
	08/18/97		14.95	26.59	<0.5	<0.5	<0.5	<0.5	<50	18	No free product or sheen
	09/29/97		NM	NC	NS	NS	NS	NS	NS	NS	Not measured
	11/05/97		15.43	26.11	<0.5	<0.5	<0.5	<0.5	<50	8.9/8.0 ^b	No free product or sheen
	03/31/98		10.25	31.29	<0.5	<0.5	<0.5	1.3	<5.0	6	No free product or sheen
	05/26/98		11.45	30.09	NS	NS	NS	NS	NS	NS	No free product or sheen
	05/28/98		NM	NC	<0.5	<0.5	<0.5	<0.5	<50	10	No free product or sheen
	08/19/98		13.08	28.46	<0.5	<0.5	<0.5	<0.5	<50	27	No free product or sheen
	11/17/98		13.93	27.61	<0.5	<0.5	<0.5	<0.5	<50	30	No free product or sheen

TABLE 1

GROUND WATER MONITORING DATA

Beacon Station No. 721
 44 Lewelling Boulevard
 San Lorenzo, California

Monitoring Well	Date	Top of Riser Elevation (ft)	Depth to Water (ft)	Ground Water Elevation (ft)	Benzene (µg/L)	Toluene (µg/L)	Ethyl-benzene (µg/L)	Total Xylenes (µg/L)	TPH as gasoline (µg/L)	MTBE (µg/L)	Comments
MW-7	02/18/99	41.54	12.16	29.38	<0.5	<0.5	<0.5	<0.5	51	22	No free product or sheen
(Cont.)	06/24/99		13.35	28.19	NS	NS	NS	NS	NS	NS	Not sampled
	08/30/99		14.23	27.31	NS	NS	NS	NS	NS	NS	Not sampled
	11/09/99		14.60	26.94	<0.5	<0.5	<0.5	<0.5	<50	16	No free product or sheen
	03/22/00		11.91	29.63	<0.5	<0.5	<0.5	<0.5	<50	18	No free product or sheen
	06/12/00		13.28	28.26	NS	NS	NS	NS	NS	NS	Not sampled
	09/06/00		14.12	27.42	NS	NS	NS	NS	NS	NS	Not sampled

TABLE 1

GROUND WATER MONITORING DATA

Beacon Station No. 721
44 Lewelling Boulevard
San Lorenzo, California

Monitoring Well	Date	Top of Riser Elevation (ft)	Depth to Water (ft)	Ground Water Elevation (ft)	Benzene (µg/L)	Toluene (µg/L)	Ethyl-benzene (µg/L)	Total Xylenes (µg/L)	TPH as gasoline (µg/L)	MTBE (µg/L)	Comments
MW-8	02/18/92	42.26	16.57	25.69	<0.5	<0.5	9.5	<0.5	1,200	NA	
	05/14/92		16.24	26.02	<0.5	<0.5	<0.5	<0.5	130	NA	
	08/27/92		18.28	23.98	<0.5	<0.5	<0.5	<0.5	140	NA	
	11/19/92		19.32	22.94	<0.5	<0.5	2.0	<0.5	320	NA	
	02/03/93		14.87	27.39	<0.5	<0.5	<0.5	<0.5	<50	NA	
	06/23/93		15.18	27.08	<0.5	<0.5	<0.5	<0.5	<50	NA	No free product or sheen
	09/22/93		18.79	23.47	<0.5	0.67	<0.5	<0.5	<50	NA	No free product or sheen
	01/24/94		17.06	25.20	<0.5	<0.5	<0.5	<0.5	290	NA	
	04/07/94		15.95	26.31	<0.5	<0.5	<0.5	<0.5	<50	NA	No free product or sheen
	06/07/94		15.10	27.16	<0.5	<0.5	<0.5	<0.5	<50	NA	No free product or sheen
	09/28/94		17.63	24.63	<0.5	<0.5	<0.5	<0.5	<50	NA	No free product or sheen
	12/14/94		16.66	25.60	<0.5	<0.5	<0.5	<0.5	<50	NA	No free product or sheen
	03/15/95		14.30	27.96	<0.5	<0.5	<0.5	<0.5	<50	NA	No free product or sheen
	06/13/95		14.37	27.89	<0.5	<0.5	<0.5	<0.5	<50	NA	No free product or sheen
	09/28/95		15.62	26.64	NS	NS	NS	NS	NS	NA	No free product or sheen
	12/28/95		15.62	26.64	<0.5	<0.5	<0.5	<0.5	<50	<5.0	No free product or sheen
	03/12/96		12.75	29.51	<0.5	<0.5	<0.5	<0.5	<50	<5.0	No free product or sheen
	06/11/96		13.94	28.32	<0.5	<0.5	<0.5	<0.5	<50	<5.0	No free product or sheen
	10/02/96		15.41	26.85	<0.5	<0.5	<0.5	<0.5	<50	<5.0	No free product or sheen
	01/28/97		12.30	29.96	<0.5	<0.5	<0.5	<0.5	<50	<5.0	No free product or sheen
	05/20/97		14.42	27.84	<0.5	<0.5	<0.5	<0.5	<50	<5.0	No free product or sheen
	08/18/97		16.16	26.10	<0.5	<0.5	<0.5	<0.5	<50	<5.0	No free product or sheen
	09/29/97		NM	NC	NS	NS	NS	NS	NS	NS	Not measured
	11/05/97		16.25	26.01	<0.5	<0.5	<0.5	<0.5	<50	<5.0/<0.5 ^b	No free product or sheen
	03/31/98		11.49	30.77	<0.5	<0.5	<0.5	<0.5	<50	<5.0	No free product or sheen
	05/26/98		12.60	29.66	NS	NS	NS	NS	NS	NS	No free product or sheen
	05/28/98		NM	NC	<0.5	<0.5	<0.5	<0.5	<50	<5.0	No free product or sheen
	08/19/98		14.15	28.11	<0.5	<0.5	<0.5	<0.5	<50	<5.0	No free Product or sheen
	11/17/98		14.98	27.28	<0.5	<0.5	<0.5	<0.5	<50	<5.0	No free product or sheen

TABLE 1

GROUND WATER MONITORING DATA

Beacon Station No. 721
44 Lewelling Boulevard
San Lorenzo, California

Monitoring Well	Date	Top of Riser Elevation (ft)	Depth to Water (ft)	Ground Water Elevation (ft)	Benzene (µg/L)	Toluene (µg/L)	Ethyl-benzene (µg/L)	Total Xylenes (µg/L)	TPH as gasoline (µg/L)	MTBE (µg/L)	Comments
MW-8	02/18/99	42.26	13.41	28.85	<0.5	<0.5	<0.5	<0.5	<50	<5.0	No free product or sheen
(Cont.)	06/24/99		14.35	27.91	NS	NS	NS	NS	NS	NS	Not sampled
	08/30/99		15.16	27.10	NS	NS	NS	NS	NS	NS	Not sampled
	11/09/99		15.61	26.65	NS	NS	NS	NS	NS	NS	Not sampled
	03/22/00		13.17	29.09	<0.5	<0.5	<0.5	<0.5	<50	<5.0	No free product or sheen
	06/12/00		14.19	28.07	NS	NS	NS	NS	NS	NS	Not sampled
	09/06/00		15.10	27.16	NS	NS	NS	NS	NS	NS	Not sampled

TABLE 1

GROUND WATER MONITORING DATA

Beacon Station No. 721
44 Lewelling Boulevard
San Lorenzo, California

Monitoring Well	Date	Top of Riser Elevation (ft)	Depth to Water (ft)	Ground Water Elevation (ft)	Benzene (µg/L)	Toluene (µg/L)	Ethyl-benzene (µg/L)	Total Xylenes (µg/L)	TPH as gasoline (µg/L)	MTBE (µg/L)	Comments
MW-9	02/18/92	44.94	18.87	26.07	<0.5	<0.5	<0.5	<0.5	<50	NA	
	05/14/92		18.55	26.39	<0.5	<0.5	<0.5	<0.5	<50	NA	
	08/27/92		20.80	24.14	<0.5	<0.5	<0.5	<0.5	<50	NA	
	11/19/92		21.90	23.04	<0.5	<0.5	<0.5	1.3	<50	NA	
	02/03/93		17.25	27.69	<0.5	<0.5	<0.5	<0.5	<50	NA	
	06/23/93		17.61	27.33	<0.5	<0.5	<0.5	<0.5	<50	NA	No free product or sheen
	09/22/93		19.18	25.76	<0.5	<0.5	<0.5	<0.5	<50	NA	No free product or sheen
	01/24/94		19.17	25.77	<0.5	<0.5	<0.5	<0.5	<50	NA	
	04/07/94		18.23	26.71	<0.5	<0.5	<0.5	<0.5	<50	NA	No free product or sheen
	06/07/94		18.40	26.54	<0.5	<0.5	<0.5	<0.5	<50	NA	No free product or sheen
	09/28/94		20.01	24.93	<0.5	<0.5	<0.5	<0.5	<50	NA	No free product or sheen
	12/14/94		18.88	26.06	<0.5	<0.5	<0.5	<0.5	<50	NA	No free product or sheen
	03/15/95		16.24	28.70	<0.5	<0.5	<0.5	<0.5	<50	NA	No free product or sheen
	06/13/95		16.75	28.19	<0.5	<0.5	<0.5	<0.5	<50	NA	No free product or sheen
	09/28/95		18.04	26.90	<0.5	<0.5	<0.5	<0.5	<50	NA	No free product or sheen
	12/28/95		17.87	27.07	<0.5	<0.5	<0.5	<0.5	<50	<5.0	No free product or sheen
	03/12/96		NM	NC	NS	NS	NS	NS	NS	NS	Not measured
	06/11/96		16.26	28.68	<0.5	<0.5	<0.5	<0.5	<50	<5.0	No free product or sheen
	10/02/96		17.74	27.20	<0.5	<0.5	<0.5	<0.5	<50	<5.0	No free product or sheen
	01/28/97		14.51	30.43	<0.5	<0.5	<0.5	<0.5	<50	<5.0	No free product or sheen
	05/20/97		16.73	28.21	<0.5	<0.5	<0.5	<0.5	<50	<5.0	No free product or sheen
	08/18/97		NM	NC	NS	NS	NS	NS	NS	NS	Not measured
	09/29/97		NM	NC	NS	NS	NS	NS	NS	NS	Not measured
	11/05/97		18.61	26.33	<0.5	<0.5	<0.5	<0.5	<50	<5.0/<0.5 ^b	No free product or sheen
	03/31/98		NM	NC	NS	NS	NS	NS	NS	NS	Not measured
	05/26/98		15.28	29.66	NS	NS	NS	NS	NS	NS	No free product or sheen
	05/28/98		NM	NC	NS	NS	NS	NS	NS	NS	Not measured
	08/19/98		16.55	28.39	<0.5	<0.5	<0.5	<0.5	<50	<5.0	No free product or sheen
	11/17/98		17.32	27.62	<0.5	<0.5	<0.5	<0.5	<50	<5.0	No free product or sheen

TABLE 1

GROUND WATER MONITORING DATA

Beacon Station No. 721
44 Lewelling Boulevard
San Lorenzo, California

Monitoring Well	Date	Top of Riser Elevation (ft)	Depth to Water (ft)	Ground Water Elevation (ft)	Benzene (µg/L)	Toluene (µg/L)	Ethyl-benzene (µg/L)	Total Xylenes (µg/L)	TPH as gasoline (µg/L)	MTBE (µg/L)	Comments
MW-9	02/18/99	44.94	15.74	29.20	<0.5	<0.5	<0.5	<0.5	<50	<5.0	No free product or sheen
(Cont.)	06/24/99		16.73	28.21	NS	NS	NS	NS	NS	NS	Not sampled
	08/30/99		17.48	27.46	NS	NS	NS	NS	NS	NS	Not sampled
	11/09/99		17.98	26.96	NS	NS	NS	NS	NS	NS	Not sampled
	03/22/00		15.46	29.48	<0.5	<0.5	<0.5	<0.5	<50	<5.0	No free product or sheen
	06/12/00		16.70	28.24	NS	NS	NS	NS	NS	NS	Not sampled
	09/06/00		17.80	27.14	NS	NS	NS	NS	NS	NS	Not sampled

TABLE 1

GROUND WATER MONITORING DATA

Beacon Station No. 721
44 Lewelling Boulevard
San Lorenzo, California

Monitoring Well	Date	Top of Riser Elevation (ft)	Depth to Water (ft)	Ground Water Elevation (ft)	Benzene (µg/L)	Toluene (µg/L)	Ethyl-benzene (µg/L)	Total Xylenes (µg/L)	TPH as gasoline (µg/L)	MTBE (µg/L)	Comments
MW-10	02/18/92	42.34	16.63	25.71	110	57	440	53	18,000	NA	
	05/14/92		15.25	27.09	NS	NS	NS	NS	NS	NS	
	05/15/92		NM	NC	24	9.8	97	<0.5	8,500	NA	
	08/27/92		18.35	23.99	NS	NS	NS	NS	NS	NS	
	08/29/92		NM	NC	20	2.8	40	3.5	9,600	NA	
	11/19/92		19.43	22.91	36	21	330	31	5,700	NA	
	02/03/93		15.01	27.33	15	4.6	36	9.6	2,200	NA	
	06/23/93		15.30	27.04	21	24	540	45	8,100	NA	No free product or sheen
	09/22/93		16.90	25.44	22	17	350	16	6,200	NA	No free product or sheen
	01/24/94		NM	NC	NS	NS	NS	NS	NS	NA	Not measured
	04/07/94		15.97	26.37	6.4	2.9	150	4.7	4,000	NA	No free product or sheen
	06/07/94		16.04	26.30	5.6	<2.5	150	5.7	6,700	NA	No free product or sheen
	09/28/94		17.69	24.65	2.2	2.6	110	44	5,700	NA	No free product or sheen
	12/14/94		16.65	25.69	<1.3	<1.3	77	27	3,500	NA	No free product or sheen
	03/15/95		14.08	28.26	<5.0	6.7	150	23	7,200	NA	No free product or sheen
	06/13/95		14.49	27.85	9	48	610	130	8,400	NA	No free product or sheen
	09/28/95		15.81	26.53	22	17	360	24	6,300	NA	No free product or sheen
	12/28/95		15.46	26.88	4.4	5.6	340	11	5,000	37	No free product or sheen
	03/12/96		12.62	29.72	1.4	5.9	41	73	4,500	120	No free product or sheen
	06/11/96		14.40	27.94	<5.0	25	350	81	7,500	<25	No free product or sheen
	10/02/96		15.47	26.87	18	<2.5	<2.5	<2.5	2,600	<25	No free product or sheen
	01/28/97		15.69	26.65	5.9	<2.5	29	19	2,800	<25	No free product or sheen
	05/20/97		14.48	27.86	<20	34	290	74	6,000	<100	No free product or sheen
	08/18/97		15.91	26.43	<20	7.7	94	15	5,900	<50	No free product or sheen
	09/29/97		NM	NC	NS	NS	NS	NS	NS	NS	Not measured
	11/05/97		16.32	26.02	1.1	0.86	47	1.6	5,400	<50/2.3 ^b	No free product or sheen
	03/31/98		12.25	30.09	56	180	1,400	3,700	20,000	250	No free product or sheen
	05/26/98		12.97	29.37	NS	NS	NS	NS	NS	NS	No free product or sheen
	05/28/98		NM	NC	76	200	1,600	3,900	16,000	190	No free product or sheen

TABLE 1

GROUND WATER MONITORING DATA

Beacon Station No. 721
44 Lewelling Boulevard
San Lorenzo, California

Monitoring Well	Date	Top of Riser Elevation (ft)	Depth to Water (ft)	Ground Water Elevation (ft)	Benzene (µg/L)	Toluene (µg/L)	Ethyl-benzene (µg/L)	Total Xylenes (µg/L)	TPH as gasoline (µg/L)	MTBE (µg/L)	Comments
MW-10	08/19/98	42.34	14.27	28.07	95	160	1,300	1,700	14,000	<100	No free product or sheen
(Cont.)	11/17/98		15.08	27.26	82	64	590	150	7500	290	No free product or sheen
	02/18/99		13.61	28.73	41	16	270	79	4,700	<100	No free product or sheen
	06/24/99		14.50	27.84	27	74	280	160	9,400	300	No free product or sheen
	08/30/99		15.26	27.08	15	33	160	33	8,500	290	No free product or sheen
	11/09/99		15.72	26.62	3.9	11	60	14	7,600	120	No free product or sheen
	03/22/00		13.40	28.94	3.5	33	360	320	5,800	160	No free product or sheen
	06/12/00		14.42	27.92	4.3	47	370	210	7,200	270	No free product or sheen
	09/06/00		15.36	26.98	<2.0	12	24	27	4,800	300	No free product or sheen

TABLE 1

GROUND WATER MONITORING DATA

Beacon Station No. 721
44 Lewelling Boulevard
San Lorenzo, California

Monitoring Well	Date	Top of Riser Elevation (ft)	Depth to Water (ft)	Ground Water Elevation (ft)	Benzene (µg/L)	Toluene (µg/L)	Ethyl-benzene (µg/L)	Total Xylenes (µg/L)	TPH as gasoline (µg/L)	MTBE (µg/L)	Comments
MW-11	02/18/92	45.00	17.00	28.00	<0.5	<0.5	<0.5	<0.5	2,400	NA	
	05/14/92		19.02	25.98	<0.5	1.9	1.3	0.7	1,600	NA	
	08/27/92		21.13	23.87	15	2	0.6	1.2	2,100	NA	
	11/19/92		17.91	27.09	<0.5	<0.5	<0.5	<0.5	490	NA	
	02/03/92		17.91	27.09	<0.5	<0.5	0.55	<0.5	500	NA	
	06/23/93		18.14	26.86	<0.5	<0.5	<0.5	<0.5	350	NA	No free product or sheen
	09/22/93		19.63	25.37	<0.5	0.65	<0.5	0.71	200	NA	No free product or sheen
	01/24/94		19.79	25.21	<0.5	<0.5	<0.5	<0.5	450	NA	
	04/07/94		18.78	26.22	<0.5	<0.5	<0.5	<0.5	500	NA	No free product or sheen
	06/07/94		18.88	26.12	<0.5	<0.5	<0.5	0.64	560	NA	No free product or sheen
	09/28/94		20.45	24.55	<0.5	<0.5	<0.5	<0.5	600	NA	No free product or sheen
	12/14/94		19.45	25.55	<0.5	<0.5	<0.5	<0.5	340	NA	No free product or sheen
	03/15/95		17.32	27.68	<0.5	<0.5	<0.5	<0.5	340	NA	No free product or sheen
	06/13/95		17.43	27.57	<0.5	<0.5	<0.5	<0.5	210 ^a	NA	No free product or sheen
	09/28/95		18.67	26.33	4.1	0.5	<0.5	<0.5	93	NA	No free product or sheen
	12/28/95		18.31	26.69	<0.5	<0.5	<0.5	<0.5	380 ^a	<5.0	No free product or sheen
	03/12/96		15.89	29.11	<0.5	<0.5	<0.5	<0.5	110	<5.0	No free product or sheen
	06/11/96		16.98	28.02	<0.5	<0.5	<0.5	<0.5	400 ^a	<5.0	No free product or sheen
	10/02/96		18.20	26.80	<0.5	<0.5	<0.5	<0.5	<50	<5.0	No free product or sheen
	01/28/97		12.53	32.47	<0.5	<0.5	<0.5	<0.5	110 ^a	<5.0	No free product or sheen
	05/20/97		17.36	27.64	<0.5	<0.5	<0.5	<0.5	330	<5.0	No free product or sheen
	08/18/97		18.84	26.16	<0.5	<0.5	<0.5	<0.5	<50	<5.0	No free product or sheen
	09/29/97		NM	NC	NS	NS	NS	NS	NS	NS	Not measured
	11/05/97		NM	NC	NS	NS	NS	NS	NS	NS	Not measured
	03/31/98		15.39	29.61	<0.5	2.8	12	16	460	<5.0	No free product or sheen
	05/26/98		16.25	28.75	NS	NS	NS	NS	NS	NS	No free product or sheen
	05/28/98		NM	NC	14	24	88	75	1,100	24	No free product or sheen
	08/19/98		17.30	27.70	16	9.6	69	17	1,200	6	No free product or sheen
	11/17/98		18.05	26.95	15	4.4	14	<0.5	580	21	No free product or sheen

TABLE 1

GROUND WATER MONITORING DATA

Beacon Station No. 721
44 Lewelling Boulevard
San Lorenzo, California

Monitoring Well	Date	Top of Riser Elevation (ft)	Depth to Water (ft)	Ground Water Elevation (ft)	Benzene (µg/L)	Toluene (µg/L)	Ethyl-benzene (µg/L)	Total Xylenes (µg/L)	TPH as gasoline (µg/L)	MTBE (µg/L)	Comments
MW-11	02/18/99	45.00	16.87	28.13	8.0	<0.5	1.4	<0.5	390	44	No free product or sheen
(Cont.)	06/24/99		17.50	27.50	4.6	<0.5	0.66	<0.5	610	59	No free product or sheen
	08/30/99		18.19	26.81	NS	NS	NS	NS	NS	NS	Not sampled
	11/09/99		18.64	26.36	0.87	<0.5	<0.5	<0.5	250	66	No free product or sheen
	03/22/00		16.52	28.48	<0.5	<0.5	<0.5	<0.5	330	100	No free product or sheen
	06/12/00		17.44	27.56	<0.5	<0.5	<0.5	<0.5	52	49	No free product or sheen
	09/06/00		18.36	26.64	NS	NS	NS	NS	NS	NS	Not sampled

TABLE 1

GROUND WATER MONITORING DATA

Beacon Station No. 721
44 Lewelling Boulevard
San Lorenzo, California

Monitoring Well	Date	Top of Riser Elevation (ft)	Depth to Water (ft)	Ground Water Elevation (ft)	Benzene (µg/L)	Toluene (µg/L)	Ethyl-benzene (µg/L)	Total Xylenes (µg/L)	TPH as gasoline (µg/L)	MTBE (µg/L)	Comments
RW-1	05/14/92	43.17	16.88	26.29	NS	NS	NS	NS	NS	NS	
	05/15/92		NM	NC	270	62	29	140	790	NA	
	08/27/92		19.05	24.12	1,300	200	68	810	24,000	NA	
	11/19/92		21.11	22.07	NS	NS	NS	NS	NS	NS	
	02/03/92		15.48	27.69	71	35	22	110	620	NA	
	06/23/93		28.25	14.92	30	33	9.8	35	220	NA	No free product or sheen
	09/22/93		17.83	25.34	800	400	170	910	4,100	NA	No free product or sheen
	01/24/94		24.00	19.17	33	6	6.9	23	190	NA	
	04/07/94		16.05	27.12	110	57	32	260	1,500	NA	No free product or sheen
	06/07/94		16.00	27.17	130	51	45	180	1,700	NA	No free product or sheen
	09/28/94		18.35	24.82	54	9.2	12	29	350	NA	No free product or sheen
	12/14/94		19.50	23.67	6.8	2.1	1.2	3.4	79	NA	No free product or sheen
	03/15/95		17.00	26.17	NS	NS	NS	NS	NS	NS	No free product or sheen
	04/10/95		NM	NC	54	11	11	69	410	NA	Not measured
	06/13/95		14.95	28.22	1,600	780	340	1,400	8,200	NA	No free product or sheen
	09/28/95		27.63	15.54	<0.5	<0.5	<0.5	<0.5	<50	NA	No free product or sheen
	12/28/95		14.54	28.63	<0.5	<0.5	<0.5	<0.5	<50	<5.0	No free product or sheen
	03/12/96		11.02	32.15	<0.5	<0.5	<0.5	<0.5	86	110	No free product or sheen
	06/11/96		14.52	28.65	38	11	4.7	50	230	68	No free product or sheen
	10/02/96		15.53	27.64	68	29	14	75	360	47	No free product or sheen
	01/28/97		12.59	30.58	0.77	<0.5	<0.5	<0.5	<50	9	No free product or sheen
	05/20/97		14.85	28.32	<0.5	<0.5	<0.5	<0.5	<50	32	No free product or sheen
	08/18/97		16.19	26.98	25	<0.5	<0.5	3.6	220	170	No free product or sheen
	09/29/97		NM	NC	240	2.8	51	55	900	230	Not measured
	11/05/97		16.95	26.22	340	3.2	59	78	1,300	240/220 ^b	No free product or sheen
	03/31/98		11.85	31.32	450	130	200	940	4,100	4,100	No free product or sheen
	05/26/98		13.13	30.04	NS	NS	NS	NS	NS	NS	No free product or sheen
	05/28/98		NM	NC	830	210	170	720	17,000	14,000	No free product or sheen
	08/19/98		14.70	28.47	20	<2.5	7.1	15	540	2,100	No free product or sheen

TABLE 1

GROUND WATER MONITORING DATA

Beacon Station No. 721
44 Lewelling Boulevard
San Lorenzo, California

Monitoring Well	Date	Top of Riser Elevation (ft)	Depth to Water (ft)	Ground Water Elevation (ft)	Benzene (µg/L)	Toluene (µg/L)	Ethyl-benzene (µg/L)	Total Xylenes (µg/L)	TPH as gasoline (µg/L)	MTBE (µg/L)	Comments
RW-1	11/17/98	43.17	15.54	27.63	7.8	<2.5	5.6	<2.5	630	730	No free product or sheen
(cont)	02/18/99		13.75	29.42	6.7	1.6	3.2	15	180	100	No free product or sheen
	06/24/99		14.96	28.21	<0.5	<0.5	<0.5	<0.5	<50	42	No free product or sheen
	08/30/99		15.75	27.42	<0.5	<0.5	<0.5	<0.5	<50	79	No free product or sheen
	11/09/99		17.45	25.72	<0.5	<0.5	<0.5	<0.5	<50	78	No free product or sheen
	03/22/00		13.51	29.66	1.2	<0.5	<0.5	<0.5	<50	17	No free product or sheen
	06/12/00		13.65	29.52	<0.5	<0.5	<0.5	1.0	<50	40	No free product or sheen
	09/06/00		14.72	28.45	<0.5	<0.5	<0.5	<0.5	<50	11	No free product or sheen

^a Product is not typical gasoline.

^b MTBE by EPA Method 8020/EPA Method 8260.

^c Constituents by EPA Method 8260.

Top of Riser Elevations = Elevations surveyed by Aegis Environmental and are assumed relative to mean sea level.

TPH = Total petroleum hydrocarbons.

MTBE = Methyl tertiary butyl ether.

µg/L = Micrograms per liter.

NS = Not sampled.

NM = Not measured.

NC = Not calculated.

NA = Not analyzed.

Note: Aegis Environmental, Inc. collected data prior to June 23, 1993.

TABLE 2

VOLUME OF GROUND WATER TREATED

Beacon Station No. 721
44 Lewelling Boulevard
San Lorenzo, California

Date	Totalizer Reading (gallons)	Change in Totalizer Reading (gallons)	Total Discharge (gallons)	Average Flow Rate (gallons per Minute)
06/21/93	2,120	NA	2,120	NA
07/14/93	117,367	115,247	117,367	3.48
08/14/93	210,470	93,103	210,470	2.09
09/22/93	255,241	44,771	255,241	0.80
01/24/94	399,520	144,279	399,520	0.81
03/31/94	460,075	60,555	460,075	0.64
06/21/94	597,663	137,588	597,663	1.17
09/28/94	662,894	65,231	662,894	0.46
12/14/94	723,160	60,266	723,160	0.54
03/15/95	902,621	179,461	902,621	1.37
06/30/95	929,056	26,435	929,056	0.17
09/26/95	1,018,150	89,094	1,018,150	0.70
12/06/95	1,053,866	35,716	1,053,866	0.35
01/30/96	1,067,852	13,986	1,067,852	0.18
01/30/96 ^a	0	NA	1,067,852	NA
03/19/96	8,900	8,900	1,076,752	0.13
06/27/96	107,780	98,880	1,175,632	0.69
09/18/96	108,910	1,130	1,176,762	0.01
10/22/96	116,540	7,630	1,184,392	0.16
06/24/99	116,580	40	1,184,432	0.00
07/26/99	117,170	590	1,185,022	0.01
07/27/99	120,840	3,670	1,188,692	2.55
07/28/99	121,030	190	1,188,882	0.13
07/29/99	121,270	240	1,189,122	0.17
07/30/99	121,490	220	1,189,342	0.15
08/02/99	121,840	350	1,189,692	0.08
08/09/99	141,910	20,070	1,209,762	1.99
08/26/99	149,647	7,737	1,217,499	0.32
08/30/99	150,380	733	1,218,232	0.13
09/07/99	152,000	1,620	1,219,852	0.14
09/22/99	154,890	2,890	1,222,742	0.13
10/13/99	159,348	4,458	1,227,200	0.15
10/28/99	162,245	2,897	1,230,097	0.13
11/11/99	164,912	2,667	1,232,764	0.13
11/23/99	167,245	2,333	1,235,097	0.14
12/29/99	174,090	6,845	1,228,252	0.13
01/12/00	176,691	2,601	1,230,853	0.13

TABLE 2

VOLUME OF GROUND WATER TREATED

Beacon Station No. 721
 44 Lewelling Boulevard
 San Lorenzo, California

Date	Totalizer Reading (gallons)	Change in Totalizer Reading (gallons)	Total Discharge (gallons)	Average Flow Rate (gallons per Minute)
02/09/00	183,087	6,396	1,237,249	0.16
02/24/00	183,090	3	1,237,252	0.00
03/09/00	183,093	3	1,237,255	0.00
03/30/00	183,093	0	1,237,255	0.00
04/13/00	183,230	137	1,237,392	0.01
04/27/00	183,233	3	1,237,395	0.00
05/10/00	186,871	3,638	1,241,033	0.19
05/24/00	187,563	692	1,241,725	0.03
06/08/00	187,749	186	1,241,911	0.01
06/20/00	189,652	1,903	1,243,814	0.11

^a Flow totalizer replaced on January 30, 1996.

TABLE 3

CUMMULATIVE GROUND WATER SYSTEM ANALYTICAL RESULTS

Beacon Station No. 721
44 Lewelling Boulevard
San Lorenzo, California

Sample ID	Date	Benzene (µg/L)	Toluene (µg/L)	Ethyl- benzene (µg/L)	Total Xylenes (µg/L)	TPH as gasoline (µg/L)	MTBE (µg/L)	Priority Pollutant Metals (µg/L)	Phenols & Cyanide (µg/L)	pH	C.O.D. (mg/L)	T.S.S. (mg/L)
Effluent	05/28/93	<0.5	<0.5	<0.5	<0.5	<50	NA	NA	NA	NA	NA	NA
Effluent	10/01/93	<0.5	<0.5	<0.5	<0.5	<50	NA	NA	NA	NA	NA	NA
Effluent	01/24/94	<0.5	<0.5	<0.5	<0.5	<50	NA	NA	NA	NA	NA	NA
Effluent	04/07/94	<0.5	<0.5	<0.5	<0.5	<50	NA	NA	NA	NA	NA	NA
Effluent	05/18/94	<0.5	<0.5	<0.5	<0.5	<50	NA	NA	NA	NA	NA	NA
Influent	12/14/94	<0.5	<0.5	<0.5	<0.5	<50	NA	NA	NA	NA	NA	NA
Mid-Carbon	12/14/94	<0.5	<0.5	<0.5	<0.5	<50	NA	NA	NA	NA	NA	NA
Effluent	12/14/94	<0.5	<0.5	<0.5	<0.5	<50	NA	NA	NA	NA	NA	NA
Influent	03/22/95	<0.5	<0.5	<0.5	<0.5	<50	NA	NA	NA	NA	NA	NA
Mid-Carbon	03/22/95	<0.5	<0.5	<0.5	<0.5	<50	NA	NA	NA	NA	NA	NA
Effluent	03/22/95	<0.5	<0.5	<0.5	<0.5	<50	NA	NA	NA	NA	NA	NA
Influent	04/10/95	3.9	0.57	0.65	5.5	<50	NA	NA	NA	NA	NA	NA
Mid-Carbon	04/10/95	<0.5	<0.5	<0.5	<0.5	<50	NA	NA	NA	NA	NA	NA
Effluent	04/10/95	<0.5	<0.5	<0.5	<0.5	<50	NA	NA	NA	NA	NA	NA
Effluent	07/28/95	<0.5	<0.5	<0.5	<0.5	<50	NA	NA	NA	NA	NA	NA
Influent	08/10/95	<0.5	<0.5	<0.5	<0.5	<50	NA	NA	NA	NA	NA	NA
Mid-Carbon	08/10/95	<0.5	<0.5	<0.5	<0.5	<50	NA	NA	NA	NA	NA	NA
Effluent	08/10/95	<0.5	<0.5	<0.5	<0.5	<50	NA	NA	NA	NA	NA	NA

TABLE 3

CUMMULATIVE GROUND WATER SYSTEM ANALYTICAL RESULTS

Beacon Station No. 721
44 Lewelling Boulevard
San Lorenzo, California

Sample ID	Date	Benzene (µg/L)	Toluene (µg/L)	Ethyl- benzene (µg/L)	Total Xylenes (µg/L)	TPH as gasoline (µg/L)	MTBE (µg/L)	Priority Pollutant Metals (µg/L)	Phenols & Cyanide (µg/L)	pH	C.O.D. (mg/L)	T.S.S. (mg/L)
Influent	09/14/95	<0.5	<0.5	<0.5	<0.5	490 ^a	NA	NA	NA	NA	NA	NA
Mid-Carbon	09/14/95	<0.5	<0.5	<0.5	<0.5	<50	NA	NA	NA	NA	NA	NA
Effluent	09/14/95	<0.5	<0.5	<0.5	<0.5	<50	NA	NA	NA	NA	NA	NA
Influent	12/06/95	<0.5	<0.5	<0.5	<0.5	<50	NA	NA	NA	NA	NA	NA
Mid-Carbon	12/06/95	<0.5	<0.5	<0.5	<0.5	<50	NA	NA	NA	NA	NA	NA
Effluent	12/06/95	<0.5	<0.5	<0.5	<0.5	<50	NA	NA	NA	NA	NA	NA
Influent	01/30/96	<0.5	<0.5	<0.5	<0.5	<50	<5.0	NA	NA	NA	NA	NA
Mid-Carbon	01/30/96	<0.5	<0.5	<0.5	<0.5	<50	<5.0	NA	NA	NA	NA	NA
Effluent	01/30/96	<0.5	<0.5	<0.5	<0.5	<50	NA	NA	NA	NA	NA	NA
Influent	02/27/96	<0.5	<0.5	<0.5	<0.5	<50	NA	NA	NA	NA	NA	NA
Mid-Carbon	02/27/96	<0.5	<0.5	<0.5	<0.5	<50	NA	NA	NA	NA	NA	NA
Effluent	02/27/96	<0.5	<0.5	<0.5	<0.5	<50	NA	NA	NA	NA	NA	NA
Influent	03/12/96	<0.5	<0.5	<0.5	<0.5	<50	5.3	NA	NA	NA	NA	NA
Mid-Carbon	03/12/96	<0.5	<0.5	<0.5	<0.5	<50	<5.0	NA	NA	NA	NA	NA
Effluent	03/12/96	<0.5	<0.5	<0.5	<0.5	<50	<5.0	NA	NA	NA	NA	NA
Influent	04/16/96	<0.5	<0.5	<0.5	<0.5	<50	<5.0	NA	NA	NA	NA	NA
Mid-Carbon	04/16/96	<0.5	<0.5	<0.5	<0.5	<50	<5.0	NA	NA	NA	NA	NA
Effluent	04/16/96	<0.5	<0.5	<0.5	<0.5	<50	<5.0	NA	NA	NA	NA	NA

TABLE 3

CUMMULATIVE GROUND WATER SYSTEM ANALYTICAL RESULTS

Beacon Station No. 721
44 Lewelling Boulevard
San Lorenzo, California

Sample ID	Date	Benzene (µg/L)	Toluene (µg/L)	Ethyl- benzene (µg/L)	Total Xylenes (µg/L)	TPH as gasoline (µg/L)	MTBE (µg/L)	Priority Pollutant Metals (µg/L)	Phenols & Cyanide (µg/L)	pH	C.O.D. (mg/L)	T.S.S. (mg/L)
Influent	05/07/96	<0.5	<0.5	<0.5	<0.5	<50	7.9	NA	NA	NA	NA	NA
Mid-Carbon	05/07/96	<0.5	<0.5	<0.5	<0.5	<50	<5.0	NA	NA	NA	NA	NA
Effluent	05/07/96	<0.5	<0.5	<0.5	<0.5	<50	<5.0	NA	NA	NA	NA	NA
Influent	06/11/96	2.4	0.57	5.9	2.8	190	610	NA	NA	NA	NA	NA
Mid-Carbon	06/11/96	<0.5	<0.5	<0.5	<0.5	<50	<5.0	NA	NA	NA	NA	NA
Effluent	06/11/96	<0.5	<0.5	<0.5	<0.5	<50	<5.0	NA	NA	NA	NA	NA
Influent	09/18/96	<0.5	<0.5	<0.5	<0.5	<50	11	NA	NA	NA	NA	NA
Mid-Carbon	09/18/96	<0.5	<0.5	<0.5	<0.5	<50	<5.0	NA	NA	NA	NA	NA
Effluent	09/18/96	<0.5	<0.5	<0.5	<0.5	<50	<5.0	NA	NA	NA	NA	NA
Influent	06/24/99	<0.5	<0.5	<0.5	<0.5	<50	NA	NA	NA	NA	NA	NA
DAT Effluent	06/24/99	<0.5	<0.5	<0.5	<0.5	<50	NA	NA	NA	NA	NA	NA
Mid-Carbon	06/24/99	<0.5	<0.5	<0.5	<0.5	<50	NA	NA	NA	NA	NA	NA
Effluent	06/24/99	<0.5	<0.5	<0.5	<0.5	<50	NA	0.0037 ^a	ND	8.9	NA	NA
Influent	07/26/99	<0.5	<0.5	<0.5	<0.5	<50	NA	NA	NA	NA	NA	NA
Influent	07/27/99	<0.5	<0.5	<0.5	<0.5	<50	NA	NA	NA	NA	NA	NA
Influent	07/28/99	<0.5	<0.5	<0.5	<0.5	<50	NA	NA	NA	NA	NA	NA
Influent	08/02/99	<0.5	<0.5	<0.5	<0.5	<50	NA	NA	NA	NA	NA	NA
DAT Effluent	08/02/99	<0.5	<0.5	<0.5	<0.5	<50	NA	NA	NA	NA	NA	NA
Mid-Carbon	08/02/99	<0.5	<0.5	<0.5	<0.5	<50	NA	NA	NA	NA	NA	NA
Effluent	08/02/99	<0.5	<0.5	<0.5	<0.5	<50	NA	NA	NA	NA	NA	NA

TABLE 3

CUMMULATIVE GROUND WATER SYSTEM ANALYTICAL RESULTS

Beacon Station No. 721
44 Lewelling Boulevard
San Lorenzo, California

Sample ID	Date	Benzene (µg/L)	Toluene (µg/L)	Ethyl- benzene (µg/L)	Total Xylenes (µg/L)	TPH as gasoline (µg/L)	MTBE (µg/L)	Priority Pollutant Metals (µg/L)	Phenols & Cyanide (µg/L)	pH	C.O.D. (mg/L)	T.S.S. (mg/L)
Effluent	08/30/99	NA	NA	NA	NA	NA	NA	NA	NA	7.9	<1.0	2.6
Influent	09/07/99	<0.5	<0.5	<0.5	<0.5	91	NA	NA	NA	NA	NA	NA
DAT Effluent	09/07/99	<0.5	<0.5	<0.5	<0.5	<50	NA	NA	NA	NA	NA	NA
Mid-Carbon	09/07/99	<0.5	<0.5	<0.5	<0.5	<50	NA	NA	NA	NA	NA	NA
Effluent	09/07/99	<0.5	<0.5	<0.5	<0.5	<50	NA	NA	NA	NA	NA	NA
Influent	10/13/99	<0.5	<0.5	<0.5	<0.5	<50	110	NA	NA	NA	NA	NA
DAT Effluent	10/13/99	<0.5	<0.5	<0.5	<0.5	<50	<5.0	NA	NA	NA	NA	NA
Mid-Carbon	10/13/99	<0.5	<0.5	<0.5	<0.5	<50	<5.0	NA	NA	NA	NA	NA
Effluent	10/13/99	<0.5	<0.5	<0.5	<0.5	<50	<5.0	NA	NA	7.96	<10	<5.0
Influent	11/11/99	<0.5	<0.5	<0.5	0.95	<50	28	NA	NA	NA	NA	NA
DAT Effluent	11/11/99	<0.5	<0.5	<0.5	<0.5	<50	<5.0	NA	NA	NA	NA	NA
Mid-Carbon	11/11/99	<0.5	<0.5	<0.5	<0.5	<50	<5.0	NA	NA	NA	NA	NA
Effluent	11/11/99	<0.5	<0.5	<0.5	<0.5	<50	<5.0	NA	NA	8.05	<10	<5.0
Influent	12/16/99	<0.5	<0.5	<0.5	<0.5	<50	NA	NA	NA	NA	NA	NA
DAT Effluent	12/16/99	<0.5	<0.5	<0.5	<0.5	<50	<5.0	NA	NA	NA	NA	NA
Mid-Carbon	12/16/99	<0.5	<0.5	<0.5	<0.5	<50	<5.0	NA	NA	NA	NA	NA
Effluent	12/16/99	<0.5	<0.5	<0.5	<0.5	<50	<5.0	NA	NA	8.27	<10	<5.0
Influent	01/12/00	<0.5	<0.5	<0.5	<0.5	<50	NA	NA	NA	NA	NA	NA
DAT Effluent	01/12/00	<0.5	<0.5	<0.5	<0.5	<50	NA	NA	NA	NA	NA	NA
Mid-Carbon	01/12/00	<0.5	<0.5	<0.5	<0.5	<50	NA	NA	NA	NA	NA	NA
Effluent	01/12/00	<0.5	<0.5	<0.5	<0.5	<50	NA	NA	NA	7.92	<10	<5.0

TABLE 3

CUMMULATIVE GROUND WATER SYSTEM ANALYTICAL RESULTS

Beacon Station No. 721
44 Lewelling Boulevard
San Lorenzo, California

Sample ID	Date	Benzene (µg/L)	Toluene (µg/L)	Ethyl- benzene (µg/L)	Total Xylenes (µg/L)	TPH as gasoline (µg/L)	MTBE (µg/L)	Priority Pollutant Metals (µg/L)	Phenols & Cyanide (µg/L)	pH	C.O.D. (mg/L)	T.S.S. (mg/L)
Influent	02/09/00	<0.5	<0.5	<0.5	<0.5	<50	68	NA	NA	NA	NA	NA
DAT Effluent	02/09/00	<0.5	<0.5	<0.5	<0.5	<50	<5.0	NA	NA	NA	NA	NA
Mid-Carbon	02/09/00	<0.5	<0.5	<0.5	<0.5	<50	<5.0	NA	NA	NA	NA	NA
Effluent	02/09/00	<0.5	<0.5	<0.5	<0.5	<50	<5.0	NA	NA	7.82	<10	<5.0
Influent	03/09/00	<0.5	<0.5	<0.5	<0.5	<50	NA	NA	NA	NA	NA	NA
DAT Effluent	03/09/00	<0.5	<0.5	<0.5	<0.5	<50	NA	NA	NA	NA	NA	NA
Mid-Carbon	03/09/00	<0.5	<0.5	<0.5	<0.5	<50	NA	NA	NA	NA	NA	NA
Effluent	03/09/00	<0.5	<0.5	<0.5	<0.5	<50	<5.0	NA	NA	7.88	<10	<5.0
Influent	04/13/00	1.9	<0.5	0.74	4.6	69	34	NA	NA	NA	NA	NA
DAT Effluent	04/13/00	<0.5	<0.5	<0.5	<0.5	<50	<5.0	NA	NA	NA	NA	NA
Mid-Carbon	04/13/00	<0.5	<0.5	<0.5	<0.5	<50	<5.0	NA	NA	NA	NA	NA
Effluent	04/13/00	<0.5	<0.5	<0.5	<0.5	<50	<5.0	NA	NA	7.43	<10	<5.0
Influent	05/10/00	13	1.3	<0.5	5.0	<50	76	NA	NA	NA	NA	NA
DAT Effluent	05/10/00	<0.5	1.2	<0.5	1.3	<50	<5.0	NA	NA	NA	NA	NA
Mid-Carbon	05/10/00	<0.5	0.56	<0.5	<0.5	<50	<5.0	NA	NA	NA	NA	NA
Effluent	05/10/00	<0.5	<0.5	<0.5	<0.5	<50	<5.0	NA	NA	8.19	<10	<5.0

TABLE 3

CUMMULATIVE GROUND WATER SYSTEM ANALYTICAL RESULTS

Beacon Station No. 721
44 Lewelling Boulevard
San Lorenzo, California

Sample ID	Date	Benzene (µg/L)	Toluene (µg/L)	Ethyl- benzene (µg/L)	Total Xylenes (µg/L)	TPH as gasoline (µg/L)	MTBE (µg/L)	Priority Pollutant Metals (µg/L)	Phenols & Cyanide (µg/L)	pH	C.O.D. (mg/L)	T.S.S. (mg/L)
Influent	06/08/00	29	1.1	<0.5	1.8	73	170	NA	NA	NA	NA	NA
DAT Effluent	06/08/00	<0.5	1.0	<0.5	1.4	<50	<5.0	NA	NA	NA	NA	NA
Mid-Carbon	06/08/00	<0.5	0.72	<0.5	0.96	<50	<5.0	NA	NA	NA	NA	NA
Effluent	06/08/00	<0.5	1.0	<0.5	1.5	<50	<5.0	NA	NA	8.02	<10	<5.0

^a Not typical gasoline.

^b Arsenic

µg/L = Micrograms per liter.

mg/L = Milligrams per liter.

TPH = Total petroleum hydrocarbons.

MTBE = Methyl-tertiary butyl ether.

C.O.D. = Chemical oxygen demand.

T.S.S. = Total suspended solids.

TABLE 4

SVE SYSTEM ANALYTICAL RESULTS

Beacon Station No. 721
 44 Lewelling Boulevard
 San Lorenzo, California

Sample I.D.	Date	Benzene (ppmv)	Toluene (ppmv)	Ethyl-benzene (ppmv)	Total Xylenes (ppmv)	TPH as gasoline (ppmv)
Influent	04/07/00	<0.05	<0.05	<0.05	<0.05	<5.0
Mid	04/07/00	<0.05	<0.05	<0.05	<0.05	<5.0
Effluent	04/07/00	<0.05	<0.05	<0.05	<0.05	<5.0
Influent	05/10/00	<0.05	<0.05	<0.05	<0.05	<5.0
Mid	05/10/00	<0.05	<0.05	<0.05	<0.05	<5.0
Effluent	05/10/00	<0.05	<0.05	<0.05	<0.05	<5.0
Influent	06/08/00	<0.05	<0.05	<0.05	<0.05	<5.0
Mid	06/08/00	<0.05	<0.05	<0.05	<0.05	<5.0
Effluent	06/08/00	<0.05	<0.05	<0.05	<0.05	<5.0

TPH = Total Petroleum Hydrocarbons
 ppmv = parts per million by volume

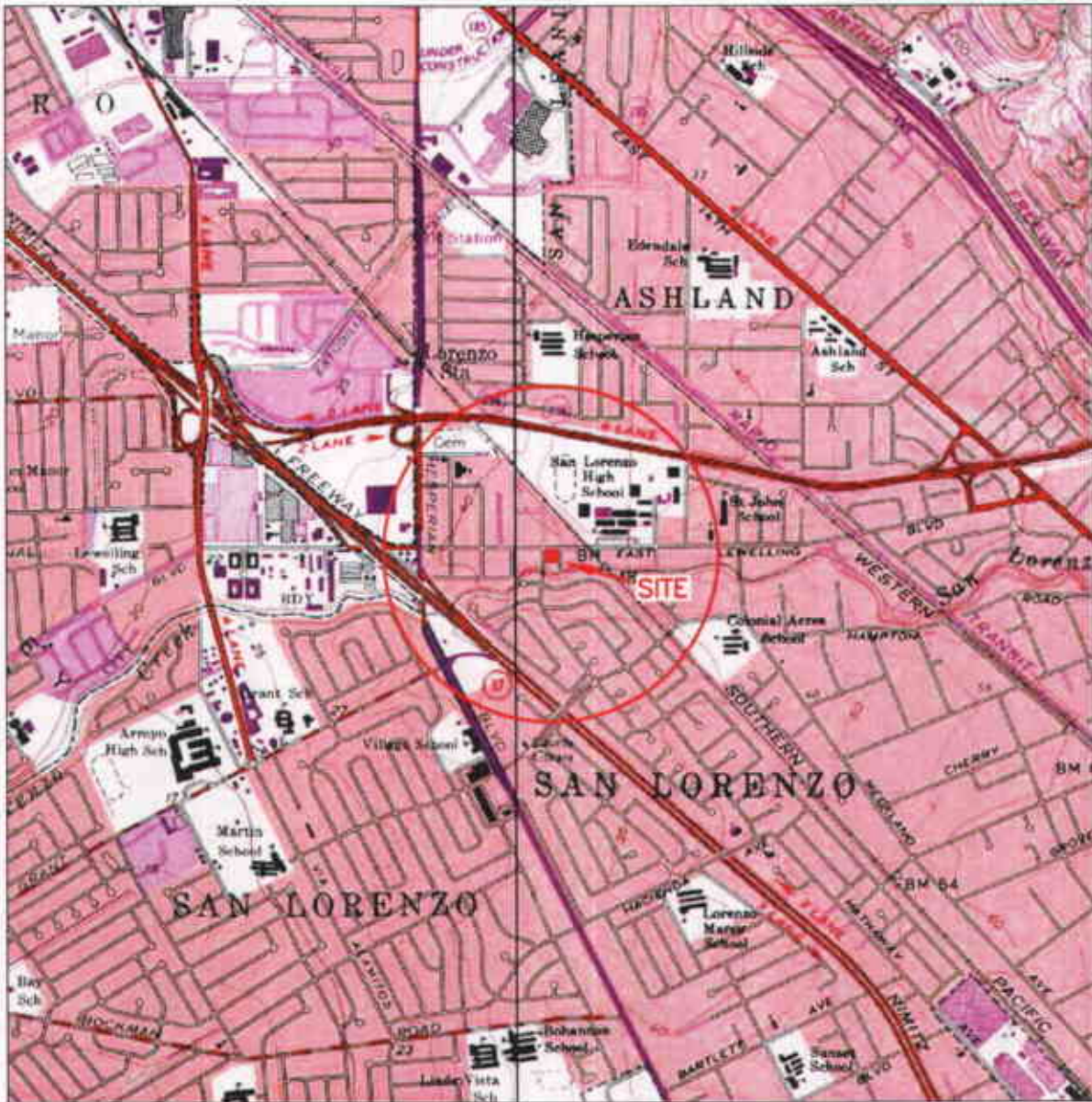

T35

R2W

GENERAL NOTES:
 BASE MAP FROM U.S.G.S.
 HAYWARD, CA
 7.5 MINUTE TOPOGRAPHIC
 PHOTOREVISED 1980

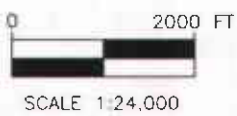

QUADRANGLE LOCATION

FIGURE 1
 SITE LOCATION MAP

BEACON STATION NO. 721
 44 LEWELLING BOULEVARD
 SAN LORENZO, CA.

PROJECT NO. 0093-936	DRAWN BY M.L. 12/6/99
FILE NO. 93-936-1A	PREPARED BY TLA
REVISION NO. 4	REVIEWED BY



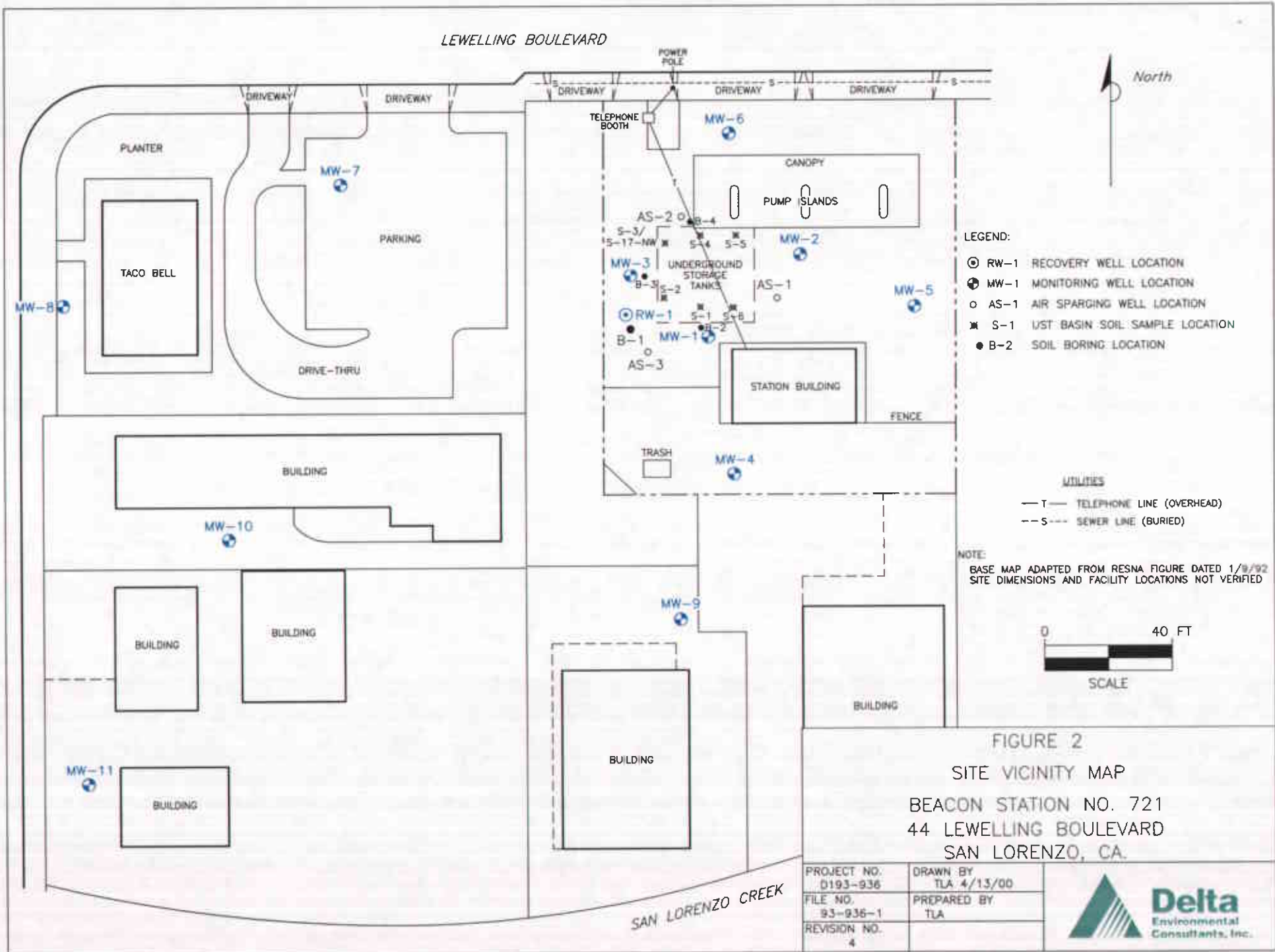

LEWELLING BOULEVARD



LEGEND:

- ⊕ RW-1 RECOVERY WELL LOCATION
- ⊙ MW-1 MONITORING WELL LOCATION
- AS-1 AIR SPARGING WELL LOCATION
- ✱ S-1 UST BASIN SOIL SAMPLE LOCATION
- B-2 SOIL BORING LOCATION

UTILITIES

- T — TELEPHONE LINE (OVERHEAD)
- - - S - - - SEWER LINE (BURIED)

NOTE:

BASE MAP ADAPTED FROM RESNA FIGURE DATED 1/9/92
SITE DIMENSIONS AND FACILITY LOCATIONS NOT VERIFIED

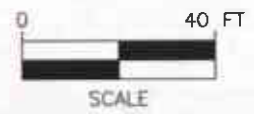

FIGURE 2

SITE VICINITY MAP

BEACON STATION NO. 721
44 LEWELLING BOULEVARD
SAN LORENZO, CA.

PROJECT NO. D193-936	DRAWN BY TLA 4/13/00
FILE NO. 93-936-1	PREPARED BY TLA
REVISION NO. 4	



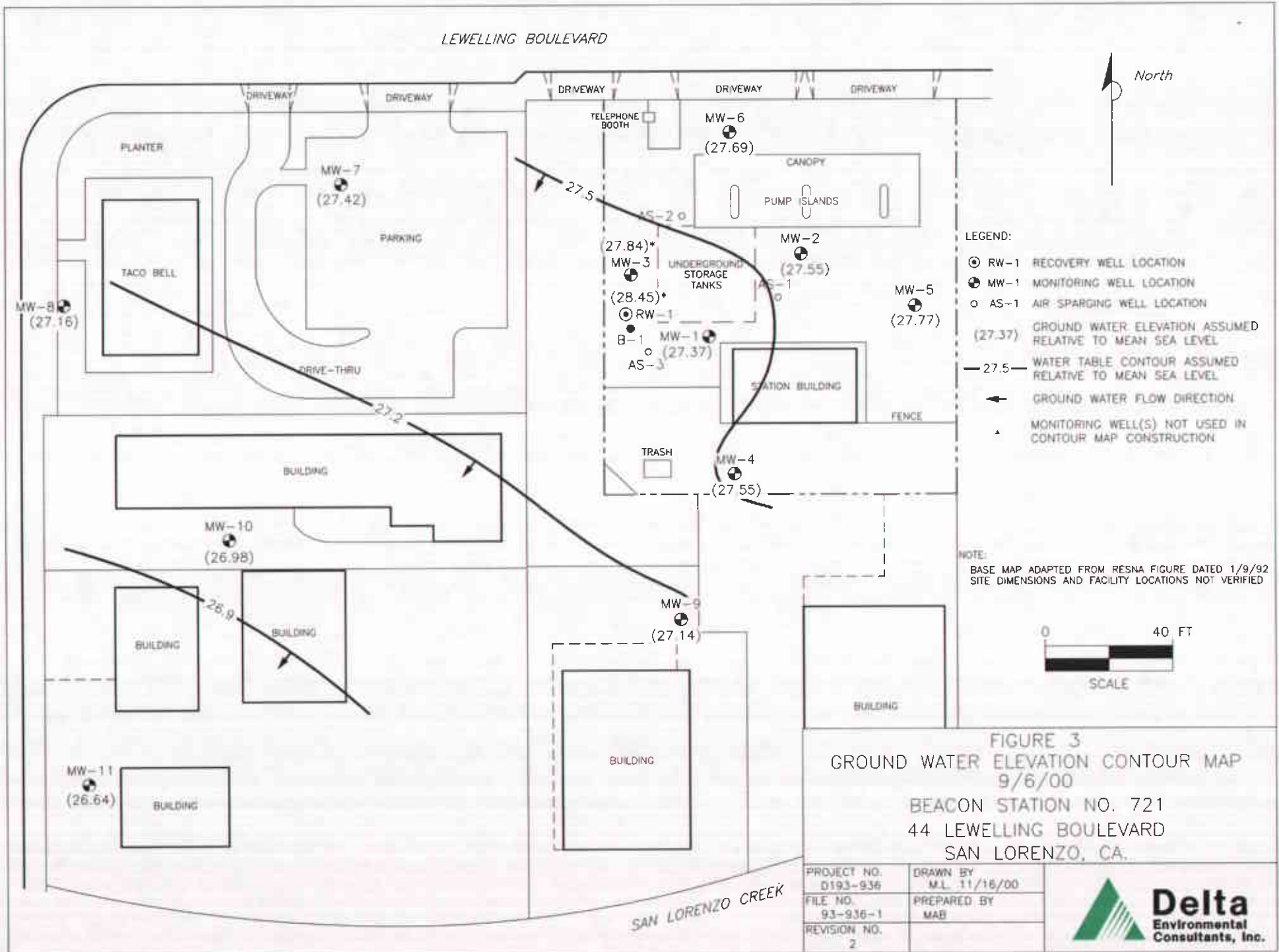

LEWELLING BOULEVARD

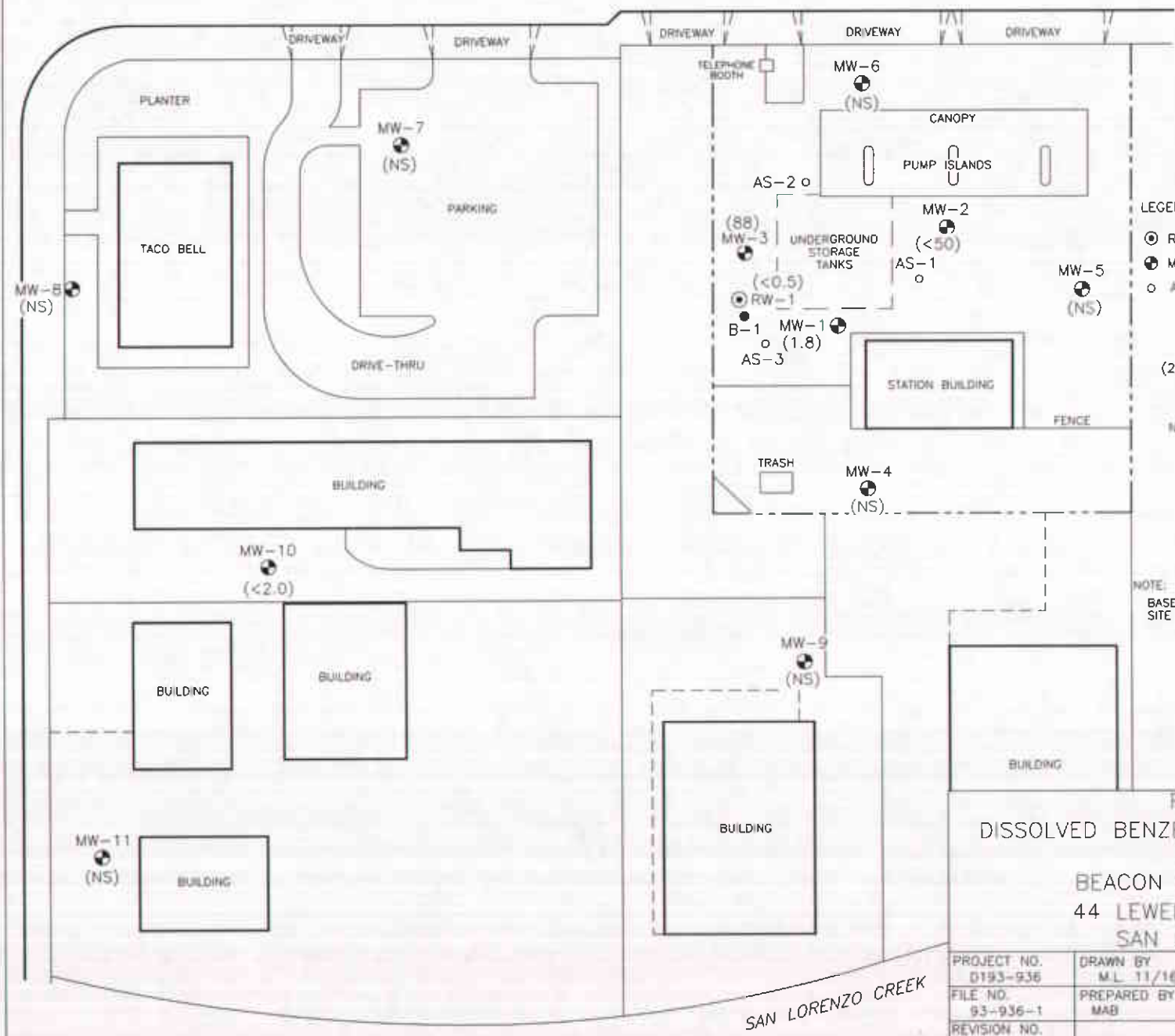

- LEGEND:
- ⊙ RW-1 RECOVERY WELL LOCATION
 - ⊕ MW-1 MONITORING WELL LOCATION
 - AS-1 AIR SPARGING WELL LOCATION
- (2.8) BENZENE CONCENTRATION IN MICROGRAMS PER LITER (ug/L)
- NS NOT SAMPLED

NOTE:
BASE MAP ADAPTED FROM RESNA FIGURE DATED 1/9/92
SITE DIMENSIONS AND FACILITY LOCATIONS NOT VERIFIED

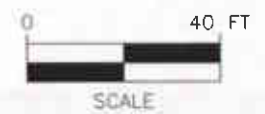

FIGURE 4
DISSOLVED BENZENE CONCENTRATION MAP
9/6/00
BEACON STATION NO. 721
44 LEWELLING BOULEVARD
SAN LORENZO, CA.

PROJECT NO. 0193-936	DRAWN BY M.L. 11/16/00
FILE NO. 93-936-1	PREPARED BY MAB
REVISION NO. 2	



SAN LORENZO CREEK

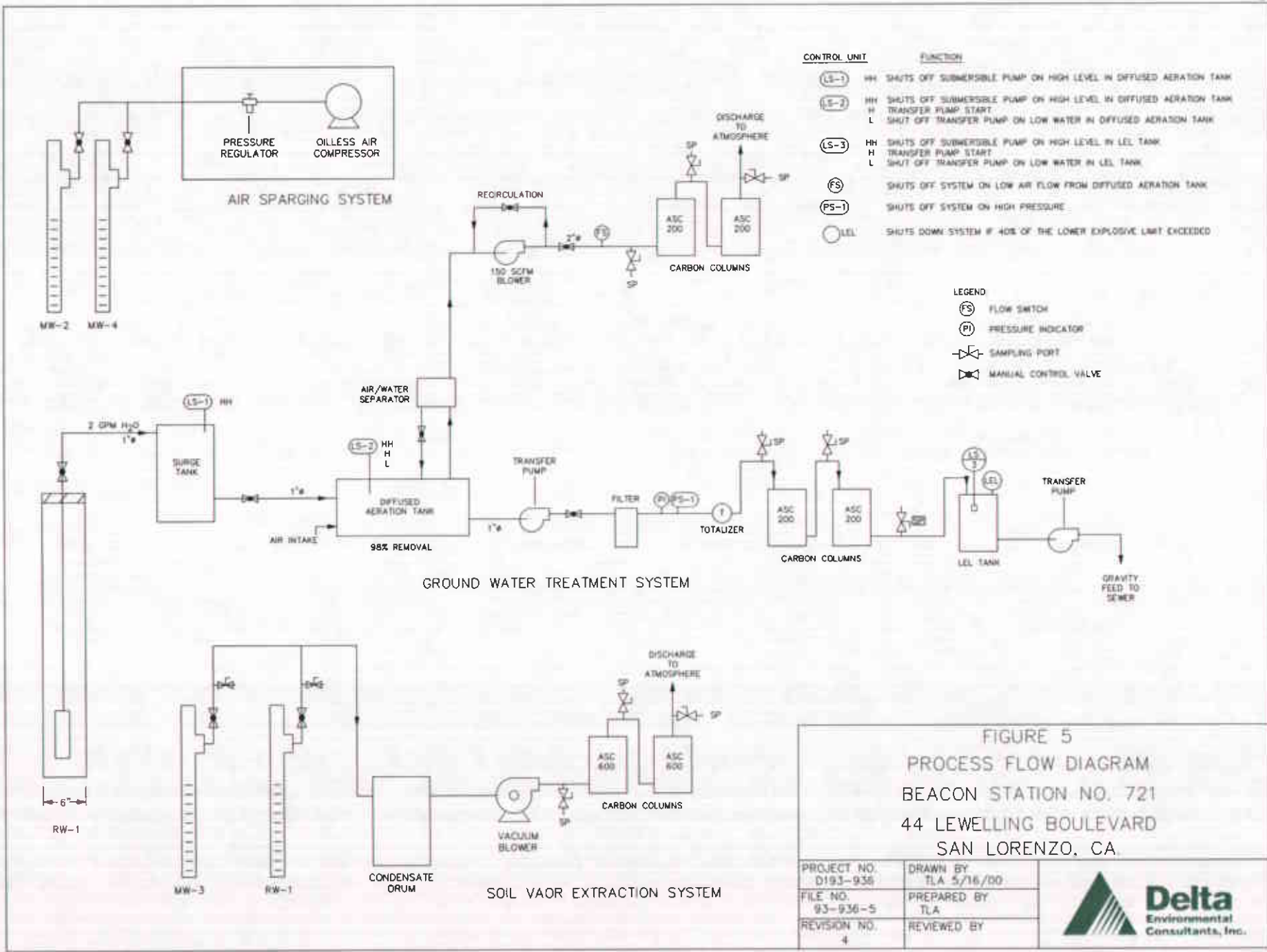



FIGURE 5
PROCESS FLOW DIAGRAM
BEACON STATION NO. 721
44 LEWELLING BOULEVARD
SAN LORENZO, CA.

PROJECT NO. D193-936	DRAWN BY TLA 5/16/00
FILE NO. 93-936-5	PREPARED BY TLA
REVISION NO. 4	REVIEWED BY



HISTORICAL BACKGROUND INFORMATION

Beacon Station No. 721
44 Lewelling Boulevard
San Lorenzo, California

PRE - ULTRAMAR INC.

- April 1987 - Three underground gasoline storage tanks were excavated and removed. Samples collected from beneath the former tanks indicated that hydrocarbons were present in the soil.
- May 1987 - Conoco installed three monitoring wells (MW-1 through MW-3). Hydrocarbons were detected in soil and ground-water samples collected from the wells. The site has been on a monitoring program since May 1987.
- December 1988 - Four additional wells (MW-4 through MW-7) were installed. Dissolved-phase hydrocarbons were detected in the new wells.
- September 1989 - Two additional wells (MW-8 and MW-9) were installed.

ULTRAMAR INC.

- July 1990 - Ultramar Inc purchased the site from Conoco. The monitoring program has continued
- March 14, 1991 - Work Plan for additional assessment submitted.
- October 1991 - Drilled two additional offsite wells (MW-10 and MW-11) southwest of the site and one onsite recovery well (RW-1).
- November 1991 - Performed ground-water pump test and vapor extraction test.
- April 1992 - Ultramar submitted an Interim Remediation Plan.
- June 1992 - Interim Remediation Plan was approved.
- March 1993 - Installed the subsurface piping for the remediation system.
- April 1993 - Completed installation of ground-water remediation system.
- June 1993 - Began operation.
- April 1993 - The ground-water extraction system began operation.
- March 1994 - The vapor extraction system began operation.
- June 8, 1994 - Obtained the Permit to Operate for the vapor extraction system.
- December 1995 - Installed an air sparging system.
- January 1997 - Discontinued to operate the remediation system. Approximately 1,184,392 gallons of ground water have been removed, treated, and discharged. Approximately 103 gallons of hydrocarbons have been removed the vapor extraction system.

CONTINUED NEXT PAGE

HISTORICAL BACKGROUND INFORMATION

Beacon Station No. 721
44 Lewelling Boulevard
San Lorenzo, California

ULTRAMAR INC. (continued)

- October 1997 - Drilled confirmation borings. Results indicate soil clean.
- June 1998 - The air sparging system was restarted.
- July 1999 - The ground water system was restarted.
- April 3, 2000 – The soil vapor extraction system was restarted.

ENCLOSURE B

Ground Water Sampling Information



3164 Gold Camp Drive, Suite 200
 Rancho Cordova, California 95670
 Direct: (916) 638-2085
 Fax: (916) 638-8385

Site Address: 44 Lewelling Boulevard
San Lorenzo, CA
 Sampled By: Hal Hansen (Doulos)

Site Name: Beacon 721
 Delta Project No.: D193-936
 Date: 09/06/00

Water Level Data					Purge Volume Calculations					Sampling Analytes					Sample Record	
Well ID	Time	Depth to Water (feet)	Depth to Bottom (feet)	D.O. (mg/L)	Casing Water Column*	Well Diameter (inches)	Multiplier Value (**)	Three Casing Volumes (gallons)	Actual Water Purged (gallons)	BTEX (8260) VOA	TPH-g (8260) VOA	MTBE (8260) VOA	TPHd (8015M) Amber	Other	Sample I.D.	Sample Time
MW-1	8:33	16.30	33.6	NM	17.34	2 inch	0.5	8.7	11	<input checked="" type="checkbox"/>	<input checked="" type="checkbox"/>	<input checked="" type="checkbox"/>	<input type="checkbox"/>	<input type="checkbox"/>	MW-1	
MW-2	8:36	15.54	34.4	NM	18.81	2 inch	0.5	9.4	12	<input checked="" type="checkbox"/>	<input checked="" type="checkbox"/>	<input checked="" type="checkbox"/>	<input type="checkbox"/>	<input type="checkbox"/>	MW-2	
MW-3	8:25	15.26	34.2	NM	18.97	2 inch	0.5	9.5	12.1	<input checked="" type="checkbox"/>	<input checked="" type="checkbox"/>	<input checked="" type="checkbox"/>	<input type="checkbox"/>	<input type="checkbox"/>	MW-3	
MW-4*	8:21	17.11	24.5	NM	7.36	2 inch	0.5	3.7	N/A	<input type="checkbox"/>	<input type="checkbox"/>	<input type="checkbox"/>	<input type="checkbox"/>	<input type="checkbox"/>		
MW-5	8:18	16.02	29.3	NM	13.29	2 inch	0.5	6.6	N/A	<input type="checkbox"/>	<input type="checkbox"/>	<input type="checkbox"/>	<input type="checkbox"/>	<input type="checkbox"/>		
MW-6	8:40	14.78	28.4	NM	13.64	2 inch	0.5	6.8	N/A	<input type="checkbox"/>	<input type="checkbox"/>	<input type="checkbox"/>	<input type="checkbox"/>	<input type="checkbox"/>		
MW-7*	8:10	14.12	24.2	NM	10.07	2 inch	0.5	5.0	N/A	<input type="checkbox"/>	<input type="checkbox"/>	<input type="checkbox"/>	<input type="checkbox"/>	<input type="checkbox"/>		
MW-8	8:03	15.10	23.0	NM	7.85	2 inch	0.5	3.9	N/A	<input type="checkbox"/>	<input type="checkbox"/>	<input type="checkbox"/>	<input type="checkbox"/>	<input type="checkbox"/>		
MW-9	8:14	17.80	23.6	NM	5.81	2 inch	0.5	2.9	N/A	<input type="checkbox"/>	<input type="checkbox"/>	<input type="checkbox"/>	<input type="checkbox"/>	<input type="checkbox"/>		
MW-10	7:59	15.36	29.4	NM	14.05	2 inch	0.5	7.0	8.9	<input checked="" type="checkbox"/>	<input checked="" type="checkbox"/>	<input checked="" type="checkbox"/>	<input type="checkbox"/>	<input type="checkbox"/>	MW-10	
MW-11*	7:55	18.36	29.4	NM	10.99	2 inch	0.5	5.5	N/A	<input type="checkbox"/>	<input type="checkbox"/>	<input type="checkbox"/>	<input type="checkbox"/>	<input type="checkbox"/>		
RW-1	8:30	14.72	34.1	NM	19.39	6 inch	4.4	85.3	-	<input type="checkbox"/>	<input type="checkbox"/>	<input type="checkbox"/>	<input type="checkbox"/>	<input type="checkbox"/>	RW-1	
										<input type="checkbox"/>	<input type="checkbox"/>	<input type="checkbox"/>	<input type="checkbox"/>	<input type="checkbox"/>		
										<input type="checkbox"/>	<input type="checkbox"/>	<input type="checkbox"/>	<input type="checkbox"/>	<input type="checkbox"/>		
										<input type="checkbox"/>	<input type="checkbox"/>	<input type="checkbox"/>	<input type="checkbox"/>	<input type="checkbox"/>		
										<input type="checkbox"/>	<input type="checkbox"/>	<input type="checkbox"/>	<input type="checkbox"/>	<input type="checkbox"/>		
										<input type="checkbox"/>	<input type="checkbox"/>	<input type="checkbox"/>	<input type="checkbox"/>	<input type="checkbox"/>		
										<input type="checkbox"/>	<input type="checkbox"/>	<input type="checkbox"/>	<input type="checkbox"/>	<input type="checkbox"/>		
										<input type="checkbox"/>	<input type="checkbox"/>	<input type="checkbox"/>	<input type="checkbox"/>	<input type="checkbox"/>		
										<input type="checkbox"/>	<input type="checkbox"/>	<input type="checkbox"/>	<input type="checkbox"/>	<input type="checkbox"/>		

Purge Method: Pump Bailer Sample Port *Casing Water Column: Depth to Bottom - Depth to Water **Multiplier Values: (2" Well: 0.5) (4" Well: 2.0) (6" Well: 4.4)

Sampling Notes: *Sample MW-4 and MW-11 during 2nd and 4th Quarters Only & MW-7 during the 4th Quarter Only. Original Copies of Field Sampling Sheets are Located in Project File



3164 Gold Camp Drive, Suite 200
 Rancho Cordova, California 95670
 Direct: (916) 638-2085
 Fax: (916) 638-8385

Site Address: 44 Lewelling Boulevard
San Lorenzo, CA
 Sampled By: Hal Hansen (Doulos)

Site Name: Beacon 721
 Delta Project No.: D193-936
 Date: 09/06/00

Well ID	Time	Temp °F	pH Units	Sp. Cond.	Volume	Well ID	Time	Temp °F	pH Units	Sp. Cond.	Volume	Well ID	Time	Temp °F	pH Units	Sp. Cond.	Volume	
MW-1	9:43	68.7	7.16	1,040	1	MW-8												
	9:44	68.1	7.14	998	2													
	9:45	69.3	7.10	990	3													
	9:46	69.4	7.06	984	4													
MW-2	10:10	68.4	7.20	1,110	1	MW-9												
	10:11	68.1	7.16	1,020	2													
	10:12	68.2	7.12	1,017	3													
	10:13	68.5	7.10	1,016	4													
MW-3	9:17	70.0	7.14	1,140	1	MW-10	8:57	68.8	7.14	1,042	1							
	9:18	70.2	7.12	1,110	2			8:58	67.8	7.12	991	2						
	9:20	71.0	7.10	1,058	3			8:59	67.3	7.09	984	3						
	9:21	71.3	7.06	1,051	4			9:00	69.8	7.07	980	4						
MW-4						MW-11												
MW-5						RW-1	Sample collected from sample port											
MW-6																		
MW-7																		

ENCLOSURE C

Copy of Groundwater Sampling Frequency Letter

ALAMEDA COUNTY
HEALTH CARE SERVICES

AGENCY
DAVID J. KEARS, Agency Director



RECEIVED

JAN 25 1999

StID 1497

January 19, 1999

Mr. Terrence Fox
Ultramar
PO Box 486
Hanford, CA 93232-0406

ENVIRONMENTAL HEALTH SERVICES
1131 Harbor Bay Parkway, Suite 250
Alameda, CA 94502-8577
(510) 567-6700
(510) 337-9335 (FAX)

RE: Groundwater Sampling Frequency at 44 Lewelling Blvd, San Lorenzo, CA

Dear Mr. Fox:

I have completed review of Delta Environmental's January 1999 *Quarterly Groundwater Monitoring Report, Fourth Quarter 1998* prepared for the above referenced site. Groundwater from well MW-2 continues to exhibit elevated levels of MTBE (up to 17,000ppb). Ultramar is planning to restart the vapor extraction system in the first quarter of 1999 to reduce the MTBE levels.

Once the remediation system is operation, please keep me apprised of the effectiveness of MTBE removal from soil and groundwater. At this time, it is appropriate to reduce the groundwater sampling frequency of the various monitoring wells as follows:

- discontinue sampling of wells MW-5, MW-6, MW-8, and MW-9;
- semi-annual sampling of wells MW-4, and MW-11;
- annual sampling of well MW-7; and,
- quarterly sampling of wells MW-1, MW-2, MW-3 and MW-10.

If you have any questions, I can be reached at (510) 567-6762.

eva chu
Hazardous Materials Specialist

beacon#721-1

ENCLOSURE D

Ground Water Monitoring
Analytical Results



Report Number : 17730

Date : 9/19/00

Richard Munsch
Delta Environmental Consultants, Inc.
3164 Gold Camp Drive, Suite 200
Rancho Cordova, CA 95670

Subject : 5 Water Samples
Project Name : Beacon 721
Project Number : 721

Dear Mr. Munsch,

Chemical analysis of the samples referenced above has been completed. Summaries of the data are contained on the following pages. Sample(s) were received under documented chain-of-custody. US EPA protocols for sample storage and preservation were followed.

Kiff Analytical is certified by the State of California (# 2236). If you have any questions regarding procedures or results, please call me at 530-297-4800.

Sincerely,

A handwritten signature in black ink that reads "Joel Kiff". The signature is written in a cursive style with a large initial "J".

Joel Kiff



Report Number : 17730

Date : 9/19/00

Project Name : **Beacon 721**Project Number : **721**Sample : **MW-1**

Matrix : Water

Lab Number : 17730-01

Sample Date :9/6/00

Parameter	Measured Value	Method Reporting Limit	Units	Analysis Method	Date Analyzed
Benzene	1.8	1.0	ug/L	EPA 8260B	9/16/00
Toluene	< 1.0	1.0	ug/L	EPA 8260B	9/16/00
Ethylbenzene	2.3	1.0	ug/L	EPA 8260B	9/16/00
Total Xylenes	< 1.0	1.0	ug/L	EPA 8260B	9/16/00
Methyl-t-butyl ether	870	10	ug/L	EPA 8260B	9/16/00
TPH as Gasoline	340	100	ug/L	EPA 8260B	9/16/00
Toluene - d8 (Surr)	101		% Recovery	EPA 8260B	9/16/00
4-Bromofluorobenzene (Surr)	104		% Recovery	EPA 8260B	9/16/00

Sample : **MW-2**

Matrix : Water

Lab Number : 17730-02

Sample Date :9/6/00

Parameter	Measured Value	Method Reporting Limit	Units	Analysis Method	Date Analyzed
Benzene	< 50	50	ug/L	EPA 8260B	9/18/00
Toluene	< 50	50	ug/L	EPA 8260B	9/18/00
Ethylbenzene	< 50	50	ug/L	EPA 8260B	9/18/00
Total Xylenes	< 50	50	ug/L	EPA 8260B	9/18/00
Methyl-t-butyl ether	46000	2000	ug/L	EPA 8260B	9/18/00
TPH as Gasoline	< 5000	5000	ug/L	EPA 8260B	9/18/00
Toluene - d8 (Surr)	100		% Recovery	EPA 8260B	9/18/00
4-Bromofluorobenzene (Surr)	94.2		% Recovery	EPA 8260B	9/18/00

Approved By:  Joel Kiff



Report Number : 17730

Date : 9/19/00

Project Name : **Beacon 721**

Project Number : **721**

Sample : **MW-3**

Matrix : Water

Lab Number : 17730-03

Sample Date :9/6/00

Parameter	Measured Value	Method Reporting Limit	Units	Analysis Method	Date Analyzed
Benzene	88	0.50	ug/L	EPA 8260B	9/16/00
Toluene	4.4	0.50	ug/L	EPA 8260B	9/16/00
Ethylbenzene	14	0.50	ug/L	EPA 8260B	9/16/00
Total Xylenes	23	0.50	ug/L	EPA 8260B	9/16/00
Methyl-t-butyl ether	120	5.0	ug/L	EPA 8260B	9/16/00
TPH as Gasoline	640	50	ug/L	EPA 8260B	9/16/00
Toluene - d8 (Surr)	99.6		% Recovery	EPA 8260B	9/16/00
4-Bromofluorobenzene (Surr)	104		% Recovery	EPA 8260B	9/16/00

Sample : **MW-10**

Matrix : Water

Lab Number : 17730-04

Sample Date :9/6/00

Parameter	Measured Value	Method Reporting Limit	Units	Analysis Method	Date Analyzed
Benzene	< 2.0	2.0	ug/L	EPA 8260B	9/16/00
Toluene	12	2.0	ug/L	EPA 8260B	9/16/00
Ethylbenzene	24	2.0	ug/L	EPA 8260B	9/16/00
Total Xylenes	27	2.0	ug/L	EPA 8260B	9/16/00
Methyl-t-butyl ether	300	20	ug/L	EPA 8260B	9/16/00
TPH as Gasoline	4800	200	ug/L	EPA 8260B	9/16/00
Toluene - d8 (Surr)	99.4		% Recovery	EPA 8260B	9/16/00
4-Bromofluorobenzene (Surr)	103		% Recovery	EPA 8260B	9/16/00

Approved By:  Joel Kiff



Report Number : 17730

Date : 9/19/00

Project Name : **Beacon 721**

Project Number : **721**

Sample : **RW-1**

Matrix : Water

Lab Number : 17730-05

Sample Date :9/6/00

Parameter	Measured Value	Method Reporting Limit	Units	Analysis Method	Date Analyzed
Benzene	< 0.50	0.50	ug/L	EPA 8260B	9/16/00
Toluene	< 0.50	0.50	ug/L	EPA 8260B	9/16/00
Ethylbenzene	< 0.50	0.50	ug/L	EPA 8260B	9/16/00
Total Xylenes	< 0.50	0.50	ug/L	EPA 8260B	9/16/00
Methyl-t-butyl ether	11	5.0	ug/L	EPA 8260B	9/16/00
TPH as Gasoline	< 50	50	ug/L	EPA 8260B	9/16/00
Toluene - d8 (Surr)	100		% Recovery	EPA 8260B	9/16/00
4-Bromofluorobenzene (Surr)	103		% Recovery	EPA 8260B	9/16/00

Approved By: Joel Kiff



Ultramar Inc.
CHAIN OF CUSTODY REPORT

17730

BEACON

Beacon Station No. 721		Sampler (Print Name) <i>Edgar Alberto</i>			ANALYSES				Date 9-6-00	Form No. 1 of 1
Project No. 721		Sampler (Signature) <i>[Signature]</i>			BTEX	TPH (gasoline)	TPH (diesel)	No. of Containers	STANDARD TAT	
Project Location SAN LORENZO		Affiliation DOULOS							REMARKS	
Sample No./Identification	Date	Time	Lab No.							
MW-1	9-6-00	9:52	-01	X	X		3			
MW-2		10:21	-02							
MW-3		9:31	-03							
MW-10		9:11	-04							
RW-1	✓	10:05	-05				1			
Relinquished by: (Signature/Affiliation) <i>[Signature] DOULOS</i>		Date	Time	Received by: (Signature/Affiliation)				Date	Time	
Relinquished by: (Signature/Affiliation)		Date	Time	Received by: (Signature/Affiliation)				Date	Time	
Relinquished by: (Signature/Affiliation)		Date	Time	Received by: (Signature/Affiliation) <i>Osama Albehary / KIPA Analytical</i>				Date 09/10	Time 1932	
Report To: <i>DELTA</i>				Bill to: ULTRAMAR INC. 525 West Third Street Hanford, CA 93230 Attention: <i>JOE ALDRIDGE</i>						

WHITE: Return to Client with Report

YELLOW: Laboratory Copy

PINK: Originator Copy