

**Weiss Associates**
*Environmental and Geologic Services*

5500 Shellmound Street, Emeryville, CA 94608-2411

Fax: 510-547-5043 Phone: 510-547-5420

## FAX TRANSMITTAL

DATE: 12/8/92

TO: JENNIFER EBERLE

FAX PHONE: 271-4320

 COMPANY: ALAMEDA COUNTY  
DEPT OF ENV HEALTH

BUSINESS PHONE: 568-3706

FROM: TOM FOJUT

PROJECT #: 81-463-100

 SUBJECT: STID #1107  
SHELL SERVICE STATION  
29 WILDWOOD AV  
PIEDMONT

 # PAGES 2  
(including this cover)

 Hard Copy to follow  
if checked

### COMMENTS & ACTIONS REQUIRED:

As you requested, here is a map with our proposed well location. We chose this location because it:

- is free of underground utility lines,
- will not require diverting automobile or pedestrian traffic during drilling and sampling the well,
- is far enough away from the street gutter to minimize surface water intrusion into the well,
- will not require blocking a nearby fire hydrant while drilling or sampling the well, and
- will allow sampling of the well without blocking the bus stop.

Please call Scott MacLeod or me if you have any questions or comments.

NOTE: Please call PAUL at (510) 547-5420 if you do not receive all pages

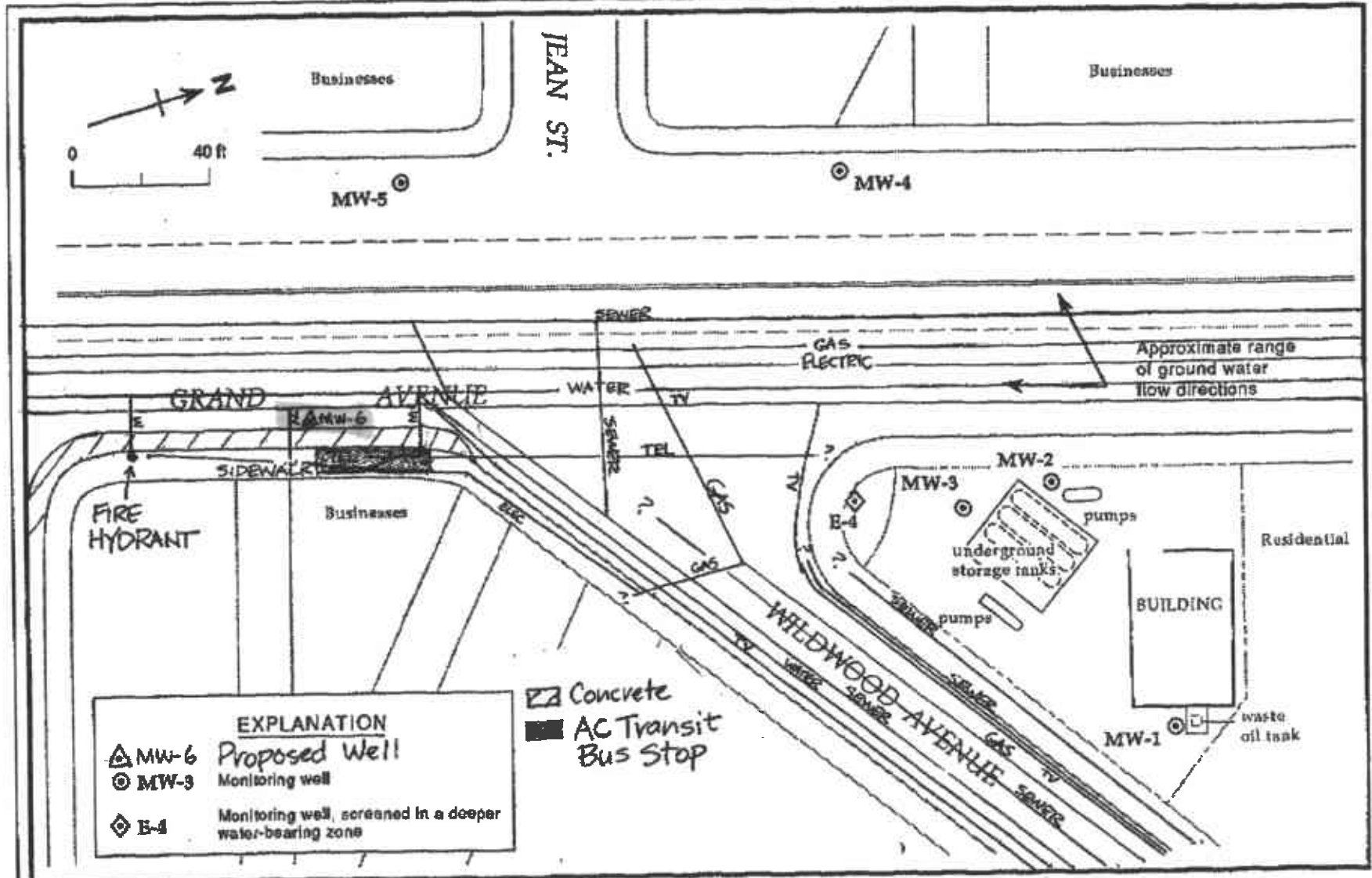

Proposed Well Location and  
 Figure 1. Underground Utilities- Shell Service Station, WIC #204-6001-0109, 29 Wildwood Avenue, Piedmont, California