

R04956



Denis L. Brown

Shell Oil Products US

August 18, 2005

HSE - Environmental Services  
20945 S. Wilmington Ave.  
Carson, CA 90810-1039  
Tel (707) 865 0251  
Fax (707) 865 2542  
Email [denis.l.brown@shell.com](mailto:denis.l.brown@shell.com)

Jerry Wickham  
Alameda County Health Care Services Agency  
1131 Harbor Bay Parkway, Suite 250  
Alameda, CA 94502-6577

Alameda County  
AUG 23 2005  
Environmental Health

Re: Third Quarter 2005 Monitoring Report  
Shell-branded Service Station  
29 Wildwood Avenue  
Piedmont, California  
SAP Code 135765  
Incident No. 98995822

Dear Mr. Wickham:

Attached for your review and comment is a copy of the *Third Quarter 2005 Monitoring Report* for the above referenced site. Upon information and belief, I declare, under penalty of perjury, that the information contained in the attached document is true and correct.

If you have any questions or concerns, please call me at (707) 865-0251.

Sincerely,

Denis L. Brown  
Sr. Environmental Engineer

August 18, 2005

Jerry Wickham  
Alameda County Health Care Services Agency  
1131 Harbor Bay Parkway, Suite 250  
Alameda, California 94502-6577

Re: **Third Quarter 2005 Monitoring Report**  
Shell-branded Service Station  
29 Wildwood Avenue  
Piedmont, California  
Incident #98995822  
Cambria Project# 247-0687-002

Alameda County  
AUG 23 2005  
Environmental Health



Dear Mr. Wickham:

On behalf of Equilon Enterprises LLC dba Shell Oil Products US (Shell), Cambria Environmental Technology, Inc. (Cambria) is submitting this groundwater monitoring report in accordance with the reporting requirements of 23 CCR 2652d.

## THIRD QUARTER 2005 ACTIVITIES

**Groundwater Monitoring:** Blaine Tech Services, Inc. (Blaine) of San Jose, California measured dissolved oxygen (DO) concentrations, gauged and sampled all site wells, calculated groundwater elevations, and compiled the analytical data. Cambria prepared a vicinity map that includes previously submitted well survey information (Figure 1) and a groundwater elevation contour map (Figure 2). Blaine's report, presenting the laboratory report and supporting field documents, is included as Attachment A.

**Additional Oxygenate Analysis:** The Alameda County Health Care Services Agency's (ACHCSA) May 16, 2003 letter directed Shell to continue analyzing all groundwater monitoring samples for the fuel oxygenates methyl tertiary butyl ether (MTBE), tert amyl methyl ether (TAME), ethyl tert butyl ether (ETBE), di-isopropyl ether (DIPE), and tert butyl alcohol (TBA) by EPA Method 8260 until further notice. Beginning fourth quarter 2002, groundwater samples from all monitoring wells were analyzed on five occasions for four additional oxygenates (TAME, ETBE, DIPE, TBA) in addition to the regular analysis for total petroleum hydrocarbons as gasoline, benzene, toluene, ethylbenzene, total xylenes, and MTBE. Results for the off-site wells MW-4 and MW-5 were below detection limits for TAME, ETBE, DIPE, and TBA for all

Cambria  
Environmental  
Technology, Inc.

5900 Hollis Street  
Suite A  
Emeryville, CA 94608  
Tel (510) 420-0700  
Fax (510) 420-9170

five events. Therefore, as recommended in the *First Quarter 2004 Monitoring Report*, Cambria discontinued analysis for these oxygenate in samples collected from off-site wells MW-4 and MW-5.

During third quarter 2005, all samples were analyzed for MTBE, and samples from wells MW-1, MW-2, and MW-3 were also analyzed for ETBE, DIPE, and TBA. Of the target analytes, only TBA and MTBE were detected in the sampled wells. TBA was detected in wells MW-2 and MW-3 at concentrations of 13 parts per billion (ppb) and 240 ppb, respectively. MTBE was detected in wells MW-2, MW-3, and MW-5 at concentrations of 120 ppb, 100 ppb, and 0.56 ppb, respectively.



The October 2001 and July 2003 samples from wells MW-2 and MW-3 were also analyzed for ethanol. Ethanol was previously detected only in MW-2. The MW-2 ethanol results were 150,000 ppb in October 2001 and 7,000 ppb in July 2003. In third quarter 2005, samples from MW-2 and MW-3 were analyzed for ethanol, and results were below laboratory detection limits.

#### **ANTICIPATED FOURTH QUARTER 2005 ACTIVITIES**

***Groundwater Monitoring:*** Blaine will measure DO, gauge and sample all site wells, and tabulate the data.

***Site Conceptual Model Update:*** Cambria will submit an updated site conceptual model to ACHCSA during fourth quarter 2005.

**CLOSING**

We appreciate the opportunity to work with you on this project. Please call David Gibbs at (510) 420-3363 if you have any questions or comments.

Sincerely,  
**Cambria Environmental Technology, Inc**



David M. Gibbs, P.G.  
Project Geologist

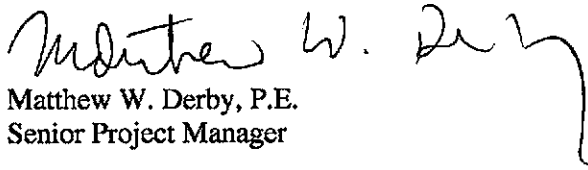

Matthew W. Derby, P.E.  
Senior Project Manager

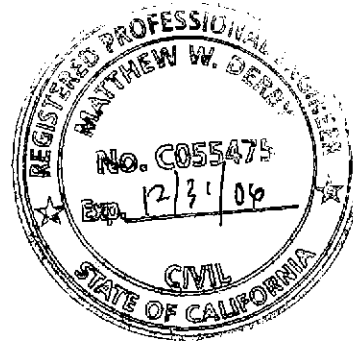

Figures: 1 - Vicinity/Area Well Survey Map  
2 - Groundwater Elevation Contour Map

Attachment: A - Blaine Groundwater Monitoring Report and Field Notes

cc: Denis Brown, Shell Oil Products US, 20945 S. Wilmington Ave., Carson, CA 90810

G:\Piedmont 29 Wildwood\QM\3q05\3q05qm.doc

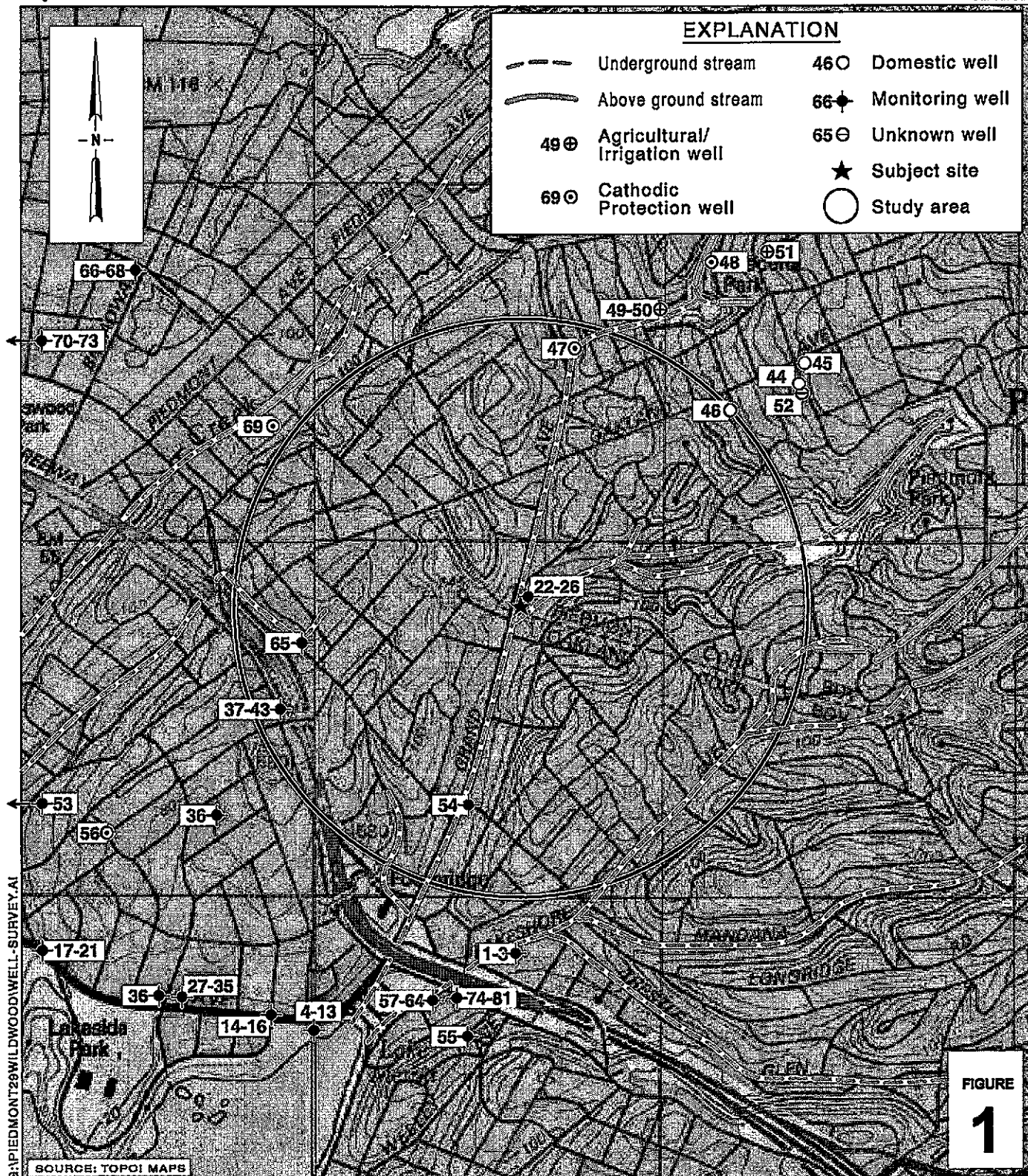

**Shell-branded Service Station**  
 29 Wildwood Avenue  
 Piedmont, California  
 Incident #98995822



C A M B R I A

**Vicinity/Area Well Survey Map**

1/2 Mile Radius



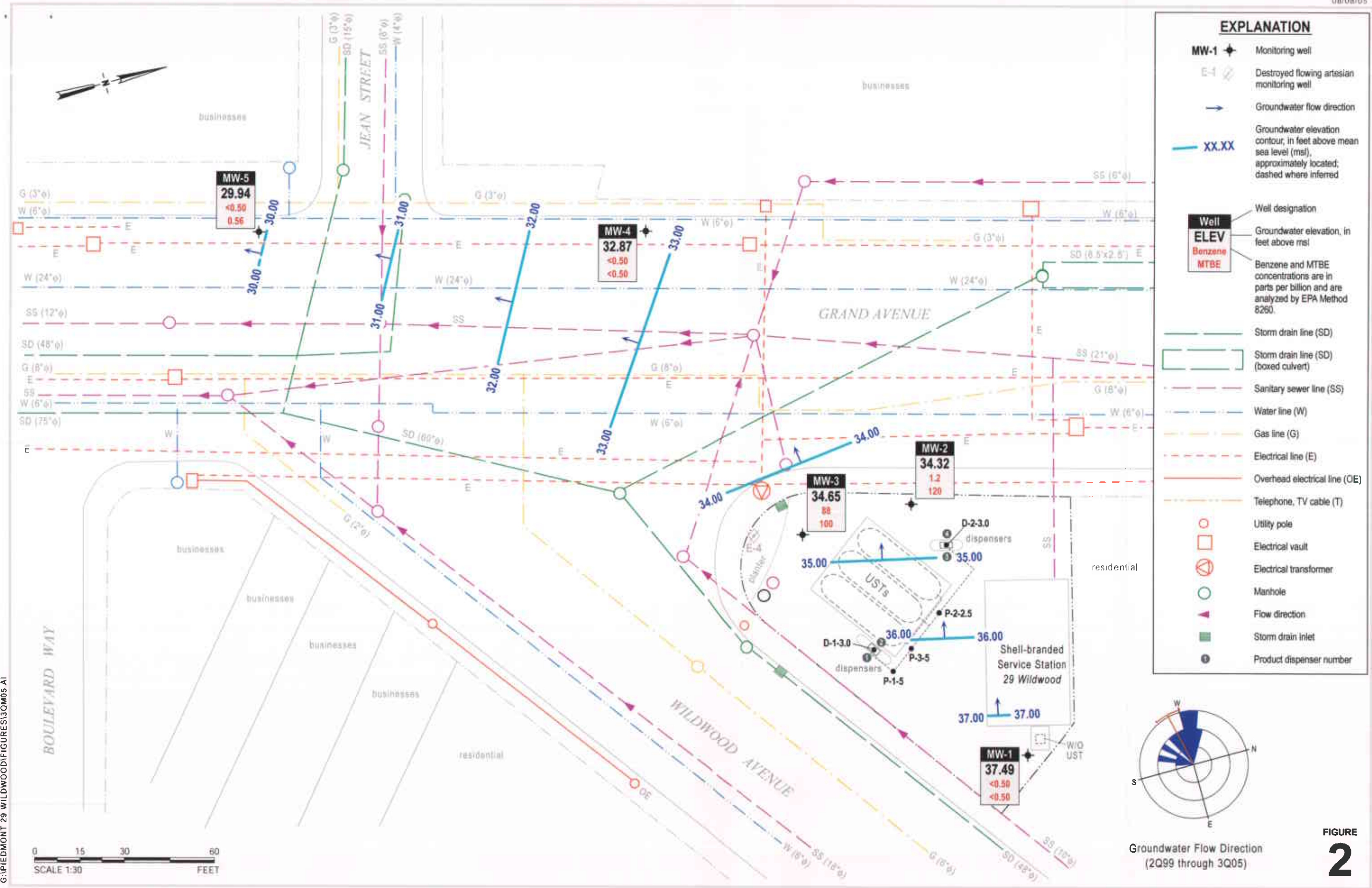

**Groundwater Elevation Contour Map**

July 19, 2005



C A M B R I A

**Shell-branded Service Station**

29 Wildwood Avenue  
Piedmont, California  
Incident No. 98995822

**FIGURE 2**

G:\PIEDMONT 29 WILDWOOD\FIGURES\3Q05 A1

**ATTACHMENT A**  
**Blaine Groundwater Monitoring Report**  
**and Field Notes**





Blaine Tech Services, Inc. conducts sampling and documentation assignments of this type as an independent third party. Our activities at this site consisted of objective data and sample collection only. No interpretation of analytical results, defining of hydrological conditions or formulation of recommendations was performed.

Please call if you have any questions.

Yours truly,

Leon Gearhart  
Project Coordinator

LG/ks

attachments: Cumulative Table of WELL CONCENTRATIONS  
Certified Analytical Report  
Field Data Sheets

cc: Anni Kreml  
Cambria Environmental Technology, Inc.  
5900 Hollis Street, Suite A  
Emeryville, CA 94608

**WELL CONCENTRATIONS**  
**Shell-branded Service Station**  
**29 Wildwood Avenue**  
**Piedmont, CA**

Well ID	Date	TPPH (ug/L)	B (ug/L)	T (ug/L)	E (ug/L)	X (ug/L)	MTBE 8020 (ug/L)	MTBE 8260 (ug/L)	DIPE (ug/L)	ETBE (ug/L)	TAME (ug/L)	TBA (ug/L)	Ethanol (ug/L)	1,2-DCA (ug/L)	EDB (ug/L)	TOC (MSL)	Depth to Water (ft.)	GW Elevation (MSL)	DO Reading (ppm)
MW-1	07/12/1989	<50	<0.5	<1	<1	<3	NA	NA	NA	NA	NA	NA	NA	NA	NA	37.96	2.76	35.20	NA
MW-1	01/30/1990	<50	<0.5	<0.5	<0.5	<0.5	NA	NA	NA	NA	NA	NA	NA	NA	NA	37.96	3.10	34.86	NA
MW-1	04/27/1990	<50	<0.5	<0.5	<0.5	<0.5	NA	NA	NA	NA	NA	NA	NA	NA	NA	37.96	3.24	34.72	NA
MW-1	07/31/1990	<50	<0.5	<0.5	<0.5	<0.5	NA	NA	NA	NA	NA	NA	NA	NA	NA	37.96	4.26	33.70	NA
MW-1	10/30/1990	<50	<0.5	<0.5	<0.5	<0.5	NA	NA	NA	NA	NA	NA	NA	NA	NA	37.96	4.25	33.71	NA
MW-1	01/31/1991	<50	<0.5	<0.5	<0.5	<0.5	NA	NA	NA	NA	NA	NA	NA	NA	NA	37.96	3.66	34.30	NA
MW-1	04/30/1991	<50	0.8	<0.5	0.6	1.2	NA	NA	NA	NA	NA	NA	NA	NA	NA	37.96	3.46	34.50	NA
MW-1	07/30/1991	<50	<0.5	<0.5	<0.5	<0.5	NA	NA	NA	NA	NA	NA	NA	NA	NA	37.96	4.14	33.82	NA
MW-1	10/29/1991	<50	<0.5	<0.5	<0.5	<0.5	NA	NA	NA	NA	NA	NA	NA	NA	NA	37.96	3.96	34.00	NA
MW-1	01/20/1992	<30	<0.3	<0.3	<0.3	<0.3	NA	NA	NA	NA	NA	NA	NA	NA	NA	37.96	3.59	34.37	NA
MW-1	04/14/1992	<50	<0.5	<0.5	<0.5	<0.5	NA	NA	NA	NA	NA	NA	NA	NA	NA	37.96	3.18	31.71	NA
MW-1	07/21/1992	<50	<0.5	<0.5	<0.5	<0.5	NA	NA	NA	NA	NA	NA	NA	NA	NA	37.96	4.17	33.79	NA
MW-1	10/02/1992	<50	<0.5	<0.5	<0.5	<0.5	NA	NA	NA	NA	NA	NA	NA	NA	NA	37.96	4.29	33.67	NA
MW-1	01/20/1993	<50	<0.5	<0.5	<0.5	<0.5	NA	NA	NA	NA	NA	NA	NA	NA	NA	37.96	2.32	35.64	NA
MW-1	05/03/1993	<50	<0.5	<0.5	<0.5	<0.5	NA	NA	NA	NA	NA	NA	NA	NA	NA	37.96	3.50	34.46	1.9
MW-1	06/28/1993	NA	NA	NA	NA	NA	NA	NA	NA	NA	NA	NA	NA	NA	NA	37.96	3.76	34.20	NA
MW-1	07/21/1993	<50	<0.5	<0.5	<0.5	<0.5	NA	NA	NA	NA	NA	NA	NA	NA	NA	37.96	4.09	33.87	4.6
MW-1	10/19/1993	50	<0.5	<0.5	<0.5	<0.5	NA	NA	NA	NA	NA	NA	NA	NA	NA	37.96	3.58	34.38	4.3
MW-1	01/20/1994	Well inaccessible		NA	NA	NA	NA	NA	NA	NA	NA	NA	NA	NA	NA	37.96	NA	NA	NA
MW-1	04/12/1994	<50	<0.5	<0.5	<0.5	<0.5	NA	NA	NA	NA	NA	NA	NA	NA	NA	37.96	3.60	34.36	7.5
MW-1	07/20/1994	<50	<0.5	<0.5	<0.5	<0.5	NA	NA	NA	NA	NA	NA	NA	NA	NA	37.96	4.10	33.86	3.2
MW-1	10/06/1994	<50	<0.5	<0.5	<0.5	<0.5	NA	NA	NA	NA	NA	NA	NA	NA	NA	37.96	4.30	33.66	3.2
MW-1	01/20/1995	<50	<0.5	<0.5	<0.5	<0.5	NA	NA	NA	NA	NA	NA	NA	NA	NA	37.96	2.94	35.02	10.6
MW-1	07/06/1995	<50	<0.5	<0.5	<0.5	<0.5	NA	NA	NA	NA	NA	NA	NA	NA	NA	37.96	3.68	34.28	NA
MW-1	01/24/1996	<50	<0.5	<0.5	<0.5	<0.5	NA	NA	NA	NA	NA	NA	NA	NA	NA	37.96	2.12	35.84	NA
MW-1	07/12/1996	<50	<0.5	<0.5	<0.5	<0.5	<2.5	NA	NA	NA	NA	NA	NA	NA	NA	37.96	3.58	34.38	2.7
MW-1	01/16/1997	120	14	10	3.6	14	<2.5	NA	NA	NA	NA	NA	NA	NA	NA	37.96	2.30	35.66	3
MW-1	10/24/1997	<50	<0.50	<0.50	<0.50	<0.50	8.6	NA	NA	NA	NA	NA	NA	NA	NA	37.96	3.66	34.30	4.5
MW-1	05/13/1998	<50	<0.50	<0.50	<0.50	<0.50	<2.5	NA	NA	NA	NA	NA	NA	NA	NA	37.96	2.81	35.15	5.1
MW-1	10/01/1998	<50	<0.50c	<0.50c	<0.50c	<0.50c	<2.5c	NA	NA	NA	NA	NA	NA	NA	NA	37.96	3.75	34.21	5.0

**WELL CONCENTRATIONS**  
**Shell-branded Service Station**  
**29 Wildwood Avenue**  
**Piedmont, CA**

Well ID	Date	TPPH (ug/L)	B (ug/L)	T (ug/L)	E (ug/L)	X (ug/L)	MTBE 8020 (ug/L)	MTBE 8260 (ug/L)	DIPE (ug/L)	ETBE (ug/L)	TAME (ug/L)	TBA (ug/L)	Ethanol (ug/L)	1,2-DCA (ug/L)	EDB (ug/L)	TOC (MSL)	Depth to Water (ft.)	GW Elevation (MSL)	DO Reading (ppm)
MW-1	04/29/1999	<50	<0.50	<0.50	<0.50	<0.50	<2.5	NA	NA	NA	NA	NA	NA	NA	NA	37.96	3.52	34.44	4.1
MW-1	11/01/1999	<50.0	<0.500	<0.500	<0.500	<0.500	5.03	NA	NA	NA	NA	NA	NA	NA	NA	37.96	4.05	33.91	3.6
MW-1	04/06/2000	<50.0	<0.500	<0.500	<0.500	<0.500	3.22	NA	NA	NA	NA	NA	NA	NA	NA	37.96	3.74	34.22	4.2
MW-1	10/30/2000	<50.0	<0.500	<0.500	<0.500	<0.500	<2.50	NA	NA	NA	NA	NA	NA	NA	NA	37.96	2.19	35.77	4.1
MW-1	04/27/2001	<50.0	<0.500	<0.500	<0.500	<0.500	<2.50	NA	NA	NA	NA	NA	NA	NA	NA	37.96	4.43	33.53	1.9
MW-1	10/31/2001	<50	<0.50	<0.50	<0.50	<0.50	NA	<5.0	NA	NA	NA	NA	NA	NA	NA	37.96	4.34	33.62	2.4
MW-1	05/09/2002	Well inaccessible		NA	NA	NA	NA	NA	NA	NA	NA	NA	NA	NA	NA	37.96	NA	NA	NA
MW-1	07/25/2002	<50	<0.50	<0.50	<0.50	<0.50	NA	<5.0	NA	NA	NA	NA	NA	NA	NA	37.96	3.53	34.43	1.2
MW-1	10/23/2002	<50	<0.50	<0.50	<0.50	<0.50	NA	<0.50	<2.0	<2.0	<2.0	<50	NA	<2.0	<2.0	40.94	3.68	37.26	3.5
MW-1	01/22/2003	Well inaccessible		NA	NA	NA	NA	NA	NA	NA	NA	NA	NA	NA	NA	40.94	NA	NA	NA
MW-1	01/29/2003	<50	<0.50	<0.50	<0.50	<0.50	NA	<5.0	NA	NA	NA	NA	NA	NA	NA	40.94	3.25	37.69	3.7
MW-1	04/30/2003	<50	<0.50	<0.50	<0.50	<1.0	NA	<5.0	NA	NA	NA	NA	NA	NA	NA	40.94	2.76	38.18	3.6
MW-1	07/14/2003	<50	<0.50	<0.50	<0.50	<1.0	NA	<1.4	<2.0	<2.0	<2.0	<5.0	NA	NA	NA	40.94	3.15	37.79	0.5
MW-1	10/23/2003	<50	<0.50	<0.50	<0.50	<1.0	NA	0.64	<2.0	<2.0	<2.0	<5.0	NA	NA	NA	40.94	3.82	37.12	3.9
MW-1	01/05/2004	<50	<0.50	<0.50	<0.50	<1.0	NA	<0.50	<2.0	<2.0	<2.0	<5.0	NA	NA	NA	40.94	3.39	37.55	1.8
MW-1	04/14/2004	<50	<0.50	<0.50	<0.50	<1.0	NA	<0.50	<2.0	<2.0	<2.0	<5.0	NA	NA	NA	40.94	3.43	37.51	4.5
MW-1	07/13/2004	<50	<0.50	<0.50	0.53	1.4	NA	<0.50	<2.0	<2.0	<2.0	<5.0	NA	NA	NA	40.94	3.70	37.24	2.5
MW-1	10/25/2004	<50	<0.50	<0.50	<0.50	<1.0	NA	<0.50	<2.0	<2.0	<2.0	<5.0	NA	NA	NA	40.94	3.60	37.34	5.45
MW-1	01/06/2005	<50	<0.50	<0.50	<0.50	<1.0	NA	<0.50	<2.0	<2.0	<2.0	<5.0	NA	NA	NA	40.94	2.90	38.04	1.5
MW-1	05/19/2005	<50	<0.50	<0.50	<0.50	1.2	NA	<0.50	<2.0	<2.0	<2.0	<5.0	NA	NA	NA	40.94	3.35	37.59	1.2
MW-1	07/19/2005	<50	<0.50	<0.50	<0.50	1.3	NA	<0.50	<2.0	<2.0	<2.0	<5.0	NA	NA	NA	40.94	3.45	37.49	NA
MW-2	07/12/1989	60	2.7	<1	<1	<3	NA	NA	NA	NA	NA	NA	NA	NA	NA	34.89	3.66	31.23	NA
MW-2	01/30/1990	<50	6.6	<0.5	0.54	0.93	NA	NA	NA	NA	NA	NA	NA	NA	NA	34.89	3.49	31.40	NA
MW-2	04/27/1990	60	2.1	<0.5	<0.5	<0.5	NA	NA	NA	NA	NA	NA	NA	NA	NA	34.89	3.79	31.10	NA
MW-2	07/31/1990	70	1.5	<0.5	<0.5	<0.5	NA	NA	NA	NA	NA	NA	NA	NA	NA	34.89	4.03	30.86	NA
MW-2	10/30/1990	70	<0.5	0.7	<0.5	1.6	NA	NA	NA	NA	NA	NA	NA	NA	NA	34.89	4.21	30.68	NA
MW-2	01/31/1991	80	<0.5	<0.5	0.9	1.9	NA	NA	NA	NA	NA	NA	NA	NA	NA	34.89	4.09	30.80	NA
MW-2	04/30/1991	100	5.9	0.6	0.7	2	NA	NA	NA	NA	NA	NA	NA	NA	NA	34.89	3.95	30.94	NA
MW-2	07/30/1991	<50	<0.5	<0.7	<0.5	<0.5	NA	NA	NA	NA	NA	NA	NA	NA	NA	34.89	4.07	30.82	NA
MW-2	10/29/1991	<50	<0.5	<0.5	<0.5	<0.5	NA	NA	NA	NA	NA	NA	NA	NA	NA	34.89	4.11	30.78	NA

**WELL CONCENTRATIONS**  
**Shell-branded Service Station**  
**29 Wildwood Avenue**  
**Piedmont, CA**

Well ID	Date	TPPH (ug/L)	B (ug/L)	T (ug/L)	E (ug/L)	X (ug/L)	MTBE 8020 (ug/L)	MTBE 8260 (ug/L)	DIPE (ug/L)	ETBE (ug/L)	TAME (ug/L)	TBA (ug/L)	Ethanol (ug/L)	1,2-DCA (ug/L)	EDB (ug/L)	TOC (MSL)	Depth to Water (ft.)	GW Elevation (MSL)	DO Reading (ppm)
MW-2	01/20/1992	<30	0.84	<0.3	<0.41	<0.48	NA	NA	NA	NA	NA	NA	NA	NA	NA	34.89	3.86	31.03	NA
MW-2	04/14/1992	70	16	<0.5	3.1	2.1	NA	NA	NA	NA	NA	NA	NA	NA	NA	34.89	3.66	34.30	NA
MW-2	07/21/1992	<50	<0.5	<0.5	<0.5	<0.5	NA	NA	NA	NA	NA	NA	NA	NA	NA	34.89	3.92	30.97	NA
MW-2	10/02/1992	<50	<0.5	<0.5	<0.5	<0.5	NA	NA	NA	NA	NA	NA	NA	NA	NA	34.89	4.45	30.44	NA
MW-2	01/20/1993	<50	3.8	<0.5	0.52	<0.5	NA	NA	NA	NA	NA	NA	NA	NA	NA	34.89	3.74	31.15	NA
MW-2	05/03/1993	680a	2.8	<0.5	<0.5	<0.5	NA	NA	NA	NA	NA	NA	NA	NA	NA	34.89	3.77	31.12	0.9
MW-2	06/28/1993	NA	NA	NA	NA	NA	NA	NA	NA	NA	NA	NA	NA	NA	NA	34.89	3.96	30.93	NA
MW-2	07/21/1993	<50	8	1.2	1.8	7.9	NA	NA	NA	NA	NA	NA	NA	NA	NA	34.89	4.39	30.50	5.9
MW-2	10/19/1993	<50	<0.5	<0.5	<0.5	<0.5	NA	NA	NA	NA	NA	NA	NA	NA	NA	34.89	3.92	30.97	5.7
MW-2	01/20/1994	<50	1.5	<0.5	<0.5	<0.5	NA	NA	NA	NA	NA	NA	NA	NA	NA	34.89	4.45	30.44	3.2
MW-2	04/12/1994	<50	2.9	<0.5	<0.5	<0.5	NA	NA	NA	NA	NA	NA	NA	NA	NA	34.89	4.72	30.17	11.4
MW-2	07/20/1994	<50	<0.5	<0.5	<0.5	<0.5	NA	NA	NA	NA	NA	NA	NA	NA	NA	34.89	5.32	29.57	2.4
MW-2	10/06/1994	<50	<0.5	<0.5	<0.5	<0.5	NA	NA	NA	NA	NA	NA	NA	NA	NA	34.89	4.03	30.86	2.9
MW-2	01/20/1995	290	28	<0.5	<0.5	<0.5	NA	NA	NA	NA	NA	NA	NA	NA	NA	34.89	3.89	31.00	4.6
MW-2	07/06/1995	120	3	<0.5	<0.5	<0.5	NA	NA	NA	NA	NA	NA	NA	NA	NA	34.89	8.84	26.05	NA
MW-2	01/24/1996	70	3.1	<0.5	0.8	1.5	NA	NA	NA	NA	NA	NA	NA	NA	NA	34.89	3.80	31.09	NA
MW-2 (D)	01/24/1996	70	3.2	0.5	0.7	1.5	NA	NA	NA	NA	NA	NA	NA	NA	NA	34.89	NA	NA	NA
MW-2	07/12/1996	<50	0.68	<0.5	<0.5	<0.5	270	NA	NA	NA	NA	NA	NA	NA	NA	34.89	3.85	31.04	3.8
MW-2	01/16/1997	230	34	1.6	1.6	4.2	460	NA	NA	NA	NA	NA	NA	NA	NA	34.89	3.84	31.05	NA
MW-2	10/24/1997	<50	<0.50	<0.50	<0.50	<0.50	54	NA	NA	NA	NA	NA	NA	NA	NA	34.89	3.75	31.14	2.9
MW-2	05/13/1998	NA	NA	NA	NA	NA	NA	NA	NA	NA	NA	NA	NA	NA	NA	34.89	3.78	31.11	NA
MW-2	10/01/1998	<50	<0.50c	<0.50c	<0.50c	<0.50c	100	NA	NA	NA	NA	NA	NA	NA	NA	34.89	4.90	29.99	3.0
MW-2	04/29/1999	NA	NA	NA	NA	NA	NA	NA	NA	NA	NA	NA	NA	NA	NA	34.89	4.69	30.20	NA
MW-2	11/01/1999	<50.0	<0.500	1.29	0.669	4.52	7.21	NA	NA	NA	NA	NA	NA	NA	NA	34.89	5.24	29.65	2.9
MW-2	04/05/2000	376d	68.1d	3.10d	2.88d	5.35d	729d	NA	NA	NA	NA	NA	NA	NA	NA	34.89	3.43	31.46	3.6
MW-2	10/30/2000	5,790	59.2	315	162	1320	346	NA	NA	NA	NA	NA	NA	NA	NA	34.89	2.35	32.54	2.8
MW-2	04/27/2001	2,720	90.8	22.8	18.1	165	512	578	NA	NA	NA	NA	NA	NA	NA	34.89	4.67	30.22	0.9
MW-2	10/31/2001	<10,000	<100	<100	<100	<100	NA	<100	<100	<100	<100	<1,000	150,000	NA	NA	34.89	3.68	31.21	1.3
MW-2	05/09/2002	490	1.5	7.8	2.1	14	NA	200	NA	NA	NA	NA	NA	NA	NA	34.89	3.18	31.71	1.1
MW-2	07/25/2002	1,200	1.0	3.3	1.3	8.3	NA	45	NA	NA	NA	NA	NA	NA	NA	34.89	3.30	31.59	0.4
MW-2	10/23/2002	1,100	0.85	3.8	1.3	7.9	NA	140	<2.0	<2.0	<2.0	<50	NA	<2.0	<2.0	37.87	3.87	34.00	0.8

**WELL CONCENTRATIONS**  
**Shell-branded Service Station**  
**29 Wildwood Avenue**  
**Piedmont, CA**

Well ID	Date	TPPH (ug/L)	B (ug/L)	T (ug/L)	E (ug/L)	X (ug/L)	MTBE 8020 (ug/L)	MTBE 8260 (ug/L)	DIPE (ug/L)	ETBE (ug/L)	TAME (ug/L)	TBA (ug/L)	Ethanol (ug/L)	1,2-DCA (ug/L)	EDB (ug/L)	TOC (MSL)	Depth to Water (ft.)	GW Elevation (MSL)	DO Reading (ppm)
MW-2	01/22/2003	730	<0.50	100	0.96	5.4	NA	230	NA	NA	NA	NA	NA	NA	NA	37.87	2.68	35.19	1.5
MW-2	04/30/2003	<500	<5.0	23	<5.0	<10	NA	410	NA	NA	NA	NA	NA	NA	NA	37.87	3.42	34.45	0.1
MW-2	07/14/2003	<800	1.2	59	1.4	9.8	NA	60	<2.0	<2.0	<2.0	8.6	7,000	NA	NA	37.87	3.50	34.37	1.1
MW-2	10/23/2003	2,000	1.7	0.88	1.5	<1.0	NA	0.98	<2.0	<2.0	<2.0	<5.0	<50	NA	NA	37.87	5.08	32.79	0.8
MW-2	01/05/2004	240	<0.50	8.3	<0.50	1.8	NA	64	<2.0	<2.0	<2.0	<5.0	<50	NA	NA	37.87	2.59	35.28	0.4
MW-2	04/14/2004	81	4.8	10	1.0	5.3	NA	170	<2.0	<2.0	<2.0	9.7	<50	NA	NA	37.87	4.15	33.72	0.2
MW-2	07/13/2004	280	1.1	44	2.4	10	NA	85	<2.0	<2.0	<2.0	5.1	<50	NA	NA	37.87	4.20	33.67	0.1
MW-2	10/25/2004	150	0.75	13	1.3	6.3	NA	41	<2.0	<2.0	<2.0	5.1	<50	NA	NA	38.32	4.65	33.67	3.30
MW-2	01/06/2005	180	7.1	4.3	0.79	3.3	NA	120	<2.0	<2.0	<2.0	14	<50	NA	NA	38.32	3.30	35.02	0.5
MW-2	05/19/2005	130	<0.50	4.4	0.90	4.0	NA	16	<2.0	<2.0	<2.0	<5.0	<50	NA	NA	38.32	4.00	34.32	0.5
<b>MW-2</b>	<b>07/19/2005</b>	<b>60</b>	<b>1.2</b>	<b>0.70</b>	<b>&lt;0.50</b>	<b>1.2</b>	<b>NA</b>	<b>120</b>	<b>&lt;2.0</b>	<b>&lt;2.0</b>	<b>&lt;2.0</b>	<b>13</b>	<b>&lt;50</b>	<b>NA</b>	<b>NA</b>	<b>38.32</b>	<b>4.00</b>	<b>34.32</b>	<b>1.64</b>
MW-3	07/12/1989	3,900	380	41	99	30	NA	NA	NA	NA	NA	NA	NA	NA	NA	35.00	3.83	31.17	NA
MW-3	01/30/1990	5,500	440	35	79	130	NA	NA	NA	NA	NA	NA	NA	NA	NA	35.00	3.24	31.76	NA
MW-3	04/27/1990	4,500	310	26	37	110	NA	NA	NA	NA	NA	NA	NA	NA	NA	35.00	4.02	30.98	NA
MW-3	07/31/1990	3,500	210	17	8.4	62	NA	NA	NA	NA	NA	NA	NA	NA	NA	35.00	4.31	30.69	NA
MW-3	10/30/1990	2,300	610	<0.5	<0.5	28	NA	NA	NA	NA	NA	NA	NA	NA	NA	35.00	4.52	30.48	NA
MW-3	01/31/1991	4,100	300	20	19	81	NA	NA	NA	NA	NA	NA	NA	NA	NA	35.00	4.33	30.67	NA
MW-3	04/30/1991	3,800	370	19	8.6	60	NA	NA	NA	NA	NA	NA	NA	NA	NA	35.00	3.79	31.21	NA
MW-3	07/30/1991	3,300	160	13	15	87	NA	NA	NA	NA	NA	NA	NA	NA	NA	35.00	4.37	30.63	NA
MW-3	10/29/1991	1,000	35	2.8	2.9	8.1	NA	NA	NA	NA	NA	NA	NA	NA	NA	35.00	4.00	31.00	NA
MW-3	01/20/1992	6,900	380	18	47	48	NA	NA	NA	NA	NA	NA	NA	NA	NA	35.00	3.87	31.13	NA
MW-3	04/14/1992	6,000	480	38	41	55	NA	NA	NA	NA	NA	NA	NA	NA	NA	35.00	3.15	31.85	NA
MW-3	07/21/1992	3,700	330	13	30	23	NA	NA	NA	NA	NA	NA	NA	NA	NA	35.00	4.17	30.83	NA
MW-3	10/02/1992	4,200	260	10	13	12	NA	NA	NA	NA	NA	NA	NA	NA	NA	35.00	4.43	30.57	NA
MW-3	01/20/1993	4,200	360	15	32	26	NA	NA	NA	NA	NA	NA	NA	NA	NA	35.00	2.20	32.80	NA
MW-3 (D)	01/20/1993	3,900	370	15	32	26	NA	NA	NA	NA	NA	NA	NA	NA	NA	35.00	NA	NA	NA
MW-3	05/03/1993	12,000	290	520	120	620	NA	NA	NA	NA	NA	NA	NA	NA	NA	35.00	3.50	31.50	0.6
MW-3	06/28/1993	NA	NA	NA	NA	NA	NA	NA	NA	NA	NA	NA	NA	NA	NA	35.00	4.08	30.92	NA
MW-3	07/21/1993	2,000	170	12	<10	11	NA	NA	NA	NA	NA	NA	NA	NA	NA	35.00	4.12	30.88	4.3
MW-3 (D)	07/21/1993	2,000	170	10	<10	14	NA	NA	NA	NA	NA	NA	NA	NA	NA	35.00	NA	NA	NA

**WELL CONCENTRATIONS**  
**Shell-branded Service Station**  
**29 Wildwood Avenue**  
**Piedmont, CA**

Well ID	Date	TPPH (ug/L)	B (ug/L)	T (ug/L)	E (ug/L)	X (ug/L)	MTBE 8020 (ug/L)	MTBE 8260 (ug/L)	DIPE (ug/L)	ETBE (ug/L)	TAME (ug/L)	TBA (ug/L)	Ethanol (ug/L)	1,2-DCA (ug/L)	EDB (ug/L)	TOC (MSL)	Depth to Water (ft.)	GW Elevation (MSL)	DO Reading (ppm)
MW-3	10/19/1993	2,000	240	<0.5	<0.5	<0.5	NA	NA	NA	NA	NA	NA	NA	NA	NA	35.00	4.20	30.80	5.7
MW-3	01/20/1994	4,200	280	<10	<10	<10	NA	NA	NA	NA	NA	NA	NA	NA	NA	35.00	4.08	30.92	4.1
MW-3 (D)	01/20/1994	3,800	250	<10	<10	<10	NA	NA	NA	NA	NA	NA	NA	NA	NA	35.00	NA	NA	4.1
MW-3	04/12/1994	4,700	380	<10	<10	<10	NA	NA	NA	NA	NA	NA	NA	NA	NA	35.00	3.70	31.30	10.6
MW-3 (D)	04/12/1994	3,400	370	<25	<25	<25	NA	NA	NA	NA	NA	NA	NA	NA	NA	35.00	NA	NA	NA
MW-3	07/20/1994	5,100	320	77	15	34	NA	NA	NA	NA	NA	NA	NA	NA	NA	35.00	4.26	30.74	2.3
MW-3 (D)	07/20/1994	4,400	250	14	13	32	NA	NA	NA	NA	NA	NA	NA	NA	NA	35.00	NA	NA	NA
MW-3	10/06/1994	4,300	280	9.7	4	15	NA	NA	NA	NA	NA	NA	NA	NA	NA	35.00	4.31	30.69	2.3
MW-3	01/20/1995	4,600	180	18	16	10	NA	NA	NA	NA	NA	NA	NA	NA	NA	35.00	3.00	32.00	11.1
MW-3 (D)	01/20/1995	4,300	170	12	15	7.2	NA	NA	NA	NA	NA	NA	NA	NA	NA	35.00	NA	NA	NA
MW-3	07/06/1995	3,900	310	<0.5	7.6	13	NA	NA	NA	NA	NA	NA	NA	NA	NA	35.00	3.75	31.25	NA
MW-3 (D)	07/06/1995	4,100	330	<0.5	7.9	2.4	NA	NA	NA	NA	NA	NA	NA	NA	NA	35.00	NA	NA	NA
MW-3	01/24/1996	5,000	210	14	14	12	NA	NA	NA	NA	NA	NA	NA	NA	NA	35.00	3.26	31.74	NA
MW-3	07/12/1996	2,700	210	<0.5	<0.5	<0.5	3,600	NA	NA	NA	NA	NA	NA	NA	NA	35.00	3.77	31.23	2.4
MW-3 (D)	07/12/1996	2,800	210	<0.5	<0.5	<0.5	3,400	NA	NA	NA	NA	NA	NA	NA	NA	35.00	NA	NA	2.4
MW-3	01/16/1997	4,200	130	19	10	34	4,400	4,600	NA	NA	NA	NA	NA	NA	NA	35.00	2.38	32.62	2.3
MW-3	10/24/1997	4,100	270	9	5.1	8.8	2,000	NA	NA	NA	NA	NA	NA	NA	NA	35.00	4.12	30.88	1.9
MW-3 (D)	10/24/1997	1,700	220	<5.0	<5.0	<5.0	1,500	NA	NA	NA	NA	NA	NA	NA	NA	35.00	NA	NA	1.9
MW-3	05/13/1998	NA	NA	NA	NA	NA	NA	NA	NA	NA	NA	NA	NA	NA	NA	35.00	3.22	31.78	NA
MW-3	10/01/1998	1,400	84c	<5.0c	<5.0c	<5.0c	2,300	NA	NA	NA	NA	NA	NA	NA	NA	35.00	4.15	30.85	2.0
MW-3 (D)	10/01/1998	2,100	100c	<10c	<10c	<10c	2,600	NA	NA	NA	NA	NA	NA	NA	NA	35.00	NA	NA	2.0
MW-3	04/29/1999	NA	NA	NA	NA	NA	NA	NA	NA	NA	NA	NA	NA	NA	NA	35.00	4.27	30.73	NA
MW-3	11/01/1999	1,850	94.3	6.09	<5.00	6.67	4,140	NA	NA	NA	NA	NA	NA	NA	NA	35.00	4.65	30.35	2.2
MW-3	04/05/2000	3,070	96.9	12.1	<10.0	<10.0	1,050	NA	NA	NA	NA	NA	NA	NA	NA	35.00	3.50	31.50	2.7
MW-3	10/30/2000	1,570	56.8	1.91	1.39	3.06	572	524	NA	NA	NA	NA	NA	NA	NA	35.00	3.40	31.60	3.1
MW-3	04/27/2001	2,420	103	12.6	<5.00	15.6	314	NA	NA	NA	NA	NA	NA	NA	NA	35.00	3.67	31.33	0.9
MW-3	10/31/2001	<50	0.71	<0.50	<0.50	<0.50	NA	31	<2.0	<2.0	<2.0	<50	<500	NA	NA	35.00	3.79	31.21	1.6
MW-3	05/09/2002	2,000	52	<10	<10	<10	NA	4,100	NA	NA	NA	NA	NA	NA	NA	35.00	3.76	31.24	0.9
MW-3	07/25/2002	1,800	50	<5.0	<5.0	<5.0	NA	1,900	NA	NA	NA	NA	NA	NA	NA	35.00	4.17	30.83	3.7
MW-3	10/23/2002	1,700	27	<5.0	<5.0	<5.0	NA	1,400	<5.0	<5.0	7.4	300	NA	<5.0	<5.0	37.97	4.36	33.61	1.6
MW-3	01/22/2003	1,800	38	2.4	1.5	2.4	NA	390	NA	NA	NA	NA	NA	NA	NA	37.97	3.09	34.88	1.3

**WELL CONCENTRATIONS**  
**Shell-branded Service Station**  
**29 Wildwood Avenue**  
**Piedmont, CA**

Well ID	Date	TPPH (ug/L)	B (ug/L)	T (ug/L)	E (ug/L)	X (ug/L)	MTBE 8020 (ug/L)	MTBE 8260 (ug/L)	DIPE (ug/L)	ETBE (ug/L)	TAME (ug/L)	TBA (ug/L)	Ethanol (ug/L)	1,2-DCA (ug/L)	EDB (ug/L)	TOC (MSL)	Depth to Water (ft.)	GW Elevation (MSL)	DO Reading (ppm)
MW-3	04/30/2003	3,300	56	5.2	<5.0	<10	NA	540	NA	NA	NA	NA	NA	NA	NA	37.97	3.39	34.58	1.5
MW-3	07/14/2003	1,000	20	2.7	<2.5	<5.0	NA	360	<10	<10	<10	72	<250	NA	NA	37.97	4.05	33.92	1.5
MW-3	10/23/2003	2,100	27	<5.0	<5.0	<10	NA	260	<20	<20	<20	<50	<500	NA	NA	37.97	4.32	33.65	1.0
MW-3	01/05/2004	2,800	91	6.0	<5.0	<10	NA	1,100	<20	<20	<20	450	510	NA	NA	37.97	1.89	36.08	1.8
MW-3	04/14/2004	3,400	47	<5.0	<5.0	<10	NA	360	<20	<20	<20	260	<500	NA	NA	37.97	3.64	34.33	3.6
MW-3	07/13/2004	2,300	21	<5.0	<5.0	<10	NA	210	<20	<20	<20	190	<500	NA	NA	37.97	4.27	33.70	2.7
MW-3	10/25/2004	1,600	21	<5.0	<5.0	<10	NA	190	<20	<20	<20	100	<500	NA	NA	37.97	3.87	34.10	3.65
MW-3	01/06/2005	2,300	46	4.3	2.9	5.8	NA	120	<8.0	<8.0	<8.0	480	<200	NA	NA	37.97	2.30	35.67	2.5
MW-3	05/19/2005	1,600	61	4.1	1.9	3.1	NA	110	<2.0	<2.0	<2.0	610	<50	NA	NA	37.97	3.44	34.53	1.1
<b>MW-3</b>	<b>07/19/2005</b>	<b>2,800</b>	<b>88</b>	<b>8.2</b>	<b>4.3</b>	<b>6.5</b>	<b>NA</b>	<b>100</b>	<b>&lt;10</b>	<b>&lt;10</b>	<b>&lt;10</b>	<b>240</b>	<b>&lt;250</b>	<b>NA</b>	<b>NA</b>	<b>37.97</b>	<b>3.32</b>	<b>34.65</b>	<b>3.08</b>
MW-4	01/30/1990	<50	<0.5	<0.5	<0.5	<0.5	NA	NA	NA	NA	NA	NA	NA	NA	NA	33.73	4.50	29.23	NA
MW-4	04/27/1990	130a	<0.5	<0.5	<0.5	<0.5	NA	NA	NA	NA	NA	NA	NA	NA	NA	33.73	3.62	30.11	NA
MW-4	07/31/1990	<50	<0.5	<0.5	<0.5	<0.5	NA	NA	NA	NA	NA	NA	NA	NA	NA	33.73	4.19	29.54	NA
MW-4	10/30/1990	<50	<0.5	<0.5	<0.5	<0.5	NA	NA	NA	NA	NA	NA	NA	NA	NA	33.73	4.19	29.54	NA
MW-4	01/31/1991	50a	<0.5	<0.5	<0.5	<0.5	NA	NA	NA	NA	NA	NA	NA	NA	NA	33.73	4.49	29.24	NA
MW-4	04/30/1991	<50	<0.5	<0.5	<0.5	<0.5	NA	NA	NA	NA	NA	NA	NA	NA	NA	33.73	4.02	29.71	NA
MW-4	07/30/1991	<50	<0.5	<0.5	<0.5	<0.5	NA	NA	NA	NA	NA	NA	NA	NA	NA	33.73	4.39	29.34	NA
MW-4	10/29/1991	<50	<0.5	<0.5	<0.5	<0.5	NA	NA	NA	NA	NA	NA	NA	NA	NA	33.73	3.75	29.98	NA
MW-4	01/20/1992	<30	<0.3	<0.3	<0.3	<0.3	NA	NA	NA	NA	NA	NA	NA	NA	NA	33.73	3.94	29.79	NA
MW-4	04/14/1992	<50	<0.5	<0.5	<0.5	<0.5	NA	NA	NA	NA	NA	NA	NA	NA	NA	33.73	3.71	30.02	NA
MW-4	07/21/1992	<50	<0.5	<0.5	<0.5	<0.5	NA	NA	NA	NA	NA	NA	NA	NA	NA	33.73	4.02	29.71	NA
MW-4	10/02/1992	<50	<0.5	<0.5	<0.5	<0.5	NA	NA	NA	NA	NA	NA	NA	NA	NA	33.73	4.13	29.60	NA
MW-4	01/20/1993	<50	<0.5	<0.5	<0.5	<0.5	NA	NA	NA	NA	NA	NA	NA	NA	NA	33.73	3.10	30.63	NA
MW-4	05/03/1993	<50	<0.5	<0.5	<0.5	<0.5	NA	NA	NA	NA	NA	NA	NA	NA	NA	33.73	3.70	30.03	1.7
MW-4	06/28/1993	NA	NA	NA	NA	NA	NA	NA	NA	NA	NA	NA	NA	NA	NA	33.73	3.81	29.92	NA
MW-4	07/21/1993	<50	0.56	<0.5	<0.5	<0.5	NA	NA	NA	NA	NA	NA	NA	NA	NA	33.73	3.81	29.92	4.5
MW-4	10/19/1993	<50	<0.5	<0.5	<0.5	<0.5	NA	NA	NA	NA	NA	NA	NA	NA	NA	33.73	3.94	29.79	5.8
MW-4	01/20/1994	<50	0.71	<0.5	<0.5	<0.5	NA	NA	NA	NA	NA	NA	NA	NA	NA	33.73	4.00	29.73	4.4
MW-4	04/12/1994	<50	<0.5	<0.5	<0.5	<0.5	NA	NA	NA	NA	NA	NA	NA	NA	NA	33.73	4.01	29.72	7.3
MW-4	07/20/1994	160	<0.5	<0.5	<0.5	<0.5	NA	NA	NA	NA	NA	NA	NA	NA	NA	33.73	3.91	29.82	6.4



**WELL CONCENTRATIONS**  
**Shell-branded Service Station**  
**29 Wildwood Avenue**  
**Piedmont, CA**

Well ID	Date	TPPH (ug/L)	B (ug/L)	T (ug/L)	E (ug/L)	X (ug/L)	MTBE 8020 (ug/L)	MTBE 8260 (ug/L)	DIPE (ug/L)	ETBE (ug/L)	TAME (ug/L)	TBA (ug/L)	Ethanol (ug/L)	1,2-DCA (ug/L)	EDB (ug/L)	TOC (MSL)	Depth to Water (ft.)	GW Elevation (MSL)	DO Reading (ppm)
MW-4	10/06/1994	410	<0.5	<0.5	<0.5	<0.5	NA	NA	NA	NA	NA	NA	NA	NA	NA	33.73	3.99	29.74	5.0
MW-4	01/20/1995	<50	<0.5	<0.5	<0.5	<0.5	NA	NA	NA	NA	NA	NA	NA	NA	NA	33.73	3.56	30.17	4.9
MW-4	07/06/1995	<50	<0.5	<0.5	<0.5	<0.5	NA	NA	NA	NA	NA	NA	NA	NA	NA	33.73	3.85	29.88	NA
MW-4	01/24/1996	<50	<0.5	<0.5	0.6	1.8	NA	NA	NA	NA	NA	NA	NA	NA	NA	33.73	2.56	31.17	NA
MW-4	07/12/1996	<50	<0.5	<0.5	<0.5	<0.5	b	NA	NA	NA	NA	NA	NA	NA	NA	33.73	3.36	30.37	2.7
MW-4	01/16/1997	Well inaccessible		NA	NA	NA	NA	NA	NA	NA	NA	NA	NA	NA	NA	33.73	NA	NA	NA
MW-4	10/24/1997	Well inaccessible		NA	NA	NA	NA	NA	NA	NA	NA	NA	NA	NA	NA	33.73	NA	NA	NA
MW-4	05/13/1998	Well inaccessible		NA	NA	NA	NA	NA	NA	NA	NA	NA	NA	NA	NA	33.73	NA	NA	NA
MW-4	10/01/1998	<50	<0.50c	<0.50c	<0.50c	0.74c	8.1	NA	NA	NA	NA	NA	NA	NA	NA	33.73	3.90	29.83	2.5
MW-4	04/29/1999	<50	<0.50	<0.50	<0.50	<0.50	5.7	NA	NA	NA	NA	NA	NA	NA	NA	33.73	3.97	29.76	2.1
MW-4	11/01/1999	Well inaccessible		NA	NA	NA	NA	NA	NA	NA	NA	NA	NA	NA	NA	33.73	NA	NA	NA
MW-4	04/05/2000	<50.0	<0.500	<0.500	<0.500	<0.500	3.64	NA	NA	NA	NA	NA	NA	NA	NA	33.73	3.63	30.10	2.1
MW-4	10/30/2000	<50.0	<0.500	<0.500	<0.500	<0.500	<2.50	NA	NA	NA	NA	NA	NA	NA	NA	33.73	3.33	30.40	3.0
MW-4	04/27/2001	<50.0	<0.500	<0.500	<0.500	<0.500	<2.50	NA	NA	NA	NA	NA	NA	NA	NA	33.73	3.48	30.25	2.2
MW-4	10/31/2001	<50	<0.50	<0.50	<0.50	<0.50	NA	<5.0	NA	NA	NA	NA	NA	NA	NA	33.73	3.58	30.15	2.8
MW-4	05/09/2002	<50	<0.50	<0.50	<0.50	<0.50	NA	<5.0	NA	NA	NA	NA	NA	NA	NA	33.73	3.74	29.99	2.0
MW-4	07/25/2002	<50	<0.50	<0.50	<0.50	<0.50	NA	<5.0	NA	NA	NA	NA	NA	NA	NA	33.73	3.71	30.02	1.3
MW-4	10/23/2002	<50	<0.50	<0.50	<0.50	<0.50	NA	<0.50	<2.0	<2.0	<2.0	<50	NA	<2.0	<2.0	36.72	3.93	32.79	2.6
MW-4	01/22/2003	<50	<0.50	<0.50	<0.50	<0.50	NA	<5.0	NA	NA	NA	NA	NA	NA	NA	36.72	3.67	33.05	3.1
MW-4	04/30/2003	<50	<0.50	<0.50	<0.50	<1.0	NA	<5.0	NA	NA	NA	NA	NA	NA	NA	36.72	3.46	33.26	2.8
MW-4	07/14/2003	56 a	<0.50	<0.50	<0.50	<1.0	NA	<0.50	<2.0	<2.0	<2.0	<5.0	NA	NA	NA	36.72	3.75	32.97	2.4
MW-4	10/23/2003	<50	<0.50	<0.50	<0.50	<1.0	NA	<0.50	<2.0	<2.0	<2.0	<5.0	NA	NA	NA	36.72	3.93	32.79	2.0
MW-4	01/05/2004	<50	<0.50	<0.50	<0.50	<1.0	NA	<0.50	<2.0	<2.0	<2.0	<5.0	NA	NA	NA	36.72	3.72	33.00	0.8
MW-4	04/14/2004	<50	<0.50	<0.50	<0.50	<1.0	NA	<0.50	<2.0	<2.0	<2.0	<5.0	NA	NA	NA	36.72	3.81	32.91	1.1
MW-4	07/13/2004	<50	<0.50	<0.50	<0.50	<1.0	NA	<0.50	NA	NA	NA	NA	NA	NA	NA	36.72	3.82	32.90	1.6
MW-4	10/25/2004	<50	<0.50	<0.50	<0.50	<1.0	NA	<0.50	NA	NA	NA	NA	NA	NA	NA	36.72	3.63	33.09	2.66
MW-4	01/06/2005	<50	<0.50	<0.50	<0.50	<1.0	NA	<0.50	NA	NA	NA	NA	NA	NA	NA	36.72	3.20	33.52	1.6
MW-4	05/19/2005	<50	<0.50	<0.50	<0.50	<1.0	NA	<0.50	NA	NA	NA	NA	NA	NA	NA	36.72	2.95	33.77	0.9
MW-4	07/19/2005	<50	<0.50	<0.50	<0.50	<1.0	NA	<0.50	NA	NA	NA	NA	NA	NA	NA	36.72	3.85	32.87	2.78
MW-5	01/30/1990	<50	<0.5	<0.5	<0.5	<0.5	NA	NA	NA	NA	NA	NA	NA	NA	NA	31.38	7.12	24.26	NA

**WELL CONCENTRATIONS**  
**Shell-branded Service Station**  
**29 Wildwood Avenue**  
**Piedmont, CA**

Weil ID	Date	TPPH (ug/L)	B (ug/L)	T (ug/L)	E (ug/L)	X (ug/L)	MTBE 8020 (ug/L)	MTBE 8260 (ug/L)	DIPE (ug/L)	ETBE (ug/L)	TAME (ug/L)	TBA (ug/L)	Ethanol (ug/L)	1,2-DCA (ug/L)	EDB (ug/L)	TOC (MSL)	Depth to Water (ft.)	GW Elevation (MSL)	DO Reading (ppm)
MW-5	04/27/1990	210a	<0.5	<0.5	<0.5	<0.5	NA	NA	NA	NA	NA	NA	NA	NA	NA	31.38	4.19	27.19	NA
MW-5	07/31/1990	90	<0.5	<0.5	<0.5	<0.5	NA	NA	NA	NA	NA	NA	NA	NA	NA	31.38	4.09	27.29	NA
MW-5	10/30/1990	100	0.8	0.7	0.6	1.4	NA	NA	NA	NA	NA	NA	NA	NA	NA	31.38	4.39	26.99	NA
MW-5	01/31/1991	80a	<0.5	<0.5	<0.5	<0.5	NA	NA	NA	NA	NA	NA	NA	NA	NA	31.38	4.49	26.89	NA
MW-5	04/30/1991	90	<0.5	<0.5	<0.5	<0.5	NA	NA	NA	NA	NA	NA	NA	NA	NA	31.38	4.27	27.11	NA
MW-5	07/30/1991	90	<0.5	<0.5	<0.5	<0.5	NA	NA	NA	NA	NA	NA	NA	NA	NA	31.38	4.32	27.06	NA
MW-5	10/29/1991	<50	<0.5	<0.5	<0.5	<0.5	NA	NA	NA	NA	NA	NA	NA	NA	NA	31.38	3.79	27.59	NA
MW-5	01/20/1992	<30	<0.3	<0.3	<0.3	<0.3	NA	NA	NA	NA	NA	NA	NA	NA	NA	31.38	4.09	27.29	NA
MW-5	04/14/1992	<50a	<0.5	<0.5	<0.5	<0.5	NA	NA	NA	NA	NA	NA	NA	NA	NA	31.38	4.12	27.26	NA
MW-5	07/21/1992	74a	<0.5	<0.5	<0.5	<0.5	NA	NA	NA	NA	NA	NA	NA	NA	NA	31.38	4.13	27.25	NA
MW-5	10/02/1992	76a	<0.5	<0.5	<0.5	<0.5	NA	NA	NA	NA	NA	NA	NA	NA	NA	31.38	4.30	27.08	NA
MW-5	01/20/1993	72a	<0.5	<0.5	<0.5	<0.5	NA	NA	NA	NA	NA	NA	NA	NA	NA	31.38	3.12	28.26	NA
MW-5	05/03/1993	70a	<0.5	<0.5	<0.5	<0.5	NA	NA	NA	NA	NA	NA	NA	NA	NA	31.38	4.07	27.31	1.6
MW-5 (D)	05/04/1993	80a	<0.5	<0.5	<0.5	<0.5	NA	NA	NA	NA	NA	NA	NA	NA	NA	31.38	NA	NA	NA
MW-5	06/28/1993	NA	NA	NA	NA	NA	NA	NA	NA	NA	NA	NA	NA	NA	NA	31.38	4.08	27.30	NA
MW-5	07/21/1993	<50	<0.5	<0.5	<0.5	<0.5	NA	NA	NA	NA	NA	NA	NA	NA	NA	31.38	4.05	27.33	3.5
MW-5	10/19/1993	51	<0.5	<0.5	<0.5	<0.5	NA	NA	NA	NA	NA	NA	NA	NA	NA	31.38	4.20	27.18	3.8
MW-5	01/20/1994	90	<0.5	<0.5	<0.5	<0.5	NA	NA	NA	NA	NA	NA	NA	NA	NA	31.38	4.40	26.98	4.2
MW-5	04/12/1994	67	<0.5	<0.5	<0.5	<0.5	NA	NA	NA	NA	NA	NA	NA	NA	NA	31.38	4.18	27.20	NA
MW-5	07/20/1994	<50	<0.5	<0.5	<0.5	<0.5	NA	NA	NA	NA	NA	NA	NA	NA	NA	31.38	4.06	27.32	3.2
MW-5	10/06/1994	80	<0.5	<0.5	<0.5	<0.5	NA	NA	NA	NA	NA	NA	NA	NA	NA	31.38	4.01	27.37	2.1
MW-5 (D)	10/06/1994	60	<0.5	<0.5	<0.5	<0.5	NA	NA	NA	NA	NA	NA	NA	NA	NA	31.38	NA	NA	NA
MW-5	01/20/1995	<50	<0.5	<0.5	<0.5	<0.5	NA	NA	NA	NA	NA	NA	NA	NA	NA	31.38	3.49	27.89	3.2
MW-5	07/06/1995	<50	<0.5	<0.5	<0.5	<0.5	NA	NA	NA	NA	NA	NA	NA	NA	NA	31.38	4.06	27.32	NA
MW-5	01/24/1996	70	<0.5	<0.5	0.8	2.9	NA	NA	NA	NA	NA	NA	NA	NA	NA	31.38	2.90	28.48	NA
MW-5	07/12/1996	62	<0.5	<0.5	<0.5	<0.5	b	NA	NA	NA	NA	NA	NA	NA	NA	31.38	4.02	27.36	1.9
MW-5	01/16/1997	66	0.91	0.89	<0.50	1.7	<2.5	NA	NA	NA	NA	NA	NA	NA	NA	31.38	2.59	28.79	2.2
MW-5 (D)	01/16/1997	<50	0.7	0.78	<0.50	1.3	<2.5	NA	NA	NA	NA	NA	NA	NA	NA	31.38	NA	NA	2.2
MW-5	10/24/1997	59	<0.50	<0.50	<0.50	<0.50	17	NA	NA	NA	NA	NA	NA	NA	NA	31.38	4.15	27.23	4.6
MW-5	05/13/1998	72	<0.50	<0.50	<0.50	<0.50	<2.5	NA	NA	NA	NA	NA	NA	NA	NA	31.38	3.64	27.74	2.1
MW-5 (D)	05/13/1998	70	<0.50	<0.50	<0.50	<0.50	<2.5	NA	NA	NA	NA	NA	NA	NA	NA	31.38	NA	NA	2.1

**WELL CONCENTRATIONS**  
**Shell-branded Service Station**  
**29 Wildwood Avenue**  
**Piedmont, CA**

Well ID	Date	TPPH (ug/L)	B (ug/L)	T (ug/L)	E (ug/L)	X (ug/L)	MTBE 8020 (ug/L)	MTBE 8260 (ug/L)	DIPE (ug/L)	ETBE (ug/L)	TAME (ug/L)	TBA (ug/L)	Ethanol (ug/L)	1,2-DCA (ug/L)	EDB (ug/L)	TOC (MSL)	Depth to Water (ft.)	GW Elevation (MSL)	DO Reading (ppm)
MW-5	10/01/1998	57	<0.50c	<0.50c	<0.50c	0.62c	20	NA	NA	NA	NA	NA	NA	NA	NA	31.38	4.25	27.13	2.2
MW-5	04/29/1999	<50	<0.50	<0.50	<0.50	<0.50	16	NA	NA	NA	NA	NA	NA	NA	NA	31.38	4.56	26.82	2.0
MW-5	11/01/1999	<50.0	<0.500	<0.500	<0.500	<0.500	3.06	NA	NA	NA	NA	NA	NA	NA	NA	31.38	4.19	27.19	2.2
MW-5	04/05/2000	<50.0	<0.500	<0.500	<0.500	<0.500	22.5	NA	NA	NA	NA	NA	NA	NA	NA	31.38	4.34	27.04	2.2
MW-5	10/30/2000	<50.0	<0.500	<0.500	<0.500	<0.500	19.3	NA	NA	NA	NA	NA	NA	NA	NA	31.38	3.25	28.13	4.0
MW-5	04/27/2001	51.5	<0.500	<0.500	<0.500	<0.500	4.29	NA	NA	NA	NA	NA	NA	NA	NA	31.38	4.07	27.31	1.0
MW-5	10/31/2001	210	<0.50	<0.50	<0.50	<0.50	NA	<5.0	NA	NA	NA	NA	NA	NA	NA	31.38	4.02	27.36	1.5
MW-5	05/09/2002	280	0.71	<0.50	<0.50	<0.50	NA	<5.0	NA	NA	NA	NA	NA	NA	NA	31.38	4.31	27.07	1.7
MW-5	07/25/2002	410	<0.50	<0.50	<0.50	<0.50	NA	<5.0	NA	NA	NA	NA	NA	NA	NA	31.38	4.32	27.06	0.7
MW-5	10/23/2002	290	<0.50	<0.50	<0.50	<0.50	NA	<0.50	<2.0	<2.0	<2.0	<50	NA	<2.0	<2.0	34.36	4.37	29.99	2.3
MW-5	01/22/2003	260	<0.50	<0.50	<0.50	<0.50	NA	<5.0	NA	NA	NA	NA	NA	NA	NA	34.36	4.12	30.24	2.4
MW-5	04/30/2003	90 a	<0.50	<0.50	<0.50	<1.0	NA	<5.0	NA	NA	NA	NA	NA	NA	NA	34.36	3.88	30.48	1.5
MW-5	07/14/2003	72 a	<0.50	<0.50	<0.50	<1.0	NA	<0.50	<2.0	<2.0	<2.0	<5.0	NA	NA	NA	34.36	4.57	29.79	1.0
MW-5	10/23/2003	120 e	<0.50	<0.50	<0.50	<1.0	NA	<0.50	<2.0	<2.0	<2.0	<5.0	NA	NA	NA	34.36	4.45	29.91	1.8
MW-5	01/05/2004	120 a	<0.50	<0.50	<0.50	1.1	NA	<0.50	<2.0	<2.0	<2.0	<5.0	NA	NA	NA	34.36	3.33	31.03	0.6
MW-5	04/14/2004	180 a	<0.50	<0.50	<0.50	<1.0	NA	<0.50	<2.0	<2.0	<2.0	<5.0	NA	NA	NA	34.36	4.52	29.84	0.6
MW-5	07/13/2004	150 a	<0.50	<0.50	<0.50	<1.0	NA	<0.50	NA	NA	NA	NA	NA	NA	NA	34.36	4.42	29.94	0.1
MW-5	10/25/2004	85 g	<0.50	<0.50	<0.50	<1.0	NA	<0.50	NA	NA	NA	NA	NA	NA	NA	34.36	4.04	30.32	2.21
MW-5	01/06/2005	88 g	<0.50	<0.50	<0.50	<1.0	NA	<0.50	NA	NA	NA	NA	NA	NA	NA	34.36	4.00	30.36	0.5
MW-5	05/19/2005	99 g	<0.50	<0.50	<0.50	<1.0	NA	<0.50	NA	NA	NA	NA	NA	NA	NA	34.36	4.20	30.16	1.0
<b>MW-5</b>	<b>07/19/2005</b>	<b>100 g</b>	<b>&lt;0.50</b>	<b>&lt;0.50</b>	<b>&lt;0.50</b>	<b>&lt;1.0</b>	<b>NA</b>	<b>0.56</b>	<b>NA</b>	<b>NA</b>	<b>NA</b>	<b>NA</b>	<b>NA</b>	<b>NA</b>	<b>NA</b>	<b>34.36</b>	<b>4.42</b>	<b>29.94</b>	<b>1.19</b>

E-4	07/12/1989	<50	<0.5	<1	<1	<3	NA	NA	NA	NA	NA	NA	NA	NA	NA	34.63	NA	>39.13	NA
E-4	01/30/1990	<50	<0.5	<0.5	<0.5	<0.5	NA	NA	NA	NA	NA	NA	NA	NA	NA	34.63	NA	>34.63	NA
E-4	04/27/1990	120a	<0.5	<0.5	<0.5	<0.5	NA	NA	NA	NA	NA	NA	NA	NA	NA	34.63	NA	>34.63	NA
E-4	07/31/1990	<50	<0.5	<0.5	<0.5	<0.5	NA	NA	NA	NA	NA	NA	NA	NA	NA	34.63	NA	>34.63	NA
E-4	10/30/1990	<50	<0.5	<0.5	<0.5	<0.5	NA	NA	NA	NA	NA	NA	NA	NA	NA	34.63	NA	>34.63	NA
E-4	01/31/1991	<50	<0.5	<0.5	<0.5	<0.5	NA	NA	NA	NA	NA	NA	NA	NA	NA	34.63	NA	>34.63	NA
E-4	04/30/1991	<50	<0.5	<0.5	<0.5	<0.5	NA	NA	NA	NA	NA	NA	NA	NA	NA	34.63	NA	>34.63	NA
E-4	07/30/1991	<50	<0.5	0.6	<0.5	<0.5	NA	NA	NA	NA	NA	NA	NA	NA	NA	34.63	NA	>34.63	NA
E-4	10/29/1991	<50	<0.5	<0.5	<0.5	<0.5	NA	NA	NA	NA	NA	NA	NA	NA	NA	34.63	NA	>34.63	NA

**WELL CONCENTRATIONS**  
**Shell-branded Service Station**  
**29 Wildwood Avenue**  
**Piedmont, CA**

Well ID	Date	TPPH (ug/L)	B (ug/L)	T (ug/L)	E (ug/L)	X (ug/L)	MTBE 8020 (ug/L)	MTBE 8260 (ug/L)	DIPE (ug/L)	ETBE (ug/L)	TAME (ug/L)	TBA (ug/L)	Ethanol (ug/L)	1,2-DCA (ug/L)	EDB (ug/L)	TOC (MSL)	Depth to Water (ft.)	GW Elevation (MSL)	DO Reading (ppm)
E-4	01/20/1992	<30	<0.3	<0.3	<0.3	<0.3	NA	NA	NA	NA	NA	NA	NA	NA	NA	34.63	NA	>34.63	NA
E-4	04/14/1992	<50	<0.5	<0.5	<0.5	<0.5	NA	NA	NA	NA	NA	NA	NA	NA	NA	34.63	NA	>34.63	NA
E-4	07/21/1992	<50	<0.5	<0.5	<0.5	<0.5	NA	NA	NA	NA	NA	NA	NA	NA	NA	34.63	NA	>34.63	NA
E-4	10/02/1992	<50	<0.5	<0.5	<0.5	<0.5	NA	NA	NA	NA	NA	NA	NA	NA	NA	34.63	NA	>34.63	NA
E-4	01/20/1993	<50	<0.5	<0.5	<0.5	<0.5	NA	NA	NA	NA	NA	NA	NA	NA	NA	34.63	NA	>34.63	NA
E-4	05/03/1993	<50	<0.5	<0.5	<0.5	<0.5	NA	NA	NA	NA	NA	NA	NA	NA	NA	34.63	NA	>34.63	0.6
E-4	06/28/1993	NA	NA	NA	NA	NA	NA	NA	NA	NA	NA	NA	NA	NA	NA	34.63	NA	>34.63	NA
E-4	07/21/1993	<50	5.4	0.72	1	4.4	NA	NA	NA	NA	NA	NA	NA	NA	NA	34.63	NA	>34.63	5.4
E-4	10/19/1993	<50	<0.5	<0.5	<0.5	<0.5	NA	NA	NA	NA	NA	NA	NA	NA	NA	34.63	NA	>34.63	5.6
E-4	01/20/1994	<50	<0.5	<0.5	<0.5	<0.5	NA	NA	NA	NA	NA	NA	NA	NA	NA	34.63	NA	>34.63	NA
E-4	04/12/1994	<50	<0.5	<0.5	<0.5	<0.5	NA	NA	NA	NA	NA	NA	NA	NA	NA	34.63	NA	>34.63	9.4
E-4	07/20/1994	<50	<0.5	<0.5	<0.5	<0.5	NA	NA	NA	NA	NA	NA	NA	NA	NA	34.63	NA	>34.63	2.0
E-4	10/06/1994	<50	<0.5	<0.5	<0.5	<0.5	NA	NA	NA	NA	NA	NA	NA	NA	NA	34.63	NA	>34.63	1.3
E-4	01/20/1995	<50	<0.5	<0.5	<0.5	<0.5	NA	NA	NA	NA	NA	NA	NA	NA	NA	34.63	NA	>34.63	3.7
E-4	05/16/1995	Well abandoned		NA	NA	NA	NA	NA	NA	NA	NA	NA	NA	NA	NA	NA	NA	NA	NA

**WELL CONCENTRATIONS**  
**Shell-branded Service Station**  
**29 Wildwood Avenue**  
**Piedmont, CA**

Well ID	Date	TPPH (ug/L)	B (ug/L)	T (ug/L)	E (ug/L)	X (ug/L)	MTBE 8020 (ug/L)	MTBE 8260 (ug/L)	DIPE (ug/L)	ETBE (ug/L)	TAME (ug/L)	TBA (ug/L)	Ethanol (ug/L)	1,2-DCA (ug/L)	EDB (ug/L)	TOC (MSL)	Depth to Water (ft.)	GW Elevation (MSL)	DO Reading (ppm)
---------	------	----------------	-------------	-------------	-------------	-------------	------------------------	------------------------	----------------	----------------	----------------	---------------	-------------------	-------------------	---------------	--------------	----------------------------	--------------------------	------------------------

Abbreviations:

TPPH = Total petroleum hydrocarbons as gasoline by EPA Method 8260B; prior to October 31, 2001, analyzed by EPA Method 8015.

BTEX = Benzene, toluene, ethylbenzene, xylenes by EPA Method 8260B; prior to October 31, 2001, analyzed by EPA Method 8020.

MTBE = Methyl tertiary butyl ether

DIPE = Di-isopropyl ether, analyzed by EPA Method 8260B

ETBE = Ethyl tertiary butyl ether, analyzed by EPA Method 8260B

TAME = Tertiary amyl methyl ether, analyzed by EPA Method 8260B

TBA = Tertiary butyl alcohol, analyzed by EPA Method 8260B

1,2-DCA = 1,2-Dichloroethane, analyzed by EPA Method 8260B

EDB = 1,2-Dibromoethane, analyzed by EPA Method 8260B

TOC = Top of Casing Elevation

SPH = Separate-Phase Hydrocarbons

GW = Groundwater

DO = Dissolved Oxygen

ug/L = Parts per billion

ppm = Parts per million

MSL = Mean sea level

ft. = Feet

<n = Below detection limit

(D) = Duplicate sample

NA = Not applicable

**WELL CONCENTRATIONS**  
**Shell-branded Service Station**  
**29 Wildwood Avenue**  
**Piedmont, CA**

Well ID	Date	TPPH (ug/L)	B (ug/L)	T (ug/L)	E (ug/L)	X (ug/L)	MTBE 8020 (ug/L)	MTBE 8260 (ug/L)	DIPE (ug/L)	ETBE (ug/L)	TAME (ug/L)	TBA (ug/L)	Ethanol (ug/L)	1,2-DCA (ug/L)	EDB (ug/L)	TOC (MSL)	Depth to Water (ft.)	GW Elevation (MSL)	DO Reading (ppm)
---------	------	----------------	-------------	-------------	-------------	-------------	------------------------	------------------------	----------------	----------------	----------------	---------------	-------------------	-------------------	---------------	--------------	----------------------------	--------------------------	------------------------

Notes:

- a = Chromatogram pattern indicated an unidentified hydrocarbon/Hydrocarbon reported does not match laboratory's standard.
  - b = Due to coelution with early eluters, no result could be determined for MTBE.
  - c = Laboratory reported 1.3 ug/L benzene, 11 ug/L toluene, 0.98 ug/L ethyl benzene, and 6.5 ug/L total xylenes in the equipment blank.
  - d = Result reported was generated out of hold time.
  - e = Sample contains discrete peaks which are Chlorinated solvents, in addition to gasoline.
  - f = Top of casing altered +0.45 feet due to wellhead maintenance on August 2, 2004.
  - g = The concentration reported reflects individual or discrete unidentified peaks not matching a typical fuel pattern.  
Ethanol analyzed by EPA Method 8260B.
- Well E-4 is a flowing artesian well; potentiometric surface above top of casing elevation.  
Site surveyed March 5, 2002 by Virgil Chavez Land Surveying of Vallejo, CA.

**Blaine Tech Services, Inc.**

August 03, 2005

1680 Rogers Avenue  
San Jose, CA 95112-1105  
Attn.: Leon Gearhart  
Project: 98995822  
Site: 29 Wildwood Avenue, Piedmont

Dear Mr. Gearhart,

Attached is our report for your samples received on 07/20/2005 15:50  
This report has been reviewed and approved for release. Reproduction of this report  
is permitted only in its entirety.

Please note that any unused portion of the samples will be discarded after  
09/03/2005 unless you have requested otherwise.

We appreciate the opportunity to be of service to you. If you have any questions,

You can also contact me via email. My email address is: [mbrewer@stl-inc.com](mailto:mbrewer@stl-inc.com)

Sincerely,

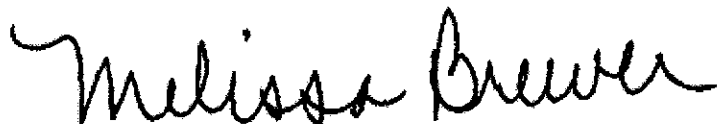

Melissa Brewer  
Project Manager



**Gas/BTEX Fuel Oxygenates by 8260B (C6-C12)**

Blaine Tech Services, Inc.

Attn.: Leon Gearhart

1680 Rogers Avenue

San Jose, CA 95112-1105

Phone: (408) 573-0555 Fax: (408) 573-7771

Project: 98995822

Received: 07/20/2005 15:50

Site: 29 Wildwood Avenue, Piedmont

**Samples Reported**

Sample Name	Date Sampled	Matrix	Lab #
MW-1	07/19/2005 16:30	Water	1
MW-2	07/19/2005 17:50	Water	2
MW-3	07/19/2005 17:29	Water	3
MW-4	07/19/2005 15:15	Water	4
MW-5	07/19/2005 15:45	Water	5

Severn Trent Laboratories, Inc.

STL San Francisco \* 1220 Quarry Lane, Pleasanton, CA 94566

Tel 925 484 1919 Fax 925 484 1096 \* www.stl-inc.com \* CA DHS ELAP# 2496

08/02/2005 18:54

Page 1 of 19

**Gas/BTEX Fuel Oxygenates by 8260B (C6-C12)**

Blaine Tech Services, Inc.

Attn.: Leon Gearhart

1680 Rogers Avenue

San Jose, CA 95112-1105

Phone: (408) 573-0555 Fax: (408) 573-7771

Project: 98995822

Received: 07/20/2005 15:50

Site: 29 Wildwood Avenue, Piedmont

Prep(s): 5030B	Test(s): 8260B
Sample ID: MW-1	Lab ID: 2005-07-0571 - 1
Sampled: 07/19/2005 16:30	Extracted: 8/1/2005 23:56
Matrix: Water	QC Batch#: 2005/08/01-2A.65
pH: <2	

Compound	Conc.	RL	Unit	Dilution	Analyzed	Flag
Gasoline [Shell]	ND	50	ug/L	1.00	08/01/2005 23:56	
Benzene	ND	0.50	ug/L	1.00	08/01/2005 23:56	
Toluene	ND	0.50	ug/L	1.00	08/01/2005 23:56	
Ethylbenzene	ND	0.50	ug/L	1.00	08/01/2005 23:56	
Total xylenes	1.3	1.0	ug/L	1.00	08/01/2005 23:56	
tert-Butyl alcohol (TBA)	ND	5.0	ug/L	1.00	08/01/2005 23:56	
Methyl tert-butyl ether (MTBE)	ND	0.50	ug/L	1.00	08/01/2005 23:56	
Di-isopropyl Ether (DIPE)	ND	2.0	ug/L	1.00	08/01/2005 23:56	
Ethyl tert-butyl ether (ETBE)	ND	2.0	ug/L	1.00	08/01/2005 23:56	
tert-Amyl methyl ether (TAME)	ND	2.0	ug/L	1.00	08/01/2005 23:56	
<b>Surrogate(s)</b>						
1,2-Dichloroethane-d4	111.6	73-130	%	1.00	08/01/2005 23:56	
Toluene-d8	100.3	81-114	%	1.00	08/01/2005 23:56	



**Gas/BTEX Fuel Oxygenates by 8260B (C6-C12)**

Blaine Tech Services, Inc.

Attn.: Leon Gearhart

1680 Rogers Avenue

San Jose, CA 95112-1105

Phone: (408) 573-0555 Fax: (408) 573-7771

Project: 98995822

Received: 07/20/2005 15:50

Site: 29 Wildwood Avenue, Piedmont

Prep(s): 5030B	Test(s): 8260B
Sample ID: MW-3	Lab ID: 2005-07-0571 - 3
Sampled: 07/19/2005 17:29	Extracted: 8/1/2005 10:07
Matrix: Water	QC Batch#: 2005/08/01-1A.65
Analysis Flag: L2, pH: <2 ( See Legend and Note Section )	

Compound	Conc.	RL	Unit	Dilution	Analyzed	Flag
Gasoline [Shell]	2800	250	ug/L	5.00	08/01/2005 10:07	
Benzene	88	2.5	ug/L	5.00	08/01/2005 10:07	
Toluene	8.2	2.5	ug/L	5.00	08/01/2005 10:07	
Ethylbenzene	4.3	2.5	ug/L	5.00	08/01/2005 10:07	
Total xylenes	6.5	5.0	ug/L	5.00	08/01/2005 10:07	
tert-Butyl alcohol (TBA)	240	25	ug/L	5.00	08/01/2005 10:07	
Methyl tert-butyl ether (MTBE)	100	2.5	ug/L	5.00	08/01/2005 10:07	
Di-isopropyl Ether (DIPE)	ND	10	ug/L	5.00	08/01/2005 10:07	
Ethyl tert-butyl ether (ETBE)	ND	10	ug/L	5.00	08/01/2005 10:07	
tert-Amyl methyl ether (TAME)	ND	10	ug/L	5.00	08/01/2005 10:07	
Ethanol	ND	250	ug/L	5.00	08/01/2005 10:07	
<b>Surrogate(s)</b>						
1,2-Dichloroethane-d4	103.0	73-130	%	5.00	08/01/2005 10:07	
Toluene-d8	88.0	81-114	%	5.00	08/01/2005 10:07	

Severn Trent Laboratories, Inc.

STL San Francisco \* 1220 Quarry Lane, Pleasanton, CA 94566

Tel 925 484 1919 Fax 925 484 1096 \* www.stl-inc.com \* CA DHS ELAP# 2496

08/02/2005 18:54

**Gas/BTEX Fuel Oxygenates by 8260B (C6-C12)**

Blaine Tech Services, Inc.

Attn.: Leon Gearhart

1680 Rogers Avenue

San Jose, CA 95112-1105

Phone: (408) 573-0555 Fax: (408) 573-7771

Project: 98995822

Received: 07/20/2005 15:50

Site: 29 Wildwood Avenue, Piedmont

Prep(s): 5030B Test(s): 8260B  
 Sample ID: MW-4 Lab ID: 2005-07-0571 - 4  
 Sampled: 07/19/2005 15:15 Extracted: 7/30/2005 11:14  
 Matrix: Water QC Batch#: 2005/07/30-1A.68  
 pH: <2

Compound	Conc.	RL	Unit	Dilution	Analyzed	Flag
Gasoline [Shell]	ND	50	ug/L	1.00	07/30/2005 11:14	
Benzene	ND	0.50	ug/L	1.00	07/30/2005 11:14	
Toluene	ND	0.50	ug/L	1.00	07/30/2005 11:14	
Ethylbenzene	ND	0.50	ug/L	1.00	07/30/2005 11:14	
Total xylenes	ND	1.0	ug/L	1.00	07/30/2005 11:14	
Methyl tert-butyl ether (MTBE)	ND	0.50	ug/L	1.00	07/30/2005 11:14	
<b>Surrogate(s)</b>						
1,2-Dichloroethane-d4	97.0	73-130	%	1.00	07/30/2005 11:14	
Toluene-d8	98.7	81-114	%	1.00	07/30/2005 11:14	

**Gas/BTEX Fuel Oxygenates by 8260B (C6-C12)**

Blaine Tech Services, Inc.

Attn.: Leon Gearhart

1680 Rogers Avenue

San Jose, CA 95112-1105

Phone: (408) 573-0555 Fax: (408) 573-7771

Project: 98995822

Received: 07/20/2005 15:50

Site: 29 Wildwood Avenue, Piedmont

Prep(s): 5030B Test(s): 8260B  
 Sample ID: MW-5 Lab ID: 2005-07-0571 - 5  
 Sampled: 07/19/2005 15:45 Extracted: 8/1/2005 09:02  
 Matrix: Water QC Batch#: 2005/08/01-1A.62  
 pH: <2

Compound	Conc.	RL	Unit	Dilution	Analyzed	Flag
Gasoline [Shell]	100	50	ug/L	1.00	08/01/2005 09:02	Q6
Benzene	ND	0.50	ug/L	1.00	08/01/2005 09:02	
Toluene	ND	0.50	ug/L	1.00	08/01/2005 09:02	
Ethylbenzene	ND	0.50	ug/L	1.00	08/01/2005 09:02	
Total xylenes	ND	1.0	ug/L	1.00	08/01/2005 09:02	
Methyl tert-butyl ether (MTBE)	0.56	0.50	ug/L	1.00	08/01/2005 09:02	
<b>Surrogate(s)</b>						
1,2-Dichloroethane-d4	100.3	73-130	%	1.00	08/01/2005 09:02	
Toluene-d8	88.3	81-114	%	1.00	08/01/2005 09:02	

**Gas/BTEX Fuel Oxygenates by 8260B (C6-C12)**

Blaine Tech Services, Inc.

Attn.: Leon Gearhart

1680 Rogers Avenue  
San Jose, CA 95112-1105  
Phone: (408) 573-0555 Fax: (408) 573-7771

Project: 98995822

Received: 07/20/2005 15:50

Site: 29 Wildwood Avenue, Piedmont

**Batch QC Report**

Prep(s): 5030B

Method Blank

MB: 2005/07/30-1A.68-042

Water

Test(s): 8260B

QC Batch # 2005/07/30-1A.68

Date Extracted: 07/30/2005 07:42

Compound	Conc.	RL	Unit	Analyzed	Flag
Gasoline [Shell]	ND	50	ug/L	07/30/2005 07:42	
tert-Butyl alcohol (TBA)	40.5	5.0	ug/L	07/30/2005 07:42	
Methyl tert-butyl ether (MTBE)	ND	0.5	ug/L	07/30/2005 07:42	
Di-isopropyl Ether (DIPE)	ND	2.0	ug/L	07/30/2005 07:42	
Ethyl tert-butyl ether (ETBE)	ND	2.0	ug/L	07/30/2005 07:42	
tert-Amyl methyl ether (TAME)	ND	2.0	ug/L	07/30/2005 07:42	
Benzene	ND	0.5	ug/L	07/30/2005 07:42	
Toluene	ND	0.5	ug/L	07/30/2005 07:42	
Ethylbenzene	ND	0.5	ug/L	07/30/2005 07:42	
Total xylenes	ND	1.0	ug/L	07/30/2005 07:42	
Ethanol	82.1	50	ug/L	07/30/2005 07:42	
<b>Surrogates(s)</b>					
1,2-Dichloroethane-d4	107.8	73-130	%	07/30/2005 07:42	
Toluene-d8	100.6	81-114	%	07/30/2005 07:42	



**Gas/BTEX Fuel Oxygenates by 8260B (C6-C12)**

Blaine Tech Services, Inc.

Attn.: Leon Gearhart

1680 Rogers Avenue  
San Jose, CA 95112-1105  
Phone: (408) 573-0555 Fax: (408) 573-7771

Project: 98995822

Received: 07/20/2005 15:50

Site: 29 Wildwood Avenue, Piedmont

**Batch QC Report**

Prep(s): 5030B

Test(s): 8260B

Method Blank

Water

QC Batch # 2005/08/01-1A.62

MB: 2005/08/01-1A.62-022

Date Extracted: 08/01/2005 08:22

Compound	Conc.	RL	Unit	Analyzed	Flag
Gasoline [Shell]	ND	50	ug/L	08/01/2005 08:22	
Methyl tert-butyl ether (MTBE)	ND	0.5	ug/L	08/01/2005 08:22	
Di-isopropyl Ether (DIPE)	ND	2.0	ug/L	08/01/2005 08:22	
Ethyl tert-butyl ether (ETBE)	ND	2.0	ug/L	08/01/2005 08:22	
tert-Amyl methyl ether (TAME)	ND	2.0	ug/L	08/01/2005 08:22	
Benzene	ND	0.5	ug/L	08/01/2005 08:22	
Toluene	ND	0.5	ug/L	08/01/2005 08:22	
Ethylbenzene	ND	0.5	ug/L	08/01/2005 08:22	
Total xylenes	ND	1.0	ug/L	08/01/2005 08:22	
Ethanol	ND	50	ug/L	08/01/2005 08:22	
<b>Surrogates(s)</b>					
1,2-Dichloroethane-d4	94.2	73-130	%	08/01/2005 08:22	
Toluene-d8	91.0	81-114	%	08/01/2005 08:22	

**Gas/BTEX Fuel Oxygenates by 8260B (C6-C12)**

Blaine Tech Services, Inc.

Attn.: Leon Gearhart

1680 Rogers Avenue  
San Jose, CA 95112-1105  
Phone: (408) 573-0555 Fax: (408) 573-7771

Project: 98995822

Received: 07/20/2005 15:50

Site: 29 Wildwood Avenue, Piedmont

**Batch QC Report**

Prep(s): 5030B

Test(s): 8260B

Method Blank

Water

QC Batch # 2005/08/01-1A.65

MB: 2005/08/01-1A.65-021

Date Extracted: 08/01/2005 08:21

Compound	Conc.	RL	Unit	Analyzed	Flag
Gasoline [Shell]	ND	50	ug/L	08/01/2005 08:21	
tert-Butyl alcohol (TBA)	ND	5.0	ug/L	08/01/2005 08:21	
Methyl tert-butyl ether (MTBE)	ND	0.5	ug/L	08/01/2005 08:21	
Di-isopropyl Ether (DIPE)	ND	2.0	ug/L	08/01/2005 08:21	
Ethyl tert-butyl ether (ETBE)	ND	2.0	ug/L	08/01/2005 08:21	
tert-Amyl methyl ether (TAME)	ND	2.0	ug/L	08/01/2005 08:21	
Benzene	ND	0.5	ug/L	08/01/2005 08:21	
Toluene	ND	0.5	ug/L	08/01/2005 08:21	
Ethylbenzene	ND	0.5	ug/L	08/01/2005 08:21	
Total xylenes	ND	1.0	ug/L	08/01/2005 08:21	
Ethanol	ND	50	ug/L	08/01/2005 08:21	
<b>Surrogates(s)</b>					
1,2-Dichloroethane-d4	92.0	73-130	%	08/01/2005 08:21	
Toluene-d8	90.2	81-114	%	08/01/2005 08:21	

Severn Trent Laboratories, Inc.

08/02/2005 18:54

STL San Francisco \* 1220 Quarry Lane, Pleasanton, CA 94566

Tel 925 484 1919 Fax 925 484 1096 \* www.stl-inc.com \* CA DHS ELAP# 2496

**Gas/BTEX Fuel Oxygenates by 8260B (C6-C12)**

Blaine Tech Services, Inc.

Attn.: Leon Gearhart

1680 Rogers Avenue

San Jose, CA 95112-1105

Phone: (408) 573-0555 Fax: (408) 573-7771

Project: 98995822

Received: 07/20/2005 15:50

Site: 29 Wildwood Avenue, Piedmont

**Batch QC Report**

Prep(s): 5030B

Test(s): 8260B

Method Blank

Water

QC Batch # 2005/08/01-2A.65

MB: 2005/08/01-2A.65-014

Date Extracted: 08/01/2005 18:14

Compound	Conc.	RL	Unit	Analyzed	Flag
Gasoline [Shell]	ND	50	ug/L	08/01/2005 18:14	
tert-Butyl alcohol (TBA)	ND	5.0	ug/L	08/01/2005 18:14	
Methyl tert-butyl ether (MTBE)	ND	0.5	ug/L	08/01/2005 18:14	
Di-isopropyl Ether (DIPE)	ND	2.0	ug/L	08/01/2005 18:14	
Ethyl tert-butyl ether (ETBE)	ND	2.0	ug/L	08/01/2005 18:14	
tert-Amyl methyl ether (TAME)	ND	2.0	ug/L	08/01/2005 18:14	
Benzene	ND	0.5	ug/L	08/01/2005 18:14	
Toluene	ND	0.5	ug/L	08/01/2005 18:14	
Ethylbenzene	ND	0.5	ug/L	08/01/2005 18:14	
Total xylenes	ND	1.0	ug/L	08/01/2005 18:14	
Ethanol	ND	50	ug/L	08/01/2005 18:14	
<b>Surrogates(s)</b>					
1,2-Dichloroethane-d4	98.2	73-130	%	08/01/2005 18:14	
Toluene-d8	92.8	81-114	%	08/01/2005 18:14	

**Gas/BTEX Fuel Oxygenates by 8260B (C6-C12)**

Blaine Tech Services, Inc.

Attn.: Leon Gearhart

1680 Rogers Avenue  
San Jose, CA 95112-1105  
Phone: (408) 573-0555 Fax: (408) 573-7771

Project: 98995822

Received: 07/20/2005 15:50

Site: 29 Wildwood Avenue, Piedmont

**Batch QC Report**

Prep(s): 5030B

Test(s): 8260B

**Laboratory Control Spike**

**Water**

**QC Batch # 2005/07/30-1A.68**

LCS 2005/07/30-1A.68-016  
LCSD

Extracted: 07/30/2005

Analyzed: 07/30/2005 07:16

Compound	Conc. ug/L		Exp.Conc.	Recovery %		RPD	Ctrl.Limits %		Flags	
	LCS	LCSD		LCS	LCSD		%	Rec.	RPD	LCS
Methyl tert-butyl ether (MTBE)	20.6		25	82.4			65-165	20		
Benzene	18.8		25	75.2			69-129	20		
Toluene	22.0		25	88.0			70-130	20		
<b>Surrogates(s)</b>										
1,2-Dichloroethane-d4	398		500	79.6			73-130			
Toluene-d8	482		500	96.4			81-114			

Severn Trent Laboratories, Inc.

STL San Francisco \* 1220 Quarry Lane, Pleasanton, CA 94566

Tel 925 484 1919 Fax 925 484 1096 \* www.stl-inc.com \* CA DHS ELAP# 2496

08/02/2005 18:54

**Gas/BTEX Fuel Oxygenates by 8260B (C6-C12)**

Blaine Tech Services, Inc.

Attn.: Leon Gearhart

1680 Rogers Avenue

San Jose, CA 95112-1105

Phone: (408) 573-0555 Fax: (408) 573-7771

Project: 98995822

Received: 07/20/2005 15:50

Site: 29 Wildwood Avenue, Piedmont

**Batch QC Report**

Prep(s): 5030B

Test(s): 8260B

**Laboratory Control Spike**

**Water**

**QC Batch # 2005/08/01-1A.62**

LCS 2005/08/01-1A.62-056

Extracted: 08/01/2005

Analyzed: 08/01/2005 07:56

LCSD 2005/08/01-1A.62-054

Extracted: 08/01/2005

Analyzed: 08/01/2005 09:54

Compound	Conc. ug/L		Exp.Conc.	Recovery %		RPD	Ctrl.Limits %		Flags	
	LCS	LCSD		LCS	LCSD		%	Rec.	RPD	LCS
Methyl tert-butyl ether (MTBE)	23.9	23.9	25	95.6	95.6	0.0	65-165	20		
Benzene	24.7	26.4	25	98.8	105.6	6.7	69-129	20		
Toluene	25.6	27.0	25	102.4	108.0	5.3	70-130	20		
<b>Surrogates(s)</b>										
1,2-Dichloroethane-d4	443	429	500	88.6	85.8		73-130			
Toluene-d8	455	454	500	91.0	90.8		81-114			

Severn Trent Laboratories, Inc.

STL San Francisco \* 1220 Quarry Lane, Pleasanton, CA 94566

Tel 925 484 1919 Fax 925 484 1096 \* www.stl-inc.com \* CA DHS ELAP# 2496

08/02/2005 18:54

Page 12 of 19

**Gas/BTEX Fuel Oxygenates by 8260B (C6-C12)**

Blaine Tech Services, Inc.  
Attn.: Leon Gearhart

1680 Rogers Avenue  
San Jose, CA 95112-1105  
Phone: (408) 573-0555 Fax: (408) 573-7771  
Project: 98995822

Received: 07/20/2005 15:50  
Site: 29 Wildwood Avenue, Piedmont

**Batch QC Report**

Prep(s): 5030B

Test(s): 8260B

**Laboratory Control Spike**

**Water**

**QC Batch # 2005/08/01-1A.65**

LCS 2005/08/01-1A.65-034  
LCSD

Extracted: 08/01/2005

Analyzed: 08/01/2005 09:34

Compound	Conc. ug/L		Exp.Conc.	Recovery %		RPD	Ctrl.Limits %		Flags	
	LCS	LCSD		LCS	LCSD		%	Rec.	RPD	LCS
Methyl tert-butyl ether (MTBE)	16.7		25	66.8			65-165	20		
Benzene	20.1		25	80.4			69-129	20		
Toluene	19.9		25	79.6			70-130	20		
<b>Surrogates(s)</b>										
1,2-Dichloroethane-d4	423		500	84.6			73-130			
Toluene-d8	474		500	94.8			81-114			

Severn Trent Laboratories, Inc.

STL San Francisco \* 1220 Quarry Lane, Pleasanton, CA 94566

Tel 925 484 1919 Fax 925 484 1096 \* www.stl-inc.com \* CA DHS ELAP# 2496

08/02/2005 18:54

Page 13 of 19

**Gas/BTEX Fuel Oxygenates by 8260B (C6-C12)**

Blaine Tech Services, Inc.

Attn.: Leon Gearhart

1680 Rogers Avenue  
San Jose, CA 95112-1105  
Phone: (408) 573-0555 Fax: (408) 573-7771

Project: 98995822

Received: 07/20/2005 15:50

Site: 29 Wildwood Avenue, Piedmont

**Batch QC Report**

Prep(s): 5030B

Test(s): 8260B

**Laboratory Control Spike**

**Water**

**QC Batch # 2005/08/01-2A.65**

LCS 2005/08/01-2A.65-048  
LCSD

Extracted: 08/01/2005

Analyzed: 08/01/2005 17:48

Compound	Conc. ug/L		Exp.Conc.	Recovery %		RPD	Ctrl.Limits %		Flags	
	LCS	LCSD		LCS	LCSD		%	Rec.	RPD	LCS
Methyl tert-butyl ether (MTBE)	24.2		25	96.8			65-165	20		
Benzene	24.4		25	97.6			69-129	20		
Toluene	26.4		25	105.6			70-130	20		
<b>Surrogates(s)</b>										
1,2-Dichloroethane-d4	477		500	95.4			73-130			
Toluene-d8	499		500	99.8			81-114			

Severn Trent Laboratories, Inc.

STL San Francisco \* 1220 Quarry Lane, Pleasanton, CA 94566

Tel 925 484 1919 Fax 925 484 1096 \* www.stl-inc.com \* CA DHS ELAP# 2496

08/02/2005 18:54

Page 14 of 19



**Gas/BTEX Fuel Oxygenates by 8260B (C6-C12)**

Blaine Tech Services, Inc.

Attn.: Leon Gearhart

1680 Rogers Avenue  
San Jose, CA 95112-1105  
Phone: (408) 573-0555 Fax: (408) 573-7771

Project: 98995822

Received: 07/20/2005 15:50

Site: 29 Wildwood Avenue, Piedmont

**Batch QC Report**

Prep(s): 5030B

Test(s): 8260B

**Matrix Spike ( MS / MSD )**

**Water**

**QC Batch # 2005/07/30-1A.68**

MS/MSD

Lab ID: 2005-07-0558 - 002

MS: 2005/07/30-1A.68-056

Extracted: 07/30/2005

Analyzed: 07/30/2005 09:56

Dilution: 40.00

MSD: 2005/07/30-1A.68-022

Extracted: 07/30/2005

Analyzed: 07/30/2005 10:22

Dilution: 40.00

Compound	Conc. ug/L			Spk.Level ug/L	Recovery %			Limits %		Flags	
	MS	MSD	Sample		MS	MSD	RPD	Rec.	RPD	MS	MSD
Methyl tert-butyl ether	3810	3760	2960	1000	85.0	80.0	6.1	65-165	20		
Benzene	763	791	ND	1000	76.3	79.1	3.6	69-129	20		
Toluene	958	966	ND	1000	95.8	96.6	0.8	70-130	20		
<b>Surrogate(s)</b>											
1,2-Dichloroethane-d4	426	421		500	85.2	84.2		73-130			
Toluene-d8	511	471		500	102.2	94.2		81-114			

Sewern Trent Laboratories, Inc.

STL San Francisco \* 1220 Quarry Lane, Pleasanton, CA 94566

Tel 925 484 1919 Fax 925 484 1096 \* www.stl-inc.com \* CA DHS ELAP# 2496

08/02/2005 18:54

**Gas/BTEX Fuel Oxygenates by 8260B (C6-C12)**

Blaine Tech Services, Inc.

Attn.: Leon Gearhart

1680 Rogers Avenue  
San Jose, CA 95112-1105  
Phone: (408) 573-0555 Fax: (408) 573-7771

Project: 98995822

Received: 07/20/2005 15:50

Site: 29 Wildwood Avenue, Piedmont

**Batch QC Report**

Prep(s): 5030B

Test(s): 8260B

**Matrix Spike ( MS / MSD )**

**Water**

**QC Batch # 2005/08/01-1A.62**

MS/MSD

Lab ID: 2005-07-0592 - 003

MS: 2005/08/01-1A.62-020

Extracted: 08/01/2005

Analyzed: 08/01/2005 10:20

Dilution: 50.00

MSD: 2005/08/01-1A.62-046

Extracted: 08/01/2005

Analyzed: 08/01/2005 10:46

Dilution: 50.00

Compound	Conc. ug/L			Spk. Level	Recovery %			Limits %		Flags	
	MS	MSD	Sample		ug/L	MS	MSD	RPD	Rec.	RPD	MS
Methyl tert-butyl ether	2910	2970	1660	1250	100.0	104.8	4.7	65-165	20		
Benzene	9470	9360	7600	1250	149.6	140.8	6.1	69-129	20	M3	M3
Toluene	1450	1570	407	1250	83.4	93.0	10.9	70-130	20		
<b>Surrogate(s)</b>											
1,2-Dichloroethane-d4	471	477		500	94.1	95.3		73-130			
Toluene-d8	464	462		500	92.7	92.4		81-114			

Severn Trent Laboratories, Inc.

STL San Francisco \* 1220 Quarry Lane, Pleasanton, CA 94566

Tel 925 484 1919 Fax 925 484 1096 \* www.stl-inc.com \* CA DHS ELAP# 2496

08/02/2005 18:54

**Gas/BTEX Fuel Oxygenates by 8260B (C6-C12)**

Blaine Tech Services, Inc.

Attn.: Leon Gearhart

1680 Rogers Avenue  
San Jose, CA 95112-1105  
Phone: (408) 573-0555 Fax: (408) 573-7771

Project: 98995822

Received: 07/20/2005 15:50

Site: 29 Wildwood Avenue, Piedmont

**Batch QC Report**

Prep(s): 5030B

Test(s): 8260B

**Matrix Spike ( MS / MSD )**

**Water**

**QC Batch # 2005/08/01-1A.65**

MW-3 >> MS

Lab ID: 2005-07-0571 - 003

MS: 2005/08/01-1A.65-033

Extracted: 08/01/2005

Analyzed: 08/01/2005 10:33

Dilution: 5.00

MSD: 2005/08/01-1A.65-059

Extracted: 08/01/2005

Analyzed: 08/01/2005 10:59

Dilution: 5.00

Compound	Conc. ug/L			Spk.Level ug/L	Recovery %			Limits %		Flags	
	MS	MSD	Sample		MS	MSD	RPD	Rec.	RPD	MS	MSD
Methyl tert-butyl ether	158	247	105	125	42.4	113.6	91.3	65-165	20	M5	R1
Benzene	177	202	87.8	125	71.4	91.4	24.6	69-129	20		R1
Toluene	108	120	8.18	125	79.9	89.5	11.3	70-130	20		
<b>Surrogate(s)</b>											
1,2-Dichloroethane-d4	378	495		500	75.6	99.0		73-130			
Toluene-d8	454	453		500	90.8	90.6		81-114			

**Gas/BTEX Fuel Oxygenates by 8260B (C6-C12)**

Blaine Tech Services, Inc.

Attn.: Leon Gearhart

1680 Rogers Avenue  
San Jose, CA 95112-1105  
Phone: (408) 573-0555 Fax: (408) 573-7771

Project: 98995822

Received: 07/20/2005 15:50

Site: 29 Wildwood Avenue, Piedmont

**Batch QC Report**

Prep(s): 5030B

Test(s): 8260B

**Matrix Spike ( MS / MSD )**

**Water**

**QC Batch # 2005/08/01-2A.65**

MS/MSD

Lab ID: 2005-07-0722 - 002

MS: 2005/08/01-2A.65-011

Extracted: 08/01/2005

Analyzed: 08/01/2005 19:11

Dilution: 1.00

MSD: 2005/08/01-2A.65-037

Extracted: 08/01/2005

Analyzed: 08/01/2005 19:37

Dilution: 5.00

Compound	Conc. ug/L			Spk.Level ug/L	Recovery %			Limits %		Flags	
	MS	MSD	Sample		MS	MSD	RPD	Rec.	RPD	MS	MSD
Methyl tert-butyl ether	23.4	23.0	ND	25	93.6	92.0	1.7	65-165	20		
Benzene	22.5	25.0	ND	25	90.0	100.0	10.5	69-129	20		
Toluene	22.6	24.9	ND	25	90.4	99.6	9.7	70-130	20		
<b>Surrogate(s)</b>											
1,2-Dichloroethane-d4	510	481		500	101.9	96.2		73-130			
Toluene-d8	483	506		500	96.6	101.2		81-114			

Severn Trent Laboratories, Inc.

STL San Francisco \* 1220 Quarry Lane, Pleasanton, CA 94566

Tel 925 484 1919 Fax 925 484 1096 \* www.stl-inc.com \* CA DHS ELAP# 2496

08/02/2005 18:54

**Gas/BTEX Fuel Oxygenates by 8260B (C6-C12)**

Blaine Tech Services, Inc.

Attn.: Leon Gearhart

1680 Rogers Avenue

San Jose, CA 95112-1105

Phone: (408) 573-0555 Fax: (408) 573-7771

Project: 98995822

Received: 07/20/2005 15:50

Site: 29 Wildwood Avenue, Piedmont

---

**Legend and Notes**

---

**Analysis Flag**

L2

Reporting limits were raised due to high level of analyte present in the sample.

**Result Flag**

M3

Sample &gt; 4x spike concentration.

M5

MS/MSD spike recoveries were below acceptance limits.  
See blank spike (LCS).

Q6

The concentration reported reflect(s) individual or discrete unidentified peaks not matching a typical fuel pattern.

R1

Analyte RPD was out of QC limits.



### WELL GAUGING DATA

Project # 050719-PM2 Date 7-19-05 Client SHELL 98995822

Site 29 Wildwood, Piedmont

Well ID	Well Size (in.)	Sheen / Odor	Depth to Immiscible Liquid (ft.)	Thickness of Immiscible Liquid (ft.)	Volume of Immiscibles Removed (ml)	Depth to water (ft.)	Depth to well bottom (ft.)	Survey Point: TOB or <u>TOC</u>
MW-1	4					3.45	13.05	TOC
MW-2	4					4.00	11.60	↓
MW-3	4					3.32	9.00	
MW-4	4					3.85	13.05	
MW-5	4					4.42	16.00	

## SHELL WELL MONITORING DATA SHEET

BTS #: 050719-PM2	Site: SHELL 98995822
Sampler: PM	Date: 7-19-05
Well I.D.: MW-1	Well Diameter: 2 3 <u>4</u> 6 8
Total Well Depth (TD): 13.05	Depth to Water (DTW): 3.45
Depth to Free Product:	Thickness of Free Product (feet):
Referenced to: <u>PVC</u> Grade	D.O. Meter (if req'd): <u>YSI</u> HACH
DTW with 80% Recharge [(Height of Water Column x 0.20) + DTW]: 5.37	

Purge Method: Bailer      Waterra      Sampling Method: Bailer  
 Disposable Bailer      Peristaltic      Disposable Bailer  
 Positive Air Displacement      Extraction Pump      Extraction Port  
Electric Submersible      Other \_\_\_\_\_      Dedicated Tubing

Other: \_\_\_\_\_

6.2 (Gals.) X	3	=	18.6	Gals.	
1 Case Volume	Specified Volumes		Calculated Volume		

Well Diameter	Multiplier	Well Diameter	Multiplier
1"	0.04	4"	0.65
2"	0.16	6"	1.47
3"	0.37	Other	radius <sup>2</sup> * 0.163

Time	Temp (°F)	pH	Cond. (mS or <u>µS</u> )	Turbidity (NTUs)	Gals. Removed	Observations
1613	71.6	8.0	766	36.9	6.2	clear
1614	71.8	7.9	779	57	17.4	"
1616	70.2	7.1	812	132	18.6	"
	DTW = 9.73 @ 1617					

Did well dewater? Yes  No  Gallons actually evacuated: 18.6

Sampling Date: 7-19-05      Sampling Time: 1630      Depth to Water: 5.22

Sample I.D.: MW-1      Laboratory: STL Other \_\_\_\_\_

Analyzed for: TPH-G BTEX MTBE TPH-D Other: See Staff

EB I.D. (if applicable): @ Time Duplicate I.D. (if applicable):

Analyzed for: TPH-G BTEX MTBE TPH-D Other:

D.O. (if req'd):	Pre-purge:	mg/L	Post-purge:	mg/L
O.R.P. (if req'd):	Pre-purge:	mV	Post-purge:	mV



## SHELL WELL MONITORING DATA SHEET

BTS #: 050719-PM2	Site: SHELL 98995822
Sampler: PM	Date: 7-19-05
Well I.D.: MW-2	Well Diameter: 2 3 (4) 6 8
Total Well Depth (TD): 11.60	Depth to Water (DTW): 4.00
Depth to Free Product:	Thickness of Free Product (feet):
Referenced to: (PVC) Grade	D.O. Meter (if req'd): (YSI) HACH
DTW with 80% Recharge [(Height of Water Column x 0.20) + DTW]: 5.52	

Purge Method: Bailer      Waterra      Sampling Method: (Bailer)  
 Disposable Bailer      Peristaltic      Disposable Bailer  
 Positive Air Displacement      Extraction Pump      Extraction Port  
 Electric Submersible      Other \_\_\_\_\_      Dedicated Tubing  
 Other: \_\_\_\_\_

4.9 (Gals.) X 3 = 14.7 Gals. I Case Volume      Specified Volumes      Calculated Volume	<table border="1" style="width: 100%; border-collapse: collapse;"> <thead> <tr> <th>Well Diameter</th> <th>Multiplier</th> <th>Well Diameter</th> <th>Multiplier</th> </tr> </thead> <tbody> <tr> <td>1"</td> <td>0.04</td> <td>4"</td> <td>0.65</td> </tr> <tr> <td>2"</td> <td>0.16</td> <td>6"</td> <td>1.47</td> </tr> <tr> <td>3"</td> <td>0.37</td> <td>Other</td> <td>radius<sup>2</sup> * 0.163</td> </tr> </tbody> </table>	Well Diameter	Multiplier	Well Diameter	Multiplier	1"	0.04	4"	0.65	2"	0.16	6"	1.47	3"	0.37	Other	radius <sup>2</sup> * 0.163
Well Diameter	Multiplier	Well Diameter	Multiplier														
1"	0.04	4"	0.65														
2"	0.16	6"	1.47														
3"	0.37	Other	radius <sup>2</sup> * 0.163														

Time	Temp (°F)	pH	Cond. (mS or µS)	Turbidity (NTUs)	Gals. Removed	Observations
1648	76.6	7.7	672	738	4.9	cloudy / odor
1649	77.6	7.3	613	40.2	9.8	clear / odor
<del>1650</del>	Well dewatered @ 9.8 gal.					
	DTW = 9.42 @ 1654					
	DTW = 7.10 @ 1725 / 6.50 @ 1735					

Did well dewater? (Yes) No      Gallons actually evacuated: 9.8

Sampling Date: 7-19-05      Sampling Time: ~~1750~~ 1750      Depth to Water: <sup>to</sup> site departure 6.42

Sample I.D.: MW-2      Laboratory: (STL) Other \_\_\_\_\_

Analyzed for: (TPH-G) BTEX MTBE TPH-D      Other: See Scope

EB I.D. (if applicable): @ Time      Duplicate I.D. (if applicable):

Analyzed for: TPH-G BTEX MTBE TPH-D      Other:

D.O. (if req'd):	Pre-purge:	mg/L	Post-purge:	mg/L
				1.64
O.R.P. (if req'd):	Pre-purge:	mV	Post-purge:	mV

## SHELL WELL MONITORING DATA SHEET

BTS #: 050719-PM2	Site: SHELL 98995822
Sampler: PM	Date: 7-19-05
Well I.D.: MW-3	Well Diameter: 2 3 <u>4</u> 6 8
Total Well Depth (TD): 9.00	Depth to Water (DTW): 3.32
Depth to Free Product:	Thickness of Free Product (feet):
Referenced to: <u>PVC</u> Grade	D.O. Meter (if req'd): <u>YSI</u> HACH
DTW with 80% Recharge [(Height of Water Column x 0.20) + DTW]: 4.46	

Purge Method: Bailer      Waterria      Sampling Method: Bailer  
 Disposable Bailer      Peristaltic      Disposable Bailer  
 Positive Air Displacement      Extraction Pump      Extraction Port  
 Electric Submersible      Other \_\_\_\_\_      Dedicated Tubing

Other: \_\_\_\_\_

$3.7$ (Gals.) X $3$ = $11.1$ Gals. 1 Case Volume      Specified Volumes      Calculated Volume	<table border="1" style="width: 100%; border-collapse: collapse; font-size: small;"> <tr> <th>Well Diameter</th> <th>Multiplier</th> <th>Well Diameter</th> <th>Multiplier</th> </tr> <tr> <td>1"</td> <td>0.04</td> <td>4"</td> <td>0.65</td> </tr> <tr> <td>2"</td> <td>0.16</td> <td>6"</td> <td>1.47</td> </tr> <tr> <td>3"</td> <td>0.37</td> <td>Other</td> <td>radius<sup>2</sup> * 0.163</td> </tr> </table>	Well Diameter	Multiplier	Well Diameter	Multiplier	1"	0.04	4"	0.65	2"	0.16	6"	1.47	3"	0.37	Other	radius <sup>2</sup> * 0.163
Well Diameter	Multiplier	Well Diameter	Multiplier														
1"	0.04	4"	0.65														
2"	0.16	6"	1.47														
3"	0.37	Other	radius <sup>2</sup> * 0.163														

Time	Temp (°F)	pH	Cond. (mS or µS)	Turbidity (NTUs)	Gals. Removed	Observations
1713				38.0	3.7	clear/odor
1718				43.9	7.4	
	Well dewatered @ 7.4 gal					
	DTW = 5.20 @ 1723					

Did well dewater?  Yes    No      Gallons actually evacuated: 7.4

Sampling Date: 7-19-05    Sampling Time: 1729    Depth to Water: 4.30

Sample I.D.: MW-3      Laboratory: STL Other \_\_\_\_\_

Analyzed for: TPH-G BTEX MTBE TPH-D Other: See Scope

EB I.D. (if applicable): \_\_\_\_\_ Time \_\_\_\_\_ Duplicate I.D. (if applicable): \_\_\_\_\_

Analyzed for: TPH-G BTEX MTBE TPH-D Other: \_\_\_\_\_

D.O. (if req'd):	Pre-purge:	mg/L	Post-purge:	3.08 mg/L
O.R.P. (if req'd):	Pre-purge:	mV	Post-purge:	mV

## SHELL WELL MONITORING DATA SHEET

BTS #: 050719-PM7	Site: SHELL 98995822
Sampler: PM	Date: 7-19-05
Well I.D.: MW-4	Well Diameter: 2 3 (4) 6 8
Total Well Depth (TD): 13.05	Depth to Water (DTW): 3.85
Depth to Free Product:	Thickness of Free Product (feet):
Referenced to: (PVC) Grade	D.O. Meter (if req'd): (YSI) HACH
DTW with 80% Recharge [(Height of Water Column x 0.20) + DTW]: 5.69	

Purge Method: Bailer      Watera      Sampling Method: (Bailer)

Disposible Bailer      Peristaltic      Disposable Bailer

Positive Air Displacement      Extraction Pump      Extraction Port

(Electric Submersible)      Other \_\_\_\_\_      Dedicated Tubing

Other: \_\_\_\_\_

6 (Gals.) X 3 = 18 Gals.

1 Case Volume      Specified Volumes      Calculated Volume

Well Diameter	Multiplier	Well Diameter	Multiplier
1"	0.04	4"	0.65
2"	0.16	6"	1.47
3"	0.37	Other	radius <sup>2</sup> * 0.163

Time	Temp (°F)	pH	Cond. (mS or µS)	Turbidity (NTUs)	Gals. Removed	Observations
1006	80.8	8.0	423	> 1000	6	cloudy
1007	79.2	7.4	429	> 1000	12	"
1008	78.0	7.2	442	> 1000	18	"

Did well dewater? Yes  No  Gallons actually evacuated: 18

Sampling Date: 7-19-05      Sampling Time: 1516      Depth to Water: 4.78

Sample I.D.: MW-4      Laboratory: (STL) Other \_\_\_\_\_

Analyzed for: ~~TPH-G~~ BTEX MTBE TPH-D Other: see scope

EB I.D. (if applicable): \_\_\_\_\_ @ \_\_\_\_\_ Time      Duplicate I.D. (if applicable): \_\_\_\_\_

Analyzed for: ~~TPH-G~~ BTEX MTBE TPH-D Other: S

D.O. (if req'd):	Pre-purge:	mg/L	Post-purge: 2.78 mg/L
O.R.P. (if req'd):	Pre-purge:	mV	Post-purge: mV

