

Atlantic Richfield Company

Shannon Couch
Operations Project Manager

PO Box 1257
San Ramon, CA 94583
Phone: (925) 275-3804
Mobile: (510) 798-8314
E-Mail: Shannon.Couch1@bp.com

January 21, 2013

Re: Fourth Quarter 2013 Status Report
Atlantic Richfield Company Station #2111
1156 Davis Street, San Leandro, California
ACEH Case #RO0000494

RECEIVED

By Alameda County Environmental Health at 3:00 pm, Jan 28, 2013

"I declare, that to the best of my knowledge at the present time, that the information and/or recommendations contained in the attached document are true and correct."

Submitted by,



Shannon Couch
Operations Project Manager

Attachment:

January 21, 2013

Project No. 06-88-615

Atlantic Richfield Company
P.O. Box 1257
San Ramon, CA 94583
Submitted via ENFOS

Attn.: Ms. Shannon Couch

Re: Fourth Quarter 2012 Status Report, Atlantic Richfield Company Station #2111,
1156 Davis Street, San Leandro, Alameda County, California; ACEH Case #RO0000494

Dear Ms. Couch:

Attached is the *Fourth Quarter 2012 Status Report* for Atlantic Richfield Company Station #2111 located at 1156 Davis Street, Alameda County, California (Site). This report presents a summary of current developments at the Site through the Fourth Quarter of 2012. Should you have questions regarding the work performed or results obtained, please do not hesitate to contact us at (707) 455-7290.

Sincerely,
BROADBENT & ASSOCIATES, INC.

James Ramos, EIT
Senior Staff Engineer

Kristene Tidwell, P.G., C.Hg.
Senior Geologist

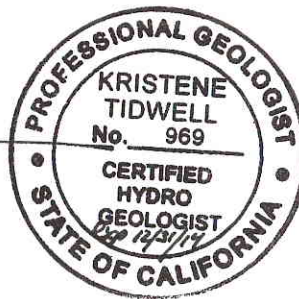

Enclosures

cc: Ms. Dilan Roe, Alameda County Environmental Health (submitted via ACEH ftp site)
Mr. Karl Busche, City of San Leandro Environmental Services Division, 835 East 14th
Street, San Leandro, California 945977 (Submitted via Geo Tracker)
Electronic copy uploaded to GeoTracker

**FOURTH QUARTER 2012
STATUS REPORT
STATION #2111, SAN LEANDRO, CALIFORNIA**

Broadbent & Associates, Inc. (Broadbent) is pleased to present this *Fourth Quarter 2012 Status Report* on behalf of Atlantic Richfield Company (ARC, a BP affiliated company) for Station #2111 located in San Leandro, Alameda County, California. Monitoring activities at the site were performed in accordance with the reporting requirements issued by the Alameda County Environmental Health (ACEH). Details of work performed, discussion of results, and recommendations are provided below.

Facility Name / Address:	Station #2111 / 1156 Davis Street, San Leandro, California
Client Project Manager / Title:	Ms. Shannon Couch, Remediation Management Project Manager
Broadbent Contact:	Kristene Tidwell, P.G., C.Hg., (707) 455-7290
Broadbent Project No.:	06-88-615
Primary Regulatory Agency / ID No.:	Alameda County Environmental Health (ACEH)/ Case #RO0000494
Current phase of project:	Monitoring
List of Acronyms / Abbreviations:	See end of report text for list of acronyms/abbreviations used in report.

WORK PERFORMED THIS QUARTER (Fourth Quarter 2012):

1. Submitted *Third Quarter 2012 Monitoring Report* on October 26, 2012 (Q3 GWM Report).
2. Submitted the *Revised Soil and Groundwater Investigation Work Plan* dated October 25, 2012 (Work Plan).
3. No environmental field activities were conducted for Fourth Quarter 2012.

WORK SCHEDULED FOR NEXT QUARTER (First Quarter 2013):

1. Submit *Fourth Quarter 2012 Status Report* (contained herein).
2. Conduct First Quarter 2013 groundwater monitoring and sampling event.
3. Prepare and submit a revised work plan considering additional ACEH requirements.

GROUNDWATER MONITORING PLAN SUMMARY:

Groundwater level gauging:	MW-1 through MW-8	(1Q & 3Q)
Groundwater sample collection:	MW-1 through MW-5, MW-7 and MW-8	(1Q & 3Q)
	MW-6	(3Q)
Biodegradation indicator parameter monitoring:	None	

QUARTERLY RESULTS SUMMARY:

LNAPL

LNAPL observed this quarter:	N/A	(yes/no)
LNAPL recovered this quarter:	N/A	(gal)
Cumulative LNAPL recovered:	N/A	(gal)

Groundwater Elevation and Gradient:

Depth to groundwater:	N/A	(ft below TOC)
Gradient direction:	N/A	(compass direction)
Gradient magnitude:	N/A	(ft/ft)
Average change in elevation:	N/A	(ft since last measurement)

Laboratory Analytical Data

Summary:

No environmental field activities were conducted during Fourth Quarter 2012.

DISCUSSION:

No environmental field work was conducted by Broadbent at the Site during the Fourth Quarter of 2012. The most recent groundwater monitoring/sampling occurred during the Third Quarter 2012, the results of which are contained within the Q3 GWM Report. Currently, reevaluation to the scope of a potential offsite investigation is being evaluated in order to expedite activities. Access to one property has as of yet not been obtained, despite repeated efforts. A *Revised Soil and Groundwater Investigation Work Plan* dated October 25, 2012 was submitted during the fourth quarter and proposed additional offsite investigation activities. The ACEH responded to this document in an email dated January 14, 2013. This email requested a revised work plan be submitted with additional requirements. This revised work plan will be submitted during the first quarter 2013. A site location map is presented as Drawing 1 and a groundwater elevation and analytical summary map from the most recent third quarter monitoring and sampling event is provided as Drawing 2.

LIMITATIONS:

The findings presented in this report are based upon observations of field personnel, points investigated, results of laboratory tests performed by TestAmerica Laboratories, Inc. (Irvine, California), and our understanding of ACEH requirements. Our services were performed in accordance with the generally accepted standard of practice at the time this report was written. No other warranty, expressed or implied was made. This report has been prepared for the exclusive use of the Atlantic Richfield Company. It is possible that variations in soil or groundwater conditions could exist beyond points explored in this investigation. Also, changes in site conditions could occur in the future due to variations in rainfall, temperature, regional water usage, or other factors.

ATTACHMENTS:

- Drawing 1: Site Location Map, Station #2111, 1156 Davis Street, San Leandro, California
Drawing 2: Groundwater Elevation Contours and Analytical Summary Map, September 28, 2012, Station #2111, 1156 Davis Street, San Leandro, California

LIST OF COMMONLY USED ACCRONYMS/ABBREVIATIONS:

ACEH:	Alameda County Environmental Health	ft/ft:	feet per foot
Broadbent:	Broadbent & Associates, Inc.	gal:	Gallons
BTEX:	Benzene, Toluene, Ethylbenzene, Total Xylenes	GRO:	Gasoline-Range Organics
1,2-DCA:	1,2-Dichloroethane	LNAPL:	Light Non-Aqueous Phase Liquid
DIPE:	Di-Isopropyl Ether	MTBE:	Methyl Tertiary Butyl Ether
DO:	Dissolved Oxygen	NO ₃ :	Nitrate as Nitrogen
DRO:	Diesel-Range Organics	ppb:	parts per billion
EDB:	1,2-Dibromomethane	SO ₄ :	Sulfate
Eh:	Oxidation Reduction Potential	TAME:	Tert-Amyl Methyl Ether
EPA:	Environmental Protection Agency	TBA:	Tertiary Butyl Ether
ETBE:	Ethyl Tertiary Butyl Ether	TOC:	Top of Casing
Fe ²⁺ :	Ferrous Iron	µg/L:	Micrograms per liter

DRAWINGS

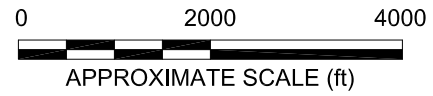
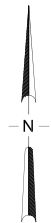
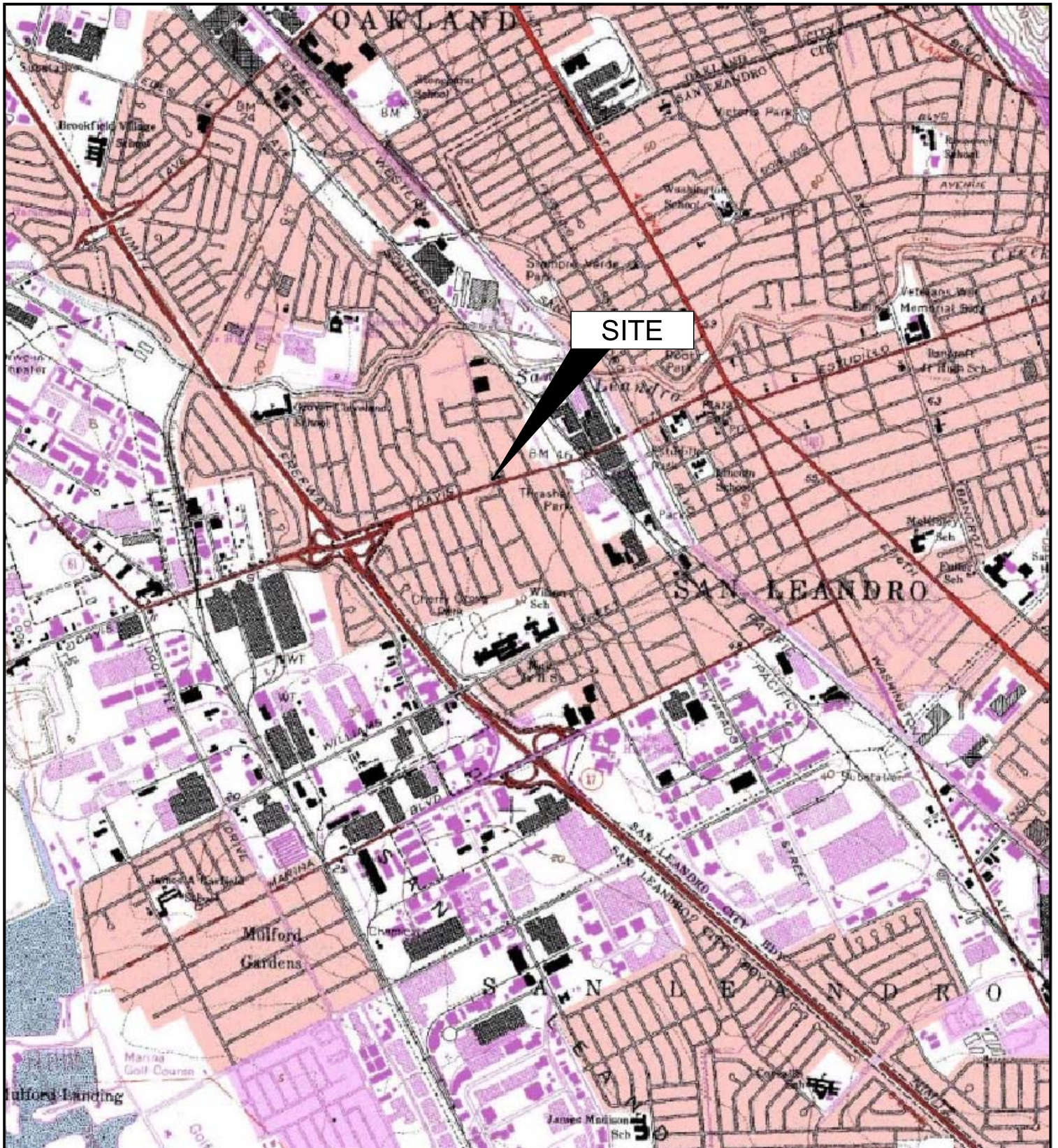

IMAGE SOURCE: USGS



1324 Mangrove Ave., Suite 212
Chico, California 95926

Project No.: 06-88-615 Date: 9/28/2012

Station #2111
1156 Davis Street
San Leandro, California

Site Location Map

Drawing

1

LEGEND

- MONITORING WELL
- VAPOR EXTRACTION WELL
- SOIL BORING LOCATION
- HYDROPUNCH LOCATION
- DESTROYED WELL
- SA(1,3) SAMPLED SEMI-ANNUALLY
- A(3) SAMPLED ANNUALLY, THIRD QUARTER
- < NOT DETECTED AT OR ABOVE LABORATORY REPORTING LIMIT
- 22.2 GROUNDWATER ELEVATION CONTOUR (FT)
- APPROXIMATE GROUNDWATER GRADIENT (FT/FT)

Well	WELL DESIGNATION
ELEV	GROUNDWATER ELEVATION (FT)
GRO	GRO, BENZENE, AND MTBE CONCENTRATIONS (µg/L)
Benzene	
MTBE	
A/Q	SAMPLING FREQUENCY

NOTE: SITE MAP ADAPTED FROM DELTA ENVIRONMENTAL FIGURES. SITE DIMENSIONS AND FACILITY LOCATIONS NOT VERIFIED.

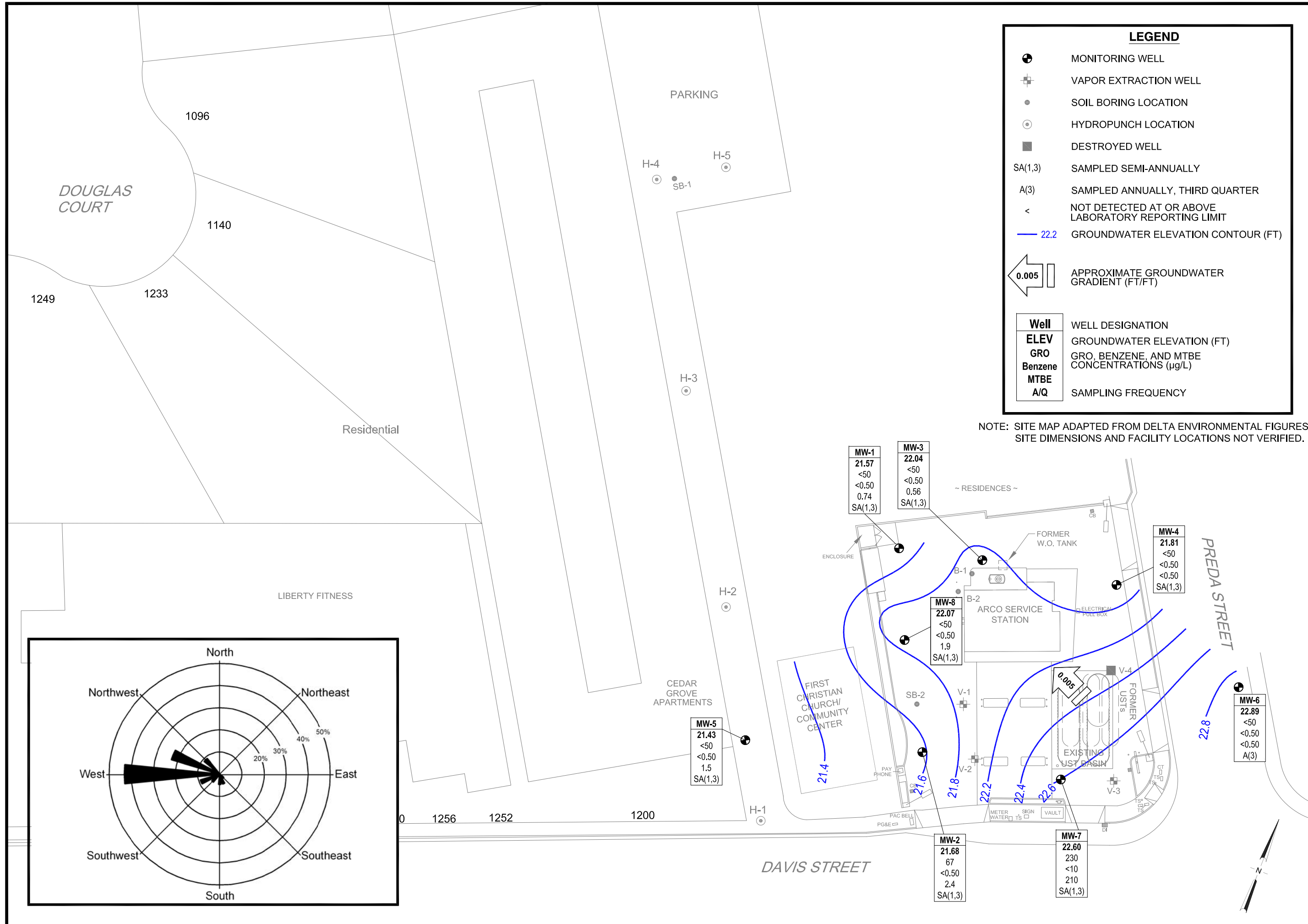

MW-1
21.57
<50
<0.50
0.74
SA(1,3)

MW-3
22.04
<50
<0.50
0.56
SA(1,3)

MW-4
21.81
<50
<0.50
<0.50
SA(1,3)

MW-8
22.07
<50
<0.50
1.9
SA(1,3)

MW-6
22.89
<50
<0.50
<0.50
A(3)

MW-5
21.43
<50
<0.50
1.5
SA(1,3)

MW-2
21.68
67
<0.50
2.4
SA(1,3)

MW-7
22.60
230
<10
210
SA(1,3)

