

ExxonMobil
Refining & Supply Company
Global Remediation

Gene N. Ortega
Territory Manager
Global Remediation -- US Retail

2300 Clayton Road, Suite 1250
Concord, CA 94520
(925) 246-8747 Telephone
(925) 246-8798 Facsimile
gene.n.ortega@exxonmobil.com

ExxonMobil
Refining & Supply

October 7, 2002

20491

Mr. Barney Chan
Alameda County Health Care Services Agency
Department of Environmental Health
1131 Harbor Bay Parkway, Room 250
Alameda, California 94502-6577

Alameda County
OCT 11 2002
Environmental Health

RE: Former Exxon RAS #7-3006/720 High Street, Oakland, California.

Dear Mr. Chan:

Attached for your review and comment is a letter report entitled *Quarterly Site Status Report, Third Quarter 2002*, dated October 7, 2002, for the above-referenced site. The report was prepared by Environmental Resolutions, Inc. (ERI) of Novato, California, and presents the details the status of activities at the subject site.

If you have any questions or comments, please contact me at (925) 246-8747.

Sincerely,



Gene N. Ortega
Territory Manager

Attachment: ERI's Quarterly Site Status Report, Third Quarter 2002, dated October 7, 2002.

cc: w/ attachment
Mr. Chuck Headlee, California Regional Water Quality Control Board, San Francisco Bay Region
Mr. Victor Chu, C/O Law Offices of Gerald Lam

w/o attachment
Ms. Paula Sime, Environmental Resolutions, Inc.

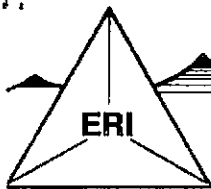

October 7, 2002
ERI 201013.R25

Alameda County
OCT 11 2002
Environmental Health

Mr. Gene N. Ortega
ExxonMobil Oil Corporation
2300 Clayton Road, Suite 1250
Concord, California 94520

Subject: Quarterly Site Status Report, Third Quarter 2002, Former Exxon Service Station 7-3006, 720 High Street, Oakland, California.

Mr. Ortega:

At the request of ExxonMobil Oil Corporation (ExxonMobil), Environmental Resolutions, Inc. (ERI) is reporting the third quarter 2002 status for the subject site. The location of the site is shown on the Site Vicinity Map (Plate 1). The locations of groundwater monitoring wells and select site features are shown on the Generalized Site Plan (Plate 2).

GROUNDWATER MONITORING AND SAMPLING

Groundwater monitoring and sampling at this site is performed on an annual basis, during the first quarter of the year. ERI submitted the first quarter 2002 annual monitoring and sampling report on May 23, 2002.

SOIL AND GROUNDWATER REMEDIATION

Air Sparge/Soil Vapor Extraction

ExxonMobil operated an air sparge/soil vapor extraction (AS/SVE) system at the site from August 1996 through July 28, 1999. The AS/SVE system removed approximately 5,144 pounds of total petroleum hydrocarbons as gasoline (TPHg) and 61 pounds of benzene during its operational period.

Groundwater Extraction and Treatment

ExxonMobil operated a groundwater remediation system (GRS) at the site from January 1, 1995, through December 23, 1998. The GRS removed approximately 10 pounds of gasoline hydrocarbons (calculated as TPHg) and 3 pounds of benzene during its operational period.

Bio-Sparge System

ERI is currently operating a bio-sparge system at the site. The system uses an air compressor to pump air into an on-site groundwater interceptor trench to enhance biodegradation.

STATUS OF INVESTIGATION

At the request of ExxonMobil, ERI is continuing annual groundwater monitoring and sampling at the site. The site is currently an active Texaco service station. Groundwater monitoring wells MW3, MW4, and MW12 were paved over during station remodeling. ERI has located and uncovered MW3. ERI anticipates that MW12 will be uncovered by the first quarter 2003 annual monitoring and sampling event. ERI will attempt to locate and uncover MW4; however, it is likely that a utility conduit is blocking access to this well.

ERI will continue to operate the biosparge system to enhance biodegradation at the site.

DOCUMENT DISTRIBUTION

ERI recommends forwarding copies of this report to:

Mr. Barney Chan
Alameda County Health Care Services Agency
Department of Environmental Health
1131 Harbor Bay Parkway, Room 250
Alameda, California 94502

Mr. Chuck Headlee
California Regional Water Quality Control Board
San Francisco Bay Region
1515 Clay Street, Suite 1400
Oakland, California 94612

Mr. Victor Chu
c/o Law offices of Gerald Lam
1407 Webster Street, # 216
Oakland, California 94612

LIMITATIONS

This report was prepared in accordance with generally accepted standards of environmental practice in California at the time this investigation was performed. This report has been prepared for ExxonMobil, and any reliance on this report by third parties shall be at such party's sole risk.

Please call Ms. Paula Sime, ERI's senior staff geologist for this site, at (415) 382-4324 with any questions regarding this project.

Sincerely,
Environmental Resolutions, Inc.



Paula Sime
Senior Staff Geologist

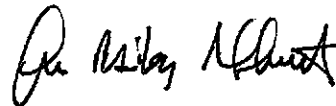

John B. Bobbitt
R.G. 4313

Attachments: Plate 1: Site Vicinity Map
Plate 2: Generalized Site Plan

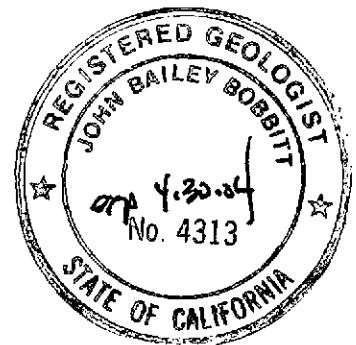

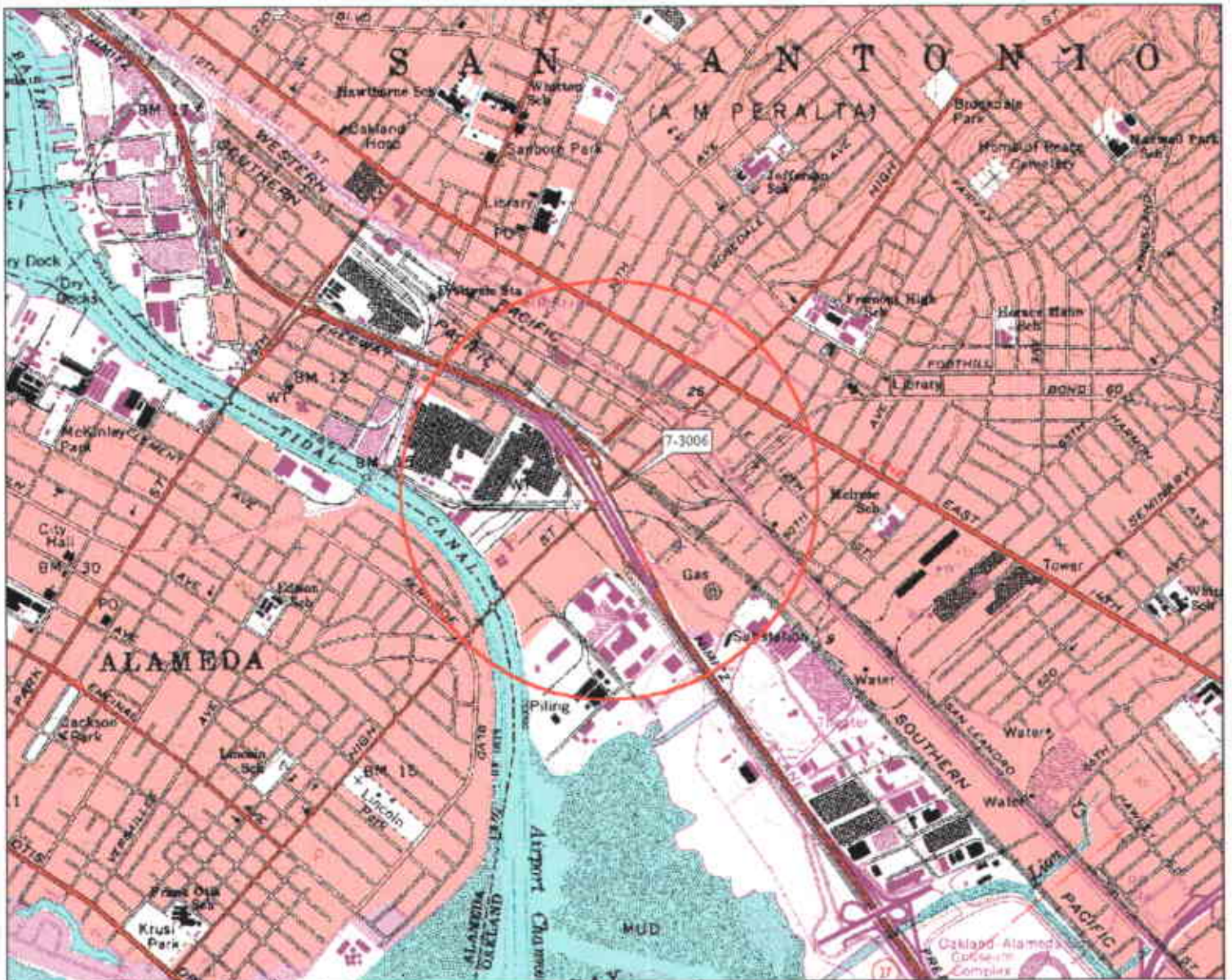

© 2010 DeLorme Topographic Maps, Inc. All rights reserved. Source Data: 1972
 1:25,000 Scale 1:25,000 Datum: NAD83

FN 2010

EXPLANATION



1/2-mile radius circle



APPROXIMATE SCALE

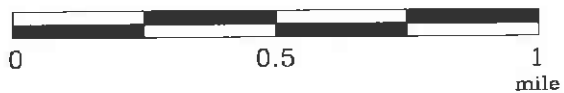

SOURCE:
 Modified from a map
 provided by
 DeLorme 3-D TopoQuads



SITE VICINITY MAP

FORMER EXXON SERVICE STATION 7-3006
 720 High Street
 Oakland, California

PROJECT NO.

2010

PLATE

1

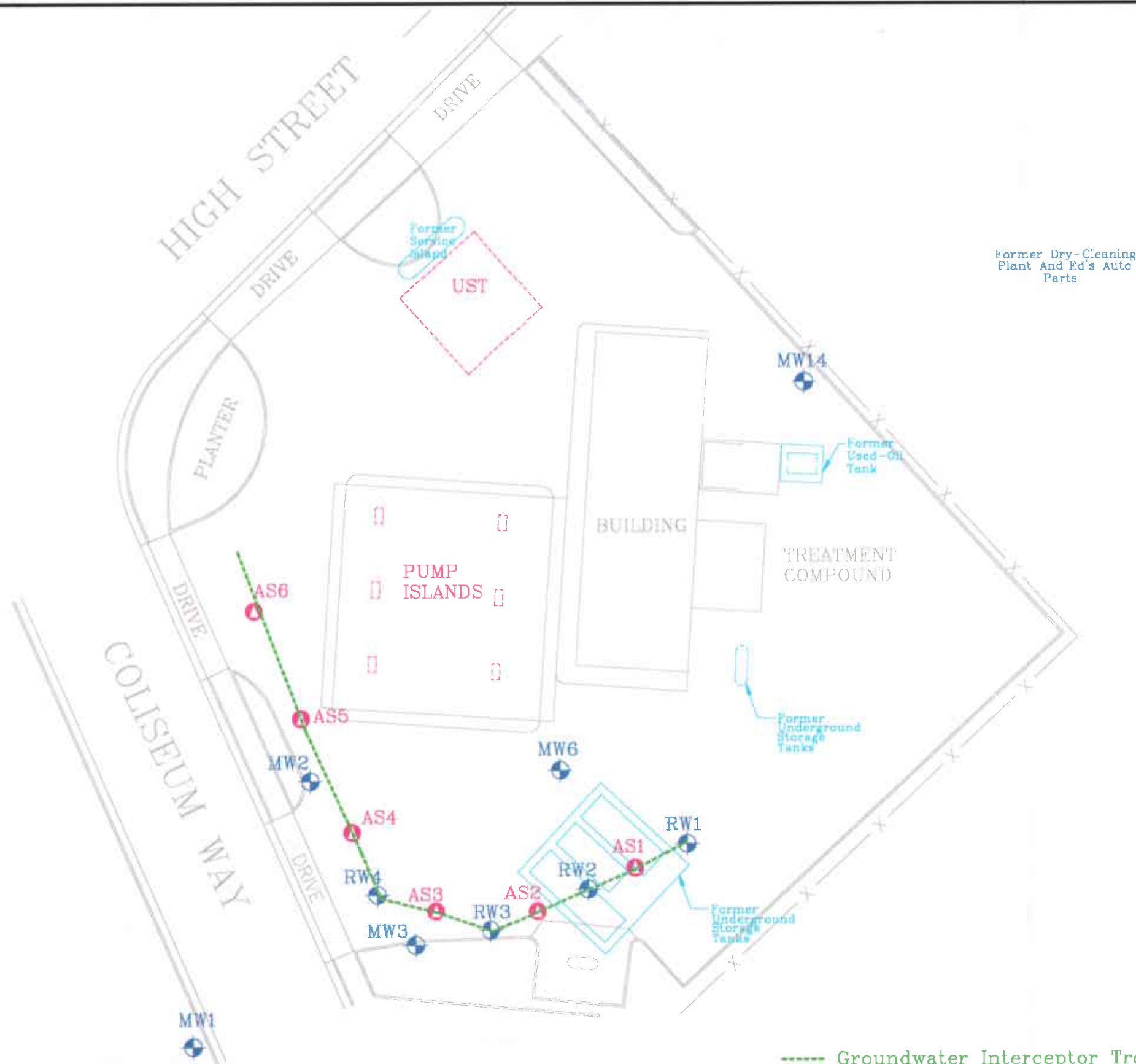

Former Dry-Cleaning
Plant And Ed's Auto
Parts

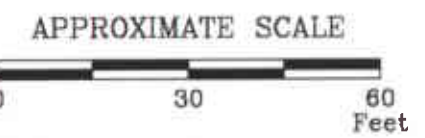

FN 20100004

SOURCE:
Modified from a map
provided by
Morrow Surveying

----- Groundwater Interceptor Trench



GENERALIZED SITE PLAN
FORMER
EXXON SERVICE STATION 7-3006
720 High Street
Oakland, California

EXPLANATION
MW14
 Groundwater Monitoring Well
AS6
 Air Sparging/Vapor Extraction Well

PROJECT NO.
2010
PLATE
2