

**CONSOLIDATED TECHNOLOGIES**  
**RESULTS FOR PRELIMINARY SUBSURFACE**  
**SITE INVESTIGATION**

**SUBJECT ADDRESS:** 706 HARRISON STREET, OAKLAND,  
California.

**PROJECT MANAGERS:** TRACY BENNETT, DAVID HOBBS &  
CHRIS MOLINARI

**By:** TRACY BENNETT

*Dec 9/92*

**ENVIRONMENTAL SERVICES**  
**BY**  
**CONSOLIDATED TECHNOLOGIES**  
**&**  
**TERRY LINDSEY EXCAVATING**  
**A GENERAL ENGINEERING FIRM**

1777 SARATOGA AVE. SAN JOSE, CA. 95129

SITE ADDRESS: 706 HARRISON ST. OAKLAND, CA.

TYPE OF WORK: LIMITED SUBSURFACE INVESTIGATION BY EXCAVATION.

JOB NOTES:

Consolidated Technologies was contracted to perform a limited subsurface site investigation at 706 Harrison St. Oakland, Ca.

Consolidated arrived at the above site at 8:30 am on the ~~11th day of December 1991~~ to commence the project. From 8:30am until 4:00pm Consolidated with the assistance of Terry Lindsey excavating moved all the surface piles and piping left from the previous contractor into uniform order.

At 4:00pm Paul Smith from Alameda County Environmental Health (ACEH) (Hazardous Material Division) arrived on site. Under the supervision of the (ACEH) we commenced sampling in the former tank pits.

The purpose of sampling this site was to confirm the suspicion of the property owner that the samples taken at the tank removal may not have been representative of the alleged contamination present.

The following is the results of this project.

Analysis performed:

- S-1: TPHG; BTEX (5030\8020)
- S-2: TPHG; BTEX
- S-2A: TPHG; BTEX
- S-3: TPHG; BTEX
- S-4: TPHG; BTEX
- S-5: TPHG; BTEX
- GS-5: TPHG; BTEX
- S-6: TPHG; BTEX
- GS-6: TPHG; BTEX
- S-7: TPHG; BTEX
- GS-7: TPHG; BTEX
- S-8: SOLUBLE LEAD (7010 STLC)

**CONSOLIDATED TECHNOLOGIES**  
Environmental Services

- Project Management
- Tank Removal
- Engineering
- Site Assessment
- Soil Remediation

**Tracy Bennett**  
Sr. Environmental Specialist  
(408) 973-9532

1777 Saratoga Ave., Suite 100, San Jose, CA 95129

**SOIL SAMPLES:**

S-1; SOUTHEAST WALL OF THE #1 TANK PIT; 17' BELOW SURFACE GRADE; STRONG ODOR, LITTLE STAINING.

S-2; NORTHEAST SIDE WALL OF THE #1 TANK PIT; 11' BELOW SURFACE GRADE; LIGHT ODOR, LITTLE STAINING.

S-2A; SOUTHEAST WALL OF THE #2 TANK PIT; 11' BELOW SURFACE GRADE; LIGHT ODOR, NO STAINING.

S-3; NORTHEAST WALL OF THE #2 TANK PIT; 11' BELOW SURFACE GRADE; NO ODOR, NO STAINING.

S-4; SOUTHEAST WALL OF THE #3 TANK PIT; 11' BELOW SURFACE GRADE; LIGHT ODOR, LITTLE STAINING.

S-5; NORTHEAST WALL OF THE #3 TANK PIT; 11 1/4' BELOW SURFACE GRADE; LIGHT ODOR, NO STAINING.

GS-5; NORTHEAST WALL OF THE #4 TANK PIT; 17' BELOW SURFACE GRADE; MODERATE ODOR, LIGHT STAINING.

S-6; WEST END OF THE #5 TANK PIT; 13' BELOW SURFACE GRADE; NO ODOR, NO STAINING.

GS-6; WEST END OF THE #5 TANK PIT; 17' BELOW SURFACE GRADE; NO ODOR, NO STAINING.

S-7; SOUTHEAST END OF THE #6 TANK PIT; 11' BELOW SURFACE GRADE; NO ODOR, NO STAINING.

GS-7; SOUTHEAST END OF THE #6 TANK PIT; 16' BELOW SURFACE GRADE; NO ODOR, NO STAINING.

S-8; SOUTHWEST END OF THE FUEL DISPENSER ISLAND; 2 1/2' BELOW SURFACE GRADE; NO ODOR NO STAINING.

SEE SITE SCHEMATIC PLATE #2

SEE LABORATORY RESULTS ON PLATE #3

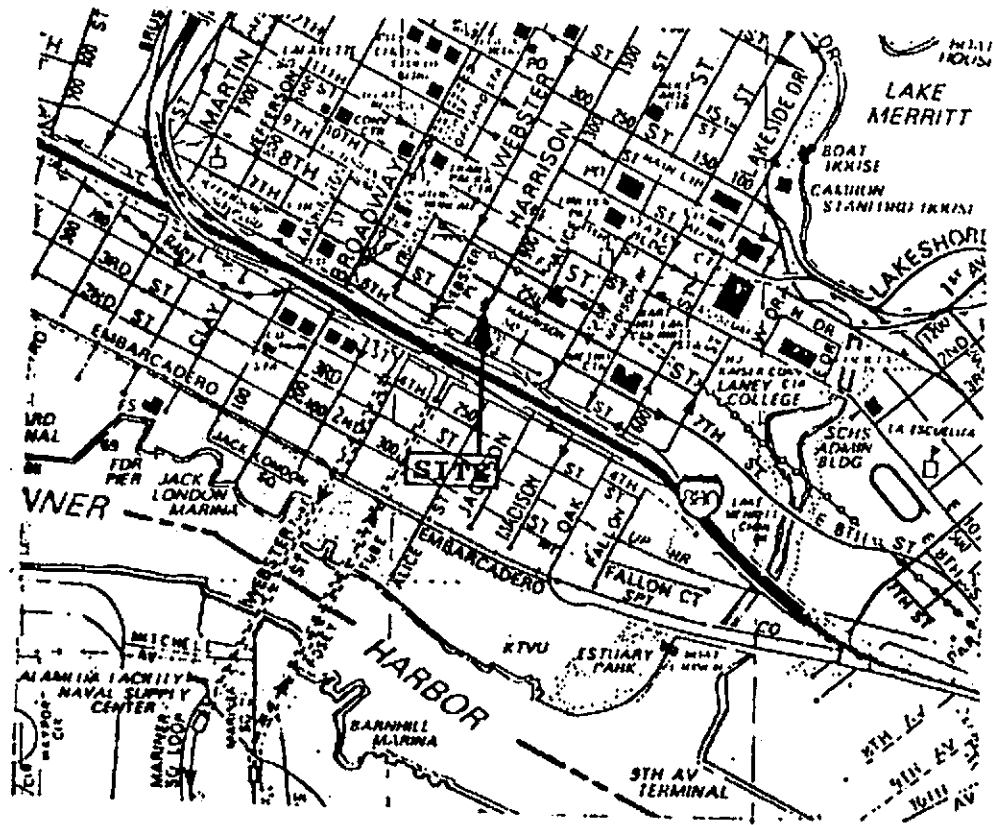
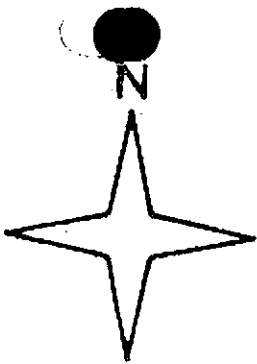

SCALE: None		APPROVED BY:	
DATE:		DRAWN BY	
		REVISED	
SITE LOCATION MAP 706 Harrison Street Oakland, California			
			plate 2
DRAWING NUMBER			

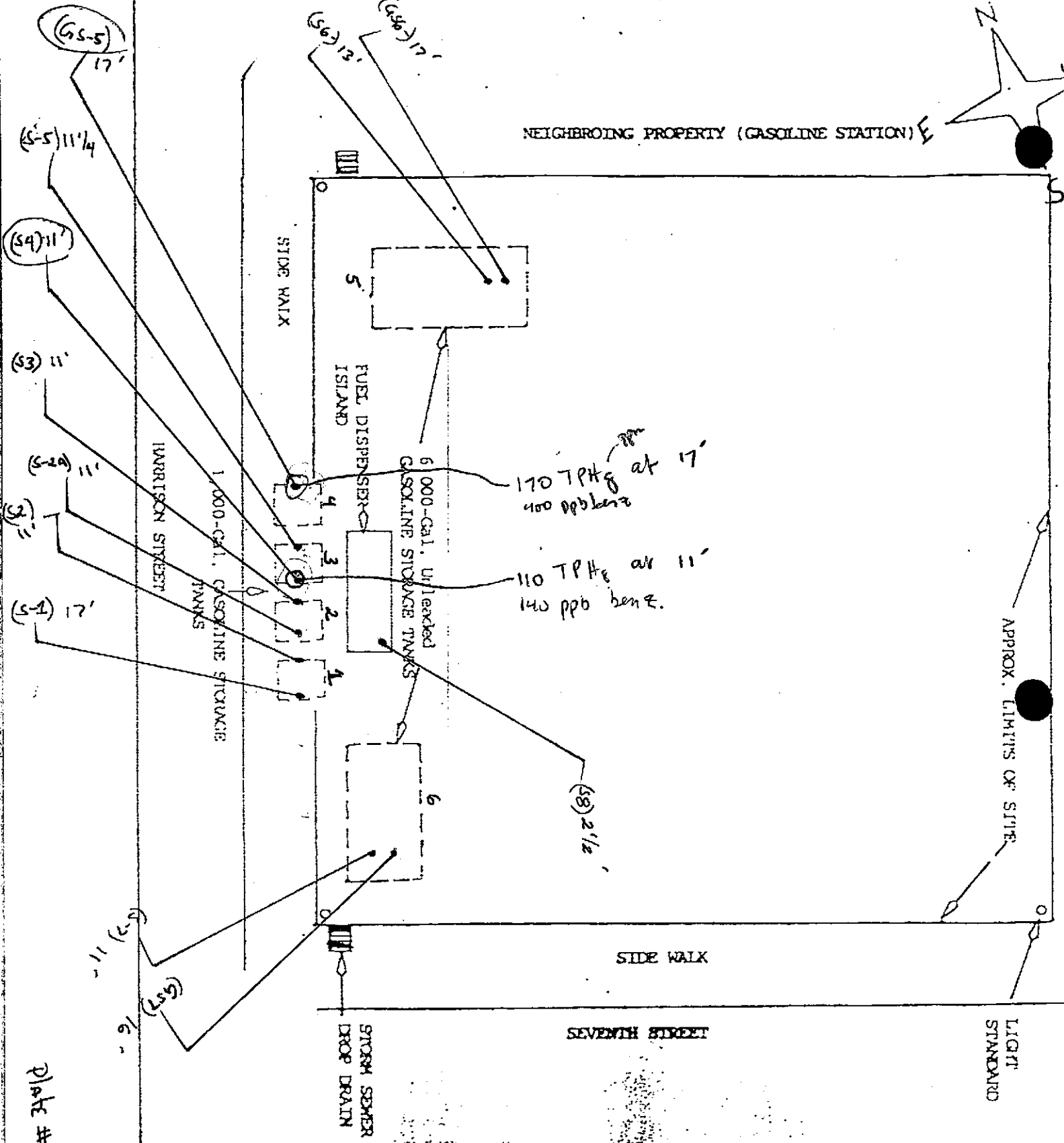

**HISTORIC SITE SCHEMATIC**  
 706 Harrison Str.  
 Oakland, California

Scale: None

Plate #2

(212-E 31)

# CHROMALAB, INC.

5 DAYS TURNAROUND

Analytical Laboratory (E694)

December 19, 1991

ChromaLab File No.: 1291104

CONSOLIDATED TECHNOLOGY

Attn: Tracy Bennett

RE: Eleven soil samples for Gasoline/BTEX analysis

Project Name: 706 HARRISON

Date Sampled: Dec. 12, 1991

Date Extracted: Dec. 16, 1991

Date Submitted: Dec. 12, 1991

Date Analyzed: Dec. 17, 1991

## RESULTS:

Sample I.D.	Gasoline (mg/Kg)	Benzene (ug/Kg)	Toluene (ug/Kg)	Ethyl Benzene (ug/Kg)	Total Xylenes (ug/Kg)	STLC Lead (mg/Kg)
S1	N.D.	6.6	8.4	N.D.	N.D.	----
S2	N.D.	N.D.	N.D.	N.D.	N.D.	----
S2 ARCHIVE	N.D.	N.D.	N.D.	N.D.	N.D.	----
S3	N.D.	N.D.	N.D.	N.D.	N.D.	----
S4	110	140	310	320	1700	----
S5	N.D.	14	N.D.	N.D.	N.D.	----
S6	N.D.	N.D.	N.D.	N.D.	N.D.	----
GS5	170	400	3600	2200	17000	----
GS6	3.0	6.4	8.5	8.4	40	----
S7	N.D.	N.D.	N.D.	N.D.	N.D.	----
GS7	N.D.	N.D.	N.D.	N.D.	N.D.	----
S8	----	----	----	----	----	36
BLANK	N.D.	N.D.	N.D.	N.D.	N.D.	N.D.
SPIKE RECOVERY	95.4%	111.2%	97.3%	105.2%	99.3%	100%
DUP. SPIKE RECOVERY	92.6%	100.1%	86.9%	94.9%	90.6%	100%
DETECTION LIMIT	1.0	5.0	5.0	5.0	5.0	0.05
METHOD OF ANALYSIS	5030/8015	8020	8020	8020	8020	7420

ChromaLab, Inc.

Eric Tam  
Laboratory Director

Plate #3

# CHROMALAB, INC.

2239 Omega Road, #1  
415/831-1788 • f

CHROMALAB FILE # 1291104  
ORDER # 4488

## Chain of Custody

DATE 12-12 PAGE 2 OF 2

PROJ MGR. <u>Troy Barnett</u>						ANALYSIS REPORT													NUMBER OF CONTAINERS
COMPANY <u>Consolidated</u>						TPH - Gasoline (EPA 5030)	TPH - Gasoline (5030, 8015) w/BTEX (EPA 602, 8020)	TPH - Diesel (EPA 3510, 3550, 8015)	PURGEABLE AROMATICS BTEX (EPA 602, 8020)	PURGEABLE HALOCARBONS (EPA 601, 8010)	VOLATILE ORGANICS (EPA 624, 8240)	BASE/NEUTRALS, ACIDS (EPA 825/827, 8270)	TOTAL OIL & GREASE (EPA 8280 D&F)	PESTICIDES/PCB (EPA 908, 8080)	PHENOLS (EPA 604, 8040)	METALS: Cd, Cr, Pb, Zn	CAM METALS (18) w/Cr VI	PRIORITY POLLUTANT METALS (19)	
ADDRESS _____						SAMPLERS (SIGNATURE) _____						(PHONE NO.) _____							
SAMPLE ID	DATE	TIME	MATRIX	LAB ID															
S1	12-12					X													
S2	↓																		
S2 Active																			
S3																			
S4																			
S5																			
S6																			
G155																			
G156																			

PROJECT INFORMATION		SAMPLE RECEIPT		RELINQUISHED BY 1		RELINQUISHED BY 2		RELINQUISHED BY 3	
PROJECT NAME: <u>706 Hazardous</u>	TOTAL NO. OF CONTAINERS	CHAIN OF CUSTODY SEALS		<u>Troy Barnett</u> <u>Group</u>					
PROJECT NUMBER: <u>Same</u>	RECU GOOD CONDITION/COLD	CONFORMS TO RECORD		<u>Troy Barnett</u> <u>12-12-91</u>					
SKIPPING ID. NO.	VIA:	LAB NO.		<u>Consolidated Tech.</u>					
SPECIAL INSTRUCTIONS/COMMENTS <u>Run all. including S2</u>				RECEIVED BY 1		RECEIVED BY 2		RECEIVED BY LABORATORY 3	
								<u>Alle M...</u> <u>18:00</u>	
								<u>T. MONETTE</u> <u>12-12-91</u>	
								<u>Chromalab</u>	

# CHROMALAB, INC.

2239 Omega Road, #1 • San Ramon, California 94583  
415/831-1788 • Facsimile 415/831-8798

# Chain of Custody

DATE 12-12 PAGE 2 OF 2

1291104

PROJECT INFORMATION				SAMPLE RECEIPT		ANALYSIS REPORT												
PROJ. MGR. _____	COMPANY _____	ADDRESS _____	SAMPLERS (SIGNATURE) _____ (PHONE NO.) _____	TPH - Gasoline (EPA 5030)	TPH - Gasoline (EPA 5030, 8015) w/BTEX (EPA 602, 8020)	TPH - Diesel (EPA 3910, 3950, 8016)	PURGEABLE AROMATICS BTEX (EPA 602, 6020)	PURGEABLE HALOCARBONS (EPA 601, 8010)	VOLATILE ORGANICS (EPA 624, 8240)	BASE/NEUTRALS, ACIDS (EPA 625/627, 8270)	TOTAL OIL & GREASE (EPA 5520 D&F)	PESTICIDES/PCB (EPA 608, 8080)	PHENOLS (EPA 604, 8040)	STLC Lead	METALS: Cd, Cr, Pb, Zn	CAM METALS (18) w/Cr-VI	PRIORITY POLLUTANT METALS (13)	NUMBER OF CONTAINERS
SAMPLE ID	DATE	TIME	LAB NO.															
S-7	↓				X													
G-57	↓				X													
S-8	12-12													X				
	↓																	

PROJECT NAME: <u>706 Howard</u>	TOTAL NO. OF CONTAINERS	RELINQUISHED BY 1. <u>[Signature]</u> <u>6:00</u>	RELINQUISHED BY 2. _____	RELINQUISHED BY 3. _____
PROJECT NUMBER: _____	CHAIN OF CUSTODY SEALS	(SIGNATURE) _____ (TIME) _____	(SIGNATURE) _____ (TIME) _____	(SIGNATURE) _____ (TIME) _____
SHIPPING ID. NO. _____	REC'D GOOD CONDITION/COLD	(PRINTED NAME) _____ (DATE) <u>12-12</u>	(PRINTED NAME) _____ (DATE) _____	(PRINTED NAME) _____ (DATE) _____
VIA: _____	CONFORMS TO RECORD	(COMPANY) _____	(COMPANY) _____	(COMPANY) _____
SPECIAL INSTRUCTIONS/COMMENTS: <u>Run All</u> <u>Fax Copy of C-O-C</u>		RECEIVED BY 1. _____	RECEIVED BY 2. _____	RECEIVED BY (LABORATORY) 3. <u>[Signature]</u> <u>18:00</u>
		(SIGNATURE) _____ (TIME) _____	(SIGNATURE) _____ (TIME) _____	(SIGNATURE) _____ (TIME) _____
		(PRINTED NAME) _____ (DATE) _____	(PRINTED NAME) _____ (DATE) _____	(PRINTED NAME) _____ (DATE) <u>12-12-91</u>
		(COMPANY) _____	(COMPANY) _____	(LAB) <u>CHROMALAB</u>