

R0480



RITCHIE & RITCHIE

MANAGEMENT CORPORATION

INDUSTRIAL, COMMERCIAL & INVESTMENT REAL ESTATE
PROPERTY MANAGEMENT, DEVELOPMENT & INSURANCE

OFFICES IN
PORTLAND
SACRAMENTO
SAN FRANCISCO
OAKLAND
SAN JOSE
SAN DIEGO

FAKE (510) 935-6358
(510) 935-7050

FAX TRANSMITTAL



DATE: 7-16-93

TIME: 1215

TO: TOM PERCOCK

ALAMEDA COUNTY HAZARDOUS MATERIALS

FROM: BILL HARDING, ASSOCIATE BROKER.

RITCHIE & RITCHIE MANAGEMENT CORPORATION

2059 Mt. Diablo Blvd., Walnut Creek, CA 94596

NUMBER OF PAGES (including this page) 3

MESSAGE: REF. OUR FONCON THIS MORNING, THE SITE
PLAN AND PLAT (12-1) IS SEARL; (11) IS OURS) MAY
HELP YOU RECONCILE CONTAMINATION AND THE
OWNERSHIP. SEARL HAS LEASED OUR PROPERTY
CONTINUOUSLY SINCE LATE 1950's OR 1960. I HAVE
A COPY OF THE LEASE AT HOME. Bill Harding.

PLEASE CALL IF YOU DID NOT RECEIVE ALL PAGES AS INDICATED

The information contained in this facsimile is intended for the use of the addressee only. If you received this facsimile in error, please notify the sender by telephone; this communication should not be copied or distributed and the original should be destroyed. Thank you.

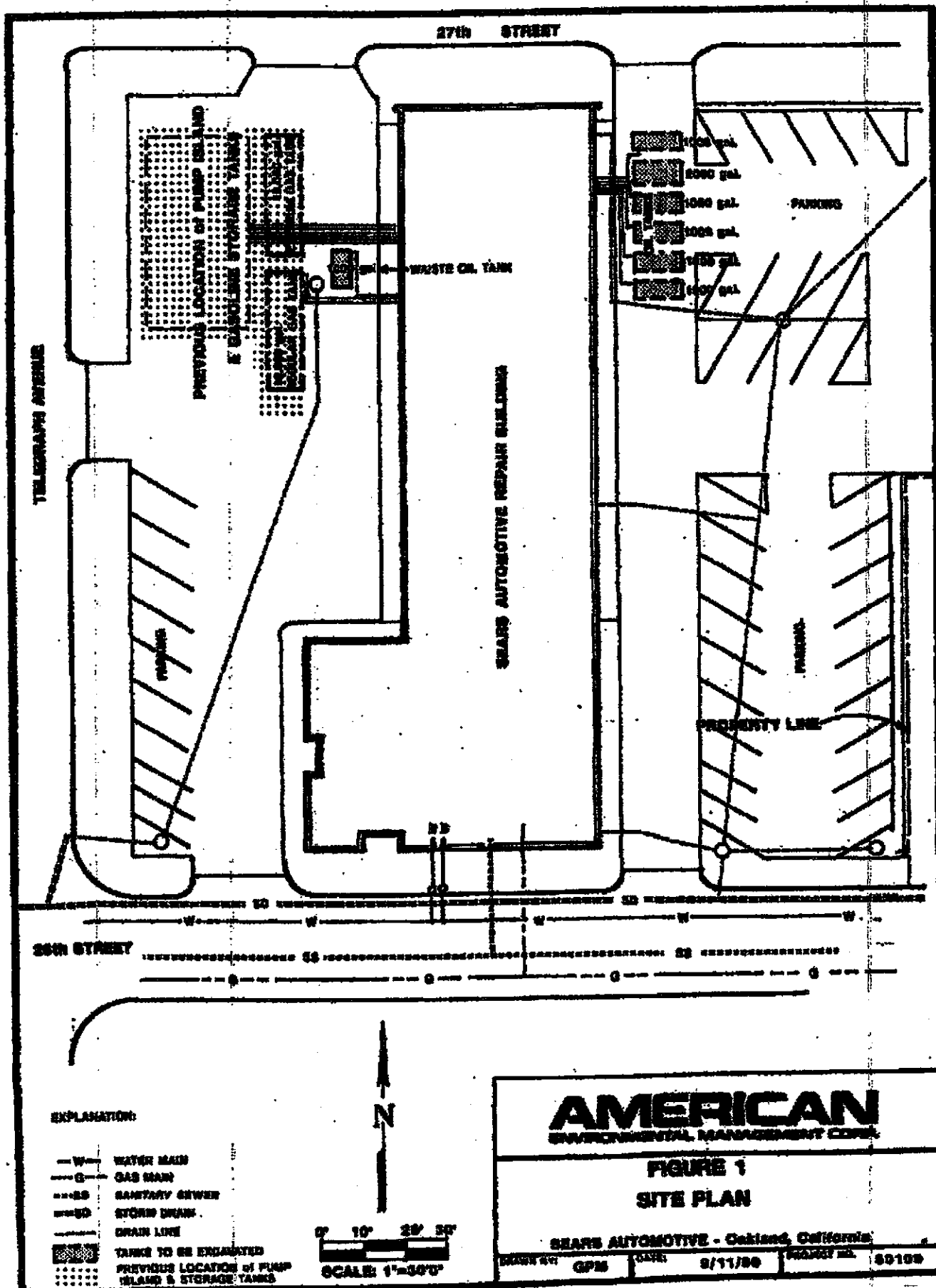

EXPLANATION:

- W — WATER MAIN
- G — GAS MAIN
- SS — SANITARY SEWER
- SD — STORM DRAIN
- — — DRAIN LINE
- [Hatched Box] TANKS TO BE ENLARGED
- [Dotted Box] PREVIOUS LOCATION OF PUMP ISLAND & STORAGE TANKS



0' 10' 20' 30'
SCALE: 1"=30'

AMERICAN
ENVIRONMENTAL MANAGEMENT CORP.

FIGURE 1
SITE PLAN

SEARS AUTOMOTIVE - Oakland, California

DRAWN BY: GPM	DATE: 9/11/90	PROJECT NO. 80109
---------------	---------------	-------------------