



ENVIRONMENTAL HEALTH SERVICES
ENVIRONMENTAL PROTECTION
1131 Harbor Bay Parkway, Suite 250
Alameda, CA 94502-6577
(510) 567-6700
FAX (510) 337-9335

FACT SHEET
LIM PROPERTY FUEL LEAK CASE
September 20, 2010

Site Location: Lim Property, 250 8th Street, Oakland, CA 94607
Fuel Leak Case #RO000479 and GeoTracker Global ID #T0600100535

Summary – This fact sheet has been prepared to inform community members and other interested parties of the status of a soil and groundwater cleanup at a former service station site at 250 8th Street in Oakland, California (see map on back). Fuel releases from former underground storage tanks resulted in soil contamination by petroleum hydrocarbons in the southern portion of the site and extending beneath 8th Street. Petroleum hydrocarbons have been detected in groundwater beneath the site and within an area extending off-site beneath 8th Street to the south. Although remedial actions to date have removed more than 23,000 pounds of petroleum hydrocarbons, additional actions are necessary to complete the site cleanup. The responsible party for the site is planning to install an ozone sparging and soil vapor extraction (SVE) system on-site and along the south side of 8th Street to complete site cleanup. Ozone is the tri-atomic form of oxygen. Ozone sparging is the process of adding an ozone/air mixture into a contaminated water-bearing zone. The ozone moves outward from the injection point through the groundwater and reacts chemically to destroy petroleum hydrocarbons. The ozone decomposes to oxygen in groundwater which can also stimulate microbial degradation of fuel hydrocarbons in the subsurface. Ozone will be injected into shallow groundwater at six locations within the site and five locations on the south side of 8th Street. Soil vapors above the groundwater will be extracted at seven locations. The effectiveness of the ozone sparging and SVE cleanup will be monitored using a network of groundwater monitoring wells and soil vapor monitoring wells.

Background – The fuel leak site is currently used as a parking lot for an auto service facility. In May 1992, ten underground storage tanks were removed from the southern portion of site adjacent to 8th Street. Between December 1992 and March 1993, 1,762 cubic yards of contaminated soil was excavated and disposed off-site. Site investigation activities were conducted at various times between 1995 and 2002. Groundwater remediation using hydrogen peroxide injection was conducted from February 1999 until November 2000 with limited success. In October 2004, dual-phase extraction using three extraction wells at the site removed over 7,000 pounds of petroleum hydrocarbons. In January 2008, an indoor air assessment was performed in the on-site building as well as several buildings on the south side of 8th Street opposite the site. Based on the findings of the indoor air assessment, it was concluded that vapor intrusion from subsurface soils to the buildings was not significant. An additional DPE 30-day event that was conducted in 2009, removed more than 16,100 pounds of petroleum hydrocarbons.

Next Step – The responsible party is working with Alameda County Environmental Health (ACEH) to implement cleanup of the site. The proposed cleanup consisting of ozone sparging and SVE is described in two documents entitled, “*Interim Remedial Action Completion Report and Updated Remedial Action Plan*,” dated March 15, 2010 and “*Ozone Sparging Well Installation and Ozone Sparging Test Results*,” dated September 10, 2010. The public is invited to review and comment on the proposed cleanup action. The cleanup plan documents can be viewed over the Internet on the ACEH website (<http://www.acgov.org/aceh/lop/ust.htm>) or the State Water Board GeoTracker website (http://www.swrcb.ca.gov/ust/cleanup/electronic_reporting). Please send written comments to Jerry Wickham at the address below. **Comments received by October 22, 2010** will be considered and responded to prior to a final determination on the proposed cleanup. If you have any questions or comments regarding the ongoing soil and groundwater cleanup at the site, please contact Jerry Wickham at the address below.

Additional information: Contact Jerry Wickham of the Alameda County Department of Environmental Health, 1131 Harbor Bay Parkway, Alameda, CA 94502 at 510-567-6791 or by email at jerry.wickham@acgov.org.

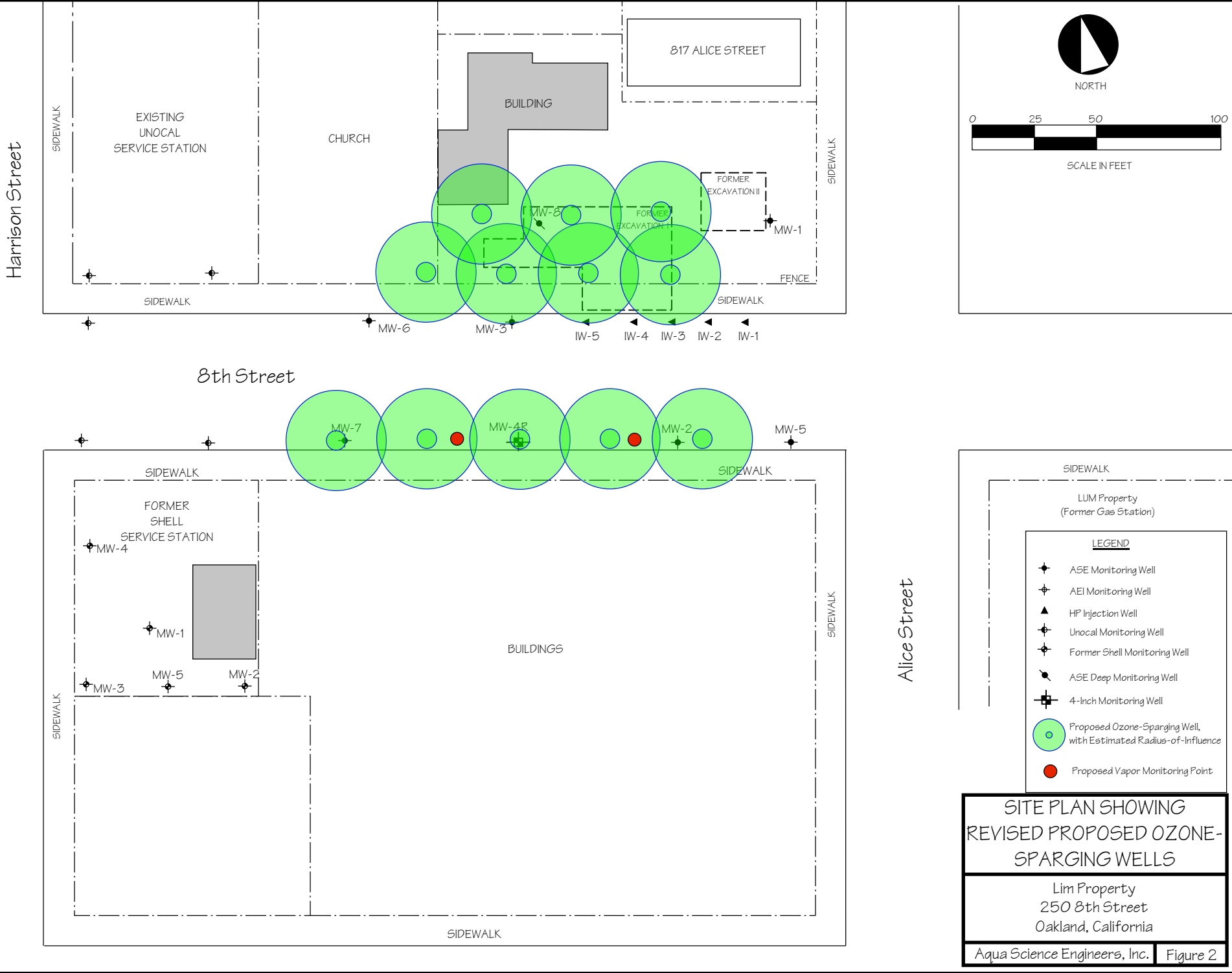

NORTH

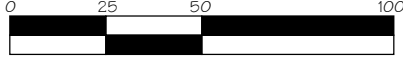

SCALE IN FEET

SIDEWALK

LUM Property
(Former Gas Station)

LEGEND

- ◆ ASE Monitoring Well
- ◆ AEI Monitoring Well
- ▲ HP Injection Well
- ◆ Unocal Monitoring Well
- ◆ Former Shell Monitoring Well
- ◆ ASE Deep Monitoring Well
- ◆ 4-Inch Monitoring Well
- Proposed Ozone-Sparging Well, with Estimated Radius-of-Influence
- Proposed Vapor Monitoring Point

**SITE PLAN SHOWING
REVISED PROPOSED OZONE-
SPARGING WELLS**

Lim Property
250 8th Street
Oakland, California

Aqua Science Engineers, Inc. Figure 2

275 NINTH STREET LLC
Parcel #: 1-185-30
3343 21ST ST
SAN FRANCISCO CA 94110

~~275 NINTH STREET LLC
Parcel #: 1-185-32
3343 21ST ST
SAN FRANCISCO CA 94110~~

~~275 NINTH STREET LLC
Parcel #: 1-185-33
3343 21ST ST
SAN FRANCISCO CA 94110~~

ADVANCE COMPANY LLC
Parcel #: 1-185-27
210 SCENIC AVE
PIEDMONT CA 94611

AU DAT V
Parcel #: 1-185-29
275 9TH ST #1
OAKLAND CA 94607

~~BUDDHIST CHURCH OF
Parcel #: 1-179-4
825 JACKSON ST
OAKLAND CA 94607~~

BUDDHIST CHURCH OF
Parcel #: 1-179-9
825 JACKSON ST
OAKLAND CA 94607

~~BUDDHIST CHURCH OF
Parcel #: 1-179-2
825 JACKSON ST
OAKLAND CA 94607~~

~~BUDDHIST CHURCH OF
Parcel #: 1-179-3
825 JACKSON ST
OAKLAND CA 94607~~

~~BUDDHIST CHURCH OF
Parcel #: 1-179-10
825 JACKSON ST
OAKLAND CA 94607~~

~~BUDDHIST CHURCH OF
Parcel #: 1-179-12
825 JACKSON ST
OAKLAND CA 94607~~

CHINESE INDEPENDENT
Parcel #: 1-185-12-2
280 8TH ST
OAKLAND CA 94607

CITY OF OAKLAND
Parcel #: 1-179-1-1
250 FRANK OGAWA PLZ #4
OAKLAND CA 94612

~~CITY OF OAKLAND
Parcel #: 1-179-1-2
250 FRANK OGAWA PLZ #4
OAKLAND CA 94612~~

ENGINEHOUSE11 LLC
Parcel #: 1-185-10
PO BOX 31114
WALNUT CREEK CA 94598

FONG NOM & WANDA L TRS
Parcel #: 1-185-23
270 7TH ST
OAKLAND CA 94607

GIN BO K & CHI Y
Parcel #: 1-185-25
342 LESTER AVE
OAKLAND CA 94606

~~GIN BO K & CHLY TRS
Parcel #: 1-185-26
342 LESTER AVE
OAKLAND CA 94606~~

HEMPHILL DAVID F &
Parcel #: 1-185-21
19601 CLEMENT DR
CASTRO VALLEY CA 94552

HOU HANK H & SHUNU H TRS
Parcel #: 1-185-19
721 ALICE ST
OAKLAND CA 94607

HYPOLITE RONALD J
Parcel #: 1-185-31
275 NINTH ST #3
OAKLAND CA 94607

LIM MAY L TR & ALICE TR
Parcel #: 1-185-11
1028 ANNERLEY RD
PIEDMONT CA 94610

PARSO ALAN L TRUST &
Parcel #: 1-179-11
816 ALICE ST
OAKLAND CA 94607

PRESBYTERY OF S F
Parcel #: 1-185-17
265 8TH ST
OAKLAND CA 94607

RESIDENT
Parcel #: 1-179-1-1
822 ALICE ST
OAKLAND CA 94607

RESIDENT
Parcel #: 1-179-1-2
ALICE ST
OAKLAND CA 94607

~~RESIDENT
Parcel #: 1-179-9
8TH ST
OAKLAND CA 94607~~

~~RESIDENT
Parcel #: 1-179-2
233 9TH ST
OAKLAND CA 94607~~

~~RESIDENT
Parcel #: 1-179-3
229 9TH ST
OAKLAND CA 94607~~

~~RESIDENT
Parcel #: 1-179-10
226 8TH ST
OAKLAND CA 94607~~

~~RESIDENT
Parcel #: 1-179-12
808 ALICE ST
OAKLAND CA 94607~~

RESIDENT
Parcel #: 1-185-1
828 HARRISON ST
OAKLAND CA 94607

RESIDENT
Parcel #: 1-185-10
817 ALICE ST
OAKLAND CA 94607

RESIDENT
Parcel #: 1-185-16
277 8TH ST
OAKLAND CA 94607

RESIDENT
Parcel #: 1-185-26
706 HARRISON ST
OAKLAND CA 94607

RESIDENT
Parcel #: 1-185-18
251 8TH ST
OAKLAND CA 94607

RESIDENT
Parcel #: 1-185-20
701 ALICE ST
OAKLAND CA 94607

RESIDENT
Parcel #: 1-185-11
250 8TH ST
OAKLAND CA 94607

RESIDENT
Parcel #: 1-185-19
719 ALICE ST
OAKLAND CA 94607

RESIDENT
Parcel #: 1-185-24
272 7TH ST
OAKLAND CA 94607

RESIDENT
Parcel #: 1-185-25
278 7TH ST
OAKLAND CA 94607

RESIDENT
Parcel #: 1-185-27
273 9TH ST
OAKLAND CA 94607

RESIDENT
Parcel #: 1-185-30
275 9TH ST #2
OAKLAND CA 94607

RESIDENT
Parcel #: 1-185-32
275 9TH ST #4
OAKLAND CA 94607

RESIDENT
Parcel #: 1-185-31
275 9TH ST #3
OAKLAND CA 94607

RESIDENT
Parcel #: 1-185-33
275 9TH ST #5
OAKLAND CA 94607

RESIDENT
Parcel #: 1-185-4
283 9TH ST
OAKLAND CA 94607

~~RESIDENT
Parcel #: 1-185-12-2
291 9TH ST
OAKLAND CA 94607~~

RESIDENT
Parcel #: 1-185-15
281 8TH ST
OAKLAND CA 94607

RESIDENT
Parcel #: 1-185-21
256 7TH ST
OAKLAND CA 94607

USMAN MUHAMMAD
Parcel #: 1-185-13
800 HARRISON ST
OAKLAND CA 94607

WONG BRUCE & EVAN ETAL
Parcel #: 1-185-4
900 JACKSON ST #104
OAKLAND CA 94607

WONG HELEN H TR
Parcel #: 1-185-24
900 JACKSON ST #104
OAKLAND CA 94607

WONG RAY F & CHIN PANSY L
Parcel #: 1-185-20
703 ALICE ST
OAKLAND CA 94607

WONG ROBERT R TR
Parcel #: 1-185-1
33 MANOR DR
PIEDMONT CA 94611

WOO HELEN L TR
Parcel #: 1-185-22
262 7TH ST
OAKLAND CA 94607

YEE PETER K & JUDY Y TRS
Parcel #: 1-185-14
726 HARRISON ST
OAKLAND CA 94607

YOUNG CONNIE K
Parcel #: 1-185-18
631 HADDON RD
OAKLAND CA 94610

ZHAO ZHI H & HE YAN Y TRS
Parcel #: 1-185-16
5040 WICKS LN
CASTRO VALLEY CA 94546

~~ZHAO ZHI H & HE YAN Y TRS
Parcel #: 1-185-15
5040 WICKS LN
CASTRO VALLEY CA 94546~~