



Chevron

June 22, 1999

Chevron Products Company
6001 Bollinger Canyon Road
Building L, Room 1080
PO Box 6004
San Ramon, CA 94583-0904

Ms. Eva Chu
Alameda County Health Care Services
Department of Environmental Health
1131 Harbor Bay Parkway, Suite 250
Alameda, CA 94502-6577

Philip R. Briggs
Project Manager
Site Assessment & Remediation
Phone 925 842-9136
Fax 925 842-8370

Re: Chevron Service Station #9-1924
4904 Southfront Road
Livermore, California

Dear Ms. Chu:

Enclosed is the Second Quarter Groundwater Monitoring Report for 1999, prepared by our consultant Blaine Tech Services, Inc. for the above noted site. The groundwater samples were analyzed for the presence of TPH-g, BTEX, MtBE constituents. Monitoring wells C-6, C-9, C-11, C-14 and C-17 are sampled semi-annually (2nd and 4th quarters), while wells C-2, C-5, C-19 and C-20 are sampled annually (2nd quarter). Monitoring wells C-1, C-3, C-7, C-8, C-10, C-12, C-13, C-15, C-16 and C-18 have been discontinued from sampling. This change in the sampling frequency was agreed to in your letter of January 6, 1997. All wells are measured for groundwater depth.

The concentrations of all the constituents continued to decrease in monitoring well C-11 from the previous sampling event. Therefore, it appears that the results detected in the 4th Quarter of 1998 were an anomaly, and the sampling results in the 1st and 2nd Quarters confirm this.

The concentrations declined in monitoring wells C-5, C-11 and C-17 from the previous sampling event, while increasing slightly in wells C-2, C-6, and C-9. The concentrations in well C-19 were below method detection limits for the BTEX constituents while in well C-20 the concentrations were below method detection limits for all of the constituents. There was insufficient water in well C-14 to take a sample.

Monitoring wells C-2, C-5, C-6, C-9, C-11, C-17 and C-20 were analyzed for oxygenates (Ethanol, t-Butanol, MtBE, DIPE, ETBE, TAME) by EPA Method 8260. Refer to page 29 and 30 of the Table of Well Data and Analytical Results for the analytical values.

ENVIRONMENTAL
PROTECTION
JUN 28 1999

June 22, 1999
Ms. Eva Chu
Chevron Service Station #9-1924
Page 2

Depth to groundwater varied from 10.83 feet to 13.79 feet below grade with a direction of flow northwesterly.

If you have any questions, call me at (925) 842-9136.

Sincerely,
CHEVRON PRODUCTS COMPANY



Philip R. Briggs
Site Assessment and Remediation Project Manager

Enclosure

cc. Mr. Bill Scudder, Chevron

Mr. Scott Hooton
BP Oil Company
295 SW 41st Street
Renton, WA 98055-4931

Mr. Gary Stumpf
Mobil Oil
3225 Gallows Road, Rm. 6W116
Fairfax, Virginia 22037

Mr. David DeWitt
Tosco
2000 Crow Canyon Place, Suite 400
San Ramon, CA 94583

Mr. Chuck Headlee
RWQCB-San Francisco Area
1550 Clay Street, Suite 1400
Oakland, CA 94612

BLAINE
TECH SERVICES INC.



1680 ROGERS AVENUE
SAN JOSE, CALIFORNIA 95112-1105
(408) 573-7771 FAX
(408) 573-0555 PHONE

June 8, 1999

Phil Briggs
Chevron U.S.A. Products Company
P.O. Box 6004
San Ramon, CA 94583-0904

- = Do removal pump. in 1st qtr.
include nitrate isocconc. map in future rpts
- Repair C-14. Bottom of well should
be 34' bgs, not 12.45' as in
field notes.

2nd Quarter 1999 Monitoring at 9-1924

Second Quarter 1999 Groundwater Monitoring at
Chevron Service Station Number 9-1924
4904 Southfront Rd.
Livermore, CA

Monitoring Performed on April 14, 1999

Groundwater Sampling Report 990414-C-1

This report covers the routine monitoring of groundwater wells at this Chevron facility. Blaine Tech Services, Inc.'s work at the site includes inspection, gauging, evacuation, purgewater containment, sample collection and sample handling in accordance with standard procedures that conform to Regional Water Quality Control Board requirements.

Routine field data collection includes depth to water, total well depth, thickness of any separate immiscible layer, water column volume, calculated volume of a three-case volume purge, elapsed evacuation time, total volume of water removed, and standard water parameter instrument readings. Sample material is collected, contained, stored, and transported to the laboratory in conformance with EPA standards. Purgewater is, likewise, collected and transported to McKittrick Waste Treatment Site for disposal.

Basic field information is presented alongside analytical values excerpted from the laboratory report in the cumulative table of **WELL DATA AND ANALYTICAL RESULTS**. The full analytical report for the most recent samples is located in the **Analytical Appendix**. The table also contains new groundwater elevation calculations taken from the computer plotted gradient

map which is located in the **Professional Engineering Appendix**.

At a minimum, Blaine Tech Services, Inc. field personnel are certified upon completion of a forty-hour Hazardous Materials and Emergency Response training course per 29 CFR 1910.120. Field personnel are also enrolled in annual eight hour refresher courses.

Blaine Tech Services, Inc. conducts sampling and documentation assignments of this type as an independent third party. In order to avoid compromising the objectivity necessary for the proper and disinterested performance of this work, Blaine Tech Services, Inc. concentrates on objective data collection and does not participate in the interpretation of analytical results, the definition of geological or hydrological conditions, the formulation of recommendations, or the marketing of remedial systems.

Please call if you have any questions.

Yours truly,



Christine Lillie
Project Coordinator

CAL/sb

attachments: Professional Engineering Appendix
Cumulative Table of Well Data and Analytical Results
Analytical Appendix
Field Data Sheets

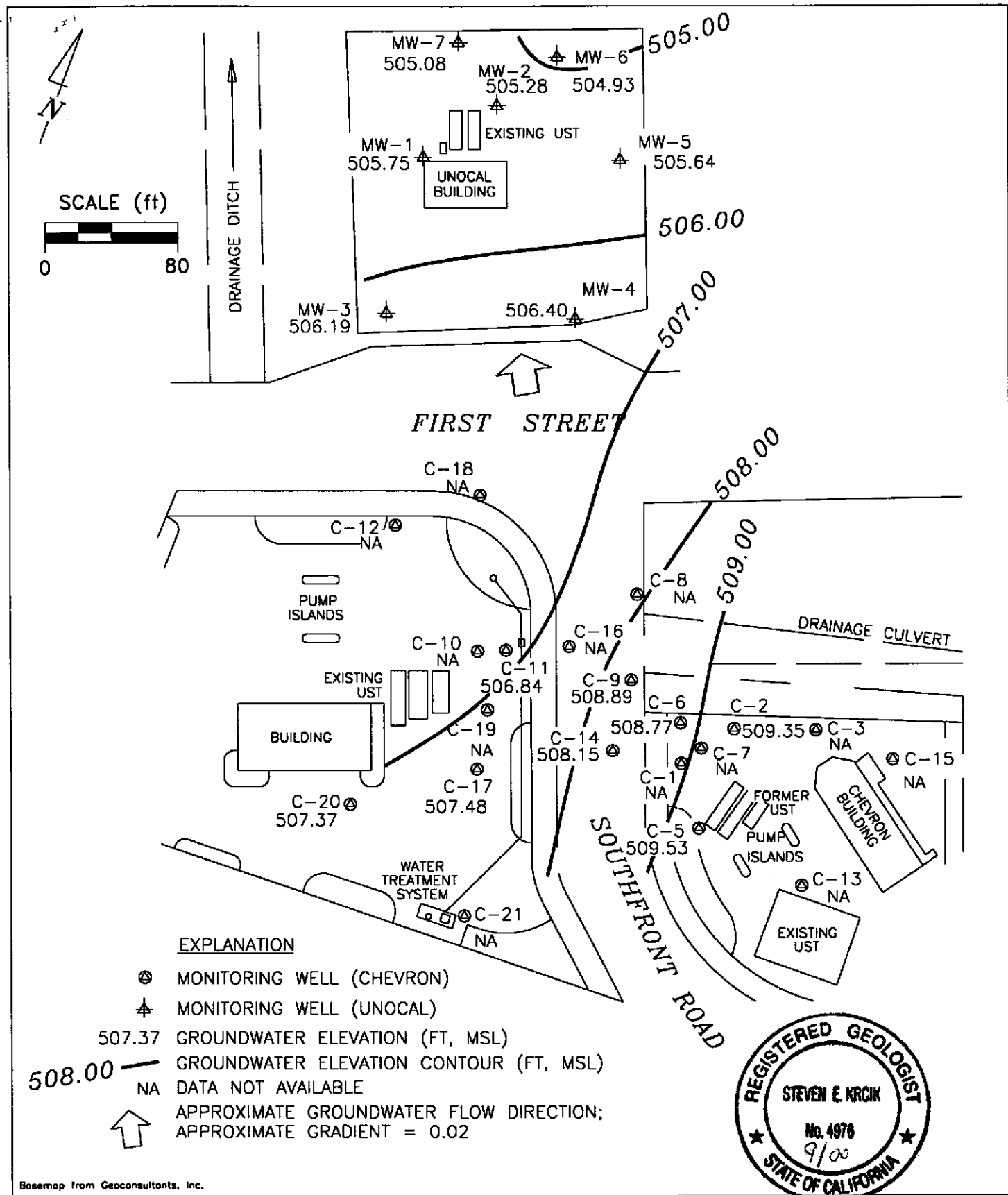

Base map from Geoconsultants, Inc.

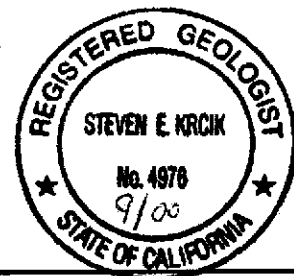

PREPARED BY

RRM
engineering contracting firm

Chevron Station 9-1924
4904 Southfront Road
Livermore, California

GROUNDWATER ELEVATION CONTOUR MAP,
APRIL 14, 1999

FIGURE:
1
PROJECT:
DAC04

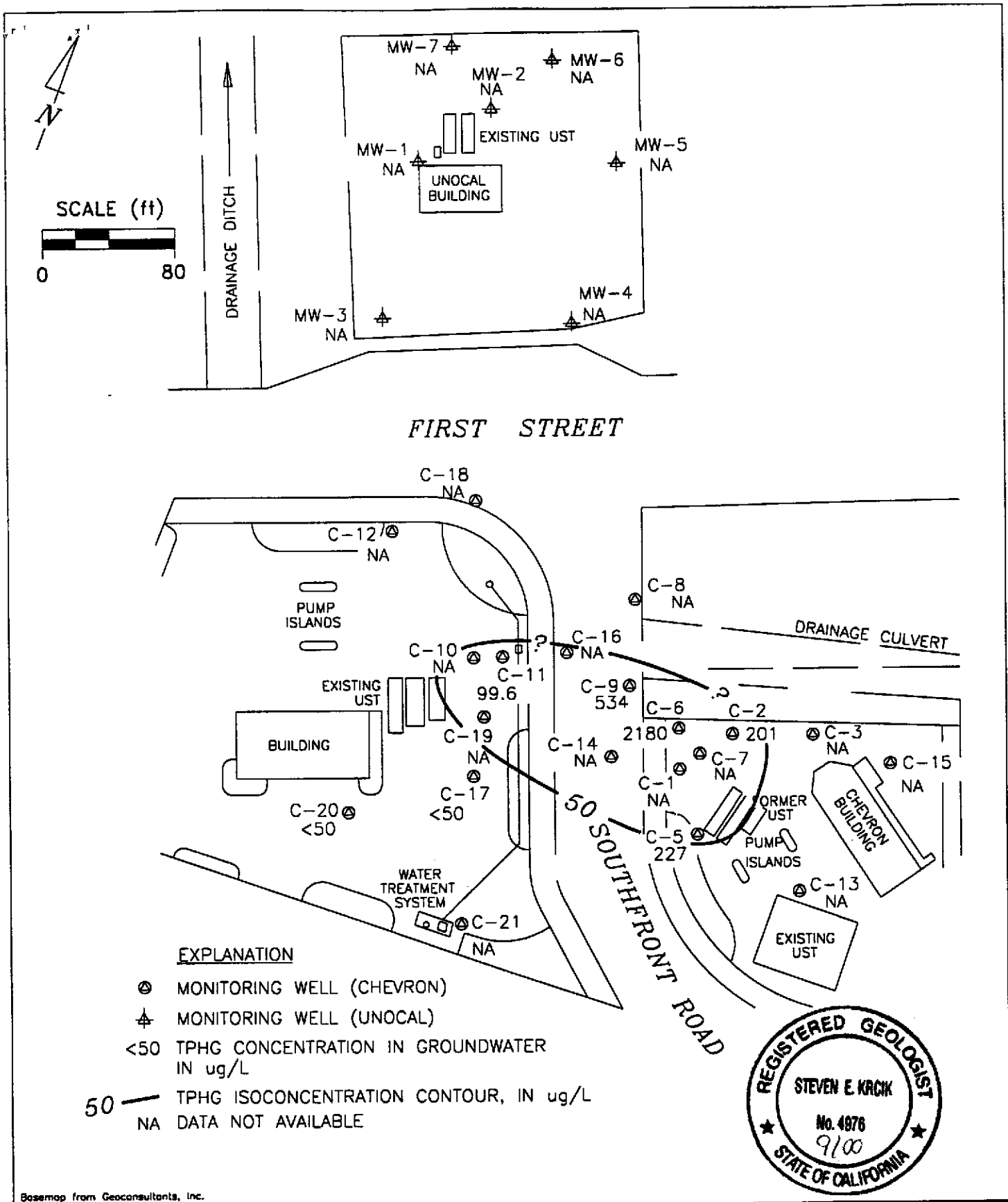

PREPARED BY RRM engineering contracting firm	Chevron Station 9-1924 4904 Southfront Road Livermore, California	FIGURE: 2
	TPHG ISOCONCENTRATION MAP APRIL 14, 1999	PROJECT: DAC04

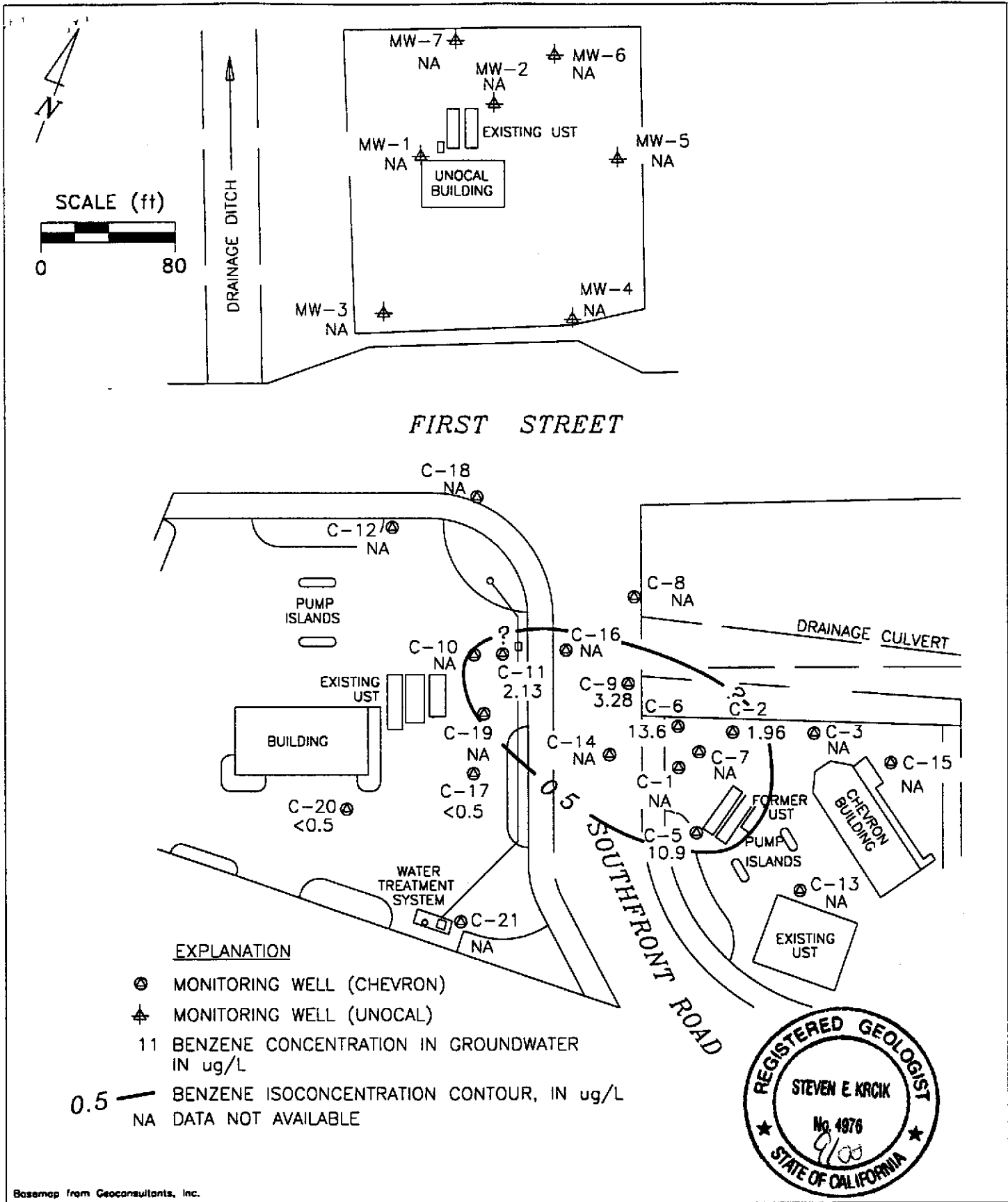

PREPARED BY

RRM
engineering contracting firm

Chevron Station 9-1924
4904 Southfront Road
Livermore, California

BENZENE ISOCONCENTRATION MAP
APRIL 14, 1999

FIGURE:
3

PROJECT:
DAC04

Table of Well Data and Analytical Results

Cumulative Table of Well Data and Analytical Results

Vertical Measurements are in feet.

Analytical results are in parts per billion (ppb)

DATE	Well Head Elev.	Ground Water Elev.	Depth To Water	Notes	TPH-Gasoline	Benzene	Toluene	Ethyl-Benzene	Xylene	MTBE	TOG	1,2-DCA	VC	MC1,1,1-TCA	1,1-DCA	PCE	Total Lead	Diss. Lead	CDS
C-1																			
03/28/86	520.39	508.64	11.75	--	--	--	--	--	--	--	--	--	--	--	--	--	--	--	--
03/15/88	520.39	506.89	13.50	--	27,000	770	87	610	2100	--	--	--	--	--	--	--	--	--	--
05/10/88	520.39	506.74	13.65	--	--	--	--	--	--	--	--	--	--	--	--	--	--	--	--
06/10/88	520.39	505.67	14.72	--	--	--	--	--	--	--	--	--	--	--	--	--	--	--	--
07/25/88	520.39	506.89	13.50	--	--	--	--	--	--	--	--	--	--	--	--	--	--	--	--
10/13/88	520.39	507.50	12.89	--	3200	220	11	62	130	--	--	--	--	--	--	--	--	--	--
01/01/89	520.39	507.50	12.89	--	--	--	--	--	--	--	--	--	--	--	--	--	--	--	--
01/12/89	520.39	--	--	--	4000	820	43	490	260	--	--	--	--	--	--	--	--	--	--
04/10/89	520.39	506.74	13.65	--	4000	100	ND	70	50	--	ND	ND	--	--	--	--	--	--	--
04/10/89	520.39	506.74	13.65	--	4000	100	ND	60	50	--	--	ND	--	--	--	--	--	--	--
06/26/89	520.39	506.45	13.94	--	600	97	20	60	50	--	ND	3.0	--	--	--	--	--	--	--
06/26/89	520.39	506.45	13.94	--	570	86	15	44	35	--	--	1.7	--	--	--	--	--	--	--
10/13/89	520.39	506.47	13.92	--	1600	64	ND	51	48	--	ND	ND	--	--	--	--	--	--	5.0
01/03/90	520.39	506.59	13.80	--	1100	36	0.68	30	30	--	--	1.0	--	--	--	--	--	--	--
05/08/90	520.39	506.48	13.91	--	1300	37	9.2	40	32	--	--	1.2	--	ND	--	ND	--	--	--
09/29/90	520.39	506.46	13.93	--	350	19	1.2	32	31	--	--	ND	--	0.7	1.4	ND	--	--	--
01/03/91	520.39	506.54	13.85	--	400	12	ND	17	14	--	--	ND	--	ND	ND	ND	--	--	--
04/12/91	520.39	506.88	13.51	--	--	--	--	--	--	--	--	--	--	--	--	--	--	--	--
09/04/91	520.39	506.29	14.10	--	--	--	--	--	--	--	--	--	--	--	--	--	--	--	--
04/06/92	520.39	507.33	13.06	--	1000	12	0.8	31	31	--	--	ND	--	ND	ND	ND	--	--	--
07/28/92	520.39	506.46	13.93	--	4200	47	110	96	260	--	--	--	--	--	--	--	--	--	--
10/16/92	520.39	505.94	14.45	--	1800	11	ND	32	55	--	--	--	--	--	--	--	--	--	--
01/14/93	520.39	509.16	11.23	--	2000	24	ND	98	62	--	--	--	--	--	--	--	--	--	--
03/26/93	520.39	509.45	10.94	--	4400	21	12	120	100	--	--	--	--	--	--	--	--	--	--
04/22/93	520.39	504.14	16.25	Sheen	18000	26	44	580	330	--	--	--	--	--	--	--	--	--	--
07/20,21/93	520.39	505.10	15.29	--	7100	73	11	470	470	--	--	--	--	--	--	--	--	--	--
10/20/93	520.39	506.89	13.50	--	880	19	26	260	190	--	--	--	--	--	--	--	--	--	--
01/20/94	520.39	507.13	13.26	--	2900	13	10	130	60	--	--	--	--	--	--	--	--	--	--
04/21/94	520.39	506.93	13.46	--	1400	8.8	7.8	82	34	--	--	--	--	--	--	--	--	--	--
07/21,22/94	520.39	506.93	13.46	--	800	4.7	2.7	34	13	--	--	--	--	--	--	--	--	ND	--
01/18/95	520.39	508.67	11.72	--	2000	18	10	130	10	--	--	--	--	--	--	--	--	--	--
04/17/95	520.39	508.58	11.81	--	2500	13	1.9	33	4.3	--	--	--	--	--	--	--	--	--	--
07/18/95	520.39	508.27	12.12	--	1100	<10	<10	27	<10	--	--	--	--	--	--	--	--	--	--
10/17/95	520.39	507.81	12.58	--	2000	13	<5.0	24	<5.0	6400	--	--	--	--	--	--	--	--	--
01/18/96	520.39	509.07	11.32	--	<2000	35	30	<20	23	6600	--	--	--	--	--	--	--	--	--
04/17/96	520.39	509.52	10.87	--	<1000	31	<10	<10	<10	<50	--	--	--	--	--	--	--	--	--
07/16/96	520.39	509.01	11.38	--	830	15	<5.0	13	<5.0	9000	--	--	--	--	--	--	--	--	--
10/16/96	520.39	508.58	11.81	--	<5000	<50	<50	<50	<50	6300	--	--	--	--	--	--	--	--	--
01/08/99	520.39	508.33	12.06	--	1600	22	<10	10	<10	1500	--	--	--	--	--	--	--	--	--
01/08/99	520.39	508.33	12.06	Confirmation Run	--	--	--	--	--	1400	--	--	--	--	--	--	--	--	--

NO LONGER MONITORED OR SAMPLED

Cumulative Table of Well Data and Analytical Results

Vertical Measurements are in feet.

Analytical results are in parts per billion (ppb)

DATE	Well	Ground	Depth	Notes	TPH- Gasoline	Benzene	Toluene	Ethyl- Benzene	Xylene	MTBE	TOG	1,2- DCA	VC	MC1,1,1- TCA	1,1- DCA	PCE	Total Lead	Diss. Lead	CDS
	Head Elev.	Water Elev.	To Water																
C-2																			
03/28/86	520.76	508.78	11.98	--	--	--	--	--	--	--	--	--	--	--	--	--	--	--	--
03/15/88	520.76	506.99	13.77	--	22,000	3900	1900	1200	1200	--	--	--	--	--	--	--	--	--	--
05/10/88	520.76	506.73	14.03	--	--	--	--	--	--	--	--	--	--	--	--	--	--	--	--
06/10/88	520.76	505.64	15.12	--	--	--	--	--	--	--	--	--	--	--	--	--	--	--	--
07/25/88	520.76	506.90	13.86	--	--	--	--	--	--	--	--	--	--	--	--	--	--	--	--
10/13/88	520.76	506.65	14.11	--	ND	ND	ND	ND	ND	--	--	--	--	--	--	--	--	--	--
01/01/89	520.76	507.93	12.83	--	--	--	--	--	--	--	--	--	--	--	--	--	--	--	--
01/12/89	520.76	--	--	--	1000	25	3.0	83	59	--	--	--	--	--	--	--	--	--	--
04/10/89	520.76	506.72	14.04	--	600	2.5	ND	15	12	--	ND	ND	--	--	--	--	--	--	--
04/10/89	520.76	506.72	14.04	--	ND	ND	ND	11	11	--	--	ND	--	--	--	--	--	--	--
06/26/89	520.76	506.42	14.34	--	640	5.3	8.0	18	14	--	ND	ND	--	--	--	--	--	--	--
06/26/89	520.76	506.42	14.34	--	750	3.7	0.6	13	8.2	--	--	2.0	--	--	--	--	--	--	--
10/13/89	520.76	506.84	13.92	--	630	ND	ND	17	10	--	--	ND	--	--	--	--	--	--	--
01/03/90	520.76	506.65	14.11	--	880	3	ND	19	17	--	--	1.0	--	--	--	--	--	--	--
05/08/90	520.76	506.48	14.28	--	340	1.3	2.7	8.4	11	--	--	1.1	--	ND	--	ND	--	--	--
09/29/90	520.76	506.51	14.25	--	74	ND	ND	4.6	1.8	--	--	ND	--	1.7	0.5	ND	--	--	--
01/03/91	520.76	506.61	14.15	--	2000	270	ND	79	93	--	--	ND	--	ND	ND	ND	ND	--	--
04/12/91	520.76	506.90	13.86	--	--	--	--	--	--	--	--	--	--	--	--	--	--	--	--
09/04/91	520.76	506.26	14.50	--	--	--	--	--	--	--	--	--	--	--	--	--	--	--	--
04/06/92	520.76	507.29	13.47	--	1200	ND	ND	54	6.1	--	--	ND	--	ND	ND	ND	ND	--	--
07/28/92	520.76	506.41	14.35	--	1000	5.2	2.9	26	16	--	--	--	--	--	--	--	--	--	--
10/16/92	520.76	505.92	14.84	--	2000	ND	2.2	20	10	--	--	--	--	--	--	--	--	--	--
01/14/93	520.76	509.54	11.22	--	1800	49	50	31	29	--	--	--	--	--	--	--	--	--	--
03/26/93	520.76	509.99	10.77	--	820	15	12	14	6.0	--	--	--	--	--	--	--	--	--	--
04/22/93	520.76	507.83	12.93	--	2000	12	12	28	29	--	--	--	--	--	--	--	--	--	--
07/20,21/93	520.76	504.74	16.02	--	1100	28	8.0	4.0	4.0	--	--	--	--	--	--	--	--	--	--
10/20/93	520.76	506.92	13.84	--	1600	140	18	22	27	--	--	--	--	--	--	--	--	--	--
01/20/94	520.76	507.16	13.60	--	760	36	3.0	7.0	3.0	--	--	--	--	--	--	--	--	--	--
04/21/94	520.76	506.66	14.10	--	430	23	2.8	6.8	6.8	--	--	--	--	--	--	--	--	--	--
07/21,22/94	520.76	506.93	13.83	--	1200	10	2.8	5.2	53	--	--	--	--	--	--	--	--	ND	--
01/18/95	520.76	508.94	11.82	--	640	1.0	<0.5	5.7	7.7	--	--	--	--	--	--	--	--	--	--
04/17/95	520.76	508.72	12.04	--	<50	<0.5	<0.5	<0.5	<0.5	--	--	--	--	--	--	--	--	--	--
07/18/95	520.76	508.34	12.42	--	81	<0.5	<0.5	<0.5	<0.5	--	--	--	--	--	--	--	--	--	--
10/17/95	520.76	507.97	12.79	--	390	<0.5	<0.5	1.2	1.2	14	--	--	--	--	--	--	--	--	--

CONTINUED ON NEXT PAGE

Cumulative Table of Well Data and Analytical Results

Vertical Measurements are in feet.

Analytical results are in parts per billion (ppb)

DATE	Well	Ground	Depth	Notes	TPH- Gasoline	Benzene	Toluene	Ethyl- Benzene	Xylene	MTBE	TOG	1,2- DCA	VC	MC 1,1,1- TCA	1,1- DCA	PCE	Total Lead	Diss. Lead	CDS
	Head Elev.	Water Elev.	To Water																
C-2 (CONT'D)																			
01/18/96	520.76	509.18	11.58	--	<50	<0.5	<0.5	<0.5	<0.5	<2.5	--	--	--	--	--	--	--	--	--
04/17/96	520.76	509.49	11.27	--	62	<0.5	<0.5	<0.5	<0.5	<2.5	--	--	--	--	--	--	--	--	--
07/16/96	520.76	508.81	11.95	--	370	2.1	1.5	3.1	3.9	47	--	--	--	--	--	--	--	--	--
10/16/96	520.76	508.36	12.40	--	460	2.4	1.3	1.8	1.9	200	--	--	--	--	--	--	--	--	--
04/10/97	520.76	508.49	12.27	--	480	0.63	<0.5	<0.5	<0.5	15	--	--	--	--	--	--	--	--	--
10/20/97	520.76	508.45	12.31	Sampled annually	--	--	--	--	--	--	--	--	--	--	--	--	--	--	--
04/30/98	520.76	509.50	11.26	--	140	1.0	0.61	1.1	1.9	6.4	--	--	--	--	--	--	--	--	--
10/07/98	520.76	509.22	11.54	--	--	--	--	--	--	--	--	--	--	--	--	--	--	--	--
04/14/99	520.76	509.35	11.41	*	201	1.96	<0.5	0.57	<0.5	11.2	--	--	--	--	--	--	--	--	--

* See Table of Additional Analyses.

Cumulative Table of Well Data and Analytical Results

Vertical Measurements are in feet.

Analytical results are in parts per billion (ppb)

DATE	Well Head Elev.	Ground Water Elev.	Depth To Water	Notes	TPH- Gasoline	Benzene	Toluene	Ethyl- Benzene	Xylene	MTBE	TOG	1,2- DCA	VC	MC 1,1,1- TCA	1,1- DCA	PCE	Total Lead	Diss. Lead	CDS
C-3																			
03/28/86	521.31	509.07	12.24	--	--	--	--	--	--	--	--	--	--	--	--	--	--	--	--
03/15/88	521.31	507.10	14.21	--	2100	86	8.0	30	36	--	--	--	--	--	--	--	--	--	--
05/10/88	521.31	506.88	14.43	--	--	--	--	--	--	--	--	--	--	--	--	--	--	--	--
06/10/88	521.31	505.78	15.53	--	--	--	--	--	--	--	--	--	--	--	--	--	--	--	--
07/25/88	521.31	507.09	14.22	--	--	--	--	--	--	--	--	--	--	--	--	--	--	--	--
10/13/88	521.31	507.21	14.10	--	ND	ND	ND	ND	ND	--	--	--	--	--	--	--	--	--	--
01/01/89	521.31	508.61	12.70	--	--	--	--	--	--	--	--	--	--	--	--	--	--	--	--
04/10/89	521.31	506.95	14.36	--	200	2.1	ND	4.4	2.6	--	ND	1.4	--	--	--	--	--	--	--
06/26/89	521.31	506.57	14.74	--	260	1.1	0.7	4.9	1.6	--	ND	1.5	--	--	--	--	--	--	--
10/13/89	521.31	506.61	14.70	--	ND	ND	ND	ND	ND	--	--	ND	--	--	--	--	--	--	--
01/03/90	521.31	506.89	14.42	--	ND	ND	ND	0.9	1.4	--	--	0.7	--	--	--	--	--	--	--
05/08/90	521.31	506.66	14.65	--	ND	ND	ND	ND	ND	--	--	0.7	--	ND	--	ND	--	--	--
09/27/90	521.31	506.64	14.67	--	71	ND	1.0	ND	ND	--	--	ND	--	1.1	1.6	ND	--	--	--
01/03/91	521.31	506.73	14.58	--	57	ND	ND	ND	ND	--	--	ND	--	ND	ND	ND	ND	--	--
04/12/91	521.31	507.08	14.23	--	98	ND	ND	1.6	ND	--	--	ND	--	ND	ND	ND	ND	--	--
09/04/91	521.31	506.43	14.88	--	64	ND	ND	ND	ND	--	--	ND	--	ND	ND	ND	ND	--	--
04/06/92	521.31	507.48	13.83	--	88	ND	ND	0.8	ND	--	--	ND	--	ND	ND	ND	ND	--	--
07/28/92	521.31	506.51	14.80	--	80	ND	ND	0.5	1.1	--	--	--	--	--	--	--	--	--	--
10/16/92	521.31	506.08	15.23	--	1400	ND	ND	6.6	11	--	--	--	--	--	--	--	--	--	--
01/14/93	521.31	509.86	11.45	--	100	ND	ND	ND	1.3	--	--	--	--	--	--	--	--	--	--
03/26/93	521.31	510.04	11.27	--	74	0.7	1.0	ND	ND	--	--	--	--	--	--	--	--	--	--
04/22/93	521.31	508.70	12.61	--	ND	ND	ND	ND	ND	--	--	--	--	--	--	--	--	--	--
07/20,21/93	521.31	505.14	16.17	--	ND	ND	ND	ND	ND	--	--	--	--	--	--	--	--	--	--
10/20/93	521.31	507.08	14.23	--	ND	ND	1.0	ND	0.8	--	--	--	--	--	--	--	--	--	--
01/20/94	521.31	507.30	14.01	--	ND	ND	ND	ND	ND	--	--	--	--	--	--	--	--	--	--
04/21/94	521.31	506.98	14.33	--	ND	ND	ND	ND	ND	--	--	--	--	--	--	--	--	--	--
07/21,22/94	521.31	507.00	14.31	--	ND	ND	ND	ND	ND	--	--	--	--	--	--	--	--	ND	--

NO LONGER MONITORED OR SAMPLED

Cumulative Table of Well Data and Analytical Results

Vertical Measurements are in feet.

Analytical results are in parts per billion (ppb)

DATE	Well Head Elev.	Ground Water Elev.	Depth To Water	Notes	TPH- Gasoline	Benzene	Toluene	Ethyl- Benzene	Xylene	MTBE	TOG	1,2- DCA	VC	MC1,1,1- TCA	1,1- DCA	PCE	Total Lead	Diss. Lead	CDS
C-5																			
03/28/86	520.82	508.82	12.00	--	--	--	--	--	--	--	--	--	--	--	--	--	--	--	--
03/15/88	520.82	507.07	13.75	--	1600	82	7.0	77	95	--	--	--	--	--	--	--	--	--	--
05/10/88	520.82	506.90	13.92	--	--	--	--	--	--	--	--	--	--	--	--	--	--	--	--
07/10/88	520.82	507.10	13.72	--	--	--	--	--	--	--	--	--	--	--	--	--	--	--	--
07/25/88	520.82	507.10	13.72	--	--	--	--	--	--	--	--	--	--	--	--	--	--	--	--
10/13/88	520.82	506.98	13.84	--	2500	ND	ND	ND	ND	--	--	--	--	--	--	--	--	--	--
01/01/89	520.82	507.41	13.41	--	--	--	--	--	--	--	--	--	--	--	--	--	--	--	--
01/12/89	520.82	--	--	--	ND	42	3.0	44	52	--	--	--	--	--	--	--	--	--	--
04/10/89	520.82	--	13.88	--	180	2.6	ND	6.2	5.5	--	ND	1.4	--	--	--	--	--	--	--
06/26/89	520.82	506.68	14.14	--	420	7.6	0.8	40	56	--	ND	1.5	--	--	--	--	--	--	--
10/13/89	520.82	506.67	14.15	--	620	ND	ND	10	ND	--	ND	ND	--	--	--	--	--	--	--
01/03/90	520.82	506.72	14.10	--	ND	0.7	ND	8.0	6.0	--	--	ND	--	--	--	--	--	--	--
05/08/90	520.82	506.82	14.00	--	140	0.6	0.8	11	7.2	--	--	0.8	--	ND	--	ND	--	--	--
09/27/90	520.82	506.82	14.00	--	360	ND	3.2	5.2	6.4	--	--	ND	--	0.7	ND	ND	--	--	--
01/03/91	520.82	506.82	14.00	--	90	ND	ND	ND	3.0	--	--	ND	--	ND	ND	ND	ND	--	--
04/12/91	520.82	507.11	13.71	--	270	12	ND	19	7.0	--	--	0.5	--	ND	ND	ND	ND	--	--
09/04/91	520.82	506.52	14.30	--	ND	ND	ND	ND	ND	--	--	ND	--	ND	ND	ND	ND	--	--
04/06/92	520.82	507.53	13.29	--	670	12	ND	40	ND	--	--	ND	--	ND	ND	ND	ND	--	--
07/28/92	520.82	506.69	14.13	--	130	15	ND	1.8	0.5	--	--	--	--	--	--	--	--	--	--
10/16/92	520.82	506.14	14.68	--	ND	ND	ND	ND	1.2	--	--	--	--	--	--	--	--	--	--
01/14/93	520.82	508.95	11.87	--	2300	13	ND	110	10	--	--	--	--	--	--	--	--	--	--
03/26/93	520.82	--	--	--	--	--	--	--	--	--	--	--	--	--	--	--	--	--	--
04/22/93	520.82	508.70	12.12	--	2300	220	18	120	65	--	--	--	--	--	--	--	--	--	--
07/20,21/93	520.82	504.78	16.04	--	970	18	5.0	8.0	14	--	--	--	--	--	--	--	--	--	--
10/20/93	520.82	506.72	14.10	--	2200	7.0	5.0	3.0	15	--	--	--	--	--	--	--	--	--	--
01/20/94	520.82	507.22	13.60	--	440	2.0	1.0	11	0.6	--	--	--	--	--	--	--	--	--	--
04/21/94	520.82	507.01	13.81	--	490	2.7	2.6	21	1.5	--	--	--	--	--	--	--	--	--	--
07/21,22/94	520.82	507.00	13.82	--	370	0.9	ND	6.5	1.0	--	--	--	--	--	--	--	--	ND	--
01/18/95	520.82	508.55	12.27	--	940	37	22	14	7.3	--	--	--	--	--	--	--	--	--	--
04/17/95	520.82	508.65	12.17	--	14,000	1200	340	160	80	--	--	--	--	--	--	--	--	--	--
07/18/95	520.82	508.51	12.31	--	<2000	180	<20	<20	<20	--	--	--	--	--	--	--	--	--	--
10/17/95	520.82	508.36	12.46	--	92	4.9	<0.5	<0.5	<0.5	240	--	--	--	--	--	--	--	--	--

CONTINUED ON NEXT PAGE

Cumulative Table of Well Data and Analytical Results

Vertical Measurements are in feet.

Analytical results are in parts per billion (ppb)

DATE	Well	Ground	Depth	Notes	TPH- Gasoline	Benzene	Toluene	Ethyl- Benzene	Xylene	MTBE	TOG	1,2- DCA	VC	MC 1,1,1- TCA	1,1- DCA	PCE	Total Lead	Diss. Lead	CDS
	Head Elev.	Water Elev.	To Water																
C-5 (CONT'D)																			
01/18/96	520.82	509.04	11.78	--	1300	180	<5.0	10	7.9	4300	--	--	--	--	--	--	--	--	--
04/17/96	520.82	509.71	11.11	--	2200	140	<10	<10	<10	5400	--	--	--	--	--	--	--	--	--
07/16/96	520.82	509.40	11.42	--	380	4.5	<0.5	3.4	3.1	1400	--	--	--	--	--	--	--	--	--
10/16/96	520.82	508.82	12.00	--	320	3.4	<1.0	<1.0	1.5	660	--	--	--	--	--	--	--	--	--
04/10/97	520.82	509.07	11.75	--	980	12	<2.5	3.0	<2.5	1700	--	--	--	--	--	--	--	--	--
10/20/97	520.82	508.76	12.06	Sampled annually	--	--	--	--	--	--	--	--	--	--	--	--	--	--	--
04/30/98	520.82	510.02	10.80	--	1500	38	<5.0	17	5.4	1700	--	--	--	--	--	--	--	--	--
10/07/98	520.82	509.78	11.04	--	--	--	--	--	--	--	--	--	--	--	--	--	--	--	--
04/14/99	520.82	509.53	11.29	*	227	10.9	0.511	1.17	1.06	468	--	--	--	--	--	--	--	--	--

* See Table of Additional Analyses.

Cumulative Table of Well Data and Analytical Results

Vertical Measurements are in feet.

Analytical results are in parts per billion (ppb)

DATE	Well Head Elev.	Ground Water Elev.	Depth To Water	Notes	TPH- Gasoline	Benzene	Toluene	Ethyl- Benzene	Xylene	MTBE	TOG	1,2-DCA	VC	MC 1,1,1- TCA	1,1- DCA	PCE	Total Lead	Diss. Lead	CDS
C-6																			
03/26/86	519.62	508.50	11.12	--	--	--	--	--	--	--	--	--	--	--	--	--	--	--	--
03/15/88	519.62	506.69	12.93	--	46,000	870	4600	1500	8200	--	--	--	--	--	--	--	--	--	--
05/10/88	519.62	506.59	13.03	--	86,000	1400	10,000	3000	19,000	--	--	--	--	--	--	--	--	--	--
06/10/88	519.62	505.51	14.11	--	--	--	--	--	--	--	--	--	--	--	--	--	--	--	--
07/25/88	519.62	506.67	12.95	--	--	--	--	--	--	--	--	--	--	--	--	--	--	--	--
10/13/88	519.62	506.48	13.14	--	5300	300	600	260	1,600	--	--	--	--	--	--	--	--	--	--
01/01/89	519.62	507.48	12.14	--	--	--	--	--	--	--	--	--	--	--	--	--	--	--	--
01/12/89	519.62	--	--	--	5000	260	110	270	720	--	--	--	--	--	--	--	--	--	--
04/12/89	519.62	506.64	12.98	--	5000	90	190	190	680	--	4.0	ND	--	--	--	--	--	--	--
06/26/89	519.62	506.23	13.39	--	3600	77	250	140	610	--	ND	ND	--	--	--	--	--	--	--
10/13/89	519.62	506.22	13.40	--	3500	32	81	100	530	--	ND	ND	--	--	--	--	--	--	--
01/03/90	519.62	506.44	13.18	--	3200	20	97	65	410	--	--	1.0	--	--	--	--	--	--	--
05/08/90	519.62	506.23	13.39	--	1800	17	140	ND	400	--	--	1.6	--	ND	--	ND	--	--	--
09/29/90	519.62	506.30	13.32	--	8000	58	210	260	2100	--	--	1.0	--	ND	2.4	1.6	--	--	--
01/03/91	519.62	506.43	13.19	--	2300	4.0	79	59	380	--	--	0.5	--	ND	ND	ND	ND	--	--
04/12/91	519.62	506.71	12.91	--	--	--	--	--	--	--	--	--	--	--	--	--	--	--	--
09/04/91	519.62	506.06	13.56	--	--	--	--	--	--	--	--	--	--	--	--	--	--	--	--
04/06/92	519.62	507.14	12.48	--	44,000	ND	120	740	3400	--	--	ND	--	ND	ND	ND	ND	--	--
07/28/92	519.62	506.15	13.47	--	120,000	220	1100	3000	13,000	--	--	--	--	--	--	--	--	--	--
10/16/92	519.62	505.67	13.95	--	570,000	ND	830	3300	9600	--	--	--	--	--	--	--	--	--	--
01/14/93	519.62	509.23	10.39	--	19,000	ND	25	460	980	--	--	--	--	--	--	--	--	--	--
03/26/93	519.62	509.79	9.83	--	11,000	30	90	290	1100	--	--	--	--	--	--	--	--	--	--
04/22/93	519.62	508.30	11.32	--	20,000	29	170	640	2400	--	--	--	--	--	--	--	--	--	--
07/20,21/93	519.62	504.70	14.92	--	32,000	130	490	1000	4900	--	--	--	--	--	--	--	--	--	--
10/20/93	519.62	506.71	12.91	--	77,000	290	790	2500	7600	--	--	--	--	--	--	--	--	--	--
01/20/94	519.62	506.94	12.68	--	22,000	10	86	510	29	--	--	--	--	--	--	--	--	--	--
04/21/94	519.62	506.74	12.88	--	6500	17	42	160	210	--	--	--	--	--	--	--	--	--	--
07/21,22/94	519.62	506.78	12.84	--	4500	ND	7.1	130	130	--	--	--	--	--	--	--	--	ND	--
01/18/95	519.62	508.61	11.01	--	3600	3.3	6.7	62	78	--	--	--	--	--	--	--	--	--	--
04/17/95	519.62	508.35	11.27	--	1500	1.6	2.2	14	12	--	--	--	--	--	--	--	--	--	--
07/18/95	519.62	508.16	11.46	--	4000	<10	<10	40	22	--	--	--	--	--	--	--	--	--	--
10/17/95	519.62	507.64	11.98	--	6000	<10	<10	100	58	5200	--	--	--	--	--	--	--	--	--

CONTINUED ON NEXT PAGE

Cumulative Table of Well Data and Analytical Results

Vertical Measurements are in feet.

Analytical results are in parts per billion (ppb)

DATE	Well Head Elev.	Ground Water Elev.	Depth To Water	Notes	TPH- Gasoline	Benzene	Toluene	Ethyl- Benzene	Xylene	MTBE	TOG	1,2- DCA	VC	MC1,1,1- TCA	1,1- DCA	PCE	Total Lead	Diss. Lead	CDS
C-6 (CONT'D)																			
01/18/96	519.62	508.78	10.84	--	1200	<5.0	<5.0	10	<5.0	2600	--	--	--	--	--	--	--	--	--
04/17/96	519.62	509.15	10.47	--	510	<2.5	<2.5	10	3.0	490	--	--	--	--	--	--	--	--	--
07/16/96	519.62	508.65	10.97	--	1300	10	<10	51	<10	2700	--	--	--	--	--	--	--	--	--
10/16/96	519.62	508.12	11.50	--	2600	31	<10	12	11	5100	--	--	--	--	--	--	--	--	--
04/10/97	519.62	508.35	11.27	Sampled biannually	1300	5.1	<2.5	17	<2.5	1300	--	--	--	--	--	--	--	--	--
10/20/97	519.62	507.85	11.77	--	2200	<2.5	4.6	14	13	1300	--	--	--	--	--	--	--	<5.0	--
04/30/98	519.62	509.01	10.61	--	1300	6.5	8.6	5.6	7.0	180	--	--	--	--	--	--	--	--	--
10/07/98	519.62	508.71	10.91	--	1200	11	<10	15	<10	710	--	--	--	--	--	--	--	--	--
04/14/99	519.62	508.77	10.85	*	2180	13.6	<2.0	5.52	4.12	116	--	--	--	--	--	--	--	--	--

* See Table of Additional Analyses.

Cumulative Table of Well Data and Analytical Results

Vertical Measurements are in feet.

Analytical results are in parts per billion (ppb)

DATE	Well Head Elev.	Ground Water Elev.	Depth To Water	Notes	TPH-Gasoline	Benzene	Toluene	Ethyl-Benzene	Xylene	MTBE	TOG	1,2-DCA	VC	MC 1,1,1-TCA	1,1-DCA	PCE	Total Lead	Diss. Lead	CDS
C-7																			
03/28/86	520.30	508.63	11.67	--	--	--	--	--	--	--	--	--	--	--	--	--	--	--	--
03/15/88	520.30	506.82	13.48	--	8000	98	690	120	120	--	--	--	--	--	--	--	--	--	--
05/10/88	520.30	506.70	13.60	--	--	--	--	--	--	--	--	--	--	--	--	--	--	--	--
06/10/88	520.30	505.62	14.68	--	--	--	--	--	--	--	--	--	--	--	--	--	--	--	--
07/25/88	520.30	506.87	13.43	--	--	--	--	--	--	--	--	--	--	--	--	--	--	--	--
10/13/88	520.30	506.69	13.61	--	16,000	4400	220	1000	3000	--	--	--	--	--	--	--	--	--	--
01/01/89	520.30	507.64	12.66	--	--	--	--	--	--	--	--	--	--	--	--	--	--	--	--
01/12/89	520.30	--	--	--	8000	950	47	670	640	--	--	--	--	--	--	--	--	--	--
04/12/89	520.30	506.70	13.60	--	6000	1100	30	760	370	--	ND	ND	--	--	--	--	--	--	--
06/26/89	520.30	506.42	13.88	--	6000	1300	50	600	340	--	ND	ND	--	--	--	--	--	--	--
10/13/89	520.30	506.49	13.81	--	3900	1300	ND	160	150	--	--	ND	--	--	--	--	--	--	--
01/03/90	520.30	506.59	13.71	--	5600	1200	13	180	200	--	--	1.0	--	--	--	--	--	--	--
05/08/90	520.30	506.45	13.85	--	3500	1100	15	110	140	--	--	1.7	--	ND	--	ND	--	--	--
09/29/90	520.30	506.50	13.80	--	2400	580	ND	46	68	--	--	0.7	--	ND	ND	ND	ND	--	--
01/03/91	520.30	506.59	13.71	--	2500	300	2.0	110	120	--	--	0.7	--	ND	ND	ND	ND	--	--
04/12/91	520.30	506.84	13.46	--	2300	190	1.0	81	87	--	--	0.6	--	ND	ND	ND	ND	--	--
09/04/91	520.30	506.21	14.09	--	--	--	--	--	--	--	--	--	--	--	--	--	--	--	--
10/07/91	520.30	--	--	--	4700	170	1.9	97	59	--	--	ND	--	24	ND	ND	ND	--	--
04/06/92	520.30	507.28	13.02	--	2400	95	0.8	110	100	--	--	ND	--	ND	ND	ND	ND	--	--
07/28/92	520.30	506.54	13.76	--	2000	120	3.4	110	110	--	--	--	--	--	--	--	--	--	--
10/16/92	520.30	505.88	14.42	--	2700	130	4.2	68	74	--	--	--	--	--	--	--	--	--	--
01/14/93	520.30	509.32	10.98	--	7800	160	33	380	210	--	--	--	--	--	--	--	--	--	--
03/26/93	520.30	509.69	10.61	--	1400	39	9.0	28	15	--	--	--	--	--	--	--	--	--	--
04/22/93	520.30	508.46	11.84	--	3800	130	18	43	36	--	--	--	--	--	--	--	--	--	--
07/20,21/93	520.30	504.94	15.36	Sheen	1900	35	18	61	87	--	--	--	--	--	--	--	--	--	--
10/20/93	520.30	506.89	13.41	--	5500	72	26	250	160	--	--	--	--	--	--	--	--	--	--
01/20/94	520.30	507.11	13.19	Sheen	3600	12	12	150	69	--	--	--	--	--	--	--	--	--	--
04/21/94	520.30	506.97	13.33	--	2100	62	11	170	68	--	--	--	--	--	--	--	--	--	--
07/21,22/94	520.30	506.91	13.39	--	1700	50	4.4	110	22	--	--	--	--	--	--	--	--	ND	--
01/18/95	520.30	508.71	11.59	--	920	16	<0.5	30	12	--	--	--	--	--	--	--	--	--	--
04/17/95	520.30	508.56	11.74	--	730	4.3	1.6	12	1.8	--	--	--	--	--	--	--	--	--	--
07/18/95	520.30	508.32	11.98	--	1200	63	<5.0	12	<5.0	--	--	--	--	--	--	--	--	--	--
10/17/95	520.30	507.82	12.48	--	1100	45	<5.0	12	<5.0	8100	--	--	--	--	--	--	--	--	--
01/18/96	520.30	508.90	11.40	--	930	7.3	<5.0	<5.0	<5.0	1900	--	--	--	--	--	--	--	--	--
04/17/96	520.30	509.34	10.96	--	980	5.5	<1.0	7.4	1.1	340	--	--	--	--	--	--	--	--	--
07/16/96	520.30	508.79	11.51	--	1400	96	<5.0	11	9.9	3000	--	--	--	--	--	--	--	--	--
10/16/96	520.30	508.30	12.00	--	4100	40	<5.0	7.5	5.5	3800	--	--	--	--	--	--	--	--	--

NO LONGER MONITORED OR SAMPLED

Cumulative Table of Well Data and Analytical Results

Vertical Measurements are in feet.

Analytical results are in parts per billion (ppb)

DATE	Well Head Elev.	Ground Water Elev.	Depth To Water	Notes	TPH-Gasoline	Benzene	Toluene	Ethyl-Benzene	Xylene	MTBE	TOG	1,2-DCA	VC	MC1,1,1-TCA	1,1-DCA	PCE	Total Lead	Diss. Lead	CDS
C-8																			
03/28/86	519.74	507.96	11.78	--	--	--	--	--	--	--	--	--	--	--	--	--	--	--	--
03/15/88	519.74	506.11	13.63	--	7500	360	25	10	ND	--	--	--	--	--	--	--	--	--	--
05/10/88	519.74	506.00	13.74	--	--	--	--	--	--	--	--	--	--	--	--	--	--	--	--
06/10/88	519.74	504.85	14.89	--	--	--	--	--	--	--	--	--	--	--	--	--	--	--	--
07/25/88	519.74	506.09	13.65	--	--	--	--	--	--	--	--	--	--	--	--	--	--	--	--
10/13/88	519.74	505.96	13.78	--	ND	6.0	5.3	ND	ND	--	--	--	--	--	--	--	--	--	--
01/01/89	519.74	507.06	12.68	--	--	--	--	--	--	--	--	--	--	--	--	--	--	--	--
01/12/89	519.74	--	--	--	ND	37	4.0	1.0	5.0	--	--	--	--	--	--	--	--	--	--
04/12/89	519.74	505.97	13.77	--	3000	13	ND	ND	ND	--	12	5.0	--	--	--	--	--	--	--
06/26/89	519.74	505.71	14.03	--	780	14	6.0	ND	6.0	--	ND	4.0	--	--	--	--	--	--	--
10/13/89	519.74	505.68	14.06	--	ND	ND	ND	ND	ND	--	ND	ND	--	--	--	--	--	--	--
01/03/90	519.74	506.00	13.74	--	910	ND	ND	1.0	1.0	--	--	1.5	--	--	--	--	--	--	--
05/07/90	519.74	505.64	14.10	--	620	3.9	6.0	0.5	3.4	--	--	1.9	--	ND	--	ND	--	--	--
09/29/90	519.74	505.77	13.97	--	77	ND	1.4	ND	ND	--	--	ND	--	0.6	ND	ND	--	--	--
01/03/91	519.74	505.93	13.81	--	67	2.0	2.0	ND	2.0	--	--	ND	--	0.7	ND	ND	ND	--	--
04/12/91	519.74	506.14	13.60	--	180	4.0	ND	ND	ND	--	--	0.6	--	ND	ND	ND	ND	--	--
09/04/91	519.74	505.60	14.14	--	140	1.8	4.7	0.8	4.8	--	--	ND	--	ND	ND	ND	ND	--	--
04/06/92	519.74	506.62	13.12	--	150	ND	ND	ND	ND	--	--	ND	--	ND	ND	ND	ND	--	--
07/28/92	519.74	505.64	14.10	--	90	ND	ND	ND	0.8	--	--	--	--	--	--	--	--	--	--
10/16/92	519.74	505.17	14.57	--	51	ND	ND	ND	ND	--	--	--	--	--	--	--	--	--	--
01/14/93	519.74	508.79	10.95	--	120	ND	1.6	1.0	3.5	--	--	--	--	--	--	--	--	--	--
03/26/93	519.74	--	--	--	--	--	--	--	--	--	--	--	--	--	--	--	--	--	--
04/22/93	519.74	507.67	12.07	--	68	ND	0.6	0.6	0.8	--	--	--	--	--	--	--	--	--	--
07/20,21/93	519.74	504.04	15.70	--	ND	ND	ND	ND	ND	--	--	--	--	--	--	--	--	--	--
10/20/93	519.74	506.23	13.51	--	ND	ND	ND	ND	ND	--	--	--	--	--	--	--	--	--	--
01/20/94	519.74	506.23	13.51	--	ND	ND	ND	ND	ND	--	--	--	--	--	--	--	--	--	--
04/21/94	519.74	506.06	13.68	--	ND	ND	ND	ND	ND	--	--	--	--	--	--	--	--	--	--
07/21,22/94	519.74	506.24	13.50	--	51	ND	ND	ND	ND	--	--	--	--	--	--	--	--	ND	--
01/18/95	519.74	--	--	Dry	--	--	--	--	--	--	--	--	--	--	--	--	--	--	--
04/17/95	519.74	--	--	Dry	--	--	--	--	--	--	--	--	--	--	--	--	--	--	--
07/18/95	519.74	--	--	Dry	--	--	--	--	--	--	--	--	--	--	--	--	--	--	--
10/17/95	519.74	507.54	12.20	Insufficient water	--	--	--	--	--	--	--	--	--	--	--	--	--	--	--
01/18/96	519.74	507.64	12.10	Insufficient water	--	--	--	--	--	--	--	--	--	--	--	--	--	--	--
04/17/96	519.74	508.87	10.87	Sampled biannually	--	--	--	--	--	--	--	--	--	--	--	--	--	--	--
07/16/96	519.74	508.26	11.48	Insufficient water	--	--	--	--	--	--	--	--	--	--	--	--	--	--	--
10/16/96	519.74	507.78	11.96	--	--	--	--	--	--	--	--	--	--	--	--	--	--	--	--

NO LONGER MONITORED OR SAMPLED

Cumulative Table of Well Data and Analytical Results

Vertical Measurements are in feet.

Analytical results are in parts per billion (ppb)

DATE	Well Head Elev.	Ground Water Elev.	Depth To Water	Notes	TPH-Gasoline	Benzene	Toluene	Ethyl-Benzene	Xylene	MTBE	TOG	1,2-DCA	VC	MC 1,1,1-TCA	1,1-DCA	PCE	Total Lead	Diss. Lead	CDS
C-9																			
03/28/86	519.52	508.28	11.24	--	--	--	--	--	--	--	--	--	--	--	--	--	--	--	--
03/15/88	519.52	506.60	12.92	--	29,000	540	560	580	3900	--	--	--	--	--	--	--	--	--	--
05/10/88	519.52	506.40	13.12	--	--	--	--	--	--	--	--	--	--	--	--	--	--	--	--
06/10/88	519.52	505.36	14.16	--	--	--	--	--	--	--	--	--	--	--	--	--	--	--	--
07/25/88	519.52	506.52	13.00	--	--	--	--	--	--	--	--	--	--	--	--	--	--	--	--
10/13/88	519.52	506.39	13.13	--	2200	57	8.0	20	150	--	--	--	--	--	--	--	--	--	--
01/01/89	519.52	507.33	12.19	--	--	--	--	--	--	--	--	--	--	--	--	--	--	--	--
01/12/89	519.52	--	--	--	2000	39	12	51	46	--	--	--	--	--	--	--	--	--	--
04/12/89	519.52	506.41	13.11	--	6000	16	20	55	240	--	ND	2.1	--	--	--	--	--	--	--
04/11/89	519.52	506.41	13.11	--	6000	14	25	45	290	--	--	ND	--	--	--	--	--	--	--
06/26/89	519.52	506.12	13.40	--	3900	37	63	140	690	--	ND	ND	--	--	--	--	--	--	--
10/13/89	519.52	506.06	13.46	--	1300	7.0	ND	26	50	--	ND	ND	--	--	--	--	--	--	--
01/03/90	519.52	506.22	13.30	--	1500	ND	0.7	202	37	--	--	1.5	--	--	--	--	--	--	--
05/07/90	519.52	506.04	13.48	--	7100	21	33	89	500	--	--	1.9	--	ND	--	ND	--	--	--
09/29/90	519.52	506.13	13.39	--	1000	21	3.9	31	110	--	--	1.0	--	0.7	1.8	1.0	--	--	--
01/03/91	519.72	506.44	13.28	--	3200	ND	ND	32	140	--	--	0.8	--	ND	ND	ND	ND	--	--
04/12/91	519.72	506.72	13.00	--	--	--	--	--	--	--	--	--	--	--	--	--	--	--	--
09/04/91	519.72	506.11	13.61	--	--	--	--	--	--	--	--	--	--	--	--	--	--	--	--
04/06/92	519.72	507.18	12.54	--	2800	ND	ND	33	130	--	--	ND	--	ND	ND	ND	ND	--	--
07/28/92	519.72	506.27	13.45	--	1000	6.5	2.4	17	37	--	--	--	--	--	--	--	--	--	--
10/16/92	519.72	505.74	13.98	--	190,000	ND	730	960	2000	--	--	--	--	--	--	--	--	--	--
01/14/93	519.72	509.28	10.44	--	2200	ND	ND	27	77	--	--	--	--	--	--	--	--	--	--
03/26/93	519.72	--	--	--	--	--	--	--	--	--	--	--	--	--	--	--	--	--	--
04/22/93	519.72	508.29	11.43	--	7300	60	40	68	98	--	--	--	--	--	--	--	--	--	--
07/20,21/93	519.72	504.52	15.20	--	30,000	160	130	450	1100	--	--	--	--	--	--	--	--	--	--
10/20/93	519.72	506.76	12.96	--	36,000	22	200	440	930	--	--	--	--	--	--	--	--	--	--
01/20/94	519.72	506.88	12.84	--	12000	55	57	27	210	--	--	--	--	--	--	--	--	--	--
04/21/94	519.72	506.58	13.14	--	2200	11	12	23	19	--	--	--	--	--	--	--	--	--	--
07/21,22/94	519.72	506.77	12.95	--	1100	ND	4.0	14	10	--	--	--	--	--	--	--	--	13	--
01/18/95	519.72	508.57	11.15	--	2100	9.2	13	19	13	--	--	--	--	--	--	--	--	--	--
04/17/95	519.72	508.41	11.31	--	3800	4.8	3.6	5.9	7.2	--	--	--	--	--	--	--	--	--	--
07/18/95	519.72	508.06	11.66	--	1700	<2.0	<2.0	9.6	8.3	--	--	--	--	--	--	--	--	--	--
10/17/95	519.72	507.99	11.73	--	1200	<1.2	<1.2	2.2	4.3	450	--	--	--	--	--	--	--	--	--

CONTINUED ON NEXT PAGE

Cumulative Table of Well Data and Analytical Results

Vertical Measurements are in feet.

Analytical results are in parts per billion (ppb)

DATE	Well	Ground	Depth	Notes	Analytical results are in parts per billion (ppb)															
	Head Elev.	Water Elev.	To Water		TPH- Gasoline	Benzene	Toluene	Ethyl- Benzene	Xylene	MTBE	TOG	1,2- DCA	VC	MC	1,1,1- TCA	1,1- DCA	PCE	Total Lead	Diss. Lead	CDS
C-9 (CONT'D)																				
01/18/96	519.72	509.04	10.68	--	1400	3.1	<2.5	<2.5	<2.5	750	--	--	--	--	--	--	--	--	--	--
04/17/96	519.72	509.67	10.05	--	480	0.94	<0.5	1.7	1.1	380	--	--	--	--	--	--	--	--	--	--
07/16/96	519.72	508.80	10.92	--	290	2.7	<0.5	2.0	3.3	420	--	--	--	--	--	--	--	--	--	--
10/16/96	519.72	508.42	11.30	--	2200	13	<10	<10	<10	1300	--	--	--	--	--	--	--	--	--	--
04/10/97	519.72	508.52	11.20	Sampled biannually	680	<5.0	<5.0	<5.0	<5.0	630	--	<0.5	<1.0	<5.0	<0.5	<0.5	<0.5	--	--	--
10/20/97	519.72	508.28	11.44	--	650	11	<5.0	8.1	7.2	1000	--	--	--	--	--	--	--	--	<5.0	--
04/30/98	519.72	509.11	10.61	--	880	4.4	3.9	2.0	8.5	200	--	<0.5	<1.0	<5.0	<0.5	<0.5	<0.5	--	--	--
10/07/98	519.72	508.87	10.85	--	<50	0.68	<0.5	<0.5	<0.5	130	--	--	--	--	--	--	--	--	--	--
04/14/99	519.72	508.89	10.83	*/**	534	3.28	<0.5	3.0	<0.5	94.4	--	<0.5	<1.0	<5.0	<0.5	<0.5	<0.5	--	--	--

* Sampled for VOCs by EPA Method 8010B. All Analytes were not detected above the detection limits <0.5 to <5.0.

** See Table of Additional Analyses.

Cumulative Table of Well Data and Analytical Results

Vertical Measurements are in feet.

Analytical results are in parts per billion (ppb)

DATE	Well Head Elev.	Ground Water Elev.	Depth To Water	Notes	TPH- Gasoline	Benzene	Toluene	Ethyl- Benzene	Xylene	MTBE	TOG	1,2- DCA	VC	MC1,1,1- TCA	1,1- DCA	PCE	Total Lead	Diss. Lead	CDS
C-10																			
03/28/86	520.41	--	--	--	--	--	--	--	--	--	--	--	--	--	--	--	--	--	--
03/15/88	520.41	505.55	14.86	--	90	7.0	ND	ND	ND	--	--	--	--	--	--	--	--	--	--
05/10/88	520.41	505.51	14.90	--	--	--	--	--	--	--	--	--	--	--	--	--	--	--	--
06/10/88	520.41	504.47	15.94	--	--	--	--	--	--	--	--	--	--	--	--	--	--	--	--
07/25/88	520.41	505.56	14.85	--	--	--	--	--	--	--	--	--	--	--	--	--	--	--	--
10/13/88	520.41	505.51	14.90	--	ND	ND	ND	ND	ND	--	--	--	--	--	--	--	--	--	--
01/01/89	520.41	505.58	14.83	--	--	--	--	--	--	--	--	--	--	--	--	--	--	--	--
01/12/89	520.41	--	--	--	ND	ND	ND	ND	ND	--	--	--	--	--	--	--	--	--	--
04/11/89	520.41	505.51	14.90	--	ND	4.8	ND	ND	ND	--	ND	6.1	--	--	--	--	--	--	--
06/26/89	520.41	505.29	15.12	--	ND	0.7	ND	ND	1.5	--	4.0	ND	--	--	--	--	--	--	--
10/13/89	520.41	505.30	15.11	--	ND	ND	ND	ND	ND	--	ND	ND	--	--	--	--	--	--	--
01/03/90	520.41	505.40	15.01	--	ND	ND	ND	ND	ND	--	--	3.0	--	--	--	--	--	--	--
05/07/90	520.41	504.88	15.53	--	ND	ND	ND	ND	ND	--	--	ND	--	ND	--	ND	--	--	--
09/27/90	520.41	505.21	15.20	--	ND	ND	ND	ND	ND	--	--	ND	--	1.2	ND	ND	--	--	--
01/03/91	520.41	505.35	15.06	--	ND	ND	ND	ND	ND	--	--	ND	--	ND	ND	ND	ND	--	--
04/12/91	520.41	505.55	14.86	--	110	16	ND	2.9	2.7	--	--	1.0	--	ND	ND	ND	ND	--	--
09/04/91	520.41	505.19	15.22	--	ND	ND	ND	ND	ND	--	--	ND	--	ND	ND	ND	ND	--	--
04/06/92	520.41	506.20	14.21	--	57	ND	ND	ND	ND	--	--	1.1	--	ND	ND	ND	ND	--	--
07/28/92	520.41	505.63	14.78	--	ND	ND	ND	ND	ND	--	--	--	--	--	--	--	--	--	--
10/16/92	520.41	504.90	15.51	--	ND	ND	ND	ND	ND	--	--	--	--	--	--	--	--	--	--
01/14/93	520.41	506.97	13.44	--	88	4.7	ND	2.3	1.6	--	--	--	--	--	--	--	--	--	--
03/26/93	520.41	507.86	12.55	--	ND	ND	ND	ND	ND	--	--	--	--	--	--	--	--	--	--
04/22/93	520.41	506.67	13.74	--	ND	ND	ND	ND	ND	--	--	--	--	--	--	--	--	--	--
07/20,21/93	520.41	503.92	16.49	--	100	ND	ND	ND	ND	--	--	--	--	--	--	--	--	--	--
10/20/93	520.41	505.77	14.64	--	ND	ND	ND	ND	ND	--	--	--	--	--	--	--	--	--	--
01/20/94	520.41	506.02	14.39	--	ND	ND	ND	ND	ND	--	--	--	--	--	--	--	--	--	--
04/21/94	520.41	505.79	14.82	--	ND	0.8	ND	ND	ND	--	--	--	--	--	--	--	--	--	--
07/21,22/94	520.41	505.84	14.57	--	ND	ND	ND	ND	ND	--	--	--	--	--	--	--	--	ND	--
01/18/95	520.41	506.77	13.64	--	<50	1.2	<0.5	<0.5	<0.5	--	--	1.2	--	--	--	--	--	--	--
04/17/95	520.41	506.87	13.54	Sampled biannually	--	--	--	--	--	--	--	--	--	--	--	--	--	--	--
07/18/95	520.41	506.97	13.44	--	<50	<0.5	<0.5	<0.5	<0.5	--	--	--	--	--	--	--	--	--	--
10/17/95	520.41	506.63	13.78	--	--	--	--	--	--	--	--	--	--	--	--	--	--	--	--
01/18/96	520.41	506.81	13.60	--	<125	3.7	<1.2	<1.2	<1.2	1000	--	--	--	--	--	--	--	--	--
04/17/96	520.41	507.23	13.18	--	--	--	--	--	--	--	--	--	--	--	--	--	--	--	--
07/16/96	520.41	507.30	13.11	--	<200	<2.0	<2.0	<2.0	<2.0	1000	--	--	--	--	--	--	--	--	--
10/16/96	520.41	506.91	13.50	--	--	--	--	--	--	--	--	--	--	--	--	--	--	--	--

NO LONGER MONITORED OR SAMPLED

Cumulative Table of Well Data and Analytical Results

Vertical Measurements are in feet.

Analytical results are in parts per billion (ppb)

DATE	Well Head Elev.	Ground Water Elev.	Depth To Water	Notes	TPH- Gasoline	Benzene	Toluene	Ethyl- Benzene	Xylene	MTBE	TOG	1,2- DCA	VC	MC1,1,1- TCA	1,1- DCA	PCE	Total Lead	Diss. Lead	CDS
C-11																			
03/28/86	520.04	506.22	13.82	--	--	--	--	--	--	--	--	--	--	--	--	--	--	--	--
03/15/88	520.04	505.55	14.49	--	--	--	--	--	--	--	--	--	--	--	--	--	--	--	--
05/10/88	520.04	505.73	14.31	--	--	--	--	--	--	--	--	--	--	--	--	--	--	--	--
06/10/88	520.04	504.57	15.47	--	--	--	--	--	--	--	--	--	--	--	--	--	--	--	--
07/25/88	520.04	506.44	13.60	--	--	--	--	--	--	--	--	--	--	--	--	--	--	--	--
10/14/88	520.04	505.51	14.53	--	2.0	240	33	4.7	67	--	--	--	--	--	--	--	--	--	--
01/01/89	520.04	505.94	14.10	--	--	--	--	--	--	--	--	--	--	--	--	--	--	--	--
01/12/89	520.04	--	--	--	ND	ND	0.8	ND	ND	--	--	--	--	--	--	--	--	--	--
04/12/89	520.04	505.68	14.36	--	ND	4.3	ND	ND	ND	--	ND	ND	--	--	--	--	--	--	--
06/26/89	520.04	505.46	14.58	--	ND	2.0	ND	ND	ND	--	4.0	ND	--	--	--	--	--	--	--
10/13/89	520.04	505.33	14.71	--	ND	ND	ND	ND	ND	--	ND	ND	--	--	--	--	--	--	--
01/03/90	520.04	505.43	14.61	--	ND	ND	ND	ND	0.7	--	--	ND	--	--	--	--	--	--	--
05/08/90	520.04	504.51	15.53	--	110	12	11	0.9	22	--	--	ND	--	ND	--	ND	--	--	--
09/28/90	520.04	504.53	15.51	--	ND	2.0	1.4	ND	3.3	--	--	ND	--	1.2	ND	ND	--	--	--
01/03/91	520.04	505.41	14.63	--	ND	2.0	ND	ND	2.0	--	--	ND	--	ND	ND	ND	1.0	--	--
04/12/91	520.04	505.74	14.30	--	--	--	--	--	--	--	--	--	--	--	--	--	--	--	--
09/04/91	520.04	505.20	14.84	--	--	--	--	--	--	--	--	--	--	--	--	--	--	--	--
04/06/92	520.04	506.48	13.56	--	ND	ND	ND	ND	ND	--	--	ND	--	ND	ND	ND	ND	--	--
07/28/92	520.04	505.65	14.39	--	ND	ND	ND	ND	ND	--	--	--	--	--	--	--	--	--	--
10/16/92	520.04	504.25	15.79	--	ND	ND	ND	ND	ND	--	--	--	--	--	--	--	--	--	--
01/14/93	520.04	507.90	12.14	--	94	ND	1.3	0.7	6.0	--	--	--	--	--	--	--	--	--	--
03/26/93	520.04	508.23	11.81	--	130	2.0	ND	0.6	1.0	--	--	--	--	--	--	--	--	--	--
04/22/93	520.04	507.10	12.94	--	ND	0.8	ND	ND	ND	--	--	--	--	--	--	--	--	--	--
07/20,21/93	520.04	503.56	16.48	--	1200	3.0	1.0	ND	1.0	--	--	--	--	--	--	--	--	--	--
10/20/93	520.04	505.58	14.46	--	ND	2.0	ND	ND	ND	--	--	--	--	--	--	--	--	--	--
01/20/94	520.04	505.92	14.12	--	140	5.0	0.6	3.0	4.0	--	--	--	--	--	--	--	--	--	--
04/21/94	520.04	505.80	14.24	--	86	1.7	0.6	1.2	1.6	--	--	--	--	--	--	--	--	--	--
07/21,22/94	520.04	505.83	14.21	--	ND	ND	ND	ND	ND	--	--	--	--	--	--	--	--	7.0	--
01/18/95	520.04	506.81	13.23	--	50	3.7	<0.5	0.9	1.9	--	--	--	--	--	--	--	--	--	--
04/17/95	520.04	507.03	13.01	--	89	1.4	1.3	0.69	0.79	--	--	--	--	--	--	--	--	--	--
07/18/95	520.04	507.04	13.00	--	89	0.95	<0.5	1.1	1.0	--	--	--	--	--	--	--	--	--	--
10/17/95	520.04	506.72	13.32	--	73	<0.5	<0.5	<0.5	<0.5	390	--	--	--	--	--	--	--	--	--

CONTINUED ON NEXT PAGE

Cumulative Table of Well Data and Analytical Results

Vertical Measurements are in feet.

Analytical results are in parts per billion (ppb)

DATE	Well	Ground	Depth	Notes	TPH- Gasoline	Benzene	Toluene	Ethyl- Benzene	Xylene	MTBE	TOG	1,2- DCA	VC	MC1,1,1- TCA	1,1- DCA	PCE	Total Lead	Diss. Lead	CDS
	Head Elev.	Water Elev.	To Water																
C-11 (CONT'D)																			
01/18/96	520.04	507.14	12.90	--	240	12	29	4.3	33	<2.5	--	--	--	--	--	--	--	--	--
04/17/96	519.95	507.47	12.48	--	<50	<0.5	<0.5	<0.5	<0.5	26	--	--	--	--	--	--	--	--	--
07/16/96	519.95	507.28	12.67	--	<500	17	<5.0	<5.0	20	5900	--	--	--	--	--	--	--	--	--
10/16/96	519.95	506.90	13.05	--	<125	<1.2	<1.2	<1.2	<1.2	910	--	--	--	--	--	--	--	--	--
04/10/97	519.95	506.77	13.18	--	<100	<1.0	<1.0	<1.0	<1.0	460	--	--	--	--	--	--	--	--	--
10/20/97	519.95	506.70	13.25	--	190	<0.5	7.2	2.6	16	8900	--	--	--	--	--	--	--	25	--
04/30/98	519.95	507.19	12.76	--	<1000	<10	<10	<10	<10	2100	--	--	--	--	--	--	--	--	--
10/07/98	519.95	507.27	12.68	--	<50,000	930	<500	<500	<500	700,000	--	--	--	--	--	--	--	--	--
01/08/99	519.95	506.74	13.21	--	<500	16	<5.0	<5.0	<5.0	11,000	--	--	--	--	--	--	--	--	--
01/08/99	519.95	506.74	13.21	Confirmation Run	--	--	--	--	--	9,900	--	--	--	--	--	--	--	--	--
04/14/99	519.95	506.84	13.11	*	99.6	2.13	<0.5	1.08	<0.5	853	--	--	--	--	--	--	--	--	--

* See Table of Additional Analyses.

Cumulative Table of Well Data and Analytical Results

Vertical Measurements are in feet.

Analytical results are in parts per billion (ppb)

DATE	Well	Ground	Depth	Notes	TPH- Gasoline	Benzene	Toluene	Ethyl- Benzene	Xylene	MTBE	TOG	1,2- DCA	VC	MC 1,1,1- TCA	1,1- DCA	PCE	Total Lead	Diss. Lead	CDS
	Head Elev.	Water Elev.	To Water																
C-12																			
03/28/86	519.82	506.21	13.61	--	--	--	--	--	--	--	--	--	--	--	--	--	--	--	--
03/15/88	519.82	505.27	14.55	--	ND	ND	ND	ND	ND	--	--	--	--	--	--	--	--	--	--
05/10/88	519.82	505.25	14.57	--	--	--	--	--	--	--	--	--	--	--	--	--	--	--	--
06/10/88	519.82	504.19	15.63	--	--	--	--	--	--	--	--	--	--	--	--	--	--	--	--
07/25/88	519.82	505.31	14.51	--	--	--	--	--	--	--	--	--	--	--	--	--	--	--	--
10/13/88	519.82	505.22	14.60	--	ND	ND	ND	ND	ND	--	--	--	--	--	--	--	--	--	--
01/12/89	519.82	505.20	14.62	--	ND	ND	ND	ND	ND	--	--	--	--	--	--	--	--	--	--
04/11/89	519.82	505.21	14.61	--	ND	ND	ND	ND	ND	--	ND	ND	--	--	--	--	--	--	--
06/26/89	519.82	505.07	14.75	--	ND	ND	ND	ND	ND	--	ND	ND	--	--	--	--	--	--	--
10/13/89	519.82	505.05	14.77	--	ND	ND	ND	ND	ND	--	ND	ND	--	--	--	--	--	--	--
01/03/90	519.82	504.97	14.85	--	ND	ND	ND	ND	0.6	--	--	ND	--	--	--	--	--	--	--
05/07/90	519.82	505.07	14.75	--	ND	ND	ND	ND	ND	--	--	ND	--	ND	--	ND	--	--	--
09/27/90	519.82	505.21	14.61	--	ND	ND	ND	ND	ND	--	--	ND	--	1.2	ND	ND	--	--	--
01/03/91	519.82	505.12	14.70	--	ND	ND	ND	ND	ND	--	--	ND	--	ND	ND	ND	ND	--	--
04/12/91	519.82	505.30	14.52	--	--	--	--	--	--	--	--	--	--	--	--	--	--	--	--
09/04/91	519.82	504.99	14.83	--	--	--	--	--	--	--	--	--	--	--	--	--	--	--	--
04/06/92	519.82	506.01	13.81	--	ND	ND	ND	ND	ND	--	--	ND	--	ND	ND	ND	ND	--	--
07/28/92	519.82	505.50	14.32	--	ND	ND	ND	ND	ND	--	--	--	--	--	--	--	--	--	--
10/16/92	519.82	504.70	15.12	--	ND	ND	ND	ND	ND	--	--	--	--	--	--	--	--	--	--
01/14/93	519.82	506.59	13.23	--	65	ND	ND	ND	1.7	--	--	--	--	--	--	--	--	--	--
03/26/93	519.82	507.62	12.20	--	ND	0.9	ND	ND	ND	--	--	--	--	--	--	--	--	--	--
04/22/93	519.82	506.61	13.21	--	ND	ND	ND	ND	ND	--	--	--	--	--	--	--	--	--	--
07/20,21/93	519.82	503.11	16.71	--	ND	ND	ND	ND	ND	--	--	--	--	--	--	--	--	--	--
10/20/93	519.82	505.63	14.19	--	ND	ND	ND	ND	ND	--	--	--	--	--	--	--	--	--	--
01/20/94	519.82	505.77	14.05	--	ND	ND	ND	ND	ND	--	--	--	--	--	--	--	--	--	--
04/21/94	519.82	505.76	14.06	--	ND	ND	ND	ND	ND	--	--	--	--	--	--	--	--	--	--
07/21,22/94	519.82	505.70	14.12	--	ND	ND	ND	ND	ND	--	--	--	--	--	--	--	ND	--	--
01/08/99	519.82	506.51	13.31	--	<50	<0.50	<0.50	<0.50	<0.50	<2.5	--	--	--	--	--	--	--	--	--
01/08/99	519.82	506.51	13.31	Confirmation Run	--	--	--	--	--	<2.0	--	--	--	--	--	--	--	--	--

NO LONGER MONITORED OR SAMPLED

Cumulative Table of Well Data and Analytical Results

Vertical Measurements are in feet.

Analytical results are in parts per billion (ppb)

DATE	Well Head Elev.	Ground Water Elev.	Depth To Water	Notes	TPH- Gasoline	Benzene	Toluene	Ethyl- Benzene	Xylene	MTBE	TOG	1,2- DCA	VC	MC 1,1,1- TCA	1,1- DCA	PCE	Total Lead	Diss. Lead	CDS
C-13																			
03/28/86	522.24	509.29	12.95	--	--	--	--	--	--	--	--	--	--	--	--	--	--	--	--
03/15/88	522.24	507.42	14.82	--	250	2.0	ND	9.0	3.0	--	--	--	--	--	--	--	--	--	--
05/10/88	522.24	507.21	15.03	--	--	--	--	--	--	--	--	--	--	--	--	--	--	--	--
06/10/88	522.24	506.14	16.10	--	--	--	--	--	--	--	--	--	--	--	--	--	--	--	--
07/25/88	522.24	507.51	14.73	--	--	--	--	--	--	--	--	--	--	--	--	--	--	--	--
10/13/88	522.24	507.33	14.91	--	ND	1.9	ND	ND	ND	--	--	--	--	--	--	--	--	--	--
01/01/89	522.24	508.14	14.10	--	--	--	--	--	--	--	--	--	--	--	--	--	--	--	--
01/12/89	522.24	--	--	--	ND	ND	0.6	4.0	ND	--	--	--	--	--	--	--	--	--	--
04/10/89	522.24	507.25	14.99	--	ND	ND	ND	8.0	ND	--	ND	ND	--	--	--	--	--	--	--
06/26/89	522.24	507.08	15.16	--	ND	0.3	ND	ND	ND	--	ND	ND	--	--	--	--	--	--	--
10/13/89	522.24	507.01	15.23	--	ND	ND	ND	ND	ND	--	ND	ND	--	--	--	--	--	--	--
01/03/90	522.24	507.09	15.15	--	ND	ND	ND	0.5	0.6	--	--	ND	--	--	--	--	--	--	--
05/08/90	522.24	507.22	15.02	--	ND	ND	ND	ND	ND	--	--	ND	--	ND	--	ND	--	--	--
09/27/90	522.24	507.13	15.11	--	ND	ND	0.6	ND	ND	--	--	ND	--	1.7	ND	ND	--	--	--
01/03/91	522.24	507.16	15.08	--	ND	ND	ND	ND	0.6	--	--	ND	--	ND	ND	ND	ND	--	--
04/12/91	522.24	507.47	14.77	--	--	--	--	--	--	--	--	--	--	--	--	--	--	--	--
09/04/91	522.24	506.81	15.43	--	--	--	--	--	--	--	--	--	--	--	--	--	--	--	--
04/06/92	522.24	507.81	14.43	--	66	ND	ND	ND	ND	--	--	ND	--	ND	ND	ND	ND	--	--
07/28/92	522.24	506.87	15.37	--	60	8.2	ND	ND	1.1	--	--	--	--	--	--	--	--	--	--
10/16/92	522.24	506.37	15.87	--	ND	ND	ND	ND	ND	--	--	--	--	--	--	--	--	--	--
01/14/93	522.24	509.41	12.83	--	100	ND	ND	ND	1.3	--	--	--	--	--	--	--	--	--	--
03/26/93	522.24	509.65	12.59	--	ND	ND	ND	ND	ND	--	--	--	--	--	--	--	--	--	--
04/22/93	522.24	509.08	13.16	--	ND	ND	ND	ND	ND	--	--	--	--	--	--	--	--	--	--
07/20,21/93	522.24	505.72	16.52	--	99	4.0	13	2.0	7.0	--	--	--	--	--	--	--	--	--	--
10/20/93	522.24	507.11	15.13	--	ND	ND	ND	ND	ND	--	--	--	--	--	--	--	--	--	--
01/20/94	522.24	507.59	14.65	--	ND	ND	ND	ND	ND	--	--	--	--	--	--	--	--	--	--
04/21/94	522.24	507.36	14.88	--	ND	ND	ND	ND	ND	--	--	--	--	--	--	--	--	--	--
07/21,22/94	522.24	507.29	14.95	--	ND	ND	ND	ND	ND	--	--	--	--	--	--	--	--	ND	--

NO LONGER MONITORED OR SAMPLED

Cumulative Table of Well Data and Analytical Results

Vertical Measurements are in feet.

Analytical results are in parts per billion (ppb)

DATE	Well Head Elev.	Ground Water Elev.	Depth To Water	Notes	TPH-Gasoline	Benzene	Toluene	Ethyl-Benzene	Xylene	MTBE	TOG	1,2-DCA	VC	MC1,1,1-TCA	1,1-DCA	PCE	Total Lead	Diss. Lead	CDS
C-14																			
03/28/86	520.08	--	--	--	--	--	--	--	--	--	--	--	--	--	--	--	--	--	--
03/15/88	520.08	--	--	--	--	--	--	--	--	--	--	--	--	--	--	--	--	--	--
05/10/88	520.08	506.69	13.39	--	120,000	13,000	29,000	2700	18	--	--	--	--	--	--	--	--	--	--
06/10/88	520.08	505.43	14.65	--	--	--	--	--	--	--	--	--	--	--	--	--	--	--	--
07/25/88	520.08	506.61	13.47	--	--	--	--	--	--	--	--	--	--	--	--	--	--	--	--
10/13/88	520.08	506.50	13.58	--	ND	ND	ND	ND	ND	--	--	--	--	--	--	--	--	--	--
01/01/89	520.08	507.08	13.00	--	--	--	--	--	--	--	--	--	--	--	--	--	--	--	--
01/12/89	520.08	--	--	--	NS	ND	ND	ND	ND	--	--	--	--	--	--	--	--	--	--
04/12/89	520.08	506.61	13.47	--	NS	ND	ND	ND	ND	--	ND	ND	--	--	--	--	--	--	--
06/26/89	520.08	506.28	13.80	--	140,000	14,000	25,000	3400	26,000	--	--	30	--	--	--	--	--	--	--
10/13/89	520.08	506.46	13.62	--	86,000	12,000	16,000	1600	13,000	--	--	--	--	--	--	--	--	--	--
01/03/90	520.08	506.17	13.91	--	120,000	9500	16,000	1800	13,000	--	--	25	3.0	--	--	--	--	--	--
01/04/90	520.08	506.17	13.91	--	76,000	3900	8100	1200	7700	--	--	18	1.0	--	--	--	--	--	--
05/08/90	520.08	506.19	13.89	--	62,000	7500	17,000	1400	14,000	--	--	13	--	ND	--	ND	--	--	--
09/27/90	520.08	506.30	13.78	--	--	--	--	--	--	--	--	--	--	--	--	--	--	--	--
01/03/91	520.08	506.36	13.72	--	--	--	--	--	--	--	--	--	--	--	--	--	--	--	--
04/12/91	520.08	507.11	12.97	--	60,000	750	3800	720	9200	--	--	ND	--	ND	ND	ND	ND	--	--
09/04/91	520.08	506.24	13.84	--	110,000	2800	11,000	1300	13,000	--	--	--	--	--	--	--	--	--	--
04/06/92	520.08	507.64	12.44	--	41,000	190	1800	440	5100	--	--	ND	--	ND	ND	ND	ND	--	--
07/28/92	520.08	506.38	13.70	--	130,000	2300	9700	1800	15,000	--	--	--	--	--	--	--	--	--	--
10/16/92	520.08	505.70	14.38	--	--	--	--	--	--	--	--	--	--	--	--	--	--	--	--
01/14/93	520.08	511.28	8.80	--	27,000	220	790	220	2700	--	--	--	--	--	--	--	--	--	--
03/26/93	520.08	510.96	9.12	--	23,000	330	1600	460	4000	--	--	--	--	--	--	--	--	--	--
04/22/93	520.08	507.98	12.10	Sheen	17,000	840	2300	130	3500	--	--	--	--	--	--	--	--	--	--
07/20,21/93	520.08	--	--	Inaccessible	--	--	--	--	--	--	--	--	--	--	--	--	--	--	--
10/20/93	520.08	505.77	14.31	Insufficient water	--	--	--	--	--	--	--	--	--	--	--	--	--	--	--
01/20/94	520.08	507.94	12.14	--	22,000	130	790	270	2400	--	--	--	--	--	--	--	--	--	--
04/21/94	520.08	508.15	11.93	--	9400	88	330	72	960	--	--	--	--	--	--	--	--	--	--
07/21,22/94	520.08	506.94	13.14	--	6200	92	180	30	530	--	--	--	--	--	--	--	330	--	--
01/18/95	520.08	--	--	Dry	--	--	--	--	--	--	--	--	--	--	--	--	--	--	--
04/17/95	520.08	--	--	Dry	--	--	--	--	--	--	--	--	--	--	--	--	--	--	--
07/18/95	520.08	--	--	Dry	--	--	--	--	--	--	--	--	--	--	--	--	--	--	--
10/17/95	520.08	507.64	12.44	Insufficient water	--	--	--	--	--	--	--	--	--	--	--	--	--	--	--

CONTINUED ON NEXT PAGE

Cumulative Table of Well Data and Analytical Results

Vertical Measurements are in feet.

Analytical results are in parts per billion (ppb)

DATE	Well Head Elev.	Ground Water Elev.	Depth To Water	Notes	TPH- Gasoline	Benzene	Toluene	Ethyl- Benzene	Xylene	MTBE	TOG	1,2- DCA	VC	MC 1,1,1- TCA	1,1- DCA	PCE	Total Lead	Diss. Lead	CDS
C-14 (CONT'D)																			
01/18/96	520.08	507.84	12.24	Insufficient water	--	--	--	--	--	--	--	--	--	--	--	--	--	--	--
04/17/96	520.08	507.91	12.17	Insufficient water	--	--	--	--	--	--	--	--	--	--	--	--	--	--	--
07/16/96	520.08	508.55	11.53	Insufficient water	--	--	--	--	--	--	--	--	--	--	--	--	--	--	--
10/16/96	520.08	507.98	12.10	Insufficient water	--	--	--	--	--	--	--	--	--	--	--	--	--	--	--
04/10/97	520.08	508.11	11.97	Insufficient water	--	--	--	--	--	--	--	--	--	--	--	--	--	--	--
10/20/97	520.08	507.79	12.29	Insufficient water	--	--	--	--	--	--	--	--	--	--	--	--	--	--	--
10/07/98	520.08	508.27	11.81	Insufficient water	--	--	--	--	--	--	--	--	--	--	--	--	--	--	--
04/14/99	520.08	508.15	11.93	Insufficient water	--	--	--	--	--	--	--	--	--	--	--	--	--	--	--
04/27/99	520.08	508.36	11.72	Insufficient water	--	--	--	--	--	--	--	--	--	--	--	--	--	--	--

Cumulative Table of Well Data and Analytical Results

Vertical Measurements are in feet.

Analytical results are in parts per billion (ppb)

DATE	Well Head Elev.	Ground Water Elev.	Depth To Water	Notes	TPH- Gasoline	Benzene	Toluene	Ethyl- Benzene	Xylene	MTBE	TOG	1,2- DCA	VC	MC 1,1,1- TCA	1,1- DCA	PCE	Total Lead	Diss. Lead	CDS
C-15																			
03/28/86	522.41	509.27	13.14	--	--	--	--	--	--	--	--	--	--	--	--	--	--	--	--
03/15/88	522.41	507.28	15.13	--	ND	ND	ND	ND	ND	--	--	--	--	--	--	--	--	--	--
05/10/88	522.41	507.01	15.40	--	--	--	--	--	--	--	--	--	--	--	--	--	--	--	--
06/10/88	522.41	505.92	16.49	--	--	--	--	--	--	--	--	--	--	--	--	--	--	--	--
07/25/88	522.41	507.24	15.17	--	--	--	--	--	--	--	--	--	--	--	--	--	--	--	--
10/13/88	522.41	507.08	15.33	--	ND	ND	ND	ND	ND	--	--	--	--	--	--	--	--	--	--
01/01/89	522.41	508.71	13.70	--	--	--	--	--	--	--	--	--	--	--	--	--	--	--	--
01/12/89	522.41	--	--	--	ND	ND	ND	ND	ND	--	--	--	--	--	--	--	--	--	--
04/12/89	522.41	507.07	15.34	--	ND	ND	ND	ND	ND	--	ND	ND	--	--	--	--	--	--	--
06/26/89	522.41	506.69	15.72	--	ND	ND	ND	ND	ND	--	ND	ND	--	--	--	--	--	--	--
10/13/89	522.41	506.45	15.96	--	ND	ND	ND	ND	ND	--	ND	ND	--	--	--	--	--	--	--
01/03/90	522.41	506.99	15.42	--	ND	ND	ND	ND	ND	--	--	ND	--	--	--	--	--	--	--
05/08/90	522.41	506.79	15.62	--	ND	ND	ND	ND	ND	--	--	ND	--	ND	--	ND	--	--	--
09/27/90	522.41	506.82	15.59	--	ND	ND	ND	ND	ND	--	--	ND	--	2.9	ND	ND	--	--	--
01/03/91	522.41	506.91	15.50	--	ND	ND	ND	ND	0.6	--	--	ND	--	ND	ND	ND	ND	--	--
04/12/91	522.41	507.20	15.21	--	--	--	--	--	--	--	--	--	--	--	--	--	--	--	--
09/04/91	522.41	506.51	15.90	--	--	--	--	--	--	--	--	--	--	--	--	--	--	--	--
04/06/92	522.41	507.53	14.88	--	ND	ND	ND	ND	ND	--	--	ND	--	ND	ND	ND	ND	--	--
07/28/92	522.41	506.59	15.82	--	ND	ND	ND	ND	ND	--	--	--	--	--	--	--	--	--	--
10/16/92	522.41	506.16	16.25	--	ND	ND	ND	ND	ND	--	--	--	--	--	--	--	--	--	--
01/14/93	522.41	509.93	12.48	--	61	ND	1.9	0.8	5.1	--	--	--	--	--	--	--	--	--	--
03/26/93	522.41	509.74	12.67	--	ND	ND	ND	ND	1.0	--	--	--	--	--	--	--	--	--	--
04/22/93	522.41	508.81	13.60	--	ND	ND	ND	ND	ND	--	--	--	--	--	--	--	--	--	--
07/20,21/93	522.41	505.54	16.87	--	ND	ND	ND	ND	ND	--	--	--	--	--	--	--	--	--	--
10/20/93	522.41	507.17	15.24	--	ND	ND	ND	ND	ND	--	--	--	--	--	--	--	--	--	--
01/20/94	522.41	507.40	15.01	--	ND	ND	ND	ND	ND	--	--	--	--	--	--	--	--	--	--
04/21/94	522.41	507.19	15.22	--	ND	ND	ND	ND	ND	--	--	--	--	--	--	--	--	--	--
07/21,22/94	522.41	507.06	15.35	--	ND	ND	ND	ND	ND	--	--	--	--	--	--	--	--	ND	--

NO LONGER MONITORED OR SAMPLED

Cumulative Table of Well Data and Analytical Results

Vertical Measurements are in feet.

Analytical results are in parts per billion (ppb)

DATE	Well Head Elev.	Ground Water Elev.	Depth To Water	Notes	TPH-Gasoline	Benzene	Toluene	Ethyl-Benzene	Xylene	MTBE	TOG	1,2-DCA	VC	MC 1,1,1-TCA	1,1-DCA	PCE	Total Lead	Diss. Lead	CDS
C-16																			
03/28/86	519.68	--	--	--	--	--	--	--	--	--	--	--	--	--	--	--	--	--	--
03/15/88	519.68	--	--	--	--	--	--	--	--	--	--	--	--	--	--	--	--	--	--
05/10/88	519.68	505.90	13.78	--	4500	1,000	73	140	180	--	--	--	--	--	--	--	--	--	--
06/10/88	519.68	504.80	14.88	--	--	--	--	--	--	--	--	--	--	--	--	--	--	--	--
07/25/88	519.68	505.99	13.69	--	--	--	--	--	--	--	--	--	--	--	--	--	--	--	--
10/13/88	519.68	505.88	13.80	--	1600	16	5.5	ND	16	--	--	--	--	--	--	--	--	--	--
01/01/89	519.68	506.23	13.45	--	--	--	--	--	--	--	--	--	--	--	--	--	--	--	--
01/12/89	519.68	--	--	--	1000	360	11	78	51	--	--	--	--	--	--	--	--	--	--
04/11/89	519.68	505.90	13.78	--	15,800	130	4.0	21	19	--	ND	8.0	--	--	--	--	--	--	--
06/26/89	519.68	505.66	14.02	--	1300	170	8.0	37	43	--	ND	ND	--	--	--	--	--	--	--
10/13/89	519.68	505.67	14.01	--	1000	20	ND	7.0	ND	--	ND	ND	--	--	--	--	--	--	--
01/03/90	519.68	505.71	13.97	--	1300	150	3.0	41	24	--	--	5.0	--	--	--	--	--	--	--
05/07/90	519.68	505.23	14.45	--	480	49	4.4	29	13	--	--	4.5	--	ND	--	ND	--	--	--
09/29/90	519.68	505.36	14.32	--	360	18	2.1	11	8.0	--	--	1.8	--	ND	ND	ND	--	--	--
01/03/91	519.68	505.72	13.96	--	230	12	ND	6.0	6.0	--	--	2.0	--	0.8	ND	ND	ND	--	--
04/12/91	519.68	505.94	13.74	--	--	--	--	--	--	--	--	--	--	--	--	--	--	--	--
09/04/91	519.68	505.46	14.22	--	--	--	--	--	--	--	--	--	--	--	--	--	--	--	--
04/06/92	519.68	506.50	13.18	--	360	30	ND	14	12	--	--	1.0	--	ND	ND	ND	ND	--	--
07/28/92	519.68	505.75	13.93	--	210	31	ND	6.8	16	--	--	--	--	--	--	--	--	--	--
10/16/92	519.68	504.76	14.92	--	140	11	ND	5.1	3.4	--	--	--	--	--	--	--	--	--	--
01/14/93	519.68	507.87	11.81	--	740	24	ND	36	21	--	--	--	--	--	--	--	--	--	--
03/26/93	519.68	508.32	11.36	--	730	22	2.0	16	10	--	--	--	--	--	--	--	--	--	--
04/22/93	519.68	507.38	12.30	--	850	46	ND	24	6.0	--	--	--	--	--	--	--	--	--	--
07/20,21/93	519.68	--	--	Inaccessible	--	--	--	--	--	--	--	--	--	--	--	--	--	--	--
10/20/93	519.68	505.68	14.00	--	290	18	2.0	16	17	--	--	--	--	--	--	--	--	--	--
01/20/94	519.68	506.20	13.48	--	360	10	1.0	12	9.0	--	--	--	--	--	--	--	--	--	--
04/21/94	519.68	505.76	13.92	--	220	15	ND	13	11	--	--	--	--	--	--	--	--	--	--
07/21,22/94	519.68	506.12	13.56	--	72	1.2	ND	ND	1.0	--	--	--	--	--	--	--	8.0	--	--
01/18/95	519.68	--	--	Inaccessible	--	--	--	--	--	--	--	--	--	--	--	--	--	--	--
04/17/95	519.68	--	--	Inaccessible	--	--	--	--	--	--	--	--	--	--	--	--	--	--	--
07/18/95	519.68	--	--	Inaccessible	--	--	--	--	--	--	--	--	--	--	--	--	--	--	--
10/17/95	519.68	--	--	Inaccessible	--	--	--	--	--	--	--	--	--	--	--	--	--	--	--
01/18/96	519.68	--	--	Inaccessible	--	--	--	--	--	--	--	--	--	--	--	--	--	--	--
04/17/96	519.68	--	--	Inaccessible	--	--	--	--	--	--	--	--	--	--	--	--	--	--	--
07/16/96	519.68	--	--	Inaccessible	--	--	--	--	--	--	--	--	--	--	--	--	--	--	--
10/16/96	519.68	--	--	Inaccessible	--	--	--	--	--	--	--	--	--	--	--	--	--	--	--

NO LONGER MONITORED OR SAMPLED

Cumulative Table of Well Data and Analytical Results

Vertical Measurements are in feet.

Analytical results are in parts per billion (ppb)

DATE	Well Head Elev.	Ground Water Elev.	Depth To Water	Notes	TPH-Gasoline	Benzene	Toluene	Ethyl-Benzene	Xylene	MTBE	TOG	1,2-DCA	VC	MC 1,1,1-TCA	1,1-DCA	PCE	Total Lead	Diss. Lead	CDS
C-17																			
03/28/86	520.82	507.34	13.48	--	--	--	--	--	--	--	--	--	--	--	--	--	--	--	--
03/15/88	520.82	506.06	14.76	--	--	--	--	--	--	--	--	--	--	--	--	--	--	--	--
05/10/88	520.82	506.05	14.77	--	--	--	--	--	--	--	--	--	--	--	--	--	--	--	--
06/10/88	520.82	504.98	15.84	--	--	--	--	--	--	--	--	--	--	--	--	--	--	--	--
07/25/88	520.82	506.19	14.63	--	--	--	--	--	--	--	--	--	--	--	--	--	--	--	--
10/13/88	520.82	505.99	14.83	--	270,000	18	900	760	5500	--	--	--	--	--	--	--	--	--	--
01/01/89	520.82	506.04	14.78	--	--	--	--	--	--	--	--	--	--	--	--	--	--	--	--
01/12/89	520.82	--	--	--	190,000	ND	490	2100	6700	--	--	--	--	--	--	--	--	--	--
04/11/89	520.82	505.99	14.83	--	27,000	30	150	320	1000	--	6.0	ND	--	--	--	--	--	--	--
06/26/89	520.82	505.79	15.03	--	20,000	50	390	660	2000	--	ND	ND	--	--	--	--	--	--	--
06/26/89	520.82	505.79	15.03	--	27,000	40	420	740	2200	--	--	ND	--	--	--	--	--	--	--
10/13/89	520.82	505.80	15.02	--	17,000	ND	48	230	480	--	ND	ND	--	--	--	--	--	--	--
01/03/90	520.82	505.72	15.10	--	14,000	ND	29	120	210	--	--	ND	--	--	--	--	--	--	--
05/08/90	520.82	505.70	15.12	--	9500	25	130	210	470	--	--	ND	--	ND	--	ND	--	--	--
09/29/90	520.82	505.83	14.99	--	ND	ND	ND	ND	ND	--	--	ND	--	ND	1.9	ND	--	--	--
09/29/90	520.82	505.83	14.99	--	ND	ND	3.4	ND	ND	--	--	ND	--	1.8	1.9	ND	--	--	--
01/03/91	520.82	505.90	14.92	--	3700	ND	28	56	140	--	--	ND	--	1.8	1.9	ND	ND	--	--
01/03/91	520.82	505.90	14.92	--	8600	ND	10	59	150	--	--	ND	--	ND	ND	ND	ND	--	--
04/12/91	520.82	506.11	14.71	--	8600	ND	5.0	47	120	--	--	ND	--	ND	ND	ND	ND	--	--
04/12/91	520.82	506.11	14.71	--	4400	ND	11	48	120	--	--	ND	--	ND	ND	ND	ND	--	--
09/04/91	520.82	505.65	15.17	--	5800	ND	27	49	79	--	--	ND	--	ND	ND	ND	ND	--	--
09/04/91	520.82	505.65	15.17	--	4100	ND	21	36	61	--	--	ND	--	ND	ND	ND	ND	--	--
04/06/92	520.82	506.68	14.14	--	2300	ND	5.8	27	29	--	--	ND	--	ND	ND	ND	ND	--	--
07/28/92	520.82	505.64	15.18	--	11,000	99	180	170	430	--	--	--	--	--	--	--	--	--	--
10/16/92	520.82	505.06	15.76	--	200,000	ND	4800	3900	6600	--	--	--	--	--	--	--	--	--	--
01/14/93	520.82	507.38	13.44	--	3500	9.3	9.1	23	34	--	--	--	--	--	--	--	--	--	--
03/26/93	520.82	508.36	12.46	--	3700	ND	19	20	35	--	--	--	--	--	--	--	--	--	--
04/22/93	520.82	507.52	13.30	--	8900	16	68	44	97	--	--	--	--	--	--	--	--	--	--
07/20,21/93	520.82	503.61	17.21	--	4200	5.0	35	33	62	--	--	--	--	--	--	--	--	--	--
10/20/93	520.82	505.73	15.09	--	4500	5.0	12	43	64	--	--	--	--	--	--	--	--	--	--
01/20/94	520.82	506.35	14.47	--	1900	4.0	42	24	73	--	--	--	--	--	--	--	--	--	--
04/21/94	520.82	505.87	14.95	--	1100	5.0	20	23	42	--	--	--	--	--	--	--	--	--	--
07/21,22/94	520.82	506.22	14.60	--	72	ND	ND	ND	0.9	--	--	--	--	--	--	--	ND	--	--
01/18/95	520.82	507.12	13.70	--	530	1.7	<0.5	5.6	8.8	--	--	--	--	--	--	--	--	--	--
04/17/95	520.82	507.57	13.25	--	440	1.9	3.0	3.6	2.4	--	--	--	--	--	--	--	--	--	--
07/18/95	520.82	507.38	13.44	--	140	5.5	<0.5	<0.5	<0.5	--	--	--	--	--	--	--	--	--	--
10/17/95	520.82	507.32	13.50	--	110	<0.5	<0.5	<0.5	0.62	<2.5	--	--	--	--	--	--	--	--	--

CONTINUED ON NEXT PAGE

Cumulative Table of Well Data and Analytical Results

Vertical Measurements are in feet.

Analytical results are in parts per billion (ppb)

DATE	Well Head Elev.	Ground Water Elev.	Depth To Water	Notes	TPH- Gasoline	Benzene	Toluene	Ethyl- Benzene	Xylene	MTBE	TOG	1,2- DCA	VC	MC1,1,1- TCA	1,1- DCA	PCE	Total Lead	Diss. Lead	CDS
C-17 (CONT'D)																			
01/18/96	520.82	507.80	13.02	--	310	19	30	5.6	40	28	--	--	--	--	--	--	--	--	--
04/17/96	520.53	507.83	12.70	--	<50	<0.5	<0.5	<0.5	<0.5	7.2	--	--	--	--	--	--	--	--	--
07/16/96	520.53	507.86	12.67	--	54	1.7	1.0	0.97	3.3	34	--	--	--	--	--	--	--	--	--
10/16/96	520.53	506.83	13.70	--	200	0.50	0.57	<0.5	2.2	15	--	--	--	--	--	--	--	--	--
04/10/97	520.53	507.34	13.19	Sampled biannually	100	<0.5	<0.5	<0.5	<0.5	66	--	--	--	--	--	--	--	--	--
10/20/97	520.53	507.18	13.35	--	64	<0.5	<0.5	<0.5	<0.5	22	--	--	--	--	--	--	--	<5.0	--
04/30/98	520.53	507.83	12.70	--	<50	<0.5	<0.5	<0.5	<0.5	47	--	--	--	--	--	--	--	--	--
10/07/98	520.53	507.60	12.93	--	56	0.81	<0.5	<0.5	<0.5	72	--	--	--	--	--	--	--	--	--
04/14/99	520.53	507.48	13.05	*	<50	<0.5	0.549	<0.5	<0.5	82	--	--	--	--	--	--	--	--	--

* See Table of Additional Analyses.

Cumulative Table of Well Data and Analytical Results

Vertical Measurements are in feet.

Analytical results are in parts per billion (ppb)

DATE	Well Head Elev.	Ground Water Elev.	Depth To Water	Notes	TPH-Gasoline	Benzene	Toluene	Ethyl-Benzene	Xylene	MTBE	TOG	1,2-DCA	VC	MC 1,1,1-TCA	1,1-DCA	PCE	Total Lead	Diss. Lead	CDS
C-18																			
03/28/86	518.96	--	--	--	--	--	--	--	--	--	--	--	--	--	--	--	--	--	--
03/15/88	518.96	--	--	--	--	--	--	--	--	--	--	--	--	--	--	--	--	--	--
05/10/88	518.96	--	--	--	--	--	--	--	--	--	--	--	--	--	--	--	--	--	--
06/10/88	518.96	504.07	14.89	--	--	--	--	--	--	--	--	--	--	--	--	--	--	--	--
07/25/88	518.96	505.17	13.79	--	--	--	--	--	--	--	--	--	--	--	--	--	--	--	--
10/13/88	518.96	505.10	13.86	--	ND	ND	ND	ND	ND	--	--	--	--	--	--	--	--	--	--
01/01/89	518.96	505.02	13.94	--	--	--	--	--	--	--	--	--	--	--	--	--	--	--	--
01/12/89	518.96	--	--	--	ND	ND	ND	ND	ND	--	--	--	--	--	--	--	--	--	--
04/11/89	518.96	504.10	14.86	--	ND	ND	ND	ND	ND	--	ND	3.6	--	--	--	--	--	--	--
06/26/89	518.96	504.94	14.02	--	ND	ND	ND	ND	ND	--	ND	3.1	--	--	--	--	--	--	--
10/13/89	518.96	503.90	15.06	--	ND	ND	ND	ND	ND	--	ND	ND	--	--	--	--	--	--	--
01/03/90	518.96	504.89	14.07	--	ND	ND	ND	ND	ND	--	--	1.0	--	--	--	--	--	--	--
05/07/90	518.96	504.95	14.01	--	ND	ND	ND	ND	ND	--	--	ND	--	ND	--	ND	--	--	--
09/27/90	518.96	505.05	13.91	--	ND	ND	ND	ND	ND	--	--	ND	--	0.6	ND	ND	--	--	--
01/03/91	518.96	504.98	13.98	--	ND	ND	ND	ND	ND	--	--	ND	--	ND	ND	ND	ND	--	--
04/12/91	518.96	505.13	13.83	--	ND	ND	ND	ND	ND	--	--	ND	--	ND	ND	ND	ND	--	--
09/04/91	518.96	504.76	14.20	--	ND	ND	ND	ND	ND	--	--	ND	--	ND	ND	ND	ND	--	--
04/06/92	518.96	505.89	13.07	--	ND	ND	ND	ND	ND	--	--	ND	--	ND	ND	ND	ND	--	--
07/28/92	518.96	505.41	13.55	--	ND	ND	ND	ND	ND	--	--	--	--	--	--	--	--	--	--
10/16/92	518.96	504.58	14.38	--	ND	ND	ND	ND	ND	--	--	--	--	--	--	--	--	--	--
01/14/93	518.96	506.50	12.46	--	56	ND	ND	ND	ND	1.8	--	--	--	--	--	--	--	--	--
03/26/93	518.96	507.50	11.46	--	ND	ND	ND	ND	ND	--	--	--	--	--	--	--	--	--	--
04/22/93	518.96	506.38	12.58	--	ND	ND	ND	ND	ND	--	--	--	--	--	--	--	--	--	--
07/20,21/93	518.96	503.32	15.64	--	92	ND	0.5	ND	ND	--	--	--	--	--	--	--	--	--	--
10/20/93	518.96	--	--	--	--	--	--	--	--	--	--	--	--	--	--	--	--	--	--
01/20/94	518.96	--	--	--	--	--	--	--	--	--	--	--	--	--	--	--	--	--	--
04/21/94	518.96	--	--	--	--	--	--	--	--	--	--	--	--	--	--	--	--	--	--
07/16/96	518.96	--	--	--	--	--	--	--	--	--	--	--	--	--	--	--	--	--	--

NO LONGER MONITORED OR SAMPLED

Cumulative Table of Well Data and Analytical Results

Vertical Measurements are in feet.

Analytical results are in parts per billion (ppb)

DATE	Well	Ground	Depth	Notes	TPH- Gasoline	Benzene	Toluene	Ethyl- Benzene	Xylene	MTBE	TOG	1,2- DCA	VC	MC1,1,1- TCA	1,1- DCA	PCE	Total Lead	Diss. Lead	CDS
	Head Elev.	Water Elev.	To Water																
C-19																			
03/28/86	520.99	--	--	--	--	--	--	--	--	--	--	--	--	--	--	--	--	--	--
03/15/88	520.99	--	--	--	--	--	--	--	--	--	--	--	--	--	--	--	--	--	--
05/10/88	520.99	505.76	15.23	--	18	1400	360	350	1300	--	--	--	--	--	--	--	--	--	--
06/10/88	520.99	504.41	16.58	--	--	--	--	--	--	--	--	--	--	--	--	--	--	--	--
07/25/88	520.99	505.80	15.19	--	--	--	--	--	--	--	--	--	--	--	--	--	--	--	--
10/13/88	520.99	505.72	15.27	--	ND	8.3	4.7	4.4	ND	--	--	--	--	--	--	--	--	--	--
01/01/89	520.99	505.79	15.20	--	--	--	--	--	--	--	--	--	--	--	--	--	--	--	--
01/12/89	520.99	--	--	--	ND	5.0	4.0	ND	ND	--	--	--	--	--	--	--	--	--	--
04/11/89	520.99	505.75	15.24	--	ND	1.8	ND	ND	ND	--	ND	13	--	--	--	--	--	--	--
04/11/89	520.99	505.75	15.24	--	500	1.2	ND	0.6	0.6	--	--	14	--	--	--	--	--	--	--
06/26/89	520.99	505.55	15.44	--	500	2.5	ND	ND	ND	--	ND	26	--	--	--	--	--	--	--
10/13/89	520.99	505.52	15.47	--	540	ND	ND	ND	ND	13	ND	13	--	--	--	--	--	--	13
01/03/90	520.99	505.54	15.45	--	ND	1.2	0.7	1.3	0.9	--	--	11	--	--	--	--	--	--	--
05/07/90	520.99	505.31	15.68	--	ND	ND	ND	ND	ND	--	--	4.6	--	ND	--	ND	--	--	--
09/28/90	520.99	505.47	15.52	--	ND	ND	ND	ND	ND	--	--	ND	--	1.2	ND	ND	--	--	--
01/03/91	520.99	505.43	15.56	--	66	ND	ND	ND	ND	--	--	1.0	--	ND	ND	ND	0.9	--	--
04/12/91	520.99	505.79	15.20	--	--	--	--	--	--	--	--	--	--	--	--	--	--	--	--
09/04/91	520.99	505.39	15.60	--	--	--	--	--	--	--	--	--	--	--	--	--	--	--	--
04/06/92	520.99	506.41	14.58	--	110	0.7	ND	1.0	ND	--	--	1.9	--	ND	ND	ND	ND	--	--
07/28/92	520.99	505.73	15.26	--	ND	1.4	ND	1.0	4.2	--	--	--	--	--	--	--	--	--	--
10/16/92	520.99	504.99	16.00	--	ND	ND	ND	ND	ND	--	--	--	--	--	--	--	--	--	--
01/14/93	520.99	507.30	13.69	--	100	1.1	ND	0.9	0.9	--	--	--	--	--	--	--	--	--	--
03/26/93	520.99	508.03	12.96	--	80	ND	ND	ND	ND	--	--	--	--	--	--	--	--	--	--
04/22/93	520.99	506.81	14.18	--	250	0.6	1.0	1.0	1.0	--	--	--	--	--	--	--	--	--	--
07/20,21/93	520.99	504.41	16.58	--	390	ND	ND	0.8	2.0	--	--	--	--	--	--	--	--	--	--
10/20/93	520.99	505.76	15.23	--	ND	ND	ND	ND	ND	--	--	--	--	--	--	--	--	--	--
01/20/94	520.99	506.15	14.84	--	ND	ND	ND	ND	ND	--	--	--	--	--	--	--	--	--	--
04/21/94	520.99	505.73	15.26	--	60	ND	ND	1.0	ND	--	--	--	--	--	--	--	--	--	--
07/21,22/94	520.99	506.09	14.90	--	ND	ND	ND	ND	ND	--	--	--	--	--	--	--	--	ND	--
01/18/95	520.99	506.97	14.02	--	<50	<0.5	<0.5	<0.5	<0.5	--	--	--	--	--	--	--	--	--	--
04/17/95	520.99	507.19	13.80	Sampled biannually	--	--	--	--	--	--	--	--	--	--	--	--	--	--	--
07/18/95	520.99	507.27	13.72	--	150	<0.5	<0.5	<0.5	<0.5	--	--	--	--	--	--	--	--	--	--
10/17/95	520.99	506.89	14.10	--	--	--	--	--	--	--	--	--	--	--	--	--	--	--	--

CONTINUED ON NEXT PAGE

Cumulative Table of Well Data and Analytical Results

Vertical Measurements are in feet.

Analytical results are in parts per billion (ppb)

DATE	Well	Ground	Depth	Notes	TPH- Gasoline	Benzene	Toluene	Ethyl- Benzene	Xylene	MTBE	TOG	1,2- DCA	VC	MC1,1,1- TCA	1,1- DCA	PCE	Total Lead	Diss. Lead	CDS
	Head Elev.	Water Elev.	To Water																
C-19 (CONT'D)																			
01/18/96	520.99	507.18	13.81	--	76	<0.5	<0.5	<0.5	<0.5	120	--	--	--	--	--	--	--	--	--
04/17/96	520.96	507.56	13.40	--	--	--	--	--	--	--	--	--	--	--	--	--	--	--	--
07/16/96	520.96	507.49	13.47	--	530	<2.5	<2.5	<2.5	<2.5	1200	--	--	--	--	--	--	--	--	--
10/16/96	520.96	507.13	13.83	--	--	--	--	--	--	--	--	--	--	--	--	--	--	--	--
04/10/97	520.96	507.06	13.90	--	<500	<5.0	<5.0	<5.0	<5.0	1600	--	--	--	--	--	--	--	--	--
10/20/97	520.96	506.94	14.02	Sampled annually	--	--	--	--	--	--	--	--	--	--	--	--	--	--	--
04/30/98	520.96	507.49	13.47	--	<500	<5.0	<5.0	<5.0	<5.0	1100	--	--	--	--	--	--	--	--	--
10/07/98	520.96	507.87	13.09	--	--	--	--	--	--	--	--	--	--	--	--	--	--	--	--
04/14/99	520.96	--	--	Inaccessible	--	--	--	--	--	--	--	--	--	--	--	--	--	--	--
04/27/99	520.96	507.17	13.79	--	124	<0.5	<0.5	<0.5	<0.5	434	--	--	--	--	--	--	--	--	--

Cumulative Table of Well Data and Analytical Results

Vertical Measurements are in feet.

Analytical results are in parts per billion (ppb)

DATE	Well	Ground	Depth	Notes	TPH- Gasoline	Benzene	Toluene	Ethyl- Benzene	Xylene	MTBE	TOG	1,2- DCA	VC	MC1,1,1- TCA	1,1- DCA	PCE	Total Lead	Diss. Lead	CDS
	Head Elev.	Water Elev.	To Water																
C-20																			
10/12/95	520.67	507.17	13.50	--	--	--	--	--	--	--	--	--	--	--	--	--	--	--	--
05/16/96	520.67	507.89	12.78	--	<50	<0.5	<0.5	<0.5	<0.5	<2.5	--	--	--	--	--	--	--	--	--
07/16/96	520.67	507.74	12.93	--	<50	2.5	1.5	0.82	2.4	4.1	--	--	--	--	--	--	--	--	--
10/16/96	520.67	507.43	13.24	--	<50	<0.5	<0.5	<0.5	<0.5	<2.5	--	--	--	--	--	--	--	--	--
04/10/97	520.67	507.35	13.32	--	<50	<0.5	<0.5	<0.5	<0.5	<2.5	--	--	--	--	--	--	--	--	--
10/20/97	520.67	507.21	13.46	Sampled annually	--	--	--	--	--	--	--	--	--	--	--	--	--	--	--
04/30/98	520.67	507.82	12.85	--	<50	<0.5	<0.5	<0.5	<0.5	<2.5	--	--	--	--	--	--	--	--	--
10/07/98	520.67	507.99	12.68	--	--	--	--	--	--	--	--	--	--	--	--	--	--	--	--
04/14/99	520.67	507.37	13.30	*	<50	<0.5	<0.5	<0.5	<0.5	<5.0	--	--	--	--	--	--	--	--	--
C-21																			
10/12/95	519.64	507.49	12.15	--	--	--	--	--	--	--	--	--	--	--	--	--	--	--	--
05/16/96	519.64	508.36	11.28	--	<50	<0.5	<0.5	<0.5	<0.5	<2.5	--	--	--	--	--	--	--	--	--
07/16/96	519.64	508.24	11.40	--	<50	0.93	1.1	0.81	2.3	2.5	--	--	--	--	--	--	--	--	--
10/16/96	519.64	508.17	11.47	--	<50	<0.5	<0.5	<0.5	<0.5	<2.5	--	--	--	--	--	--	--	--	--

NO LONGER MONITORED OR SAMPLED

* See Table of Additional Analyses.

Cumulative Table of Well Data and Analytical Results

Vertical Measurements are in feet.

Analytical results are in parts per billion (ppb)

DATE	Well Head Elev.	Ground Water Elev.	Depth To Water	Notes	TPH- Gasoline	Benzene	Toluene	Ethyl- Benzene	Xylene	MTBE	TOG	1,2- DCA	VC	MC1,1,1- TCA	1,1- DCA	PCE	Total Lead	Diss. Lead	CDS
TRIP BLANK																			
01/18/95	--	--	--	--	<50	<0.5	<0.5	<0.5	<0.5	--	--	--	--	--	--	--	--	--	--
04/17/95	--	--	--	--	<50	<0.5	<0.5	<0.5	<0.5	--	--	--	--	--	--	--	--	--	--
07/18/95	--	--	--	--	<50	<0.5	<0.5	<0.5	<0.5	--	--	--	--	--	--	--	--	--	--
10/17/95	--	--	--	--	<50	<0.5	<0.5	<0.5	<0.5	<2.5	--	--	--	--	--	--	--	--	--
01/18/96	--	--	--	--	<50	<0.5	<0.5	<0.5	<0.5	<2.5	--	--	--	--	--	--	--	--	--
04/17/96	--	--	--	--	<50	<0.5	<0.5	<0.5	<0.5	<2.5	--	--	--	--	--	--	--	--	--
07/16/96	--	--	--	--	<50	<0.5	<0.5	<0.5	<0.5	<2.5	--	--	--	--	--	--	--	--	--
10/16/96	--	--	--	--	<50	<0.5	<0.5	<0.5	<0.5	<2.5	--	--	--	--	--	--	--	--	--
04/10/97	--	--	--	--	<50	<0.5	<0.5	<0.5	<0.5	<2.5	--	--	--	--	--	--	--	--	--
10/20/97	--	--	--	--	<50	<0.5	<0.5	<0.5	<0.5	<2.5	--	--	--	--	--	--	--	--	--
04/30/98	--	--	--	--	<50	<0.5	<0.5	<0.5	<0.5	<2.5	--	--	--	--	--	--	--	--	--
10/07/98	--	--	--	--	<50	<0.5	<0.5	<0.5	<0.5	<2.5	--	--	--	--	--	--	--	--	--
01/08/99	--	--	--	--	<50	<0.5	<0.5	<0.5	<0.5	<2.5	--	--	--	--	--	--	--	--	--
04/14/99	--	--	--	--	<50	<0.5	<0.5	<0.5	<0.5	<5.0	--	--	--	--	--	--	--	--	--
04/27/99	--	--	--	--	<50	<0.5	<0.5	<0.5	<0.5	<5.0	--	--	--	--	--	--	--	--	--

Cumulative Table of Well Data and Analytical Results

ADDITIONAL ANALYSES

Analytical values are in parts per billion (ppb)

DATE	Notes	Ethanol	t- Butanol	MTBE	DIPE	ETBE	TAME
C-2							
04/14/99	--	<3000	<200	5.35	<2.0	<2.0	<2.0
C-5							
04/14/99	--	<9990	<666	619	<6.66	<6.66	27.3
C-6							
04/14/99	--	<3000	<200	138	<2.0	<2.0	10.7
C-9							
04/14/99	--	<3750	<250	114	<2.5	<2.5	<2.5
C-11							
04/14/99	--	<30,000	<2000	1390	<20	<20	<20

Cumulative Table of Well Data and Analytical Results

ADDITIONAL ANALYSES

Analytical values are in parts per billion (ppb)

DATE	Notes	Ethanol	t- Butanol	MTBE	DIPE	ETBE	TAME
C-17							
04/14/99	--	<3000	<200	83.1	<2.0	<2.0	<2.0
C-20							
04/14/99	--	<3000	<200	<2.0	<2.0	<2.0	<2.0

Note: Blaine Tech Services, Inc. began routine monitoring of the groundwater wells at this site on November 1, 1994. Earlier field data and analytical results are drawn from the August 15, 1994 Groundwater Technology, Inc. report. The October 12, 1995 and the resurvey information was provided by Groundwater Technology, Inc.

ABBREVIATIONS:

TPH = Total Petroleum Hydrocarbons
 MTBE = Methyl t-Butyl Ether
 TOG = Total Oil & Grease
 PCE = Tetrachloroethene
 1,2-DCA = 1,2-Dichloroethane
 VC = Vinyl chloride
 MC = Methylene Chloride
 TCA = 1,1,1-Trichloroethane
 1,1-DCA = 1,1-Dichloroethane
 Diss. Lead = Dissolved Lead
 CDS = Carbon Disulfide
 ND = Not detected at or above the minimum quantitation limit. See laboratory reports for minimum quantitation limits.
 DIPE = Di-Isopropyl Ether
 ETBE = Ethyl t-Butyl Ether
 TAME = t-Amyl Methyl Ether

Analytical Appendix



Sequoia Analytical

680 Chesapeake Drive
404 N. Wiget Lane
819 Striker Avenue, Suite 8
1455 McDowell Blvd. North, Ste. D
1551 Industrial Road

Redwood City, CA 94063
Walnut Creek, CA 94598
Sacramento, CA 95834
Petaluma, CA 94954
San Carlos, CA 94070-4111

(650) 364-9600
(925) 988-9600
(916) 921-9600
(707) 792-1865
(650) 232-9600

FAX (650) 364-9233
FAX (925) 988-9673
FAX (916) 921-0100
FAX (707) 792-0342
FAX (650) 232-9612

April 29, 1999

Christine Lillie
Blaine Tech Services
1680 Rogers Avenue
San Jose, CA 95112

RE: Chevron(5)/L904183

Dear Christine Lillie:

Enclosed are the results of analyses for sample(s) received by the laboratory on April 15, 1999. If you have any questions concerning this report, please feel free to contact me.

Sincerely,

for Mike Gregory
Project Manager D.M.





Sequoia Analytical

680 Chesapeake Drive
404 N. Wiget Lane
819 Striker Avenue, Suite 8
1455 McDowell Blvd. North, Ste. D
1551 Industrial Road

Redwood City, CA 94063
Walnut Creek, CA 94598
Sacramento, CA 95834
Petaluma, CA 94954
San Carlos, CA 94070-4111

(650) 364-9600
(925) 988-9600
(916) 921-9600
(707) 792-1865
(650) 232-9600

FAX (650) 364-9233
FAX (925) 988-9673
FAX (916) 921-0100
FAX (707) 792-0342
FAX (650) 232-9612

Blaine Tech Services 1680 Rogers Avenue San Jose, CA 95112	Project: Chevron(5) Project Number: Chevron 9-1924, 990414-C1 Project Manager: Christine Lillie	Sampled: 4/14/99 Received: 4/15/99 Reported: 4/29/99
------------------------------------------------------------------	-------------------------------------------------------------------------------------------------------	------------------------------------------------------------

ANALYTICAL REPORT FOR L904183

Sample Description	Laboratory Sample Number	Sample Matrix	Date Sampled
C-2	L904183-01	Water	4/14/99
C-5	L904183-02	Water	4/14/99
C-6	L904183-03	Water	4/14/99
C-9	L904183-04	Water	4/14/99
C-11	L904183-05	Water	4/14/99
C-17	L904183-06	Water	4/14/99
C-20	L904183-07	Water	4/14/99
TB	L904183-08	Water	4/14/99





Sequoia Analytical

680 Chesapeake Drive
404 N. Wiget Lane
819 Striker Avenue, Suite 8
1455 McDowell Blvd. North, Ste. D
1551 Industrial Road

Redwood City, CA 94063
Walnut Creek, CA 94598
Sacramento, CA 95834
Petaluma, CA 94954
San Carlos, CA 94070-4111

(650) 364-9600
(925) 988-9600
(916) 921-9600
(707) 792-1865
(650) 232-9600

FAX (650) 364-9233
FAX (925) 988-9673
FAX (916) 921-0100
FAX (707) 792-0342
FAX (650) 232-9612

Blaine Tech Services 1680 Rogers Avenue San Jose, CA 95112	Project: Chevron(5) Project Number: Chevron 9-1924, 990414-C1 Project Manager: Christine Lillie	Sampled: 4/14/99 Received: 4/15/99 Reported: 4/29/99
------------------------------------------------------------------	-------------------------------------------------------------------------------------------------------	------------------------------------------------------------

Sample Description: C-2
Laboratory Sample Number: L904183-01

Analyte	Batch Number	Date Prepared	Date Analyzed	Specific Method/ Surrogate Limits	Reporting Limit	Result	Units	Notes*
---------	--------------	---------------	---------------	--------------------------------------	-----------------	--------	-------	--------

Sequoia Analytical - San Carlos

Total Purgeable Hydrocarbons (C6-C12), BTEX and MTBE by DHS LUFT

Purgeable Hydrocarbons as Gasoline	9040098	4/20/99	4/20/99		50.0	201	ug/l	2
Benzene	"	"	"		0.500	1.96	"	
Toluene	"	"	"		0.500	ND	"	
Ethylbenzene	"	"	"		0.500	0.570	"	
Xylenes (total)	"	"	"		0.500	ND	"	
Methyl tert-butyl ether	"	"	"		5.00	11.2	"	
Surrogate: a,a,a-Trifluorotoluene	"	"	"	70.0-130		110	%	

Volatile Organic Oxygenated Compounds by EPA Method 8260A

Ethanol	9040107	4/22/99	4/22/99		3000	ND	ug/l	
Tert-butyl alcohol	"	"	"		200	ND	"	
Methyl tert-butyl ether	"	"	"		2.00	5.35	"	
Di-isopropyl ether	"	"	"		2.00	ND	"	
Ethyl tert-butyl ether	"	"	"		2.00	ND	"	
Tert-amyl methyl ether	"	"	"		2.00	ND	"	
Surrogate: 1,2-Dichloroethane-d4	"	"	"	76.0-114		101	%	





Sequoia Analytical

680 Chesapeake Drive
404 N. Wiget Lane
819 Striker Avenue, Suite 8
1455 McDowell Blvd. North, Ste. D
1551 Industrial Road

Redwood City, CA 94063
Walnut Creek, CA 94598
Sacramento, CA 95834
Petaluma, CA 94954
San Carlos, CA 94070-4111

(650) 364-9600
(925) 988-9600
(916) 921-9600
(707) 792-1865
(650) 232-9600

FAX (650) 364-9233
FAX (925) 988-9673
FAX (916) 921-0100
FAX (707) 792-0342
FAX (650) 232-9612

Blaine Tech Services 1680 Rogers Avenue San Jose, CA 95112	Project: Chevron(5) Project Number: Chevron 9-1924, 990414-C1 Project Manager: Christine Lillie	Sampled: 4/14/99 Received: 4/15/99 Reported: 4/29/99
------------------------------------------------------------------	-------------------------------------------------------------------------------------------------------	------------------------------------------------------------

Sample Description: C-5
Laboratory Sample Number: L904183-02

Analyte	Batch Number	Date Prepared	Date Analyzed	Specific Method/ Surrogate Limits	Reporting Limit	Result	Units	Notes*
---------	--------------	---------------	---------------	--------------------------------------	-----------------	--------	-------	--------

Sequoia Analytical - San Carlos

Total Purgeable Hydrocarbons (C6-C12), BTEX and MTBE by DHS LUFT

Purgeable Hydrocarbons as Gasoline	9040098	4/20/99	4/20/99		50.0	227	ug/l	2
Benzene	"	"	"		0.500	10.9	"	
Toluene	"	"	"		0.500	0.511	"	
Ethylbenzene	"	"	"		0.500	1.17	"	
Xylenes (total)	"	"	"		0.500	1.06	"	
Methyl tert-butyl ether	9040105	4/21/99	4/21/99		50	468	"	
<i>Surrogate: a,a,a-Trifluorotoluene</i>	9040098	4/20/99	4/20/99	70.0-130		103	%	

Volatile Organic Oxygenated Compounds by EPA Method 8260A

Ethanol	9040107	4/22/99	4/22/99		9990	ND	ug/l	
Tert-butyl alcohol	"	"	"		666	ND	"	
Methyl tert-butyl ether	"	"	"		6.66	619	"	
Di-isopropyl ether	"	"	"		6.66	ND	"	
Ethyl tert-butyl ether	"	"	"		6.66	ND	"	
Tert-amyl methyl ether	"	"	"		6.66	27.3	"	
<i>Surrogate: 1,2-Dichloroethane-d4</i>	"	"	"	76.0-114		110	%	





Sequoia Analytical

680 Chesapeake Drive
404 N. Wiget Lane
819 Striker Avenue, Suite 8
1455 McDowell Blvd. North, Ste. D
1551 Industrial Road

Redwood City, CA 94063
Walnut Creek, CA 94598
Sacramento, CA 95834
Petaluma, CA 94954
San Carlos, CA 94070-4111

(650) 364-9600
(925) 988-9600
(916) 921-9600
(707) 792-1865
(650) 232-9600

FAX (650) 364-9233
FAX (925) 988-9673
FAX (916) 921-0100
FAX (707) 792-0342
FAX (650) 232-9612

Blaine Tech Services 1680 Rogers Avenue San Jose, CA 95112	Project: Chevron(5) Project Number: Chevron 9-1924, 990414-C1 Project Manager: Christine Lillie	Sampled: 4/14/99 Received: 4/15/99 Reported: 4/29/99
------------------------------------------------------------------	-------------------------------------------------------------------------------------------------------	------------------------------------------------------------

Sample Description: C-6
Laboratory Sample Number: L904183-03

Analyte	Batch Number	Date Prepared	Date Analyzed	Specific Method/ Surrogate Limits	Reporting Limit	Result	Units	Notes*
---------	--------------	---------------	---------------	--------------------------------------	-----------------	--------	-------	--------

Sequoia Analytical - San Carlos

Total Purgeable Hydrocarbons (C6-C12), BTEX and MTBE by DHS LUFT

Purgeable Hydrocarbons as Gasoline	9040105	4/21/99	4/21/99		200	2180	ug/l	2
Benzene	"	"	"		2.00	13.6	"	
Toluene	"	"	"		2.00	ND	"	
Ethylbenzene	"	"	"		2.00	5.52	"	
Xylenes (total)	"	"	"		2.00	4.12	"	
Methyl tert-butyl ether	"	"	"		20.0	116	"	
<i>Surrogate: a,a-Trifluorotoluene</i>	"	"	"	70.0-130		90.5	%	

Volatile Organic Oxygenated Compounds by EPA Method 8260A

Ethanol	9040107	4/23/99	4/22/99		3000	ND	ug/l	
Tert-butyl alcohol	"	"	"		200	ND	"	
Methyl tert-butyl ether	"	"	"		2.00	138	"	
Di-isopropyl ether	"	"	"		2.00	ND	"	
Ethyl tert-butyl ether	"	"	"		2.00	ND	"	
Tert-amyl methyl ether	"	"	"		2.00	10.7	"	
<i>Surrogate: 1,2-Dichloroethane-d4</i>	"	"	"	76.0-114		99.4	%	





Sequoia Analytical

680 Chesapeake Drive
404 N. Wiget Lane
819 Striker Avenue, Suite 8
1455 McDowell Blvd. North, Ste. D
1551 Industrial Road

Redwood City, CA 94063
Walnut Creek, CA 94598
Sacramento, CA 95834
Petaluma, CA 94954
San Carlos, CA 94070-4111

(650) 364-9600
(925) 988-9600
(916) 921-9600
(707) 792-1865
(650) 232-9600

FAX (650) 364-9233
FAX (925) 988-9673
FAX (916) 921-0100
FAX (707) 792-0342
FAX (650) 232-9612

Blaine Tech Services 1680 Rogers Avenue San Jose, CA 95112	Project: Chevron(5) Project Number: Chevron 9-1924, 990414-C1 Project Manager: Christine Lillie	Sampled: 4/14/99 Received: 4/15/99 Reported: 4/29/99
------------------------------------------------------------------	-------------------------------------------------------------------------------------------------------	------------------------------------------------------------

Sample Description: C-9
Laboratory Sample Number: L904183-04

Analyte	Batch Number	Date Prepared	Date Analyzed	Specific Method/ Surrogate Limits	Reporting Limit	Result	Units	Notes*
---------	--------------	---------------	---------------	--------------------------------------	-----------------	--------	-------	--------

Sequoia Analytical - San Carlos

Total Purgeable Hydrocarbons (C6-C12), BTEX and MTBE by DHS LUFT

Purgeable Hydrocarbons as Gasoline	9040098	4/20/99	4/20/99		50.0	534	ug/l	2
Benzene	"	"	"		0.500	3.28	"	
Toluene	"	"	"		0.500	ND	"	
Ethylbenzene	"	"	"		0.500	3.00	"	
Xylenes (total)	"	"	"		0.500	ND	"	
Methyl tert-butyl ether	"	"	"		5.00	94.4	"	
Surrogate: a,a,a-Trifluorotoluene	"	"	"	70.0-130		152	%	

Volatile Organic Compounds by EPA Method 8010B

Bromodichloromethane	9040110	4/26/99	4/26/99		0.500	ND	ug/l	3
Bromoform	"	"	"		0.500	ND	"	
Bromomethane	"	"	"		1.00	ND	"	
Carbon tetrachloride	"	"	"		0.500	ND	"	
Chlorobenzene	"	"	"		0.500	ND	"	
Chloroethane	"	"	"		1.00	ND	"	
2-Chloroethylvinyl ether	"	"	"		1.00	ND	"	
Chloroform	"	"	"		0.500	ND	"	
Chloromethane	"	"	"		1.00	ND	"	
Dibromochloromethane	"	"	"		0.500	ND	"	
1,3-Dichlorobenzene	"	"	"		0.500	ND	"	
1,4-Dichlorobenzene	"	"	"		0.500	ND	"	
1,2-Dichlorobenzene	"	"	"		0.500	ND	"	
1,1-Dichloroethane	"	"	"		0.500	ND	"	
1,2-Dichloroethane	"	"	"		0.500	ND	"	
1,1-Dichloroethene	"	"	"		0.500	ND	"	
cis-1,2-Dichloroethene	"	"	"		0.500	ND	"	
trans-1,2-Dichloroethene	"	"	"		0.500	ND	"	
1,2-Dichloropropane	"	"	"		0.500	ND	"	
cis-1,3-Dichloropropene	"	"	"		0.500	ND	"	
trans-1,3-Dichloropropene	"	"	"		0.500	ND	"	
Methylene chloride	"	"	"		5.00	ND	"	
1,1,1,2-Tetrachloroethane	"	"	"		0.500	ND	"	
Tetrachloroethene	"	"	"		0.500	ND	"	
1,1,1-Trichloroethane	"	"	"		0.500	ND	"	
1,1,2-Trichloroethane	"	"	"		0.500	ND	"	
Trichloroethene	"	"	"		0.500	ND	"	
Trichlorofluoromethane	"	"	"		0.500	ND	"	
Vinyl chloride	"	"	"		1.00	ND	"	
Surrogate: 4-BFB	"	"	"	70.0-130		73.8	%	





Sequoia Analytical

680 Chesapeake Drive
404 N. Wiget Lane
819 Striker Avenue, Suite 8
1455 McDowell Blvd. North, Ste. D
1551 Industrial Road

Redwood City, CA 94063 (650) 364-9600
Walnut Creek, CA 94598 (925) 988-9600
Sacramento, CA 95834 (916) 921-9600
Petaluma, CA 94954 (707) 792-1865
San Carlos, CA 94070-4111 (650) 232-9600

FAX (650) 364-9233
FAX (925) 988-9673
FAX (916) 921-0100
FAX (707) 792-0342
FAX (650) 232-9612

Blaine Tech Services 1680 Rogers Avenue San Jose, CA 95112	Project: Chevron(5) Project Number: Chevron 9-1924, 990414-C1 Project Manager: Christine Lillie	Sampled: 4/14/99 Received: 4/15/99 Reported: 4/29/99
------------------------------------------------------------------	-------------------------------------------------------------------------------------------------------	------------------------------------------------------------

Sample Description: C-9
Laboratory Sample Number: L904183-04

Analyte	Batch Number	Date Prepared	Date Analyzed	Specific Method/ Surrogate Limits	Reporting Limit	Result	Units	Notes*
Volatile Organic Oxygenated Compounds by EPA Method 8260A								
Ethanol	9040107	4/22/99	4/22/99		3750	ND	ug/l	
Tert-butyl alcohol	"	"	"		250	ND	"	
Methyl tert-butyl ether	"	"	"		2.50	114	"	
Di-isopropyl ether	"	"	"		2.50	ND	"	
Ethyl tert-butyl ether	"	"	"		2.50	ND	"	
Tert-amyl methyl ether	"	"	"		2.50	ND	"	
<i>Surrogate: 1,2-Dichloroethane-d4</i>	"	"	"	76.0-114		101	%	





Sequoia Analytical

680 Chesapeake Drive
404 N. Wiget Lane
819 Striker Avenue, Suite 8
1455 McDowell Blvd. North, Ste. D
1551 Industrial Road

Redwood City, CA 94063
Walnut Creek, CA 94598
Sacramento, CA 95834
Petaluma, CA 94954
San Carlos, CA 94070-4111

(650) 364-9600
(925) 988-9600
(916) 921-9600
(707) 792-1865
(650) 232-9600

FAX (650) 364-9233
FAX (925) 988-9673
FAX (916) 921-0100
FAX (707) 792-0342
FAX (650) 232-9612

Blaine Tech Services 1680 Rogers Avenue San Jose, CA 95112	Project: Chevron(5) Project Number: Chevron 9-1924, 990414-C1 Project Manager: Christine Lillie	Sampled: 4/14/99 Received: 4/15/99 Reported: 4/29/99
------------------------------------------------------------------	-------------------------------------------------------------------------------------------------------	------------------------------------------------------------

Sample Description: C-11
Laboratory Sample Number: L904183-05

Analyte	Batch Number	Date Prepared	Date Analyzed	Specific Method/ Surrogate Limits	Reporting Limit	Result	Units	Notes*
---------	--------------	---------------	---------------	--------------------------------------	-----------------	--------	-------	--------

Sequoia Analytical - San Carlos

Total Purgeable Hydrocarbons (C6-C12), BTEX and MTBE by DHS LUFT

Purgeable Hydrocarbons as Gasoline	9040098	4/20/99	4/20/99		50.0	99.6	ug/l	2
Benzene	"	"	"		0.500	2.13	"	
Toluene	"	"	"		0.500	ND	"	
Ethylbenzene	"	"	"		0.500	1.08	"	
Xylenes (total)	"	"	"		0.500	ND	"	
Methyl tert-butyl ether	9040104	4/21/99	4/21/99		50	853	"	
Surrogate: a,a,a-Trifluorotoluene	9040098	4/20/99	4/20/99	70.0-130		101	%	

Volatile Organic Oxygenated Compounds by EPA Method 8260A

Ethanol	9040107	4/22/99	4/22/99		30000	ND	ug/l	
Tert-butyl alcohol	"	"	"		2000	ND	"	
Methyl tert-butyl ether	"	"	"		20.0	1390	"	
Di-isopropyl ether	"	"	"		20.0	ND	"	
Ethyl tert-butyl ether	"	"	"		20.0	ND	"	
Tert-amyl methyl ether	"	"	"		20.0	ND	"	
Surrogate: 1,2-Dichloroethane-d4	"	"	"	76.0-114		103	%	





Sequoia Analytical

680 Chesapeake Drive
404 N. Wiget Lane
819 Striker Avenue, Suite 8
1455 McDowell Blvd. North, Ste. D
1551 Industrial Road

Redwood City, CA 94063 (650) 364-9600
Walnut Creek, CA 94598 (925) 988-9600
Sacramento, CA 95834 (916) 921-9600
Petaluma, CA 94954 (707) 792-1865
San Carlos, CA 94070-4111 (650) 232-9600

FAX (650) 364-9233
FAX (925) 988-9673
FAX (916) 921-0100
FAX (707) 792-0342
FAX (650) 232-9612

Blaine Tech Services 1680 Rogers Avenue San Jose, CA 95112	Project: Chevron(5) Project Number: Chevron 9-1924, 990414-C1 Project Manager: Christine Lillie	Sampled: 4/14/99 Received: 4/15/99 Reported: 4/29/99
------------------------------------------------------------------	-------------------------------------------------------------------------------------------------------	------------------------------------------------------------

Sample Description: C-17
Laboratory Sample Number: L904183-06

Analyte	Batch Number	Date Prepared	Date Analyzed	Specific Method/ Surrogate Limits	Reporting Limit	Result	Units	Notes*
---------	--------------	---------------	---------------	--------------------------------------	-----------------	--------	-------	--------

Sequoia Analytical - San Carlos

Total Purgeable Hydrocarbons (C6-C12), BTEX and MTBE by DHS LUFT

Purgeable Hydrocarbons as Gasoline	9040105	4/21/99	4/21/99		50.0	ND	ug/l	
Benzene	"	"	"		0.500	ND	"	
Toluene	"	"	"		0.500	0.549	"	
Ethylbenzene	"	"	"		0.500	ND	"	
Xylenes (total)	"	"	"		0.500	ND	"	
Methyl tert-butyl ether	"	"	"		5.00	82.0	"	
<i>Surrogate: a,a,a-Trifluorotoluene</i>	"	"	"	70.0-130		84.8	%	

Volatile Organic Oxygenated Compounds by EPA Method 8260A

Ethanol	9040114	4/23/99	4/23/99		3000	ND	ug/l	
Tert-butyl alcohol	"	"	"		200	ND	"	
Methyl tert-butyl ether	"	"	"		2.00	83.1	"	
Di-isopropyl ether	"	"	"		2.00	ND	"	
Ethyl tert-butyl ether	"	"	"		2.00	ND	"	
Tert-amyl methyl ether	"	"	"		2.00	ND	"	
<i>Surrogate: 1,2-Dichloroethane-d4</i>	"	"	"	76.0-114		97.0	%	





Sequoia Analytical

680 Chesapeake Drive
404 N. Wiget Lane
819 Striker Avenue, Suite 8
1455 McDowell Blvd. North, Ste. D
1551 Industrial Road

Redwood City, CA 94063
Walnut Creek, CA 94598
Sacramento, CA 95834
Petaluma, CA 94954
San Carlos, CA 94070-4111

(650) 364-9600
(925) 988-9600
(916) 921-9600
(707) 792-1865
(650) 232-9600

FAX (650) 364-9233
FAX (925) 988-9673
FAX (916) 921-0100
FAX (707) 792-0342
FAX (650) 232-9612

Blaine Tech Services 1680 Rogers Avenue San Jose, CA 95112	Project: Chevron(5) Project Number: Chevron 9-1924, 990414-C1 Project Manager: Christine Lillie	Sampled: 4/14/99 Received: 4/15/99 Reported: 4/29/99
------------------------------------------------------------------	-------------------------------------------------------------------------------------------------------	------------------------------------------------------------

Sample Description: C-20
Laboratory Sample Number: L904183-07

Analyte	Batch Number	Date Prepared	Date Analyzed	Specific Method/ Surrogate Limits	Reporting Limit	Result	Units	Notes*
---------	--------------	---------------	---------------	--------------------------------------	-----------------	--------	-------	--------

Sequoia Analytical - San Carlos

Total Purgeable Hydrocarbons (C6-C12), BTEX and MTBE by DHS LUFT

Purgeable Hydrocarbons as Gasoline	9040104	4/21/99	4/21/99		50.0	ND	ug/l	
Benzene	"	"	"		0.500	ND	"	
Toluene	"	"	"		0.500	ND	"	
Ethylbenzene	"	"	"		0.500	ND	"	
Xylenes (total)	"	"	"		0.500	ND	"	
Methyl tert-butyl ether	"	"	"		5.00	ND	"	
Surrogate: a,a,a-Trifluorotoluene	"	"	"	70.0-130		98.1	%	

Volatile Organic Oxygenated Compounds by EPA Method 8260A

Ethanol	9040107	4/22/99	4/22/99		3000	ND	ug/l	
Tert-butyl alcohol	"	"	"		200	ND	"	
Methyl tert-butyl ether	"	"	"		2.00	ND	"	
Di-isopropyl ether	"	"	"		2.00	ND	"	
Ethyl tert-butyl ether	"	"	"		2.00	ND	"	
Tert-amyl methyl ether	"	"	"		2.00	ND	"	
Surrogate: 1,2-Dichloroethane-d4	"	"	"	76.0-114		100	%	





Sequoia Analytical

680 Chesapeake Drive
404 N. Wiget Lane
819 Striker Avenue, Suite 8
1455 McDowell Blvd. North, Ste. D
1551 Industrial Road

Redwood City, CA 94063
Walnut Creek, CA 94598
Sacramento, CA 95834
Petaluma, CA 94954
San Carlos, CA 94070-4111

(650) 364-9600
(925) 988-9600
(916) 921-9600
(707) 792-1865
(650) 232-9600

FAX (650) 364-9233
FAX (925) 988-9673
FAX (916) 921-0100
FAX (707) 792-0342
FAX (650) 232-9612

Blaine Tech Services 1680 Rogers Avenue San Jose, CA 95112	Project: Chevron(5) Project Number: Chevron 9-1924, 990414-C1 Project Manager: Christine Lillie	Sampled: 4/14/99 Received: 4/15/99 Reported: 4/29/99
------------------------------------------------------------------	-------------------------------------------------------------------------------------------------------	------------------------------------------------------------

Sample Description: TB
Laboratory Sample Number: L904183-08

Analyte	Batch Number	Date Prepared	Date Analyzed	Specific Method/ Surrogate Limits	Reporting Limit	Result	Units	Notes*
---------	--------------	---------------	---------------	--------------------------------------	-----------------	--------	-------	--------

Sequoia Analytical - San Carlos

Total Purgeable Hydrocarbons (C6-C12), BTEX and MTBE by DHS LUFT

Purgeable Hydrocarbons as Gasoline	9040104	4/21/99	4/21/99		50.0	ND	ug/l	
Benzene	"	"	"		0.500	ND	"	
Toluene	"	"	"		0.500	ND	"	
Ethylbenzene	"	"	"		0.500	ND	"	
Xylenes (total)	"	"	"		0.500	ND	"	
Methyl tert-butyl ether	"	"	"		5.00	ND	"	
Surrogate: <i>a,a,a</i> -Trifluorotoluene	"	"	"	70.0-130		109	%	





Sequoia Analytical

680 Chesapeake Drive
404 N. Wiget Lane
819 Striker Avenue, Suite 8
1455 McDowell Blvd. North, Ste. D
1551 Industrial Road

Redwood City, CA 94063
Walnut Creek, CA 94598
Sacramento, CA 95834
Petaluma, CA 94954
San Carlos, CA 94070-4111

(650) 364-9600
(925) 988-9600
(916) 921-9600
(707) 792-1865
(650) 232-9600

FAX (650) 364-9233
FAX (925) 988-9673
FAX (916) 921-0100
FAX (707) 792-0342
FAX (650) 232-9612

Blaine Tech Services 1680 Rogers Avenue San Jose, CA 95112	Project: Chevron(5) Project Number: Chevron 9-1924, 990414-C1 Project Manager: Christine Lillie	Sampled: 4/14/99 Received: 4/15/99 Reported: 4/29/99
------------------------------------------------------------------	-------------------------------------------------------------------------------------------------------	------------------------------------------------------------

Total Purgeable Hydrocarbons (C6-C12), BTEX and MTBE by DHS LUFT/Quality Control Sequoia Analytical - San Carlos

Analyte	Date Analyzed	Spike Level	Sample Result	QC Result	Units	Reporting Limit Recov. Limits	Recov. %	RPD Limit	RPD %	Notes*
Batch: 9040098		Date Prepared: 4/20/99		Extraction Method: EPA 5030B [P/T]						
Blank		9040098-BLK1								
Purgeable Hydrocarbons as Gasoline	4/20/99			ND	ug/l	50.0				
Benzene	"			ND	"	0.500				
Toluene	"			ND	"	0.500				
Ethylbenzene	"			ND	"	0.500				
Xylenes (total)	"			ND	"	0.500				
Methyl tert-butyl ether	"			ND	"	5.00				
Surrogate: a,a,a-Trifluorotoluene	"	10.0		10.4	"	70.0-130	104			
LCS		9040098-BS1								
Benzene	4/20/99	10.0		9.53	ug/l	70.0-130	95.3			
Toluene	"	10.0		9.64	"	70.0-130	96.4			
Ethylbenzene	"	10.0		9.67	"	70.0-130	96.7			
Xylenes (total)	"	30.0		28.9	"	70.0-130	96.3			
Surrogate: a,a,a-Trifluorotoluene	"	10.0		9.93	"	70.0-130	99.3			
Matrix Spike		9040098-MS1 L904188-04								
Benzene	4/20/99	10.0	ND	9.93	ug/l	60.0-140	99.3			
Toluene	"	10.0	ND	9.88	"	60.0-140	98.8			
Ethylbenzene	"	10.0	ND	9.95	"	60.0-140	99.5			
Xylenes (total)	"	30.0	ND	29.7	"	60.0-140	99.0			
Surrogate: a,a,a-Trifluorotoluene	"	10.0		9.60	"	70.0-130	96.0			
Matrix Spike Dup		9040098-MSD1 L904188-04								
Benzene	4/20/99	10.0	ND	9.40	ug/l	60.0-140	94.0	25.0	5.48	
Toluene	"	10.0	ND	9.45	"	60.0-140	94.5	25.0	4.45	
Ethylbenzene	"	10.0	ND	9.47	"	60.0-140	94.7	25.0	4.94	
Xylenes (total)	"	30.0	ND	28.3	"	60.0-140	94.3	25.0	4.86	
Surrogate: a,a,a-Trifluorotoluene	"	10.0		9.13	"	70.0-130	91.3			
Batch: 9040104		Date Prepared: 4/21/99		Extraction Method: EPA 5030B [P/T]						
Blank		9040104-BLK1								
Purgeable Hydrocarbons as Gasoline	4/21/99			ND	ug/l	50.0				
Benzene	"			ND	"	0.500				
Toluene	"			ND	"	0.500				
Ethylbenzene	"			ND	"	0.500				
Xylenes (total)	"			ND	"	0.500				
Methyl tert-butyl ether	"			ND	"	5.00				
Surrogate: a,a,a-Trifluorotoluene	"	10.0		9.93	"	70.0-130	99.3			





Blaine Tech Services 1680 Rogers Avenue San Jose, CA 95112	Project: Chevron(5) Project Number: Chevron 9-1924, 990414-C1 Project Manager: Christine Lillie	Sampled: 4/14/99 Received: 4/15/99 Reported: 4/29/99
------------------------------------------------------------------	-------------------------------------------------------------------------------------------------------	------------------------------------------------------------

Total Purgeable Hydrocarbons (C6-C12), BTEX and MTBE by DHS LUFT/Quality Control
Sequoia Analytical - San Carlos

Analyte	Date Analyzed	Spike Level	Sample Result	QC Result	Units	Reporting Limit Recov. Limits	Recov. %	RPD Limit	RPD %	Notes*
LCS										
9040104-BS1										
Purgeable Hydrocarbons as Gasoline	4/21/99	250		221	ug/l	70.0-130	88.4			
Surrogate: a,a,a-Trifluorotoluene	"	10.0		16.6	"	70.0-130	166			1
Matrix Spike										
9040104-MS1										
Purgeable Hydrocarbons as Gasoline	4/21/99	250		200	ug/l	60.0-140	80.0			
Surrogate: a,a,a-Trifluorotoluene	"	10.0		65.6	"	70.0-130	NR			1
Matrix Spike Dup										
9040104-MSD1										
Purgeable Hydrocarbons as Gasoline	4/21/99	250		200	ug/l	60.0-140	80.0	25.0	0	
Surrogate: a,a,a-Trifluorotoluene	"	10.0		ND	"	70.0-130	NR			1
Batch: 9040105										
Blank										
Date Prepared: 4/21/99										
Extraction Method: EPA 5030B [P/T]										
9040105-BLK1										
Purgeable Hydrocarbons as Gasoline	4/21/99			ND	ug/l	50.0				
Benzene	"			ND	"	0.500				
Toluene	"			ND	"	0.500				
Ethylbenzene	"			ND	"	0.500				
Xylenes (total)	"			ND	"	0.500				
Methyl tert-butyl ether	"			ND	"	5.00				
Surrogate: a,a,a-Trifluorotoluene	"	10.0		9.18	"	70.0-130	91.8			
LCS										
9040105-BS1										
Purgeable Hydrocarbons as Gasoline	4/21/99	250		234	ug/l	70.0-130	93.6			
Surrogate: a,a,a-Trifluorotoluene	"	10.0		8.90	"	70.0-130	89.0			
Matrix Spike										
9040105-MS1 L904240-01										
Purgeable Hydrocarbons as Gasoline	4/21/99	250	ND	252	ug/l	60.0-140	101			
Surrogate: a,a,a-Trifluorotoluene	"	10.0		9.23	"	70.0-130	92.3			
Matrix Spike Dup										
9040105-MSD1 L904240-01										
Purgeable Hydrocarbons as Gasoline	4/21/99	250	ND	245	ug/l	60.0-140	98.0	25.0	3.02	
Surrogate: a,a,a-Trifluorotoluene	"	10.0		8.62	"	70.0-130	86.2			





Sequoia Analytical

680 Chesapeake Drive
404 N. Wiget Lane
819 Striker Avenue, Suite 8
1455 McDowell Blvd. North, Ste. D
1551 Industrial Road

Redwood City, CA 94063
Walnut Creek, CA 94598
Sacramento, CA 95834
Petaluma, CA 94954
San Carlos, CA 94070-4111

(650) 364-9600
(925) 988-9600
(916) 921-9600
(707) 792-1865
(650) 232-9600
FAX (650) 364-9233
FAX (925) 988-9673
FAX (916) 921-0100
FAX (707) 792-0342
FAX (650) 232-9612

Blaine Tech Services 1680 Rogers Avenue San Jose, CA 95112	Project: Chevron(5) Project Number: Chevron 9-1924, 990414-C1 Project Manager: Christine Lillie	Sampled: 4/14/99 Received: 4/15/99 Reported: 4/29/99
------------------------------------------------------------------	-------------------------------------------------------------------------------------------------------	------------------------------------------------------------

Volatile Organic Compounds by EPA Method 8010B/Quality Control Sequoia Analytical - San Carlos

Analyte	Date Analyzed	Spike Level	Sample Result	QC Result	Units	Reporting Limit Recov. Limits	Recov. %	RPD Limit	RPD %	Notes*
---------	---------------	-------------	---------------	-----------	-------	----------------------------------	----------	-----------	-------	--------

Batch: 9040110

Date Prepared: 4/22/99

Extraction Method: EPA 5030B [P/T]

Blank

9040110-BLK1

Freon 113	4/22/99			ND	ug/l	0.500				
Bromodichloromethane	"			ND	"	0.500				
Bromoform	"			ND	"	0.500				
Bromomethane	"			ND	"	1.00				
Carbon tetrachloride	"			ND	"	0.500				
Chlorobenzene	"			ND	"	0.500				
Chloroethane	"			ND	"	1.00				
2-Chloroethylvinyl ether	"			ND	"	1.00				
Chloroform	"			ND	"	0.500				
Chloromethane	"			ND	"	1.00				
Dibromochloromethane	"			ND	"	0.500				
1,3-Dichlorobenzene	"			ND	"	0.500				
1,4-Dichlorobenzene	"			ND	"	0.500				
1,2-Dichlorobenzene	"			ND	"	0.500				
1,1-Dichloroethane	"			ND	"	0.500				
1,2-Dichloroethane	"			ND	"	0.500				
1,1-Dichloroethene	"			ND	"	0.500				
cis-1,2-Dichloroethene	"			ND	"	0.500				
trans-1,2-Dichloroethene	"			ND	"	0.500				
1,2-Dichloropropane	"			ND	"	0.500				
cis-1,3-Dichloropropene	"			ND	"	0.500				
trans-1,3-Dichloropropene	"			ND	"	0.500				
Methylene chloride	"			ND	"	5.00				
1,1,1,2-Tetrachloroethane	"			ND	"	0.500				
Tetrachloroethene	"			ND	"	0.500				
1,1,1-Trichloroethane	"			ND	"	0.500				
1,1,2-Trichloroethane	"			ND	"	0.500				
Trichloroethene	"			ND	"	0.500				
Trichlorofluoromethane	"			ND	"	0.500				
Vinyl chloride	"			ND	"	1.00				
Surrogate: 4-BFB	"	10.0		8.93	"	70.0-130	89.3			

Blank

9040110-BLK2

Freon 113	4/26/99			ND	ug/l	0.500				
Bromodichloromethane	"			ND	"	0.500				
Bromoform	"			ND	"	0.500				
Bromomethane	"			ND	"	1.00				
Carbon tetrachloride	"			ND	"	0.500				
Chlorobenzene	"			ND	"	0.500				
Chloroethane	"			ND	"	1.00				





Sequoia Analytical

680 Chesapeake Drive
404 N. Wiget Lane
819 Striker Avenue, Suite 8
1455 McDowell Blvd. North, Ste. D
1551 Industrial Road

Redwood City, CA 94063
Walnut Creek, CA 94598
Sacramento, CA 95834
Petaluma, CA 94954
San Carlos, CA 94070-4111

(650) 364-9600
(925) 988-9600
(916) 921-9600
(707) 792-1865
(650) 232-9600

FAX (650) 364-9233
FAX (925) 988-9673
FAX (916) 921-0100
FAX (707) 792-0342
FAX (650) 232-9612

Blaine Tech Services 1680 Rogers Avenue San Jose, CA 95112	Project: Chevron(5) Project Number: Chevron 9-1924, 990414-C1 Project Manager: Christine Lillie	Sampled: 4/14/99 Received: 4/15/99 Reported: 4/29/99
------------------------------------------------------------------	-------------------------------------------------------------------------------------------------------	------------------------------------------------------------

Volatile Organic Compounds by EPA Method 8010B/Quality Control Sequoia Analytical - San Carlos

Analyte	Date Analyzed	Spike Level	Sample Result	QC Result	Units	Reporting Limit Recov. Limits	Recov. %	RPD Limit	RPD %	Notes*
Blank (continued)		9040110-BLK2								
2-Chloroethylvinyl ether	4/26/99			ND	ug/l	1.00				
Chloroform	"			ND	"	0.500				
Chloromethane	"			ND	"	1.00				
Dibromochloromethane	"			ND	"	0.500				
1,3-Dichlorobenzene	"			ND	"	0.500				
1,4-Dichlorobenzene	"			ND	"	0.500				
1,2-Dichlorobenzene	"			ND	"	0.500				
1,1-Dichloroethane	"			ND	"	0.500				
1,2-Dichloroethane	"			ND	"	0.500				
1,1-Dichloroethene	"			ND	"	0.500				
cis-1,2-Dichloroethene	"			ND	"	0.500				
trans-1,2-Dichloroethene	"			ND	"	0.500				
1,2-Dichloropropane	"			ND	"	0.500				
cis-1,3-Dichloropropene	"			ND	"	0.500				
trans-1,3-Dichloropropene	"			ND	"	0.500				
Methylene chloride	"			ND	"	5.00				
1,1,1,2-Tetrachloroethane	"			ND	"	0.500				
Tetrachloroethene	"			ND	"	0.500				
1,1,1-Trichloroethane	"			ND	"	0.500				
1,1,2-Trichloroethane	"			ND	"	0.500				
Trichloroethene	"			ND	"	0.500				
Trichlorofluoromethane	"			ND	"	0.500				
Vinyl chloride	"			ND	"	1.00				
<i>Surrogate: 4-BFB</i>	"	10.0		9.12	"	70.0-130	91.2			
LCS		9040110-BS1								
Chlorobenzene	4/22/99	10.0		8.36	ug/l	70.0-130	83.6			
1,1-Dichloroethene	"	10.0		9.53	"	65.0-135	95.3			
Trichloroethene	"	10.0		9.55	"	70.0-130	95.5			
<i>Surrogate: 4-BFB</i>	"	10.0		7.19	"	70.0-130	71.9			
LCS		9040110-BS2								
Chlorobenzene	4/26/99	10.0		10.9	ug/l	70.0-130	109			
1,1-Dichloroethene	"	10.0		13.2	"	65.0-135	132			
Trichloroethene	"	10.0		13.9	"	70.0-130	139			3
<i>Surrogate: 4-BFB</i>	"	10.0		7.05	"	70.0-130	70.5			
Matrix Spike		9040110-MS1 L904153-06								
Chlorobenzene	4/22/99	10.0	ND	10.6	ug/l	60.0-140	106			
1,1-Dichloroethene	"	10.0	ND	12.2	"	60.0-140	122			
Trichloroethene	"	10.0	ND	12.2	"	60.0-140	122			





Sequoia Analytical

680 Chesapeake Drive
404 N. Wiget Lane
819 Striker Avenue, Suite 8
1455 McDowell Blvd. North, Ste. D
1551 Industrial Road

Redwood City, CA 94063 (650) 364-9600 FAX (650) 364-9233
Walnut Creek, CA 94598 (925) 988-9600 FAX (925) 988-9673
Sacramento, CA 95834 (916) 921-9600 FAX (916) 921-0100
Petaluma, CA 94954 (707) 792-1865 FAX (707) 792-0342
San Carlos, CA 94070-4111 (650) 232-9600 FAX (650) 232-9612

Blaine Tech Services 1680 Rogers Avenue San Jose, CA 95112	Project: Chevron(5) Project Number: Chevron 9-1924, 990414-C1 Project Manager: Christine Lillie	Sampled: 4/14/99 Received: 4/15/99 Reported: 4/29/99
------------------------------------------------------------------	-------------------------------------------------------------------------------------------------------	------------------------------------------------------------

Volatile Organic Compounds by EPA Method 8010B/Quality Control Sequoia Analytical - San Carlos

Analyte	Date Analyzed	Spike Level	Sample Result	QC Result	Units	Reporting Limit Recov. Limits	Recov. %	RPD Limit	RPD %	Notes*
Matrix Spike (continued)		9040110-MS1	L904153-06							
Surrogate: 4-BFB	4/22/99	10.0		7.67	ug/l	70.0-130	76.7			
Matrix Spike Dup		9040110-MSD1	L904153-06							
Chlorobenzene	4/22/99	10.0	ND	10.4	ug/l	60.0-140	104	25.0	1.90	
1,1-Dichloroethene	"	10.0	ND	11.4	"	60.0-140	114	25.0	6.78	
Trichloroethene	"	10.0	ND	11.7	"	60.0-140	117	25.0	4.18	
Surrogate: 4-BFB	"	10.0		8.55	"	70.0-130	85.5			





Blaine Tech Services 1680 Rogers Avenue San Jose, CA 95112	Project: Chevron(S) Project Number: Chevron 9-1924, 990414-C1 Project Manager: Christine Lillie	Sampled: 4/14/99 Received: 4/15/99 Reported: 4/29/99
------------------------------------------------------------------	-------------------------------------------------------------------------------------------------------	------------------------------------------------------------

Volatile Organic Oxygenated Compounds by EPA Method 8260A/Quality Control
Sequoia Analytical - San Carlos

Analyte	Date Analyzed	Spike Level	Sample Result	QC Result	Units	Reporting Limit Recov. Limits	Recov. %	RPD Limit	RPD %	Notes*
---------	---------------	-------------	---------------	-----------	-------	----------------------------------	----------	-----------	-------	--------

Batch: 9040107	Date Prepared: 4/21/99	Extraction Method: EPA 5030B IP/TI								
Blank	9040107-BLK1									
Ethanol	4/21/99			ND	ug/l	3000				
Tert-butyl alcohol	"			ND	"	200				
Methyl tert-butyl ether	"			ND	"	2.00				
Di-isopropyl ether	"			ND	"	2.00				
Ethyl tert-butyl ether	"			ND	"	2.00				
Tert-amyl methyl ether	"			ND	"	2.00				
<i>Surrogate: 1,2-Dichloroethane-d4</i>	"	50.0		52.4	"	76.0-114	105			

Blank	9040107-BLK2									
Ethanol	4/22/99			ND	ug/l	3000				
Tert-butyl alcohol	"			ND	"	200				
Methyl tert-butyl ether	"			ND	"	2.00				
Di-isopropyl ether	"			ND	"	2.00				
Ethyl tert-butyl ether	"			ND	"	2.00				
Tert-amyl methyl ether	"			ND	"	2.00				
<i>Surrogate: 1,2-Dichloroethane-d4</i>	"	50.0		52.0	"	76.0-114	104			

Blank	9040107-BLK3									
Ethanol	4/22/99			ND	ug/l	3000				
Tert-butyl alcohol	"			ND	"	200				
Methyl tert-butyl ether	"			ND	"	2.00				
Di-isopropyl ether	"			ND	"	2.00				
Ethyl tert-butyl ether	"			ND	"	2.00				
Tert-amyl methyl ether	"			ND	"	2.00				
<i>Surrogate: 1,2-Dichloroethane-d4</i>	"	50.0		51.0	"	76.0-114	102			

LCS	9040107-BS1									
Methyl tert-butyl ether	4/21/99	50.0		48.1	ug/l	70.0-130	96.2			
<i>Surrogate: 1,2-Dichloroethane-d4</i>	"	50.0		52.7	"	76.0-114	105			

LCS	9040107-BS2									
Methyl tert-butyl ether	4/22/99	50.0		48.3	ug/l	70.0-130	96.6			
<i>Surrogate: 1,2-Dichloroethane-d4</i>	"	50.0		52.9	"	76.0-114	106			

LCS	9040107-BS3									
Methyl tert-butyl ether	4/22/99	50.0		45.9	ug/l	70.0-130	91.8			
<i>Surrogate: 1,2-Dichloroethane-d4</i>	"	50.0		51.8	"	76.0-114	104			

Matrix Spike	9040107-MS1	L904208-15								
Methyl tert-butyl ether	4/21/99	50.0	ND	50.9	ug/l	60.0-140	102			





Sequoia Analytical

680 Chesapeake Drive
404 N. Wiget Lane
819 Striker Avenue, Suite 8
1455 McDowell Blvd. North, Ste. D
1551 Industrial Road

Redwood City, CA 94063 (650) 364-9600
Walnut Creek, CA 94598 (925) 988-9600
Sacramento, CA 95834 (916) 921-9600
Petaluma, CA 94954 (707) 792-1865
San Carlos, CA 94070-4111 (650) 232-9600

FAX (650) 364-9233
FAX (925) 988-9673
FAX (916) 921-0100
FAX (707) 792-0342
FAX (650) 232-9612

Blaine Tech Services 1680 Rogers Avenue San Jose, CA 95112	Project: Chevron(S) Project Number: Chevron 9-1924, 990414-C1 Project Manager: Christine Lillie	Sampled: 4/14/99 Received: 4/15/99 Reported: 4/29/99
------------------------------------------------------------------	-------------------------------------------------------------------------------------------------------	------------------------------------------------------------

Volatile Organic Oxygenated Compounds by EPA Method 8260A/Quality Control Sequoia Analytical - San Carlos

Analyte	Date Analyzed	Spike Level	Sample Result	QC Result	Units	Reporting Limit Recov. Limits	Recov. %	RPD Limit	RPD %	Notes*
Matrix Spike (continued)		9040107-MS1	L904208-15							
Surrogate: 1,2-Dichloroethane-d4	4/21/99	50.0		55.0	ug/l	76.0-114	110			
Matrix Spike Dup		9040107-MSD1	L904208-15							
Methyl tert-butyl ether	4/21/99	50.0	ND	51.7	ug/l	60.0-140	103	25.0	0.976	
Surrogate: 1,2-Dichloroethane-d4	"	50.0		55.8	"	76.0-114	112			
Batch: 9040114		Date Prepared: 4/22/99		Extraction Method: EPA 5030B (P/T)						
Blank		9040114-BLK1								
Ethanol	4/22/99			ND	ug/l	3000				
Tert-butyl alcohol	"			ND	"	200				
Methyl tert-butyl ether	"			ND	"	2.00				
Di-isopropyl ether	"			ND	"	2.00				
Ethyl tert-butyl ether	"			ND	"	2.00				
Tert-amyl methyl ether	"			ND	"	2.00				
Surrogate: 1,2-Dichloroethane-d4	"	50.0		51.0	"	76.0-114	102			
Blank		9040114-BLK2								
Ethanol	4/23/99			ND	ug/l	3000				
Tert-butyl alcohol	"			ND	"	200				
Methyl tert-butyl ether	"			ND	"	2.00				
Di-isopropyl ether	"			ND	"	2.00				
Ethyl tert-butyl ether	"			ND	"	2.00				
Tert-amyl methyl ether	"			ND	"	2.00				
Surrogate: 1,2-Dichloroethane-d4	"	50.0		53.0	"	76.0-114	106			
LCS		9040114-BS1								
Methyl tert-butyl ether	4/22/99	50.0		45.9	ug/l	70.0-130	91.8			
Surrogate: 1,2-Dichloroethane-d4	"	50.0		51.8	"	76.0-114	104			
LCS		9040114-BS2								
Methyl tert-butyl ether	4/23/99	50.0		47.8	ug/l	70.0-130	95.6			
Surrogate: 1,2-Dichloroethane-d4	"	50.0		53.8	"	76.0-114	108			
Matrix Spike		9040114-MS1	L904185-02							
Methyl tert-butyl ether	4/22/99	50.0	10.3	58.9	ug/l	60.0-140	97.2			
Surrogate: 1,2-Dichloroethane-d4	"	50.0		54.1	"	76.0-114	108			
Matrix Spike Dup		9040114-MSD1	L904185-02							
Methyl tert-butyl ether	4/22/99	50.0	10.3	58.4	ug/l	60.0-140	96.2	25.0	1.03	
Surrogate: 1,2-Dichloroethane-d4	"	50.0		52.8	"	76.0-114	106			





Sequoia Analytical

680 Chesapeake Drive
404 N. Wiget Lane
819 Striker Avenue, Suite 8
1455 McDowell Blvd. North, Ste. D
1551 Industrial Road

Redwood City, CA 94063
Walnut Creek, CA 94598
Sacramento, CA 95834
Petaluma, CA 94954
San Carlos, CA 94070-4111

(650) 364-9600
(925) 988-9600
(916) 921-9600
(707) 792-1865
(650) 232-9600

FAX (650) 364-9233
FAX (925) 988-9673
FAX (916) 921-0100
FAX (707) 792-0342
FAX (650) 232-9612

Blaine Tech Services
1680 Rogers Avenue
San Jose, CA 95112

Project: Chevron(5)
Project Number: Chevron 9-1924, 990414-C1
Project Manager: Christine Lillie

Sampled: 4/14/99
Received: 4/15/99
Reported: 4/29/99

Notes and Definitions

#	Note
---	------

- | | |
|--------|------------------------------------------------------------------------------------------------|
| 1 | The surrogate recovery was outside established control limits due to coelution from the spike. |
| 2 | Chromatogram pattern: Gasoline C6-C12 |
| 3 | Trichloroethene was 9% above the established control limit. The data is estimated |
| DET | Analyte DETECTED |
| ND | Analyte NOT DETECTED at or above the reporting limit |
| NR | Not Reported |
| dry | Sample results reported on a dry weight basis |
| Recov. | Recovery |
| RPD | Relative Percent Difference |



Fax copy of Lab Report and COC to Chevron Contact: Yes No

Chain-of-Custody-Record

Chevron Products Co.
P.O. BOX 6004
San Ramon, CA 94583
Fax (925)842-8370

Chevron Facility Number: 9-1924
 Facility Address: 4904 Southfront St., Livermore
 Consultant Project Number: 990414-C1
 Consultant Name: BLAINE TECH SERVICE, INC.
 Address: 1680 ROGERS AVE., SAN JOSE
 Project Contact (Name): CHRISTINE LILLIE
 (Phone): 408-573-0555 (Fax Number): 408-573-7771

Chevron Contact (Name): PHIL BRIGGS
 (Phone): (925) 842-9136
 Laboratory Name: SEQUOIA
 Laboratory Service Order: 9144488
 Laboratory Service Code: ZZ02800
 Samples Collected by (Name): Christine Lillie
 Signature: [Signature]

State Method: A OR WA NW Series CO UT

Sample Number	Number of Containers	Matrix S = Soil A = Air W = Water C = Other	Sample Preservation	Date/Time	ETEX/MTBE/TPH GAS (8020 + 8015)	ETEX + TPH GAS (8020 + 8015)	TPH Diesel (8015)	Oxygenates (8280)	Petroleum Hydrocarbons (8010)	Extractions Organics (8270)	Oil and Grease (8520)	Metals (ICAP or AA) Cd, Cr, Pb, Zn, Ni	ETEX (8020)	ETEX/MTBE/Naph. (8020)	TPH - HCB	TPH - P Extentives	Remarks
1-2	6	W	HCL	4/14/99 12:30	X	X	X	X	X	X	X						Lab Sample No
3-5				13:30	X	X	X	X	X	X	X						
6				12:50	X	X	X	X	X	X	X						
7-9				17:50	X	X	X	X	X	X	X						
11				11:35	X	X	X	X	X	X	X						
14					X	X	X	X	X	X	X						
17				11:45	X	X	X	X	X	X	X						
19					X	X	X	X	X	X	X						
20				10:55	X	X	X	X	X	X	X						
13	2				X	X	X	X	X	X	X						

Received By (Signature) <u>[Signature]</u>	Organization <u>BTS</u>	Date/Time <u>4/15 11:40</u>	Received By (Signature) <u>[Signature]</u>	Organization <u>[Signature]</u>	Date/Time <u>4/15/99</u>	Lead Y/N	Turn Around Time (Circle Choice) 24 hrs. 48 hrs. 5 Days 10 Days
By (Signature)	Organization	Date/Time	Received By (Signature)	Organization	Date/Time	Lead Y/N	
Signature)	Organization	Date/Time	Received For Laboratory By (Signature)	Organization	Date/Time	Lead Y/N	

TEL: 908 270 7711
 FAX: 908 270 7711
 P. 002



May 12, 1999

Christine Lillie
Blaine Tech Services
1680 Rogers Avenue
San Jose, CA 95112

RE: Chevron(5)/L905003

Dear Christine Lillie:

Enclosed are the results of analyses for sample(s) received by the laboratory on April 28, 1999. If you have any questions concerning this report, please feel free to contact me.

Sincerely,

Mike Gregory
Project Manager D.M.





Blaine Tech Services 1680 Rogers Avenue San Jose, CA 95112	Project: Chevron(5) Project Number: Chevron 9-1924, 990427-Z4 Project Manager: Christine Lillie	Sampled: 4/27/99 Received: 4/28/99 Reported: 5/12/99
------------------------------------------------------------------	-------------------------------------------------------------------------------------------------------	------------------------------------------------------------

ANALYTICAL REPORT FOR L905003

Sample Description	Laboratory Sample Number	Sample Matrix	Date Sampled
C-19	L905003-01	Water	4/27/99
TB	L905003-02	Water	4/27/99





Blaine Tech Services 1680 Rogers Avenue San Jose, CA 95112	Project: Chevron(5) Project Number: Chevron 9-1924, 990427-Z4 Project Manager: Christine Lillie	Sampled: 4/27/99 Received: 4/28/99 Reported: 5/12/99
------------------------------------------------------------------	-------------------------------------------------------------------------------------------------------	------------------------------------------------------------

Sample Description: C-19
Laboratory Sample Number: L905003-01

Analyte	Batch Number	Date Prepared	Date Analyzed	Specific Method/ Surrogate Limits	Reporting Limit	Result	Units	Notes*
---------	--------------	---------------	---------------	--------------------------------------	-----------------	--------	-------	--------

Sequoia Analytical - San Carlos

Total Purgeable Hydrocarbons (C6-C12), BTEX and MTBE by DHS LUFT

Purgeable Hydrocarbons as Gasoline	9050023	5/6/99	5/6/99		50.0	124	ug/l	1
Benzene	"	"	"		0.500	ND	"	
Toluene	"	"	"		0.500	ND	"	
Ethylbenzene	"	"	"		0.500	ND	"	
Xylenes (total)	"	"	"		0.500	ND	"	
Methyl tert-butyl ether	"	"	"		20	434	"	
<i>Surrogate: a,a,a-Trifluorotoluene</i>	"	"	"	70.0-130		89.5	%	





Blaine Tech Services 1680 Rogers Avenue San Jose, CA 95112	Project: Chevron(5) Project Number: Chevron 9-1924, 990427-Z4 Project Manager: Christine Lillie	Sampled: 4/27/99 Received: 4/28/99 Reported: 5/12/99
------------------------------------------------------------------	-------------------------------------------------------------------------------------------------------	------------------------------------------------------------

Sample Description: TB
Laboratory Sample Number: L905003-02

Analyte	Batch Number	Date Prepared	Date Analyzed	Specific Method/ Surrogate Limits	Reporting Limit	Result	Units	Notes*
---------	--------------	---------------	---------------	--------------------------------------	-----------------	--------	-------	--------

Sequoia Analytical - San Carlos

Total Purgeable Hydrocarbons (C6-C12), BTEX and MTBE by DHS LUFT

Purgeable Hydrocarbons as Gasoline	9050023	5/6/99	5/6/99		50.0	ND	ug/l	
Benzene	"	"	"		0.500	ND	"	
Toluene	"	"	"		0.500	ND	"	
Ethylbenzene	"	"	"		0.500	ND	"	
Xylenes (total)	"	"	"		0.500	ND	"	
Methyl tert-butyl ether	"	"	"		5.00	ND	"	
Surrogate: <i>a,a,a-Trifluorotoluene</i>	"	"	"	70.0-130		89.0	%	





Blaine Tech Services 1680 Rogers Avenue San Jose, CA 95112	Project: Chevron(5) Project Number: Chevron 9-1924, 990427-Z4 Project Manager: Christine Lillie	Sampled: 4/27/99 Received: 4/28/99 Reported: 5/12/99
------------------------------------------------------------------	-------------------------------------------------------------------------------------------------------	------------------------------------------------------------

Total Purgeable Hydrocarbons (C6-C12), BTEX and MTBE by DHS LUFT/Quality Control
Sequoia Analytical - San Carlos

Analyte	Date Analyzed	Spike Level	Sample Result	QC Result	Units	Reporting Limit Recov. Limits	Recov. %	RPD Limit	RPD %	Notes*
Batch: 9050023		Date Prepared: 5/6/99			Extraction Method: EPA 5030B IP/TI					
Blank		9050023-BLK1								
Purgeable Hydrocarbons as Gasoline	5/6/99			ND	ug/l	50.0				
Benzene	"			ND	"	0.500				
Toluene	"			ND	"	0.500				
Ethylbenzene	"			ND	"	0.500				
Xylenes (total)	"			ND	"	0.500				
Methyl tert-butyl ether	"			ND	"	5.00				
Surrogate: a,a,a-Trifluorotoluene	"	10.0		8.31	"	70.0-130	83.1			
LCS		9050023-BS1								
Purgeable Hydrocarbons as Gasoline	5/6/99	250		203	ug/l	70.0-130	81.2			
Surrogate: a,a,a-Trifluorotoluene	"	10.0		8.65	"	70.0-130	86.5			
Matrix Spike		9050023-MS1		L904392-02						
Purgeable Hydrocarbons as Gasoline	5/6/99	250	ND	195	ug/l	60.0-140	78.0			
Surrogate: a,a,a-Trifluorotoluene	"	10.0		8.91	"	70.0-130	89.1			
Matrix Spike Dup		9050023-MSD1		L904392-02						
Purgeable Hydrocarbons as Gasoline	5/6/99	250	ND	211	ug/l	60.0-140	84.4	25.0	7.88	
Surrogate: a,a,a-Trifluorotoluene	"	10.0		9.44	"	70.0-130	94.4			





Blaine Tech Services 1680 Rogers Avenue San Jose, CA 95112	Project: Chevron(5) Project Number: Chevron 9-1924, 990427-Z4 Project Manager: Christine Lillie	Sampled: 4/27/99 Received: 4/28/99 Reported: 5/12/99
------------------------------------------------------------------	-------------------------------------------------------------------------------------------------------	------------------------------------------------------------

Notes and Definitions

#	Note
1	Chromatogram Pattern: Unidentified Hydrocarbons C6-C12
DET	Analyte DETECTED
ND	Analyte NOT DETECTED at or above the reporting limit
NR	Not Reported
dry	Sample results reported on a dry weight basis
Recov.	Recovery
RPD	Relative Percent Difference



Fax copy of Lab Report and COC to Chevron Contact: Yes No

Chain-of-Custody-Record

<p>Chevron Products Co. P.O. BOX 6004 San Ramon, CA 94583 FAX (925)842-8370</p>	<p>Chevron Facility Number <u>9-1924</u> Facility Address <u>4904 Southfront St., Livermore</u> Consultant Project Number <u>990427-22</u> Consultant Name <u>BLAINE TECH SERVICE, INC.</u> Address <u>1680 ROGERS AVE., SAN JOSE</u> Project Contact (Name) <u>CHRISTINE LILLIE</u> (Phone) <u>408-573-0555</u> (Fax Number) <u>408-573-7771</u></p>	<p>Chevron Contact (Name) <u>PHIL BRIGGS</u> (Phone) <u>(925) 842-9136</u> Laboratory Name <u>SEQUOIA</u> Laboratory Service Order <u>9144488</u> Laboratory Service Code <u>ZZ02800</u> Samples Collected by (Name) <u>Jeremy</u> Signature <u>[Signature]</u></p>
---------------------------------------------------------------------------------------------	-------------------------------------------------------------------------------------------------------------------------------------------------------------------------------------------------------------------------------------------------------------------------------------------------------------------------------------------------------------------------------	---------------------------------------------------------------------------------------------------------------------------------------------------------------------------------------------------------------------------------------------------------------------------------------------

Sample Number	Number of Containers	Matrix S = Soil W = Water A = Air C = Charcoal	Sample Preservation	Date/Time	State Method: <input type="checkbox"/> CA <input type="checkbox"/> OR <input type="checkbox"/> WA <input type="checkbox"/> NW Series <input type="checkbox"/> CO <input type="checkbox"/> UT													Remarks							
					BTEX/MTBE+TPH GAS (8020 + 8015)	BTEX + TPH GAS (8020 + 8015)	TPH Dredged (8015)	Organics (8280)	Purgeable Halocarbons (8010)	Purgeable Organics (8280)	Extractable Organics (8270)	Oil and Grease (5520)	Metals (ICAP or AA) Cd, Cr, Pb, Zn, Ni	BTEX (8020)	BTEX/MTBE/NaPh (8020)	TPH - HCID	TPH - D - Extended								
C-19	3	↓	↓	4/27/99	X	01																		Lab Sample No.	
B	2	↓	↓	-	X	02																			
																									490
																									L905003

Relinquished By (Signature) <u>[Signature]</u>	Organization <u>BTB</u>	Date/Time <u>4/28/99</u> 11:03	Received By (Signature) <u>[Signature]</u>	Organization <u>SEQUOIA</u>	Date/Time <u>4/28/99</u>	Iced Y/N	Turn Around Time (Circle Choice) 24 hrs. 48 hrs. 5 Days 10 Days As Contracted
Shipped By (Signature) <u>[Signature]</u>	Organization	Date/Time <u>4/28/99</u>	Received By (Signature) <u>Craig Mullen</u>	Organization	Date/Time <u>4/28/99 13:05</u>	Iced <input checked="" type="checkbox"/> Y/N	
By (Signature)	Organization	Date/Time	Received For Laboratory By (Signature)	Organization	Date/Time	Iced Y/N	

Field Data Sheets

CHEVRON WELL MONITORING DATA SHEET

Project #: 990427-22	Station #: 9-1924
Sampler: JR	Date: 4-27-99
Well I.D.: C-14	Well Diameter: 2 (3) 4 6 8
Total Well Depth: 12.35	Depth to Water: 11.72
Depth to Free Product:	Thickness of Free Product (feet):
Referenced to: PVC Grade	D.O. Meter (if req'd): YSI HACH

Well Diameter	Multiplier	Well Diameter	Multiplier
2"	0.16	5"	1.02
3"	0.37	6"	1.47
4"	0.65	Other	radius ² * 0.163

Purge Method:

- Bailer
- Disposable Bailer
- Middleburg
- Electric Submersible
- Extraction Pump
- Other: _____

Sampling Method:

- Bailer
- Disposable Bailer
- Extraction Port
- Other: _____

_____	X	_____	=	_____ Gals.
1 Case Volume (Gals.)		Specified Volumes		Calculated Volume

Time	Temp (°F)	pH	Cond.	Gals. Removed	Observations
					*insufficient H ₂ O to sample

Did well dewater?	Yes	No	Gallons actually evacuated:
Sampling Time:	Sampling Date:		
Sample I.D.:	Laboratory: Sequoia CORE N. Creek Assoc. Labs		
Analyzed for: TPH-G BTEX MTBE TPH-D Other:			
Duplicate I.D.:	Analyzed for: TPH-G BTEX MTBE TPH-D Other:		
D.O. (if req'd):	Pre-purge:	mg/L	Post-purge: mg/L
D.R.P. (if req'd):	Pre-purge:	mV	Post-purge: mV

CHEVRON WELL MONITORING DATA SHEET

Project #: 990427-22	Station #: 9-1924
Sampler: JR	Date: 4-27-99
Well I.D.: C-19	Well Diameter: (2) 3 4 6 8
Total Well Depth: 23.95	Depth to Water: 11 13.79
Depth to Free Product:	Thickness of Free Product (feet):
Referenced to: (PVC) Grade	D.O. Meter (if req'd): YSI HACH

Well Diameter	Multiplier	Well Diameter	Multiplier
2"	0.16	5"	1.02
3"	0.37	6"	1.47
4"	0.65	Other	radius ² * 0.163

Purge Method:	Sampling Method:
Bailer	Bailer
Disposable Bailer <input checked="" type="checkbox"/>	Disposable Bailer <input checked="" type="checkbox"/>
Middleburg	Extraction Port
Electric Submersible	Other: _____
Extraction Pump	
Other: _____	

1.6	x	3	=	4.8	Gals.
1 Case Volume (Gals.)		Specified Volumes		Calculated Volume	

Time	Temp (°F)	pH	Cond.	Gals. Removed	Observations
1442	64.8	7.4	1850	2	
1445	65.2	7.4	1706	4	
1447	65.5	7.3	1626	5	

Did well dewater? Yes <input type="checkbox"/> No <input checked="" type="checkbox"/>	Gallons actually evacuated: 5
Sampling Time: 1450	Sampling Date: 4-27-99
Sample I.D.: C-19	Laboratory: (Sequoia) CORE N. Creek Assoc. Labs
Analyzed for: (TPH-G BTEX MTBE) TPH-D Other:	
Duplicate I.D.:	Analyzed for: TPH-G BTEX MTBE TPH-D Other:
D.O. (if req'd):	Pre-purge: <input type="text"/> mg/L Post-purge: <input type="text"/> mg/L
O.R.P. (if req'd):	Pre-purge: <input type="text"/> mV Post-purge: <input type="text"/> mV

CHEVRON WELL MONITORING DATA SHEET

Project #: 990414-C1	Station #: 9-1924
Sampler: CB	Date: 4/14/99
Well I.D.: C-2	Well Diameter: 2 (3) 4 6 8
Total Well Depth: 23.80	Depth to Water: 11.41
Depth to Free Product:	Thickness of Free Product (feet):
Referenced to: PVC Grade	D.O. Meter (if req'd): YSI HACH

Well Diameter	Multiplier	Well Diameter	Multiplier
2"	0.16	5"	1.02
3"	0.37	6"	1.47
4"	0.65	Other	radius ² * 0.163

Purge Method: Bailer
 Disposable Bailer
 Middleburg
Electric Submersible
 Extraction Pump
 Other: _____

Sampling Method: Bailer
 Disposable Bailer ✓
 Extraction Port
 Other: _____

4.6	x	3	=	13.8	Gals.
1 Case Volume (Gals.)		Specified Volumes		Calculated Volume	

Time	Temp (°F)	pH	Cond.	Gals. Removed	Observations
12:22	66.8	7.3	1500	5	
12:24	66.2	7.2	1400	10	
12:27	66.8	7.2	1400	14	

Did well dewater? Yes No Gallons actually evacuated: 14

Sampling Time: 12:30 Sampling Date: 4/14/99

Sample I.D.: C-2 Laboratory: Sequoia CORE N. Creek Assoc. Labs

Analyzed for: TPH-G BTEX MTBE TPH-D Other: Oxygenates by 8260

Duplicate I.D.: Analyzed for: TPH-G BTEX MTBE TPH-D Other:

D.O. (if req'd):	Pre-purge:	mg/L	Post-purge:	mg/L
O.R.P. (if req'd):	Pre-purge:	mV	Post-purge:	mV

CHEVRON WELL MONITORING DATA SHEET

Project #: 990414-C1	Station #: 9-1924
Sampler: CB	Date: 4/14/99
Well I.D.: C-5	Well Diameter: 2 (3) 4 6 8
Total Well Depth: 19.00	Depth to Water: 11.29
Depth to Free Product:	Thickness of Free Product (feet):
Referenced to: PVC Grade	D.O. Meter (if req'd): YSI HACH

Well Diameter	Multiplier	Well Diameter	Multiplier
2"	0.16	5"	1.02
3"	0.37	6"	1.47
4"	0.65	Other	radius ² * 0.165

Purge Method: Bailer Disposable Bailer Middleburg <u>Electric Submersible</u> Extraction Pump Other: _____	Sampling Method: Bailer Disposable Bailer ✓ Extraction Port Other: _____
---------------------------------------------------------------------------------------------------------------------------	-----------------------------------------------------------------------------------

2.9	x	3	=	8.7	Gals.
1 Case Volume (Gals.)		Specified Volumes		Calculated Volume	

Time	Temp (°F)	pH	Cond.	Gals. Removed	Observations
13:12	68.8	7.6	1500	3	Gandy
13:14	68.2	7.5	1600	6	
13:16	68.4	7.5	1600	9	

Did well dewater? Yes <input type="radio"/> No <input checked="" type="radio"/>	Gallons actually evacuated: 9
Sampling Time: 13:20	Sampling Date: 4/14/99
Sample I.D.: C-5	Laboratory: Sequoia CORE N. Creek Assoc. Labs
Analyzed for: TPH-G BTEX MTBE TPH-D Other: Oxygenates by 8260	
Duplicate I.D.:	Analyzed for: TPH-G BTEX MTBE TPH-D Other:
D.O. (if req'd):	Pre-purge: <input type="text"/> mg/L Post-purge: <input type="text"/> mg/L
O.R.P. (if req'd):	Pre-purge: <input type="text"/> mV Post-purge: <input type="text"/> mV

CHEVRON WELL MONITORING DATA SHEET

Project #: 990414-C1	Station #: 9-1924
Sampler: CB	Date: 4/14/99
Well I.D.: C-6	Well Diameter: 2 <u>6</u> 4 6 8
Total Well Depth: 21.93	Depth to Water: 10.83
Depth to Free Product:	Thickness of Free Product (feet):
Referenced to: <u>PVC</u> Grade	D.O. Meter (if req'd): YSI HACH

Well Diameter	Multiplier	Well Diameter	Multiplier
2"	0.16	5"	1.02
3"	0.37	6"	1.47
4"	0.65	Other	radius ² * 0.163

Purge Method: Bailer Sampling Method: Bailer
 Disposable Bailer Disposable Bailer
 Middleburg Extraction Port
Electric Submersible Other: _____
 Extraction Pump

Other: _____

4	x	3	=	12	Gals.
1 Case Volume (Gals.)		Specified Volumes		Calculated Volume	

Time	Temp (°F)	pH	Cond.	Gals. Removed	Observations
12:44	66.8	7.3	1300	4	OOR
12:46	65.4	7.2	1300	8	
12:48	66.0	7.2	1300	12	

Did well dewater? Yes No Gallons actually evacuated: 12

Sampling Time: 12:50 Sampling Date: 4/14/99

Sample I.D.: C-6 Laboratory: Sequoia CORE N. Creek Assoc. Labs

Analyzed for: TPH-G BTEX MTBE TPH-D Other: Oxygenates by 8260

Duplicate I.D.: Analyzed for: TPH-G BTEX MTBE TPH-D Other:

D.O. (if req'd):	Pre-purge:	mg/L	Post-purge:	"
O.R.P. (if req'd):	Pre-purge:	mV	Post-purge:	

CHEVRON WELL MONITORING DATA SHEET

Project #: 990414-C1	Station #: 9-1924
Sampler: CB	Date: 4/14/99
Well I.D.: C-9	Well Diameter: 2 (3) 4 6 8
Total Well Depth: 22.40	Depth to Water: 10.83
Depth to Free Product:	Thickness of Free Product (feet):
Referenced to: PVC Grade	D.O. Meter (if req'd): YSI HACH

Well Diameter	Multiplier	Well Diameter	Multiplier
2"	0.16	5"	1.02
3"	0.37	6"	1.47
4"	0.65	Other	radius ² * 0.163

Purge Method: Bailer Sampling Method: Bailer
 Disposable Bailer Disposable Bailer ✓
 Middleburg Extraction Port
Electric Submersible Other: _____
 Extraction Pump
 Other: _____

4.3	x	3	=	12.9	Gals.
1 Case Volume (Gals.)		Specified Volumes		Calculated Volume	

Time	Temp (°F)	pH	Cond.	Gals. Removed	Observations
13:44	67.8	7.2	1400	5	
13:46	65.8	7.3	1500	10	
13:48	65.4	7.3	1500	13	

Did well dewater? Yes No Gallons actually evacuated: 13

Sampling Time: 13:50 Sampling Date: 4/14/99

Sample I.D.: C-9 Laboratory: Sequoia CORE N. Creek Assoc. Labs

Analyzed for: TPH-G BTEX MTBE TPH-D Other: Oxygenates by 8260/8010

Duplicate I.D.: Analyzed for: TPH-G BTEX MTBE TPH-D Other:

D.O. (if req'd):	Pre-purge:	mg/L	Post-purge:	mg/L
O.R.P. (if req'd):	Pre-purge:	mV	Post-purge:	mV

CHEVRON WELL MONITORING DATA SHEET

Project #: 990414-C1	Station #: 9-1924
Sampler: CB	Date: 4/14/99
Well I.D.: C-11	Well Diameter: 2 (3) 4 6 8
Total Well Depth: 19.48	Depth to Water: 13.11
Depth to Free Product:	Thickness of Free Product (feet):
Referenced to: PVC Grade	D.O. Meter (if req'd): YSI HACH

Well Diameter	Multiplier	Well Diameter	Multiplier
2"	0.16	5"	1.02
3"	0.37	6"	1.47
4"	0.65	Other	radius ² * 0.165

Purge Method: Bailer Sampling Method: Bailer
 Disposable Bailer Disposable Bailer
 Middleburg Extraction Port
Electric Submersible Other: _____
 Extraction Pump

Other: _____

2.4	x	3	=	7.2	Gals.
1 Case Volume (Gals.)		Specified Volumes		Calculated Volume	

Time	Temp (°F)	pH	Cond.	Gals. Removed	Observations
11:18	64.2	6.8	700	3	Very silty
11:20	64.6	6.9	700	6	
11:22	64.8	6.9	700	8	

Did well dewater? Yes No Gallons actually evacuated: 8

Sampling Time: 11:25 Sampling Date: 4/14/99

Sample I.D.: C-11 Laboratory: Sequoia CORE N. Creek Assoc. Labs

Analyzed for: TPH-G BTEX MTBE TPH-D Other: Oxygenates by 8260

uplicate I.D.: Analyzed for: TPH-G BTEX MTBE TPH-D Other:

(if req'd):	Pre-purge:	mg/L	Post-purge:	mg/L
P. (if req'd):	Pre-purge:	mV	Post-purge:	mV

CHEVRON WELL MONITORING DATA SHEET

Project #: 990414-C1	Station #: 9-1924
Sampler: CB	Date: 4/14/99
Well I.D.: C-14	Well Diameter: 2 <u>3</u> 4 6 8
Total Well Depth: 12.45	Depth to Water: 11.93
Depth to Free Product:	Thickness of Free Product (feet):
Referenced to: <u>PVC</u> Grade	D.O. Meter (if req'd): YSI HACH

Well Diameter	Multiplier	Well Diameter	Multiplier
2"	0.16	5"	1.02
3"	0.37	6"	1.47
4"	0.65	Other	radius ² * 0.163

Purge Method: Bailer Sampling Method: Bailer
 Disposable Bailer Disposable Bailer
 Middleburg Extraction Port
Electric Submersible Other: _____
 Extraction Pump

0.2 x 3 = 0.6 Gals.
1 Case Volume (Gals.) Specified Volumes Calculated Volume

Time	Temp (°F)	pH	Cond.	Gals. Removed	Observations
					Insufficient Water Amount to Sample

Did well dewater? Yes No Gallons actually evacuated: _____

Sampling Time: _____ Sampling Date: 4/14/99

Sample I.D.: C-14 Laboratory: Sequoia CORE N. Creek Assoc. Labs

Analyzed for: TPH-G BTEX MTBE TPH-D Other: Oxygenates by 8260/8010

Duplicate I.D.: _____ Analyzed for: TPH-G BTEX MTBE TPH-D Other: _____

D.O. (if req'd):	Pre-purge:	mg/L	Post-purge:	mg/L
	O.R.P. (if req'd):	mV	Post-purge:	mV

CHEVRON WELL MONITORING DATA SHEET

Project #: 990414-C1	Station #: 9-1924
Sampler: CB	Date: 4/14/99
Well I.D.: C-17	Well Diameter: 2 (3) 4 6 8
Total Well Depth: 20.00	Depth to Water: 13.05
Depth to Free Product:	Thickness of Free Product (feet):
Referenced to: PVC Grade	D.O. Meter (if req'd): YSI HACH

Well Diameter	Multiplier	Well Diameter	Multiplier
2"	0.16	5"	1.02
3"	0.37	6"	1.47
4"	0.65	Other	radius ² * 0.163

Purge Method: Bailer Disposable Bailer Middleburg Electric Submersible Extraction Pump

Other: _____

Sampling Method: Bailer Disposable Bailer Extraction Port

Other: _____

2.6	x	3	=	7.8	Gals.
1 Case Volume (Gals.)		Specified Volumes		Calculated Volume	

Time	Temp (°F)	pH	Cond.	Gals. Removed	Observations
11:39	63.6	7.0	1300	3	
11:41	62.8	7.0	1300	6	
11:43	63.0	7.0	1200	8	

Did well dewater? Yes No Gallons actually evacuated: 8

Sampling Time: 11:45 Sampling Date: 4/14/99

Sample I.D.: C-17 Laboratory: Sequoia CORE N. Creek Assoc. Labs

Analyzed for: TPH-G BTEX MTBE TPH-D Other: Oxygenates by 8260

Duplicate I.D.: Analyzed for: TPH-G BTEX MTBE TPH-D Other:

D.O. (if req'd):	Pre-purge:	mg/L	Post-purge:	mg/L
O.R.P. (if req'd):	Pre-purge:	mV	Post-purge:	mV

CHEVRON WELL MONITORING DATA SHEET

Project #: 990414-C1	Station #: 9-1924
Sampler: CB	Date: 4/14/99
Well I.D.: C-19	Well Diameter: (2) 3 4 6 8
Total Well Depth: 2390	Depth to Water:
Depth to Free Product:	Thickness of Free Product (feet):
Referenced to: (PVC) Grade	D.O. Meter (if req'd): YSI HACH

Well Diameter	Multiplier	Well Diameter	Multiplier
2"	0.16	5"	1.02
3"	0.37	6"	1.47
4"	0.65	Other	radius ² * 0.163

Purge Method:

Bailer
 Disposable Bailer
 Middleburg
 Electric Submersible
 Extraction Pump
 Other: _____

Sampling Method:

Bailer
 Disposable Bailer
 Extraction Port
 Other: _____

_____	X	3	=	_____
1 Case Volume (Gals.)		Specified Volumes		Calculated Volume

Time	Temp (°F)	pH	Cond.	Gals. Removed	Observations
					Well was paved over!
					No Access

Did well dewater? Yes No Gallons actually evacuated: _____

Sampling Time: _____ Sampling Date: 4/14/99

Sample I.D.: C-19 Laboratory: (Sequoia) CORE N. Creek Assoc. Labs

Analyzed for: (TPH-G BTEX MTBE) TPH-D Other: Oxygenates by 8260

Duplicate I.D.: _____ Analyzed for: TPH-G BTEX MTBE TPH-D Other: _____

D.O. (if req'd):	Pre-purge:	mg/L	Post-purge:	mg/L
O.R.P. (if req'd):	Pre-purge:	mV	Post-purge:	mV

CHEVRON WELL MONITORING DATA SHEET

Project #: 990414-C1	Station #: 9-1924
Sampler: CB	Date: 4/14/99
Well I.D.: C-20	Well Diameter: (2) 3 4 6 8
Total Well Depth: 24.10	Depth to Water: 13.30
Depth to Free Product:	Thickness of Free Product (feet):
Referenced to: PVC Grade	D.O. Meter (if req'd): YSI HACH

Well Diameter	Multiplier	Well Diameter	Multiplier
2"	0.16	5"	1.02
3"	0.37	6"	1.47
4"	0.65	Other	radius ² * 0.163

Purge Method: Bailer Disposable Bailer Middleburg Electric Submersible Extraction Pump Other: _____

Sampling Method: Bailer Disposable Bailer Extraction Port Other: _____

4.0	1.7	x	3	=	12.51	Gals.
I Case Volume (Gals.)		Specified Volumes		Calculated Volume		

Time	Temp (°F)	pH	Cond.	Gals. Removed	Observations
10:45	65.6	6.9	2200	4 2	
10:49	64.0	6.9	900	8 4	
10:53	63.8	7.0	900	14 6	

Did well dewater? Yes No Gallons actually evacuated: ~~12~~ 6

Sampling Time: 10:55 Sampling Date: 4/14/99

Sample I.D.: C-20 Laboratory: Sequoia CORE N. Creek Assoc. Labs

Analyzed for: TPH-G BTEX MTBE TPH-D Other: Oxygenates by 8260

Duplicate I.D.: Analyzed for: TPH-G BTEX MTBE TPH-D Other:

D.O. (if req'd):	Pre-purge:	mg/L	Post-purge:	mg/L
O.R.P. (if req'd):	Pre-purge:	mV	Post-purge:	mV