



RECEIVED

By Alameda County Environmental Health at 4:58 pm, Jun 05, 2014

Alexis Fischer
Project Manager
Marketing Business Unit

**Chevron Environmental
Management Company**
6101 Bollinger Canyon Road
San Ramon, CA 94583
Tel (925) 790-6441
afischer@chevron.com

Alameda County Environmental Health (ACEH)
1131 Harbor Bay Parkway, Suite 250
Alameda, CA 94502-6577

Re: Former Chevron Service Station No. 96991
2920 Castro Valley Boulevard
Castro Valley, CA

I have reviewed the following *Well Destruction Report*, dated May 30, 2014.

The information in this report is accurate to the best of my knowledge and all local Agency/Regional Board guidelines have been followed. This report was prepared by Conestoga Rovers and Associates, upon whose assistance and advice I have relied.

This letter is submitted pursuant to the requirements of California Water Code Section 13267(b)(1) and the regulating implementation entitled Appendix A pertaining thereto.

I declare under penalty of perjury that the foregoing is true and correct to the best of my knowledge.

Sincerely,

A handwritten signature in blue ink that reads "Alexis Fischer".

Alexis Fischer
Project Manager

Attachment: Well Destruction Report



**CONESTOGA-ROVERS
& ASSOCIATES**

10969 Trade Center Drive, Suite 107
Rancho Cordova, California 95670
Telephone: (916) 889-8900 Fax: (916) 889-8999
www.CRAworld.com

May 30, 2014

Reference No. 611633D

Mr. Mark Detterman, P.G., C.E.G.
Alameda County Environmental Health
1131 Harbor Bay Parkway, Suite 250
Alameda, California 94502-6577

Re: Well Destruction Report
Chevron Service Station 96991
2920 Castro Valley Boulevard
Castro Valley, California
Case No. RO475

Dear Mr. Detterman:

Conestoga-Rovers & Associates (CRA) is submitting this *Well Destruction Report* for the site referenced above (Figure 1) on behalf of Chevron Environmental Management Company (Chevron). As the final step prior to case closure, in accordance with the Alameda County Environmental Health (ACEH) letter dated July 26, 2013 (Attachment A), remaining site monitoring wells MW-1 through MW-7 were destroyed as described below. Well destruction was performed in general accordance with Alameda County Public Works Agency (ACPWA) water resources well permit numbers W2014-0397 through W2014-0403, dated April 23, 2014. A roadway encroachment permit number R14 LD 13250 was also obtained from ACPWA for the destruction of offsite monitoring wells MW-5 and MW-6. Copies of all permits are included as Attachment B.

On April 28 and 29, 2014, CRA staff observed PeneCore Drilling (C-57 License No. 906899) destroy wells MW-1 through MW-7 (Figure 2). As permitted by ACPWA, wells MW-4 and MW-7 were destroyed by pressure grouting with neat cement grout. In an April 2, 2014 email (Attachment B), the ACPWA requested that wells MW-1 through MW-3 be destroyed by drilling out the well casing and annular space materials to total depth due to their 0.75-inch diameter size, and wells MW-5 and MW-6 be destroyed by pressure grouting and drilling out the top 5 feet due to their location in the Alameda County right-of-way. In an email dated April 21, 2014 (Attachment B), the ACPWA amended their request and approved a variance to the destruction method for wells MW-1, MW-2, MW-5 and MW-6

Equal
Employment Opportunity
Employer



**CONESTOGA-ROVERS
& ASSOCIATES**

May 30, 2014

Reference No. 611633D

- 2 -

by pressure grouting due to safety issues related to nearby buried utility lines. Well MW-3 was destroyed by drilling out the well casing and annular space materials to total depth using a 4-inch diameter auger. Once the wells were destroyed the well boxes were removed, and the resulting cavities were backfilled with concrete to match existing surface grade, except for wells MW-5 and MW-6 that were completed to grade with hot-patch asphalt. CRA's standard field procedures for monitoring well destruction are included as Attachment C.

All waste material generated during well destruction was placed in a DOT-approved 55-gallon steel drum and temporarily stored onsite, pending disposal at a licensed facility. On May 29, 2014, the drum was removed from the site by Belshire Environmental Services, Inc., for transport to TSP Soil Recyclers of California's Adelanto facility for disposal. The generator copy of the waste manifest is included as Attachment D. Department of Water Resources (DWR) Well Completion/Destruction Forms (Form 188) have been submitted to the DWR by mail and ACPWA by email.



**CONESTOGA-ROVERS
& ASSOCIATES**

May 30, 2014

Reference No. 611633D

- 3 -

We appreciate your assistance with this project and look forward to receipt of the case closure letter. Please contact Mr. Nate Allen at (916) 889-8929 if you have any questions or need any additional information.

Sincerely,

CONESTOGA-ROVERS & ASSOCIATES

A handwritten signature in cursive script that reads "Charley Austin".

Charley Austin

A handwritten signature in cursive script that reads "Nate Allen".

Nate Allen, P.G. 9075

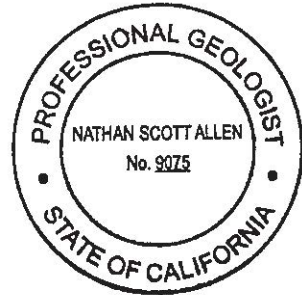

CA/mws/17

Encl.

Figure 1 Vicinity Map

Figure 2 Site Plan

Attachment A ACEH Correspondence

Attachment B Permits

Attachment C Standard Field Procedures

Attachment D Drum Disposal Manifest

cc: Ms. Alexis Fischer, Chevron (*electronic copy only*)

K&K Petroleum, LLC, property owner

Figures

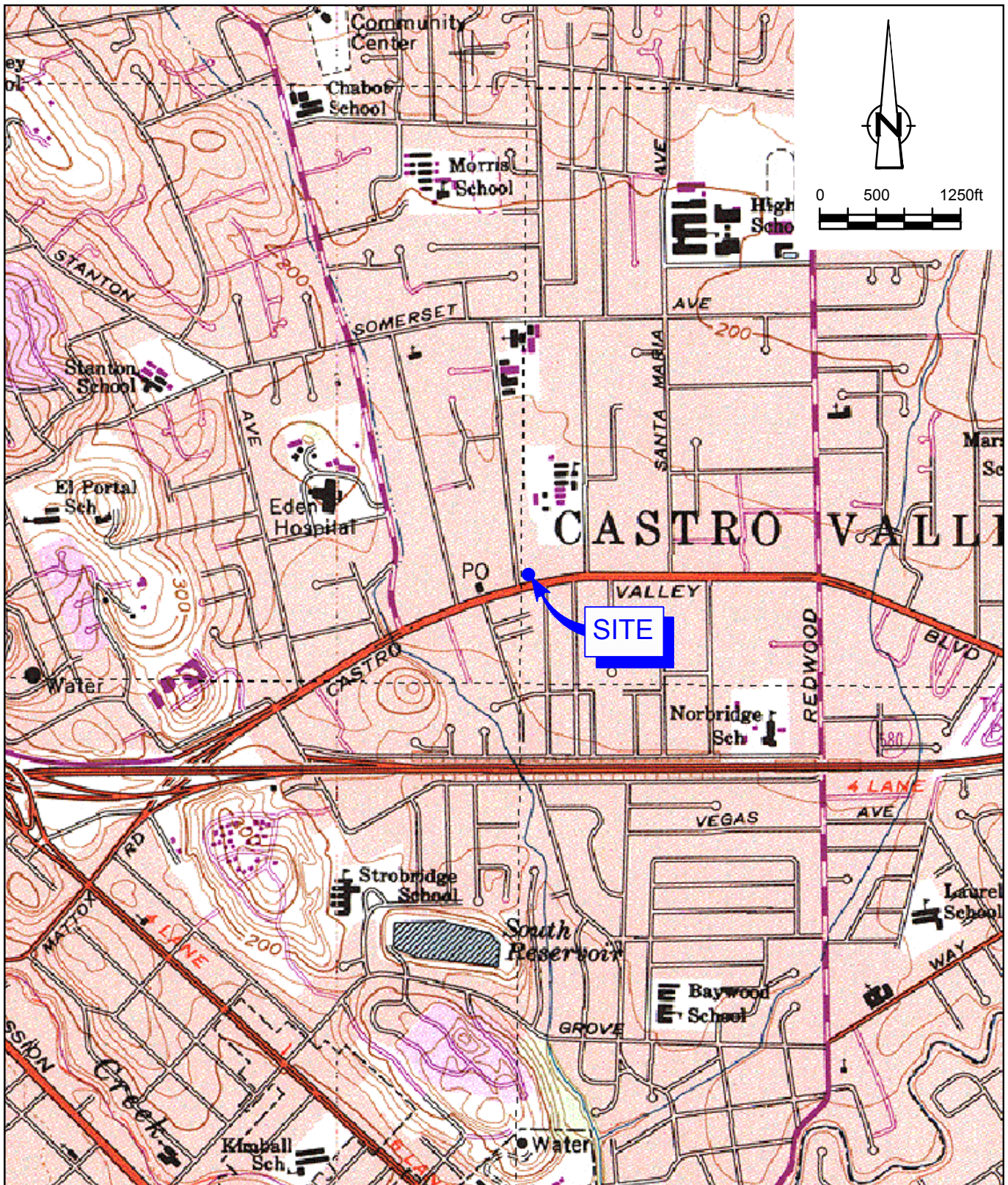

SOURCE: TOPO! MAPS.

figure 1

VICINITY MAP
 CHEVRON SERVICE STATION 96991
 2920 CASTRO VALLEY BOULEVARD
Castro Valley, California



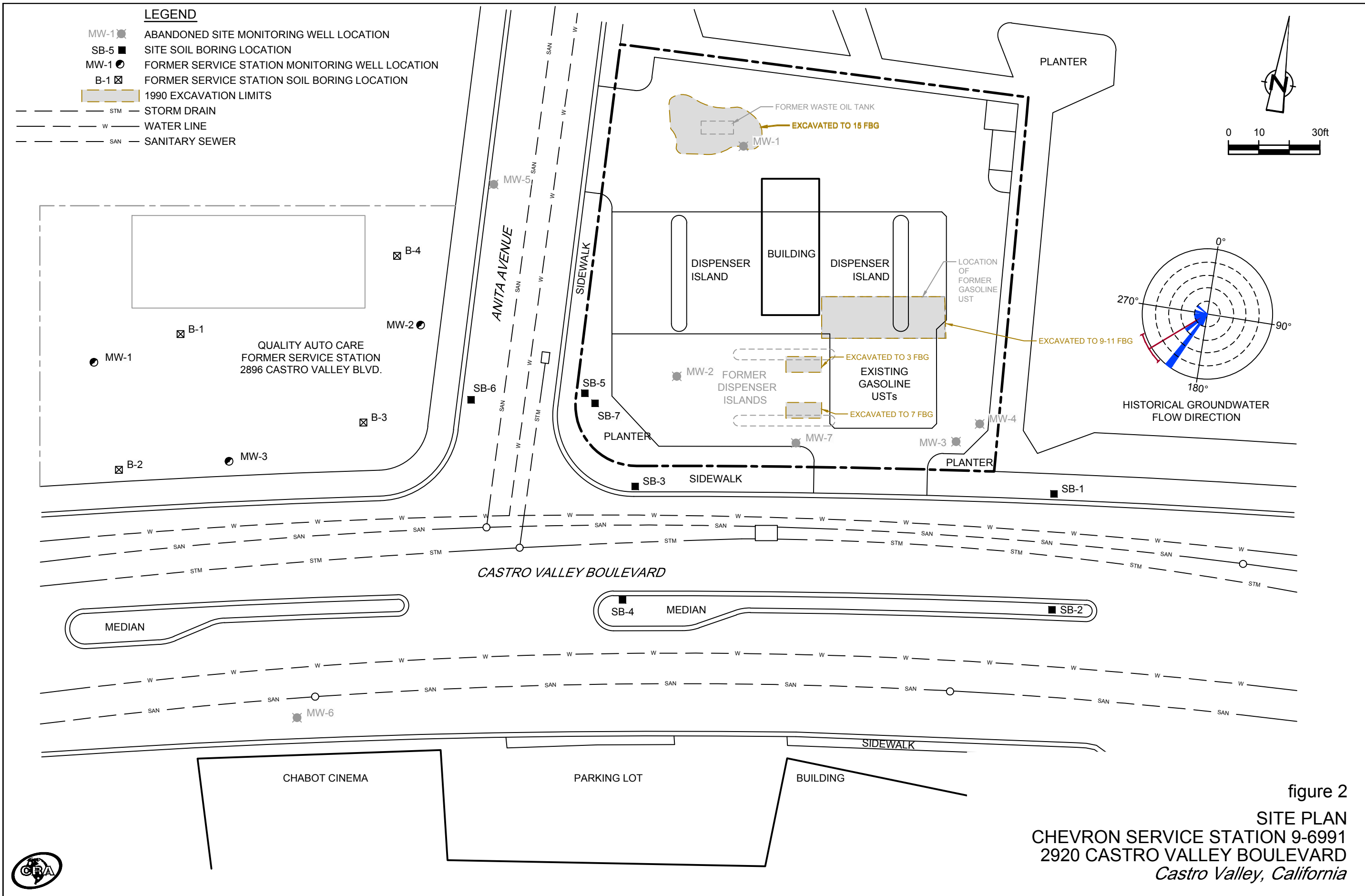

Attachment A

ACEH Correspondence

ALAMEDA COUNTY
HEALTH CARE SERVICES
AGENCY
ALEX BRISCOE, Agency Director



ENVIRONMENTAL HEALTH DEPARTMENT
ENVIRONMENTAL PROTECTION
1131 Harbor Bay Parkway, Suite 250
Alameda, CA 94502-6577
(510) 567-6700
FAX (510) 337-9335

July 26, 2013

Mr. Brian Waite
Chevron Environmental Management Company
6101 Bollinger Canyon Road
San Ramon, CA 94583
(Sent via electronic mail to:
BWaite@chevron.com)

Mr. Jack Edwards
2920 Castro Valley Boulevard
Castro Valley, CA 94546

Surinder Pal Goswamy
2920 Castro Valley Boulevard
Castro Valley, CA 94546

K&K Petroleum LLC
6071 Laurel Creek Road
Pleasanton, CA 94588

Subject: Monitoring Well Decommissioning for Case Closure of Fuel Leak Case No. RO0000475 and Geotracker Global ID T0600100324, Chevron #9-6991, 2920 Castro Valley Boulevard, CA 94546

Dear Messrs. Waite, Edwards, and Goswamy, and K&K Petroleum:

Alameda County Environmental Health (ACEH) and California Regional Water Quality Control Board staff have reviewed the fuel leak case file and case closure summary for the above-referenced site and concur that no further action related to the underground storage tank fuel release is required at this time. Prior to issuance of a remedial action completion certificate, monitoring wells at the site must be properly destroyed, per California Water Code and all current record owners of fee title to the site must be notified by the primary or active responsible party of the proposed closure action.

Site Management Requirements

ACEH is currently assessing whether site management requirements are applicable to this site and will notify Responsible Parties in a separate communication.

Monitoring Well Destruction

ACEH requests that you contact Alameda County Public Works Agency at (510) 567-6791 to obtain the necessary permits, decommission the well, and electronically upload the well destruction report to ACEH's ftp server and the State Water Resources Control Board's GeoTracker website within forty five (60) days from the date of this letter.

Upon our receipt of the report of well decommissioning, (which includes confirmation of investigation derived waste disposal) this office will issue you the remedial action completion certificate.

NOTIFICATION OF FIELDWORK ACTIVITIES

Please schedule and complete the fieldwork activities by the date specified below and provide ACEH with at least three (3) business days notification prior to conducting the fieldwork.

TECHNICAL REPORT REQUEST

Please submit the following deliverable to ACEH (Attention: Mark Detterman), according to the following schedule:

- **September 26, 2013** – Well Destruction Report

Should you have any questions, please contact me at (510) 567-6876 or send me an electronic mail message at mark.detterman@acgov.org.

Sincerely,



Digitally signed by Mark Detterman
DN: cn=Mark Detterman, o, ou,
email=mark.detterman@acgov.org, c=US
Date: 2013.07.26 13:12:57 -07'00'

Mark E. Detterman, PG, CEG
Senior Hazardous Materials Specialist

Enclosures: Attachment 1 – Responsible Party (ies) Legal Requirements / Obligations
Electronic Report Upload (ftp) Instructions

cc: James Kiernan, 10969 Trade Center Drive, Suite 106, Rancho Cordova, CA 95670
(sent via electronic mail to jkiernan@croworld.com)

Donna Drogos, ACEH, (sent via electronic mail to donna.drogos@acgov.org)
Dilan Roe (Sent via electronic mail to dilan.roe@acgov.org)
Mark Detterman, ACEH, (sent via electronic mail to mark.detterman@acgov.org)
Geotracker, Electronic File

ATTACHMENT 1

**Responsible Party(ies) Legal Requirements/Obligations
& ACEH Electronic Report Upload (ftp) Instructions**

Attachment 1

Responsible Party(ies) Legal Requirements/Obligations

REPORT/DATA REQUESTS

These reports/data are being requested pursuant to Division 7 of the California Water Code (Water Quality), Chapter 6.7 of Division 20 of the California Health and Safety Code (Underground Storage of Hazardous Substances), and Chapter 16 of Division 3 of Title 23 of the California Code of Regulations (Underground Storage Tank Regulations).

ELECTRONIC SUBMITTAL OF REPORTS

ACEH's Environmental Cleanup Oversight Programs (Local Oversight Program [LOP] for unauthorized releases from petroleum Underground Storage Tanks [USTs], and Site Cleanup Program [SCP] for unauthorized releases of non-petroleum hazardous substances) require submission of reports in electronic format pursuant to Chapter 3 of Division 7, Sections 13195 and 13197.5 of the California Water Code, and Chapter 30, Articles 1 and 2, Sections 3890 to 3895 of Division 3 of Title 23 of the California Code of Regulations (23 CCR). Instructions for submission of electronic documents to the ACEH FTP site are provided on the attached "Electronic Report Upload Instructions."

Submission of reports to the ACEH FTP site is in addition to requirements for electronic submittal of information (ESI) to the State Water Resources Control Board's (SWRCB) Geotracker website. In April 2001, the SWRCB adopted 23 CCR, Division 3, Chapter 16, Article 12, Sections 2729 and 2729.1 (Electronic Submission of Laboratory Data for UST Reports). Article 12 required electronic submittal of analytical laboratory data submitted in a report to a regulatory agency (effective September 1, 2001), and surveyed locations (latitude, longitude and elevation) of groundwater monitoring wells (effective January 1, 2002) in Electronic Deliverable Format (EDF) to Geotracker. Article 12 was subsequently repealed in 2004 and replaced with Article 30 (Electronic Submittal of Information) which expanded the ESI requirements to include electronic submittal of any report or data required by a regulatory agency from a cleanup site. The expanded ESI submittal requirements for petroleum UST sites subject to the requirements of 23 CCR, Division 3, Chapter 16, Article 11, became effective December 16, 2004. All other electronic submittals required pursuant to Chapter 30 became effective January 1, 2005. Please visit the SWRCB website for more information on these requirements. (http://www.waterboards.ca.gov/water_issues/programs/ust/electronic_submittal/)

PERJURY STATEMENT

All work plans, technical reports, or technical documents submitted to ACEH must be accompanied by a cover letter from the responsible party that states, at a minimum, the following: "I declare, under penalty of perjury, that the information and/or recommendations contained in the attached document or report is true and correct to the best of my knowledge." This letter must be signed by an officer or legally authorized representative of your company. Please include a cover letter satisfying these requirements with all future reports and technical documents submitted for this fuel leak case.

PROFESSIONAL CERTIFICATION & CONCLUSIONS/RECOMMENDATIONS

The California Business and Professions Code (Sections 6735, 7835, and 7835.1) requires that work plans and technical or implementation reports containing geologic or engineering evaluations and/or judgments be performed under the direction of an appropriately registered or certified professional. For your submittal to be considered a valid technical report, you are to present site specific data, data interpretations, and recommendations prepared by an appropriately licensed professional and include the professional registration stamp, signature, and statement of professional certification. Please ensure all that all technical reports submitted for this fuel leak case meet this requirement.

UNDERGROUND STORAGE TANK CLEANUP FUND

Please note that delays in investigation, late reports, or enforcement actions may result in your becoming ineligible to receive grant money from the state's Underground Storage Tank Cleanup Fund (Senate Bill 2004) to reimburse you for the cost of cleanup.

AGENCY OVERSIGHT

If it appears as though significant delays are occurring or reports are not submitted as requested, we will consider referring your case to the Regional Board or other appropriate agency, including the County District Attorney, for possible enforcement actions. California Health and Safety Code, Section 25299.76 authorizes enforcement including administrative action or monetary penalties of up to \$10,000 per day for each day of violation.

Alameda County Environmental Cleanup Oversight Programs (LOP and SCP)	REVISION DATE: July 25, 2012
	ISSUE DATE: July 5, 2005
	PREVIOUS REVISIONS: October 31, 2005; December 16, 2005; March 27, 2009; July 8, 2010
SECTION: Miscellaneous Administrative Topics & Procedures	SUBJECT: Electronic Report Upload (ftp) Instructions

The Alameda County Environmental Cleanup Oversight Programs (petroleum UST and SCP) require submission of all reports in electronic form to the county's FTP site. Paper copies of reports will no longer be accepted. The electronic copy replaces the paper copy and will be used for all public information requests, regulatory review, and compliance/enforcement activities.

REQUIREMENTS

- Please **do not** submit reports as attachments to electronic mail.
- Entire report including cover letter must be submitted to the ftp site as a **single Portable Document Format (PDF) with no password protection**.
- It is **preferable** that reports be converted to PDF format from their original format, (e.g., Microsoft Word) rather than scanned.
- **Signature pages and perjury statements must be included and have either original or electronic signature.**
- **Do not password protect the document.** Once indexed and inserted into the correct electronic case file, the document will be secured in compliance with the County's current security standards and a password. **Documents with password protection will not be accepted.**
- Each page in the PDF document should be rotated in the direction that will make it easiest to read on a computer monitor.
- Reports must be named and saved using the following naming convention:

RO#_Report Name_Year-Month-Date (e.g., RO#5555_WorkPlan_2005-06-14)

Submission Instructions

- 1) Obtain User Name and Password
 - a) Contact the Alameda County Environmental Health Department to obtain a User Name and Password to upload files to the ftp site.
 - i) Send an e-mail to loptoxic@acgov.org
 - b) In the subject line of your request, be sure to include "**ftp PASSWORD REQUEST**" and in the body of your request, include the **Contact Information, Site Addresses, and the Case Numbers (RO# available in Geotracker) you will be posting for.**
- 2) Upload Files to the ftp Site
 - a) Using Internet Explorer (IE4+), go to [://alcoftp1.acgov.org](http://alcoftp1.acgov.org)
 - (i) Note: Netscape, Safari, and Firefox browsers will not open the FTP site as they are NOT being supported at this time.
 - b) Click on Page located on the Command bar on upper right side of window, and then scroll down to Open FTP Site in Windows Explorer.
 - c) Enter your User Name and Password. (Note: Both are Case Sensitive.)
 - d) Open "My Computer" on your computer and navigate to the file(s) you wish to upload to the ftp site.
 - e) With both "My Computer" and the ftp site open in separate windows, drag and drop the file(s) from "My Computer" to the ftp window.
- 3) Send E-mail Notifications to the Environmental Cleanup Oversight Programs
 - a) Send email to loptoxic@acgov.org notify us that you have placed a report on our ftp site.
 - b) Copy your Caseworker on the e-mail. Your Caseworker's e-mail address is the entire first name then a period and entire last name @acgov.org. (e.g., firstname.lastname@acgov.org)
 - c) The subject line of the e-mail must start with the RO# followed by **Report Upload**. (e.g., Subject: RO1234 Report Upload) If site is a new case without an RO#, use the street address instead.
 - d) If your document meets the above requirements and you follow the submission instructions, you will receive a notification by email indicating that your document was successfully uploaded to the ftp site.

Attachment B

Approved Permits

Alameda County Public Works Agency - Water Resources Well Permit

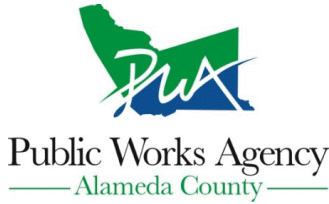

399 Elmhurst Street
Hayward, CA 94544-1395
Telephone: (510)670-6633 Fax:(510)782-1939

Application Approved on: 04/23/2014 By jamesy

Permit Numbers: W2014-0397 to W2014-0403
Permits Valid from 04/28/2014 to 05/02/2014

Application Id: 1396466431836
Site Location: 2920 Castro Valley Boulevard
Project Start Date: 04/28/2014
Assigned Inspector: Contact Steve Miller at (510) 670-5517 or stevem@acpwa.org

City of Project Site: Castro Valley

Completion Date: 05/02/2014

Applicant: Conestoga-Rovers & Associates - Bridget Floyd
10969 Trade Center Drive, Suite 107, Rancho Cordova, CA, CA
Property Owner: K & K PETROLEUM LLC
6071 LAUREL CREEK DR, PLEASANTON, CA 94588
Client: Chevron 96991
6101 Bollinger Canyon Rd., San Ramon, CA 94583
Contact: Nate Allen

Phone: 916-889-8900 x132
95670
Phone: --
Phone: --
Phone: 916-889-8900 x129
Cell: --

Total Due: \$2779.00
Receipt Number: WR2014-0152 Total Amount Paid: \$2779.00
Payer Name : Nathan S Allen Paid By: VISA **PAID IN FULL**

Works Requesting Permits:

Well Destruction-Monitoring - 7 Wells
Driller: PeneCore Drilling - Lic #: 906899 - Method: press

Work Total: \$2779.00

Specifications

Permit #	Issued Date	Expire Date	Owner Well Id	Hole Diam.	Casing Diam.	Seal Depth	Max. Depth	State Well #	Orig. Permit #	DWR #
W2014-0397	04/23/2014	07/27/2014	MW-1	2.00 in.	0.75 in.	2.00 ft	18.00 ft	3S/2N04R1 4	91504	Logs Only
W2014-0398	04/23/2014	07/27/2014	MW-2	2.00 in.	0.75 in.	3.00 ft	21.00 ft	3S/2N04R1 5	91504	Logs Only
W2014-0399	04/23/2014	07/27/2014	MW-3	2.00 in.	0.75 in.	2.00 ft	20.00 ft	3S/2N04R1 6	91504	Logs Only
W2014-0400	04/23/2014	07/27/2014	MW-4	8.00 in.	2.00 in.	2.50 ft	20.00 ft	3S/2N04R	92122	No Records
W2014-0401	04/23/2014	07/27/2014	MW-5	8.00 in.	2.00 in.	3.00 ft	20.00 ft	3S/2N04R	92122	No Records
W2014-0402	04/23/2014	07/27/2014	MW-6	8.00 in.	2.00 in.	6.00 ft	26.50 ft	3S/2N04R	92122	No Records
W2014-0403	04/23/2014	07/27/2014	MW-7	8.00 in.	2.00 in.	4.00 ft	21.50 ft	3S/2N04R	92122	No Records

Specific Work Permit Conditions

1. Drilling Permit(s) can be voided/ cancelled only in writing. It is the applicant's responsibility to notify Alameda County Public Works Agency, Water Resources Section in writing for an extension or to cancel the drilling permit application. No drilling permit application(s) shall be extended beyond ninety (90) days from the original start date. Applicants may not cancel a drilling permit application after the completion date of the permit issued has passed.

2. Prior to any drilling activities, it shall be the applicant's responsibility to contact and coordinate an Underground Service Alert (USA), obtain encroachment permit(s), excavation permit(s) or any other permits or agreements required for that Federal, State, County or City, and follow all City or County Ordinances. No work shall begin until all the permits and requirements have been approved or obtained. It shall also be the applicants responsibilities to provide to the Cities or to Alameda County an Traffic Safety Plan for any lane closures or detours planned. No work shall begin until all the

Alameda County Public Works Agency - Water Resources Well Permit

permits and requirements have been approved or obtained.

3. Compliance with the well-sealing specifications shall not exempt the well-sealing contractor from complying with appropriate State reporting-requirements related to well construction or destruction (Sections 13750 through 13755 (Division 7, Chapter 10, Article 3) of the California Water Code). Contractor must complete State DWR Form 188 and mail original to the Alameda County Public Works Agency, Water Resources Section, within 60 days. Include permit number and site map.
4. Applicant shall submit the copies of the approved encroachment permit to this office within 60 days.
5. Permittee shall assume entire responsibility for all activities and uses under this permit and shall indemnify, defend and save the Alameda County Public Works Agency, its officers, agents, and employees free and harmless from any and all expense, cost and liability in connection with or resulting from the exercise of this Permit including, but not limited to, property damage, personal injury and wrongful death.
6. Applicant shall contact Steve Miller for an inspection time at (510) 670-5517 or email to stevem@acpwa.org at least five (5) working days prior to starting, once the permit has been approved. Confirm the scheduled date(s) at least 24 hours prior to drilling.
7. Permittee, permittee's contractors, consultants or agents shall be responsible to assure that all material or waters generated during drilling, boring destruction, and/or other activities associated with this Permit will be safely handled, properly managed, and disposed of according to all applicable federal, state, and local statutes regulating such. In no case shall these materials and/or waters be allowed to enter, or potentially enter, on or off-site storm sewers, dry wells, or waterways or be allowed to move off the property where work is being completed.
8. Remove the Christy box or similar structure.

Destroy well by grouting neat cement with a tremie pipe or pressure grouting (25 psi for 5min.) to the bottom of the well and by filling with neat cement to three (3-5) feet below surface grade. Allow the sealing material to spill over the top of the casing to fill any annular space between casing and soil.

After the seal has set, backfill the remaining hole with concrete or compacted material to match existing conditions.

9. Remove the Christy box or similar structure. Destroy wells MW-1, MW-2 and MW-3 by overdrilling to total depth & Tremie Grouting with Cement. After the seal has set, backfill the remaining hole with concrete or compacted material to match existing.
10. Remove the Christy box or similar structure. Destroy wells MW-5 and MW-6 by overdrilling the upper 5ft. bgs & Tremie Grouting with Cement. After the seal has set, backfill the remaining hole with concrete or compacted material to match existing. Note: Wells can be grouted first and then overdrilled later also.
11. Remove the Christy box or similar structure. Destroy all other wells by grouting neat cement with a tremie pipe or pressure grouting (25 psi for 5min.) to the bottom of the well and by filling with neat cement to three (3-5) feet below surface grade. Allow the sealing material to spill over the top of the casing to fill any annular space between casing and soil. After the seal has set, backfill the remaining hole with concrete or compacted material to match existing conditions.
12. Copy of approved drilling permit must be on site at all times. Failure to present or show proof of the approved permit application on site shall result in a fine of \$500.00.

Austin, Elizabeth (Charley)

From: Miller, Steve [stevem@acpwa.org]
Sent: Monday, April 21, 2014 4:18 PM
To: Austin, Elizabeth (Charley)
Subject: RE: Variance/change in permit requested for 2920 Castro Valley Blvd

Hi Charley,

I looked over the ULS report and will allow the wells in question to be pressure grouted accordingly, as "on-site" amendments to the permit as issued by James. As for the permit itself, it appears ready to be approved. Did you submit the encroachment permit to James yet?

Steve

From: Austin, Elizabeth (Charley) [<mailto:eaustin@croworld.com>]
Sent: Monday, April 21, 2014 2:15 PM
To: Miller, Steve
Subject: Variance/change in permit requested for 2920 Castro Valley Blvd

Hey Steve,

I hope all is well! I'm requesting a variance for some of the wells located at 2920 Castro Valley Blvd, Castro Valley, CA. The online well permit application is 1396466431836. I'm requesting to only pressure grout MW-1, MW-2, MW-5, and MW-6 due to proximity to underground lines. Please see the attached geophysical survey for information regarding utility conflicts.

Also, what is the status of this application? We have the work planned for next week, so I need to verify that we will have the permit by then and also setup the inspection with you.

Thank you!

Charley Austin
Conestoga-Rovers & Associates (CRA)
2300 Clayton Road, Suite 920
Concord, California 94520
Phone: 925.849.1017
Fax: 925.849.1040
Email: caustin@croworld.com
www.croworld.com



Think before you print 🖨️ **Perform every task the safe way, the right way, every time!**

This communication and any accompanying document(s) are confidential and are intended for the sole use of the addressee. If you are not the intended recipient, please notify me at the telephone number shown above or by return e-mail and delete this e-mail and any copies. You are advised that any disclosure, copying, distribution, or the taking of any action in reliance upon the communication without consent is strictly prohibited. Thank you.

Work Order Number:* 80001
 *This WO is ___ / is not open for charges.

Permit Number: R14 LD 13250
 Permit Issuance Date: 4/23/14
 Permit Expiration Date: 6/23/14

**COUNTY OF ALAMEDA PUBLIC WORKS AGENCY
 ROADWAY ENCROACHMENT PERMIT**

This Permit is issued in accordance with Chapter 12.08 of the Alameda County General Ordinance Code

Name & Address of Property Owner:
 K&K Petroleum LLC
 6071 Laurel Creek Dr.
 Pleasanton, CA 94588

Job Site Address:
 2920 Castro Valley Blvd
 Castro Valley, CA 94546

Phone Number:
Name & Address of Contractor:
 Penecore Drilling
 220 N. EAST STREET
 Woodland, CA 95776
Phone Number: 530-681-3198

(This statement to be completed by the Agency)
 This permit is issued to the owner ___ / contractor ;
 if "owner" is checked, he/she is ___ / is not ___ exempt
 from the requirement that work in the roadway be
 performed by a licensed contractor.

+ Conestoga-Rovers & Associates (CRA), 10969 Trade Center Dr, Ste 107, Rancho Cordova
 The Applicant intends to perform the following work scope:

Destroy 2 monitoring wells (MW-5 and MW-6) by pressure
 grouting and overdrilling the top 5', then removing the well
 vault

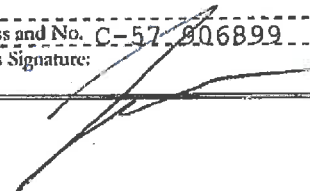
Licensed Contractor Declaration:
 I hereby affirm, under penalty of perjury, that I hold the
 following contractor's license, which is in full force and
 effect, under the applicable provisions of the State
 Business and Professions Code.
 License Class and No. C-57-806899
 Contractor's Signature: 

Worker's Compensation Insurance Declaration:
 I hereby affirm, under penalty of perjury, that I will, during
 the performance of any and all work authorized by this
 permit, satisfy the requirements of the State Labor Code
 with regard to Worker's Compensation Insurance, as
 declared below:
 ___ I will maintain a certificate of consent to self-insure.
 I will maintain the following insurance policy:
 Carrier's Name and Policy No.: WIND BUSINESS
WESTCO INSURANCE COMPANY
 ___ I will not employ any person in any manner so as to become
 subject to the worker's compensation laws of the State.
 Owner's/Contractor's Signature: 

All work and/or access shall be performed in accordance with the requirements of Chapter 12.08 and,
 unless otherwise specified below, shall be fully compliant with each of the terms and conditions of the
 attached General Provisions:

JAMES YOO

CALL THIS NUMBER FOR INSPECTIONS: 510 670 6632

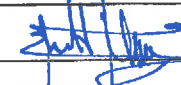
Bond Information:
 BY: 
 BY: , Alameda County

Insp. Fee or Deposit \$99.
\$225
 Work Completed (Date): _____
 Inspector: _____

I certify that the information that I have entered into this permit application is correct, and I agree to comply with all of the
 terms and conditions and other requirements of the issued Permit.
Charles [Signature] 4/18/14
 Signature of Applicant Date

THIS PERMIT IS INCOMPLETE WITHOUT THE ATTACHED GENERAL PROVISIONS

Attachment C

Standard Field Procedures

STANDARD FIELD PROCEDURES FOR WELL AND VAPOR PROBE DESTRUCTION

This document presents standard field procedures for properly destroying groundwater monitoring wells. The objective of well destruction is to destroy wells in a manner that is protective of potential water resources. The two procedures most commonly used are pressure grouting and drilling out the well. These procedures are designed to comply with Federal, State and local regulatory guidelines. Specific field procedures are summarized below.

Well Pressure Grouting

Pressure grouting consists of injecting neat Portland cement through a tremie pipe under pressure to the bottom of the well. The cement is composed of about five gallons of water to a 94 pound sack of Portland I/II Cement. Once the well casing is full of grout, it is pressurized for five minutes by applying a pressure of 25 pounds per square inch (psi) with a grout pump. The well casing can also be pressurized by extending the well casing to the appropriate height and filling it with grout. In either case, the additional pressure allows the grout to be forced into the sand pack. After grouting the sand pack and casing, the well vault is removed and the area resurfaced or backfilled as required.

Well Drill Out

When well drill out is required, the well location is cleared for subsurface utilities and a hollow-stem auger (or other appropriate) drilling rig is used to drill out the well casing and filter pack materials. First, drill rods are placed down the well and used to guide the augers as they drill out the well. A guide auger is used in place of the drill rods if feasible. Once the well is drilled out, the boring is filled with Portland cement injected through the augers or a tremmie pipe under pressure to the bottom of the boring. The well vault is removed and the area resurfaced or backfilled as required.

Vapor Probe Destruction

Vapor probes are destroyed by manually removing the tubing from the ground. The probe construction material (sand pack and bentonite seal) are removed by either hand auger, air knife, or drill rig. The probe tubing and construction materials are stored in DOT approved containers for waste profiling and disposal. The open borings are backfilled with Portland Type I/II cement through a tremie pipe at the bottom of the boring. The probe vault is removed and the area resurfaced as required to match the existing surface conditions.

Waste Handling and Disposal

Soil cuttings from drilling activities are usually stockpiled onsite and covered by plastic sheeting. At least three individual soil samples are collected from the stockpiles and composited at the analytic laboratory. The composite sample is analyzed for the same constituents analyzed in the borehole samples in addition to any analytes required by the receiving disposal facility. Soil cuttings are transported by licensed waste haulers and disposed in secure, licensed facilities based on the composite analytic results.

Attachment D

Drum Disposal Manifest

NON-HAZARDOUS WASTE MANIFEST		1. Generator ID Number CAR000148688	2. Page 1 of 1	3. Emergency Response Phone (800) 424 6800	4. Waste Tracking Number WR2376-001
5. Generator's Name and Mailing Address Chevron Environmental Management Co. c/o Chevron Products Company Waste Dept P.O. Box 8004 San Ramon, CA 94583 Generator's Phone: (877) 388-6044			Generator's Site Address (if different than mailing address) Chevron 56381 2920 Castro Valley Blvd Castro Valley, CA 94546		
6. Transporter 1 Company Name BESL SHIRE			U.S. EPA ID Number CAR000148688		
7. Transporter 2 Company Name			U.S. EPA ID Number		
8. Designated Facility Name and Site Address Soil Site 12328 Hibiscus Ave Adelanto, CA 92301 Facility's Phone: (800) 852-5001			U.S. EPA ID Number		
9. Waste Shipping Name and Description		10. Containers		11. Total Quantity	12. Unit Wt./Vol.
		No.	Type		
1. Non DOT Regulated Material (Soil contaminated with petroleum products, non hazardous)		001	DM	300	P
2.					
3.					
4.					
13. Special Handling Instructions and Additional Information Process: Investigation and Remediation of Past Contamination BESI: 240151 ERG: N/A To be bulked in BESI yard WEAR LEVEL D PPE & SPLASH PROTECTION (IF APPLICABLE) BUSINESS UNIT: M&U SITE ID: 00801 WR2374 PROFILE #: 42701					
14. GENERATOR'S/OFFEROR'S CERTIFICATION: I hereby declare that the contents of this consignment are fully and accurately described above by the proper shipping name, and are classified, packaged, marked and labeled/placarded, and are in all respects in proper condition for transport according to applicable international and national governmental regulations.					
Generator's/Offeror's Printed/Typed Name Larry Monhart of BESL on behalf of generator		Signature 		Month Day Year 5/29/14	
15. International Shipments <input type="checkbox"/> Import to U.S. <input type="checkbox"/> Export from U.S. Port of entry/exit: _____ Date leaving U.S.: _____					
16. Transporter Acknowledgment of Receipt of Materials					
Transporter 1 Printed/Typed Name Larry Monhart		Signature 		Month Day Year 5/29/14	
Transporter 2 Printed/Typed Name		Signature		Month Day Year	
17. Discrepancy					
17a. Discrepancy Indication Space <input type="checkbox"/> Quantity <input type="checkbox"/> Type <input type="checkbox"/> Residue <input type="checkbox"/> Partial Rejection <input type="checkbox"/> Full Rejection					
Manifest Reference Number: _____ U.S. EPA ID Number					
17b. Alternate Facility (or Generator) _____ U.S. EPA ID Number					
Facility's Phone: _____					
17c. Signature of Alternate Facility (or Generator) _____ Month Day Year					
18. Designated Facility Owner or Operator: Certification of receipt of materials covered by the manifest except as noted in Item 17a					
Printed/Typed Name		Signature		Month Day Year	