

1680 ROGERS AVENUE
SAN JOSE, CA 95112-1105
(408) 573-7771 FAX
(408) 573-0555 PHONE

February 9, 1999

Phil Briggs
Chevron U.S.A. Products Company
P.O. Box 6004
San Ramon, CA 94583-0904

4th Quarter 1998 Monitoring at 9-6991

Fourth Quarter 1998 Groundwater Monitoring at
Chevron Service Station Number 9-6991
2920 Castro Valley Blvd.
Castro Valley, CA

Monitoring Performed on December 17, 1998...

Groundwater Sampling Report 981217-Z-4

This report covers the routine monitoring of groundwater wells at this Chevron facility. Blaine Tech Services, Inc.'s work at the site includes inspection, gauging, evacuation, purgewater containment, sample collection and sample handling in accordance with standard procedures that conform to Regional Water Quality Control Board requirements.

Routine field data collection includes depth to water, total well depth, thickness of any separate immiscible layer, water column volume, calculated volume of a three-case volume purge, elapsed evacuation time, total volume of water removed, and standard water parameter instrument readings. Sample material is collected, contained, stored, and transported to the laboratory in conformance with EPA standards. Purgewater is, likewise, collected and transported to McKittrick Waste Treatment Site for disposal.

Basic field information is presented alongside analytical values excerpted from the laboratory report in the cumulative table of **WELL DATA AND ANALYTICAL RESULTS**. The full analytical report for the most recent samples is located in the **Analytical Appendix**. The table also contains new groundwater elevation calculations taken from the computer plotted gradient map which is

located in the **Professional Engineering Appendix**.

At a minimum, Blaine Tech Services, Inc. field personnel are certified upon completion of a forty-hour Hazardous Materials and Emergency Response training course per 29 CFR 1910.120. Field personnel are also enrolled in annual eight hour refresher courses.

Blaine Tech Services, Inc. conducts sampling and documentation assignments of this type as an independent third party. In order to avoid compromising the objectivity necessary for the proper and disinterested performance of this work, Blaine Tech Services, Inc. concentrates on objective data collection and does not participate in the interpretation of analytical results, the definition of geological or hydrological conditions, the formulation of recommendations, or the marketing of remedial systems.

Please call if you have any questions.

Yours truly,

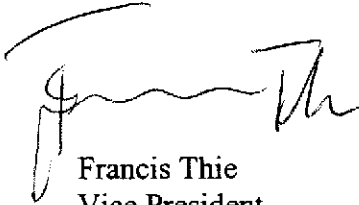

Francis Thie
Vice President

FPT/dg

attachments: Professional Engineering Appendix
Cumulative Table of Well Data and Analytical Results
Analytical Appendix
Field Data Sheets

Professional Engineering Appendix

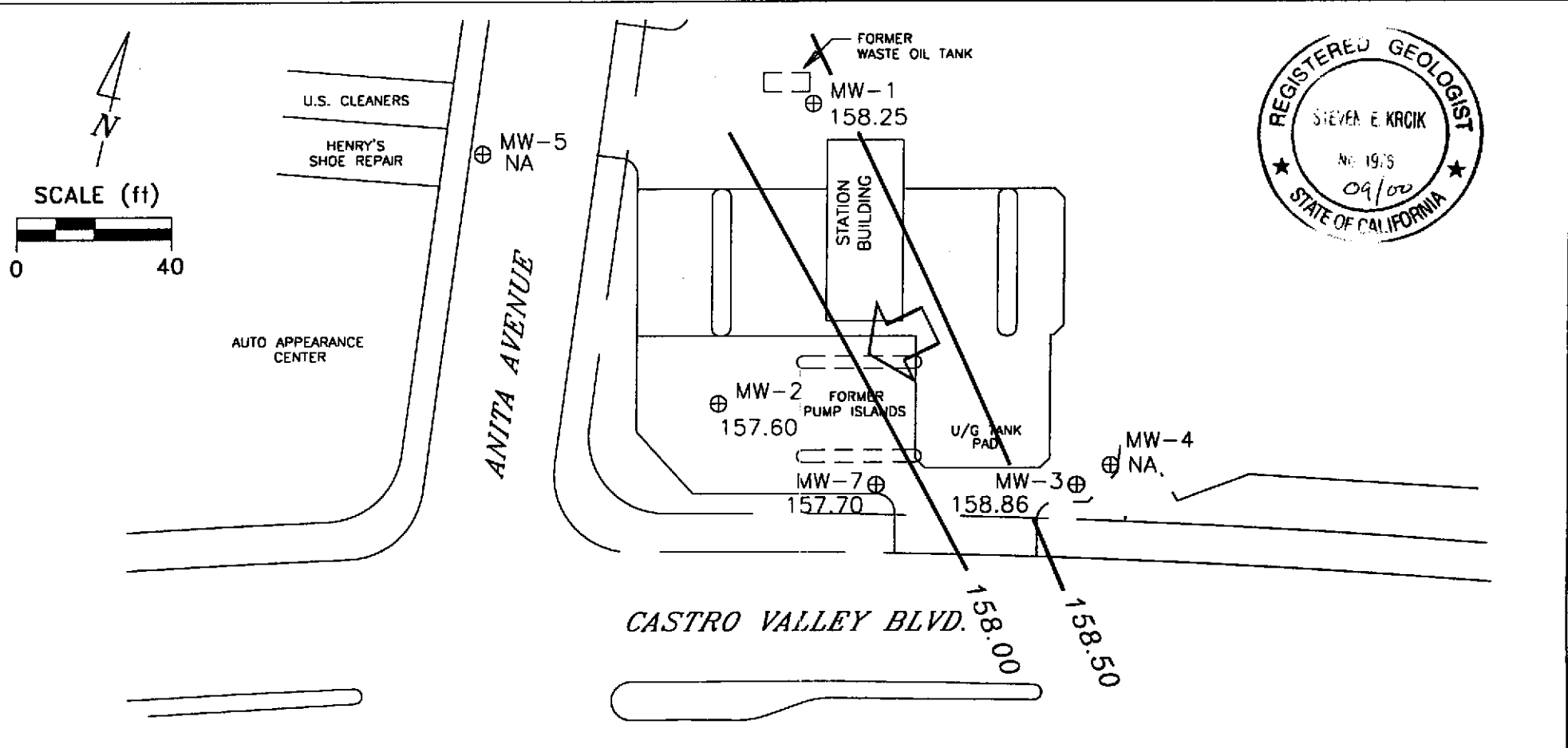

- EXPLANATION**
- ⊕ MONITORING WELL
 - 158.86 GROUNDWATER ELEVATION (FT, MSL)
 - 157.25 — GROUNDWATER ELEVATION CONTOUR (FT, MSL)
 - NA DATA NOT AVAILABLE
 - ↘ APPROXIMATE GROUNDWATER FLOW DIRECTION;
APPROXIMATE GRADIENT = 0.01

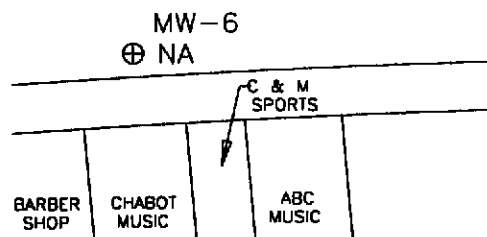

Basemap from Geoconsultants, Inc.

PREPARED BY

Chevron Station 9-6991
 2920 Castro Valley Boulevard
 Castro Valley, California

GROUNDWATER ELEVATION CONTOUR MAP,
DECEMBER 17, 1998

FIGURE:
 1
 PROJECT:
 DAC04

Table of Well Data and Analytical Results

Cumulative Table of Well Data and Analytical Results

Vertical Measurements are in feet.

Analytical results are in parts per billion (ppb)

DATE	Well Head Elev.	Ground Water Elev.	Depth To Water	Notes	TPH-Gasoline	Benzene	Toluene	Ethyl-Benzene	Xylene	MTBE	TPH-Diesel	TOG
MW-1												
10/08/91	169.30	158.20	11.10	--	230	45	<0.5	0.9	9.1	--	--	<5000
11/04/91	169.30	158.27	11.03	--	340	120	<0.5	<0.5	6.1	--	--	--
12/04/91	169.30	158.25	11.05	--	<50	3.9	<0.5	<0.5	<0.5	--	170	<5000
06/05/92	169.30	158.26	11.04	--	100	26	0.6	0.5	1.0	--	<50	--
10/27/92	169.30	158.20	11.10	--	<50	11	<0.5	<0.5	<0.5	--	54	--
12/30/92	169.30	--	--	--	<50	24	<0.5	<0.5	<0.5	--	170	--
01/27/93	169.30	158.67	10.63	--	--	--	--	--	--	--	--	--
03/05/93	169.30	--	--	--	<50	<0.5	<0.5	<0.5	<0.5	--	<50	--
03/17/93	169.30	158.59	10.71	--	--	--	--	--	--	--	--	--
06/18/93	169.30	158.29	11.01	--	<50	0.6	<0.5	<0.5	<1.5	--	<50	--
09/28/93	169.30	157.35	11.95	--	<50	0.8	<0.5	<0.5	<1.5	--	<50	--
12/30/93	169.30	158.34	10.96	--	<50	8.5	<0.5	<0.5	<0.5	--	<50	--
04/07/94	169.30	158.49	10.81	--	<50	<0.5	<0.5	<0.5	<0.5	--	<10	--
05/31/94	169.30	158.38	10.92	--	<50	1.0	<0.5	<0.5	<0.5	--	<50	--
09/23/94	169.30	158.40	10.90	--	<50	1.3	<0.5	<0.5	<0.5	--	<50	--
11/30/94	169.30	158.76	10.54	--	<50	8.9	<0.5	<0.5	<0.5	--	570*	--
03/30/95	169.30	158.60	10.70	--	<50	<0.5	<0.5	<0.5	<0.5	--	110**	--
06/06/95	169.30	158.38	10.92	--	61	15	<0.5	<0.5	<0.5	--	570**	--
09/25/95	169.30	158.30	11.00	--	<50	4.7	<0.5	<0.5	<0.5	--	550**	--
12/28/95	169.30	158.50	10.80	--	72	9.1	0.65	<0.5	<0.5	6.0	330**	--
03/05/96	169.30	159.20	10.10	Sampled annually	<50	7.8	<0.5	<0.5	<0.5	<2.5	780**	--
09/13/96	169.30	158.28	11.02	--	--	--	--	--	--	--	--	--
12/19/96	169.30	158.08	11.22	--	--	--	--	--	--	--	--	--
03/20/97	169.30	158.40	10.90	--	<50	2.2	<0.5	<0.5	<0.5	<2.5	350**	--
06/27/97	169.30	158.27	11.03	--	--	--	--	--	--	--	--	--
09/19/97	169.30	158.34	10.96	--	--	--	--	--	--	--	--	--
12/05/97	169.30	158.62	10.68	--	--	--	--	--	--	--	--	--
03/31/98	169.30	158.67	10.63	--	<50	6.7	<0.5	<0.5	<0.5	<2.5	760**	--
06/19/98	169.30	159.62	9.68	--	--	--	--	--	--	--	--	--
08/13/98	169.30	157.67	11.63	--	--	--	--	--	--	--	--	--
12/17/98	169.30	158.25	11.05	--	--	--	--	--	--	--	--	--

* Chromatogram pattern indicates a non-diesel mix.

** Chromatogram pattern indicates an unidentified hydrocarbon.

Cumulative Table of Well Data and Analytical Results

Vertical Measurements are in feet.

Analytical results are in parts per billion (ppb)

DATE	Well Head Elev.	Ground Water Elev.	Depth To Water	Notes	TPH-Gasoline	Benzene	Toluene	Ethyl-Benzene	Xylene	MTBE	TPH-Diesel	TOG
MW-2												
10/08/91	169.15	157.20	11.95	--	110	5.1	1.1	0.8	26	--	--	--
11/19/91	169.15	157.40	11.75	--	120	11	1.1	<0.5	17	--	--	--
12/04/91	169.15	157.35	11.80	--	440	30	2.5	<0.5	52	--	130	--
06/05/92	169.15	157.35	11.80	--	80	13	<0.5	<0.5	1.0	--	130	--
10/27/92	169.15	157.15	12.00	--	54	13	<0.5	<0.5	<0.5	--	110	--
12/30/92	169.15	--	--	--	180	30	<0.5	<0.5	1.0	--	92	--
01/27/93	169.15	158.24	10.91	--	--	--	--	--	--	--	--	--
03/05/93	169.15	--	--	--	<50	<0.5	<0.5	<0.5	<0.5	--	<50	--
03/17/93	169.15	158.26	10.89	--	--	--	--	--	--	--	--	--
06/18/93	169.15	157.41	11.74	--	<50	1.4	<0.5	<0.5	<1.5	--	<50	--
09/28/93	169.15	157.97	11.18	--	<50	0.6	<0.5	<0.5	<1.5	--	<50	--
12/30/93	169.15	158.34	21.00	--	<50	0.9	<0.5	<0.5	<0.5	--	<50	--
04/07/94	169.15	158.40	10.75	--	<50	<0.5	<0.5	<0.5	<0.5	--	<10	--
05/31/94	169.15	158.35	10.80	--	<50	<0.5	<0.5	<0.5	<0.5	--	<50	--
09/23/94	169.15	157.50	11.65	--	<50	0.7	<0.5	<0.5	<0.5	--	120	--
11/30/94	169.15	158.41	10.74	--	55	2.9	<0.5	1.4	0.94	--	570*	--
03/30/95	169.15	158.25	10.90	--	91	4.5	<0.5	3.8	<0.5	--	430**	--
06/06/95	169.15	157.73	11.42	--	<50	<0.5	<0.5	<0.5	<0.5	--	410**	--
09/25/95	169.15	157.52	11.63	--	<50	<0.5	<0.5	<0.5	<0.5	--	220**	--
12/28/95	169.15	157.98	11.17	--	<2000	<20	<20	<20	<20	5000	120**	--
03/05/96	169.15	159.09	10.06	Sampled biannually	<2000	<20	<20	<20	<20	10,000	860**	--
09/13/96	169.15	157.37	11.78	--	1100	25	<10	<10	<10	20,000	1300	--
12/19/96	169.15	158.30	10.85	--	--	--	--	--	--	--	--	--
03/20/97	169.15	157.75	11.40	--	2400	<10	<10	46	<10	6200	190**	--
06/27/97	169.15	157.35	11.80	--	--	--	--	--	--	--	--	--
09/19/97	169.15	157.43	11.72	--	<50	<0.5	<0.5	<0.5	<0.5	280	60**	--
12/08/97	169.15	158.27	10.88	--	--	--	--	--	--	--	--	--
03/31/98	169.15	158.46	10.69	--	110	30	0.74	0.74	0.59	1000	220**	--
06/19/98	169.15	159.31	9.84	--	--	--	--	--	--	--	--	--
08/31/98	169.15	157.43	11.72	--	<100	3.4	<1.0	<1.0	<1.0	980	380**	--
12/17/98	169.15	157.60	11.55	--	--	--	--	--	--	490	--	--

* Chromatogram pattern indicates a non-diesel mix + discrete peaks.

** Chromatogram pattern indicates an unidentified hydrocarbon.

Cumulative Table of Well Data and Analytical Results

Vertical Measurements are in feet. Analytical results are in parts per billion (ppb)

DATE	Well Head Elev.	Ground Water Elev.	Depth To Water	Notes	TPH-Gasoline	Benzene	Toluene	Ethyl-Benzene	Xylene	MTBE	TPH-Diesel	TOG
MW-3												
10/08/91	169.11	160.84	8.27	--	81	1.9	0.7	0.8	2.4	--	--	--
11/04/91	169.11	158.26	10.85	--	60	<0.5	<0.5	<0.5	<0.5	--	--	--
12/04/91	169.11	158.06	11.05	--	<50	<0.5	<0.5	<0.5	<0.5	--	<50	--
06/05/92	169.11	157.96	11.15	--	<50	<0.5	<0.5	<0.5	<0.5	--	170	--
10/27/92	169.11	157.51	11.60	--	<50	<0.5	<0.5	<0.5	<0.5	--	120	--
12/30/92	169.11	--	--	--	<50	<0.5	<0.5	<0.5	<0.5	--	170	--
01/27/93	169.11	160.00	9.11	--	--	--	--	--	--	--	--	--
03/05/93	169.11	--	--	--	--	--	--	--	--	--	--	--
03/17/93	169.11	159.16	9.95	--	--	--	--	--	--	--	--	--
06/18/93	169.11	158.22	10.89	--	<50	<0.5	<0.5	<0.5	<1.5	--	<50	--
09/28/93	169.11	159.49	9.62	--	<50	<0.5	<0.5	<0.5	<1.5	--	<50	--
12/30/93	169.11	159.80	9.31	--	<50	<0.5	<0.5	<0.5	<0.5	--	<50	--
04/07/94	169.11	160.30	8.81	--	<50	<0.5	<0.5	<0.5	<0.5	--	<10	--
05/31/94	169.11	160.21	8.90	--	<50	<0.5	<0.5	<0.5	<0.5	--	<50	--
09/23/94	169.11	158.48	10.63	--	<50	<0.5	<0.5	<0.5	<0.5	--	<50	--
11/30/94	169.11	160.19	8.92	Inaccessible	--	--	--	--	--	--	--	--
03/30/95	169.11	160.01	9.10	--	<50	<0.5	<0.5	<0.5	<0.5	--	290*	--
06/06/95	169.11	158.79	10.32	--	<50	<0.5	<0.5	<0.5	<0.5	--	150*	--
09/25/95	169.11	158.11	11.00	--	<50	<0.5	<0.5	<0.5	<0.5	--	260*	--
12/28/95	169.11	158.96	10.15	--	<250	<2.5	<2.5	<2.5	<2.5	1400	200*	--
12/17/96	169.11	158.86	10.25	--	<250	<2.5	<2.5	<2.5	<2.5	62,000	130*	--

* Chromatogram pattern indicates an unidentified hydrocarbon.

Cumulative Table of Well Data and Analytical Results

Vertical Measurements are in feet.

Analytical results are in parts per billion (ppb)

DATE	Well Head Elev.	Ground Water Elev.	Depth To Water	Notes	TPH-Gasoline	Benzene	Toluene	Ethyl-Benzene	Xylene	MTBE	TPH-Diesel	TOG
MW-4												
10/27/92	169.18	157.79	11.39	--	<50	<0.5	0.6	0.5	4.3	--	<50	--
12/30/92	169.18	159.05	10.13	--	<50	<0.5	<0.5	<0.5	<0.5	--	<50	--
01/27/93	169.18	160.09	9.09	--	--	--	--	--	--	--	--	--
03/05/93	169.18	--	--	--	<50	<0.5	<0.5	<0.5	<0.5	--	<50	--
03/17/93	169.18	159.28	9.90	--	--	--	--	--	--	--	--	--
06/18/93	169.18	158.50	10.68	--	<50	<0.5	<0.5	<0.5	<1.5	--	<50	--
09/28/93	169.18	159.82	9.36	--	<50	<0.5	<0.5	<0.5	<1.5	--	<50	--
12/30/93	169.18	159.91	9.27	--	<50	<0.5	<0.5	<0.5	<0.5	--	<50	--
04/07/94	169.18	160.37	8.81	--	<50	<0.5	<0.5	<0.5	<0.5	--	<10	--
05/31/94	169.18	160.27	8.91	--	<50	<0.5	<0.5	<0.5	<0.5	--	<50	--
09/23/94	169.18	158.79	10.39	--	<50	<0.5	<0.5	<0.5	<0.5	--	<50	--
11/30/94	169.18	160.08	9.10	--	<50	<0.5	<0.5	<0.5	<0.5	--	58*	--
03/30/95	169.18	160.66	8.52	--	<50	<0.5	<0.5	<0.5	<0.5	--	61**	--
06/06/95	169.18	158.70	10.48	--	<50	<0.5	<0.5	<0.5	<0.5	--	<50	--
09/25/95	169.18	158.38	10.80	--	<50	<0.5	<0.5	<0.5	<0.5	--	<50	--
12/28/95	169.18	159.23	9.95	--	<50	<0.5	<0.5	<0.5	<0.5	9.9	<50	--

NO LONGER MONITORED OR SAMPLED

* Chromatogram pattern indicates a non-diesel mix.

** Chromatogram pattern indicates an unidentified hydrocarbon.

Cumulative Table of Well Data and Analytical Results

Vertical Measurements are in feet. Analytical results are in parts per billion (ppb)

DATE	Well Head Elev.	Ground Water Elev.	Depth To Water	Notes	TPH-Gasoline	Benzene	Toluene	Ethyl-Benzene	Xylene	MTBE	TPH-Diesel	TOG
MW-5												
10/27/92	167.41	157.46	9.95	--	74	<0.5	<0.5	0.6	7.1	--	<50	--
12/30/92	167.41	158.21	9.20	--	<50	<0.5	<0.5	<0.5	<0.5	--	<50	--
01/27/93	167.41	157.80	9.61	--	--	--	--	--	--	--	--	--
03/05/93	167.41	--	--	--	<50	<0.5	<0.5	<0.5	<0.5	--	<50	--
03/17/93	167.41	157.90	9.51	--	--	--	--	--	--	--	--	--
06/18/93	167.41	157.56	9.85	--	<50	<0.5	<0.5	<0.5	<0.5	--	<50	--
09/28/93	167.41	157.55	9.86	--	<50	<0.5	<0.5	<0.5	<1.5	--	<50	--
12/30/93	167.41	157.08	10.33	--	<50	<0.5	<0.5	<0.5	<0.5	--	<50	--
04/07/94	167.41	157.69	9.72	--	<50	<0.5	<0.5	<0.5	<0.5	--	<10	--
05/31/94	167.41	157.68	9.73	--	<50	<0.5	<0.5	<0.5	<0.5	--	<50	--
09/23/94	167.41	157.56	9.85	--	<50	<0.5	<0.5	<0.5	<0.5	--	<50	--
11/30/94	167.41	157.73	9.68	--	<50	<0.5	<0.5	<0.5	<0.5	--	79*	--
03/30/95	167.41	157.79	9.62	--	<50	<0.5	<0.5	<0.5	<0.5	--	<50	--
06/06/95	167.41	157.55	9.86	--	<50	<0.5	<0.5	<0.5	<0.5	--	<50	--
09/25/95	167.41	157.56	9.85	--	<50	<0.5	<0.5	<0.5	<0.5	--	<50	--
12/28/95	167.41	157.67	9.74	--	<50	<0.5	<0.5	<0.5	<0.5	<2.5	<50	--

NO LONGER MONITORED OR SAMPLED

MW-6

10/27/92	166.46	153.92	12.54	--	600	22	22	24	130	--	<50	--
12/30/92	166.46	156.26	10.20	--	1700	170	16	46	160	--	470	--
01/27/93	166.46	156.44	10.02	--	--	--	--	--	--	--	--	--
03/05/93	166.46	--	--	--	480	76	0.9	3.1	7.1	--	150	--
03/17/93	166.46	155.79	10.67	--	--	--	--	--	--	--	--	--
06/18/93	166.46	154.63	11.83	--	240	37	3.4	2.9	18	--	51	--
09/28/93	166.46	154.90	11.56	--	150	11	1.2	1.3	4.3	--	120	--
12/30/93	166.46	154.81	11.65	--	680	77	5.1	5.5	13	--	290	--
04/07/94	166.46	155.34	11.12	--	190	24	2.9	1.9	8.0	--	<10	--
05/31/94	166.46	--	--	--	--	--	--	--	--	--	--	--
09/23/94	166.46	155.05	11.41	--	--	--	--	--	--	--	--	--
11/30/94	166.46	156.58	9.88	--	320	49	0.58	1.4	1.2	--	150*	--

NO LONGER MONITORED OR SAMPLED.

* Chromatogram pattern indicates a non-diesel mix.

Cumulative Table of Well Data and Analytical Results

Vertical Measurements are in feet.

Analytical results are in parts per billion (ppb)

DATE	Well Head Elev.	Ground Water Elev.	Depth To Water	Notes	TPH-Gasoline	Benzene	Toluene	Ethyl-Benzene	Xylene	MTBE	TPH-Diesel	TOG
MW-7												
09/25/95	168.80	157.20	11.60	--	220	0.79	<0.5	0.67	<0.5	--	1400*	--
12/28/95	168.80	158.14	10.66	--	<50	<0.5	<0.5	<0.5	<0.5	<2.5	590*	--
03/05/96	168.80	159.74	9.06	--	1400	<10	<10	47	<10	5300	320*	--
06/27/96	168.80	157.27	11.53	--	<2500	<25	<25	<25	<25	14,000	630*	--
09/13/96	168.80	156.88	11.92	--	1100	26	<10	24	<10	20,000	1400	--
12/19/96	168.80	158.29	10.51	--	<5000	<50	<50	<50	<50	12,000	1100**	--
03/20/97	168.80	157.84	10.96	--	<1000	<10	<10	<10	<10	2100	1600**	--
03/20/97	168.80	157.84	10.96	Confirmation run	--	--	--	--	--	2000	--	--
06/27/97	168.80	157.02	11.78	--	2000	<20	<20	<20	<20	11,000	1600*	--
09/19/97	168.80	156.87	11.93	--	<1000	35	<10	<10	<10	13,000	1900*	--
12/05/97	168.80	158.40	10.40	--	2100	47	2.7	28	<2.5	15,000	1100*	--
03/31/98	168.80	158.89	9.91	--	410	4.0	0.61	2.2	<0.5	<2.5	780*	--
06/19/98	168.80	159.09	9.71	--	1100	16	<10	17	<10	12,000	480*	--
08/31/98	168.80	157.11	11.69	--	<500	350	22	<5.0	<5.0	47,000	580*	--
12/17/98	168.80	157.70	11.10	--	1800	<10	<10	24	<10	13,000	970	--
12/17/98	168.80	157.70	11.10	Confirmation run	--	--	--	--	--	14,000	--	--

* Chromatogram pattern indicates an unidentified hydrocarbon.

** Chromatogram pattern indicates an unidentified hydrocarbon and weathered diesel.

Cumulative Table of Well Data and Analytical Results

Vertical Measurements are in feet.

Analytical results are in parts per billion (ppb)

DATE	Well Head Elev.	Ground Water Elev.	Depth To Water	Notes	TPH-Gasoline	Benzene	Toluene	Ethyl-Benzene	Xylene	MTBE	TPH-Diesel	TOG
TRIP BLANK												
10/08/91	--	--	--	--	<50	<0.5	<0.5	<0.5	<0.5	--	--	--
11/04/91	--	--	--	--	<50	<0.5	<0.5	<0.5	<0.5	--	--	--
12/04/91	--	--	--	--	<50	<0.5	<0.5	<0.5	<0.5	--	<50	--
06/05/92	--	--	--	--	<50	<0.5	<0.5	<0.5	<0.5	--	--	--
12/30/92	--	--	--	--	<50	<0.5	<0.5	<0.5	<0.5	--	--	--
01/27/93	--	--	--	--	--	--	--	--	--	--	<50	--
03/05/93	--	--	--	--	<50	<0.5	<0.5	<0.5	<0.5	--	--	--
03/17/93	--	--	--	--	--	--	--	--	--	--	--	--
06/18/93	--	--	--	--	<50	<0.5	<0.5	<0.5	<1.5	--	--	--
09/28/93	--	--	--	--	<50	<0.5	<0.5	<0.5	<0.5	--	--	--
12/30/93	--	--	--	--	<50	<0.5	<0.5	<0.5	<0.5	--	--	--
04/07/94	--	--	--	--	<50	<0.5	<0.5	<0.5	<0.5	--	--	--
05/31/94	--	--	--	--	<50	<0.5	<0.5	<0.5	<0.5	--	--	--
09/23/94	--	--	--	--	<50	<0.5	<0.5	<0.5	<0.5	--	--	--
11/30/94	--	--	--	--	<50	<0.5	<0.5	<0.5	<0.5	--	--	--
03/30/95	--	--	--	--	<50	<0.5	<0.5	<0.5	<0.5	--	--	--
06/06/95	--	--	--	--	<50	<0.5	<0.5	<0.5	<0.5	--	--	--
09/25/95	--	--	--	--	<50	<0.5	<0.5	<0.5	<0.5	--	--	--
12/28/95	--	--	--	--	<50	<0.5	<0.5	<0.5	<0.5	--	--	--
03/05/96	--	--	--	--	<50	<0.5	<0.5	<0.5	<0.5	--	--	--
06/27/96	--	--	--	--	<50	<0.5	<0.5	<0.5	<0.5	--	--	--
09/13/96	--	--	--	--	<50	<0.5	<0.5	<0.5	<0.5	--	--	--
12/19/96	--	--	--	--	<50	<0.5	<0.5	<0.5	<0.5	<2.5	--	--
03/20/97	--	--	--	--	<50	<0.5	<0.5	<0.5	<0.5	<2.5	--	--
06/27/97	--	--	--	--	<50	<0.5	<0.5	<0.5	<0.5	<2.5	--	--
09/19/97	--	--	--	--	<50	<0.5	<0.5	<0.5	<0.5	<2.5	--	--
12/05/97	--	--	--	--	<50	<0.5	<0.5	<0.5	<0.5	<2.5	--	--

CONTINUED ON NEXT PAGE

Cumulative Table of Well Data and Analytical Results

Vertical Measurements are in feet. Analytical results are in parts per billion (ppb)

DATE	Well Head Elev.	Ground Water Elev.	Depth To Water	Notes	TPH-Gasoline	Benzene	Toluene	Ethyl-Benzene	Xylene	MTBE	TPH-Diesel	TOG
TRIP BLANK (CONT'D)												
03/31/98	--	--	--	--	<50	<0.5	<0.5	<0.5	<0.5	<2.5	--	--
06/19/98	--	--	--	--	<50	<0.5	<0.5	<0.5	<0.5	<2.5	--	--
08/31/98	--	--	--	--	<50	<0.5	<0.5	<0.5	<0.5	<2.5	--	--

Note: Blaine Tech Services, Inc. began routine monitoring of the groundwater wells at this site on November 1, 1994. Earlier field data and analytical results are drawn from the September 27, 1994 Groundwater Technology, Inc. report.

ABBREVIATIONS

TPH = Total Petroleum Hydrocarbons

MTBE = Methyl t-butyl Ether

TOG = Total Oil and Grease

Analytical Appendix



**Sequoia
Analytical**

680 Chesapeake Drive
404 N. Wiget Lane
819 Striker Avenue, Suite 8
1455 McDowell Blvd. North, Ste. D

Redwood City, CA 94063
Walnut Creek, CA 94598
Sacramento, CA 95834
Petaluma, CA 94954

(650) 364-9600 FAX (650) 364-9233
(925) 988-9600 FAX (925) 988-9673
(916) 921-9600 FAX (916) 921-0100
(707) 792-1865 FAX (707) 792-0342

Blaine Tech Services 1680 Rogers Avenue San Jose, CA 95112	Client Proj. ID: Chevron 9-6991/ 981217-Z4 Sample Descript: MW-2 Matrix: LIQUID Analysis Method: EPA 8260 Lab Number: 9812C50-01	Sampled: 12/17/98 Received: 12/18/98 Analyzed: 12/22/98 Reported: 01/06/99
--	--	---

QC Batch Number: MS122198MTBEH6A
Instrument ID: H6

Methyl t-Butyl Ether (MTBE)

Analyte	Detection Limit ug/L	Sample Results ug/L
Methyl t-Butyl Ether	8.4	480
Surrogates	Control Limits %	% Recovery
1,2-Dichloroethane-d4	76 114	98

Analytes reported as N.D. were not present above the stated limit of detection.

SEQUOIA ANALYTICAL - ELAP #1210

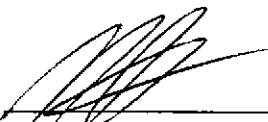

Mike Gregory
Project Manager





Sequoia Analytical

680 Chesapeake Drive
404 N. Wiget Lane
819 Striker Avenue, Suite 8
1455 McDowell Blvd. North, Ste. D

Redwood City, CA 94063
Walnut Creek, CA 94598
Sacramento, CA 95834
Petaluma, CA 94954

(650) 364-9600 FAX (650) 364-9233
(925) 988-9600 FAX (925) 988-9673
(916) 921-9600 FAX (916) 921-0100
(707) 792-1865 FAX (707) 792-0342

Blaine Tech Services 1680 Rogers Avenue San Jose, CA 95112	Client Proj. ID: Chevron 9-6991/ 981217-Z4 Sample Descript: MW-3 Matrix: LIQUID Analysis Method: 8015Mod/8020 Lab Number: 9812C50-02	Sampled: 12/17/98 Received: 12/18/98 Analyzed: 12/30/98 Reported: 01/06/99
Attention: Christine Lillie		

QC Batch Number: GC123098802009A
Instrument ID: HP9

Total Purgeable Hydrocarbons (TPPH) with BTEX and MTBE

Analyte	Detection Limit ug/L	Sample Results ug/L
TPPH as Gas	250	N.D.
Methyl t-Butyl Ether	50	62000
Benzene	2.5	N.D.
Toluene	2.5	N.D.
Ethyl Benzene	2.5	N.D.
Xylenes (Total)	2.5	N.D.
Chromatogram Pattern:		
Surrogates	Control Limits %	% Recovery
Trifluorotoluene	70 130	94

Analytes reported as N.D. were not present above the stated limit of detection.

SEQUOIA ANALYTICAL - ELAP #1271

Mike Gregory
Project Manager





**Sequoia
Analytical**

680 Chesapeake Drive
404 N. Wiget Lane
819 Striker Avenue, Suite 8
1455 McDowell Blvd. North. Ste. D

Redwood City, CA 94063
Walnut Creek, CA 94598
Sacramento, CA 95834
Petaluma, CA 94954

(650) 364-9600
(925) 988-9600
(916) 921-9600
(707) 792-1865

FAX (650) 364-9233
FAX (925) 988-9673
FAX (916) 921-0100
FAX (707) 792-0342

Blaine Tech Services 1680 Rogers Avenue San Jose, CA 95112	Client Proj. ID: Chevron 9-6991 / 981217-Z4 Sample Descript: MW-3 Matrix: LIQUID Analysis Method: EPA 8015 Mod Lab Number: 9812C50-02	Sampled: 12/17/98 Received: 12/18/98 Extracted: 12/28/98 Analyzed: 12/31/98 Reported: 01/06/99
--	---	--

QC Batch Number: GC1228980HBPEXC
Instrument ID: GCHP4A

Total Extractable Petroleum Hydrocarbons (TEPH)

Analyte	Detection Limit ug/L	Sample Results ug/L
TEPH as Diesel Chromatogram Pattern:	50 C9-C24	130 Unid.-HC
Surrogates	Control Limits %	% Recovery
n-Pentacosane (C25)	50 150	102

Analytes reported as N.D. were not present above the stated limit of detection.

SEQUOIA ANALYTICAL - ELAP #1210



Mike Gregory
Project Manager





Sequoia Analytical

680 Chesapeake Drive
404 N. Wiger Lane
819 Striker Avenue, Suite 8
1455 McDowell Blvd. North, Ste. D

Redwood City, CA 94063
Walnut Creek, CA 94598
Sacramento, CA 95834
Petalinga, CA 94954

(650) 364-9600
(925) 988-9600
(916) 921-9600
(707) 792-1865

FAX (650) 364-9233
FAX (925) 988-9673
FAX (916) 921-0100
FAX (707) 792-0342

Blaine Tech Services 1680 Rogers Avenue San Jose, CA 95112	Client Proj. ID: Chevron 9-6991/ 981217-Z4 Sample Descript: MW-7 Matrix: LIQUID Analysis Method: 8015Mod/8020 Lab Number: 9812C50-03	Sampled: 12/17/98 Received: 12/18/98 Analyzed: 12/29/98 Reported: 01/06/99
--	--	---

QC Batch Number: GC122998802009A
Instrument ID: HP9

Total Purgeable Hydrocarbons (TPPH) with BTEX and MTBE

Analyte	Detection Limit ug/L	Sample Results ug/L
TPPH as Gas	1000	1800
Methyl t-Butyl Ether	500	13000
Benzene	10	N.D.
Toluene	10	N.D.
Ethyl Benzene	10	24
Xylenes (Total)	10	N.D.
Chromatogram Pattern:		GAS
Surrogates	Control Limits %	% Recovery
Trifluorotoluene	70 130	95

Analytes reported as N.D. were not present above the stated limit of detection.

SEQUOIA ANALYTICAL - ELAP #1271

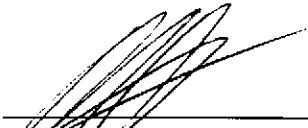

 Mike Gregory
 Project Manager





**Sequoia
Analytical**

680 Chesapeake Drive
404 N. Wiger Lane
819 Striker Avenue, Suite 8
1455 McDowell Blvd. North, Ste. D

Redwood City, CA 94063
Walnut Creek, CA 94598
Sacramento, CA 95834
Petaluma, CA 94954

(650) 364-9600
(925) 988-9600
(916) 921-9600
(707) 792-1865

FAX (650) 364-9233
FAX (925) 988-9673
FAX (916) 921-0100
FAX (707) 792-0342

Blaine Tech Services 1680 Rogers Avenue San Jose, CA 95112	Client Proj. ID: Chevron 9-6991 / 981217-Z4 Sample Descript: MW-7 Matrix: LIQUID Analysis Method: EPA 8260 Lab Number: 9812C50-03	Sampled: 12/17/98 Received: 12/18/98 Analyzed: 12/22/98 Reported: 01/06/99
--	---	---

QC Batch Number: MS122198MTBEH6A
Instrument ID: H6

Methyl t-Butyl Ether (MTBE)

Analyte	Detection Limit ug/L	Sample Results ug/L
Methyl t-Butyl Ether	166	14000
Surrogates	Control Limits %	% Recovery
1,2-Dichloroethane-d4	76 114	98

Analytes reported as N.D. were not present above the stated limit of detection.

SEQUOIA ANALYTICAL - ELAP #1210



Mike Gregory
Project Manager





**Sequoia
Analytical**

680 Chesapeake Drive
404 N. Wiget Lane
819 Striker Avenue, Suite 8
1455 McDowell Blvd. North, Ste. D

Redwood City, CA 94063
Walnut Creek, CA 94598
Sacramento, CA 95834
Petaluma, CA 94954

(650) 364-9600
(925) 988-9600
(916) 921-9600
(707) 792-1865

FAX (650) 364-9233
FAX (925) 988-9673
FAX (916) 921-0100
FAX (707) 792-0342

Blaine Tech Services
1680 Rogers Avenue
San Jose, CA 95112

Client Proj. ID: Chevron 9-6991 / 981217-Z4
Sample Descript: MW-7
Matrix: LIQUID
Analysis Method: EPA 8015 Mod
Lab Number: 9812C50-03

Sampled: 12/17/98
Received: 12/18/98
Extracted: 12/28/98
Analyzed: 12/31/98
Reported: 01/06/99

QC Batch Number: GC1228980HBPEXC
Instrument ID: GCHP4A

Total Extractable Petroleum Hydrocarbons (TEPH)

Analyte	Detection Limit ug/L	Sample Results ug/L
TEPH as Diesel Chromatogram Pattern:	50 C9-C24	970 W-diesel
Surrogates	Control Limits %	% Recovery
n-Pentacosane (C25)	50 150	96

Analytes reported as N.D. were not present above the stated limit of detection.

SEQUOIA ANALYTICAL - ELAP #1210

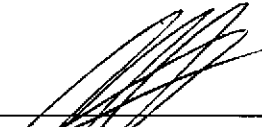

Mike Gregory
Project Manager





**Sequoia
Analytical**

680 Chesapeake Drive
404 N. Wiget Lane
819 Striker Avenue, Suite 8
1455 McDowell Blvd. North, Ste. D

Redwood City, CA 94063
Walnut Creek, CA 94598
Sacramento, CA 95834
Petaluma, CA 94954

(650) 364-9600
(925) 988-9600
(916) 921-9600
(707) 792-1865

FAX (650) 364-9233
FAX (925) 988-9673
FAX (916) 921-0100
FAX (707) 792-0342

Blaine Tech Services 1680 Rogers Avenue San Jose, CA 95112	Client Proj. ID: Chevron 9-6991 / 981217-Z4 Sample Descript: TB Matrix: LIQUID Analysis Method: 8015Mod/8020 Lab Number: 9812C50-04	Sampled: 12/17/98 Received: 12/18/98 Analyzed: 12/29/98 Reported: 01/06/99
--	---	---

QC Batch Number: GC122998802009A
Instrument ID: HP9

Total Purgeable Hydrocarbons (TPPH) with BTEX and MTBE

Analyte	Detection Limit ug/L	Sample Results ug/L
TPPH as Gas	50	N.D.
Methyl t-Butyl Ether	2.5	N.D.
Benzene	0.50	N.D.
Toluene	0.50	N.D.
Ethyl Benzene	0.50	N.D.
Xylenes (Total)	0.50	N.D.
Chromatogram Pattern:		

Surrogates	Control Limits %	% Recovery
Trifluorotoluene	70 130	96

Analytes reported as N.D. were not present above the stated limit of detection.

SEQUOIA ANALYTICAL - ELAP #1271



Mike Gregory
Project Manager





Sequoia
Analytical

680 Chesapeake Drive
404 N. Wiget Lane
819 Striker Avenue, Suite 8
1455 McDowell Blvd. North, Ste. D

Redwood City, CA 94063
Walnut Creek, CA 94598
Sacramento, CA 95834
Petaluma, CA 94954

(650) 364-9600
(925) 988-9600
(916) 921-9600
(707) 792-1865

FAX (650) 364-9233
FAX (925) 988-9673
FAX (916) 921-0100
FAX (707) 792-0342

Blaine Tech Services
1680 Rogers Avenue
San Jose, CA 95112
Attention: Christine Lillie

Client Proj. ID: Chevron 9-6991/ 981217-Z4

Received: 12/18/98

Lab Proj. ID: 9812C50

Reported: 01/06/99

LABORATORY NARRATIVE

In order to properly interpret this report, it must be reproduced in its entirety. This report contains a total of 13 pages including the laboratory narrative, sample results, quality control, and related documents as required (cover page, COC, raw data, etc.).

TPH-GAS/BTEX:

Sample 9812C50-02 was diluted 5-fold.
Sample 9812C50-03 was diluted 20-fold.

MTBE (8260):

Sample 9812C50-01 was diluted 4.2-fold.
Sample 9812C50-03 was diluted 83-fold.

SEQUOIA ANALYTICAL

Mike Gregory
Project Manager





**Sequoia
Analytical**

680 Chesapeake Drive
404 N. Wiget Lane
819 Striker Avenue, Suite 8
1455 McDowell Blvd. North, Ste. D

Redwood City, CA 94063
Walnut Creek, CA 94598
Sacramento, CA 95834
Petaluma, CA 94954

(650) 364-9600
(925) 988-9600
(916) 921-9600
(707) 792-1865

FAX (650) 364-9233
FAX (925) 988-9673
FAX (916) 921-0100
FAX (707) 792-0342

Blaine Tech Services
1680 Rogers Avenue
San Jose, CA 95112
Attention: Christine Lillie

Client Project ID: Chevron 9-6991/ 981217-Z4

QC Sample Group: 9812C50-02,03

Reported: Jan 6, 1999

QUALITY CONTROL DATA REPORT

Matrix: Liquid
Method: EPA 8015A
Analyst: A. PORTER

ANALYTE Diesel

QC Batch #: GC1228980HBPEXC

LCS ID: BLK122898CS/CSD

Date Prepared: 12/28/98
Date Analyzed: 12/31/98
Instrument I.D.#: GCHP48

Conc. Spiked, ug/L: 1000

Blank Spike, ug/L: 700
% Recovery: 70

Blank
Spike Duplicate, ug/L: 780
% Recovery: 78

Relative % Difference: 11

% Recovery
Control Limits: 50-150

RPD Control Limits: 0-50

Quality Assurance Statement: All standard operating procedures and quality control requirements have been met.

SEQUOIA ANALYTICAL

Mike Gregory
Project Manager

Please Note:

The LCS is a control sample of known, interferent free matrix that is analyzed using the same reagents, preparation, and analytical methods employed for the samples. The matrix spike is an aliquot of sample fortified with known quantities of specific compounds and subjected to the entire analytical procedure. If the recovery of analytes from the matrix spike does not fall within specified control limits due to matrix interference, the LCS recovery is to be used to validate the batch.





Sequoia Analytical

680 Chesapeake Drive
404 N. Wiget Lane
819 Striker Avenue, Suite 8
1455 McDowell Blvd. North, Ste. D

Redwood City, CA 94063
Walnut Creek, CA 94598
Sacramento, CA 95834
Petaluma, CA 94954

(650) 364-9600
(925) 988-9600
(916) 921-9600
(707) 792-1865

FAX (650) 364-9233
FAX (925) 988-9673
FAX (916) 921-0100
FAX (707) 792-0342

Blaine Tech Services, Inc.
1680 Rogers Ave.
San Jose, CA 95112
Attention: Christine Lillie

Client Project ID: Chevron 9-6991 / 981217-Z4
Matrix: Liquid

Work Order #: 9812C50 -02

Reported: Jan 6, 1999

QUALITY CONTROL DATA REPORT

Analyte:	Benzene	Toluene	Ethyl Benzene	Xylenes	BTEX as TPH
QC Batch#:	GC123098802009A	GC123098802009A	GC123098802009A	GC123098802009A	GC123098802009A
Analy. Method:	EPA 8020	EPA 8020	EPA 8020	EPA 8020	EPA 8015M
Prep. Method:	EPA 5030	EPA 5030	EPA 5030	EPA 5030	EPA 5030

Analyst:	C. Westwater	C. Westwater	C. Westwater	C. Westwater	C. Westwater
MS/MSD #:	8121895	8121895	8121895	8121895	8121895
Sample Conc.:	N.D.	N.D.	N.D.	N.D.	N.D.
Prepared Date:	12/30/98	12/30/98	12/30/98	12/30/98	12/30/98
Analyzed Date:	12/30/98	12/30/98	12/30/98	12/30/98	12/30/98
Instrument I.D.#:	HP9	HP9	HP9	HP9	HP9
Conc. Spiked:	20 µg/L	20 µg/L	20 µg/L	60 µg/L	340 µg/L
Result:	21	22	23	70	330
MS % Recovery:	105	110	115	117	97
Dup. Result:	21	22	22	68	320
MSD % Recov.:	105	110	110	113	94
RPD:	0.0	0.0	4.4	2.9	3.1
RPD Limit:	0-20	0-20	0-20	0-20	0-50

LCS #:	LCS123098	LCS123098	LCS123098	LCS123098	LCS123098
Prepared Date:	12/30/98	12/30/98	12/30/98	12/30/98	12/30/98
Analyzed Date:	12/30/98	12/30/98	12/30/98	12/30/98	12/30/98
Instrument I.D.#:	HP9	HP9	HP9	HP9	HP9
Conc. Spiked:	20 µg/L	20 µg/L	20 µg/L	60 µg/L	340 µg/L
LCS Result:	20	20	21	65	320
LCS % Recov.:	100	100	105	108	94

MS/MSD	60-140	60-140	60-140	60-140	60-140
LCS	70-130	70-130	70-130	70-130	50-150
Control Limits					

SEQUOIA ANALYTICAL
Elap #1271

Mike Gregory
Project Manager

Please Note:

The LCS is a control sample of known, interferent-free matrix that is analyzed using the same reagents, preparation, and analytical methods employed for the samples. The matrix spike is an aliquot of sample fortified with known quantities of specific compounds and subjected to the entire analytical procedure. If the recovery of analytes from the matrix spike does not fall within specified control limits due to matrix interference, the LCS recovery is to be used to validate the batch.

** MS = Matrix Spike, MSD = MS Duplicate, RPD = Relative % Difference

9812C50.BLA <1>





Sequoia Analytical

680 Chesapeake Drive
404 N. Wiget Lane
819 Striker Avenue, Suite 8
1455 McDowell Blvd. North, Ste. D

Redwood City, CA 94063
Walnut Creek, CA 94598
Sacramento, CA 95834
Petaluma, CA 94954

(650) 364-9600
(925) 988-9600
(916) 921-9600
(707) 792-1865

FAX (650) 364-9233
FAX (925) 988-9673
FAX (916) 921-0100
FAX (707) 792-0342

Blaine Tech Services, Inc.
1680 Rogers Ave.
San Jose, CA 95112
Attention: Christine Lillie

Client Project ID: Chevron 9-6991 / 981217-Z4
Matrix: Liquid

Work Order #: 9812C50-03, 04

Reported: Jan 6, 1999

QUALITY CONTROL DATA REPORT

Analyte:	Benzene	Toluene	Ethyl Benzene	Xylenes	BTEX as TPH
QC Batch#:	GC122998802009A	GC122998802009A	GC122998802009A	GC122998802009A	GC122998802009A
Analy. Method:	EPA 8020	EPA 8020	EPA 8020	EPA 8020	EPA 8015M
Prep. Method:	EPA 5030	EPA 5030	EPA 5030	EPA 5030	EPA 5030

Analyst:	C. Westwater	C. Westwater	C. Westwater	C. Westwater	C. Westwater
MS/MSD #:	8121721	8121721	8121721	8121721	8121721
Sample Conc.:	N.D.	N.D.	N.D.	N.D.	N.D.
Prepared Date:	12/29/98	12/29/98	12/29/98	12/29/98	12/29/98
Analyzed Date:	12/29/98	12/29/98	12/29/98	12/29/98	12/29/98
Instrument I.D.#:	HP9	HP9	HP9	HP9	HP9
Conc. Spiked:	20 µg/L	20 µg/L	20 µg/L	60 µg/L	340 µg/L
Result:	21	22	22	69	420
MS % Recovery:	105	110	110	115	124
Dup. Result:	21	22	22	69	410
MSD % Recov.:	105	110	110	115	121
RPD:	0.0	0.0	0.0	0.0	2.4
RPD Limit:	0-20	0-20	0-20	0-20	0-50

LCS #:	LCS122998	LCS122998	LCS122998	LCS122998	LCS122998
Prepared Date:	12/29/98	12/29/98	12/29/98	12/29/98	12/29/98
Analyzed Date:	12/29/98	12/29/98	12/29/98	12/29/98	12/29/98
Instrument I.D.#:	HP9	HP9	HP9	HP9	HP9
Conc. Spiked:	20 µg/L	20 µg/L	20 µg/L	60 µg/L	340 µg/L
LCS Result:	20	21	21	66	310
LCS % Recov.:	100	105	105	110	91

MS/MSD	60-140	60-140	60-140	60-140	
LCS	70-130	70-130	70-130	70-130	50-150
Control Limits					

SEQUOIA ANALYTICAL
Elap #1271

Mike Gregory
Project Manager

Please Note:

The LCS is a control sample of known, interferent-free matrix that is analyzed using the same reagents, preparation, and analytical methods employed for the samples. The matrix spike is an aliquot of sample fortified with known quantities of specific compounds and subjected to the entire analytical procedure. If the recovery of analytes from the matrix spike does not fall within specified control limits due to matrix interference, the LCS recovery is to be used to validate the batch.

** MS=Matrix Spike, MSD=MS Duplicate, RPD=Relative % Difference

9812C50.BLA <2>





Sequoia Analytical

680 Chesapeake Drive
404 N. Wiget Lane
819 Striker Avenue, Suite 8
1455 McDowell Blvd. North, Ste. D

Redwood City, CA 94063
Walnut Creek, CA 94598
Sacramento, CA 95834
Petaluma, CA 94954

(650) 364-9600
(925) 988-9600
(916) 921-9600
(707) 792-1865

FAX (650) 364-9233
FAX (925) 988-9673
FAX (916) 921-0100
FAX (707) 792-0342

Blaine Tech Services, Inc.
1680 Rogers Ave.
San Jose, CA 95112
Attention: Christine Lillie

Client Project ID: Chevron 9-6991 / 981217-Z4
Matrix: Liquid

Work Order #: 9812C50-01, 03

Reported: Jan 6, 1999

QUALITY CONTROL DATA REPORT

Analyte: MTBE

QC Batch#: MS122198MTBEH6A

Analy. Method: EPA 8260

Prep. Method: N.A.

Analyst: T. Costello

MS/MSD #: 9812B8417

Sample Conc.: N.D.

Prepared Date: 12/21/98

Analyzed Date: 12/21/98

Instrument I.D.#: H6

Conc. Spiked: 50 µg/L

Result: 43

MS % Recovery: 86

Dup. Result: 37

MSD % Recov.: 74

RPD: 15

RPD Limit: 0-25

LCS #: LCS122298

Prepared Date: 12/22/98

Analyzed Date: 12/22/98

Instrument I.D.#: H6

Conc. Spiked: 50 µg/L

LCS Result: 42

LCS % Recov.: 84

MS/MSD 60-140

LCS 70-130

Control Limits

Please Note:

The LCS is a control sample of known, interferent-free matrix that is analyzed using the same reagents, preparation, and analytical methods employed for the samples. The matrix spike is an aliquot of sample fortified with known quantities of specific compounds and subjected to the entire analytical procedure. If the recovery of analytes from the matrix spike does not fall within specified control limits due to matrix interference, the LCS recovery is to be used to validate the batch.

SEQUOIA ANALYTICAL

Mike Gregory
Project Manager

** MS = Matrix Spike, MSD = MS Duplicate, RPD = Relative % Difference

9812C50.BLA <3>



Fax copy of Lab Report and COC to Chevron Contact: Yes No

Chain-of-Custody-Record:

Chevron Products Co. P.O. BOX 6004 San Ramon, CA 94583 FAX (925)842-8370	Chevron Facility Number <u>9-6991</u> Facility Address <u>2920 Castro Valley Blvd., Castro Valley</u> Consultant Project Number <u>981217-24</u> Consultant Name <u>BLAINE TECH SERVICE, INC.</u> Address <u>1680 ROGERS AVE., SAN JOSE</u> Project Contact (Name) <u>CHRISTINE LILLIE</u> (Phone) <u>408-573-0555</u> (Fax Number) <u>408-573-7771</u>	Chevron Contact (Name) <u>PHIL BRIGGS</u> (Phone) <u>(925) 842-9136</u> Laboratory Name <u>SEQUOIA</u> Laboratory Service Order <u>9144488</u> Laboratory Service Code <u>ZZ02800</u> Samples Collected by (Name) <u>Jeremy</u> Signature <u>[Signature]</u>
--	---	--

Sample Number	Number of Containers	Matrix S = Soil A = Air W = Water C = Charcoal	Sample Preservation	Date/Time	State Method: <input type="checkbox"/> CA <input type="checkbox"/> OR <input type="checkbox"/> WA <input type="checkbox"/> NW Series <input type="checkbox"/> CO <input type="checkbox"/> UT														Remarks		
					BTEX/MTBE+TPH GAS (8020 + 8015)	BTEX + TPH GAS (8020 + 8015)	TPH Diesel (8015)	Oxygenates (8260)	Purgeable Halocarbons (8010)	Purgeable Organics (8260)	Extractable Organics (8270)	Oil and Grease (5520)	Metals (ICAP or AA) Cd,Cr,Pb,Zn,Ni	BTEX (8020)	BTEX/MTBE/Naph. (8020)	TPH - HCID	TPH-D Extended	MTBE by 8260			
MW 2 ³	3	W	ACC	12/17 1525																Lab Sample No.	
MW 3 ^{3u}	4	↓	↓	1555	XX		XX														01
MW 7 ⁱ	8	↓	↓	1615	XX		XX														02 18 1 4?
TB L	2	↓	↓	-	XX																03
																					04

Relinquished By (Signature) <u>[Signature]</u>	Organization <u>BTB</u>	Date/Time <u>12/18/98</u>	Received By (Signature) <u>[Signature]</u>	Organization <u>Sequoia</u>	Date/Time <u>12-18-98</u>	Iced Y/N	Turn Around Time (Circle Choice) <input type="radio"/> 24 Hrs. <input type="radio"/> 48 Hrs. <input type="radio"/> 5 Days <input type="radio"/> 10 Days <input type="radio"/> As Contracted
Relinquished By (Signature) <u>[Signature]</u>	Organization <u>Sequoia</u>	Date/Time <u>12-18-98</u>	Received By (Signature) <u>[Signature]</u>	Organization	Date/Time	Iced Y/N	
Relinquished By (Signature)	Organization	Date/Time	Received For Laboratory By (Signature)		Date/Time	Iced Y/N	

Field Data Sheets

CHEVRON WELL MONITORING DATA SHEET

Project #: 981217-25 Station #: 9-6991
 Sampler: JR Start Date: 12-17-98
 Well I.D.: MW-2 Well Diameter: (circle one) 2 3 4 6 3/4"
 Total Well Depth: Depth to Water:
 Before 17.90 After Before 11.55 After
 Depth to Free Product: Thickness of Free Product (feet):
 Measurements referenced to: PVC Grade Other:

Well Diameter	VCF	Well Diameter	VCF
1"	0.04	6"	1.47
2"	0.16	8"	2.61
3"	0.37	10"	4.08
4"	0.65	12"	5.87
5"	1.02	16"	10.43

0.1 x 3 = 0.3
 1 Case Volume Specified Volumes = gallons

Purging: Bailer
 Disposable Bailer
 Middleburg
 Electric Submersible
 Extraction Pump
 Other pin bailer

Sampling: Bailer
 Disposable Bailer
 Extraction Port
 Other pin bailer

TIME	TEMP. (F)	pH	COND.	TURBIDITY:	VOLUME REMOVED:	OBSERVATIONS:	
1512	71.2	7.3	1000	X	.1	- turbid	
1517	70.0	7.2	900		.2		
1522	69.8	7.1	840		.3		
						D.O	1.8 mg/l
						ORP	-126

Did Well Dewater? No If yes, gals. Gallons Actually Evacuated: .3

Sampling Time: ~~1512~~ 1525 Sampling Date: 12-17-98

Sample I.D.: MW-2 Laboratory: Sequoia

Analyzed for: TPH-G BTEX TPH-D OTHER: MTBE 5, 8260

Duplicate I.D.: Cleaning Blank I.D.:

Analyzed for: TPH-G BTEX TPH-D OTHER:

CHEVRON WELL MONITORING DATA SHEET

Project #: <u>981217-25</u>	Station #: <u>9-6991</u>
Sampler: <u>JR</u>	Start Date: <u>12-17-98</u>
Well I.D.: <u>MW-7</u>	Well Diameter: (circle one) <u>(2)</u> 3 4 6
Total Well Depth: Before <u>19.81</u> After	Depth to Water: Before <u>11.10</u> After
Depth to Free Product:	Thickness of Free Product (feet):
Measurements referenced to: <u>(PVC)</u> Grade Other:	

Well Diameter	VCF	Well Diameter	VCF
1"	0.04	6"	1.47
2"	0.16	8"	2.61
3"	0.37	10"	4.08
4"	0.65	12"	5.87
5"	1.02	16"	10.43

<u>1.4</u>	<u>x</u>	<u>3</u>	<u>=</u>	<u>4.2</u>
1 Case Volume		Specified Volumes		gallons

Purging: Bailer Disposable Bailer <input checked="" type="checkbox"/> Middleburg Electric Submersible Extraction Pump Other _____	Sampling: Bailer Disposable Bailer <input checked="" type="checkbox"/> Extraction Port Other _____
--	---

TIME	TEMP. (F)	pH	COND.	TURBIDITY:	VOLUME REMOVED:	OBSERVATIONS:
1605	71.8	7.3	1200	X	1.5	-turbid
1607	71.2	7.3	1000		3	
1609	70.6	7.2	1000		4.5	
					D.O	<u>1.2</u>
					ORP	<u>-15</u>

Did Well Dewater? (NO) If yes, gals. Gallons Actually Evacuated: 4.5

Sampling Time: <u>1615</u>	Sampling Date: <u>12-17-98</u>
Sample I.D.: <u>MW7</u>	Laboratory: <u>Sequoia</u>
Analyzed for: (Circle) <u>TPH-G BTEX TPH-D</u> OTHER: <u>MTBE & MTBE by 8260</u>	
Duplicate I.D.:	Cleaning Blank I.D.:
Analyzed for: (Circle) <u>TPH-G BTEX TPH-D</u> OTHER:	