

ENVIRONMENTAL ENGINEERING, INC
2680 Bishop Drive, Suite 203
San Ramon, California 94583
TEL (925) 244-6600
FAX (925) 244-6601

FAX TRANSMITTAL

DATE: June 11, 2002 FAX# 510-337-9335

TO: Scott

COMPANY: Alameda County

FROM: Terly Perini

SUBJECT: 2nd Q 2002 GW Monitoring Report Freedom Ave
San Leandro

NUMBER OF PAGES INCLUDING COVER: _____

MESSAGE:

Table 1
Groundwater Elevation Data, June 7, 2002
15101 Freedom Avenue, San Leandro, CA

Monitoring Well	Top of Casing Elevation ¹ (feet)	Depth to Water (feet)	Groundwater Elevation (feet)	Product Thickness (feet)
MW-1	51.71	22.95	28.76	0
MW-2	49.66	20.95	28.71	0
MW-3	51.16	22.46	28.70	0
MW-4	50.54	21.97	28.57	0
MW-5	47.79	19.23	28.56	0

Notes:

Monitoring wells were surveyed by Kier and Wright Civil Engineer & Land Surveyors. Surveying was conducted on May 7, 2002.

¹: Top of casing elevations were surveyed to an assumed datum of 67.07 M.S.L

Table 2
Historical Groundwater Elevation Data
15101 Freedom Avenue, San Leandro, CA

Date	MW-1	MW-2	MW-3	MW-4	MW-5
Jun-02	28.76	28.71	28.70	28.57	28.56

Notes:

The first time SOMA monitored this Site was in May 2002.

Table 3
Field Measurements at the Time of Sampling, May 10, 2002
 15101 Freedom Avenue, San Leandro, CA

Monitoring Well	pH	Temp (°C)	E.C. (uS/cm)
MW-1	6.88	19.90	1342
MW-2	7.17	19.60	1496
MW-3	6.80	20.40	1249
MW-4	6.78	19.10	1590
MW-5	6.79	20.50	1276

Table 4
Groundwater Analytical Data, May 10, 2002
 15101 Freedom Avenue, San Leandro, CA

Monitoring Well	TPH-g (µg/L)	Benzene (µg/L)	Toluene (µg/L)	Ethylbenzene (µg/L)	Total Xylenes (µg/L)	MtBE ¹ (µg/L)	Total Lead (µg/L)
MW-1	5,700	360	4.5	340	450	2	<3
MW-2	3,100	67	8.0	250	215	56	<3
MW-3	44,000	6,000	900	1,500	6,200	2,400	15
MW-4	880	25	1.0 ^c	110	52	12,000	<3
MW-5	25,000	1,000	1,200	1,100	3,060	1,800	3.5

Notes:

< : Not detected above laboratory reporting limits.

^c Presence confirmed, but confirmation concentration differed by more than a factor of two.

¹ MtBE Confirmed by EPA Method 8260B.

Table 5
Historical Groundwater Analytical Data
15101 Freedom Avenue, San Leandro, CA

Monitoring Well	Date	TPH-g (µg/L)	Benzene (µg/L)	Toluene (µg/L)	Ethylbenzene (µg/L)	Total Xylenes (µg/L)	MtBE ¹ (µg/L)	Total Lead (µg/L)
MW-1	May-02	5700	360	4.5	340	450	2	<3
MW-2	May-02	3100	67	8	250	215	56	<3
MW-3	May-02	44000	6000	900	1500	6200	2400	15
MW-4	May-02	880	25	1.0C	110	52	12,000	<3
MW-5	May-02	25,000	1000	1200	1,100	3,060	1800	3.5

Notes:

<: Not detected above laboratory detection limits.

C Presence confirmed, but confirmation concentration differed by more than a factor of two.

¹ MtBE confirmed by EPA Method 8260B.

The first time SOMA monitored this Site was in May 2002.

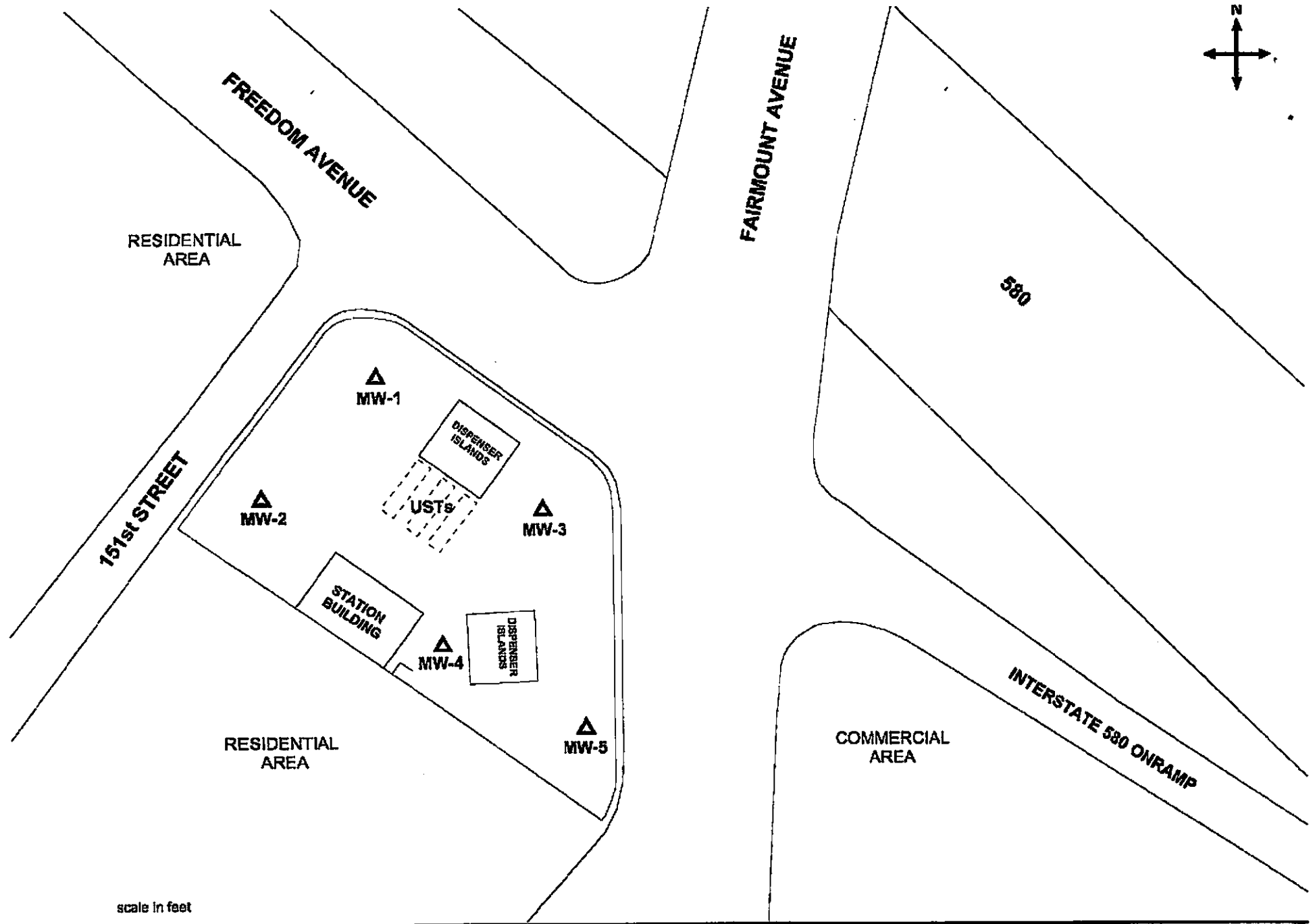

scale in feet

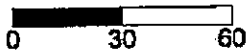
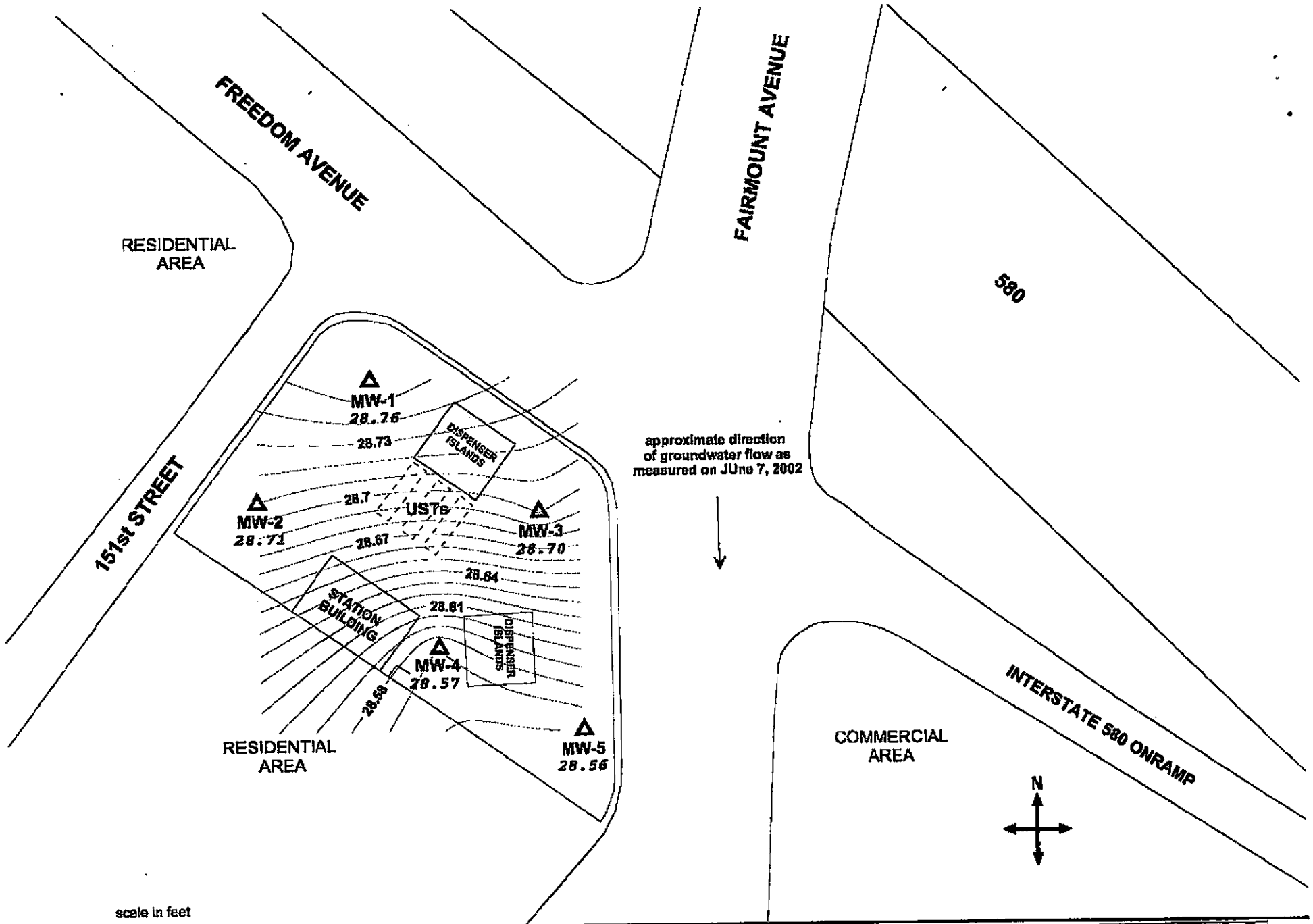

Figure 2: Site map showing locations of groundwater monitoring wells.





approximate direction of groundwater flow as measured on June 7, 2002

scale in feet

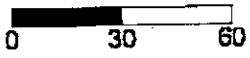

Figure 3: Groundwater elevation contour map in feet. June 7, 2002.

