

geo - logic geotechnical and environmental consulting services

1140 - 5th Avenue, Crockett, CA 94525

(510) 787-6867 • Fax (510) 787-1457

6/7/99

To: Scott Seery

From: Joel Greger

Re: Laboratory results - ~~Site Report~~

- S corner of tank pit - levels lower @ 16.5', 19.5', then higher @ 24.5'

Vicinity of P12 (3.5') over excavated

P 12 (5') taken as confirmation sample

Geo-Logic
Arco Station, 15101 Freedom Blvd., San Leandro
Paradiso Job No. 99-444

June 7, 1999

TABLE 1

SUMMARY OF LABORATORY ANALYSES - SOIL

<u>Sample/depth</u>	<u>TPH</u> <u>Gas</u>	<u>Benzene</u>	<u>Toluene</u>	<u>Ethyl-</u> <u>benzene</u>	<u>Xylenes</u>	<u>MTBE</u>
(Collected on May 20 and May 21, 1999)						
T1W (12.5')	1,700	11	13	22	19	0.22
T1W (13.5')	3,900	28	34	34	41	0.71/0.58
T1E (12.5')	2,000	15	12	19	20	0.28
T2W (14')	1,300	7.7	6.5	10	13	0.14
T2E (12.5')	1,800	20	17	23	26	0.19
T3W (14')	990	5.9	5.7	6.4	6.8	<0.005
T3E (14')	960	5.0	4.3	5.2	5.1	<0.005
P1 (2.5')	5.2	0.015	0.009	0.019	0.021	0.009
P2 (2.5')	1.4	<0.005	<0.005	0.011	0.020	<0.005
P3 (2.5')	0.76	<0.005	<0.005	<0.005	0.017	<0.005
P4 (3')	0.88	<0.005	<0.005	0.010	0.019	<0.005
P5 (2.5')	1.1	<0.005	<0.005	0.016	0.023	<0.005
P6 (2.5')	0.90	<0.005	<0.005	0.022	0.018	<0.005
P7 (2.5')	11	0.037	0.018	0.042	0.044	0.020/0.031
P8 (3.5')	6.1	0.041	0.040	0.052	0.062	0.011
P9 (3.5')	13	0.090	0.077	0.094	0.12	0.052
P10 (3.5')	7.2	0.038	0.044	0.061	0.058	<0.005
P11 (3')	48	0.42	0.27	0.38	0.56	0.28
P12 (3.5')	370	2.6	1.4	3.0	2.9	0.93/0.70
P13 (3')	20	0.14	0.096	0.15	0.22	0.17
P14 (3')	2.9	<0.005	<0.005	0.017	0.030	<0.005
P15 (3.5')	13	0.079	0.049	0.099	0.16	0.066
Comp S1*	5.7	0.036	0.029	0.037	0.048	<0.005

(Collected on June 2, 1999)

T1W (16.5')	390	1.0	0.73	1.1	1.7	0.089
T1W (19.5')	340	1.1	0.66	0.84	1.3	0.12
T1W (24.5')			9.7	12	15	0.78/0.55
P12 (5')	110	0.26	0.15	0.23	0.33	0.026

Det. Limit/
Method Blank <0.1 <0.005 <0.005 <0.005 <0.005 <0.005

Total lead was detected at a concentration of 42 mg/kg.
The concentrations of MTBE detected by EPA Method 8020 in T1W(13.5'),
T1W(24.5'), P7(2.5'), and P12(3.5') were confirmed by EPA Method
8260.

Results are in milligrams per kilogram (mg/kg).

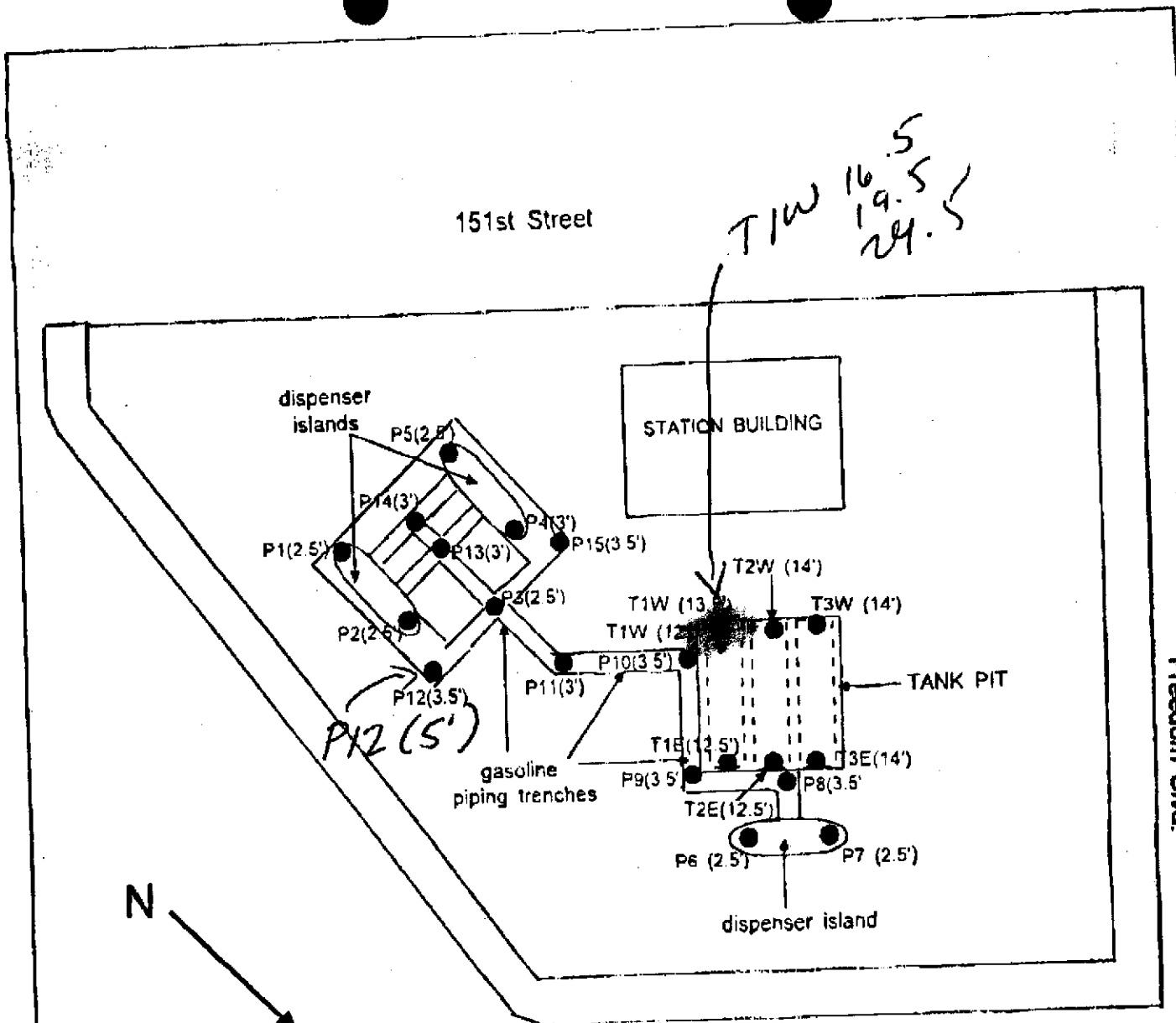

LEGEND

● Sample (depth)

Samples collected on May 20 and May 21, 1999

SCALE: 1" = 30'

ARCO STATION 15101 FREEDOM BLVD. SAN LEANDRO, CALIFORNIA	Figure No:	Date: MAY 21, 1999
	1	Drawn By: JG/Geo-Logic

Sample Location Map