

Ro 469

CAMBRIA

July 7, 2004

Mr. Keith L. Matthews
Hazardous Materials Inspector
Office of Emergency Services
City of Oakland, Fire Services Agency
1605 Martin Luther King, Jr. Way
Oakland, California 94612

Re: **Dispenser and Piping Upgrade Sampling Report**
Shell-branded Service Station
6039 College Avenue
Oakland, California
Incident # 98995745
Cambria Project #206-0503-001

Received
JUL 12 2004
Environmental Health



Dear Mr. Matthews:

On behalf of Equilon Enterprises LLC dba Shell Oil Products US, Cambria Environmental Technology, Inc. (Cambria) is submitting this *Dispenser and Piping Upgrade Sampling Report* which presents the results of sampling conducted during station upgrade activities at the referenced site. Presented below are a summary of site conditions, sampling activities and analytical results.

SITE CONDITIONS

Location and Site Use: This Shell-branded service station at 6039 College Avenue in Oakland, California is situated in a mixed commercial/residential neighborhood (Figures 1 and 2). The service station has been in operation since 1940. Groundwater sampling has been performed at the site since 1990.

Site Lithology: The site is underlain by fine-grained Quaternary alluvial deposits consisting of interbedded sandy clay and sandy silt with rare silty gravel and sand units to the total depth explored of 50 feet (ft).

Groundwater Depth and Flow Direction: Depth to water in the site wells has historically ranged from approximately 8 to 21 feet below grade (fbg) since the wells were first monitored in February of 1990. Historically, the groundwater flow direction has been to the west-southwest.

Cambria
Environmental
Technology, Inc.

5900 Hollis Street
Suite A
Emeryville, CA 94608
Tel (510) 420-0700
Fax (510) 420-9170

During the first quarter of 2004, the gradient was approximately 0.15 ft/ft. Currently, there are six monitoring wells, four of which are monitored and sampled quarterly and two of which are monitored and sampled annually. There are also two on-site tank backfill wells.

2004 Upgrade Activities: Paradiso Mechanical, Inc. (Paradiso) of San Leandro, California performed upgrades to the site's facilities during May of 2004. Paradiso upgraded the under dispenser containment to the dispenser locations adjacent to product, vapor and vent lines. Additionally, Paradiso replaced and upgraded enhanced vapor recovery on the underground storage tank (UST) fuel fill port sumps on the top of the UST's in the tank pit area.



SAMPLING ACTIVITIES AND SAMPLE ANALYSIS

Personnel Present: Stewart Dalie, Staff Scientist, Cambria
Keith L. Matthews, Hazardous Materials Inspector, City of Oakland, Fire Services Agency.
Mark Freitas, Construction Forman, Paradiso.

Sample Date: May 7, 2004.

Sampling Requirements: Based on the conversation between Stewart Dalie and Keith Matthews during field activities on May 7, 2004, one soil sample was required to be collected beneath each dispenser and at 90-degree elbows of product piping within 1 to 2 feet of native soil (Figure 2). Based on field conditions and the scope of work, only the dispenser locations and the adjacent 90-degree elbows of product piping were exposed.

Dispenser and Pipeline Sampling: Under the direction of Mr. Matthews, eight soil samples were collected between at 5 fbg (Figure 2). These included four samples (D-1 through D-4) from beneath dispensers and four samples (P-1 through P-4) from beneath product piping. Field indications of hydrocarbons, including staining and odor, were not observed in the vicinity of the sampled areas. Cambria's standard procedures for dispenser and piping sampling are presented as Attachment A.

Sample Analyses: State-certified laboratory Severn Trent Laboratories Inc. of Pleasanton, California analyzed all eight samples for total petroleum hydrocarbons as gasoline (TPHg), benzene, toluene, ethylbenzene, and xylenes (BTEX), and methyl tert-butyl ether (MTBE) by EPA Method 8260B. Laboratory analytical results are summarized in Table 1. Laboratory analytical reports and chain of custody records are presented as Attachment B.

Waste Handling: To characterize stockpiled soil for disposal, four brass tubes of soil were collected for approximately 2 cubic yards of stockpiled soil, and then composited by the analytical laboratory. The soil was analyzed for TPHg and BTEX by EPA Method 8260B and for total threshold limit concentration lead. The stockpile was transported on May 14, 2004 to Forward Landfill in Manteca, California for disposal as a non-hazardous waste. Waste disposal documentation is included as Attachment C.

ANALYTICAL RESULTS



MTBE and benzene were not detected in any of the soil samples collected during the upgrade activities. TPHg was detected in only one sample, collected at P-3-4' at a concentration of 17 parts per million. However, the laboratory noted that the hydrocarbons detected in the gasoline range did not match the laboratory gasoline standard. Analytical results are summarized in Table 1, and the laboratory report is included as Attachment B.

CONCLUSIONS

The current soil sampling results indicate minimal impact of TPHg to soil in one localized vicinity, near the former dispenser pans adjacent to the 90-degree piping elbow on the western side of the site. Based on conversations with Mr. Matthews of the City of Oakland Fire Services Agency on May 7, 2004, Cambria agrees with the recommendation that no further investigation is warranted at this time.

CLOSING

Please call Caryl Weekley at (510) 420-3324 if you have any questions or comments.

Sincerely,
Cambria Environmental Technology, Inc.



Caryl A. Weekley
Caryl A. Weekley, R.G.
Senior Project Geologist

Matthew W. Derby
Matthew W. Derby, P.E.
Senior Project Engineer

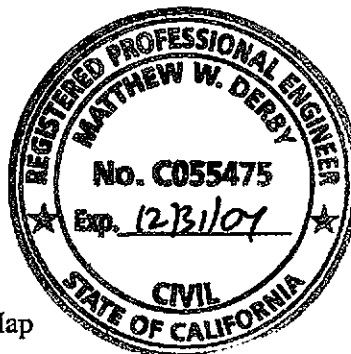

Figures: 1 - Vicinity/Area Well Survey Map
 2 - Soil Sample Location Map

Table: 1 - Soil Analytical Data

Attachments: A - Standard Piping and Dispenser Removal Sampling Procedures
 B - Laboratory Analytical Data
 C - Waste Disposal Documentation

cc: Karen Petryna, Shell Oil Products US, 20945 S. Wilmington, Carson CA 90810
 Mr. Don Hwang, Alameda County Health Care Services Agency, 1131 Harbor Bay
 Parkway, Suite 250, Alameda, California 94502-6577
 Bill Merchant, Shell Oil Products US, 9141 E. Stockton Boulevard, Suite 250-321, Elk
 Grove, CA 95624
 Russell J. Bruzzone, Inc., 899 Hope Lane, Lafayette, CA 94549
 Montrose Investment Co., Attn: Jim Graham, 242 Rivera Circle, Greenbrae Marina,
 Larkspur, CA 94939

G:\Oakland 6039 College Avenue\Upgrades\6039 2004 upgrade report.doc

G:\OAKLAND 6039 COLLEGE\FIGURES\VIC-WELL-SURVEY.A1

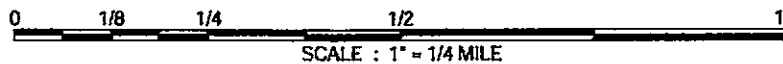
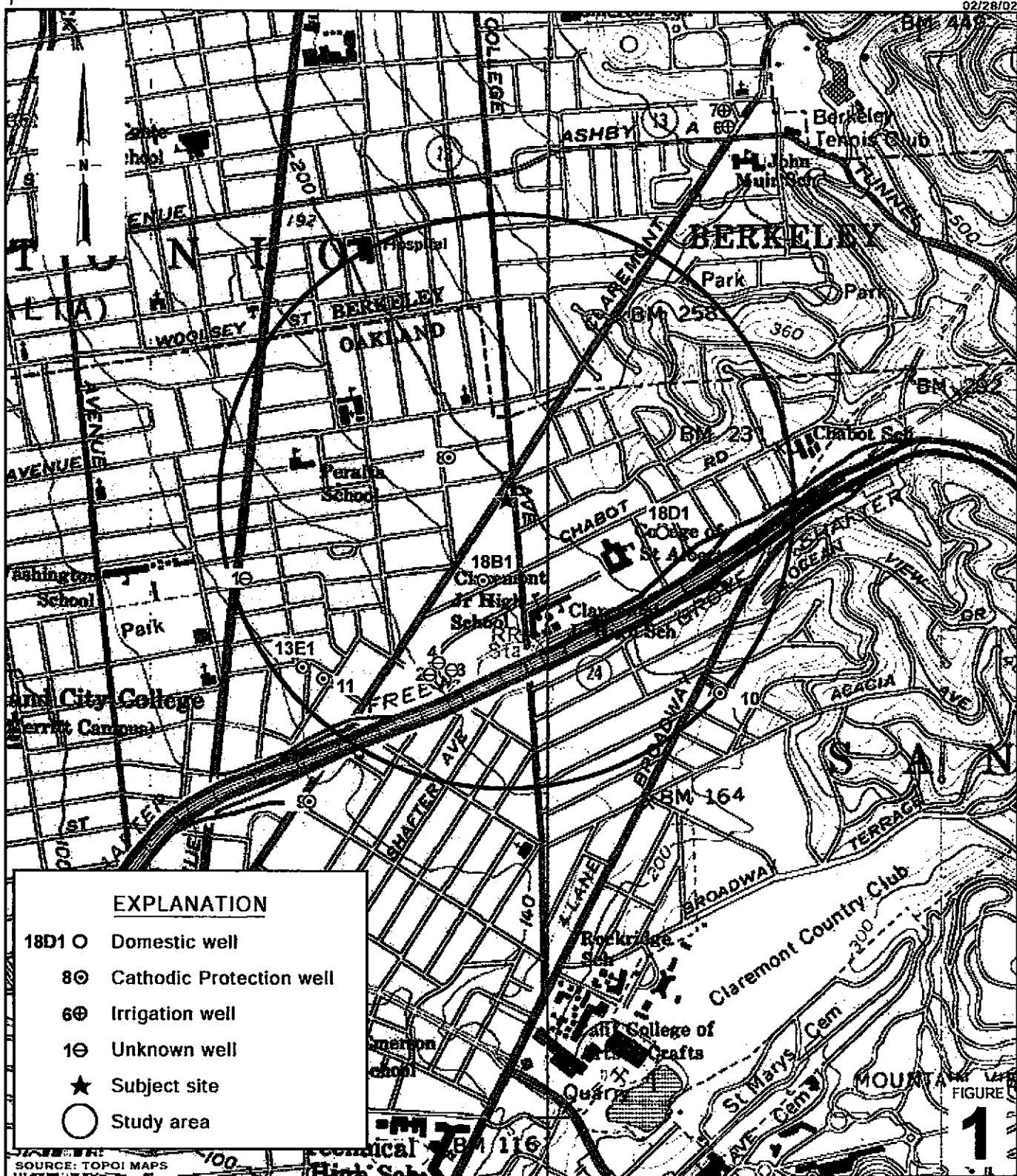

Shell-branded Service Station
 6039 College Avenue
 Oakland, California
 Incident #98995745



C A M B R I A

**Vicinity / Area Well
 Survey Map**

1/2 Mile Radius

FIGURE 1

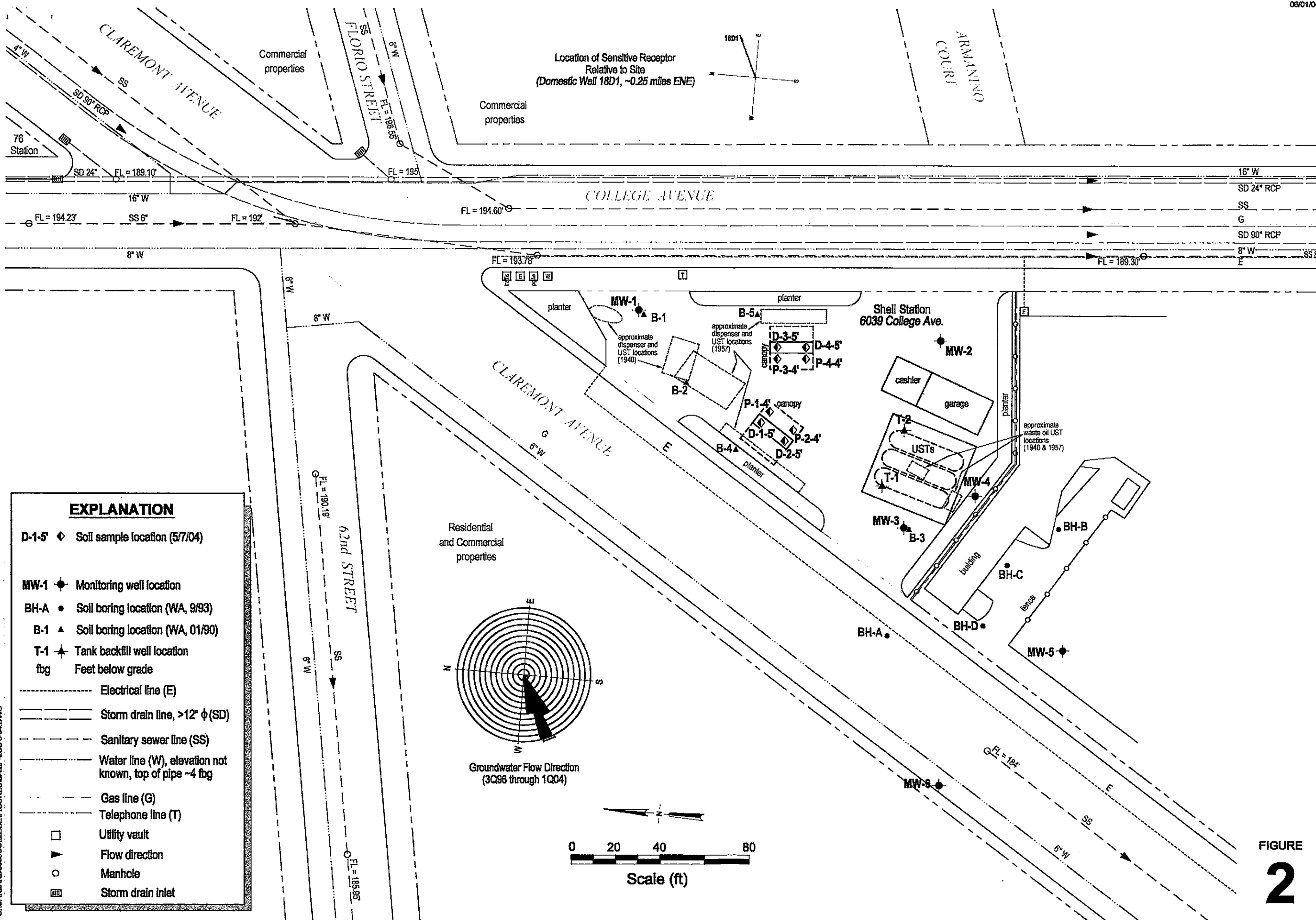

EXPLANATION

- D-1-5 ♦ Soil sample location (5/7/04)
- MW-1 ● Monitoring well location
- BH-A ● Soil boring location (WA, 9/93)
- B-1 ▲ Soil boring location (WA, 01/90)
- T-1 ▲ Tank backfill well location
- fbg Feet below grade
- Electrical line (E)
- Storm drain line, >12" φ (SD)
- Sanitary sewer line (SS)
- Water line (W), elevation not known, top of pipe ~4 fbg
- Gas line (G)
- Telephone line (T)
- Utility vault
- ▶ Flow direction
- Manhole
- ▣ Storm drain inlet

FIGURE 2

Shell-branded Service Station

6039 College Avenue
Oakland, California
Incident #98995745

06/01/04 06/01/04 COLLEGE STATION AMP-1.DWG 6-04.DWG

CAMBRIA

Table 1. Soil Analytical Data -Shell-branded Service Station, Incident #98995745, 6039 College Avenue, Oakland, California

Sample ID	Sample Depth (fbg)	Sample Date	TPHg	(parts per million)				
				Benzene	Toluene	Ethyl-benzene	Total Xylenes	MTBE
D-1-5'	5	5/7/04	<1.0	<0.0050	<0.0050	<0.0050	<0.0050	<0.0050
D-2-5'	5	5/7/04	<1.0	<0.0050	<0.0050	<0.0050	<0.0050	<0.0050
D-3-5'	5	5/7/04	<1.0	<0.0050	<0.0050	<0.0050	<0.0050	<0.0050
D-4-5'	5	5/7/04	<1.0	<0.0050	<0.0050	<0.0050	<0.0050	<0.0050
P-1-4'	4	5/7/04	<1.0	<0.0050	<0.0050	<0.0050	<0.0050	<0.0050
P-2-4'	4	5/7/04	<1.0	<0.0050	<0.0050	<0.0050	<0.0050	<0.0050
P-3-4'	4	5/7/04	17 ^a	<0.022	<0.022	<0.022	<0.022	<0.022
P-4-4'	4	5/7/04	<1.0	<0.0050	<0.0050	<0.0050	<0.0050	<0.0050

Abbreviations and Notes:

TPHg = Total petroleum hydrocarbons as gasoline, analyzed by modified EPA Method 8260B.

Benzene, toluene, ethylbenzene, and total xylenes analyzed by EPA Method 8260B.

MTBE = Methyl tertiary butyl ether, analyzed by modified EPA Method 8260B.

fbg = Feet below grade.

<n = Below laboratory detection limit of n ppm.

a = Hydrocarbon reported in the gasoline range does not match the lab's gasoline standard.

ATTACHMENT A

Standard Piping and Dispenser Removal Sampling Procedures

CAMBRIA

STANDARD PIPING AND DISPENSER REMOVAL SAMPLING PROCEDURES

Cambria Environmental Technology, Inc. (Cambria) has developed standard operating procedures for collecting soil samples during petroleum dispenser and piping removal. These procedures ensure that the samples are collected, handled, and documented in compliance with California Administration Code Title 23: Waters; Chapter 3: Water Resources Control Board; Subchapter 16: Underground Storage Tank Regulations (Title 23). Cambria's sampling procedures are based on guidelines contained in the California State Regional Water Quality Control Board Tri-Regional Staff Recommendations for Preliminary Evaluation and Investigation of Underground Tank Sites dated August 10, 1990.

Piping and Dispenser Removal Sampling

The objective of sample collection during routine dispenser and piping removals is to determine whether hydrocarbons or other stored chemicals have been released to the subsurface. We collect one soil sample from the native soil beneath each dispenser unit, at each piping elbow, and at every 20 ft of product piping, as applicable.

The soil samples are collected in steam cleaned brass or steel tubes from either a driven split-spoon type sampler or the bucket of a backhoe. When a backhoe is used, approximately three inches of soil are scraped from the surface and the tube is driven into the exposed soil.

Upon removal from the split-spoon sampler or the backhoe, the samples are trimmed flush, capped with Teflon sheets and plastic end caps, labeled, logged and refrigerated for delivery under chain of custody to a State certified analytic laboratory.

F:\TEMPLATE\SOPs\PIPING.doc

ATTACHMENT B

Laboratory Analytical Data

Cambria Environmental Emeryville

May 12, 2004

5900 Hollis Street, Ste. A
Emeryville, CA 94608

Attn.: Caryl Weekley

Project#: 206-0503-001

Project: 98995745

Site: 6039 College Avenue, Oakland, CA

Dear Ms. Weekley,

Attached is our report for your samples received on 05/07/2004 17:05

This report has been reviewed and approved for release. Reproduction of this report is permitted only in its entirety.

Please note that any unused portion of the samples will be discarded after 06/21/2004 unless you have requested otherwise.

We appreciate the opportunity to be of service to you. If you have any questions, please call me at (925) 484-1919.

You can also contact me via email. My email address is: vvancil@stl-inc.com

Sincerely,



Vincent Vancil
Project Manager

Severn Trent Laboratories, Inc.

STL San Francisco * 1220 Quarry Lane, Pleasanton, CA 94566

Tel 925 484 1919 Fax 925 484 1096 * www.stl-inc.com * CA DHS ELAP# 2496

Gas/BTEX/MTBE by 8260B (C6-C12)

Cambria Environmental Emeryville

Attn.: Caryl Weekley

5900 Hollis Street, Ste. A
Emeryville, CA 94608
Phone: (510) 420-3324 Fax: (510) 420-9170Project: 206-0503-001
98995745

Received: 05/07/2004 17:05

Site: 6039 College Avenue, Oakland, CA

Samples Reported

Sample Name	Date Sampled	Matrix	Lab #
P-1-4'	05/07/2004 11:00	Soil	1
D-1-5'	05/07/2004 11:05	Soil	2
P-2-4'	05/07/2004 11:20	Soil	3
D-2-5'	05/07/2004 11:10	Soil	4
P-3-4'	05/07/2004 11:35	Soil	5
D-3-5'	05/07/2004 11:45	Soil	6
P-4-4'	05/07/2004 12:00	Soil	7
D-4-5'	05/07/2004 11:50	Soil	8

Severn Trent Laboratories, Inc.

STL San Francisco * 1220 Quarry Lane, Pleasanton, CA 94566

Tel 925 484 1919 Fax 925 484 1096 * www.stl-inc.com * CA DHS ELAP# 2496

05/12/2004 10:36

Gas/BTEX/MTBE by 8260B (C6-C12)

Cambria Environmental Emeryville

Attn.: Caryl Weekley

5900 Hollis Street, Ste. A

Emeryville, CA 94608

Phone: (510) 420-3324 Fax: (510) 420-9170

Project: 206-0503-001

98995745

Received: 05/07/2004 17:05

Site: 6039 College Avenue, Oakland, CA

Prep(s):	5030B	Test(s):	8260B
Sample ID:	P-1-4	Lab ID:	2004-05-0244 - 1
Sampled:	05/07/2004 11:00	Extracted:	5/11/2004 15:19
Matrix:	Soil	QC Batch#:	2004/05/11-1B.69

Compound	Conc.	RL	Unit	Dilution	Analyzed	Flag
Gasoline	ND	1.0	mg/Kg	1.00	05/11/2004 15:19	
Benzene	ND	0.0050	mg/Kg	1.00	05/11/2004 15:19	
Toluene	ND	0.0050	mg/Kg	1.00	05/11/2004 15:19	
Ethyl benzene	ND	0.0050	mg/Kg	1.00	05/11/2004 15:19	
Total xylenes	ND	0.0050	mg/Kg	1.00	05/11/2004 15:19	
Methyl tert-butyl ether (MTBE)	ND	0.0050	mg/Kg	1.00	05/11/2004 15:19	
Surrogate(s)						
1,2-Dichloroethane-d4	98.3	70-121	%	1.00	05/11/2004 15:19	
Toluene-d8	86.5	81-117	%	1.00	05/11/2004 15:19	

Severn Trent Laboratories, Inc.

STL San Francisco * 1220 Quarry Lane, Pleasanton, CA 94566

Tel 925 484 1919 Fax 925 484 1096 * www.stl-inc.com * CA DHS ELAP# 2496

05/12/2004 10:36

Gas/BTEX/MTBE by 8260B (C6-C12)

Cambria Environmental Emeryville

Attn.: Caryl Weekley

5900 Hollis Street, Ste. A
Emeryville, CA 94608
Phone: (510) 420-3324 Fax: (510) 420-9170

Project: 206-0503-001
98995745

Received: 05/07/2004 17:05

Site: 6039 College Avenue, Oakland, CA

Prep(s): 5030B	Test(s): 8260B
Sample ID: D-1-5	Lab ID: 2004-05-0244 - 2
Sampled: 05/07/2004 11:05	Extracted: 5/10/2004 20:44
Matrix: Soil	QC Batch#: 2004/05/10-2B.69

Compound	Conc.	RL	Unit	Dilution	Analyzed	Flag
Gasoline	ND	1.0	mg/Kg	1.00	05/10/2004 20:44	
Benzene	ND	0.0050	mg/Kg	1.00	05/10/2004 20:44	
Toluene	ND	0.0050	mg/Kg	1.00	05/10/2004 20:44	
Ethyl benzene	ND	0.0050	mg/Kg	1.00	05/10/2004 20:44	
Total xylenes	ND	0.0050	mg/Kg	1.00	05/10/2004 20:44	
Methyl tert-butyl ether (MTBE)	ND	0.0050	mg/Kg	1.00	05/10/2004 20:44	
Surrogate(s)						
1,2-Dichloroethane-d4	101.5	70-121	%	1.00	05/10/2004 20:44	
Toluene-d8	91.8	81-117	%	1.00	05/10/2004 20:44	

Gas/BTEX/MTBE by 8260B (C6-C12)

Cambria Environmental Emeryville

Attn.: Caryl Weekley

5900 Hollis Street, Ste. A

Emeryville, CA 94608

Phone: (510) 420-3324 Fax: (510) 420-9170

Project: 206-0503-001

98995745

Received: 05/07/2004 17:05

Site: 6039 College Avenue, Oakland, CA

Prep(s):	5030B	Test(s):	8260B
Sample ID:	P-2-4	Lab ID:	2004-05-0244 - 3
Sampled:	05/07/2004 11:20	Extracted:	5/10/2004 21:03
Matrix:	Soil	QC Batch#:	2004/05/10-2B 69

Compound	Conc.	RL	Unit	Dilution	Analyzed	Flag
Gasoline	ND	1.0	mg/Kg	1.00	05/10/2004 21:03	
Benzene	ND	0.0050	mg/Kg	1.00	05/10/2004 21:03	
Toluene	ND	0.0050	mg/Kg	1.00	05/10/2004 21:03	
Ethyl benzene	ND	0.0050	mg/Kg	1.00	05/10/2004 21:03	
Total xylenes	ND	0.0050	mg/Kg	1.00	05/10/2004 21:03	
Methyl tert-butyl ether (MTBE)	ND	0.0050	mg/Kg	1.00	05/10/2004 21:03	
Surrogate(s)						
1,2-Dichloroethane-d4	96.1	70-121	%	1.00	05/10/2004 21:03	
Toluene-d8	86.4	81-117	%	1.00	05/10/2004 21:03	

Severn Trent Laboratories, Inc.

STL San Francisco * 1220 Quarry Lane, Pleasanton, CA 94566

Tel 925 484 1919 Fax 925 484 1096 * www.stl-inc.com * CA DHS ELAP# 2496

05/12/2004 10:36

Gas/BTEX/MTBE by 8260B (C6-C12)

Cambria Environmental Emeryville

Attn.: Caryl Weekley

5900 Hollis Street, Ste. A
Emeryville, CA 94608
Phone: (510) 420-3324 Fax: (510) 420-9170

Project: 206-0503-001
98995745

Received: 05/07/2004 17:05

Site: 6039 College Avenue, Oakland, CA

Prep(s): 5030B	Test(s): 8260B
Sample ID: D-2-5	Lab ID: 2004-05-0244-4
Sampled: 05/07/2004 11:10	Extracted: 5/11/2004 14:25
Matrix: Soil	QC Batch#: 2004/05/11-1B.69

Compound	Conc.	RL	Unit	Dilution	Analyzed	Flag
Gasoline	ND	1.0	mg/Kg	1.00	05/11/2004 14:25	
Benzene	ND	0.0050	mg/Kg	1.00	05/11/2004 14:25	
Toluene	ND	0.0050	mg/Kg	1.00	05/11/2004 14:25	
Ethyl benzene	ND	0.0050	mg/Kg	1.00	05/11/2004 14:25	
Total xylenes	ND	0.0050	mg/Kg	1.00	05/11/2004 14:25	
Methyl tert-butyl ether (MTBE)	ND	0.0050	mg/Kg	1.00	05/11/2004 14:25	
Surrogate(s)						
1,2-Dichloroethane-d4	95.0	70-121	%	1.00	05/11/2004 14:25	
Toluene-d8	79.2	81-117	%	1.00	05/11/2004 14:25	sl

Severn Trent Laboratories, Inc.

STL San Francisco * 1220 Quarry Lane, Pleasanton, CA 94566

Tel 925 484 1919 Fax 925 484 1096 * www.stl-inc.com * CA DHS ELAP# 2496

05/12/2004 10:36

Gas/BTEX/MTBE by 8260B (C6-C12)

Cambria Environmental Emeryville

Attn.: Caryl Weekley

5900 Hollis Street, Ste. A

Emeryville, CA 94608

Phone: (510) 420-3324 Fax: (510) 420-9170

Project: 206-0503-001

98995745

Received: 05/07/2004 17:05

Site: 6039 College Avenue, Oakland, CA

Prep(s):	5030B	Test(s):	8260B
Sample ID:	P-3-4	Lab ID:	2004-05-0244 - 5
Sampled:	05/07/2004 11:35	Extracted:	5/11/2004 15:01
Matrix:	Soil	QC Batch#:	2004/05/11-1B-69
Analysis Flag: 0 (See Legend and Note Section)			

Compound	Conc.	RL	Unit	Dilution	Analyzed	Flag
Gasoline	17	4.3	mg/Kg	4.31	05/11/2004 15:01	g
Benzene	ND	0.022	mg/Kg	4.31	05/11/2004 15:01	
Toluene	ND	0.022	mg/Kg	4.31	05/11/2004 15:01	
Ethyl benzene	ND	0.022	mg/Kg	4.31	05/11/2004 15:01	
Total xylenes	ND	0.022	mg/Kg	4.31	05/11/2004 15:01	
Methyl tert-butyl ether (MTBE)	ND	0.022	mg/Kg	4.31	05/11/2004 15:01	
Surrogate(s)						
1,2-Dichloroethane-d4	92.1	70-121	%	4.31	05/11/2004 15:01	
Toluene-d8	96.4	81-117	%	4.31	05/11/2004 15:01	

Severn Trent Laboratories, Inc.

STL San Francisco * 1220 Quarry Lane, Pleasanton, CA 94566

Tel 925 484 1919 Fax 925 484 1096 * www.stl-inc.com * CA DHS ELAP# 2496

05/12/2004 10:36

Gas/BTEX/MTBE by 8260B (C6-C12)

Cambria Environmental Emeryville

Attn.: Caryl Weekley

5900 Hollis Street, Ste. A
Emeryville, CA 94608
Phone: (510) 420-3324 Fax: (510) 420-9170

Project: 206-0503-001
98995745

Received: 05/07/2004 17:05

Site: 6039 College Avenue, Oakland, CA

Prep(s): 5030B	Test(s): 8260B
Sample ID: D-3-5	Lab ID: 2004-05-0244-6
Sampled: 05/07/2004 11:45	Extracted: 5/10/2004 21:56
Matrix: Soil	QC Batch#: 2004/05/10-28.69

Compound	Conc.	RL	Unit	Dilution	Analyzed	Flag
Gasoline	ND	1.0	mg/Kg	1.00	05/10/2004 21:56	
Benzene	ND	0.0050	mg/Kg	1.00	05/10/2004 21:56	
Toluene	ND	0.0050	mg/Kg	1.00	05/10/2004 21:56	
Ethyl benzene	ND	0.0050	mg/Kg	1.00	05/10/2004 21:56	
Total xylenes	ND	0.0050	mg/Kg	1.00	05/10/2004 21:56	
Methyl tert-butyl ether (MTBE)	ND	0.0050	mg/Kg	1.00	05/10/2004 21:56	
Surrogate(s)						
1,2-Dichloroethane-d4	94.9	70-121	%	1.00	05/10/2004 21:56	
Toluene-d8	92.7	81-117	%	1.00	05/10/2004 21:56	

Severn Trent Laboratories, Inc.

STL San Francisco * 1220 Quarry Lane, Pleasanton, CA 94566

Tel 925 484 1919 Fax 925 484 1096 * www.stl-inc.com * CA DHS ELAP# 2496

05/12/2004 10:36

Gas/BTEX/MTBE by 8260B (C6-C12)

Cambria Environmental Emeryville

Attn.: Caryl Weekley

5900 Hollis Street, Ste. A

Emeryville, CA 94608

Phone: (510) 420-3324 Fax: (510) 420-9170

Project: 206-0503-001

98995745

Received: 05/07/2004 17:05

Site: 6039 College Avenue, Oakland, CA

Prep(s):	5030B	Test(s):	8260B
Sample ID:	P-4-4	Lab ID:	2004-05-0244 - 7
Sampled:	05/07/2004 12:00	Extracted:	5/11/2004 14:43
Matrix:	Soil	QC Batch#:	2004/05/11-1B.69

Compound	Conc.	RL	Unit	Dilution	Analyzed	Flag
Gasoline	ND	1.0	mg/Kg	1.00	05/11/2004 14:43	
Benzene	ND	0.0050	mg/Kg	1.00	05/11/2004 14:43	
Toluene	ND	0.0050	mg/Kg	1.00	05/11/2004 14:43	
Ethyl benzene	ND	0.0050	mg/Kg	1.00	05/11/2004 14:43	
Total xylenes	ND	0.0050	mg/Kg	1.00	05/11/2004 14:43	
Methyl tert-butyl ether (MTBE)	ND	0.0050	mg/Kg	1.00	05/11/2004 14:43	
Surrogate(s)						
1,2-Dichloroethane-d4	91.6	70-121	%	1.00	05/11/2004 14:43	
Toluene-d8	81.9	81-117	%	1.00	05/11/2004 14:43	

Severn Trent Laboratories, Inc.

STL San Francisco * 1220 Quarry Lane, Pleasanton, CA 94566

Tel 925 484 1919 Fax 925 484 1096 * www.stl-inc.com * CA DHS ELAP# 2496

05/12/2004 10:36

Gas/BTEX/MTBE by 8260B (C6-C12)

Cambria Environmental Emeryville

Attn.: Caryl Weekley

5900 Hollis Street, Ste. A
Emeryville, CA 94608
Phone: (510) 420-3324 Fax: (510) 420-9170

Project: 206-0503-001
98995745

Received: 05/07/2004 17:05

Site: 6039 College Avenue, Oakland, CA

Prep(s):	5030B	Test(s):	8260B
Sample ID:	D-4-5	Lab ID:	2004-05-0244 - 8
Sampled:	05/07/2004 11:50	Extracted:	5/10/2004 22:33
Matrix:	Soil	QC Batch#:	2004/05/10-2B.69

Compound	Conc.	RL	Unit	Dilution	Analyzed	Flag
Gasoline	ND	1.0	mg/Kg	1.00	05/10/2004 22:33	
Benzene	ND	0.0050	mg/Kg	1.00	05/10/2004 22:33	
Toluene	ND	0.0050	mg/Kg	1.00	05/10/2004 22:33	
Ethyl benzene	ND	0.0050	mg/Kg	1.00	05/10/2004 22:33	
Total xylenes	ND	0.0050	mg/Kg	1.00	05/10/2004 22:33	
Methyl tert-butyl ether (MTBE)	ND	0.0050	mg/Kg	1.00	05/10/2004 22:33	
Surrogate(s)						
1,2-Dichloroethane-d4	98.8	70-121	%	1.00	05/10/2004 22:33	
Toluene-d8	89.4	81-117	%	1.00	05/10/2004 22:33	

Gas/BTEX/MTBE by 8260B (C6-C12)

Cambria Environmental Emeryville

Attn.: Caryl Weekley

5900 Hollis Street, Ste. A
Emeryville, CA 94608
Phone: (510) 420-3324 Fax: (510) 420-9170

Project: 206-0503-001
98995745

Received: 05/07/2004 17:05

Site: 6039 College Avenue, Oakland, CA

Batch QC Report			
Prep(s): 5030B			Test(s): 8260B
Method Blank	Soil		QC Batch # 2004/05/10-2B.69
MB: 2004/05/10-2B.69-005			Date Extracted: 05/10/2004 18:05

Compound	Conc.	RL	Unit	Analyzed	Flag
Gasoline	ND	1.000	mg/Kg	05/10/2004 18:05	
Methyl tert-butyl ether (MTBE)	ND	0.0050	mg/Kg	05/10/2004 18:05	
Benzene	ND	0.0050	mg/Kg	05/10/2004 18:05	
Toluene	ND	0.0050	mg/Kg	05/10/2004 18:05	
Ethyl benzene	ND	0.0050	mg/Kg	05/10/2004 18:05	
Total xylenes	ND	0.0050	mg/Kg	05/10/2004 18:05	
Surrogates(s)					
1,2-Dichloroethane-d4	96.6	70-121	%	05/10/2004 18:05	
Toluene-d8	100.3	81-117	%	05/10/2004 18:05	

Gas/BTEX/MTBE by 8260B (C6-C12)

Cambria Environmental Emeryville

Attn.: Caryl Weekley

5900 Hollis Street, Ste. A
Emeryville, CA 94608
Phone: (510) 420-3324 Fax: (510) 420-9170

Project: 206-0503-001
98995745

Received: 05/07/2004 17:05

Site: 6039 College Avenue, Oakland, CA

Batch QC Report					
Prep(s): 5030B			Test(s): 8260B		
Method Blank			Soil:		
MB: 2004/05/11-1B.69-030			QC Batch # 2004/05/11-1B.69		
			Date Extracted: 05/11/2004 07:30		
Compound	Conc.	RL	Unit	Analyzed	Flag
Gasoline	ND	1.000	mg/Kg	05/11/2004 07:30	
Methyl tert-butyl ether (MTBE)	ND	0.0050	mg/Kg	05/11/2004 07:30	
Benzene	ND	0.0050	mg/Kg	05/11/2004 07:30	
Toluene	ND	0.0050	mg/Kg	05/11/2004 07:30	
Ethyl benzene	ND	0.0050	mg/Kg	05/11/2004 07:30	
Total xylenes	ND	0.0050	mg/Kg	05/11/2004 07:30	
Surrogates(s)					
1,2-Dichloroethane-d4	87.5	70-121	%	05/11/2004 07:30	
Toluene-d8	92.4	81-117	%	05/11/2004 07:30	

Gas/BTEX/MTBE by 8260B (C6-C12)

Cambria Environmental Emeryville

Attn.: Caryl Weekley

5900 Hollis Street, Ste. A
Emeryville, CA 94608
Phone: (510) 420-3324 Fax: (510) 420-9170

Project: 206-0503-001
98995745

Received: 05/07/2004 17:05

Site: 6039 College Avenue, Oakland, CA

Batch QC Report			
Prep(s): 5030B		Test(s): 8260B	
Laboratory Control Spike		Soil	QC Batch #: 2004/05/10-2B 69
LCS	2004/05/10-2B 69-029	Extracted: 05/10/2004	Analyzed: 05/10/2004 17:29
LCSD	2004/05/10-2B 69-047	Extracted: 05/10/2004	Analyzed: 05/10/2004 17:47

Compound	Conc. mg/Kg		Exp.Conc.	Recovery %		RPD	Ctrl.Limits %		Flags	
	LCS	LCSD		LCS	LCSD		%	Rec.	RPD	LCS
Methyl tert-butyl ether (MTBE)	0.0347	0.0392	0.05	69.4	78.4	12.2	65-165	20		
Benzene	0.0413	0.0415	0.05	82.6	83.0	0.5	69-129	20		
Toluene	0.0458	0.0478	0.05	91.6	95.6	4.3	70-130	20		
Surrogates(s)										
1,2-Dichloroethane-d4	395	405	500	79.0	81.0		70-121			
Toluene-d8	492	482	500	98.4	96.4		81-117			

Gas/BTEX/MTBE by 8260B (C6-C12)

Cambria Environmental Emeryville
Attn.: Caryl Weekley

5900 Hollis Street, Ste. A
Emeryville, CA 94608
Phone: (510) 420-3324 Fax: (510) 420-9170

Project: 206-0503-001
98995745

Received: 05/07/2004 17:05

Site: 6039 College Avenue, Oakland, CA

Batch QC Report										
Prep(s): 5030B						Test(s): 8260B				
Laboratory Control Spike			Soil			QC Batch # 2004/05/11-1B 69				
LCS	2004/05/11-1B 69-052		Extracted: 05/11/2004			Analyzed: 05/11/2004 06:52				
LCSD	2004/05/11-1B 69-010		Extracted: 05/11/2004			Analyzed: 05/11/2004 07:10				
Compound	Conc. mg/Kg		Exp.Conc.	Recovery %		RPD	Ctrl.Limits %		Flags	
	LCS	LCSD		LCS	LCSD		%	Rec.	RPD	LCS
Methyl tert-butyl ether (MTBE)	0.0445	0.0440	0.05	89.0	88.0	1.1	65-165	20		
Benzene	0.0444	0.0444	0.05	88.8	88.8	0.0	69-129	20		
Toluene	0.0488	0.0490	0.05	97.6	98.0	0.4	70-130	20		
Surrogates(s)										
1,2-Dichloroethane-d4	401	409	500	80.2	81.8		70-121			
Toluene-d8	471	481	500	94.2	96.2		81-117			

Gas/BTEX/MTBE by 8260B (C6-C12)

Cambria Environmental Emeryville

Attn.: Caryl Weekley

5900 Hollis Street, Ste. A
Emeryville, CA 94608
Phone: (510) 420-3324 Fax: (510) 420-9170

Project: 206-0503-001
98995745

Received: 05/07/2004 17:05

Site: 6039 College Avenue, Oakland, CA

Batch QC Report			
Prep(s):	5030B	Test(s):	8260B
Matrix Spike (MS / MSD)		Soil	QC Batch # 2004/05/11-1B.69
P-1-4	>> MS	Lab ID:	2004-05-0244-001
MS:	2004/05/11-1B.69-007	Extracted:	05/11/2004
		Analyzed:	05/11/2004 14:07
		Dilution:	1.00
MSD:	2004/05/11-1B.69-037	Extracted:	05/11/2004
		Analyzed:	05/11/2004 15:37
		Dilution:	1.00

Compound	Conc. mg/Kg		Spk.Level	Recovery %			Limits %		Flags		
	MS	MSD		Sample	mg/Kg	MS	MSD	RPD	Rec.	RPD	MS
Methyl tert-butyl ether	0.0432	0.0520	ND	0.045289	95.4	110.9	15.0	65-165	20		
Benzene	0.0426	0.0474	ND	0.045289	94.0	101.1	7.3	69-129	20		
Toluene	0.0425	0.0481	ND	0.045289	93.8	102.6	9.0	70-130	20		
Surrogate(s)											
1,2-Dichloroethane-d4	439	474		500	87.8	94.8		70-121			
Toluene-d8	444	475		500	88.9	95.0		81-117			

Gas/BTEX/MTBE by 8260B (C6-C12)

Cambria Environmental Emeryville

Attn.: Caryl Weekley

5900 Hollis Street, Ste. A

Emeryville, CA 94608

Phone: (510) 420-3324 Fax: (510) 420-9170

Project: 206-0503-001

98995745

Received: 05/07/2004 17:05

Site: 6039 College Avenue, Oakland, CA

Legend and Notes

Analysis Flag

o

Reporting limits were raised due to high level of analyte present in the sample.

Result Flag

g

Hydrocarbon reported in the gasoline range does not match our gasoline standard.

sl

Surrogate recoveries were lower than QC limit due to matrix interference, confirmed by reanalysis.

Severn Trent Laboratories, Inc.

STL San Francisco * 1220 Quarry Lane, Pleasanton, CA 94566

Tel 925 484 1919 Fax 925 484 1096 * www.stl-inc.com * CA DHS ELAP# 2496

05/12/2004 10:36

LAB: STL San Francisco

SHELL Chain Of Custody Record

85623

Lab Identification (if necessary):

Address: 1220 Quarry Lane

City, State, Zip: Pleasanton CA, 94566

Shell Project Manager to be invoiced:

SCIENCE & ENGINEERING
 TECHNICAL SERVICES
 CUMULOUS

2004-05-0244

Bill Merchant

INCIDENT NUMBER (S&E ONLY)

9 8 9 9 5 7 4 5

SAP or CRMT NUMBER (TS/QRMT)

1 3 5 6 8 5

DATE: 5/7/04

Page 1 of 1

SAMPLING CONTRACT: Cambria Environmental
ADDRESS: 5900 Hollis St, Ste A, Emeryville, CA
PHONE CONTACT (Monday or Afternoon): Caryl Weeley
TELEPHONE: 510-420-3324
FAX: 510-420-9170
EMAIL: sdalle@cambria-env.com

UCC CODE: CETO
SITE ADDRESS (Street and City): 6039 College Avenue, Oakland CA
GLOBAL ADDR: T0600101272

CONTRACT DELIVERABLE TO (Responsible Party or Designee): sheskoaklanded7@cambria-env.com
PHONE NO.: 510-420-3339
E-MAIL: sdalle@cambria-env.com
CONSULTANT FAX/TELEPHONE: 206-0503-001

SAMPLER NAME(S) (Print): Stu Dalia

LAB USE ONLY

REQUESTED ANALYSIS

RUSH

TURNAROUND TIME (BUSINESS DAYS):
 10-24 HOURS 5 DAYS 72 HOURS 18 HOURS 24 HOURS LESS THAN 24 HOURS

LA RWQCB REPORT FORM USE AGENCY

OCMS MTBE CONFIRMATION: HIGHEST _____ HIGHEST PER BORING _____ ALL _____

SPECIAL INSTRUCTIONS OR NOTES: CHECK BOX IF EDO IS NOT NEEDED:

Please see results to sdalle@cambria-env.com

TPH - Gas, Purgeable	TPH	BTX	TBA	MTBE (8260B - 0.5ppb RL)	TAME, D1PE, ETBE, EDB, 1,2-DCA	Ethanol (8250B)	Methanol	EDB & 1,2-DCA (8260B)	EPA 5035 Extraction for Volatiles	VOCs Halogenated/Aromatics (8016)	TRPH (416-1)	Vapor VOCs: STX / MTBE (TO-15)	Vapor VOCs - Full List (TO-15)	Vapor TPH (ASTM D4156)	Vapor Fixed Gases (ASTM D1846)	Test for Disposal (4B)	Test for Disposal, see attached	TPH - Diesel, Extractable (8016m)	MTBE (8260B) Confirmation, See Note
----------------------	-----	-----	-----	--------------------------	--------------------------------	-----------------	----------	-----------------------	-----------------------------------	-----------------------------------	--------------	--------------------------------	--------------------------------	------------------------	--------------------------------	------------------------	---------------------------------	-----------------------------------	-------------------------------------

FIELD NOTES:
 Container/Preservative
 or PID Reading
 or Laboratory Notes

3.0°C
 On ICE: Field point ID

TEMPERATURE ON RECEIPT: _____

L.S. #S	Field Sample Identification	SAMPLING		MATRIX	NO. OF CONT.	TPH	BTX	TBA	MTBE	TAME, D1PE, ETBE, EDB, 1,2-DCA	Ethanol	Methanol	EDB & 1,2-DCA	EPA 5035	VOCs	TRPH	Vapor VOCs	Vapor VOCs - Full List	Vapor TPH	Vapor Fixed Gases	Test for Disposal	Test for Disposal	TPH - Diesel	MTBE	TEMPERATURE ON RECEIPT
		DATE	TIME																						
	P-1-4'	5/7/04	100500	Soil	1	X	X		X																
	D-1-5'		1105																						
	P-2-4'		1120																						
	D-2-5'		1150																						
	P-3-4'		1135																						
	D-3-5'		1145																						
	P-4-4'		1200																						
	D-4-5'		1130																						

Relinquished by (Signature): [Signature] **Received by (Signature):** [Signature] **Date:** 5/7/04 **Time:** 3 PM

Relinquished by (Signature): [Signature] **Received by (Signature):** [Signature] **Date:** 5/7/04 **Time:** 1705

Relinquished by (Signature): [Signature] **Received by (Signature):** Name: [Signature] / STL-SF **Date:** 5/7/04 **Time:** 1705

Cambria Environmental Emeryville

May 10, 2004

5900 Hollis Street, Ste. A
Emeryville, CA 94608

Attn.: Caryl Weekley

Project#: 206-0503-001

Project: 98995745

Site: 6039 College Avenue, Oakland, CA

Dear Ms. Weekley,

Attached is our report for your samples received on 05/07/2004 17:05

This report has been reviewed and approved for release. Reproduction of this report is permitted only in its entirety.

Please note that any unused portion of the samples will be discarded after 06/21/2004 unless you have requested otherwise.

We appreciate the opportunity to be of service to you. If you have any questions, please call me at (925) 484-1919.

You can also contact me via email. My email address is: vvancil@stl-inc.com

Sincerely,

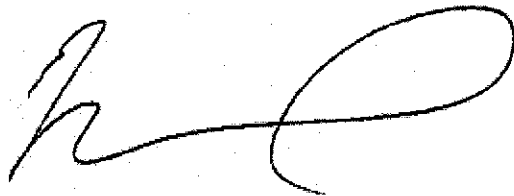

Vincent Vancil
Project Manager

Severn Trent Laboratories, Inc.

STL San Francisco * 1220 Quarry Lane, Pleasanton, CA 94566

Tel 925 484 1919 Fax 925 484 1096 * www.stl-inc.com * CA DHS ELAP# 2496

Gas/BTEX Fuel Oxygenates by 8260B (C6-C12)

Cambria Environmental Emeryville

Attn.: Caryl Weekley

5900 Hollis Street, Ste. A

Emeryville, CA 94608

Phone: (510) 420-3324 Fax: (510) 420-9170

Project: 206-0503-001

98995745

Received: 05/07/2004 17:05

Site: 6039 College Avenue, Oakland, CA

Samples Reported

Sample Name	Date Sampled	Matrix	Lab #
SP-1	05/07/2004 13:00	Soil	1

Severn Trent Laboratories, Inc.

STL San Francisco * 1220 Quarry Lane, Pleasanton, CA 94566

Tel 925 484 1919 Fax 925 484 1096 * www.stl-inc.com * CA DHS ELAP# 2496

05/10/2004 15:05

Gas/BTEX Fuel Oxygenates by 8260B (C6-C12)

Cambria Environmental Emeryville

Attn.: Caryl Weekley

5900 Hollis Street, Ste. A

Emeryville, CA 94608

Phone: (510) 420-3324 Fax: (510) 420-9170

Project: 206-0503-001

98995745

Received: 05/07/2004 17:05

Site: 6039 College Avenue, Oakland, CA

Prep(s):	5030B	Test(s):	8260B
Sample ID:	SP-1	Lab ID:	2004-05-0243-1
Sampled:	05/07/2004 13:00	Extracted:	5/10/2004 14:39
Matrix:	Soil	QC Batch#:	2004/05/10-1A.69

Compound	Conc.	RL	Unit	Dilution	Analyzed	Flag
Gasoline	ND	1.0	mg/Kg	1.00	05/10/2004 14:39	
Benzene	ND	0.0050	mg/Kg	1.00	05/10/2004 14:39	
Toluene	ND	0.0050	mg/Kg	1.00	05/10/2004 14:39	
Ethyl benzene	ND	0.0050	mg/Kg	1.00	05/10/2004 14:39	
Total xylenes	ND	0.0050	mg/Kg	1.00	05/10/2004 14:39	
Surrogate(s)						
1,2-Dichloroethane-d4	85.5	70-121	%	1.00	05/10/2004 14:39	
Toluene-d8	93.3	81-117	%	1.00	05/10/2004 14:39	

Severn Trent Laboratories, Inc.

STL San Francisco * 1220 Quarry Lane, Pleasanton, CA 94566

Tel 925 484 1919 Fax 925 484 1096 * www.stl-inc.com * CA DHS ELAP# 2496

05/10/2004 15:05

Gas/BTEX Fuel Oxygenates by 8260B (C6-C12)

Cambria Environmental Emeryville

Attn.: Caryl Weekley

5900 Hollis Street, Ste. A

Emeryville, CA 94608

Phone: (510) 420-3324 Fax: (510) 420-9170

Project: 206-0503-001

98995745

Received: 05/07/2004 17:05

Site: 6039 College Avenue, Oakland, CA

Batch QC Report					
Prep(s): 5030B				Test(s): 8260B	
Method Blank		Soil		QC Batch # 2004/05/10-1A.69	
MB: 2004/05/10-1A 69-025				Date Extracted: 05/10/2004 08:25	

Compound	Conc.	RL	Unit	Analyzed	Flag
Gasoline	ND	1.0	mg/Kg	05/10/2004 08:25	
Benzene	ND	0.0050	mg/Kg	05/10/2004 08:25	
Toluene	ND	0.0050	mg/Kg	05/10/2004 08:25	
Ethyl benzene	ND	0.0050	mg/Kg	05/10/2004 08:25	
Total xylenes	ND	0.0050	mg/Kg	05/10/2004 08:25	
Surrogates(s)					
1,2-Dichloroethane-d4	89.4	70-121	%	05/10/2004 08:25	
Toluene-d8	98.6	81-117	%	05/10/2004 08:25	

Gas/BTEX Fuel Oxygenates by 8260B (C6-C12)

Cambria Environmental Emeryville

Attn.: Caryl Weekley

5900 Hollis Street, Ste. A
Emeryville, CA 94608
Phone: (510) 420-3324 Fax: (510) 420-9170

Project: 206-0503-001
98995745

Received: 05/07/2004 17:05

Site: 6039 College Avenue, Oakland, CA

Batch QC Report										
Prep(s): 5030B					Test(s): 8260B					
Laboratory Control Spike			Soil			QC Batch # 2004/05/10-1A 69				
LCS	2004/05/10-1A 69-049		Extracted: 05/10/2004			Analyzed: 05/10/2004 07:49				
LCSD	2004/05/10-1A 69-007		Extracted: 05/10/2004			Analyzed: 05/10/2004 08:07				
Compound	Conc. mg/Kg		Exp.Conc.	Recovery %		RPD	Ctrl.Limits %		Flags	
	LCS	LCSD		LCS	LCSD		%	Rec.	RPD	LCS
Benzene	0.0478	0.0454	0.05	95.6	90.8	5.2	69-129	20		
Toluene	0.0514	0.0504	0.05	102.8	100.8	2.0	70-130	20		
Surrogates(s)										
1,2-Dichloroethane-d4	386	385	500	77.2	77.0		70-121			
Toluene-d8	486	474	500	97.2	94.8		81-117			

Severn Trent Laboratories, Inc.

STL San Francisco * 1220 Quarry Lane, Pleasanton, CA 94566

Tel 925 484 1919 Fax 925 484 1096 * www.stl-inc.com * CA DHS ELAP# 2496

05/10/2004 15:05

Total Lead

Cambria Environmental Emeryville

Attn.: Caryl Weekley

5900 Hollis Street, Ste. A

Emeryville, CA 94608

Phone: (510) 420-3324 Fax: (510) 420-9170

Project: 206-0503-001

98995745

Received: 05/07/2004 17:05

Site: 6039 College Avenue, Oakland, CA

Samples Reported

Sample Name	Date Sampled	Matrix	Lab #
SP-1	05/07/2004 13:00	Soil	1

Total Lead

Cambria Environmental Emeryville

Attn.: Caryl Weekley

5900 Hollis Street, Ste. A

Emeryville, CA 94608

Phone: (510) 420-3324 Fax: (510) 420-9170

Project: 206-0503-001

98995745

Received: 05/07/2004 17:05

Site: 6039 College Avenue, Oakland, CA

Prep(s):	3050B	Test(s):	6010B
Sample ID:	SP-1	Lab ID:	2004-05-0243 - 1
Sampled:	05/07/2004 13:00	Extracted:	5/6/2004 19:32
Matrix:	Soil	QC Batch#:	2004/05/07-06.15

Compound	Conc.	RL	Unit	Dilution	Analyzed	Flag
Lead	5.2	1.0	mg/Kg	1.00	05/10/2004 10:58	

Severn Trent Laboratories, Inc.

STL San Francisco * 1220 Quarry Lane, Pleasanton, CA 94566

Tel 925 484 1919 Fax 925 484 1096 * www.stl-inc.com * CA DHS ELAP# 2496

05/10/2004 15:43

Total Lead

Cambria Environmental Emeryville
Attn.: Caryl Weekley

5900 Hollis Street, Ste. A
Emeryville, CA 94608
Phone: (510) 420-3324 Fax: (510) 420-9170

Project: 206-0503-001
98995745

Received: 05/07/2004 17:05

Site: 6039 College Avenue, Oakland, CA

Batch QC Report					
Prep(s): 3050B				Test(s): 6010B	
Method Blank		Soil		QC Batch # 2004/05/07-06.15	
MB: 2004/05/07-06.15-043				Date Extracted: 05/06/2004 19:32	

Compound	Conc.	RL	Unit	Analyzed	Flag
Lead	ND	1.0	mg/Kg	05/10/2004 09:29	

Total Lead

Cambria Environmental Emeryville

Attn.: Caryl Weekley

5900 Hollis Street, Ste. A
Emeryville, CA 94608
Phone: (510) 420-3324 Fax: (510) 420-9170

Project: 206-0503-001
98995745

Received: 05/07/2004 17:05

Site: 6039 College Avenue, Oakland, CA

Batch QC Report										
Prep(s): 3050B					Test(s): 6010B					
Laboratory Control Spike			Soil			QC Batch # 2004/05/07-06:15				
LCS	2004/05/07-06:15-044		Extracted: 05/06/2004			Analyzed: 05/10/2004 09:33				
LCSD	2004/05/07-06:15-047		Extracted: 05/06/2004			Analyzed: 05/10/2004 09:48				
Compound	Conc. mg/Kg		Exp.Conc.	Recovery %		RPD	Ctrl.Limits %		Flags	
	LCS	LCSD		LCS	LCSD		%	Rec.	RPD	LCS
Lead	97.7	98.2	100.0	97.7	98.2	0.5	80-120	20		

LAB: STL San Francisco

SHELL Chain Of Custody Record

85623

Lab Identification (if necessary):

Address: 1220 Country Lane

City, State, Zip: Pleasanton CA, 94566

Shell Project Manager to be Invoiced:

- SURVEILLANCE & ENGINEERING
- TECHNICAL SERVICES
- CRMT HOLDINGS

2004-05-0243

Bill Merchant

INCIDENT NUMBER (SEE ONLY)

9 8 9 9 5 7 4 5

DATE: 5/7/04

SAP or CRMT NUMBER (S/CRMT)

1 3 5 6 8 5

Page 1 of 2

SAMPLING COMPANY: Cambria Environmental
LOG CODE: CETO
SITE ADDRESS (Street and City): 6039 College Avenue, Oakland CA
GLOBAL ID#: T0600101272

ADDRESS: 5900 Hollis St., Ste A, Emeryville, CA
EDP DELIVERABLE TO (Responsible Party or Designee): [Blank]
PHONE NO.: 910-420-3339
EMAIL: sdallo@cambria-env.com
CONSULTANT PROJECT NO.: 200-0501-001

PROJECT CONTACT (Name/Job #/POC Reason): Caryl Weekley
EMAIL: sdallo@cambria-env.com
TELEPHONE: 510-420-3324
FAX: 510-420-3170
EMAIL: sdallo@cambria-env.com

TURNAROUND TIME (BUSINESS DAYS):
 10 DAYS 5 DAYS 72 HOURS 48 HOUR 24 HOURS LESS THAN 24 HOURS

LA - RWQCB REPORT FORM UST AGENCY

GC/MS MTBE CONFIRMATION: HIGHEST _____ HIGHEST per BGR/MS ALL _____

SPECIAL INSTRUCTIONS OR NOTES: CHECK BOX IF EDO IS NOT NEEDED:
 Please cc results to sdallo@cambria-env.com

4 pt composite for water

REQUESTED ANALYSIS

RUSH

FIELD NOTES:

Container/Preservative or PID Readings or Laboratory Notes

3.0°C

On ICE Field point

TEMPERATURE ON RECEIPT °C

Lab #	Field Sample Identification	SAMPLING		MTRX	NO. OF CONT.	TPH - Gas, Purgeable	BTEX	TBA	MTBE (B20B) - 0.5ppb RL	TAME, DPE, ETBE, EDR, 1,2 DCA	Ethanol (B250B)	Methanol	EDG & 1,2-DCA (B260B)	EPA Eoas Extraction for Volatiles	VOCs (Hexogenated/Aromatic) (B021B)	TPH (B18.1)	Vapor VOCs - BTEX / MTBE (T0-15)	Vapor VOCs - Full List (T0-49)	Vapor TPH (ASTM 3416m)	Vapor Fixed Gases (ASTM D1946)	Test for Disposal (4B-)	Test for Disposal, see attached	TPH - Diesel, Extractable (B015m)	MTBE (B06B) Confirmation, See Note	TEMPERATURE ON RECEIPT °C	
		DATE	TIME																							
	SP-1A	5/7/04	1:00	Soil	1	X	X																			
	SP-1B	↓	↓	↓	↓	↓	↓															X				
	SP-1C	↓	↓	↓	↓	↓	↓															↓				
	SP-1D	↓	↓	↓	↓	↓	↓															↓				

SP-1

Requested by (Signature): [Signature] **Received by (Signature):** [Signature]
Date: 5/7/04 **Time:** 8:00 AM

Requested by (Signature): [Signature] **Received by (Signature):** [Signature]
Date: 5/7/04 **Time:** 1705

Requested by (Signature): [Signature] **Received by (Signature):** [Signature]
Date: 5/7/04 **Time:** 1705

DISTRIBUTION: White with final report, Green to PM, Yellow and Pink to Client.

10/15/01 Revision

CSO Graphix (714) 991-8702

This information is business proprietary and confidential and must not be divulged or shared outside the company. The use of this information is strictly for the purpose of doing business with the Centralized Residual Management Team (CRMT). Upon termination of the relationship with the CRMT, this information is not to be forwarded, duplicated, shared or used for any purpose other than for the documentation of past actions.

RESIDUAL MANAGEMENT PROCEDURE

ISSUED DATE: 08/01/01
 CANCELS ISSUE:
 ISSUED BY: LRR

RESIDUAL STREAM: SOIL WITH UNLEADED GASOLINE
VENDOR: ALLIED-BFI
LOCATION: ALLIED WASTE - MANTECA
 9999 SOUTH AUSTIN ROAD
 MANTECA, CA 95336

CALIFORNIA - TRANSPORTATION AND RETAIL

BTEX - EPA 8021B/8260B (IF BENZENE IS > OR = TO 10 MG/KG THEN TCLP BENZENE IS REQUIRED)

CAM METALS = TTLC METALS - **LEAD ONLY**

STLC ON ALL TTLC METALS 10 TIMES STLC MAXIMUM

TTLC LEAD => 13 MG/KG REQUIRES ORGANIC LEAD ANALYSIS

IF ANY TTLC TOTAL METAL IS > OR = TO 20 TIMES TCLP REGULATORY LEVELS, TCLP IS REQUIRED

TOTAL PETROLEUM HYDROCARBONS, METHOD 418.1 OR **8015** - GASOLINE

~~MTBE METHOD 8260B (GC/MS)~~

AQUATIC BIOASSAY (FISH TOX) IS ONLY TO BE RUN ON SAMPLES > OR = TO 5000 PPM TPH. AQUATIC BIOASSAY (FISH TOX) = PART 800 OF STANDARD METHODS FOR THE EXAMINATION OF WATER AND WASTEWATER (15TH EDITION)

LABORATORY INSTRUCTIONS (MINIMUM GUIDELINES ONLY)

-ALTERNATE APPROVED TEST METHODS PER SW846 ARE ALSO ACCEPTABLE

-ALL REQUIRED TESTS ON COMPOSITE (**max 4:1**)

-LABORATORY IS TO SUPPLY QA/QC INFORMATION WITH ALL ANALYTICAL REPORTS

~~MAIL OR FAX ALL ANALYSIS TO THE CENTRALIZED RESIDUAL MANAGEMENT TEAM~~

PROCEDURE ORIGINAL DATE: 08/01/01
 PROCEDURE REVISED DATE: 08/01/01

ATTACHMENT C

Waste Disposal Confirmation



Hazardous Waste Hauler (Registration #2843)

8896 Elder Creek Rd. • Sacramento, CA 95828 • FAX (916) 381-1573

Disposal Confirmation

Request for Transportation Received: 05/13/04

Consultant Information

Company: Cambria Environmental
 Contact: Stu Dalie
 Phone: 510 420-3339
 Fax: 510 420-9170

Site Information

Station #: N/A
 Street Address: 6039 College Ave.
 City, State, ZIP: Oakland, CA

Customer: Shell Oil Company RESA-0023-LDC
 RIPR #: 34703
 SAP # / Location: 135685
 Incident #: 98995745
 Location / WIC #: N/A
 Environmental Engineer: Bill Merchant

Material Description: Contaminated Soil
 Estimated Quantity: 2 yards
 Service Requested Date: _____

Disposal Facility: Forward Landfill
 Contact: Joe Griffith
 Phone: 800 204-4242
 Approval #: 4479
 Date of Disposal: 5/14/04
 Actual Tonnage: 11.36

Transporter: Manley & Sons Trucking, Inc.
 Contact: Lora Cardenas or Sandy Rose
 Phone: 916 381-6864
 Fax: 916 381-1573
 Invoice: _____
 Date of Invoice: _____