

C A M B R I A

ENVIRONMENTAL  
PROTECTION

July 28, 1998

98 AUG 19 AM 1:55

Scott Seery  
Alameda Health Care Services  
Department of Environmental Health  
1131 Harbor Bay Parkway, Suite 250  
Alameda, California 94502-6577

Re: **Second Quarter 1998 Monitoring Report**  
Shell-branded Service Station  
6039 College Avenue  
Oakland, California  
WIC #204-5508-3301  
Cambria Project #24-314-298



Dear Mr. Seery:

On behalf of Equilon Enterprises LLC, Cambria Environmental Technology, Inc. (Cambria) is submitting this ground water monitoring report in accordance with the reporting requirements of 23 CCR 2652d.

### **SECOND QUARTER 1998 ACTIVITIES**

Blaine Tech Services, Inc. (Blaine) of San Jose, California checked for separate-phase hydrocarbons (SPHs) and gauged all wells. Well MW-4 was the only well scheduled to be sampled this quarter. Due to the presence of SPHs in well MW-4, Blaine manually bailed 0.64 pounds of SPHs from the skimmer and no sample was collected. Cambria calculated ground water elevations (Table 1), compiled the historical analytical data (Tables 2a and 2b), tabulated the SPH removal (Table 3), and prepared a ground water elevation contour map (Figure 1). The Blaine report, which does not include a laboratory report this quarter, is included as Attachment A.

### **ANTICIPATED THIRD QUARTER 1998 ACTIVITIES**

Blaine will measure and remove detected SPHs, gauge all wells, and sample well MW-4 if no SPHs are present. Cambria will tabulate the data and prepare a monitoring report.

Oakland, CA  
Sonoma, CA  
Portland, OR  
Seattle, WA

**Cambria  
Environmental  
Technology, Inc.**

1144 65th Street  
Suite B  
Oakland, CA 94608  
Tel (510) 420-0700  
Fax (510) 420-9170

C A M B R I A

Scott Seery  
July 28, 1998

**CLOSING**

We appreciate the opportunity to work with you on this project. Please call Darryk Ataide at (510) 420-3339 if you have any questions or comments.

Sincerely,  
**Cambria Environmental Technology, Inc.**



  
Darryk Ataide  
Project Environmental Scientist

  
Diane M. Lundquist, P.E.  
Principal Engineer



Attachment: A - Blaine Ground Water Monitoring Report

cc: Karen Petryna, Equiva Services LLC, 108 Cutting Boulevard, Richmond, California 94804  
Tom Callaghan, Regional Water Quality Control Board, San Francisco Bay Region, 1515  
Clay Street, Suite 1400, Oakland, California 94612

G:\OAK6039\QM\2Q98QM.WPD

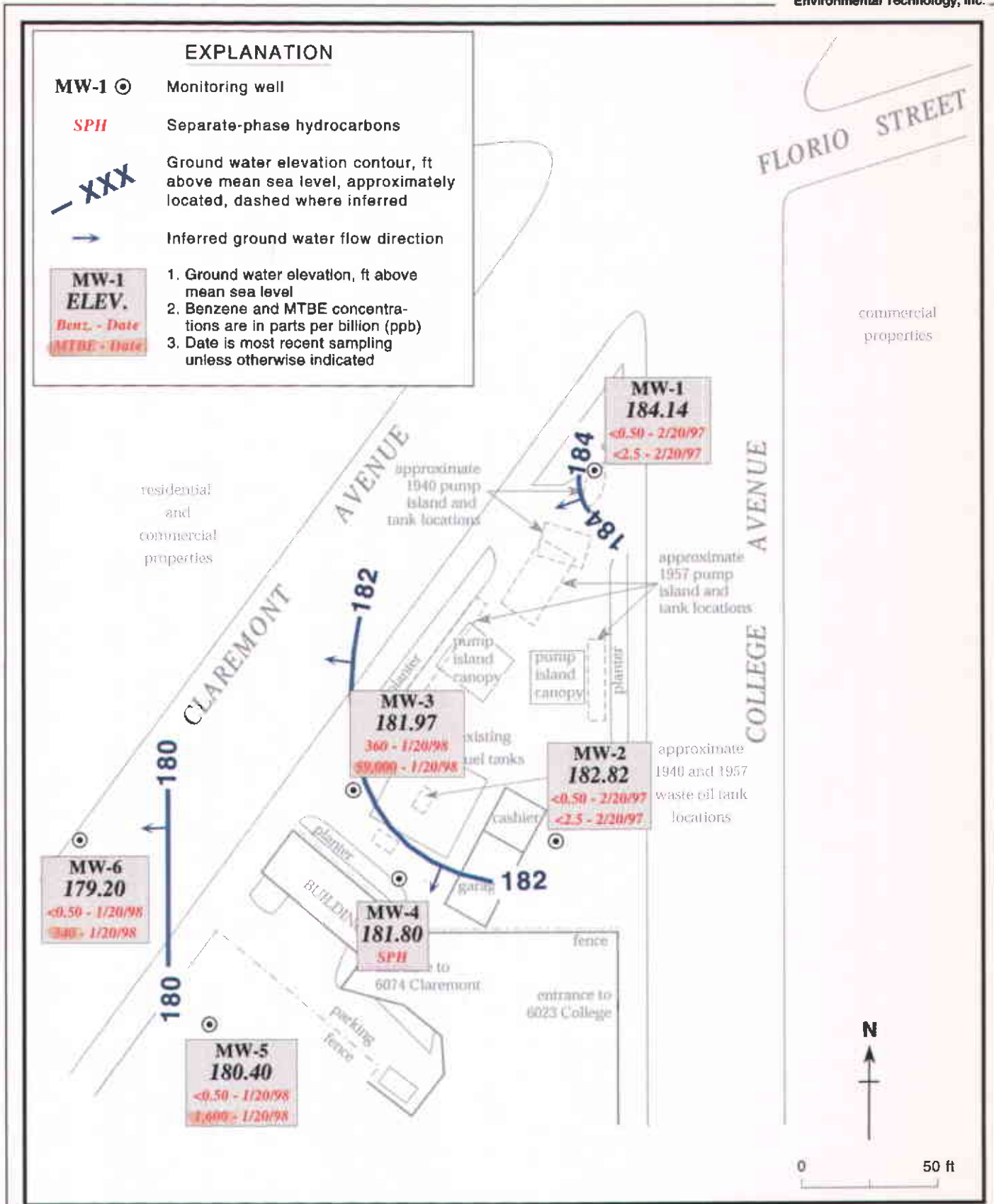

Figure 1. Ground Water Elevation Contours - June 5, 1998 - Shell-branded Service Station, WIC #204-5508-3301, 6039 College Avenue, Oakland, California

**Table 1. Ground Water Elevations – Shell-branded Service Station WIC #204-5508-3301, 6039 College Avenue, Oakland, California**

Well ID	Date	Top-of-Casing Elevation (ft above msl)	Depth to Water (ft below TOC)	Separate-Phase Hydrocarbon Thickness (ft)	Ground Water Elevation (ft above msl) <sup>a</sup>
MW-1	02/15/90	195.89	17.73	---	178.16
	04/19/90		18.51	---	177.38
	05/14/90		18.92	---	176.97
	06/21/90		18.21	---	177.68
	09/12/90		19.81	---	176.08
	11/27/90		20.39	---	175.50
	03/08/91		16.85	---	179.04
	06/03/91		17.82	---	178.07
	08/30/91		19.87	---	176.02
	11/22/91		20.58	---	175.31
	03/18/92		13.55	---	182.34
	05/28/92		17.08	---	178.81
	08/19/92		19.07	---	176.82
	11/17/92		20.11	---	175.78
	02/12/93		12.10	---	183.79
	06/10/93		14.87	---	181.02
	08/18/93		16.90	---	178.99
	11/19/93		19.72	---	176.17
	02/28/94		15.08	---	180.81
	05/04/94		17.20	---	178.69
	08/10/94		18.76	---	177.13
	11/08/94		16.00	---	179.89
	02/01/95		10.18	---	185.71
	05/10/95		11.88	---	184.01
	08/24/95		15.60	---	180.29
	11/10/95		18.24	---	177.65
	02/24/96		9.88	---	186.01
	05/22/96		12.24	---	183.65
	08/19/96		15.86	---	180.03
	12/05/96		16.21	---	179.68
	01/08/97		9.73	---	186.16
	02/20/97		11.60	---	184.29
	05/30/97		15.02	---	180.87
08/18/97	17.20	---	178.69		
11/03/97	16.02	---	179.87		
01/20/98	9.35	---	186.54		
	<b>06/05/98</b>		<b>11.75</b>	---	<b>184.14</b>
MW-2	02/15/90	194.27	16.90	---	177.37
	04/19/90		17.69	---	176.58
	05/14/90		18.01	---	176.26
	06/21/90		17.39	---	176.88
	09/12/90		19.00	---	175.27
	11/27/90		19.44	---	174.83
	03/08/91		15.96	---	178.31

**Table 1. Ground Water Elevations – Shell-branded Service Station WIC #204-5508-3301, 6039 College Avenue, Oakland, California (continued)**

Well ID	Date	Top-of-Casing Elevation (ft above msl)	Depth to Water (ft below TOC)	Separate-Phase Hydrocarbon Thickness (ft)	Ground Water Elevation (ft above msl) <sup>a</sup>
	06/03/91		17.00	---	177.27
	08/30/91		18.95	---	175.32
	11/22/91		19.55	---	174.72
	03/18/92		12.91	---	181.36
	05/28/92		16.25	---	178.02
	08/19/92		18.21	---	176.06
	11/17/92		19.15	---	175.12
	02/12/93		11.60	---	182.67
	06/10/93		14.14	---	180.13
	08/18/93		16.10	---	178.17
	11/19/93		18.77	---	175.50
	02/28/94		14.35	---	179.92
	05/04/94		16.34	---	177.93
	08/10/94		15.79	---	178.48
	11/08/94		15.04	---	179.23
	02/01/95		10.08	---	184.19
	05/10/95		11.68	---	182.59
	08/24/95		14.94	---	179.33
	11/10/95		13.36	---	180.91
	02/24/96		9.90	---	184.37
	05/22/96		11.80	---	182.47
	08/19/96		15.08	---	179.19
	12/05/96		15.16	---	179.11
	01/08/97		9.76	---	184.51
	02/20/97		11.47	---	182.80
	05/30/97		14.30	---	179.97
	08/18/97		16.33	---	177.94
	11/03/97		15.54	---	178.73
	01/20/98		9.43	---	184.84
	<b>06/05/98</b>		<b>11.45</b>	<b>---</b>	<b>182.82</b>
MW-3	02/15/90	192.52	15.81	---	176.71
	04/19/90		16.57	---	175.95
	05/14/90		16.97	---	175.55
	06/21/90		16.27	---	176.25
	09/12/90		18.78	---	173.74
	11/27/90		18.27	---	174.25
	03/08/91		14.86	---	177.66
	06/03/91		15.84	---	176.68
	08/30/91		17.79	---	174.73
	11/22/91		18.40	---	174.12
	03/18/92		12.03	---	180.49
	05/28/92		15.16	---	177.36
	08/19/92		17.03	---	175.49
	11/17/92		17.94	---	174.58

**Table 1. Ground Water Elevations – Shell-branded Service Station WIC #204-5508-3301, 6039 College Avenue, Oakland, California (continued)**

Well ID	Date	Top-of-Casing Elevation (ft above msl)	Depth to Water (ft below TOC)	Separate-Phase Hydrocarbon Thickness (ft)	Ground Water Elevation (ft above msl) <sup>a</sup>
	02/12/93		9.16	---	183.36
	06/10/93		13.20	---	179.32
	08/18/93		14.93	---	177.59
	11/19/93		17.58	---	174.94
	02/28/94		13.30	---	179.22
	05/04/94		15.25	---	177.27
	08/10/94		16.63	---	175.89
	11/08/94		13.88	---	178.64
	02/01/95		9.25	---	183.27
	05/10/95		10.76	---	181.74
	08/24/95		13.90	---	178.62
	11/10/95		16.20	---	176.32
	02/24/96		8.93	---	183.59
	05/22/96		10.86	---	181.66
	08/19/96		13.97	---	178.55
	12/05/96		14.06	---	178.46
	02/20/97		10.60	---	181.92
	05/30/97		13.26	---	179.26
	08/18/97		15.21	---	177.31
	11/03/97		14.49	---	178.03
	01/20/98		8.43	---	184.09
	<b>06/05/98</b>		<b>10.55</b>	<b>---</b>	<b>181.97</b>
MW-4	02/15/90	193.37	16.73	---	176.65
	04/19/90		17.48	---	175.89
	05/14/90		17.88	---	175.49
	06/21/90		17.18	---	176.19
	09/12/90		17.85	---	175.52
	11/27/90		19.16	---	174.21
	03/08/91		15.77	---	177.60
	06/03/91		16.77	---	176.60
	08/30/91		18.71	---	174.66
	11/22/91		---	---	---
	03/18/92		13.15	0.24	180.41
	05/28/92		16.22	0.12	177.25
	08/19/92		18.05	0.09	175.39
	11/17/92		18.89	---	174.48
	02/12/93		11.78	<0.01	181.59
	06/10/93		14.20	---	179.17
	08/18/93		15.95	0.01	177.43
	11/19/93		18.48	0.01	174.90
	02/28/94		14.60	<0.01	178.77
	05/04/94		16.15	<0.01	177.22
	08/10/94		17.58	0.02	175.81
	11/08/94		15.05	0.05	178.36

**Table 1. Ground Water Elevations – Shell-branded Service Station WIC #204-5508-3301, 6039 College Avenue, Oakland, California (continued)**

Well ID	Date	Top-of-Casing Elevation (ft above msl)	Depth to Water (ft below TOC)	Separate-Phase Hydrocarbon Thickness (ft)	Ground Water Elevation (ft above msl) <sup>a</sup>
	02/01/95		10.71	0.04	182.69
	05/10/95		11.90	0.06	181.52
	08/24/95		14.97	0.02	178.42
	11/10/95		17.27	---	176.10
	02/24/96		10.44	0.03	182.95
	05/22/96		11.88	0.03	181.51
	08/19/96		15.23	0.02	178.16
	12/05/96		14.70	0.02	178.69
	01/08/97		11.60	0.02	181.79
	02/20/97		11.91	---	181.46
	05/30/97		14.68	---	178.69
	08/18/97		15.07	---	178.30
	11/03/97		15.87	---	177.50
	01/20/98		10.25	0.62	183.62
	<b>06/05/98</b>		<b>11.62</b>	<b>0.06</b>	<b>181.80</b>
MW-5	08/30/91	190.35	16.74	---	173.61
	11/22/91		17.27	---	173.08
	03/18/92		11.28	---	179.07
	05/28/92 <sup>b</sup>		---	---	---
	08/19/92		15.99	---	174.36
	11/17/92		16.84	---	173.51
	02/12/93		10.30	---	180.05
	06/10/93		12.36	---	177.99
	08/18/93		14.02	---	176.33
	11/19/93		16.50	---	173.85
	02/28/94		12.55	---	177.80
	05/04/94		14.27	---	176.08
	08/10/94		15.60	---	174.75
	11/08/94		12.85	---	177.50
	02/01/95		8.98	---	181.37
	05/10/95		10.16	---	180.19
	08/24/95		12.98	---	177.37
	11/10/95		15.12	---	175.23
	02/24/96 <sup>b</sup>		---	---	---
	05/22/96		10.10	---	180.25
	08/19/96		13.09	---	177.26
	12/05/96		13.31	---	177.04
	02/20/97		9.55	---	180.80
	05/30/97		12.40	---	177.95
	08/18/97		14.19	---	176.16
	11/03/97		13.66	---	176.69
	01/20/98		8.06	---	182.29
	<b>06/05/98</b>		<b>9.95</b>	<b>---</b>	<b>180.40</b>

**Table 1. Ground Water Elevations – Shell-branded Service Station WIC #204-5508-3301, 6039 College Avenue, Oakland, California (continued)**

Well ID	Date	Top-of-Casing Elevation (ft above msl)	Depth to Water (ft below TOC)	Separate-Phase Hydrocarbon Thickness (ft)	Ground Water Elevation (ft above msl) <sup>a</sup>
MW-6	09/21/93	189.05	14.64	---	174.41
	11/19/93		---	---	
	02/28/94		12.18	---	176.87
	05/04/94		13.62	---	175.43
	08/10/94		14.98	---	174.07
	11/08/94		12.20	---	176.85
	02/01/95		8.70	---	180.35
	05/10/95		9.86	---	179.19
	08/24/95		12.46	---	176.59
	11/10/95		14.56	---	174.49
	02/24/96 <sup>b</sup>		---	---	---
	05/22/96		10.23	---	178.82
	08/19/96		12.61	---	176.44
	12/05/96		12.47	---	176.58
	02/20/97		9.85	---	179.20
	05/30/97		11.96	---	177.09
	08/18/97		13.65	---	175.40
	11/03/97 <sup>b</sup>		---	---	---
	01/20/98		7.76	---	181.29
	<b>06/05/98</b>			<b>9.85</b>	<b>---</b>
T-1	05/30/97	Not Surveyed	Dry	---	Dry
	08/18/97		Dry	---	Dry
	11/03/97		Dry	---	Dry
	01/20/98		Dry	---	Dry
	<b>06/05/98</b>		<b>Dry</b>	<b>---</b>	<b>Dry</b>
T-2	05/30/97	Not Surveyed	Dry	---	Dry
	08/18/97		Dry	---	Dry
	11/03/97		Dry	---	Dry
	01/20/98		Dry	---	Dry
	<b>06/05/98</b>		<b>Dry</b>	<b>---</b>	<b>Dry</b>

**Abbreviations and Notes:**

- a = When separate-phase hydrocarbons are present, ground water elevation is corrected by the relation:  
Corrected ground water elevation = (TOC Elevation) - (depth to water) + (0.8 x separate-phase hydrocarbon thickness)
- b = Well inaccessible
- = Data not available
- ft = Feet
- msl = Mean sea level
- TOC= Top of casing



**Table 2a. Analytical Results for Ground Water - Gasoline Components – Shell-branded Service Station WIC #204-5508-3301, 6039 College Avenue, Oakland, California**

Well/Boring ID (Qtrs Sampled)	Date Sampled	Depth to Water (ft)	TPH-G	MTBE	B	T	E	X
			(Concentrations in µg/L)					
MW-1 (Discontinued)	02/13/90	17.73	95	---	ND	0.67	0.37	3.2
	05/14/90	18.92	95	---	0.70	0.57	0.71	3.5
	09/12/90	19.81	ND	---	ND	ND	ND	ND
	11/27/90	20.39	---	---	---	---	---	---
	03/08/91	16.85	ND	---	ND	ND	ND	ND
	06/03/91	17.82	ND	---	ND	ND	ND	ND
	08/30/91	19.87	16.85	---	ND	ND	ND	ND
	11/22/91	20.58	<50	---	<0.5	<0.5	<0.5	<0.5
	03/18/92	13.55	<30	---	<0.3	<0.3	<0.3	<0.3
	05/28/92	17.08	<50	---	<0.5	<0.5	<0.5	<0.5
	08/19/92	19.07	<50	---	<0.5	<0.5	<0.5	<0.5
	11/17/92	20.11	<50	---	<0.5	<0.5	<0.5	<0.5
	02/12/93	12.10	<50	---	<0.5	<0.5	<0.5	<0.5
	06/10/93	14.87	<50	---	<0.5	<0.5	<0.5	<0.5
	06/10/93 <sup>dup</sup>	14.87	<50	---	<0.5	<0.5	<0.5	<0.5
	08/18/93	16.90	<50	---	<0.5	<0.5	<0.5	<0.5
	11/19/93	19.72	<50	---	<0.5	<0.5	<0.5	<0.5
	02/18/94	15.08	<50	---	<0.5	<0.5	<0.5	1.7
	05/04/94	17.20	<50	---	<0.5	<0.5	<0.5	<0.5
	08/10/94	18.76	<50	---	<0.5	<0.5	<0.5	<0.5
	08/10/94 <sup>dup</sup>	18.76	<50	---	<0.5	<0.5	<0.5	<0.5
	11/08/94	16.00	<50	---	<0.5	<0.5	<0.5	<0.5
	02/01/95	10.18	<50	---	<0.5	<0.5	<0.5	<0.5
	05/10/95	11.88	<50	---	<0.5	<0.5	<0.5	<0.5
	08/24/95	15.60	<50	---	<0.5	<0.5	<0.5	<0.5
	11/10/95	18.24	<50	---	<0.5	<0.5	<0.5	<0.5
	02/24/96	9.88	<50	---	<0.5	<0.5	<0.5	<0.5
	05/22/96	12.24	<50	<2.5	<0.5	<0.5	<0.5	<0.5
	08/19/96	15.86	<50	<2.5	<0.5	<0.5	<0.5	<0.5
	12/05/96	16.21	160	<2.5	7.3	8.2	5.5	23
01/08/97	9.73	<50	<2.5	<0.50	<0.50	<0.50	<0.50	
02/20/97	11.60	<50	<2.5	<0.50	<0.50	<0.50	<0.50	
02/20/97 <sup>dup</sup>	11.60	<50	<2.5	<0.50	<0.50	<0.50	<0.50	

**Table 2a. Analytical Results for Ground Water - Gasoline Components – Shell-branded Service Station WIC #204-5508-3301, 6039 College Avenue, Oakland, California (continued)**

Well/Boring ID (Qtrs Sampled)	Date Sampled	Depth to Water (ft)	TPH-G	MTBE	B	T	E	X
			(Concentrations in µg/L)					
MW-2 (Discontinued)	02/13/90	16.90	ND	---	ND	ND	ND	ND
	05/14/90	18.01	ND	---	ND	ND	ND	ND
	09/12/90	19.00	ND	---	ND	ND	ND	ND
	11/27/90	19.44	ND	---	ND	ND	ND	ND
	03/08/91	15.96	ND	---	ND	ND	ND	ND
	06/03/91	17.00	ND	---	ND	ND	ND	ND
	08/30/91	18.95	ND	---	ND	ND	ND	ND
	11/22/91	19.55	<50	---	<0.5	<0.5	<0.5	<0.5
	03/18/92	12.91	<50	---	<0.3	<0.3	<0.3	<0.3
	05/28/92	16.25	<50	---	<0.5	<0.5	<0.5	<0.5
	08/19/92	18.21	<50	---	<0.5	2	1.2	1.9
	11/17/92	19.15	<50	---	<0.5	2	1.2	1.9
	02/12/93 <sup>dup</sup>	11.60	<50	---	<0.5	<0.5	<0.5	<0.5
	02/12/93	11.60	<50	---	<0.5	<0.5	<0.5	<0.5
	06/10/93	14.14	<50	---	<0.5	<0.5	<0.5	<0.5
	08/18/93	16.10	<50	---	<0.5	<0.5	<0.5	<0.5
	08/18/93 <sup>dup</sup>	16.10	<50	---	<0.5	<0.5	<0.5	<0.5
	11/19/93	18.77	<50	---	<0.5	<0.5	<0.5	<0.5
	02/18/94	14.55	<50	---	<0.5	<0.5	<0.5	1.6
	05/04/94	16.34	<50	---	<0.5	<0.5	<0.5	<0.5
	08/10/94	15.79	<50	---	<0.5	<0.5	<0.5	<0.5
	11/08/94	15.04	<50	---	<0.5	<0.5	<0.5	<0.5
	02/01/95	10.08	<50	---	<0.5	<0.5	<0.5	<0.5
	05/10/95	11.68	<50	---	<0.5	<0.5	<0.5	<0.5
	08/24/95	14.94	<50	---	<0.5	<0.5	<0.5	<0.5
	11/10/95	13.36	<50	---	1.7	0.8	1.4	4.9
	02/24/96	9.90	<50	---	<0.5	<0.5	<0.5	<0.5
	02/24/96 <sup>dup</sup>	9.90	<50	---	<0.5	<0.5	<0.5	<0.5
	05/22/96	11.80	<50	<2.5	<0.5	<0.5	<0.5	<0.5
	08/19/96	15.08	<50	<2.5	<0.5	<0.5	<0.5	<0.5
	08/19/96 <sup>dup</sup>	15.08	<50	<2.5	<0.5	<0.5	<0.5	<0.5
	12/05/96	15.16	<50	<2.5	1.5	1.6	1.2	5.2
01/08/97	9.76	<50	<2.5	<0.50	<0.50	<0.50	<0.50	
02/20/97	11.47	<50	<2.5	<0.50	<0.50	<0.50	<0.50	

**Table 2a. Analytical Results for Ground Water - Gasoline Components – Shell-branded Service Station WIC #204-5508-3301, 6039 College Avenue, Oakland, California (continued)**

Well/Boring ID (Qtrs Sampled)	Date Sampled	Depth to Water (ft)	TPH-G	MTBE	(Concentrations in µg/L)			
			←		B	T	E	X
MW-3 (1st)	02/13/90	15.81	4,700	---	320	29	110	33
	02/13/90 <sup>dup</sup>	15.81	4,600	---	380	8.6	160	57
	05/14/90	16.97	1,400	---	130	8.6	40	17
	05/14/90 <sup>dup</sup>	16.97	8,200	---	120	31	38	13
	09/12/90	18.78	2,000	---	58	5.8	16	15
	11/27/90	18.27	540	---	18	1.5	8.7	2.5
	03/08/91	14.86	3,400	---	630	33	270	18
	06/03/91	15.84	1,700	---	260	13	98	24
	08/30/91	17.79	870	---	44	6.1	10	2.9
	11/22/91	18.40	310	---	18	1.2	3.3	2.9
	03/18/92	12.03	67,100	---	620	28	220	38
	05/28/92	15.16	2,300	---	200	9	71	17
	08/19/92	17.03	5,700	---	71	77	52	130
	11/17/92	17.94	3,600	---	16	8.6	24	50
	02/12/93	9.16	4,700	---	820	58	130	77
	06/10/93	13.20	2,200	---	310	23	89	23
	08/18/93	14.93	260	---	27	2.0	7.0	2.2
	11/19/93	17.58	1,500 <sup>a</sup>	---	24	54	37	17
	02/18/94	13.30	2,700	---	65	5.2	16	6.3
	02/18/94 <sup>dup</sup>		3,100	---	82	6.7	19	7.9
	05/04/94	15.25	780	---	120	7.5	21	6.9
	05/04/94 <sup>dup</sup>	15.25	920	---	120	7.7	22	7.1
	08/10/94	16.63	920	---	20	2.3	3.0	2.2
	11/08/94	13.88	1,300	---	180	16	7.0	12
	11/08/94 <sup>dup</sup>	13.88	1,200	---	170	15	7.2	11
	02/01/95	9.25	1,400	---	210	8.5	11	8.7
	05/10/95	10.76	460	---	97	10	1.0	19
	08/24/95	13.90	640	---	68	21	14	19
	11/10/95	16.20	350	---	15	2.3	1.2	2.5
	02/24/96	8.93	3,300	---	240	53	38	55
	05/22/96	10.86	1,300	3,500	110	15	<10	<10
08/19/96	13.97	350	340	15	3.3	3.4	3.3	
12/05/96	14.06	290	370	12	7.6	5.4	16	
12/05/96 <sup>dup</sup>	14.06	290	360	13	7.6	5.8	17	
02/20/97	10.60	980	3,200	69	7.9	14	15	

**Table 2a. Analytical Results for Ground Water - Gasoline Components – Shell-branded Service Station WIC #204-5508-3301, 6039 College Avenue, Oakland, California (continued)**

Well/Boring ID (Qtrs Sampled)	Date Sampled	Depth to Water (ft)	TPH-G	MTBE	B	T	E	X
			← (Concentrations in µg/L) →					
	01/20/98	8.43	3,100	59,000	360	1,000	73	420
	01/20/98 <sup>dnp</sup>	8.43	3,000	54,000	330	950	68	390
MW-4 (All)	02/13/90	16.73	ND	---	ND	ND	ND	ND
	05/14/90	17.88	650	---	160	7	1.9	3.1
	09/12/90	17.85	440	---	91	1.1	0.75	0.79
	09/12/90 <sup>dnp</sup>	17.85	520	---	85	0.71	0.71	0.81
	11/27/90	19.16	470	---	64	1.2	0.80	2.7
	03/08/91	15.77	1,100	---	330	3.5	88	5.8
	06/03/91	16.77	670	---	240	2.3	1.6	2.3
	08/30/91	18.71	570	---	64	1.8	0.9	0.9
	11/22/91 <sup>SPH</sup>	---	---	---	---	---	---	---
	03/18/92 <sup>SPH</sup>	13.15	---	---	---	---	---	---
	05/28/92 <sup>SPH</sup>	16.22	---	---	---	---	---	---
	08/19/92 <sup>SPH</sup>	18.05	---	---	---	---	---	---
	11/17/92 <sup>SPH</sup>	18.89	---	---	---	---	---	---
	02/12/93 <sup>SPH</sup>	11.78	---	---	---	---	---	---
	06/10/93	14.20	---	---	---	---	---	---
	08/18/93 <sup>SPH</sup>	15.95	---	---	---	---	---	---
	11/19/93 <sup>SPH</sup>	18.48	---	---	---	---	---	---
	02/28/94 <sup>SPH</sup>	14.60	---	---	---	---	---	---
	05/04/94 <sup>SPH</sup>	16.15	---	---	---	---	---	---
	08/10/94 <sup>SPH</sup>	17.58	---	---	---	---	---	---
	11/08/94 <sup>SPH</sup>	15.05	---	---	---	---	---	---
	02/01/95 <sup>SPH</sup>	10.71	---	---	---	---	---	---
	05/10/95	11.90	---	---	---	---	---	---
	08/24/95	14.97	---	---	---	---	---	---
	11/10/95	17.27	4,700	---	100	22	23	38
	02/24/96	10.44	---	---	---	---	---	---
	08/19/96 <sup>SPH</sup>	15.23	---	---	---	---	---	---
	12/05/96 <sup>SPH</sup>	14.07	---	---	---	---	---	---
	01/08/97	11.60	<10,000	24,000	<100	<100	<100	<100
	02/20/97	11.91	<10,000	59,000	490	<100	<100	<100
	05/30/97	14.68	<2,000	6,100	72	<20	<20	<20
	08/18/97	15.07	<5,000	31,000	150	570	<50	130

**Table 2a. Analytical Results for Ground Water - Gasoline Components – Shell-branded Service Station WIC #204-5508-3301, 6039 College Avenue, Oakland, California (continued)**

Well/Boring ID (Qtrs Sampled)	Date Sampled	Depth to Water (ft)	TPH-G	MTBE	B	T	E	X
			(Concentrations in µg/L)					
	11/03/97	15.87	32,000	78,000 <sup>e</sup>	1,100	6,100	640	3,600
	01/20/98 <sup>SPH</sup>	10.25	---	---	---	---	---	---
	06/05/98 <sup>SPH</sup>	11.62	---	---	---	---	---	---
MW-5 (1st)	08/30/91	16.74	ND	---	ND	ND	ND	ND
	11/22/91	17.27	<50	---	<0.5	<0.5	<0.5	<0.5
	03/18/92	11.28	<30	---	<0.3	<0.3	<0.3	<0.3
	05/28/92 <sup>b</sup>	---	---	---	---	---	---	---
	08/19/92	15.99	<50	---	<0.5	<0.5	<0.5	<0.5
	11/17/92	16.84	<50	---	<0.5	<0.5	<0.5	<0.5
	02/12/93	10.30	<50	---	<0.5	<0.5	<0.5	<0.5
	06/10/93	12.36	<50	---	<0.5	<0.5	<0.5	<0.5
	08/18/93	14.02	<50	---	<0.5	<0.5	<0.5	<0.5
	11/19/93	16.50	<50	---	<0.5	<0.5	<0.5	<0.5
	11/19/93 <sup>dup</sup>	16.50	<50	---	<0.5	<0.5	<0.5	<0.5
	02/18/94	12.55	<50	---	<0.5	<0.5	<0.5	<0.5
	05/04/94	14.27	<50	---	<0.5	<0.5	<0.5	<0.5
	08/10/94	15.60	70 <sup>f</sup>	---	<0.5	<0.5	<0.5	<0.5
	11/08/94	12.85	<50	---	<0.5	<0.5	<0.5	<0.5
	02/01/95	8.98	<50	---	<0.5	<0.5	<0.5	<0.5
	05/10/95	10.16	<50	---	<0.5	<0.5	<0.5	<0.5
	05/10/95 <sup>dup</sup>	10.16	<50	---	<0.5	<0.5	<0.5	<0.5
	08/24/95	12.98	<50	---	<0.5	<0.5	<0.5	<0.5
	11/10/95	15.12	<50	---	<0.5	<0.5	<0.5	<0.5
	02/24/96 <sup>b</sup>	---	---	---	---	---	---	---
	05/22/96	10.10	<2,000	9,800	<20	<20	<20	<20
	08/19/96	13.09	<2,500	13,000	<25	<25	<25	<25
	12/05/96	13.31	<500	2,800	<5.0	<5.0	<5.0	<5.0
	02/20/97	9.55	<1,000	5,600	<10	<10	<10	<10
	01/20/98	8.06	<50	1,600	<0.50	<0.50	<0.50	<0.50
MW-6 (1st)	09/21/93	14.64	<50	---	<0.5	<0.5	<0.5	<0.5
	11/19/93 <sup>c</sup>	---	---	---	---	---	---	---
	02/28/94	12.18	98 <sup>d</sup>	---	<0.5	<0.5	<0.5	<0.5
	05/04/94	13.62	<50	---	<0.5	<0.5	<0.5	<0.5

**Table 2a. Analytical Results for Ground Water - Gasoline Components – Shell-branded Service Station WIC #204-5508-3301, 6039 College Avenue, Oakland, California (continued)**

Well/Boring ID (Qtrs Sampled)	Date Sampled	Depth to Water (ft)	TPH-G ←	MTBE →	B (Concentrations in µg/L)	T →	E →	X →
	08/10/94	14.98	80 <sup>f</sup>	---	<0.5	<0.5	<0.5	<0.5
	11/08/94 <sup>b</sup>	12.20	---	---	---	---	---	---
	02/01/95	8.70	120	---	3.5	21	3.4	22
	02/01/95 <sup>dup</sup>	8.70	110	---	0.6	0.6	0.5	0.9
	05/10/95	9.86	---	---	---	---	---	---
	08/24/95	12.46	80	---	<0.5	<0.5	1.8	2.4
	08/24/95 <sup>dup</sup>	12.46	70	---	<0.5	<0.5	1.2	1.3
	11/10/95	14.56	<50	---	<0.5	<0.5	<0.5	<0.5
	11/10/95	14.56	60	---	<0.5	<0.5	<0.5	<0.5
	02/24/96 <sup>b</sup>	---	---	---	---	---	---	---
	05/22/96	10.23	<50	290	<0.5	<0.5	<0.5	<0.5
	08/19/96	12.61	<1,250	1,100	<12	<12	<12	<12
	12/05/96	12.47	<125	440	<1.2	<1.2	<1.2	<1.2
	02/20/97	9.85	<100	480	<1.0	<1.0	<1.0	<1.0
	01/20/98	7.76	<50	340	<0.50	<0.50	<0.50	<0.50
BH-A	09/09/93	16.50	4,900	---	18	<5	54	11
BH-B	09/09/93	15.85	<50	---	<0.5	<0.5	<0.5	<0.5
BH-C <sup>e</sup>	09/10/93	15.80	640 <sup>f</sup>	---	3.5	<0.5	0.6	<0.5
BH-D <sup>e</sup>	09/10/93	14.2	24,000 <sup>f</sup>	---	720	86	44	11
Bailer	08/19/92	---	<50	---	<0.5	<0.5	<0.5	<0.5
Blank	11/17/92	---	<50	---	<0.5	<0.5	<0.5	<0.5
Trip	02/13/90	---	ND	---	ND	ND	ND	ND
Blank	05/14/90	---	ND	---	ND	ND	ND	ND
	09/12/90	---	ND	---	ND	ND	ND	ND
	03/08/91	---	ND	---	ND	ND	ND	ND
	06/03/91	---	ND	---	ND	ND	ND	ND
	08/30/91	---	ND	---	ND	ND	ND	ND
	03/18/92	---	<30	---	<0.3	<0.3	<0.3	<0.3
	05/28/92	---	<50	---	<0.5	<0.5	<0.5	<0.5

**Table 2a. Analytical Results for Ground Water - Gasoline Components – Shell-branded Service Station WIC #204-5508-3301, 6039 College Avenue, Oakland, California (continued)**

Well/Boring ID (Qtrs Sampled)	Date Sampled	Depth to Water (ft)	TPH-G	MTBE	B	T	E	X
			(Concentrations in µg/L)					
	08/19/92	---	<50	---	<0.5	<0.5	<0.5	<0.5
	11/17/92	---	<50	---	<0.5	<0.5	<0.5	<0.5
	02/12/93	---	<50	---	<0.5	<0.5	<0.5	<0.5
	06/10/93	---	<50	---	<0.5	<0.5	<0.5	<0.5
	11/19/93	---	<50	---	<0.5	<0.5	<0.5	<0.5
	02/28/94	---	<50	---	<0.5	<0.5	<0.5	<0.5
	05/04/94	---	<50	---	<0.5	<0.5	<0.5	<0.5
	08/10/94	---	<50	---	<0.5	<0.5	<0.5	<0.5
	11/08/94	---	<50	---	<0.5	<0.5	<0.5	<0.5
	02/01/95	---	<50	---	<0.5	<0.5	<0.5	<0.5
	05/10/95	---	<50	---	<0.5	<0.5	<0.5	<0.5
	08/24/95	---	<50	---	<0.5	<0.5	<0.5	<0.5
	11/10/95	---	<50	---	<0.5	0.7	<0.5	<0.5
MCLs			NE	NE	1	150	700	1,750

**Abbreviations:**

TPH-G = Total petroleum hydrocarbons as gasoline by modified EPA Method 8015  
 MTBE = Methyl tert-butyl ether by EPA Method 8020  
 B = Benzene by EPA Method 8020  
 T = Toluene by EPA Method 8020  
 E = Ethylbenzene by EPA Method 8020  
 X = Xylenes by EPA Method 8020  
 NE = Not established  
 ND = Not detected  
 MCLs = California primary maximum contaminant levels for drinking water  
 (22 CCR 64444)  
 --- = Not analyzed  
 dup = Duplicate sample  
 µg/L = Micrograms per liter  
 SPH = Separate phase hydrocarbons present in well; not sampled

**Notes:**

a = Concentration reported as TPH-G is due to the presence of gasoline and a discrete peak not indicative of gasoline  
 b = Well inaccessible and not sampled  
 c = Well inadvertently not sampled  
 d = The concentration reported as TPH-G is primarily due to the presence of a discrete peak not indicative of gasoline  
 e = Due to chain of custody miscommunication, analyses run after holding time expiration  
 f = The positive result has an atypical pattern for gasoline analysis  
 g = MTBE result was reported above the calibration range, therefore the result should be considered an estimate

**Table 2b. Analytical Results for Groundwater - Non-Gasoline Components – Shell-branded Service Station**  
WIC #204-5508-3301, 6039 College Avenue, Oakland, California

Well/Boring ID (Qtrs Sampled)	Date Sampled	Depth to Water (ft)	TPH-D	TPH-MO	POG	Naphthalene*		DO (mg/L)
						parts per billion (µg/L)		
MW-1	02/13/90	17.73	650	770	---	---	---	---
(Discontinued)	05/14/90	18.92	ND	770	---	---	---	---
	09/12/90	19.81	84	ND	---	---	---	---
	11/27/90	20.39	---	---	---	---	---	---
	03/08/91	16.85	50	ND	---	---	---	---
	06/03/91	17.82	ND	ND	---	---	---	---
	08/30/91	19.87	520	ND	---	---	---	---
	11/22/91	20.58	<50	<500	---	---	---	---
	03/18/92	13.55	<50	---	---	---	---	---
	05/28/92	17.08	<50	---	---	---	---	---
	08/19/92	19.07	<50	---	---	---	---	---
	11/17/92	20.11	<50	---	---	---	---	---
	02/12/93	12.10	<50	---	---	---	---	---
	06/10/93	14.87	---	---	---	---	---	---
	06/10/93 <sup>dup</sup>	14.87	---	---	---	---	---	---
	08/18/93	16.90	---	---	---	---	---	---
	11/19/93	19.72	---	---	---	---	---	---
	02/18/94	15.08	---	---	---	---	---	---
	05/04/94	17.20	---	---	---	---	---	---
	08/10/94	18.76	---	---	---	---	---	---
	08/10/94 <sup>dup</sup>	18.76	---	---	---	---	---	---
	11/08/94	16.00	---	---	---	---	---	---
	02/01/95	10.18	---	---	---	---	---	---
	05/10/95	11.88	---	---	---	---	---	---
	08/24/95	15.60	---	---	---	---	---	---
	11/10/95	18.24	---	---	---	---	---	---
	02/24/96	9.88	---	---	---	---	---	---
	05/22/96	12.24	---	---	---	---	---	---
	08/19/96	15.86	---	---	---	---	---	---
	12/05/96	16.21	---	---	---	---	---	8.6
	02/20/97	11.60	---	---	---	---	---	8.0



**Table 2b. Analytical Results for Groundwater - Non-Gasoline Components – Shell-branded Service Station  
WIC #204-5508-3301, 6039 College Avenue, Oakland, California (continued)**

Well/Boring ID (Qtrs Sampled)	Date Sampled	Depth to Water (ft)	TPH-D	TPH-MO	POG	Naphthalene*	2-Methylnaphthalene*	DO (mg/L)
			←————— parts per billion (µg/L) —————→					
MW-2 (Discontinued)	02/13/90	16.90	560	ND	---	---	---	---
	05/14/90	18.01	ND	ND	---	---	---	---
	09/12/90	19.00	ND	ND	---	---	---	---
	11/27/90	19.44	ND	ND	---	---	---	---
	03/08/91	15.96	ND	ND	---	---	---	---
	06/03/91	17.00	ND	ND	---	---	---	---
	08/30/91	18.95	ND	ND	---	---	---	---
	11/22/91	19.55	<50	<500	---	---	---	---
	03/18/92	12.91	---	---	---	---	---	---
	05/28/92	16.25	---	---	---	---	---	---
	08/19/92	18.21	---	---	---	---	---	---
	11/17/92	19.15	---	---	---	---	---	---
	02/12/93 <sup>dup</sup>	11.60	---	---	---	---	---	---
	02/12/93	11.60	---	---	---	---	---	---
	06/10/93	14.14	---	---	---	---	---	---
	08/18/93	16.10	---	---	---	---	---	---
	08/18/93 <sup>dup</sup>	16.10	---	---	---	---	---	---
	11/19/93	18.77	---	---	---	---	---	---
	02/18/94	14.55	---	---	---	---	---	---
	05/04/94	16.34	---	---	---	---	---	---
	08/10/94	15.79	---	---	---	---	---	---
	11/08/94	15.04	---	---	---	---	---	---
	02/01/95	10.08	---	---	---	---	---	---
	05/10/95	11.68	---	---	---	---	---	---
	08/24/95	14.94	---	---	---	---	---	---
	11/10/95	13.36	---	---	---	---	---	---
	02/24/96	9.90	---	---	---	---	---	---
	02/24/96 <sup>dup</sup>	9.90	---	---	---	---	---	---
	05/22/96	11.80	---	---	---	---	---	---
	08/19/96	15.08	---	---	---	---	---	---
	08/19/96 <sup>dup</sup>	15.08	---	---	---	---	---	---
	12/05/96	15.16	---	---	---	---	---	7.0
02/20/97	11.47	---	---	---	---	---	7.1	

**Table 2b. Analytical Results for Groundwater - Non-Gasoline Components – Shell-branded Service Station  
WIC #204-5508-3301, 6039 College Avenue, Oakland, California (continued)**

Well/Boring ID (Qtrs Sampled)	Date Sampled	Depth to Water (ft)	TPH-D ←	TPH-MO →	POG parts per billion (µg/L)	Naphthalene*	2-Methylnaphthalene*	DO (mg/L)
MW-3 (1st)	02/13/90	15.81	3,100	3,000	---	---	---	---
	02/13/90 <sup>dup</sup>	15.81	4,500	8,300	---	---	---	---
	05/14/90	16.97	620	40,000	---	---	---	---
	05/14/90 <sup>dup</sup>	16.97	660	10,000	---	---	---	---
	09/12/90	18.78	1,500	19,000	---	---	---	---
	11/27/90	18.27	240	460	---	---	---	---
	03/08/91	14.86	2,100	ND	---	---	---	---
	06/03/91	15.84	690 <sup>a</sup>	ND	---	---	---	---
	08/30/91	17.79	370 <sup>b</sup>	500	---	---	---	---
	11/22/91	18.40	140	500	---	---	---	---
	03/18/92	12.03	1,900	20,000	---	---	---	---
	05/28/92	15.16	1,100 <sup>c</sup>	4,600	---	---	---	---
	08/19/92	17.03	1,000 <sup>c</sup>	1,800	---	---	---	---
	11/17/92	17.94	160 <sup>c</sup>	1,200	---	---	---	---
	02/12/93	9.16	560 <sup>c</sup>	<50	---	---	---	---
	06/10/93	13.20	---	940 <sup>d</sup>	---	---	---	---
	08/18/93	14.93	---	460 <sup>d</sup>	---	---	---	---
	11/19/93	17.58	---	960 <sup>d</sup>	<5,000	---	---	---
	02/18/94	13.30	---	1,600	<5,000	---	---	---
	02/18/94 <sup>dup</sup>	---	---	2,200	<5,000	---	---	---
	05/04/94	15.25	---	710	<5,000	e	e	---
	05/04/94 <sup>dup</sup>	15.25	---	1,600	<5,000	f	f	---
	08/10/94	16.63	---	<500	<5,000	ND	ND	---
	11/08/94	13.88	---	1,300	---	---	---	---
	11/08/94 <sup>dup</sup>	13.88	---	730	---	---	---	---
	02/01/95	9.25	---	900 <sup>j</sup>	---	---	27	ND
	05/10/95	10.76	---	---	<5,000	ND	ND	---
	08/24/95	13.90	---	---	<5,000	12	ND	---
	11/10/95	16.20	---	---	<5,000	---	---	---
	02/24/96	8.93	---	---	<5,000	---	---	---
05/22/96	10.86	---	---	<5,000	37	8.4	---	
08/19/96	13.97	---	---	9,200	ND	ND	---	
12/05/96	14.06	---	---	---	ND	ND	8.4	

**Table 2b. Analytical Results for Groundwater - Non-Gasoline Components – Shell-branded Service Station  
WIC #204-5508-3301, 6039 College Avenue, Oakland, California (continued)**

Well/Boring ID (Qtrs Sampled)	Date Sampled	Depth to Water (ft)	TPH-D	TPH-MO	POG	Naphthalene*		2-Methylnaphthalene*	DO (mg/L)
						parts per billion (µg/L)			
	12/05/96 <sup>dup</sup>	14.06	---	---	---	ND	ND	ND	8.4
	02/20/97	10.60	---	---	<5,000	23	<5.0	<5.0	8.2
	01/20/98	8.43	---	---	<5,000	13	<5.0	<5.0	6.1
	01/20/98 <sup>dup</sup>	8.43	---	---	<5,000	8.8	<5.0	<5.0	6.1
MW-4 (All)	02/13/90	16.73	1,200	3,000	---	---	---	---	---
	05/14/90	17.88	350	12,000	---	---	---	---	---
	09/12/90	17.85	260	2,600	---	---	---	---	---
	09/12/90 <sup>dup</sup>	17.85	1,100	16,000	---	---	---	---	---
	11/27/90	19.16	2,400	1,000	---	---	---	---	---
	03/08/91	15.77	2,600	15,000	---	---	---	---	---
	06/03/91	16.77	1,100	ND	---	6.5	---	---	---
	08/30/91	18.71	280	2,000	---	11.0	---	---	---
	11/22/91 <sup>SPH</sup>	---	---	---	---	---	---	---	---
	03/18/92 <sup>SPH</sup>	13.15	---	---	---	---	---	---	---
	05/28/92 <sup>SPH</sup>	16.22	---	---	---	---	---	---	---
	08/19/92 <sup>SPH</sup>	18.05	---	---	---	---	---	---	---
	11/17/92 <sup>SPH</sup>	18.89	---	---	---	---	---	---	---
	02/12/93 <sup>SPH</sup>	11.78	---	---	---	---	---	---	---
	06/10/93	14.20	---	---	---	---	---	---	---
	08/18/93 <sup>SPH</sup>	15.95	---	---	---	---	---	---	---
	11/19/93 <sup>SPH</sup>	18.48	---	---	---	---	---	---	---
	02/28/94 <sup>SPH</sup>	14.60	---	---	---	---	---	---	---
	05/04/94 <sup>SPH</sup>	16.15	---	---	---	---	---	---	---
	08/10/94 <sup>SPH</sup>	17.58	---	---	---	---	---	---	---
	11/08/94 <sup>SPH</sup>	15.05	---	---	---	---	---	---	---
	02/01/95 <sup>SPH</sup>	10.71	---	---	---	---	---	---	---
	05/10/95	11.90	---	---	---	---	---	---	---
	08/24/95	14.97	---	---	---	---	---	---	---
	11/10/95	17.27	---	---	29,000	---	---	---	---
02/24/96	10.44	---	---	---	---	---	---	---	
08/19/96 <sup>SPH</sup>	15.23	---	---	---	---	---	---	---	
12/05/96 <sup>SPH</sup>	14.07	---	---	---	---	---	---	---	

**Table 2b. Analytical Results for Groundwater - Non-Gasoline Components – Shell-branded Service Station  
WIC #204-5508-3301, 6039 College Avenue, Oakland, California (continued)**

Well/Boring ID (Qtrs Sampled)	Date Sampled	Depth to Water (ft)	TPH-D	TPH-MO	POG	Naphthalene*		2-Methylnaphthalene*	DO (mg/L)
						parts per billion (µg/L)			
	02/20/97	11.91	---	---	8,700	5.6		<5.0	7.0
	05/30/97	14.68	---	---	8,100	<5.0		<5.0	9.0
	08/18/97	15.07	---	---	67,000	<5.0		<5.0	3.9
	11/03/97	15.87	---	---	160,000	120		57	1.8
	01/20/98 <sup>SPH</sup>	10.25	---	---	---	---		---	---
	06/05/98 <sup>SPH</sup>	11.62	---	---	---	---		---	---
MW-5 (1st)	08/30/91	16.74	80	ND	---	---		---	---
	11/22/91	17.27	<50	<500	---	---		---	---
	03/18/92	11.28	<50	---	---	---		---	---
	05/28/92 <sup>s</sup>	---	---	---	---	---		---	---
	08/19/92	15.99	<50	---	---	---		---	---
	11/17/92	16.84	<50	---	---	---		---	---
	02/12/93	10.30	<50	---	---	---		---	---
	06/10/93	12.36	---	---	---	---		---	---
	08/18/93	14.02	---	---	---	---		---	---
	11/19/93	16.50	---	---	---	---		---	---
	11/19/93 <sup>dup</sup>	16.50	---	---	---	---		---	---
	02/18/94	12.55	---	---	---	---		---	---
	05/04/94	14.27	---	---	---	---		---	---
	08/10/94	15.60	---	---	---	---		---	---
	11/08/94	12.85	---	---	---	---		---	---
	02/01/95	8.98	---	---	---	---		---	---
	05/10/95	10.16	---	---	---	---		---	---
	05/10/95 <sup>dup</sup>	10.16	---	---	---	---		---	---
	08/24/95	12.98	---	---	---	---		---	---
	11/10/95	15.12	---	---	---	---		---	---
	02/24/96 <sup>j</sup>	---	---	---	---	---		---	---
	05/22/96	10.10	---	---	---	---		---	---
	08/19/96	13.09	---	---	---	---		---	---
	12/05/96	13.31	---	---	---	---		---	4.0
	02/20/97	9.55	---	---	---	---		---	4.2
	01/20/98	8.06	---	---	---	---		---	3.7

**Table 2b. Analytical Results for Groundwater - Non-Gasoline Components – Shell-branded Service Station  
WIC #204-5508-3301, 6039 College Avenue, Oakland, California (continued)**

Well/Boring ID (Qtrs Sampled)	Date Sampled	Depth to Water (ft)	TPH-D ←	TPH-MO	POG parts per billion (µg/L)	Naphthalene* →	2-Methylnaphthalene* →	DO (mg/L)
MW-6 (1st)	09/21/93	14.64	<50	---	<5,000	<10-50	<10-50	---
	11/19/93 <sup>h</sup>	---	---	---	---	---	---	---
	02/28/94	12.18	---	---	<5,000	---	---	---
	05/04/94	13.62	---	---	<5,000	<2-10	<2-10	---
	08/10/94	14.98	---	---	<5,000	ND	ND	---
	11/08/94 <sup>i</sup>	12.20	---	---	---	---	---	---
	02/01/95	8.70	---	---	---	---	---	---
	02/01/95 <sup>dup</sup>	8.70	---	---	---	---	---	---
	05/10/95	9.86	---	---	---	---	---	---
	08/24/95	12.46	---	---	---	---	---	---
	08/24/95 <sup>dup</sup>	12.46	---	---	---	---	---	---
	11/10/95	14.56	---	---	---	---	---	---
	11/10/95	14.56	---	---	---	---	---	---
	02/24/96 <sup>j</sup>	---	---	---	---	---	---	---
	05/22/96	10.23	---	---	---	---	---	---
	08/19/96	12.61	---	---	---	---	---	---
	12/05/96	12.47	---	---	---	---	---	3.6
02/20/97	9.85	---	---	---	---	---	3.9	
01/20/98	7.76	---	---	---	---	---	2.7	
BH-A	09/09/93	16.50	2,900 <sup>e</sup>	---	<5,000	23	13	---
BH-B	09/09/93	15.85	150	---	<5,000	ND	ND	---
BH-C <sup>i</sup>	09/10/93	15.80	100	---	<5,000	ND	ND	---
BH-D <sup>i</sup>	09/10/93	14.2	25,000 <sup>e</sup>	---	20,000	18	75	---
Bailer	08/19/92	---	---	---	---	---	---	---
Blank	11/17/92	---	---	---	---	---	---	---
Trip	02/13/90	---	---	---	---	---	---	---
Blank	05/14/90	---	---	---	---	---	---	---

**Table 2b. Analytical Results for Groundwater - Non-Gasoline Components – Shell-branded Service Station  
WIC #204-5508-3301, 6039 College Avenue, Oakland, California (continued)**

Well/Boring ID (Qtrs Sampled)	Date Sampled	Depth to Water (ft)	TPH-D	TPH-MO	POG	Naphthalene*		DO (mg/L)
						parts per billion (µg/L)		
	09/12/90	---	---	---	---	---	---	---
	03/08/91	---	---	---	---	---	---	---
	06/03/91	---	---	---	---	---	---	---
	08/30/91	---	---	---	---	---	---	---
	03/18/92	---	<50	---	---	---	---	---
	05/28/92	---	---	---	---	---	---	---
	08/19/92	---	---	---	---	---	---	---
	11/17/92	---	---	---	---	---	---	---
	02/12/93	---	---	---	---	---	---	---
	06/10/93	---	---	---	---	---	---	---
	11/19/93	---	---	---	---	---	---	---
	02/28/94	---	---	---	---	---	---	---
	05/04/94	---	---	---	---	---	---	---
	08/10/94	---	---	---	---	---	---	---
	11/08/94	---	---	---	---	---	---	---
	02/01/95	---	---	---	---	---	---	---
	05/10/95	---	---	---	---	---	---	---
	08/24/95	---	---	---	---	---	---	---
	11/10/95	---	---	---	---	---	---	---

---

**Table 2b. Analytical Results for Groundwater - Non-Gasoline Components – Shell-branded Service Station  
WIC #204-5508-3301, 6039 College Avenue, Oakland, California (continued)**

---

**Abbreviations:**

TPH-D = Total petroleum hydrocarbons as diesel by modified EPA Method 8015  
TPH-MO = Total petroleum hydrocarbons as motor oil by modified EPA Method 8015  
POG = Polar oil & grease by EPA Method 5520B/F  
DO = Dissolved oxygen  
\* = Semi-volatile organic compounds by EPA Method 8270; only detected compounds tabulated  
--- = Not analyzed or measured  
<n = Not detected at detection limits of n µg/L  
ND = Not detected, detection limit not known  
SPH = Separate-phase hydrocarbons in well, not sampled  
dup = Duplicate sample  
mg/L = Milligrams per liter  
µg/L = Micrograms per liter  
ft = Feet

**Notes:**

a = Positive results for diesel appear to be less volatile constituents of gasoline  
b = Positive results for diesel has atypical diesel pattern  
c = Concentration reported as diesel is primarily due to the presence of a lighter petroleum product, possibly gasoline or kerosene  
d = Concentration reported as motor oil is due to the presence of a combination of motor oil and a lighter petroleum product of hydrocarbon range C6-C12, possibly gasoline  
e = Compounds are within chromatographic range of gasoline but are not characteristic of the standard gasoline pattern  
f = Results include compounds apparently due to gasoline as well as those due to diesel  
g = Well inaccessible and not sampled  
h = Well inadvertently not sampled  
i = Due to chain of custody miscommunication analyses run after holding time expiration  
j = Concentration reported as motor oil is due to the presence of heavier and lighter petroleum products

**Table 3. Separate-Phase Hydrocarbon Removal – Shell-branded Service Station  
WIC #204-5508-3301, 6039 College Avenue, Oakland, California**

Well ID	Date	Separate-Phase Hydrocarbon Thickness (ft)	Separate-Phase Hydrocarbons Removed (lbs)	Cumulative Hydrocarbons Removed (lbs)
MW-4 <sup>a</sup>	01/15/92	---	3.12	3.12
	02/15/92	---	3.12	6.24
	03/18/92	0.24	---	6.24
	04/29/92	---	1.50	7.74
	05/28/92	0.12	0.18	7.92
	08/19/92	0.09	0.96	8.88
	11/17/92	---	0.96	9.84
	02/12/93	<0.01	---	9.84
	06/10/93	0.02	0.06	9.90
	08/18/93	0.01	0.06	9.96
	11/19/93	0.01	0.06	10.02
	02/28/94	0.01	0.06	10.08
	05/04/94	0.00	0.06	10.14
	08/10/94	0.02	0.06	10.20
	11/10/94	0.05	0.08	10.28
	02/01/95	0.04	0.06	10.34
	05/10/95	0.06	0.16	10.50
	08/24/95	0.02	---	10.50
	11/10/95	<0.01	---	10.50
	02/24/96	0.03	0.44	10.94
	05/22/96	0.03	---	10.94
	08/19/96	0.02	---	10.94
	12/05/96	0.02	---	10.94
	01/08/97	0.02	0.08	11.02
	01/20/98	0.62	1.37	12.39
	<b>06/05/98</b>	<b>0.06</b>	<b>0.64</b>	<b>13.03</b>

**Abbreviations & Notes:**

- ft = Feet
- lbs = Pounds
- 
- 
- 
- a = Petrotrap separate-phase hydrocarbon skimmer installed in well

Separate-phase hydrocarbons removed calculated using the relation: 1 liter gasoline = 1.61 lbs.



**ATTACHMENT A**

Blaine Ground Water Monitoring Report

**BLAINE**  
TECH SERVICES INC.

1680 ROGERS AVENUE  
SAN JOSE, CALIFORNIA 95112  
(408) 573-7771 FAX  
(408) 573-0555 PHONE



June 25, 1998

Shell Oil Company  
P.O. Box 8080  
Martinez, CA 94553

Attn: Alex Perez

Shell WIC #204-5508-3301  
6039 College Avenue  
Oakland, California

2nd Quarter 1998

## Groundwater Monitoring Report 980605-C-1

---

Blaine Tech Services, Inc. performs environmental documentation as an independent third party. Copies of our Monitoring Report are forwarded to the consultant overseeing work at this site. Submission of the assembled documents to interested regulatory agencies will be made by the designated consultant.

Groundwater monitoring at this site was performed in accordance with Standard Operating Procedures provided to the interested regulatory agencies. If you have any questions about the work performed at this site please call me at (408)573-0555 ext. 201.

Yours truly,

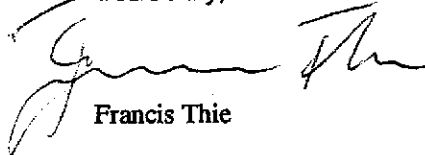

Francis Thie

attachments: Table of Well Gauging Data  
Field Data Sheets

cc: Cambria Environmental Technology, Inc.  
1144 65th Street, Suite C  
Oakland, CA 94608  
Attn: Maureen Feineman

(Any professional evaluations or recommendations will be made by the consultant under separate cover.)

## TABLE OF WELL GAUGING DATA

WELL I.D.	DATA COLLECTION DATE	MEASUREMENT REFERENCED TO	QUALITATIVE OBSERVATIONS (sheen)	DEPTH TO FIRST IMMISCIBLES LIQUID (FPZ) (feet)	THICKNESS OF IMMISCIBLES LIQUID ZONE (feet)	VOLUME OF IMMISCIBLES REMOVED (ml)	DEPTH TO WATER (feet)	DEPTH TO WELL BOTTOM (feet)
MW-1	06/05/98	TOC	--	NONE	--	--	11.75	24.37
MW-2	06/05/98	TOC	--	NONE	--	--	11.45	24.16
MW-3	06/05/98	TOC	--	NONE	--	--	10.55	24.75
MW-4	06/05/98	TOC	FREE PRODUCT	11.56	0.06	400	11.62	--
MW-5	06/05/98	TOC	--	NONE	--	--	9.95	28.50
MW-6	06/05/98	TOC	--	NONE	--	--	9.85	24.17
T-1	06/05/98	TOC	--	NONE	--	--	DRY	4.10
T-2	06/05/98	TOC	--	NONE	--	--	DRY	7.95