



March 25, 1998

Project Number 192-01-03

Mr. Scott Seery
Alameda County Health Services Department
Environmental Health Division
1131 Harbor Bay Parkway, #250
Alameda, CA 94502-6577

**Subject: Revisions to Work Plan for Environmental Site Assessment at
Foothill Beacon, 16210 Foothill Blvd, San Leandro, California**

Dear Mr. Seery:

As we discussed by phone today, Parker Environmental is making your requested revisions to the Subject Work Plan.

The first revision is to the proposed well locations on Figure 2. Based on your experience with monitoring wells nearby, the groundwater gradient is toward the southwest. One proposed well has been moved to take advantage of this information, and is show on the attached revised Figure 2.

Other revisions to the Work Plan include adding MTBE to the list of compounds to be analyzed; having a minimum of 72 hours between well construction, well development and well purging and sampling; and making a field decision concerning well screen size (.01 or .02) due to the fine grain soil size.

Sincerely:
PARKER ENVIRONMENTAL SERVICES

James D. Parker, R.E.A. # 1059
President

Attachment: Figure 2 - Site Plan, Proposed Well Locations (Revised 3/25/98)

cc: Mr. Hooshang Hadjian
Mr. Gary Lowe, H₂OGEOL

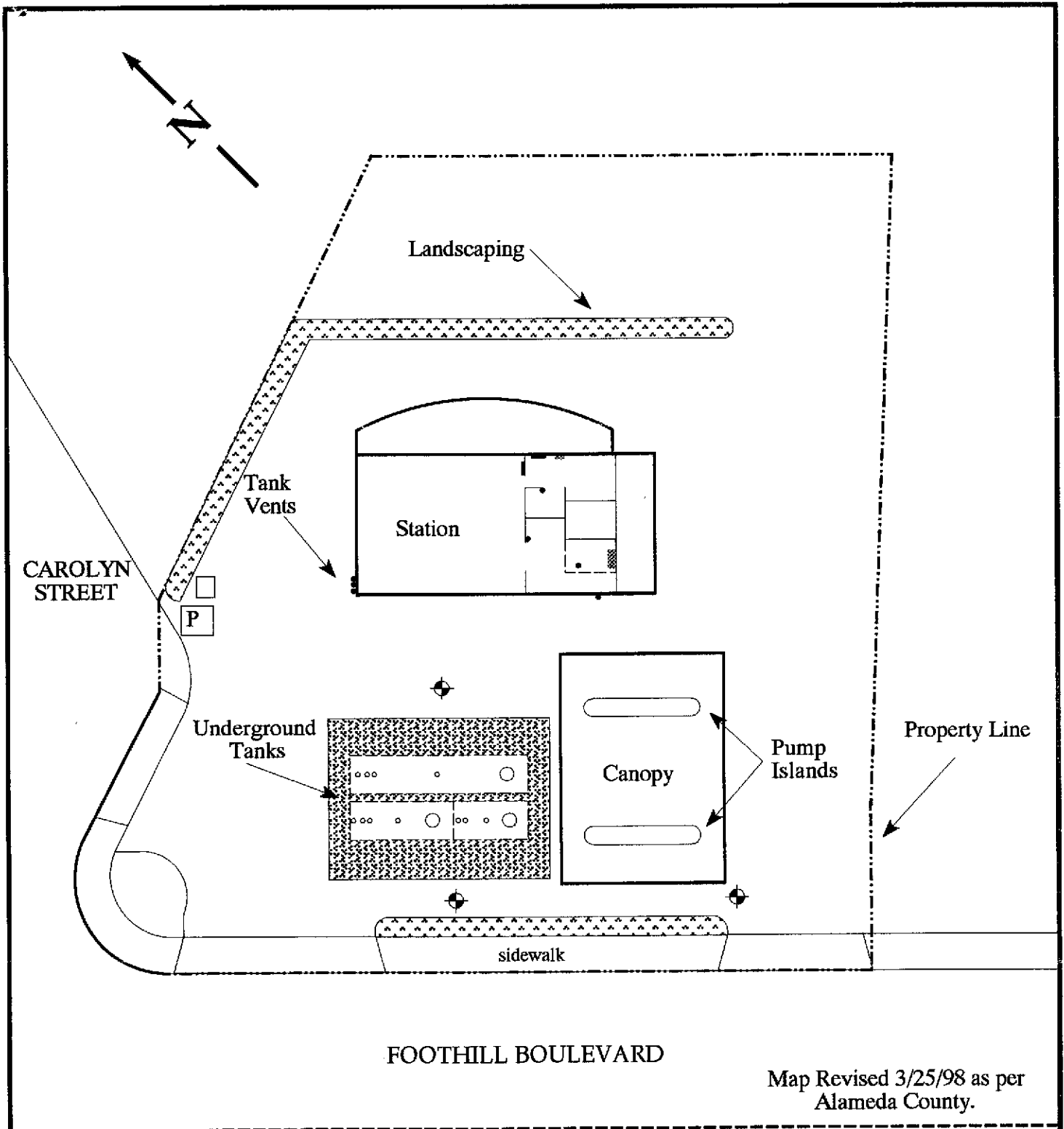

580 FREEWAY

⊕ = proposed monitoring well

Scale: 1" = 30'

Location of site features are approximate.

PARKER
Environmental
Services

190 East 7th Street
Pittsburg, CA 94565
(510) 439-1024

Proposed Well Locations
Foothill Beacon
16210 Foothill Boulevard
San Leandro, CA

PARKER
Environmental Services

190 East 7th Street
Pittsburg, CA 94565
(925) 439-1024

Fax: (925) 439-2566

FAX TO: Alameda County FAX # 510-337-9335

ATTENTION: Scott Seery DATE: 3-25-98

SENDER: Jim Parker

Total number of pages including cover: 3

Comments: Revisions to WP and Drawing
Original to follow in mail.

