

2013 MAR 19 AM 8  
GROUND WATER CONSULTANCY

Alameda County

MAR 19 2013

Environmental Health

Mr. Mark E. Detterman  
Senior Hazardous Materials Specialist  
Alameda County Health Care Services Agency  
Environmental Health Services  
Environmental Protection  
1131 Harbor Bay Parkway, Suite 250  
Alameda, CA 94502-9335

March 15, 2013

RE: Monitoring Well Destruction Report for Foothill Gas, 16210 Foothill Blvd., San Leandro, CA: ACHCSA Fuel leak Case #RO0000457; .RWQCB Case #01-2261; GeoTracker Global ID T06000102077.

Dear Mr. Detterman;

This Well Abandonment Report is submitted by H<sub>2</sub>OGEOL on behalf of the former Foothill Gas, 16210 Foothill Boulevard in San Leandro. Alameda County Public Works Agency permits W2013-0040 (MW-1), W2013-0041 (MW-2), and W2013-0042 (MW-3), were issued on January 17, 2013 for the three wells to be abandoned (copy attached). The locations of the 3 wells at the site are shown in the attached Figure 2a from the files of record for this site.

The well destructions were performed by representatives of Clear Heart Drilling (C-57#780357): All three wells were constructed of 2-inch PVC materials.

**MW-1** had a total depth of 39.18 below casing top. Clear Heart Drilling destroyed the well by first pumping water from the well and then placing 5 gal. water per 94 Lb. Portland Cement grout to the bottom of the well through a tremie hose. The grout level was brought up to near the top of the casing using this method. After removal of the tremie hose the grout level was brought up to the surface. Then a wellhead pipe fitting assemble was attached to the wellhead and air pressure was applied at 25 psi for a minimum of 5 minutes. This procedure was repeated until there was no perceptible decline in grout level. The following day, after the grout was allowed to set, the grout level was topped off and the monitoring well protective box and encasing concrete was removed and fresh concrete was placed in its stead and blackened with lamp black to match the surrounding asphalt.

**MW-2** had a total depth of 24.73 below casing top. Clear Heart Drilling destroyed the well by first pumping water from the well and then placing 5 gal. water per 94 Lb. Portland Cement grout to the bottom of the well through a tremie hose. The grout level was brought up to near the top of the casing using this method. After removal of the tremie hose the grout level was brought up to the surface. Then a wellhead pipe fitting assemble was attached to the wellhead and air pressure was applied at 25 psi for a minimum of 5 minutes. This procedure was repeated until there was no perceptible decline in grout level. The following day, after the grout was allowed to set, the grout

Mr. Mark E. Detterman  
March 15, 2013  
Page 2

level was topped off and the monitoring well protective box and encasing concrete was removed and fresh concrete was placed in its stead and blackened with lamp black to match the surrounding asphalt.

MW-3 had a total depth of 25.02 below casing top. Clear Heart Drilling destroyed the well by first pumping water from the well and then placing 5 gal. water per 94 Lb. Portland Cement grout to the bottom of the well through a tremie hose. The grout level was brought up to near the middle of the casing using this method. After removal of the tremie hose the grout level was brought up to the surface. Then a wellhead pipe fitting assemble was attached to the wellhead and air pressure was applied at 25 psi for a minimum of 5 minutes. This procedure was repeated until there was no perceptible decline in grout level. The following day, after the grout was allowed to set, the grout level was topped off and the monitoring well protective box and encasing concrete was removed and fresh concrete was placed in its stead and blackened with lamp black to match the surrounding asphalt.

Clear Heart Drilling completed the State of California Well Completion Report for the destruction of these three wells on March 1, 2013. Copies are attached.

Please call Bruce Jacobsen of West & Associates at 925-705-1400 (cell) or Gary D. Lowe at 925-373-9211 if you have any questions or comments on this letter. We can also be reached by email at [bjacobsen@astound.net](mailto:bjacobsen@astound.net) and [h2ogeol@comcast.net](mailto:h2ogeol@comcast.net) respectively.

Sincerely,

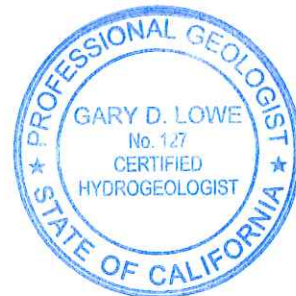
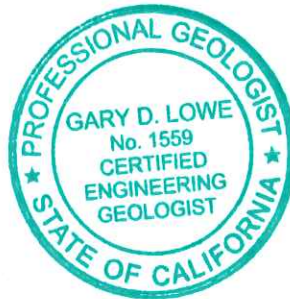

Gary D. Lowe, P.G. (3768), C.E.G. (1559) C.H.G. (127)  
Principal, Hydrogeologist  
H<sub>2</sub>OGEOL A GroundWater Consultancy  
Xc:

Hadjian & Simin Hooshang, 16210 Foothill Blvd., San Leandro, CA 94578-2105

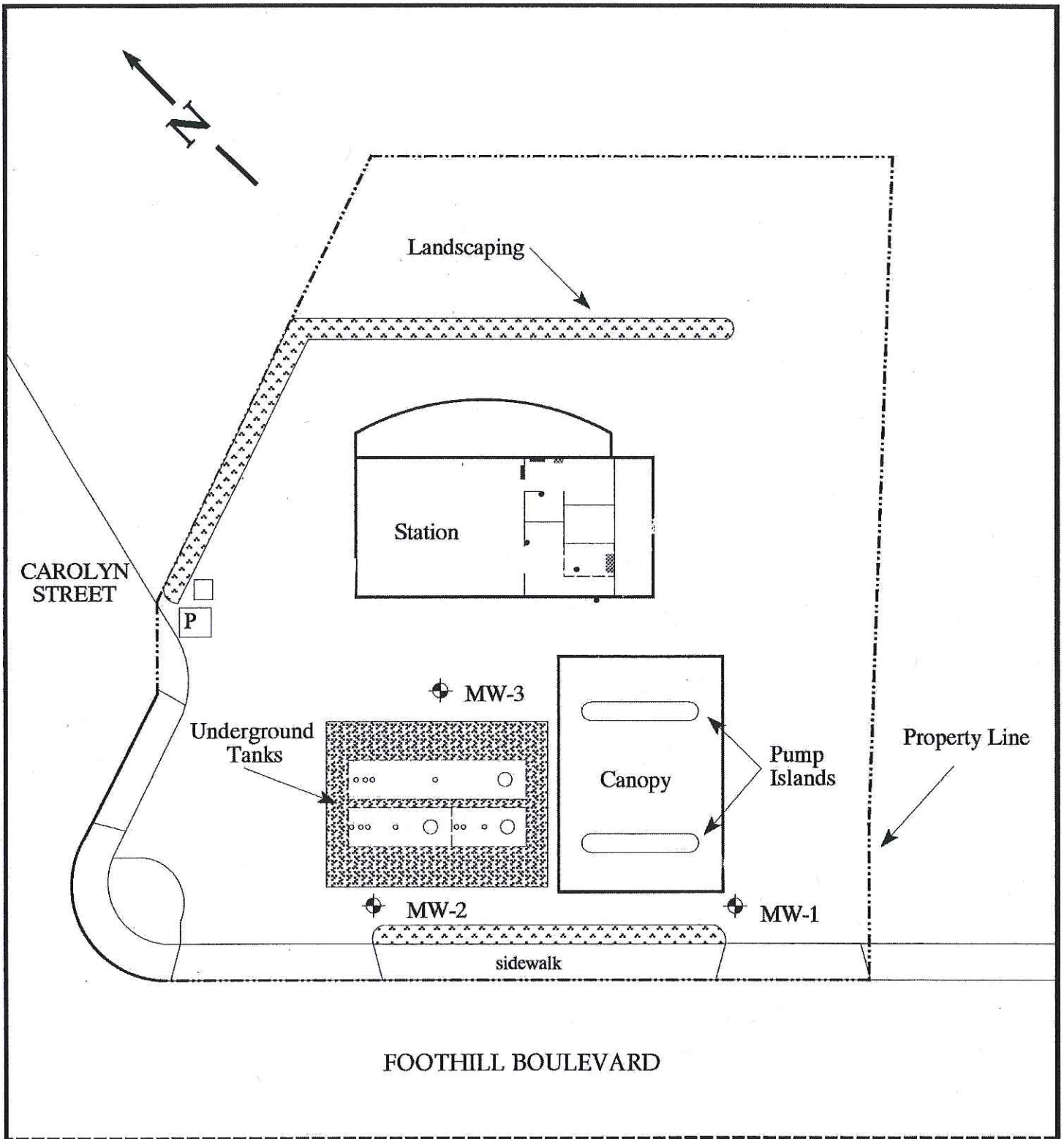

580 FREEWAY

⊕ = proposed monitoring well

Scale: 1" = 30'

Location of site features are approximate.

**PARKER**  
Environmental  
Services

190 East 7th Street  
Pittsburg, CA 94565  
(925) 439-1024

Figure 2a -  
Foothill Beacon  
16210 Foothill Boulevard  
San Leandro, CA

# Alameda County Public Works Agency - Water Resources Well Permit



399 Elmhurst Street  
Hayward, CA 94544-1395  
Telephone: (510)670-6633 Fax:(510)782-1939

**Application Approved on: 01/17/2013 By jamesy**

**Permit Numbers: W2013-0040 to W2013-0042**  
**Permits Valid from 01/24/2013 to 02/08/2013**

**Application Id:** 1358201148623  
**Site Location:** 16210 Foothill Blvd, San Leandro  
**Project Start Date:** 01/24/2013  
**Assigned Inspector:** Contact Vicky Hamlin at (510) 670-5443 or vickyh@acpwa.org

**City of Project Site:** San Leandro

**Completion Date:** 02/08/2013

**Applicant:** H2OGeol A Groundwater Consultancy - Gary

**Phone:** 925-373-9211

Low  
PO Box 2165, Livermore, CA 94551  
Hadjian & Simin Hooshang  
16210 Foothill Blvd, San Leandro, CA 94578

**Property Owner:**

**Phone:** 925-323-5411

**Client:** \*\* same as Property Owner \*\*

	<b>Total Due:</b>	\$1191.00
<b>Receipt Number: WR2013-0018</b>	<b>Total Amount Paid:</b>	\$1191.00
<b>Payer Name : H2OGeol A Groundwater Consultancy</b>	Paid By: CHECK	<b>PAID IN FULL</b>

**Works Requesting Permits:**

Well Destruction-Monitoring - 3 Wells  
Driller: Clear Heart Drilling - Lic #: 780357 - Method: press

**Work Total: \$1191.00**

**Specifications**

Permit #	Issued Date	Expire Date	Owner Well Id	Hole Diam.	Casing Diam.	Seal Depth	Max. Depth	State Well #	Orig. Permit #	DWR #
W2013-0040	01/17/2013	04/24/2013	MW1	8.00 in.	2.00 in.	9.50 ft	20.00 ft	No Records	98WR349 ?	No Records
W2013-0041	01/17/2013	04/24/2013	MW2	8.00 in.	2.00 in.	9.50 ft	20.00 ft	No Records	98WR349 ?	No Records
W2013-0042	01/17/2013	04/24/2013	MW3	8.00 in.	2.00 in.	9.50 ft	20.00 ft	No Records	98WR349 ?	No Records

**Specific Work Permit Conditions**

1. Prior to any drilling activities, it shall be the applicant's responsibility to contact and coordinate an Underground Service Alert (USA), obtain encroachment permit(s), excavation permit(s) or any other permits or agreements required for that Federal, State, County or City, and follow all City or County Ordinances. No work shall begin until all the permits and requirements have been approved or obtained. It shall also be the applicants responsibilities to provide to the Cities or to Alameda County an Traffic Safety Plan for any lane closures or detours planned. No work shall begin until all the permits and requirements have been approved or obtained.
  
2. Compliance with the well-sealing specifications shall not exempt the well-sealing contractor from complying with appropriate State reporting-requirements related to well construction or destruction (Sections 13750 through 13755 (Division 7, Chapter 10, Article 3) of the California Water Code). Contractor must complete State DWR Form 188 and mail original to the Alameda County Public Works Agency, Water Resources Section, within 60 days. Include permit number and site map.
  
3. Permittee shall assume entire responsibility for all activities and uses under this permit and shall indemnify, defend and save the Alameda County Public Works Agency, its officers, agents, and employees free and harmless from any and all expense, cost and liability in connection with or resulting from the exercise of this Permit including, but not limited to, property damage, personal injury and wrongful death.

## Alameda County Public Works Agency - Water Resources Well Permit

4. Applicant shall contact Vicky Hamlin for an inspection time at 510-670-5443 or email to vickyh@acpwa.org at least five (5) working days prior to starting, once the permit has been approved. Confirm the scheduled date(s) at least 24 hours prior to drilling.

5. Permittee, permittee's contractors, consultants or agents shall be responsible to assure that all material or waters generated during drilling, boring destruction, and/or other activities associated with this Permit will be safely handled, properly managed, and disposed of according to all applicable federal, state, and local statutes regulating such. In no case shall these materials and/or waters be allowed to enter, or potentially enter, on or off-site storm sewers, dry wells, or waterways or be allowed to move off the property where work is being completed.

6. Remove the Christy box or similar structure.

Destroy well by grouting neat cement with a tremie pipe or pressure grouting (25 psi for 5min.) to the bottom of the well and by filling with neat cement to three (3-5) feet below surface grade. Allow the sealing material to spill over the top of the casing to fill any annular space between casing and soil.

After the seal has set, backfill the remaining hole with concrete or compacted material to match existing conditions.

7. Copy of approved drilling permit must be on site at all times. Failure to present or show proof of the approved permit application on site shall result in a fine of \$500.00.

---

**CONFIDENTIAL**

STATE OF CALIFORNIA DWR  
WELL COMPLETION REPORT  
(WELL LOGS)

**REMOVED**

**CONFIDENTIAL**

STATE OF CALIFORNIA DWR  
WELL COMPLETION REPORT  
(WELL LOGS)

**REMOVED**

**CONFIDENTIAL**

**STATE OF CALIFORNIA DWR  
WELL COMPLETION REPORT  
(WELL LOGS)**

**REMOVED**