

1996.08-07 13:49  
 510 337 9335  
 ALAMEDA CO EHS HAZ-OPS

| COM No. | REMOTE STATION | START TIME  | DURATION | PAGES | RESULT | USER ID | REMARKS |
|---------|----------------|-------------|----------|-------|--------|---------|---------|
| 073     | 5515219        | 08-07 13:47 | 01' 28   | 03/03 | OK     |         |         |

7499402045

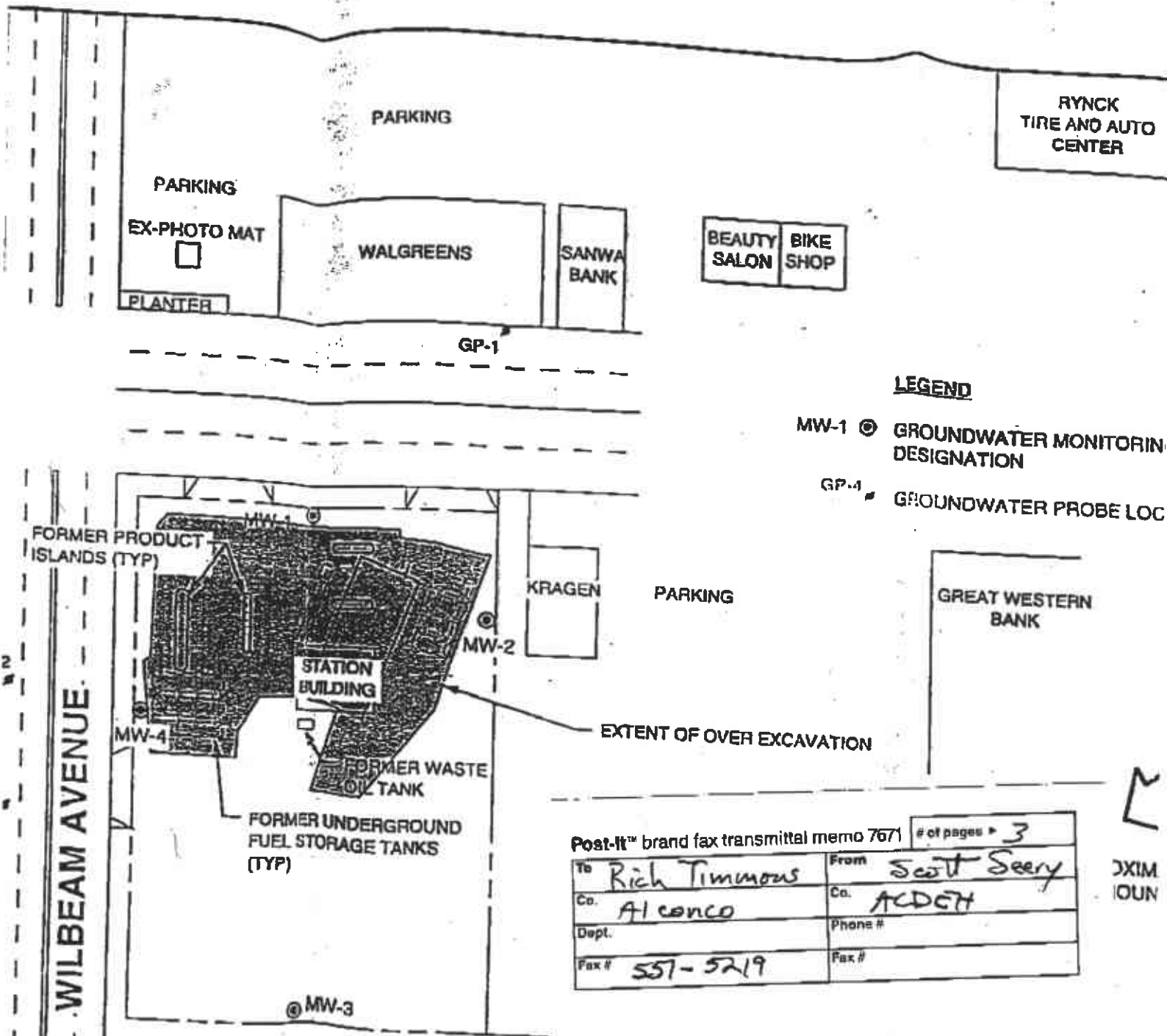

**LEGEND**  
 MW-1 ⊙ GROUNDWATER MONITORING DESIGNATION  
 GP-1 ⊙ GROUNDWATER PROBE LOC

Post-It™ brand fax transmittal memo 7671 # of pages 3

|                 |                  |
|-----------------|------------------|
| To Rich Timmons | From Scott Seery |
| Co. Alconco     | Co. ACDEH        |
| Dept.           | Phone #          |
| Fax # 557-5219  | Fax #            |

DXIM  
 IOUN

RYNCK  
TIRE AND AUTO  
CENTER

PARKING

PARKING

EX-PHOTO MAT

PLANTER

WALGREENS

SANWA  
BANK

BEAUTY  
SALON

BIKE  
SHOP

GP-1

**LEGEND**

MW-1 GROUNDWATER MONITORING DESIGNATION

GP-1 GROUNDWATER PROBE LOC

FORMER PRODUCT ISLANDS (TYP)

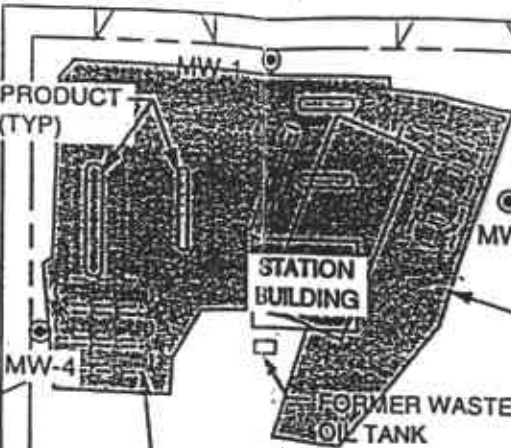

KRAGEN

PARKING

GREAT WESTERN  
BANK

MW-2

STATION BUILDING

EXTENT OF OVER EXCAVATION

FORMER UNDERGROUND FUEL STORAGE TANKS (TYP)

FORMER WASTE OIL TANK

MW-4

Post-It™ brand fax transmittal memo 7671 # of pages 3

|       |              |         |             |
|-------|--------------|---------|-------------|
| To    | Rich Timmons | From    | Scott Seery |
| Co.   | Alconco      | Co.     | ACDEH       |
| Dept. |              | Phone # |             |
| Fax # | 551-5219     | Fax #   |             |

OXIM IOUN

MW-3

SHOPPING CENTER

LAWN

APARTMENTS

APARTMENTS

LUCKYS  
SUPERMARKET

FORMER CHEVRON U.S.A. SERVICE STATION 9-4930  
3369 Castro Valley Boulevard at Wilbeam Avenue  
Castro Valley, California

0 FEET

EXTENDED SITE MAP

WILBEAM AVENUE

WILBEAM AVENUE

CASTRO VALLEY BOULEVARD

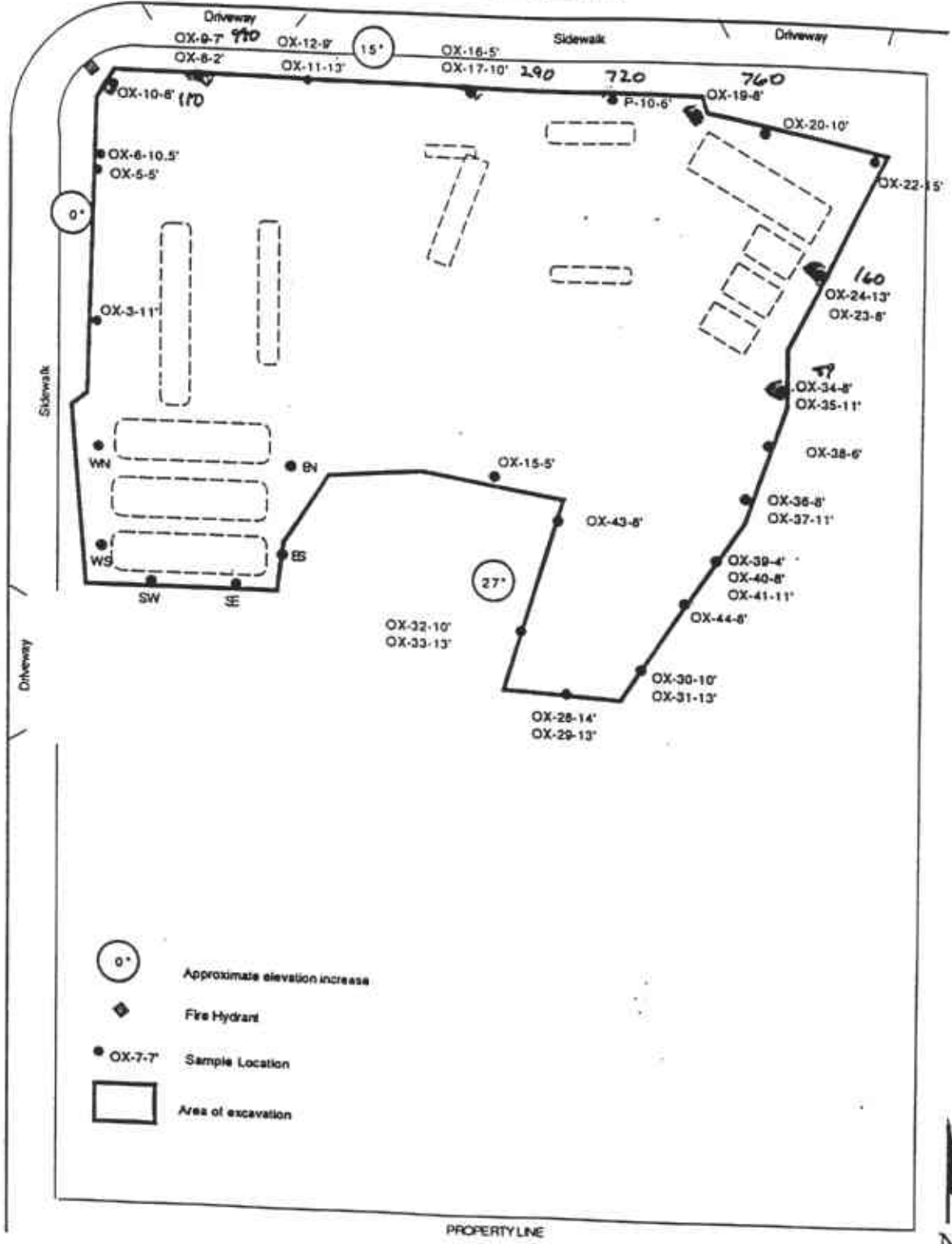

- Approximate elevation increase
- Fire Hydrant
- OX-7-7 Sample Location
- Area of excavation

PROPERTY LINE

Approximate Scale 1" = 30'



**Touchstone  
Developments**  
Environmental Management

**Sidewall  
Sample Location Map**  
Chevron Service Station No. 9-4930  
3369 Castro Valley Boulevard  
Castro Valley, California

**Figure 4**

05-12-93

mjt

Project # 4930-2

# CASTRO VALLEY BOULEVARD

OUTDOOR SEATING  
CRETE PATIO  
R=20'

(N) BICYCLE RACK (8)

(N) BENCH

(N) PLANTER

EXISTING SIDEWALK

S 89°06' W

140.29'

4' ASBESTOS  
CRACKING

NEW BICYCLE  
RACK

MAN  
CURE PAV

25'-6"

34'-8"

4'-9"

ADDITIONAL  
BUILDING  
AREA  
2,016 S.F.

102'-0"

NEW  
BOSTON  
MARKET  
2,983 S.F.

71'-8"

55'-3"

(N) CONC. WALKWAY

TRASH  
ENCL.

AP# 084-0060-001-06

WILBEAM AVENUE

CENTERLINE  
STREET

S 01°15' E

89.84'

121'-4"

AP# 084-0060-013-03

165.19'

S 01°15' E

S 89°06' W

159.86'

28'-0"

## SITE PLAN

SCALE: 1"=20'-0"



NORTH