

Hutch's Car Washes, Inc.

SINCE 1955

DETAILING

QUIK LUBE

Mark Detterman
Alameda County Health Care Services Agency
1131 Harbor Bay Parkway, Suite 250
Alameda, CA 94502

RECEIVED

9:17 am, May 23, 2012

Alameda County
Environmental Health

SUBJECT: RO0000451
Hutch's Car Wash
17945 Hesperian Blvd
San Lorenzo, CA 94580

Dear Mr. Detterman:

Attached please find a copy of the most recent report for the above referenced site.

I declare, under penalty of perjury, that the information and/or recommendations contained in the attached document or report is true and correct to the best of my knowledge.

Sincerely,

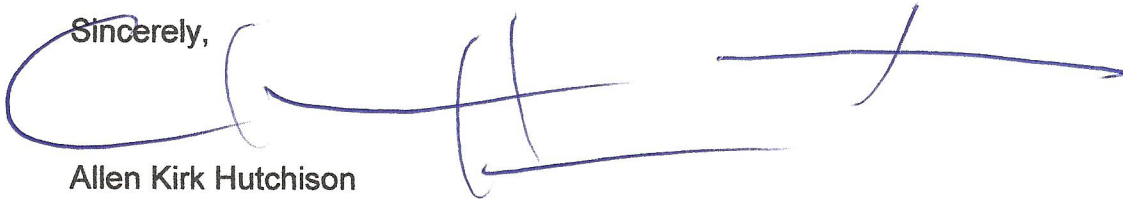

Allen Kirk Hutchison

Attachment



Aqua Science Engineers, Inc. 55 Oak Court, Suite 220, Danville, CA 94526
(925) 820-9391 - Fax (925) 837-4853 - www.aquascienceengineers.com

July 16, 2010

GROUNDWATER MONITORING REPORT
MAY 2010 GROUNDWATER SAMPLING
ASE JOB NO. 3411
at
Hutch's Carwash
17945 Hesperian Boulevard
San Lorenzo, California

Submitted by:
AQUA SCIENCE ENGINEERS, INC.
55 Oak Court, Suite 220
Danville, CA 94526
(925) 820-9391



Aqua Science Engineers, Inc. 55 Oak Court, Suite 220, Danville, CA 94526
(925) 820-9391 - Fax (925) 837-4853 - www.aquascienceengineers.com

1.0 INTRODUCTION

The following is a report detailing the results of the May 21, 2010 groundwater sampling at the Hutch's Carwash property located at 17945 Hesperian Boulevard in San Lorenzo, California (Figures 1 and 2).

2.0 GROUNDWATER FLOW DIRECTION AND GRADIENT

On May 21, 2010, ASE measured the depth to water in each site monitoring well using an electric water level sounder. The surface of the groundwater was also checked for the presence of free-floating hydrocarbons or sheen. No free-floating hydrocarbons or sheen were observed in any of the monitoring wells. Groundwater elevation data is presented in Table One.

The groundwater flow is to the northwest at a gradient of 0.0015-feet/foot. Groundwater elevation (potentiometric surface) contours are plotted on Figure 2.

3.0 GROUNDWATER SAMPLE COLLECTION AND ANALYSIS

On May 21, 2010, ASE collected a groundwater sample from monitoring well MW-1 for analyses. Monitoring well MW-3 is no longer being sampled because hydrocarbons have not been detected since its installation. Monitoring well MW-2 is also no longer being sampled in accordance with a letter from the Alameda County Health Care Services Agency (ACHCSA) dated August 12, 2002 stating MW-2 may be excluded from further sampling events until further notice. Prior to sampling, monitoring well MW-1 was purged of three well casing volumes of groundwater. Samples were then collected using a disposable polyethylene bailer. The groundwater samples were decanted from the bottom of the bailer using a low-flow emptying device into 40-ml volatile organic analysis (VOA) vials, preserved with hydrochloric acid, labeled, and stored on ice for transport to Kiff Analytical, LLC of Davis, California (CA ELAP #2236) under appropriate chain of custody documentation.

The well sampling purge water was contained in a sealed and labeled 55-gallon steel drum. The well sampling field logs are included as Appendix A.

The groundwater samples were analyzed by Kiff Analytical, LLC for total petroleum hydrocarbons as gasoline (TPH-G), benzene, toluene, ethyl benzene, and total xylenes (collectively known as BTEX) and methyl tertiary butyl ether (MTBE) by EPA Method 8260B.

The analytical results are tabulated in Table Two, and copies of the certified analytical report and chain of custody form are included in Appendix B.



Aqua Science Engineers, Inc. 55 Oak Court, Suite 220, Danville, CA 94526
(925) 820-9391 - Fax (925) 837-4853 - www.aquascienceengineers.com

4.0 RESULTS AND CONCLUSIONS

The groundwater sample collected from monitoring well MW-1 contained 69 parts per billion (ppb) TPH-G and 33 ppb MTBE. These concentrations show a decrease from the previous sampling in December 2009.

The MTBE concentration in the groundwater sample collected from monitoring well MW-1 exceeded the California Regional Water Quality Control Board, San Francisco Bay Region (RWQCB) Environmental Screening Level (ESL) presented in the "Screening For Environmental Concerns at Sites With Contaminated Soil and Groundwater" document dated May 2008 for sites where water is a current or potential source of drinking water. However, the MTBE concentration did not exceed the ESL for sites where groundwater is not a current or potential source of drinking water.

5.0 RECOMMENDATIONS

A soil and groundwater assessment is scheduled for July 2010. Recommendations will be provided in the report for that assessment, which will likely be completed in August 2010.

6.0 REPORT LIMITATIONS

The results presented in this report represent conditions at the time of groundwater sampling, at the specific locations where the samples were collected, and for the specific parameters analyzed by the laboratory.

It does not fully characterize the site for contamination resulting from unknown sources, or for parameters not analyzed by the laboratory. All of the laboratory work cited in this report was prepared under the direction of an independent CAL-DHS certified laboratory. The independent laboratory is solely responsible for the contents and conclusions of the chemical analysis data.



Aqua Science Engineers, Inc. 55 Oak Court, Suite 220, Danville, CA 94526
(925) 820-9391 - Fax (925) 837-4853 - www.aquascienceengineers.com

Aqua Science Engineers appreciates the opportunity to provide environmental consulting services for this project. Should you have any questions or comments, please feel free to call us at (925) 820-9391.

Respectfully submitted,

AQUA SCIENCE ENGINEERS, INC.

A handwritten signature in black ink that reads 'Robert E. Kitay'.

Robert E. Kitay, P.G., R.E.A.
Senior Geologist

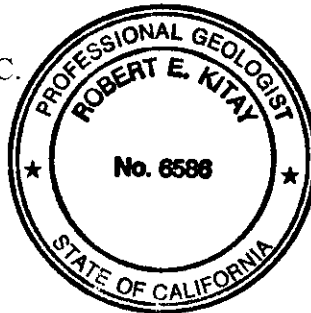

Attachments: Figures 1 and 2
Appendices A and B

cc: Mr. Kirk Hutchison, Hutch's Car Wash
Mr. Steven Plunkett, Alameda County Health Care Services Agency



Aqua Science Engineers, Inc. 55 Oak Court, Suite 220, Danville, CA 94526
(925) 820-9391 - Fax (925) 837-4853 - www.aquascienceengineers.com

FIGURES

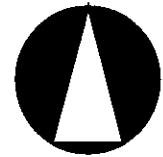

NORTH

NOT TO SCALE

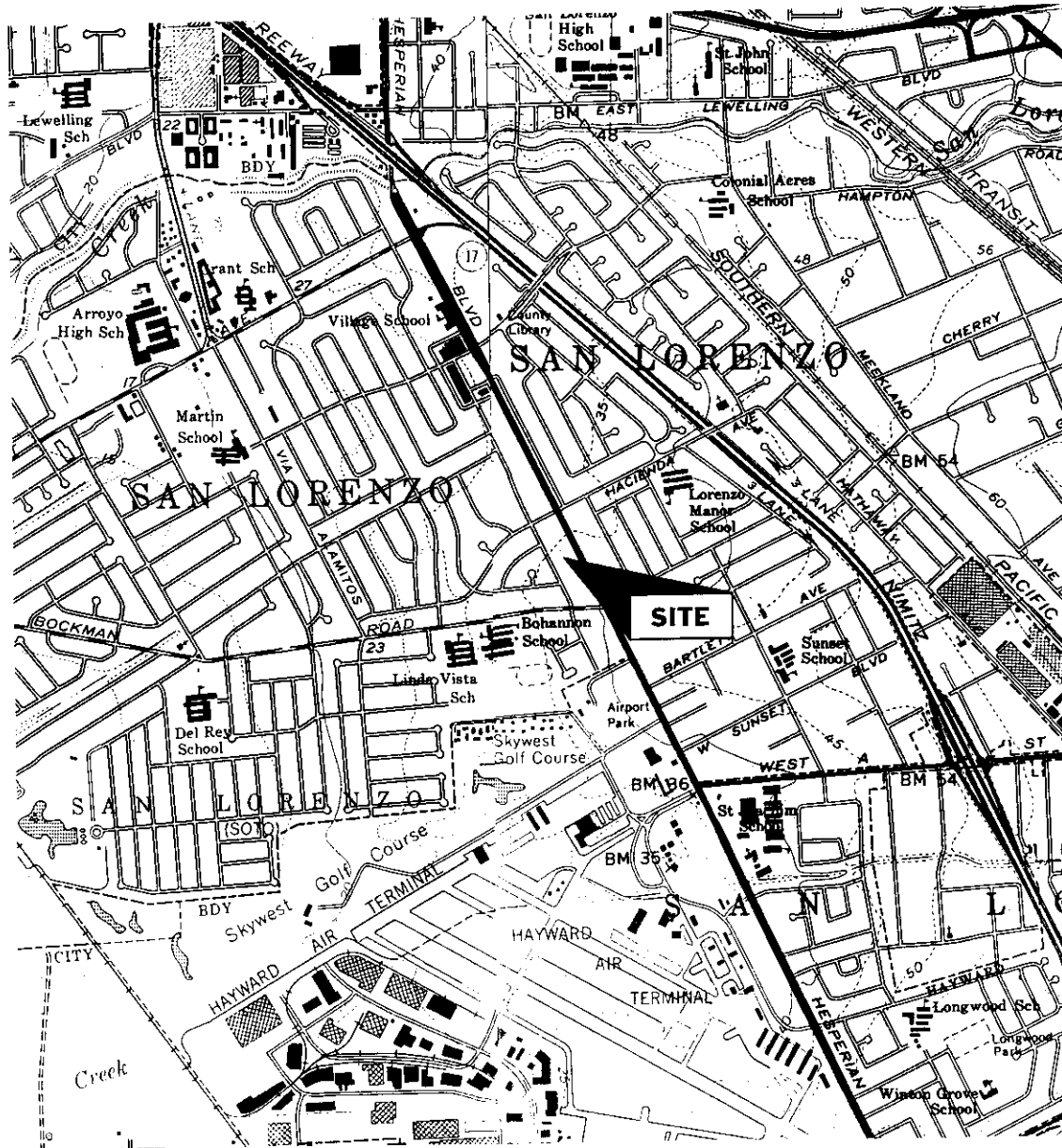

LOCATION MAP

Hutch's Carwash
17945 Hesperian Boulevard
San Lorenzo, California

AQUA SCIENCE ENGINEERS, INC. Figure 1

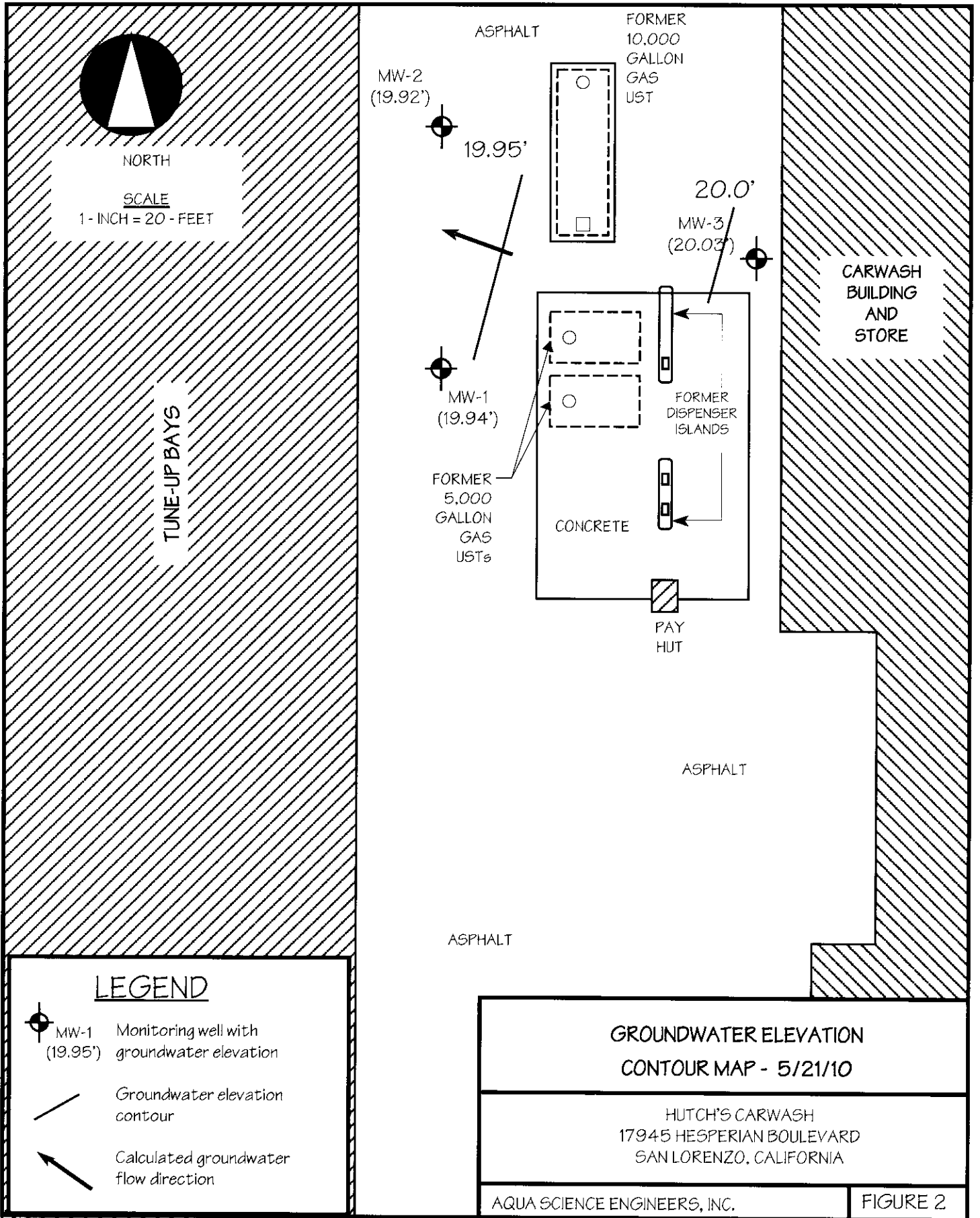

NORTH

SCALE
 1-INCH = 20- FEET

TUNE-UP BAYS

ASPHALT

FORMER
 10,000
 GALLON
 GAS
 UST

MW-2
 (19.92')

19.95'

20.0'

MW-3
 (20.03')

CARWASH
 BUILDING
 AND
 STORE

MW-1
 (19.94')

FORMER
 DISPENSER
 ISLANDS

FORMER
 5,000
 GALLON
 GAS
 USTs

CONCRETE

PAY
 HUT

ASPHALT

ASPHALT



Aqua Science Engineers, Inc. 55 Oak Court, Suite 220, Danville, CA 94526
(925) 820-9391 - Fax (925) 837-4853 - www.aquascienceengineers.com

TABLES

TABLE ONE
Groundwater Elevation Data
Hutch's Carwash
17945 Hesperian Blvd., San Lorenzo, CA

Well ID	Date of Measurement	Top of Casing Elevation (Relative to Mean Sea Level)	Depth to Water (feet)	Groundwater Elevation (project data)
MW-1	10/6/99	35.00	15.58	19.42
	1/13/00		15.58	19.42
	4/12/00		14.75	20.25
	7/19/00		15.29	19.71
	10/25/00		15.56	19.44
	1/16/01		15.22	19.78
	4/4/01		15.05	19.95
	7/6/01		15.49	19.51
	10/1/01		15.78	19.22
	1/7/02		13.83	21.17
	4/2/02		14.83	20.17
	7/9/02		15.41	19.59
	10/1/02		15.70	19.3
	1/24/03		14.69	20.31
	7/25/03		15.41	19.59
	1/16/04		14.73	20.27
	7/14/04		15.54	19.46
	1/29/05		14.38	20.62
	7/22/05		15.23	19.77
	1/25/06		14.00	21.00
6/10/06	15.13	19.87		
1/26/07	15.30	19.70		
7/5/07	15.46	19.54		
1/30/08	14.32	20.68		
1/27/09	15.43	19.57		
12/8/09	15.57	19.43		
5/21/10	15.06	19.94		
MW-2	10/6/99	35.21	15.84	19.37
	1/13/00		15.78	19.43
	4/12/00		14.94	20.27
	7/19/00		15.54	19.67
	10/25/00		15.81	19.4
	1/16/01		15.50	19.71
	4/4/01		15.28	19.93
	7/6/01		15.73	19.48
	10/1/01		16.06	19.15
	1/7/02		14.08	21.13
	4/2/02		15.04	20.17
	7/9/02		15.66	19.55
	10/1/02		15.96	19.25
	1/24/03		14.90	20.31
	7/25/03		15.68	19.53
	1/16/04		14.93	20.28
	7/14/04		15.81	19.40
	1/29/05		14.90	20.31
	7/22/05		15.46	19.75
	1/25/06		14.16	21.05
6/10/06	15.40	19.81		
1/26/07	15.55	19.66		
7/5/07	15.72	19.49		
1/30/08	14.51	20.70		
1/27/09	15.67	19.54		
12/8/09	15.85	19.36		
5/21/10	15.29	19.92		

TABLE ONE
Groundwater Elevation Data
Hutch's Carwash
17945 Hesperian Blvd., San Lorenzo, CA

Well ID	Date of Measurement	Top of Casing Elevation (Relative to Mean Sea Level)	Depth to Water (feet)	Groundwater Elevation (project data)
MW-3	10/6/99	34.47	14.98	19.49
	1/13/00		14.98	19.49
	4/12/00		14.09	20.38
	7/19/00		14.70	19.77
	10/25/00		14.98	19.49
	1/16/01		14.58	19.89
	4/4/01		14.43	20.04
	7/6/01		14.85	19.62
	10/1/01		15.21	19.26
	1/7/02		13.24	21.23
	4/2/02		14.20	20.27
	7/9/02		14.81	19.66
	10/1/02		15.12	19.35
	1/24/03		14.05	20.42
	7/25/03		14.82	19.65
	1/16/04		14.08	20.39
	7/14/04		14.94	19.53
	1/29/05		14.03	20.44
	7/22/05		14.59	19.88
	1/25/06		13.31	21.16
6/10/06	14.53	19.94		
1/26/07	14.69	19.78		
7/5/07	14.88	19.59		
1/30/08	13.64	20.83		
1/27/09	14.83	19.64		
12/8/09	14.98	19.49		
5/21/10	14.44	20.03		

TABLE TWO
Summary of Analytical Results for GROUNDWATER Samples
Hutch's Carwash
17945 Hesperian Blvd., San Lorenzo, CA
All results are in parts per billion (ppb)

Well ID & Dates Sampled	TPH-G	Benzene	Toluene	Ethyl- benzene	Total Xylenes	MTBE
MW-1						
10/6/99	1,500	3.3	2.3	27	72	120
1/13/00	1,500	15	19	19	33	650
4/12/00	1,700	18	13	45	79	2,600
7/19/00	2,200	31	< 5.0	81	100	2,000
10/25/00	3,300	20	< 5.0	98	9.4	3,300
1/16/01	4,100	34	14	60	120	1,300
4/4/01	2,900	14	< 0.5	34	32	2,000
7/6/01	1,300	4.4	< 0.5	12	13	700
10/1/01	1,100	4.1	< 0.5	18	19	520
1/7/02	1,400	34	< 0.5	13	15	1,300
4/2/02	1,900	30	6.7	24	30	1,000
7/9/02	1,500	26	< 5.0	12	8.6	820
10/1/02	830	3.6	< 2.5	7.4	2.9	520
1/24/03	1,300	6.2	< 5.0	12	< 5.0	680
7/25/03	520	15	< 1.0	11	1.0	250
1/16/04	540	3.9	< 2.5	8.3	3.1	290
7/14/04	220	< 1.0	< 1.0	8.1	< 1.0	140
1/29/05	160	1.0	< 0.5	2.5	< 1.0	60
7/22/05	380	2.5	< 1.0	9.1	< 2.0	210
1/25/06	250	1.2	< 1.0	3.3	< 2.0	220
6/10/06	< 100	< 1.0	< 1.0	1.3	< 2.0	180
1/26/07	< 50	< 0.5	< 0.5	< 0.5	< 1.0	18
7/5/07	< 50	< 0.5	< 0.5	< 0.5	< 1.0	37
1/30/08	< 200	< 2.0	< 2.0	< 2.0	< 4.0	290
1/27/09	140	< 0.5	< 0.5	< 0.5	< 0.5	170
12/8/09	170	< 0.5	< 0.5	< 0.5	< 0.5	150
5/20/10	69	< 0.5	< 0.5	< 0.5	< 0.5	33

TABLE TWO
Summary of Analytical Results for GROUNDWATER Samples
Hutch's Carwash
17945 Hesperian Blvd., San Lorenzo, CA
All results are in parts per billion (ppb)

Well ID & Dates Sampled	TPH-G	Benzene	Toluene	Ethyl- benzene	Total Xylenes	MTBE
MW-2						
10/6/99	< 50	< 0.5	< 0.5	< 0.5	< 0.5	18
1/13/00	< 50	< 0.5	< 0.5	< 0.5	< 0.5	16
4/12/00	< 100	< 1.0	< 1.0	< 1.0	< 1.0	240
7/19/00	< 50	< 0.5	< 0.5	< 0.5	< 0.5	< 5.0
10/25/00	< 50	< 0.5	< 0.5	< 0.5	< 0.5	6
1/16/01	< 50	< 0.5	< 0.5	< 0.5	< 0.5	8
4/4/01	< 50	< 0.5	< 0.5	< 0.5	< 0.5	< 5.0
7/6/01	< 50	< 0.5	< 0.5	< 0.5	< 0.5	6
10/1/01	< 50	< 0.5	< 0.5	< 0.5	< 0.5	21
1/7/02	< 50	< 0.5	< 0.5	< 0.5	< 0.5	< 5.0
4/2/02	< 50	< 0.5	< 0.5	< 0.5	< 0.5	< 5.0
7/9/02	< 50	< 0.5	< 0.5	< 0.5	< 0.5	< 5.0
10/1/02	No longer sampled					
MW-3						
10/6/99	< 50	< 0.5	< 0.5	< 0.5	< 0.5	< 5.0
1/13/00	< 50	< 0.5	< 0.5	< 0.5	< 0.5	< 5.0
4/12/00	< 50	< 0.5	< 0.5	< 0.5	< 0.5	< 5.0
7/19/00	< 50	< 0.5	< 0.5	< 0.5	< 0.5	< 5.0
10/25/00	< 50	< 0.5	< 0.5	< 0.5	< 0.5	< 5.0
1/16/01	No longer sampled					
ESL (DW)	100	1	40	30	20	5
ESL (NDW)	210	46	130	43	100	1,800

Notes:

* EPA Method 8020/EPA Method 8260 (MTBE confirmation)

** Hydrocarbon reported in the gasoline range does not match the laboratory gasoline standard

*** Sample contains a discrete peak in addition to gasoline

ESL = Environmental screening level presented in the "Screening For Environmental Concerns at Sites With Contaminated Soil and Groundwater (May 2008)" document prepared by the California Regional Water Quality Control Board, San Francisco Bay Region.

DW = Groundwater is considered a current or potential source of drinking water

NDW = Groundwater is not considered a current or potential source of drinking water

Most current data is in **Bold**

Non-detectable concentrations noted by the less than sign (<) followed by the laboratory reporting limit



Aqua Science Engineers, Inc. 55 Oak Court, Suite 220, Danville, CA 94526
(925) 820-9391 - Fax (925) 837-4853 - www.aquascienceengineers.com

APPENDIX A

Well Sampling Field Logs

AQUA SCIENCE ENGINEERS

WELL SAMPLING FIELD LOG

PROJECT NAME Hutch's S.L.

JOB NUMBER 3411 DATE OF SAMPLING 5-21-10

WELL ID. ~~250~~ MW-1 SAMPLER RK

TOTAL DEPTH OF WELL 260 WELL DIAMETER 2

DEPTH TO WATER PRIOR TO PURGING 15.06

PRODUCT THICKNESS 0

DEPTH OF WELL CASING IN WATER 10.94

NUMBER OF GALLONS PER WELL CASING VOLUME 1.8

NUMBER OF WELL CASING VOLUMES TO BE REMOVED 3

REQUIRED VOLUME OF GROUNDWATER TO BE PURGED PRIOR TO SAMPLING 5.5 gal

EQUIPMENT USED TO PURGE WELL New Disposable bailer

TIME EVACUATION STARTED 1500 TIME EVACUATION COMPLETED 1510

TIME SAMPLES WERE COLLECTED 1515

IS WELL GO DRY NO AFTER HOW MANY GALLONS —

VOLUME OF GROUNDWATER PURGED 5.5 gal

SAMPLING DEVICE New Disposable bailer

SAMPLE COLOR None ODOR/SEDIMENT slight hcy / slight brown

HEMICAL DATA

VOLUME PURGED	TEMPERATURE	pH	CONDUCTIVITY
1	65.7	7.03	857
2	65.4	7.03	858
3	65.4	7.03	859

SAMPLES COLLECTED

SAMPLE	# OF CONTAINERS	SIZE AND TYPE OF CONTAINER	ANALYSIS	PRESERVED
MW-1	3	40-ml vof	TPH-G/BTEX/MPPE	RK1



Aqua Science Engineers, Inc. 55 Oak Court, Suite 220, Danville, CA 94526
(925) 820-9391 - Fax (925) 837-4853 - www.aquascienceengineers.com

APPENDIX B

Certified Analytical Report
and
Chain of Custody Documentation



Laboratory Results

Robert Kitay
Aqua Science Engineers, Inc.
55 Oak Court, Suite 220
Danville, CA 94526

Subject : 1 Water Sample
Project Name : Hutch's Car Wash
Project Number : 3411

Dear Mr. Kitay,

Chemical analysis of the samples referenced above has been completed. Summaries of the data are contained on the following pages. Sample(s) were received under documented chain-of-custody. US EPA protocols for sample storage and preservation were followed. Testing procedures comply with the 2003 NELAC standard. All soil samples are reported on a total weight (wet weight) basis unless noted otherwise in the case narrative. Laboratory results relate only to the samples tested. This report may be freely reproduced in full, but may only be reproduced in part with the express permission of Kiff Analytical, LLC. Kiff Analytical, LLC is certified by the State of California under the National Environmental Laboratory Accreditation Program (NELAP), lab # 08263CA. If you have any questions regarding procedures or results, please call me at 530-297-4800.

Sincerely,



Joel Kiff



Report Number : 73137

Date : 05/24/2010

Project Name : **Hutch's Car Wash**

Project Number : **3411**

Sample : **MW-1**

Matrix : Water

Lab Number : 73137-01

Sample Date :05/20/2010

Parameter	Measured Value	Method Reporting Limit	Units	Analysis Method	Date Analyzed
Benzene	< 0.50	0.50	ug/L	EPA 8260B	05/22/2010
Toluene	< 0.50	0.50	ug/L	EPA 8260B	05/22/2010
Ethylbenzene	< 0.50	0.50	ug/L	EPA 8260B	05/22/2010
Total Xylenes	< 0.50	0.50	ug/L	EPA 8260B	05/22/2010
Methyl-t-butyl ether (MTBE)	33	0.50	ug/L	EPA 8260B	05/22/2010
TPH as Gasoline	69	50	ug/L	EPA 8260B	05/22/2010
1,2-Dichloroethane-d4 (Surr)	106		% Recovery	EPA 8260B	05/22/2010
Toluene - d8 (Surr)	101		% Recovery	EPA 8260B	05/22/2010

2) MRL raised due to interference

QC Report : Method Blank Data

Project Name : **Hutch's Car Wash**

Project Number : **3411**

Parameter	Measured Value	Method Reporting Limit	Units	Analysis Method	Date Analyzed
Benzene	< 0.50	0.50	ug/L	EPA 8260B	05/22/2010
Ethylbenzene	< 0.50	0.50	ug/L	EPA 8260B	05/22/2010
Toluene	< 0.50	0.50	ug/L	EPA 8260B	05/22/2010
Total Xylenes	< 0.50	0.50	ug/L	EPA 8260B	05/22/2010
Methyl-t-butyl ether (MTBE)	< 0.50	0.50	ug/L	EPA 8260B	05/22/2010
TPH as Gasoline	< 50	50	ug/L	EPA 8260B	05/22/2010
1,2-Dichloroethane-d4 (Surr)	109		%	EPA 8260B	05/22/2010
Toluene - d8 (Surr)	101		%	EPA 8260B	05/22/2010

Parameter	Measured Value	Method Reporting Limit	Units	Analysis Method	Date Analyzed
-----------	----------------	------------------------	-------	-----------------	---------------

QC Report : Matrix Spike/ Matrix Spike Duplicate

Project Name : **Hutch's Car Wash**Project Number : **3411**

Parameter	Spiked Sample	Sample Value	Spike Level	Spike Dup. Level	Spiked Sample Value	Duplicate Spiked Sample Value	Units	Analysis Method	Date Analyzed	Spiked Sample Percent Recov.	Duplicate Spiked Sample Percent Recov.	Relative Percent Diff.	Spiked Sample Percent Recov. Limit	Relative Percent Diff. Limit
Benzene	73137-01	<0.50	40.0	39.7	40.8	38.9	ug/L	EPA 8260B	5/22/10	102	98.1	3.76	80-120	25
Ethylbenzene	73137-01	<0.50	40.0	39.7	39.8	38.1	ug/L	EPA 8260B	5/22/10	99.6	96.1	3.60	80-120	25
Methyl-t-butyl ether	73137-01	33	40.2	39.9	75.8	70.9	ug/L	EPA 8260B	5/22/10	106	95.0	11.2	69.7-121	25
O-Xylene	73137-01	<0.50	40.0	39.7	38.7	37.4	ug/L	EPA 8260B	5/22/10	96.8	94.2	2.67	79.7-120	25
P + M Xylene	73137-01	<0.50	40.0	39.7	38.5	36.7	ug/L	EPA 8260B	5/22/10	96.4	92.6	4.00	76.8-120	25
Toluene	73137-01	<0.50	40.0	39.7	40.4	38.8	ug/L	EPA 8260B	5/22/10	101	97.8	3.16	80-120	25

QC Report : Laboratory Control Sample (LCS)Project Name : **Hutch's Car Wash**Project Number : **3411**

Parameter	Spike Level	Units	Analysis Method	Date Analyzed	LCS Percent Recov.	LCS Percent Recov. Limit
Benzene	40.0	ug/L	EPA 8260B	5/22/10	96.8	80-120
Ethylbenzene	40.0	ug/L	EPA 8260B	5/22/10	94.9	80-120
Methyl-t-butyl ether	40.2	ug/L	EPA 8260B	5/22/10	99.0	69.7-121
O-Xylene	40.0	ug/L	EPA 8260B	5/22/10	93.6	79.7-120
P + M Xylene	40.0	ug/L	EPA 8260B	5/22/10	92.3	76.8-120
Toluene	40.0	ug/L	EPA 8260B	5/22/10	96.1	80-120

73137

Aqua Science Engineers, Inc.
55 Oak Court, Suite 220
Danville, CA 94526
(925) 820-9391
FAX (925) 837-4853

Chain of Custody

PAGE 1 of 1

SAMPLER (SIGNATURE)

PROJECT NAME Hutch's carwash

JOB NO. 3411

ADDRESS 17945 Hesperian Blvd, San Lorenzo, CA

ANALYSIS REQUEST

SPECIAL INSTRUCTIONS:

SAMPLE ID.	DATE	TIME	MATRIX	QUANTITY	TPH-GAS / MTBE & BTEX (EPA 821/8015-8020) 9209	TPH-DIESEL (EPA 3510/8015)	TPH-DIESEL & MOTOR OIL (EPA 3510/8015)	CAM 17 METALS (EPA 6010+7000)	SEMI-VOLATILE ORGANICS (EPA 825/8270)	Pb (TOTAL or DISSOLVED) (EPA 6010)	PESTICIDES (EPA 8061)	FUEL OXYGENATES (EPA 8280)	PURGEABLE HALOCARBONS (EPA 601/8010)	TPH-G/BTEX/5 OXYS (EPA METHOD 8260)	MULTI-RANGE HYDROCARBONS WITH SILICA GEL CLEANUP (EPA 6015)	VOLATILE ORGANICS (EPA 824/8240/8260)	LUFT METALS (5) (EPA 6010+7000)	COMPOSITE 4:1	EDF		
MW-1	5-20-10	1515	W	3	X															X	-01

RELINQUISHED BY:
Robert E. Kiff 5-20-10
(signature) (time)

RECEIVED BY:
[Signature]
(signature) (time)

RELINQUISHED BY:
[Signature]
(signature) (time)

RECEIVED BY LABORATORY:
Rozmide 1133
(signature) (time)

COMMENTS:

Robert E. Kiff 11/30
(printed name) (date)

[Signature]
(printed name) (date)

[Signature]
(printed name) (date)

Ron McGee 052110
(printed name) (date)

TURN AROUND TIME
STANDARD 24Hr 48Hr 72Hr
OTHER:

Company-ASE, INC.

Company-

Company-

Company-
Kiff Analytical

