



73 Digital Drive
 Novato, CA 94949
 Phone: (415) 382-7400
 FAX: (415) 382-7415

Exxon Company, U.S.A.
QUARTERLY STATUS REPORT
 January - March 1993
 Date: April 12, 1993

RAS # 7-0104
 1725 Park Street
 Alameda, California
 RESNA No. 170077

Work Performed During This Quarter

January through March 1993

- o Performed Quarterly Groundwater Monitoring for first quarter 1993 on February 5, 1993.
- o Submitted work plan for installation of offsite groundwater monitoring wells on February 26, 1993.
- o Completed construction and began operation of groundwater extraction and treatment system in March 1993.

Quarterly Groundwater Sampling (2/5/93) Results (ug/L)

Well No.	B	T	E	X	TPHg	Historical Trend	
MW-1	2,400	160	1,400	790	11,000	Increase	
MW-2	0.01-foot separate phase hydrocarbons						Increase
MW-3	3,600	110	1,300	430	13,000	Increase	
MW-4	2,300	820	980	2,200	15,000	Increase	
MW-5	Emulsion						Unchanged
MW-6	2,500	4,300	1,700	5,300	26,000	Increase	
MW-7	1,100	2,300	1,200	4,200	33,000	Increase	

Free Phase Product Recovery

Unknown

Work to be Performed Next Quarter

Estimated Completion Date: 6/30/93

- o Submit quarterly monitoring report and perform quarterly monitoring event.
- o Operate and maintain groundwater remediation system
- o Perform agency file review of offsite sources and submit report and install offsite monitoring wells.



Work to be Performed Next 12 Months

Estimated Completion Date: 3/31/94

- o Submit report on installation of offsite wells.
- o Continue quarterly groundwater monitoring and sampling program to evaluate the trends of gasoline hydrocarbons and groundwater flow direction and gradient.
- o Operate and maintain groundwater remediation system.

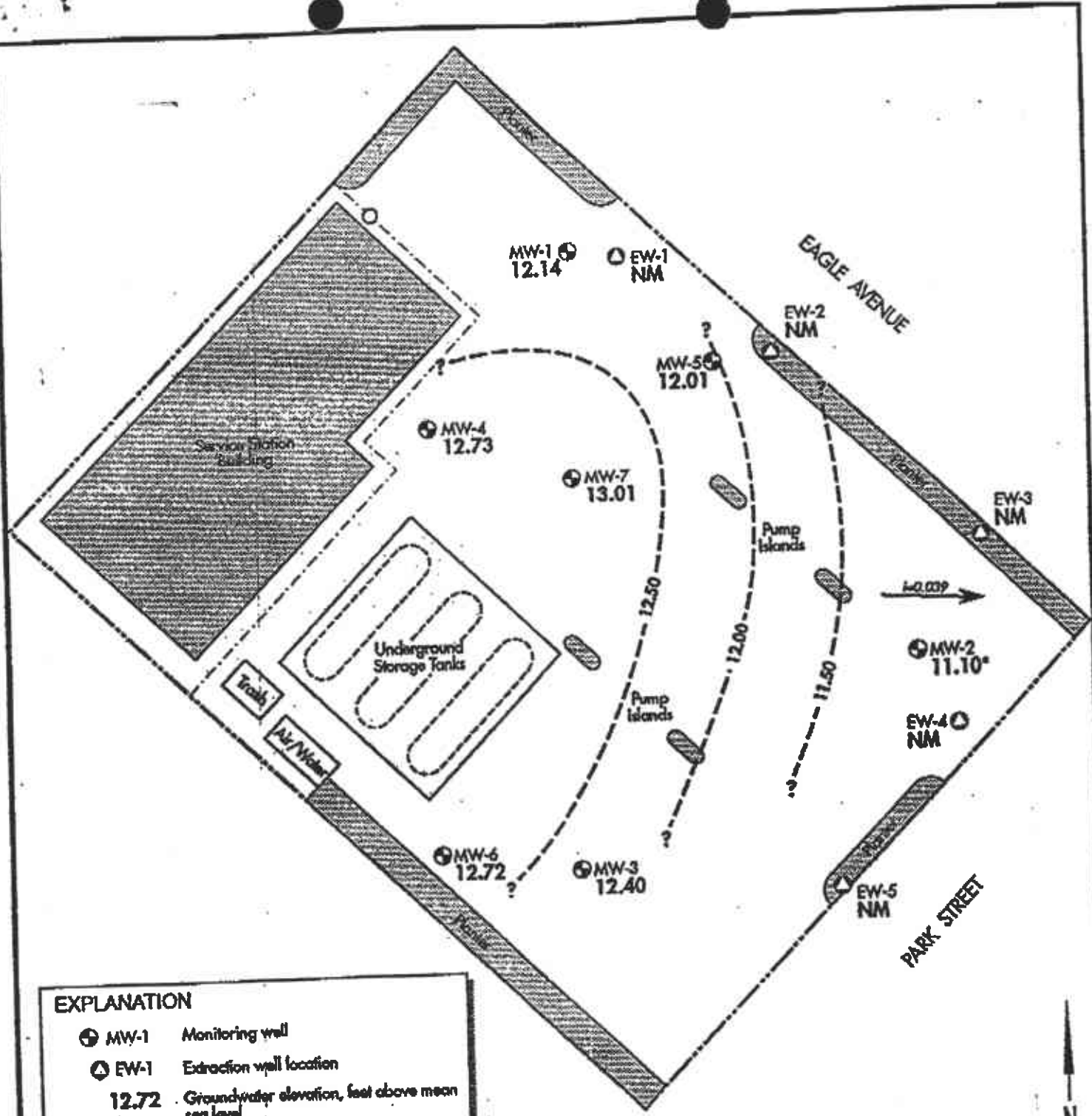

EXPLANATION

- ⊕ MW-1 Monitoring well
- ⊖ EW-1 Extraction well location
- 12.72 Groundwater elevation, feet above mean sea level
- NM Not measured
- Corrected for the presence of floating product
- 12.00 - - - ? Groundwater elevation contour, feet above mean sea level, dashed where inferred, queried where uncertain
- ← -0.004 Estimated direction of groundwater flow with evaluated gradient

Map Source: Site Map by Harding Lawson Associates, 1002

POTENTIOMETRIC SURFACE MAP
 February 2, 1993
 Exxon Service Station No. 7-0104
 1725 Park Street
 Alameda, California

PLATE
2

RESNA

PROJECT NO. 170077.01

3/93