

RECEIVED

4:04 pm, Feb 15, 2012

Alameda County
Environmental Health



February 9, 2012
Cardno ERI 2506C.L48

Mr. Fuad M Ateyeh
1725 Park Street
Alameda, California, 94501

Cardno ERI
License A/C10-611383

601 N McDowell Boulevard
Petaluma, CA 94954
USA

Phone 707 766 2000
Toll-free 800 382 9105
Fax 707 789 9414
www.cardno.com

www.cardnoeri.com

SUBJECT Notification of Scheduled Environmental Activities
Former Exxon Service Station 70104
1725 Park Street, Alameda, California

Mr. Ateyeh:

At the request of ExxonMobil Environmental Services (EMES), on behalf of Exxon Mobil Corporation, Cardno ERI is notifying you of the upcoming drilling activities of two off-site soil borings (SB14 and SB15) and six on-site soil borings (SB16 through SB21) at the subject site. The boring locations are shown on the attached Generalized Site Plan. The borings will be core-cut and advanced using hand-auger equipment. Boring locations will be backfilled with grout and capped with concrete upon completion.

Specific field activities related to the work include:

- Drilling activities, February 28 and February 29, 2012
- Surveying activities, Date to be determined

Soil cuttings and rinsate water from drilling activities will be placed in 55-gallon drums and stored at the subject site pending characterization and disposal. Upon receipt of laboratory analytical results of soil samples from the drums, Cardno ERI will coordinate with EMES for disposal of the soil and water.

Cardno ERI appreciates your cooperation in ensuring that field work occurs safely and efficiently.

Please contact Ms. Paula Sime, Cardno ERI's project manager for this site, at paula.sime@cardno.com or at (707) 766-2000 with any questions regarding this site.

Sincerely,

SCANNED
IMAGE
Alex Snyder for:

Rebekah A. Westrup
Senior Staff Geologist
for Cardno ERI
707 766 2000
Email: rebekah.westrup@cardno.com



SCANNED
IMAGE

Paula Sime
Senior Project Manager
for Cardno ERI
707 766 2000
Email: paula.sime@cardno.com

February 9, 2012
Cardno ERI 2506C.L48 Former Exxon Service Station 70104, Alameda, California

Enclosure: Generalized Site Plan

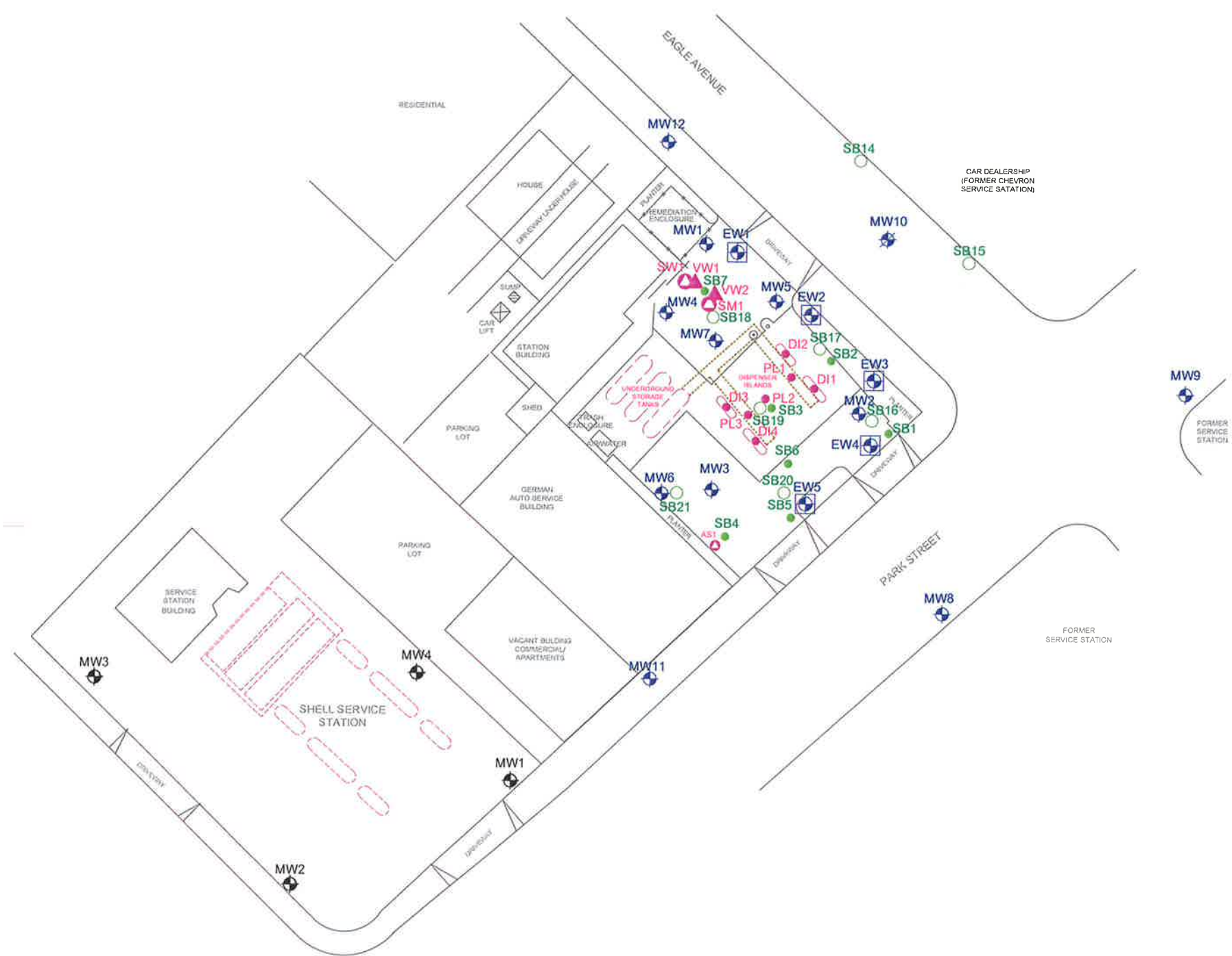
cc: Ms. Jennifer C. Sedlachek, ExxonMobil Environmental Services
 Ms. Barbara Jakub, P.G., Alameda County Health Care Services Agency, Department of Environmental
 Health
 Mr. Shay Wideman, The Valero Companies, Environmental Liability Management



FN 2506 12 L48 GSP_SP



GENERALIZED SITE PLAN

FORMER
EXXON SERVICE STATION 70104
1725 Park Street
Alameda, California

EXPLANATION

- | | | |
|--|---|--|
| <ul style="list-style-type: none"> MW12 Groundwater Monitoring Well EW4 Recovery Well MW10 Destroyed Groundwater Monitoring Well | <ul style="list-style-type: none"> MW4 Groundwater Monitoring Well By Others VW2 Vapor Extraction Well AS1 Air Sparge/Soil Vapor Well DI4 Dispenser Island Boring | <ul style="list-style-type: none"> SB7 Soil Boring PL3 Product Line Boring SB21 Proposed Soil Boring |
|--|---|--|

PROJECT NO.	2506
PLATE	1