



3330 Data Drive, Suite 100
 Rancho Cordova, CA 95670
 Phone: (916) 638-2085
 Fax: (916) 638-8385



TRANSMITTAL FORM

DATE: 9 MARCH 1995
 RECIPIENT: EVA CHIL
 COMPANY: ALAMEDA COUNTY HEALTH CARE SERVICES AGENCY
 RECIPIENT FAX NO.: (510) 337-9335
 SENDER: LINDA MCGAHAN
 NO. OF PAGES TO FOLLOW: ① SITE MAP
 SUBJECT: EXXON 7-0104, 1725 PARK ST., ALAMEDA
 DELTA PROJECT NO.: _____
 MESSAGE: _____

EVA:

DUE TO THE LOGISTICS OF THE SITE, WE CAN INSTALL ONE WELL, MW-11 ANYWHERE WITHIN THE GERMAN AUTO SERVICE PARKING LOT. THE CAR LIFT/SUMP HAVE UNDERGROUND PIPING AND THE BACK DRIVEWAY SLANTS DOWNWARD (LOT 2230) AND WOULD REQUIRE DRILLING AT AN ANGLE.

REVIEW LOCATION. IF NEEDED, WE CAN INSTALL A SECOND WELL IN THE PARKING LOT OF THE VACANT BUILDING (LOTS 1713/1715) TOWARDS THE SHELL STATION, OR MOVE MW-11 TOWARDS THE NORTHWEST.

PLEASE CALL ME TO DISCUSS - THANKS,
#(916) 638-2085 LIN

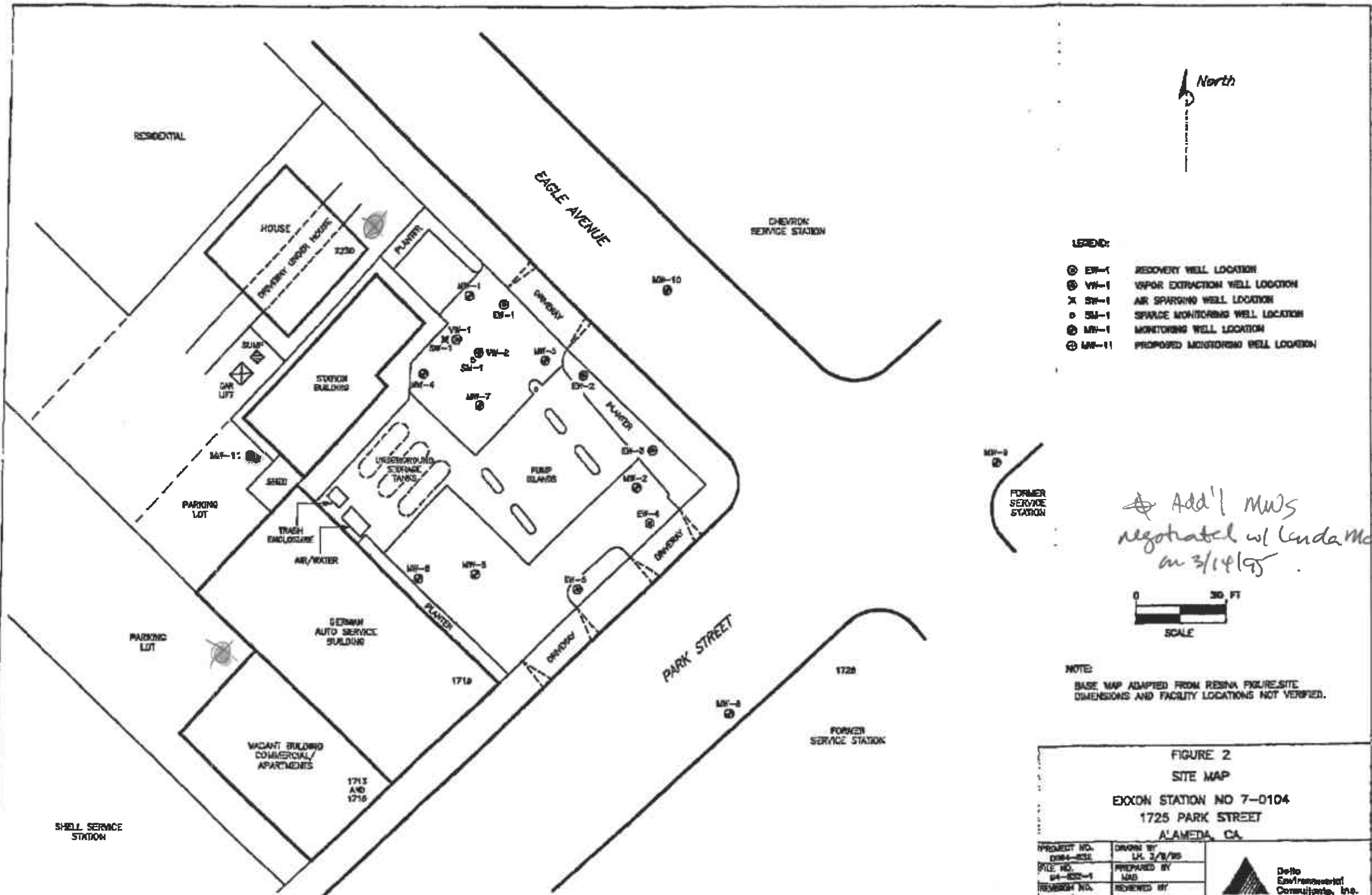

- LEGEND:**
- ⊙ MW-1 RECOVERY WELL LOCATION
 - ⊙ MW-2 VAPOR EXTRACTION WELL LOCATION
 - ⊙ MW-3 AIR SPARGING WELL LOCATION
 - ⊙ MW-4 SPACE MONITORING WELL LOCATION
 - ⊙ MW-5 MONITORING WELL LOCATION
 - ⊙ MW-6 PROPOSED MONITORING WELL LOCATION

*⊙ Add'l MWs
negotiated w/ Linda McG.
on 3/14/95*



NOTE:
BASE MAP ADAPTED FROM RESINA FIGURE SITE.
DIMENSIONS AND FACILITY LOCATIONS NOT VERIFIED.

**FIGURE 2
SITE MAP
EXXON STATION NO 7-0104
1725 PARK STREET
ALAMEDA, CA**

| | |
|-------------------------|-----------------------|
| PROJECT NO. 0284-032 | DRAWN BY LH 3/8/95 |
| DRAWING NO. 04-032-1 | PREPARED BY LMS |
| REVISION NO. | REVIEWED BY |



**Delta
Environmental
Consultants, Inc.**

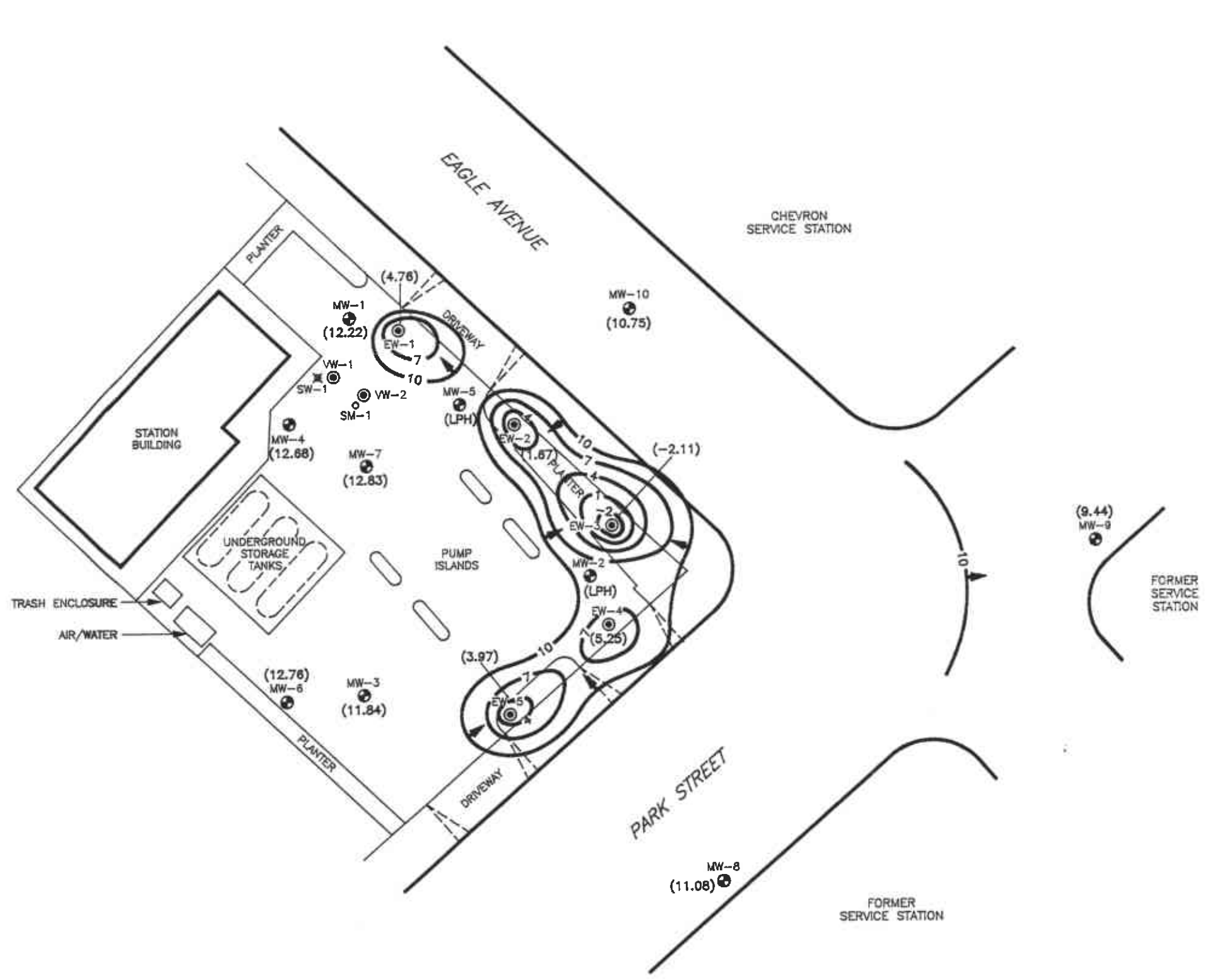

- LEGEND:**
- ⊙ EW-1 RECOVERY WELL LOCATION
 - ⊙ VW-1 VAPOR EXTRACTION WELL LOCATION
 - ⊗ SW-1 AIR SPARGING WELL LOCATION
 - SM-1 SPARGE MONITORING WELL LOCATION
 - ⊕ MW-1 MONITORING WELL LOCATION
 - (12.22) GROUND WATER ELEVATION IN FEET ABOVE MEAN SEA LEVEL (MSL)
 - 10 - WATER TABLE CONTOUR IN FEET ABOVE MSL
 - ➔ GROUND WATER FLOW DIRECTION
 - (LPH) LIQUID PHASE HYDROCARBONS

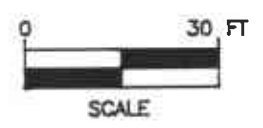

NOTE:
BASE MAP ADAPTED FROM RESNA FIGURE SITE
DIMENSIONS AND FACILITY LOCATIONS NOT VERIFIED.

FIGURE 3
WATER TABLE CONTOUR MAP - 1/13/95
EXXON STATION NO 7-0104
1725 PARK STREET
ALAMEDA, CA.

| | |
|-------------------------|-----------------------------------|
| PROJECT NO. 0094-832 | DRAWN BY I.H. 2/16/95 |
| FILE NO. 94-832-1 | PREPARED BY WLB |
| REVISION NO. 2 | REVIEWED BY <i>[Signature]</i> |

**Delta
Environmental
Consultants, Inc.**

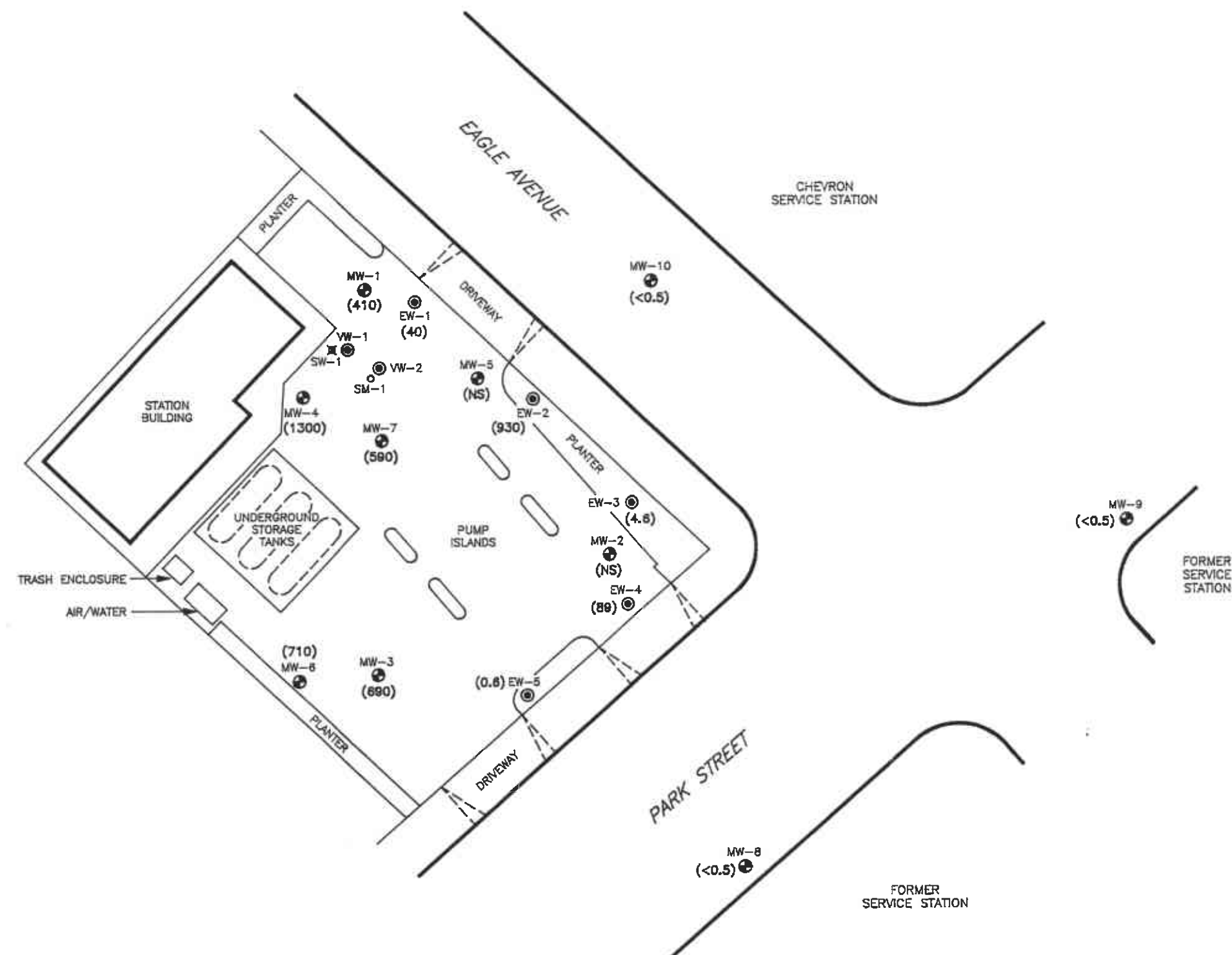

- LEGEND:**
- ⊙ EW-1 RECOVERY WELL LOCATION
 - ⊙ VW-1 VAPOR EXTRACTION WELL LOCATION
 - ⊗ SW-1 AIR SPARGING WELL LOCATION
 - SM-1 SPARGE MONITORING WELL LOCATION
 - MW-1 MONITORING WELL LOCATION
 - (410) DISSOLVED BENZENE CONCENTRATION IN GROUND WATER IN MICROGRAMS PER LITER
 - (NS) NOT SAMPLED

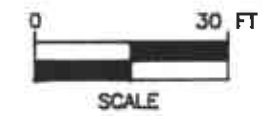

NOTE:
 BASE MAP ADAPTED FROM RESNA FIGURE SITE DIMENSIONS AND FACILITY LOCATIONS NOT VERIFIED.

FIGURE 4
DISSOLVED BENZENE CONCENTRATION MAP
 1/13/95
 EXXON STATION NO 7-0104
 1725 PARK STREET
 ALAMEDA, CA.

| | | |
|-------------------------|-----------------------------------|--|
| PROJECT NO. 0094-832 | DRAWN BY L.H. 1/30/95 | Delta Environmental Consultants, Inc. |
| FILE NO. 94-832-1 | PREPARED BY WLB | |
| REVISION NO. 1 | REVIEWED BY <i>[Signature]</i> | |