



SITE LOCATIONS

ALAMEDA

SAN LEANDRO

GROUNDWATER FLOW (APPROX.)

EXXON

#7-0104

CAVANAUGH MOTORS

GOOD CHEVROLET

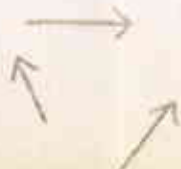

Exxon #7-0104
 1725 Park Street

MILES



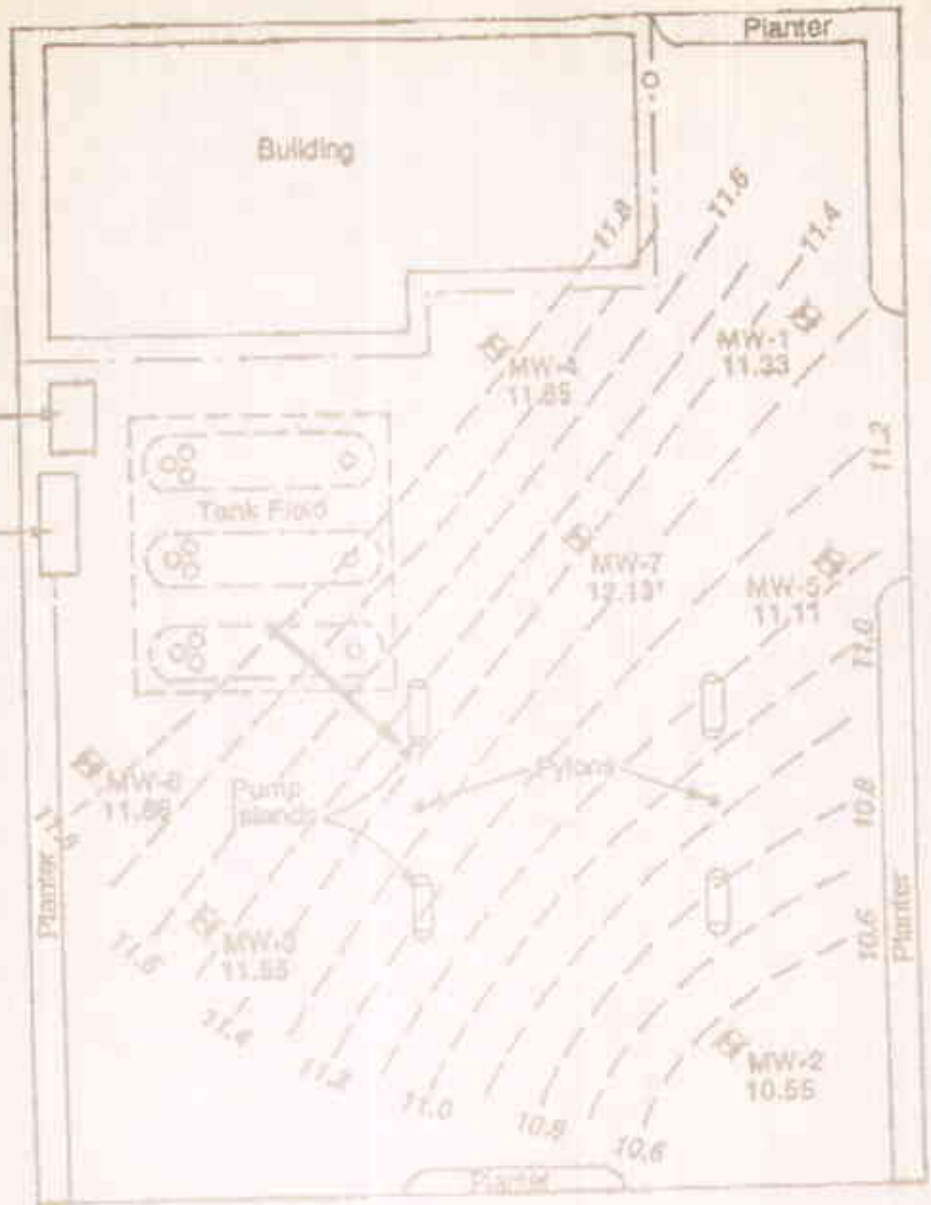

EXPLANATION

- ◆ Monitoring Well Location
- 11.55 Potentiometric Surface Elevation in Feet Above Mean Sea Level
- 11.6 Potentiometric Surface Elevation Contour
- Approximate Direction of Local Ground-Water Flow
- * Elevation not used for contouring (see text)

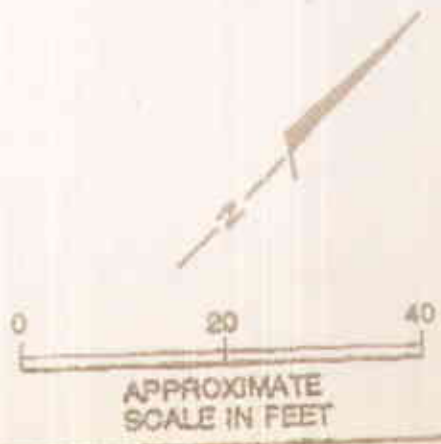

Harding Lawson Associates
Engineering and
Environmental Services

Generalized Potentiometric Surface
Contour Map - February 13, 1990
Phase III Evaluation of Petroleum Hydrocarbons
Exxon Station #7-0104
Alameda, California

PLATE
3

JOB NUMBER
4167.309.02

APPROVED
[Signature]

DATE
3/90

REVISED

DATE

APPENDIX A

APPENDIX B

APPENDIX C

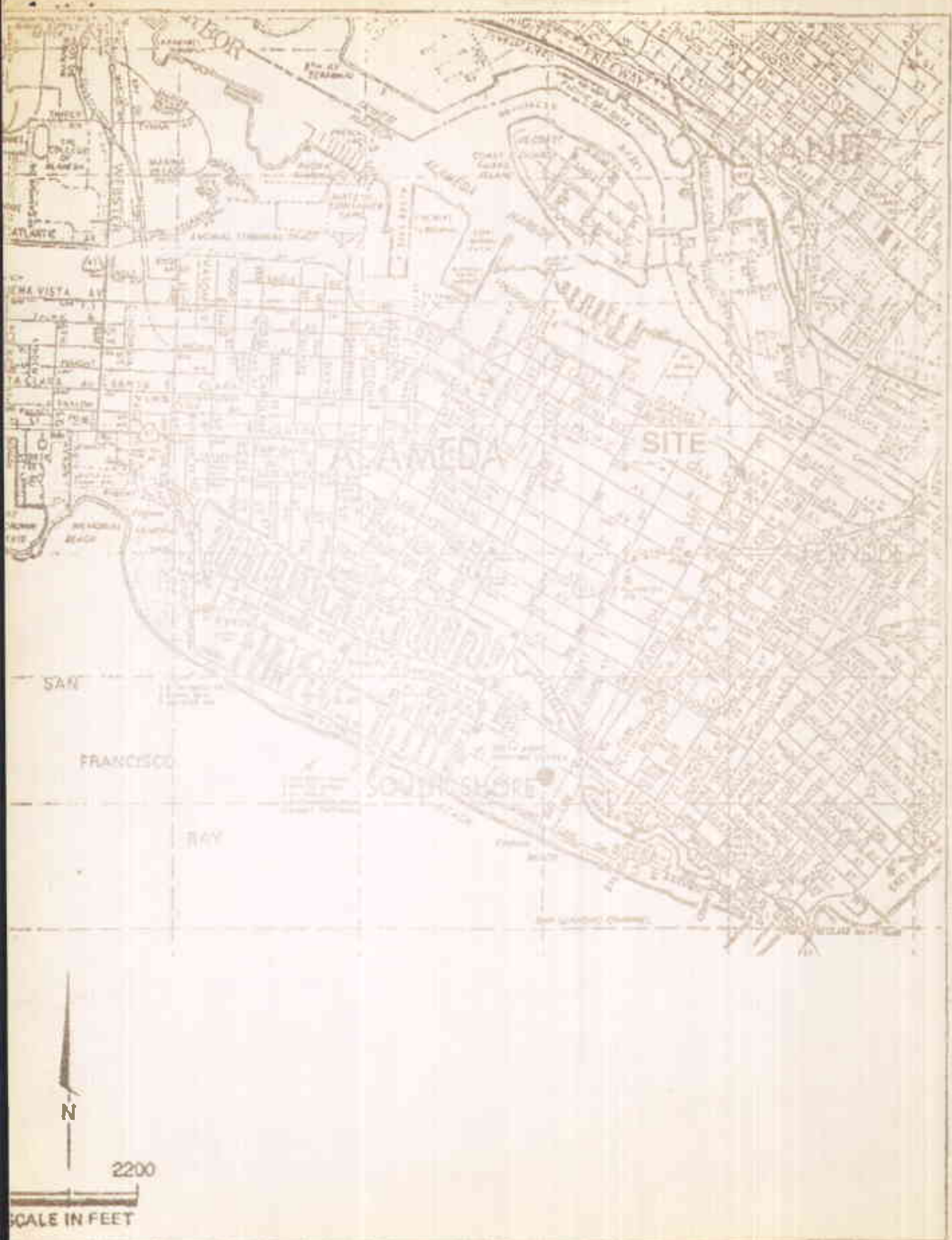

APPENDIX A

Harding Lawson Associates
Engineering and
Environmental Services

Area Map
Phase III Evaluation of Petroleum Hydrocarbons
Exxon Station #7-0104
Alameda, California

PLATE
1

JON HAMBY
4167,308.02

APPROVED

DATE
3/90

REVISED

DATE