



**CONESTOGA-ROVERS
& ASSOCIATES**

5900 Hollis Street, Suite A
Emeryville, California 94608
Telephone: (510) 420-0700 Fax: (510) 420-9170
www.CRAworld.com

TRANSMITTAL

DATE: May 22, 2009 REFERENCE NO.: 633100

TO: Mr. Steven Plunkett PROJECT NAME: 1750 Adams Avenue, San Leandro

Hazardous Materials Specialist
Alameda County Environmental Health Services
(ACEHS)
1131 Harbor Bay Parkway, Suite 250
Alameda, California 94502-6577

RECEIVED

10:46 am, Jun 03, 2009

Alameda County
Environmental Health

Please find enclosed: Draft Final
 Originals Other
 Prints

Sent via: Mail Same Day Courier
 Overnight Courier Other Geotracker and Alameda County FTP

QUANTITY	DESCRIPTION
1	Site Conceptual Model

As Requested For Review and Comment
 For Your Use

COMMENTS:
If you have any questions regarding the contents of this document, please contact Robert Foss at (510) 420-3348.

Copy to: Mr. Bruce Hickman,
Hart & Hickman, PC
Ms. Angela Maidment,
Estes Express Lines

Completed by: Robert C. Foss Signed: Robert C. Foss
[Please Print]

Filing: Correspondence File



SITE CONCEPTUAL MODEL

**FORMER GI TRUCKING COMPANY (ESTES EXPRESS LINES)
1750 ADAMS AVENUE
SAN LEANDRO, CALIFORNIA**

AGENCY CASE NO. RO00000442

MAY 5, 2009

REF. NO. 631000 (1)

This report is printed on recycled paper.

**Prepared by:
Conestoga-Rovers
& Associates**

5900 Hollis Street, Suite A
Emeryville, California
U.S.A. 94608

Office: (510) 420-0700
Fax: (510) 420-9170

web: <http://www.CRAworld.com>

TABLE OF CONTENTS

	<u>Page</u>
1.0 INTRODUCTION	1
1.1 SITE BACKGROUND	1
1.2 PREVIOUS INVESTIGATIONS	1
2.0 SITE CHARACTERIZATION	4
2.1 REGIONAL AND LOCAL GEOLOGY	4
2.2 REGIONAL AND LOCAL HYDROGEOLOGY	4
2.3 SOIL HYDROCARBON DISTRIBUTION	4
2.4 GROUNDWATER HYDROCARBON DISTRIBUTION	5
2.5 NON-AQUEOUS PHASE LIQUID DISTRIBUTION	5
3.0 FIRST QUARTER 2009 GROUNDWATER MONITORING & SAMPLING	6
3.1 CURRENT QUARTER RESULTS	6
3.2 GROUNDWATER ACTIVITIES	6
4.0 HYDROCARBON SOURCE AND REMEDIATION STATUS	8
4.1 RELEASE SOURCE AND VOLUME	8
4.2 POLYNUCLEAR AROMATIC HYDROCARBONS (PAH/PNA)	8
4.3 STEPS TAKEN TO STOP RELEASE	9
5.0 WELL AND SENSITIVE RECEPTOR SURVEY	10
5.1 DESIGNATED BENEFICIAL GROUNDWATER USE	10
5.2 WELL AND SURFACE WATER SURVEY RESULTS	10
5.3 LIKELIHOOD OF IMPACT TO WELLS	11
5.4 PREFERENTIAL FLOW PATHWAYS	11
5.4.1 UTILITY SURVEY	11
5.5 LIKELIHOOD OF IMPACT TO UTILITY TRENCHES	13
6.0 RISK ASSESSMENT	15
6.1 POTENTIAL EXPOSURE ROUTES	15
6.2 SUMMARY OF ESL COMPARISON	16
7.0 DATA GAPS	17

LIST OF FIGURES
(Following Text)

FIGURE 1	VICINITY MAP
FIGURE 2	SITE PLAN
FIGURE 3	POTENTIOMETRIC MAP
FIGURE 4	WELL SURVEY MAP
FIGURE 5	CROSS SECTION A-A'

LIST OF TABLES
(Following Text)

TABLE 1	GROUNDWATER ANALYTICAL DATA
TABLE 2	CUMULATIVE SOIL ANALYTICAL DATA
TABLE 3	WELL CONSTRUCTION DETAILS
TABLE 4	WELL SURVEY DATA

LIST OF APPENDICES

APPENDIX A	AGENCY CORRESPONDENCE
APPENDIX B	BORING/WELL LOGS
APPENDIX C	CERTIFIED ANALYTICAL REPORTS AND CHAIN-OF-CUSTODY DOCUMENTATION

1.0 INTRODUCTION

On behalf of Estes Express Lines, Inc. (Estes), Conestoga-Rovers & Associates (CRA) has prepared this Site Conceptual Model (SCM) for the site referenced above. This document was prepared in response to a letter request from the Alameda County Environmental Health Services Agency (ACEH). A copy of the ACEH's letter, dated January 22, 2009 is included as Appendix A.

The SCM provides a description of the site history, distribution of contaminants, and the relationship between the source area, transport pathways, and potential receptors. This SCM should be considered an initial draft document that will be updated and refined as new data becomes available.

1.1 SITE BACKGROUND

Site Description: The property is located on the southwest corner of the intersection of Adams Avenue and Bigge Street, in a mixed commercial/industrial area of San Leandro, California (Figure 1). Development on the site consists of a warehouse building used for freight storage and loading, a maintenance shop and an office. A set of five underground storage tanks (USTs) (four 12,000-gallon diesel and one 800-gallon used oil) were once operated at the site and were removed and properly disposed of. The 800-gallon used oil UST was removed in December 1986 and the four remaining USTs were removed in June 1999. The surrounding properties consist of light industrial and commercial businesses, with residential development approximately 850 feet northeast of the site, in the cross-gradient direction.

Site Ownership and Leasing: The property is owned by Estes Terminals California LLC and operated by Estes Express Lines of Richmond, Virginia.

Current Site Use: The site is used as an operating freight storage and transfer facility.

1.2 PREVIOUS INVESTIGATIONS

Environmental activities have been conducted at this site since July 1986 and are summarized below. Due to the transfer of property ownership, the current property owner was not able to provide copies of all previous reports. Therefore, although a review ACEH files were completed, CRA was unable to locate all the previous reports from the client and during a file review at ACEH. Present groundwater analytical data

are presented in Table 1. Available soil analytical data are presented in Table 2. Boring/well construction logs for wells MW-1/RW-1, MW-2, MW-3, MW-4 and RW-2 are presented as Appendix B. Figure 2 illustrates the former tankpit, excavation limits and well locations.

1986 Used-Oil UST Removal and Monitoring Well Installation: On July 29, 1986, Blymyer Engineers, Inc. (Blymyer) attempted a tank tightness test on the five USTs at the site. The 800-gallon fiberglass used-oil UST would not maintain a constant product level. On September 29, 1986 Xerxes Fiberglass Inc, the UST manufacturer, inspected the tank and determined that the bottom had ruptured and could not be repaired. On December 4, 1986, the used-oil UST was removed from the site and light non-aqueous phase liquid (LNAPL) and petroleum hydrocarbon saturated soil were observed in the excavation area. Approximately 45 cubic yards of petroleum hydrocarbon impacted soil was excavated and disposed of at a Class 1 disposal facility. LNAPL and groundwater were purged from the excavation multiple times until only a sheen of petroleum hydrocarbons was observed. No estimates of the amount of LNAPL or groundwater were provided. Due to the discovery of the petroleum hydrocarbon impact, recovery well MW-1/RW-1 and monitoring wells MW-2 through MW-5 were installed around the UST cavity. Waste oil was detected (EPA Method 3550) in soil samples from borings MW-2 through MW-5 at concentrations ranging from 71 milligrams per kilogram (mg/kg) to 210 mg/kg. No petroleum hydrocarbons were detected in groundwater after the installation of wells MW-2 through MW-5.

1993 Passive Skimmer Installation: In October 1993, Blymyer installed a passive LNAPL recovery skimmer in well MW-1/RW-1.

1996 Recovery Well Installation: In June 1996, Blymyer installed recovery well RW-2 near the four existing 12,000-gallon diesel USTs. A passive LNAPL recovery skimmer was installed in well RW-2 to accelerate recovery of free phase diesel product. According to Blymyer, a second diesel release had occurred at the site from a leaking gasket in the diesel fuel pump. Blymyer estimated the volume of the release to be approximately 250-gallons of diesel. In November 1996, site personnel estimated the inventory loss as approximately 165-gallons. Since 1996, approximately 178-gallons of diesel have been recovered from the site.

1999 UST Removal: In June 1999, Blymyer removed the four 12,000-gallon USTs from the site. Confirmation soil samples EX-1 through EX-10 were collected from the sidewalls of the excavation at the approximate soil-groundwater interface. During a period of several days LNAPL was pumped from the UST excavation, drummed onsite,

and properly disposed of. Due to elevated petroleum hydrocarbon concentrations detected in soil confirmation samples, the UST excavation was over-excavated by 2 linear feet in the northern and southern corners, and also along the southeastern and northeastern sidewalls. Over-excavation soil confirmation samples EX-11 through EX-15 were collected at the approximate soil-groundwater interface to verify remaining concentrations of petroleum hydrocarbons. Residual concentrations of total petroleum hydrocarbons as diesel (TPHd) in confirmation samples ranged from <1 to 2,400 mg/kg. Well MW-4 was destroyed as a result of the over-excavation. Approximately 427 tons of impacted soil was excavated and properly disposed of during these field activities.

Groundwater Monitoring and Sampling: Depth to water measurements and groundwater samples were collected from each of the wells quarterly since well installation in November 1988 through February 1996. These samples were analyzed for TPHd only through May 1993. Beginning in August 1993, the samples were also analyzed for benzene, toluene, ethylbenzene and xylenes (BTEX). In November 1994, samples collected from wells MW-2 and MW-3 were analyzed for TPH as gasoline (TPHg), and in February 1995 samples from these two wells were also analyzed for TPHg and TPH as motor oil (TPHmo). In August 1993, well MW-2 was also analyzed for MTBE. Beginning in August 1996, monitoring and sampling frequency was reduced to semi-annually through March 1999. Sampling then ceased until annual sampling occurred from 2002 through 2005. Another monitoring and sampling event occurred in March 2007. The most recent sampling event occurred on April 21, 2009. Semi-annual sampling had been requested by ACEH in the January 22, 2009 letter, and as a result, another event is scheduled to occur in October 2009.

2.0 SITE CHARACTERIZATION

2.1 REGIONAL AND LOCAL GEOLOGY

The site is located in the San Francisco Bay region, a structural depression that is bounded by northwest trending mountains of the Coast Range geomorphic province of California. The regional geologic map indicates that Quaternary alluvium exists beneath the site. Soils encountered during previous subsurface investigations were silty clay, sandy clay, sandy silt, clayey sand, and silty sand to the maximum explored depth of 26.5 feet below grade (fbg).

2.2 REGIONAL AND LOCAL HYDROGEOLOGY

The site resides within the East Bay Plain Groundwater Sub-Basin. The California Regional Water Quality Control Board - San Francisco Bay Region (RWQCB) has designated groundwater within this basin suitable for municipal and domestic water supply. The regional site topography gradually slopes west towards the San Francisco Bay, located approximately 1 mile southwest of the site. San Leandro Creek is located approximately 800 feet north and 1,500 feet east of the site and flows toward the northwest into San Leandro Bay, which is located approximately 1 mile northwest of the site.

Groundwater has been, more or less, regularly monitored and sampled at the site since 1988. Groundwater flows consistently towards the east to southeast at a gradient ranging between approximately 0.02 and 0.125. Calculated from the April 2009 monitoring and sampling event, groundwater flows toward the southeast at a gradient of 0.03 (Figure 3). The depth to groundwater has historically ranged from approximately 3.18 to 9.46 fbg. Historical groundwater level measurements are summarized in Table 1. Well construction details are included as Table 3.

2.3 SOIL HYDROCARBON DISTRIBUTION

Due to the shallow water table, soil samples were collected during excavation sampling at depths of 5 to 6 fbg. Soil samples collected during soil boring/well installation were collected at 4 and 8 fbg. Petroleum hydrocarbons were detected in 7 of 10 samples collected from the sidewalls of the UST tankpit in June 1999. The primary compound observed was diesel, ranging from <1.0 to 4,500 mg/kg. The samples were also analyzed for TPHg, BTEX and MTBE. TPHg was observed at concentrations ranging

from <1.0 to 390 mg/kg. Only very minor BTEX and no MTBE were reported. Overexcavation samples were analyzed for TPHd, BTEX and MTBE, with results showing TPHd ranging from 620 to 2,400 mg/kg, less BTEX than previously and no MTBE. Soil samples collected during soil boring/well installation were analyzed only for oil and grease. Due to the shallow water table and fine grained nature of subsurface sediments, it is anticipated that minimal additional hydrocarbon impacts exist below 10 fbg, the maximum soil depth analyzed. The lateral and vertical extent of petroleum hydrocarbons in soil appears to be adequately defined. However, ACEH has requested additional site characterization to confirm this. Soil analytical data are presented in Table 2.

2.4 GROUNDWATER HYDROCARBON DISTRIBUTION

The highest historical petroleum hydrocarbon concentrations detected in groundwater were 9,300 micrograms per liter ($\mu\text{g}/\text{l}$) TPHmo (RW-1), 280,000 $\mu\text{g}/\text{l}$ TPHd (RW-2) and 17 $\mu\text{g}/\text{l}$ MTBE (MW-3). Currently, no detected concentrations of petroleum hydrocarbons are present in groundwater at the site, except in wells RW-1 and RW-2 where only TPHmo and TPHd appear to be of concern. TPHg was reported in well RW-1 at 160 $\mu\text{g}/\text{l}$, but the laboratory notation suggests that the gasoline range chromatogram may be the lighter end of diesel, rather than actual gasoline. As requested by ACEH, groundwater samples were analyzed for naphthalene. No naphthalene was reported above the detection limit of 0.5 $\mu\text{g}/\text{l}$ in any site well. The current network of wells defines the horizontal extent of dissolved petroleum hydrocarbons in all directions, except upgradient where MW-4 was located (Figure 3). Groundwater analytical data are presented on Table 1.

2.5 NON-AQUEOUS PHASE LIQUID DISTRIBUTION

During the 1986 waste oil UST removal, LNAPL was observed in the excavation pit. This prompted the installation of recovery well RW-1 in the excavation and a skimmer was placed in the well for LNAPL recovery. LNAPL had been observed in RW-1 since its installation in 1986, with a maximum thickness of 0.35 ft during the Third Quarter 1996. This has decreased to a sheen or no measurable accumulations of LNAPL since the August 1996 observation referenced above. On June 6, 1996, 4-inch diameter recovery well RW-2 was installed in the tank excavation and a skimmer was placed in the well for LNAPL recovery. LNAPL was observed in RW-2 at an initial thickness of 0.31 ft in the Third Quarter 1996. No LNAPL has been seen in well RW-2 since this initial observation. LNAPL data are available in Table 1.

3.0 FIRST QUARTER 2009 GROUNDWATER MONITORING & SAMPLING

On April 21, 2009, wells MW-2, MW-3, MW-5, RW-1 and RW-2 were monitored and sampled. The wells were purged of an appropriate volume prior to sampling and parameters were checked for stabilization to insure a representative sample.

3.1 CURRENT QUARTER RESULTS

Groundwater Flow Direction	Southeast
Hydraulic Gradient	0.03
Average Depth to Water	6.02 fbg
Is Free Product Present on Site	"Immiscible Sheen" reported

3.2 GROUNDWATER ACTIVITIES

Groundwater was encountered at depths between 5.65 (MW-5) and 6.38 (MW-2) feet below top of casing during this sampling event (Table 1). The groundwater gradient was calculated at 0.03 toward the southeast (Figure 3).

The laboratory analytical report is presented as Appendix C. This quarter, no TPHd or TPHmo were detected in any of the wells with the exception of RW-1 and RW-2. TPHd were reported at 6,000 and 50,000 µg/l in RW-2 and RW-1, respectively. TPHmo was reported at 3,000 and 23,000 µg/l in RW-2 and RW-1, respectively. No TPHg was detected above the laboratory reporting limit (also referred to as the practical quantitation limit (PQL)) of 50 µg/l in any well except RW-1 at 160 µg/l. No benzene, toluene, ethylbenzene, xylenes or naphthalene were detected in any of the wells. A lighter than water immiscible sheen was reported on samples from RW-1 and RW-2. However, with the reported analytic results, this sheen may be biologically derived as opposed to hydrocarbon derived.

The hydrocarbon plume appears to be contained within the former tankpit, as indicated by wells RW-1 and RW-2, and is delineated to the east (cross-gradient) by MW-5, to the southeast (downgradient) by MW-2, to the south (crossgradient) by MW-3 and to the west (upgradient) by former well MW-4. Well MW-4 was drilled and constructed in native material directly adjacent to the tankpit and was destroyed during the 1999 UST

removal and overexcavation. Despite its close proximity to the tankpit, records indicate that no hydrocarbons were detected in either soil samples or groundwater from the time of its first sampling in 1988 up to its destruction in 1999.

4.0 HYDROCARBON SOURCE AND REMEDIATION STATUS

The primary chemical of concern (COC) at the site is TPHd. The ACEH has requested analysis for naphthalene, resulting from elevated detection limits reported in the UST soil sample analyses laboratory report.

4.1 RELEASE SOURCE AND VOLUME

The onsite petroleum hydrocarbon source has been defined as the former UST tankpit. The location of the former tanks is illustrated on Figure 2. The former USTs were located just west (northwest) of the maintenance building, with the edge of the tankpit approximately 12 feet from the building. Blymyer Engineers, Inc., reported two separate releases at the site. One release, from the former used oil UST was reported in September 1986, resulting from a failed tank tightness test. The other release was reported by Blymyer in their July 1996 report titled, *Installation of Recovery Well RW-2*. Blymyer's report stated that during the April 1987 retesting of the diesel USTs, site personnel reported that a diesel dispenser had been knocked over which may have caused damage to subsurface product piping. No time frame as to when this occurred was stated in the report. It has been estimated that up to 250 gallons may have been released, although there are no solid data to back that up. Soil samples collected from wells installed around the perimeter of the tankpit suggest that hydrocarbons are isolated to, or remain in close proximity of, the tankpit.

4.2 POLYNUCLEAR AROMATIC HYDROCARBONS (PAH/PNA)

Two of the soil samples collected during the UST removal confirmation sampling were analyzed by EPA Method 8270. The laboratory report states that these two samples were diluted due to a high organic content, thereby raising the detection limits of the analysis. ACEH has referred to a naphthalene ESL of 1.3 mg/kg for shallow soils where groundwater is or potentially a drinking water source. For these two samples, no compounds were reported above the detection limits of 20 mg/kg (EX-2) and 10 mg/kg (EX-10). The ACEH has requested further site characterization, specifically for naphthalene, as a result of these elevated detection limits for the 1999 sample analyses. Groundwater samples collected April 21, 2009 have shown no naphthalene present above the normal VOC detection limit of 0.5 µg/l. A workplan for the requested additional characterization will be submitted simultaneously with this document.

4.3 STEPS TAKEN TO STOP RELEASE

A passive LNAPL recovery skimmer was installed in well RW-1 in 1993 and another in RW-2 in 1996 to accelerate recovery of diesel LNAPL. Previous reports had stated that since 1996, approximately 178-gallons of diesel have been recovered from the tankpit. However, groundwater monitoring data have not indicated a continuing presence of LNAPL after the August 1996 event. The USTs, underground piping and dispenser island were removed in 1986 (waste oil) and 1999 (diesel). Removal of the USTs, piping and impacted backfill material, along with the overexcavation of sidewall soils removed the primary source of the release; however, residual petroleum hydrocarbons continue to exist in soil around the perimeter of the former UST tankpit.

5.0 WELL AND SENSITIVE RECEPTOR SURVEY

5.1 DESIGNATED BENEFICIAL GROUNDWATER USE

The site lies within the East Bay Plain subbasin of the South Bay Groundwater Basin. Groundwater in this basin is designated beneficial for municipal and domestic supply, industrial process supply, industrial service water supply, and agricultural water supply.

5.2 WELL AND SURFACE WATER SURVEY RESULTS

In 2007, Cambria requested Well Completion Reports for all wells within a ½-mile radius of the site from the California State Department of Water Resources (DWR). In addition, Cambria requested a search of all wells within a ½-mile radius of the site from Alameda County Public Works Agency (ACPWA). The search identified a total of 80 wells located on 20 different sites. Figure 4 presents the locations of the 20 sites containing wells within the search radius. The 80 wells included 76 groundwater monitoring wells, two irrigation wells, one cathodic protection well, and one well of unknown use. The two irrigation wells are located 0.24 and 0.34 miles upgradient of the subject site. One well is screened from 25 to 305 feet below grade (fbg). No information regarding well construction is available for the other, except its total depth of 250 feet. The current use of these wells is unknown. The one well of unknown usage is actually located beyond the ½ mile radius, downgradient of the subject site. The one well identified as a cathodic protection well was constructed in the manner that constitutes appropriate well destruction methods by filling the borehole with grout, or in this case, concrete to the surface.

Historically, groundwater on the site has flowed toward the east and southeast. Site A through D (one unknown well, four monitoring wells, and one cathodic protection well) are located on the northeast side of San Leandro Creek and the site is located on the southwest side of the creek. San Leandro Creek, intermittently lined and unlined, likely acts as a hydrologic barrier between sites A through D and the site. Therefore, wells at sites A through D likely could not be impacted by the diesel plume onsite.

Sites H, I, J, L, and M (two irrigation wells and 13 monitoring wells) are located over 1,250 feet upgradient of the site. No petroleum hydrocarbons were ever detected in upgradient well MW-4 and the diesel plume onsite at its maximum extent likely never migrated offsite. Therefore, it is extremely unlikely that wells at these sites could ever be impacted by the diesel plume onsite.

For the purpose of this well survey and to be conservative, all wells located east, south, and southwest of the site are considered to be downgradient of the site, this includes sites E, F, G, K, and N through T. These 11 sites contain 59 monitoring wells and the majority of these sites are registered with the State as current or former leaking underground fuel tank (LUFT) sites. The closest downgradient monitoring wells are located at site K (10700 Bigge Avenue, San Leandro), which is approximately 0.19 miles (1,003 ft) east of the site. Site K is a former LUFT site that is now closed. Due to the distance between site K and the subject site, it is unlikely that any of the wells at K or any other downgradient site have been or are could become impacted by the onsite groundwater plume. Table 3 includes information obtained from the DWR and ACPWA well search pertaining to the 59 wells noted above.

5.3 LIKELIHOOD OF IMPACT TO WELLS

Based on the locations and distance of the wells, no wells were identified that are likely to be impacted by the limited hydrocarbon plume onsite.

5.4 PREFERENTIAL FLOW PATHWAYS

As documented below, the only utility trenches appearing capable of providing for preferential flow are the sanitary sewer and the storm drain trenches running parallel beneath Adams Avenue, more or less perpendicular to the historical flow direction of groundwater. However, as inferred by the fine-grained composition of subsurface sediments and the 90 ft distance to the closest trench (Figures 2 and 5), it is highly unlikely that groundwater has migrated to the point of intersecting either of these trenches.

5.4.1 UTILITY SURVEY

In 2007, Cambria completed a conduit study to assess whether utility trenches could be acting as potential preferential pathways for groundwater and petroleum hydrocarbon migration. To identify utilities in the site vicinity, Cambria marked the site and notified Underground Service Alert (USA). USA then notified all utility purveyors to mark out any utilities in the public right-of-way along the site perimeter, including Adams Avenue and Bigge Street. Next, Cambria retained OHJ Subsurface Utility Locator to perform a utility survey onsite and to verify USA markings along Adams Avenue and

Bigge Street. Additionally, Cambria obtained and reviewed maps from East Bay Municipal Utility District for water lines and from the City of San Leandro for sanitary sewer and storm drain lines to verify that all nearby utilities had been identified. Cambria was unable to obtain the depths of many of the utilities from the geophysical survey or utility maps. The locations of utility conduits in the vicinity of the site are identified in plan view on Figure 2. Figure 5 illustrates a geologic cross-section showing the locations of utility conduits downgradient of the former USTs beneath Adams Avenue.

Water Lines: A 12-inch diameter water main runs beneath Adams Avenue approximately 45 ft southeast of the site property boundary. This line trends northeast-southwest and runs perpendicular into the 12-inch water main running below Bigge Street. The Bigge Street water main is located approximately 36 ft northeast of the site property boundary and trends northwest-southeast. A water lateral enters the site at the warehouse building located northeast of the source area onsite. The maintenance building that is directly downgradient of the former USTs receives its water from a water lateral that originates from the warehouse building. In the San Francisco Bay Area, water lines are rarely buried deeper than 4 fbg.

Sewer Lines: An 8-inch sanitary sewer line is located beneath Adams Avenue approximately 22 ft southeast of the property boundary. The sewer line trends northeast-southwest and flows toward the southwest (Figure 2). Another 8-inch sanitary sewer line runs beneath Bigge Avenue, approximately 45 ft northeast of the property line and is indicated to flow into the line beneath Adams. No elevations for these sewer lines were provided by the City of San Leandro. Sewer lines are gravity fed and the flow has been identified southwest, below Adams Avenue. Since the property is located at the head of Adams Avenue, it is anticipated that the line passes by the property at a relatively shallow depth, probably less than 6 fbg.

Storm Drains: A 24-inch diameter storm drain begins just east of the intersection of Bigge Street and Adams Avenue, flowing northwesterly to the intersection. Beneath the intersection of Bigge and Adams, the line makes a 90 degree turn and flows southwesterly beneath Adams Avenue, approximately 10 ft southeast of the property line. The location of this line is illustrated on Figures 2 and 5. Onsite, a storm drain drop inlet catch basin is located approximately eight feet north of the UST excavation area. This catch basin drains towards Adams Avenue (east-southeast) and comes within 10 feet of well MW-5. Like sewer lines described above, storm drains are gravity fed and the flow of this line has also been identified as southwesterly, below Adams Avenue.

Since the property is located at the head of Adams Avenue, it is anticipated that the line passes by the property at a relatively shallow depth, again probably less than 6 fbg.

Gas, Communication and Electrical Lines: A trench containing gas and communication lines and possibly electrical lines exists beneath the southeast sidewalk of Adams Avenue. The utility trench runs parallel to the street and is approximately 56 feet southeast of the property line. Electrical and communication lines are located overhead and enter the site from a power drop located near the driveway along the northwestern side of Adams Avenue. From this power drop electrical and communication lines run northwest to a junction box onsite. From the onsite junction box a buried electrical line runs south-southwesterly, to the maintenance building. This buried line runs approximately 6 ft southeast (downgradient) of well MW-5. In the vicinity of the former USTs, an asphalt patch covers the trench of the former vent lines. Two other lines identified between the excavation and maintenance building are thought to be old electrical lines that provided power to the USTs and former dispenser island. These types of utilities are usually very shallow and generally their depths range between 2 and 5 fbg.

5.5 LIKELIHOOD OF IMPACT TO UTILITY TRENCHES

Historical depth to groundwater has ranged from approximately 3.18 to 9.46 fbg and flow direction has been calculated toward the southeast. The average depth to groundwater is approximately 5.7 fbg. An evaluation of concentration vs. distance, as observed between source area wells RW-1 and RW-2 and downgradient wells MW-2, MW-3 and MW-5, indicates that it is unlikely the diesel plume has ever migrated offsite. Therefore, it is unlikely that any offsite utilities have been impacted by the onsite diesel plume.

Onsite, only the former vent line trench, two inferred electrical lines, the electrical line to the building and the storm drain north of the UST excavation could possibly act as preferential pathways for LNAPL and groundwater migration. The former vent line trench and the two inferred electrical lines would likely be buried at approximately the same depth as the top of the USTs, estimated to have been approximately 3 fbg. Considering this, it is unlikely that any of these lines could act as preferential pathways.

The electrical line that powers the maintenance building is located downgradient of well MW-5 and the geophysical survey identified that this utility at its deepest was 5 fbg. The storm drain is located approximately eight feet north (crossgradient-upgradient) of the UST excavation and runs eastward past well MW-5 to a catch basin located in

Adams Avenue. This storm drain line has measured at approximately 4 fbg in the catch basin onsite. Petroleum hydrocarbons have been detected only once in wells MW-5 (61 µg/L TPHd). It is possible that both of these utilities have occasionally intercepted groundwater; however, due to the historical groundwater flow direction, low soil permeability and historical low to non-detected groundwater analyses outside the tankpit, it is unlikely that elevated dissolved-phase petroleum hydrocarbons and especially LNAPL have ever migrated along to or along these utilities.

6.0 RISK ASSESSMENT

To evaluate the potential health risk to onsite commercial occupants, hypothetical residents and future construction workers, CRA conducted a Tier 1 risk assessment following the guidelines outlined in the San Francisco Bay Region-RWQCB's Screening for Environmental Concerns at sites with Contaminated Soil and Groundwater, Interim Final November 2007 (revised May 2008) document. The RWQCB approach compares representative chemical concentrations to environmental screening levels (ESLs). The ESLs are used as screening levels in determining if further evaluation is warranted, in prioritizing areas of concern, in establishing initial cleanup goals, and in estimation of potential health risks. The presence of a chemical at concentrations in excess of an ESL does not necessarily indicate that adverse impacts to human health or the environment are occurring; this simply indicates that additional assessment may be warranted. Tables 1 and 2 present the RWQCB ESLs that were evaluated and the soil and groundwater analytical data collected at the site.

6.1 POTENTIAL EXPOSURE ROUTES

Groundwater: No offsite wells were identified that are likely to be impacted by the hydrocarbon plume onsite. However, as a conservative measure, CRA compared groundwater concentrations to ESLs established for groundwater that is a current or potential drinking water resource (ESL Table F-1A), presented on Table 1.

Soil: The entire source area on the site is capped with concrete and asphalt, and therefore no soil is exposed at the surface. However, as a conservative measure, CRA compared soil analytical data to residential (ESL Table K-1), commercial/industrial (ESL Table K-2), and construction/trench worker (ESL Table K-3) ESLs for direct exposure (Table 2). In addition, CRA compared vadose zone soil concentrations to soil leaching ESLs (ESL Table G) for groundwater that is a current or potential drinking water resource.

Indoor & Outdoor Soil Vapor Intrusion: The onsite maintenance building is adjacent to the source area, but not located directly over it. However, as a conservative measure, CRA evaluated volatilization of hydrocarbon vapors from groundwater and soil (ESL Tables E-1, E-2 and E-3) into indoor air for both residential and commercial/industrial exposure scenarios. Tables 1 and 2 present the soil and groundwater analytical data and ESLs comparison.

6.2 SUMMARY OF ESL COMPARISON

Soil: Petroleum hydrocarbon concentrations in soil exceed the RWQCB ESLs for potential vapor intrusion, leaching concerns and direct-exposure for residential, commercial/industrial and construction/trench worker.

Groundwater: Dissolved-phase petroleum hydrocarbons exceed the ESLs for groundwater that is a potential source of drinking water. No ESLs related to potential vapor intrusion concerns are exceeded by the dissolved-phase petroleum hydrocarbons concentrations.

However, it is CRA's intention to present an argument for a finding that groundwater in this specific vicinity should not be viewed as a potential source of drinking water and should be subject to less stringent cleanup standards. That argument will be submitted in a separate document.

7.0 DATA GAPS

Per the request of ACEHS, soil borings and grab groundwater samples will be collected downgradient of the former tankpit to investigate the possible migration of hydrocarbon impacts away from the source area. A workplan for further investigation will be submitted simultaneously with this SCM.

All of Which is Respectfully Submitted,
CONESTOGA-ROVERS & ASSOCIATES

Christine Orłowski

Christine Orłowski

Robert Foss

Robert Foss, PG #7445

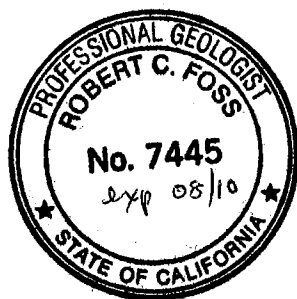

References

- Amherst, Inc., 1999: *File Report – February 8, 1999*, 1275 Montgomery Avenue, San Bruno, California.
- Amherst, Inc., 2000: *Phase I Environmental Site Assessment – June 2000*, 1275 Montgomery Avenue, San Bruno, California.
- Amherst, Inc., 2000: *Closure Report for Phase II Corporation - Plating and Etching Facility and Permit by Rule Wastewater Treatment Facility – September 15, 2000*, 1245 Montgomery Avenue, San Bruno, California.
- California Regional Water Quality Control Board, San Francisco Bay Region, 2005: *Screening for Environmental Concerns at Sites with Contaminated Soil and Groundwater – February 2005*.
- Cambria, 2004: *Site Assessment Report – October 7, 2004*, San Bruno Investment Co. Inc., 1245 Montgomery Avenue, San Bruno, California.
- Cambria, 2004: *Site Assessment Work Plan – February 3, 2005*, San Bruno Investment Co. Inc., 1245 Montgomery Avenue, San Bruno, California.
- Cambria, 2005: *Site Assessment Report – August 31, 2005*, San Bruno Investment Co. Inc., 1245 Montgomery Avenue, San Bruno, California.
- Department of Toxic Substances Control, California Environmental Protection Agency, 2005: *Guidance for the Evaluation and Mitigation of Subsurface Vapor Intrusion to Indoor Air – revised February 7, 2005*.
- Guidetti J.R. and Schaefer C.F., 1995: *Groundwater Investigation and Wellhead Protection Program for the Greater San Bruno Area*, San Mateo County Environmental Services Division, Redwood City, California.
- Interstate Technology & Regulatory Council (ITRC), 1999: *Natural Attenuation of Chlorinated Solvents in Groundwater: Principles and Practices – September 1999*.
- Interstate Technology & Regulatory Council (ITRC), 2003: *An Introduction to Characterizing Sites Contaminated with DNAPLs – September 2003*.
- Murphy, B.L. and Morrison, R.D., 2002: *Introduction to Environmental Forensics*. Academic Press, San Diego.
- New Jersey Department of Environmental Protection, 2005: *Vapor Intrusion Guidance – October 2005*.
- TEC Accutite, 2002: *Monitoring Well Installation Report – December 2002*, San Bruno Investment Co. Inc., 1245 Montgomery Avenue, San Bruno, California.
- TEC Accutite, 2002: *Subsurface Investigation – October 2002*, San Bruno Investment Co. Inc., 1245 Montgomery Avenue, San Bruno, California.

TEC Accutite, 2002: *Subsurface Investigation – March 2001*, San Bruno Investment Co. Inc.,
1245 Montgomery Avenue, San Bruno, California.

U.S. Environmental Protection Agency, 2003 – *User’s Guide for Evaluating Subsurface Vapor
Intrusion into Buildings – June 19, 2003.*

U.S. Environmental Protection Agency, 2005: *Uncertainty and the Johnson-Ettinger Model for Vapor
Intrusion Calculations – September 2005*

FIGURES

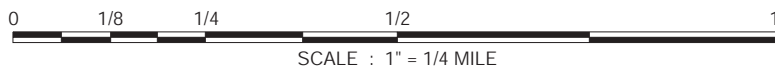
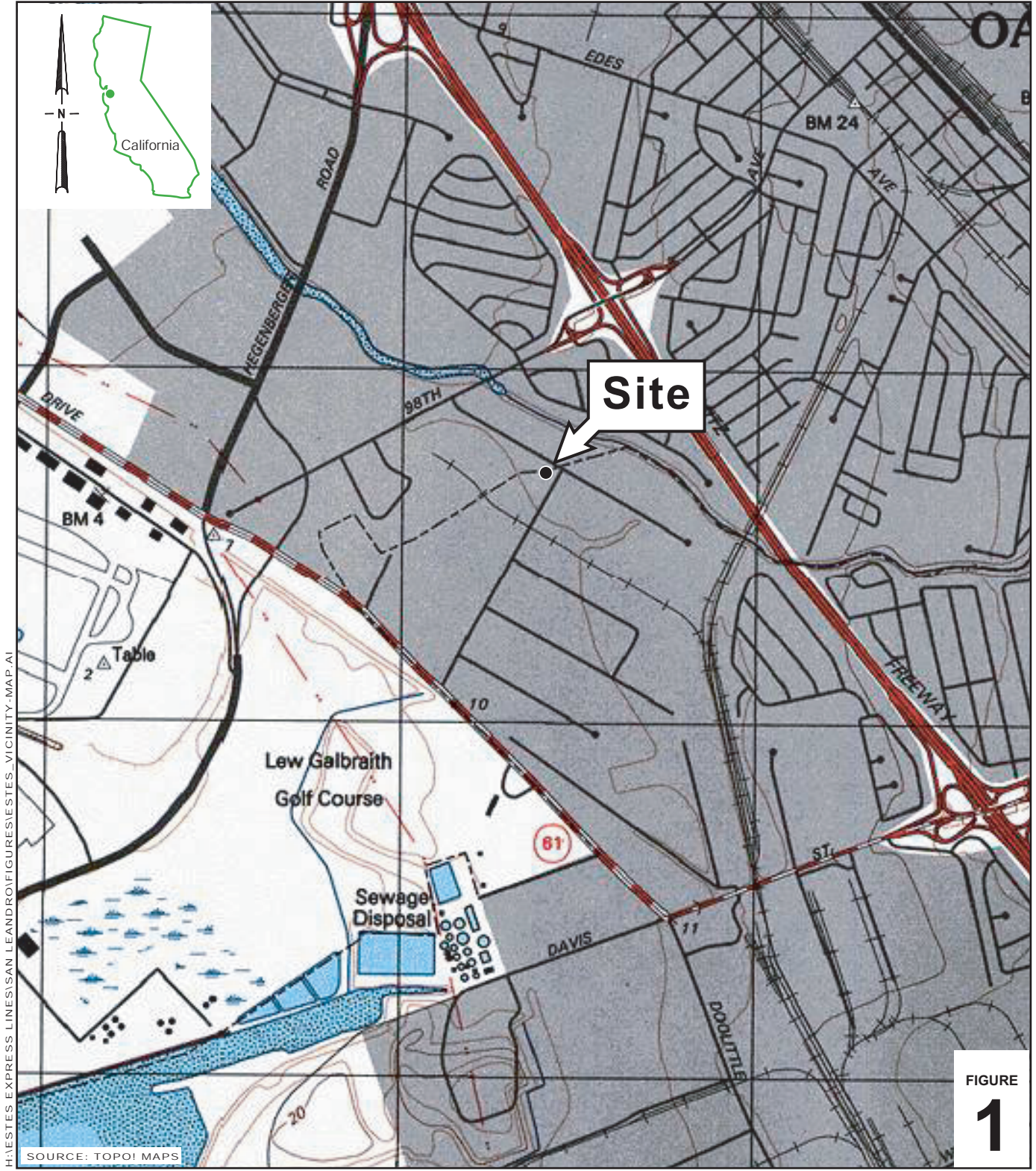

FIGURE
1

**Former GI Trucking Company
(Estes Express Lines)**

1750 Adams Avenue
San Leandro, California



**CONESTOGA-ROVERS
& ASSOCIATES**

Vicinity Map

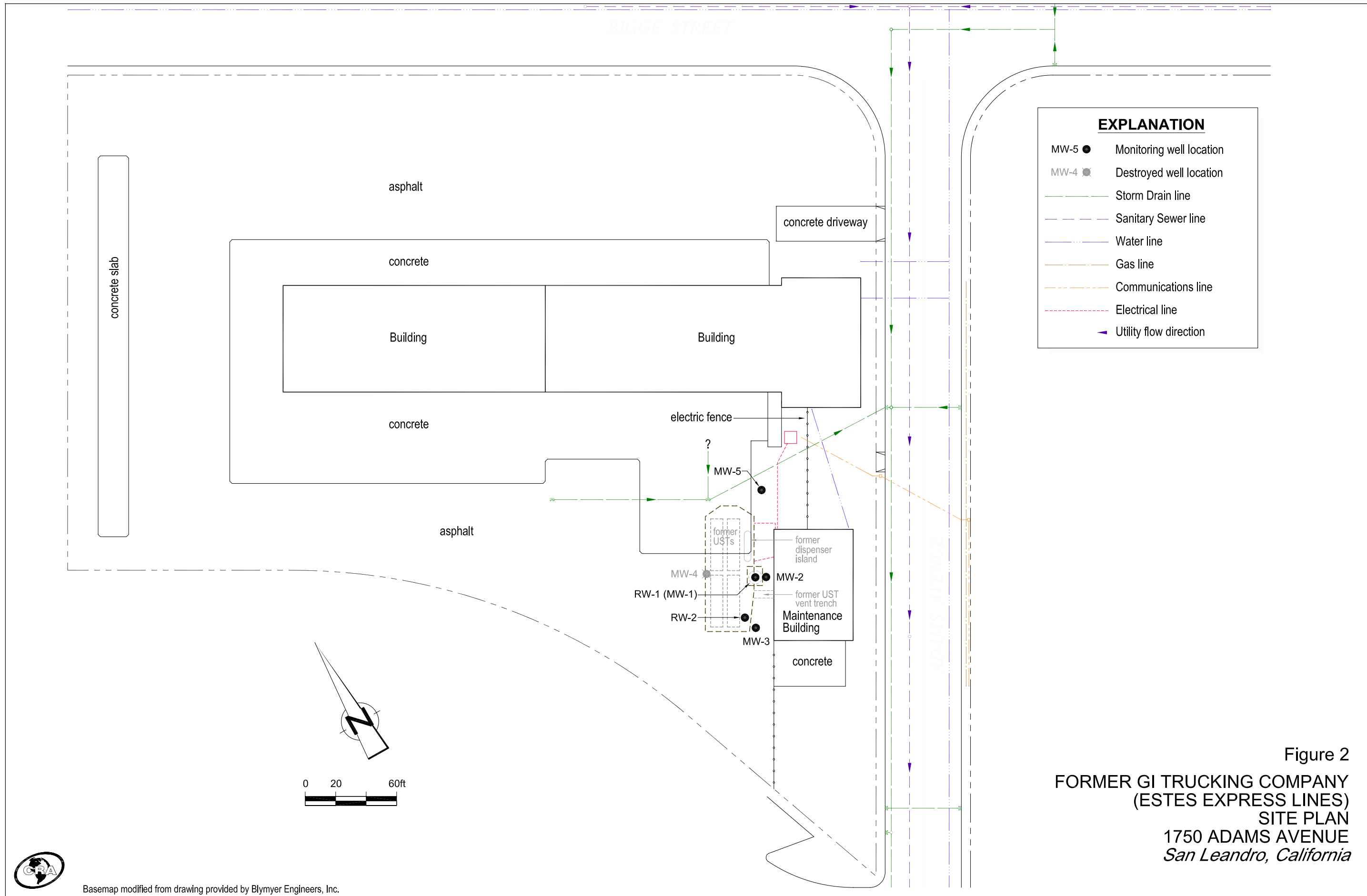

EXPLANATION	
MW-5 ●	Monitoring well location
MW-4 ●	Destroyed well location
—	Storm Drain line
—	Sanitary Sewer line
—	Water line
—	Gas line
—	Communications line
—	Electrical line
—	Utility flow direction

Figure 2
 FORMER GI TRUCKING COMPANY
 (ESTES EXPRESS LINES)
 SITE PLAN
 1750 ADAMS AVENUE
 San Leandro, California



Basemap modified from drawing provided by Blymyer Engineers, Inc.

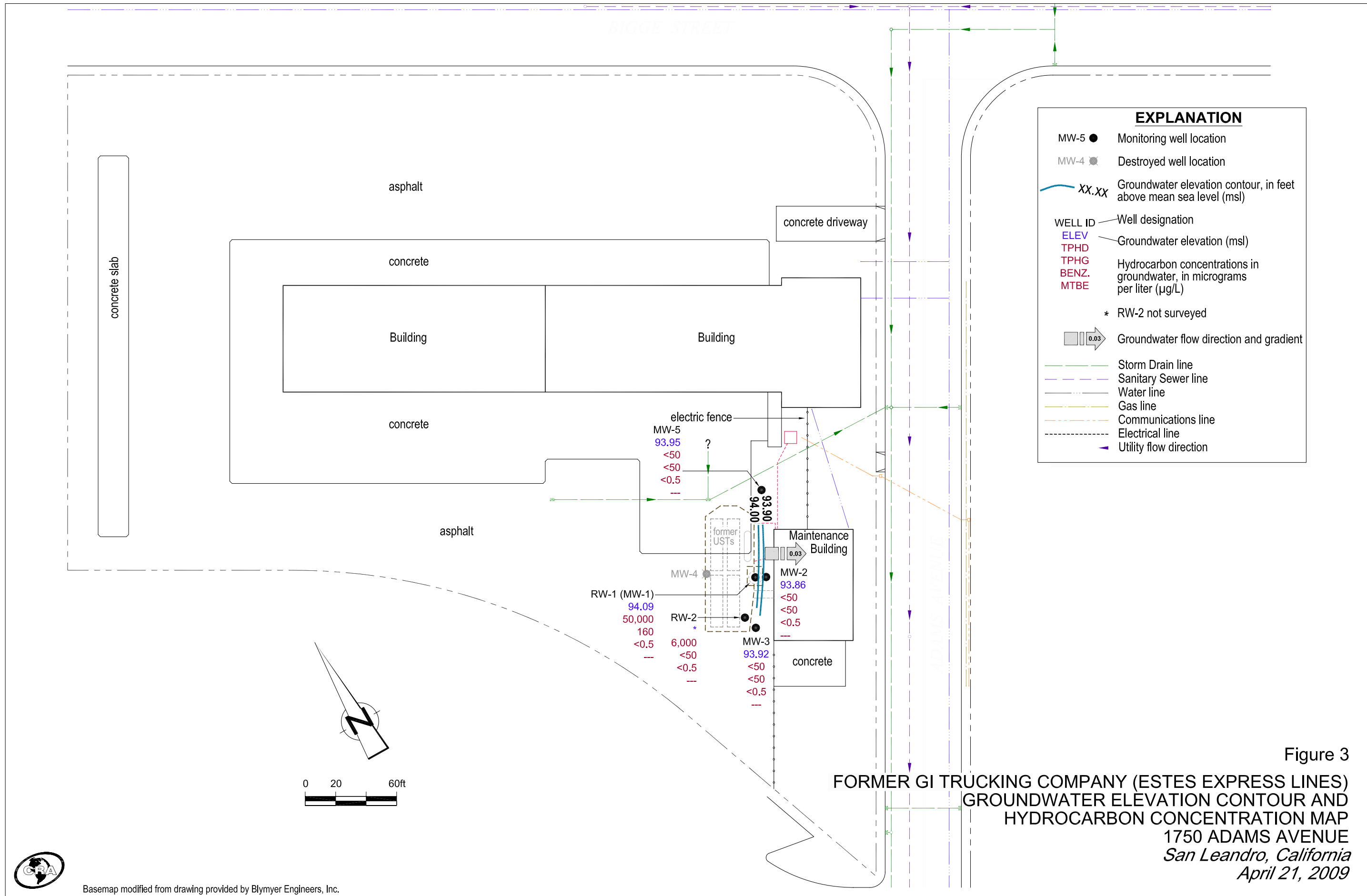
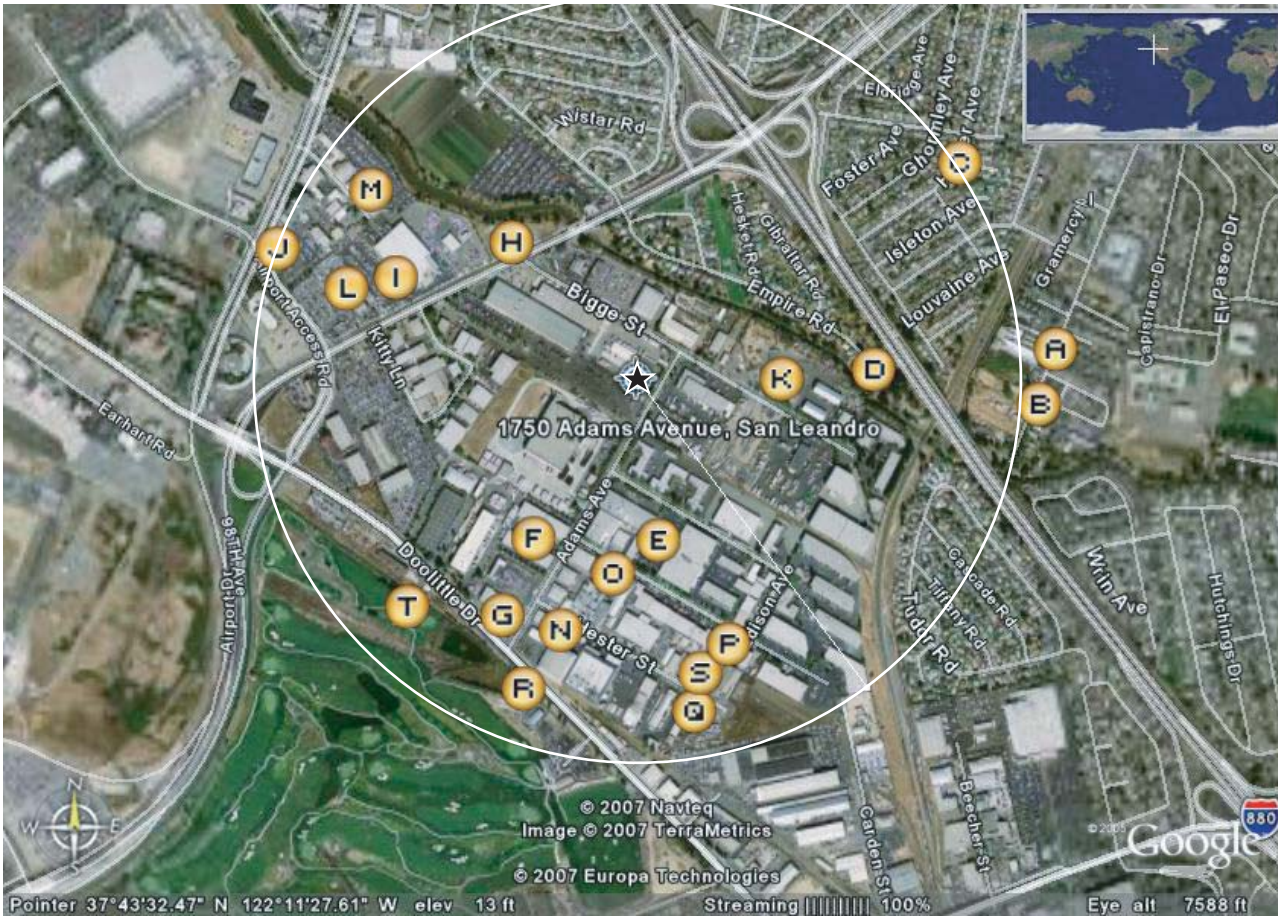
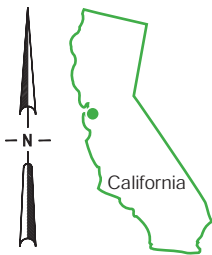

Figure 3



FORMER GI TRUCKING COMPANY (ESTES EXPRESS LINES)
 GROUNDWATER ELEVATION CONTOUR AND
 HYDROCARBON CONCENTRATION MAP
 1750 ADAMS AVENUE
 San Leandro, California
 April 21, 2009

Basemap modified from drawing provided by Blymyer Engineers, Inc.





EXPLANATION

-  Site containing well(s) refer to table 2 for detailed well information
-  Subject site
-  Study area

SOURCE: GOOGLE EARTH PRO

FIGURE

4



SCALE : 1" = 1/4 MILE

**Former GI Trucking Company
(Estes Express Lines)**

1750 Adams Avenue
San Leandro, California



**CONESTOGA-ROVERS
& ASSOCIATES**

Well Survey Map

1/2 Mile Search Radius

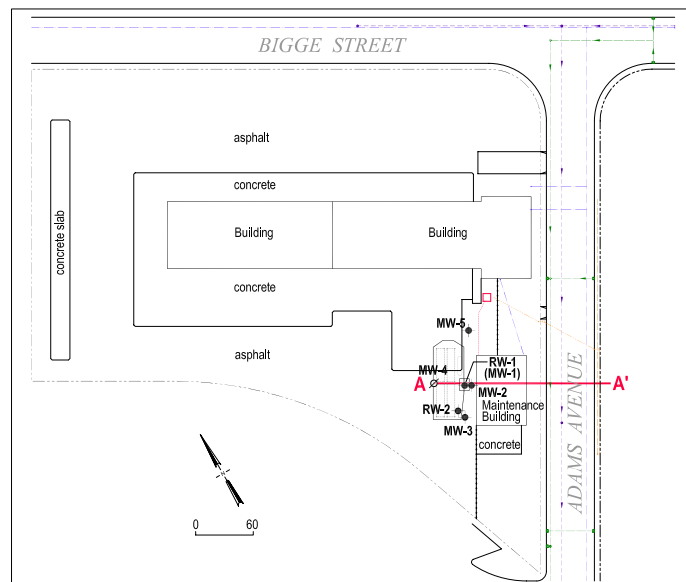
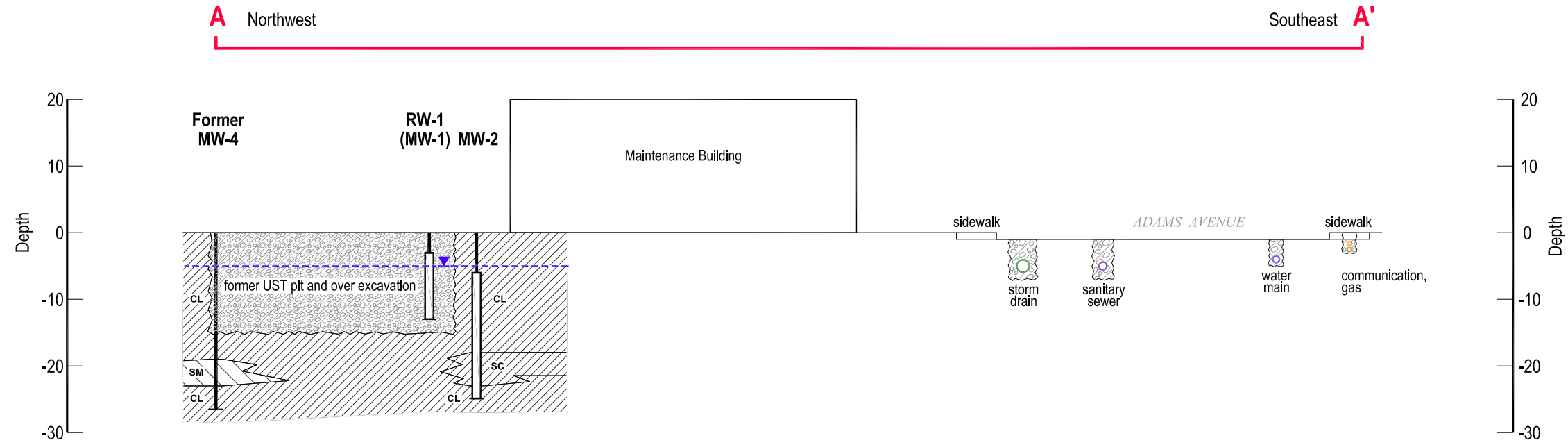

EXPLANATION

- = Low Permeability Soils
CL - Clay, Silty Clay, Sandy Clay
- = Moderate Permeability Soils
SM - Silty Sand
- = Fill (tank pit, utility trench)

Well ID — Well Designation

- Groundwater Monitoring Well
- Well Screen Interval
- Bottom of boring

Depth of Groundwater - 03/02/07

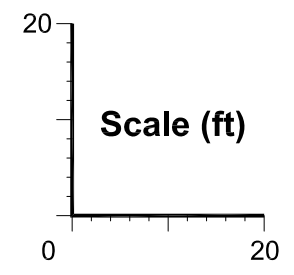

FIGURE
5

**Former GI Trucking Company
(Estes Express Lines)**

1750 Adams Avenue
San Leandro, California



**CONESTOGA-ROVERS
& ASSOCIATES**

Geologic Cross Section A-A'

TABLES

TABLE 1
GROUNDWATER ELEVATION AND ANALYTICAL DATA
ESTES-GI TRUCKING COMPANY
1750 ADAMS AVENUE, SAN LEANDRO, CALIFORNIA

Sample ID	Date	Depth to Water (ft btoc)	SPH Thickness (ft)	Groundwater Elevation (arbitrary)	TPHmo	TPHd	TPHg	Benzene	Toluene	Ethylbenzene	Xylenes	MTBE	ETBE	TAME	DIPE	TBA	1,2-DCA	EDB	Ethanol	Napthalene
TOC	Sampled	(ft btoc)	(ft)	(arbitrary)	Recorded in ug/L															
<i>Final Groundwater ESL (Table E-1), Potential Vapor Intrusion Concerns</i>																				
<i>Residential</i>					NE	use soil gas	540	380,000	170,000	160,000	24,000	NE	NE	NE	use soil gas	200	NE	NE	3,200	
<i>Commercial/Industrial</i>					NE	use soil gas	1,800	530,000	170,000	160,000	80,000	NE	NE	NE	use soil gas	690	NE	NE	11,000	
<i>Final Groundwater ESL (Table F-1), Groundwater is a Current or Potential Drinking Water Resource</i>																				
					100	100	100	1.0	40	30	20	5.0	NE	NE	NE	12	0.5	0.05	NE	17
MW-1	11/15/1988	--	0.22	--	--	--	--	--	--	--	--	--	--	--	--	--	--	--	--	--
100.00	2/16/1989	6.03	0.20	94.13	--	--	--	--	--	--	--	--	--	--	--	--	--	--	--	--
	5/19/1989	6.31	0.20	93.85	--	--	--	--	--	--	--	--	--	--	--	--	--	--	--	--
	8/22/1989	6.72	0.18	93.42	--	--	--	--	--	--	--	--	--	--	--	--	--	--	--	--
	11/21/1989	6.51	Sheen	93.49	--	--	--	--	--	--	--	--	--	--	--	--	--	--	--	--
	2/23/1990	5.74	Sheen	94.26	--	--	--	--	--	--	--	--	--	--	--	--	--	--	--	--
	5/23/1990	6.34	0.15	93.78	--	--	--	--	--	--	--	--	--	--	--	--	--	--	--	--
	8/27/1990	6.27	Sheen	93.73	--	--	--	--	--	--	--	--	--	--	--	--	--	--	--	--
	12/3/1990	6.49	Sheen	93.51	--	--	--	--	--	--	--	--	--	--	--	--	--	--	--	--
	3/13/1991	4.94	Sheen	95.06	--	--	--	--	--	--	--	--	--	--	--	--	--	--	--	--
	5/29/1991	9.46	Sheen	90.54	--	--	--	--	--	--	--	--	--	--	--	--	--	--	--	--
	8/28/1991	6.31	0.09	93.76	--	--	--	--	--	--	--	--	--	--	--	--	--	--	--	--
	12/9/1991	6.49	0.20	93.67	--	--	--	--	--	--	--	--	--	--	--	--	--	--	--	--
	2/18/1992	4.19	0.10	95.89	--	--	--	--	--	--	--	--	--	--	--	--	--	--	--	--
	5/15/1992	5.72	0.17	94.42	--	--	--	--	--	--	--	--	--	--	--	--	--	--	--	--
	8/13/1992	6.12	0.19	94.03	--	--	--	--	--	--	--	--	--	--	--	--	--	--	--	--
	12/3/1992	5.65	0.10	94.43	--	--	--	--	--	--	--	--	--	--	--	--	--	--	--	--
	3/25/1993	4.60	Sheen	95.40	--	--	--	--	--	--	--	--	--	--	--	--	--	--	--	--
	5/21/1993	5.56	0.09	94.51	--	--	--	--	--	--	--	--	--	--	--	--	--	--	--	--
	8/17/1993	6.07	0.13	94.03	--	--	--	--	--	--	--	--	--	--	--	--	--	--	--	--
	12/13/1993	--	Sheen	--	--	--	--	--	--	--	--	--	--	--	--	--	--	--	--	--
	2/24/1994	4.97	Sheen	95.63	--	--	--	--	--	--	--	--	--	--	--	--	--	--	--	--
	5/11/1994	5.20	Sheen	94.80	--	--	--	--	--	--	--	--	--	--	--	--	--	--	--	--
	8/23/1994	6.06	0.08	94.00	--	--	--	--	--	--	--	--	--	--	--	--	--	--	--	--
	11/29/1994	5.98	Sheen	94.02	--	--	--	--	--	--	--	--	--	--	--	--	--	--	--	--
	2/15/1995	4.93	Sheen	95.07	--	--	--	--	--	--	--	--	--	--	--	--	--	--	--	--
	5/18/1995	4.99	Sheen	95.01	--	--	--	--	--	--	--	--	--	--	--	--	--	--	--	--
	8/16/1995	6.46	Sheen	93.54	--	--	--	--	--	--	--	--	--	--	--	--	--	--	--	--
11/16/1995	5.21	Sheen	94.79	--	--	--	--	--	--	--	--	--	--	--	--	--	--	--	--	
2/15/1996	4.68	Sheen	95.32	--	--	--	--	--	--	--	--	--	--	--	--	--	--	--	--	
	July 1996	← Well MW-1 Reconstructed as well RW-1 →																		
	8/5/1996	6.05	0.35	94.23	--	--	--	--	--	--	--	--	--	--	--	--	--	--	--	
	2/6/1997	4.40	Sheen	95.60	--	--	--	--	--	--	--	--	--	--	--	--	--	--	--	
	8/22/1997	4.90	Sheen	95.10	--	--	--	--	--	--	--	--	--	--	--	--	--	--	--	
	2/12/1998	3.18	0.00	96.82	--	89,000	--	--	--	--	--	--	--	--	--	--	--	--	--	
	8/27/1998	5.95	Sheen	94.05	--	--	--	--	--	--	--	--	--	--	--	--	--	--	--	
	3/4/1999*	4.98	Sheen	95.02	--	--	--	--	--	--	--	--	--	--	--	--	--	--	--	
	5/30/2001	--	Sheen	--	--	--	--	--	--	--	--	--	--	--	--	--	--	--	--	
	6/18/2002	6.28	0.00	93.72	--	--	--	--	--	--	--	--	--	--	--	--	--	--	--	
	3/13/2003	6.15	0.00	93.85	--	--	--	--	--	--	--	--	--	--	--	--	--	--	--	
	3/17/2004	5.60	0.00	94.40	--	--	--	--	--	--	--	--	--	--	--	--	--	--	--	
RW-1	3/17/2005	5.39	0.00	94.61	--	--	--	--	--	--	--	--	--	--	--	--	--	--	--	

TABLE 1
GROUNDWATER ELEVATION AND ANALYTICAL DATA
ESTES-GI TRUCKING COMPANY
1750 ADAMS AVENUE, SAN LEANDRO, CALIFORNIA

Sample ID	Date	Depth to Water (ft btoc)	SPH Thickness (ft)	Groundwater Elevation (arbitrary)	TPHmo	TPHd	TPHg	Benzene	Toluene	Ethylbenzene	Xylenes	MTBE	ETBE	TAME	DIPE	TBA	1,2-DCA	EDB	Ethanol	Napthalene
TOC	Sampled				←								Recorded in ug/L							→
<i>Final Groundwater ESL (Table E-1), Potential Vapor Intrusion Concerns</i>																				
<i>Residential</i>					NE	use soil gas	540	380,000	170,000	160,000	24,000	NE	NE	NE	use soil gas	200	NE	NE	3,200	
<i>Commercial/Industrial</i>					NE	use soil gas	1,800	530,000	170,000	160,000	80,000	NE	NE	NE	use soil gas	690	NE	NE	11,000	
<i>Final Groundwater ESL (Table F-1), Groundwater is a Current or Potential Drinking Water Resource</i>																				
					100	100	100	1.0	40	30	20	5.0	NE	NE	NE	12	0.5	0.05	NE	17
100.00	3/2/2007	5.22	Sheen	94.78	9,300	16,000 c	140 g	<0.5	<0.5	<0.5	<0.5	<0.5	<0.5	<0.5	<0.5	<5.0	<0.5	<0.5	<50	--
	4/21/2009	5.91	Sheen	94.09	23,000	50,000 c, d	160 b, d	<0.5	<0.5	<0.5	<0.5	--	--	--	--	--	--	--	--	<0.5 d
MW-2	11/15/1988	--	--	--	--	<200	--	--	--	--	--	--	--	--	--	--	--	--	--	--
100.24	2/16/1989	6.13	0.00	94.11	--	<90	--	--	--	--	--	--	--	--	--	--	--	--	--	--
	5/19/1989	6.24	0.00	94.00	--	<80	--	--	--	--	--	--	--	--	--	--	--	--	--	--
	8/22/1989	6.68	0.00	93.56	--	<30	--	--	--	--	--	--	--	--	--	--	--	--	--	--
	11/21/1989	6.64	0.00	93.60	--	<30	--	--	--	--	--	--	--	--	--	--	--	--	--	--
	2/23/1990	6.04	0.00	94.20	--	<50	--	--	--	--	--	--	--	--	--	--	--	--	--	--
	5/23/1990	6.40	0.00	93.84	--	<50	--	--	--	--	--	--	--	--	--	--	--	--	--	--
	8/27/1990	6.70	0.00	93.54	--	<50	--	--	--	--	--	--	--	--	--	--	--	--	--	--
	12/3/1990	6.83	0.00	93.41	--	<50	--	--	--	--	--	--	--	--	--	--	--	--	--	--
	3/13/1991	5.64	0.00	94.60	--	<50	--	--	--	--	--	--	--	--	--	--	--	--	--	--
	5/29/1991	6.31	0.00	93.93	--	<50	--	--	--	--	--	--	--	--	--	--	--	--	--	--
	8/28/1991	6.68	0.00	93.56	--	<50	--	--	--	--	--	--	--	--	--	--	--	--	--	--
	12/9/1991	6.69	0.00	93.55	--	<50	--	--	--	--	--	--	--	--	--	--	--	--	--	--
	2/18/1992	4.96	0.00	95.28	--	<50	--	--	--	--	--	--	--	--	--	--	--	--	--	--
	5/15/1992	6.07	0.00	94.17	--	<50	--	--	--	--	--	--	--	--	--	--	--	--	--	--
	8/13/1992	6.42	0.00	93.82	--	<50	--	--	--	--	--	--	--	--	--	--	--	--	--	--
	12/3/1992	6.25	0.00	93.99	--	<50	--	--	--	--	--	--	--	--	--	--	--	--	--	--
	3/25/1993	5.40	0.00	94.84	--	<50	--	--	--	--	--	--	--	--	--	--	--	--	--	--
	5/21/1993	6.04	0.00	94.20	--	<50	--	--	--	--	--	--	--	--	--	--	--	--	--	--
	8/17/1993	6.42	0.00	93.82	--	<50	--	<0.5	<0.5	<0.5	<0.5	<0.5	--	--	--	--	--	--	--	--
	12/13/1993	6.09	0.00	94.15	--	<50	--	<0.5	<0.5	<0.5	<0.5	--	--	--	--	--	--	--	--	--
	2/24/1994	5.57	0.00	94.67	--	<50	--	<0.5	<0.5	<0.5	<0.5	--	--	--	--	--	--	--	--	--
	5/11/1994	5.94	0.00	94.30	--	<50	--	<0.5	<0.5	<0.5	<0.5	--	--	--	--	--	--	--	--	--
	8/23/1994	6.44	0.00	93.80	--	<50	--	<0.5	<0.5	<0.5	<0.5	--	--	--	--	--	--	--	--	--
	11/29/1994	5.82	0.00	94.42	--	90	<50	<0.5	<0.5	<0.5	<0.5	--	--	--	--	--	--	--	--	--
	2/15/1995	5.68	0.00	94.56	<500	100	<50	<0.5	1.2	<0.5	<0.5	--	--	--	--	--	--	--	--	--
	5/18/1995	--	--	--	--	--	--	--	--	--	--	--	--	--	--	--	--	--	--	--
	8/16/1995	6.19	0.00	94.05	--	63	--	<0.5	<0.5	<0.5	<0.5	--	--	--	--	--	--	--	--	--
	11/16/1995	--	--	--	--	--	--	--	--	--	--	--	--	--	--	--	--	--	--	--
	2/15/1996	5.62	0.00	94.62	--	79	--	<0.5	<0.5	<0.5	<0.5	--	--	--	--	--	--	--	--	--
	8/5/1996	6.22	0.00	94.02	--	100	--	<0.5	<0.5	<0.5	<0.5	--	--	--	--	--	--	--	--	--
	2/6/1997	5.50	0.00	94.74	--	140	--	<0.5	<0.5	<0.5	<0.5	--	--	--	--	--	--	--	--	--
	8/22/1997	6.57	0.00	93.67	--	<100	--	<0.5	<0.5	<0.5	<0.5	--	--	--	--	--	--	--	--	--
	2/12/1998	4.88	0.00	95.36	--	<100	--	<0.5	<0.5	<0.5	<0.5	--	--	--	--	--	--	--	--	--
	8/27/1998	6.42	0.00	93.82	--	93	--	<0.5	<0.5	<0.5	<0.5	--	--	--	--	--	--	--	--	--
	3/4/1999*	6.39	0.00	93.85	--	<50	--	<0.5	<0.5	<0.5	<0.5	<5	--	--	--	--	--	--	--	--
	5/30/2001	--	--	--	--	--	--	--	--	--	--	--	--	--	--	--	--	--	--	--
MW-2	6/18/2002	7.14	0.00	93.10	--	<50	--	<0.5	<0.5	<0.5	<0.5	<2.5	--	--	--	--	--	--	--	--
100.24	3/13/2003	6.64	0.00	93.60	--	<48	--	<0.5	<0.5	<0.5	<0.5	<2.0	--	--	--	--	--	--	--	--

TABLE 1
GROUNDWATER ELEVATION AND ANALYTICAL DATA
ESTES-GI TRUCKING COMPANY
1750 ADAMS AVENUE, SAN LEANDRO, CALIFORNIA

Sample ID	Date	Depth to Water (ft btoc)	SPH Thickness (ft)	Groundwater Elevation (arbitrary)	TPHmo	TPHd	TPHg	Benzene	Toluene	Ethylbenzene	Xylenes	MTBE	ETBE	TAME	DIPE	TBA	1,2-DCA	EDB	Ethanol	Napthalene
TOC	Sampled				←								Recorded in ug/L							→
<i>Final Groundwater ESL (Table E-1), Potential Vapor Intrusion Concerns</i>																				
<i>Residential</i>					NE	use soil gas	540	380,000	170,000	160,000	24,000	NE	NE	NE	NE	use soil gas	200	NE	NE	3,200
<i>Commercial/Industrial</i>					NE	use soil gas	1,800	530,000	170,000	160,000	80,000	NE	NE	NE	NE	use soil gas	690	NE	NE	11,000
<i>Final Groundwater ESL (Table F-1), Groundwater is a Current or Potential Drinking Water Resource</i>																				
					100	100	100	1.0	40	30	20	5.0	NE	NE	NE	12	0.5	0.05	NE	17
	3/17/2004	6.63	0.00	93.61	--	<500	--	<0.5	<0.5	<0.5	<0.5	<2.5	--	--	--	--	--	--	--	--
	3/17/2005	6.76	0.00	93.48	--	<50	--	<0.5	<0.5	<0.5	<0.5	<5	--	--	--	--	--	--	--	--
	3/2/2007	5.77	0.00	94.47	<250	<50	<50	<0.5	<0.5	<0.5	<0.5	<0.5	<0.5	<0.5	<0.5	<5.0	<0.5	<0.5	<50	--
	4/21/2009	6.38	0.00	93.86	<250	<50	<50	<0.5	<0.5	<0.5	<0.5	--	--	--	--	--	--	--	--	<0.5
MW-3	11/15/1988	--	--	--	--	<200	--	--	--	--	--	--	--	--	--	--	--	--	--	--
100.22	2/16/1989	6.00	0.00	94.22	--	<90	--	--	--	--	--	--	--	--	--	--	--	--	--	--
	5/19/1989	6.20	0.00	94.02	--	<80	--	--	--	--	--	--	--	--	--	--	--	--	--	--
	8/22/1989	6.60	0.00	93.62	--	<30	--	--	--	--	--	--	--	--	--	--	--	--	--	--
	11/21/1989	6.55	0.00	93.67	--	<30	--	--	--	--	--	--	--	--	--	--	--	--	--	--
	2/23/1990	5.83	0.00	94.39	--	340	--	--	--	--	--	--	--	--	--	--	--	--	--	--
	5/23/1990	6.38	0.00	93.84	--	640	--	--	--	--	--	--	--	--	--	--	--	--	--	--
	8/27/1990	6.67	0.00	93.55	--	410	--	--	--	--	--	--	--	--	--	--	--	--	--	--
	12/3/1990	6.75	0.00	93.47	--	<50	--	--	--	--	--	--	--	--	--	--	--	--	--	--
	3/13/1991	5.42	0.00	94.80	--	1,300	--	--	--	--	--	--	--	--	--	--	--	--	--	--
	5/29/1991	6.28	0.00	93.94	--	540	--	--	--	--	--	--	--	--	--	--	--	--	--	--
	8/28/1991	6.62	0.00	93.60	--	240	--	--	--	--	--	--	--	--	--	--	--	--	--	--
	12/9/1991	6.65	0.00	93.57	--	200	--	--	--	--	--	--	--	--	--	--	--	--	--	--
	2/18/1992	4.73	0.00	95.49	--	890	--	--	--	--	--	--	--	--	--	--	--	--	--	--
	5/15/1992	5.99	0.00	94.23	--	380	--	--	--	--	--	--	--	--	--	--	--	--	--	--
	8/13/1992	6.32	0.00	93.90	--	200	--	--	--	--	--	--	--	--	--	--	--	--	--	--
	12/3/1992	6.23	0.00	93.99	--	<50	--	--	--	--	--	--	--	--	--	--	--	--	--	--
	3/25/1993	5.27	0.00	94.95	--	1,600	--	--	--	--	--	--	--	--	--	--	--	--	--	--
	5/21/1993	5.97	0.00	94.25	--	720	--	--	--	--	--	--	--	--	--	--	--	--	--	--
	8/17/1993	6.59	0.00	93.63	--	480	--	<0.5	<0.5	<0.5	<0.5	--	--	--	--	--	--	--	--	--
	12/13/1993	6.33	0.00	93.89	--	190	--	<0.5	<0.5	<0.5	<0.5	--	--	--	--	--	--	--	--	--
	2/24/1994	5.76	0.00	94.46	--	380	--	<0.5	<0.5	<0.5	<0.5	--	--	--	--	--	--	--	--	--
100.18	5/11/1994	5.84	0.00	94.34	--	580	--	<0.5	<0.5	<0.5	<0.5	--	--	--	--	--	--	--	--	--
	8/23/1994	6.38	0.00	93.80	--	450	--	<0.5	0.6	<0.5	<0.5	--	--	--	--	--	--	--	--	--
	11/29/1994	5.76	0.00	94.42	--	960	<50	<0.5	<0.5	<0.5	<0.5	--	--	--	--	--	--	--	--	--
	2/15/1995	5.60	0.00	94.58	<500	1,700	<50	<0.5	<0.5	<0.5	<0.5	--	--	--	--	--	--	--	--	--
	5/18/1995	--	--	--	--	--	--	--	--	--	--	--	--	--	--	--	--	--	--	--
	8/16/1995	6.11	0.00	94.07	--	1,100	--	<0.5	<0.5	<0.5	<0.5	--	--	--	--	--	--	--	--	--
	11/16/1995	--	--	--	--	--	--	--	--	--	--	--	--	--	--	--	--	--	--	--
	2/15/1996	5.48	0.00	94.70	--	1,300	--	<0.5	<0.5	<0.5	<0.5	--	--	--	--	--	--	--	--	--
	8/5/1996	6.16	0.00	94.02	--	1,000	--	<0.5	<0.5	<0.5	<0.5	--	--	--	--	--	--	--	--	--
	2/6/1997	5.36	0.00	94.82	--	2,400	--	<0.5	<0.5	<0.5	<0.5	--	--	--	--	--	--	--	--	--
	8/22/1997	5.85	0.00	94.33	--	2,000	--	<0.5	<0.5	<0.5	<0.5	--	--	--	--	--	--	--	--	--
	2/12/1998	4.81	0.00	95.37	--	1,500	--	<0.5	<0.5	<0.5	<0.5	--	--	--	--	--	--	--	--	--
MW-3	8/27/1998	6.25	0.00	93.93	--	410	--	<0.5	<0.5	<0.5	<0.5	--	--	--	--	--	--	--	--	--
100.18	3/4/1999*	6.14	0.00	94.04	--	330	--	<0.5	<0.5	<0.5	<0.5	17	--	--	--	--	--	--	--	--
	5/30/2001	--	--	--	--	--	--	--	--	--	--	--	--	--	--	--	--	--	--	--

TABLE 1

GROUNDWATER ELEVATION AND ANALYTICAL DATA
 ESTES-GI TRUCKING COMPANY
 1750 ADAMS AVENUE, SAN LEANDRO, CALIFORNIA

Sample ID	Date	Depth to Water	SPH Thickness	Groundwater Elevation	TPHmo	TPHd	TPHg	Benzene	Toluene	Ethylbenzene	Xylenes	MTBE	ETBE	TAME	DIPE	TBA	1,2-DCA	EDB	Ethanol	Napthalene	
TOC	Sampled	(ft btoc)	(ft)	(arbitrary)	Recorded in ug/L																
<i>Final Groundwater ESL (Table E-1), Potential Vapor Intrusion Concerns</i>																					
<i>Residential</i>					NE	use soil gas	540	380,000	170,000	160,000	24,000	NE	NE	NE	use soil gas	200	NE	NE	3,200		
<i>Commercial/Industrial</i>					NE	use soil gas	1,800	530,000	170,000	160,000	80,000	NE	NE	NE	use soil gas	690	NE	NE	11,000		
<i>Final Groundwater ESL (Table F-1), Groundwater is a Current or Potential Drinking Water Resource</i>																					
					100	100	100	1.0	40	30	20	5.0	NE	NE	NE	12	0.5	0.05	NE	17	
	6/18/2002	7.07	0.00	93.11	--	1,100	--	<0.5	<0.5	<0.5	<0.5	3.6/3.1	--	--	--	--	--	--	--	--	
	3/13/2003	6.45	0.00	93.73	--	680	--	<0.5	<0.5	<0.5	<0.5	2.9	--	--	--	--	--	--	--	--	
	3/17/2004	5.98	0.00	94.20	--	450	--	<0.5	<0.5	<0.5	<0.5	<2.5	--	--	--	--	--	--	--	--	
	3/17/2005	5.72	0.00	94.46	--	160	--	<0.5	<0.5	<0.5	<0.5	<5.0	--	--	--	--	--	--	--	--	
	3/2/2007	5.68	0.00	94.50	<250	<50	<50	<0.5	<0.5	<0.5	<0.5	<0.5	<0.5	<0.5	<0.5	<5.0	<0.5	<0.5	<50	--	
	4/21/2009	6.26	0.00	93.92	<250	<50	<50	<0.5	<0.5	<0.5	<0.5	--	--	--	--	--	--	--	--	<0.5	
MW-4	11/15/1988	--	--	--	--	<200	--	--	--	--	--	--	--	--	--	--	--	--	--	--	
99.48	2/16/1989	5.92	0.00	93.56	--	<90	--	--	--	--	--	--	--	--	--	--	--	--	--	--	
	5/19/1989	5.25	0.00	94.23	--	<80	--	--	--	--	--	--	--	--	--	--	--	--	--	--	
	8/22/1989	6.76	0.00	92.72	--	<30	--	--	--	--	--	--	--	--	--	--	--	--	--	--	
	11/21/1989	5.72	0.00	93.76	--	<30	--	--	--	--	--	--	--	--	--	--	--	--	--	--	
	2/23/1990	4.92	0.00	94.56	--	<50	--	--	--	--	--	--	--	--	--	--	--	--	--	--	
	5/23/1990	5.39	0.00	94.09	--	<50	--	--	--	--	--	--	--	--	--	--	--	--	--	--	
	8/27/1990	5.66	0.00	93.82	--	<50	--	--	--	--	--	--	--	--	--	--	--	--	--	--	
	12/3/1990	5.95	0.00	93.53	--	<50	--	--	--	--	--	--	--	--	--	--	--	--	--	--	
	3/13/1991	4.39	0.00	95.09	--	<50	--	--	--	--	--	--	--	--	--	--	--	--	--	--	
	5/29/1991	5.27	0.00	94.21	--	<50	--	--	--	--	--	--	--	--	--	--	--	--	--	--	
	8/28/1991	5.70	0.00	93.78	--	<50	--	--	--	--	--	--	--	--	--	--	--	--	--	--	
	12/9/1991	5.78	0.00	93.70	--	<50	--	--	--	--	--	--	--	--	--	--	--	--	--	--	
	2/18/1992	3.60	0.00	95.88	--	<50	--	--	--	--	--	--	--	--	--	--	--	--	--	--	
	5/15/1992	5.03	0.00	94.45	--	<50	--	--	--	--	--	--	--	--	--	--	--	--	--	--	
	8/13/1992	5.40	0.00	94.08	--	<50	--	--	--	--	--	--	--	--	--	--	--	--	--	--	
	12/3/1992	5.14	0.00	94.34	--	<50	--	--	--	--	--	--	--	--	--	--	--	--	--	--	
	3/25/1993	4.14	0.00	95.34	--	<50	--	--	--	--	--	--	--	--	--	--	--	--	--	--	
	5/21/1993	4.95	0.00	94.53	--	<50	--	--	--	--	--	--	--	--	--	--	--	--	--	--	
	8/17/1993	5.40	0.00	94.08	--	<50	--	<0.5	<0.5	<0.5	<0.5	--	--	--	--	--	--	--	--	--	
	12/13/1993	5.08	0.00	94.40	--	<50	--	<0.5	<0.5	<0.5	<0.5	--	--	--	--	--	--	--	--	--	
	2/24/1994	4.38	0.00	95.10	--	<50	--	<0.5	<0.5	<0.5	<0.5	--	--	--	--	--	--	--	--	--	
	5/11/1994	4.85	0.00	94.63	--	<50	--	<0.5	<0.5	<0.5	<0.5	--	--	--	--	--	--	--	--	--	
	8/23/1994	5.47	0.00	94.01	--	<50	--	<0.5	<0.5	<0.5	<0.5	--	--	--	--	--	--	--	--	--	
	11/29/1994	4.76	0.00	94.72	--	--	--	--	--	--	--	--	--	--	--	--	--	--	--	--	
	2/15/1995	--	--	--	--	--	--	--	--	--	--	--	--	--	--	--	--	--	--	--	
	5/18/2005	--	--	--	--	--	--	--	--	--	--	--	--	--	--	--	--	--	--	--	
	8/16/1995	5.16	0.00	94.32	--	--	--	--	--	--	--	--	--	--	--	--	--	--	--	--	
	11/16/1995	--	--	--	--	--	--	--	--	--	--	--	--	--	--	--	--	--	--	--	
	2/15/1996	4.40	0.00	95.08	--	--	--	--	--	--	--	--	--	--	--	--	--	--	--	--	

TABLE 1

GROUNDWATER ELEVATION AND ANALYTICAL DATA
 ESTES-GI TRUCKING COMPANY
 1750 ADAMS AVENUE, SAN LEANDRO, CALIFORNIA

Sample ID	Date	Depth to Water (ft btoc)	SPH Thickness (ft)	Groundwater Elevation (arbitrary)	TPHmo	TPHd	TPHg	Benzene	Toluene	Ethylbenzene	Xylenes	MTBE	ETBE	TAME	DIPE	TBA	1,2-DCA	EDB	Ethanol	Napthalene
TOC	Sampled				Recorded in ug/L															
<i>Final Groundwater ESL (Table E-1), Potential Vapor Intrusion Concerns</i>																				
<i>Residential</i>					NE	use soil gas	540	380,000	170,000	160,000	24,000	NE	NE	NE	use soil gas	200	NE	NE	3,200	
<i>Commercial/Industrial</i>					NE	use soil gas	1,800	530,000	170,000	160,000	80,000	NE	NE	NE	use soil gas	690	NE	NE	11,000	
<i>Final Groundwater ESL (Table F-1), Groundwater is a Current or Potential Drinking Water Resource</i>																				
					100	100	100	1.0	40	30	20	5.0	NE	NE	NE	12	0.5	0.05	NE	17
MW-4	8/5/1996	5.27	0.00	94.21	--	--	--	--	--	--	--	--	--	--	--	--	--	--	--	--
99.46	2/6/1997	4.26	0.00	95.20	--	--	--	--	--	--	--	--	--	--	--	--	--	--	--	--
	8/22/1997	5.09	0.00	94.37	--	--	--	--	--	--	--	--	--	--	--	--	--	--	--	--
	2/12/1998	3.58	0.00	95.88	--	--	--	--	--	--	--	--	--	--	--	--	--	--	--	--
	8/27/1998	5.43	0.00	94.03	--	--	--	--	--	--	--	--	--	--	--	--	--	--	--	--
	3/4/1999*	5.34	0.00	94.12	--	--	--	--	--	--	--	--	--	--	--	--	--	--	--	--
	June 1999	Well Destroyed																		
MW-5	11/15/1988	--	--	--	--	<200	--	--	--	--	--	--	--	--	--	--	--	--	--	--
99.60	2/16/1989	5.42	0.00	94.18	--	<90	--	--	--	--	--	--	--	--	--	--	--	--	--	--
	5/19/1989	5.53	0.00	94.07	--	<80	--	--	--	--	--	--	--	--	--	--	--	--	--	--
	8/22/1989	5.94	0.00	93.66	--	<30	--	--	--	--	--	--	--	--	--	--	--	--	--	--
	11/21/1989	5.91	0.00	93.69	--	<30	--	--	--	--	--	--	--	--	--	--	--	--	--	--
	2/23/1990	5.69	0.00	93.91	--	<50	--	--	--	--	--	--	--	--	--	--	--	--	--	--
	5/23/1990	5.92	0.00	93.68	--	<50	--	--	--	--	--	--	--	--	--	--	--	--	--	--
	8/27/1990	6.17	0.00	93.43	--	<50	--	--	--	--	--	--	--	--	--	--	--	--	--	--
	12/3/1990	6.05	0.00	93.55	--	<50	--	--	--	--	--	--	--	--	--	--	--	--	--	--
	3/13/1991	5.01	0.00	94.59	--	<50	--	--	--	--	--	--	--	--	--	--	--	--	--	--
	5/29/1991	5.57	0.00	94.03	--	<50	--	--	--	--	--	--	--	--	--	--	--	--	--	--
	8/28/1991	5.90	0.00	93.70	--	<50	--	--	--	--	--	--	--	--	--	--	--	--	--	--
	12/9/1991	5.99	0.00	93.61	--	<50	--	--	--	--	--	--	--	--	--	--	--	--	--	--
	2/18/1992	4.45	0.00	95.15	--	<50	--	--	--	--	--	--	--	--	--	--	--	--	--	--
	5/15/1992	5.33	0.00	94.27	--	<50	--	--	--	--	--	--	--	--	--	--	--	--	--	--
	8/13/1992	5.62	0.00	93.98	--	<50	--	--	--	--	--	--	--	--	--	--	--	--	--	--
	12/3/1992	5.58	0.00	94.02	--	<50	--	--	--	--	--	--	--	--	--	--	--	--	--	--
	3/25/1993	4.34	0.00	95.26	--	<50	--	--	--	--	--	--	--	--	--	--	--	--	--	--
	5/21/1993	5.28	0.00	94.32	--	<50	--	--	--	--	--	--	--	--	--	--	--	--	--	--
	8/17/1993	5.61	0.00	93.99	--	<50	--	<0.05	<0.5	<0.5	<0.5	<0.5	<0.5	--	--	--	--	--	--	--
	12/13/1993	5.38	0.00	94.22	--	<50	--	<0.05	<0.5	<0.5	<0.5	<0.5	<0.5	--	--	--	--	--	--	--
	2/24/1994	4.90	0.00	94.70	--	<50	--	<0.05	<0.5	<0.5	<0.5	<0.5	<0.5	--	--	--	--	--	--	--
	5/11/1994	5.23	0.00	94.37	--	<50	--	<0.05	<0.5	<0.5	<0.5	<0.5	<0.5	--	--	--	--	--	--	--
	8/23/1994	5.70	0.00	93.90	--	<50	--	<0.05	<0.5	<0.5	<0.5	<0.5	<0.5	--	--	--	--	--	--	--
	11/29/1994	5.12	0.00	94.48	--	--	--	--	--	--	--	--	--	--	--	--	--	--	--	--
	2/15/1995	--	--	--	--	--	--	--	--	--	--	--	--	--	--	--	--	--	--	--
	5/18/2005	--	--	--	--	--	--	--	--	--	--	--	--	--	--	--	--	--	--	--
8/16/1995	5.47	0.00	94.13	--	--	--	--	--	--	--	--	--	--	--	--	--	--	--	--	
11/16/1995	--	--	--	--	--	--	--	--	--	--	--	--	--	--	--	--	--	--	--	
2/15/1996	4.90	0.00	94.70	--	--	--	--	--	--	--	--	--	--	--	--	--	--	--	--	
8/5/1996	5.50	0.00	94.10	--	--	--	--	--	--	--	--	--	--	--	--	--	--	--	--	
2/6/1997	4.80	0.00	94.80	--	--	--	--	--	--	--	--	--	--	--	--	--	--	--	--	
8/22/1997	6.37	0.00	93.23	--	--	--	--	--	--	--	--	--	--	--	--	--	--	--	--	
MW-5	2/12/1998	4.32	0.00	95.28	--	--	--	--	--	--	--	--	--	--	--	--	--	--	--	

TABLE 1

**GROUNDWATER ELEVATION AND ANALYTICAL DATA
ESTES-GI TRUCKING COMPANY
1750 ADAMS AVENUE, SAN LEANDRO, CALIFORNIA**

Sample ID	Date	Depth to Water (ft btoc)	SPH Thickness (ft)	Groundwater Elevation (arbitrary)	TPHmo	TPHd	TPHg	Benzene	Toluene	Ethylbenzene	Xylenes	MTBE	ETBE	TAME	DIPE	TBA	1,2-DCA	EDB	Ethanol	Napthalene
TOC	Sampled	(ft btoc)	(ft)	(arbitrary)	Recorded in ug/L															
<i>Final Groundwater ESL (Table E-1), Potential Vapor Intrusion Concerns</i>																				
<i>Residential</i>					NE	use soil gas	540	380,000	170,000	160,000	24,000	NE	NE	NE	NE	use soil gas	200	NE	NE	3,200
<i>Commercial/Industrial</i>					NE	use soil gas	1,800	530,000	170,000	160,000	80,000	NE	NE	NE	NE	use soil gas	690	NE	NE	11,000
<i>Final Groundwater ESL (Table F-1), Groundwater is a Current or Potential Drinking Water Resource</i>																				
					100	100	100	1.0	40	30	20	5.0	NE	NE	NE	12	0.5	0.05	NE	17
99.60	8/27/1998	5.77	0.00	93.83	--	--	--	--	--	--	--	--	--	--	--	--	--	--	--	--
	3/4/1999*	5.88	0.00	93.72	--	--	--	--	--	--	--	--	--	--	--	--	--	--	--	--
	6/18/2002	5.97	0.00	93.63	--	61	--	<0.5	<0.5	<0.5	<0.5	<2.5	--	--	--	--	--	--	--	--
	3/13/2003	5.77	0.00	93.83	--	<47	--	<0.5	<0.5	<0.5	<0.5	<2.0	--	--	--	--	--	--	--	--
	3/17/2004	5.37	0.00	94.23	--	<50	--	<0.5	<0.5	<0.5	<0.5	<2.5	--	--	--	--	--	--	--	--
	3/17/2005	5.23	0.00	94.37	--	<50	--	<0.5	<0.5	<0.5	<0.5	<5.0	--	--	--	--	--	--	--	--
	3/2/2007	5.12	0.00	94.48	<250	<50	<50	<0.5	<0.5	<0.5	<0.5	<0.5	<0.5	<0.5	<0.5	<5.0	<0.5	<0.5	<50	--
	4/21/2009	5.65	0.00	93.95	<250	<50	<50	<0.5	<0.5	<0.5	<0.5	--	--	--	--	--	--	--	--	<0.5
RW-2 <i>not sureye.</i>	8/5/1996	6.02	0.31	--	--	--	--	--	--	--	--	--	--	--	--	--	--	--	--	--
	2/6/1997	4.41	0.00	--	--	--	--	--	--	--	--	--	--	--	--	--	--	--	--	--
	8/22/1997	4.88	0.00	--	--	--	--	--	--	--	--	--	--	--	--	--	--	--	--	--
	2/12/1998	3.21	0.00	--	--	100,000	--	<0.5	<0.5	<0.5	<0.5	--	--	--	--	--	--	--	--	--
	8/27/1998	5.92	0.00	--	--	--	--	--	--	--	--	--	--	--	--	--	--	--	--	--
	3/4/1999*	4.95	0.00	--	--	74,000	--	<1.0	<1.0	<1.0	<1.0	<10	--	--	--	--	--	--	--	--
	5/30/2001	--	0.00	--	--	9,000	--	<0.5	<0.5	<0.5	<0.5	--	--	--	--	--	--	--	--	--
	6/18/2002	6.30	0.00	--	--	280,000	--	<10	<10	<10	<10	<50	--	--	--	--	--	--	--	--
	3/13/2003	6.11	0.00	--	--	--	--	--	--	--	--	--	--	--	--	--	--	--	--	--
	3/17/2004	5.58	0.00	--	--	--	--	--	--	--	--	--	--	--	--	--	--	--	--	--
	3/17/2005	5.30	0.00	--	--	--	--	--	--	--	--	--	--	--	--	--	--	--	--	--
	3/2/2007	5.21	0.00	--	2,500	5,500 c	<50	<0.5	<0.5	<0.5	<0.5	<0.5	<0.5	<0.5	<0.5	<5.0	<0.5	<0.5	<50	--
	4/21/2009	5.88	Sheen	--	3,000	6,000 c, d	<50 d	<0.5	<0.5	<0.5	<0.5	--	--	--	--	--	--	--	--	<0.5 d

Notes:

TOC = elevation of the top of casing relative to an arbitrary elevation from well RW-1's TOC (100.00 ft)

ft btoc = measured in feet below top of casing

SPH = separate phase hydrocarbons or non-aqueous phase liquid (NAPL)

ug/L = micrograms per liter

Sheen = non-measurable SPH sheen observed

-- = Not measured, not analyzed, not applicable

TPHd = total petroleum hydrocarbons as diesel analyzed by modified EPA Method 8015; beginning 3/2/2007 analyzed by EPA Method 8015C with silica gel cleanup

TPHmo = total petroleum hydrocarbons as motor oil analyzed by EPA Method 8015C with silica gel cleanup

TPHg = total petroleum hydrocarbons as gasoline analyzed by EPA Method 8015C

BTEX = benzene, toluene, ethylbenzene, xylenes analyzed by EPA Method 8020/8021B; beginning 3/2/2007 analyzed by EPA Method 8260B

MTBE = methyl tertiary-butyl ether analyzed by EPA Method 8020/8021B; beginning 3/2/2007 analyzed by EPA Method 8260B

ETBE = ethyl tertiary-butyl ether analyzed by EPA Method 8260B

TAME = tertiary-amyl methyl ether analyzed by EPA Method 8260B

DIPE = di-isopropyl ether analyzed by EPA Method 8260B

TBA = tertiary butyl alcohol analyzed by EPA Method 8260B

1,2-DCA = one, two-dichloroethane analyzed by EPA Method 8260B

EDB = ethylene dibromide analyzed by EPA Method 8260B

Ethanol analyzed by EPA Method 8260B

* = data collected on March 4 & 11, 1999

b = strongly aged gasoline or diesel range compounds are significant in the gasoline chromatogram

c = aged diesel (?) is significant

d = lighter than water immisible sheen/product is present

**HISTORICAL SOIL ANALYTICAL DATA
ESTES-GI TRUCKING COMPANY
1750 ADAMS AVENUE, SAN LEANDRO, CALIFORNIA**

<i>Sample ID</i>	<i>Date Sampled</i>	<i>Depth (ft)</i>	<i>Oil & Grease (mg/kg)</i>	<i>TPHd (mg/kg)</i>	<i>TPHg (mg/kg)</i>	<i>Benzene (mg/kg)</i>	<i>Toluene (mg/kg)</i>	<i>Ethylbenzene (mg/kg)</i>	<i>Xylenes (mg/kg)</i>	<i>MTBE (mg/kg)</i>		
<i>Final ESL (Table G), Soil Leaching Screening Level (Drinking Water Resource)</i>												
			NE	83	83	0.044	2.9	3.3	2.3	0.023		
<i>Final ESL (Table K-1), Residential Direct Exposure</i>												
			370	110	110	0.12	63	2.3	31	30		
<i>Final ESL (Table K-2), Commercial/Industrial Worker Direct Exposure</i>												
			3,700	450	450	0.27	210	5.0	100	65		
<i>Final ESL (Table K-3), Construction/Trench Worker Exposure</i>												
			12,000	4,200	4,200	12	650	210	420	2,800		
<i>Excavation</i>												
<i>EX-1</i>	6/9/1999	5	--	2,300	b	81	d	<0.5	<0.5	<0.5	<0.5	<5.0
<i>EX-2</i>	6/9/1999	5	--	4,500	a	120	d	<0.5	<0.5	<0.5	<0.5	<5.0
<i>EX-3</i>	6/9/1999	5	--	2,100	a	26	d	<0.5	<0.5	<0.5	<0.5	<5.0
<i>EX-4</i>	6/9/1999	5	--	<1.0		<1.0		<0.5	<0.5	<0.5	<0.5	<5.0
<i>EX-5</i>	6/9/1999	6	--	<1.0		<1.0		<0.5	<0.5	<0.5	<0.5	<5.0
<i>EX-6</i>	6/9/1999	6.5	--	85	b	3.7	d	<0.5	<0.5	<0.5	<0.5	<5.0
<i>EX-7</i>	6/9/1999	6	--	<1.0		<1.0		<0.5	<0.5	<0.5	<0.5	<5.0
<i>EX-8</i>	6/9/1999	6	--	2,000	b	120	d	<0.5	<0.01	<0.5	0.17	<5.0
<i>EX-9</i>	6/9/1999	6	--	2,000	b	120	d	<0.5	0.013	<0.5	0.19	<5.0
<i>EX-10</i>	6/9/1999	6	--	2,900	b,c	390	d,e	<0.03	0.45	0.45	1.5	<0.20

TABLE 2

**HISTORICAL SOIL ANALYTICAL DATA
ESTES-GI TRUCKING COMPANY
1750 ADAMS AVENUE, SAN LEANDRO, CALIFORNIA**

<i>Sample ID</i>	<i>Date Sampled</i>	<i>Depth (ft)</i>	<i>Oil & Grease (mg/kg)</i>	<i>TPHd (mg/kg)</i>	<i>TPHg (mg/kg)</i>	<i>Benzene (mg/kg)</i>	<i>Toluene (mg/kg)</i>	<i>Ethylbenzene (mg/kg)</i>	<i>Xylenes (mg/kg)</i>	<i>MTBE (mg/kg)</i>	
<i>Final ESL (Table G), Soil Leaching Screening Level (Drinking Water Resource)</i>											
			NE	83	83	0.044	2.9	3.3	2.3	0.023	
<i>Final ESL (Table K-1), Residential Direct Exposure</i>											
			370	110	110	0.12	63	2.3	31	30	
<i>Final ESL (Table K-2), Commercial/Industrial Worker Direct Exposure</i>											
			3,700	450	450	0.27	210	5.0	100	65	
<i>Final ESL (Table K-3), Construction/Trench Worker Exposure</i>											
			12,000	4,200	4,200	12	650	210	420	2,800	
<i>Over-Excavation</i>											
<i>EX-11</i>	6/11/1999	6	--	2,400	a	--	<0.005	<0.23	<0.005	<0.16	<0.1
<i>EX-12</i>	6/11/1999	6	--	620	b	--	<0.023	<0.005	<0.005	0.032	<0.1
<i>EX-13</i>	6/11/1999	6	--	2,200	a	--	<0.005	0.045	<0.005	<0.005	<0.1
<i>EX-14</i>	6/11/1999	6	--	620	b	--	<0.005	<0.005	<0.005	0.034	<0.21
<i>EX-15</i>	6/11/1999	5.5	--	2,400	a	--	<0.005	<0.005	<0.005	0.096	<0.1
<i>Monitoring Wells</i>											
<i>M-1/R-1</i>	12/31/1986	4	110	--	--	--	--	--	--	--	--
	12/31/1986	8	80	--	--	--	--	--	--	--	--
<i>M-2</i>	12/31/1986	5	210	--	--	--	--	--	--	--	--
	12/31/1986	9	118	--	--	--	--	--	--	--	--
<i>M-3</i>	12/31/1986	8	137	--	--	--	--	--	--	--	--
<i>M-4</i>	12/31/1986	5	91	--	--	--	--	--	--	--	--
	12/31/1986	10	71	--	--	--	--	--	--	--	--

**HISTORICAL SOIL ANALYTICAL DATA
ESTES-GI TRUCKING COMPANY
1750 ADAMS AVENUE, SAN LEANDRO, CALIFORNIA**

<i>Sample ID</i>	<i>Date Sampled</i>	<i>Depth (ft)</i>	<i>Oil & Grease (mg/kg)</i>	<i>TPHd (mg/kg)</i>	<i>TPHg (mg/kg)</i>	<i>Benzene (mg/kg)</i>	<i>Toluene (mg/kg)</i>	<i>Ethylbenzene (mg/kg)</i>	<i>Xylenes (mg/kg)</i>	<i>MTBE (mg/kg)</i>
<i>Final ESL (Table G), Soil Leaching Screening Level (Drinking Water Resource)</i>										
			NE	83	83	0.044	2.9	3.3	2.3	0.023
<i>Final ESL (Table K-1), Residential Direct Exposure</i>										
			370	110	110	0.12	63	2.3	31	30
<i>Final ESL (Table K-2), Commercial/Industrial Worker Direct Exposure</i>										
			3,700	450	450	0.27	210	5.0	100	65
<i>Final ESL (Table K-3), Construction/Trench Worker Exposure</i>										
			12,000	4,200	4,200	12	650	210	420	2,800

Notes:

mg/kg = milligram per kilogram

-- = not analyzed

Oil & Grease (Soil/Waste Oil) by EPA Method 3550

TPHd = total petroleum hydrocarbons as diesel analyzed by modified EPA Method 8015

TPHg = total petroleum hydrocarbons as gasoline analyzed by EPA Method 8015C

BTEX = benzene, toluene, ethylbenzene, xylenes analyzed by modified EPA Method 8015/8020

MTBE = methyl tertiary-butyl ether analyzed by EPA Method 8020

a = unmodified or weakly modified gasoline is significant

b = lighter gasoline range compounds (the most mobile fraction) are significant

c = gasoline range compounds having broad chromatographic peaks are significant; biologically altered gasoline?

d = strongly aged gasoline or diesel range compounds are significant

e = no recognizable pattern

TABLE 3

**WELL CONSTRUCTION DETAILS
ESTES-GI TRUCKING COMPANY
1750 ADAMS AVENUE, SAN LEANDRO, CALIFORNIA**

<i>Well</i>	<i>Status</i>	<i>Date Installed</i>	<i>Casing Diameter (inches)</i>	<i>Total Depth (fbg)</i>	<i>Top of Screen Interval (fbg)</i>	<i>Bottom Screen of Interval (fbg)</i>	<i>Length of Screen (fbg)</i>
<i>MW-1/RW-1</i>	Active	12/31/86	2	25	6	25	19
<i>MW-2</i>	Active	12/31/86	2	25	6	25	19
<i>MW-3</i>	Active	12/31/86	2	25	6	25	19
<i>MW-4</i>	Destroyed	12/31/86	2	25	6	25	19
<i>MW-5</i>	Active				Unknown		
<i>RW-2</i>	Active	6/6/96	4	13	3	13	10

Notes/Abbreviations

fbg= feet below ground

TABLE 4

**DWR/ACPWA WELL SURVEY SUMMARY
ESTES-GI TRUCKING COMPANY
1750 ADAMS AVENUE, SAN LEANDRO, CALIFORNIA**

Map ID	State Well No.	Well Owner	Approximate Well Location	Installation Date	Well Type	Current Well Use	Total Well Depth (ft bgs)	Screened Interval (ft bgs)	Seal Interval (ft bgs)	Approximate Distance from Former USTs (ft)	Approximate Distance from Former USTs (mi)
A	2S/3W-27	G. Kindle	358 105th Ave, Oakland	8/1/1945	NA	NA	120	NA	NA	2,851	0.54
B-1	2S/3W-27L1	Verl's Construction	342 105th Avenue, Oakland	2/22/1990	Monitoring	NA	25	11-25	0-9	2,693	0.51
B-2	2S/3W-27L2	Verl's Construction	342 105th Avenue, Oakland	2/22/1990	Monitoring	NA	25	9-25	0-9	2,693	0.51
B-3	2S/3W-27L3	Verl's Construction	342 105th Avenue, Oakland	2/23/1990	Monitoring	NA	25	8-25	0-9	2,693	0.51
C	2S/3W-27F3	PG&E	St. Elmo & Hunter, Oakland	2/27/1976	Cathodic Protection	NA	120	NA	0-95	2,587	0.49
D	2S/3W-34M1	Caterpillar, Inc	Empire Road, Oakland End of Circle 400 ft South of Gibraltar Rd	5/28/1990	Monitoring	NA	65	50-65	0-47	1,637	0.31
E-1	2S/3W-28R1	Moore Business Forms	528 Whitney Street, San Leandro	7/1/1985	Monitoring (W-1)	NA	14	5-14	0-4	1,320	0.25
E-2	2S/3W-28R2	Moore Business Forms	528 Whitney Street, San Leandro	7/1/1985	Monitoring (W-2)	NA	14	5-14	0-4	1,320	0.25
E-3	2S/3W-28R3	Moore Business Forms	528 Whitney Street, San Leandro	7/1/1985	Monitoring (W-3)	NA	14	5-14	0-4	1,320	0.25
E-4	2S/3W-28R21	Principle Financial Group	528 Whitney Street, San Leandro	February 1994	Monitoring	NA	23	NA	NA	1,320	0.25
E-5	2S/3W-28R22	Principle Financial Group	528 Whitney Street, San Leandro	February 1994	Monitoring	NA	20	NA	NA	1,320	0.25

TABLE 4

**DWR/ACPWA WELL SURVEY SUMMARY
ESTES-GI TRUCKING COMPANY
1750 ADAMS AVENUE, SAN LEANDRO, CALIFORNIA**

Map ID	State Well No.	Well Owner	Approximate Well Location	Installation Date	Well Type	Current Well Use	Total Well Depth (ft bgs)	Screened Interval (ft bgs)	Seal Interval (ft bgs)	Approximate Distance from Former USTs (ft)	Approximate Distance from Former USTs (mi)
F-1	2S/3W-28Q	Safeway Milk Plant	2000 Adams Street, San Leandro	10/5/1989	Monitoring (MW-1)	NA	21	6-21	0-4	1,267	0.24
F-2	2S/3W-28Q6	Safeway Milk Plant	2000 Adams Street, San Leandro	10/5/1989	Monitoring (MW-2)	NA	21	6-21	0-4	1,267	0.24
F-3	2S/3W-28Q	Safeway Milk Plant	2000 Adams Street, San Leandro	10/5/1989	Monitoring (MW-3)	NA	21	6-21	0-4	1,267	0.24
F-4	2S/3W-28Q3	Safeway Milk Plant	2000 Adams Street, San Leandro	6/30/1986	Monitoring (SM-1)	NA	27	9-27	0-4	1,267	0.24
F-5	2S/3W-28Q4	Safeway Milk Plant	2000 Adams Street, San Leandro	7/1/1986	Monitoring (SM-2)	NA	20	7-21	0-6	1,267	0.24
F-6	2S/3W-2855	Safeway Milk Plant	2000 Adams Street, San Leandro	5/12/1987	Monitoring (SMP-3)	NA	21.5	5-21.5	0-2.5	1,267	0.24
F-7	2S/3W-28J5	Safeway Milk Plant	2000 Adams Street, San Leandro	June 1987	Monitoring	NA	21	NA	NA	1,267	0.24
F-8	2S/3W-28J8	Safeway Milk Plant	2000 Adams Street, San Leandro	12/4/1997	Monitoring	NA	20	NA	NA	1,267	0.24
F-9	2S/3W-28J9	Safeway Milk Plant	2000 Adams Street, San Leandro	12/4/1997	Monitoring	NA	20	NA	NA	1,267	0.24
F-10	2S/3W-28J10	Safeway Milk Plant	2000 Adams Street, San Leandro	12/4/1997	Monitoring	NA	20	NA	NA	1,267	0.24
G-1	2S/3W-28Q1	Edgewater International Trucks	390 Doolittle Drive, San Leandro	5/2/1986	Monitoring/ Remediation (EW-1)	NA	26	6-26	0-5	1,795	0.34

TABLE 4

**DWR/ACPWA WELL SURVEY SUMMARY
ESTES-GI TRUCKING COMPANY
1750 ADAMS AVENUE, SAN LEANDRO, CALIFORNIA**

Map ID	State Well No.	Well Owner	Approximate Well Location	Installation Date	Well Type	Current Well Use	Total Well Depth (ft bgs)	Screened Interval (ft bgs)	Seal Interval (ft bgs)	Approximate Distance from Former USTs (ft)	Approximate Distance from Former USTs (mi)
G-2	2S/3W-28Q2	Edgewater International Trucks	390 Doolittle Drive, San Leandro	5/2/1986	Monitoring/ Remediation (EW-2)	NA	25	6-25	0-5	1,795	0.34
H-1	2S/3W-28G1	Ratto Bros, Inc	190 Tunis Road & 98th Avenue, Oakland	July 1956	Irrigation	NA	250	NA	NA	1,795	0.34
H-2	2S/3W-28G2	Ratto Bros, Inc	191 98th Avenue, Oakland,	6/2/1988	Irrigation	NA	305	25-305	0-25	1,267	0.24
I-1	2S/3W-28G3	California Glass Company	155 98th Avenue, Oakland	3/26/1990	Monitoring (EA-1)	NA	20	5-20	0-3.5	1,795	0.34
I-2	2S/3W-28G4	California Glass Company	155 98th Avenue, Oakland	3/26/1990	Monitoring (EA-2)	NA	20	5-20	0-3.5	1,795	0.34
I-3	2S/3W-28G5	California Glass Company	155 98th Avenue, Oakland	3/27/1990	Monitoring (EA-3)	NA	20	5-20	0-3.5	1,795	0.34
J-1	2S/3W-287	David Property	106-110 Hegenberger Road	February 1994	Monitoring	NA	23	NA	NA	2,587	0.49
J-2	2S/3W-288	David Property	106-110 Hegenberger Road	February 1994	Monitoring	NA	24	NA	NA	2,587	0.49
J-3	2S/3W-289	David Property	106-110 Hegenberger Road	February 1994	Monitoring	NA	31	NA	NA	2,587	0.49
K-1	2S/3W-28J6	Bigge Crane and Rigging	10700 Bigge Avenue, San Leandro	February 1993	Monitoring (MW-1)	NA	24	NA	NA	1,003	0.19
K-2	2S/3W-28J7	Bigge Crane and Rigging	10700 Bigge Avenue, San Leandro	February 1993	Monitoring (MW-2)	NA	24	NA	NA	1,003	0.19

TABLE 4

**DWR/ACPWA WELL SURVEY SUMMARY
ESTES-GI TRUCKING COMPANY
1750 ADAMS AVENUE, SAN LEANDRO, CALIFORNIA**

Map ID	State Well No.	Well Owner	Approximate Well Location	Installation Date	Well Type	Current Well Use	Total Well Depth (ft bgs)	Screened Interval (ft bgs)	Seal Interval (ft bgs)	Approximate Distance from Former USTs (ft)	Approximate Distance from Former USTs (mi)
L-1	2S/3W-28G6	Budget Rent-a-Car	121 98th Avenue, Oakland	May 1993	Monitoring	NA	11	NA	NA	2,059	0.39
L-2	2S/3W-28G7	Budget Rent-a-Car	121 98th Avenue, Oakland	May 1993	Monitoring	NA	11	NA	NA	2,059	0.39
L-3	2S/3W-28G8	Budget Rent-a-Car	121 98th Avenue, Oakland	May 1993	Monitoring	NA	11	NA	NA	2,059	0.39
L-4	2S/3W-28G9	Budget Rent-a-Car	121 98th Avenue, Oakland	September 1994	Monitoring	NA	11	NA	NA	2,059	0.39
M-1	2S/3W-28F4	Paramount Pest Control	20 Hegenberger Place, Oakland	July 1993	Monitoring	NA	25	NA	NA	2,165	0.41
M-2	2S/3W-28F5	Paramount Pest Control	20 Hegenberger Place, Oakland	July 1993	Monitoring	NA	25	NA	NA	2,165	0.41
M-3	2S/3W-28F6	Paramount Pest Control	20 Hegenberger Place, Oakland	July 1993	Monitoring	NA	25	NA	NA	2,165	0.41
N	2S/3W-28R4	Precision Founders, Inc	414 Hester Street, San Leandro	October 1990	Monitoring	NA	61	NA	NA	1,795	0.34
O-1	2S/3W-28R5	Benkiser Electric	519 Whitney Street, San Leandro	May 1991	Monitoring	NA	11	NA	NA	1,320	0.25
O-2	2S/3W-28R7	Benkiser Electric	519 Whitney Street, San Leandro	March 1991	Monitoring	NA	11	NA	NA	1,320	0.25
O-3	2S/3W-28R8	Benkiser Electric	519 Whitney Street, San Leandro	March 1991	Monitoring	NA	11	NA	NA	1,320	0.25

TABLE 4

**DWR/ACPWA WELL SURVEY SUMMARY
ESTES-GI TRUCKING COMPANY
1750 ADAMS AVENUE, SAN LEANDRO, CALIFORNIA**

Map ID	State Well No.	Well Owner	Approximate Well Location	Installation Date	Well Type	Current Well Use	Total Well Depth (ft bgs)	Screened Interval (ft bgs)	Seal Interval (ft bgs)	Approximate Distance from Former USTs (ft)	Approximate Distance from Former USTs (mi)
P-1	2S/3W-28R9	Bedford Properties	717 Whitney Street, San Leandro	October 1991	Monitoring (MW-1)	NA	17	NA	NA	1,901	0.36
P-2	2S/3W-28R10	Bedford Properties	717 Whitney Street, San Leandro	October 1991	Monitoring (MW-2)	NA	16	NA	NA	1,901	0.36
P-3	2S/3W-28R11	Bedford Properties	717 Whitney Street, San Leandro	October 1991	Monitoring (MW-3)	NA	17	NA	NA	1,901	0.36
P-4	2S/3W-28R12	Bedford Properties	717 Whitney Street, San Leandro	October 1991	Monitoring (MW-4)	NA	17	NA	NA	1,901	0.36
P-5	2S/3W-28R16	Bedford Properties	717 Whitney Street, San Leandro	October 1991	Monitoring (MW-5)	NA	14	NA	NA	1,901	0.36
P-6	2S/3W-28R17	Bedford Properties	717 Whitney Street, San Leandro	October 1991	Monitoring (MW-6)	NA	13	NA	NA	1,901	0.36
P-7	2S/3W-28R18	Eaton Corporation	717 Whitney Street, San Leandro	October 1991	Monitoring	NA	10	NA	NA	1,901	0.36
P-8	2S/3W-28R19	Eaton Corporation	717 Whitney Street, San Leandro	October 1991	Monitoring	NA	10	NA	NA	1,901	0.36
P-9	2S/3W-28R20	Eaton Corporation	717 Whitney Street, San Leandro	October 1991	Monitoring	NA	10	NA	NA	1,901	0.36
Q-1	2S/3W-28R15	C, K, M, B & L	485 Hester Street, San Leandro	January 1993	Monitoring (MW-1)	NA	15	NA	NA	2,270	0.43
Q-2	2S/3W-28R13	C, K, M, B & L	485 Hester Street, San Leandro	January 1993	Monitoring (MW-2)	NA	16	NA	NA	2,270	0.43

**DWR/ACPWA WELL SURVEY SUMMARY
ESTES-GI TRUCKING COMPANY
1750 ADAMS AVENUE, SAN LEANDRO, CALIFORNIA**

Map ID	State Well No.	Well Owner	Approximate Well Location	Installation Date	Well Type	Current Well Use	Total Well Depth (ft bgs)	Screened Interval (ft bgs)	Seal Interval (ft bgs)	Approximate Distance from Former USTs (ft)	Approximate Distance from Former USTs (mi)
Q-3	2S/3W-28R14	C, K, M, B & L	485 Hester Street, San Leandro	January 1993	Monitoring (MW-3)	NA	16	NA	NA	2,270	0.43
R	2S/3W-28Q11	Port of Oakland	10505 Doolittle Drive, Oakland	April 1991	Monitoring	NA	20	NA	NA	2,270	0.43
S	2S/3W-28R23	Kaiser Aerotech	480 Hester Street, San Leandro	March 1997	Monitoring	NA	10	NA	NA	2,059	0.39
T*	2S/3W-28L	Former Lew Galbraith Golf Course	Port of Oakland	November 1995	Monitoring	NA	NA	NA	NA	2,218	0.42

Notes and Abbreviations:

Well information provided by the State of California Department of Water Resources (DWR) and Alameda County Public Works Agency (ACPWA)

Map ID = Well identification letter refers to well location on Figure 4.

State Well Number = California State well identification number as recorded by the Department of Water Resources in Sacramento, California.

Approximate Well Location = Well locations plotted according to the information provided on the DWR *Well Completion Reports* and additional research.

Well Type = stated well use from *Well Completion Report* provided by DWR and ACPWA

NA = Not available

ft bgs = feet below ground surface

southwest of the site. Since the wells are scattered throughout the course, the Map ID was plotted near the northeastern boundary to be conservative.

APPENDIX A

AGENCY CORRESPONDENCE

ALAMEDA COUNTY
HEALTH CARE SERVICES

AGENCY

DAVID J. KEARS, Agency Director



ENVIRONMENTAL HEALTH SERVICES
ENVIRONMENTAL PROTECTION
1131 Harbor Bay Parkway, Suite 250
Alameda, CA 94502-6577
(510) 567-6700
FAX (510) 337-9335

January 22, 2009

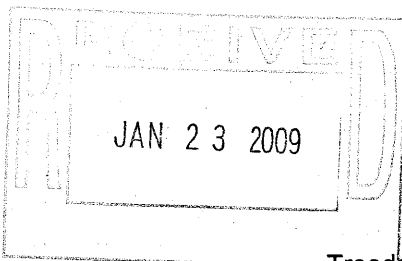

Mike Rogers
ABF Freight Systems
P.O. Box 10048
Fort Smith, AR 72917-0048

Treedark Real Estate Corp
3801 Greenwood Road
Fort Smith, AR 72903

Estes Terminals California
3901 W. Broad Street
Richmond, VA 23230

Subject: Fuel Leak Case No. RO0000442 and GeoTracker Global ID T0600100900, GI Trucking Company, 1750 Adams Avenue, San Leandro, CA 94577

Dear Responsible Parties:

Alameda County Environmental Health (ACEH) staff has reviewed the case file for the above-referenced site including the recently submitted document entitled, "Annual 2007 Monitoring Report and Preferential Pathway Study," dated March 29, 2007, which was prepared by Cambria Environmental Technology, Inc. for the subject site. Cambria conducted groundwater sampling of the existing monitoring well network, a well survey and preferential pathway study to determine whether contaminants may be preferentially migrating off-site. Groundwater sampling analytical results detected sheen in RW-1. Cambria identified the closest well down-gradient to be over 1,000 feet away. Therefore, Cambria concluded that "it is unlikely that any of the wells at site K or any other downgradient site have been or are currently being impacted by the onsite groundwater plume." Cambria subsequently recommended that this case be considered a low risk groundwater case since "no significant migration of LNAPL or diesel plume is or has occurred at the site."

Based on the analytical results to date, which still identifies the presence of sheen on top of the groundwater at the site, ACEH cannot consider case closure for the subject site at this time since sites with sheen (i.e. free product) are not considered low risk groundwater cases. Additionally, the source area is not adequately characterized and the free and dissolved phase contaminant plumes are undefined. This decision to deny closure is subject to appeal to the State Water Resources Control Board (SWRCB), pursuant to Section 25299.39.2(b) of the Health and Safety Code (Thompson-Richter Underground Storage Tank Reform Act - Senate Bill 562). Please contact the SWRCB Underground Storage Tank Program at (916) 341-5851 for information regarding the appeal process.

ACEH requests that you address the following technical comments and send us the technical work plan and reports requested below.

TECHNICAL COMMENTS

1. **Contaminant Source Area Characterization** – In June 1999, four 12,000-gallon fiberglass USTs were removed from the site. Significantly elevated concentrations of total petroleum

hydrocarbons (TPH) as diesel (d) were detected in excavation sidewall soil samples ranging from 85 mg/kg to 4,500 mg/kg. Additional excavation of contaminated soil was conducted to remove the significantly contaminated soil. Confirmation sidewall soil samples detected TPH-d ranging from 620 mg/kg to 2,400 mg/kg. Although naphthalene was not detected at the site, the laboratory detection limit that was reported was significantly elevated ranging from <10 mg/kg to <20 mg/kg. Please note that the Regional Water Quality Control Board's (RWQCB) Environmental Screening Levels (ESLs) for naphthalene and TPH-d are 1.3 mg/kg and 83 mg/kg, respectively, indicating that the site is not adequately characterized and poses a potential risk to human health and the environment. Please propose a scope of work to address the above-mentioned concerns and submit a work plan due by the date specified below.

2. **Site Conceptual Model** – At this time, it may be advantageous to develop a site conceptual model (SCM), which synthesizes all the analytical data and evaluates all potential exposure pathways and potential receptors that may exist at the site, including identifying or developing site cleanup objectives and goals. At a minimum, the SCM should include:

- (1) Local and regional plan view maps that illustrate the location of sources (former facilities, piping, tanks, etc.) extent of contamination, direction and rate of groundwater flow, potential preferential pathways, and locations of receptors;
- (2) Geologic cross section maps that illustrate subsurface features, man-made conduits, and lateral and vertical extent of contamination;
- (3) Plots of chemical concentrations versus time;
- (4) Plots of chemical concentrations versus distance from the source;
- (5) Summary tables of chemical concentrations in different media (i.e. soil, groundwater, and soil vapor); and
- (6) Well logs, boring logs, and well survey maps;
- (7) Discussion of likely contaminant fate and transport.

If data gaps (i.e. potential contaminant volatilization to indoor air or contaminant leaching to groundwater, etc.) are identified in the SCM, please include a proposed scope of work to address those data gaps in the work plan due by the date specified below. Please note that the work plan must address all technical comments presented in this correspondence and all data gaps identified in the SCM.

3. **Groundwater Contaminant Plume Monitoring** – Currently, annual groundwater sampling is being conducted. Since sheen continues to be present at the site, please increase the groundwater monitoring frequency to semi-annual and submit a report due by the dates specified below. Also, include naphthalene to the analytical sampling suite.

NOTIFICATION OF FIELDWORK ACTIVITIES

Please schedule and complete the fieldwork activities by the date specified below and provide ACEH with at least three (3) business days notification prior to conducting the fieldwork, including routine groundwater sampling.

TECHNICAL REPORT REQUEST

Please submit technical reports to ACEH (Attention: Paresh Khatri), according to the following schedule:

- **April 22, 2009** – Site Conceptual Model & Soil and Water Investigation Work Plan
- **April 30, 2009** – Semi-annual Monitoring Report (1st Quarter 2009)
- **October 30, 2009** – Semi-annual Monitoring Report (3rd Quarter 2009)

These reports are being requested pursuant to California Health and Safety Code Section 25296.10. 23 CCR Sections 2652 through 2654, and 2721 through 2728 outline the responsibilities of a responsible party in response to an unauthorized release from a petroleum UST system, and require your compliance with this request.

ELECTRONIC SUBMITTAL OF REPORTS

ACEH's Environmental Cleanup Oversight Programs (LOP and SLIC) require submission of reports in electronic form. The electronic copy replaces paper copies and is expected to be used for all public information requests, regulatory review, and compliance/enforcement activities. Instructions for submission of electronic documents to the Alameda County Environmental Cleanup Oversight Program FTP site are provided on the attached "Electronic Report Upload Instructions." Submission of reports to the Alameda County FTP site is an addition to existing requirements for electronic submittal of information to the State Water Resources Control Board (SWRCB) GeoTracker website. In September 2004, the SWRCB adopted regulations that require electronic submittal of information for all groundwater cleanup programs. For several years, responsible parties for cleanup of leaks from underground storage tanks (USTs) have been required to submit groundwater analytical data, surveyed locations of monitoring wells, and other data to the GeoTracker database over the Internet. Beginning July 1, 2005, these same reporting requirements were added to Spills, Leaks, Investigations, and Cleanup (SLIC) sites. Beginning July 1, 2005, electronic submittal of a complete copy of all reports for all sites is required in GeoTracker (in PDF format). Please visit the SWRCB website for more information on these requirements (http://www.swrcb.ca.gov/ust/electronic_submittal/report_rqmts.shtml).

PERJURY STATEMENT

All work plans, technical reports, or technical documents submitted to ACEH must be accompanied by a cover letter from the responsible party that states, at a minimum, the following: "I declare, under penalty of perjury, that the information and/or recommendations contained in the attached document or report is true and correct to the best of my knowledge." This letter must be signed by an officer or legally authorized representative of your company. Please include a cover letter satisfying these requirements with all future reports and technical documents submitted for this fuel leak case.

PROFESSIONAL CERTIFICATION & CONCLUSIONS/RECOMMENDATIONS

The California Business and Professions Code (Sections 6735, 6835, and 7835.1) requires that work plans and technical or implementation reports containing geologic or engineering evaluations and/or judgments be performed under the direction of an appropriately registered or certified professional. For your submittal to be considered a valid technical report, you are to present site specific data, data interpretations, and recommendations prepared by an appropriately licensed professional and include the professional registration stamp, signature, and statement of professional certification. Please ensure all that all technical reports submitted for this fuel leak case meet this requirement.

UNDERGROUND STORAGE TANK CLEANUP FUND

Please note that delays in investigation, later reports, or enforcement actions may result in your becoming ineligible to receive grant money from the state's Underground Storage Tank Cleanup Fund (Senate Bill 2004) to reimburse you for the cost of cleanup.

AGENCY OVERSIGHT

If it appears as though significant delays are occurring or reports are not submitted as requested, we will consider referring your case to the Regional Board or other appropriate agency, including the County District Attorney, for possible enforcement actions. California Health and Safety Code, Section 25299.76 authorizes enforcement including administrative action or monetary penalties of up to \$10,000 per day for each day of violation.

If you have any questions, please call me at (510) 383-1767 or send me an electronic mail message at steven.plunkett@acgov.org.

Sincerely,



Steven Plunkett
Hazardous Materials Specialist

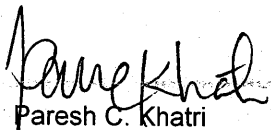

Paresh C. Khatri
Hazardous Materials Specialist

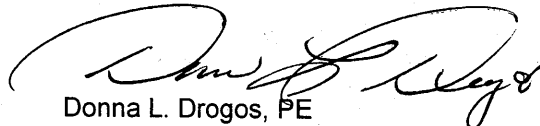

Donna L. Drogos, PE
Supervising Hazardous Materials Specialist

Enclosure: ACEH Electronic Report Upload (ftp) Instructions

cc: Conestoga Rovers & Associates (formerly Cambria Environmental Technology, Inc.), 5900 Hollis
Street, Suite A, Emeryville, CA 94608
Donna Drogos, ACEH
Steven Plunkett, ACEH
File

Alameda County Environmental Cleanup Oversight Programs (LOP and SLIC)	ISSUE DATE: July 5, 2005
	REVISION DATE: December 16, 2005
	PREVIOUS REVISIONS: October 31, 2005
SECTION: Miscellaneous Administrative Topics & Procedures	SUBJECT: Electronic Report Upload (ftp) Instructions

Effective **January 31, 2006**, the Alameda County Environmental Cleanup Oversight Programs (LOP and SLIC) require submission of all reports in electronic form to the county's ftp site. Paper copies of reports will no longer be accepted. The electronic copy replaces the paper copy and will be used for all public information requests, regulatory review, and compliance/enforcement activities.

REQUIREMENTS

- Entire report including cover letter must be submitted to the ftp site as a **single portable document format (PDF) with no password protection**. (Please do not submit reports as attachments to electronic mail.)
- It is **preferable** that reports be converted to PDF format from their original format, (e.g., Microsoft Word) rather than scanned.
- Signature pages and perjury statements **must** be included and have either original or electronic signature.
- **Do not password protect the document**. Once indexed and inserted into the correct electronic case file, the document will be secured in compliance with the County's current security standards and a password. **Documents with password protection will not be accepted.**
- Each page in the PDF document should be rotated in the direction that will make it easiest to read on a computer monitor.
- Reports must be named and saved using the following naming convention:
RO#_Report Name_Year-Month-Date (e.g., RO#5555_WorkPlan_2005-06-14)

Additional Recommendations

- A separate copy of the tables in the document should be submitted by e-mail to your Caseworker in **Excel** format. These are for use by assigned Caseworker only.

Submission Instructions

- 1) Obtain User Name and Password:
 - a) Contact the Alameda County Environmental Health Department to obtain a User Name and Password to upload files to the ftp site.
 - i) Send an e-mail to dehloptoxic@acgov.org
or
 - ii) Send a fax on company letterhead to (510) 337-9335, to the attention of Alicia Lam-Finneke.
 - b) In the subject line of your request, be sure to include "**ftp PASSWORD REQUEST**" and in the body of your request, include the **Contact Information, Site Addresses, and the Case Numbers (RO# available in Geotracker) you will be posting for.**
- 2) Upload Files to the ftp Site
 - a) Using Internet Explorer (IE4+), go to <ftp://alcoftp1.acgov.org>
 - (i) Note: Netscape and Firefox browsers will not open the FTP site.
 - b) Click on File, then on Login As.
 - c) Enter your User Name and Password. (Note: Both are Case Sensitive.)
 - d) Open "My Computer" on your computer and navigate to the file(s) you wish to upload to the ftp site.
 - e) With both "My Computer" and the ftp site open in separate windows, drag and drop the file(s) from "My Computer" to the ftp window.
- 3) Send E-mail Notifications to the Environmental Cleanup Oversight Programs
 - a) Send email to dehloptoxic@acgov.org notify us that you have placed a report on our ftp site.
 - b) Copy your Caseworker on the e-mail. Your Caseworker's e-mail address is the entire first name then a period and entire last name at acgov.org. (e.g., firstname.lastname@acgov.org)
 - c) The subject line of the e-mail must start with the RO# followed by **Report Upload**. (e.g., Subject: RO1234 Report Upload)

APPENDIX B

BORING/ WELL LOGS

LOGGED BY LDF DATE DRILLED 12-31-86 BORING DIAMETER 8" BORING NO. 6-1

Depth, ft.	Sample No. and type	Symbol	SOIL DESCRIPTION	Unified Soil Classification	Blows/foot 300 ft-lbs.	Q _u - 1. s. f. Penetration	Dry Density p.c.f.	Moisture & dry wt.	MISC. LAB RESULTS
2			A.C. & A. B. Dark grey sl. sandy CLAY, moist (Dark brown, very sandy)	CL					<div style="border: 1px solid black; padding: 5px; display: inline-block;">M-1</div>
4	1								
6									
8	2		Dark grey silty CLAY, moist (Tan mottling, wet)	CH					
10									
12			Buff & olive green sandy CLAY, wet	CL					
14									
16									
18			(Light brown)						
20									
22									
24			Interlayered brown & grey silty CLAY, moist	CH					
26									
BOH 25 feet Well Construction Details: Set 25' of 2" diameter sch.40 PVC Casing, lower 19' perforated. Aquarium sand backfill to 5', cement seal to surface. Installed vault box and locking well cap.									

LOGGED BY LDP DATE DRILLED 12-31-86 BORING DIAMETER 8" BORING NO. M-2

Depth, ft.	Sample No. and type	Symbol	SOIL DESCRIPTION	Unified Soil Classification	Blows/foot 350 ft-lbs.	Q _u - t. s. f.	Penetration	Dry Density	P.C.F.	Moisture % dry wt.	MISC. LAB RESULTS
2			A.C. & A.B.								<div style="border: 1px solid black; padding: 5px; display: inline-block;">M-2</div>
4			Blue-green silty CLAY, moist, minor fine sand (brown)	CL							
6	1		(Grey-green, wet, minor GRAVEL)								
8											
10	2										
12											
14			Mottled buff and olive green sandy CLAY, wet	CL							
16											
18											
20			Mottled grey & brown clayey fine SAND, wet	SC							
22											
24			Blue-grey silty CLAY, moist (brown)	CH							
26			BOH 25 feet Well Construction Details: Set 25' of 2" diameter sch.40 PVC casing, lower 19' perforated, aquarium sand backfill to 5', concrete seal to surface. Installed vault box and locking well cap.								

LOGGED BY LDP DATE DRILLED 12-31-86 BORING DIAMETER 8" BORING NO. 1-3

Depth, ft.	Sample No. and type	Symbol	SOIL DESCRIPTION	Unified Soil Classification	Blows/foot 300 ft-lbs.	Q _u - t. s. i. Penetrometer	Dry Density p.c.f.	Moisture % dry wt.	MISC. LAB RESULTS
2			A.C. & A.B.						M-3
2			Blue-grey very silty CLAY, moist	CH					
4	1								
6									
8	2		(Mottled olive green and grey, very moist)						
10									
12									
14			Buff and olive green sandy CLAY, wet	CL					
16									
18			(tan)						
20									
22			Lt brown fine sandy SILT, wet	ML					
24									
26			Olive green and grey silty CLAY, moist	CH					
			BOH 25 feet Well Construction Details: Set 25' of 2" diameter sch. 40 PVC casing, lower 19' perforated. Aquarium sand backfill to 5', cement seal to surface. Installed vault box and locking well cap.						

LOGGED BY LLP DATE DRILL 12-21-86 BORING DIAMETER 8" BORING NO. 1--

Depth, ft.	Sample No. and Type	Symbol	SOIL DESCRIPTION	Unified Soil Classification	Blows/foot 250 ft.-lbs.	Q _u - t. s. f. Penetrometer	Dry Density p.c.f.	Moisture % dry wt.	MISC. LAB. RESULTS
2			A.C. & A.E. Brown clayey med. GRAVEL, moist	GC					M-4
4			Brown very sandy SILT, moist	ML					
6	1		Dk. brown silty CLAY, moist	CH					
8									
10	2		↓ (Grey-green, Very moist, minor GRAVEL, minor orange oxide staining)						
12									
14	3		Mottled buff, olive green, olive brown, very sandy CLAY with minor fine gravel, wet	CL					
16									
18									
20	4		Lt. brown silty very fine SAND very moist to wet	SB					
22									
24									
26	5		Olive green silty CLAY, moist, (Brown, minor fine GRAVEL)	CH					
28									
			BORE 26 1/2 feet Well Construction Details: Set 25' of 2" diameter, Sch. 40 PVC casing, lower 19' perforated. Aquarium sand backfill to 5'. Cement seal to surface. Installed vault box and locking well cap.						

PAVLAK & Associates

FIGURE NO. 5 - BORING LOG

Inst date : 6/6/96

RW-2

4-inch dia
PVC

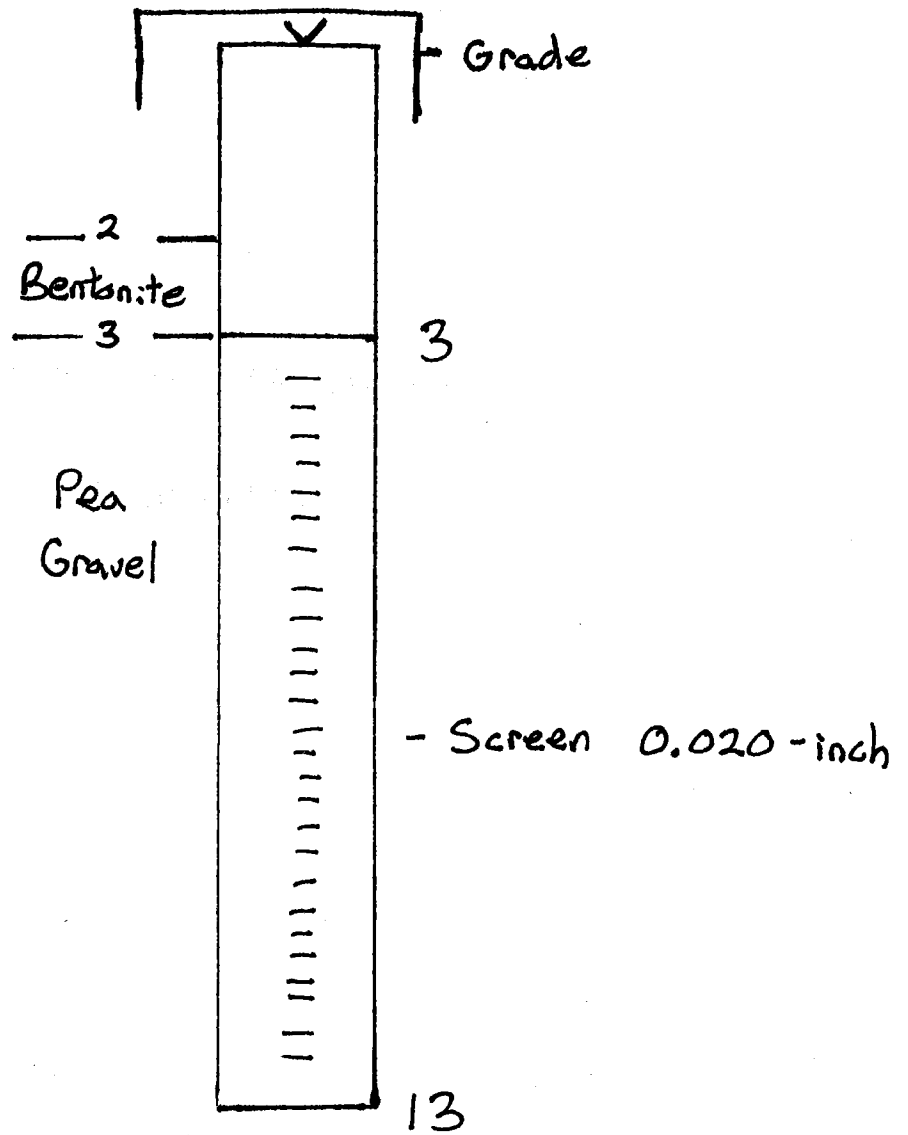

APPENDIX C

CERTIFIED ANALYTICAL REPORTS
AND CHAIN OF CUSTODY DOCUMENTATION



McC Campbell Analytical, Inc.

"When Quality Counts"

1534 Willow Pass Road, Pittsburg, CA 94565-1701
Web: www.mcccampbell.com E-mail: main@mcccampbell.com
Telephone: 877-252-9262 Fax: 925-252-9269

Conestoga-Rovers & Associates 5900 Hollis St, Suite A Emeryville, CA 94608	Client Project ID: #631000; Estes-GI Trucking Company	Date Sampled: 04/21/09
	Client Contact: Bob Foss	Date Received: 04/21/09
	Client P.O.:	Date Reported: 04/27/09
		Date Completed: 04/24/09

WorkOrder: 0904518

April 27, 2009

Dear Bob:

Enclosed within are:

- 1) The results of the **5** analyzed samples from your project: **#631000; Estes-GI Trucking Compa**
- 2) A QC report for the above samples,
- 3) A copy of the chain of custody, and
- 4) An invoice for analytical services.

All analyses were completed satisfactorily and all QC samples were found to be within our control limits.

If you have any questions or concerns, please feel free to give me a call. Thank you for choosing

McC Campbell Analytical Laboratories for your analytical needs.

Best regards,

Angela Rydelius
Laboratory Manager
McC Campbell Analytical, Inc.



McCAMPBELL ANALYTICAL, INC.
 1534 WILLOW PASS ROAD
 PITTSBURG, CA 94565-1701
 Website: www.mccampbell.com Email: main@mccampbell.com
 Telephone: (877) 252-9262 Fax: (925) 252-9269

CHAIN OF CUSTODY RECORD

TURN AROUND TIME

RUSH 24 HR 48 HR 72 HR 5 DAY

GeoTracker EDF PDF Excel Write On (DW)

Check if sample is effluent and "J" flag is required

Report To: **Bob Foss** Bill To: **Conestoga-Rovers & Associates**
 Company: **Conestoga-Rovers & Associates**
5900 Hollis St., Ste. A
Emeryville, CA
 Tele: (510) 420-3348 E-Mail: bfoss@crworld.com
 Project #: **631000** Fax: (510) 420-9170
 Project Location: **1750 Adams Ave., San Leandro, CA**
 Project Name: **Estes-G.I. Trucking Company**
 Sampler Signature: **Muskan Environmental Sampling**

Analysis Request

Other

Comments

BTEX & TPH as Gas (602 / 8021 / 8015)	
TPH as Diesel (8015) / with silica gel / no cleanup	
Total Petroleum Oil & Grease (1664 / 5520 E/B&F)	
Total Petroleum Hydrocarbons (418.1)	
EPA 502.2 / 601 / 8010 / 8021 (HVOCs)	
MTBE / BTEX ONLY (EPA 602 / 8021)	
EPA 505 / 608 / 8081 (CI Pesticides)	
EPA 608 / 8082 PCB's ONLY; Aroclors / Congeners	
EPA 507 / 8141 (NP Pesticides)	
EPA 515 / 8151 (Acidic CI Herbicides)	
EPA 524.2 / 624 / 8260 (VOCs)	
EPA 525.2 / 625 / 8270 (SVOCs)	
EPA 8270 SIM / 8310 (PAHs / PNAs)	
CAM 17 Metals (200.7 / 200.8 / 6010 / 6020)	
LUFT 5 Metals (200.7 / 200.8 / 6010 / 6020)	
Lead (200.7 / 200.8 / 6010 / 6020)	
Naphthalene by 22605	

Filter
Samples
for Metals
analysis:
Yes / No

SAMPLE ID	LOCATION/ Field Point Name	SAMPLING		# Containers	Type Containers	MATRIX					METHOD PRESERVED							
		Date	Time			Water	Soil	Air	Sludge	Other	ICE	HCL	HNO ₃	Other				
MW-2		4-21-09	11:30	4	von Amb	X						X	X					
MW-3			12:00									X	X					
MW-5			11:00									X	X					
RW-1			1:00									X	X					
RW-2			12:30	X	X							X	X					
TB				1	vac	X						X	X					

Naphthalene by 22605

hd

+
+
+
+
+
+
+

Relinquished By: <i>[Signature]</i>	Date: 4/21/09	Time: 1355	Received By: <i>[Signature]</i>
Relinquished By: <i>[Signature]</i>	Date: _____	Time: _____	Received By: _____
Relinquished By: _____	Date: _____	Time: _____	Received By: _____

ICE/P **4.2**
 GOOD CONDITION
 HEAD SPACE ABSENT
 DECHLORINATED IN LAB
 APPROPRIATE CONTAINERS
 PRESERVED IN LAB _____
 COMMENTS:
 VOAS O&G METALS OTHER
 PRESERVATION pH<2

McC Campbell Analytical, Inc.



1534 Willow Pass Rd
Pittsburg, CA 94565-1701
(925) 252-9262

CHAIN-OF-CUSTODY RECORD

WorkOrder: 0904518

ClientCode: CETE

WriteOn
 EDF
 Excel
 Fax
 Email
 HardCopy
 ThirdParty
 J-flag

Report to:	Bob Foss	Email: bfoss@croworld.com, mwerner@crowo	Bill to:	Accounts Payable	Requested TAT: 5 days
	Conestoga-Rovers & Associates	cc:		Conestoga-Rovers & Associates	Date Received: 04/21/2009
	5900 Hollis St, Suite A	PO:		5900 Hollis St, Ste. A	Date Printed: 04/21/2009
	Emeryville, CA 94608	ProjectNo: #631000; Estes-GI Trucking Company		Emeryville, CA 94608	
	(510) 420-0700 FAX (510) 420-9170				

Lab ID	Client ID	Matrix	Collection Date	Hold	Requested Tests (See legend below)											
					1	2	3	4	5	6	7	8	9	10	11	12
0904518-001	MW-2	Water	4/21/2009 11:30	<input type="checkbox"/>	C	A	A	B								
0904518-002	MW-3	Water	4/21/2009 12:00	<input type="checkbox"/>	C	A		B								
0904518-003	MW-5	Water	4/21/2009 11:00	<input type="checkbox"/>	C	A		B								
0904518-004	RW-1	Water	4/21/2009 13:00	<input type="checkbox"/>	C	A		B								
0904518-005	RW-2	Water	4/21/2009 12:30	<input type="checkbox"/>	C	A		B								

Test Legend:

1	8260VOC_W	2	G-MBTEX_W	3	PREFD REPORT	4	TPH(DMO)WSG_W	5	
6		7		8		9		10	
11		12							

Prepared by: Maria Venegas

Comments:

NOTE: Soil samples are discarded 60 days after results are reported unless other arrangements are made (Water samples are 30 days).
Hazardous samples will be returned to client or disposed of at client expense.



Sample Receipt Checklist

Client Name: **Conestoga-Rovers & Associates**
Project Name: **#631000; Estes-GI Trucking Company**
WorkOrder N°: **0904518** Matrix Water

Date and Time Received: **04/21/09 2:42:00 PM**
Checklist completed and reviewed by: **Maria Venegas**
Carrier: Client Drop-In

Chain of Custody (COC) Information

Chain of custody present?	Yes <input checked="" type="checkbox"/>	No <input type="checkbox"/>
Chain of custody signed when relinquished and received?	Yes <input checked="" type="checkbox"/>	No <input type="checkbox"/>
Chain of custody agrees with sample labels?	Yes <input checked="" type="checkbox"/>	No <input type="checkbox"/>
Sample IDs noted by Client on COC?	Yes <input checked="" type="checkbox"/>	No <input type="checkbox"/>
Date and Time of collection noted by Client on COC?	Yes <input checked="" type="checkbox"/>	No <input type="checkbox"/>
Sampler's name noted on COC?	Yes <input checked="" type="checkbox"/>	No <input type="checkbox"/>

Sample Receipt Information

Custody seals intact on shipping container/cooler?	Yes <input type="checkbox"/>	No <input type="checkbox"/>	NA <input checked="" type="checkbox"/>
Shipping container/cooler in good condition?	Yes <input checked="" type="checkbox"/>	No <input type="checkbox"/>	
Samples in proper containers/bottles?	Yes <input checked="" type="checkbox"/>	No <input type="checkbox"/>	
Sample containers intact?	Yes <input checked="" type="checkbox"/>	No <input type="checkbox"/>	
Sufficient sample volume for indicated test?	Yes <input checked="" type="checkbox"/>	No <input type="checkbox"/>	

Sample Preservation and Hold Time (HT) Information

All samples received within holding time?	Yes <input checked="" type="checkbox"/>	No <input type="checkbox"/>	
Container/Temp Blank temperature	Cooler Temp: 4.2°C		NA <input type="checkbox"/>
Water - VOA vials have zero headspace / no bubbles?	Yes <input checked="" type="checkbox"/>	No <input type="checkbox"/>	No VOA vials submitted <input type="checkbox"/>
Sample labels checked for correct preservation?	Yes <input checked="" type="checkbox"/>	No <input type="checkbox"/>	
TTLC Metal - pH acceptable upon receipt (pH<2)?	Yes <input type="checkbox"/>	No <input type="checkbox"/>	NA <input checked="" type="checkbox"/>
Samples Received on Ice?	Yes <input checked="" type="checkbox"/>	No <input type="checkbox"/>	

(Ice Type: WET ICE)

* NOTE: If the "No" box is checked, see comments below.

Client contacted: _____ Date contacted: _____ Contacted by: _____

Comments:



McC Campbell Analytical, Inc.

"When Quality Counts"

1534 Willow Pass Road, Pittsburg, CA 94565-1701
 Web: www.mcccampbell.com E-mail: main@mcccampbell.com
 Telephone: 877-252-9262 Fax: 925-252-9269

Conestoga-Rovers & Associates 5900 Hollis St, Suite A Emeryville, CA 94608	Client Project ID: #631000; Estes-GI Trucking Company	Date Sampled: 04/21/09
	Client Contact: Bob Foss	Date Received: 04/21/09
	Client P.O.:	Date Extracted: 04/22/09-04/24/09
		Date Analyzed 04/22/09-04/24/09

Volatle Organics by P&T and GC/MS*

Extraction method: SW5030B

Analytical methods: SW8260B

Work Order: 0904518

Lab ID	Client ID	Matrix	Naphthalene	DF	% SS
001C	MW-2	W	ND	1	95
002C	MW-3	W	ND	1	95
003C	MW-5	W	ND	1	95
004C	RW-1	W	ND,b6	1	100
005C	RW-2	W	ND,b6	1	99

Reporting Limit for DF =1; ND means not detected at or above the reporting limit	W	0.5	µg/L
	S	NA	NA

* water and vapor samples and all TCLP & SPLP extracts are reported in µg/L, soil/sludge/solid samples in µg/kg, wipe samples in µg/wipe, product/oil/non-aqueous liquid samples in mg/L.

ND means not detected above the reporting limit; N/A means analyte not applicable to this analysis.

surrogate diluted out of range or surrogate coelutes with another peak.

b6) lighter than water immiscible sheen/product is present



McC Campbell Analytical, Inc.

"When Quality Counts"

1534 Willow Pass Road, Pittsburg, CA 94565-1701
Web: www.mcccampbell.com E-mail: main@mcccampbell.com
Telephone: 877-252-9262 Fax: 925-252-9269

Conestoga-Rovers & Associates 5900 Hollis St, Suite A Emeryville, CA 94608	Client Project ID: #631000; Estes-GI Trucking Company	Date Sampled: 04/21/09
	Client Contact: Bob Foss	Date Received: 04/21/09
	Client P.O.:	Date Extracted: 04/22/09-04/24/09
		Date Analyzed 04/22/09-04/24/09

Gasoline Range (C6-C12) Volatile Hydrocarbons as Gasoline with BTEX and MTBE*

Extraction method SW5030B

Analytical methods SW8021B/8015Bm

Work Order: 0904518

Lab ID	Client ID	Matrix	TPH(g)	MTBE	Benzene	Toluene	Ethylbenzene	Xylenes	DF	% SS
001A	MW-2	W	ND	---	ND	ND	ND	ND	1	105
002A	MW-3	W	ND	---	ND	ND	ND	ND	1	106
003A	MW-5	W	ND	---	ND	ND	ND	ND	1	92
004A	RW-1	W	160,d7,b6	---	ND	ND	ND	ND	1	99
005A	RW-2	W	ND,b6	---	ND	ND	ND	ND	1	105

Reporting Limit for DF =1; ND means not detected at or above the reporting limit	W	50	5.0	0.5	0.5	0.5	0.5	µg/L
	S	1.0	0.05	0.005	0.005	0.005	0.005	mg/Kg

* water and vapor samples and all TCLP & SPLP extracts are reported in ug/L, soil/sludge/solid samples in mg/kg, wipe samples in µg/wipe, product/oil/non-aqueous liquid samples in mg/L.

cluttered chromatogram; sample peak coelutes with surrogate peak.

+The following descriptions of the TPH chromatogram are cursory in nature and McC Campbell Analytical is not responsible for their interpretation:

b6) lighter than water immiscible sheen/product is present
d7) strongly aged gasoline or diesel range compounds are significant in the TPH(g) chromatogram



McC Campbell Analytical, Inc.

"When Quality Counts"

1534 Willow Pass Road, Pittsburg, CA 94565-1701
Web: www.mccampbell.com E-mail: main@mccampbell.com
Telephone: 877-252-9262 Fax: 925-252-9269

Conestoga-Rovers & Associates 5900 Hollis St, Suite A Emeryville, CA 94608	Client Project ID: #631000; Estes-GI Trucking Company	Date Sampled: 04/21/09
	Client Contact: Bob Foss	Date Received: 04/21/09
	Client P.O.:	Date Extracted: 04/21/09
		Date Analyzed: 04/21/09-04/22/09

Total Extractable Petroleum Hydrocarbons with Silica Gel Clean-Up*

Extraction method: SW3510C/3630C

Analytical methods: SW8015B

Work Order: 0904518

Lab ID	Client ID	Matrix	TPH-Diesel (C10-C23)	TPH-Motor Oil (C18-C36)	DF	% SS
0904518-001B	MW-2	W	ND	ND	1	103
0904518-002B	MW-3	W	ND	ND	1	103
0904518-003B	MW-5	W	ND	ND	1	104
0904518-004B	RW-1	W	50,000,e3,b6	23,000	10	101
0904518-005B	RW-2	W	6000,e3,b6	3000	1	105

Reporting Limit for DF =1; ND means not detected at or above the reporting limit	W	50	250	µg/L
	S	NA	NA	mg/Kg

* water samples are reported in µg/L, wipe samples in µg/wipe, soil/solid/sludge samples in mg/kg, product/oil/non-aqueous liquid samples in mg/L, and all DISTLC / STLC / SPLP / TCLP extracts are reported in µg/L.

#) cluttered chromatogram resulting in coeluted surrogate and sample peaks, or; surrogate peak is on elevated baseline, or; surrogate has been diminished by dilution of original extract; &) low or no surrogate due to matrix interference.

+The following descriptions of the TPH chromatogram are cursory in nature and McC Campbell Analytical is not responsible for their interpretation:

- b6) lighter than water immiscible sheen/product is present
- e3) aged diesel is significant



QC SUMMARY REPORT FOR SW8015B

W.O. Sample Matrix: Water

QC Matrix: Water

BatchID: 42773

WorkOrder: 0904518

EPA Method SW8015B		Extraction SW3510C/3630C							Spiked Sample ID: N/A			
Analyte	Sample	Spiked	MS	MSD	MS-MSD	LCS	LCSD	LCS-LCSD	Acceptance Criteria (%)			
	µg/L	µg/L	% Rec.	% Rec.	% RPD	% Rec.	% Rec.	% RPD	MS / MSD	RPD	LCS/LCSD	RPD
TPH-Diesel (C10-C23)	N/A	1000	N/A	N/A	N/A	100	100	0	N/A	N/A	70 - 130	30
%SS:	N/A	2500	N/A	N/A	N/A	107	107	0	N/A	N/A	70 - 130	30

All target compounds in the Method Blank of this extraction batch were ND less than the method RL with the following exceptions:
NONE

BATCH 42773 SUMMARY

Lab ID	Date Sampled	Date Extracted	Date Analyzed	Lab ID	Date Sampled	Date Extracted	Date Analyzed
0904518-001B	04/21/09 11:30 AM	04/21/09	04/21/09 9:41 PM	0904518-002B	04/21/09 12:00 PM	04/21/09	04/21/09 10:49 PM
0904518-003B	04/21/09 11:00 AM	04/21/09	04/21/09 11:57 PM	0904518-004B	04/21/09 1:00 PM	04/21/09	04/22/09 2:14 AM
0904518-005B	04/21/09 12:30 PM	04/21/09	04/22/09 4:31 AM				

MS = Matrix Spike; MSD = Matrix Spike Duplicate; LCS = Laboratory Control Sample; LCSD = Laboratory Control Sample Duplicate; RPD = Relative Percent Deviation.

% Recovery = 100 * (MS-Sample) / (Amount Spiked); RPD = 100 * (MS - MSD) / ((MS + MSD) / 2).

MS / MSD spike recoveries and / or %RPD may fall outside of laboratory acceptance criteria due to one or more of the following reasons: a) the sample is inhomogenous AND contains significant concentrations of analyte relative to the amount spiked, or b) the spiked sample's matrix interferes with the spike recovery.

N/A = not enough sample to perform matrix spike and matrix spike duplicate.

NR = analyte concentration in sample exceeds spike amount for soil matrix or exceeds 2x spike amount for water matrix or sample diluted due to high matrix or analyte content.



QC SUMMARY REPORT FOR SW8260B

W.O. Sample Matrix: Water

QC Matrix: Water

BatchID: 42801

WorkOrder: 0904518

Analyte	Extraction SW5030B			Spiked Sample ID: 0904493-002D								
	Sample µg/L	Spiked µg/L	MS % Rec.	MSD % Rec.	MS-MSD % RPD	LCS % Rec.	LCSD % Rec.	LCS-LCSD % RPD	Acceptance Criteria (%)			
tert-Amyl methyl ether (TAME)	ND<100	10	95.6	96	0.392	97.2	99.1	1.92	70 - 130	30	70 - 130	30
Benzene	ND<100	10	113	112	0.539	105	105	0	70 - 130	30	70 - 130	30
t-Butyl alcohol (TBA)	ND<400	50	73.2	77.3	5.43	91.7	94	2.58	70 - 130	30	70 - 130	30
Chlorobenzene	ND<100	10	114	115	0.658	107	106	1.23	70 - 130	30	70 - 130	30
1,2-Dibromoethane (EDB)	ND<100	10	123	126	2.14	115	115	0	70 - 130	30	70 - 130	30
1,2-Dichloroethane (1,2-DCA)	ND<100	10	90.7	90.1	0.662	104	107	2.21	70 - 130	30	70 - 130	30
1,1-Dichloroethene	ND<100	10	70.7	71.6	1.34	88.4	87.5	0.982	70 - 130	30	70 - 130	30
Diisopropyl ether (DIPE)	ND<100	10	103	103	0	94.3	95.7	1.47	70 - 130	30	70 - 130	30
Ethyl tert-butyl ether (ETBE)	ND<100	10	114	113	0.216	104	106	2.08	70 - 130	30	70 - 130	30
Methyl-t-butyl ether (MTBE)	ND<100	10	102	101	0.756	97.4	101	3.25	70 - 130	30	70 - 130	30
Toluene	ND<100	10	125	125	0	115	115	0	70 - 130	30	70 - 130	30
Trichloroethene	ND<100	10	119	121	1.25	123	125	2.03	70 - 130	30	70 - 130	30
%SS1:	79	25	76	77	0.655	76	77	0.779	70 - 130	30	70 - 130	30
%SS2:	100	25	89	88	0.804	103	103	0	70 - 130	30	70 - 130	30
%SS3:	94	2.5	91	94	2.65	97	97	0	70 - 130	30	70 - 130	30

All target compounds in the Method Blank of this extraction batch were ND less than the method RL with the following exceptions:
NONE

BATCH 42801 SUMMARY

Lab ID	Date Sampled	Date Extracted	Date Analyzed	Lab ID	Date Sampled	Date Extracted	Date Analyzed
0904518-001C	04/21/09 11:30 AM	04/22/09	04/22/09 9:15 PM	0904518-002C	04/21/09 12:00 PM	04/22/09	04/22/09 10:02 PM
0904518-003C	04/21/09 11:00 AM	04/22/09	04/22/09 10:45 PM	0904518-004C	04/21/09 1:00 PM	04/24/09	04/24/09 6:24 AM
0904518-005C	04/21/09 12:30 PM	04/24/09	04/24/09 7:07 AM				

MS = Matrix Spike; MSD = Matrix Spike Duplicate; LCS = Laboratory Control Sample; LCSD = Laboratory Control Sample Duplicate; RPD = Relative Percent Deviation.

% Recovery = 100 * (MS-Sample) / (Amount Spiked); RPD = 100 * (MS - MSD) / ((MS + MSD) / 2).

* MS and / or MSD spike recoveries may not be near 100% or the RPDs near 0% if: a) the sample is inhomogenous AND contains significant concentrations of analyte relative to the amount spiked, or b) if that specific sample matrix interferes with spike recovery.

N/A = not enough sample to perform matrix spike and matrix spike duplicate.

NR = analyte concentration in sample exceeds spike amount for soil matrix or exceeds 2x spike amount for water matrix or sample diluted due to high matrix or analyte content.

Laboratory extraction solvents such as methylene chloride and acetone may occasionally appear in the method blank at low levels.



QC SUMMARY REPORT FOR SW8021B/8015Bm

W.O. Sample Matrix: Water

QC Matrix: Water

BatchID: 42818

WorkOrder: 0904518

Analyte	EPA Method SW8021B/8015Bm		Extraction SW5030B						Spiked Sample ID: 0904518-003A			
	Sample	Spiked	MS	MSD	MS-MSD	LCS	LCSD	LCS-LCSD	Acceptance Criteria (%)			
	µg/L	µg/L	% Rec.	% Rec.	% RPD	% Rec.	% Rec.	% RPD	MS / MSD	RPD	LCS/LCSD	RPD
TPH(btex) [£]	ND	60	100	101	1.37	103	113	9.35	70 - 130	20	70 - 130	20
MTBE	ND	10	96.9	94.8	2.21	112	106	5.34	70 - 130	20	70 - 130	20
Benzene	ND	10	92.1	92.2	0.141	91.4	98.6	7.56	70 - 130	20	70 - 130	20
Toluene	ND	10	90.1	90.5	0.338	93.7	103	9.42	70 - 130	20	70 - 130	20
Ethylbenzene	ND	10	89.6	89	0.749	94.4	98.1	3.91	70 - 130	20	70 - 130	20
Xylenes	ND	30	90.8	89.8	1.08	106	114	7.68	70 - 130	20	70 - 130	20
%SS:	92	10	98	99	1.31	101	106	4.65	70 - 130	20	70 - 130	20

All target compounds in the Method Blank of this extraction batch were ND less than the method RL with the following exceptions:
NONE

BATCH 42818 SUMMARY

Lab ID	Date Sampled	Date Extracted	Date Analyzed	Lab ID	Date Sampled	Date Extracted	Date Analyzed
0904518-001A	04/21/09 11:30 AM	04/23/09	04/23/09 6:44 AM	0904518-002A	04/21/09 12:00 PM	04/23/09	04/23/09 7:13 AM
0904518-003A	04/21/09 11:00 AM	04/22/09	04/22/09 6:40 PM	0904518-004A	04/21/09 1:00 PM	04/24/09	04/24/09 2:00 AM
0904518-005A	04/21/09 12:30 PM	04/24/09	04/24/09 2:30 AM				

MS = Matrix Spike; MSD = Matrix Spike Duplicate; LCS = Laboratory Control Sample; LCSD = Laboratory Control Sample Duplicate; RPD = Relative Percent Deviation.

% Recovery = 100 * (MS-Sample) / (Amount Spiked); RPD = 100 * (MS - MSD) / ((MS + MSD) / 2).

MS / MSD spike recoveries and / or %RPD may fall outside of laboratory acceptance criteria due to one or more of the following reasons: a) the sample is inhomogenous AND contains significant concentrations of analyte relative to the amount spiked, or b) the spiked sample's matrix interferes with the spike recovery.

£ TPH(btex) = sum of BTEX areas from the FID.

cluttered chromatogram; sample peak coelutes with surrogate peak.

N/A = not enough sample to perform matrix spike and matrix spike duplicate.

NR = matrix interference and/or analyte concentration in sample exceeds spike amount for soil matrix or exceeds 2x spike amount for water matrix or sample diluted due to high matrix or analyte content, or inconsistency in sample containers.