



ENVIRONMENTAL  
SECTION  
90 SEP 29 PM 2:27

1921 Ringwood Avenue  
San Jose, CA 95131-1721  
Tel. 408.453.7300  
Fax. 408.437.9526

Date: September 29, 1999  
Project: 360-014.2B

To: Mr. Barney Chan  
Alameda County Environmental  
Health Services  
1131 Harbor Bay Pkwy, Suite 250  
Alameda, CA 94502

#1138

3

We have enclosed:

Copies	Description
1	Errata for Quarterly Report - Second Quarter 1999, Former Dorr-Oliver Site 2901 Glascock Street, Oakland, California

For your:  Use  
 Approval  
 Review  
 Information

Comments Enclosed are corrected Table 1 and Figure 1 for the above referenced report  
If you have any questions, please call me at (408) 453-7300 x 682. Thank you.

Diane Sarmiento  
Senior Engineer

1921 Ringwood Avenue  
San Jose, CA 95131-1721  
Tel. 408.453.7300  
Fax. 408.437.9526



September 29, 1999

Project 360-014.2B

Mr. Dennis Buran  
Glascok Street Properties  
383 Diablo Road, Suite 100  
Danville, California 94562

RE: ERRATA for Quarterly Report – Second Quarter 1999  
Former Dorr-Oliver Site  
2901 Glascok Street  
Oakland, California

Dear Mr. Buran:

Attached are a revised Table 2 and Figure 1 for the Second Quarter 1999 report for the Former Dorr-Oliver Site at 2901 Glascok Street in Oakland, California. On Table 2, the value for TEPH as diesel for monitoring well MW-8 has been corrected from 10,004 micrograms per liter (ug/l or parts per billion) to 10,400 ug/l as reported on the laboratory report. On Figure 2, the posted concentration values for monitoring well MW-2 are corrected to "ND/ND" for benzene/TEPH-d and for MW-8 the posted concentrations values are corrected to ND/10,400\*. Please replace Table 2 and Figure 1 in the report dated August 19, 1999.

A copy of these revisions has been sent to Mr. Barney Chan at Alameda County Environmental Health Services (ACEHS).

If you have any questions, please call.

Sincerely,

The IT Corporation (formerly Pacific Environmental Group)

Diane L. Sarmiento, P.E.  
Senior Engineer

Attachments: Revised Table 2  
Revised Figure 1

Cc: Mr. Barney Chan, Alameda County Environmental Health Services

Table 2  
**Groundwater Analytical Data**  
 Total Petroleum Hydrocarbons  
 (TPPH as Gasoline, BTEX Compounds, TEPH as Diesel, Motor Oil, and MtBE)

Former Dorr-Oliver Site  
 2901 Glascock Street  
 Oakland, California

Well Number	Date Sampled	TPPH as Gasoline (µg/L)	Benzene (µg/L)	Toluene (µg/L)	Ethyl-benzene (µg/L)	Xylenes (µg/L)	TEPH as Diesel (1) (µg/L)	Motor Oil (µg/L)	MtBE (µg/L)
MW-1	10/06/94	NS	NS	NS	NS	NS	NS	NS	NS
	01/20/95	670	5.3	ND	ND	1.1	1,900	NA	NA
	05/15/95	290	7.9	ND	ND	1.4	3,400	NA	NA
	08/28/95	250	5.4	ND	ND	1.1	1,800	NA	NA
	11/29/95	NA	NA	NA	NA	NA	ND	ND	NA
	12/06/95	770	4.8	ND	ND	1.3	39,000	NA	NA
	01/18/96	NA	NA	NA	NA	NA	23,000	NA	NA
	03/08/96	360	2,600	ND	ND	1.9	16,000	NA	24
	07/02/96	5,300 a	ND	ND	ND	ND	6,600	ND	ND
	12/17/96	540 b	3.4	ND	ND	0.83	2,800 c	1,600 d	60
	03/21/97	590	5.5	0.66	ND	ND	5,500 e	5,000 d	71
	05/16/97	NA	NA	NA	NA	NA	NA	NA	NA
	06/25/97	470 h	ND	ND	ND	ND	39,000 e	26,000 d	45
	09/29/97	510 h	2.2	ND	ND	ND	5,000 e	4,000 d	37
	12/11/97	ND	ND	ND	ND	ND	1,900 e	1,300 d	ND
	03/27/98	280 k	5.0	0.60	ND	ND	4,600 e	3,900 d	890
	06/26/98	450 f	2.6	ND	ND	ND	1,700 e	1,300 d	41
	09/11/98	230 l	2.8	ND	ND	1.8	3,000 m	ND	8.7
	09/11/98	NA	NA	NA	NA	NA	620 g	520 d	NA
12/24/98	380 b	5.0	ND	ND	ND	2,100 g	1,600 d	ND	
03/31/99	190 b	3.0	ND	ND	1.4	10,000 e	6,600 d	55	
06/17/99	133	3.27	ND	ND	ND	1,920 g	2,770 d	11.9	
MW-2	10/06/94	NS	NS	NS	NS	NS	NS	NS	NS
	01/20/95	520	2.2	1.9	ND	1.3	4,000	NA	NA
	05/15/95	310	2.3	1.9	ND	1.4	5,100	NA	NA
	08/28/95	320	2.9	2.9	ND	2.6	4,100	NA	NA
	11/29/95	NS	NS	NS	NS	NS	NS	NS	NS
	12/06/95	210	2.0	2.2	ND	0.57	17,000	NA	NA
	01/18/96	NA	NA	NA	NA	NA	22,000	NA	NA
	03/08/96	310	2.4	1.9	ND	1.4	56,000	NA	ND
	07/02/96	9,300 a	ND	ND	ND	ND	19,000	ND	ND
	12/17/96	140 b	1.1	2.0	ND	1.4	10,000 e	5,400 d	ND
	03/21/97	230	2.1	1.9	ND	ND	17,000 e	16,000 d	ND
	05/16/97	NA	NA	NA	NA	NA	NA	NA	NA
	06/25/97	630 h	ND	ND	ND	ND	16,000 e	13,000 d	ND
	09/29/97	300 h	1.3	0.66	ND	ND	32,000 e	20,000 d	ND
	12/11/97	ND	ND	ND	ND	ND	4,800 e	4,000 d	ND
	03/27/98	94 k	1.3	1.30	ND	ND	15,000 e	11,000 d	18
	06/26/98	490 b	ND	ND	ND	ND	11,000 e	5,900 d	ND
	09/11/98	550 l	ND	ND	ND	ND	11,000 n	ND	ND
	09/11/98	NA	NA	NA	NA	NA	6,100 g	ND	NA
12/24/98	990 b	ND	6.8	9.1	17	2,000 g	1,200 d	ND	
3/31/99	580 p	1.3	2.2	ND	0.99	21,000 g	14,000 d	ND	
06/17/99	525	ND	ND	ND	ND	ND	ND	ND	
MW-3	10/06/94	NA	ND	ND	ND	ND	320	NA	NA
	01/20/95	86	ND	ND	ND	ND	460	NA	NA
	05/15/95	60	ND	ND	ND	ND	310	NA	NA
	08/28/95	ND	ND	ND	ND	ND	310	NA	NA

Table 2  
**Groundwater Analytical Data**  
 Total Petroleum Hydrocarbons  
 (TPPH as Gasoline, BTEX Compounds, TEPH as Diesel, Motor Oil, and MtBE)

Former Dorr-Oliver Site  
 2901 Glascock Street  
 Oakland, California

Well Number	Date Sampled	TPPH as Gasoline ( $\mu\text{g/L}$ )	Benzene ( $\mu\text{g/L}$ )	Toluene ( $\mu\text{g/L}$ )	Ethyl-benzene ( $\mu\text{g/L}$ )	Xylenes ( $\mu\text{g/L}$ )	TEPH as Diesel (1) ( $\mu\text{g/L}$ )	Motor Oil ( $\mu\text{g/L}$ )	MtBE ( $\mu\text{g/L}$ )
	11/29/95	NS	NS	NS	NS	NS	NS	NS	NS
	12/06/95	120	ND	ND	ND	ND	1,000	NA	NA
	01/18/96	NA	NA	NA	NA	NA	210	NA	NA
	03/08/96	67	ND	ND	ND	ND	1,000	NA	7.2
	07/02/96	230 a	ND	ND	ND	ND	640	ND	ND
	12/17/96	240 f	ND	ND	ND	ND	560 e	ND	ND
	03/21/97	760 h	ND	ND	ND	0.94	2,100 e	1900 d	5.6
	05/16/97	NA	NA	NA	NA	NA	NA	NA	NA
	06/25/97	180 h	ND	ND	ND	0.58	610 g	ND	5.3
	09/29/97	84 i	ND	ND	ND	ND	470 g	ND	ND
	12/11/97	ND	ND	ND	ND	ND	380 e	ND	ND
	03/27/98	ND	ND	ND	ND	ND	220 g	ND	ND
	06/26/98	68 b	ND	ND	ND	ND	210 g	ND	ND
	09/11/98	110 l	ND	ND	ND	ND	320 o	ND	ND
	09/11/98	NA	NA	NA	NA	NA	210 g	ND	NA
	12/24/98	ND	ND	ND	ND	ND	220 g	ND	ND
	03/31/99	73 q	ND	ND	ND	ND	680 r	580 r	ND
	06/17/99	72	ND	ND	ND	0.696	325 g	516 d	ND
MW-4	10/06/94	NA	ND	ND	ND	ND	ND	NA	NA
	01/20/95	ND	ND	ND	ND	ND	ND	NA	NA
	05/15/95	ND	ND	ND	ND	ND	ND	NA	NA
	08/28/95	ND	ND	ND	ND	ND	ND	NA	NA
	11/29/95	NA	NA	NA	NA	NA	NA	NA	NA
	12/06/95	ND	ND	ND	ND	ND	57	NA	NA
	01/18/96	NA	NA	NA	NA	NA	ND	NA	NA
	03/08/96	ND	ND	ND	ND	ND	100	NA	ND
	07/02/96	ND	ND	ND	ND	ND	ND	ND	ND
	12/17/96	ND	ND	ND	ND	ND	310 g	530 d	ND
	03/21/97	ND	ND	ND	ND	ND	180 g	500 d	ND
	06/25/97	ND	ND	ND	ND	ND	120 g	ND	ND
	09/29/97	ND	ND	ND	ND	ND	130 g	ND	ND
	12/11/97	ND	ND	ND	ND	ND	57 g	ND	ND
	03/27/98	ND	ND	ND	ND	ND	ND	ND	ND
	06/26/98	ND	ND	ND	ND	ND	ND	ND	ND
	09/11/98	ND	ND	ND	ND	ND	ND	ND	ND
	09/11/98	NA	NA	NA	NA	NA	230 g	ND	NA
	12/24/98	ND	ND	ND	ND	ND	65 g	ND	ND
	03/31/99	ND	ND	ND	ND	ND	140 r	ND	ND
	06/17/99	ND	ND	ND	ND	ND	ND	ND	ND
MW-5*	05/15/95	ND	ND	ND	ND	ND	490	NA	NA
	08/28/95	ND	ND	ND	ND	ND	170	NA	NA
	11/29/95	NS	NS	NS	NS	NS	NS	NS	NS
	12/06/95	ND	ND	ND	ND	ND	250	NA	NA
	01/18/96	NA	NA	NA	NA	NA	49	NA	NA
	03/08/96	ND	ND	ND	ND	ND	210	ND	12
	07/02/96	200 a	ND	ND	ND	ND	110	ND	ND

Table 2  
**Groundwater Analytical Data**  
 Total Petroleum Hydrocarbons  
 (TPPH as Gasoline, BTEX Compounds, TEPH as Diesel, Motor Oil, and MtBE)

Former Dorr-Oliver Site  
 2901 Glascock Street  
 Oakland, California

Well Number	Date Sampled	TPPH as Gasoline ( $\mu\text{g/L}$ )	Benzene ( $\mu\text{g/L}$ )	Toluene ( $\mu\text{g/L}$ )	Ethyl-benzene ( $\mu\text{g/L}$ )	Xylenes ( $\mu\text{g/L}$ )	TEPH as Diesel (1) ( $\mu\text{g/L}$ )	Motor Oil ( $\mu\text{g/L}$ )	MtBE ( $\mu\text{g/L}$ )
MW-6	05/15/95	120	5.6	0.88	ND	2.1	1,100	NA	NA
	08/28/95	140	6.1	0.77	ND	2.3	2,100	NA	NA
	11/29/95	NA	NA	NA	NA	NA	35,000	5,400	NA
	12/06/95	140	4.6	0.89	ND	1.7	38,000	NA	NA
	01/18/96	NA	NA	NA	NA	NA	59,000	NA	NA
	03/08/96	160	3.4	0.57	ND	1.9	14,000	NA	ND
	07/02/96	3,300 a	3.1	ND	ND	ND	2,300	1,300	ND
	12/17/96	150 b	3.4	0.93	ND	1.7	15,000 e	14,000 d	14
	03/21/97	300	3.5	0.91	ND	0.79	18,000 e	17,000 d	19
	05/16/97	NA	NA	NA	NA	NA	NA	NA	NA
	06/25/97	590 h	3.2	ND	ND	ND	9,300 e	7,900 d	15
	09/29/97	490 h	2.6	0.83	ND	1.5	7,900 e	7,900 d	13
	12/11/97	ND	ND	ND	ND	ND	5,600 e	5,100 j	ND
	03/27/98	ND	ND	ND	ND	ND	1,500 e	1,400 d	ND
	06/26/98	290 f	5.3	ND	ND	1.1	9,200 e	6,400 d	11
	09/11/98	660 i	500	ND	ND	ND	4,200 m	ND	6.5
	09/11/98	NA	NA	NA	NA	NA	1,600 g	1,300 d	NA
	12/24/98	ND	ND	ND	ND	ND	1,000 g	690 d	ND
	03/31/99	330 b	4.2	0.83	ND	1.5	22,000 e	16,000 d	ND
	06/17/99	504	4.56	0.863	0.573	1.2	1,460 s	7,090 d	9.85
MW-7	05/15/95	110	ND	ND	ND	ND	ND	NA	NA
	08/28/95	ND	ND	ND	ND	ND	ND	NA	NA
	11/29/95	NA	NA	NA	NA	NA	NA	NA	NA
	12/06/95	62	ND	ND	ND	ND	ND	NA	NA
	01/18/96	NA	NA	NA	NA	NA	ND	NA	NA
	03/08/96	ND	ND	ND	ND	ND	ND	NA	ND
	07/02/96	ND	ND	ND	ND	ND	ND	ND	580
	12/17/96	ND	ND	ND	ND	ND	120 g	ND	100
	03/21/97	ND	ND	ND	ND	ND	79 g	ND	190
	06/25/97	ND	ND	ND	ND	ND	58 g	ND	580
	09/29/97	ND	ND	ND	ND	ND	ND	ND	310
	12/11/97	ND	ND	ND	ND	ND	ND	ND	ND
	03/27/98	ND	ND	ND	ND	ND	ND	ND	ND
	06/26/98	ND	ND	ND	ND	ND	ND	ND	110
	09/11/98	ND	ND	ND	ND	ND	ND	ND	110
	09/11/98	NA	NA	NA	NA	NA	140 g	ND	NA
12/24/98	ND	ND	ND	ND	ND	ND	ND	150	
03/31/99	ND	ND	ND	ND	ND	78 r	ND	11	
06/17/99	ND	ND	ND	ND	ND	53.7 g	ND	59.1	
MW-8	11/29/95	NA	NA	NA	NA	NA	NA	NA	NA
	01/18/96	NA	NA	NA	NA	NA	ND	NA	NA
	03/08/96	NS	NS	NS	NS	NS	NS	NS	NS
	07/02/96	ND	0.74	0.88	ND	0.82	ND	ND	ND
	12/17/96	ND	ND	ND	ND	ND	53 g	ND	ND
	03/21/97	ND	ND	ND	ND	ND	ND	ND	ND
	06/25/97	ND	ND	ND	ND	ND	ND	ND	ND
	09/29/97	ND	ND	ND	ND	ND	ND	ND	ND
12/11/97	270	8.0	1.8	5.7	14	ND	ND	72	

Table 2  
**Groundwater Analytical Data**  
 Total Petroleum Hydrocarbons  
 (TPPH as Gasoline, BTEX Compounds, TEPH as Diesel, Motor Oil, and MtBE)

Former Dorr-Oliver Site  
 2901 Glascock Street  
 Oakland, California

Well Number	Date Sampled	TPPH as Gasoline ( $\mu\text{g/L}$ )	Benzene ( $\mu\text{g/L}$ )	Toluene ( $\mu\text{g/L}$ )	Ethyl-benzene ( $\mu\text{g/L}$ )	Xylenes ( $\mu\text{g/L}$ )	TEPH as Diesel (1) ( $\mu\text{g/L}$ )	Motor Oil ( $\mu\text{g/L}$ )	MtBE ( $\mu\text{g/L}$ )
	03/27/98	ND	ND	ND	ND	ND	ND	ND	ND
	06/26/98	ND	ND	ND	ND	ND	ND	ND	ND
	09/11/98	ND	ND	ND	ND	ND	ND	ND	ND
	09/11/98	NA	NA	NA	NA	NA	130 g	ND	NA
	12/24/98	ND	ND	ND	ND	ND	ND	ND	ND
	03/31/99	ND	ND	ND	ND	ND	ND	ND	ND
	06/17/99	ND	ND	ND	ND	ND	10,400 g	12,700 d	ND

TPPH = Total purgeable petroleum hydrocarbons  
 TEPH = Total extractable petroleum hydrocarbons  
 MtBE = Methyl tert-butyl ether  
 $\mu\text{g/L}$  = Micrograms per liter  
 NS = Not sampled  
 ND = Not detected (see certified analytical reports for detection limits)  
 NA = Not analyzed  
 \* = Well MW-5 was destroyed in September 1996.

(1) TEPH as diesel analysed with silica gel cleanup

- Chromatogram pattern is not gasoline, but volatile fraction of diesel quantified as gasoline.
- Chromatogram pattern is not gasoline, but unidentified hydrocarbons in C6 - C12 range.
- Chromatogram pattern is a mixture of weathered diesel and unidentified hydrocarbons in C9 - C24 range.
- Chromatogram pattern is not motor oil, but unidentified hydrocarbons in C16 - C36 range.
- Chromatogram pattern is weathered diesel in C9 - C24 range.
- Chromatogram pattern is not gasoline, but unidentified hydrocarbons > C10.
- Chromatogram pattern is not diesel, but unidentified hydrocarbons in the C9 - C24 range.
- Chromatogram pattern is weathered gasoline.
- Chromatogram pattern is not gasoline, but unidentified hydrocarbons in C6 - C8 range.
- Chromatogram pattern is not motor oil, but unidentified hydrocarbons in the C16 to C34 range.
- Chromatogram pattern is not gasoline, but unidentified hydrocarbons > C5.
- Chromatogram pattern is not gasoline, but unidentified hydrocarbons > C12.
- Chromatogram pattern is a mixture of weathered diesel and unidentified hydrocarbons in the C18 - C40 range.
- Chromatogram pattern is a mixture of weathered diesel and unidentified hydrocarbons in the C9 - C40 range.
- Chromatogram pattern is not diesel, but unidentified hydrocarbons in the C9 - C40 range.
- Chromatogram pattern is a mixture of gasoline and unidentified hydrocarbons > C10.
- Chromatogram pattern is not gasoline, but unidentified hydrocarbons > C8.
- Chromatogram pattern is unidentified hydrocarbons in the C9 - C40 range.
- Chromatogram pattern is a mixture of weathered diesel and unidentified hydrocarbons in the C15 - C24 range.

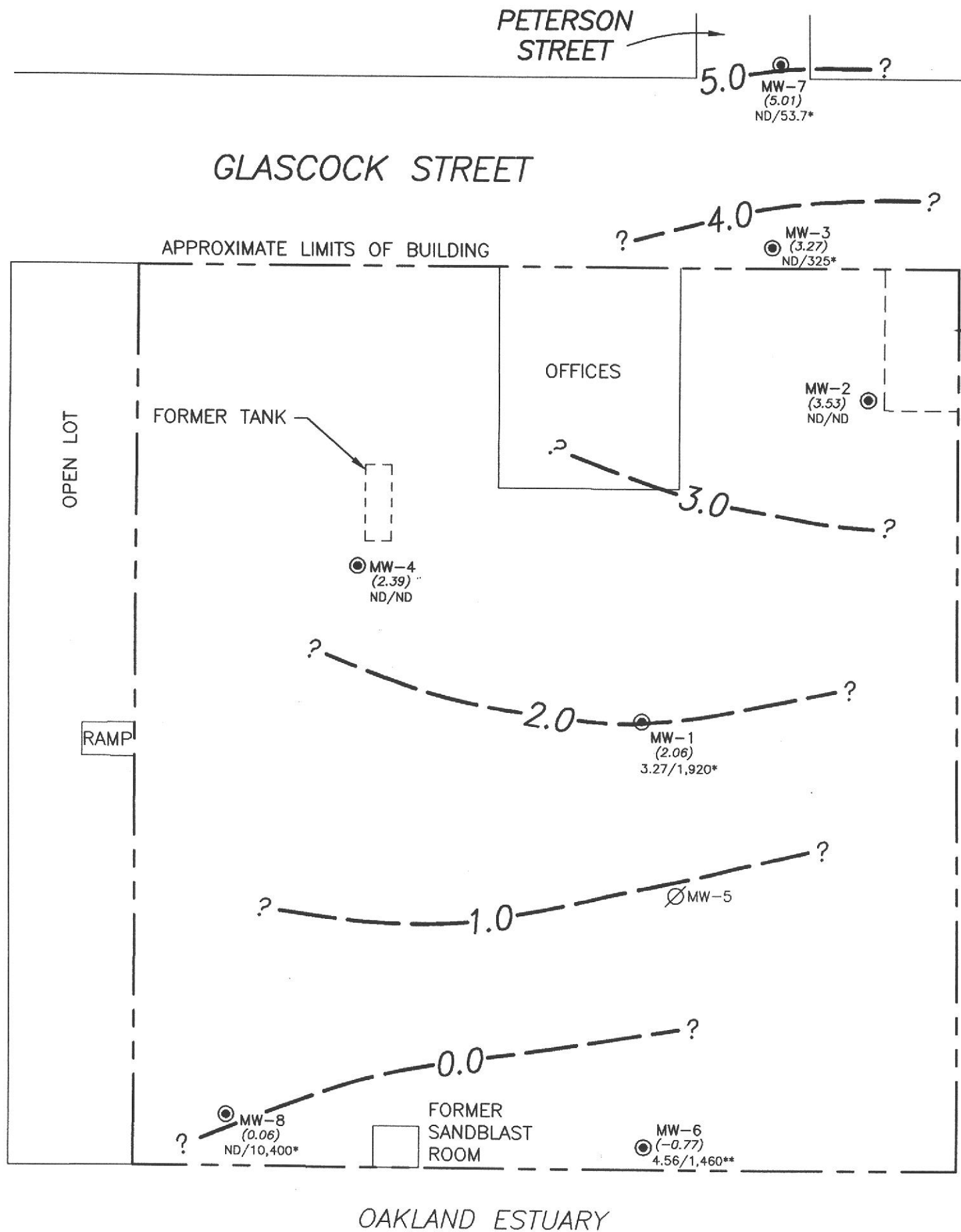
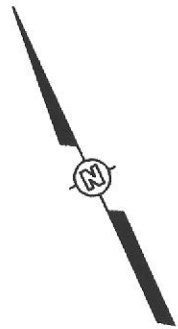

- LEGEND**
- Groundwater monitoring well
  - ∅ Destroyed groundwater monitoring well
  - (3.53) Groundwater elevation (Ft.-MSL); measured 6/17/99
  - ?- - - Groundwater elevation contour (Ft.-MSL)
  - 1.3/21,000\* Benzene/TEPH-d concentration in groundwater (parts per billion); measured 6/17/99
  - ND Not detected
  - \* Not diesel; unidentified hydrocarbons C9-C24
  - \*\* Weathered diesel and unidentified hydrocarbons

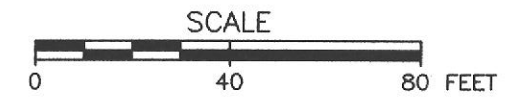

**IT CORPORATION**

GLASCOCK STREET PROPERTIES  
FORMER DORR-OLIVER SITE

**FIGURE 1**  
GROUNDWATER ELEVATION CONTOURS  
SECOND QUARTER 1999  
2901 GLASCOCK STREET  
OAKLAND, CALIFORNIA