

ACTON •  
MICKELSON •  
van DAM, INC.

Consulting Scientists, Engineers, and Geologists

TO: EVA CHU DATE: 3-23-94  
 COMPANY: HAZARDOUS MATERIALS PROJECT NO. 19024.03  
 FAX NUMBER: 510) 569-4757 NO. OF PAGES 2

SUBJECT/COMMENTS:

PER YOUR REQUEST: SITE MAP FOR  
1619 W. FIRST ST  
LIVERMORE, CA

SENT BY: Todd DEL FRATE

4511 Golden Foothill Parkway, Suite 1  
El Dorado Hills, California 95762

(916) 939-7550  
Fax (916) 939-7570

*See 3/23*

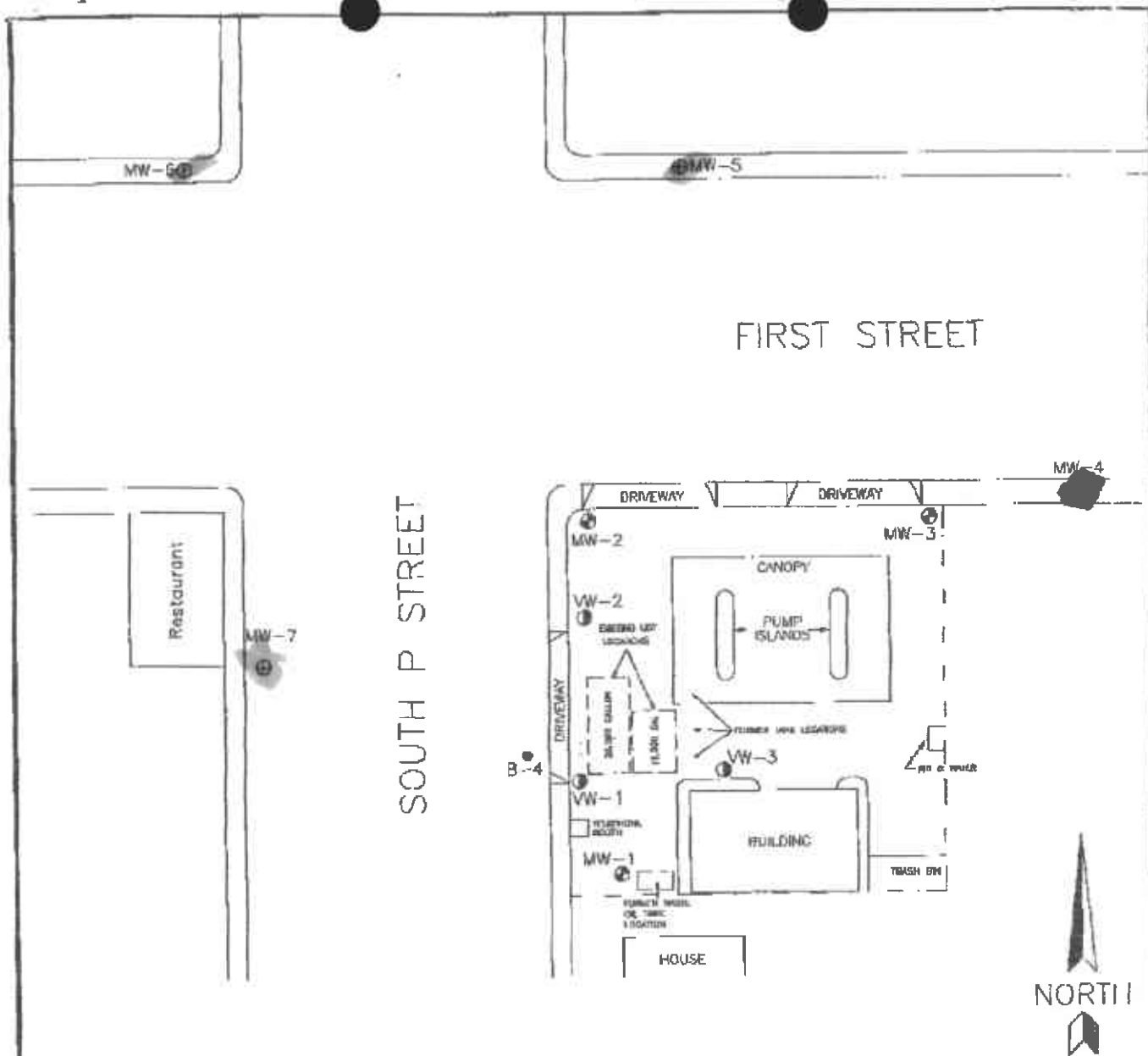

LEGEND

- VW-3 VADOSE WELL LOCATION AND NUMBER
- MW-3 MONITORING WELL LOCATION AND NUMBER
- B-4 SOIL BORING LOCATION AND NUMBER
- - - - - PROPERTY BOUNDARY
- MW-7 PROPOSED MONITORING WELL AND NUMBER



Approximate Scale (in feet)

FIGURE 2

SITE MAP  
 BEACON STATION #604  
 1619 WEST FIRST STREET  
 LIVERMORE, CALIFORNIA

Project No. 19024.03	Drawn DA	Acton • Mickelson • van Dam, Inc. Consulting Scientists, Engineers, and Geologists 5090 Robert J. Mathews Parkway, #1 El Dorado Hills, California 95762 (916) 939-7550
File No. FIG2	Prepared FAD	
Revision	Reviewed	