

TANK CLOSURE REPORT

1230 14TH STREET
OAKLAND, CA 94607

12/29/93

ALCO
HAZMAT
94 JAN 14 PM 12:33

Prepared For:
SABEK, INC.
1045 AIRPORT BOULEVARD
SOUTH SAN FRANCISCO, CA 94080

Submitted By:
TANK PROTECT ENGINEERING
Of Northern California, Inc.
December 29, 1993

Project Number 150

Lee Huckins

Lee N. Huckins
Hydrogeologist

TANK CLOSURE REPORT

1230 14TH STREET
OAKLAND, CA 94607

Prepared For:
SABEK, INC.

1045 AIRPORT BOULEVARD
SOUTH SAN FRANCISCO, CA 94080

December 29, 1993

This report has been prepared by the staff of **Tank Protect Engineering of Northern California, Inc.** under direction of an Engineer and/or Geologist whose seal(s) and/or signature(s) appear hereon.

The findings, recommendations, specifications or professional opinions are presented, within the limits prescribed by the client, after being prepared in accordance with generally accepted professional engineering and geologic practice. We make no other warranty, either expressed or implied.

Lyle Travis

Lyle Travis
Civil Engineer

TABLE OF CONTENTS

1.0 INTRODUCTION 1

2.0 TANK REMOVAL 1

 2.1 Soil Sampling 3

 2.1.1 Results of Chemical Analyses 4

3.0 UNDERGROUND STORAGE TANK UNAUTHORIZED RELEASE
(LEAK)/CONTAMINATION SITE REPORT 4

4.0 DISPOSITION OF EXCAVATION 5

FIGURE

- 1. SITE PLAN, TANK REMOVAL (8/24-8/26/93)

TABLES

- 1. SUMMARY OF SOIL SAMPLE ANALYTICAL RESULTS
- 2. SUMMARY OF SOIL SAMPLE ANALYTICAL RESULTS FOR METALS

APPENDICES

- A. . ALAMEDA COUNTY HEALTH CARE SERVICE AGENCY,
DEPARTMENT OF ENVIRONMENTAL HEALTH, HAZARDOUS
MATERIALS DIVISION, UNDERGROUND TANK CLOSURE PLAN
. CITY OF OAKLAND, PERMIT TO EXCAVATE AND INSTALL,
REPAIR, OR REMOVE INFLAMMABLE LIQUID TANKS
. BAY AREA AIR QUALITY MANAGEMENT DISTRICT,
NOTIFICATION FORM
. EVERGREEN ENVIRONMENTAL SERVICES, BILL OF LADING
. CITY OF OAKLAND REPORT OF FIRE INSPECTION

- . ALAMEDA COUNTY, DEPARTMENT OF ENVIRONMENTAL HEALTH, HAZARDOUS MATERIALS INSPECTION FORMS
 - . UNIFORM HAZARDOUS WASTE MANIFESTS
 - . H&H ENVIRONMENTAL SERVICES, CERTIFICATE OF DISPOSAL
 - . UNDERGROUND STORAGE TANK UNAUTHORIZED RELEASE (LEAK)/CONTAMINATION SITE REPORT
- B. SAMPLE HANDLING PROCEDURES
- C. CERTIFIED ANALYTICAL REPORTS AND CHAIN-OF-CUSTODY DOCUMENTATION

1.0 INTRODUCTION

The subject site is a gasoline service station located at 1230 14th Street in the City of Oakland in Alameda County, California. The site is owned by Sabek, Inc. (Sabek), whose contact person is Mr. Andy Saberi [telephone number (415) 588-3088]. Tank Protect Engineering of Northern California, Inc. (TPE) was contracted by Sabek to remove 4 underground fuel tanks and 1 underground waste oil tank.

This report documents tank closure activities and soil sample analytical results.

2.0 TANK REMOVAL

Prior to removing the tanks, TPE obtained an acceptance of an Underground Tank Closure Plan from the Alameda County Health Care Services Agency (ACHCSA), Department of Environmental Health, Hazardous Materials Division; submitted an inspection fee, and received a Permit to Excavate and Install, Repair, or Remove Inflammable Liquid Tanks (Tank Permit No. 9710) from the City of Oakland; and notified the Bay Area Air Quality Management District (BAAQMD) on August 19, 1993 (see Appendix A).

Tank removal activities began on August 23, 1993 by removing concrete and/or asphalt covers from over the tanks and excavating backfill soil from around the tanks. Two excavations were conducted to uncover the tanks. One excavation contained a 550-gallon waste oil tank and the second excavation contained two ^{3,500}5,000-gallon unleaded fuel tanks and 2 leaded fuel tanks; one ^{7,500}5,000-gallon and one 8,000-gallon (see Figure 1). All tanks were of single-walled steel construction. The excavation containing the fuel tanks reached a maximum depth of about 9 feet and the excavation containing the waste oil tank reached a maximum depth of about 7 feet.

A total of about 334 cubic yards (cyds) of soil were excavated and stockpiled on site during uncovering of the tanks and later soil sampling activities. All excavated soil was covered with plastic sheeting. Contamination was apparent in the excavated soil and excavation sidewalls based on the presence of hydrocarbon stains and odors. The lithology of both the backfill material and native soil was a clay sand.

Groundwater was encountered in the excavation at a depth of about 16.0 feet. ?

All tanks were empty of liquids with the exception of the waste oil tank. Sabek arranged for about 300 gallons of waste oil and water to be removed from the tank and transported off site on August 24, 1993 by Evergreen Environmental Services, Bill of Lading, under manifest number 93299989 (see Appendix A).

where is it?
The tanks were removed from the excavations on August 24, 1993. Prior to hoisting the tanks from the excavations, each tank was purged of flammable vapors (see City of Oakland Report of Fire Inspection in Appendix A) by displacement with dry ice as indicated by a combustible gas indicator (Gastech model 1314). After removing each tank to the ground surface, they were visually examined for evidence of leakage. ~~All tanks appeared in good condition with no obvious holes. The waste oil tank was empty.~~

[see Alameda County, Department of Environmental Health (ACDEH) Hazardous Materials Inspection Form in Appendix A].

After removal, the tanks were transported off site by H&H Ship Service Company (H&H) as hazardous waste under Uniform Hazardous Waste Manifest, State Manifest Document Numbers 92220549, 92220551, and 92220552 (see Appendix A) to their facility located at 220 China Basin Street in San Francisco, California. After rendering the tanks harmless, H&H disposed of the tanks as scrap metal at Schnitzer Steel located in Oakland and Levin Metals located in Richmond, California. *ok*

Tank removal and subsequent soil sampling were conducted in accordance with the California Regional Water Quality Control Board (CRWQCB)-San Francisco Bay Region's "Tri-Regional Board Staff Recommendations for Preliminary Evaluation and Investigation of Underground Tank Sites", dated August 10, 1990, and under the supervision of representatives of the ACDEH and the City of Oakland Fire Prevention Bureau.

2.1 Soil Sampling

On August 25 and 26, 1993, discrete soil samples were collected for chemical analyses from the floor of the excavation near the ends of each fuel tank and from beneath

the fill-end of the waste oil tank (see Figure 1) at depths ranging from about 8.5 to 14.0 feet. Two additional samples were collected from the west sidewall of the fuel tanks excavation at a depth of about 6.0 feet where apparent soil contamination was present. The above samples were collected about 1 to 2 feet into the native soil by excavating a block of soil with either a backhoe or excavator bucket and driving a clean 2-inch diameter by 6-inch long brass tube into the soil in the bucket with a slide-hammer corer.

Discrete soil samples were also collected from native soil beneath each dispenser and from the stockpiled soil at the locations shown in Figure 1. Most stockpile soil samples were collected as discrete samples for laboratory compositing, such that 4 discrete samples were composited into 1 sample per about 100 cyds, for stockpile characterization. One stockpile containing about 25.5 cyds was characterized by collecting 1 discrete sample (see sample VSPC-1 in Figure 1). The dispenser island samples were collected at a depth of about 1 foot below the top of native soil and the stockpile samples were collected at depths of about 3.0 feet below the stockpile's surface. All the above samples were collected directly into brass tubes driven by a slide-hammer corer.

After collecting each sample, the brass tube ends were covered with Teflon sheeting and capped with plastic end-caps. The samples were labeled to show site address, project number, sample number, sample depth, date, time, sampler, and stored in individual plastic bags in an iced-cooler for transport to California State Department of Health Services (DHS) certified Priority Environmental Labs (PRIORITY) located in Milpitas, California and accompanied by chain-of-custody documentation (see Appendix B for TPE's protocol relative to sample handling procedures).

All soil samples were analyzed for total petroleum hydrocarbons as gasoline (TPHG); benzene, toluene, ethylbenzene, and xylenes (BTEX) by the United States Environmental Protection Agency (EPA) Methods 5030/8015 and 8020, respectively. Soil sample S-1, collected from beneath the waste oil tank, was additionally analyzed for total petroleum hydrocarbons as diesel (TPHD), oil & grease, and volatile organics by EPA Method 3550/8015, 5520 D&F, and 8010, respectively; and for cadmium, chromium, total lead, zinc, and nickel by various EPA Methods. Samples S-2, S-6, DS-

1, and DS-4, collected beneath leaded fuel tank and dispensers, were additionally analyzed for total lead by EPA Method 7420.

2.1.1 Results of Chemical Analyses

TPHG was detected in all soil samples ranging in concentration from 1.3 parts per million (ppm) to 18,000 ppm. All BTEX chemicals were detected in all samples, with the exception of no benzene in 3 samples. TPHD, oil & grease, and total lead were detected in sample S-1 at concentrations of 1,200 ppm, 7,700 ppm, and 47 ppm, respectively. Total lead was also detected in samples DS-1 and DS-4 at concentrations of 33 ppm and 11 ppm, respectively. Chromium, nickel, and zinc were also detected in sample S-1 at concentrations of 43 ppm, 36 ppm, and 35 ppm, respectively.

Analytical results are summarized in Tables 1 and 2 and documented with a certified analytical report and chain-of-custody in Appendix C.

3.0 UNDERGROUND STORAGE TANK UNAUTHORIZED RELEASE (LEAK)/CONTAMINATION SITE REPORT

Because of the above analytical results, an Underground Storage Tank Unauthorized Release (Leak)/Contamination Site Report was prepared for the ACDEH (see Appendix A).

4.0 DISPOSITION OF EXCAVATION

Tank removal activities were completed on August 26, 1993. The excavation was left open and protected with a surrounding wire fence and caution tape.

FIGURES

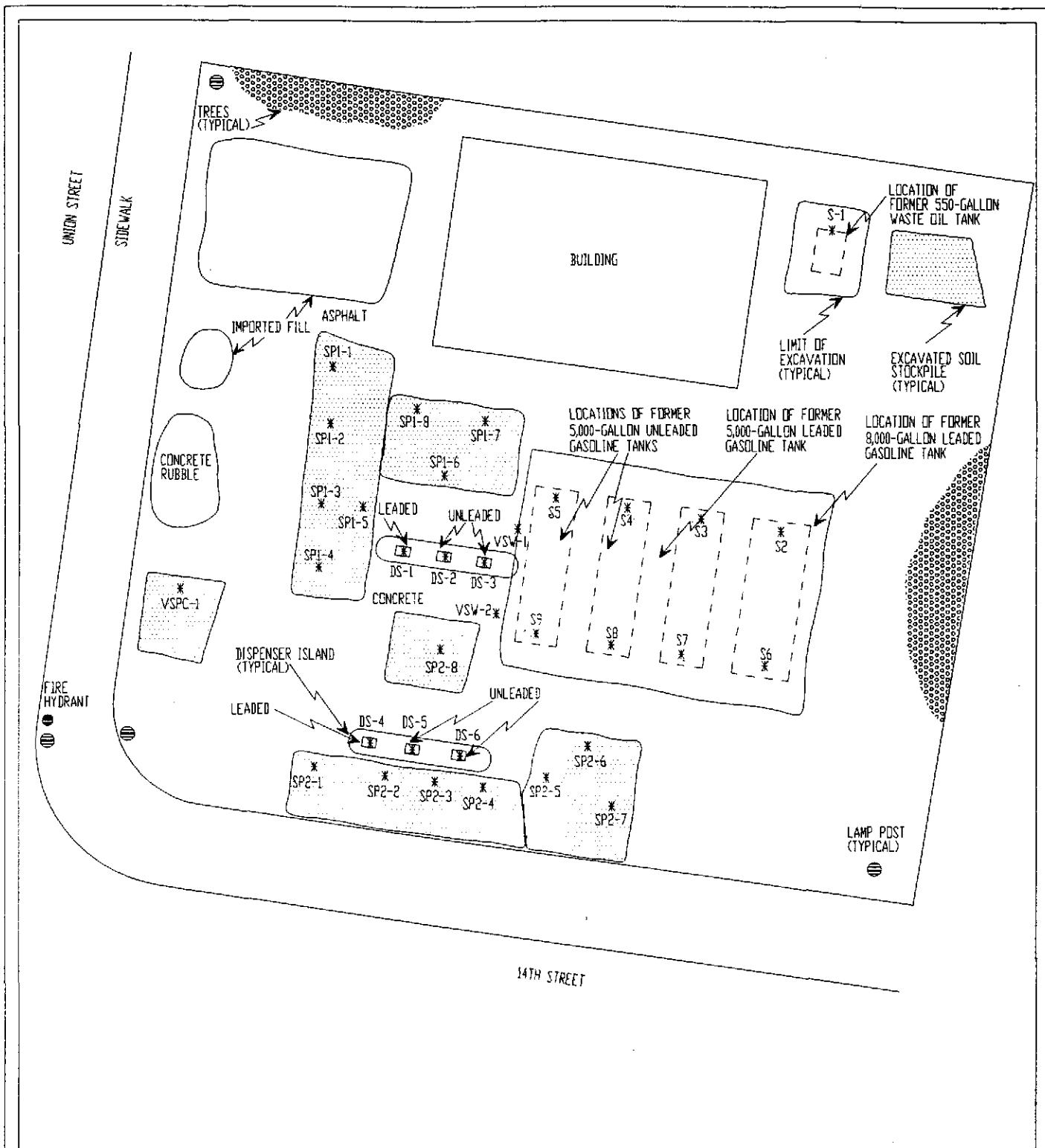

LEGEND

S-1 NAME AND LOCATION
* OF SOIL SAMPLE

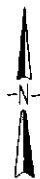

0 20
SCALE IN FEET

TANK PROTECT ENGINEERING

SITE PLAN
TANK REMOVAL (8/24-8/26/93)

1230 14TH STREET
OAKLAND, CA 94607

DATE	9/1/93
FIGURE	1
FILE #	150-1
DRAWN BY	TM
CHECKED BY	JVM

TABLES

TABLE 1
SUMMARY OF SOIL SAMPLE ANALYTICAL RESULTS
(ppm¹)

Sample ID Name	Date	Depth (Feet)	TPHD	TPHG	Benzene	Toluene	Ethyl-Benzene	Xylenes	Oil & Grease
DS-1	08/25/93	1.0	NA ² ✓	15 ✓	.0070 ✓	.017	.021	.072	NA
DS-2	08/25/93	1.0	NA ✓	2.0 ✓	.0053 ✓	.0089	.012	.031	NA
DS-3	08/25/93	1.0	NA ✓	1.3 ✓	<.0050 ✓	.0059	.0061	.018	NA
DS-4	08/25/93	1.0	NA ✓	2.7 ✓	.0055 ✓	.0094	.016	.047	NA
DS-5	08/25/93	1.0	NA ✓	3.4 ✓	.0059 ✓	.011	.018	.061	NA
DS-6	08/25/93	1.0	NA ✓	11 ✓	.0068 ✓	.015	.018	.064	NA
S-1 ³ waste oil UST	08/25/93	8.5	1,200 ✓	87 ✓	.030 ✓	.089	.110	.380	7,700 ✓
S-2	08/25/93	14.0	NA ✓	2,200 ✓	1,400 ✓	3,200	3,500	13,000	NA
S-3	08/25/93	11.0	NA ✓	530 ✓	.400 ✓	.760	.830	3,100	NA
S-4	08/25/93	11.0	NA ✓	40 ✓	.004 ✓	.059	.066	.290	NA
S-5	08/25/93	11.0	NA ✓	1.4 ✓	<.0050 ✓	.0063	.0081	.025	NA
S-6	08/25/93	13.0	NA ✓	1,600 ✓	.970 ✓	2,300	2,700	10,000	NA
S-7	08/25/93	11.0	NA ✓	11,000 ✓	6,700 ✓	16,000	18,000	69,000	NA
S-8	08/25/93	11.0	NA ✓	18,000 ✓	11,000 ✓	26,000	30,000	110,000	NA
S-9	08/25/93	11.0	NA ✓	6,200 ✓	3,700 ✓	8,700	10,000	37,000	NA
SP1-1, 2, 3, 4	08/25/93	3.0	NA ✓	960 ✓	.580 ✓	1,400	1,600	5,900	NA
SP1-5, 6, 7, 8	08/25/93	3.0	NA ✓	950 ✓	.360 ✓	1,400	1,500	5,700	NA
VSW-1	08/25/93	6.0	NA ✓	4,800 ✓	2,900 ✓	7,000	8,000	30,000	NA
VSW-2	08/25/93	6.0	NA ✓	21 ✓	.150 ✓	.290	.330	1,300	NA
SP2-1, 2, 3, 4	08/26/93	3.0	NA ✓	3,500 ✓	2,200 ✓	5,100	5,900	22,000	NA
SP2-5, 6, 7, 8	08/26/93	3.0	NA ✓	4,800 ✓	2,800 ✓	7,100	8,200	31,000	NA
VSPC-1	08/26/93	3.0	NA ✓	1.7 ✓	<.0050 ✓	.0066	.0096	.028	NA

¹ PARTS PER MILLION

² NOT ANALYZED

³ ALSO ANALYZED BY EPA METHOD 8010; ALL RESULTS WERE NONDETECTABLE ✓

TABLE 2
 SUMMARY OF SOIL SAMPLE ANALYTICAL RESULTS
 FOR METALS
 (ppm¹)

Sample ID Name	Date	Depth (Feet)	Cadmium	Chromium	Lead	Nickel	Zinc
S-1	08/25/93 ✓	8.5	<0.5 ✓	43 ✓	47 ✓	36 ✓	35 ✓
S-2	08/25/93	14.0	NA ²	NA	<1.0 ✓	NA	NA
S-6	08/25/93	13.0	NA	NA	<1.0 ✓	NA	NA
DS-1	08/25/93	1.0	NA	NA	33 ✓	NA	NA
DS-4	08/25/93	1.0	NA	NA	11 ✓	NA	NA

¹ PARTS PER MILLION STLCs → 1.0 5.0 5.0 20 250

² NOT ANALYZED

APPENDICES

APPENDIX A

- . ALAMEDA COUNTY HEALTH CARE SERVICE AGENCY,
DEPARTMENT OF ENVIRONMENTAL HEALTH, HAZARDOUS
MATERIALS DIVISION, UNDERGROUND TANK CLOSURE PLAN
- . CITY OF OAKLAND, PERMIT TO EXCAVATE AND INSTALL,
REPAIR, OR REMOVE INFLAMMABLE LIQUID TANKS
- . BAY AREA AIR QUALITY MANAGEMENT DISTRICT,
NOTIFICATION FORM
- . EVERGREEN ENVIRONMENTAL SERVICES, BILL OF LADING
CITY OF OAKLAND REPORT OF FIRE INSPECTION
- . ALAMEDA COUNTY, DEPARTMENT OF ENVIRONMENTAL
HEALTH, HAZARDOUS MATERIALS INSPECTION FORMS
- . UNIFORM HAZARDOUS WASTE MANIFESTS
- . H&H ENVIRONMENTAL SERVICES, CERTIFICATE OF DISPOSAL
- . UNDERGROUND STORAGE TANK UNAUTHORIZED RELEASE
(LEAK)/CONTAMINATION SITE REPORT

ALAMEDA COUNTY HEALTH CARE SERVICES AGENCY
 DEPARTMENT OF ENVIRONMENTAL HEALTH
 HAZARDOUS MATERIALS DIVISION
 80 SWAN WAY, ROOM 200
 OAKLAND, CA 94621
 PHONE NO. 510/271-4320

ACCEPTED

Underground Storage Tank Closure Permit Application

Alameda County Division of Hazardous Materials
 80 Swan Way, Suite 200,
 Oakland, CA 94621

Telephone: (510) 271-4320

These plans and all plans have been received and found to be acceptable and comply with the requirements of State and Local Health laws. Changes to your closing plans must be by this department in cooperation with State and local laws. The local permit and design is now prepared for any required building permits for construction/demolition.

One copy of the accepted plans must be on the job and available to all contractor and crew men involved with the removal.

Any change or alteration of these plans and specifications must be submitted to this department and to the fire and building inspection department to determine if such changes meet the requirements of State and local laws.

Notify this Department at least 72 hours prior to the following required inspections:

- _____ Removal of Tank(s) and Piping
- _____ Sampling
- _____ Final Inspection

Issuance of a) permit to operate, b) permanent site closure, is dependent on compliance with accepted plans and all applicable laws and regulations.

***THERE IS A FINANCIAL PENALTY FOR NOT OBTAINING THESE INSPECTIONS**

Contact Specialist:

*J. Eberle 7-2-92
 See changes in red*

UNDERGROUND TANK CLOSURE PLAN

* * * Complete according to attached instructions * * *

1. Business Name Former service station
 Business Owner Sabek, Inc.
 2. Site Address 1230 14th Street
 City Oakland, CA Zip 94607 Phone (510) 822-4222
 3. Mailing Address 1045 Airport Blvd
 City S. San Francisco, CA Zip 94080 Phone (415) 588-3088
 4. Land Owner Sabek, Inc.
 Address 1045 Airport Blvd City, State S. San Francisco Zip 94080
CA
 5. Generator name under which tank will be manifested _____
Sabek, Inc.
- EPA I.D. No. under which tank will be manifested CAC000869056

Excavation Permit Granted No. _____
Tank Permit No. 9710

CITY OF OAKLAND

Permit to Excavate and Install, Repair, or Remove Inflammable Liquid Tanks. No. 9710
July 9, 1993

PERMISSION IS HEREBY GRANTED TO remove install repair Gasoline tank and excavate commencing _____ feet inside PROPERTY line

on the _____ side of _____ Street _____ Avenue _____ feet _____ of _____ Street _____ Avenue

House No. 1230 - 14th Street Present Storage _____

Owner Sabek, Inc. Address 1045 Airport Blvd, S. S. F. 94084 Phone 415-588-3088

Applicant Tank Protect Engineering of N. Calif. Address 2821 Whipple Rd. Union City 94587-1233 Phone 429-8088

Dimensions of street (sidewalk) surface to be disturbed _____ X _____ Capacity _____ Gallons, each.
1 3 5,000
1 550

Remarks: _____
This Permit is granted in accordance with existing City Ordinances.
Owner hereby agrees to remove tanks on discontinuance of use or when notified by the City Authorities.
When installing, removing or repairing tanks, no open flame to be on or near premises.

Approved _____ Fire Marshal
Approved _____ Drainage Division Engineering Dept.

EXCAVATING PERMIT

Issued in accordance with Ord. No. 278 CMS, Sec. 4-2.04

_____ square feet of digging or removal granted.

The receipt of \$ _____ special deposit is hereby acknowledged.

GENERAL DEPOSIT. BUREAU OF PERMITS AND LICENSES. By _____ Fire Marshal

CERTIFICATE OF TANK AND EQUIPMENT INSPECTION

Inspected and passed on _____ 19____

Inspection Fee Paid _____ \$ 240.00 ck#3322 rec#685638
Received by G. M. Johnson FIRE PREVENTION BUREAU
Before Covering Tanks, Above Certificate Must Be Signed.
When ready for inspection notify Fire Prevention Bureau, 273-3851

THIS PERMIT MUST BE LEFT ON THE WORK AS AUTHORITY THEREFOR.



939 ELLIS STREET
SAN FRANCISCO, CALIFORNIA 94109
(415) 771-6000

Aeration of Contaminated Soil and
Removal of Underground Storage Tanks

NOTIFICATION FORM

- Removal or Replacement of Tanks
- Excavation of Contaminated Soil

SITE INFORMATION

Chen

SITE ADDRESS 1230 14th Street
 CITY, STATE Oakland, CA ZIP 94612
 OWNER NAME Sabek, Inc.
 SPECIFIC LOCATION OF PROJECT _____

<p><u>TANK REMOVAL</u></p> <p>SCHEDULED STARTUP DATE <u>8/23/93</u></p> <p>VAPORS REMOVED BY:</p> <p><input type="checkbox"/> WATER WASH</p> <p><input checked="" type="checkbox"/> VAPOR FREEING (CO²)</p> <p><input type="checkbox"/> VENTILATION</p>	<p><u>CONTAMINATED SOIL EXCAVATION</u></p> <p>SCHEDULED STARTUP DATE _____</p> <p>STOCKPILES WILL BE COVERED? YES _____ NO _____</p> <p>ALTERNATIVE METHOD OF AERATION (DESCRIBE BELOW):</p> <p>_____</p> <p>(MAY REQUIRE PERMIT)</p>
---	--

CONTRACTOR INFORMATION

NAME Tank Protect Engineering CONTACT Marc Zamoradi
 ADDRESS 2821 Whipple Rd. PHONE (510) 429-8088
 CITY, STATE, ZIP Union City, CA 94587

CONSULTANT INFORMATION

(IF APPLICABLE)

NAME _____ CONTACT _____
 ADDRESS _____ PHONE () _____
 CITY, STATE, ZIP _____

FOR OFFICE USE ONLY

DATE RECEIVED FAX <u>8/19/93</u>	BY <u>Blg</u> (init.)	
DATE POSTMARKED _____	BY _____ (init.)	
CC: INSPECTOR NO. <u>605</u>	DATE <u>8/23/93</u>	BY <u>Blg</u> (init.)
UPDATE: CONTACT NAME _____	DATE _____	BY _____ (init.)
BAAQMD N # _____	DATA ENTRY <u>8/23/93</u>	

BAAQMD
Bay Area Air Quality
Management District

Acknowledgment

Bay Area Air Quality Management District
acknowledges receipt of your Tank
Removal/Contaminated Soil Excavation
Notification Form received on

8/19/93 Bly



**EVERGREEN
ENVIRONMENTAL
SERVICES**

6880 SMITH AVE., NEWARK, CA 94560
(800) 972-5284 EPA ID# CAD 980695761

A DIVISION OF CALIFORNIA OIL RECYCLERS, INC.

**Bill Of Lading/
INVOICE 325636**

JOB LOCATION

BILLING INFORMATION

DATE **8-24-93**

CUSTOMER	NAME <i>Gas Station / Sabek, Inc</i>	NAME <i>Sabek, Inc</i>	CASH <input type="checkbox"/> CHECK <input checked="" type="checkbox"/> <i>Verbal</i>
	ADDRESS <i>1230 14th St @ Union</i>	ADDRESS <i>1045 Airport Blvd.</i>	CUSTOMER NO.
	CITY STATE ZIP CO <i>Oakland, Ca. 94607</i>	CITY STATE ZIP CO <i>South San Francisco, Ca. 94080</i>	PHONE NO. <i>200-499-5977</i> <i>(800) 540-9579</i>

PLEASE PAY FROM THIS INVOICE

TERMS: NET 7 DAYS

PRODUCT	MANIFEST #	GALLONS	PRICE	AMOUNT
USED OIL, NON-RCRA HAZARDOUS WASTE, COMBUSTIBLE LIQUID, NA1270	LUBRICATING			
	INDUSTRIAL			
NON-RCRA HAZARDOUS WASTE LIQUID	UN1142 (AUTOMOTIVE ANTIFREEZE)			
	UN9189 (OIL & WATER)	<i>93299789</i>	<i>300</i>	<i>1.85 gal. 555.00</i>
WASTE PETROLEUM OIL NOS COMBUSTIBLE LIQUID NA1270 (GREATER THAN 1000 ppm HALOGENS)				
TEST PASS <input type="checkbox"/> FAIL <input type="checkbox"/> PPM				
OTHER: <i>Flame Test - O.K.</i>				
DRAINED USED OIL FILTERS	CRUSHED	UNCRUNCHED	EMPTY	

TSD/ EVERGREEN OIL, INC. (510) 795-4400
6880 Smith Avenue EPA ID# CAD 980887418
Newark, California 94560

I certify that the information and amounts shown above are true and correct and that the used oil provided to Evergreen Environmental Services meets the definition of used oil pursuant to California Health & Safety Code, Section 25250.1, unless otherwise noted. This further serves as notification that the above waste is banned from land disposal pursuant to Section 66268.7(10) of Title 22. I also acknowledge that I have read and agree to the terms and conditions set forth on the reverse side of this form.

TOTAL CHARGES *555.00*

J. Dixon DRIVER ROUTE # *5* DRIVER SIGNATURE GENERATOR'S SIGNATURE *[Signature]*

CITY OF OAKLAND
REPORT OF FIRE INSPECTION

ENGINE CO.

ADDRESS 1230 14th ST

NAME TANK PROTECT

GENERAL INSPECTION

PERMIT
OTHER

HAZARD NOTED

HAZARD ABATED

NOTICE LEFT LETTER

1st NOTICE

2nd NOTICE

FINAL

DATE	VIOLATION	O.F.C.	CONTACTED
8-24-93	WITNESSED TANK REMOVED 550 gal LEL 2% O ₂ 1%		
	8,000 gal LEL 1% O ₂ 5%; 7500 O ₂ 3%, LEL 1%		
	7,500 gal LEL 4% O ₂ 2%; 7500 LEL 2% O ₂ 1%		

A REINSPECTION WILL BE MADE WITHIN _____ DAYS.

FIRE PREVENTION BUREAU - PHONE 273-3851

INSPECTOR GARY J. LINDS

white -env.health
 yellow -facility
 pink -files

ALAMEDA COUNTY, DEPARTMENT OF ENVIRONMENTAL HEALTH
 Hazardous Materials Inspection Form

80 Swan Way, #200
 Oakland, CA 94621
 (415) 271-4320

p. 1 of 2

II, III

Site ID # _____ Site Name Sabek former Service Station Today's Date 8/24/93

Site Address 1230-14th St.
 City Oakland Zip 94607 Phone _____

MAX AMT stored > 500 lbs, 55 gal., 200 cft.?

Inspection Categories:

- I. Haz. Mat/Waste GENERATOR/TRANSPORTER
- II. Business Plans, Acute Hazardous Materials
- III. Underground Tanks removal

* Calif. Administration Code (CAC) or the Health & Safety Code (HS&C)

Comments:

H + M onsite with manifest # 92220551 for the 2-5,000 gal USTs, manifest # 92220552 for 12550 gal. UST, + manifest # 92220549 for the 8,000 gal and one 5,000 gal. UST.

Soil being removed from tank pit has a terrific gasoline odor.

Gary Collins of OFD onsite to verify safety/inertness of USTs.

1.45

Removal of 550 gal waste oil tank. They removed ~300 gal of waste oil from UST this a.m.; UST is rusted, single-walled steel, but no obvious holes. Tank invert at 7' bgs.

2.20

Removal of 7500-gal gasoline tank. UST is single-walled steel + does not have rust or obvious holes. Tank invert at 9' bgs.

II.A BUSINESS PLANS (Title 19)

- 1. Immediate Reporting 2703
- 2. Bus. Plan Stds. 25503(b)
- 3. RR Cars > 30 days 25503.7
- 4. Inventory Information 25504(a)
- 5. Inventory Complete 2730
- 6. Emergency Response 25504(b)
- 7. Training 25504(c)
- 8. Deficiency 25505(a)
- 9. Modification 25505(b)

II.B ACUTELY HAZ MATLS

- 10. Registration Form Filed 25533(a)
- 11. Form Complete 25533(b)
- 12. RMPP Contents 25534(c)
- 13. Implement Sch. Req'd? (Y/N)
- 14. OnSite Conseq. Assess. 25524(c)
- 15. Probable Risk Assessment 25534(d)
- 16. Persons Responsible 25534(g)
- 17. Certification 25534(i)
- 18. Exemption Request? (Y/N)
- 19. Trade Secret Requested? 25538

1.00

III. UNDERGROUND TANKS (Title 23)

- General
- 1. Permit Application 25284 (H&S)
 - 2. Pipeline Leak Detection 25292 (H&S)
 - 3. Records Maintenance 2712
 - 4. Release Report 2651
 - 5. Closure Plans 2670

- Monitoring for Existing Tanks
- 6. Method
 - 1) Monthly Test
 - 2) Daily Vadose
 - Semi-annual groundwater
 - One time soils
 - 3) Daily Vadose
 - One time soils
 - Annual tank test
 - 4) Monthly Groundwater
 - One time soils
 - 5) Daily Inventory
 - Annual tank testing
 - Cont pipe leak det
 - Vadose/groundwater mon.
 - 6) Daily Inventory
 - Annual tank testing
 - Cont pipe leak det
 - 7) Weekly Tank Gauge
 - Annual tank test
 - 8) Annual Tank Testing
 - Daily Inventory
 - 9) Other _____

- 7. Precs Tank Test Date: 2643
- 8. Inventory Rec. 2644
- 9. Soil Testing 2646
- 10. Ground Water. 2647

- New Tanks
- 11. Monitor Plan 2632
 - 12. Access. Secure 2634
 - 13. Plans Submit Date: 2711
 - 14. As Built Date: 2635

Contact: Lee N. Huckins
 Title: Hydrogeologist
 Signature: Lee Huckins

Inspector: Jennifer Zherke
 Signature: J Zherke

II, III

white -env.health
 yellow -facility,
 pink -files

ALAMEDA COUNTY, DEPARTMENT OF
 ENVIRONMENTAL HEALTH
 Hazardous Materials Inspection Form

80 Swan Way, #200
 Oakland, CA 94621
 (415) 271-4320

p. 2 of 2

II, III

Site ID # _____ Site Name former service station Today's date 8/24/93

Site Address 1230-14th St
 City Oakland Zip 94607 Phone _____

MAX AMT stored > 500 lbs, 55 gal., 200 cft.?

Inspection Categories:

- I. Haz. Mat/Waste GENERATOR/TRANSPORTER
- II. Business Plans, Acute Hazardous Materials
- III. Underground Tanks Removal

* Calif. Administration Code (CAC) or the Health & Safety Code (HS&C)

Comments:

3:50 Removal of 7,500-gal. Superunleaded UST (Tank C). UST is single-walled steel & does not have rust or obvious holes.

3:20 Removal of 8,000-gal. leaded UST (Tank D). UST is single-walled steel with a tar wrap; therefore unable to detect rust or holes. Soil on sidewalls appears to be clean.

4:00 Removal of 7,500-gal. unleaded UST (tank A). UST is single-walled steel & does not have rust or obvious holes. The soil in this end of the pit is severely discolored & odorous. Gasoline is leaking out of the piping into pit (small amt).
 * Stockpiles & pit to be sampled later/tomorrow. Site should be secured. The 7,500 gal. USTs are actually 5,000-gal. in tank.

II.A BUSINESS PLANS (Title 19)

- 1. Immediate Reporting 2703
- 2. Bus. Plan Stds. 25503(b)
- 3. RR Cars > 30 days 25503.7
- 4. Inventory Information 25504(a)
- 5. Inventory Complete 2730
- 6. Emergency Response 25504(b)
- 7. Training 25504(c)
- 8. Deficiency 25505(a)
- 9. Modification 25505(b)

II.B ACUTELY HAZ. MATLS

- 10. Registration Form Filed 25533(a)
- 11. Form Complete 25533(b)
- 12. RMPP Contents 25534(c)
- 13. Implement Sch. Req'd? (Y/N)
- 14. OffSite Conseq. Assess. 25524(c)
- 15. Probable Risk Assessment 25534(d)
- 16. Persons Responsible 25534(g)
- 17. Certification 25534(f)
- 18. Exemption Request? (Y/N) 25536(b)
- 19. Trade Secret Requested? 25538

III. UNDERGROUND TANKS (Title 23)

- General**
- 1. Permit Application 25284 (H&S)
- 2. Pipeline Leak Detection 25292 (H&S)
- 3. Records Maintenance 2712
- 4. Release Report 2651
- 5. Closure Plans 2670
- Monitoring for Existing Tanks**
- 6. Method
 - 1) Monthly Test
 - 2) Daily Vadose
 - Semi-annual groundwater
 - One time soils
 - 3) Daily Vadose
 - One time soils
 - Annual tank test
 - 4) Monthly Gndwater
 - One time soils
 - 5) Daily Inventory
 - Annual tank testing
 - Cont pipe leak det
 - Vadose/gndwater mon.
 - 6) Daily Inventory
 - Annual tank testing
 - Cont pipe leak det
 - 7) Weekly Tank Gauge
 - Annual tank test
 - 8) Annual Tank Testing
 - Daily Inventory
 - 9) Other _____
- 7. Precs Tank Test Date: 2643
- 8. Inventory Rec. 2644
- 9. Soil Testing. 2646
- 10. Ground Water. 2647
- New Tanks**
- 11. Monitor Plan 2632
- 12. Access. Secure 2634
- 13. Plans Submit Date: 2711
- 14. As Built Date: 2635

Rev 8/88

Contact: Dee Hukins - Leet Hukins
 Title: Hydrogeologist
 Signature: Dee Hukins

Inspector: Jennifer Eberle
 Signature: J Eberle

II, III

white -env.health
 yellow -facility
 pink -files

ALAMEDA COUNTY, DEPARTMENT OF ENVIRONMENTAL HEALTH

80 Swan Way, #200
 Oakland, CA 94621
 (415) 271-4320

Hazardous Materials Inspection Form

p.1 of 2

II, III

Site ID # _____ Site Name former service station Today's date 8/25/93

Site Address 1230-14th St.

City Oakland Zip 94607 Phone _____

MAX AMT stored > 500 lbs. 55 gal., 200 cft.?

Inspection Categories:

- I. Haz. Mat/Waste GENERATOR/TRANSPORTER
- II. Business Plans, Acute Hazardous Materials
- III. Underground Tanks sampling (see map)

Callf. Administration Code (CAC) or the Health & Safety Code (HS&C)

1:00 Crew just finishing lunch.
 Comments:
 1:30 Waste oil pit: soil sample from beneath fill and at ~3 1/2' bas. Soil below fill end is bright emerald green, but surrounding soil is brown. (S-1) Sidewalls look clean.

1:55 Fuel tank pit: (one large excavation) Soil samples taken below tanks:
 S-2 is N end Tank D (14' bas)
 S-3 is N end Tank C (11' bas)
 2:30 S-4 is N end Tank B (11' bas)
 2:40 S-6 is S end Tank D (13' bas)
S-7 is S end Tank C (11' bas)
 3:05 S-8 is S end Tank B (11' bas)
S-9 is S end Tank A (11' bas)
 3:20 S-5 is N end Tank A (11' bas).

All samples in fuel tank had odor + were discolored.
S-1 to be sampled for waste oil constituents.
S-2 + S-6 to be sampled for total Pb, ~~as well~~

II.A BUSINESS PLANS (Title 19)

- 1. Immediate Reporting 2703
- 2. Bus. Plan Stds. 25503(b)
- 3. RR Cars > 30 days 25503.7
- 4. Inventory Information 25504(a)
- 5. Inventory Complete 2730
- 6. Emergency Response 25504(b)
- 7. Training 25504(c)
- 8. Deficiency 25505(a)
- 9. Modification 25505(b)

II.B ACUTELY HAZ. MATLS

- 10. Registration Form Filed 25533(a)
- 11. Form Complete 25533(b)
- 12. RMPP Contents 25534(c)
- 13. Implement Sch. Req'd? (Y/N) 25524(c)
- 14. OffSite Conseq. Assess. 25534(d)
- 15. Probable Risk Assessment 25534(g)
- 16. Persons Responsible 25534(i)
- 17. Certification 25534(j)
- 18. Exemption Request? (Y/N) 25536(b)
- 19. Trade Secret Requested? 25538

III. UNDERGROUND TANKS (Title 23)

- General
 - 1. Permit Application 25284 (H&S)
 - 2. Pipeline Leak Detection 25292 (H&S)
 - 3. Records Maintenance 2712
 - 4. Release Report 2651
 - 5. Closure Plans 2670
- 6. Method
 - 1) Monthly Test 1:55
 - 2) Daily Vadose
 - Semi-annual groundwater
 - One time soils
 - 3) Daily Vadose
 - One time soils
 - Annual tank test
 - 4) Monthly Groundwater
 - One time soils
 - 5) Daily Inventory
 - Annual tank testing
 - Cont pipe leak det
 - Vadose/gndwater mon. 2:30
 - 6) Daily Inventory
 - Annual tank testing
 - Cont pipe leak det 2:40
 - 7) Weekly Tank Gauge
 - Annual tank testing
 - Annual Tank Testing
 - Daily Inventory
 - 9) Other 3:05
- 7. Precs Tank Test
 - Date: 2643
- 8. Inventory Rec. 2644
- 9. Soil Testing 2646
- 10. Ground Water. 2647
- 11. Monitor Plan 2632
- 12. Access. Secure 2634
- 13. Plans Submit 2711
- 14. As Built 2635

Rev 8/88

All samples analyzed for TPH-g + BTEX.

Contact: LYLE TRAVIS
 Title: CIVIL ENGR
 Signature: [Signature]

Inspector: Jennifer Eberle
 Signature: [Signature]

II, III

92220549
 IN CASE OF EMERGENCY OR SPILL, CALL THE NATIONAL RESPONSE CENTER 1-800-424-8802; WITHIN CALIFORNIA, CALL 1-800-852-7550

UNIFORM HAZARDOUS WASTE MANIFEST		1. Generator's US EPA ID No. C A C 0 0 0 8 6 9 0 5 6		Manifest Document No. 0 0 0 0 1		2. Page 1 of 1		Information in the shaded areas is not required by Federal law.					
3. Generator's Name and Mailing Address SABEK, INC. 1045 Airport Blvd., So. San Francisco, CA. 94080						A. State Manifest Document Number 92220549							
4. Generator's Phone (415) 588-3088						B. State Generator's ID							
5. Transporter 1 Company Name H & H SHIP SERVICE COMPANY				6. US EPA ID Number C A D 0 0 4 7 7 1 1 6 8		C. State Transporter's ID 401996							
7. Transporter 2 Company Name						D. Transporter's Phone (415) 543-4835							
9. Designated Facility Name and Site Address H & H Ship Service Company 220 China Basin Street San Francisco, CA. 94107						10. US EPA ID Number C A D 0 0 4 7 7 1 1 6 8		G. State Facility's ID					
						H. Facility's Phone (415) 543-4835							
11. US DOT Description (including Proper Shipping Name, Hazard Class, and ID Number)						12. Containers		13. Total		14. Unit		E. Waste Number	
						No.		Type		Quantity		Wt/Vol	
RESIDUE GASOLINE TANK NON-RCRA HAZARDOUS WASTE SOLID						0 0 1		T P 0 8 0 0 0		P		State 512 EPA/Other	
RESIDUE GASOLINE TANK NON-RCRA HAZARDOUS WASTE SOLID						0 0 1		T P 0 5 0 0 0		P		State 512 EPA/Other	
c.												State EPA/Other	
d.												State EPA/Other	
15. Additional Descriptions for Materials Listed Above EMPTY 8,000 gallon and 5,000 gallon tanks last containing gasoline. Tanks inerted with dry ice for transport. PROFILE #A28						K. Handling Codes for Wastes Listed Above a. 01 b. 01 c. d.							
15. Special Handling Instructions and Additional Information JOB #13154 24 Hr. Emergency Contact: H & H # (415) 543-4835 APPROPRIATE PROTECTIVE CLOTHING AND RESPIRATOR						JOB SITE: SABEK, INC. 1230 - 14TH STREET OAKLAND, CALIFORNIA							
16. GENERATOR'S CERTIFICATION: I hereby declare that the contents of the consignment are fully and accurately described above by proper shipping name and are classified, packed, marked, and labeled, and are in all respects in proper condition for transport by highway according to applicable federal, state and international laws.													
If I am a large quantity generator, I certify that I have a program in place to reduce the volume and toxicity of waste generated to the degree I have determined to be economically practicable and that I have selected the practicable method of treatment, storage, or disposal currently available to me which minimizes the present and future threat to human health and the environment; OR, if I am a small quantity generator, I have made a good faith effort to minimize my waste generation and select the best waste management method that is available to me and that I can afford.													
Printed/Typed Name Lee Huckins on behalf of				Signature Lee Huckins		Month 0 8		Day 2 4		Year 9			
17. Transporter 1 Acknowledgement of Receipt of Materials Printed/Typed Name MARTIN J. COSTELLO				Signature [Signature]		Month 0 8		Day 2 4		Year 9			
18. Transporter 2 Acknowledgement of Receipt of Materials Printed/Typed Name				Signature		Month		Day		Year			
19. Discrepancy Indication Space													
20. Facility Owner or Operator Certification of receipt of hazardous materials covered by this manifest except as noted in Item 19. Printed/Typed Name Rashan Shadlow				Signature [Signature]		Month 0 8		Day 2 4		Year 9			

DO NOT WRITE BELOW THIS LINE.

white -env.health
 yellow -facility
 pink -files

ALAMEDA COUNTY, DEPARTMENT OF ENVIRONMENTAL HEALTH
 Hazardous Materials Inspection Form

80 Swan Way, #200
 Oakland, CA 94621
 (415) 271-4320

p. 2 of 2

II, III

Site ID # _____ Site Name former service station Today's Date 8/25/93

Site Address 1230-14th St.
 City Oakland Zip 94607 Phone _____

MAX AMT stored > 500 lbs, 55 gal., 200 cft.?

Inspection Categories:

- I. Haz. Mat/Waste GENERATOR/TRANSPORTER
- II. Business Plans, Acute Hazardous Materials
- III. Underground Tanks

* Calif. Administration Code (CAC) or the Health & Safety Code (HS&C)

Comments:

3:35 Sampling under dispensers (see map):
 DS1 at ~1' bgs - sandy; appears clean
 4:55 DS2 at ~1' bgs } soil; + no odor
 DS3 at ~1' bgs }
 4:10 DS4 at ~1' bgs }
 DS5 at ~1' bgs }
 DS6 at ~1' bgs }
 DS1 and DS4 will be analyzed for total Pb, as well as TPHg + BTEX.
 All DS samples to be analyzed for TPHg + BTEX.
 4:30 West sidewall of fuel pit sampled because it's ~~is~~ stained.
 VSW-1 at ~6' bgs } stained + odorous
 VSW-2 at ~6' bgs }

II.A BUSINESS PLANS (Title 19)

- 1. Immediate Reporting 2703
- 2. Bus. Plan Sids. 25503(b)
- 3. RR Cars > 30 days 25503.7
- 4. Inventory Information 25504(a)
- 5. Inventory Complete 2730
- 6. Emergency Response 25504(b)
- 7. Training 25504(c)
- 8. Deficiency 25505(a)
- 9. Modification 25505(b)

II.B ACUTELY HAZ. MATLS

- 10. Registration Form Filed 25533(a)
- 11. Form Complete 25533(b)
- 12. RMPP Contents 25534(c)
- 13. Implement Sch. Req'd? (Y/N)
- 14. OffSite Conseq. Assess. 25524(c)
- 15. Probable Risk Assessment 25534(d)
- 16. Persons Responsible 25534(g)
- 17. Certification 25534(f)
- 18. Exemption Request? (Y/N) 25536(b)
- 19. Trade Secret Requested? 25538

III. UNDERGROUND TANKS (Title 23)

- General
- 1. Permit Application 25284 (H&S)
 - 2. Pipeline Leak Detection 25292 (H&S)
 - 3. Records Maintenance 2712
 - 4. Release Report 2651
 - 5. Closure Plans 2670

- Monitoring for Existing Tanks
- 6. Method
 - 1) Monthly Test
 - 2) Daily Vadose
Semi-annual groundwater
One time sols
 - 3) Daily Vadose
One time sols
Annual tank test
 - 4) Monthly Gndwater
One time sols
 - 5) Daily Inventory
Annual tank testing
Cont pipe leak det
Vadose/gndwater mon.
 - 6) Daily Inventory
Annual tank testing
Cont pipe leak det
 - 7) Weekly Tank Gauge
Annual tank testing
 - 8) Annual Tank Testing
Daily inventory
 - 9) Other _____

- 7. Prets Tank Test 2643
Date: _____
- 8. Inventory Rec. 2644
- 9. Soil Testing 2646
- 10. Ground Water 2647

- New Tanks
- 11. Monitor Plan 2632
 - 12. Access. Secure 2634
 - 13. Plans Submit 2711
Date: _____
 - 14. As Built 2635
Date: _____

Rev 8/88

Contact: _____

Title: _____

Signature: Joe Jenkins

Inspector: Jennifer Eberle

Signature: J Eberle

II, III

92220551
 IN CASE OF EMERGENCY OR SPILL, CALL THE NATIONAL RESPONSE CENTER 1-800-424-8802. WITHIN CALIFORNIA, CALL 1-800-852-7550
 GENERATOR
 FACILITY

UNIFORM HAZARDOUS WASTE MANIFEST		1. Generator's US EPA ID No. C A C 0 0 0 8 6 9 0 5 6 0 0 0 0 1		Manifest Document No.		2. Page 1 of 1		Information in the shaded areas is not required by Federal law.					
3. Generator's Name and Mailing Address SABEK, INC. 1045 Airport Blvd., So. San Francisco, CA. 94080						A. State Manifest Document Number 92220551							
4. Generator's Phone (415) 588-3088						B. State Generator's ID							
5. Transporter 1 Company Name H & H SHIP SERVICE COMPANY				6. US EPA ID Number C A D 0 0 4 7 7 1 1 6 8		C. State Transporter's ID 401998							
7. Transporter 2 Company Name						D. Transporter's Phone (415) 543-4835							
9. Designated Facility Name and Site Address H & H Ship Service Company 220 China Basin Street San Francisco, CA. 94107						10. US EPA ID Number C A D 0 0 4 7 7 1 1 6 8		G. State Facility's ID C A D 0 0 4 7 7 1 1 6 8					
11. US DOT Description (including Proper Shipping Name, Hazard Class, and ID Number)						12. Containers		13. Total Quantity		14. Unit Wt/Vol		E. Waste Number	
a. RESIDUE GASOLINE TANKS NON-RCRA HAZARDOUS WASTE SOLID						0 0 2 T P		0 5 0 0 0		P		State 512 EPA/Other	
b.												State EPA/Other	
c.												State EPA/Other	
d.												State EPA/Other	
J. Additional Descriptions for Materials Listed Above EMPTY 5,000 gallon tanks fast containing gasoline. Tanks inerted with dry ice for transport. PROFILE #A28						K. Handling Codes for Wastes Listed Above a. 01 b. c. d.							
15. Special Handling Instructions and Additional Information JOB #13154 24 Hr. Emergency Contact: H & H #(415) 543-4835 APPROPRIATE PROTECTIVE CLOTHING AND RESPIRATOR													
16. GENERATOR'S CERTIFICATION: I hereby declare that the contents of the consignment are fully and accurately described above by proper shipping name and are classified, packed, marked, and labeled, and are in all respects in proper condition for transport by highway according to applicable federal, state and international laws. If I am a large quantity generator, I certify that I have a program in place to reduce the volume and toxicity of waste generated to the degree I have determined to be economically practicable and that I have selected the practicable method of treatment, storage, or disposal currently available to me which minimizes the present and future threat to human health and the environment; OR, if I am a small quantity generator, I have made a good faith effort to minimize my waste generation and select the best waste management method that is available to me and that I can afford.													
Printed/Typed Name LYLE TRAVIS FOR SABEK INC.				Signature <i>[Signature]</i>				Month 0 8		Day 2 4		Year 9	
17. Transporter 1 Acknowledgement of Receipt of Materials Printed/Typed Name JOSE J. MORENO				Signature <i>[Signature]</i>				Month 0 8		Day 2 4		Year 9	
18. Transporter 2 Acknowledgement of Receipt of Materials Printed/Typed Name				Signature				Month		Day		Year	
19. Discrepancy Indication Space													
20. Facility Owner or Operator Certification of receipt of hazardous materials covered by this manifest except as noted in Item 19 Printed/Typed Name Rashan Shadlov				Signature <i>[Signature]</i>				Month 0 8		Day 2 4		Year 9	

DO NOT WRITE BELOW THIS LINE.

UNIFORM HAZARDOUS WASTE MANIFEST

1. Generator's US EPA ID No. C A C 0 0 0 8 6 9 0 5 6 2 0 5 5 2 Manifest Document No. 2 0 5 5 2 of 1 2. Page 1

Information in the shaded areas is not required by Federal law.

3. Generator's Name and Mailing Address
SABEK, INC.
 1045 Airport Blvd., So. San Francisco, CA. 94080

4. Generator's Phone (415) 588-3088

5. Transporter 1 Company Name **H & H Ship Service Company** 6. US EPA ID Number C A D 0 0 4 7 7 1 1 6 8

7. Transporter 2 Company Name _____ 8. US EPA ID Number _____

9. Designated Facility Name and Site Address **Erickson, Inc.** 10. US EPA ID Number C A D 0 0 3 4 6 6 3 9 2
 255 Parr Blvd.
 Richmond, Ca. 94801

11. US DOT Description (including Proper Shipping Name, Hazard Class, and ID Number)

12. Containers No. Type 13. Total Quantity 14. Unit Wt/Vol

a. *Write to Empty Storage Tanks*
NO. 2 BR Hazardous Waste Solids

0 0 1 T P 0 0 5 5 0 P

b. _____

c. _____

d. _____

J. Additional Descriptions for Materials Listed Above
Qty: 1 Empty Storage Tank (s) / Tank (s) have been inerted with 15 lbs. Dry Ice per 1000 Gals. Capacity.

K. Handling Codes for Wastes Listed Above
 a. _____ b. _____
 c. _____ d. _____

15. Special Handling Instructions and Additional Information
 Keep away from sources of ignition. Always wear hardhats when working around U.S.T.'s. 24 Hr.
 Contact Name H & H Phone #(415) 543-4835. JOB #13154

16. GENERATOR'S CERTIFICATION: I hereby declare that the contents of the consignment are fully and accurately described above by proper shipping name and are classified, packed, marked, and labeled, and are in all respects in proper condition for transport by highway according to applicable federal, state and international laws.
 If I am a large quantity generator, I certify that I have a program in place to reduce the volume and toxicity of waste generated to the degree I have determined to be economically practicable and that I have selected the practicable method of treatment, storage, or disposal currently available to me which minimizes the present and future threat to human health and the environment; OR, if I am a small quantity generator, I have made a good faith effort to minimize my waste generation and select the best waste management method that is available to me and that I can afford.

Printed/Typed Name **Lee Hickins** on behalf of _____

Signature *Lee Hickins*

Month Day Year 0 8 2 4 9 2

17. Transporter 1 Acknowledgement of Receipt of Materials
 Printed/Typed Name **JOSE J. MORENO**

Signature _____

Month Day Year 0 8 2 4 9 2

18. Transporter 2 Acknowledgement of Receipt of Materials
 Printed/Typed Name **Martin J Costello**

Signature *Martin J Costello*

Month Day Year 0 8 2 4 9 2

19. Discrepancy Indication Space

20. Facility Owner or Operator Certification of receipt of hazardous materials covered by this manifest except as noted in Item 19.
 Printed/Typed Name _____ Signature _____ Month Day Year _____

DO NOT WRITE BELOW THIS LINE.

IN CASE OF EMERGENCY OR SPILL, CALL THE NATIONAL RESPONSE CENTER 1-800-424-8802; WITHIN CALIFORNIA, CALL 1-800-852-7550

GENERATOR

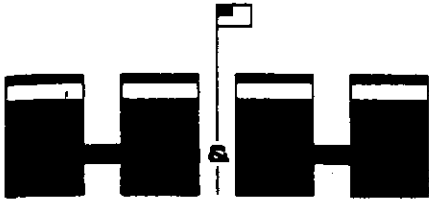

ENVIRONMENTAL SERVICES
 (DIVISION OF H&H SHIP SERVICE CO., INC.)

220 CHINA BASIN, SAN FRANCISCO, CA 94107 • DAY AND NIGHT: (415) 543-4835 FAX (415) 543-8265

CERTIFICATE OF DISPOSAL

AUGUST 27, 1993

H & H Ship Service Company hereby certifies to TANK PROTECT ENG.

1. The storage tank(s), size(s) ONE (1) 550 GALS. WASTE OIL

removed from the SABEK, INC.

facility at 1230 - 14TH STREET

OAKLAND, CALIFORNIA

were transported to H & H Ship Service Company, 220 China Basin St., San Francisco, California 94107.

2. The following tank(s), H & H Job Number 13154

have been steam cleaned, cut with approximately 2' x 2' holes, rendered harmless and disposed of as scrap metal.

3. Disposal site: LEVIN METALS, RICHMOND, CALIFORNIA

4. The foregoing method of destruction/disposal is suitable for the materials involved, and fully complies with all applicable regulatory and permit requirements.

5. Should you require further information, please call (415) 543-4835 or (415) 905-5510.

Very truly yours,

Lourdes B. Lopez

Lourdes B. Lopez
 Operations Coordinator

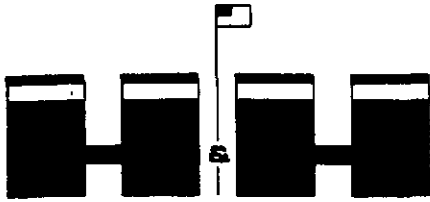

ENVIRONMENTAL SERVICES
 (DIVISION OF H&H SHIP SERVICE CO., INC.)

220 CHINA BASIN, SAN FRANCISCO, CA 94107 • DAY AND NIGHT: (415) 543-4835 FAX (415) 543-8265

CERTIFICATE OF DISPOSAL

AUGUST 27, 1993

H & H Ship Service Company hereby certifies to TANK PROTECT ENG.

1. The storage tank(s), size(s) ONE (1) 8,000 GALS. &
THREE (3) 5,000 GALS.

removed from the SABEK, INC.
 facility at 1230 - 14TH STREET
OAKLAND, CALIFORNIA

were transported to H & H Ship Service Company, 220 China Basin St., San Francisco, California 94107.

2. The following tank(s), H & H Job Number 13154
 have been steam cleaned, cut with approximately 2' x 2' holes, rendered harmless and disposed of as scrap metal.
3. Disposal site: SCHNITZER STEEL, OAKLAND, CALIFORNIA
4. The foregoing method of destruction/disposal is suitable for the materials involved, and fully complies with all applicable regulatory and permit requirements.
5. Should you require further information, please call (415) 543-4835 or (415) 905-5510.

Very truly yours,

Lourdes B. Lopez
 Lourdes B. Lopez
 Operations Coordinator

UNDERGROUND STORAGE TANK UNAUTHORIZED RELEASE (LEAK) / CONTAMINATION SITE REPORT

EMERGENCY <input type="checkbox"/> YES <input checked="" type="checkbox"/> NO		HAS STATE OFFICE OF EMERGENCY SERVICES REPORT BEEN FILED? <input type="checkbox"/> YES <input type="checkbox"/> NO		FOR LOCAL AGENCY USE ONLY I HEREBY CERTIFY THAT I HAVE DISTRIBUTED THIS INFORMATION ACCORDING TO THE DISTRIBUTION SHOWN ON THE INSTRUCTION SHEET ON THE BACK PAGE OF THIS FORM.		
REPORT DATE 0 <u>9</u> <u>1</u> <u>7</u> <u>9</u> <u>3</u>		CASE #		SIGNED _____ DATE _____		
REPORTED BY	NAME OF INDIVIDUAL FILING REPORT Marc Zomorodi		PHONE (510) 429-8088		SIGNATURE 	
	REPRESENTING <input checked="" type="checkbox"/> OWNER/OPERATOR <input type="checkbox"/> REGIONAL BOARD <input type="checkbox"/> LOCAL AGENCY <input type="checkbox"/> OTHER		COMPANY OR AGENCY NAME Tank Protect Engineering of Northern California, Inc.			
	ADDRESS 2821 Whipple Road Union City, CA 94587					
RESPONSIBLE PARTY	NAME Sabek, Inc. <input type="checkbox"/> UNKNOWN		CONTACT PERSON Andy Saberi		PHONE (415) 588-3088	
	ADDRESS 1045 Airport Blvd. S. San Francisco, CA 94080					
SITE LOCATION	FACILITY NAME (IF APPLICABLE)		OPERATOR Sabek, Inc.		PHONE (510) 822-4222	
	ADDRESS 1230 14th Street Oakland, Alameda 94607					
	CROSS STREET					
IMPLEMENTING AGENCIES	LOCAL AGENCY AGENCY NAME Alameda County Health Care Servs. Agency		CONTACT PERSON Jennifer Eberle		PHONE (510) 271-4320	
	REGIONAL BOARD CRWOCB - San Francisco Bay Region		PHONE (510) 464-1255			
SUBSTANCES INVOLVED	(1) NAME Petroleum hydrocarbons - see below				QUANTITY LOST (GALLONS) <input type="checkbox"/> UNKNOWN	
	(2) <input type="checkbox"/> UNKNOWN					
DISCOVERY/ABATEMENT	DATE DISCOVERED 0 <u>8</u> <u>2</u> <u>4</u> <u>9</u> <u>3</u>		HOW DISCOVERED <input type="checkbox"/> INVENTORY CONTROL <input type="checkbox"/> SUBSURFACE MONITORING <input type="checkbox"/> NUISANCE CONDITIONS <input type="checkbox"/> TANK TEST <input checked="" type="checkbox"/> TANK REMOVAL <input type="checkbox"/> OTHER			
	DATE DISCHARGE BEGAN <input checked="" type="checkbox"/> UNKNOWN		METHOD USED TO STOP DISCHARGE (CHECK ALL THAT APPLY) <input type="checkbox"/> REMOVE CONTENTS <input checked="" type="checkbox"/> CLOSE TANK & REMOVE <input type="checkbox"/> REPAIR PIPING <input type="checkbox"/> REPAIR TANK <input type="checkbox"/> CLOSE TANK & FILL IN PLACE <input type="checkbox"/> CHANGE PROCEDURE <input type="checkbox"/> REPLACE TANK <input type="checkbox"/> OTHER			
	HAS DISCHARGE BEEN STOPPED? <input type="checkbox"/> YES <input type="checkbox"/> NO IF YES, DATE _____					
SOURCE/CAUSE	SOURCE OF DISCHARGE <input type="checkbox"/> TANK LEAK <input checked="" type="checkbox"/> UNKNOWN <input type="checkbox"/> PIPING LEAK <input type="checkbox"/> OTHER		CAUSE(S) <input type="checkbox"/> OVERFILL <input type="checkbox"/> RUPTURE/FAILURE <input type="checkbox"/> SPILL <input type="checkbox"/> CORROSION <input checked="" type="checkbox"/> UNKNOWN <input type="checkbox"/> OTHER			
	CHECK ONE ONLY <input type="checkbox"/> UNDETERMINED <input type="checkbox"/> SOIL ONLY <input type="checkbox"/> GROUNDWATER <input type="checkbox"/> DRINKING WATER - (CHECK ONLY IF WATER WELLS HAVE ACTUALLY BEEN AFFECTED)					
CURRENT STATUS	CHECK ONE ONLY <input type="checkbox"/> NO ACTION TAKEN <input type="checkbox"/> PRELIMINARY SITE ASSESSMENT WORKPLAN SUBMITTED <input type="checkbox"/> POLLUTION CHARACTERIZATION <input type="checkbox"/> LEAK BEING CONFIRMED <input type="checkbox"/> PRELIMINARY SITE ASSESSMENT UNDERWAY <input type="checkbox"/> POST CLEANUP MONITORING IN PROGRESS <input type="checkbox"/> REMEDIATION PLAN <input type="checkbox"/> CASE CLOSED (CLEANUP COMPLETED OR UNNECESSARY) <input type="checkbox"/> CLEANUP UNDERWAY					
	REMEDIAL ACTION	CHECK APPROPRIATE ACTION(S) (SEE BACK FOR DETAILS)				
<input type="checkbox"/> CAP SITE (CD)		<input type="checkbox"/> EXCAVATE & DISPOSE (ED)		<input type="checkbox"/> REMOVE FREE PRODUCT (FP)		
<input type="checkbox"/> CONTAINMENT BARRIER (CB)		<input type="checkbox"/> EXCAVATE & TREAT (ET)		<input type="checkbox"/> PUMP & TREAT GROUNDWATER (GT)		
<input type="checkbox"/> VACUUM EXTRACT (VE)		<input type="checkbox"/> NO ACTION REQUIRED (NA)		<input type="checkbox"/> TREATMENT AT HOOKUP (HU)		
<input type="checkbox"/> ENHANCED BIO DEGRADATION (IT) <input type="checkbox"/> REPLACE SUPPLY (RS) <input type="checkbox"/> VENT SOIL (VS) <input type="checkbox"/> OTHER (OT)						
COMMENTS	Removed three 5,000-gallons gasoline, one 8,000-gallon gasoline and one 550-gallon waste oil underground storage tanks.					

APPENDIX B

SAMPLE HANDLING PROCEDURES

APPENDIX B

SAMPLE HANDLING PROCEDURES

Soil and groundwater samples will be packaged carefully to avoid breakage or contamination, and will be delivered to the laboratory in an iced-cooler. The following sample packaging requirements will be followed.

- . Sample bottle/sleeve lids will not be mixed. All sample lids will stay with the original containers and have custody seals affixed to them.
- . Samples will be secured in coolers to maintain custody, control temperature, and prevent breakage during transportation to the laboratory.
- . A chain-of-custody form will be completed for all samples and accompany the sample cooler to the laboratory.
- . Ice, blue ice, or dry ice (dry ice will be used for preserving soil samples collected for the Alameda County Water District) will be used to cool samples during transport to the laboratory.
- . Each sample will be identified by affixing a pressure sensitive, gummed label, or standardized tag on the container(s). This label will contain the site identification, sample identification number, date and time of sample collection, and the collector's initials.
- . Soil samples collected in brass tubes will be preserved by covering the ends with Teflon tape and capped with plastic end-caps. The tubes will be labeled, sealed in quart size bags, and placed in an iced-cooler for transport to the laboratory.

All groundwater sample containers will be precleaned and will be obtained from a State Department of Health Services certified analytical laboratory.

Sample Control/Chain-of-Custody: All field personnel will refer to this workplan to verify the methods to be employed during sample collection. All sample gathering activities will be recorded in the site file; all sample transfers will be documented in the chain-of-custody; samples are to be identified with labels and all sample bottles are to be custody-sealed. All information is to be recorded in waterproof ink. All TPE field personnel are personally responsible for sample collection and the care and custody of collected samples until the samples are transferred or properly dispatched.

The custody record will be completed by the field technician or professional who has been designated by the TPE project manager as being responsible for sample shipment to the appropriate laboratory. The custody record will include, among other things, the following information: site identification, name of person collecting the samples, date and time samples were collected, type of sampling conducted (composite/grab), location of sampling station, number and type of containers used, and signature of the TPE person relinquishing samples to a non-TPE person with the date and time of transfer noted. The relinquishing individual will also put all the specific shipping data on the custody record.

Records will be maintained by a designated TPE field employee for each sample, site identification, sampling locations, station numbers, dates, times, sampler's name, designation of the samples as a grab or composite, notation of the type of sample (e.g. groundwater, soil boring, etc.), preservatives used, on-site measurement data, and other observations or remarks.

APPENDIX C

CERTIFIED ANALYTICAL REPORTS AND
CHAIN-OF-CUSTODY DOCUMENTATION



PRIORITY ENVIRONMENTAL LABS

Precision Environmental Analytical Laboratory

August 31, 1993

PEL # 9308104

TANK PROTECT ENGINEERING, INC.

Attn: Jeff

Re: Twenty two soil samples for Gasoline/BTEX, Diesel, and Oil & Grease analyses.

Project name: Sabek, Inc.
Project number: 150A082693

Project location: 1230 14th St.

Date sampled: Aug 25-26, 1993
Date extracted: Aug 27-30, 1993

Date submitted: Aug 27, 1993
Date analyzed: Aug 27-30, 1993

RESULTS:

SAMPLE I.D.	Gasoline (mg/Kg)	Diesel (mg/Kg)	Benzene (ug/Kg)	Toluene (ug/Kg)	Ethyl Benzene (ug/Kg)	Total Xylenes (ug/Kg)	Oil & Grease (mg/Kg)
DS-1	13	---	7.0	17	21	72	---
DS-2	2.0	---	5.3	8.9	12	31	---
DS-3	1.3	---	N.D.	5.9	6.1	18	---
DS-4	2.7	---	5.5	9.4	16	47	---
DS-5	3.4	---	5.9	11	18	61	---
DS-6	11	---	6.8	15	18	64	---
S-1	67	1200	38	89	110	380	7700
S-2	2200	---	1400	3200	3500	13000	---
S-3	530	---	400	760	830	3100	---
S-4	40	---	31	59	66	290	---
S-5	1.4	---	N.D.	6.3	8.1	25	---
S-6	1600	---	970	2300	2700	10000	---
S-7	11000	---	6700	16000	18000	69000	---
S-8	18000	---	11000	26000	30000	110000	---
S-9	6200	---	3700	8700	10000	37000	---
SP1-1,2,3,4*	960	---	580	1400	1600	5900	---
SP1-5,6,7,8*	950	---	560	1400	1500	5700	---
SP2-1,2,3,4*	3500	---	2200	5100	5900	22000	---
SP2-5,6,7,8*	4800	---	2800	7100	8200	31000	---
VSPC-1	1.7	---	N.D.	6.6	9.6	28	---
VSW-1	4800	---	2900	7000	8000	30000	---
VSW-2	21	---	150	290	330	1300	---
Blank	N.D.	N.D.	N.D.	N.D.	N.D.	N.D.	N.D.
Spiked Recovery	82.3%	94.1%	84.0%	85.2%	83.1%	92.2%	---
Duplicate Spiked Recovery	92.0%	93.6%	89.5%	90.6%	88.4%	98.7%	---
Detection limit	1.0	1.0	5.0	5.0	5.0	5.0	10
Method of Analysis	5030/ 8015	3550/ 8015	8020	8020	8020	8020	5520 D & F

*Composited soil samples.

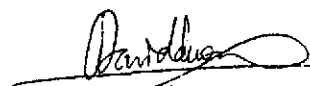
David Duong
Laboratory Director



PRIORITY ENVIRONMENTAL LABS

Precision Environmental Analytical Laboratory

September 02, 1993

PEL # 9308104

TANK PROTECT ENGINEERING, INC.

Attn: Jeff

Re: Five soil samples for Cadmium, Chromium, Lead, Nickel,
and Zinc analyses.

Project name: Sabek, Inc.
Project location: 1230 14th St.
Project number: 150A082693

Date sampled: Aug 25-26, 1993
Date extracted: Aug 31, 1993

Date submitted: Aug 27, 1993
Date analyzed: Aug 31, 1993

RESULTS:

SAMPLE I.D.	Cadmium (mg/Kg)	Chromium (mg/Kg)	Lead (mg/Kg)	Nickel (mg/Kg)	Zinc (mg/Kg)
S-1	N.D.	43	47	36	35
S-2	---	---	N.D.	---	---
S-6	---	---	N.D.	---	---
DS-1	---	---	33	---	---
DS-4	---	---	11	---	---
Blank	N.D.	N.D.	N.D.	N.D.	N.D.
Detection limit	0.5	1.0	1.0	1.0	1.0
Method of Analysis	7130	7190	7420	7520	7950

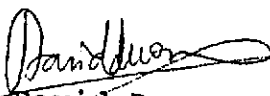
David Duong
Laboratory Director



PRIORITY ENVIRONMENTAL LABS

Precision Environmental Analytical Laboratory

August 31, 1993

PEL #: 9308104

TANK PROTECT ENGINEERING, INC.

Attn: Jeff

Project name : Sabek, Inc.
Project location: 1230 14th St.
Sample I.D.: S-1

Project number: 150A082693

Date Sampled: Aug 25, 1993
Date Analyzed: Aug 30, 1993

Date Submitted: Aug 27, 1993

Method of Analysis: EPA 8010

Detection limit: 5.0 ug/Kg

COMPOUND NAME	CONCENTRATION (ug/Kg)	SPIKE RECOVERY (%)
Chloromethane	N.D.	-----
Vinyl Chloride	N.D.	91.6
Bromomethane	N.D.	-----
Chloroethane	N.D.	-----
Trichlorofluoromethane	N.D.	-----
1,1-Dichloroethene	N.D.	87.8
Methylene Chloride	N.D.	-----
1,2-Dichloroethene (TOTAL)	N.D.	-----
1,1-Dichloroethane	N.D.	83.5
Chloroform	N.D.	-----
1,1,1-Trichloroethane	N.D.	89.2
Carbon Tetrachloride	N.D.	-----
1,2-Dichloroethane	N.D.	-----
Trichloroethene	N.D.	101.6
1,2-Dichloropropane	N.D.	-----
Bromodichloromethane	N.D.	-----
2-Chloroethylvinylether	N.D.	-----
Trans-1,3-Dichloropropene	N.D.	-----
Cis-1,3-Dichloropropene	N.D.	-----
1,1,2-Trichloroethane	N.D.	-----
Tetrachloroethene	N.D.	103.8
Dibromochloromethane	N.D.	-----
Chlorobenzene	N.D.	-----
Bromoform	N.D.	-----
1,1,2,2-Tetrachloroethane	N.D.	-----
1,3-Dichlorobenzene	N.D.	-----
1,4-Dichlorobenzene	N.D.	-----
1,2-Dichlorobenzene	N.D.	-----

David Duong
Laboratory Director



TANK PROTECT ENGINEERING

2821 WHIPPLE ROAD
 UNION CITY, CA 94587
 (415)429-8088
 (800)523-8088
 FAX(415)429-8089

PEL # 9308104 (1 of 4)

INV # 23944

LAB: Priority Env

TURNAROUND: normal

P.O. #: 686

PAGE 1 OF 4

CHAIN OF CUSTODY

PROJECT NO.		SITE NAME & ADDRESS				(1) TYPE OF CON- TAINER	ANALYTES REQUESTED						REMARKS
150A082693		Sabek Inc 1230 14 th Street					TOTAL LIGHT HC	AROMATIC HC	TOTAL HC (BTEX)	OIL & GREASE	VOC SCAN	OTHER	
SAMPLER NAME, ADDRESS AND TELEPHONE NUMBER Lee Huckins 2821 WHIPPLE ROAD, UNION CITY, CA 94587 (415) 429-8088													
ID NO.	DATE	TIME	SOIL	WATER	SAMPLING LOCATION								
SPH	8/25	1215	X		3-6	Brass	X	X					
SP1-2	8/25	1210	X		3.0	Brass	X	X				Composite into 1 sample ^{SP1} (1-4)	
SP1-3	8/25	1225	X		3.0	Brass	X	X					
SP1-4	8/25	1230	X		3.0	Brass	X	X					
SP1-5	8/25	1240	X		3.0	Brass	X	X					
SP1-6	8/25	1245	X		3.0	Brass	X	X				Composite into 1 sample ^{SP1} (5-8)	
SP1-7	8/25	1250	X		3.0	Brass	X	X					
SP1-8	8/25	1255	X		3.0	Brass	X	X					
S-1	8/25	1335	X		8.5'	Brass	X	X	X	X	X	OEG EPA 5520-F	
Relinquished by: (Signature) Lee Huckins		Date / Time 8/26/93 1:00		Received by: (Signature) [Signature]		Relinquished by: (Signature) [Signature]		Date / Time 8/29/93 9:42		Received by: (Signature)			
Relinquished by: (Signature)		Date / Time		Received by: (Signature) PEL		Relinquished by: (Signature)		Date / Time		Received by: (Signature)			
Relinquished by: (Signature)		Date / Time 8/27/93 9:45		Received for Laboratory by: (Signature) [Signature]		Date / Time		Remarks					

DATE: 8-26-93



TANK PROTECT ENGINEERING

2821 WHIPPLE ROAD
 UNION CITY, CA 94587
 (415) 429-8089
 (800) 523-8088
 FAX (415) 429-8089

PEL # 9308104 (2 of 4)

INV # 23944

LAB: Priority Env

TURNAROUND: Normal

P.O. #: 686

PAGE 2 OF 4

CHAIN OF CUSTODY

PROJECT NO.		SITE NAME & ADDRESS				(1) TYPE OF CON- TAINER	ANALYTES REQUESTED							REMARKS
SAMPLER NAME, ADDRESS AND TELEPHONE NUMBER		SAMPLING LOCATION					TOTAL LIGHT HC	AROMATIC HC	TOTAL HEAVY HC	OIL & GREASE	POC SCAN (621's)	OTHER	Total Pb	
ID NO.	DATE	TIME	SOIL	WATER	SAMPLING LOCATION									
KOD082693		Sabel Inc 1230 14th St												
Lee Hutchins 2821 WHIPPLE ROAD, UNION CITY, CA 94587 (415) 429-8088														
S-2	8/25	1400	X		14'	Brass	X	X					X	
S-3	8/25	1415	2		11.0	Brass	X	X						
S-4	8/25	1425	2		11.0	Brass	X	X						
S-5	8/25	15	2		11.0	Brass	X	X						
S-6	8/25	1440	2		13.0	Brass	X	X					X	
S-7	8/25	1455	2		11.0	Brass	X	X						
S-8	8/25	1500	2		11.0	Brass	X	X						
S-9	8/25	1510	2		11.0	Brass	X	X						
DS-1	8/25	1550	2		1.0	Brass	X	X					X	
Relinquished by: (Signature) <i>Lee Hutchins</i>		Date / Time 8/26/93 14:00		Received by: (Signature) <i>Jim Miller</i>		Relinquished by: (Signature) <i>Jim Miller</i>		Date / Time 8/28/93 14:42		Received by: (Signature)				
Relinquished by: (Signature)		Date / Time		Received by: (Signature) <i>Unknown</i>		Relinquished by: (Signature)		Date / Time		Received by: (Signature)				
Relinquished by: (Signature)		Date / Time 8/27/93 9:45		Received for Laboratory by: (Signature) <i>PEL</i>		Date / Time		Remarks						

DATE: 8-26-93



TANK PROTECT ENGINEERING

2821 WHIPPLE ROAD
 UNION CITY, CA 94587
 (415)429-8088
 (800)523-8088
 FAX(415)429-8089

PEL # 9308104 (3 of 4)
 INV # 23944

LAB: Priority Env
 TURNAROUND: Normal
 P.O. #: 1686

PAGE 3 OF 4

CHAIN OF CUSTODY

PROJECT NO.		SITE NAME & ADDRESS				(1) TYPE OF CON- TAINER	ANALYTES REQUESTED							REMARKS
SAMPLER NAME, ADDRESS AND TELEPHONE NUMBER							TOTAL LIGHT HC	AROMATIC HC	TOTAL HEAVY HC	OIL & GREASE	PC SCAN (624's)	OTHER		
ID NO.	DATE	TIME	SOIL	WATER	SAMPLING LOCATION									
A 15082093		Sabel Inc 1230 14th St												
Lee Huckins		2821 WHIPPLE ROAD, UNION CITY, CA 94587 (415) 429-8088												
DS-2	8/25/93	1555	✓		1.0	Brass	✓	✓						
DS-3	8/25	1600	✓		1.0	Brass	✓	✓						
DS-4	8/25	1612	✓		1.0	Brass	✓	✓				✓		
DS-5	8/25	1615	✓		1.0	Brass	✓	✓						
DS-6	8/25	1615	✓		1.0	Brass	✓	✓						
VSW-1	8/25	1630	✓		6.0	Brass	✓	✓						
VSW-2	8/25	1635	✓		6.0	Brass	✓	✓						
SP2-1	8/26	1205	✓		3.0	Brass	✓	✓						
SP2-2	8/26	1209	✓		3.0	Brass	✓	✓						Composite into 1 sample SP2(1-4)
Relinquished by: (Signature) Lee Huckins		Date / Time 8/26/93 4:00		Received by: (Signature) [Signature]		Relinquished by: (Signature) [Signature]		Date / Time 8/27/93 9:43		Received by: (Signature)				
Relinquished by: (Signature)		Date / Time		Received by: (Signature)		Relinquished by: (Signature)		Date / Time		Received by: (Signature)				
Relinquished by: (Signature)		Date / Time 8/27/93 9:45		Received for Laboratory by: (Signature) PEL		Date / Time		Remarks						

DATE: 8-26-93



TANK PROTECT ENGINEERING

2821 WHIPPLE ROAD
 UNION CITY, CA 94587
 (415) 429-8088
 (800) 523-8088
 FAX (415) 429-8089

PEL # 9308104 (4 of 4)

INV # 23944

LAB: Priority Env

TURNAROUND: Normal

P.O. #: 686

PAGE 4 OF 4

CHAIN OF CUSTODY

PROJECT NO.		SITE NAME & ADDRESS				(1) TYPE OF CON- TAINER	ANALYTES REQUESTED						REMARKS
SAMPLER NAME, ADDRESS AND TELEPHONE NUMBER		SAMPLING LOCATION					TOTAL LIGHT HC	AROMATIC HC	TOTAL HC (HTX)	OIL & GREASE	POC SCAN (624's)	OTHER	
ID NO.	DATE	TIME	SOIL	WATER	SAMPLING LOCATION								
50A SD 082693					Sabek Inc 1730 14th St								
Lee Hudkins 2821 WHIPPLE ROAD, UNION CITY, CA 94587 (415) 429-8088													
SP23	8/26	1214	x		3.0	Brass	x	x				Composite into 1 sample SP2(1-4)	
SP24	8/26	1218	x		3.0	Brass	x	x					
SP25	8/26	1223	x		3.0	Brass	x	x					
SP26	8/26	1227	x		3.0	Brass	x	x					
SP27	8/26	1233	x		3.0	Brass	x	x				Composite into 1 sample SP2(5-8)	
SP28	8/26	1240	x		3.0	Brass	x	x					
USPC-1	8/26	1250	x		3.0	Brass	x	x					
USPC-2	8/26	1255	x		3.0	Brass	x	x					
Relinquished by: (Signature) <i>Lee Hudkins</i>		Date / Time 8/26/93 4:00	Received by: (Signature) <i>Jan Moe</i>		Relinquished by: (Signature) <i>Jan Moe</i>		Date / Time 8/27/93 9:43	Received by: (Signature)					
Relinquished by: (Signature)		Date / Time	Received by: (Signature) <i>John</i>		Relinquished by: (Signature)		Date / Time	Received by: (Signature)					
Relinquished by: (Signature)		Date / Time 8/27/93 9:45	Received for Laboratory by: (Signature) <i>PEL</i>		Date / Time	Remarks							

DATE: 8-26-93