

ST ID 5579

**Final Summary Report
Tabulation of Current Analytical Data
Shellmound Ventures (Parcels I, II, and III)
and Former Barbary Coast Steel Properties
Emeryville, California**

April 21, 1995

Prepared for :

City of Emeryville
Public Works Department
2200 Powell Street, 12th Floor
Emeryville, California 94608-1806

AGI Project No. 15,681.005.04

April 21, 1995

AGI Project No. 15,681.005.04

Mr. Maurice Kaufman
City of Emeryville
Public Works Department
2200 Powell Street, 12th Floor
Emeryville, California 94608

**FINAL SUMMARY REPORT
TABULATION OF CURRENT ANALYTICAL DATA
SHELLMOUND VENTURES (PARCELS I, II, AND III)
AND FORMER BARBARY COAST STEEL PROPERTIES
EMERYVILLE, CALIFORNIA**

AGI is pleased to present this summary report describing professional consulting services provided for tabulation of current analytical data for the Shellmound Ventures Property (Parcels I, II, and III) and the former Barbary Coast Steel property, located in Emeryville, California, as shown on Figure 1. AGI's services were provided in accordance with our proposal of March 20, 1995. We understand the purpose of the data tabulation is to provide useable information to contractors bidding for road construction work within the project area.

PURPOSE AND SCOPE OF SERVICES

The purpose of our services was to provide a tabular summary of available laboratory analytical information and graphical information regarding data locations, to be included in a bid package prepared for road construction projects at the site. Our scope of services included the following:

- Tabulating available laboratory analytical data for soil and groundwater samples collected from the properties, including sample identification number, location (property from which collected), depth (soil), date collected, and contaminant concentrations detected.
- Preparing site plans showing soil and groundwater sample identification numbers and locations.
- Preparing a brief report which summarizes current data at the properties, and includes the tables and plans described above. The report will not include copies of laboratory reports.

SITE DESCRIPTION AND BACKGROUND

The site consists of the Shellmound Ventures Property (Shellmound Parcels I, II, and III), and the adjacent former Barbary Coast Steel property to the south. Shellmound Parcels I, II, and III are located between Shellmound Street and Interstate 80, near the south end of Shellmound Street. The Barbary Coast Steel property is located directly south of the Shellmound Ventures Property, at the south end of Shellmound Street. Former site buildings have been removed, and subsurface utility and roadway construction activities are currently ongoing at the site.

AGI previously performed a site characterization of the Shellmound Ventures Property, and presented the results in a draft report, dated February 28, 1995. Results of site investigations performed at the Shellmound Ventures Property by others were included in the characterization report, and the analytical data are presented in Tables 1 through 6. Site investigations performed by others at the former Barbary Coast Steel property were summarized for this report, and available analytical data from these investigations are included in Tables 7 through 12. Data gathered for the tables in this report were provided by the City of Emeryville and the California Department of Toxic Substances Control. A list of data references is attached.

SUMMARY OF INVESTIGATION DATA

Shellmound Ventures Property

The Shellmound Ventures Property, shown on Figure 2, is currently fenced and relatively level. The previously hummocky surface has been modified for construction operations. Parcels II and III contain stockpiles of excavated material generated by ongoing construction activities. Portions of the eastern half of Parcels I and II have been raised by fill material placed on the surface. The previous surface material consisted of soil, slag, and construction debris. Nine monitoring wells exist on or near Parcel III. One well (MW17) has been covered by debris. Temescal Creek, a concrete-lined channel, is located between Parcels II and III, and is not part of the Shellmound Ventures Property.

The Shellmound Ventures Property is currently blanketed with a 2 to 12-foot-thick layer of fill consisting of soil intermixed with slag and construction debris. Additional fill placed on the surface during roadway construction activities may have increased the thickness of the fill in some areas. Beneath the fill are Bay Deposits consisting of clay, clayey sand, and sand lenses. The depth to groundwater measured in the existing wells has ranged from about 5 to 8 feet below the ground surface (bgs). The general direction of groundwater flow in Parcel III is toward Temescal Creek. The measured groundwater flow direction across Parcels I and II has ranged from west to southwest.

Available investigation data gathered included analytical results for soil and groundwater samples collected from the property. Table 1 presents results of soil sample analyses for petroleum hydrocarbons, volatile organic compounds (VOCs), semivolatile organic compounds

(SVOCs), and polychlorinated biphenyls (PCBs). Table 2 presents results of soil sample analyses for heavy metals. Table 3 presents results of soil sample analyses for pH and specific conductivity. Locations of soil samples collected from the property are shown on Figure 3.

Table 4 presents results of groundwater sample analyses for petroleum hydrocarbons, VOCs, SVOCs, and PCBs. Table 5 presents results of groundwater sample analyses for heavy metals. Table 6 presents results of groundwater sample analyses for pH, specific conductivity, and total dissolved solids. Locations of groundwater samples collected are shown on Figure 4.

Sample locations shown on Figures 3 and 4 were obtained from locations mapped by AGI and others. No survey data for sample locations were discovered in the reviewed data. Based upon the lack of survey data, sample locations are considered approximate.

Barbary Coast Steel Property

The Barbary Coast Steel Property, shown on Figure 5, is currently fenced and relatively level, and is adjacent to the south side of Shellmound Parcel 1. Road construction is ongoing at the property, including a fly-over structure constructed over existing railroad lines at the eastern property boundary. Portions of the northeastern quarter of the property have been raised by fill material placed on the surface. The previous surface material consisted of soil, slag, and construction debris. Prior to construction activities, 18 monitoring wells and one water supply well existed on the property. One well (MW1) was abandoned prior to commencement of construction activities. The former Temescal Creek channel was located near the center of the property, prior to realignment of the creek to its current location to the north.

The Barbary Coast Steel Property is currently blanketed with a 3 to 12-foot-thick layer of fill consisting of soil intermixed with slag and construction debris. Additional fill placed on the surface during roadway construction activities may have increased the thickness of the fill in some areas. Fill has been removed in other areas as part of construction activities. Beneath the fill are Bay Deposits consisting of clay, clayey sand, and sand lenses. The depth to groundwater encountered at the property has ranged from about 3 to 8 feet bgs. The general direction of groundwater flow across the property is to the southwest.

Available investigation data gathered included analytical results for soil and groundwater samples collected from the property. Table 7 presents results of soil sample analyses for petroleum hydrocarbons, VOCs, SVOCs, and PCBs. Table 8 presents results of soil sample analyses for heavy metals. Table 9 presents results of soil sample analyses for pH and specific conductivity. Locations of soil samples collected from the property are shown on Figure 6.

Table 10 presents results of groundwater sample analyses for petroleum hydrocarbons, VOCs, SVOCs, and PCBs. Table 11 presents results of groundwater sample analyses for heavy metals. Table 12 presents results of groundwater sample analyses for pH, specific conductivity, and total dissolved solids. Locations of groundwater samples collected are shown on Figure 7.

Sample locations shown on Figures 6 and 7 were obtained from locations mapped by others.

Emeryville Public Works Department
April 21, 1995
Page 4

No survey data for sample locations were discovered in the reviewed data. Based upon the lack of survey data, sample locations are considered approximate.

SUMMARY OF ANALYTICAL RESULTS

Of the soil contaminants detected, petroleum hydrocarbons, PCBs, and heavy metals appear to be most prevalent or of most concern to evaluating disposal requirements for excavated material. Total petroleum hydrocarbons as gasoline (TPH-G), hydraulic oil and/or total oil and grease (TPH-OG), and/or diesel (TPH-D) were detected in 33 samples at concentrations above that which is generally acceptable at local landfills. Only one of the 33 samples was collected from the Shellmound Ventures Property. PCBs were present in eight samples at the Shellmound Ventures Property, but were not detected in any soil samples from the Barbary Coast Steel Property. Concentrations of PCBs in six of the eight samples were above the Total Threshold Limit Concentrations (TTLC) of 1.0 mg/kg. Heavy metals were detected in all soil samples analyzed. Lead, Copper, and/or Zinc were detected in more than 50 soil samples at concentrations exceeding their respective TTLC values (lead: 1,000 mg/kg; copper: 2,500 mg/kg; zinc: 5,000 mg/kg).

Concentrations of contaminants detected in samples collected from several locations at the site exceed the TTLCs. The TTLC values are used under California law for characterizing a waste as hazardous. Material excavated from areas where the TTLC for any specific contaminant is exceeded may therefore require handling and disposal as hazardous waste. Areas from which samples were not collected, or from which samples collected were not analyzed, may contain contaminants at concentrations in excess of TTLC values. During road construction, any excavated material should be analyzed for the contaminants of concern (based upon the specific location) to determine appropriate handling and disposal requirements.

If you have any questions regarding this data tabulation and summary report, please call. We appreciate the opportunity to provide services to the City of Emeryville, and look forward to assisting you with future needs.

Sincerely,

AGI Technologies

John B. Adams
Project Manager

JBA/WPH/jba

attachments
FILE:DATATAB.WPS



Reference: Map from USGS 7.5 minute quadrangle titled Oakland West.

AGI
TECHNOLOGIES

Vicinity Map
Emeryville Public Works/Data Tabulation
Emeryville, California

FIGURE

1

PROJECT NO.
15,881.005

DRAWN
DFF

DATE
17 Apr 95

APPROVED

REVISED

DATE

HARCROS PIGMENTS
(FORMERLY PFIZER PIGMENTS)

MYERS CONTAINER CORPORATION

BARBARY COAST STEEL
(FORMERLY JUDSON STEEL)

SHELLMOUND STREET

PARCEL I

PARCEL II

PARCEL III





PROPOSED
ROADWAY

Jambuchi Creek

INTERSTATE 80 FREEWAY

CALTRANS EASEMENT

POWELL STREET PLAZA
(FORMER P.I.E. SITE)

- LEGEND**
- MW-17  Existing Monitor Well
 - HP9  Hydropunch Sampling Location
 - B-1  Soil Boring
 - P2  Piezometer (Groundwater level data only)

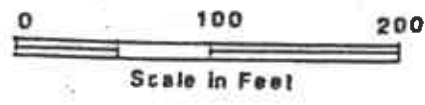
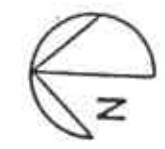

Reference: A.L.T.A. Survey, Shellmound Venture Properties, A.P.N. 049-1516-004, 006 & 007, City of Emeryville, Alameda County, California, by Mark Thomas & Co., Inc., dated 2/10/84.

AGI TECHNOLOGIES	Shellmound Ventures Property		Emeryville Public Works/Data Tabulation		Emeryville, California	FIGURE 2
	PROJECT NO. 15,681.005	DRAWN DFF	DATE 17 Apr 95	APPROVED	REVISED	DATE

HARCROS PIGMENTS
(FORMERLY PFIZER PIGMENTS)

MYERS CONTAINER CORPORATION

BARBARY COAST STEEL
(FORMERLY JUDSON STEEL)

SHELLMOUND STREET

PARCEL I

PARCEL II

PARCEL III

Approximate
Range of Groundwater
Flow Direction
(February 1995)

PROPOSED

ROADWAY

Temescal Creek

P2

P3

P1

MW-17

MG-4

PZ-1

(5/90)

MW-18

(11/93)

MG-1

(11/93)

MG-7

(11/94)

(11/93)

(4/89)

(5/90)

MG-3

MW-16

CALTRANS EASEMENT

INTERSTATE 80 FREEWAY

POWELL
STREET PLAZA
(FORMER
P.I.E. SITE)

LEGEND

MW-18

Existing Monitor Well

P2

Piezometer

(4/89)

Localized Groundwater Flow Direction
(Date monitored)

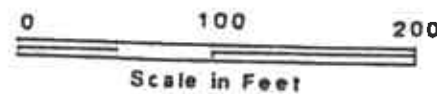
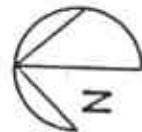

Reference: A.L.T.A. Survey, Shellmound Venture Properties, A.P.N. 049-1516-004, 006 & 007, City of Emeryville, Alameda County, California, by Mark Thomas & Co., Inc., dated 2/10/94.

AGI
TECHNOLOGIES

Groundwater Sample Locations - Shellmound Ventures Property
Emeryville Public Works/Data Tabulation
Emeryville, California

FIGURE
3

PROJECT NO. 15,681.005 DRAWN DFF DATE 17 Apr 95 APPROVED REVISED DATE

HARCROS PIGMENTS
(FORMERLY PFIZER PIGMENTS)

MYERS CONTAINER CORPORATION

BARBARY COAST STEEL
(FORMERLY JUDSON STEEL)

SHELLMOUND STREET

PARCEL II

PARCEL I

PARCEL III

PROPOSED
ROADWAY

Remocacci Creek

POWELL STREET PLAZA
(FORMER P.I.E. SITE)

CALTRANS EASEMENT

INTERSTATE 80 FREEWAY

LEGEND

- SS7 ⊕ Surface Soil Sample by AGI
- Surface ⊕ Surface Soil Sample by others
- B-10 ● Subsurface Soil Sample
- T-3 — Test Pit

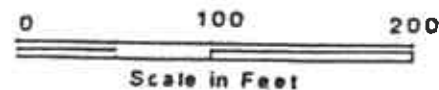

Reference: A.L.T.A. Survey, Shellmound Venture Properties, A.P.N. 049-1516-004, 006 & 007, City of Emeryville, Alameda County, California, by Mark Thomas & Co., Inc., dated 2/10/94.

AGI Soil Sample Locations - Shellmound Ventures Property FIGURE 4
 Emeryville Public Works/Data Tabulation
 Emeryville, California

PROJECT NO. 15,681.005	DRAWN OFF	DATE 17 Apr 95	APPROVED
			REVISED
			DATE

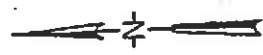

SOUTHERN PACIFIC RAILROAD RIGHT-OF-WAY

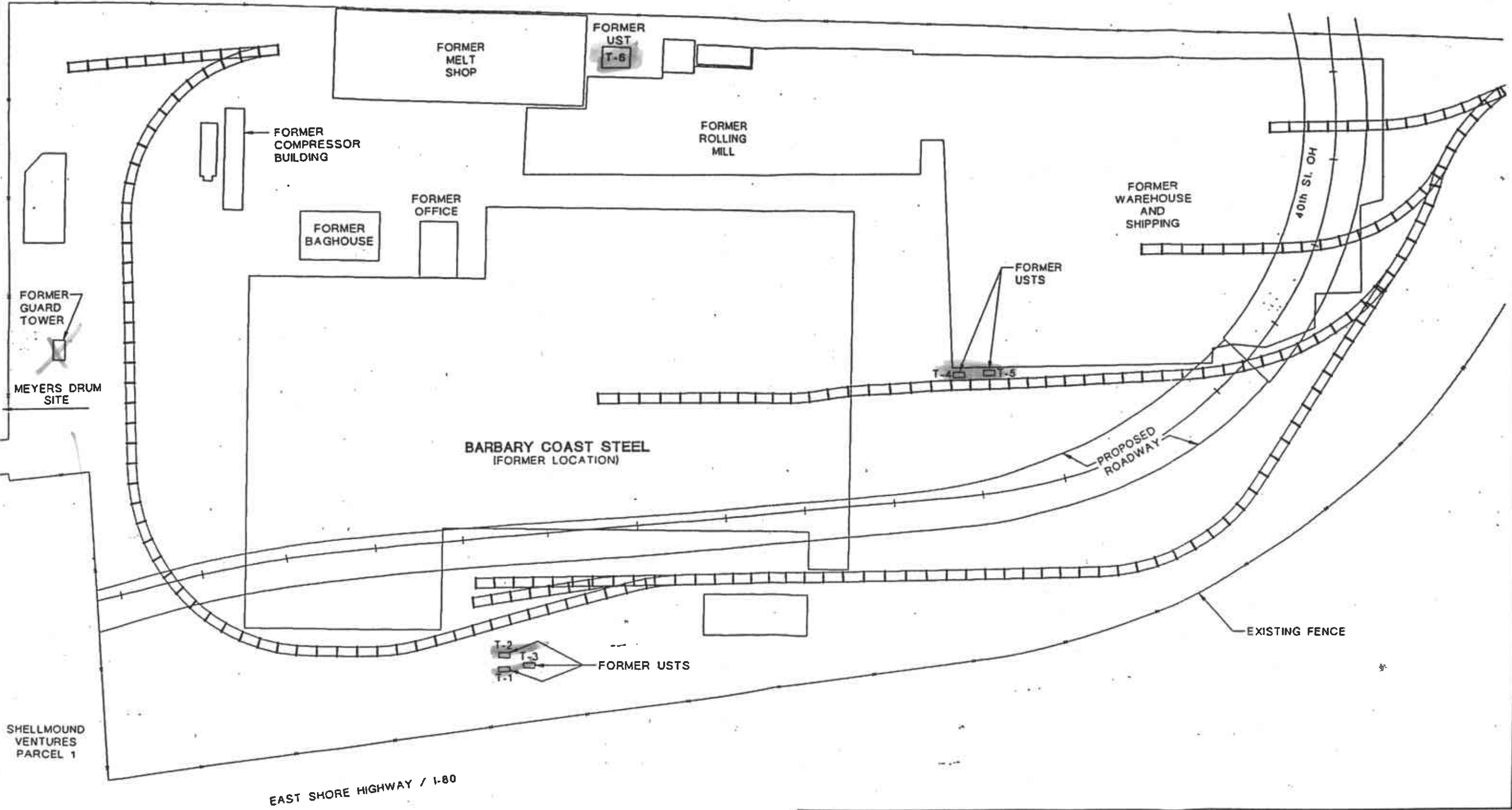

SHELLMOUND VENTURES PARCEL 1

EAST SHORE HIGHWAY / I-80

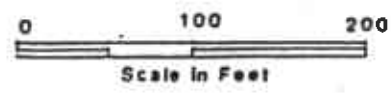

AGI TECHNOLOGIES	Barbary Coast Steel Property		Emeryville Public Works/Data Tabulation		Emeryville, California	FIGURE
	PROJECT NO. 15,681.005	DRAWN DFF	DATE 17 Apr 95	APPROVED	REVISED	DATE
						5

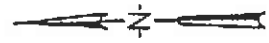

SOUTHERN PACIFIC RAILROAD RIGHT-OF-WAY

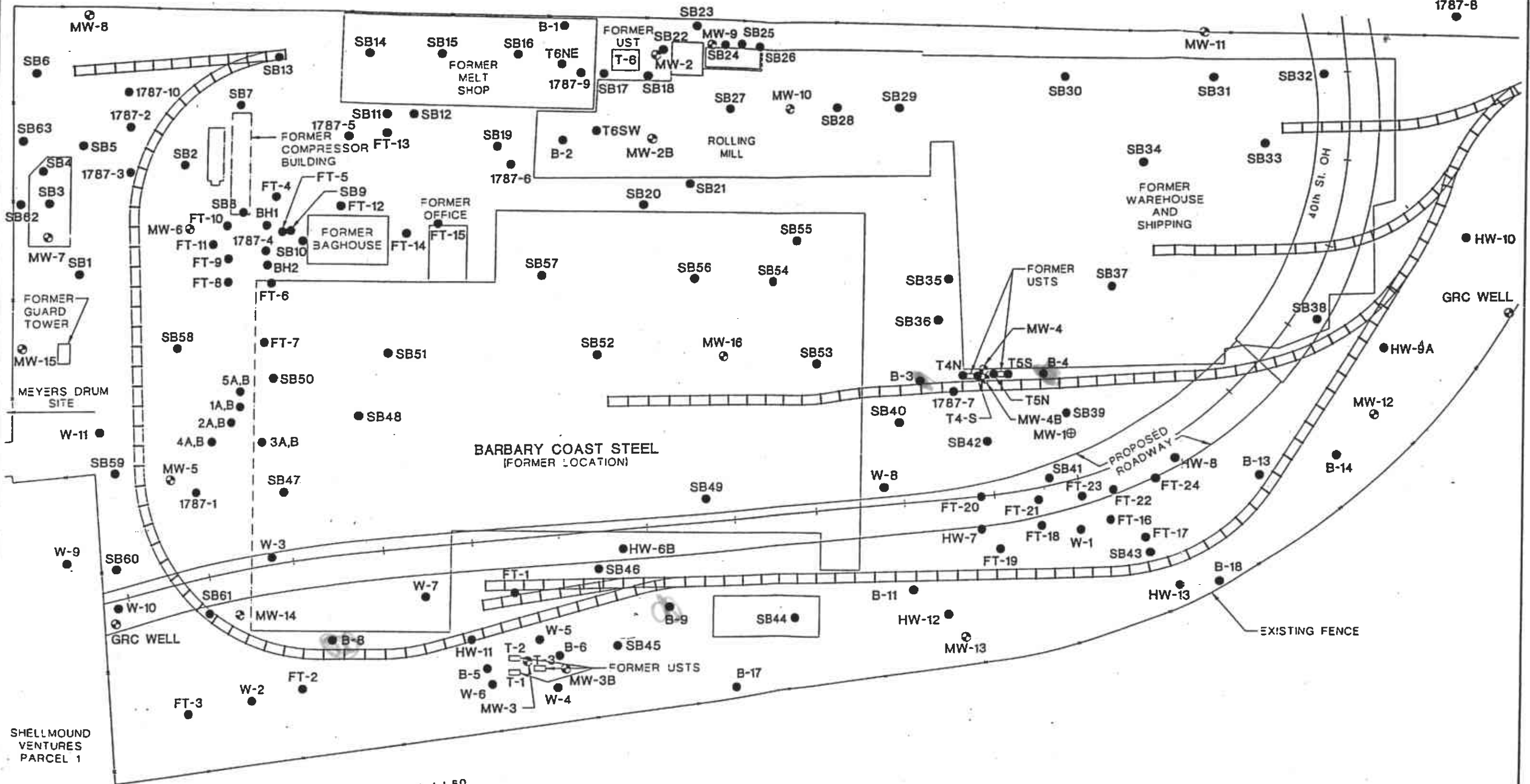

1787-8

MW-8

SB6

SB14

SB15

SB16

B-1

T6NE

SB23

FORMER UST

T-8

MW-2

SB22

MW-9

SB25

MW-11

SB32

1787-10

SB13

SB11

SB12

SB19

T6SW

B-2

MW-2B

ROLLING MILL

SB27

MW-10

SB28

SB29

SB30

SB31

SB33

SB34

FORMER WAREHOUSE AND SHIPPING

HW-10

40th St. OH

SB63

1787-2

SB2

1787-5

FORMER COMPRESSOR BUILDING

FT-13

SB9

FT-12

FORMER OFFICE

FT-14

FORMER BAGHOUSE

FT-15

SB20

SB21

SB35

FORMER USTS

MW-4

SB37

SB38

SB39

MW-12

HW-9A

SB62

1787-3

MW-6

FT-10

BH1

FT-4

SB8

FT-11

1787-4

SB10

BH2

FT-8

FT-6

SB58

SB57

SB56

SB55

SB54

SB53

SB52

MW-16

SB51

GRC WELL

FORMER GUARD TOWER

MW-7

SB1

SB58

FT-7

SB50

SB48

SB47

SB46

SB49

SB44

SB43

SB42

SB41

SB40

SB39

MW-4B

MW-10

SB38

SB37

SB36

SB35

HW-8

MW-15

FORMER GUARD TOWER

SB58

FT-7

SB50

SB48

SB47

SB46

SB49

SB44

SB43

SB42

SB41

SB40

SB39

MW-4B

MW-10

SB38

SB37

SB36

SB35

SB34

HW-9A

MEYERS DRUM SITE

W-11

5A,B

1A,B

2A,B

3A,B

SB48

SB47

SB46

SB49

SB44

SB43

SB42

SB41

SB40

SB39

MW-4B

MW-10

SB38

SB37

SB36

SB35

HW-8

W-11

SB59

MW-5

1787-1

SB47

SB46

SB49

SB44

SB43

SB42

SB41

SB40

SB39

MW-4B

MW-10

SB38

SB37

SB36

SB35

SB34

SB33

SB32

HW-9A

W-9

SB60

MW-5

1787-1

SB47

SB46

SB49

SB44

SB43

SB42

SB41

SB40

SB39

MW-4B

MW-10

SB38

SB37

SB36

SB35

SB34

SB33

SB32

HW-8

W-9

W-10

SB61

MW-14

W-3

W-7

W-5

W-6

W-4

W-11

W-1

W-2

W-3

W-4

W-5

W-6

W-7

W-8

W-9

W-10

W-11

W-12

HW-8

SHELLMOUND VENTURES PARCEL 1

W-10

FT-3

W-2

FT-2

W-3

W-7

W-5

W-6

W-4

W-11

W-1

W-2

W-3

W-4

W-5

W-6

W-7

W-8

W-9

W-10

W-11

HW-8

EAST SHORE HIGHWAY / I-60

- LEGEND**
- Soil Boring
 - Monitoring Well
 - ⊕ Abandoned Well
 - Former Underground Storage Tank



AGI TECHNOLOGIES Soil Sample Locations - Barbary Coast Steel Property
 Emeryville Public Works/Data Tabulation
 Emeryville, California

PROJECT NO. 15,681.005 DRAWN DFF DATE 17 Apr 95 APPROVED REVISED DATE

FIGURE 6

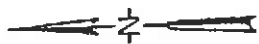

SOUTHERN PACIFIC RAILROAD RIGHT-OF-WAY

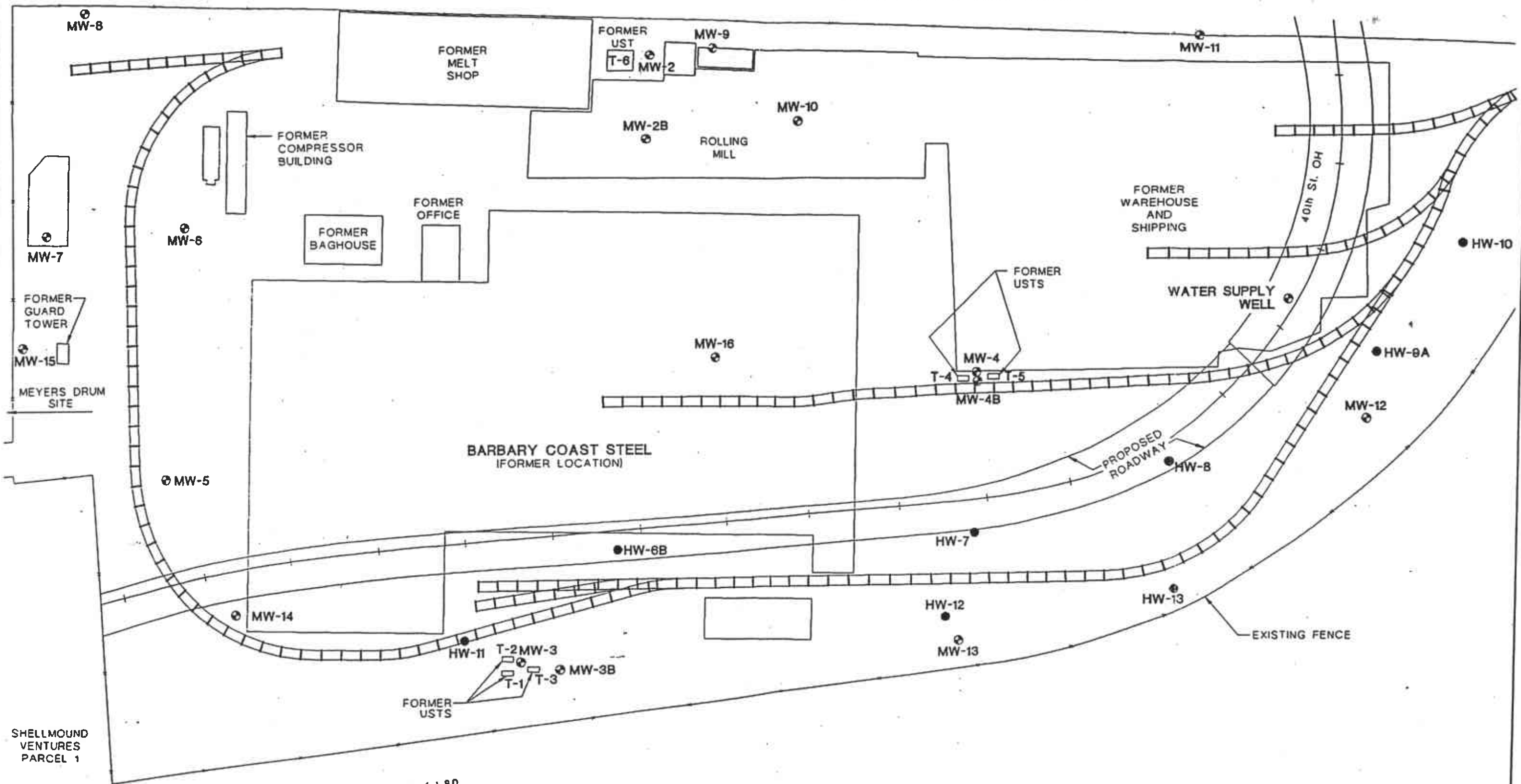

SHELLMOUND VENTURES PARCEL 1

EAST SHORE HIGHWAY / I-80

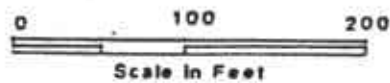

LEGEND

- Soil Boring
- ⊕ Monitoring Well
- ⊖ Abandoned Well
- Former Underground Storage Tank

AGI
TECHNOLOGIES

Groundwater Sample Locations - Barbary Coast Steel Property

Emeryville Public Works/Data Tabulation
Emeryville, California

FIGURE

7

PROJECT NO.
15,681.005

DRAWN
DFF

DATE
17 Apr 95

APPROVED

REVISED

DATE

TABLE 1
SUMMARY OF CHEMICAL ANALYSES - SOIL
PETROLEUM HYDROCARBON, VOLATILE AND SEMI-VOLATILE ORGANIC COMPOUNDS, AND POLYCHLORINATED BIPHENYLS
SHELLMOUND VENTURES PROPERTY
Emeryville, California

All concentrations expressed in milligrams per kilogram, equivalent to parts per million (ppm)

Sample Number	Parcel	Date Sampled	Depth (ft bgs)	TPH-D	TPH-OG	Total Hydrocarbons	Benzene	Toluene	Ethyl-Benzene	Total Xylenes	VOCs	SVOCs	PCBs
N-7	I	Sep-87	8.0		NA	NA	NA	NA	NA	NA	NA	NA	
N-8, N-9	I	Sep-87	5.0	ND	NA	NA	NA	NA	NA	NA	NA	NA	
			10.0	ND	NA	NA	NA	NA	NA	NA	NA	NA	NA
N-10	I	Sep-87	9.0	ND	NA	NA	NA	NA	NA	NA	NA	NA	ND
P-13	I	Sep-87	8.0	NA	NA	NA	NA	NA	NA	NA	ND	NA	2.3 (3)
P-16	I	Sep-87	9.0	NA	NA	NA	NA	NA	NA	NA	ND	NA	ND
P-22	I	Sep-87	3.0	NA	NA	NA	NA	NA	NA	NA	NA	NA	ND
P-23	I	Sep-87	1.0	NA	NA	NA	NA	NA	NA	NA	NA	NA	2.0 (4)
MW-16	I	Mar-88	5.5	15	NA	NA	NA	NA	NA	NA	NA	NA	14.8 (5)
MW-17	I	Mar-88	9.5		NA	NA	NA	NA	NA	NA	NA	NA	NA
HW-1	I	Apr-92	3.0	ND		NA	NA	NA	NA	NA	NA	NA	NA
			5.5	ND	100	NA	NA	NA	NA	NA	NA	ND	NA
HW-2	I	Apr-92	4.5	1.8	29	NA	NA	NA	NA	NA	ND	NA	
			6.0	ND	ND	NA	NA	NA	NA	NA	ND	NA	ND
			11.0	ND	ND	NA	NA	NA	NA	NA	ND	NA	ND
EBM-8-16	I	Sep-92	5.5	NA	NA	ND	ND	ND	ND	ND	NA	31.67 (x1)	ND
			10.5	NA	NA	1.89 (1)	ND	ND	ND	ND	NA	45.14 (x2)	ND
			16.0	NA	NA	ND	ND	ND	ND	ND	NA	2.36 (x3)	ND
SS11	I	04/13/94	0.0 - 0.5	NA	NA	NA	NA	NA	NA	NA	NA	NA	
SS12	I	04/13/94	0.0 - 0.5	NA	NA	NA	NA	NA	NA	NA	NA	NA	
P-10	II	Sep-87	8.0	NA	NA	NA	NA	NA	NA	NA	NA	NA	15 (6)
HW-3	II	Apr-92	2.5	19		NA	NA	NA	NA	NA	NA	NA	ND
HW-4	II	Apr-92	4.5	ND	ND	NA	NA	NA	NA	NA	ND	NA	ND
			6.0	7.3	150	NA	NA	NA	NA	NA	ND	NA	ND
			11.0	3.3	92	NA	NA	NA	NA	NA	ND	NA	ND

TABLE 1
SUMMARY OF CHEMICAL ANALYSES - SOIL
PETROLEUM HYDROCARBON, VOLATILE AND SEMI-VOLATILE ORGANIC COMPOUNDS, AND POLYCHLORINATED BIPHENYLS
SHELLMOUND VENTURES PROPERTY
Emeryville, California

All concentrations expressed in milligrams per kilogram, equivalent to parts per million (ppm)

Sample Number	Parcel	Date Sampled	Depth (ft bgs)	TPH-D	TPH-OG	Total Hydrocarbons	Benzene	Toluene	Ethyl-Benzene	Total Xylenes	VOCs	SVOCs	PCBs
EBM B-5	II	Sep-92	5.5	NA	NA	ND	ND	ND	ND	ND	ND	57.73 (x4)	ND
			10.5	NA	NA	98.18 (1)	ND	ND	ND	ND	ND	476.07 (x5)	ND
			15.5	NA	NA	2.99 (1)	ND	ND	ND	ND	ND	21.17 (x6)	ND
			20.5	NA	NA	ND	ND	ND	ND	ND	ND	2.74 (x7)	ND
			25.5	NA	NA	ND	ND	ND	ND	ND	ND	12.67 (x8)	ND
EBM B-6	II	Sep-92	8.0	NA	NA	31.95 (1)	ND	ND	ND	ND	ND	2.31 (x9)	ND
			9.5	NA	NA	21.12 (1)	ND	ND	ND	0.0308	0.211 (7)	1535.61 (x10)	ND
			13.0	NA	NA	0.5 (1)	ND	ND	ND	ND	ND	52.38 (x11)	ND
			23.0	NA	NA	ND	ND	ND	ND	ND	ND	1.81 (x12)	ND
			28.0	NA	NA	ND	ND	ND	ND	ND	ND	2.16 (x13)	ND
N4	III	Apr-87	9.0	764.4	NA	NA	NA	NA	NA	NA	NA	NA	
MG-3 / B-8	III	Mar-88	8.5	5400	NA	NA	NA	NA	NA	NA	NA	NA	
MG-2 / B-7	III	Apr-89	6.0	ND	NA	NA	ND	ND	ND	ND	NA	NA	
MG-4 / B-9	III	Apr-89	4.5	630	NA	NA	ND	ND	ND	ND	NA	NA	
B-11	III	Apr-90	12.0	190	NA	NA	ND	0.028	ND	0.042	NA	NA	NA
			15.0	430	NA	NA	ND	ND	ND	0.084	NA	NA	NA
HW-5	III	Apr-92	2.5	ND	16	NA	NA	NA	NA	NA	ND	NA	ND
			8.0	ND	23	NA	NA	NA	NA	NA	ND	NA	ND
			11.0	8.4	87	NA	NA	NA	NA	NA	0.0194 (6)	NA	ND

TABLE 1
SUMMARY OF CHEMICAL ANALYSES - SOIL
PETROLEUM HYDROCARBON, VOLATILE AND SEMI-VOLATILE ORGANIC COMPOUNDS, AND POLYCHLORINATED BIPHENYLS
SHELLMOUND VENTURES PROPERTY
Emeryville, California

Notes:

(ft bgs) - feet below ground surface.

TPH-D - Total petroleum hydrocarbons quantified as diesel.

TPH-OG - Total petroleum hydrocarbons quantified as oil and grease.

VOCs - Volatile organic compounds.

SVOCs - Semivolatile organic compounds.

PCBs - Polychlorinated biphenyls.

NA = Not analyzed.

ND = Not detected.

TPH-D, and TPH-OG detected using EPA Test Method 8015M.

Total Hydrocarbons detected using EPA Test Method 8240/8260.

Benzene, Toluene, Ethylbenzene, and Total Xylenes detected using EPA Test Method 8020.

VOCs detected using one or a combination of the following EPA Test Methods: 8010, 8240, 8260.

(1) Analyzed using EPA Test Method 8240/8260 by the East Bay Municipal Utility District. Hydrocarbons detected were grouped into three categories: saturated, unsaturated, and aromatic. Because of the broad range covered by each category, these results should be viewed as only a preliminary screen.

(2) Arochlor 1242 detected at 0.63 ppm, Arochlor 1254 detected at 3.8 ppm

(3) Arochlor 1254 detected at 2.3 ppm

(4) Arochlor 1242 detected at 2.7 ppm, Arochlor 1254 detected at 5.3

(5) Arochlor 1242 detected at 3.8 ppm, Arochlor 1254 detected at 11 ppm

(6) PCB detected was Arochlor 1254

(7) 1,2,4-Trimethylbenzene = 0.069 ppm, 1,2,5-Trimethylbenzene = 0.04 ppm

Napthalene = 0.044 ppm, P-Isopropyltoluene = 0.058

(8) Trichloroethylene = 0.0064 ppm, Tetrachloroethylene = 0.013 ppm

SUMMARY OF DETECTED SVOCs

Reference Number	Total Hydrocarbons (ppm)	Total PNAs (ppm)	Total Phthalates (ppm)
x1	31.48	0.12	0.07
x2	45.1	0.04	ND
x3	2.38	ND	ND
x4	57	0.73	ND
x5	473	2.09	0.98
x6	21.1	0.07	ND
x7	2.3	0.36	0.08
x8	5.82	4.3	2.55
x9	ND	1.78	0.53
x10	1530	5.07	0.54
x11	50.7	0.49	1.19
x12	1.73	ND	0.08
x13	2.08	ND	0.1

TABLE 5
SUMMARY OF CHEMICAL ANALYSES - GROUNDWATER
METALS
SHELLMOUND VENTURES PROPERTY
Emeryville, California

All concentrations expressed in milligrams per liter, equivalent to parts per million (ppm)

Sample Number	Parcel	Date Sampled	Sb	As	Ba	Be	Cd	Cr	H-Cr	Co	Cu	Pb	Hg	Mo	Ni	Se	Ag	Tl	V	Zn	
MG-2	III	Apr-89	ND	0.19	1.4	ND	ND	ND	NA	ND	ND	ND	ND	ND	ND	ND	ND	ND	ND	ND	
		Apr-90	NA	0.25	NA	NA	NA	0.049	NA	NA	NA	NA	0.29	NA	NA	NA	NA	NA	NA	NA	ND
		May/June-90	NA	NA	NA	NA	NA	NA	ND	NA	NA	NA	ND	NA	NA	NA	NA	NA	NA	NA	0.97
		Jul-90	ND	0.21	5.2	ND	ND	ND	NA	ND	0.08	0.032	ND	ND	ND	0.01	ND	ND	ND	ND	ND
		May-92	ND	0.4	2.1	ND	ND	ND	NA	ND	ND	ND	ND	ND	ND	ND	ND	ND	ND	ND	0.06
MG-3	III	Apr-89	ND	0.002	1.0	ND	ND	ND	NA	ND	ND	ND	ND	ND	ND	ND	ND	ND	ND	ND	
		Apr-90	NA	0.014	NA	NA	NA	0.014	NA	NA	NA	0.59	NA	NA	NA	NA	NA	NA	NA	NA	0.27
		May/June-90	NA	NA	NA	NA	NA	ND	NA	NA	NA	ND	NA	NA	NA	NA	NA	NA	NA	NA	ND
		Jul-90	ND	ND	1.2	ND	ND	ND	NA	ND	ND	ND	ND	ND	ND	0.02	ND	ND	ND	ND	0.04
		May-92	ND	0.008	1.5	ND	ND	ND	NA	ND	ND	ND	ND	ND	ND	ND	ND	ND	ND	ND	0.09
MG-4	III	Apr-89	ND	0.028	0.1	ND	ND	ND	NA	ND	ND	ND	ND	ND	ND	ND	ND	ND	ND	ND	
		Apr-90	NA	0.056	NA	NA	NA	ND	NA	NA	NA	0.036	NA	NA	NA	NA	NA	NA	NA	NA	0.054
		Jul-90	ND	0.064	0.27	ND	ND	ND	NA	ND	ND	ND	ND	ND	0.02	ND	ND	ND	ND	ND	0.03
		May-92	ND	0.1	0.2	ND	ND	ND	NA	ND	ND	ND	ND	ND	ND	ND	ND	ND	ND	ND	0.03
MG-7	III	Apr-89	ND	0.035	ND	ND	ND	NA	ND	ND	ND	ND	ND	0.12	ND	0.003	ND	ND	ND	ND	
MW-16	III	Apr-89	ND	0.006	0.16	ND	ND	ND	NA	ND	ND	ND	ND	ND	ND	0.002	ND	ND	ND	ND	
		Apr-90	NA	0.045	NA	NA	NA	0.17	NA	NA	NA	0.49	NA	NA	NA	NA	NA	NA	NA	NA	
		Jul-90	ND	ND	0.19	ND	ND	ND	NA	ND	0.07	0.038	ND	ND	0.03	ND	ND	ND	ND	ND	
		May-92	ND	0.02	ND	ND	ND	ND	NA	ND	ND	ND	ND	ND	ND	ND	ND	ND	ND	ND	
MW-17	III	Apr-89	ND	0.003	0.58	ND	ND	NA	ND	ND	ND	ND	ND	ND	ND	ND	ND	ND	ND		
MW-18	III	Apr-90	NA	0.023	NA	NA	NA	0.011	NA	NA	NA	0.062	NA	NA	NA	NA	NA	NA	NA	0.16	
		Jul-90	ND	0.014	1.1	ND	ND	ND	NA	ND	0.04	ND	ND	ND	ND	ND	ND	ND	ND	0.03	
		May-92	ND	0.029	0.8	ND	ND	ND	NA	ND	ND	ND	ND	ND	ND	ND	ND	ND	ND	ND	
PZ-1	III	May-92	ND	0.46	2.5	ND	ND	ND	NA	ND	ND	ND	ND	ND	ND	ND	ND	ND	ND	ND	
		04/29/94	ND	0.18	2.8	ND	ND	ND	NA	ND	ND	ND	ND	ND	ND	ND	ND	ND	ND	ND	
HW-5	III	Apr-92	NA	NA	NA	NA	ND	0.03	NA	NA	NA	ND	NA	NA	ND	NA	NA	NA	NA	0.021	

Notes:

NA - Not analyzed.

ND - Not detected.

(1) Filtered sample

(2) HP19 is duplicate from HP4

Acronym Definitions for Metals

Sb = Antimony	Cd = Cadmium	Cu = Copper	Ni = Nickel	V = Vanadium
As = Arsenic	Cr = Chromium	Pb = Lead	Se = Selenium	Zn = Zinc
Ba = Barium	H-Cr = Chromium(hexavalent)	Hg = Mercury	Ag = Silver	
Be = Beryllium	Co = Cobalt	Mo = Molybdenum	Tl = Thallium	

TABLE 6
SUMMARY OF CHEMICAL ANALYSES - GROUNDWATER
pH, SPECIFIC CONDUCTIVITY AND TOTAL DISSOLVED SOLIDS
SHELLMOUND VENTURES PROPERTY
Emeryville, California

Sample Number	Date Sampled	Parcel	pH (std. pH units)	Specific Conductivity (uhmos/cm)	Total Dissolved Solids (mg/l)
HP1	04/18/94	I	10.3	1,500	NA
HP2	04/18/94	I	11.7	5,760	NA
HP3	04/19/94	I	7.3	2,670	NA
HP4	04/19/94	I	7.5	3,330	NA
HP19 (1)	04/19/94	I	7.5	3,550	NA
HP5	04/20/94	I	7.3	13,500	NA
HP6	04/20/94	I	8.7	2,690	NA
HP7	04/20/94	II	7.6	7,610	NA
HP8	04/25/94	II	10.4	1,220	NA
HP9	04/25/94	II	11.3	1,220	NA
HP10	04/25/94	II	11.6	1,110	NA
HP11	04/27/94	II	8.0	1,330	NA
HP12	04/27/94	II	7.6	2,100	NA
HP13	04/27/94	II	7.6	2,320	NA
HP14	04/27/94	II	9.1	1,660	NA
HP15	04/28/94	III	7.4	3,980	NA
HP20 (2)	04/28/94	III	7.4	3,990	NA
HP16	04/28/94	III	7.2	6,870	NA
HP17	04/28/94	III	7.3	3,990	NA
HP18	04/28/94	III	11.2	2,220	NA
MG-1	04/29/94	III	NA	NA	1,510
MG-2	04/29/94	III	NA	NA	1,730
MG-3	04/29/94	III	NA	NA	900
MG-4	04/29/94	III	NA	NA	2,070
MG-7	04/29/94	III	NA	NA	1,370
MW-16	04/29/94	III	NA	NA	11,700
MW-18	04/29/94	III	NA	NA	2,090
PZ-1	04/29/94	III	NA	NA	3,480

Notes:

std. pH units - Standard pH units of measure.

uhmos/cm - Micromhos per centimeter.

mg/l - Milligrams per liter.

NA - Not analyzed.

(1) HP19 is a duplicate of HP4

(2) HP20 is a duplicate of HP15

TABLE 7
SUMMARY OF CHEMICAL ANALYSES - SOIL
PETROLEUM HYDROCARBONS, VOLATILE AND SEMI-VOLATILE ORGANIC COMPOUNDS, AND POLYCHLORINATED BIPHENYLS
BARBARY COAST STEEL PROPERTY
Emeryville, California

All concentrations expressed in milligrams per kilogram, equivalent to parts per million (ppm)

Sample Number	Date Sampled	Depth (ft bgs)	TPH-G	TPH-D	TPH-OG	Total Hydrocarbons	Benzene	Toluene	Ethyl-Benzene	Total Xylenes	VOCs	SVOCs	PCBs
1A	Jan 87	1.5	NA	NA	NA	NA	NA	NA	NA	NA	18	NA	NA
1B	Jan 87	7.5	NA	NA	NA	NA	NA	NA	NA	NA	ND	NA	NA
2A	Jan 87	1.5	NA	NA	NA	NA	NA	NA	NA	NA	23	NA	NA
2B	Jan 87	8.5	NA	NA	NA	NA	NA	NA	NA	NA	ND	NA	NA
3A	Jan 87	1.5	NA	NA	NA	NA	NA	NA	NA	NA	ND	NA	NA
3B	Jan 87	7.5	NA	NA	NA	NA	NA	NA	NA	NA	ND	NA	NA
4A	Jan 87	1.5	NA	NA	NA	NA	NA	NA	NA	NA	ND	NA	NA
4B	Jan 87	8.0	NA	NA	NA	NA	NA	NA	NA	NA	ND	NA	NA
5A	Jan 87	1.5	NA	NA	NA	NA	NA	NA	NA	NA	ND	NA	NA
5B	Jan 87	7.5	NA	NA	NA	NA	NA	NA	NA	NA	ND	NA	NA
1787-1	Jan 87	3.0	NA	NA	NA	14.4	NA	NA	NA	NA	NA	NA	NA
1787-2	Jan 87	1.5	NA	NA	NA	NA	NA	NA	NA	NA	NA	NA	NA
1787-3	Jan 87	2.5	NA	NA	NA	NA	NA	NA	NA	NA	NA	NA	NA
1787-4	Jan 87	2.0	NA	ND	ND	1000	NA	NA	NA	NA	NA	NA	NA
1787-5	Jan 87	1.0	NA	ND	ND	1000	NA	NA	NA	NA	NA	NA	NA
1787-6	Jan 87	2.0	NA	ND	ND	2.6	NA	NA	NA	NA	NA	NA	NA
1787-7	Jan 87	6.0	NA	ND	ND	3.7	NA	NA	NA	NA	NA	NA	NA
1787-8	Jan 87	1.0	NA	ND	ND	3.3	NA	NA	NA	NA	NA	NA	NA
1787-9	Jan 87	2.0	NA	ND	ND	17	NA	NA	NA	NA	NA	NA	NA
1787-10	Jan 87	6.0	NA	ND	ND	1.7	NA	NA	NA	NA	NA	NA	NA
B-1	Jun 93	3.0	NA	ND	740	NA	ND	ND	ND	ND	ND	NA	NA
	Jun 93	6.5	NA	ND	10000	NA	ND	ND	ND	ND	ND	NA	NA

TABLE 7
SUMMARY OF CHEMICAL ANALYSES - SOIL
PETROLEUM HYDROCARBONS, VOLATILE AND SEMI-VOLATILE ORGANIC COMPOUNDS, AND POLYCHLORINATED BIPHENYLS
BARBARY COAST STEEL PROPERTY
Emeryville, California

All concentrations expressed in milligrams per kilogram, equivalent to parts per million (ppm)

Sample Number	Date Sampled	Depth (ft bgs)	TPH-G	TPH-D	TPH-OG	Total Hydrocarbons	Benzene	Toluene	Ethyl-Benzene	Total Xylenes	VOCs	SVOCs	PCBs
B-2	Jun 93	3.0	NA	ND	380	NA	ND	ND	ND	ND	ND	NA	NA
	Jun 93	6.5	NA	ND	860	NA	ND	ND	ND	ND	ND	NA	NA
B-3	Jun 93	3.0	ND	ND	95	NA	ND	ND	ND	ND	ND	NA	NA
	Jun 93	6.0	ND	ND	ND	NA	ND	ND	ND	ND	ND	NA	NA
B-4	Jun 93	2.5	8.9	27	ND	NA	ND	ND	ND	ND	ND	NA	NA
	Jun 93	6.5	37	340	ND	NA	ND	ND	ND	ND	ND	NA	NA
B-5	Jun 93	2.5	ND	ND	390	NA	ND	ND	ND	ND	ND	NA	NA
	Jun 93	6.5	ND	ND	240	NA	ND	ND	ND	ND	ND	NA	NA
B-6	Jun 93	2.0	ND	ND	1000	NA	ND	ND	ND	ND	ND	NA	NA
	Jun 93	6.0	ND	ND	240	NA	ND	ND	ND	ND	ND	NA	NA
B-8	Apr 93	5.5	NA	NA	NA	0.7	NA	NA	NA	NA	0.7	ND	NA
	Apr 93	10.5	NA	NA	NA	176.0	NA	NA	NA	NA	4.0	172.0	NA
	Apr 93	11.0	NA	NA	NA	25.0	NA	NA	NA	NA	0.7	24.0	NA
	Apr 93	15.5	NA	NA	NA	62.0	NA	NA	NA	NA	4.0	58.0	NA
	Apr 93	23.5	NA	NA	NA	1.0	NA	NA	NA	NA	ND	1.0	NA
B-9	Apr 93	23.5	NA	NA	NA	1.0	NA	NA	NA	NA	ND	1.0	NA
	Apr 93	6.0	NA	NA	NA	151.0	NA	NA	NA	NA	3.0	148.0	NA
	Apr 93	11.0	NA	NA	NA	5.0	NA	NA	NA	NA	1.0	4.0	NA
	Apr 93	15.5	NA	NA	NA	1.0	NA	NA	NA	NA	1.0	ND	NA
	Apr 93	23.0	NA	NA	NA	4.0	NA	NA	NA	NA	1.0	3.0	NA
	Apr 93	28.0	NA	NA	NA	4.0	NA	NA	NA	NA	ND	4.0	NA

TABLE 7
SUMMARY OF CHEMICAL ANALYSES - SOIL
PETROLEUM HYDROCARBONS, VOLATILE AND SEMI-VOLATILE ORGANIC COMPOUNDS, AND POLYCHLORINATED BIPHENYLS
BARBARY COAST STEEL PROPERTY
Emeryville, California

All concentrations expressed in milligrams per kilogram, equivalent to parts per million (ppm)

Sample Number	Date Sampled	Depth (ft bgs)	TPH-G	TPH-D	TPH-OG	Total Hydrocarbons	Benzene	Toluene	Ethyl-Benzene	Total Xylenes	VOCs	SVOCs	PCBs
B-11	Apr 93	10.5	NA	NA	NA	3.0	NA	NA	NA	NA	ND	3.0	NA
	Apr 93	18.0	NA	NA	NA	14.0	NA	NA	NA	NA	ND	14.0	NA
	Apr 93	23.0	NA	NA	NA	2.0	NA	NA	NA	NA	ND	2.0	NA
	Apr 93	28.0	NA	NA	NA	1.0	NA	NA	NA	NA	ND	1.0	NA
B-13	Apr 93	5.5	NA	NA	NA	8.0	NA	NA	NA	NA	1.0	97.0	NA
	Apr 93	10.5	NA	NA	NA	8.0	NA	NA	NA	NA	0.4	8.0	NA
	Apr 93	15.5	NA	NA	NA	4.0	NA	NA	NA	NA	ND	4.0	NA
	Apr 93	20.5	NA	NA	NA	ND	NA	NA	NA	NA	ND	ND	NA
	Apr 93	25.5	NA	NA	NA	ND	NA	NA	NA	NA	ND	ND	NA
B-14	Apr 93	8.0	NA	NA	NA	22.0	NA	NA	NA	NA	ND	22.0	NA
	Apr 93	15.0	NA	NA	NA	1.0	NA	NA	NA	NA	ND	1.0	NA
	Apr 93	18.5	NA	NA	NA	7.0	NA	NA	NA	NA	ND	7.0	NA
	Apr 93	23.0	NA	NA	NA	5.0	NA	NA	NA	NA	ND	5.0	NA
	Apr 93	28.0	NA	NA	NA	4.0	NA	NA	NA	NA	ND	4.0	NA
B-17	Apr 93	6.0	NA	NA	NA	6.0	NA	NA	NA	NA	ND	6.0	NA
	Apr 93	6.0	NA	NA	NA	45.0	NA	NA	NA	NA	ND	45.0	NA
	Apr 93	10.5	NA	NA	NA	4.0	NA	NA	NA	NA	ND	4.0	NA
	Apr 93	17.0	NA	NA	NA	3.0	NA	NA	NA	NA	ND	330.0	NA
	Apr 93	17.0	NA	NA	NA	3.0	NA	NA	NA	NA	ND	3	NA
B-18	Apr 93	6.0	NA	NA	NA	58.0	NA	NA	NA	NA	13.0	102.0	NA
	Apr 93	10.0	NA	NA	NA	58.0	NA	NA	NA	NA	ND	58.0	NA
CS-2	Jul 93	U	NA	ND	170	NA	NA	NA	NA	NA	NA	NA	NA
CS-3	Jul 93	U	NA	ND	260	NA	NA	NA	NA	NA	NA	NA	NA

TABLE 7
SUMMARY OF CHEMICAL ANALYSES - SOIL
PETROLEUM HYDROCARBONS, VOLATILE AND SEMI-VOLATILE ORGANIC COMPOUNDS, AND POLYCHLORINATED BIPHENYLS
BARBARY COAST STEEL PROPERTY
Emeryville, California

All concentrations expressed in milligrams per kilogram, equivalent to parts per million (ppm)

Sample Number	Date Sampled	Depth (ft bgs)	TPH-G	TPH-D	TPH-OG	Total Hydrocarbons	Benzene	Toluene	Ethyl-Benzene	Total Xylenes	VOCs	SVOCs	PCBs
CS-4	Jul 93	U	NA	ND	660	NA	NA	NA	NA	NA	NA	NA	NA
CS-5	Jul 93	U	NA	ND	ND	NA	NA	NA	NA	NA	NA	NA	NA
CS-6	Jul 93	U	NA	ND	83	NA	NA	NA	NA	NA	NA	NA	NA
CS-7	Jul 93	U	NA	ND	240	NA	NA	NA	NA	NA	NA	NA	NA
CS-8	Jul 93	U	NA	ND	460	NA	NA	NA	NA	NA	NA	NA	NA
HW-1	Apr 92	3	NA	NA	NA	ND	ND	ND	ND	ND	ND	NA	NA
	Apr 92	5.5	NA	NA	NA	ND	ND	ND	ND	ND	ND	NA	NA
HW-2	Apr 92	4.5	NA	NA	NA	ND	ND	ND	ND	ND	ND	NA	NA
	Apr 92	6	NA	NA	NA	ND	ND	ND	ND	ND	ND	NA	NA
	Apr 92	11	NA	NA	NA	ND	ND	ND	ND	ND	ND	NA	NA
HW-3	Apr 92	2.5	NA	NA	NA	ND	ND	ND	ND	ND	ND	NA	NA
HW-4	Apr 92	4.5	NA	NA	NA	ND	ND	ND	ND	ND	ND	NA	NA
	Apr 92	6	NA	NA	NA	ND	ND	ND	ND	ND	ND	NA	NA
	Apr 92	11	NA	NA	NA	ND	ND	ND	ND	ND	ND	NA	NA
HW-5	Apr 92	2.5	NA	NA	NA	ND	ND	ND	ND	ND	ND	NA	NA
	Apr 92	8	NA	NA	NA	ND	ND	ND	ND	ND	ND	NA	NA
	Apr 92	11	NA	NA	NA	ND	ND	ND	ND	ND	19.4	NA	NA
HW-6B	Apr 92	5.0	ND	ND	ND	NA	ND	ND	ND	ND	ND	NA	ND
	Apr 92	8.5	ND	ND	200	NA	ND	ND	ND	ND	ND	NA	ND
	Apr 92	11.5	ND	ND	ND	NA	ND	ND	ND	ND	ND	NA	ND
	Apr 92	16.5	ND	ND	ND	NA	ND	ND	ND	ND	ND	NA	ND
	Apr 92	20.0	ND	ND	ND	NA	ND	ND	ND	ND	ND	NA	ND

TABLE 7
SUMMARY OF CHEMICAL ANALYSES - SOIL
PETROLEUM HYDROCARBONS, VOLATILE AND SEMI-VOLATILE ORGANIC COMPOUNDS, AND POLYCHLORINATED BIPHENYLS
BARBARY COAST STEEL PROPERTY
Emeryville, California

All concentrations expressed in milligrams per kilogram, equivalent to parts per million (ppm)

Sample Number	Date Sampled	Depth (ft bgs)	TPH-G	TPH-D	TPH-OG	Total Hydrocarbons	Benzene	Toluene	Ethyl-Benzene	Total Xylenes	VOCs	SVOCs	PCBs
HW-7	Apr 92	5.0	ND	210	3.68	NA	ND	ND	ND	ND	0.6245	NA	ND
	Apr 92	10.0	ND	52	38	NA	ND	ND	ND	ND	0.011	0.39	ND
	Apr 92	13.5	ND	ND	ND	NA	ND	ND	ND	ND	ND	NA	ND
	Apr 92	16.5	ND	ND	35	NA	ND	ND	ND	ND	ND	NA	ND
	Apr 92	21.5	ND	ND	ND	NA	ND	ND	ND	ND	ND	NA	ND
HW-8	Apr 92	2.5	ND	ND	ND	NA	ND	ND	ND	ND	ND	NA	ND
	Apr 92	4.5	1.8	ND	39	NA	0.21	0.57	0.43	0.37	ND	NA	ND
	Apr 92	7.0	2.2	ND	ND	NA	ND	ND	ND	ND	ND	NA	ND
	Apr 92	10.0	ND	ND	ND	NA	ND	ND	ND	ND	ND	NA	ND
	Apr 92	16.0	ND	ND	ND	NA	ND	ND	ND	ND	ND	NA	ND
	Apr 92	21.5	ND	ND	ND	NA	ND	ND	ND	ND	ND	NA	ND
HW-9A	Apr 92	3.5	ND	ND	42	NA	ND	ND	ND	ND	ND	NA	ND
	Apr 92	6.5	ND	3.7	140	NA	ND	ND	ND	ND	ND	NA	ND
	Apr 92	10.5	ND	ND	25	NA	ND	ND	ND	ND	ND	NA	ND
	Apr 92	15.5	ND	ND	21	NA	ND	ND	ND	ND	ND	NA	ND
	Apr 92	21.5	ND	ND	33	NA	ND	ND	ND	ND	ND	NA	ND
HW-10	Apr 92	5.0	ND	ND	92	NA	ND	ND	ND	ND	ND	NA	ND
	Apr 92	8.0	ND	ND	70	NA	ND	ND	ND	ND	ND	NA	ND
	Apr 92	11.0	ND	ND	41	NA	ND	ND	ND	ND	ND	NA	ND
	Apr 92	16.0	ND	ND	35	NA	ND	ND	ND	ND	ND	NA	ND
	Apr 92	21.0	ND	ND	ND	NA	ND	ND	ND	ND	ND	NA	ND
HW-11	Apr 92	3.0	ND	ND	80	NA	ND	ND	ND	ND	ND	NA	ND
	Apr 92	6.0	2.2	6.7	58	NA	ND	ND	ND	ND	ND	NA	ND
	Apr 92	11.0	ND	460	690	NA	ND	ND	ND	ND	ND	1.27	ND

TABLE 7
SUMMARY OF CHEMICAL ANALYSES - SOIL
PETROLEUM HYDROCARBONS, VOLATILE AND SEMI-VOLATILE ORGANIC COMPOUNDS, AND POLYCHLORINATED BIPHENYLS
BARBARY COAST STEEL PROPERTY
Emeryville, California

All concentrations expressed in milligrams per kilogram, equivalent to parts per million (ppm)

Sample Number	Date Sampled	Depth (ft bgs)	TPH-G	TPH-D	TPH-OG	Total Hydrocarbons	Benzene	Toluene	Ethyl-Benzene	Total Xylenes	VOCs	SVOCs	PCBs
MW-8	Jul 93	0.5	ND	ND	36	NA	NA	NA	NA	NA	NA	NA	NA
	Jul 93	4.0	ND	ND	ND	NA	NA	NA	NA	NA	NA	NA	NA
MW-9	Jul 93	1.5	ND	ND		NA	NA	NA	NA	NA	NA	NA	NA
	Jul 93	4.5	ND	ND		NA	NA	NA	NA	NA	NA	NA	NA
MW-10	Jul 93	1.0	ND	ND		NA	NA	NA	NA	NA	NA	NA	NA
	Jul 93	4.5	ND	ND		NA	NA	NA	NA	NA	NA	NA	NA
MW-11	Jul 93	1.5	ND	ND		NA	NA	NA	NA	NA	NA	NA	NA
	Jul 93	4.5	ND	ND	12	NA	NA	NA	NA	NA	NA	NA	NA
MW-12	Jul 93	1.0	ND	ND		NA	NA	NA	NA	NA	NA	NA	NA
	Jul 93	4.5	ND	ND	ND	NA	NA	NA	NA	NA	NA	NA	NA
MW-13	Jul 93	1.5	ND	ND	ND	NA	NA	NA	NA	NA	NA	NA	NA
	Jul 93	4.5	ND	ND	ND	NA	NA	NA	NA	NA	NA	NA	NA
MW-14	Jul 93	1.0	ND	ND	65	NA	NA	NA	NA	NA	NA	NA	NA
	Jul 93	4.5	ND	ND		NA	NA	NA	NA	NA	NA	NA	NA
MW-15	Jul 93	0.5	ND	ND	720	NA	NA	NA	NA	NA	NA	4.5	NA
	Jul 93	4.0	ND	5500	ND	NA	NA	NA	NA	NA	NA		NA
MW-16	Jul 93	0.5	ND	ND		NA	NA	NA	NA	NA	NA	NA	NA
	Jul 93	4.0	ND	ND		NA	NA	NA	NA	NA	NA	NA	NA
SB-1	Jul 93	1.0	ND	ND		NA	NA	NA	NA	NA	NA	NA	NA
	Jul 93	3.5	ND	ND		NA	NA	NA	NA	NA	NA	NA	NA
	Jul 93	6.0	ND	ND		NA	NA	NA	NA	NA	NA	NA	NA
SB-2	Jul 93	1.5	ND	ND		NA	NA	NA	NA	NA	NA	NA	NA
	Jul 93	4.5	ND	ND		NA	NA	NA	NA	NA	NA	NA	NA

TABLE 7
SUMMARY OF CHEMICAL ANALYSES - SOIL
PETROLEUM HYDROCARBONS, VOLATILE AND SEMI-VOLATILE ORGANIC COMPOUNDS, AND POLYCHLORINATED BIPHENYLS
BARBARY COAST STEEL PROPERTY
Emeryville, California

All concentrations expressed in milligrams per kilogram, equivalent to parts per million (ppm)

Sample Number	Date Sampled	Depth (ft bgs)	TPH-G	TPH-D	TPH-OG	Total Hydrocarbons	Benzene	Toluene	Ethyl-Benzene	Total Xylenes	VOCs	SVOCs	PCBs
SB-3	Jul 93	0.5	ND	ND		NA	NA	NA	NA	NA	NA	ND	NA
	Jul 93	4.0	ND	ND	930	NA	NA	NA	NA	NA	NA	ND	NA
SB-4	Jul 93	0.5	ND	ND	710	NA	NA	NA	NA	NA	NA	ND	NA
SB-5	Aug 93	1.0	ND	ND		NA	NA	NA	NA	NA	NA	NA	NA
	Aug 93	4.5	ND	ND	ND	NA	NA	NA	NA	NA	NA	NA	NA
SB-6	Jul 93	1.0	ND	ND	36	NA	ND	ND	ND	ND	ND	NA	NA
	Jul 93	4.5	ND	ND	43	NA	ND	ND	ND	ND	0.108	NA	NA
SB-7	Jul 93	1.0	ND	ND	110	NA	NA	NA	NA	NA	NA	NA	NA
SB-8	Jul 93	1.0	ND	ND	140	NA	NA	NA	NA	NA	NA	NA	NA
	Jul 93	4.5	ND	ND	76	NA	NA	NA	NA	NA	NA	NA	NA
SB-11	Jul 93	0.5	ND	ND	320	NA	NA	NA	NA	NA	NA	NA	NA
	Jul 93	4.5	ND	ND		NA	NA	NA	NA	NA	NA	NA	NA
SB-12	Jul 93	0.5	ND	ND	150	NA	NA	NA	NA	NA	NA	NA	NA
	Jul 93	4.5	ND	ND	100	NA	NA	NA	NA	NA	NA	NA	NA
SB-17	Jul 93	1.0	ND	ND	ND	NA	NA	NA	NA	NA	NA	NA	NA
	Jul 93	4.5	ND	ND	240	NA	NA	NA	NA	NA	NA	NA	NA
SB-18	Jul 93	1.0	ND	ND	77	NA	NA	NA	NA	NA	NA	NA	NA
	Jul 93	4.0	ND	ND	81	NA	NA	NA	NA	NA	NA	NA	NA
SB-19	Aug 93	1.0	ND	ND	88	NA	NA	NA	NA	NA	NA	NA	NA
SB-20	Jul 93	1.5	ND	ND	97	NA	NA	NA	NA	NA	NA	NA	NA
SB-21	Jul 93	1.5	ND	ND	710	NA	NA	NA	NA	NA	NA	NA	NA
	Jul 93	4.5	ND	ND	55	NA	NA	NA	NA	NA	NA	NA	NA
SB-22	Jul 93	1.0	ND	ND		NA	NA	NA	NA	NA	NA	NA	NA
	Jul 93	4.5	ND	ND	120	NA	NA	NA	NA	NA	NA	NA	NA

TABLE 7
SUMMARY OF CHEMICAL ANALYSES - SOIL
PETROLEUM HYDROCARBONS, VOLATILE AND SEMI-VOLATILE ORGANIC COMPOUNDS, AND POLYCHLORINATED BIPHENYLS
BARBARY COAST STEEL PROPERTY
Emeryville, California

All concentrations expressed in milligrams per kilogram, equivalent to parts per million (ppm)

Sample Number	Date Sampled	Depth (ft bgs)	TPH-G	TPH-D	TPH-OG	Total Hydrocarbons	Benzene	Toluene	Ethyl-Benzene	Total Xylenes	VOCs	SVOCs	PCBs
SB-23	Aug 93	1.0	ND	ND	270	NA	NA	NA	NA	NA	NA	NA	NA
	Aug 93	4.5	ND	ND	330	NA	NA	NA	NA	NA	NA	NA	NA
SB-24	Jul 93	1.0	ND	ND	60	NA	NA	NA	NA	NA	NA	NA	NA
	Jul 93	4.5	ND	ND	280	NA	NA	NA	NA	NA	NA	NA	NA
SB-25	Jul 93	1.0	ND	ND	150	NA	NA	NA	NA	NA	NA	NA	NA
	Jul 93	4.5	ND	ND	800	NA	NA	NA	NA	NA	NA	NA	NA
SB-26	Jul 93	1.0	ND	ND	300	NA	NA	NA	NA	NA	NA	NA	NA
	Jul 93	4.5	ND	ND	ND	NA	NA	NA	NA	NA	NA	NA	NA
SB-27	Jul 93	1.0	ND	ND	110	NA	NA	NA	NA	NA	NA	NA	NA
	Jul 93	4.5	ND	ND	170	NA	NA	NA	NA	NA	NA	NA	NA
SB-28	Jul 93	1.0	ND	ND	220	NA	NA	NA	NA	NA	NA	NA	NA
	Jul 93	4.5	ND	ND	1400	NA	NA	NA	NA	NA	NA	NA	NA
SB-29	Jul 93	1.0	ND	ND	2100	NA	NA	NA	NA	NA	NA	NA	NA
	Jul 93	4.5	ND	ND	980	NA	NA	NA	NA	NA	NA	NA	NA
SB-30	Jul 93	1.5	ND	ND	400	NA	NA	NA	NA	NA	NA	NA	NA
	Jul 93	4.5	ND	ND	ND	NA	NA	NA	NA	NA	NA	NA	NA
SB-31	Jul 93	1.0	ND	ND	110	NA	NA	NA	NA	NA	NA	NA	NA
	Jul 93	4.5	ND	ND	54	NA	NA	NA	NA	NA	NA	NA	NA
SB-32	Jul 93	1.5	ND	ND	300	NA	NA	NA	NA	NA	NA	NA	NA
	Jul 93	4.5	ND	ND	110	NA	NA	NA	NA	NA	NA	NA	NA
SB-33	Jul 93	1.5	ND	ND	520	NA	NA	NA	NA	NA	NA	NA	NA
	Jul 93	4.5	ND	ND	14	NA	NA	NA	NA	NA	NA	NA	NA
SB-34	Jul 93	1.5	ND	ND	720	NA	NA	NA	NA	NA	NA	NA	NA
	Jul 93	4.5	ND	ND	360	NA	NA	NA	NA	NA	NA	NA	NA

TABLE 1
SUMMARY OF CHEMICAL ANALYSES - SOIL
PETROLEUM HYDROCARBON, VOLATILE AND SEMI-VOLATILE ORGANIC COMPOUNDS, AND POLYCHLORINATED BIPHENYLS
SHELLMOUND VENTURES PROPERTY
Emeryville, California

All concentrations expressed in milligrams per kilogram, equivalent to parts per million (ppm)

Sample Number	Parcel	Date Sampled	Depth (ft bgs)	TPH-D	TPH-OG	Total Hydrocarbons	Benzene	Toluene	Ethyl-Benzene	Total Xylenes	VOCs	SVOCs	PCBs
N-7	I	Sep-87	8.0	70.6	NA	NA	NA	NA	NA	NA	NA	NA	4.43 (2)
N-8, N-9	I	Sep-87	5.0	ND	NA	NA	NA	NA	NA	NA	NA	NA	NA
			10.0	ND	NA	NA	NA	NA	NA	NA	NA	NA	NA
N-10	I	Sep-87	9.0	ND	NA	NA	NA	NA	NA	NA	NA	NA	2.3 (3)
P-13	I	Sep-87	8.0	NA	NA	NA	NA	NA	NA	NA	ND	NA	ND
P-16	I	Sep-87	9.0	NA	NA	NA	NA	NA	NA	NA	ND	NA	ND
P-22	I	Sep-87	3.0	NA	NA	NA	NA	NA	NA	NA	NA	NA	8.0 (4)
P-23	I	Sep-87	1.0	NA	NA	NA	NA	NA	NA	NA	NA	NA	14.0 (5)
MW-16	I	Mar-88	5.5	15	NA	NA	NA	NA	NA	NA	NA	NA	NA
MW-17	I	Mar-88	9.5	240	NA	NA	NA	NA	NA	NA	NA	NA	NA
HW-1	I	Apr-92	3.0	ND	110	NA	NA	NA	NA	NA	ND	NA	0.055
			5.5	ND	100	NA	NA	NA	NA	NA	ND	NA	0.29
HW-2	I	Apr-92	4.5	1.8	29	NA	NA	NA	NA	NA	ND	NA	ND
			6.0	ND	ND	NA	NA	NA	NA	NA	ND	NA	ND
			11.0	ND	ND	NA	NA	NA	NA	NA	ND	NA	ND
EBM-B-16	I	Sep-92	5.5	NA	NA	ND	ND	ND	ND	ND	NA	31.67 (x1)	ND
			10.5	NA	NA	1.89 (1)	ND	ND	ND	ND	NA	45.14 (x2)	ND
			16.0	NA	NA	ND	ND	ND	ND	ND	NA	2.36 (x3)	ND
SS11	I	04/13/94	0.0 - 0.5	NA	NA	NA	NA	NA	NA	NA	NA	NA	4.5 (6)
SS12	I	04/13/94	0.0 - 0.5	NA	NA	NA	NA	NA	NA	NA	NA	NA	15 (6)
P-10	II	Sep-87	8.0	NA	NA	NA	NA	NA	NA	NA	NA	NA	ND
HW-3	II	Apr-92	2.5	19	200	NA	NA	NA	NA	NA	ND	NA	ND
HW-4	II	Apr-92	4.5	ND	ND	NA	NA	NA	NA	NA	ND	NA	ND
			6.0	7.3	150	NA	NA	NA	NA	NA	ND	NA	ND
			11.0	3.3	92	NA	NA	NA	NA	NA	ND	NA	ND

TABLE 1
SUMMARY OF CHEMICAL ANALYSES - SOIL
PETROLEUM HYDROCARBON, VOLATILE AND SEMI-VOLATILE ORGANIC COMPOUNDS, AND POLYCHLORINATED BIPHENYLS
SHELLMOUND VENTURES PROPERTY
Emeryville, California

All concentrations expressed in milligrams per kilogram, equivalent to parts per million (ppm)

Sample Number	Parcel	Date Sampled	Depth (ft bgs)	TPH-D	TPH-OG	Total Hydrocarbons	Benzene	Toluene	Ethyl-Benzene	Total Xylenes	VOCs	SVOCs	PCBs
EBM B-5	II	Sep-92	5.5	NA	NA	ND	ND	ND	ND	ND	ND	57.73 (x4)	ND
			10.5	NA	NA	98.18 (1)	ND	ND	ND	ND	ND	476.07 (x5)	ND
			15.5	NA	NA	2.99 (1)	ND	ND	ND	ND	ND	21.17 (x6)	ND
			20.5	NA	NA	ND	ND	ND	ND	ND	ND	2.74 (x7)	ND
			25.5	NA	NA	ND	ND	ND	ND	ND	ND	12.87 (x8)	ND
EBM B-6	II	Sep-92	8.0	NA	NA	31.95 (1)	ND	ND	ND	ND	ND	2.31 (x9)	ND
			9.5	NA	NA	21.12 (1)	ND	ND	ND	0.0308	0.211 (7)	1535.81 (x10)	ND
			13.0	NA	NA	0.5 (1)	ND	ND	ND	ND	ND	52.38 (x11)	ND
			23.0	NA	NA	ND	ND	ND	ND	ND	ND	1.81 (x12)	ND
			28.0	NA	NA	ND	ND	ND	ND	ND	ND	2.16 (x13)	ND
N4	III	Apr-87	9.0	764.4	NA	NA	NA	NA	NA	NA	NA	NA	
MG-3 / B-8	III	Mar-88	8.5	5400	NA	NA	NA	NA	NA	NA	NA	NA	
MG-2 / B-7	III	Apr-89	6.0	ND	NA	NA	ND	ND	ND	ND	NA	NA	
MG-4 / B-9	III	Apr-89	4.5	630	NA	NA	ND	ND	ND	ND	NA	NA	
B-11	III	Apr-90	12.0	190	NA	NA	ND	0.028	ND	0.042	NA	NA	NA
			15.0	430	NA	NA	ND	ND	ND	0.084	NA	NA	NA
HW-5	III	Apr-92	2.5	ND	16	NA	NA	NA	NA	NA	ND	NA	ND
			8.0	ND	23	NA	NA	NA	NA	NA	ND	NA	ND
			11.0	8.4	87	NA	NA	NA	NA	NA	0.0194 (8)	NA	ND

TABLE 1
SUMMARY OF CHEMICAL ANALYSES - SOIL
PETROLEUM HYDROCARBON, VOLATILE AND SEMI-VOLATILE ORGANIC COMPOUNDS, AND POLYCHLORINATED BIPHENYLS
SHELLMOUND VENTURES PROPERTY
Emeryville, California

Notes:

(ft bgs) - feet below ground surface.

TPH-D - Total petroleum hydrocarbons quantified as diesel.

TPH-OG - Total petroleum hydrocarbons quantified as oil and grease.

VOCs - Volatile organic compounds.

SVOCs - Semivolatile organic compounds.

PCBs - Polychlorinated biphenyls.

NA = Not analyzed.

ND = Not detected.

TPH-D, and TPH-OG detected using EPA Test Method 8015M.

Total Hydrocarbons detected using EPA Test Method 8240/8260.

Benzene, Toluene, Ethylbenzene, and Total Xylenes detected using EPA Test Method 8020.

VOCs detected using one or a combination of the following EPA Test Methods: 8010, 8240, 8260.

(1) Analyzed using EPA Test Method 8240/8260 by the East Bay Municipal Utility District. Hydrocarbons detected were grouped into three categories: saturated, unsaturated, and aromatic. Because of the broad range covered by each category, these results should be viewed as only a preliminary screen.

(2) Arochlor 1242 detected at 0.63 ppm, Arochlor 1254 detected at 3.8 ppm

(3) Arochlor 1254 detected at 2.3 ppm

(4) Arochlor 1242 detected at 2.7 ppm, Arochlor 1254 detected at 5.3

(5) Arochlor 1242 detected at 3.8 ppm, Arochlor 1254 detected at 11 ppm

(6) PCB detected was Arochlor 1254

(7) 1,2,4-Trimethylbenzene = 0.069 ppm, 1,2,5-Trimethylbenzene = 0.04 ppm

Naphthalene = 0.044 ppm, P-Isopropyltoluene = 0.058

(8) Trichloroethylene = 0.0064 ppm, Tetrachloroethylene = 0.013 ppm

SUMMARY OF DETECTED SVOCs

Reference Number	Total Hydrocarbons (ppm)	Total PNAs (ppm)	Total Phthalates (ppm)
x1	31.48	0.12	0.07
x2	45.1	0.04	ND
x3	2.36	ND	ND
x4	57	0.73	ND
x5	473	2.09	0.98
x6	21.1	0.07	ND
x7	2.3	0.36	0.08
x8	5.82	4.3	2.55
x9	ND	1.78	0.53
x10	1530	5.07	0.54
x11	50.7	0.49	1.19
x12	1.73	ND	0.08
x13	2.06	ND	0.1

TABLE 2
SUMMARY OF CHEMICAL ANALYSES - SOIL
METALS
SHELLMOUND VENTURES PROPERTY
Emeryville, California

All concentrations expressed in milligrams per kilogram, equivalent to parts per million (ppm)

Sample Number	Parcel	Date Sampled	Depth (ft bgs)	Sb	As	Ba	Be	Cd	Cr	H-Cr (3)	Co	Cu	Pb	Hg	Mo	Ni	Se	Ag	Ti	V	Zn	
N-3	I	Sep-87	3.0	ND	20.0	422.7	1.4	18.3	1119.6	NA	8.5	844.2	212.2	8.9	8.9	83.7	ND	ND	42.8	80.8	5320.4	
N-8/N-9	I	Sep-87	5.0	ND	ND	219.9	1.1	4.51	57.7	NA	11.1	38.1	38.2	ND	ND	45.5	ND	ND	ND	44.1	86.4	
			10.0	ND	32.4	193.8	1.5	4.29	68.1	NA	9.4	28.8	51.8	ND	ND	47.3	ND	ND	ND	50.2	182.1	
HW-1	I	Apr-92	3.0	NA	NA	NA	NA	5.9	68	NA	NA	NA	9.1	NA	NA	98	NA	NA	NA	NA	32	
			5.5 (1)	NA	ND	NA	NA	0.53	0.8	NA	NA	NA	NA	91	NA	NA	1.8	NA	NA	NA	NA	89
			5.5	NA	0.5	NA	NA	11	21	NA	NA	NA	NA	210	NA	NA	20	NA	NA	NA	NA	360
HW-2	I	Apr-92	4.5	NA	NA	NA	NA	2	140	NA	NA	NA	21	NA	NA	3.4	NA	NA	NA	NA	55	
			8 (1)	NA	ND	NA	NA	0.24	14	NA	NA	NA	0.18	NA	NA	0.38	NA	NA	NA	NA	2.9	
			8.0	NA	ND	NA	NA	2	180	NA	NA	NA	10	NA	NA	3.8	NA	NA	NA	NA	20	
			11.0	NA	NA	NA	NA	1.2	17	NA	NA	NA	5.5	NA	NA	17	NA	NA	NA	NA	19	
EBM B-16 (1)	I	Sep-92	5.5	ND	3.0	17	0.11	ND	31	NA	5.9	10	11	ND	0.8	25	ND	ND	8.0	23	27	
			10.5	ND	4.0	27	0.18	ND	33	NA	8.8	17	14	1.5	0.5	35	ND	ND	8.0	30	41	
			16.0	ND	ND	30	0.15	ND	30	NA	4.9	8.0	7.0	ND	0.7	22	ND	ND	ND	23	23	
SS11	I	04/13/94	0.0 - 0.5	6.5	29	280	0.6	5.40	170	0.1	13	540	490	0.78	13	99	ND	0.61	ND	53	1100	
SS12	I	04/13/94	0.0 - 0.5	ND	3.9	54	0.28	0.45	28	ND	9.6	49	20	1.3	ND	39	ND	ND	ND	27	100	
N1/N2	II	Sep-87	3.0	ND	19.2	162.9	0.8	4.32	66.9	NA	6.0	59.3	94.5	ND	ND	33.5	ND	ND	ND	31.7	2138.2	
			8.0	ND	19.3	176.2	1.2	4.29	124.1	NA	6.0	45.0	98.2	ND	ND	29.0	ND	ND	ND	46.3	280.8	
N5	II	Sep-87	5.0	ND	ND	264.5	1.7	14.5	2228.1	NA	3.6	166.4	241.8	ND	8.0	29.3	ND	ND	ND	81.3	2316.4	
HW-3	II	Apr-92	2.5 (2)	NA	0.5	NA	NA	1.5	3.9	NA	NA	NA	81	NA	NA	6.8	NA	NA	NA	NA	160	
			2.5	NA	6.2	NA	NA	5.9	57	NA	NA	NA	300	NA	NA	58	NA	NA	NA	NA	600	
HW-4	II	Apr-92	4.5	NA	NA	NA	NA	9.3	160	NA	NA	NA	4.3	NA	NA	21	NA	NA	NA	NA	59	
			6.0	NA	NA	NA	NA	5.4	61	NA	NA	NA	43	NA	NA	57	NA	NA	NA	NA	290	
			11.0 (2)	NA	ND	NA	NA	0.03	1.4	NA	NA	NA	0.4	NA	NA	0.27	NA	NA	NA	NA	5.1	
			11.0	NA	1.2	NA	NA	3.9	180	NA	NA	NA	240	NA	NA	11	NA	NA	NA	NA	634	
EBM B-5 / P-1	II	Apr-92	5.5	8	14	200	0.31	15	460	NA	8.8	230	650	2.1	6.9	63	ND	2.2	10	74	2800	
			10.5	ND	39	180	0.4	0.7	39	NA	8.3	48	120	1.0	2.5	43	ND	1.8	8.0	35	210	
			15.5	5.0	2.0	45	0.28	ND	97	NA	13	23	36	0.7	0.8	85	ND	0.2	4.0	28	53	
			20.5	4.0	ND	170	0.67	0.7	50	NA	8.8	33	7.0	ND	1.8	42	ND	ND	5.0	41	74	
			25.5	5.0	ND	210	0.93	0.3	60	NA	11	46	8.0	ND	1.6	58	ND	ND	4.0	58	78	

TABLE 2
SUMMARY OF CHEMICAL ANALYSES - SOIL
METALS
SHELLMOUND VENTURES PROPERTY
Emeryville, California

All concentrations expressed in milligrams per kilogram, equivalent to parts per million (ppm)

Sample Number	Parcel	Date Sampled	Depth (ft bgs)	Sb	As	Ba	Be	Cd	Cr	H-Cr (3)	Co	Cu	Pb	Hg	Mo	Ni	Se	Ag	Tl	V	Zn		
EBMB-6	II	Apr-92	8.0	ND	32	140	0.4	5.8	62	NA	9.3	62	240	2.1	1.1	53	ND	3.5	ND	46	430		
			9.5	ND	37	88	0.2	5.1	71	NA	5.7	120	120	2.5	1.7	38	ND	4.2	ND	29	440		
			13.0	ND	ND	37	0.23	ND	36	NA	8.7	32	3.0	ND	2.6	33	ND	ND	ND	34	35		
			23.0	ND	5.0	150	0.6	ND	56	NA	11	27	6.0	ND	1.2	59	ND	ND	5.0	52	62		
			28.0	ND	4.0	120	0.5	ND	50	NA	12	29	6.0	ND	1.2	52	ND	ND	5.0	43	58		
SS7	II	04/13/94	0.0 - 0.5	ND	6.3	92	0.28	2.8	110	ND	10	190	290	6.3	4.0	61	ND	1.8	ND	30	460		
SS8	II	04/13/94	0.0 - 0.5	ND	ND	150	0.39	0.87	16	0.41	5.7	100	53	2.2	2.5	36	ND	ND	ND	13	140		
SS9	II	04/13/94	0.0 - 0.5	12	23	260	0.27	7.1	290	ND	24	1100	580	0.59	31	210	ND	1.7	ND	78	1700		
SSDUP1 (4)	II	04/13/94	0.0 - 0.5	ND	29	140	ND	9.1	290	ND	32	2000	310	0.34	57	280	ND	ND	ND	47	1300		
SS10	II	04/13/94	0.0 - 0.5	ND	3.6	130	0.19	1.6	36	ND	11	2800	2100	1	1.5	36	ND	13	ND	31	830		
G-1	I & II	Apr-90	3.0	NA	NA	NA	NA	NA	NA	NA	NA	NA	NA	NA	NA	NA	NA	NA	NA	NA	NA	83	
			6.0	NA	NA	NA	NA	NA	NA	NA	NA	NA	NA	NA	NA	NA	NA	NA	NA	NA	NA	NA	8100
			9.0	NA	NA	NA	NA	NA	NA	NA	NA	NA	NA	NA	NA	NA	NA	NA	NA	NA	NA	NA	53
G-2	I & II	Apr-90	3.0	NA	NA	NA	NA	NA	NA	NA	NA	NA	NA	NA	NA	NA	NA	NA	NA	NA	NA	1100	
			6.0	NA	NA	NA	NA	NA	NA	NA	NA	NA	NA	NA	NA	NA	NA	NA	NA	NA	NA	210	
			9.0	NA	NA	NA	NA	NA	NA	NA	NA	NA	NA	NA	NA	NA	NA	NA	NA	NA	NA	230	
G-3	I & II	Apr-90	3.0	NA	NA	NA	NA	NA	NA	NA	NA	NA	NA	NA	NA	NA	NA	NA	NA	NA	NA	720	
			6.0	NA	NA	NA	NA	NA	NA	NA	NA	NA	NA	NA	NA	NA	NA	NA	NA	NA	NA	850	
G-4	I & II	Apr-90	3.0	NA	NA	NA	NA	NA	NA	NA	NA	NA	NA	NA	NA	NA	NA	NA	NA	NA	NA	530	
			6.0	NA	NA	NA	NA	NA	NA	NA	NA	NA	NA	NA	NA	NA	NA	NA	NA	NA	NA	700	
			9.0	NA	NA	NA	NA	NA	NA	NA	NA	NA	NA	NA	NA	NA	NA	NA	NA	NA	NA	530	
G-5	I & II	Apr-90	3.0	NA	NA	NA	NA	NA	NA	NA	NA	NA	NA	NA	NA	NA	NA	NA	NA	NA	NA	68	
			6.0	NA	NA	NA	NA	NA	NA	NA	NA	NA	NA	NA	NA	NA	NA	NA	NA	NA	NA	740	
			9.0	NA	NA	NA	NA	NA	NA	NA	NA	NA	NA	NA	NA	NA	NA	NA	NA	NA	NA	890	
West Side	I & II	Jul-90	NA	NA	NA	NA	NA	NA	NA	NA	NA	NA	NA	NA	NA	NA	NA	NA	NA	NA	430		
East Side	I & II	Jul-90	NA	NA	NA	NA	NA	NA	NA	NA	NA	NA	NA	NA	NA	NA	NA	NA	NA	NA	180		
Center	I & II	Jul-90	NA	NA	NA	NA	NA	NA	NA	NA	NA	NA	NA	NA	NA	NA	NA	NA	NA	NA	3615		
B-1	III	Apr-89	2.5	ND	23	950	ND	12	92	NA	14	96	1000	0.58	3.7	29	0.2	ND	ND	24	810		
B-2	III	Apr-89	1.0	6.1	7.3	350	ND	36	1500	NA	13	400	400	ND	14	130	0.4	0.9	ND	100	2300		
B-3	III	Apr-89	2.0	1.3	38	230	ND	32	290	NA	18	490	680	0.24	11	150	0.2	1	ND	54	1800		
B-4	III	Apr-89	3.0	NA	8.2	330	NA	38	580	NA	6.2	220	20000	0.64	4.5	58	0.2	6.3	NA	47	850		

TABLE 2
SUMMARY OF CHEMICAL ANALYSES - SOIL
METALS
SHELLMOUND VENTURES PROPERTY
Emeryville, California

All concentrations expressed in milligrams per kilogram, equivalent to parts per million (ppm)

Sample Number	Parcel	Date Sampled	Depth (ft bgs)	Sb	As	Ba	Be	Cd	Cr	H-Cr (3)	Co	Cu	Pb	Hg	Mo	Ni	Se	Ag	Tl	V	Zn		
MG-1 / B-5	III	Apr-89	4.0	NA	9	710	NA	30	1500	NA	7.8	320	1200	NA	9	67	0.8	3	NA	110	5700		
MG-2 / B-7	III	Apr-89	6.0	ND	28	400	ND	210	560	NA	65	730	6100	0.09	13	130	ND	6.5	ND	78	12300		
MG-3 / B-8	III	Apr-89	2.0	ND	12	350	ND	71	1000	NA	8.8	330	660	0.28	16	88	ND	2.4	ND	100	4100		
MG-4 / B-9	III	Apr-89	2.0	ND	8.7	310	ND	20	310	NA	13	220	120	0.12	7.1	84	ND	2.5	ND	120	660		
MG-7 / B-6	III	Apr-89	2.5	NA	36	370	NA	47	1100	NA	20	910	1300	0.25	19	210	0.2	4.2	NA	83	2200		
B-10	III	Apr-90	6.0	NA	NA	NA	NA	ND	NA	NA	NA	NA	5.7	NA	NA	NA	NA	NA	NA	NA	NA	64	
			12.0	NA	NA	NA	NA	NA	ND	NA	NA	NA	NA	5.7	NA	NA	NA	NA	NA	NA	NA	NA	65
			15.0	NA	NA	NA	NA	NA	ND	NA	NA	NA	NA	11	NA	NA	NA	NA	NA	NA	NA	NA	110
B-11	III	Apr-90	6.0	NA	NA	NA	NA	3.4	NA	NA	NA	NA	780	NA	NA	NA	NA	NA	NA	NA	NA	1400	
			12.0	NA	NA	NA	NA	NA	ND	NA	NA	NA	NA	170	NA	NA	NA	NA	NA	NA	NA	NA	300
			15.0	NA	NA	NA	NA	NA	1.8	NA	NA	NA	NA	1500	NA	NA	NA	NA	NA	NA	NA	NA	5000
N6	III	Apr-87	5.0	ND	ND	221.9	2.3	6.82	319.6	NA	5.3	137.4	160.4	ND	6.4	44.2	ND	ND	ND	61.9	998.6		
T-1	III	July-91	2.5	NA	NA	NA	NA	NA	NA	NA	NA	NA	100	NA	NA	NA	NA	NA	NA	NA	NA	NA	
			5.0	NA	NA	NA	NA	NA	NA	NA	NA	NA	NA	240	NA	NA	NA	NA	NA	NA	NA	NA	NA
			6.0	ND	60	92	ND	4	32	NA	8.8	63	160	3.2	ND	38	ND	ND	ND	19	290	NA	
T-2	III	July-91	1.0	NA	NA	NA	NA	NA	NA	NA	NA	NA	430	NA	NA	NA	NA	NA	NA	NA	NA	NA	
			2.5	NA	NA	NA	NA	NA	NA	NA	NA	NA	NA	1200	NA	NA	NA	NA	NA	NA	NA	NA	NA
T-3	III	July-91	2.5	NA	NA	NA	NA	NA	NA	NA	NA	NA	NA	720	NA	NA	NA	NA	NA	NA	NA	NA	
			5.0	NA	NA	NA	NA	NA	NA	NA	NA	NA	NA	100	NA	NA	NA	NA	NA	NA	NA	NA	NA
T-4	III	July-91	1.0	NA	NA	NA	NA	NA	NA	NA	NA	NA	800	NA	NA	NA	NA	NA	NA	NA	NA		
T-6	III	July-91	1.0	NA	NA	NA	NA	NA	NA	NA	NA	NA	NA	430	NA	NA	NA	NA	NA	NA	NA	NA	
			4.0	NA	NA	NA	NA	NA	NA	NA	NA	NA	NA	220	NA	NA	NA	NA	NA	NA	NA	NA	
			5.0	NA	NA	NA	NA	NA	NA	NA	NA	NA	NA	66	NA	NA	NA	NA	NA	NA	NA	NA	
T-7	III	July-91	2.0	ND	20	190	ND	7.5	110	NA	7.1	720	340	0.2	5.5	110	ND	2	ND	49	2000		
T-8	III	July-91	2.0	ND	7.5	330	ND	46	380	NA	7.8	310	4200	0.1	ND	44	ND	6.6	ND	72	6400		
T-9	III	July-91	1.0	NA	NA	NA	NA	NA	NA	NA	NA	NA	860	NA	NA	NA	NA	NA	NA	NA	NA		
T-10	III	July-91	1.0	ND	6.4	300	ND	12	490	NA	6.6	220	630	0.2	ND	26	ND	1	19	63	2200		
T-12	III	July-91	3.0	NA	NA	NA	NA	NA	NA	NA	NA	NA	7200	NA	NA	NA	NA	NA	NA	NA	NA		
T-13	III	July-91	1.0	ND	9.4	150	ND	46	430	NA	4.6	210	1400	ND	4.4	25	ND	3.2	ND	82	10000		
Surface	III	July-91	0.0	ND	24	12	ND	1.7	18	NA	5.8	610	37	ND	12	91	ND	4.8	ND	40	150		

**TABLE 2
SUMMARY OF CHEMICAL ANALYSES - SOIL
METALS
SHELLMOUND VENTURES PROPERTY
Emeryville, California**

All concentrations expressed in milligrams per kilogram, equivalent to parts per million (ppm)

Sample Number	Parcel	Date Sampled	Depth (ft bgs)	Sb	As	Ba	Be	Cd	Cr	H-Cr (3)	Co	Cu	Pb	Hg	Mo	Ni	Se	Ag	Tl	V	Zn		
HW-5	III	Apr-92	2.5	NA	ND	NA	NA	ND	1.2	NA	NA	NA	0.89	NA	NA	0.13	NA	NA	NA	NA	NA	ND	
			2.5	NA	ND	NA	NA	3.2	229	NA	NA	NA	77	NA	NA	5.7	NA	NA	NA	NA	NA	NA	58
			8.0	NA	NA	NA	NA	2.5	73	NA	NA	NA	NA	ND	NA	NA	47	NA	NA	NA	NA	NA	5
			11.0	NA	NA	NA	NA	5.9	96	NA	NA	NA	NA	80	NA	NA	24	NA	NA	NA	NA	NA	95
SS1	III	04/13/94	0.0 - 0.5	6.7	22	170	0.1	12	190	ND	19	840	2200	1.0	13	190	ND	1.1	ND	33	1300		
SS2	III	04/13/94	0.0 - 0.5	ND	21	74	ND	ND	150	ND	21	1200	77	ND	37	240	ND	ND	ND	38	370		
SS3	III	04/13/94	0.0 - 0.5	3.4	18	280	0.11	15	540	ND	14	630	910	ND	14	130	ND	1.2	ND	56	2000		
SS4	III	04/13/94	0.0 - 0.5	ND	4.1	210	0.14	11	280	ND	8.8	220	880	0.17	3.9	33	ND	1.0	ND	49	2100		
SS5	III	04/13/94	0.0 - 0.5	ND	7.0	340	ND	19	1400	ND	9.3	250	1300	ND	11	40	ND	ND	ND	110	4200		
SS6	III	04/13/94	0.0 - 0.5	6.4	11	240	0.19	12	360	ND	11	320	990	0.21	6.4	57	ND	0.85	ND	47	1500		

Notes:

(ft bgs) - Feet below ground surface.

ND - Not detected.

NA - Not analyzed.

(1) Soil sample results in ppm were analyzed for STLC

(2) Filtered sample

(3) H-Cr = Hexavalent Chromium

(4) SSDUP1 is a duplicate of SS9

Acronym Definitions for Metals

Sb = Antimony

As = Arsenic

Ba = Barium

Be = Beryllium

Cd = Cadmium

Cr = Chromium

H-Cr = Chromium(hexavalent)

Co = Cobalt

Cu = Copper

Pb = Lead

Hg = Mercury

Mo = Molybdenum

Ni = Nickel

Se = Selenium

Ag = Silver

Tl = Thallium

V = Vanadium

Zn = Zinc

TABLE 3
SUMMARY OF CHEMICAL ANALYSES - SOILS
pH, AND SPECIFIC CONDUCTIVITY
SHELLMOUND VENTURES PROPERTY
Emeryville, California

Sample Number	Parcel	Date Sampled	pH (std. pH units)	Specific Conductivity (umhos/cm)
SS11	I	04/13/94	9.6	77
SS12	I	04/13/94	8.5	28
SS7	II	04/13/94	8.7	39
SS8	II	04/13/94	9.6	82
SS9	II	04/13/94	8.7	48
SSDUP1 (1)	II	04/13/94	8.9	57
SS10	II	04/13/94	8.5	17
SS1	III	04/13/94	8.6	64
SS2	III	04/13/94	9.0	11
SS3	III	04/13/94	9.4	39
SS4	III	04/13/94	9.5	31
SS5	III	04/13/94	10.0	55
SS6	III	04/13/94	9.7	180

Notes:

std. pH units - Standard pH units of measure.

umhos/cm - Micromhos per centimeter

(1) SSDUP1 is duplicate of SS9

TABLE 4
SUMMARY OF CHEMICAL ANALYSES - GROUNDWATER
PETROLEUM HYDROCARBONS, VOLATILE AND SEMI-VOLATILE ORGANIC COMPOUNDS, AND POLYCHLORINATED BIPHENYLS
SHELLMOUND VENTURES PROPERTY
Emeryville, California

All concentrations expressed in milligrams per liter, equivalent to parts per million (ppm)

Sample Number	Parcel	Date Sampled	TPH-G	TPH-D	TPH-OG	TPH-K	Benzene	Toluene	Ethyl-Benzene	Total Xylenes	VOCs	SVOCs	PCBs
HW-2	I	Apr-92	ND	3.4	29	NA	ND	ND	ND	ND	ND	ND	ND
EBM B-16	I	Sep-92	NA	NA	NA	NA	ND	ND	ND	ND	0.0015 (5)	1624.002 (12)	ND
HP1	I	04/18/94	ND	2 (2)	3 (3)	ND	ND	ND	ND	ND	ND	0.060 (13)	ND
HP2	I	04/18/94	0.070	2.5 (2)	3 (3)	(4)	ND	ND	ND	ND	ND	0.050 (14)	ND
HP3	I	04/19/94	0.070	1.2 (2)	ND	(4)	ND	ND	ND	ND	ND	ND	ND
HP4	I	04/19/94	0.060	7.6 (2)	6 (3)	(4)	ND	ND	ND	ND	ND	ND	ND
HP19 (1)	I	04/19/94	0.060	6.7 (2)	5 (3)	(4)	ND	ND	ND	ND	ND	ND	ND
HP5	I	04/20/94	ND	5.2 (2)	5 (3)	(4)	ND	ND	ND	ND	0.03 (6)	0.010 (15)	ND
HP6	I	04/20/94	ND	8 (2)	11 (3)	(4)	ND	ND	ND	ND	0.02 (7)	ND	ND
HW-4	II	Apr-92	ND	0.43	1.2	NA	ND	ND	ND	ND	ND	NA	ND
EBM B-5	II	Sep-92	NA	NA	NA	NA	ND	ND	ND	ND	0.01 (8)	2614.034 (16)	ND
EBM B-6	II	Sep-92	NA	NA	NA	NA	ND	ND	ND	ND	ND	809 (17)	0.000163 (20)
HP-7	II	04/20/94	ND	1.6 (2)	1 (3)	(4)	ND	ND	ND	ND	ND	ND	NA
HP-8	II	04/25/94	ND	1.4 (2)	4 (3)	ND	ND	ND	ND	ND	0.06 (9)	ND	NA
HP-9	II	04/25/94	ND	2.5 (2)	4 (3)	ND	ND	ND	ND	ND	0.07 (10)	ND	NA
HP-10	II	04/25/94	ND	2.9 (2)	4 (3)	ND	0.009	ND	ND	ND	0.04 (11)	ND	NA
HP-11	II	04/27/94	ND	1.8 (2)	7 (3)	ND	ND	ND	ND	ND	ND	0.010 (16)	NA
HP-12	II	04/27/94	ND	0.69 (2)	ND	ND	ND	ND	ND	ND	ND	ND	NA
HP-13	II	04/27/94	ND	0.3 (2)	ND	ND	ND	ND	ND	ND	ND	ND	NA
HP-14	II	04/27/94	ND	1.6 (2)	3 (3)	ND	ND	ND	ND	ND	ND	0.060 (19)	NA
B-1	III	Apr-89	NA	ND	NA	NA	0.0005	0.001	ND	0.006	NA	NA	NA
B-2	III	Apr-89	NA	37	NA	NA	0.0026	0.0007	ND	0.0035	NA	NA	NA
B-3	III	Apr-89	NA	13	NA	NA	0.0008	0.0005	ND	0.0014	NA	NA	NA

TABLE 4
SUMMARY OF CHEMICAL ANALYSES - GROUNDWATER
PETROLEUM HYDROCARBONS, VOLATILE AND SEMI-VOLATILE ORGANIC COMPOUNDS, AND POLYCHLORINATED BIPHENYLS
SHELLMOUND VENTURES PROPERTY
Emeryville, California

All concentrations expressed in milligrams per liter, equivalent to parts per million (ppm)

Sample Number	Parcel	Date Sampled	TPH-G	TPH-D	TPH-OG	TPH-K	Benzene	Toluene	Ethyl-Benzene	Total Xylenes	VOCs	SVOCs	PCBs	
B-4	III	Apr-89	NA	ND	NA	NA	ND	0.0003	ND	0.0003	NA	NA	NA	
MG-1 / B-5	III	Apr-89	NS FP (21)	NS FP	NA	NA	NS FP	NS FP	NS FP	NS FP	NA	NA	NA	
		Apr-90	NA	NS FP	NA	NA	NA	NA	NA	NA	NA	NA	NA	
		Mar-91	NS FP	NS FP	NA	NA	NS FP	NS FP	NS FP	NS FP	NS FP	NA	NA	NA
		04/29/94	1.5 (22)	410	NA	(4)	0.19	0.004	0.001	0.0036	NA	NA	NA	
MG-2 / B-7	III	Apr-89	NA	ND	NA	NA	0.09	0.0027	ND	0.0017	NA	NA	NA	
		Apr-90	NA	2.7	NA	NA	0.0014	ND	ND	0.003	0.071 (23)	NA	NA	
		Mar-91	<0.05	ND	NA	NA	0.001	ND	ND	ND	NA	NA	NA	
		May-92	0.21	1.4	NA	NA	0.082	0.0018	0.0006	0.0014	NA	NA	NA	
		04/29/94	0.350 (20)	4	NA	(4)	0.024	0.0011	ND	ND	NA	NA	NA	
MG-3 / B-8	III	Apr-89	NA	ND	NA	NA	0.1	0.0023	ND	0.0089	NA	NA	NA	
		Apr-90	NA	1.2	NA	NA	0.15	ND	ND	ND	NA	NA	NA	
		Mar-91	0.81	2.6	NA	NA	0.075	0.0008	0.0004	0.002	NA	NA	NA	
		04/29/94	0.600 (20)	320	NA	(4)	NA	NA	ND	ND	ND	ND (24)	NA	
MG-4 / B-9	III	Apr-89	NA	ND	NA	NA	0.0003	ND	ND	0.0013	NA	NA	NA	
		Apr-90	NA	0.22	NA	NA	0.0038	ND	ND	ND	NA	NA	NA	
		Mar-91	<0.05	ND	NA	NA	0.0004	ND	ND	0.0005	NA	NA	NA	
		May-92	<0.05	ND	NA	NA	ND	ND	ND	ND	NA	NA	NA	
		04/29/94	<0.050	4	3 (3)	(4)	ND	ND	ND	ND	NA	NA	NA	
MG-7	III	Apr-89	NA	39	NA	NA	ND	0.0004	ND	0.0004	NA	NA	NA	
		Mar-91	<0.05	ND	NA	NA	ND	ND	ND	ND	NA	NA	NA	
		May-92	<0.05	0.06	NA	NA	ND	ND	ND	ND	NA	NA	NA	
		04/29/94	<0.050	(2)	NA	ND	ND	ND	ND	ND	NA	NA	NA	

TABLE 4
SUMMARY OF CHEMICAL ANALYSES - GROUNDWATER
PETROLEUM HYDROCARBONS, VOLATILE AND SEMI-VOLATILE ORGANIC COMPOUNDS, AND POLYCHLORINATED BIPHENYLS
SHELLMOUND VENTURES PROPERTY
Emeryville, California

All concentrations expressed in milligrams per liter, equivalent to parts per million (ppm)

Sample Number	Parcel	Date Sampled	TPH-G	TPH-D	TPH-OG	TPH-K	Benzene	Toluene	Ethyl-Benzene	Total Xylenes	VOCs	SVOCs	PCBs
MW-16	III	Apr-89	NA	ND	NA	NA	0.0009	0.0026	0.0004	0.0041	NA	NA	NA
		Apr-90	NA	0.055	NA	NA	ND	ND	ND	0.00043	NA	NA	NA
		Mar-91	ND	ND	NA	NA	ND	ND	ND	ND	NA	NA	NA
		May-92	ND	0.14	NA	NA	ND	ND	ND	ND	NA	NA	NA
		04/29/94	ND	ND	NA	ND	NA	NA	NA	NA	NA	ND	ND
MW-17	III	Apr-89	NA	ND	NA	NA	ND	ND	ND	ND	NA	NA	NA
MW-18	III	Apr-90	NA	0.17	NA	NA	0.00089	0.0031	0.00038	0.004	NA	NA	NA
		May-92	ND	ND	NA	NA	ND	ND	ND	ND	NA	NA	NA
		04/29/94	ND	3.8	4 (3)	(4)	ND	ND	ND	ND	NA	NA	NA
PZ-1	III	Mar-91	0.32	0.034	NA	NA	0.0004	ND	ND	0.001	NA	NA	NA
		May-92	0.12	0.6	NA	NA	0.0018	0.0003	0.0003	0.0012	NA	NA	NA
		04/29/94	ND	4.1	4 (3)	(4)	NA	NA	NA	NA	ND	ND	NA
HW-5	III	Apr-92	ND	1.7	3.1	NA	0.006	ND	ND	ND	0.0209 (27)	ND	ND
HP15	III	04/28/94	ND	4.8	5 (3)	(26)	NA	NA	NA	NA	ND	NA	NA
HP20 (25)	III	04/28/94	ND	5.8	7 (3)	(26)	NA	NA	NA	NA	ND	NA	NA
HP16	III	04/28/94	ND	1.6	2 (3)	(26)	NA	NA	NA	NA	0.02	NA	NA
HP17	III	04/28/94	ND	2.6	4 (3)	(26)	NA	NA	NA	NA	ND	NA	NA
HP18	III	04/28/94	0.4	36	40 (3)	(26)	NA	NA	NA	NA	0.0027 (28)	NA	NA

TABLE 4
SUMMARY OF CHEMICAL ANALYSES - GROUNDWATER
PETROLEUM HYDROCARBONS, VOLATILE AND SEMI-VOLATILE ORGANIC COMPOUNDS, AND POLYCHLORINATED BIPHENYLS
SHELLMOUND VENTURES PROPERTY
Emeryville, California

Notes:

TPH-G - Total petroleum hydrocarbons quantified as gasoline.

TPH-D - Total petroleum hydrocarbons quantified as diesel.

TPH-OG - Total petroleum hydrocarbons quantified as oil and grease.

TPH-K - Total petroleum hydrocarbons quantified as kerosene.

VOCs - Volatile organic compounds.

SVOCs - Semivolatile organic compounds.

PCBs - Polychlorinated biphenyls.

NA - Not analyzed.

ND - Not detected.

TPH-G, TPH-D, and TPH-OG detected using EPA Test Method 8015M.

Total Hydrocarbons detected using EPA Test Methods 8240/8260. Benzene, Toluene, Ethylbenzene and Total Xylenes detected using EPA Test Method 8020. VOCs were detected using one or a combination of the following EPA Test Methods: 8010, 8240, and/or 8260. Semi-Volatile Organic Compounds were analyzed using EPA 8270, Poly Chlorinated Biphenyls by EPA 8060.

(1) Duplicate of HP4

(2) Sample chromatogram does not match diesel standard chromatogram

(3) Hydrocarbon pattern does not match a diesel pattern, but may include some kind of hydraulic or transformer oil. Values are estimated and based on a calibration for motor oil.

(4) Kerosene range not reported due to overlap of hydrocarbon range

(5) PCE at 0.0015 ppm

(6) Acetone at 0.03 ppm

(7) Acetone at 0.02 ppm

(8) Acetone at 0.01 ppm

(9) Acetone at 0.06 ppm

(10) Acetone at 0.07 ppm

(11) Acetone at 0.04 ppm

(12) Using EPA Test Method 8270, Total Hydrocarbons were detected at a concentration of 1620 ppm.

Total Poly Nuclear Aromatics were detected at a concentration of 0.002 ppm,

and Total Phthalates detected at 4 ppm. No speciation was available in the referenced McLaren Hart report

(13) Bis (2-Ethylhexyl) phthalate detected at 0.060 ppm

(14) 2-Methylphenol = 0.020 ppm, 2,4-Dimethylphenol = 0.010 ppm, Bis (2-Ethylhexyl) phthalate = 0.020 ppm

(15) Naphthalene detected at 0.010 ppm

(16) Using EPA Test Method 8270, Total Hydrocarbons were detected at a concentration of 2780 ppm

Total Phthalates were detected at 34 ppm. No information was available pertaining to speciation of the hydrocarbons or phthalates. Polynuclear aromatics were detected in the following quantities:

Phenol = 0.004 ppm, Benzo(a)anthracene = 0.004 ppm, Benzo(a)pyrene = 0.002 ppm

3,4-Benzofluoranthene = 0.004 ppm, Phenanthrene = 0.004 ppm, Pyrene = 0.006 ppm,

Chrysene = 0.005 ppm, and Fluoranthene 0.005 ppm.

(17) Using EPA Test Method 8270, Total Hydrocarbons were detected at a concentration of 805 ppm

Total Phthalates were detected at a concentration of 4 ppm.

(18) Bis (2-Ethylhexyl) phthalate detected at 0.010 ppm

(19) Di-n-Butylphthalate detected at 0.060 ppm

(20) Methoxychlor = 0.000183

(21) = Not Sampled due to the presence of Free Product

(22) Sample chromatogram does not resemble gasoline standard

(23) Acetone 0.071

(24) Analytes targeted by test method have reporting limits of either 100 or 500 ppb due to high hydrocarbon background

(25) HP20 is a duplicate of HP15

(26) Quantified as diesel due to overlap of hydrocarbon ranges

(27) Trichloroethylene detected at 0.0068 ppm, Tetrachloroethylene detected at 0.006 ppm,

Chloroform detected at 0.0051 ppm

(28) Vinyl Chloride at 0.027

TABLE 5
SUMMARY OF CHEMICAL ANALYSES - GROUNDWATER
METALS
SHELLMOUND VENTURES PROPERTY
Emeryville, California

All concentrations expressed in milligrams per liter, equivalent to parts per million (ppm)

Sample Number	Parcel	Date Sampled	Sb	As	Ba	Be	Cd	Cr	H-Cr	Co	Cu	Pb	Hg	Mo	Ni	Se	Ag	Tl	V	Zn	
HW-2	I	Apr-92	NA	NA	NA	NA	ND	0.04	NA	NA	NA	ND	NA	NA	ND	NA	NA	NA	NA	0.005	
EBM B-16-W (1)	I	Sep-92	ND	ND	0.062	ND	ND	ND	NA	ND	ND	ND	ND	0.11	0.01	ND	ND	ND	0.081	ND	
HP1	I	04/18/94	ND	0.0099	0.094	ND	ND	ND	ND	ND	0.0092	ND	ND	0.058	ND	ND	ND	ND	0.042	ND	
HP2	I	04/18/94	ND	ND	0.160	ND	ND	ND	ND	ND	0.02	ND	ND	0.100	ND	ND	ND	ND	0.031	0.025	
HP3	I	04/18/94	ND	0.0074	0.062	ND	ND	ND	ND	ND	0.018	0.0039	ND	ND	ND	ND	ND	ND	ND	0.025	
HP4	I	04/19/94	ND	0.098	0.031	ND	ND	0.013	ND	ND	0.012	ND	ND	ND	ND	ND	ND	ND	0.023	0.022	
HP18 (2)	I	04/18/94	ND	0.098	0.029	ND	ND	0.013	ND	ND	ND	ND	ND	0.016	ND	ND	ND	ND	0.02	ND	
HP5	I	04/20/94	ND	0.054	0.062	ND	ND	ND	ND	ND	ND	ND	ND	ND	ND	ND	ND	ND	ND	ND	
HP6	I	04/20/94	ND	0.052	0.210	ND	ND	ND	ND	ND	ND	ND	ND	ND	ND	ND	ND	ND	ND	ND	
HW-4	II	Apr-92	NA	NA	NA	NA	ND	0.08	NA	NA	NA	ND	NA	NA	ND	NA	NA	NA	NA	0.02	
EBM B-5-W (1)	II	Sep-92	0.3	ND	7.2	0.029	ND	0.43	NA	0.5	ND	ND	ND	0.04	1.7	ND	ND	0.5	0.92	3.9	
EBM B-6-W (1)	II	Sep-92	0.06	ND	3.3	ND	ND	ND	NA	0.064	ND	ND	0.01	0.009	0.18	ND	ND	0.05	0.029	2.1	
HP7	II	04/20/94	ND	0.03	0.046	ND	ND	ND	ND	ND	ND	ND	ND	ND	ND	ND	ND	ND	0.011	ND	
HP8	II	04/25/94	ND	0.034	0.023	ND	ND	ND	ND	ND	ND	0.0057	ND	0.058	0.027	ND	ND	ND	0.100	ND	
HP9	II	04/25/94	ND	0.011	0.039	ND	ND	ND	ND	ND	ND	ND	ND	0.28	ND	ND	ND	ND	0.084	ND	
HP10	II	04/25/94	ND	0.018	0.039	ND	ND	ND	ND	ND	ND	ND	ND	0.088	ND	ND	ND	ND	0.110	ND	
HP11	II	04/27/94	ND	0.011	0.300	ND	ND	ND	ND	ND	ND	ND	ND	0.01	0.023	ND	ND	ND	0.014	0.023	
HP12	II	04/27/94	ND	0.0082	0.120	ND	ND	ND	0.01	ND	ND	0.0043	ND	ND	0.11	ND	ND	ND	ND	0.096	
HP13	II	04/27/94	0.061	0.210	0.038	ND	ND	ND	ND	ND	ND	ND	ND	ND	0.022	ND	ND	ND	ND	ND	
HP14	II	04/27/94	0.061	0.200	0.023	ND	ND	ND	ND	ND	ND	ND	ND	0.11	0.034	ND	ND	ND	0.025	0.045	
B-1	III	Apr-89	ND	1.7	0.48	ND	ND	ND	NA	ND	ND	ND	ND	ND	ND	0.001	ND	ND	ND	ND	
B-2	III	Apr-89	ND	0.003	0.33	ND	ND	ND	NA	ND	ND	ND	ND	ND	ND	0.12	ND	ND	ND	ND	
B-3	III	Apr-89	0.07	0.005	0.12	ND	ND	ND	NA	ND	ND	ND	ND	0.11	ND	0.001	ND	ND	0.04	0.04	
B-4	III	Apr-89	ND	0.018	0.06	ND	ND	ND	NA	ND	ND	ND	ND	ND	ND	0.001	ND	ND	ND	0.06	
MG-1	III	Apr-89	ND	0.005	2.2	ND	ND	ND	NA	ND	ND	ND	ND	ND	ND	0.001	ND	ND	ND	ND	
		Jul-90	ND	0.009	0.14	ND	ND	ND	NA	ND	0.04	ND	ND	ND	ND	ND	ND	ND	ND	ND	ND
		May-92	ND	0.019	7.9	ND	ND	ND	NA	ND	ND	ND	ND	ND	0.01	ND	ND	ND	ND	ND	0.02

TABLE 7
SUMMARY OF CHEMICAL ANALYSES - SOIL
PETROLEUM HYDROCARBONS, VOLATILE AND SEMI-VOLATILE ORGANIC COMPOUNDS, AND POLYCHLORINATED BIPHENYLS
BARBARY COAST STEEL PROPERTY
Emeryville, California

All concentrations expressed in milligrams per kilogram, equivalent to parts per million (ppm)

Sample Number	Date Sampled	Depth (ft bgs)	TPH-G	TPH-D	TPH-OG	Total Hydrocarbons	Benzene	Toluene	Ethyl-Benzene	Total Xylenes	VOCs	SVOCs	PCBs
SB-35	Jul 93	0.5	ND	ND	490	NA	NA	NA	NA	NA	NA	NA	NA
	Jul 93	4.5	ND	ND	350	NA	NA	NA	NA	NA	NA	NA	NA
SB-36	Jul 93	0.5	ND	ND	2300	NA	NA	NA	NA	NA	NA	NA	NA
	Jul 93	4.5	ND	ND	50	NA	NA	NA	NA	NA	NA	NA	NA
SB-37	Jul 93	0.5	ND	ND	1700	NA	NA	NA	NA	NA	NA	NA	NA
	Jul 93	4.5	ND	ND	380	NA	NA	NA	NA	NA	NA	NA	NA
SB-38	Jul 93	1.5	ND	ND	810	NA	ND	ND	ND	ND	ND	NA	NA
	Jul 93	4.5	ND	ND	840	NA	ND	ND	ND	ND	0.109	NA	NA
SB-39	Jul 93	1.5	ND	ND	470	NA	NA	NA	NA	NA	NA	NA	NA
	Jul 93	4.5	ND	ND	74	NA	NA	NA	NA	NA	NA	NA	NA
SB-40	Jul 93	1.0	ND	ND	420	NA	NA	NA	NA	NA	NA	NA	NA
	Jul 93	4.5	ND	ND	150	NA	NA	NA	NA	NA	NA	NA	NA
SB-41	Jul 93	1.0	ND	ND	710	NA	NA	NA	NA	NA	NA	NA	NA
	Aug 93	4.5	ND	ND	280	NA	NA	NA	NA	NA	NA	NA	NA
SB-42	Jul 93	1.0	ND	ND	170	NA	ND	ND	ND	ND	NA	NA	NA
	Jul 93	4.5	1.3	5000	ND	NA	ND	ND	0.01	0.01	NA	NA	NA
SB-43	Jul 93	1.5	ND	ND	ND	NA	NA	NA	NA	NA	NA	NA	NA
	Jul 93	4.5	ND	ND	990	NA	NA	NA	NA	NA	NA	NA	NA
SB-44	Jul 93	1.5	ND	ND	310	NA	NA	NA	NA	NA	NA	NA	NA
	Jul 93	4.5	ND	ND	480	NA	NA	NA	NA	NA	NA	NA	NA
SB-45	Jul 93	1.0	ND	ND	190	NA	NA	NA	NA	NA	NA	NA	NA
	Jul 93	4.5	ND	ND	1000	NA	NA	NA	NA	NA	NA	NA	NA
SB-46	Jul 93	1.0	ND	ND	43	NA	ND	0.007	ND	0.013	NA	NA	NA
	Aug 93	4.5	ND	ND	83	NA	ND	ND	ND	ND	NA	NA	NA

TABLE 7
SUMMARY OF CHEMICAL ANALYSES - SOIL
PETROLEUM HYDROCARBONS, VOLATILE AND SEMI-VOLATILE ORGANIC COMPOUNDS, AND POLYCHLORINATED BIPHENYLS
BARBARY COAST STEEL PROPERTY
Emeryville, California

All concentrations expressed in milligrams per kilogram, equivalent to parts per million (ppm)

Sample Number	Date Sampled	Depth (ft bgs)	TPH-G	TPH-D	TPH-OG	Total Hydrocarbons	Benzene	Toluene	Ethyl-Benzene	Total Xylenes	VOCs	SVOCs	PCBs
SB-47	Aug 93	1.0	ND	ND	28	NA	NA	NA	NA	NA	NA	NA	NA
	Jul 93	4.5	ND	ND	6	NA	NA	NA	NA	NA	NA	NA	NA
SB-48	Jul 93	1.5	ND	ND	86	NA	NA	NA	NA	NA	NA	NA	NA
	Jul 93	4.5	ND	ND	56	NA	NA	NA	NA	NA	NA	NA	NA
SB-49	Jul 93	1.5	ND	ND	130	NA	NA	NA	NA	NA	NA	NA	NA
	Jul 93	4.5	ND	ND	39	NA	NA	NA	NA	NA	NA	NA	NA
SB-50	Jul 93	1.5	ND	ND	16	NA	NA	NA	NA	NA	NA	NA	NA
	Jul 93	4.5	ND	ND	89	NA	NA	NA	NA	NA	NA	NA	NA
SB-51	Jul 93	1.0	ND	ND	1600	NA	NA	NA	NA	NA	NA	NA	NA
	Jul 93	4.5	ND	ND	70	NA	ND	ND	ND	ND	ND	NA	NA
SB-52	Jul 93	1.0	ND	ND	4300	NA	NA	NA	NA	NA	NA	NA	NA
	Jul 93	4.5	ND	ND	2200	NA	NA	NA	NA	NA	NA	NA	NA
SB-53	Jul 93	1.5	ND	ND	1900	NA	NA	NA	NA	NA	NA	NA	NA
	Jul 93	4.5	ND	ND	5700	NA	NA	NA	NA	NA	NA	NA	NA
SB-54	Jul 93	1.5	ND	ND	710	NA	NA	NA	NA	NA	NA	NA	NA
	Jul 93	4.5	ND	ND	55	NA	NA	NA	NA	NA	NA	NA	NA
SB-55	Jul 93	0.5	ND	ND	190	NA	NA	NA	NA	NA	NA	NA	NA
	Jul 93	4.5	ND	ND	9400	NA	NA	NA	NA	NA	NA	NA	NA
SB-56	Jul 93	1.0	ND	ND	ND	NA	NA	NA	NA	NA	NA	0.017	NA
	Jul 93	4.5	ND	ND	ND	NA	NA	NA	NA	NA	NA	0.263	NA
SB-57	Jul 93	1.5	ND	ND	97	NA	NA	NA	NA	NA	NA	ND	NA
	Jul 93	4.5	ND	ND	ND	NA	NA	NA	NA	NA	NA	0.285	NA
SB-58	Aug 93	1.0	ND	ND	1400	NA	NA	NA	NA	NA	NA	NA	NA
	Aug 93	7.0	ND	ND	22	NA	NA	NA	NA	NA	NA	NA	NA

TABLE 7
SUMMARY OF CHEMICAL ANALYSES - SOIL
PETROLEUM HYDROCARBONS, VOLATILE AND SEMI-VOLATILE ORGANIC COMPOUNDS, AND POLYCHLORINATED BIPHENYLS
BARBARY COAST STEEL PROPERTY
Emeryville, California

All concentrations expressed in milligrams per kilogram, equivalent to parts per million (ppm)

Sample Number	Date Sampled	Depth (ft bgs)	TPH-G	TPH-D	TPH-OG	Total Hydrocarbons	Benzene	Toluene	Ethyl-Benzene	Total Xylenes	VOCs	SVOCs	PCBs
SB-59	Aug 93	1.0	ND	1300	ND	NA	NA	NA	NA	NA	NA	NA	NA
	Aug 93	8.0	ND	ND	150	NA	NA	NA	NA	NA	NA	NA	NA
SB-60	Aug 93	1.0	ND	ND	330	NA	NA	NA	NA	NA	NA	NA	NA
	Aug 93	7.0	ND	ND	260	NA	NA	NA	NA	NA	NA	NA	NA
SB-61	Aug 93	1.0	ND	ND	280	NA	NA	NA	NA	NA	NA	NA	NA
	Aug 93	8.0	ND	ND	63	NA	NA	NA	NA	NA	NA	NA	NA
SB-62	Feb 94	0.5	ND	ND	320	NA	NA	NA	NA	NA	NA	ND	NA
SB-63	Feb 94	0.5	ND	ND	230	NA	NA	NA	NA	NA	NA	ND	NA
	Feb 94	4.0	ND	ND	ND	NA	NA	NA	NA	NA	NA	ND	NA
T4N	Feb 88	8.0	6	NA	NA	NA	ND	ND	ND	ND	NA	NA	NA
T4S	Feb 88	8.0	ND	NA	NA	NA	NA	NA	NA	NA	NA	NA	NA
T5N	Feb 88	7.0	NA	9870	NA	NA	NA	NA	NA	NA	NA	NA	NA
T5S	Feb 88	8.0	NA	9650	NA	NA	NA	NA	NA	NA	NA	NA	NA
T6NE	Feb 88	4.5	NA	1100	NA	NA	NA	NA	NA	NA	NA	NA	NA
T6SW	Feb 88	5.5	NA	ND	NA	NA	NA	NA	NA	NA	NA	NA	NA
TS-1	Aug 93		ND	ND	11000	NA	NA	NA	NA	NA	NA	NA	NA
W-1	Sep 87	5.0	NA	NA	NA	ND	NA	NA	NA	NA	NA	NA	NA
W-2	Sep 87	1.5	NA	NA	NA	ND	NA	NA	NA	NA	NA	NA	NA
W-3	Sep 87	14.0	NA	NA	NA	ND	NA	NA	NA	NA	NA	NA	NA
W-4	Sep 87	9.0	NA	NA	NA	ND	NA	NA	NA	NA	NA	NA	NA
W-5	Sep 87	9.0	NA	NA	NA	ND	NA	NA	NA	NA	NA	NA	NA
W-6	Sep 87	9.0	NA	NA	NA	ND	NA	NA	NA	NA	NA	NA	NA
W-7	Sep 87	8.0	NA	NA	NA	18.4	NA	NA	NA	NA	NA	NA	NA
W-8	Sep 87	9.0	NA	NA	NA	ND	NA	NA	NA	NA	NA	NA	NA

TABLE 7
SUMMARY OF CHEMICAL ANALYSES - SOIL
PETROLEUM HYDROCARBONS, VOLATILE AND SEMI-VOLATILE ORGANIC COMPOUNDS, AND POLYCHLORINATED BIPHENYLS
BARBARY COAST STEEL PROPERTY
Emeryville, California

All concentrations expressed in milligrams per kilogram, equivalent to parts per million (ppm)

Sample Number	Date Sampled	Depth (ft bgs)	TPH-G	TPH-D	TPH-OG	Total Hydrocarbons	Benzene	Toluene	Ethyl-Benzene	Total Xylenes	VOCs	SVOCs	PCBs
W-9	Sep 87	4.0	NA	NA	NA	329.8	NA	NA	NA	NA	NA	NA	NA
W-10	Sep 87	8.0	NA	NA	NA	7.89	NA	NA	NA	NA	NA	NA	NA
W-11	Sep 87	7.0	NA	NA	NA	ND	NA	NA	NA	NA	NA	NA	NA

Notes:

TPH-G - Total petroleum hydrocarbons quantified as gasoline.

TPH-D - Total petroleum hydrocarbons quantified as diesel.

TPH-OG - Total petroleum hydrocarbons quantified as oil and grease.

VOCs - Volatile organic compounds.

SVOCs - Semivolatile organic compounds.

PCBs - Polychlorinated biphenyls.

ND - Not detected.

NA - Not analyzed.

TPH-D, TPH-G, and TPH-OG detected using EPA Test Method 8015M.

Total Hydrocarbons detected using EPA Test Method 8240/8260.

Benzene, Toluene, Ethylbenzene, and Total Xylenes detected using EPA Test Method 8020.

VOCs detected using one or a combination of EPA Test Methods 8010, 8020, 8240, 8260.

(ft bgs) - Feet below ground surface.

U - Unknown, or data not available.

TABLE 8
SUMMARY OF CHEMICAL ANALYSES - SOIL
METALS
BARBARY COAST STEEL PROPERTY
Emeryville, California

All concentrations expressed in milligrams per kilogram, equivalent to parts per million (ppm)

Sample Number	Date Sampled	Depth (ft bgs)	Sb	As	Ba	Be	Cd	Cr	Co	Cu	Fe	Pb	Mn	Hg	Mo	Ni	Se	Ag	Tl	Sn	V	Zn
W1	09/01/87	5	ND	33.9	278.8	ND	13.3	110.1	11.4	1636.0	NA	1408.0	1187	ND	ND	162.2	ND	ND	105.3	196.5	30.7	3431.0
W2	09/01/87	1.5	ND	14.8	196.3	ND	17.5	354.0	32.1	3018.0	NA	906.2	5349	ND	11.7	4890.0	ND	1.4	186.1	37.1	47.8	1894.0
W3	09/01/87	14	ND	4.0	99.7	ND	2.5	32.1	5.4	18.7	NA	7.5	155.8	ND	ND	34.0	ND	ND	ND	ND	30.5	46.4
W6	09/01/87	9	ND	19.1	140.2	ND	10.8	236.3	8.8	339.4	NA	179.0	3181	ND	ND	75.2	ND	ND	72.2	27.7	37.6	746.2
W7	09/01/87	8	ND	ND	62.5	ND	6.7	36.5	12.3	54.0	NA	295.6	397.0	ND	ND	49.3	ND	ND	163.2	ND	27.9	240
MW-2B	08/10/93	0.5 - 1.0	ND	22	133	ND	ND	207	15	485	NA	53	NA	0.2	NA	93	ND	ND	ND	21	34	271
		3.5 - 4.0	NA	21	96	NA	ND	52	NA	765	NA	733	NA	NA	NA	86	NA	27	1	46	48	1,060
MW-3B	08/10/93	0.5 - 1.0	NA	27	339	NA	ND	904	NA	747	NA	89	NA	NA	NA	132	NA	ND	ND	80	110	172
		3.5 - 4.0	NA	17	164	NA	ND	1,110	NA	656	NA	106	NA	NA	NA	122	NA	4	ND	74	127	186
MW-4B	08/10/93	0.0 - 0.5	NA	6	50	NA	ND	61	NA	163	NA	72	NA	NA	NA	54	NA	ND	ND	17	131	247
		3.5 - 4.0	NA	33	129	NA	ND	60	NA	283	NA	388	NA	NA	NA	110	NA	ND	ND	30	33	336
MW-5	07/30/93	0.5	NA	25	409	NA	37	840	NA	1650	NA	1160	NA	NA	NA	425	NA	2	1	82	91	47,400
		4	NA	10	128	NA	ND	118	NA	340	NA	3770	NA	NA	NA	36	NA	ND	ND	26	28	578
MW-6	07/28/93	0.5	NA	37	822	NA	24	586	NA	1360	NA	1910	NA	NA	NA	186	NA	3	ND	168	68	28,400
		4.5	NA	24	244	NA	3	109	NA	2820	NA	613	NA	NA	NA	118	NA	ND	ND	315	34	1,020
MW-8	07/28/93	0.5	NA	28	97	NA	6	197	NA	431	NA	679	NA	NA	NA	114	NA	ND	ND	57	43	1,080
		4.5	NA	5	61	NA	ND	27	NA	13	NA	ND	NA	NA	NA	29	NA	ND	ND	ND	20	37
MW-9	07/26/93	1	38	28	397	ND	24	335	42	2200	NA	1890	NA	3.1	NA	433	ND	ND	ND	102	41	5,260
		4	NA	28	186	NA	12	364	NA	1220	NA	895	NA	NA	NA	211	NA	ND	ND	104	47	2,320
MW-10	07/30/93	0.5	12	44	62	ND	ND	57	66	828	NA	111	NA	ND	NA	181	ND	ND	1	92	12	164
		4	NA	7	149	NA	2	44	NA	66	NA	110	NA	NA	NA	57	NA	5	ND	ND	36	124
MW-11	07/23/93	1	NA	17	85	NA	ND	185	NA	385	NA	138	NA	NA	NA	165	NA	ND	ND	35	58	345
		4	NA	20	46	NA	ND	100	NA	255	NA	226	NA	NA	NA	106	NA	ND	ND	28	53	306

TABLE 8
SUMMARY OF CHEMICAL ANALYSES - SOIL
METALS
BARBARY COAST STEEL PROPERTY
Emeryville, California

All concentrations expressed in milligrams per kilogram, equivalent to parts per million (ppm)

Sample Number	Date Sampled	Depth (ft bgs)	Sb	As	Ba	Be	Cd	Cr	Co	Cu	Fe	Pb	Mn	Hg	Mo	Ni	Se	Ag	Tl	Sn	V	Zn
MW-12	07/23/93	0.5	NA	10	324	NA	4	1110	NA	258	NA	274	NA	NA	NA	67	NA	2	ND	30	108	931
		4	NA	9	206	NA	4	672	NA	206	NA	247	NA	NA	NA	79	NA	ND	ND	24	70	840
MW-13	07/23/93	1	NA	10	102	NA	13	30	NA	35	NA	22	NA	NA	NA	40	NA	ND	ND	ND	50.0	147
		4	NA	22	85	NA	6.0	19.0	NA	49	NA	42	NA	NA	NA	24.0	NA	ND	ND	ND	77.0	237
MW-14	07/30/93	0.5	NA	3	1100	NA	2.0	1050	NA	541	NA	108	NA	NA	NA	88.0	NA	6.0	ND	22.0	201.0	1,020
		4	NA	53	419	NA	ND	780	NA	388	NA	277	NA	NA	NA	214.0	NA	ND	1	41.0	122.0	534
MW-15	02/22/94	0.5	12	36	320	ND	8.0	310	25	1400	NA	550	NA	0.8	NA	340	ND	1	ND	ND	51.0	1,900
		4	ND	44	290	ND	11	520	40	2000	NA	550	NA	ND	NA	470	ND	ND	ND	270	76	700
MW-16	02/22/94	0.5	ND	32	250	ND	2	270	36	510	NA	2400	NA	28	NA	160	ND	ND	ND	ND	32	550
		4	ND	3	48	ND	ND	4	3	18	NA	33	NA	ND	NA	13	ND	ND	ND	ND	8	30
SB-1	07/20/93	0.5	35	21	621	ND	2	1400	43	2,290	NA	386	NA	0.7	NA	430	ND	ND	ND	88	114	1,920
		3	NA	27	244	NA	ND	719	NA	2,320	NA	615	NA	NA	NA	410	NA	ND	ND	102	60	1,250
		5.5	NA	43	436	NA	30	598	NA	5,770	NA	7,210	NA	NA	NA	706	NA	ND	ND	471	68	4,290
SB-2	07/22/93	1	NA	28	499	NA	44	627	NA	1070	NA	1850	NA	NA	NA	244	NA	8	ND	85	100	8,060
		4	NA	39	248	NA	4	231	NA	695	NA	483	NA	NA	NA	251	NA	ND	ND	74	35	1,100
SB-5	08/02/93	0.5	NA	20	511	NA	18	419	NA	1270	NA	2140	NA	NA	NA	163	NA	4	1	112	76	4,680
		4	NA	2	120	NA	ND	40	NA	33	NA	62	NA	NA	NA	60	NA	ND	ND	ND	28	1,760
SB-9	07/22/93	1	NA	71	220	NA	379	621	NA	1230	NA	14900	NA	NA	NA	210	NA	49	ND	168	79	98,000
		4.5	NA	15	212	NA	849	157	NA	272	NA	1260	NA	NA	NA	68	NA	6	ND	178	64	9,460
SB-10	07/22/93	1	ND	41	200	ND	429	660	21	1320	NA	16800	NA	1.5	NA	214	1	47	ND	148	67	113,000
		4.5	NA	17	146	NA	7	93	NA	71	NA	342	NA	NA	NA	114	NA	ND	ND	195	46	2,780
SB-13	07/26/93	1	ND	6	87	ND	29	62	10	92	NA	888	NA	0.2	NA	35	ND	2	ND	14	32	3,420
		4	NA	34	157	NA	18	65	NA	183	NA	611	NA	NA	NA	70	NA	ND	ND	35	29	1,610

TABLE 8
SUMMARY OF CHEMICAL ANALYSES - SOIL
METALS
BARBARY COAST STEEL PROPERTY
Emeryville, California

All concentrations expressed in milligrams per kilogram, equivalent to parts per million (ppm)

Sample Number	Date Sampled	Depth (ft bgs)	Sb	As	Ba	Be	Cd	Cr	Co	Cu	Fe	Pb	Mn	Hg	Mo	Ni	Se	Ag	Tl	Sn	V	Zn
SB-14	07/26/93	1	NA	6	206	NA	14	519	NA	351	NA	757	NA	NA	NA	92	NA	2	ND	47	60	5,110
		4.5	NA	13	155	NA	7	391	NA	341	NA	1620	NA	NA	NA	129	NA	ND	ND	69	34	2,530
SB-15	07/26/93	1	11	14	274	ND	26	479	17	703	NA	1040	NA	0.6	NA	147	ND	6	ND	29	68	9,200
		4.5	NA	10	89	NA	ND	74	NA	53	NA	124	NA	NA	NA	72	NA	7	ND	ND	33	249
SB-16	07/26/93	1	NA	10	131	NA	ND	529	NA	1100	NA	271	NA	NA	NA	257	NA	4	ND	51	66	1,530
		4.5	NA	5	124	NA	ND	44	NA	82	NA	37	NA	NA	NA	47	NA	ND	ND	ND	23	144
SB-17	07/30/93	0.5	NA	3	39	NA	ND	32	NA	26	NA	38	NA	NA	NA	32	NA	ND	ND	ND	18	67
		4	NA	6	67	NA	ND	31	NA	80	NA	153	NA	NA	NA	48	NA	ND	ND	12	18	244
SB-18	07/27/93	0.5	21	14	62	ND	8	614	48	1890	NA	237	NA	1.6	NA	313	ND	ND	ND	168	71	1,070
		4	NA	8	770	NA	2	338	NA	356	NA	139	NA	NA	NA	72	NA	4	ND	27	117	727
SB-19	08/31/93	1	NA	8	579	NA	56	402	NA	763	NA	2650	NA	NA	NA	165	NA	10	ND	42	98	27,900
SB-20	07/21/93	1	NA	21	127	NA	ND	78	NA	1310	NA	2300	NA	NA	NA	80	NA	ND	ND	89	34	758
SB-21	07/21/93	1	NA	3	220	NA	ND	44	NA	35	NA	37	NA	NA	NA	36	NA	ND	ND	ND	32	54
		4	NA	14	127	NA	ND	240	NA	241	NA	431	NA	NA	NA	65	NA	ND	ND	96	51	555
SB-22	07/22/93	1	NA	5	749	NA	ND	438	NA	349	NA	105	NA	NA	NA	75	NA	ND	ND	18	124	644
		4	NA	8	159	NA	ND	173	NA	290	NA	83	NA	NA	NA	86	NA	ND	ND	28	126	404
SB-23	08/02/93	0.5	NA	2	10	NA	ND	44	NA	199	NA	26	NA	NA	NA	39	NA	ND	ND	14	46	137
		4	NA	9	77	NA	ND	58	NA	160	NA	75	NA	NA	NA	44	NA	ND	ND	16	15	196
SB-27	07/27/93	0.5	NA	10	145	NA	ND	91	NA	155	NA	224	NA	NA	NA	79	NA	ND	ND	17	37	319
		4	NA	21	269	NA	ND	53	NA	230	NA	730	NA	NA	NA	87	NA	ND	ND	44	22	818
SB-28	07/27/93	0.5	NA	15	253	NA	ND	64	NA	172	NA	201	NA	NA	NA	82	NA	ND	ND	26	32	314
		4	NA	40	160	NA	ND	84	NA	635	NA	435	NA	NA	NA	140	NA	ND	ND	52	21	596

TABLE 8
SUMMARY OF CHEMICAL ANALYSES - SOIL
METALS
BARBARY COAST STEEL PROPERTY
Emeryville, California

All concentrations expressed in milligrams per kilogram, equivalent to parts per million (ppm)

Sample Number	Date Sampled	Depth (ft bgs)	Sb	As	Ba	Be	Cd	Cr	Co	Cu	Fe	Pb	Mn	Hg	Mo	Ni	Se	Ag	Tl	Sn	V	Zn
SB-29	07/27/93	0.5	NA	11	82	NA	ND	58	NA	249	NA	23	NA	NA	NA	89	NA	6	ND	31	12	60
		4	NA	71	224	NA	ND	58	NA	422	NA	753	NA	NA	NA	106	NA	ND	ND	52	54	1,450
SB-30	07/20/93	1	NA	35	308	NA	16	1400	NA	1590	NA	1340	NA	NA	NA	409	NA	ND	ND	152	88	17,400
		4	NA	5	674	NA	ND	32	NA	1720	NA	4360	NA	NA	NA	132	NA	ND	ND	637	42	202
SB-31	07/20/93	0.5	12	19	116	ND	2	519	26	402	NA	346	NA	1.8	NA	179	ND	ND	1	36	29	668
		4	NA	5	125	NA	ND	53	NA	45	NA	ND	NA	NA	NA	56	NA	ND	ND	ND	28	91
SB-32	07/20/93	1.5	NA	16	173	NA	ND	330	NA	396	NA	245	NA	NA	NA	117	NA	ND	ND	65	52	361
		4	NA	21	121	NA	ND	43	NA	120	NA	153	NA	NA	NA	34	NA	ND	ND	15	25	231
SB-33	07/20/93	1	NA	24	121	NA	ND	168	NA	631	NA	160	NA	NA	NA	165	NA	ND	ND	103	26	351
		4	NA	47	84	NA	ND	72	NA	330	NA	320	NA	NA	NA	98	NA	ND	ND	179	27	277
SB-34	07/21/93	1	62	46	12	ND	ND	494	78	3420	NA	115	NA	ND	NA	859	ND	ND	ND	247	ND	145
		3.5	NA	36	32	NA	ND	277	NA	1650	NA	100	NA	NA	NA	458	NA	ND	ND	114	ND	158
SB-35	07/27/93	0.5	NA	47	60	NA	ND	321	NA	1500	NA	210	NA	NA	NA	392	NA	ND	ND	141	30	400
		4.5	NA	72	201	NA	ND	86	NA	529	NA	910	NA	NA	NA	196	NA	ND	ND	50	33	1,620
SB-36	07/21/93	0.5	NA	60	29	NA	ND	294	NA	2100	NA	170	NA	NA	NA	581	NA	ND	ND	248	ND	210
		4.5	NA	93	538	NA	ND	49	NA	364	NA	2030	NA	NA	NA	130	NA	ND	ND	ND	59	606
SB-37	07/21/93	0.5	NA	75	10	NA	ND	443	NA	2860	NA	129	NA	NA	NA	776	NA	ND	ND	299	ND	99
		4.5	NA	74	83	NA	ND	379	NA	2240	NA	334	NA	NA	NA	580	NA	ND	ND	262	ND	234
SB-38	07/21/93	1	528	40	485	ND	ND	118	59	838	NA	5000	NA	2.8	NA	142	ND	19	ND	322	66	2200
		4	NA	22	1370	NA	ND	56	NA	259	NA	728	NA	NA	NA	66	NA	ND	ND	65	45	939
SB-39	07/21/93	1	NA	51	233	NA	ND	461	NA	1170	NA	1130	NA	NA	NA	406	NA	ND	ND	84	26	898
		4.5	NA	48	143	NA	ND	75	NA	416	NA	614	NA	NA	NA	97	NA	ND	ND	44	29	553

**TABLE 8
SUMMARY OF CHEMICAL ANALYSES - SOIL
METALS
BARBARY COAST STEEL PROPERTY
Emeryville, California**

All concentrations expressed in milligrams per kilogram, equivalent to parts per million (ppm)

Sample Number	Date Sampled	Depth (ft bgs)	Sb	As	Ba	Be	Cd	Cr	Co	Cu	Fe	Pb	Mn	Hg	Mo	Ni	Se	Ag	Ti	Sn	V	Zn
SB-40	07/21/93	0.5	21	34	175	ND	ND	135	33	767	NA	449	NA	1.2	NA	210	ND	ND	ND	126	25	390
		4.5	NA	31	555	NA	ND	40	NA	180	NA	183	NA	NA	NA	79	NA	ND	ND	22	48	142
SB-41	07/22/93	0.5	NA	10	173	NA	ND	204	NA	125	NA	189	NA	NA	NA	65	NA	ND	ND	14	70	385
		4	NA	57	381	NA	4	43	NA	2380	NA	4020	NA	NA	NA	118	NA	ND	ND	281	24	2140
SB-42	07/22/93	0.5	NA	55	188	NA	3	237	NA	1390	NA	1200	NA	NA	NA	353	NA	ND	ND	192	54	1270
		4	NA	31	129	NA	ND	143	NA	816	NA	605	NA	NA	NA	230	NA	ND	ND	91	29	599
SB-43	07/22/93	1	ND	13	254	ND	ND	63	22	327	NA	186	NA	0.6	NA	111	ND	ND	ND	23	52	260
		4	NA	42	467	NA	ND	169	NA	786	NA	632	NA	NA	NA	207	NA	ND	ND	149	30	1120
SB-44	07/22/93	1	NA	8	360	NA	ND	97	NA	98	NA	70	NA	NA	NA	83	NA	ND	ND	12	54	109
		4	NA	2	105	NA	ND	23	NA	86	NA	50	NA	NA	NA	16	NA	7	ND	ND	75	66
SB-45	07/22/93	0.5	18	27	233	ND	ND	724	21	718	NA	517	NA	0.6	NA	153	ND	ND	ND	96	120	851
		4.5	NA	4	324	NA	ND	2040	NA	239	NA	41	NA	NA	NA	57	NA	3	ND	39	283	83
SB-46	07/22/93	0.5	NA	4	97	NA	ND	336	NA	29	NA	ND	NA	NA	NA	48	NA	ND	ND	ND	42	64
		4	NA	7	165	NA	ND	410	NA	59	NA	114	NA	NA	NA	25	NA	ND	ND	ND	46	127
SB-47	08/02/93	0.5	NA	7	955	NA	7	784	NA	642	NA	434	NA	NA	NA	116	NA	6	1	27	128	2,770
		4.5	NA	11	240	NA	ND	421	NA	328	NA	167	NA	NA	NA	87	NA	ND	ND	40	82	296
SB-48	07/21/93	1	ND	4	92	ND	1	33	21	39	NA	595	NA	0.2	NA	29	ND	ND	ND	ND	25	224
		4	NA	52	88	NA	ND	49	NA	298	NA	148	NA	NA	NA	112	NA	ND	ND	ND	22	439
SB-49	07/22/93	1	NA	8	320	NA	ND	126	NA	176	NA	255	NA	NA	NA	61	NA	ND	ND	17	53	230
		4	NA	15	271	NA	1	73	NA	234	NA	334	NA	NA	NA	56	NA	ND	ND	30	57	383
SB-50	07/21/93	1	ND	5	25	ND	7	63	4	105	NA	1,310	NA	ND	NA	27	ND	ND	ND	10	17	1,300
		4	NA	10	133	NA	7	72	NA	146	NA	1,470	NA	NA	NA	45	NA	ND	ND	28	54	1,260

**TABLE 8
SUMMARY OF CHEMICAL ANALYSES - SOIL
METALS
BARBARY COAST STEEL PROPERTY
Emeryville, California**

All concentrations expressed in milligrams per kilogram, equivalent to parts per million (ppm)

Sample Number	Date Sampled	Depth (ft bgs)	Sb	As	Ba	Be	Cd	Cr	Co	Cu	Fe	Pb	Mn	Hg	Mo	Ni	Se	Ag	Tl	Sn	V	Zn
SB-51	07/21/93	0.5	NA	2	35	NA	ND	12	NA	37	NA	82	NA	NA	NA	11	NA	ND	ND	94	5	119
		4	NA	9	137	NA	ND	46	NA	54	NA	76	NA	NA	NA	62	NA	ND	ND	30	31	77
SB-52	07/21/93	0.5	19	24	583	ND	ND	162	44	563	NA	6,640	NA	0.5	NA	141	ND	ND	ND	31	14	648
		4.5	NA	33	311	NA	ND	126	NA	436	NA	4,360	NA	NA	NA	108	NA	ND	ND	10	12	529
SB-53	07/21/93	1	NA	46	510	NA	4	280	NA	1070	NA	19,900	NA	NA	NA	294	NA	ND	ND	46	ND	1,420
		4	NA	42	578	NA	ND	480	NA	980	NA	34,100	NA	NA	NA	322	NA	ND	ND	ND	4	1,220
SB-54	07/27/93	0.5	NA	75	208	NA	ND	129	NA	438	NA	1,490	NA	NA	NA	79	NA	3	93	45	72	1,210
		4.5	NA	12	92	NA	ND	62	NA	16	NA	ND	NA	NA	NA	40	NA	ND	4	ND	54	38
SB-55	07/27/93	0.5	11	21	213	ND	ND	68	35	341	NA	990	NA	1.2	NA	111	ND	ND	ND	34	26	752
SB-56	07/21/93	0.5	NA	45	102	NA	ND	125	NA	999	NA	295	NA	NA	NA	242	NA	ND	ND	108	13	636
		4	NA	5	109	NA	ND	63	NA	113	NA	81	NA	NA	NA	69	NA	3	ND	16	38	290
SB-57	07/21/93	1	NA	20	124	NA	2	93	NA	447	NA	527	NA	NA	NA	158	NA	ND	ND	87	25	614
		4	NA	36	111	NA	ND	95	NA	318	NA	378	NA	NA	NA	107	NA	ND	ND	31	51	849
SB-58	08/31/93	1	NA	15	864	NA	24	568	NA	2,090	NA	2,150	NA	NA	NA	215	NA	6	ND	128	83	5,820
		7	NA	5	60	NA	ND	58	NA	63	NA	67	NA	NA	NA	94	NA	ND	ND	28	22	94
SB-59	08/31/93	1	NA	6	920	NA	5	762	NA	637	NA	410	NA	NA	NA	108	NA	7	ND	24	138	2,390
		8	NA	11	146	NA	ND	447	NA	499	NA	98	NA	NA	NA	18	NA	ND	ND	43	43	246
SB-60	08/31/93	1	NA	10	1,210	NA	5	735	NA	983	NA	486	NA	NA	NA	150	NA	8	ND	33	127	2,210
		7	NA	17	650	NA	16	838	NA	774	NA	1130	NA	NA	NA	116	NA	4	ND	69	103	6440
SB-61	08/31/93	1	NA	10	919	NA	7	716	NA	751	NA	458	NA	NA	NA	133	NA	7	ND	36	133	2980
		8	NA	24	402	NA	7	1050	NA	354	NA	459	NA	NA	NA	59	NA	3	ND	37	166	2230
SB-62	02/22/94	0.5	17	40	8	ND	ND	52	12	860	NA	69	NA	ND	NA	190	ND	ND	ND	ND	6	73

TABLE 8
SUMMARY OF CHEMICAL ANALYSES - SOIL
METALS
BARBARY COAST STEEL PROPERTY
Emeryville, California

All concentrations expressed in milligrams per kilogram, equivalent to parts per million (ppm)

Sample Number	Date Sampled	Depth (ft bgs)	Sb	As	Ba	Be	Cd	Cr	Co	Cu	Fe	Pb	Mn	Hg	Mo	Ni	Se	Ag	Tl	Sn	V	Zn
SB-63	02/22/94	0.5	ND	46	11	ND	ND	220	45	2100	NA	31	NA	ND	NA	820	ND	ND	ND	ND	ND	100
		4	ND	3	97	ND	ND	31	7	16	NA	16	NA	ND	NA	40	ND	ND	ND	ND	29	50
CS-2	07/26/93	U	NA	8	441	NA	6	677	NA	505	NA	419	NA	NA	NA	98	NA	4	ND	26	96	1520
CS-3	07/26/93	U	12	11	1030	ND	6	1080	16	763	NA	369	NA	1	NA	123	ND	6	ND	42	160	1920
CS-4	07/26/93	U	NA	7	945	NA	14	973	NA	579	NA	553	NA	NA	NA	110	NA	6	ND	42	148	2010
CS-5	07/26/93	U	NA	2	1140	NA	ND	2660	NA	436	NA	41	NA	NA	NA	48	NA	6	ND	15	220	278
CS-6	07/26/93	U	NA	2	1400	NA	ND	1790	NA	376	NA	94	NA	NA	NA	52	NA	7	ND	16	190	797
CS-7	07/26/93	U	NA	5	780	NA	3	953	NA	3050	NA	438	NA	NA	NA	59	NA	8	ND	20	182	1170
CS-8	07/26/93	U	NA	8	710	NA	7	642	NA	798	NA	586	NA	NA	NA	87	NA	8	ND	56	135	2020
TS-1	08/09/93	U	ND	86	7	ND	5	624	62	3480	NA	ND	NA	ND	NA	1190	ND	13	ND	182	60	177
1787-1A	01/07/87	3	ND	ND	783.0	ND	5.8	115.0	ND	958.6	75240.6	366.2	9575.7	ND	ND	334.1	ND	ND	ND	ND	ND	438.4
1787-4A	01/07/87	2	ND	ND	100.3	ND	137.3	218.0	ND	609.9	45971.9	4964.2	2611.1	ND	32.7	140.0	ND	ND	ND	32.8	48.7	23052.2
1787-5A	01/07/87	1	ND	ND	445.3	ND	5.6	141.5	10.3	2415	7938.4	441.3	6611.7	ND	63.2	747.4	ND	ND	17.1	ND	ND	2502.6
1787-6B	01/07/87	2	ND	ND	77.4	ND	2.8	113.8	ND	262.7	49519.1	183.3	1045.0	ND	26.9	71.9	ND	ND	ND	6.9	24.8	300.2
BH-1A	02/01/87	1	NA	NA	NA	NA	27	NA	NA	NA	NA	150	NA	NA	NA	NA	NA	NA	NA	NA	NA	NA
BH-1B	02/01/87	3	NA	NA	NA	NA	34	NA	NA	NA	NA	1900	NA	NA	NA	NA	NA	NA	NA	NA	NA	NA
BH-1C	02/01/87	5	NA	NA	NA	NA	53	NA	NA	NA	NA	1700	NA	NA	NA	NA	NA	NA	NA	NA	NA	NA
BH-2A	02/01/87	1	NA	NA	NA	NA	300	NA	NA	NA	NA	13000	NA	NA	NA	NA	NA	NA	NA	NA	NA	NA
BH-2B	02/01/87	3	NA	NA	NA	NA	64	NA	NA	NA	NA	1500	NA	NA	NA	NA	NA	NA	NA	NA	NA	NA
BH2C	02/01/87	3	NA	NA	NA	NA	120	NA	NA	NA	NA	1800	NA	NA	NA	NA	NA	NA	NA	NA	NA	NA
FT-1	10/01/87	4	ND	ND	105.7	ND	8.2	1262.0	1.9	33.3	NA	15.5	10849.0	ND	ND	4.0	ND	ND	ND	ND	76.8	39.3
FT-2	10/01/87	2	ND	ND	129.7	ND	15.8	2557.0	1.8	53.6	NA	38.7	22763.0	ND	ND	4.7	ND	ND	ND	ND	58.0	79.9

TABLE 8
SUMMARY OF CHEMICAL ANALYSES - SOIL
METALS
BARBARY COAST STEEL PROPERTY
Emeryville, California

All concentrations expressed in milligrams per kilogram, equivalent to parts per million (ppm)

Sample Number	Date Sampled	Depth (ft bgs)	Sb	As	Ba	Be	Cd	Cr	Co	Cu	Fe	Pb	Mn	Hg	Mo	Ni	Se	Ag	Tl	Sn	V	Zn
FT-3	10/01/87	2	ND	ND	230.1	ND	24.7	319.0	5.8	1861.6	NA	990.0	94995.8	ND	4.4	144.8	ND	2.5	ND	51.8	84.0	3727.1
		4	ND	15.4	201.7	ND	30.6	304.6	10.5	1160.4	NA	388.9	8151.3	ND	7.3	123.2	ND	ND	ND	65.6	53.4	1987.7
FT-4	10/01/87	2	ND	ND	211.0	ND	45.7	329.0	5.0	119.3	NA	1055.7	6416.7	ND	ND	40.3	ND	2.0	ND	ND	46.7	5765.7
FT-5	10/01/87	2	ND	19.1	130.2	ND	91.7	180.7	9.4	173.9	NA	2733.8	4136.0	ND	ND	50.7	ND	ND	ND	43.8	43.9	6083.4
		4	ND	ND	148.4	ND	26.7	217.0	5.5	158.0	NA	303.5	7288.9	ND	ND	28.2	ND	4.1	ND	27.0	50.7	1320.2
		6	ND	ND	113.1	ND	60.5	104.8	7.8	106.6	NA	790.0	2684.0	ND	ND	32.3	ND	ND	ND	21.8	34.0	3129.9
FT-6	10/01/87	2	ND	ND	85.5	ND	26.5	125.2	3.7	216.3	NA	2263.0	2756.5	ND	ND	32.9	ND	ND	ND	19.6	25.1	3708.8
FT-7	10/01/87	2	ND	36.1	1503.9	ND	271.8	190.1	12.5	425.8	NA	3539.2	5212.5	ND	14.6	143.7	ND	2.3	ND	38.0	49.8	41010.5
FT-8	10/01/87	2	ND	19.8	85.6	ND	16.7	189.8	9.1	1087.2	NA	942.2	2385.0	ND	ND	110.2	ND	ND	ND	53.3	37.6	2596.2
		4	ND	ND	189.8	ND	19.7	812.4	9.3	282.2	NA	226.1	5570.0	ND	ND	140.5	ND	ND	ND	46.6	54.4	1048.5
		6	ND	ND	155.6	ND	7	69.9	12.4	84.6	NA	41.1	732.0	ND	ND	104.3	ND	ND	ND	ND	35.1	218.5
FT-9	10/01/87	2	ND	32.2	151.1	ND	25.2	430.3	13.1	1381.6	NA	136.3	6108.0	ND	ND	298.7	ND	ND	ND	53.7	45.7	307.8
FT-10	10/01/87	2	ND	35.1	43	ND	26.2	210	12.9	1476	NA	781.5	1797.9	ND	ND	203.5	ND	ND	ND	72.8	46.7	418.1
FT-11	10/01/87	2	ND	50.3	491.8	ND	47.10	136.4	17.1	1114	NA	1841.2	1799.5	ND	ND	212.9	ND	ND	ND	83.1	63.6	8580.0
FT-12	10/01/87	2	ND	ND	132	ND	13.00	408.7	3.9	59.2	NA	208.3	2631.3	ND	ND	25.9	ND	ND	ND	12.3	35.7	2012.1
FT-13	10/01/87	2	ND	ND	41.3	ND	37.40	66.8	16.4	196.5	NA	87.8	1099.2	ND	ND	41.9	ND	ND	ND	52.9	70.6	131.4
FT-14	10/01/87	2	ND	ND	148.6	ND	7.73	355.9	4.6	157.3	NA	70.6	3788.3	ND	ND	22.7	ND	ND	ND	7.5	82.0	197.6
FT-15	10/01/87	1.5	ND	ND	40.6	ND	6.63	428.6	2.4	201.3	NA	134.6	1221.8	ND	ND	25.3	ND	ND	ND	7.7	13.5	1184.7
FT-16	10/01/87	2	ND	27.5	140.9	ND	25.40	342.5	13.4	721.3	NA	1129.1	2209.4	ND	ND	140.8	ND	2.7	ND	61.2	46.6	2650.4
FT-17	10/01/87	2	ND	ND	230.9	ND	19.00	787.7	7.9	204.1	NA	216.3	8398.3	ND	ND	47.0	ND	ND	ND	37.8	37.4	1883.8
FT-18	10/01/87	2	ND	55.5	76.8	ND	38.3	42.7	31.3	470.2	NA	359.7	886.7	ND	ND	80.9	ND	ND	ND	34.4	72.6	273.5
		6	ND	28.3	69	ND	35.2	33.4	22.3	267.7	NA	177.4	741.7	ND	ND	54.7	ND	ND	ND	16.9	67.3	183.8

TABLE 8
SUMMARY OF CHEMICAL ANALYSES - SOIL
METALS
BARBARY COAST STEEL PROPERTY
Emeryville, California

All concentrations expressed in milligrams per kilogram, equivalent to parts per million (ppm)

Sample Number	Date Sampled	Depth (ft bgs)	Sb	As	Ba	Be	Cd	Cr	Co	Cu	Fe	Pb	Mn	Hg	Mo	Ni	Sa	Ag	Tl	Sn	V	Zn
FT-19	10/01/87	2	ND	29.6	169.4	ND	25	35.7	17.2	290.6	NA	836.8	692.3	ND	ND	63.9	ND	ND	ND	26.3	46.6	770.4
FT-20	10/01/87	2	ND	39	242.6	ND	36.8	39.7	23.9	805.4	NA	2345	643.6	ND	ND	62.9	ND	ND	ND	40.3	65.6	2021.2
FT-21	10/01/87	2	ND	32.5	87.8	ND	37.9	75.5	23	334.7	NA	704.5	996	ND	ND	65.6	ND	ND	ND	28.8	66.7	833.1
FT-22	10/01/87	2	ND	17.8	135	ND	19.3	350.2	13.8	458.5	NA	264	2137.6	ND	ND	119.4	ND	ND	ND	36.3	41.8	400.8
		6	ND	30.4	191.9	ND	27.2	53.5	18.4	335.8	NA	1319	811.4	ND	ND	49.3	ND	ND	ND	27.8	49.3	2545.8
FT-23	10/01/87	2	ND	15.8	147	ND	20.8	258.4	12.8	589.8	NA	743.7	2181.8	ND	ND	77.3	ND	ND	ND	29.7	47.4	1325.5
		4	ND	24.8	168.5	ND	32.2	684.3	14.9	260.3	NA	904.3	4092.7	ND	ND	60.5	ND	ND	ND	27.2	50.7	2533
		6	ND	23.9	124.1	ND	31.1	289.8	16.5	1256.6	NA	1045	2225.6	ND	ND	48.6	ND	ND	ND	27.7	52.5	1410.2
FT-24	10/01/87	2	ND	35.5	205.7	ND	26.8	187.0	15.8	1864.4	NA	1949	1920.2	ND	ND	155.3	ND	ND	ND	80.1	39.7	3065.2
HW-1	04/10/92	3.0 - 3.5	NA	NA	NA	NA	5.9	68	NA	NA	NA	9.1	NA	NA	NA	98	NA	NA	NA	NA	NA	32
		5.5 - 6.0	NA	NA	NA	NA	11	21	NA	NA	NA	210	NA	NA	NA	20	NA	NA	NA	NA	NA	360
		5.5 - 6.0 (1)	NA	ND	NA	NA	0.53	0.8	NA	NA	NA	91	NA	NA	NA	0.6	NA	NA	NA	NA	NA	89
HW-2	04/09/92	4.5 - 5.0	NA	NA	NA	NA	2.0	140	NA	NA	NA	21	NA	NA	NA	3.4	NA	NA	NA	NA	NA	55
		6.0 - 6.5	NA	ND	NA	NA	2.0	160	NA	NA	NA	10	NA	NA	NA	3.8	NA	NA	NA	NA	NA	20
		6.0-6.5 (1)	NA	ND	NA	NA	0.24	14	NA	NA	NA	0.18	NA	NA	NA	0.38	NA	NA	NA	NA	NA	2.9
		11.0 - 11.5	NA	NA	NA	NA	1.2	17	NA	NA	NA	5.5	NA	NA	NA	17	NA	NA	NA	NA	NA	18
HW-3	04/09/92	2.5 - 3.0	NA	6.2	NA	NA	5.9	57	NA	NA	NA	300	NA	NA	NA	58	NA	NA	NA	NA	NA	600
		2.5 - 3.0 (1)	NA	0.5	NA	NA	1.5	3.9	NA	NA	NA	81	NA	NA	NA	6.6	NA	NA	NA	NA	NA	160
HW-4	04/09/92	4.5 - 5.0	NA	NA	NA	NA	9.3	160	NA	NA	NA	4.3	NA	NA	NA	21	NA	NA	NA	NA	NA	59
		6.0 - 6.5	NA	NA	NA	NA	5.4	61	NA	NA	NA	43	NA	NA	NA	57	NA	NA	NA	NA	NA	290
		11.0 - 11.5	NA	1.2	NA	NA	3.9	180	NA	NA	NA	240	NA	NA	NA	11	NA	NA	NA	NA	NA	634
		1.0 - 11.5 (1)	NA	ND	NA	NA	0.03	1.4	NA	NA	NA	0.4	NA	NA	NA	0.27	NA	NA	NA	NA	NA	5.1

TABLE 8
SUMMARY OF CHEMICAL ANALYSES - SOIL
METALS
BARBARY COAST STEEL PROPERTY
Emeryville, California

All concentrations expressed in milligrams per kilogram, equivalent to parts per million (ppm)

Sample Number	Date Sampled	Depth (ft bgs)	Sb	As	Ba	Be	Cd	Cr	Co	Cu	Fe	Pb	Mn	Hg	Mo	Ni	Se	Ag	Tl	Sn	V	Zn	
HW-5	04/09/92	2.5 - 3.0	NA	ND	NA	NA	3.2	229	NA	NA	NA	77	NA	NA	NA	5.7	NA	NA	NA	NA	NA	58	
		2.5 - 3.0 (1)	NA	ND	NA	NA	ND	1.2	NA	NA	NA	0.89	NA	NA	NA	0.13	NA	NA	NA	NA	NA	NA	ND
		8.0 - 8.5	NA	NA	NA	NA	2.5	73	NA	NA	NA	ND	NA	NA	NA	47	NA	NA	NA	NA	NA	NA	5
		11.0 - 11.5	NA	NA	NA	NA	5.9	96	NA	NA	NA	80	NA	NA	NA	24	NA	NA	NA	NA	NA	NA	95
HW-6B	04/10/92	4.5 - 5.0	NA	ND	NA	NA	13	5.4	NA	NA	NA	35	NA	NA	NA	11	NA	NA	NA	NA	NA	62	
		8.0 - 8.5	NA	NA	NA	NA	7.4	7.0	NA	NA	NA	40	NA	NA	NA	9.6	NA	NA	NA	NA	NA	64	
		11.0 - 11.5	NA	NA	NA	NA	1.8	19	NA	NA	NA	4.5	NA	NA	NA	13	NA	NA	NA	NA	NA	22	
		16.0 - 16.5	NA	NA	NA	NA	1.5	12	NA	NA	NA	2.7	NA	NA	NA	12	NA	NA	NA	NA	NA	13	
		19.5 - 20.0	NA	NA	NA	NA	1.5	14	NA	NA	NA	3.5	NA	NA	NA	17	NA	NA	NA	NA	NA	19	
HW-7	04/10/92	4.5 - 5.0	NA	ND	NA	NA	9.8	3.4	NA	NA	NA	120	NA	NA	NA	6.6	NA	NA	NA	NA	NA	230	
		9.5 - 10.0	NA	NA	NA	NA	8.2	4	NA	NA	NA	51	NA	NA	NA	13	NA	NA	NA	NA	NA	120	
		13.0 - 13.5	NA	NA	NA	NA	1.7	14	NA	NA	NA	4.0	NA	NA	NA	20	NA	NA	NA	NA	NA	19	
		16.0 - 16.5	NA	NA	NA	NA	1.5	14	NA	NA	NA	3.9	NA	NA	NA	16	NA	NA	NA	NA	NA	18	
		21.0 - 21.5	NA	NA	NA	NA	1.8	15	NA	NA	NA	3.3	NA	NA	NA	22	NA	NA	NA	NA	NA	22	
HW-8	04/10/92	2.5 - 3.0	NA	ND	NA	NA	1.9	37	NA	NA	NA	69	NA	NA	NA	8.2	NA	NA	NA	NA	NA	160	
		4.5 - 5.0	NA	NA	NA	NA	6.8	14	NA	NA	NA	51	NA	NA	NA	14	NA	NA	NA	NA	NA	73	
		7.0 - 7.5	NA	NA	NA	NA	7.4	6	NA	NA	NA	22	NA	NA	NA	14	NA	NA	NA	NA	NA	26	
		10.0 - 10.5	NA	NA	NA	NA	1.5	27	NA	NA	NA	4.3	NA	NA	NA	19	NA	NA	NA	NA	NA	25	
		16.0 - 16.5	NA	NA	NA	NA	1.1	17	NA	NA	NA	4.0	NA	NA	NA	37	NA	NA	NA	NA	NA	18	
		21.5 - 22.0	NA	NA	NA	NA	1.0	13	NA	NA	NA	3.2	NA	NA	NA	26	NA	NA	NA	NA	NA	15	
HW-9A	04/10/92	3.0 - 3.5	NA	NA	NA	NA	5.6	13	NA	NA	NA	49	NA	NA	NA	51	NA	NA	NA	NA	NA	59	
		6.0 - 6.5	NA	ND	NA	NA	8.5	5.6	NA	NA	NA	64	NA	NA	NA	13	NA	NA	NA	NA	NA	130	

**TABLE 8
SUMMARY OF CHEMICAL ANALYSES - SOIL
METALS
BARBARY COAST STEEL PROPERTY
Emeryville, California**

All concentrations expressed in milligrams per kilogram, equivalent to parts per million (ppm)

Sample Number	Date Sampled	Depth (ft bgs)	Sb	As	Ba	Be	Cd	Cr	Co	Cu	Fe	Pb	Mn	Hg	Mo	Ni	Se	Ag	Tl	Sn	V	Zn	
HW-9A	04/10/92	10.0 - 10.5	NA	NA	NA	NA	1.6	21	NA	NA	NA	3.5	NA	NA	NA	20	NA	NA	NA	NA	NA	23	
		15.0 - 15.5	NA	NA	NA	NA	1.5	21	NA	NA	NA	NA	3.7	NA	NA	NA	15	NA	NA	NA	NA	NA	16
		21.0 - 21.5	NA	NA	NA	NA	1.3	20	NA	NA	NA	NA	4.4	NA	NA	NA	23	NA	NA	NA	NA	NA	21
HW-10	04/10/92	4.5 - 5.0	NA	ND	NA	NA	7.3	6.1	NA	NA	NA	73	NA	NA	NA	21	NA	NA	NA	NA	NA	1100	
		7.5 - 8.0	NA	NA	NA	NA	1.59	19	NA	NA	NA	12.9	NA	NA	NA	20	NA	NA	NA	NA	NA	32	
HW-10	04/10/92	11.0 - 11.5	NA	NA	NA	NA	0.9	12	NA	NA	NA	3.4	NA	NA	NA	13	NA	NA	NA	NA	NA	15	
		16.0 - 16.5	NA	NA	NA	NA	1.4	15	NA	NA	NA	4.2	NA	NA	NA	21	NA	NA	NA	NA	NA	21	
		21.0 - 21.5	NA	NA	NA	NA	1.2	15	NA	NA	NA	2.8	NA	NA	NA	20	NA	NA	NA	NA	NA	19	
HW-11	04/09/92	2.5 - 3.0 (2)	NA	86	NA	NA	105	330	NA	NA	NA	16,000	NA	NA	NA	86	NA	NA	NA	NA	NA	9.8	
		6.0 - 6.5	NA	NA	NA	NA	14	35	NA	NA	NA	11	NA	NA	NA	52	NA	NA	NA	NA	NA	190	
		11.0 - 11.5	NA	NA	NA	NA	2.4	161	NA	NA	NA	8.9	NA	NA	NA	4.1	NA	NA	NA	NA	NA	16	
HW-12	04/09/92	3.0 - 3.5 (2)	NA	22	NA	NA	5.7	28	NA	NA	NA	330	NA	NA	NA	15	NA	NA	NA	NA	NA	490	
		5.5 - 6.0	NA	NA	NA	NA	1.8	32	NA	NA	NA	16	NA	NA	NA	8.4	NA	NA	NA	NA	NA	43	
		9.5 - 10.0	NA	NA	NA	NA	0.62	9.2	NA	NA	NA	3.1	NA	NA	NA	9.5	NA	NA	NA	NA	NA	11	
HW-13	04/09/92	5.5 - 6.0 (2)	NA	ND	NA	NA	12	170	NA	NA	NA	12	NA	NA	NA	15	NA	NA	NA	NA	NA	16	
		11.0 - 11.5	NA	NA	NA	NA	1.5	17	NA	NA	NA	2.9	NA	NA	NA	18	NA	NA	NA	NA	NA	23	
B-8	Apr 93	5.5	NA	NA	NA	NA	NA	2800	NA	530	NA	540	NA	NA	NA	NA	NA	NA	NA	NA	NA	1800	
	Apr 93	10.5	NA	NA	NA	NA	NA	1700	NA	1200	NA	2200	NA	NA	NA	NA	NA	NA	NA	NA	NA	6900	
	Apr 93	11.0	NA	NA	NA	NA	NA	110	NA	70	NA	18	NA	NA	NA	NA	NA	NA	NA	NA	NA	220	
	Apr 93	15.5	NA	NA	NA	NA	NA	430	NA	100	NA	39	NA	NA	NA	NA	NA	NA	NA	NA	NA	180	
	Apr 93	23.5	NA	NA	NA	NA	NA	66	NA	26	NA	7	NA	NA	NA	NA	NA	NA	NA	NA	NA	66	
	Apr 93	23.5	NA	NA	NA	NA	NA	98	NA	1200	NA	24	NA	NA	NA	NA	NA	NA	NA	NA	NA	80	

TABLE 8
SUMMARY OF CHEMICAL ANALYSES - SOIL
METALS
BARBARY COAST STEEL PROPERTY
Emeryville, California

All concentrations expressed in milligrams per kilogram, equivalent to parts per million (ppm)

Sample Number	Date Sampled	Depth (ft bgs)	Sb	As	Ba	Be	Cd	Cr	Co	Cu	Fe	Pb	Mn	Hg	Mo	Ni	Se	Ag	Tl	Sn	V	Zn
B-9	Apr 93	6.0	NA	NA	NA	NA	NA	38	NA	3300	NA	4900	NA	NA	NA	NA	NA	NA	NA	NA	NA	1100
	Apr 93	11.0	NA	NA	NA	NA	NA	43	NA	14	NA	6	NA	NA	NA	NA	NA	NA	NA	NA	NA	24
	Apr 93	15.5	NA	NA	NA	NA	NA	50	NA	15	NA	6	NA	NA	NA	NA	NA	NA	NA	NA	NA	54
	Apr 93	23.0	NA	NA	NA	NA	NA	56	NA	18	NA	5	NA	NA	NA	NA	NA	NA	NA	NA	NA	53
	Apr 93	28.0	NA	NA	NA	NA	NA	60	NA	23	NA	9	NA	NA	NA	NA	NA	NA	NA	NA	NA	55
B-11	Apr 93	10.5	NA	NA	NA	NA	NA	56	NA	17	NA	7	NA	NA	NA	NA	NA	NA	NA	NA	NA	61
	Apr 93	18.0	NA	NA	NA	NA	NA	37	NA	19	NA	6	NA	NA	NA	NA	NA	NA	NA	NA	NA	39
	Apr 93	23.0	NA	NA	NA	NA	NA	49	NA	19	NA	6	NA	NA	NA	NA	NA	NA	NA	NA	NA	51
	Apr 93	28.0	NA	NA	NA	NA	NA	47	NA	19	NA	5	NA	NA	NA	NA	NA	NA	NA	NA	NA	44
B-13	Apr 93	5.5	NA	NA	NA	NA	NA	48	NA	28	NA	32	NA	NA	NA	NA	NA	NA	NA	NA	NA	76
	Apr 93	10.5	NA	NA	NA	NA	NA	59	NA	28	NA	7	NA	NA	NA	NA	NA	NA	NA	NA	NA	62
	Apr 93	15.5	NA	NA	NA	NA	NA	46	NA	13	NA	4	NA	NA	NA	NA	NA	NA	NA	NA	NA	35
	Apr 93	20.5	NA	NA	NA	NA	NA	42	NA	18	NA	5	NA	NA	NA	NA	NA	NA	NA	NA	NA	48
	Apr 93	25.5	NA	NA	NA	NA	NA	38	NA	20	NA	5	NA	NA	NA	NA	NA	NA	NA	NA	NA	50
B-14	Apr 93	8.0	NA	NA	NA	NA	NA	49	NA	15	NA	3	NA	NA	NA	NA	NA	NA	NA	NA	NA	40
	Apr 93	15.0	NA	NA	NA	NA	NA	42	NA	14	NA	3	NA	NA	NA	NA	NA	NA	NA	NA	NA	33
	Apr 93	18.5	NA	NA	NA	NA	NA	46	NA	18	NA	7	NA	NA	NA	NA	NA	NA	NA	NA	NA	44
	Apr 93	23.0	NA	NA	NA	NA	NA	41	NA	24	NA	4	NA	NA	NA	NA	NA	NA	NA	NA	NA	46
	Apr 93	28.0	NA	NA	NA	NA	NA	55	NA	35	NA	3	NA	NA	NA	NA	NA	NA	NA	NA	NA	67
B-17	Apr 93	6.0	NA	NA	NA	NA	NA	3300	NA	150	NA	30	NA	NA	NA	NA	NA	NA	NA	NA	NA	40
	Apr 93	6.0	NA	NA	NA	NA	NA	1700	NA	740	NA	460	NA	NA	NA	NA	NA	NA	NA	NA	NA	1200
	Apr 93	10.5	NA	NA	NA	NA	NA	41	NA	23	NA	8	NA	NA	NA	NA	NA	NA	NA	NA	NA	40
	Apr 93	17.0	NA	NA	NA	NA	NA	55	NA	14	NA	6	NA	NA	NA	NA	NA	NA	NA	NA	NA	35

TABLE 9
SUMMARY OF CHEMICAL ANALYSES - SOIL
pH
BARBARY COAST STEEL PROPERTY
Emeryville, California

Sample Number	Sample Depth (ft, bgs)	pH (std. pH units)
W1	5	8.85
W2	1.5	10.75
W3	14	8.90
W4	9	11.20
W5	9	10.85
W6	9	10.75
W7	8	10.95
W8	9	8.15
W9	4	10.50
W10	8	10.70
W11	7	11.15
1787-1	3	9.65
1787-2	1.5	8.70
1787-3	2.5	10.10
1787-4	2	11.65
1787-5	1	11.65
1787-6	2	10.10
1787-7	6	8.15
1787-8	1	9.30
1787-9	2	10.55
1787-10	6	7.10
CS-1	NR	10.47

Notes:

ft, bgs - Feet below ground surface.

std. pH units - Standard pH units of measure.

NR - Not recorded.

TABLE 10
SUMMARY OF CHEMICAL ANALYSES - GROUNDWATER
PETROLEUM HYDROCARBONS, VOLATILE AND SEMI-VOLATILE ORGANIC COMPOUNDS, AND POLYCHLORINATED BIPHENYLS
BARBARY COAST STEEL PROPERTY
Emeryville, California

All concentrations expressed in milligrams per liter, equivalent to parts per million (ppm)

Sample Number	Date Sampled	TPH-G	TPH-D	TPH-OG	Total Hydrocarbons	Benzene	Toluene	Ethyl-Benzene	Total Xylenes	VOCs	SVOCs	PCBs
MW-1	Mar 89	ND	NA	NA	NA	NA	NA	NA	NA	NA	NA	NA
MW-2	Jun 92	1.8	13	NA	NA	NA	NA	NA	NA	NA	NA	NA
MW-2B	Aug 93	ND	ND	NA	ND	ND	ND	ND	ND	ND	NA	NA
	Feb 94	ND	ND	ND	NA	NA	NA	NA	NA	NA	NA	NA
MW-3	Jun 92	140	5	NA	NA	NA	NA	NA	NA	ND	NA	NA
	Jul 93	ND	2.2	NA	NA	ND	ND	ND	ND	NA	NA	NA
	Feb 94	NA	NA	NA	NA	NA	NA	NA	NA	0.001	NA	NA
MW-3B	Aug 93	ND	ND	ND	ND	ND	ND	ND	ND	NA	NA	NA
	Feb 94	NA	NA	NA	NA	NA	NA	NA	NA	NA	NA	NA
MW-4	Jun 92	0.17	27	NA	NA	NA	NA	NA	NA	NA	NA	NA
	Aug 93	0.45	24	NA	NA	ND	ND	ND	ND	ND	NA	NA
	Feb 94	NA	NA	NA	NA	NA	NA	NA	NA	NA	NA	NA
MW-4B	Aug 93	ND	ND	ND	ND	ND	ND	ND	ND	ND	NA	NA
	Feb 94	NA	NA	NA	NA	NA	NA	NA	NA	NA	NA	NA
MW-5	Aug 93	ND	ND	1	NA	ND	ND	ND	ND	NA	NA	0.073
	Feb 94	NA	NA	NA	NA	NA	NA	NA	NA	NA	ND	NA
MW-6	Aug 93	ND	ND	ND	ND	ND	ND	ND	ND	ND	NA	ND
	Feb 94	NA	NA	NA	NA	NA	NA	NA	NA	NA	ND	NA
MW-7	Aug 93	ND	ND	ND	ND	ND	ND	ND	ND	NA	NA	NA
	Feb 94	NA	NA	NA	NA	NA	NA	NA	NA	NA	ND	NA
MW-8	Aug 93	ND	ND	ND	ND	ND	ND	ND	ND	NA	NA	NA
	Feb 94	NA	NA	NA	NA	NA	NA	NA	NA	NA	ND	NA

TABLE 10
SUMMARY OF CHEMICAL ANALYSES - GROUNDWATER
PETROLEUM HYDROCARBONS, VOLATILE AND SEMI-VOLATILE ORGANIC COMPOUNDS, AND POLYCHLORINATED BIPHENYLS
BARBARY COAST STEEL PROPERTY
Emeryville, California

All concentrations expressed in milligrams per liter, equivalent to parts per million (ppm)

Sample Number	Date Sampled	TPH-G	TPH-D	TPH-OG	Total Hydrocarbons	Benzene	Toluene	Ethyl-Benzene	Total Xylenes	VOCs	SVOCs	PCBs
MW-9	Aug 93	ND	ND	ND	ND	ND	ND	ND	ND	NA	NA	NA
	Feb 94	NA	NA	NA	NA	NA	NA	NA	NA	NA	NA	NA
MW-10	Aug 93	ND	ND	ND	NA	ND	ND	ND	ND	ND	NA	NA
	Feb 94	NA	NA	NA	NA	NA	NA	NA	NA	NA	NA	NA
MW-11	Aug 93	ND	ND	ND	ND	ND	ND	ND	ND	NA	NA	NA
	Feb 94	NA	NA	NA	NA	NA	NA	NA	NA	NA	NA	NA
MW-12	Aug 93	NA	0.95	NA	NA	ND	ND	ND	ND	NA	NA	NA
	Feb 94	NA	NA	NA	NA	NA	NA	NA	NA	NA	NA	NA
MW-13	Aug 93	0.061	1.8	NA	NA	ND	ND	ND	NA	NA	NA	NA
	Feb 94	NA	NA	NA	NA	NA	NA	NA	NA	NA	NA	NA
MW-14	Aug 93	NA	0.046	NA	NA	ND	ND	ND	0.0008	NA	NA	NA
	Feb 94	NA	NA	NA	NA	NA	NA	NA	NA	NA	NA	NA
MW-15	Feb 94	0.69	5.1	NA	NA	0.0099	0.056	0.012	0.1	NA	NA	NA
MW-16	Feb 94	ND	ND	ND	ND	ND	ND	ND	ND	NA	0.031	NA
Water Supply Well	Dec 93	ND	ND	ND	ND	0.0024	ND	ND	ND	0.003	NA	ND
	Jan 94	NA	NA	NA	NA	NA	NA	NA	NA	ND	NA	ND
W-6.5-T6	Feb 88	NA	NA	NA	64	NA	NA	NA	NA	NA	NA	NA
W-6-T3	Feb 88	NA	NA	NA	1.78	NA	NA	NA	NA	NA	NA	NA
W-7-T3	Feb 88	NA	NA	NA	0.4	NA	NA	NA	NA	NA	NA	NA
W-8-T4	Feb 89	NA	NA	NA	7.2	NA	NA	NA	NA	NA	NA	NA
GS-1	Jun 91	ND	ND	240	NA	NA	NA	NA	NA	NA	NA	NA
GS-2	Jun 91	ND	ND	ND	NA	NA	NA	NA	NA	NA	NA	NA
GS-3	Jun 91	ND	300	ND	NA	NA	NA	NA	NA	NA	NA	NA

TABLE 10
SUMMARY OF CHEMICAL ANALYSES - GROUNDWATER
PETROLEUM HYDROCARBONS, VOLATILE AND SEMI-VOLATILE ORGANIC COMPOUNDS, AND POLYCHLORINATED BIPHENYLS
BARBARY COAST STEEL PROPERTY
Emeryville, California

All concentrations expressed in milligrams per liter, equivalent to parts per million (ppm)

Sample Number	Date Sampled	TPH-G	TPH-D	TPH-OG	Total Hydrocarbons	Benzene	Toluene	Ethyl-Benzene	Total Xylenes	VOCs	SVOCs	PCBs
HW-6B	Apr 92	ND	ND	ND	NA	NA	NA	NA	NA	NA	NA	NA
HW-7	Apr 92	0.055	0.0015	26	NA	NA	NA	NA	NA	NA	NA	NA
HW-8	Apr 92	ND	ND	1.7	NA	NA	NA	NA	NA	NA	NA	NA
HW-9A	Apr 92	ND	ND	1.8	NA	NA	NA	NA	NA	NA	NA	NA
HW-10	Apr 92	ND	ND	3.5	NA	NA	NA	NA	NA	NA	NA	NA
HW-11	Apr 92	0.16	63	58	NA	NA	NA	NA	NA	NA	NA	NA
HW-12	Apr 92	NA	0.17	20	NA	NA	NA	NA	NA	NA	NA	NA
HW-13	Apr 92	ND	ND	1.7	NA	NA	NA	NA	NA	NA	NA	NA
PW-1	Aug 93	0.057	ND	11	NA	NA	NA	NA	NA	NA	NA	NA
PW-2	Aug 93	ND	ND	0.51	NA	NA	NA	NA	NA	NA	NA	NA
PW-3	Aug 93	ND	ND	0.21	NA	NA	NA	NA	NA	NA	NA	NA
TW-1	Aug 93	ND	ND	0.74	NA	NA	NA	NA	NA	NA	NA	NA

Notes:

TPH-G - Total petroleum hydrocarbons quantified as gasoline.

TPH-D - Total petroleum hydrocarbons quantified as diesel.

TPH-OG - Total petroleum hydrocarbons quantified as hydraulic oil or total oil and grease.

VOCs - Volatile organic compounds.

SVOCs - Semivolatile organic compounds.

PCBs - Polychlorinated biphenyls.

NA - Not Analyzed.

ND - Not detected.

TPH-G, TPH-D, and TPH-OG detected using EPA Test Method 8015M.

Total Hydrocarbons detected using EPA Test Methods 8240/8260.

Benzene, toluene, ethylbenzene, and total xylenes detected using EPA Test Method 8020.

VOCs detected using one or a combination of EPA Test Methods 8010, 8020, 8240, and/or 8260.

SVOCs detected using EPA 8270, Poly Chlorinated Biphenyls by EPA 8080.

Polychlorinated biphenyls detected using EPA Test Method 8080.

TABLE 11
SUMMARY OF CHEMICAL ANALYSES - GROUNDWATER
METALS
BARBARY COAST STEEL PROPERTY
Emeryville, California

All concentrations expressed in milligrams per liter, equivalent to parts per million (ppm)

Sample Number	Date Sampled	Sb	As	Ba	Be	Cd	Cr	Co	Cu	Pb	Hg	Mo	Ni	Se	Ag	Tl	Sn	V	Zn
MW-2B	Aug 93	ND	0.013	0.706	ND	ND	0.115	0.026	0.123	0.053	0.1520	NA	0.145	ND	ND	ND	ND	0.162	0.230
	Feb 94	ND	ND	0.080	ND	ND	ND	ND	ND	ND	0.0006	NA	ND	ND	ND	ND	ND	ND	0.020
MW-3	Jul 93	0.068	0.060	0.487	ND	0.016	0.255	0.053	1.520	2.460	0.0015	0.071	0.292	ND	ND	ND	ND	0.203	4.320
	Feb 94	ND	0.006	0.070	ND	ND	ND	ND	ND	ND	0.0008	NA	ND	ND	ND	ND	ND	ND	ND
MW-3B	Aug 93	ND	0.041	2.530	ND	0.358	ND	0.085	0.336	0.093	0.0010	NA	0.388	ND	0.028	ND	ND	0.325	0.487
	Feb 94	ND	ND	0.060	ND	ND	ND	ND	ND	ND	0.0006	NA	ND	ND	ND	ND	ND	0.010	ND
MW-4	Aug 93	ND	0.082	4.630	0.020	0.007	0.914	0.241	0.742	0.772	0.0047	NA	1.140	ND	ND	ND	ND	0.101	1.970
	Feb 94	NA	NA	NA	NA	NA	NA	NA	NA	NA	NA	NA	NA	NA	NA	NA	NA	NA	NA
MW-4B	Aug 93	ND	0.045	0.968	0.006	ND	0.410	0.112	0.253	0.078	ND	NA	0.544	ND	ND	ND	ND	0.414	0.586
	Feb 94	ND	0.007	0.040	ND	ND	ND	ND	ND	ND	0.0007	NA	ND	ND	ND	ND	ND	ND	0.020
MW-5	Aug 93	0.168	0.267	5.370	ND	ND	1.160	0.138	21.800	18.100	0.0503	NA	1.700	ND	0.039	ND	1.050	0.500	41.100
	Feb 94	ND	0.008	0.120	ND	ND	ND	ND	0.020	0.005	0.0006	NA	ND	ND	ND	ND	ND	ND	0.020
MW-6	Aug 93	ND	0.036	0.818	ND	ND	0.120	0.038	0.172	0.166	ND	NA	0.196	ND	ND	ND	ND	0.133	0.888
	Feb 94	ND	0.007	0.170	ND	ND	ND	ND	ND	ND	0.0007	NA	ND	ND	ND	ND	ND	ND	0.050
MW-7	Aug 93	ND	0.007	0.203	ND	ND	ND	ND	0.030	0.017	ND	NA	ND	ND	ND	ND	ND	ND	0.035
	Feb 94	ND	0.040	0.220	ND	ND	ND	ND	ND	ND	0.0012	NA	ND	ND	ND	ND	ND	ND	0.020
MW-8	Aug 93	ND	0.019	1.220	ND	ND	0.285	0.085	0.220	0.019	ND	NA	0.161	0.020	ND	ND	ND	0.312	0.587
	Feb 94	ND	0.011	0.150	ND	ND	ND	ND	ND	ND	ND	NA	ND	ND	ND	ND	ND	ND	ND
MW-9	Aug 93	ND	0.031	0.936	ND	0.013	0.320	0.082	1.500	1.168	0.0048	NA	0.402	ND	ND	ND	ND	0.220	3.870
	Feb 94	ND	0.005	0.150	ND	ND	ND	ND	ND	ND	ND	NA	ND	ND	ND	ND	ND	ND	0.070
MW-10	Aug 93	ND	0.027	0.870	ND	ND	0.171	0.056	0.492	0.218	0.0008	NA	0.279	ND	ND	ND	ND	0.182	0.493
	Feb 94	ND	0.010	0.130	ND	ND	ND	ND	ND	ND	ND	NA	ND	ND	ND	ND	ND	ND	0.020

TABLE 11
SUMMARY OF CHEMICAL ANALYSES - GROUNDWATER
METALS
BARBARY COAST STEEL PROPERTY
Emeryville, California

All concentrations expressed in milligrams per liter, equivalent to parts per million (ppm)

Sample Number	Date Sampled	Sb	As	Ba	Be	Cd	Cr	Co	Cu	Pb	Hg	Mo	Ni	Se	Ag	Tl	Sn	V	Zn
MW-11	Aug 93	ND	0.019	0.151	ND	ND	0.010	ND	0.024	0.016	ND	NA	ND	ND	ND	ND	ND	0.021	0.089
	Feb 94	ND	ND	0.090	ND	ND	ND	ND	ND	ND	ND	NA	ND	ND	ND	ND	ND	ND	0.030
MW-12	Aug 93	ND	0.114	2.640	ND	0.007	0.605	0.149	0.712	1.670	0.0079	NA	0.608	ND	ND	ND	0.337	0.513	7.760
	Feb 94	ND	ND	0.300	ND	ND	ND	ND	ND	ND	ND	NA	ND	ND	ND	ND	ND	ND	ND
MW-13	Aug 93	ND	0.116	2.440	ND	0.009	0.631	0.119	2.600	2.130	0.0012	NA	0.648	ND	ND	ND	0.166	0.463	2.410
	Feb 94	ND	0.007	1.100	ND	ND	ND	ND	ND	ND	ND	NA	ND	ND	ND	ND	ND	ND	ND
MW-14	Aug 93	ND	0.132	4.100	ND	0.134	1.420	0.171	7.710	10.900	0.0219	NA	1.640	ND	0.024	ND	0.533	0.701	24.400
	Feb 94	ND	0.010	0.100	ND	ND	ND	ND	ND	ND	0.0007	NA	ND	ND	ND	ND	ND	0.030	ND
MW-15	Feb 94	ND	0.150	0.130	ND	ND	0.020	ND	0.040	0.250	ND	NA	0.080	ND	ND	ND	ND	0.150	0.050
MW-16	Feb 94	ND	ND	0.060	ND	ND	ND	ND	ND	ND	ND	NA	ND	ND	ND	ND	ND	ND	0.010
WSW-1	Dec 93	ND	0.028	1.110	ND	ND	0.053	ND	0.273	0.110	ND	NA	0.048	ND	ND	ND	ND	0.114	0.411
	Jan 94	ND	ND	0.107	ND	ND	ND	ND	ND	ND	ND	NA	ND	ND	ND	ND	ND	ND	0.018
PW-1	Aug 93	ND	ND	ND	ND	ND	ND	ND	0.015	0.004	ND	NA	ND	ND	ND	ND	ND	ND	0.077
PW-2	Aug 93	ND	ND	0.012	ND	ND	ND	ND	0.017	ND	ND	NA	0.028	ND	ND	ND	ND	ND	0.036
PW-3	Aug 93	ND	ND	0.014	ND	ND	ND	ND	0.023	ND	ND	NA	ND	ND	ND	ND	ND	ND	0.029
TW-1	Aug 93	ND	ND	0.034	ND	ND	ND	ND	0.048	ND	ND	NA	0.021	ND	ND	ND	ND	ND	0.217

Notes:

NA - Not analyzed.
 ND - Not detected.

Acronym Definitions for Metals			
Sb = Antimony	Cr = Chromium	Mo = Molybdenum	Sn = Tin
As = Arsenic	Co = Cobalt	Ni = Nickel	V = Vanadium
Ba = Barium	Cu = Copper	Se = Selenium	Zn = Zinc
Be = Beryllium	Pb = Lead	Ag = Silver	
Cd = Cadmium	Hg = Mercury	Tl = Thallium	

TABLE 12
SUMMARY OF CHEMICAL ANALYSES - GROUNDWATER
pH, SPECIFIC CONDUCTIVITY AND TOTAL DISSOLVED SOLIDS
BARBARY COAST STEEL PROPERTY
Emeryville, California

Sample Number	Date Sampled	pH (std. pH units)	Specific Conductivity (uhmos/cm)	Total Dissolved Solids (mg/l)
MW-2B	Aug 93	NA	1,200	790
	Feb 94	NA	NA	NA
MW-3	Jul 93	NA	8,900	5,700
	Feb 94	NA	NA	NA
MW-3B	Aug 93	NA	5,200	3,200
	Feb 94	NA	NA	NA
MW-4	Aug 93	NA	2,900	1,900
	Feb 94	NA	NA	NA
MW-4B	Aug 93	NA	4,500	3,100
	Feb 94	NA	NA	NA
MW-5	Aug 93	8.98	4,100	2,700
	Feb 94	NA	NA	NA
MW-6	Aug 93	NA	770	530
	Feb 94	NA	NA	NA
MW-7	Aug 93	NA	2,100	1,600
	Feb 94	NA	NA	NA
MW-8	Aug 93	NA	670	420
	Feb 94	NA	NA	NA
MW-9	Aug 93	NA	1,100	740
	Feb 94	NA	NA	NA
MW-10	Aug 93	NA	1,200	740
	Feb 94	NA	NA	NA
MW-11	Aug 93	NA	1,600	1,000
	Feb 94	NA	NA	NA
MW-12	Aug 93	NA	2,300	1,400
	Feb 94	NA	NA	NA
MW-13	Aug 93	NA	13,000	9,500
	Feb 94	NA	NA	NA
MW-14	Aug 93	10.92	3,600	2,400
	Feb 94	NA	NA	NA
MW-15	Feb 94	NA	NA	NA
MW-16	Feb 94	NA	NA	NA
WSW-1	Dec 93	NA	550	360
	Jan 94	NA	NA	NA

Notes:

std. pH units - Standard pH units of measure.

uhmos/cm - Micromhos per centimeter.

mg/l - Milligrams per liter.

NA - Not analyzed.

Harding Lawson Associates. October 13, 1989. *Draft Soil and GW Investigation, A & J Trucking Co., Inc. Property, 5600 Shellmound Ave., Emeryville, California.*

Heath, J. S., Koblis, K., Sager, S., and Day, C., 1993. *Risk Assessment for Total Petroleum Hydrocarbons, in: Hydrocarbon Contaminated Soils*, Edward J. Calabrese and Paul T. Kostecki (eds), Lewis Publishers, Chelsea, MI.

Helley, E. J., Lajoie, K. R., Spangle, W. E., and Blair, M. L., 1979. *Flatland Deposits of the San Francisco Bay Region, California—Their Geology and Engineering Properties, and Their Importance to Comprehensive Planning*, U. S. Geological Survey Professional Paper 943.

Hickenbottom, K. and Muir, K., June 1988. *Geohydrology and Groundwater - Quality Overview, East Bay Plain Area, Alameda County, California*. Alameda County Flood Control and Water Conservation District, Report 205 (J).

McLaren Hart. June 30, 1992. *Status of Documentation Review and Submittal of Proposal for Additional Activities for Assessors Parcel Numbers 49-1516-04,06, and 07 on Shellmound Avenue, Emeryville, California.*

McLaren Hart. September 9, 1993. *Transmittal of Revised Tables and Figures for Shellmound I, II, and III Properties.*

McLaren Hart. August 25, 1993. *Transmittal of Reports, 1992 Documentation Review and Tables and Figures for Meeting with Cal-EPA DTSC Regarding Shellmound I, II, and III Properties on August 26, 1993.*

McLaren Hart. September 21, 1993. *Review of Laboratory Data for the Shellmound I, II, and III Properties, Emeryville.*

PES Environmental, Inc. September 27, 1991. *Preliminary Endangerment Assessment, Shellmound III Site, 4300 Eastshore Highway, Emeryville, California.*

PES Environmental, Inc. May 30, 1990. *Report, Hydrogeologic Investigation, 4300 Eastshore Highway, Emeryville, California.*

PES Environmental, Inc. March 7, 1991. *Work Plan. Soil and Groundwater Investigation, Shellmound III Site, 4300 East Shore Highway, Emeryville, California.*

PES Environmental, Inc. July 7, 1992. *Results of Groundwater Sampling and Analyses, Shellmound III Site, 4300 Eastshore Highway, Emeryville, California.*

PES Environmental, Inc. January 9, 1995. *Characterization of Petroleum Hydrocarbons in Soil and Groundwater at Powell Street Plaza and Shellmound III Properties, Emeryville, California.*

Radbruch, Dorothy H., 1957. *Areal and Engineering Geology of the Oakland West Quadrangle, California*, U. S. Geological Survey Miscellaneous Geologic Investigations Map I-239.

- Roux Associates, Inc.. February 22, 1988. *Initial Site Investigation for Removed Waste Oil Tank at Pfizer Pigment Plant, Emeryville, California.*
- Roux Associates, Inc. August 12, 1988. *Underground Storage Tank Site Investigation at Pfizer Pigments, Inc., Emeryville, California.*
- Roux Associates, Inc. March 31, 1989. *Tank Removal Plan and Site/Area Safety Plan, Pfizer Pigments, Inc., 4650 Shellmound, Emeryville, California.*
- Roux Associates, Inc. May 5, 1989. *Quarterly Groundwater Monitoring, Pfizer Plant, Emeryville, California.*
- Roux Associates, Inc. July 17, 1989. (Title obscured on copy. It is a site investigation to assess hydrocarbon contamination detected in soils beneath the Pfizer Pigments Plant, Emeryville, California.)
- Roux Associates, Inc. August 7, 1989. *Quarterly Groundwater Monitoring, Pfizer Plant, Emeryville, California.*
- Roux Associates, Inc. February 16, 1990. *Groundwater Monitoring, Pfizer Pigments Plant, Emeryville, California.*
- Roux Associates West, Inc. March 8, 1990. *Removal of Eleven Underground Storage Tanks, Pfizer Pigments Plant, Emeryville, California.*
- Roux Associates West, Inc. March 8, 1990. *Work Plan, Site Investigation and Fuel Recovery, Pfizer Pigments Plant, Emeryville, California.*
- Roux Associates West, Inc. May 1, 1990. *Final Report, Diesel Fuel Site Investigation, Pfizer Pigments Plant, Emeryville, California.*
- Roux Associates West, Inc. May 29, 1990. *Work Plan - Soil Remediation and Groundwater Monitoring, Harcros Pigments Plant, Emeryville, California.*
- Roux Associates West, Inc. March 31, 1991. *Quarterly Groundwater Monitoring, Harcros Pigments Plant, 4650 Shellmound St., Emeryville, California.*
- Roux Associates, Inc. May 31, 1991. *Remedial Excavation of Soils, Former Underground Storage Tank Pit, Harcros Pigments Facilities, Emeryville, California.*
- Roux Associates, Inc. June 10, 1991. *Second Quarterly Groundwater Monitoring Report, Harcros Pigments Facility, Emeryville, California.*
- Roux Associates, Inc. January, 13, 1991. *Fourth Quarter Groundwater Monitoring, Harcros Pigments Plant, Emeryville, California.*

Shacklette, H. T., and Boerngen, J. G., 1984. *Element Concentrations in Soils and Other Surficial Materials of the Conterminous United States*, U. S. Geological Survey Professional Paper 1270.

Tenera. June 2, 1989. *Phase II E.S.A. of Certain Property in Emeryville, CA*. Berkeley, CA.

Tenera. August 28, 1989. *Plan of Remediation for Development of the Marriott Site in Emeryville, California*.

The Emeryville Historical Society. Autumn, 1993. *Judson and Emeryville's Age of Iron and Steel*, The Journal of the Emeryville Historical Society, Volume IV, Number 3.

TRC Environmental Consultants, Inc. August 12, 1991 (Revised November 22, 1991). *Public Participation Plan, Myers Container Corp., Drum Reconditioning Facility, 4500 Shellmound Street, Emeryville, California*.

TRC Environmental Corp. June 8, 1993. *Quarterly Monitoring and Sampling, Myers Container Corp., 4500 Shellmound Street, Emeryville, California*.

TRC Environmental Corp. August 20, 1993. *Soil and Groundwater Investigation, Myers Container Corp, 4500 Shellmound Street, Emeryville, California*.

TRC Environmental Corp. March 12, 1992 (Revised September 3, 1992). *Remedial Investigation, Volume I. Myers Container Corporation, 4500 Shellmound Street, Emeryville, California*.

TRC Environmental Corp. (date unknown). *Remedial Investigation Report Volume II, Appendices A-H, Myers Container Corporation, 4500 Shellmound Street, Emeryville, California*.

TRC Environmental Corp. March 12, 1992. *Remedial Investigation Vol. I, Myers Container Corporation, 4500 Shellmound Street, Emeryville, California*.

TRC Environmental Corp. (date unknown). *Appendix D: Downhole Geophysics Reports. E: Survey Data. F: Geotechnical Results. H: Interim Measures/Sump Investigation. G: Aquifer Analyses. H: Interim Measures/Summary Investigation*. (report title unknown).

TRC Environmental Corp. (date unknown). *Remedial Investigation Report Vol. III Appendices I-J, Myers Contain Corporation*.

TRC Environmental Corp. September 13, 1991. *Interim Measures Report Drum Reconditioning Facility, 4500 Shellmound Street, Emeryville, California*.

TRC Environmental Corp. August 31, 1990. *Soil and GW Investigation, Myers Container Corp.*

U.S. Department of Commerce. 1993. *1990 Census of Population and Housing, Population and Housing Characteristics for Census Tracts San Francisco-Oakland-San Jose, California*. CPH-3-294A, Bureau of Census, Economics and Statistics Administration, Washington, D.C.

Wahler Associates. April 1992. *Hazardous Waste Investigations and Remedial Alternatives for Shellmound Ventures Property and Barbary Coast Steel Corporation. Walnut Creek, CA.*

Wahler Associates. May 1992. *Draft Hazardous Waste Investigations and Remedial Alternatives for Shellmound Ventures Property, Barbary Coast, Judson Steel.*

Wahler Associates. May 1992. *Draft Hazardous Waste Investigations and Remedial Alternatives for Barbary Coast Steel Corp. Property.*