

**RECEIVED**

By Alameda County Environmental Health 2:20 pm, Nov 18, 2015



ARCADIS U.S., Inc.  
100 Montgomery Street, Suite 300  
San Francisco, CA 94104  
Tel 415.374.2744  
Fax 415.374.2745  
www.arcadis-us.com

**Second and Third Quarter 2013 Semi-Annual Groundwater Monitoring Report**

Former BP Station #11109,  
4280 Foothill Blvd  
Oakland, California  
ACEH Case #RO0000426

ENVIRONMENT

"I declare that to the best of my knowledge at the present time, that the information and/or recommendations contained in the attached document are true and correct."

Date:  
October 30, 2013

Submitted by:

Contact:  
Hollis E. Phillips

ARCADIS U.S., Inc

Phone:  
415.432.6903

Email:  
Hollis.phillips@arcadis-us.com

Hollis E. Phillips, PG  
Project Manager

Our ref:  
GP09BPNA.C106.N0000

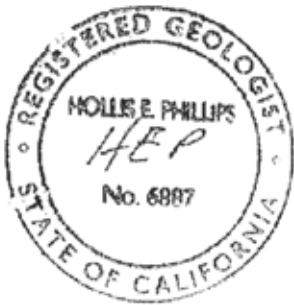

Imagine the result



Ms. Dilan Roe, P.E.  
Hazardous Materials Specialist  
Alameda County Environmental Health  
1131 Harbor Bay Parkway  
Alameda, CA 94502

Subject:

**Second and Third Quarter 2013 Semi-Annual Groundwater Monitoring Report**  
Former BP Station #11109,  
4280 Foothill Blvd, Oakland, California  
ACEH Case #RO0000426

Dear Ms. Roe:

ARCADIS U.S., Inc. (ARCADIS) has prepared this *Second and Third Quarter 2013 Semi-Annual Groundwater Monitoring Report* to document the results of groundwater monitoring and sampling and remediation progress at the Former BP Service Station #11109 located at 4280 Foothill Boulevard in Oakland, Alameda County, California (the Site; Figure 1).

## 1. Summary

A summary of the work performed at the Site during this reporting period and the proposed work for the next reporting period is provided below.

### **Work Performed – This Semi-Annual Reporting Period (April 1, 2013 to September 30, 2013)**

- Submitted the *Results of DPE Pilot Test and SPH Removal* summary letter on June 28, 2013 detailing the field activities conducted in accordance with the *Feasibility Study and Corrective Action Plan (ARCADIS 2011)* and the subsequent *Revised Proposed Pilot Study Activities* letter (ARCADIS 2012).
- Submitted the *ACEH Low Threat Closure Policy Checklist and Site Conceptual Model* on June 28, 2013.
- Conducted Third Quarter 2013 semi-annual groundwater monitoring event on September 20, 2013 and replaced LNAPL absorbent socks in monitoring wells MW-5, MW-10, and MW-12.

ARCADIS U.S., Inc.  
100 Montgomery Street, Ste. 300  
San Francisco, CA 94104  
Tel 415.374.2744  
Fax 415.374.2745  
www.arcadis-us.com

ENVIRONMENT

Date:  
October 30, 2013

Contact:  
Arpen Shah

Phone:  
415.432.6916

Email:  
Arpen.Shah@arcadis-us.com

Our ref:  
GP09BPNA.C106.N0000

**Work Proposed – Next Semi-Annual Reporting Period (October 1, 2013 to March 31, 2013)**

- Submit the *Second and Third Quarter 2013 Semi-Annual Groundwater Monitoring Report* contained herein.
- Prepare for semi-annual groundwater monitoring/sampling activities to be conducted in First Quarter 2014.

**2. Groundwater Monitoring/Sampling Activities and Results**

Third Quarter 2013 groundwater monitoring was conducted on September 20, 2013 by Broadbent & Associates, Inc. (BAI) personnel. Groundwater monitoring was conducted concurrently at the adjacent Chevron #9-0076 (ACEH Case #RO0000427) to further characterize hydrogeology in the vicinity of the Site. Prior to groundwater sampling, depth-to-water measurements were collected in wells MW-2 through MW-12 with an oil/water interface probe. A sheen was observed in monitoring wells MW-5, MW-10, and MW-12; however no measurable light non-aqueous phase liquid (LNAPL) was present. Monitoring well MW-2 was noted as dry during gauging activities; no other irregularities were noted during water level gauging. Depth-to-water (DTW) measurements on-site ranged from 10.26 ft below top of casing (bTOC) at MW-5 to 16.02 ft bTOC at MW-6. Resulting groundwater surface elevations on-site ranged from 27.07 feet above mean sea level (ft msl) at MW-8 to 33.15 ft msl at MW-9. Groundwater elevations at the adjacent Chevron site calculated using provided field forms and surveyed top of casing (TOC) values from GeoTracker varied from 5.31 ft msl (C-9) to 28.39 ft msl (C-10). DTW measurements recorded at monitoring wells C-4 and C-10 were not consistent with historical field parameter; therefore, the calculated groundwater elevations at C-4 and C-10 were not used to generate groundwater contours. Field methods used during groundwater monitoring are provided in Appendix A, and field data sheets are included in Appendix B. Groundwater elevations are summarized in Table 1, and a groundwater elevation contour map is presented in Figure 2.

Groundwater samples were collected on September 20, 2013 from wells MW-3, MW-4, MW-6, MW-7, and MW-11 using HydraSleeve™ groundwater samplers, which collect a representative sample from a specific depth interval within the monitoring well screen. Samples were not collected from wells MW-5, MW-10, and MW-12 due to the presence of sheen. No irregularities were reported during sampling. Samples were submitted under chain-of-custody protocol to TestAmerica Laboratories, Inc. (Pleasanton, California) for analysis of Gasoline-Range Organics (GRO, C6-C12) by EPA Method 8260B (MW-4, MW-7, MW-11); for Benzene, Toluene, Ethylbenzene, Total Xylenes (BTEX), Ethyl Tertiary Butyl Ether (ETBE), Tert-Amyl Methyl Ether

(TAME), Di-Isopropyl Ether (DIPE), 1,2-Dibromomethane (EDB), 1,2-Dichloroethane (1,2-DCA), Tert-Butyl Alcohol (TBA) and Ethanol by EPA Method 8260 (MW-7, MW-11); and Methyl Tertiary Butyl Ether (MTBE) by EPA Method 8260B (MW-3, MW-4, MW-6, MW-7, MW-11). No significant irregularities were encountered during analysis of the samples. The laboratory analytical report, including chain-of-custody documentation, is provided in Appendix C.

Groundwater monitoring data (GEO\_WELL) and laboratory analytical results (EDF) were uploaded to the GeoTracker AB2886 database. Upload confirmation receipts are provided in Appendix D.

### 3. LNAPL Removal Activities

LNAPL absorbent socks were placed in monitoring wells MW-5, MW-10, and MW-12 on May 7, 2013 to remove residual LNAPL at each location, as discussed in the *Results of DPE Pilot Test and SPH Removal* summary letter. Following gauging and sampling activities, the absorbent socks were removed from the wells and replaced. The socks appeared to have absorbed LNAPL within the wells since deployment and no measurable free product was observed in the wells. Upon removal, the absorbent sock at MW-5 was observed to be a quarter of the full length saturated with LNAPL and socks in MW-10 and MW-12 were each observed to be half saturated. Field notes from LNAPL removal activities are provided in Appendix B.

### 4. Discussion/Conclusions

Groundwater levels were between historic minimum and maximum elevations for all wells monitored on-site except MW-10. The water elevation at MW-10 (29.28 ft msl) was below the previous historic minimum of 29.51 (observed in March 2012), but is consistent with other data collected during the reporting period and therefore is considered usable.

The groundwater elevations observed at monitoring wells C-4 and C-10 at the adjacent Chevron station were not consistent with historical observations, and thus was not considered in contouring. Groundwater elevations calculated for the Site and the adjacent Chevron facility yielded an average horizontal gradient of approximately 0.03 ft/ft. As presented in Table 2, historical interpretation of groundwater monitoring data by previous consultants indicated a shift in the groundwater flow direction from southwest to northwest in the third quarter 2009. However, review of historical field notes and groundwater contours indicates that data at various monitoring locations have consistently been designated “anomalous” and were not considered in groundwater contouring in order to render more uniform interpretation of the

hydrogeology at the Site. Additionally, groundwater contouring following 2009 did not consider groundwater elevations at the adjacent Chevron station, which historically supported the interpretation that groundwater flow in the vicinity of the Site is to the southwest. Review of field measurements of DTW collected during the third quarter 2013 event indicate groundwater elevations do not vary uniformly across the Site; however, all data collected on-site was considered to be within the range of minimum and maximum water elevations, thus no data may be considered anomalous (with the exception of C-4 and C-10 at the adjacent site). Consideration of groundwater elevations at the adjacent Chevron site supports the current interpretation that the overall groundwater flow direction in the vicinity of the Site is to the southwest, as observed prior to 2009. The current groundwater elevation contour map is provided on Figure 2.

- Groundwater monitoring laboratory analytical results are summarized in Table 1 and are consistent with historical concentrations observed except the GRO concentration at MW-4. A groundwater analytical summary map is presented as Figure 3.
  - GRO was detected in three monitoring wells (MW-4, MW-7, and MW-11) ranging from 580 µg/L (MW-7) to 10,000 µg/L (MW-11).
  - Benzene was detected monitoring well MW-11 with a concentration of 120 µg/L.
  - Toluene was detected monitoring well MW-11 with a concentration of 130 µg/L.
  - Ethylbenzene was detected monitoring well MW-11 with a concentration of 320 µg/L.
  - Total Xylenes were detected monitoring well MW-11 with a concentration of 720 µg/L.
  - MTBE was detected in four monitoring wells (MW-3, MW-4, MW-6, and MW-7) ranging from 2.3 µg/L (MW-7) to 21 µg/L (MW-4)
  - ETBE, TAME, DIPE, EDB, TBA 1,2-DCA, and ethanol were below laboratory reporting limits for all wells sampled

## 5. Recommendations

ARCADIS recommends continued groundwater monitoring and sampling on a semi-annual basis in accordance with the approved schedule until the site is approved for No Further Action.

**6. Limitations**

The findings presented in this report are based upon observations of field personnel, points investigated, results of laboratory tests performed by TestAmerica Laboratories, Inc. (Pleasanton, California), and our understanding of Alameda County Environmental Health (ACEH) requirements. Our services were performed in accordance with the generally accepted standard of practice at the time this report was written. No other warranty, expressed or implied was made. This report has been prepared for the exclusive use of ARCADIS-US, Inc. and Atlantic Richfield Company. It is possible that variations in soil or groundwater conditions could exist beyond points explored in this investigation. Also, changes in site conditions could occur in the future due to variations in rainfall, temperature, regional water usage, or other factors.

If you have any questions or comments regarding the contents of this report, please contact Arpen Shah by telephone (415.432.6916) or by e-mail ([Arpen.Shah@arcadis-us.com](mailto:Arpen.Shah@arcadis-us.com)), or contact Hollis Phillips by telephone (415.432.6903) or by e-mail ([Hollis.Phillips@arcadis-us.com](mailto:Hollis.Phillips@arcadis-us.com)).

Sincerely,

ARCADIS

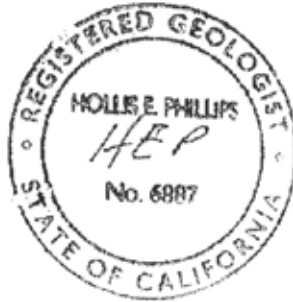
Hollis E. Phillips, P.G. (No. 6887)  
 Project Manager

cc: Ms. Dilan Roe, Alameda County Environmental Health (Submitted via ACEH ftp Site)  
 Mr. Ed Ralston, ConocoPhillips, 76 Broadway, Sacramento, California 95818  
 Electronic copy uploaded to GeoTracker

**ATTACHMENTS:**

- Figure 1: Site Location Map
- Figure 2: Groundwater Elevation Contour Map - September 20, 2013
- Figure 3: Analytical Summary Map – September 20, 2013
  
- Table 1: Summary of Groundwater Monitoring Data: Relative Water Elevations and Laboratory Analyses
- Table 2: Historical Groundwater Flow Direction and Gradient
  
- Appendix A: Field Methods
- Appendix B: Field Data Sheets
- Appendix C: Laboratory Report and Chain-of-Custody Documentation
- Appendix D: GeoTracker Upload Confirmation Receipts

**LIST OF COMMONLY USED ACCRONYMS/ABBREVIATIONS:**

ACEH:	Alameda County Environmental Health	ft/ft:	feet per foot
BAI:	Broadbent & Associates, Inc.	gal:	Gallons
BTEX:	Benzene, Toluene, Ethylbenzene, Total Xylenes	GRO:	Gasoline-Range Organics
1,2-DCA:	1,2-Dichloroethane	LNAPL:	Light Non-Aqueous Phase Liquid
DIPE:	Di-Isopropyl Ether	MTBE:	Methyl Tertiary Butyl Ether
DO:	Dissolved Oxygen	TAME:	Tert-Amyl Methyl Ether
DRO:	Diesel-Range Organics	TBA:	Tertiary Butyl Ether
EDB:	1,2-Dibromomethane	TOC:	Top of Casing
EPA:	Environmental Protection Agency	mg/L:	Micrograms per liter
ETBE:	Ethyl Tertiary Butyl Ether		



**Figures**

CITY: PATALUMA, CA DIV/GROUP: ENV DB: J. HARRIS LD: PIC: RM: H. PHILLIPS TM: B. MCKENNA L YR: 01/01/01 OFF: REF: G:\ENV\CAD\Fataluma\AC\TGP09BP\NAC106\REV000\GPO9BP\NAC106-1.dwg LAYOUT: 17:15 (LMS TECH) PAGES: SETUP: PLOT/STYLE/TABLE: ARCADIS.CTB PLOTTED: 11/20/2009 8:40 AM BY: HARRIS, JESSICA

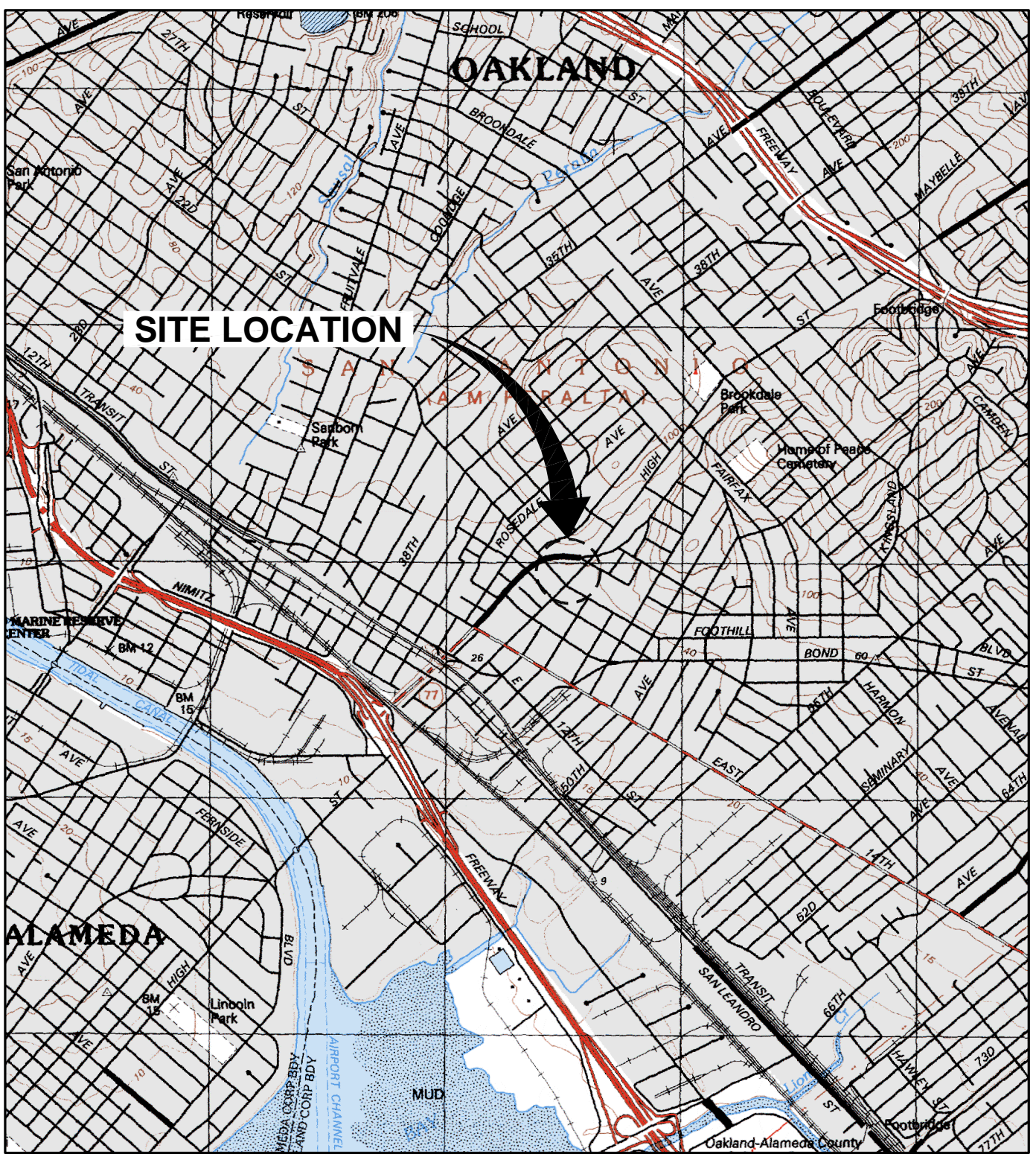

REFERENCE: BASE MAP USGS 7.5. MIN. TOPO. QUAD., OAKLAND WEST, CA., 1993, AND SAN LEANDRO, 1993, REVISED 1996.



FORMER BP STATION #11109  
 4280 FOOTHILL BOULEVARD  
 OAKLAND, CALIFORNIA

**SITE LOCATION MAP**

FIGURE  
**1**

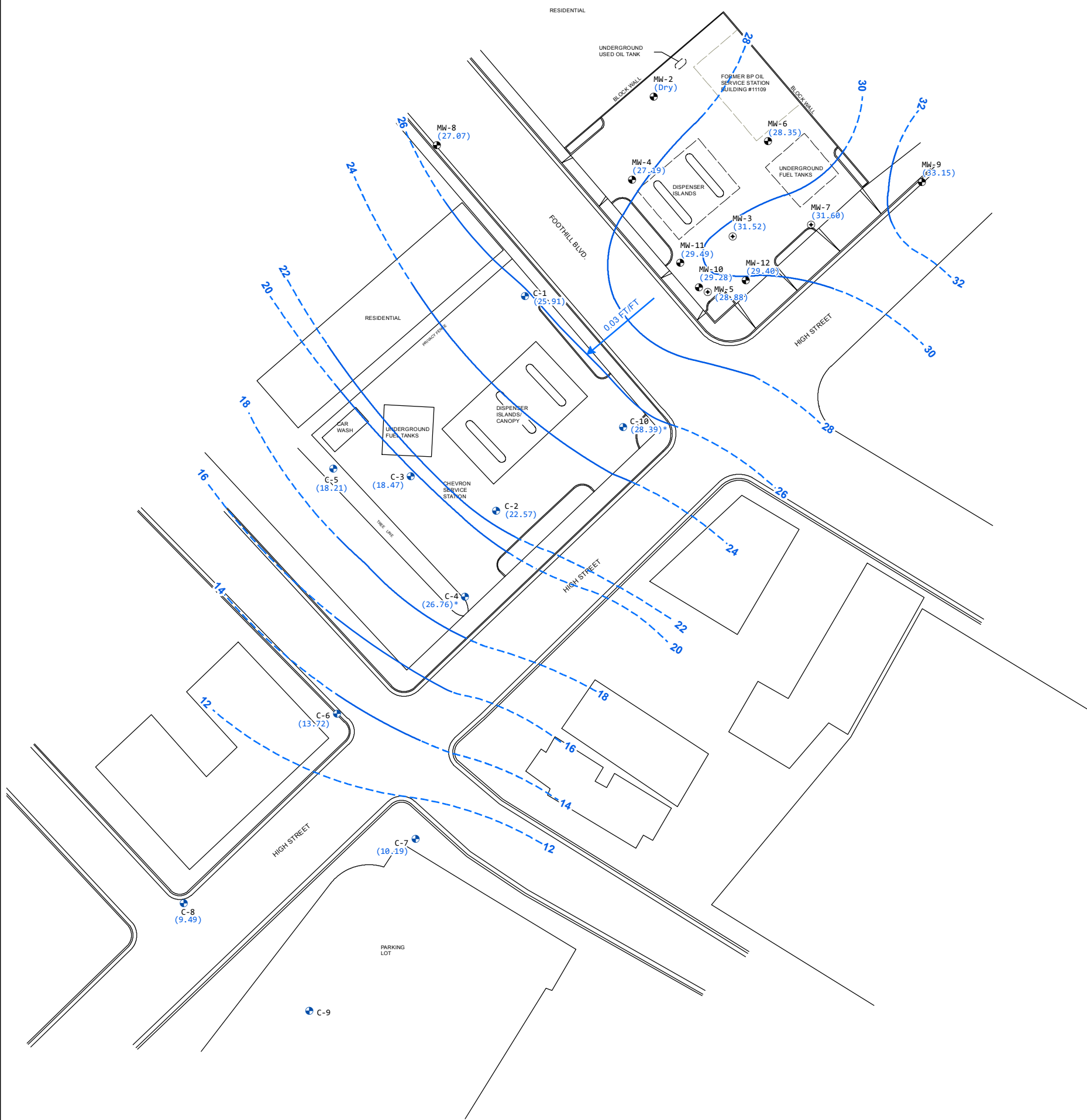

**LEGEND:**

- GROUNDWATER MONITORING WELL
- GROUNDWATER MONITORING WELL-CHEVRON
- ⊕ RECOVERY POINT
- (27.07) GROUNDWATER ELEVATION (FEET ABOVE MEAN SEA LEVEL)
- 12 — GROUNDWATER ELEVATION CONTOUR LINE (DASHED WHERE INFERRED)
- 0.03 → GROUNDWATER FLOW DIRECTION (FOOT PER FOOT)
- \* NOT USED FOR CONTOURING
- NG NOT GAUGED

NOTE:  
 GROUNDWATER ELEVATIONS AT ADJACENT CHEVRON SITE CALCULATED BASED ON FIELD DEPTH TO WATER DATA PROVIDED BY CHEVRON AND TOP OF CASING MEASUREMENTS AVAILABLE ON GEOTRACKER

- NOTES:  
 1. BASE MAP PROVIDED BY BROADBENT & ASSOCIATES, INC. DATED 10/26/2009, REFERENCE 06-88-646, AT A SCALE OF 1"=40'.

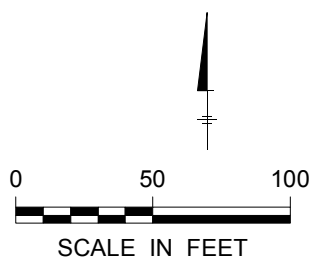

FORMER BP STATION #11109 4280 FOOTHILL BOULEVARD OAKLAND, CALIFORNIA	
<b>GROUNDWATER MONITORING REPORT THIRD QUARTER 2013</b>	
<b>GROUNDWATER ELEVATION CONTOUR MAP - SEPTEMBER 20, 2013</b>	
	FIGURE <b>2</b>



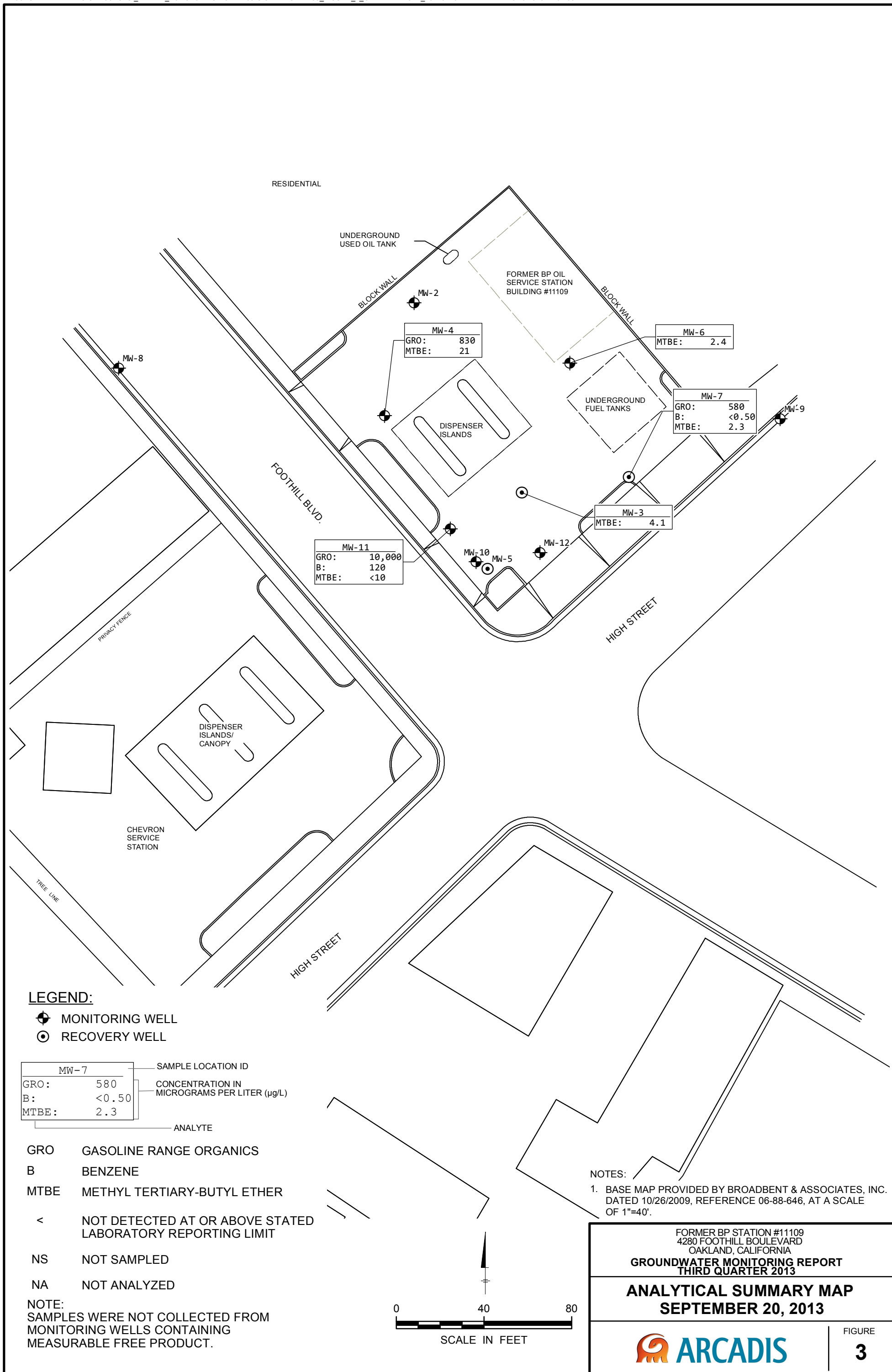

**LEGEND:**

- ⊕ MONITORING WELL
- ⊙ RECOVERY WELL

MW-7		SAMPLE LOCATION ID
GRO:	580	CONCENTRATION IN MICROGRAMS PER LITER (µg/L)
B:	<0.50	
MTBE:	2.3	ANALYTE

- GRO GASOLINE RANGE ORGANICS
- B BENZENE
- MTBE METHYL TERTIARY-BUTYL ETHER
- < NOT DETECTED AT OR ABOVE STATED LABORATORY REPORTING LIMIT
- NS NOT SAMPLED
- NA NOT ANALYZED

NOTE:  
 SAMPLES WERE NOT COLLECTED FROM MONITORING WELLS CONTAINING MEASURABLE FREE PRODUCT.

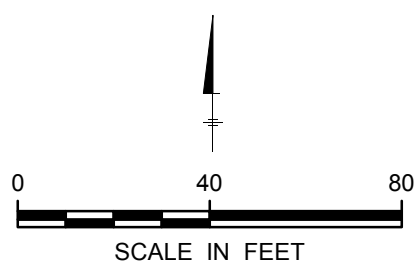

NOTES:  
 1. BASE MAP PROVIDED BY BROADBENT & ASSOCIATES, INC. DATED 10/26/2009, REFERENCE 06-88-646, AT A SCALE OF 1"=40'.

FORMER BP STATION #11109 4280 FOOTHILL BOULEVARD OAKLAND, CALIFORNIA	
<b>GROUNDWATER MONITORING REPORT          THIRD QUARTER 2013</b>	
<b>ANALYTICAL SUMMARY MAP          SEPTEMBER 20, 2013</b>	
	FIGURE <b>3</b>



**Tables**









**Table 1**  
**Summary of Groundwater Monitoring Data: Relative Water Elevations and Laboratory Analyses**  
**CA-11109**  
**4280 Foothill Blvd., Oakland, CA 94601**

Well ID	Date	Notes	TOC (ft msl)	DTW (ft)	DTP	GW Elev (ft msl)	DRO (µg/L)	GRO (µg/L)	Benzene (µg/L)	Toluene (µg/L)	Ethylbenzene (µg/L)	Xylenes (µg/L)	MTBE (µg/L)	TBA (µg/L)	DIPE (µg/L)	ETBE (µg/L)	TAME (µg/L)	Ethanol (µg/L)	1,2-DCA (µg/L)	EDB (µg/L)
MW-4	3/23/2010		42.88	10.82		32.06	--	<50	<0.50	<0.50	<0.50	<1.0	84	18	<0.50	<0.50	0.88	<100	<0.50	<0.50
MW-4	6/10/2010		42.88	12.67		30.21	--	--	--	--	--	--	--	--	--	--	--	--	--	--
MW-4	9/16/2010		42.88	15.72		27.16	--	120	<0.50	<0.50	<0.50	<1.0	72	8.0	<0.50	<0.50	0.82	<100	<0.50	<0.50
MW-4	2/23/2011		42.88	11.43		31.45	--	<50	--	--	--	--	55	--	--	--	--	--	--	--
MW-4	9/28/2011		42.88	15.34		27.54	--	150	--	--	--	--	62	--	--	--	--	--	--	--
MW-4	3/8/2012		42.88	15.03		27.85	--	120	--	--	--	--	42	--	--	--	--	--	--	--
MW-4	9/5/2012		42.88	15.90	--	26.98	--	56	<0.50	<0.50	<0.50	<1.0	47	18	<0.50	<0.50	<0.50	<250	<0.50	<0.50
MW-4	3/20/2013		42.88	13.80	--	29.08	--	<50	--	--	--	--	17	--	--	--	--	--	--	--
MW-4	9/20/2013		42.88	15.69	--	27.19	--	830	--	--	--	--	21	--	--	--	--	--	--	--
MW-5	10/3/1991		39.55	18.08		21.47	--	79,000	13,000	7,400	1,400	6,200	--	--	--	--	--	--	--	--
MW-5	10/15/1991		39.55	18.55		21.00	--	--	--	--	--	--	--	--	--	--	--	--	--	--
MW-5	12/4/1991	g	39.55	18.44		20.98	--	--	--	--	--	--	--	--	--	--	--	--	--	--
MW-5	12/16/1991	g	39.55	18.66		20.88	--	--	--	--	--	--	--	--	--	--	--	--	--	--
MW-5	1/6/1992	g	39.55	19.12		20.32	--	--	--	--	--	--	--	--	--	--	--	--	--	--
MW-5	1/22/1992		39.55	14.59		24.96	--	--	--	--	--	--	--	--	--	--	--	--	--	--
MW-5	1/28/1992		39.55	15.25		24.30	--	--	--	--	--	--	--	--	--	--	--	--	--	--
MW-5	2/5/1992	b	39.55	15.58		23.97	--	--	--	--	--	--	--	--	--	--	--	--	--	--
MW-5	2/12/1992	g	39.55	15.54		24.00	--	--	--	--	--	--	--	--	--	--	--	--	--	--
MW-5	2/17/1992	b	39.55	13.98		25.57	--	--	--	--	--	--	--	--	--	--	--	--	--	--
MW-5	4/3/1992	g	39.55	13.63		25.88	--	--	--	--	--	--	--	--	--	--	--	--	--	--
MW-5	4/8/1992	g	39.55	13.17		26.37	--	--	--	--	--	--	--	--	--	--	--	--	--	--
MW-5	4/14/1992	g	39.55	13.45		26.09	--	--	--	--	--	--	--	--	--	--	--	--	--	--
MW-5	4/29/1992	g	39.55	13.75		25.73	--	--	--	--	--	--	--	--	--	--	--	--	--	--
MW-5	5/7/1992	g	39.55	16.15		23.36	--	--	--	--	--	--	--	--	--	--	--	--	--	--
MW-5	7/3/1992	g	39.55	17.67		21.80	--	--	--	--	--	--	--	--	--	--	--	--	--	--
MW-5	9/1/1992	g	39.55	17.83		21.22	--	--	--	--	--	--	--	--	--	--	--	--	--	--
MW-5	10/8/1992	g	39.55	17.86		20.77	--	--	--	--	--	--	--	--	--	--	--	--	--	--
MW-5	12/31/1992	b	39.55	15.20		24.35	--	--	--	--	--	--	--	--	--	--	--	--	--	--
MW-5	4/21/1993	g	39.55	12.64		26.89	--	--	--	--	--	--	--	--	--	--	--	--	--	--
MW-5	7/7/1993	g,f	39.14	12.68		25.64	--	--	--	--	--	--	--	--	--	--	--	--	--	--
MW-5	9/21/1993	b	39.14	14.35		24.79	--	--	--	--	--	--	--	--	--	--	--	--	--	--
MW-5	12/17/1993	g	39.14	12.61		26.12	--	--	--	--	--	--	--	--	--	--	--	--	--	--
MW-5	4/7/1994		39.14	30.00		9.14	--	66,000	3,000	1,700	250	6,800	2,002	--	--	--	--	--	--	--
MW-5	7/6/1994		--	--		--	--	29,000	1,900	300	63	2,700	1,141	--	--	--	--	--	--	--
MW-5	10/7/1994		39.14	28.70		10.44	--	250,000	2,600	660	830	5,200	37.7	--	--	--	--	--	--	--
MW-5	10/7/1994	e	39.14	28.70		10.44	--	45,000	2,900	540	260	2,600	--	--	--	--	--	--	--	--
MW-5	1/27/1995		39.14	28.70		10.44	--	--	--	--	--	--	--	--	--	--	--	--	--	--
MW-5	3/30/1995		39.14	28.95		10.19	--	50,000	7,900	2,600	520	6,400	--	--	--	--	--	--	--	--
MW-5	3/30/1995	e	39.14	28.95		10.19	--	43,000	7,900	2,500	440	6,200	--	--	--	--	--	--	--	--
MW-5	6/20/1995		39.14	22.54		16.60	--	34,000	5,100	1,900	300	3,700	--	--	--	--	--	--	--	--
MW-5	6/20/1995	e	39.14	22.54		16.60	--	26,000	3,500	290	<25	3,300	--	--	--	--	--	--	--	--
MW-5	10/3/1995		39.14	18.84		20.30	--	12,000	68	42	11	1,600	330	--	--	--	--	--	--	--
MW-5	10/3/1995	e	39.14	18.84		20.30	--	12,000	46	39	10	1,600	320	--	--	--	--	--	--	--
MW-5	12/6/1995		39.14	19.07		20.07	--	16,000	1,200	93	51	700	600	--	--	--	--	--	--	--
MW-5	3/21/1996		39.14	7.43		31.71	--	1,500	89	28	6	250	<10	--	--	--	--	--	--	--
MW-5	3/21/1996	e	39.14	7.43		31.71	--	1,900	92	30	7	270	<10	--	--	--	--	--	--	--
MW-5	6/21/1996		39.14	9.87		29.27	--	3,500	740	150	19	400	<100	--	--	--	--	--	--	--
MW-5	6/21/1996	e	39.14	9.87		29.27	--	2,700	680	140	20	400	<50	--	--	--	--	--	--	--
MW-5	9/6/1996		39.14	10.52		28.62	--	--	--	--	--	--	--	--	--	--	--	--	--	--
MW-5	9/9/1996		--	--		--	--	82,000	3,100	1,700	850	9,100	<2,500	--	--	--	--	--	--	--
MW-5	9/9/1996	e	--	--		--	--	90,000	2,900	1,600	670	6,900	<2,500	--	--	--	--	--	--	--
MW-5	12/19/1996		39.14	8.62		30.52	--	41,000	790	820	120	2,040	<500	--	--	--	--	--	--	--
MW-5	12/19/1996	e	39.14	8.62		30.52	--	26,000	490	430	63	1,140	<500	--	--	--	--	--	--	--
MW-5	3/17/1997		39.14	8.22		30.92	--	5,500	1.9	2.4	<1.0	<1.0	29	--	--	--	--	--	--	--
MW-5	3/17/1997	e	39.14	8.22		30.92	--	6,600	2.5	2.7	<1.0	<1.0	28	--	--	--	--	--	--	--
MW-5	8/12/1997	g	39.14	12.18		26.74	--	33,000	6,400	2,400	680	4,400	<1,000	--	--	--	--	--	--	--
MW-5	8/12/1997	e	39.14	12.18		26.74	--	36,000	6,100	2,500	720	4,500	<500	--	--	--	--	--	--	--
MW-5	12/10/1997	g	39.14	10.78		28.30	--	31,000	3,000	2,500	560	5,100	500	--	--	--	--	--	--	--
MW-5	12/10/1997	e	39.14	10.78		28.30	--	37,000	2,900	2,500	440	4,800	--	--	--	--	--	--	--	--
MW-5	3/12/1998	g	39.14	10.11		28.81	--	100,000	1,600	870	250	2,600	<250	--	--	--	--	--	--	--
MW-5	6/23/1998		39.14	10.20		28.92	--	27,000	2,500	840	370	2,900	<250	--	--	--	--	--	--	--
MW-5	6/23/1998	e	39.14	10.20		28.92	--	27,000	2,600	840	400	2,950	<500	--	--	--	--	--	--	--
MW-5	8/25/1999	g	39.14	14.69		24.07	--	180,000	2,700	400	830	2,800	26	--	--	--	--	--	--	--
MW-5	3/9/2000	g	39.14	14.83		23.71	--	53,000	12,000	2,600	1,900	9,100	<5.0	--	--	--	--	--	--	--
MW-5	3/8/2002	g	39.14	11.45		26.19	--	33,000	8,240	1,080	1,010	2,900	34.3	--	--	--	--	--	--	--
MW-5	3/18/2002		39.14	8.03		31.11	--	--	--	--	--	--	--	--	--	--	--	--	--	--
MW-5	3/11/2003	g	39.14	9.60		29.09	--	--	--	--	--	--	--	--	--	--	--	--	--	--
MW-5	12/9/2003	g	39.14	11.44		27.72	--	--	--	--	--	--	--	--	--	--	--	--	--	--
MW-5	3/9/2004		39.14	7.91		31.23	--	31,000	3,900	1,100	780	3,600	<50	<2,000	<50	<50	<50	<10,000	96	<50
MW-5	9/17/2004	g	39.14	12.13		27.13	--	--	--	--	--	--	--	--	--	--	--	--	--	--

**Table 1**  
**Summary of Groundwater Monitoring Data: Relative Water Elevations and Laboratory Analyses**  
**CA-11109**  
**4280 Foothill Blvd., Oakland, CA 94601**

Well ID	Date	Notes	TOC (ft msl)	DTW (ft)	DTP	GW Elev (ft msl)	DRO (µg/L)	GRO (µg/L)	Benzene (µg/L)	Toluene (µg/L)	Ethylbenzene (µg/L)	Xylenes (µg/L)	MTBE (µg/L)	TBA (µg/L)	DIPE (µg/L)	ETBE (µg/L)	TAME (µg/L)	Ethanol (µg/L)	1,2-DCA (µg/L)	EDB (µg/L)	
MW-5	3/7/2005	g	39.14	8.62		30.52	--	--	--	--	--	--	--	--	--	--	--	--	--	--	--
MW-5	9/6/2005	g	39.14	11.16		27.98	--	--	--	--	--	--	--	--	--	--	--	--	--	--	--
MW-5	3/6/2006	g,b	39.14	8.60		30.54	--	32,000	7,500	810	1,200	2,300	<50	<2,000	60	<50	<50	<30,000	<50	<50	
MW-5	9/5/2006	g	39.14	6.16		32.98	--	--	--	--	--	--	--	--	--	--	--	--	--	--	--
MW-5	3/5/2007	b	39.14	8.34		30.80	--	90,000	10,000	4,200	1,900	7,900	<50	<2,000	57	<50	<50	<30,000	<50	<50	
MW-5	9/7/2007	g	39.14	15.15		23.99	--	--	--	--	--	--	--	--	--	--	--	--	--	--	--
MW-5	1/14/2008	g	39.14	10.30		28.84	--	--	--	--	--	--	--	--	--	--	--	--	--	--	--
MW-5	2/27/2008	g	39.14	13.22		25.92	--	--	--	--	--	--	--	--	--	--	--	--	--	--	--
MW-5	3/6/2008	g	39.14	12.90		26.24	--	--	--	--	--	--	--	--	--	--	--	--	--	--	--
MW-5	9/3/2008	g	39.14	12.90		26.24	--	--	--	--	--	--	--	--	--	--	--	--	--	--	--
MW-5	3/4/2009	g	39.14	8.45		30.69	--	--	--	--	--	--	--	--	--	--	--	--	--	--	--
MW-5	4/8/2009	g	39.14	9.05		30.09	--	--	--	--	--	--	--	--	--	--	--	--	--	--	--
MW-5	5/11/2009	g	39.14	9.10		30.04	--	--	--	--	--	--	--	--	--	--	--	--	--	--	--
MW-5	6/16/2009	g	39.14	9.15		29.99	--	--	--	--	--	--	--	--	--	--	--	--	--	--	--
MW-5	7/22/2009	g	39.14	9.33		29.81	--	--	--	--	--	--	--	--	--	--	--	--	--	--	--
MW-5	8/6/2009	g	39.14	10.05		29.09	--	--	--	--	--	--	--	--	--	--	--	--	--	--	--
MW-5	9/30/2009	g	39.14	10.55		28.59	--	--	--	--	--	--	--	--	--	--	--	--	--	--	--
MW-5	10/28/2009		39.14	10.48		28.66	--	--	--	--	--	--	--	--	--	--	--	--	--	--	--
MW-5	3/23/2010		39.14	7.10		32.04	--	67,000	1,400	380	620	1,800	<5.0	<40	<5.0	<5.0	<5.0	<1,000	<5.0	<5.0	
MW-5	6/10/2010	g	39.14	8.26		30.88	--	--	--	--	--	--	--	--	--	--	--	--	--	--	--
MW-5	9/16/2010	g	39.14	9.14		30.00	--	--	--	--	--	--	--	--	--	--	--	--	--	--	--
MW-5	2/23/2011	g	39.14	8.33		30.81	--	--	--	--	--	--	--	--	--	--	--	--	--	--	--
MW-5	9/28/2011	g	39.14	10.46		28.68	--	--	--	--	--	--	--	--	--	--	--	--	--	--	--
MW-5	3/8/2012	g	39.14	10.27		28.87	--	--	--	--	--	--	--	--	--	--	--	--	--	--	--
MW-5	9/5/2012	g	39.14	11.80		27.69	--	--	--	--	--	--	--	--	--	--	--	--	--	--	--
MW-5	3/20/2013	g	39.14	9.73	9.71	29.43	--	--	--	--	--	--	--	--	--	--	--	--	--	--	--
MW-5	9/20/2013	b, i	39.14	10.26	--	28.88	--	--	--	--	--	--	--	--	--	--	--	--	--	--	--
MW-6	10/3/1991		41.59	20.73		20.86	--	<50	0.7	0.8	<0.3	1.3	--	--	--	--	--	--	--	--	--
MW-6	10/15/1991		41.59	21.20		20.39	--	--	--	--	--	--	--	--	--	--	--	--	--	--	--
MW-6	12/4/1991		41.59	21.26		20.33	--	--	--	--	--	--	--	--	--	--	--	--	--	--	--
MW-6	12/16/1991		41.59	21.12		20.47	--	--	--	--	--	--	--	--	--	--	--	--	--	--	--
MW-6	1/6/1992		41.59	20.29		21.30	--	<50	<0.5	<0.5	<0.5	1.6	--	--	--	--	--	--	--	--	--
MW-6	1/22/1992		41.59	20.12		21.47	--	--	--	--	--	--	--	--	--	--	--	--	--	--	--
MW-6	1/28/1992		41.59	20.20		21.39	--	--	--	--	--	--	--	--	--	--	--	--	--	--	--
MW-6	2/5/1992		41.59	20.09		21.50	--	--	--	--	--	--	--	--	--	--	--	--	--	--	--
MW-6	2/12/1992		41.59	19.15		22.44	--	--	--	--	--	--	--	--	--	--	--	--	--	--	--
MW-6	2/17/1992		41.59	18.02		23.57	--	--	--	--	--	--	--	--	--	--	--	--	--	--	--
MW-6	4/3/1992		41.59	16.62		24.97	--	--	--	--	--	--	--	--	--	--	--	--	--	--	--
MW-6	4/8/1992		41.59	17.06		24.53	--	<50	0.6	<0.5	0.8	<0.5	--	--	--	--	--	--	--	--	--
MW-6	4/14/1992		41.59	17.23		24.36	--	--	--	--	--	--	--	--	--	--	--	--	--	--	--
MW-6	4/29/1992		41.59	18.12		23.47	--	--	--	--	--	--	--	--	--	--	--	--	--	--	--
MW-6	5/7/1992		41.59	18.52		23.07	--	--	--	--	--	--	--	--	--	--	--	--	--	--	--
MW-6	7/3/1992		41.59	19.71		21.88	--	<50	<0.5	<0.5	<0.5	<0.5	--	--	--	--	--	--	--	--	--
MW-6	10/8/1992		41.59	21.22		20.37	--	<50	<0.5	<0.5	<0.5	<0.5	--	--	--	--	--	--	--	--	--
MW-6	10/8/1992	e	41.59	21.22		20.37	--	<50	<0.5	<0.5	<0.5	<0.5	--	--	--	--	--	--	--	--	--
MW-6	12/31/1992		41.59	21.33		20.26	--	<50	<0.5	<0.5	<0.5	<0.5	--	--	--	--	--	--	--	--	--
MW-6	4/21/1993		41.59	16.45		25.14	--	<50	<0.5	<0.5	<0.5	<0.5	--	--	--	--	--	--	--	--	--
MW-6	7/7/1993		41.59	18.68		22.91	--	<50	<0.5	<0.5	<0.5	<0.5	28.96	--	--	--	--	--	--	--	--
MW-6	9/21/1993		41.59	19.64		21.95	--	<50	<0.5	<0.5	<0.5	1.6	--	--	--	--	--	--	--	--	--
MW-6	12/17/1993		41.59	21.08		20.51	--	--	--	--	--	--	--	--	--	--	--	--	--	--	--
MW-6	12/23/1993		--	--		--	--	<50	<0.5	0.5	<0.5	0.6	13.95	--	--	--	--	--	--	--	--
MW-6	4/7/1994		41.59	21.27		20.32	--	<50	<0.5	<0.5	<0.5	<0.5	35.1	--	--	--	--	--	--	--	--
MW-6	7/6/1994		41.59	19.81		21.78	--	<50	<0.5	<0.5	<0.5	<0.5	--	--	--	--	--	--	--	--	--
MW-6	7/6/1994	e	41.59	19.81		21.78	--	<50	<0.5	<0.5	<0.5	<0.5	--	--	--	--	--	--	--	--	--
MW-6	10/7/1994		41.59	21.25		20.34	--	<50	<0.5	<0.5	<0.5	<0.5	24.3	--	--	--	--	--	--	--	--
MW-6	1/27/1995		41.59	12.39		29.20	--	<50	<0.5	<0.5	<0.5	<0.5	<1.0	--	--	--	--	--	--	--	--
MW-6	3/30/1995		41.59	11.34		30.25	--	<50	<0.50	<0.50	<0.50	<1.0	--	--	--	--	--	--	--	--	--
MW-6	6/20/1995		41.59	15.12		26.47	--	<50	<0.50	<0.50	<0.50	<1.0	--	--	--	--	--	--	--	--	--
MW-6	10/3/1995		41.59	20.68		20.91	--	<50	<0.50	<0.50	<0.50	<1.0	66	--	--	--	--	--	--	--	--
MW-6	12/6/1995		41.59	23.77		17.82	--	<50	<0.50	<0.50	<0.50	<1.0	45	--	--	--	--	--	--	--	--
MW-6	3/21/1996		41.59	11.55		30.04	--	<50	<0.5	<1.0	<1.0	<1.0	41	--	--	--	--	--	--	--	--
MW-6	6/21/1996		41.59	12.60		28.99	--	<50	<1.0	<1.0	<1.0	<1.0	<10	--	--	--	--	--	--	--	--
MW-6	9/6/1996		41.59	13.25		28.34	--	--	--	--	--	--	--	--	--	--	--	--	--	--	--
MW-6	9/9/1996		--	--		--	--	<50	<0.5	<1.0	<1.0	<1.0	22	--	--	--	--	--	--	--	--
MW-6	12/19/1996		41.59	11.45		30.14	--	<50	<0.5	<1.0	<1.0	<1.0	<10	--	--	--	--	--	--	--	--
MW-6	3/17/1997		41.59	10.80		30.79	--	--	--	--	--	--	--	--	--	--	--	--	--	--	--
MW-6	8/12/1997		41.59	13.11		28.48	--	--	--	--	--	--	--	--	--	--	--	--	--	--	--
MW-6	12/10/1997		41.59	13.84		27.75	--	--	--	--	--	--	--	--	--	--	--	--	--	--	--
MW-6	3/12/1998		41.59	11.17		30.42	--	--	--	--	--	--	--	--	--	--	--	--	--	--	--
MW-6	6/23/1998		41.59	13.27		28.32	--	--	--	--	--	--	--	--	--	--	--	--	--	--	--

**Table 1**  
**Summary of Groundwater Monitoring Data: Relative Water Elevations and Laboratory Analyses**  
**CA-11109**  
**4280 Foothill Blvd., Oakland, CA 94601**

Well ID	Date	Notes	TOC (ft msl)	DTW (ft)	DTP	GW Elev (ft msl)	DRO (µg/L)	GRO (µg/L)	Benzene (µg/L)	Toluene (µg/L)	Ethylbenzene (µg/L)	Xylenes (µg/L)	MTBE (µg/L)	TBA (µg/L)	DIPE (µg/L)	ETBE (µg/L)	TAME (µg/L)	Ethanol (µg/L)	1,2-DCA (µg/L)	EDB (µg/L)	
MW-6	3/31/1999		41.59	12.91		28.68	--	--	--	--	--	--	--	--	--	--	--	--	--	--	--
MW-6	8/25/1999		41.59	15.93		25.66	--	--	--	--	--	--	--	--	--	--	--	--	--	--	--
MW-6	3/9/2000		41.59	11.49		27.33	--	--	--	--	--	--	--	--	--	--	--	--	--	--	--
MW-6	3/8/2001		41.59	10.81		30.78	--	--	--	--	--	--	--	--	--	--	--	--	--	--	--
MW-6	3/8/2002		41.59	14.28		27.31	--	--	--	--	--	--	--	--	--	--	--	--	--	--	--
MW-6	3/18/2002		41.59	13.10		28.49	--	--	--	--	--	--	--	--	--	--	--	--	--	--	--
MW-6	3/11/2003		41.59	13.63		27.96	--	--	--	--	--	--	--	--	--	--	--	--	--	--	--
MW-6	12/9/2003		41.59	14.26		27.33	--	<50	<0.50	<0.50	<0.50	<0.50	12	<20	<0.50	<0.50	<0.50	<100	--	--	
MW-6	3/9/2004		41.59	11.87		29.72	--	<50	<0.50	<0.50	<0.50	<0.50	10	<20	<0.50	<0.50	<0.50	<100	0.58	<0.50	
MW-6	9/17/2004		41.59	16.45		25.14	--	--	--	--	--	--	--	--	--	--	--	--	--	--	--
MW-6	3/7/2005		41.59	13.65		27.94	--	<50	<0.50	<0.50	<0.50	<0.50	5.8	<20	<0.50	<0.50	<0.50	<100	<0.50	<0.50	
MW-6	9/6/2005		44.37	14.23		30.14	--	--	--	--	--	--	--	--	--	--	--	--	--	--	--
MW-6	3/6/2006		44.37	12.89		31.48	--	<50	<0.50	<0.50	<0.50	<0.50	8.1	<20	<0.50	<0.50	<0.50	<300	<0.50	<0.50	
MW-6	9/5/2006		44.37	14.10		30.27	--	--	--	--	--	--	--	--	--	--	--	--	--	--	--
MW-6	3/5/2007		44.37	11.43		32.94	--	<50	<0.50	<0.50	<0.50	<0.50	5.6	<20	<0.50	<0.50	<0.50	<300	<0.50	<0.50	
MW-6	9/7/2007		44.37	16.00		28.37	--	--	--	--	--	--	--	--	--	--	--	--	--	--	--
MW-6	3/6/2008		44.37	11.84		32.53	--	<50	<0.50	<0.50	<0.50	<0.50	1.9	<10	<0.50	<0.50	<0.50	<300	<0.50	<0.50	
MW-6	9/3/2008		44.37	16.24		28.13	--	--	--	--	--	--	--	--	--	--	--	--	--	--	--
MW-6	3/4/2009		44.37	11.68		32.69	--	<50	<0.50	<0.50	<0.50	<0.50	2.8	<10	<0.50	<0.50	<0.50	<300	<0.50	<0.50	
MW-6	9/30/2009		44.37	16.83		27.54	--	<50	<0.50	<0.50	<0.50	<0.50	4.4	<10	<0.50	<0.50	<0.50	<300	<0.50	<0.50	
MW-6	10/28/2009		44.37	15.63		28.74	--	--	--	--	--	--	--	--	--	--	--	--	--	--	--
MW-6	3/23/2010		44.37	11.48		32.89	--	<50	<0.50	<0.50	<0.50	<1.0	1.0	<4.0	<0.50	<0.50	<0.50	<100	<0.50	<0.50	
MW-6	6/10/2010		44.37	12.54		31.83	--	--	--	--	--	--	--	--	--	--	--	--	--	--	--
MW-6	9/16/2010		44.37	15.95		28.42	--	<50	<0.50	<0.50	<0.50	<1.0	0.80	<4.0	<0.50	<0.50	<0.50	<100	<0.50	<0.50	
MW-6	2/23/2011		44.37	12.34		32.03	--	--	--	--	--	--	<0.50	--	--	--	--	--	--	--	--
MW-6	9/28/2011		44.37	15.81		28.56	--	--	--	--	--	--	3.4	--	--	--	--	--	--	--	--
MW-6	3/8/2012		44.37	15.51		28.86	--	--	--	--	--	--	0.58	--	--	--	--	--	--	--	--
MW-6	9/5/2012		44.37	15.88		28.49	--	--	--	--	--	--	2.1	--	--	--	--	--	--	--	--
MW-6	3/20/2013		44.37	14.36	--	30.01	--	<50	<0.50	<0.50	<0.50	<1.0	<0.50	<4.0	<0.50	<0.50	<0.50	<250	<0.50	<0.50	
MW-6	9/20/2013		44.37	16.02	--	28.35	--	--	--	--	--	--	2.4	--	--	--	--	--	--	--	--
MW-7	10/3/1991		40.64	14.93		25.71	--	360	62	13	3.4	20	--	--	--	--	--	--	--	--	--
MW-7	10/15/1991		40.64	15.16		25.48	--	--	--	--	--	--	--	--	--	--	--	--	--	--	--
MW-7	12/4/1991		40.64	15.41		25.23	--	--	--	--	--	--	--	--	--	--	--	--	--	--	--
MW-7	12/16/1991		40.64	15.21		25.43	--	--	--	--	--	--	--	--	--	--	--	--	--	--	--
MW-7	1/6/1992		40.64	14.56		26.08	--	1,100	170	<0.5	24	23	--	--	--	--	--	--	--	--	--
MW-7	1/22/1992		40.64	14.63		26.01	--	--	--	--	--	--	--	--	--	--	--	--	--	--	--
MW-7	1/28/1992		40.64	14.73		25.91	--	--	--	--	--	--	--	--	--	--	--	--	--	--	--
MW-7	2/5/1992		40.64	14.58		26.06	--	--	--	--	--	--	--	--	--	--	--	--	--	--	--
MW-7	2/12/1992		40.64	13.94		26.70	--	--	--	--	--	--	--	--	--	--	--	--	--	--	--
MW-7	2/17/1992		40.64	13.10		27.54	--	--	--	--	--	--	--	--	--	--	--	--	--	--	--
MW-7	4/3/1992		40.64	12.66		27.98	--	--	--	--	--	--	--	--	--	--	--	--	--	--	--
MW-7	4/8/1992		40.64	12.77		27.87	--	750	150	<0.5	23	9.9	--	--	--	--	--	--	--	--	--
MW-7	4/14/1992		40.64	13.02		27.62	--	--	--	--	--	--	--	--	--	--	--	--	--	--	--
MW-7	4/29/1992		40.64	13.59		27.05	--	--	--	--	--	--	--	--	--	--	--	--	--	--	--
MW-7	5/7/1992		40.64	13.95		26.69	--	--	--	--	--	--	--	--	--	--	--	--	--	--	--
MW-7	7/3/1992		40.64	14.73		25.91	--	660	210	<2.5	33	8	--	--	--	--	--	--	--	--	--
MW-7	10/8/1992		40.64	15.75		24.89	--	320	49	1.4	13	6.2	--	--	--	--	--	--	--	--	--
MW-7	12/31/1992		40.64	13.57		27.07	--	900	100	<2.5	28	4.3	--	--	--	--	--	--	--	--	--
MW-7	4/21/1993		40.64	14.56		26.08	--	510	83	1.2	10	5.8	--	--	--	--	--	--	--	--	--
MW-7	7/7/1993	f	40.32	13.40		26.92	--	1,100	160	2	27	4	10.84	--	--	--	--	--	--	--	--
MW-7	7/7/1993	e	40.32	13.40		26.92	--	1,100	170	1.9	29	2.84	9.84	--	--	--	--	--	--	--	--
MW-7	9/21/1993		40.32	14.40		25.92	--	690	150	3.1	26	5.7	--	--	--	--	--	--	--	--	--
MW-7	9/21/1993	e	40.32	14.40		25.92	--	640	140	1.7	23	2.4	--	--	--	--	--	--	--	--	--
MW-7	12/17/1993		40.32	13.65		26.67	--	--	--	--	--	--	--	--	--	--	--	--	--	--	--
MW-7	12/23/1993		40.32	13.65		26.67	--	--	--	--	--	--	--	--	--	--	--	--	--	--	--
MW-7	4/7/1994		40.32	30.62		9.70	--	250	64	1.2	9	1.8	7.81	--	--	--	--	--	--	--	--
MW-7	7/6/1994		40.32	16.88		23.44	--	410	94	1.3	10	3.5	<5.0	--	--	--	--	--	--	--	--
MW-7	10/7/1994		40.32	25.59		14.73	--	<50	9.2	<0.5	<0.5	<0.5	<5.0	--	--	--	--	--	--	--	--
MW-7	1/27/1995		40.32	9.82		30.50	--	810	570	3	60	17	--	--	--	--	--	--	--	--	--
MW-7	1/27/1995	e	40.32	9.82		30.50	--	930	620	4	77	21	--	--	--	--	--	--	--	--	--
MW-7	3/30/1995		40.32	9.15		31.17	--	180	65	0.53	2	<1.0	--	--	--	--	--	--	--	--	--
MW-7	6/20/1995		40.32	11.38		28.94	--	2,800	980	<5.0	<5.0	43	--	--	--	--	--	--	--	--	--
MW-7	10/3/1995		40.32	29.95		10.37	--	<50	<0.50	<0.50	<0.50	<1.0	<5.0	--	--	--	--	--	--	--	--
MW-7	12/6/1995		40.32	29.85		10.47	--	<50	<0.50	<0.50	<0.50	<1.0	<5.0	--	--	--	--	--	--	--	--
MW-7	3/21/1996		40.32	9.76		30.56	--	1,000	390	2	40	13	<10	--	--	--	--	--	--	--	--
MW-7	6/21/1996		40.32	11.01		29.31	--	<250	40	<0.50	<0.50	<5.0	<5.0	--	--	--	--	--	--	--	--
MW-7	9/6/1996		40.32	11.68		28.64	--	--	--	--	--	--	--	--	--	--	--	--	--	--	--
MW-7	9/9/1996		--	--		--	--	<250	13	<5.0	<5.0	<5.0	<5.0	--	--	--	--	--	--	--	--
MW-7	12/19/1996		40.32	10.78		29.54	--	70	1.2	<1.0	1	<1.0	<10	--	--	--	--	--	--	--	--
MW-7	3/17/1997		40.32	9.96		30.36	--	--	--	--	--	--	--	--	--	--	--	--	--	--	--

Table 1  
 Summary of Groundwater Monitoring Data: Relative Water Elevations and Laboratory Analyses  
 CA-11109  
 4280 Foothill Blvd., Oakland, CA 94601

Well ID	Date	Notes	TOC (ft msl)	DTW (ft)	DTP	GW Elev (ft msl)	DRO (µg/L)	GRO (µg/L)	Benzene (µg/L)	Toluene (µg/L)	Ethylbenzene (µg/L)	Xylenes (µg/L)	MTBE (µg/L)	TBA (µg/L)	DIPE (µg/L)	ETBE (µg/L)	TAME (µg/L)	Ethanol (µg/L)	1,2-DCA (µg/L)	EDB (µg/L)	
MW-7	8/12/1997		40.32	11.44		28.88	--	--	--	--	--	--	--	--	--	--	--	--	--	--	--
MW-7	12/10/1997		40.32	10.42		29.90	--	--	--	--	--	--	--	--	--	--	--	--	--	--	--
MW-7	3/12/1998		40.32	9.51		30.81	--	--	--	--	--	--	--	--	--	--	--	--	--	--	--
MW-7	6/23/1998		40.32	9.98		30.34	--	--	--	--	--	--	--	--	--	--	--	--	--	--	--
MW-7	3/31/1999		40.32	10.38		29.94	--	--	--	--	--	--	--	--	--	--	--	--	--	--	--
MW-7	8/25/1999		40.32	12.38		27.94	--	--	--	--	--	--	--	--	--	--	--	--	--	--	--
MW-7	3/9/2000		40.32	8.48		31.84	--	--	--	--	--	--	--	--	--	--	--	--	--	--	--
MW-7	3/8/2001		40.32	8.37		31.95	--	--	--	--	--	--	--	--	--	--	--	--	--	--	--
MW-7	3/18/2002		40.32	9.94		30.38	--	--	--	--	--	--	--	--	--	--	--	--	--	--	--
MW-7	3/11/2003		40.32	11.26		29.06	--	--	--	--	--	--	--	--	--	--	--	--	--	--	--
MW-7	12/9/2003		40.32	12.76		27.56	--	270	26	<0.50	<0.50	<0.50	8.7	<20	<0.50	<0.50	<0.50	<100	--	--	
MW-7	3/9/2004		40.32	10.91		29.41	--	320	49	0.73	1.8	0.59	6.9	<20	<0.50	<0.50	<0.50	<100	1.2	<0.50	
MW-7	9/17/2004		40.32	13.20		27.12	--	330	17	<0.50	<0.50	<0.50	7.0	<20	<0.50	<0.50	<0.50	<100	<0.50	<0.50	
MW-7	3/7/2005		40.32	8.18		32.14	--	340	41	0.79	0.79	0.73	7.2	<20	<0.50	<0.50	<0.50	<100	<0.50	<0.50	
MW-7	9/6/2005		43.10	11.80		31.30	--	1,100	130	1.2	1.8	<1.5	16	30	0.60	<0.50	<0.50	<150	<0.50	<0.50	
MW-7	3/6/2006		43.10	8.39		34.71	--	440	31	0.78	0.74	0.81	8.3	<20	<0.50	<0.50	<0.50	<300	<0.50	<0.50	
MW-7	9/5/2006		43.10	11.45		31.65	--	2,000	260	3.1	5.9	<2.5	12	<100	<2.5	<2.5	<2.5	<1,500	<2.5	<2.5	
MW-7	3/5/2007		43.10	9.31		33.79	--	2,200	110	2.2	4.0	1.8	7.6	<40	<1.0	<1.0	<1.0	<600	<1.0	<1.0	
MW-7	9/7/2007		43.10	12.18		30.92	--	220	8.4	<0.50	<0.50	<0.50	1.2	<20	<0.50	<0.50	<0.50	<300	<0.50	<0.50	
MW-7	3/6/2008		43.10	10.05		33.05	--	1,800	54	1.2	1.1	<1.0	<1.0	<20	<1.0	<1.0	<1.0	<600	<1.0	<1.0	
MW-7	9/3/2008		43.10	13.17		29.93	--	540	13	0.69	<0.50	<0.50	5.5	17	<0.50	<0.50	<0.50	<300	<0.50	<0.50	
MW-7	3/4/2009		43.10	8.25		34.85	--	720	15	0.59	0.53	<0.50	3.4	12	<0.50	<0.50	<0.50	<300	<0.50	<0.50	
MW-7	9/30/2009		43.10	12.70		30.40	--	1,200	44	1.0	0.74	0.79	3.3	<10	<0.50	<0.50	<0.50	<300	<0.50	<0.50	
MW-7	10/28/2009		43.10	11.17		31.93	--	--	--	--	--	--	--	--	--	--	--	--	--	--	
MW-7	3/23/2010		43.10	9.28		33.82	--	610	11	<0.50	<0.50	<1.0	<0.50	12	<0.50	<0.50	<0.50	<100	<0.50	<0.50	
MW-7	6/10/2010		43.10	10.24		32.86	--	--	--	--	--	--	--	--	--	--	--	--	--	--	
MW-7	9/16/2010		43.10	12.16		30.94	--	4,700	130	<5.0	7.4	<10	<5.0	<40	<5.0	<5.0	<5.0	<1,000	<5.0	<5.0	
MW-7	2/23/2011		43.10	9.62		33.48	--	2,200	26	1.1	1.4	1.6	4.0	<4.0	<0.50	<0.50	<0.50	<250	<0.50	<0.50	
MW-7	9/28/2011		43.10	11.80		31.30	--	3,800	380	4.8	28	4.3	9.5	13	<0.50	<0.50	<0.50	<250	<0.50	<0.50	
MW-7	3/8/2012		43.10	11.69		31.41	--	560	1.4	<0.50	<0.50	<1.0	2.3	<4.0	<0.50	<0.50	<0.50	<250	<0.50	<0.50	
MW-7	9/5/2012		43.10	11.60		31.50	--	830	16	1.3	0.66	1.4	3.0	<4.0	<0.50	<0.50	<0.50	<250	<0.50	<0.50	
MW-7	3/20/2013		43.10	10.88	--	32.22	--	--	--	--	3.4	--	--	--	--	--	--	--	--	--	
MW-7	9/20/2013		43.10	11.50	--	31.60	--	580	<0.50	<0.50	<0.50	<1.0	2.3	<10	<0.50	<0.50	<0.50	<250	<0.50	<0.50	
MW-8	10/3/1991		38.18	22.37		15.81	--	<50	<0.3	0.6	<0.3	0.9	--	--	--	--	--	--	--	--	
MW-8	10/15/1991		38.18	22.70		15.48	--	--	--	--	--	--	--	--	--	--	--	--	--	--	
MW-8	12/4/1991		38.18	22.44		15.74	--	--	--	--	--	--	--	--	--	--	--	--	--	--	
MW-8	12/16/1991		38.18	22.47		15.71	--	--	--	--	--	--	--	--	--	--	--	--	--	--	
MW-8	1/6/1992		38.18	21.94		16.24	--	<50	<0.5	<0.5	<0.5	<0.5	--	--	--	--	--	--	--	--	
MW-8	1/22/1992		38.18	21.44		16.74	--	--	--	--	--	--	--	--	--	--	--	--	--	--	
MW-8	1/28/1992		38.18	21.20		16.98	--	--	--	--	--	--	--	--	--	--	--	--	--	--	
MW-8	2/5/1992		38.18	20.88		17.30	--	--	--	--	--	--	--	--	--	--	--	--	--	--	
MW-8	2/12/1992		38.18	20.54		17.64	--	--	--	--	--	--	--	--	--	--	--	--	--	--	
MW-8	2/17/1992		38.18	19.99		18.19	--	--	--	--	--	--	--	--	--	--	--	--	--	--	
MW-8	4/3/1992		38.18	16.75		21.43	--	--	--	--	--	--	--	--	--	--	--	--	--	--	
MW-8	4/8/1992		38.18	16.57		21.61	--	<50	<0.5	<0.5	<0.5	<0.5	--	--	--	--	--	--	--	--	
MW-8	4/29/1992		38.18	18.61		19.57	--	--	--	--	--	--	--	--	--	--	--	--	--	--	
MW-8	5/7/1992		38.18	18.41		19.77	--	--	--	--	--	--	--	--	--	--	--	--	--	--	
MW-8	7/3/1992		38.18	20.35		17.83	--	<50	<0.5	<0.5	<0.5	<0.5	--	--	--	--	--	--	--	--	
MW-8	10/8/1992		38.18	21.74		16.44	--	--	--	--	--	--	--	--	--	--	--	--	--	--	
MW-8	12/31/1992		38.18	19.09		19.09	--	<50	<0.5	<0.5	<0.5	<0.5	--	--	--	--	--	--	--	--	
MW-8	4/21/1993		38.18	18.92		19.26	--	<50	<0.5	<0.5	<0.5	<0.5	--	--	--	--	--	--	--	--	
MW-8	7/7/1993		38.18	17.76		20.42	--	<50	<0.5	<0.5	<0.5	<0.5	<5.0	--	--	--	--	--	--	--	
MW-8	9/21/1993		38.18	19.71		18.47	--	<50	2.9	2.2	2.2	7.1	--	--	--	--	--	--	--	--	
MW-8	12/17/1993		38.18	21.33		16.85	--	--	--	--	--	--	--	--	--	--	--	--	--	--	
MW-8	12/23/1993		38.18	21.33		16.85	--	<50	<0.5	<0.5	<0.5	0.6	<5.0	--	--	--	--	--	--	--	
MW-8	4/7/1994		38.18	21.51		16.67	--	<50	<0.5	<0.5	<0.5	<0.5	<5.0	--	--	--	--	--	--	--	
MW-8	7/6/1994		38.18	17.41		20.77	--	<50	<0.5	<0.5	<0.5	<0.5	<5.0	--	--	--	--	--	--	--	
MW-8	10/7/1994		38.18	19.20		18.98	--	<50	<0.5	<0.5	<0.5	<0.5	<5.0	--	--	--	--	--	--	--	
MW-8	1/27/1995		38.18	12.25		25.93	--	<50	<0.5	<0.5	<0.5	<1.0	--	--	--	--	--	--	--	--	
MW-8	3/30/1995		38.18	10.35		27.83	--	<50	<0.50	<0.50	<0.50	<1.0	--	--	--	--	--	--	--	--	
MW-8	6/20/1995		38.18	13.37		24.81	--	<50	<0.50	<0.50	<0.50	<1.0	--	--	--	--	--	--	--	--	
MW-8	12/6/1995		38.18	18.42		19.76	--	<50	<0.50	<0.50	<0.50	<1.0	47	--	--	--	--	--	--	--	
MW-8	6/21/1996		38.18	13.03		25.15	--	<50	<0.5	<1.0	<1.0	<1.0	<10	--	--	--	--	--	--	--	
MW-8	9/6/1996		38.18	13.70		24.48	--	--	--	--	--	--	--	--	--	--	--	--	--	--	
MW-8	9/9/1996		--	--		--	--	<50	<0.5	<1.0	<1.0	<1.0	<10	--	--	--	--	--	--	--	
MW-8	12/19/1996		38.18	11.93		26.25	--	<50	<0.5	<1.0	<1.0	<1.0	<10	--	--	--	--	--	--	--	
MW-8	3/17/1997		38.18	11.29		26.89	--	--	--	--	--	--	--	--	--	--	--	--	--	--	
MW-8	8/12/1997		38.18	13.73		24.45	--	--	--	--	--	--	--	--	--	--	--	--	--	--	
MW-8	12/10/1997		38.18	11.88		26.30	--	--	--	--	--	--	--	--	--	--	--	--	--	--	
MW-8	3/12/1998		38.18	11.89		26.29	--	--	--	--	--	--	--	--	--	--	--	--	--	--	

**Table 1**  
**Summary of Groundwater Monitoring Data: Relative Water Elevations and Laboratory Analyses**  
**CA-11109**  
**4280 Foothill Blvd., Oakland, CA 94601**

Well ID	Date	Notes	TOC (ft msl)	DTW (ft)	DTP	GW Elev (ft msl)	DRO (µg/L)	GRO (µg/L)	Benzene (µg/L)	Toluene (µg/L)	Ethylbenzene (µg/L)	Xylenes (µg/L)	MTBE (µg/L)	TBA (µg/L)	DIPE (µg/L)	ETBE (µg/L)	TAME (µg/L)	Ethanol (µg/L)	1,2-DCA (µg/L)	EDB (µg/L)	
MW-8	6/23/1998		38.18	11.33		26.85	--	--	--	--	--	--	--	--	--	--	--	--	--	--	--
MW-8	3/31/1999		38.18	12.68		25.50	--	--	--	--	--	--	--	--	--	--	--	--	--	--	--
MW-8	8/25/1999		38.18	14.93		23.25	--	--	--	--	--	--	--	--	--	--	--	--	--	--	--
MW-8	3/9/2000		38.18	9.14		29.04	--	--	--	--	--	--	--	--	--	--	--	--	--	--	--
MW-8	3/8/2001		38.18	8.41		29.77	--	--	--	--	--	--	--	--	--	--	--	--	--	--	--
MW-8	3/8/2002		38.18	11.18		27.00	--	--	--	--	--	--	--	--	--	--	--	--	--	--	--
MW-8	3/18/2002		38.18	10.72		27.46	--	--	--	--	--	--	--	--	--	--	--	--	--	--	--
MW-8	3/11/2003		38.18	10.46		27.72	--	--	--	--	--	--	--	--	--	--	--	--	--	--	--
MW-8	3/9/2004		38.18	9.79		28.39	--	<50	<0.50	<0.50	<0.50	<0.50	0.50	<20	<0.50	<0.50	<0.50	<100	<0.50	<0.50	
MW-8	9/17/2004		38.18	15.35		22.83	--	--	--	--	--	--	--	--	--	--	--	--	--	--	--
MW-8	3/7/2005		38.18	7.94		30.24	--	<50	<0.50	<0.50	<0.50	<0.50	<0.50	<20	<0.50	<0.50	<0.50	<100	<0.50	<0.50	
MW-8	9/6/2005		40.95	13.06		27.89	--	--	--	--	--	--	--	--	--	--	--	--	--	--	--
MW-8	3/6/2006		40.95	9.26		31.69	--	<50	<0.50	<0.50	<0.50	<0.50	0.59	<20	<0.50	<0.50	<0.50	<300	<0.50	<0.50	
MW-8	9/5/2006		40.95	12.61		28.34	--	--	--	--	--	--	--	--	--	--	--	--	--	--	--
MW-8	3/5/2007		40.95	9.12		31.83	--	<50	<0.50	<0.50	<0.50	0.53	<0.50	<20	<0.50	<0.50	<0.50	<300	<0.50	<0.50	
MW-8	9/7/2007		40.95	13.56		27.39	--	--	--	--	--	--	--	--	--	--	--	--	--	--	--
MW-8	3/6/2008		40.95	9.80		31.15	--	<50	<0.50	<0.50	<0.50	<0.50	<0.50	<10	<0.50	<0.50	<0.50	<300	<0.50	<0.50	
MW-8	9/3/2008		40.95	14.20		26.75	--	--	--	--	--	--	--	--	--	--	--	--	--	--	--
MW-8	3/4/2009		40.95	9.51		31.44	--	<50	<0.50	<0.50	<0.50	<0.50	<0.50	<10	<0.50	<0.50	<0.50	<300	<0.50	<0.50	
MW-8	9/30/2009		40.95	14.92		26.03	--	--	--	--	--	--	--	--	--	--	--	--	--	--	--
MW-8	10/28/2009		40.95	13.56		27.39	--	--	--	--	--	--	--	--	--	--	--	--	--	--	--
MW-8	6/10/2010		40.95	11.06		29.89	--	--	--	--	--	--	--	--	--	--	--	--	--	--	--
MW-8	9/16/2010		40.95	14.41		26.54	--	<50	<0.50	<0.50	<0.50	<1.0	<0.50	<4.0	<0.50	<0.50	<0.50	<100	<0.50	<0.50	
MW-8	9/28/2011		40.95	13.87		27.08	--	--	--	--	--	--	--	--	--	--	--	--	--	--	--
MW-8	3/8/2012		40.95	13.27		27.68	--	--	--	--	--	--	--	--	--	--	--	--	--	--	--
MW-8	9/5/2012		40.95	--		--	--	--	--	--	--	--	--	--	--	--	--	--	--	--	--
MW-8	3/20/2013		40.95	11.90	--	29.05	--	--	--	--	--	--	--	--	--	--	--	--	--	--	--
MW-8	9/20/2013		40.95	13.88	--	27.07	--	--	--	--	--	--	--	--	--	--	--	--	--	--	--
MW-9	10/3/1991		41.25	14.12		27.13	--	<50	<0.3	0.4	<0.3	<0.3	--	--	--	--	--	--	--	--	--
MW-9	10/15/1991		41.25	14.27		26.98	--	--	--	--	--	--	--	--	--	--	--	--	--	--	--
MW-9	12/4/1991		41.25	13.84		27.41	--	--	--	--	--	--	--	--	--	--	--	--	--	--	--
MW-9	12/16/1991		41.25	14.18		27.07	--	--	--	--	--	--	--	--	--	--	--	--	--	--	--
MW-9	1/6/1992		41.25	13.42		27.83	--	<50	<0.5	<0.5	<0.5	0.9	--	--	--	--	--	--	--	--	--
MW-9	1/22/1992		41.25	13.75		27.50	--	--	--	--	--	--	--	--	--	--	--	--	--	--	--
MW-9	1/28/1992		41.25	14.76		26.49	--	--	--	--	--	--	--	--	--	--	--	--	--	--	--
MW-9	2/5/1992		41.25	13.38		27.87	--	--	--	--	--	--	--	--	--	--	--	--	--	--	--
MW-9	2/12/1992		41.25	11.86		29.39	--	--	--	--	--	--	--	--	--	--	--	--	--	--	--
MW-9	2/17/1992		41.25	10.78		30.47	--	--	--	--	--	--	--	--	--	--	--	--	--	--	--
MW-9	4/3/1992		41.25	11.63		29.62	--	--	--	--	--	--	--	--	--	--	--	--	--	--	--
MW-9	4/8/1992		41.25	12.25		29.00	--	<50	<0.5	<0.5	<0.5	<0.5	--	--	--	--	--	--	--	--	--
MW-9	4/14/1992		41.25	12.32		28.93	--	--	--	--	--	--	--	--	--	--	--	--	--	--	--
MW-9	4/29/1992		41.25	13.07		28.18	--	--	--	--	--	--	--	--	--	--	--	--	--	--	--
MW-9	5/7/1992		41.25	14.43		26.82	--	--	--	--	--	--	--	--	--	--	--	--	--	--	--
MW-9	7/3/1992		41.25	13.85		27.40	--	<50	<0.5	<0.5	<0.5	<0.5	--	--	--	--	--	--	--	--	--
MW-9	10/8/1992		41.25	14.89		26.36	--	<50	<0.5	<0.5	<0.5	<0.5	--	--	--	--	--	--	--	--	--
MW-9	12/31/1992		41.25	11.90		29.35	--	<50	<0.5	<0.5	<0.5	<0.5	--	--	--	--	--	--	--	--	--
MW-9	4/21/1993		41.25	13.68		27.57	--	<50	<0.5	<0.5	<0.5	<0.5	--	--	--	--	--	--	--	--	--
MW-9	7/7/1993		41.25	13.12		28.13	--	<50	<0.5	<0.5	<0.5	<0.5	<5.0	--	--	--	--	--	--	--	--
MW-9	9/21/1993		41.25	14.00		27.25	--	<50	<0.5	<0.5	<0.5	0.9	--	--	--	--	--	--	--	--	--
MW-9	12/17/1993		41.25	12.98		28.27	--	--	--	--	--	--	--	--	--	--	--	--	--	--	--
MW-9	12/23/1993		--	--		--	--	<50	<0.5	<0.5	<0.5	0.9	<5.0	--	--	--	--	--	--	--	--
MW-9	4/7/1994		41.25	13.24		28.01	--	<50	<0.5	<0.5	<0.5	<0.5	<5.0	--	--	--	--	--	--	--	--
MW-9	7/6/1994		41.25	13.77		27.48	--	<50	<0.5	<0.5	<0.5	<0.5	--	--	--	--	--	--	--	--	--
MW-9	10/7/1994		41.25	14.60		26.65	--	<50	<0.5	<0.5	<0.5	<0.5	<5.0	--	--	--	--	--	--	--	--
MW-9	1/27/1995		41.25	8.47		32.78	--	<50	<0.5	<0.5	<0.5	<1.0	--	--	--	--	--	--	--	--	--
MW-9	3/30/1995		41.25	8.19		33.06	--	<50	<0.50	<0.50	<0.50	<1.0	--	--	--	--	--	--	--	--	--
MW-9	6/20/1995		41.25	11.25		30.00	--	<50	<0.50	<0.50	<0.50	<1.0	--	--	--	--	--	--	--	--	--
MW-9	10/3/1995		41.25	14.68		26.57	--	<50	<0.50	<0.50	<0.50	<1.0	<5.0	--	--	--	--	--	--	--	--
MW-9	12/6/1995		41.25	16.07		25.18	--	<50	<0.50	<0.50	<0.50	<1.0	46	--	--	--	--	--	--	--	--
MW-9	3/21/1996		41.25	9.60		31.65	--	<50	<0.5	<1.0	<1.0	<1.0	<10	--	--	--	--	--	--	--	--
MW-9	6/21/1996		41.25	10.86		30.39	--	<50	<0.5	<1.0	<1.0	<1.0	<10	--	--	--	--	--	--	--	--
MW-9	9/6/1996		41.25	11.52		29.73	--	--	--	--	--	--	--	--	--	--	--	--	--	--	--
MW-9	9/9/1996		--	--		--	--	<50	<0.5	<1.0	<1.0	<1.0	21	--	--	--	--	--	--	--	--
MW-9	12/19/1996		41.25	10.43		30.82	--	<50	<0.5	<1.0	<1.0	<1.0	<10	--	--	--	--	--	--	--	--
MW-9	3/17/1997		41.25	9.87		31.38	--	--	--	--	--	--	--	--	--	--	--	--	--	--	--
MW-9	8/12/1997		41.25	11.44		29.81	--	--	--	--	--	--	--	--	--	--	--	--	--	--	--
MW-9	12/10/1997		41.25	10.44		30.81	--	--	--	--	--	--	--	--	--	--	--	--	--	--	--
MW-9	3/12/1998		41.25	9.50		31.75	--	--	--	--	--	--	--	--	--	--	--	--	--	--	--
MW-9	6/23/1998		41.25	10.06		31.19	--	--	--	--	--	--	--	--	--	--	--	--	--	--	--
MW-9	3/31/1999		41.25	9.06		32.19	--	--	--	--	--	--	--	--	--	--	--	--	--	--	--

Table 1  
 Summary of Groundwater Monitoring Data: Relative Water Elevations and Laboratory Analyses  
 CA-11109  
 4280 Foothill Blvd., Oakland, CA 94601

Well ID	Date	Notes	TOC (ft msl)	DTW (ft)	DTP	GW Elev (ft msl)	DRO (µg/L)	GRO (µg/L)	Benzene (µg/L)	Toluene (µg/L)	Ethylbenzene (µg/L)	Xylenes (µg/L)	MTBE (µg/L)	TBA (µg/L)	DIPE (µg/L)	ETBE (µg/L)	TAME (µg/L)	Ethanol (µg/L)	1,2-DCA (µg/L)	EDB (µg/L)	
MW-9	8/25/1999		41.25	12.00		29.25	--	--	--	--	--	--	--	--	--	--	--	--	--	--	--
MW-9	3/9/2000		41.25	10.57		30.68	--	--	--	--	--	--	--	--	--	--	--	--	--	--	--
MW-9	3/8/2001		41.25	9.73		31.52	--	--	--	--	--	--	--	--	--	--	--	--	--	--	--
MW-9	3/8/2002		41.25	11.89		29.36	--	--	--	--	--	--	--	--	--	--	--	--	--	--	--
MW-9	3/18/2002		41.25	9.68		31.57	--	--	--	--	--	--	--	--	--	--	--	--	--	--	--
MW-9	3/11/2003		41.25	9.21		32.04	--	--	--	--	--	--	--	--	--	--	--	--	--	--	--
MW-9	3/9/2004		41.25	10.99		30.26	--	<50	<0.50	<0.50	<0.50	<0.50	<0.50	<20	<0.50	<0.50	<0.50	<100	<0.50	<0.50	<0.50
MW-9	9/17/2004		41.25	13.35		27.90	--	--	--	--	--	--	--	--	--	--	--	--	--	--	--
MW-9	3/7/2005		41.25	8.94		32.31	--	<50	<0.50	<0.50	<0.50	<0.50	<0.50	<20	<0.50	<0.50	<0.50	<100	<0.50	<0.50	<0.50
MW-9	9/6/2005		44.06	11.99		32.07	--	--	--	--	--	--	--	--	--	--	--	--	--	--	--
MW-9	3/6/2006		44.06	8.26		35.80	--	<50	<0.50	<0.50	<0.50	<0.50	<0.50	<20	<0.50	<0.50	<0.50	<300	<0.50	<0.50	<0.50
MW-9	9/5/2006		44.06	11.63		32.43	--	--	--	--	--	--	--	--	--	--	--	--	--	--	--
MW-9	3/5/2007		44.06	9.33		34.73	--	<50	<0.50	<0.50	<0.50	<0.50	<0.50	<20	<0.50	<0.50	<0.50	<300	<0.50	<0.50	<0.50
MW-9	9/7/2007		44.06	12.28		31.78	--	--	--	--	--	--	--	--	--	--	--	--	--	--	--
MW-9	3/6/2008		44.06	10.11		33.95	--	<50	<0.50	<0.50	<0.50	<0.50	<0.50	<10	<0.50	<0.50	<0.50	<300	<0.50	<0.50	<0.50
MW-9	9/3/2008		44.06	13.49		30.57	--	--	--	--	--	--	--	--	--	--	--	--	--	--	--
MW-9	3/4/2009		44.06	8.15		35.91	--	<50	<0.50	<0.50	<0.50	<0.50	<0.50	<10	<0.50	<0.50	<0.50	<300	<0.50	<0.50	<0.50
MW-9	9/30/2009		44.06	12.98		31.08	--	--	--	--	--	--	--	--	--	--	--	--	--	--	--
MW-9	10/28/2009		44.06	11.98		32.08	--	--	--	--	--	--	--	--	--	--	--	--	--	--	--
MW-9	3/23/2010		44.06	10.59		33.47	--	<50	<0.50	<0.50	<0.50	<1.0	<0.50	<4.0	<0.50	<0.50	<0.50	<100	<0.50	<0.50	<0.50
MW-9	6/10/2010		44.06	10.25		33.81	--	--	--	--	--	--	--	--	--	--	--	--	--	--	--
MW-9	2/23/2011		44.06	9.71		34.35	--	--	--	--	--	--	--	--	--	--	--	--	--	--	--
MW-9	9/28/2011		44.06	11.66		32.40	--	--	--	--	--	--	--	--	--	--	--	--	--	--	--
MW-9	3/8/2012		44.06	11.56		32.50	--	--	--	--	--	--	--	--	--	--	--	--	--	--	--
MW-9	9/5/2012		44.06	11.18		32.88	--	--	--	--	--	--	--	--	--	--	--	--	--	--	--
MW-9	3/20/2013		44.06	10.00	--	34.06	--	--	--	--	--	--	--	--	--	--	--	--	--	--	--
MW-9	9/20/2013		44.06	10.91	--	33.15	--	--	--	--	--	--	--	--	--	--	--	--	--	--	--
MW-10	6/16/2009	g	39.78	8.60		31.19	--	--	--	--	--	--	--	--	--	--	--	--	--	--	--
MW-10	7/22/2009	g	39.78	9.68		30.11	--	--	--	--	--	--	--	--	--	--	--	--	--	--	--
MW-10	8/6/2009		39.78	9.48		30.30	--	--	--	--	--	--	--	--	--	--	--	--	--	--	--
MW-10	9/30/2009	g	39.78	9.69		30.10	--	--	--	--	--	--	--	--	--	--	--	--	--	--	--
MW-10	10/28/2009		39.78	8.53		31.25	--	62,000	8,300	5,300	3,100	12,000	<50	<400	<50	<50	<50	<10,000	<50	<50	<50
MW-10	3/23/2010	b	39.78	7.70		32.08	--	59,000	6,500	4,800	2,300	9,700	<100	<800	<100	<100	<100	<20,000	<100	<100	<100
MW-10	6/10/2010	g	39.78	8.93		30.86	--	--	--	--	--	--	--	--	--	--	--	--	--	--	--
MW-10	9/16/2010	g	39.78	9.69		30.10	--	--	--	--	--	--	--	--	--	--	--	--	--	--	--
MW-10	2/23/2011		39.78	7.99		31.79	--	61,000	7,000	5,300	2,800	12,000	<100	<800	<100	<100	<100	<50,000	<100	<100	<100
MW-10	9/28/2011	g	39.78	10.36		29.64	--	--	--	--	--	--	--	--	--	--	--	--	--	--	--
MW-10	3/8/2012	g	39.78	10.51		29.51	--	--	--	--	--	--	--	--	--	--	--	--	--	--	--
MW-10	9/5/2012	g	39.78	10.25		29.54	--	--	--	--	--	--	--	--	--	--	--	--	--	--	--
MW-10	3/20/2013	g	39.78	9.48	9.47	30.31	--	--	--	--	--	--	--	--	--	--	--	--	--	--	--
MW-10	9/20/2013	b, i	39.78	10.50	--	29.28	--	--	--	--	--	--	--	--	--	--	--	--	--	--	--
MW-11	9/30/2009		40.04	10.55		29.49	--	30,000	850	1,400	1,000	3,700	27	<200	<10	<10	<10	<6,000	<10	<10	<10
MW-11	10/28/2009		40.04	8.00		32.04	--	27,000	1,100	2,300	1,500	5,800	<50	<400	<50	<50	<50	<10,000	<50	<50	<50
MW-11	3/23/2010		40.04	7.25		32.79	--	21,000	530	830	790	2,200	<25	<200	<25	<25	<25	<5,000	<25	<25	<25
MW-11	6/10/2010	b	40.04	9.65		30.39	--	--	--	--	--	--	--	--	--	--	--	--	--	--	--
MW-11	9/16/2010		40.04	9.42		30.62	--	--	--	--	--	--	--	--	--	--	--	--	--	--	--
MW-11	2/23/2011		40.04	7.60		32.44	--	10,000	380	260	330	540	7.2	<40	<5.0	<5.0	<5.0	<2,500	<5.0	<5.0	<5.0
MW-11	9/28/2011		40.04	9.88		30.16	--	5,900	230	92	260	370	6.4	26	<2.5	<2.5	<2.5	<1,300	<2.5	<2.5	<2.5
MW-11	3/8/2012		40.04	9.71		30.33	--	5,000	280	170	250	380	<5.0	<40	<5.0	<5.0	<5.0	<2,500	<5.0	<5.0	<5.0
MW-11	9/5/2012		40.04	10.60		29.44	--	22,000	1,000	1,600	1,200	4,500	6.2	<40	<5.0	<5.0	<5.0	<2,500	<5.0	<5.0	<5.0
MW-11	3/20/2013	i	40.04	9.54	--	30.50	--	16,000	250	620	680	2,200	<10	<80	<10	<10	<10	<5,000	<10	<10	<10
MW-11	9/20/2013		40.04	10.55	--	29.49	--	10,000	120	130	320	720	<10	<200	<10	<10	<10	<5000	<10	<10	<10
MW-12	9/30/2009		40.32	11.02		29.32	--	--	--	--	--	--	--	--	--	--	--	--	--	--	--
MW-12	10/28/2009		40.32	10.40		29.92	--	43,000	5,800	800	2,900	6,800	<50	<400	<50	<50	<50	<10,000	<50	<50	<50
MW-12	3/23/2010	b	40.32	11.46		28.86	--	39,000	4,800	1,000	3,100	6,400	<25	<200	<25	<25	<25	<5,000	<25	<25	<25
MW-12	6/10/2010	b	40.32	11.35		29.87	--	--	--	--	--	--	--	--	--	--	--	--	--	--	--
MW-12	9/16/2010	g	40.32	11.54		28.80	--	--	--	--	--	--	--	--	--	--	--	--	--	--	--
MW-12	2/23/2011	g	40.32	10.80		29.60	--	--	--	--	--	--	--	--	--	--	--	--	--	--	--
MW-12	9/28/2011	g	40.32	11.48		28.99	--	--	--	--	--	--	--	--	--	--	--	--	--	--	--
MW-12	3/8/2012	g	40.32	11.92		28.64	--	--	--	--	--	--	--	--	--	--	--	--	--	--	--
MW-12	9/5/2012	g	40.32	11.63		29.76	--	--	--	--	--	--	--	--	--	--	--	--	--	--	--
MW-12	3/20/2013	g	40.32	10.13	10.09	30.22	--	--	--	--	--	--	--	--	--	--	--	--	--	--	--
MW-12	9/20/2013	b, i	40.32	10.92	--	29.40	--	--	--	--	--	--	--	--	--	--	--	--	--	--	--
QC-2	10/8/1992	h	--	--		--	--	<50	<0.5	<0.5	<0.5	<0.5	<0.5	--	--	--	--	--	--	--	--
QC-2	12/31/1992	h	--	--		--	--	<50	<0.5	<0.5	<0.5	<0.5	<0.5	--	--	--	--	--	--	--	--
QC-2	7/7/1993	h	--	--		--	--	<50	<0.5	<0.5	<0.5	<0.5	0.6	--	--	--	--	--	--	--	--
QC-2	9/21/1993	h	--	--		--	--	<50	<0.5	<0.5	<0.5	<0.5	<0.5	--	--	--	--	--	--	--	--
QC-2	12/23/1993	h	--	--		--	--	<50	<0.5	<0.5	<0.5	<0.5	<0.5	--	--	--	--	--	--	--	--
QC-2	4/7/1994	h	--	--		--	--	<50	<0.5	<0.5	<0.5	<0.5	<0.5	--	--	--	--	--	--	--	--

**Table 1**  
**Summary of Groundwater Monitoring Data: Relative Water Elevations and Laboratory Analyses**  
**CA-11109**  
**4280 Foothill Blvd., Oakland, CA 94601**

Well ID	Date	Notes	TOC (ft msl)	DTW (ft)	DTP	GW Elev (ft msl)	DRO (µg/L)	GRO (µg/L)	Benzene (µg/L)	Toluene (µg/L)	Ethylbenzene (µg/L)	Xylenes (µg/L)	MTBE (µg/L)	TBA (µg/L)	DIPE (µg/L)	ETBE (µg/L)	TAME (µg/L)	Ethanol (µg/L)	1,2-DCA (µg/L)	EDB (µg/L)	
QC-2	7/6/1994	h	--	--		--	--	<50	<0.5	<0.5	<0.5	<0.5	--	--	--	--	--	--	--	--	--
QC-2	10/7/1994	h	--	--		--	--	<50	<0.5	<0.5	<0.5	<0.5	--	--	--	--	--	--	--	--	--
QC-2	1/27/1995	h	--	--		--	--	<50	<0.5	0.5	<0.5	<1.0	--	--	--	--	--	--	--	--	--
QC-2	3/30/1995	h	--	--		--	--	<50	<0.50	<0.50	<0.50	<1.0	--	--	--	--	--	--	--	--	--
QC-2	6/20/1995	h	--	--		--	--	<50	<0.50	<0.50	<0.50	<1.0	--	--	--	--	--	--	--	--	--
QC-2	10/3/1995	h	--	--		--	--	<50	<0.50	<0.50	<0.50	<1.0	<5.0	--	--	--	--	--	--	--	--
QC-2	12/6/1995	h	--	--		--	--	<50	<0.50	<0.50	<0.50	<1.0	<5.0	--	--	--	--	--	--	--	--
QC-2	3/21/1996	h	--	--		--	--	<50	<0.5	<1.0	<1.0	<1.0	<10	--	--	--	--	--	--	--	--
QC-2	6/21/1996	h	--	--		--	--	<50	<0.5	<1.0	<1.0	<1.0	<10	--	--	--	--	--	--	--	--

**Notes:**

1,2-DCA = 1,2-Dichloroethane

DIPE = Di-isopropyl ether

DO= Dissolved oxygen

DRO = Diesel range organics, range C10-C28

DTW = Depth to water in ft bgs

EDB = 1,2-Dibromomethane

ETBE = Ethyl tert butyl ether

GRO = Gasoline range organics, range C4-C12

GWE = Groundwater measured in ft

MTBE = Methyl tert butyl ether

TAME = Ter-amyl methyl ether

TBA = Ter-butyl alcohol

TOC = Top of casing measured in ft

µg/L= Micrograms per liter

ft bgs = Feet below ground surface

-- = Not analyzed/applicable/measured/ available

< = Not detected at or above reported detection limit

(a) Sample exceeded EPA recommended holding time

(b) Sheen in well

(c) Well not sampled due to damage during site construction

(d) Insufficient water to sample

(e) Blind duplicate

(f) TOC lowered

(g) Free product in well

(h) Trip Blank

(i) Hydrocarbon odor observed at wellhead

(j) Well is dry

GWE adjusted assuming specific gravity of 0.75 for free product

Beginning in the fourth quarter 2003, the laboratory modified the reported analyte list. TPH-g was changed to GRO. The resulting data may be impacted by the potential of non-TPH-g analytes within the requested fuel range resulting in a higher concentration being reported.

Beginning in the second quarter 2004, the carbon range for GRO was changed from C6-C10 to C4-C12.

GRO analysis was completed by EPA method 8260B (C4-C12) for samples collected from the time period April 2006 through February 4, 2008. The analysis for GRO was changed to EPA method 8015B (C6-C12) for samples collected from the time period February 5, 2008 through the present.

The data within this table collected prior to April 2006 was provided to Broadbent & Associates, Inc. by Atlantic Richfield Company and their previous consultants. Broadbent & Associates, Inc. has not verified the accuracy of this information.

**Table 2**  
**Historical Groundwater Flow Direction and Gradient**  
**CA-11109**  
**4280 Foothill Blvd., Oakland, CA 94601**

Date Measured	Approximate Gradient Direction	Approximate Gradient Magnitude (ft/ft)
3/6/2006	Southwest	0.05
9/5/2006	Southwest	0.05
2/21/2007	Southwest	0.02
9/7/2007	Southwest	0.03
3/6/2008	Southwest	0.01
9/3/2008	Southwest	0.006
3/4/2009	Southwest	0.02
9/30/2009	Northwest	0.07
10/28/2009	Northwest	0.04
3/23/2010	Northwest	0.03
6/10/2010	Northwest	0.02
9/16/2010	Northwest	0.07
2/23/2011	Northwest	0.04
9/28/2011	Northwest	0.02
3/8/2012	Northwest	0.06
9/5/2012	West-Northwest	0.04
3/20/2013	Southwest	0.03
9/20/2013	Southwest	0.03

**Notes:**

N/A = Not Available

ft/ft = Feet per foot

Note: All data collected following April 2006 was collected by Broadbent & Associates, Inc. The data within this table collected prior to April 2006 was provided to Broadbent & Associates, Inc. by Atlantic Richfield Company and their previous consultants.





**Appendix A**

Field Methods

## **QUALITY ASSURANCE/QUALITY CONTROL FIELD METHODS**

Field methods discussed herein were implemented to provide for accuracy and reliability of field activities, data collection, sample collection, and handling. Discussion of these methods is provided below.

### **1.0 Equipment Calibration**

Equipment calibration was performed per equipment manufacturer specifications before use.

### **2.0 Depth to Groundwater and Light Non-Aqueous Phase Liquid Measurement**

Depth to groundwater was measured in wells identified for gauging in the scope of work using a decontaminated water level indicator. The depth to water measurement was taken from a cut notch or permanent mark at the top of the well casing to which the well head elevation was originally surveyed.

Once depth to water was measured, an oil/water interface meter or a new disposable bailer was utilized to evaluate the presence and, if present, to measure the “apparent” thickness of light non-aqueous phase liquid (LNAPL) in the well. If LNAPL was present in the well, groundwater purging and sampling were not performed, unless sampling procedures in the scope of work specified collection of samples in the presence of LNAPL. Otherwise, time allowing, LNAPL was bailed from the well using either a new disposable bailer, or the disposal bailer previously used for initial LNAPL assessment. Bailing of LNAPL continued until the thickness of LNAPL (or volume) stabilized in each bailer pulled from the well, or LNAPL was no longer present. After LNAPL thickness either stabilized or was eliminated, periodic depth to water and depth to LNAPL measurements were collected as product came back into the well to evaluate product recovery rate and to aid in further assessment of LNAPL in the subsurface. LNAPL thickness measurements were recorded as “apparent.” If a bailer was used for LNAPL thickness measurement, the field sampler noted the bailer entry diameter and chamber diameter to enable correction of thickness measurements. Recovered LNAPL was stored on-site in a labeled steel drum(s) or other appropriate container(s) prior to disposal.

### **3.0 Well Purging and Groundwater Sample Collection**

Well purging and groundwater sampling were performed in wells specified in the scope of work after measuring depth to groundwater and evaluating the presence of LNAPL. Purging and sampling were performed using one of the methods detailed below. The method used was noted in the field records. Purge water was stored on-site in labeled steel drum(s) or other appropriate container(s) prior to disposal or on-site treatment (in cases where treatment using an on-site system is authorized).

#### **3.1 Purging a Predetermined Well Volume**

Purging a predetermined well volume is performed per ASTM International (ASTM) D4448-01. This purging method has the objective of removing a predetermined volume of stagnant water from the well prior to sampling. The volume of stagnant water

is defined as either the volume of water contained within the well casing, or the volume within the well casing and sand/gravel in the annulus if natural flow through these is deemed insufficient to keep them flushed out.

This purging method involves removal of a minimum of three stagnant water volumes from the well using a decontaminated pump with new disposable plastic discharge or suction tubing, dedicated well tubing, or using a new disposable or decontaminated reusable bailer. If a new disposable bailer was used for assessment of LNAPL, that bailer may be used for purging. The withdrawal rate used is one that minimizes drawdown while satisfying time constraints.

To evaluate when purging is complete, one or more groundwater stabilization parameters are monitored and recorded during purging activities until stabilization is achieved. Most commonly, stabilization parameters include temperature, conductivity, and pH, but field procedures detailed in the scope of work may also include monitoring of dissolved oxygen concentrations, oxidation reduction potential, and/or turbidity<sup>1</sup>. Parameters are considered stable when two (2) consecutive readings recorded three (3) minutes apart fall within ranges provided below in Table 1. In the event that the parameters have not stabilized and five (5) well casing volumes have been removed, purging activities will cease and be considered complete. Once the well is purged, a groundwater sample(s) is collected from the well using a new disposable bailer. If a new disposable bailer was used for purging, that bailer may be used to collect the sample(s). A sample is not collected if the well is inadvertently purged dry.

Table 1. Criteria for Defining Stabilization of Water-Quality Indicator Parameters

Parameter	Stabilization Criterion
Temperature	± 0.2°C (± 0.36°F)
pH	± 0.1 standard units
Conductivity	± 3%
Dissolved oxygen	± 10%
Oxidation reduction potential	± 10 mV
Turbidity <sup>1</sup>	± 10% or 1.0 NTU (whichever is greater)

### 3.2 Low-Flow Purging and Sampling

“Low-Flow”, “Minimal Drawdown”, or “Low-Stress” purging is performed per ASTM D6771-02. It is a method of groundwater removal from within a well’s screened interval that is intended to minimize drawdown and mixing of the water column in the well casing. This is accomplished by pumping the well using a decontaminated pump with new disposable plastic discharge or suction tubing or dedicated well tubing at a low flow rate while evaluating the groundwater elevation during pumping.

<sup>1</sup> As stated in ASTM D6771-02, turbidity is not a chemical parameter and not indicative of when formation-quality water is being purged; however, turbidity may be helpful in evaluating stress on the formation during purging. Turbidity measurements are taken at the same time that stabilization parameter measurements are made, or, at a minimum, once when purging is initiated and again just prior to sample collection, after stabilization parameters have stabilized. To avoid artifacts in sample analysis, turbidity should be as low as possible when samples are collected. If turbidity values are persistently high, the withdrawal rate is lowered until turbidity decreases. If high turbidity persists even after lowering the withdrawal rate, the purging is stopped for a period of time until turbidity settles, and the purging process is then restarted. If this fails to solve the problem, the purging/sampling process for the well is ceased, and well maintenance or redevelopment is considered.

The low flow pumping rate is well specific and is generally established at a volume that is less than or equal to the natural recovery rate of the well. A pump with adjustable flow rate control is positioned with the intake at or near the mid-point of the submerged well screen. The pumping rate used during low-flow purging is low enough to minimize mobilization of particulate matter and drawdown (stress) of the water column. Low-flow purging rates will vary based on the individual well characteristics; however, the purge rate should not exceed 1.0 Liter per minute (L/min) or 0.25 gallon per minute (gal/min). Low-flow purging should begin at a rate of approximately 0.1 L/min (0.03 gal/min)<sup>2</sup>, or the lowest rate possible, and be adjusted based on an evaluation of drawdown. Water level measurements should be recorded at approximate one (1) to two (2) minute intervals until the low-flow rate has been established, and drawdown is minimized. As a general rule, drawdown should not exceed 25% of the distance between the top of the water column and the pump in-take.

To evaluate when purging is complete, one or more groundwater stabilization parameters are monitored and recorded during purging activities until stabilization is achieved. Most commonly, stabilization parameters include temperature, conductivity, and pH, but field procedures detailed in the scope of work may also include monitoring of dissolved oxygen concentrations, oxidation reduction potential, and/or turbidity<sup>1</sup>. The frequency between measurements will be at an interval of one (1) to three (3) minutes; however, if a flow cell is used, the frequency will be determined based on the time required to evacuate one cell volume. Stabilization is defined as three (3) consecutive readings recorded several minutes apart falling within ranges provided in Table 1. Samples will be collected by filling appropriate containers from the pump discharge tubing at a rate not to exceed the established pumping rate.

### 3.3 Minimal Purge, Discrete Depth, and Passive Sampling

Per ASTM D4448-01, sampling techniques that do not rely on purging, or require only minimal purging, may be used if a particular zone within a screened interval is to be sampled or if a well is not capable of yielding sufficient groundwater for purging. To properly use these sampling techniques, a water sample is collected within the screened interval with little or no mixing of the water column within the casing. These techniques include minimal purge sampling which uses a dedicated sampling pump capable of pumping rates of less than 0.1 L/min (0.03 gal/min)<sup>2</sup>, discrete depth sampling using a bailer that allows groundwater entry at a controlled depth (e.g. differential pressure bailer), or passive (diffusion) sampling. These techniques are based on certain studies referenced in ASTM D4448-01 that indicate that under certain conditions, natural groundwater flow is laminar and horizontal with little or no mixing within the well screen.

---

<sup>2</sup> According to ASTM D4448-01, studies have indicated that at flow rates of 0.1 L/min, low-density polyethylene (LDPE) and plasticized polypropylene tubing materials are prone to sorption. Therefore, TFE-fluorocarbon or other appropriate tubing material is used, particularly when tubing lengths of 50 feet or longer are used.

#### 4.0 Decontamination

Reusable groundwater sampling equipment were cleaned using a solution of Alconox or other acceptable detergent, rinsed with tap water, and finally rinsed with distilled water prior to use in each well. Decontamination water was stored on-site in labeled steel drum(s) or other appropriate container(s) prior to disposal.

#### 5.0 Sample Containers, Labeling, and Storage

Samples were collected in laboratory prepared containers with appropriate preservative (if preservative was required). Samples were properly labeled (site name, sample I.D., sampler initials, date, and time of collection) and stored chilled (refrigerator or ice chest with ice) until delivery to a certified laboratory, under chain of custody procedures.

#### 6.0 Chain of Custody Record and Procedure

The field sampler was personally responsible for care and custody of the samples collected until they were properly transferred to another party. To document custody and transfer of samples, a Chain of Custody Record was prepared. The Chain of Custody Record provided identification of the samples corresponding to sample labels and specified analyses to be performed by the laboratory. The original Chain of Custody Record accompanied the shipment, and a copy of the record was stored in the project file. When the samples were transferred, the individuals relinquishing and receiving them signed, dated, and noted the time of transfer on the record.

#### 7.0 Field Records

Daily Report and data forms were completed by staff personnel to provide daily record of significant events, observations, and measurements. Field records were signed, dated, and stored in the project file.

# HYDRASleeve™

Simple by Design

US Patent No. 6,481,300; No. 6,837,120 others pending

## Standard Operating Procedure: Sampling Ground Water with a HydraSleeve

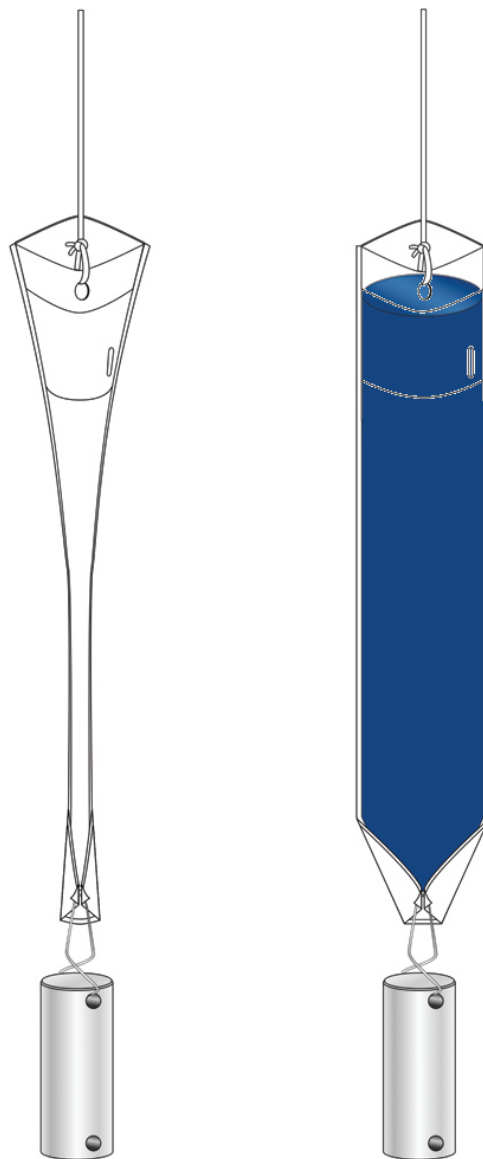

This Guide should be used in addition to field manuals appropriate to sampling device (i.e., HydraSleeve or Super Sleeve).

Find the appropriate field manual on the HydraSleeve website at <http://www.hydrasleeve.com>.

For more information about the HydraSleeve, or if you have questions, contact:  
GeoInsight, 2007 Glass Road, Las Cruces, NM 88005, 1-800-996-2225,  
[info@hydrasleeve.com](mailto:info@hydrasleeve.com).

Copyright, GeoInsight.

## Table of Contents

---

Introduction.....	1
Applications of the HydraSleeve .....	1
Description of the HydraSleeve .....	3
Selecting the HydraSleeve Size to Meet Site-Specific Sampling Objectives.....	4
HydraSleeve Deployment .....	5
Information Required Before Deploying a HydraSleeve.....	5
HydraSleeve Placement .....	6
Procedures for Sampling with the HydraSleeve .....	8
Measurement of Field Indicator Parameters .....	11
Alternate Deployment Strategies .....	11
Post-Sampling Activities .....	14
References.....	15

## Introduction

---

The HydraSleeve is classified as a no-purge (passive) grab sampling device, meaning that it is used to collect ground-water samples directly from the screened interval of a well without having to purge the well prior to sample collection. When it is used as described in this Standard Operating Procedure (SOP), the HydraSleeve causes no drawdown in the well (until the sample is withdrawn from the water column) and only minimal disturbance of the water column, because it has a very thin cross section and it displaces very little water (<100 ml) during deployment in the well. The HydraSleeve collects a sample from within the screen only, and it excludes water from any other part of the water column in the well through the use of a self-sealing check valve at the top of the sampler. It is a single-use (disposable) sampler that is not intended for reuse, so there are no decontamination requirements for the sampler itself.

The use of no-purge sampling as a means of collecting representative ground-water samples depends on the natural movement of ground water (under ambient hydraulic head) from the formation adjacent to the well screen through the screen. Robin and Gillham (1987) demonstrated the existence of a dynamic equilibrium between the water in a formation and the water in a well screen installed in that formation, which results in formation-quality water being available in the well screen for sampling at all times. No-purge sampling devices like the HydraSleeve collect this formation-quality water as the sample, under undisturbed (non-pumping) natural flow conditions. Samples collected in this manner generally provide more conservative (i.e., higher concentration) values than samples collected using well-volume purging, and values equivalent to samples collected using low-flow purging and sampling (Parsons, 2005).

## Applications of the HydraSleeve

---

The HydraSleeve can be used to collect representative samples of ground water for all analytes (volatile organic compounds [VOCs], semi-volatile organic compounds [SVOCs], common metals, trace metals, major cations and anions, dissolved gases, total dissolved solids, radionuclides, pesticides, PCBs, explosive compounds, and all other analytical parameters). Designs are available to collect samples from wells from 1” inside diameter and larger. The HydraSleeve can collect samples from wells of any yield, but it is especially well-suited to collecting samples from low-yield wells, where other sampling methods can’t be used reliably because their use results in dewatering of the well screen and alteration of sample chemistry (McAlary and Barker, 1987).

The HydraSleeve can collect samples from wells of any depth, and it can be used for single-event sampling or long-term ground-water monitoring programs. Because of its thin cross section and flexible construction, it can be used in narrow, constricted or damaged wells where rigid sampling devices may not fit. Using multiple HydraSleeves deployed in series along a single suspension line or tether, it is also possible to conduct in-well vertical profiling in wells in which contaminant concentrations are thought to be stratified.



As with all groundwater sampling devices, HydraSleeves should not be used to collect groundwater samples from wells in which separate (non-aqueous) phase hydrocarbons (i.e., gasoline, diesel fuel or jet fuel) are present because of the possibility of incorporating some of the separate-phase hydrocarbon into the sample.

## Description of the HydraSleeve

---

The HydraSleeve (Figure 1) consists of the following basic components:

- A suspension line or tether (A.), attached to the spring clip or directly to the top of the sleeve to deploy the device into and recover the device from the well. Tethers with depth indicators marked in 1-foot intervals are available from the manufacturer.
- A long, flexible, 4-mil thick lay-flat polyethylene sample sleeve (C.) sealed at the bottom (this is the sample chamber), which comes in different sizes, as discussed below with a self-sealing reed-type flexible polyethylene check valve built into the top of the sleeve (B.) to prevent water from entering or exiting the sampler except during sample acquisition.
- A reusable stainless-steel weight with clip (D.), which is attached to the bottom of the sleeve to carry it down the well to its intended depth in the water column. Bottom weights available from the manufacturer are 0.75" OD and are available in three sizes: 5 oz. (2.5" long); 8 oz. (4" long); and 16 oz. (8" long). In lieu of a bottom weight, an optional top weight may be attached to the top of the HydraSleeve to carry it to depth and to compress it at the bottom of the well (not shown in Figure 1);
- A discharge tube that is used to puncture the HydraSleeve after it is recovered from the well so the sample can be decanted into sample bottles (not shown).
- Just above the self-sealing check valve at the top of the sleeve are two holes which provide attachment points for the spring clip and/or suspension line or tether. At the bottom of the sample sleeve are two holes which provide attachment points for the weight clip and weight.

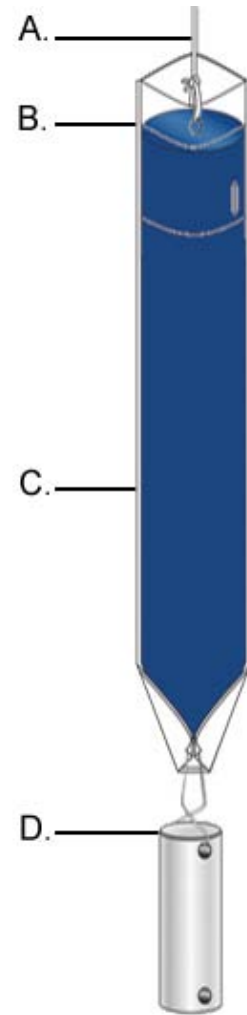

Figure 1. HydraSleeve components.

**Note:** The sample sleeve and the discharge tube are designed for one-time use and are disposable. The spring clip, weight and weight clip may be reused after thorough cleaning. Suspension cord is generally disposed after one use although, if it is dedicated to the well, it may be reused at the discretion of the sampling personnel.

## Selecting the HydraSleeve Size to Meet Site-Specific Sampling Objectives

It is important to understand that each HydraSleeve is able to collect a finite volume of sample because, after the HydraSleeve is deployed, you only get one chance to collect an undisturbed sample. Thus, the volume of sample required to meet your site-specific sampling and analytical requirements will dictate the size of HydraSleeve you need to meet these requirements.

The volume of sample collected by the HydraSleeve varies with the diameter and length of the HydraSleeve. Dimensions and volumes of available HydraSleeve models are detailed in Table 1.

**Table 1. Dimensions and volumes of HydraSleeve models.**

Diameter	Volume	Length	Lay-Flat Width	Filled Dia.
<i>2-Inch HydraSleeves</i>				
Standard 625-ml HydraSleeve	625 ml	< 30"	2.5"	1.4"
Standard 1-Liter HydraSleeve	1 Liter	38"	3"	1.9"
1-Liter HydraSleeve SS	1 Liter	36"	3"	1.9"
2-Liter HydraSleeve SS	2 Liters	60"	3"	1.9"
<i>4-Inch HydraSleeves</i>				
Standard 1.6-Liter HydraSleeve	1.6 Liters	30"	3.8"	2.3"
Custom 2-Liter HydraSleeve	2 Liters	36"	4"	2.7"

HydraSleeves can be custom-fabricated by the manufacturer in varying diameters and lengths to meet specific volume requirements. HydraSleeves can also be deployed in series (i.e., multiple HydraSleeves attached to one tether) to collect additional sample to meet specific volume requirements, as described below.

If you have questions regarding the availability of sufficient volume of sample to satisfy laboratory requirements for analysis, it is recommended that you contact the laboratory to discuss the minimum volumes needed for each suite of analytes. Laboratories often require only 10% to 25% of the volume they specify to complete analysis for specific suites of analytes, so they can often work with much smaller sample volumes that can easily be supplied by a HydraSleeve.

## HydraSleeve Deployment

---

### Information Required Before Deploying a HydraSleeve

Before installing a HydraSleeve in any well, you will need to know the following:

- The inside diameter of the well
- The length of the well screen
- The water level in the well
- The position of the well screen in the well
- The total depth of the well

The inside diameter of the well is used to determine the appropriate HydraSleeve diameter for use in the well. The other information is used to determine the proper placement of the HydraSleeve in the well to collect a representative sample from the screen (see HydraSleeve Placement, below), and to determine the appropriate length of tether to attach to the HydraSleeve to deploy it at the appropriate position in the well.

Most of this information (with the exception of the water level) should be available from the well log; if not, it will have to be collected by some other means. The inside diameter of the well can be measured at the top of the well casing, and the total depth of the well can be measured by sounding the bottom of the well with a weighted tape. The position and length of the well screen may have to be determined using a down-hole camera if a well log is not available. The water level in the well can be measured using any commonly available water-level gauge.

## HydraSleeve Placement

The HydraSleeve is designed to collect a sample directly from the well screen, and it fills by pulling it up through the screen a distance equivalent to 1 to 1.5 times its length. This upward motion causes the top check valve to open, which allows the device to fill. To optimize sample recovery, it is recommended that the HydraSleeve be placed in the well so that the bottom weight rests on the bottom of the well and the top of the HydraSleeve is as close to the bottom of the well screen as possible. This should allow the sampler to fill before the top of the device reaches the top of the screen as it is pulled up through the water column, and ensure that only water from the screen is collected as the sample. In short-screen wells, or wells with a short water column, it may be necessary to use a top-weight on the HydraSleeve to compress it in the bottom of the well so that, when it is recovered, it has room to fill before it reaches the top of the screen.

### Example

2" ID PVC well, 50' total depth, 10' screen at the bottom of the well, with water level above the screen (the entire screen contains water).

*Correct Placement (figure 2):* Using a standard HydraSleeve for a 2" well (2.6" flat width/1.5" filled OD x 30" long, 650 ml volume), deploy the sampler so the weight (an 8 oz., 4"-long weight with a 2"-long clip) rests at the bottom of the well. The top of the sleeve is thus set at about 36" above the bottom of the well. When the sampler is recovered, it will be pulled upward approximately 30" to 45" before it is filled; therefore, it is full (and the top check valve closes) at approximately 66" (5 ½ feet) to 81" (6 ¾ feet) above the bottom of the well, which is well before the sampler reaches the top of the screen. In this example, only water from the screen is collected as a sample.

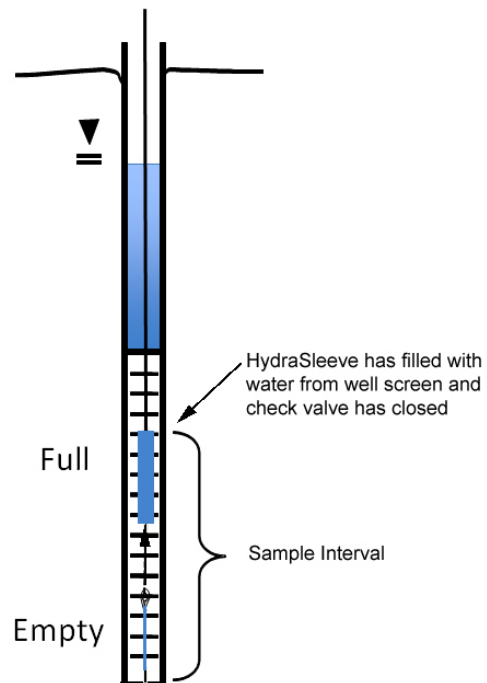

Figure 2. Correct placement of HydraSleeve.

*Incorrect Placement (figure 3):* If the well screen in this example was only 5' long, and the HydraSleeve was placed as above, it would not fill before the top of the device reached the top of the well screen, so the sample would include water from above the screen, which may not have the same chemistry.

*The solution?* Deploy the HydraSleeve with a top weight, so that it is collapsed to within 6" to 9" of the bottom of the well. When the HydraSleeve is recovered, it will fill within 39" (3 ¼ feet) to 54" (4 ½ feet) above the bottom of the well, or just before the sampler reaches the top of the screen, so it collects only water from the screen as the sample.

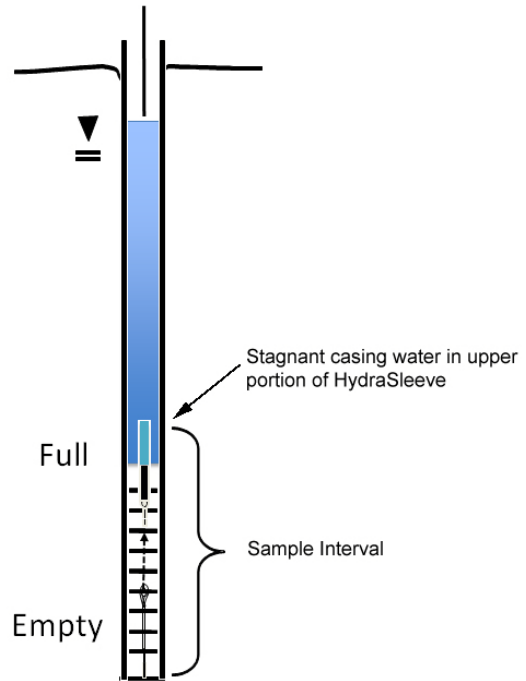

Figure 3. Incorrect placement of HydraSleeve.

This example illustrates one of many types of HydraSleeve placements. More complex placements are discussed in a later section.

## Procedures for Sampling with the HydraSleeve

---

Collecting a ground-water sample with a HydraSleeve is a simple one-person operation.

**Note:** Before deploying the HydraSleeve in the well, collect the depth-to-water measurement that you will use to determine the preferred position of the HydraSleeve in the well. This measurement may also be used with measurements from other wells to create a ground-water contour map. If necessary, also measure the depth to the bottom of the well to verify actual well depth to confirm your decision on placement of the HydraSleeve in the water column.

Measure the correct amount of tether needed to suspend the HydraSleeve in the well so that the weight will rest on the bottom of the well (or at your preferred position in the well). Make sure to account for the need to leave a few feet of tether at the top of the well to allow recovery of the sleeve

**Note:** Always wear sterile gloves when handling and discharging the HydraSleeve.

### I. Assembling the HydraSleeve

1. Remove the HydraSleeve from its packaging, unfold it, and hold it by its top.
2. Crimp the top of the HydraSleeve by folding the hard polyethylene reinforcing strips at the holes.
3. Attach the spring clip to the holes to ensure that the top will remain open until the sampler is retrieved.
4. Attach the tether to the spring clip by tying a knot in the tether.

**Note:** Alternatively, attach the tether to one (NOT both) of the holes at the top of the Hydrasleeve by tying a knot in the tether.

5. Fold the flaps with the two holes at the bottom of the HydraSleeve together and slide the weight clip through the holes.
6. Attach a weight to the bottom of the weight clip to ensure that the HydraSleeve will descend to the bottom of the well.

## II. Deploying the HydraSleeve

1. Using the tether, carefully lower the HydraSleeve to the bottom of the well, or to your preferred depth in the water column

During installation, hydrostatic pressure in the water column will keep the self-sealing check valve at the top of the HydraSleeve closed, and ensure that it retains its flat, empty profile for an indefinite period prior to recovery.

**Note:** Make sure that it is not pulled upward at any time during its descent. If the HydraSleeve is pulled upward at a rate greater than 0.5'/second at any time prior to recovery, the top check valve will open and water will enter the HydraSleeve prematurely.

2. Secure the tether at the top of the well by placing the well cap on the top of the well casing and over the tether.

**Note:** Alternatively, you can tie the tether to a hook on the bottom of the well cap (you will need to leave a few inches of slack in the line to avoid pulling the sampler up as the cap is removed at the next sampling event).

## III. Equilibrating the Well

The equilibration time is the time it takes for conditions in the water column (primarily flow dynamics and contaminant distribution) to restabilize after vertical mixing occurs (caused by installation of a sampling device in the well).

- Situation: The HydraSleeve is deployed for the first time or for only one time in a well

The HydraSleeve is very thin in cross section and displaces very little water (<100 ml) during deployment so, unlike most other sampling devices, it does not disturb the water column to the point at which long equilibration times are necessary to ensure recovery of a representative sample.

In most cases, the HydraSleeve can be recovered immediately (with no equilibration time) or within a few hours. In regulatory jurisdictions that impose specific requirements for equilibration times prior to recovery of no-purge sampling devices, these requirements should be followed.

- Situation: The HydraSleeve is being deployed for recovery during a future sampling event

In periodic (i.e., quarterly or semi-annual) sampling programs, the sampler for the current sampling event can be recovered and a new sampler (for the next sampling event)



deployed immediately thereafter, so the new sampler remains in the well until the next sampling event.

Thus, a long equilibration time is ensured and, at the next sampling event, the sampler can be recovered immediately. This means that separate mobilizations, to deploy and then to recover the sampler, are not required. HydraSleeves can be left in a well for an indefinite period of time without concern.

#### **IV. HydraSleeve Recovery and Sample Collection**

1. Hold on to the tether while removing the well cap.
2. Secure the tether at the top of the well while maintaining tension on the tether (but without pulling the tether upwards)
3. Measure the water level in the well.
4. In one smooth motion, pull the tether up between 30” to 45” (36” to 54” for the longer HydraSleeve) at a rate of about 1’ per second (or faster).

The motion will open the top check valve and allow the HydraSleeve to fill (it should fill in about 1 to 1.5 times the length of the HydraSleeve). This is analogous to coring the water column in the well from the bottom up.

When the HydraSleeve is full, the top check valve will close. You should begin to feel the weight of the HydraSleeve on the tether and it will begin to displace water. The closed check valve prevents loss of sample and entry of water from zones above the well screen as the HydraSleeve is recovered.

5. Continue pulling the tether upward until the HydraSleeve is at the top of the well.
6. Decant and discard the small volume of water trapped in the Hydrasleeve above the check valve by turning the sleeve over.

#### **V. Sample Collection**

**Note:** Sample collection should be done immediately after the HydraSleeve has been brought to the surface to preserve sample integrity.

1. Remove the discharge tube from its sleeve.
2. Hold the HydraSleeve at the check valve.
3. Puncture the HydraSleeve just below the check valve with the pointed end of the discharge tube
4. Discharge water from the HydraSleeve into your sample containers.

Control the discharge from the HydraSleeve by either raising the bottom of the sleeve, by squeezing it like a tube of toothpaste, or both.

5. Continue filling sample containers until all are full.

## Measurement of Field Indicator Parameters

Field indicator parameter measurement is generally done during well purging and sampling to confirm when parameters are stable and sampling can begin. Because no-purge sampling does not require purging, field indicator parameter measurement is not necessary for the purpose of confirming when purging is complete.

If field indicator parameter measurement is required to meet a specific non-purging regulatory requirement, it can be done by taking measurements from water within a HydraSleeve that is not used for collecting a sample to submit for laboratory analysis (i.e., a second HydraSleeve installed in conjunction with the primary sample collection HydraSleeve [see Multiple Sampler Deployment below]).

## Alternate Deployment Strategies

### Deployment in Wells with Limited Water Columns

For wells in which only a limited water column exists to be sampled, the HydraSleeve can be deployed with an optional top weight instead of a bottom weight, which collapses the HydraSleeve to a very short (approximately 6” to 9”) length, and allows the HydraSleeve to fill in a water column only 36” to 45” in height.

### Multiple Sampler Deployment

Multiple sampler deployment in a single well screen can accomplish two purposes:

- It can collect additional sample volume to satisfy site or laboratory-specific sample volume requirements.
- It can accommodate the need for collecting field indicator parameter measurements.
- It can be used to collect samples from multiple intervals in the screen to allow identification of possible contaminant stratification.

It is possible to use up to 3 standard 30” HydraSleeves deployed in series along a single tether to collect samples from a 10’ long well screen without collecting water from the interval above the screen.

The samplers must be attached to the tether at both the top and bottom of the sleeve. Attach the tether at the top with a stainless-steel clip (available from the manufacturer). Attach the tether at the bottom using a cable tie. The samplers must be attached as follows (figure 4):

- The first (attached to the tether as described above, with the weight at the bottom) at the bottom of the screen
- The second attached immediately above the first
- The third (attached the same as the second) immediately above the second

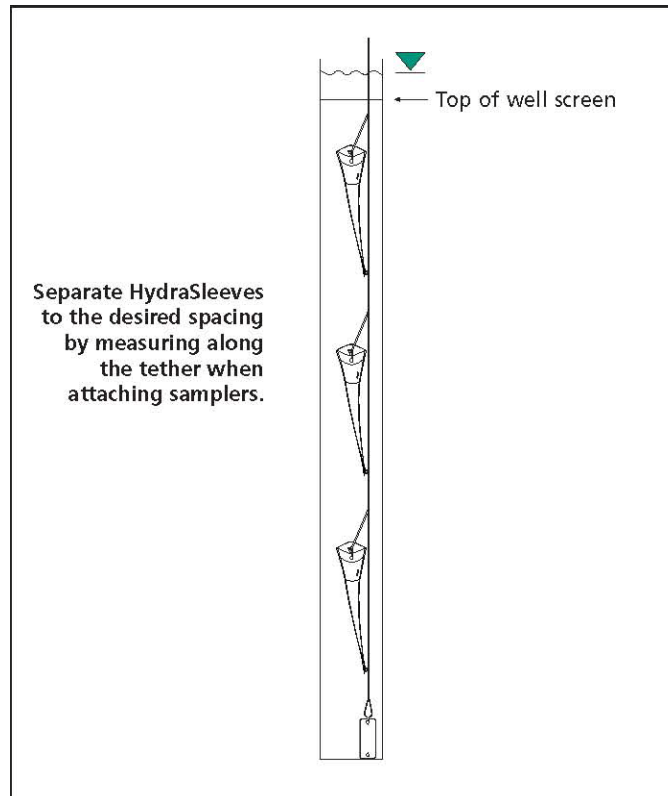

Figure 4. Multiple HydraSleeve deployment.

Alternately, the first sampler can be attached to the tether as described above, a second attached to the bottom of the first using a short length of tether (in place of the weight), and the third attached to the bottom of the second in the same manner, with the weight attached to the bottom of the third sampler (figure 5).

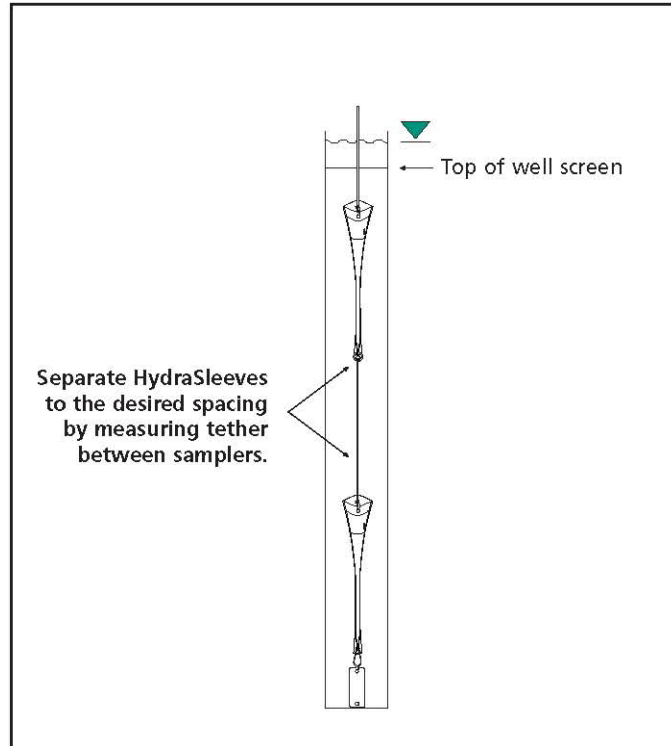

Figure 5. Alternative method for deploying multiple HydraSleeves.

In either case, when attaching multiple HydraSleeves in series, more weight may be required to hold the samplers in place in the well than would be required with a single sampler. Recovery of multiple samplers and collection of samples is done in the same manner as for single sampler deployments.

## **Post-Sampling Activities**

---

The recovered HydraSleeve and the sample discharge tubing should be disposed as per the solid waste management plan for the site. To prepare for the next sampling event, a new HydraSleeve can be deployed in the well (as described previously) and left in the well until the next sampling event, at which time it can be recovered.

The weight and weight clip can be reused on this sampler after they have been thoroughly cleaned as per the site equipment decontamination plan. The tether may be dedicated to the well and reused or discarded at the discretion of sampling personnel.

## References

---

McAlary, T. A. and J. F. Barker, 1987, Volatilization Losses of Organics During Ground-Water Sampling From Low-Permeability Materials, Ground-Water Monitoring Review, Vol. 7, No. 4, pp. 63-68

Parsons, 2005, Results Report for the Demonstration of No-Purge Ground-Water Sampling Devices at Former McClellan Air Force Base, California; Contract F44650-99-D-0005, Delivery Order DKO1, U.S. Army Corps of Engineers (Omaha District), U.S. Air Force Center for Environmental Excellence, and U.S. Air Force Real Property Agency

Robin, M. J. L. and R. W. Gillham, 1987, Field Evaluation of Well Purging Procedures, Ground-Water Monitoring Review, Vol. 7, No. 4, pp. 85-93



**Appendix B**

Field Data Sheets



DAILY REPORT

Page 1 of 1

Project: Arcadis 11109 Project No.: 09-88-646

Field Representative(s): Alex Martinez Day: Friday Date: 9/20/13

Time Onsite: From: 0610 To: 0945 ; From: To: ; From: To:

- Signed HASP, Safety Glasses, Hard Hat, Steel Toe Boots, Safety Vest, UST Emergency System Shut-off Switches Located, Proper Gloves, Proper Level of Barricading, Other PPE (describe)

Weather: Sunny

Equipment In Use: Interface probe, V52 meter, hydrasteelies, soakease

Visitors: None

TIME:

WORK DESCRIPTION:

0610 Arrived onsite

0615 Set up to place hydrasteelies & gauge wells

0755 Set up to sample hydrasteelie wells

0945 Completed fieldwork & offsite.

\* Soakease were previously placed in wells MW- 5, 10, & 12 on 5/7/13. Upon changing the socks, all three appear to have absorbed the LNAPL (See LNAPL Recovery Sheet). Soakease appear to effectively remove LNAPL from each well. Steel canisters and new socks (4") were placed in each well. Samples were not collected.

Signature: Alex Martinez





GROUNDWATER MONITORING SITE SHEET

Project: Arcadis 11109 Project No.: 09-88-646 Date: 9/20/13

Field Representative: AM Elevation: —

Formation recharge rate is historically: High Low (circle one)

W. L. Indicator ID #: — Oil/Water Interface ID #: — (List #s of all equip used.)

WELL ID RECORD					WELL GAUGING RECORD					NOTES
Well ID	Well Sampling Order	As-Built Well Diameter (inches)	As-Built Well Screen Interval (ft)	Previous Depth to Water (ft)	Time (24:00)	Depth to LNAPL (ft)	Apparent LNAPL Thickness (ft)*	Depth to Water (ft)	Well Total Depth (ft)	
MW-2					0704	—	—	Dry	12.81	
MW-3					0642	—	—	11.40	31.42	
MW-4					0648	—	—	15.69	26.74	
* MW-5					0713	—	—	10.26	32.07	Strong odor & sheen
MW-6					0623	—	—	16.02	34.49	
MW-7					0632	—	—	11.50	33.32	
MW-8					0620	—	—	13.88	29.95	
MW-9					0616	—	—	10.91	29.47	
* MW-10					0719	—	—	10.50	29.90	Strong odor & sheen
MW-11					0655	—	—	10.55	30.00	
* MW-12					0721	—	—	10.92	30.18	Strong odor & sheen
* Socks replaced in each well & canisters added.										

\* Device used to measure LNAPL thickness: Bailer Oil/Water Interface Meter (circle one)  
 If bailer used, note bailer dimensions (inches): Entry Diameter \_\_\_\_\_ Chamber Diameter \_\_\_\_\_

Signature: Ally Martin



GROUNDWATER SAMPLING DATA SHEET

Page 2 of 6

Project: Arcadis 11109 Project No.: 09-88-646 Date: 9/20/13  
 Field Representative: AM  
 Well ID: MW-3 Start Time: — End Time: — Total Time (minutes): —

PURGE EQUIPMENT  Disp. Bailer  120V Pump  Flow Cell  
 Disp. Tubing  12V Pump  Peristaltic Pump Other/ID#: Hydrasleeve (HS)

WELL HEAD INTEGRITY (cap, lock, vault, etc.) Comments: \_\_\_\_\_  
 Good  Improvement Needed (circle one)

PURGING/SAMPLING METHOD Predetermined Well Volume Low-Flow Other: HS (circle one)

PREDETERMINED WELL VOLUME				Diagram	LOW-FLOW			
Casing Diameter	Unit Volume (gal/ft)	(circle one)			Previous Low-Flow Purge Rate	(lpm)		
1" (0.04)	1.25" (0.08)	2" (0.17)	3" (0.38)		Total Well Depth (a)	_____ (ft)		
4" (0.66)	6" (1.50)	8" (2.60)	12" (5.81)		Initial Depth to Water (b)	_____ (ft)		
Total Well Depth (a): _____ (ft)					Pump In-take Depth = b + (a-b)/2: _____ (ft)			
Initial Depth to Water (b): _____ (ft)					Maximum Allowable Drawdown = (a-b)/8: _____ (ft)			
Water Column Height (WCH) = (a - b): _____ (ft)					Low-Flow Purge Rate: _____ (Lpm)*			
Water Column Volume (WCV) = WCH x Unit Volume: _____ (gal)					Comments: _____			
Three Casing Volumes = WCV x 3: _____ (gal)					*Low-flow purge rate should be within range of instruments used but should not exceed 0.25 gpm. Drawdown should not exceed Maximum Allowable Drawdown.			
Five Casing Volumes = WCV x 5: _____ (gal)								
Pump Depth (if pump used): _____ (ft)								

GROUNDWATER STABILIZATION PARAMETER RECORD

Time (24:00)	Cumulative Vol. gal or L	Temperature °C	pH	Conductivity µS or mS	DO mg/L	ORP mV	Turbidity NTU	NOTES Odor, color, sheen or other
0823	1.0	21.46	7.08	0.504	4.66	131	283	

Previous Stabilized Parameters \_\_\_\_\_

PURGE COMPLETION RECORD  Low Flow & Parameters Stable  3 Casing Volumes & Parameters Stable  5 Casing Volumes  
 Other: HS

SAMPLE COLLECTION RECORD		GEOCHEMICAL PARAMETERS		
Depth to Water at Sampling: _____ (ft)		Parameter	Time	Measurement
Sample Collected Via: <input type="checkbox"/> Disp. Bailer <input type="checkbox"/> Dedicated Pump Tubing		DO (mg/L)		
<input type="checkbox"/> Disp. Pump Tubing Other: <u>HS</u>		Ferrous Iron (mg/L)		
Sample ID: <u>MW-3</u>	Sample Collection Time: <u>0815</u> (24:00)	Redox Potential (mV)		
Containers (#): <u>3</u> VOA ( <input checked="" type="checkbox"/> preserved or <input type="checkbox"/> unpreserved )	<input type="checkbox"/> Liter Amber	Alkalinity (mg/L)		
Other: _____	Other: _____	Other:		
Other: _____	Other: _____	Other:		

Signature: Aly Mark





GROUNDWATER SAMPLING DATA SHEET

Project: Arcadis 11109 Project No.: 09-88-646 Date: 9/20/13
Field Representative: AM
Well ID: MW-4 Start Time: End Time: Total Time (minutes):

PURGE EQUIPMENT: Disp. Bailer, 120V Pump, Flow Cell, Disp. Tubing, 12V Pump, Peristaltic Pump, Other/ID#: HS

WELL HEAD INTEGRITY (cap, lock, vault, etc.) Comments: Good Improvement Needed (circle one)

PURGING/SAMPLING METHOD: Predetermined Well Volume, Low-Flow, Other: HS (circle one)

Table with columns: PREDETERMINED WELL VOLUME, LOW-FLOW. Includes casing diameter options, well depth measurements, and purge rate calculations.

GROUNDWATER STABILIZATION PARAMETER RECORD

Table with 9 columns: Time (24:00), Cumulative Vol. (gal or L), Temperature (C), pH, Conductivity (uS or mS), DO (mg/L), ORP (mV), Turbidity (NTU), NOTES. Row 1 contains handwritten data: 0855, 1.0, 21.19, 6.92, 0.379, 4.41, -81, 163, Lt-Med. hydrocarbon odor.

PURGE COMPLETION RECORD: Low Flow & Parameters Stable, 3 Casing Volumes & Parameters Stable, 5 Casing Volumes. Other: HS

Table with columns: SAMPLE COLLECTION RECORD, GEOCHEMICAL PARAMETERS. Includes depth to water, sample collection method, sample ID (MW-4), collection time (0850), and various chemical parameters like DO, Ferrous Iron, Redox Potential, Alkalinity.

Signature: [Handwritten Signature]



# GROUNDWATER SAMPLING DATA SHEET

Page 4 of 6

Project: Arcadis 1109 Project No.: 09-88-646 Date: 9/20/13  
 Field Representative: AM  
 Well ID: MW-6 Start Time: - End Time: - Total Time (minutes): -

PURGE EQUIPMENT  Disp. Bailer  120V Pump  Flow Cell  
 Disp. Tubing  12V Pump  Peristaltic Pump Other/ID#: HS

WELL HEAD INTEGRITY (cap, lock, vault, etc.) Comments: \_\_\_\_\_  
 Good  Improvement Needed (circle one)

PURGING/SAMPLING METHOD  Predetermined Well Volume  Low-Flow  Other: HS (circle one)

PREDETERMINED WELL VOLUME					LOW-FLOW				
Casing Diameter   Unit Volume (gal/ft) (circle one)					Previous Low-Flow Purge Rate: _____ (lpm)				
1"   (0.04)	1.25"   (0.08)	2"   (0.17)	<u>3"   (0.38)</u>	Other: _____	Total Well Depth (a): _____ (ft)				
4"   (0.66)	6"   (1.50)	8"   (2.60)	12"   (5.81)	_____   (_____)	Initial Depth to Water (b): _____ (ft)				
Total Well Depth (a): _____ (ft)					Pump In-take Depth = b + (a-b)/2: _____ (ft)				
Initial Depth to Water (b): _____ (ft)					Maximum Allowable Drawdown = (a-b)/8: _____ (ft)				
Water Column Height (WCH) = (a - b): _____ (ft)					Low-Flow Purge Rate: _____ (Lpm)*				
Water Column Volume (WCV) = WCH x Unit Volume: _____ (gal)					Comments: _____				
Three Casing Volumes = WCV x 3: _____ (gal)					<p>*Low-flow purge rate should be within range of instruments used but should not exceed 0.25 gpm. Drawdown should not exceed Maximum Allowable Drawdown.</p>				
Five Casing Volumes = WCV x 5: _____ (gal)									
Pump Depth (if pump used): _____ (ft)									

### GROUNDWATER STABILIZATION PARAMETER RECORD

Time (24:00)	Cumulative Vol. gal or L	Temperature °C	pH	Conductivity μS or mS	DO mg/L	ORP mV	Turbidity NTU	NOTES Odor, color, sheen or other
<u>0808</u>	<u>1.0</u>	<u>20.10</u>	<u>7.08</u>	<u>0.343</u>	<u>4.72</u>	<u>124</u>	<u>271</u>	

Previous Stabilized Parameters \_\_\_\_\_

PURGE COMPLETION RECORD  Low Flow & Parameters Stable  3 Casing Volumes & Parameters Stable  5 Casing Volumes  
 Other: HS

SAMPLE COLLECTION RECORD				GEOCHEMICAL PARAMETERS			
Depth to Water at Sampling: <u>-</u> (ft)				Parameter	Time	Measurement	

Sample Collected Via:  Disp. Bailer  Dedicated Pump Tubing  
 Disp. Pump Tubing Other: HS  
 Sample ID: MW-6 Sample Collection Time: 0800 (24:00)  
 Containers (#): 3 VOA (  preserved or  unpreserved)    Liter Amber  
 Other: \_\_\_\_\_ Other: \_\_\_\_\_  
 Other: \_\_\_\_\_ Other: \_\_\_\_\_

Signature: Alex Mack Revision: 3/15/2013





GROUNDWATER SAMPLING DATA SHEET

Project: Arcadis 1109 Project No.: 09-88-646 Date: 9/20/13
Field Representative: AM
Well ID: MW-7 Start Time: End Time: Total Time (minutes):

PURGE EQUIPMENT: Disp. Bailer, 120V Pump, Flow Cell, Disp. Tubing, 12V Pump, Peristaltic Pump, Other/ID#: HS

WELL HEAD INTEGRITY (cap, lock, vault, etc.) Comments: Good Improvement Needed (circle one)

PURGING/SAMPLING METHOD: Predetermined Well Volume, Low-Flow, Other: HS (circle one)

PREDETERMINED WELL VOLUME and LOW-FLOW sections with diagrams and calculation fields for well depth, water column height, and purge rate.

GROUNDWATER STABILIZATION PARAMETER RECORD

Table with 9 columns: Time (24:00), Cumulative Vol. (gal or L), Temperature (°C), pH, Conductivity (µS or mS), DO (mg/L), ORP (mV), Turbidity (NTU), NOTES. Includes handwritten data for time 0839 and notes on hydrocarbon odor.

Previous Stabilized Parameters

PURGE COMPLETION RECORD: Low Flow & Parameters Stable, 3 Casing Volumes & Parameters Stable, 5 Casing Volumes, Other: HS

SAMPLE COLLECTION RECORD and GEOCHEMICAL PARAMETERS sections with fields for depth to water, sample collection time, and various chemical parameters.

Signature: Alex [Handwritten Signature]



GROUNDWATER SAMPLING DATA SHEET

Project: Arcadis 11109 Project No.: 09-88-646 Date: 9/20/13
Field Representative: AM
Well ID: MW-11 Start Time: End Time: Total Time (minutes):

PURGE EQUIPMENT: Disp. Bailer, 120V Pump, Flow Cell, Disp. Tubing, 12V Pump, Peristaltic Pump, Other/ID#: HS

WELL HEAD INTEGRITY (cap, lock, vault, etc.) Comments:
Good Improvement Needed (circle one)

PURGING/SAMPLING METHOD: Predetermined Well Volume, Low-Flow, Other: HS (circle one)

PREDETERMINED WELL VOLUME and LOW-FLOW sections with a well diagram showing casing diameter and water level. Includes formulas for WCH, WCV, and drawdown.

GROUNDWATER STABILIZATION PARAMETER RECORD

Table with 9 columns: Time (24:00), Cumulative Vol. (gal or L), Temperature (°C), pH, Conductivity (µS or mS), DO (mg/L), ORP (mV), Turbidity (NTU), NOTES (Odor, color, sheen or other). Row 1 contains handwritten data.

Previous Stabilized Parameters

PURGE COMPLETION RECORD: Low Flow & Parameters Stable, 3 Casing Volumes & Parameters Stable, 5 Casing Volumes, Other: HS

SAMPLE COLLECTION RECORD and GEOCHEMICAL PARAMETERS

Form for sample collection details including depth to water, collection method, sample ID (MW-11), collection time (0905), and geochemical parameters like DO, Ferrous Iron, Redox Potential, and Alkalinity.

Signature: [Handwritten Signature]





Passive LNAPL Recovery Field Data Sheets

Site Name: Arcadis 11109 Project No.: 09-88-646
Site Location: 4280 Foothill Blvd. Oakland, CA

Date: 9/20/13 Technician: Alex Martinez
Onsite Time: 0610 Weather Conditions: Partly Cloudy
Offsite Time: 0945 Ambient Temperature: 60°F

Table with 5 columns: Parameter, Mw-5, Mw-10, Mw-12, and empty. Rows include Well Diameter, Sock Diameter, saturation status, and depths to LNAPL and water.

No. of 55-gallon drums: 1

Table with 8 columns: Drum #, Fill Start Date, Is it full?, If not, how full?, and 4 empty columns.

\* No water in drum. Placed used socktease in trash bags & in 5 gallon buckets

Table with 5 columns: Parameter, Mw-5, Mw-10, Mw-12, and empty. Rows include Sock Replaced?, Sock Diameter, Total Sock Length, and Sock Length Above/Below Water.

\*Note: When installing sock, set the depth of sock such that 2/3 of it is above the water table. Store the used socks in sealed 5-gallon buckets and store them in 55-gal drum labelled hazardous waste.

Comments/Notes: [Blank lines for notes]

Signature: \_\_\_\_\_ Date: 9/20/13

# Chain of Custody Record

48760

Client Contact		Project Manager: Kristene Tidwell			Site Contact/Sampler: Alex Martinez		Date:		COC No:	
Broadbent & Associates, Inc.		Tel/Fax: 707-455-7290 / 707-455-7295			Lab Contact: Dimple Sharma		Carrier:		_____ of _____ COCs	
875 Cotting Lane, Suite G		Analysis Turnaround Time			Filtered Sample CRO by 8260B BTEX/5 FO & EDB by 8260 1,2-DCA & Ethanol by 8260 MTBE by 8260B				Job No.	
Vacaville, CA 95688		Calendar (C) or Work Days (W) _____							SDG No.	
Phone: 707-455-7290		TAT if different from Below _____							Sample Specific Notes:	
Fax: 707-455-7295		<input checked="" type="checkbox"/> 2 weeks								
Project Name: Arcadis 11109		<input type="checkbox"/> 1 week								
4280 Foothill Blvd., Oakland, CA		<input type="checkbox"/> 2 days								
P O # GP09BPNA.C106		<input type="checkbox"/> 1 day								
Sample Identification	Sample Date	Sample Time	Sample Type	Matrix	# of Cont.					
MW-3	9/20/2013	0815	GRAB	AQ	3					
MW-4	9/20/2013	0850	GRAB	AQ	3	X		X		
MW-6	9/20/2013	0800	GRAB	AQ	3			X		
MW-7	9/20/2013	0835	GRAB	AQ	3	X	X	X		
MW-11	9/20/2013	0905	GRAB	AQ	3	X	X	X		
TB-11109-09202013	--	--	--	AQ	2					On Hold
Preservation Used: 1= Ice, 2= HCl; 3= H2SO4; 4=HNO3; 5=NaOH; 6= Other _____										
Possible Hazard Identification					Sample Disposal (A fee may be assessed if samples are retained longer than 1 month)					
<input type="checkbox"/> Non-Hazard <input type="checkbox"/> Flammable <input type="checkbox"/> Skin Irritant <input type="checkbox"/> Poison, B <input type="checkbox"/> Unknown <input type="checkbox"/>					<input type="checkbox"/> Return To Client <input type="checkbox"/> Disposal By Lab                    Archive for _____ Months					
Special Instructions:										
Relinquished by:		Company:		Date/Time:		Received by:		Company:		Date/Time:
Alex Martinez <i>Alex Martinez</i>		Broadbent & Associates		9/20/13/1235		Joan Mulla <i>Joan Mulla</i>		Test America		9-20-13 1235
Relinquished by:		Company:		Date/Time:		Received by:		Company:		Date/Time:
Relinquished by:		Company:		Date/Time:		Received by:		Company:		Date/Time:

4.02





**Appendix C**

Laboratory Report and Chain-of-Custody Documentation

# TestAmerica

THE LEADER IN ENVIRONMENTAL TESTING

## ANALYTICAL REPORT

TestAmerica Laboratories, Inc.  
TestAmerica Pleasanton  
1220 Quarry Lane  
Pleasanton, CA 94566  
Tel: (925)484-1919

TestAmerica Job ID: 720-52469-1  
Client Project/Site: BP #11109, Oakland

For:  
ARCADIS U.S., Inc.  
100 Montgomery Street  
Suite 300  
San Francisco, California 94104

Attn: Hollis Phillips

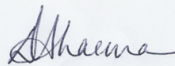

Authorized for release by:  
9/26/2013 3:10:49 PM

Dimple Sharma, Project Manager I  
[dimple.sharma@testamericainc.com](mailto:dimple.sharma@testamericainc.com)



### LINKS

Review your project  
results through  
**TotalAccess**

Have a Question?



Visit us at:  
[www.testamericainc.com](http://www.testamericainc.com)

*This report has been electronically signed and authorized by the signatory. Electronic signature is intended to be the legally binding equivalent of a traditionally handwritten signature.*

*Results relate only to the items tested and the sample(s) as received by the laboratory.*

- 1
- 2
- 3
- 4
- 5
- 6
- 7
- 8
- 9
- 10
- 11
- 12
- 13
- 14



# Table of Contents

Cover Page . . . . .	1
Table of Contents . . . . .	2
Definitions/Glossary . . . . .	3
Case Narrative . . . . .	4
Detection Summary . . . . .	5
Client Sample Results . . . . .	6
QC Sample Results . . . . .	11
QC Association Summary . . . . .	14
Lab Chronicle . . . . .	15
Certification Summary . . . . .	16
Method Summary . . . . .	17
Sample Summary . . . . .	18
Chain of Custody . . . . .	19
Receipt Checklists . . . . .	20

## Definitions/Glossary

Client: ARCADIS U.S., Inc.  
Project/Site: BP #11109, Oakland

TestAmerica Job ID: 720-52469-1

### Glossary

Abbreviation	These commonly used abbreviations may or may not be present in this report.
▫	Listed under the "D" column to designate that the result is reported on a dry weight basis
%R	Percent Recovery
CNF	Contains no Free Liquid
DER	Duplicate error ratio (normalized absolute difference)
Dil Fac	Dilution Factor
DL, RA, RE, IN	Indicates a Dilution, Re-analysis, Re-extraction, or additional Initial metals/anion analysis of the sample
DLC	Decision level concentration
MDA	Minimum detectable activity
EDL	Estimated Detection Limit
MDC	Minimum detectable concentration
MDL	Method Detection Limit
ML	Minimum Level (Dioxin)
NC	Not Calculated
ND	Not detected at the reporting limit (or MDL or EDL if shown)
PQL	Practical Quantitation Limit
QC	Quality Control
RER	Relative error ratio
RL	Reporting Limit or Requested Limit (Radiochemistry)
RPD	Relative Percent Difference, a measure of the relative difference between two points
TEF	Toxicity Equivalent Factor (Dioxin)
TEQ	Toxicity Equivalent Quotient (Dioxin)

# Case Narrative

Client: ARCADIS U.S., Inc.  
Project/Site: BP #11109, Oakland

TestAmerica Job ID: 720-52469-1

---

**Job ID: 720-52469-1**

---

**Laboratory: TestAmerica Pleasanton**

---

**Narrative**

**Job Narrative**  
720-52469-1

**Comments**

No additional comments.

**Receipt**

The samples were received on 9/20/2013 12:35 PM; the samples arrived in good condition, properly preserved and, where required, on ice. The temperature of the cooler at receipt was 4.0° C.

**GC/MS VOA**

No analytical or quality issues were noted.



# Detection Summary

Client: ARCADIS U.S., Inc.  
 Project/Site: BP #11109, Oakland

TestAmerica Job ID: 720-52469-1

## Client Sample ID: MW-3

## Lab Sample ID: 720-52469-1

Analyte	Result	Qualifier	RL	MDL	Unit	Dil	Fac	D	Method	Prep Type
Methyl tert-butyl ether	4.1		0.50		ug/L	1			8260B/CA_LUFT MS	Total/NA

## Client Sample ID: MW-4

## Lab Sample ID: 720-52469-2

Analyte	Result	Qualifier	RL	MDL	Unit	Dil	Fac	D	Method	Prep Type
Methyl tert-butyl ether	21		0.50		ug/L	1			8260B/CA_LUFT MS	Total/NA
Gasoline Range Organics (GRO) -C6-C12	830		50		ug/L	1			8260B/CA_LUFT MS	Total/NA

## Client Sample ID: MW-6

## Lab Sample ID: 720-52469-3

Analyte	Result	Qualifier	RL	MDL	Unit	Dil	Fac	D	Method	Prep Type
Methyl tert-butyl ether	2.4		0.50		ug/L	1			8260B/CA_LUFT MS	Total/NA

## Client Sample ID: MW-7

## Lab Sample ID: 720-52469-4

Analyte	Result	Qualifier	RL	MDL	Unit	Dil	Fac	D	Method	Prep Type
MTBE	2.3		0.50		ug/L	1			8260B/CA_LUFT MS	Total/NA
Gasoline Range Organics (GRO) -C6-C12	580		50		ug/L	1			8260B/CA_LUFT MS	Total/NA

## Client Sample ID: MW-11

## Lab Sample ID: 720-52469-5

Analyte	Result	Qualifier	RL	MDL	Unit	Dil	Fac	D	Method	Prep Type
Benzene	120		10		ug/L	20			8260B/CA_LUFT MS	Total/NA
Ethylbenzene	320		10		ug/L	20			8260B/CA_LUFT MS	Total/NA
Toluene	130		10		ug/L	20			8260B/CA_LUFT MS	Total/NA
Xylenes, Total	720		20		ug/L	20			8260B/CA_LUFT MS	Total/NA
Gasoline Range Organics (GRO) -C6-C12	10000		1000		ug/L	20			8260B/CA_LUFT MS	Total/NA

This Detection Summary does not include radiochemical test results.

TestAmerica Pleasanton

# Client Sample Results

Client: ARCADIS U.S., Inc.  
 Project/Site: BP #11109, Oakland

TestAmerica Job ID: 720-52469-1

**Client Sample ID: MW-3**  
**Date Collected: 09/20/13 08:15**  
**Date Received: 09/20/13 12:35**

**Lab Sample ID: 720-52469-1**  
**Matrix: Water**

**Method: 8260B/CA\_LUFTMS - 8260B / CA LUFT MS**

Analyte	Result	Qualifier	RL	MDL	Unit	D	Prepared	Analyzed	Dil Fac
Methyl tert-butyl ether	4.1		0.50		ug/L			09/20/13 23:30	1
Surrogate	%Recovery	Qualifier	Limits				Prepared	Analyzed	Dil Fac
4-Bromofluorobenzene	91		67 - 130					09/20/13 23:30	1
1,2-Dichloroethane-d4 (Surr)	90		72 - 130					09/20/13 23:30	1
Toluene-d8 (Surr)	99		70 - 130					09/20/13 23:30	1



# Client Sample Results

Client: ARCADIS U.S., Inc.  
 Project/Site: BP #11109, Oakland

TestAmerica Job ID: 720-52469-1

**Client Sample ID: MW-4**  
**Date Collected: 09/20/13 08:50**  
**Date Received: 09/20/13 12:35**

**Lab Sample ID: 720-52469-2**  
**Matrix: Water**

**Method: 8260B/CA\_LUFTMS - 8260B / CA LUFT MS**

Analyte	Result	Qualifier	RL	MDL	Unit	D	Prepared	Analyzed	Dil Fac
Methyl tert-butyl ether	21		0.50		ug/L			09/21/13 00:53	1
Gasoline Range Organics (GRO) -C6-C12	830		50		ug/L			09/21/13 00:53	1
Surrogate	%Recovery	Qualifier	Limits				Prepared	Analyzed	Dil Fac
4-Bromofluorobenzene	101		67 - 130					09/21/13 00:53	1
1,2-Dichloroethane-d4 (Surr)	87		72 - 130					09/21/13 00:53	1
Toluene-d8 (Surr)	103		70 - 130					09/21/13 00:53	1





# Client Sample Results

Client: ARCADIS U.S., Inc.  
 Project/Site: BP #11109, Oakland

TestAmerica Job ID: 720-52469-1

**Client Sample ID: MW-6**

**Lab Sample ID: 720-52469-3**

**Date Collected: 09/20/13 08:00**

**Matrix: Water**

**Date Received: 09/20/13 12:35**

**Method: 8260B/CA\_LUFTMS - 8260B / CA LUFT MS**

Analyte	Result	Qualifier	RL	MDL	Unit	D	Prepared	Analyzed	Dil Fac
Methyl tert-butyl ether	2.4		0.50		ug/L			09/21/13 01:21	1
Surrogate	%Recovery	Qualifier	Limits				Prepared	Analyzed	Dil Fac
4-Bromofluorobenzene	93		67 - 130					09/21/13 01:21	1
1,2-Dichloroethane-d4 (Surr)	92		72 - 130					09/21/13 01:21	1
Toluene-d8 (Surr)	99		70 - 130					09/21/13 01:21	1



# Client Sample Results

Client: ARCADIS U.S., Inc.  
 Project/Site: BP #11109, Oakland

TestAmerica Job ID: 720-52469-1

**Client Sample ID: MW-7**  
**Date Collected: 09/20/13 08:35**  
**Date Received: 09/20/13 12:35**

**Lab Sample ID: 720-52469-4**  
**Matrix: Water**

**Method: 8260B/CA\_LUFTMS - 8260B / CA LUFT MS**

Analyte	Result	Qualifier	RL	MDL	Unit	D	Prepared	Analyzed	Dil Fac
<b>MTBE</b>	<b>2.3</b>		0.50		ug/L			09/21/13 01:49	1
Benzene	ND		0.50		ug/L			09/21/13 01:49	1
EDB	ND		0.50		ug/L			09/21/13 01:49	1
1,2-DCA	ND		0.50		ug/L			09/21/13 01:49	1
Ethylbenzene	ND		0.50		ug/L			09/21/13 01:49	1
Toluene	ND		0.50		ug/L			09/21/13 01:49	1
Xylenes, Total	ND		1.0		ug/L			09/21/13 01:49	1
<b>Gasoline Range Organics (GRO)</b>	<b>580</b>		50		ug/L			09/21/13 01:49	1
<b>-C6-C12</b>									
TBA	ND		10		ug/L			09/21/13 01:49	1
Ethanol	ND		250		ug/L			09/21/13 01:49	1
DIPE	ND		0.50		ug/L			09/21/13 01:49	1
TAME	ND		0.50		ug/L			09/21/13 01:49	1
Ethyl t-butyl ether	ND		0.50		ug/L			09/21/13 01:49	1
<b>Surrogate</b>	<b>%Recovery</b>	<b>Qualifier</b>	<b>Limits</b>				<b>Prepared</b>	<b>Analyzed</b>	<b>Dil Fac</b>
4-Bromofluorobenzene	98		67 - 130					09/21/13 01:49	1
1,2-Dichloroethane-d4 (Surr)	92		72 - 130					09/21/13 01:49	1
Toluene-d8 (Surr)	103		70 - 130					09/21/13 01:49	1

# Client Sample Results

Client: ARCADIS U.S., Inc.  
 Project/Site: BP #11109, Oakland

TestAmerica Job ID: 720-52469-1

**Client Sample ID: MW-11**

**Lab Sample ID: 720-52469-5**

**Date Collected: 09/20/13 09:05**

**Matrix: Water**

**Date Received: 09/20/13 12:35**

**Method: 8260B/CA\_LUFTMS - 8260B / CA LUFT MS**

Analyte	Result	Qualifier	RL	MDL	Unit	D	Prepared	Analyzed	Dil Fac
MTBE	ND		10		ug/L			09/21/13 02:17	20
<b>Benzene</b>	<b>120</b>		10		ug/L			09/21/13 02:17	20
EDB	ND		10		ug/L			09/21/13 02:17	20
1,2-DCA	ND		10		ug/L			09/21/13 02:17	20
<b>Ethylbenzene</b>	<b>320</b>		10		ug/L			09/21/13 02:17	20
<b>Toluene</b>	<b>130</b>		10		ug/L			09/21/13 02:17	20
<b>Xylenes, Total</b>	<b>720</b>		20		ug/L			09/21/13 02:17	20
<b>Gasoline Range Organics (GRO)</b>	<b>10000</b>		1000		ug/L			09/21/13 02:17	20
<b>-C6-C12</b>									
TBA	ND		200		ug/L			09/21/13 02:17	20
Ethanol	ND		5000		ug/L			09/21/13 02:17	20
DIPE	ND		10		ug/L			09/21/13 02:17	20
TAME	ND		10		ug/L			09/21/13 02:17	20
Ethyl t-butyl ether	ND		10		ug/L			09/21/13 02:17	20
<b>Surrogate</b>	<b>%Recovery</b>	<b>Qualifier</b>	<b>Limits</b>				<b>Prepared</b>	<b>Analyzed</b>	<b>Dil Fac</b>
4-Bromofluorobenzene	98		67 - 130					09/21/13 02:17	20
1,2-Dichloroethane-d4 (Surr)	88		72 - 130					09/21/13 02:17	20
Toluene-d8 (Surr)	102		70 - 130					09/21/13 02:17	20

# QC Sample Results

Client: ARCADIS U.S., Inc.  
Project/Site: BP #11109, Oakland

TestAmerica Job ID: 720-52469-1

## Method: 8260B/CA\_LUFTMS - 8260B / CA LUFT MS

**Lab Sample ID: MB 720-144672/4**

**Matrix: Water**

**Analysis Batch: 144672**

**Client Sample ID: Method Blank**

**Prep Type: Total/NA**

Analyte	MB Result	MB Qualifier	RL	MDL	Unit	D	Prepared	Analyzed	Dil Fac
Methyl tert-butyl ether	ND		0.50		ug/L			09/20/13 20:15	1
MTBE	ND		0.50		ug/L			09/20/13 20:15	1
Benzene	ND		0.50		ug/L			09/20/13 20:15	1
EDB	ND		0.50		ug/L			09/20/13 20:15	1
1,2-DCA	ND		0.50		ug/L			09/20/13 20:15	1
Ethylbenzene	ND		0.50		ug/L			09/20/13 20:15	1
Toluene	ND		0.50		ug/L			09/20/13 20:15	1
Xylenes, Total	ND		1.0		ug/L			09/20/13 20:15	1
Gasoline Range Organics (GRO) -C6-C12	ND		50		ug/L			09/20/13 20:15	1
TBA	ND		10		ug/L			09/20/13 20:15	1
Ethanol	ND		250		ug/L			09/20/13 20:15	1
DIPE	ND		0.50		ug/L			09/20/13 20:15	1
TAME	ND		0.50		ug/L			09/20/13 20:15	1
Ethyl t-butyl ether	ND		0.50		ug/L			09/20/13 20:15	1

Surrogate	MB %Recovery	MB Qualifier	Limits	Prepared	Analyzed	Dil Fac
4-Bromofluorobenzene	93		67 - 130		09/20/13 20:15	1
1,2-Dichloroethane-d4 (Surr)	90		72 - 130		09/20/13 20:15	1
Toluene-d8 (Surr)	101		70 - 130		09/20/13 20:15	1

**Lab Sample ID: LCS 720-144672/5**

**Matrix: Water**

**Analysis Batch: 144672**

**Client Sample ID: Lab Control Sample**

**Prep Type: Total/NA**

Analyte	Spike Added	LCS Result	LCS Qualifier	Unit	D	%Rec	%Rec. Limits
Methyl tert-butyl ether	25.0	24.4		ug/L		98	62 - 130
MTBE	25.0	24.4		ug/L		98	62 - 130

Surrogate	LCS %Recovery	LCS Qualifier	Limits
4-Bromofluorobenzene	98		67 - 130
1,2-Dichloroethane-d4 (Surr)	87		72 - 130
Toluene-d8 (Surr)	101		70 - 130

**Lab Sample ID: LCS 720-144672/7**

**Matrix: Water**

**Analysis Batch: 144672**

**Client Sample ID: Lab Control Sample**

**Prep Type: Total/NA**

Analyte	Spike Added	LCS Result	LCS Qualifier	Unit	D	%Rec	%Rec. Limits
Gasoline Range Organics (GRO) -C6-C12	500	510		ug/L		102	58 - 120

Surrogate	LCS %Recovery	LCS Qualifier	Limits
4-Bromofluorobenzene	97		67 - 130
1,2-Dichloroethane-d4 (Surr)	90		72 - 130
Toluene-d8 (Surr)	101		70 - 130

TestAmerica Pleasanton

# QC Sample Results

Client: ARCADIS U.S., Inc.  
Project/Site: BP #11109, Oakland

TestAmerica Job ID: 720-52469-1

## Method: 8260B/CA\_LUFTMS - 8260B / CA LUFT MS (Continued)

**Lab Sample ID: LCSD 720-144672/6**

**Matrix: Water**

**Analysis Batch: 144672**

**Client Sample ID: Lab Control Sample Dup**

**Prep Type: Total/NA**

Analyte	Spike Added	LCSD Result	LCSD Qualifier	Unit	D	%Rec	%Rec. Limits	RPD	RPD Limit
Methyl tert-butyl ether	25.0	25.6		ug/L		102	62 - 130	5	20
MTBE	25.0	25.6		ug/L		102	62 - 130	5	20
Benzene	25.0	23.4		ug/L		93	79 - 130	0	20
EDB	25.0	26.4		ug/L		106	70 - 130	3	20
1,2-DCA	25.0	23.0		ug/L		92	61 - 132	2	20
Ethylbenzene	25.0	22.8		ug/L		91	80 - 120	0	20
Toluene	25.0	23.0		ug/L		92	78 - 120	0	20
m-Xylene & p-Xylene	50.0	46.9		ug/L		94	70 - 142	0	20
o-Xylene	25.0	24.7		ug/L		99	70 - 130	1	20
TBA	500	442		ug/L		88	70 - 130	1	20
Ethanol	500	416		ug/L		83	31 - 216	4	30
DIPE	25.0	25.2		ug/L		101	69 - 134	2	20
TAME	25.0	27.7		ug/L		111	79 - 130	3	20
Ethyl t-butyl ether	25.0	26.1		ug/L		104	70 - 130	3	20

Surrogate	LCSD %Recovery	LCSD Qualifier	Limits
4-Bromofluorobenzene	96		67 - 130
1,2-Dichloroethane-d4 (Surr)	90		72 - 130
Toluene-d8 (Surr)	101		70 - 130

**Lab Sample ID: LCSD 720-144672/8**

**Matrix: Water**

**Analysis Batch: 144672**

**Client Sample ID: Lab Control Sample Dup**

**Prep Type: Total/NA**

Analyte	Spike Added	LCSD Result	LCSD Qualifier	Unit	D	%Rec	%Rec. Limits	RPD	RPD Limit
Gasoline Range Organics (GRO) -C6-C12	500	499		ug/L		100	58 - 120	2	20

Surrogate	LCSD %Recovery	LCSD Qualifier	Limits
4-Bromofluorobenzene	96		67 - 130
1,2-Dichloroethane-d4 (Surr)	89		72 - 130
Toluene-d8 (Surr)	102		70 - 130

**Lab Sample ID: 720-52469-1 MS**

**Matrix: Water**

**Analysis Batch: 144672**

**Client Sample ID: MW-3**

**Prep Type: Total/NA**

Analyte	Sample Result	Sample Qualifier	Spike Added	MS Result	MS Qualifier	Unit	D	%Rec	%Rec. Limits
Methyl tert-butyl ether	4.1		25.0	29.4		ug/L		101	60 - 138
MTBE	4.1		25.0	29.4		ug/L		101	60 - 138
Benzene	ND		25.0	23.3		ug/L		93	60 - 140
EDB	ND		25.0	26.1		ug/L		104	60 - 140
1,2-DCA	ND		25.0	23.1		ug/L		92	60 - 140
Ethylbenzene	ND		25.0	23.0		ug/L		92	60 - 140
Toluene	ND		25.0	23.1		ug/L		92	60 - 140
m-Xylene & p-Xylene	ND		50.0	47.4		ug/L		95	60 - 140
o-Xylene	ND		25.0	24.9		ug/L		99	60 - 140
TBA	ND		500	454		ug/L		91	60 - 140

TestAmerica Pleasanton

# QC Sample Results

Client: ARCADIS U.S., Inc.  
Project/Site: BP #11109, Oakland

TestAmerica Job ID: 720-52469-1

## Method: 8260B/CA\_LUFTMS - 8260B / CA LUFT MS (Continued)

**Lab Sample ID: 720-52469-1 MS**

**Matrix: Water**

**Analysis Batch: 144672**

**Client Sample ID: MW-3**

**Prep Type: Total/NA**

Analyte	Sample	Sample	Spike	MS	MS	Unit	D	%Rec	%Rec. Limits
	Result	Qualifier	Added	Result	Qualifier				
Ethanol	ND		500	442		ug/L		88	60 - 140
DIPE	ND		25.0	25.3		ug/L		101	60 - 140
TAME	ND		25.0	27.3		ug/L		109	60 - 140
Ethyl t-butyl ether	ND		25.0	25.9		ug/L		103	60 - 140

Surrogate	MS	MS	Limits
	%Recovery	Qualifier	
4-Bromofluorobenzene	97		67 - 130
1,2-Dichloroethane-d4 (Surr)	89		72 - 130
Toluene-d8 (Surr)	101		70 - 130

**Lab Sample ID: 720-52469-1 MSD**

**Matrix: Water**

**Analysis Batch: 144672**

**Client Sample ID: MW-3**

**Prep Type: Total/NA**

Analyte	Sample	Sample	Spike	MSD	MSD	Unit	D	%Rec	%Rec. Limits	RPD	RPD
	Result	Qualifier	Added	Result	Qualifier					RPD	Limit
Methyl tert-butyl ether	4.1		25.0	29.3		ug/L		101	60 - 138	0	20
MTBE	4.1		25.0	29.3		ug/L		101	60 - 138	0	20
Benzene	ND		25.0	23.4		ug/L		94	60 - 140	0	20
EDB	ND		25.0	26.1		ug/L		104	60 - 140	0	20
1,2-DCA	ND		25.0	22.9		ug/L		92	60 - 140	1	20
Ethylbenzene	ND		25.0	22.7		ug/L		91	60 - 140	1	20
Toluene	ND		25.0	22.8		ug/L		91	60 - 140	1	20
m-Xylene & p-Xylene	ND		50.0	46.9		ug/L		94	60 - 140	1	20
o-Xylene	ND		25.0	24.6		ug/L		98	60 - 140	1	20
TBA	ND		500	450		ug/L		90	60 - 140	1	20
Ethanol	ND		500	433		ug/L		87	60 - 140	2	20
DIPE	ND		25.0	25.2		ug/L		101	60 - 140	0	20
TAME	ND		25.0	27.4		ug/L		110	60 - 140	0	20
Ethyl t-butyl ether	ND		25.0	25.9		ug/L		103	60 - 140	0	20

Surrogate	MSD	MSD	Limits
	%Recovery	Qualifier	
4-Bromofluorobenzene	96		67 - 130
1,2-Dichloroethane-d4 (Surr)	90		72 - 130
Toluene-d8 (Surr)	101		70 - 130

TestAmerica Pleasanton

# QC Association Summary

Client: ARCADIS U.S., Inc.  
 Project/Site: BP #11109, Oakland

TestAmerica Job ID: 720-52469-1

## GC/MS VOA

### Analysis Batch: 144672

Lab Sample ID	Client Sample ID	Prep Type	Matrix	Method	Prep Batch
720-52469-1	MW-3	Total/NA	Water	8260B/CA_LUFT MS	
720-52469-1 MS	MW-3	Total/NA	Water	8260B/CA_LUFT MS	
720-52469-1 MSD	MW-3	Total/NA	Water	8260B/CA_LUFT MS	
720-52469-2	MW-4	Total/NA	Water	8260B/CA_LUFT MS	
720-52469-3	MW-6	Total/NA	Water	8260B/CA_LUFT MS	
720-52469-4	MW-7	Total/NA	Water	8260B/CA_LUFT MS	
720-52469-5	MW-11	Total/NA	Water	8260B/CA_LUFT MS	
LCS 720-144672/5	Lab Control Sample	Total/NA	Water	8260B/CA_LUFT MS	
LCS 720-144672/7	Lab Control Sample	Total/NA	Water	8260B/CA_LUFT MS	
LCSD 720-144672/6	Lab Control Sample Dup	Total/NA	Water	8260B/CA_LUFT MS	
LCSD 720-144672/8	Lab Control Sample Dup	Total/NA	Water	8260B/CA_LUFT MS	
MB 720-144672/4	Method Blank	Total/NA	Water	8260B/CA_LUFT MS	

# Lab Chronicle

Client: ARCADIS U.S., Inc.  
Project/Site: BP #11109, Oakland

TestAmerica Job ID: 720-52469-1

## Client Sample ID: MW-3

Date Collected: 09/20/13 08:15

Date Received: 09/20/13 12:35

## Lab Sample ID: 720-52469-1

Matrix: Water

Prep Type	Batch Type	Batch Method	Run	Dilution Factor	Batch Number	Prepared or Analyzed	Analyst	Lab
Total/NA	Analysis	8260B/CA_LUFTMS		1	144672	09/20/13 23:30	PDR	TAL PLS

## Client Sample ID: MW-4

Date Collected: 09/20/13 08:50

Date Received: 09/20/13 12:35

## Lab Sample ID: 720-52469-2

Matrix: Water

Prep Type	Batch Type	Batch Method	Run	Dilution Factor	Batch Number	Prepared or Analyzed	Analyst	Lab
Total/NA	Analysis	8260B/CA_LUFTMS		1	144672	09/21/13 00:53	PDR	TAL PLS

## Client Sample ID: MW-6

Date Collected: 09/20/13 08:00

Date Received: 09/20/13 12:35

## Lab Sample ID: 720-52469-3

Matrix: Water

Prep Type	Batch Type	Batch Method	Run	Dilution Factor	Batch Number	Prepared or Analyzed	Analyst	Lab
Total/NA	Analysis	8260B/CA_LUFTMS		1	144672	09/21/13 01:21	PDR	TAL PLS

## Client Sample ID: MW-7

Date Collected: 09/20/13 08:35

Date Received: 09/20/13 12:35

## Lab Sample ID: 720-52469-4

Matrix: Water

Prep Type	Batch Type	Batch Method	Run	Dilution Factor	Batch Number	Prepared or Analyzed	Analyst	Lab
Total/NA	Analysis	8260B/CA_LUFTMS		1	144672	09/21/13 01:49	PDR	TAL PLS

## Client Sample ID: MW-11

Date Collected: 09/20/13 09:05

Date Received: 09/20/13 12:35

## Lab Sample ID: 720-52469-5

Matrix: Water

Prep Type	Batch Type	Batch Method	Run	Dilution Factor	Batch Number	Prepared or Analyzed	Analyst	Lab
Total/NA	Analysis	8260B/CA_LUFTMS		20	144672	09/21/13 02:17	PDR	TAL PLS

### Laboratory References:

TAL PLS = TestAmerica Pleasanton, 1220 Quarry Lane, Pleasanton, CA 94566, TEL (925)484-1919



# Certification Summary

Client: ARCADIS U.S., Inc.  
Project/Site: BP #11109, Oakland

TestAmerica Job ID: 720-52469-1

## Laboratory: TestAmerica Pleasanton

All certifications held by this laboratory are listed. Not all certifications are applicable to this report.

Authority	Program	EPA Region	Certification ID	Expiration Date
California	State Program	9	2496	01-31-14

- 1
- 2
- 3
- 4
- 5
- 6
- 7
- 8
- 9
- 10
- 11
- 12
- 13
- 14

# Method Summary

Client: ARCADIS U.S., Inc.  
Project/Site: BP #11109, Oakland

TestAmerica Job ID: 720-52469-1

Method	Method Description	Protocol	Laboratory
8260B/CA_LUFTM S	8260B / CA LUFT MS	SW846	TAL PLS

**Protocol References:**

SW846 = "Test Methods For Evaluating Solid Waste, Physical/Chemical Methods", Third Edition, November 1986 And Its Updates.

**Laboratory References:**

TAL PLS = TestAmerica Pleasanton, 1220 Quarry Lane, Pleasanton, CA 94566, TEL (925)484-1919

- 1
- 2
- 3
- 4
- 5
- 6
- 7
- 8
- 9
- 10
- 11
- 12
- 13
- 14

# Sample Summary

Client: ARCADIS U.S., Inc.  
Project/Site: BP #11109, Oakland

TestAmerica Job ID: 720-52469-1

Lab Sample ID	Client Sample ID	Matrix	Collected	Received
720-52469-1	MW-3	Water	09/20/13 08:15	09/20/13 12:35
720-52469-2	MW-4	Water	09/20/13 08:50	09/20/13 12:35
720-52469-3	MW-6	Water	09/20/13 08:00	09/20/13 12:35
720-52469-4	MW-7	Water	09/20/13 08:35	09/20/13 12:35
720-52469-5	MW-11	Water	09/20/13 09:05	09/20/13 12:35

- 1
- 2
- 3
- 4
- 5
- 6
- 7
- 8
- 9
- 10
- 11
- 12
- 13
- 14

**San Francisco**  
1220 Quarry Lane

Pleasanton, CA 94566  
phone 925.484.1919 fax 925.600.3002

**Chain of Custody Record**  
**720-52469**

**TestAmerica**  
THE LEADER IN ENVIRONMENTAL TESTING  
14876  
TestAmerica Laboratories, Inc.

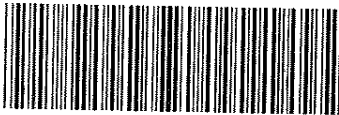
<b>Client Contact</b> Broadbent & Associates, Inc. 875 Cotting Lane, Suite G Vacaville, CA 95688 Phone: 707-455-7290 Fax: 707-455-7295 Project Name: Arcadis 11109 4280 Foothill Blvd., Oakland, CA P O # GP09BPNA.C106		<b>Project Manager: Kristene Tidwell</b> Tel/Fax: 707-455-7290 / 707-455-7295		<b>Site Contact/Sampler: Alex Martinez</b> Date:		<b>Lab Contact: Dimple Sharma</b> Carrier:		<b>COC No:</b> _____ of _____ COCs	
		<b>Analysis Turnaround Time</b> Calendar (C) or Work Days (W) _____ TAT if different from Below _____ <input checked="" type="checkbox"/> 2 weeks <input type="checkbox"/> 1 week <input type="checkbox"/> 2 days <input type="checkbox"/> 1 day		Filtered Sample GRO by 8260B BTEX/5 FO & EDB by 8260 1,2-DCA & Ethanol by 8260 MTBE by 8260B				Job No.	
								SDG No.	
								Sample Specific Notes:	
<b>Sample Identification</b>	<b>Sample Date</b>	<b>Sample Time</b>	<b>Sample Type</b>	<b>Matrix</b>	<b># of Cont.</b>				
MW-3	9/20/2013	0815	GRAB	AQ	3			X	
MW-4	9/20/2013	0850	GRAB	AQ	3	X		X	
MW-6	9/20/2013	0800	GRAB	AQ	3			X	
MW-7	9/20/2013	0835	GRAB	AQ	3	X	X	X	
MW-11	9/20/2013	0905	GRAB	AQ	3	X	X	X	
TB-11109-09202013	--	--	--	AQ	2				On Hold
 720-52469 Chain of Custody									
<b>Preservation Used:</b> 1= Ice, 2= HCl; 3= H2SO4; 4=HNO3; 5=NaOH; 6= Other _____									
<b>Possible Hazard Identification</b> <input type="checkbox"/> Non-Hazard <input type="checkbox"/> Flammable <input type="checkbox"/> Skin Irritant <input type="checkbox"/> Poison B <input type="checkbox"/> Unknown						<b>Sample Disposal ( A fee may be assessed if samples are retained longer than 1 month)</b> <input type="checkbox"/> Return To Client <input type="checkbox"/> Disposal By Lab                   Archive for _____ Months			
<b>Special Instructions:</b>									
Relinquished by: <i>Alex Martinez</i>		Company: Broadbent & Associates		Date/Time: 9/20/13/1235		Received by: <i>Don Mulla</i>		Company: Test America	
Relinquished by:		Company:		Date/Time:		Received by:		Company:	
Relinquished by:		Company:		Date/Time:		Received by:		Company:	

4.02

9-20-13 1235

## Login Sample Receipt Checklist

Client: ARCADIS U.S., Inc.

Job Number: 720-52469-1

**Login Number: 52469**

**List Source: TestAmerica Pleasanton**

**List Number: 1**

**Creator: Mullen, Joan**

Question	Answer	Comment
Radioactivity wasn't checked or is $\leq$ background as measured by a survey meter.	N/A	
The cooler's custody seal, if present, is intact.	N/A	
Sample custody seals, if present, are intact.	N/A	
The cooler or samples do not appear to have been compromised or tampered with.	True	
Samples were received on ice.	True	
Cooler Temperature is acceptable.	True	
Cooler Temperature is recorded.	True	
COC is present.	True	
COC is filled out in ink and legible.	True	
COC is filled out with all pertinent information.	True	
Is the Field Sampler's name present on COC?	True	
There are no discrepancies between the containers received and the COC.	True	
Samples are received within Holding Time.	True	
Sample containers have legible labels.	True	
Containers are not broken or leaking.	True	
Sample collection date/times are provided.	True	
Appropriate sample containers are used.	True	
Sample bottles are completely filled.	True	
Sample Preservation Verified.	N/A	
There is sufficient vol. for all requested analyses, incl. any requested MS/MSDs	True	
Containers requiring zero headspace have no headspace or bubble is $<6\text{mm}$ (1/4").	True	
Multiphasic samples are not present.	True	
Samples do not require splitting or compositing.	True	
Residual Chlorine Checked.	N/A	





**Appendix D**

GeoTracker Upload Confirmation Receipts

STATE WATER RESOURCES CONTROL BOARD  
**GEOTRACKER ESI**

## UPLOADING A GEO\_REPORT FILE

**SUCCESS**

Your GEO\_REPORT file has been successfully submitted!

<b><u>Submittal Type:</u></b>	<b>GEO_REPORT</b>
<b><u>Report Title:</u></b>	<b>Second and Third Quarter 2013 Semi-Annual Groundwater Monitoring Report 111615</b>
<b><u>Report Type:</u></b>	<b>Monitoring Report - Semi-Annually</b>
<b><u>Report Date:</u></b>	<b>10/30/2013</b>
<b><u>Facility Global ID:</u></b>	<b>T0600100217</b>
<b><u>Facility Name:</u></b>	<b>BP #11109</b>
<b><u>File Name:</u></b>	<b>RO0000426_GWM_R_2013-10-30.pdf</b>
<b><u>Organization Name:</u></b>	<b>ARCADIS</b>
<b><u>Username:</u></b>	<b>ARCADISBP</b>
<b><u>IP Address:</u></b>	<b>108.171.135.188</b>
<b><u>Submittal Date/Time:</u></b>	<b>11/16/2015 12:24:07 PM</b>
<b><u>Confirmation Number:</u></b>	<b>7276472628</b>

Copyright © 2015 State of California