



Atlantic Richfield Company
(a BP affiliated company)

6 Centerpointe Drive, Room 172
La Palma, CA 90623-1066
Phone: (714) 670-5303
Fax: (714) 670-5195



October 28, 2005

Re: Second Semiannual 2005 Groundwater Monitoring Report
Former BP Service Station #11109
4280 Foothill Boulevard
Oakland, California
Regulatory Case No.: R00000102

"I declare, that to the best of my knowledge at the present time, that the information and/or recommendations contained in the attached document are true and correct.

Submitted by:

Kyle Christie
Environmental Business Manager



October 28, 2005

Ms. Donna Drogos
Alameda County Health Care Services Agency
1131 Harbor Bay Parkway, Suite 250
Alameda, CA 94502

Re: **Second Semiannual 2005 Groundwater Monitoring Report
Former BP Service Station #11109
4280 Foothill Boulevard
Oakland, California
Regulatory Case No.: RO0000102**

Dear Ms. Drogos:

On behalf of the Atlantic Richfield Company (a BP affiliated company), URS Corporation (URS) is submitting the *Second Semiannual 2005 Groundwater Monitoring Report* for the Former BP Service Station #11109, located at 4280 Foothill Boulevard, Oakland, California.

If you have any questions regarding this submission, please call me at (510) 874-1758.

Sincerely,

URS CORPORATION

Lynelle Onishi
Project Manager

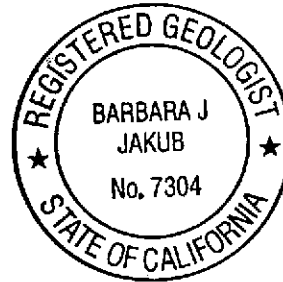

Barbara J. Jakub, P.G.
Senior Geologist

Enclosure: Second Semiannual 2005 Groundwater Monitoring Report

cc: Mr. Kyle Christie, Atlantic Richfield Company (RM), electronic copy uploaded to ENFOS
Ms. Shelby Lathrop, Conoco Phillips, electronic copy uploaded to URS ftp server
Mr. Chris Jimmerson, Delta Environmental Consulting, electronic copy uploaded to ENFOS

REPORT

SECOND SEMIANNUAL 2005 GROUNDWATER MONITORING REPORT

FORMER BP SERVICE STATION #11109
4280 FOOTHILL BOULEVARD
OAKLAND, CALIFORNIA

Prepared for
RM

October 28, 2005

URS

URS Corporation
1333 Broadway, Suite 800
Oakland, California 94612

Date: October 28, 2005

Quarter: 3Q 05

SECOND SEMIANNUAL 2005 GROUNDWATER MONITORING REPORT

Facility No.: 11109 Address: 4280 Foothill Blvd., Oakland, CA
RM Environmental Business Manager: Kyle Christie
Consulting Co./Contact Person: URS Corporation / Lynelle Onishi
Primary Agency: Alameda County Health Care Services Agency
Regulatory Case No.: RO0000102

WORK PERFORMED THIS QUARTER (Third - 2005):

1. Prepared and submitted the Second Quarter 2005 Status Report.
2. Performed the second semiannual 2005 groundwater monitoring event on September 6, 2005.
3. Performed monthly free product gauging and bailing of well MW-5 on July 2, August 24, and September 6, 2005.
4. Resurveyed wells on September 16, 2005.

WORK PROPOSED FOR NEXT QUARTER (Fourth - 2005):

1. Prepare and submit this Second Semiannual 2005 groundwater monitoring report.
2. Prepare and submit Fourth Quarter 2005 Status Report.
3. Perform monthly free product gauging and bailing of well MW-5.

Current Phase of Project: GW monitoring / sampling/ Free Product (FP) bailing
Frequency of Groundwater Sampling: Semi-annually: MW-2, MW-4, MW-5, MW-7 (1Q/3Q)
Annually: Wells MW-8, MW-9, MW-3, MW-6 (1Q)
Frequency of Groundwater Monitoring: Semi-annually
Current Remediation Techniques: Monthly FP bailing in MW-5
FP Removed this Quarter: 0.119 gallons
Cumulative FP Removed: 1.358 gallons
Approximate Depth to Groundwater: 10.81 (MW-3) to 14.64 (MW-4) feet
Groundwater Gradient (direction): Southwest
Groundwater Gradient (magnitude): 0.05 feet per foot

DISCUSSION:

A total of 0.119 gallons of free product was removed from well MW-5 during the September 6, 2005 monthly bailing event. No free product was observed during the July and August 2005 bailing events. Gasoline range organics were detected at or above the laboratory reporting limit in both of the wells sampled this quarter at concentrations of 81 micrograms per liter ($\mu\text{g/L}$) (MW-4) and 1,100 $\mu\text{g/L}$ (MW-7). Benzene, toluene,

ethylbenzene, tert-butyl alcohol and di-isopropyl ether were detected at or above their respective laboratory reporting limits in one well (MW-7) at concentrations of 130 µg/L, 1.2 µg/L, 1.8 µg/L, 30 µg/L and 0.6 µg/L, respectively. Methyl tert-butyl ether was detected at or above the laboratory reporting limit in both of the wells sampled at concentrations of 16 µg/L (MW-7) and 180 µg/L (MW-4). Tert-amyl methyl ether was detected at or above laboratory reporting limit in one well (MW-4) at a concentration of 2.8 µg/L. No other fuel components were detected at or above their respective laboratory reporting limits this quarter.

Well MW-2 was not sampled due to the well casing being obstructed by an unknown object at approximately 12.88 feet, as noted in the First Quarter 2005 Groundwater Monitoring Report. Well MW-5 was not sampled as free product was present in the well.

The site wells were re-surveyed on September 16, 2005, to assist in confirming the groundwater flow direction at the site.

The groundwater flow direction is to the southwest at a hydraulic gradient of 0.05 feet per foot.

ATTACHMENTS:

- Figure 1 – Groundwater Elevation Contour and Analytical Summary Map – September 6, 2005
- Table 1 – Groundwater Elevation and Analytical Data
- Table 2 – Fuel Additives Analytical Data
- Table 3 – Free Product Removal
- Attachment A – Field Procedures and Field Data Sheets
- Attachment B – Laboratory Procedures, Certified Analytical Reports, and Chain-of-Custody Records
- Attachment C – Error Check Reports and EDF/Geowell Submittal Confirmations
- Attachment D – Joint Monitoring Data
- Attachment E – Well Survey Data

Oct 28, 2005 - 5:36pm
 X:\x_env\waste\BP_GEM\Sites\Nites_Sites\1109\Reports\Monitoring\2005_Q3\Drawings\1109-3005-GW.dwg

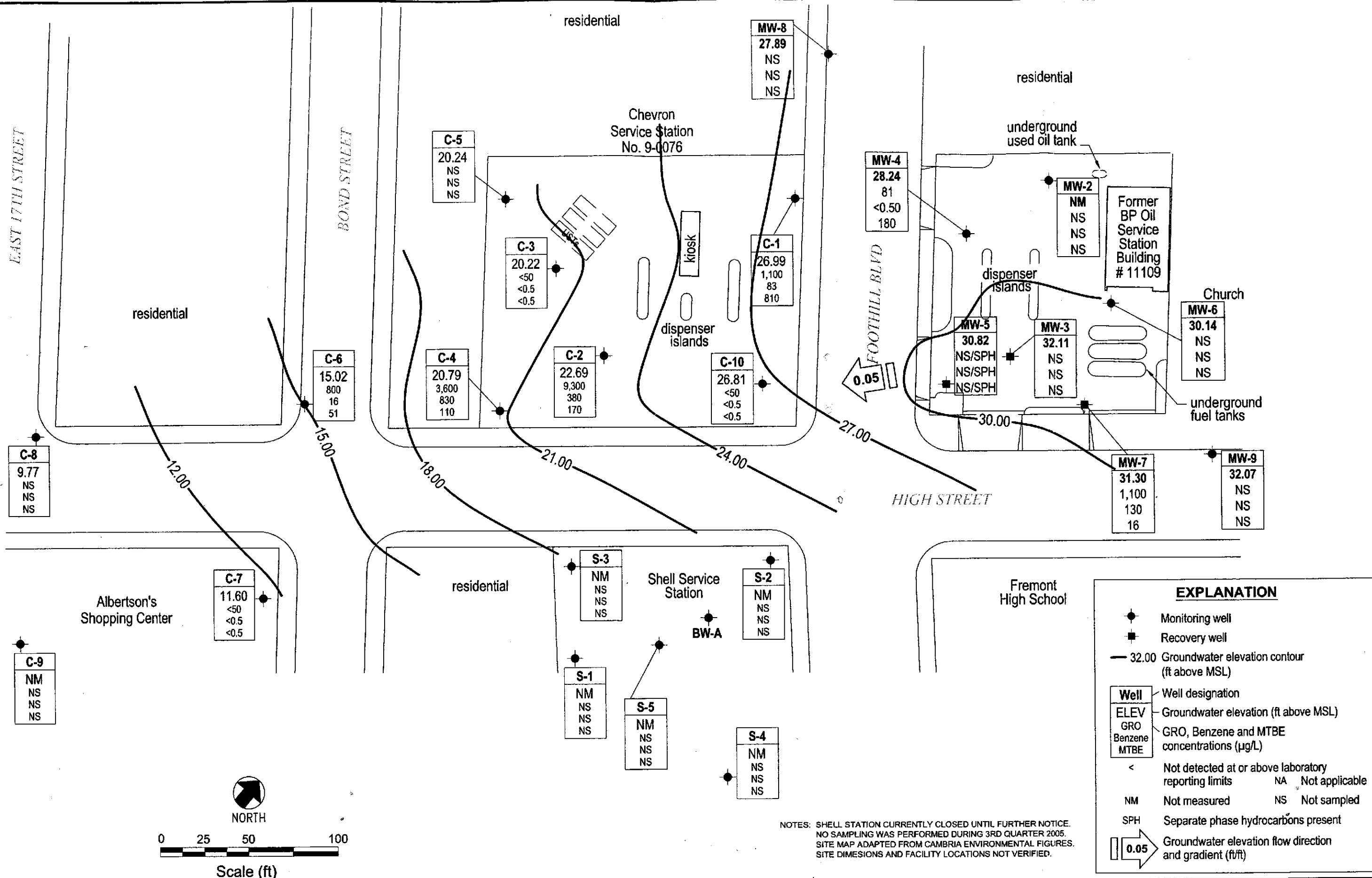

NOTES: SHELL STATION CURRENTLY CLOSED UNTIL FURTHER NOTICE.
 NO SAMPLING WAS PERFORMED DURING 3RD QUARTER 2005.
 SITE MAP ADAPTED FROM CAMBRIA ENVIRONMENTAL FIGURES.
 SITE DIMENSIONS AND FACILITY LOCATIONS NOT VERIFIED.

URS	Project No. 38487248	GROUNDWATER ELEVATION CONTOUR AND ANALYTICAL SUMMARY MAP	FIGURE
	Former BP Service Station #11109 4280 Foothill Boulevard Oakland, California		
		Third Quarter 2005 (September 6, 2005)	

Table 1

Groundwater Elevation and Analytical Data
Former BP Station #11109
4280 Foothill Blvd., Oakland, CA

Well No.	Date	P/ NP	Foot Note	TOC (ft MSL)	DTW (ft bgs)	Product Thickness (feet)	GWE (ft MSL)	GRO/ TPH-g (µg/L)	Benzene (µg/L)	Toluene (µg/L)	Ethyl-benzene (µg/L)	Total Xylenes (µg/L)	MTBE (µg/L)	DO (mg/L)	Lab	pH	DRO/ TPH-d (µg/L)	TOG (µg/L)	HVOC (µg/L)
MW-1	1/31/1990	--	--	38.19	15.41	--	22.78	--	--	--	--	--	--	--	--	--	--	--	--
	2/5/1990	--	c	38.19		--		--	--	--	--	--	--	--	--	--	--	--	--
MW-2	2/5/1990	--	--	41.22	21.90	--	19.31	1,300	14	<0.1	9	13	--	--	SUP	--	--	--	--
	2/14/1991	--	d	41.22	21.16	--	20.06	<50	<0.3	<0.3	<0.3	<0.3	--	--	SUP	--	<10000	<5000	51
	5/13/1991	--	e	41.22	21.32	--	19.90	<50	<0.3	<0.3	<0.3	<0.3	--	--	SUP	--	<50	6,000	0.5
	7/24/1991	--	--	41.22	22.92	--	18.30	--	--	--	--	--	--	--	--	--	--	--	--
	10/3/1991	--	e	41.22	24.90	--	16.32	<50	<0.3	0.8	<0.3	<0.3	--	--	SUP	--	<50	<5000	0.7
	10/15/1991	--	--	41.22	24.10	--	17.12	--	--	--	--	--	--	--	--	--	--	--	--
	12/4/1991	--	f	41.22	--	--	--	--	--	--	--	--	--	--	--	--	--	--	--
	12/16/1991	--	--	41.22	23.95	--	17.27	--	--	--	--	--	--	--	--	--	--	--	--
	1/6/1992	--	--	41.22	23.30	--	17.92	<50	<0.3	<0.3	<0.3	<0.3	--	--	--	--	--	--	--
	1/22/1992	--	--	41.22	23.14	--	18.08	--	--	--	--	--	--	--	ANA	--	<50	<5000	ND
	1/28/1992	--	--	41.22	22.99	--	18.23	--	--	--	--	--	--	--	--	--	--	--	--
	2/5/1992	--	--	41.22	22.63	--	18.59	--	--	--	--	--	--	--	--	--	--	--	--
	2/12/1992	--	--	41.22	22.04	--	19.18	--	--	--	--	--	--	--	--	--	--	--	--
	2/17/1992	--	--	41.22	20.84	--	20.38	--	--	--	--	--	--	--	--	--	--	--	--
	4/3/1992	--	--	41.22	18.29	--	22.93	--	--	--	--	--	--	--	--	--	--	--	--
	4/8/1992	--	--	41.22	18.86	--	22.36	<50	<0.5	<0.5	<0.5	<0.5	--	--	ANA	--	63	<5000	ND
	4/14/1992	--	--	41.22	19.45	--	21.77	--	--	--	--	--	--	--	--	--	--	--	--
	4/29/1992	--	--	41.22	20.35	--	20.87	--	--	--	--	--	--	--	--	--	--	--	--
	5/7/1992	--	--	41.22	20.84	--	20.38	--	--	--	--	--	--	--	--	--	--	--	--
	7/3/1992	--	--	41.22	22.34	--	18.88	<50	<0.5	<0.5	<0.5	<0.5	--	--	--	--	--	--	--
	10/8/1992	--	--	41.22	23.73	--	17.49	<50	<0.5	<0.5	<0.5	<0.5	--	--	ANA	--	--	--	--
	12/31/1992	--	--	41.22	21.12	--	20.10	<50	<0.5	<0.5	<0.5	<0.5	--	--	ANA	--	--	--	--
	4/21/1993	--	g, n	41.22	17.68	--	23.54	<50	<0.5	<0.5	<0.5	<0.5	--	--	ANA	--	--	--	--
	7/7/1993	--	e, n	41.22	20.30	--	20.92	<50	<0.5	<0.5	<0.5	<0.5	--	--	PACE	--	<50	<5000	ND
	9/21/1993	--	n	41.22	21.93	--	19.29	<50	0.9	0.7	0.7	2.6	21.54	--	PACE	--	--	--	1.0
	12/17/1993	--	--	41.22	21.48	--	19.74	--	--	--	--	--	--	--	--	--	--	--	--
	12/23/1993	--	n	41.22	--	--	--	<50	<0.5	<0.5	<0.5	0.7	--	--	--	--	--	--	--
	4/7/1994	--	n	41.22	20.25	--	20.97	<50	<0.5	<0.5	<0.5	<0.5	12.2	5.9	PACE	--	--	--	--
	7/6/1994	--	n	41.22	20.59	--	20.63	<50	<0.5	<0.5	<0.5	<0.5	--	3.1	PACE	--	--	--	--
	10/7/1994	--	n	41.22	22.04	--	19.18	<50	<0.5	<0.5	<0.5	<0.5	15.2	2.8	PACE	--	--	--	--
	1/27/1995	--	--	41.22	26.12	--	15.10	<50	<0.5	<0.5	<0.5	<0.5	--	4.8	ATI	--	440	<5000	--
	3/30/1995	--	--	41.22	12.34	--	28.88	<50	<0.50	<0.50	<0.50	<1.0	--	7.2	ATI	--	--	--	--

Table 1

Groundwater Elevation and Analytical Data
Former BP Station #11109
4280 Foothill Blvd., Oakland, CA

Well No.	Date	P/ NP	Foot Note	TOC (ft MSL)	DTW (ft bgs)	Product Thickness (feet)	GWE (ft MSL)	GRO/ TPH-g (µg/L)	Benzene (µg/L)	Toluene (µg/L)	Ethyl-benzene (µg/L)	Total Xylenes (µg/L)	MTBE (µg/L)	DO (mg/L)	Lab	pH	DRO/ TPH-d (µg/L)	TOG (µg/L)	HVOC (µg/L)
MW-2	6/20/1995	--	--	41.22	16.42	--	24.80	<50	<0.50	<0.50	<0.50	<1.0	--	6.0	ATI	--	--	--	--
	10/3/1995	--	--	41.22	20.06	--	21.16	<50	<0.50	<0.50	<0.50	<1.0	<5.0	5.7	ATI	--	--	--	--
	12/6/1995	--	--	41.22	21.31	--	19.91	<50	<0.50	<0.50	<0.50	<1.0	46	5.4	ATI	--	--	--	--
	3/21/1996	--	--	41.22	12.28	--	28.94	<50	<0.5	<1.0	<1.0	<1.0	<1.0	7.4	SPL	--	--	--	--
	6/21/1996	--	--	41.22	13.28	--	27.94	<50	<0.5	<1	<1	<1	<10	7.3	SPL	--	--	--	--
	9/6/1996	--	--	41.22	13.94	--	27.28	--	--	--	--	--	--	--	--	--	--	--	--
	9/9/1996	--	--	41.22	--	--	--	<50	<0.5	<1.0	<1.0	<1.0	<10	7.4	SPL	--	--	--	--
	12/19/1996	--	--	41.22	12.19	--	29.03	<50	<0.5	<1.0	<1.0	<1.0	<10	7.9	SPL	--	--	--	--
	3/17/1997	--	--	41.22	11.59	--	29.63	--	--	--	--	--	--	--	--	--	--	--	--
	8/12/1997	--	--	41.22	13.21	--	28.01	--	--	--	--	--	--	--	--	--	--	--	--
	12/10/1997	--	--	41.22	12.34	--	28.88	--	--	--	--	--	--	--	--	--	--	--	--
	3/12/1998	--	--	41.22	11.04	--	30.18	--	--	--	--	--	--	--	--	--	--	--	--
	6/23/1998	--	--	41.22	11.77	--	29.45	--	--	--	--	--	--	--	--	--	--	--	--
	3/31/1999	--	--	41.22	12.38	--	28.84	--	--	--	--	--	--	--	--	--	--	--	--
	8/25/1999	--	--	41.22	17.72	--	23.50	--	--	--	--	--	--	--	--	--	--	--	--
	3/9/2000	--	--	41.22	11.94	--	29.28	--	--	--	--	--	--	--	--	--	--	--	--
	3/8/2001	--	--	41.22	10.31	--	30.91	--	--	--	--	--	--	--	--	--	--	--	--
	3/8/2002	--	--	41.22	14.35	--	26.87	--	--	--	--	--	--	--	--	--	--	--	--
	3/18/2002	--	--	41.22	13.11	--	28.11	--	--	--	--	--	--	--	--	--	--	--	--
	3/11/2003	--	--	41.22	13.24	--	27.98	--	--	--	--	--	--	--	--	--	--	--	--
	12/09/2003	P	q	41.22	18.58	--	22.64	350	<0.50	<0.50	0.56	2.8	24	--	SEQM	6.2	--	--	--
	03/09/2004	P	--	41.22	12.52	--	28.70	74	<0.50	<0.50	0.83	4.7	27	--	SEQM	6.5	--	--	--
	09/17/2004	P	--	41.22	18.05	--	23.17	59	<0.50	<0.50	<0.50	<0.50	21	--	SEQM	6.3	--	--	--
	03/07/2005	--	p	41.22	2.32	--	38.90	--	--	--	--	--	--	--	--	--	--	--	--
	09/06/2005	--	r	41.22	--	--	--	--	--	--	--	--	--	--	--	--	--	--	--
MW-3	2/5/1990	--	--	40.74	17.45	--	23.29	1,400	15	<2.5	11	8	--	--	SUP	--	--	--	--
	2/14/1991	--	--	40.74	18.52	--	22.22	320	8	<0.3	8	1	--	--	SUP	--	--	--	--
	5/13/1991	--	--	40.74	19.32	--	21.42	640	13	<0.3	18	1	--	--	SUP	--	--	--	--
	7/24/1991	--	--	40.74	20.69	--	20.05	--	--	--	--	--	--	--	--	--	--	--	--
	10/3/1991	--	--	40.74	19.47	--	21.27	940	21	<0.3	23	2.1	--	--	SUP	--	--	--	--
	10/15/1991	--	--	40.74	20.46	--	20.28	--	--	--	--	--	--	--	--	--	--	--	--
	12/4/1991	--	--	40.74	18.29	--	22.45	--	--	--	--	--	--	--	--	--	--	--	--
	12/16/1991	--	--	40.74	18.34	--	22.40	--	--	--	--	--	--	--	--	--	--	--	--
	1/6/1992	--	--	40.74	18.50	--	22.24	580	6.1	1	6.1	7.1	--	--	ANA	--	--	--	--

Table 1

Groundwater Elevation and Analytical Data
Former BP Station #11109
4280 Foothill Blvd., Oakland, CA

Well No.	Date	P/ NP	Foot Note	TOC (ft MSL)	DTW (ft bgs)	Product Thickness (feet)	GWE (ft MSL)	GRO/ TPH-g (µg/L)	Benzene (µg/L)	Toluene (µg/L)	Ethyl-benzene (µg/L)	Total Xylenes (µg/L)	MTBE (µg/L)	DO (mg/L)	Lab	pH	DRO/ TPH-d (µg/L)	TOG (µg/L)	HVOC (µg/L)
MW-3	1/22/1992	--	--	40.74	17.86	--	22.88	--	--	--	--	--	--	--	--	--	--	--	--
	1/28/1992	--	--	40.74	15.84	--	24.90	--	--	--	--	--	--	--	--	--	--	--	--
	2/5/1992	--	--	40.74	17.53	--	23.21	--	--	--	--	--	--	--	--	--	--	--	--
	2/12/1992	--	--	40.74	17.15	--	23.59	--	--	--	--	--	--	--	--	--	--	--	--
	2/17/1992	--	--	40.74	16.18	--	24.56	--	--	--	--	--	--	--	--	--	--	--	--
	4/3/1992	--	--	40.74	14.80	--	25.94	--	--	--	--	--	--	--	--	--	--	--	--
	4/8/1992	--	--	40.74	17.06	--	23.68	1,100	30	4.6	32	11	--	--	ANA	--	--	--	--
	4/14/1992	--	--	40.74	15.22	--	25.52	--	--	--	--	--	--	--	--	--	--	--	--
	4/29/1992	--	--	40.74	15.90	--	24.84	--	--	--	--	--	--	--	--	--	--	--	--
	5/7/1992	--	--	40.74	16.35	--	24.39	--	--	--	--	--	--	--	--	--	--	--	--
	7/3/1992	--	--	40.74	17.74	--	23.00	1,200	38	<2.5	24	<2.5	--	--	ANA	--	--	--	--
	10/8/1992	--	--	40.74	19.06	--	21.68	1,400	31	<0.5	25	13	--	--	ANA	--	--	--	--
	12/31/1992	--	h	40.74	--	--	--	960	11	3.6	10	3.8	--	--	ANA	--	--	--	--
	12/31/1992	--	--	40.74	16.61	--	24.13	820	12	4.1	13	5.9	--	--	ANA	--	--	--	--
	4/21/1993	--	h, n	40.74	--	--	--	390	5	<0.5	3.7	1.5	--	--	PACE	--	--	--	--
	4/21/1993	--	n	40.74	14.24	--	26.50	420	5.6	<0.5	3.9	1.4	--	--	PACE	--	--	--	--
	7/7/1993	--	i, n	40.13	15.19	--	24.94	54	0.6	0.6	<0.5	<0.5	12.68	--	PACE	--	--	--	--
	9/21/1993	--	n	40.13	16.58	--	23.55	540	7.9	0.9	4.7	2.4	--	--	PACE	--	--	--	--
	12/17/1993	--	--	40.13	15.82	--	24.31	--	--	--	--	--	--	--	--	--	--	--	--
	12/23/1993	--	h	40.13	--	--	--	480	9.2	<0.5	5.4	5.3	--	--	PACE	--	--	--	--
	12/23/1993	--	n	40.13	--	--	--	500	9.8	1.5	3.3	2.1	--	--	PACE	--	--	--	--
	4/7/1994	--	h	40.13	--	--	--	460	20	7.7	9	11	--	--	PACE	--	--	--	--
	4/7/1994	--	n	40.13	28.50	--	11.63	460	20	7.4	8.9	11	18.2	--	PACE	--	--	--	--
	7/6/1994	--	n	40.13	--	--	--	300	10	0.6	1.7	6.4	5.54	4.8	PACE	--	--	--	--
	10/7/1994	--	n	40.13	27.65	--	12.48	620	28	<0.5	2.2	12	31.4	4.4	PACE	--	--	31	--
	1/27/1995	--	j	40.13	27.65	--	12.48	--	--	--	--	--	--	--	--	--	--	--	--
	3/30/1995	--	--	40.13	26.05	--	14.08	300	10	6	3.4	18	--	7.6	ATI	--	--	--	--
	6/20/1995	--	--	40.13	19.49	--	20.64	170	7.2	3.4	0.85	15	--	--	ATI	--	--	--	--
	10/3/1995	--	--	40.13	24.93	--	15.20	170	2.1	<0.50	0.81	8	6.7	--	ATI	--	--	--	--
	12/6/1995	--	h	40.13	--	--	--	1,400	6.1	3	1.7	190	53	--	ATI	--	--	--	--
	12/6/1995	--	--	40.13	25.14	--	14.99	1,700	6.7	3.1	2.8	210	64	--	ATI	--	--	--	--
	3/21/1996	--	--	40.13	9.48	--	30.65	<50	0.5	<1	<1	1	<10	7.3	SPL	--	--	--	--
	6/21/1996	--	--	40.13	11.60	--	28.53	<50	13	<1	<1	<1	12	7.6	SPL	--	--	--	--
	9/6/1996	--	--	40.13	12.23	--	27.90	--	--	--	--	--	--	--	--	--	--	--	--
	9/9/1996	--	--	40.13	--	--	--	<250	6.5	<5.0	<5.0	<5.0	<50	7.6	SPL	--	--	--	--

Table 1

Groundwater Elevation and Analytical Data
 Former BP Station #11109
 4280 Foothill Blvd., Oakland, CA

Well No.	Date	P/ NP	Foot Note	TOC (ft MSL)	DTW (ft bgs)	Product Thickness (feet)	GWE (ft MSL)	GRO/ TPH-g (µg/L)	Benzene (µg/L)	Toluene (µg/L)	Ethyl-benzene (µg/L)	Total Xylenes (µg/L)	MTBE (µg/L)	DO (mg/L)	Lab	pH	DRO/ TPH-d (µg/L)	TOG (µg/L)	HVOC (µg/L)
MW-3	12/19/1996	--	--	40.13	10.46	--	29.67	<50	4.1	<1.0	<1.0	<1.0	<10	8.4	SPL	--	--	--	--
	3/17/1997	--	--	40.13	9.86	--	30.27	50	<5	<1.0	<1.0	<1.0	<10	7.4	SPL	--	--	--	--
	8/12/1997	--	--	40.13	12.11	--	28.02	<50	0.79	<1.0	<1.0	<1.0	10	6.1	SPL	--	--	--	--
	12/10/1997	--	--	40.13	10.90	--	29.23	<50	<0.5	<1.0	<1.0	<1.0	<10	3.2	SPL	--	--	--	--
	3/12/1998	--	h	40.13	--	--	--	<50	<0.5	<1.0	<1.0	<1.0	<10	--	SPL	--	--	--	--
	3/12/1998	--	--	40.13	10.20	--	29.93	<50	<0.5	<1.0	<1.0	<1.0	<10	6.3	SPL	--	--	--	--
	6/23/1998	--	--	40.13	10.17	--	29.96	50	<0.5	<1.0	<1.0	<1.0	<10	3.4	SPL	--	--	--	--
	3/31/1999	--	--	40.13	11.45	--	28.68	60	<1.0	<1.0	<1.0	<1.0	6.2	--	SPL	--	--	--	--
	8/25/1999	--	--	40.13	12.52	--	27.61	<50	<1.0	<1.0	<1.0	<1.0	7.7	--	SPL	--	--	--	--
	3/9/2000	--	--	40.13	12.39	--	27.74	<50	<0.5	0.54	<0.5	1.7	6.3	--	PACE	--	--	--	--
	3/8/2001	--	--	40.13	10.41	--	29.72	<50	<0.5	<0.5	<0.5	0.59	7.7	--	PACE	--	--	--	--
	3/8/2002	--	--	40.13	9.83	--	30.30	62	<0.5	<0.5	<0.5	<1.0	11.6	--	PACE	--	--	--	--
	3/18/2002	--	--	40.13	9.20	--	30.93	--	--	--	--	--	--	--	--	--	--	--	--
	3/11/2003	--	--	40.13	10.54	--	29.59	<50	<0.50	<0.50	<0.50	<0.50	6.7	--	SEQ	--	--	--	--
	12/09/2003	P	--	40.13	12.88	--	27.25	<50	<0.50	<0.50	<0.50	<0.50	6.4	--	SEQM	6.3	--	--	--
	03/09/2004	P	--	40.13	9.49	--	30.64	<50	<0.50	<0.50	<0.50	0.63	6.9	--	SEQM	6.1	--	--	--
	09/17/2004	--	--	40.13	12.76	--	27.37	--	--	--	--	--	--	--	--	--	--	--	--
	03/07/2005	P	--	40.13	7.30	--	32.83	<50	<0.50	<0.50	<0.50	0.52	5.1	--	SEQM	7.0	--	--	--
	09/06/2005	--	--	42.92	10.81	--	32.11	--	--	--	--	--	--	--	--	--	--	--	--
MW-4	2/5/1990	--	--	40.11	20.75	--	19.36	620	<0.5	9	<0.5	10	--	--	SUP	--	--	--	--
	2/14/1991	--	--	40.11	21.73	--	18.38	180	<0.3	<0.3	0.4	2	--	--	SUP	--	--	--	--
	5/13/1991	--	--	40.11	18.55	--	21.56	72	0.7	<0.3	<0.3	<0.3	--	--	SUP	--	--	--	--
	7/24/1991	--	--	40.11	21.31	--	18.80	--	--	--	--	--	--	--	--	--	--	--	--
	10/3/1991	--	--	40.11	22.57	--	17.54	57	<0.3	<0.3	<0.3	<0.3	--	--	--	--	--	--	--
	10/15/1991	--	--	40.11	22.88	--	17.23	--	--	--	--	--	--	--	SUP	--	--	--	--
	12/4/1991	--	--	40.11	22.54	--	17.57	--	--	--	--	--	--	--	--	--	--	--	--
	12/16/1991	--	--	40.11	22.59	--	17.52	--	--	--	--	--	--	--	--	--	--	--	--
	1/6/1992	--	--	40.11	22.00	--	18.11	480	0.8	3.2	1.9	7.7	--	--	ANA	--	--	--	--
	1/22/1992	--	--	40.11	21.58	--	18.53	--	--	--	--	--	--	--	--	--	--	--	--
	1/28/1992	--	--	40.11	21.42	--	18.69	--	--	--	--	--	--	--	--	--	--	--	--
	2/5/1992	--	--	40.11	21.10	--	19.01	--	--	--	--	--	--	--	--	--	--	--	--
	2/12/1992	--	--	40.11	20.74	--	19.37	--	--	--	--	--	--	--	--	--	--	--	--
	2/17/1992	--	--	40.11	19.78	--	20.33	--	--	--	--	--	--	--	--	--	--	--	--
	4/3/1992	--	--	40.11	16.80	--	23.31	--	--	--	--	--	--	--	--	--	--	--	--

Table 1

Groundwater Elevation and Analytical Data

Former BP Station #11109

4280 Foothill Blvd., Oakland, CA

Well No.	Date	P/ NP	Foot Note	TOC (ft MSL)	DTW (ft bgs)	Product Thickness (feet)	GWE (ft MSL)	GRO/ TPH-g (µg/L)	Benzene (µg/L)	Toluene (µg/L)	Ethyl-benzene (µg/L)	Total Xylenes (µg/L)	MTBE (µg/L)	DO (mg/L)	Lab	pH	DRO/ TPH-d (µg/L)	TOG (µg/L)	HVOC (µg/L)
MW-4	4/8/1992	--	--	40.11	17.13	--	22.98	<50	<0.5	<0.5	<0.5	<0.5	--	--	ANA	--	--	--	--
	4/14/1992	--	--	40.11	17.74	--	22.37	--	--	--	--	--	--	--	--	--	--	--	--
	4/29/1992	--	--	40.11	18.56	--	21.55	--	--	--	--	--	--	--	--	--	--	--	--
	5/7/1992	--	--	40.11	19.10	--	21.01	--	--	--	--	--	--	--	--	--	--	--	--
	7/3/1992	--	--	40.11	20.71	--	19.40	<50	0.6	<0.5	<0.5	<0.5	--	--	ANA	--	--	--	--
	10/8/1992	--	--	40.11	22.43	--	17.68	270	<0.5	2.1	2.5	3.2	--	--	ANA	--	--	--	--
	12/31/1992	--	--	40.11	19.58	--	20.53	150	<0.5	<0.5	<0.5	1.3	--	--	ANA	--	--	--	--
	4/21/1993	--	n	40.11	17.79	--	22.32	<50	<0.5	<0.5	<0.5	<0.5	--	--	PACE	--	--	--	--
	7/7/1993	--	n	40.11	18.44	--	21.67	160	1.2	5.4	3.8	19	5.51	--	PACE	--	--	--	--
	9/21/1993	--	n	40.11	20.14	--	19.97	71	<0.5	1.9	<0.5	2.1	--	--	PACE	--	--	--	--
	12/17/1993	--	--	40.11	19.80	--	20.31	--	--	--	--	--	--	--	--	--	--	--	--
	12/23/1993	--	n	40.11		--		<50	3.1	1.6	0.8	3.8	5.7	--	PACE	--	--	--	--
	4/7/1994	--	n	40.11	19.12	--	20.99	<50	<0.5	<0.5	<0.5	<0.5	11.7	6.6	PACE	--	--	--	--
	7/6/1994	--	n	40.11	19.90	--	20.21	62	<0.5	<0.5	<0.5	<0.5	--	4.1	PACE	--	--	--	--
	10/7/1994	--	n	40.11	20.07	--	20.04	<50	<0.5	<0.5	<0.5	<0.5	7.38	3.6	PACE	--	--	--	--
	1/27/1995	--	--	40.11	13.72	--	26.39	<50	<0.5	<0.5	<0.5	<1	--	2.7	ATI	--	--	--	--
	3/30/1995	--	--	40.11	11.46	--	28.65	<50	<0.50	<0.50	<0.50	<1.0	--	8.3	ATI	--	--	--	--
	6/20/1995	--	--	40.11	14.78	--	25.33	<50	<0.50	<0.50	<0.50	<1.0	--	--	ATI	--	--	--	--
	10/3/1995	--	--	40.11	19.62	--	20.49	<50	<0.50	<0.50	<0.50	<1.0	5	5.8	ATI	--	--	--	--
	12/6/1995	--	--	40.11	19.91	--	20.20	<50	<0.50	<0.50	<0.50	<1.0	47	5.7	ATI	--	--	--	--
	3/21/1996	--	--	40.11	11.12	--	28.99	<50	<0.5	<1	<1	<1	<10	7.8	SPL	--	--	--	--
	6/21/1996	--	--	40.11	12.21	--	27.90	<50	<0.5	<1	<1	<1	<10	7.9	SPL	--	--	--	--
	9/6/1996	--	--	40.11	12.89	--	27.22	--	--	--	--	--	--	--	--	--	--	--	--
	9/9/1996	--	--	40.11		--		<50	<0.5	<1.0	<1.0	<1.0	<10	7.2	SPL	--	--	--	--
	12/19/1996	--	--	40.11	11.01	--	29.10	<50	<0.5	<1.0	<1.0	<1.0	<10	8.4	SPL	--	--	--	--
	3/17/1997	--	--	40.11	10.42	--	29.69	--	--	--	--	--	--	--	--	--	--	--	--
	8/12/1997	--	--	40.11	12.77	--	27.34	--	--	--	--	--	--	--	--	--	--	--	--
	12/10/1997	--	--	40.11	11.22	--	28.89	--	--	--	--	--	--	--	--	--	--	--	--
	3/12/1998	--	--	40.11	10.81	--	29.30	--	--	--	--	--	--	--	--	--	--	--	--
	6/23/1998	--	--	40.11	10.61	--	29.50	--	--	--	--	--	--	--	--	--	--	--	--
	3/31/1999	--	--	40.11	11.46	--	28.65	--	--	--	--	--	--	--	--	--	--	--	--
	8/25/1999	--	--	40.11	16.16	--	23.95	--	--	--	--	--	--	--	--	--	--	--	--
	3/9/2000	--	--	40.11	12.23	--	27.88	--	--	--	--	--	--	--	--	--	--	--	--
	3/8/2001	--	--	40.11	11.04	--	29.07	--	--	--	--	--	--	--	--	--	--	--	--
	3/8/2002	--	--	40.11	12.73	--	27.38	--	--	--	--	--	--	--	--	--	--	--	--

Table 1

Groundwater Elevation and Analytical Data

Former BP Station #11109
4280 Foothill Blvd., Oakland, CA

Well No.	Date	P/ NP	Foot Note	TOC (ft MSL)	DTW (ft bgs)	Product Thickness (feet)	GWE (ft MSL)	GRO/ TPH-g (µg/L)	Benzene (µg/L)	Toluene (µg/L)	Ethyl-benzene (µg/L)	Total Xylenes (µg/L)	MTBE (µg/L)	DO (mg/L)	Lab	pH	DRO/ TPH-d (µg/L)	TOG (µg/L)	HVOC (µg/L)
MW-4	3/18/2002	--	--	40.11	11.62	--	28.49	--	--	--	--	--	--	--	--	--	--	--	--
	3/11/2003	--	--	40.11	13.44	--	26.67	--	--	--	--	--	--	--	--	--	--	--	--
	12/09/2003	P	--	40.11	15.03	--	25.08	<250	<2.5	<2.5	<2.5	<2.5	130	--	SEQM	6.1	--	--	--
	03/09/2004	P	--	40.11	11.04	--	29.07	<50	<0.50	<0.50	<0.50	<0.50	35	--	SEQM	5.5	--	--	--
	09/17/2004	P	--	40.11	16.75	--	23.36	<250	<2.5	<2.5	<2.5	<2.5	140	--	SEQM	6.5	--	--	--
	03/07/2005	P	--	40.11	11.02	--	29.09	67	<0.50	<0.50	<0.50	<0.50	42	--	SEQM	6.6	--	--	--
	09/06/2005	P	s, t	42.88	14.64	--	28.24	81	<0.50	<0.50	<0.50	<1.5	180	--	SEQM	6.7	--	--	--
MW-5	10/3/1991	--	--	39.55	18.08	--	21.47	79,000	13,000	7,400	1,400	6,200	--	--	SUP	--	--	--	--
	10/15/1991	--	--	39.55	18.55	--	21.00	--	--	--	--	--	--	--	--	--	--	--	--
	12/4/1991	--	a	39.55	18.44	0.13	20.98	--	--	--	--	--	--	--	--	--	--	--	--
	12/16/1991	--	a	39.55	18.66	0.01	20.88	--	--	--	--	--	--	--	--	--	--	--	--
	1/6/1992	--	a	39.55	19.12	0.11	20.32	--	--	--	--	--	--	--	--	--	--	--	--
	1/22/1992	--	--	39.55	14.59	--	24.96	--	--	--	--	--	--	--	--	--	--	--	--
	1/28/1992	--	--	39.55	15.25	--	24.30	--	--	--	--	--	--	--	--	--	--	--	--
	2/5/1992	--	q	39.55	15.58	--	23.97	--	--	--	--	--	--	--	--	--	--	--	--
	2/12/1992	--	a	39.55	15.54	0.01	24.00	--	--	--	--	--	--	--	--	--	--	--	--
	2/17/1992	--	q	39.55	13.98	--	25.57	--	--	--	--	--	--	--	--	--	--	--	--
	4/3/1992	--	a	39.55	13.63	0.04	25.88	--	--	--	--	--	--	--	--	--	--	--	--
	4/8/1992	--	a	39.55	13.17	0.01	26.37	--	--	--	--	--	--	--	--	--	--	--	--
	4/14/1992	--	a	39.55	13.45	0.01	26.09	--	--	--	--	--	--	--	--	--	--	--	--
	4/29/1992	--	a	39.55	13.75	0.07	25.73	--	--	--	--	--	--	--	--	--	--	--	--
	5/7/1992	--	a	39.55	16.15	0.04	23.36	--	--	--	--	--	--	--	--	--	--	--	--
	7/3/1992	--	a	39.55	17.67	0.08	21.80	--	--	--	--	--	--	--	--	--	--	--	--
	9/1/1992	--	a	39.55	17.83	0.50	21.22	--	--	--	--	--	--	--	--	--	--	--	--
	10/8/1992	--	a	39.55	17.86	0.92	20.77	--	--	--	--	--	--	--	--	--	--	--	--
	12/31/1992	--	q	39.55	15.20	--	24.35	--	--	--	--	--	--	--	--	--	--	--	--
	4/21/1993	--	a	39.55	12.64	0.02	26.89	--	--	--	--	--	--	--	--	--	--	--	--
	7/7/1993	--	a, i	39.14	12.68	0.82	25.64	--	--	--	--	--	--	--	--	--	--	--	--
	9/21/1993	--	q	39.14	14.35	--	24.79	--	--	--	--	--	--	--	--	--	--	--	--
	12/17/1993	--	a	39.14	12.61	0.41	26.12	--	--	--	--	--	--	--	--	--	--	--	--
	4/7/1994	--	n	39.14	30.00	--	9.14	66,000	3,000	1,700	250	6,800	2,002	--	PACE	--	--	--	--
	7/6/1994 ^s	--	n	39.14	--	--	--	29,000	1,900	330	63	2,700	1,141	--	PACE	--	--	--	--
	10/7/1994	--	h	39.14	--	--	--	45,000	2,900	540	260	2,600	--	--	PACE	--	--	--	--
	10/7/1994	--	n	39.14	28.70	--	10.44	250,000	2,600	660	830	5,200	37.7	4.2	PACE	--	--	--	--

Table 1

Groundwater Elevation and Analytical Data

Former BP Station #11109
4280 Foothill Blvd., Oakland, CA

Well No.	Date	P/ NP	Foot Note	TOC (ft MSL)	DTW (ft bgs)	Product Thickness (feet)	GWE (ft MSL)	GRO/ TPH-g (µg/L)	Benzene (µg/L)	Toluene (µg/L)	Ethyl-benzene (µg/L)	Total Xylenes (µg/L)	MTBE (µg/L)	DO (mg/L)	Lab	pH	DRO/ TPH-d (µg/L)	TOG (µg/L)	HVOC (µg/L)
MW-5	1/27/1995	--	--	39.14	28.70	--	10.44	--	--	--	--	--	--	--	--	--	--	--	--
	3/30/1995	--	h	39.14	--	--	--	43,000	7,900	2,500	440	6,200	--	--	ATI	--	--	--	--
	3/30/1995	--	--	39.14	28.95	--	10.19	50,000	7,900	2,600	520	6,400	--	5.5	ATI	--	--	--	--
	6/20/1995	--	h	39.14	--	--	--	26,000	3,500	290	<25	3,300	--	--	ATI	--	--	--	--
	6/20/1995	--	--	39.14	22.54	--	16.60	34,000	5,100	1,900	300	3,700	--	--	ATI	--	--	--	--
	10/3/1995	--	h	39.14	--	--	--	12,000	46	39	10	1,600	320	--	ATI	--	--	--	--
	10/3/1995	--	--	39.14	18.84	--	20.30	12,000	68	42	11	1,600	330	--	ATI	--	--	--	--
	12/6/1995	--	--	39.14	19.07	--	20.07	16,000	1,200	93	51	700	600	--	ATI	--	--	--	--
	3/21/1996	--	h	39.14	--	--	--	1,900	92	30	7	270	<10	--	SPL	--	--	--	--
	3/21/1996	--	--	39.14	7.43	--	31.71	1,500	89	28	6	250	<10	7.2	SPL	--	--	--	--
	6/21/1996	--	h	39.14	--	--	--	2,700	680	140	20	400	<50	--	SPL	--	--	--	--
	6/21/1996	--	--	39.14	9.87	--	29.27	3,500	740	150	19	400	<100	7.1	SPL	--	--	--	--
	9/6/1996	--	--	39.14	10.52	--	28.62	--	--	--	--	--	--	--	--	--	--	--	--
	9/9/1996	--	h	39.14	--	--	--	90,000	2,900	1,600	670	6,900	<2500	--	SPL	--	--	--	--
	9/9/1996	--	--	39.14	--	--	--	82,000	3,100	1,700	850	9,100	<2500	7.5	SPL	--	--	--	--
	12/19/1996	--	h	39.14	--	--	--	26,000	490	430	63	1,140	<500	--	SPL	--	--	--	--
	12/19/1996	--	--	39.14	8.62	--	30.52	41,000	790	820	120	2,040	<500	7.7	SPL	--	--	--	--
	3/17/1997	--	h	39.14	--	--	--	6,600	2.5	2.7	<1.0	<1.0	28	--	SPL	--	--	--	--
	3/17/1997	--	--	39.14	8.22	--	30.92	5,500	1.9	2.4	<1.0	<1.0	29	6.4	SPL	--	--	--	--
	8/12/1997	--	h	39.14	--	--	--	36,000	6,100	2,500	720	4,500	<500	--	SPL	--	--	--	--
	8/12/1997	--	a	39.14	12.18	0.22	26.74	33,000	6,400	2,400	680	4,400	<1000	6.8	SPL	--	--	--	--
	12/10/1997	--	h	39.14	--	--	--	37,000	2,900	2,500	440	4,800	--	--	SPL	--	--	--	--
	12/10/1997	--	a	39.14	10.78	0.06	28.30	31,000	3,000	2,500	560	5,100	500	1.8	SPL	--	--	--	--
	3/12/1998	--	a	39.14	10.11	0.22	28.81	100,000	1,600	870	250	2,600	<250	6.1	SPL	--	--	--	--
	6/23/1998	--	h	39.14	--	--	--	27,000	2,600	840	400	2,950	<500	--	SPL	--	--	--	--
	6/23/1998	--	a	39.14	10.20	0.02	28.92	27,000	2,500	840	370	2,900	<250	2.1	SPL	--	--	--	--
	3/31/1999	--	f	39.14	--	--	--	--	--	--	--	--	--	--	--	--	--	--	--
✓	8/25/1999	--	a	39.14	14.69	0.38	24.07	180,000	2,700	400	830	2,800	26	--	SPL	--	--	--	--
	3/9/2000	--	a	39.14	14.83	0.60	23.71	53,000	12,000	2,600	1,900	9,100	<5.0	--	PACE	--	--	--	--
	3/8/2001	--	f	39.14	--	--	--	--	--	--	--	--	--	--	--	--	--	--	--
	3/8/2002	--	a	39.14	11.45	1.50	26.19	33,000	8,240	1,080	1,010	2,900	34.3	--	PACE	--	--	--	--
	3/18/2002	--	--	39.14	8.03	--	31.11	--	--	--	--	--	--	--	--	--	--	--	--
	3/11/2003	--	a	39.14	9.60	0.45	29.09	--	--	--	--	--	--	--	--	--	--	--	--
	12/09/2003	--	a	39.14	11.44	0.03	27.72	--	--	--	--	--	--	--	--	--	--	--	--
	03/09/2004	P	--	39.14	7.91	--	31.23	31,000	3,900	1,100	780	3,600	<50	--	SEQM	6.6	--	--	--

Table 1

Groundwater Elevation and Analytical Data

Former BP Station #11109
4280 Foothill Blvd., Oakland, CA

Well No.	Date	P/ NP	Foot Note	TOC (ft MSL)	DTW (ft bgs)	Product Thickness (feet)	GWE (ft MSL)	GRO/ TPH-g (µg/L)	Benzene (µg/L)	Toluene (µg/L)	Ethyl-benzene (µg/L)	Total Xylenes (µg/L)	MTBE (µg/L)	DO (mg/L)	Lab	pH	DRO/ TPH-d (µg/L)	TOG (µg/L)	HVOC (µg/L)
MW-5	09/17/2004	--	a	39.14	12.13	0.15	27.13	--	--	--	--	--	--	--	--	--	--	--	--
	03/07/2005	--	a	39.14	8.62	0.02	30.54	--	--	--	--	--	--	--	--	--	--	--	--
	09/06/2005	--	a	41.98	11.16	0.18	30.96	--	--	--	--	--	--	--	--	--	--	--	--
MW-6	10/3/1991	--	--	41.59	20.73	--	20.86	<50	0.7	0.8	<0.3	1.3	--	--	SUP	--	--	--	--
	10/15/1991	--	--	41.59	21.20	--	20.39	--	--	--	--	--	--	--	--	--	--	--	--
	12/4/1991	--	--	41.59	21.26	--	20.33	--	--	--	--	--	--	--	--	--	--	--	--
	12/16/1991	--	--	41.59	21.12	--	20.47	--	--	--	--	--	--	--	--	--	--	--	--
	1/6/1992	--	--	41.59	20.29	--	21.30	<50	<0.5	<0.5	<0.5	1.6	--	--	ANA	--	--	--	--
	1/22/1992	--	--	41.59	20.12	--	21.47	--	--	--	--	--	--	--	--	--	--	--	--
	1/28/1992	--	--	41.59	20.20	--	21.39	--	--	--	--	--	--	--	--	--	--	--	--
	2/5/1992	--	--	41.59	20.09	--	21.50	--	--	--	--	--	--	--	--	--	--	--	--
	2/12/1992	--	--	41.59	19.15	--	22.44	--	--	--	--	--	--	--	--	--	--	--	--
	2/17/1992	--	--	41.59	18.02	--	23.57	--	--	--	--	--	--	--	--	--	--	--	--
	4/3/1992	--	--	41.59	16.62	--	24.97	--	--	--	--	--	--	--	--	--	--	--	--
	4/8/1992	--	--	41.59	17.06	--	24.53	<50	0.6	<0.5	0.8	<0.5	--	--	ANA	--	--	--	--
	4/14/1992	--	--	41.59	17.23	--	24.36	--	--	--	--	--	--	--	--	--	--	--	--
	4/29/1992	--	--	41.59	18.12	--	23.47	--	--	--	--	--	--	--	--	--	--	--	--
	5/7/1992	--	--	41.59	18.52	--	23.07	--	--	--	--	--	--	--	--	--	--	--	--
	7/3/1992	--	--	41.59	19.71	--	21.88	<50	<0.5	<0.5	<0.5	<0.5	--	--	ANA	--	--	--	--
	10/8/1992	--	h	41.59	---	--	---	<50	<0.5	<0.5	<0.5	<0.5	--	--	ANA	--	--	--	--
	10/8/1992	--	--	41.59	21.22	--	20.37	<50	<0.5	<0.5	<0.5	<0.5	--	--	ANA	--	--	--	--
	12/31/1992	--	--	41.59	21.33	--	20.26	<50	<0.5	<0.5	<0.5	<0.5	--	--	ANA	--	--	--	--
	4/21/1993	--	n	41.59	16.45	--	25.14	<50	<0.5	<0.5	<0.5	<0.5	--	--	ANA	--	--	--	--
	7/7/1993	--	j, n	41.59	18.68	--	22.91	<50	<0.5	<0.5	<0.5	<0.5	28.96	--	PACE	--	--	--	--
	9/21/1993	--	n	41.59	19.64	--	21.95	<50	<0.5	<0.5	<0.5	<0.5	--	--	PACE	--	--	29	--
	12/17/1993	--	--	41.59	21.08	--	20.51	--	--	--	--	1.6	--	--	PACE	--	--	--	--
	12/23/1993	--	n	41.59	---	--	---	<50	<0.5	0.5	<0.5	0.6	13.95	--	PACE	--	--	--	--
	4/7/1994	--	n	41.59	21.27	--	20.32	<50	<0.5	<0.5	<0.5	<0.5	35.1	6.1	PACE	--	--	--	--
	7/6/1994	--	h	41.59	--	--	--	<50	<0.5	<0.5	<0.5	<0.5	--	--	PACE	--	--	--	--
	7/6/1994	--	n	41.59	19.81	--	21.78	<50	<0.5	<0.5	<0.5	<0.5	--	--	PACE	--	--	--	--
	10/7/1994	--	j, n	41.59	21.25	--	20.34	<50	<0.5	<0.5	<0.5	<0.5	24.3	4.0	PACE	--	--	--	--
	1/27/1995	--	--	41.59	12.39	--	29.20	<50	<0.5	<0.5	<0.5	<1	--	4.2	ATI	--	--	24	--
	3/30/1995	--	--	41.59	11.34	--	30.25	<50	<0.50	<0.50	<0.50	<1.0	--	6.1	ATI	--	--	--	--
	6/20/1995	--	--	41.59	15.12	--	26.47	<50	<0.50	<0.50	<0.50	<1.0	--	--	ATI	--	--	--	--

Table 1

Groundwater Elevation and Analytical Data

Former BP Station #11109
4280 Foothill Blvd., Oakland, CA

Well No.	Date	P/ NP	Foot Note	TOC (ft MSL)	DTW (ft bgs)	Product Thickness (feet)	GWE (ft MSL)	GRO/ TPH-g (µg/L)	Benzene (µg/L)	Toluene (µg/L)	Ethyl-benzene (µg/L)	Total Xylenes (µg/L)	MTBE (µg/L)	DO (mg/L)	Lab	pH	DRO/ TPH-d (µg/L)	TOG (µg/L)	HVOC (µg/L)
MW-6	10/3/1995	--	--	41.59	20.68	--	20.91	<50	<0.50	<0.50	<0.50	<1.0	66	6.4	ATI	--	--	--	--
	12/6/1995	--	--	41.59	23.77	--	17.82	<50	<0.50	<0.50	<0.50	<1.0	45	5.7	ATI	--	--	--	--
	3/21/1996	--	--	41.59	11.55	--	30.04	<50	<0.5	<1	<1	<1	41	9.1	SPL	--	--	--	--
	6/21/1996	--	--	41.59	12.60	--	28.99	<50	<0.5	<1	<1	<1	<10	8.6	SPL	--	--	--	--
	9/6/1996	--	--	41.59	13.25	--	28.34	--	--	--	--	--	--	--	--	--	--	--	--
	9/9/1996	--	k	41.59		--		<50	<0.5	<1.0	<1.0	<1.0	22/22	7.9	SPL	--	--	--	--
	12/19/1996	--	--	41.59	11.45	--	30.14	<50	<0.5	<1.0	<1.0	<1.0	<10	7.7	SPL	--	--	--	--
	3/17/1997	--	--	41.59	10.80	--	30.79	--	--	--	--	--	--	--	--	--	--	--	--
	8/12/1997	--	--	41.59	13.11	--	28.48	--	--	--	--	--	--	--	--	--	--	--	--
	12/10/1997	--	--	41.59	13.84	--	27.75	--	--	--	--	--	--	--	--	--	--	--	--
	3/12/1998	--	--	41.59	11.17	--	30.42	--	--	--	--	--	--	--	--	--	--	--	--
	6/23/1998	--	--	41.59	13.27	--	28.32	--	--	--	--	--	--	--	--	--	--	--	--
	3/31/1999	--	--	41.59	12.91	--	28.68	--	--	--	--	--	--	--	--	--	--	--	--
	8/25/1999	--	--	41.59	15.93	--	25.66	--	--	--	--	--	--	--	--	--	--	--	--
	3/9/2000	--	--	41.59	11.49	--	30.10	--	--	--	--	--	--	--	--	--	--	--	--
	3/8/2001	--	--	41.59	10.81	--	30.78	--	--	--	--	--	--	--	--	--	--	--	--
	3/8/2002	--	--	41.59	14.28	--	27.31	--	--	--	--	--	--	--	--	--	--	--	--
	3/18/2002	--	--	41.59	13.10	--	28.49	--	--	--	--	--	--	--	--	--	--	--	--
	3/11/2003	--	--	41.59	13.63	--	27.96	--	--	--	--	--	--	--	--	--	--	--	--
	12/09/2003	P	--	41.59	14.26	--	27.33	<50	<0.50	<0.50	<0.50	<0.50	12	--	SEQM	6.4	--	--	--
	03/09/2004	NP	--	41.59	11.87	--	29.72	<50	<0.50	<0.50	<0.50	<0.50	10	--	SEQM	7.1	--	--	--
	09/17/2004	--	--	41.59	16.45	--	25.14	--	--	--	--	--	--	--	--	--	--	--	--
	03/07/2005	P	--	41.59	13.65	--	27.94	<50	<0.50	<0.50	<0.50	<0.50	5.8	--	SEQM	6.7	--	--	--
	09/06/2005	--	--	44.37	14.23	--	30.14	--	--	--	--	--	--	--	--	--	--	--	--
MW-7	10/3/1991	--	--	40.64	14.93	--	25.71	360	62	13	3.4	20	--	--	SUP	--	--	--	--
	10/15/1991	--	--	40.64	15.16	--	25.48	--	--	--	--	--	--	--	--	--	--	--	--
	12/4/1991	--	--	40.64	15.41	--	25.23	--	--	--	--	--	--	--	--	--	--	--	--
	12/16/1991	--	--	40.64	15.21	--	25.43	--	--	--	--	--	--	--	--	--	--	--	--
	1/6/1992	--	--	40.64	14.56	--	26.08	1,100	170	<0.5	24	23	--	--	ANA	--	--	--	--
	1/22/1992	--	--	40.64	14.63	--	26.01	--	--	--	--	--	--	--	--	--	--	--	--
	1/28/1992	--	--	40.64	14.73	--	25.91	--	--	--	--	--	--	--	--	--	--	--	--
	2/5/1992	--	--	40.64	14.58	--	26.06	--	--	--	--	--	--	--	--	--	--	--	--
	2/12/1992	--	--	40.64	13.94	--	26.70	--	--	--	--	--	--	--	--	--	--	--	--
	2/17/1992	--	--	40.64	13.10	--	27.54	--	--	--	--	--	--	--	--	--	--	--	--

Table 1

Groundwater Elevation and Analytical Data

Former BP Station #11109
4280 Foothill Blvd., Oakland, CA

Well No.	Date	P/ NP	Foot Note	TOC (ft MSL)	DTW (ft bgs)	Product Thickness (feet)	GWE (ft MSL)	GRO/ TPH-g (µg/L)	Benzene (µg/L)	Toluene (µg/L)	Ethyl-benzene (µg/L)	Total Xylenes (µg/L)	MTBE (µg/L)	DO (mg/L)	Lab	pH	DRO/ TPH-d (µg/L)	TOG (µg/L)	HVOC (µg/L)
MW-7	4/3/1992	--	--	40.64	12.66	--	27.98	--	--	--	--	--	--	--	---	--	--	---	---
	4/8/1992	--	--	40.64	12.77	--	27.87	750	150	<0.5	23	9.9	--	--	ANA	--	--	---	---
	4/14/1992	--	--	40.64	13.02	--	27.62	--	--	--	--	--	--	--	---	--	--	---	---
	4/29/1992	--	--	40.64	13.59	--	27.05	--	--	--	--	--	--	--	---	--	--	---	---
	5/7/1992	--	--	40.64	13.95	--	26.69	--	--	--	--	--	--	--	---	--	--	---	---
	7/3/1992	--	--	40.64	14.73	--	25.91	660	210	<2.5	33	8	--	--	ANA	--	--	---	---
	10/8/1992	--	--	40.64	15.75	--	24.89	320	49	1.4	13	6.2	--	--	ANA	--	--	---	---
	12/31/1992	--	--	40.64	13.57	--	27.07	900	100	<2.5	28	4.3	--	--	ANA	--	--	---	---
	4/21/1993	--	n	40.64	14.56	--	26.08	510	83	1.2	10	5.8	--	--	PACE	--	--	---	---
	7/7/1993	--	h, n	40.32	--	--	--	1,100	170	1.9	29	2.84	9.84	--	PACE	--	--	---	---
	7/7/1993	--	i, n	40.32	13.40	--	26.92	1,100	160	2	27	4	10.84	--	PACE	--	--	---	---
	9/21/1993	--	h, n	40.32	--	--	--	640	140	1.7	23	2.4	--	--	PACE	--	--	---	---
	9/21/1993	--	n	40.32	14.40	--	25.92	690	150	3.1	26	5.7	--	--	PACE	--	--	---	---
	12/17/1993	--	--	40.32	13.65	--	26.67	--	--	--	--	--	--	--	---	--	--	---	---
	12/23/1993	--	n	40.32	--	--	--	250	64	1.2	9	1.8	7.81	--	PACE	--	--	---	---
	4/7/1994	--	n	40.32	30.62	--	9.70	140	32	1.4	<0.5	<0.5	6.32	--	PACE	--	--	---	---
	7/6/1994	--	n	40.32	16.88	--	23.44	410	94	1.3	10	3.5	<5.0	4.4	PACE	--	--	---	---
	10/7/1994	--	n	40.32	25.59	--	14.73	<50	9.2	<0.5	<0.5	<0.5	<5.0	4.9	PACE	--	--	---	---
	1/27/1995	--	h	40.32	--	--	--	930	620	4	77	21	--	--	ATI	--	--	---	---
	1/27/1995	--	--	40.32	9.82	--	30.50	810	570	3	60	17	--	0.0	ATI	--	--	---	---
	3/30/1995	--	--	40.32	9.15	--	31.17	180	65	0.53	2	<1.0	--	7.8	ATI	--	--	---	---
	6/20/1995	--	--	40.32	11.38	--	28.94	2,800	980	<5.0	<5.0	43	--	--	ATI	--	--	---	---
	10/3/1995	--	--	40.32	29.95	--	10.37	<50	<0.50	<0.50	<0.50	<1.0	<5.0	--	ATI	--	--	---	---
	12/6/1995	--	--	40.32	29.85	--	10.47	<50	<0.50	<0.50	<0.50	<1.0	<5.0	--	ATI	--	--	---	---
	3/21/1996	--	--	40.32	9.76	--	30.56	1,000	390	2	40	13	<10	7.4	SPL	--	--	---	---
	6/21/1996	--	--	40.32	11.01	--	29.31	<250	40	<5	<5	<5	<50	7.4	SPL	--	--	---	---
	9/6/1996	--	--	40.32	11.68	--	28.64	--	--	--	--	--	--	--	---	--	--	---	---
	9/9/1996	--	--	40.32	--	--	--	<250	13	<5.0	<5.0	<5.0	<50	7.2	SPL	--	--	---	---
	12/19/1996	--	--	40.32	10.78	--	29.54	70	1.2	<1.0	1	<1.0	<10	8.3	SPL	--	--	---	---
	3/17/1997	--	--	40.32	9.96	--	30.36	--	--	--	--	--	--	--	---	--	--	---	---
	8/12/1997	--	--	40.32	11.44	--	28.88	--	--	--	--	--	--	--	---	--	--	---	---
	12/10/1997	--	--	40.32	10.42	--	29.90	--	--	--	--	--	--	--	---	--	--	---	---
	3/12/1998	--	--	40.32	9.51	--	30.81	--	--	--	--	--	--	--	---	--	--	---	---
	6/23/1998	--	--	40.32	9.98	--	30.34	--	--	--	--	--	--	--	---	--	--	---	---
	3/31/1999	--	--	40.32	10.38	--	29.94	--	--	--	--	--	--	--	---	--	--	---	---

Table 1

Groundwater Elevation and Analytical Data

Former BP Station #11109
4280 Foothill Blvd., Oakland, CA

Well No.	Date	P/ NP	Foot Note	TOC (ft MSL)	DTW (ft bgs)	Product Thickness (feet)	GWE (ft MSL)	GRO/ TPH-g (µg/L)	Benzene (µg/L)	Toluene (µg/L)	Ethyl-benzene (µg/L)	Total Xylenes (µg/L)	MTBE (µg/L)	DO (mg/L)	Lab	pH	DRO/ TPH-d (µg/L)	TOG (µg/L)	HVOC (µg/L)
MW-7	8/25/1999	--	--	40.32	12.38	--	27.94	--	--	--	--	--	--	--	--	--	--	--	--
	3/9/2000	--	--	40.32	8.48	--	31.84	--	--	--	--	--	--	--	--	--	--	--	--
	3/8/2001	--	--	40.32	8.37	--	31.95	--	--	--	--	--	--	--	--	--	--	--	--
	3/8/2002	--	f	40.32		--		--	--	--	--	--	--	--	--	--	--	--	--
	3/18/2002	--	--	40.32	9.94	--	30.38	--	--	--	--	--	--	--	--	--	--	--	--
	3/11/2003	--	--	40.32	11.26	--	29.06	--	--	--	--	--	--	--	--	--	--	--	--
	12/09/2003	P	--	40.32	12.76	--	27.56	270	26	<0.50	<0.50	<0.50	8.7	--	SEQM	6.1	--	--	--
	03/09/2004	P	--	40.32	10.91	--	29.41	320	49	0.73	1.8	0.59	6.9	--	SEQM	6.2	--	--	--
	09/17/2004	P	--	40.32	13.20	--	27.12	330	17	<0.50	<0.50	<0.50	7.0	--	SEQM	6.6	--	--	--
	03/07/2005	P	--	40.32	8.18	--	32.14	340	41	0.79	0.79	0.73	7.2	--	SEQM	6.9	--	--	--
	09/06/2005	P	--	43.10	11.80	--	31.30	1,100	130	1.2	1.8	<1.5	16	--	SEQM	6.7	--	--	--
MW-8	10/3/1991	--	--	38.18	22.37	--	15.81	<50	<0.3	0.6	<0.3	0.9	--	--	SUP	--	--	--	--
	10/15/1991	--	--	38.18	22.70	--	15.48	--	--	--	--	--	--	--	--	--	--	--	--
	12/4/1991	--	--	38.18	22.44	--	15.74	--	--	--	--	--	--	--	--	--	--	--	--
	12/16/1991	--	--	38.18	22.47	--	15.71	--	--	--	--	--	--	--	--	--	--	--	--
	1/6/1992	--	--	38.18	21.94	--	16.24	<50	<0.5	<0.5	<0.5	<0.5	--	--	ANA	--	--	--	--
	1/22/1992	--	--	38.18	21.44	--	16.74	--	--	--	--	--	--	--	--	--	--	--	--
	1/28/1992	--	--	38.18	21.20	--	16.98	--	--	--	--	--	--	--	--	--	--	--	--
	2/5/1992	--	--	38.18	20.88	--	17.30	--	--	--	--	--	--	--	--	--	--	--	--
	2/12/1992	--	--	38.18	20.54	--	17.64	--	--	--	--	--	--	--	--	--	--	--	--
	2/17/1992	--	--	38.18	19.99	--	18.19	--	--	--	--	--	--	--	--	--	--	--	--
	4/3/1992	--	--	38.18	16.75	--	21.43	--	--	--	--	--	--	--	--	--	--	--	--
	4/8/1992	--	--	38.18	16.57	--	21.61	<50	<0.5	<0.5	<0.5	<0.5	--	--	ANA	--	--	--	--
	4/14/1992	--	f	38.18	--	--	--	--	--	--	--	--	--	--	--	--	--	--	--
	4/29/1992	--	--	38.18	18.61	--	19.57	--	--	--	--	--	--	--	--	--	--	--	--
	5/7/1992	--	--	38.18	18.41	--	19.77	--	--	--	--	--	--	--	--	--	--	--	--
	7/3/1992	--	--	38.18	20.35	--	17.83	<50	<0.5	<0.5	<0.5	<0.5	--	--	ANA	--	--	--	--
	10/8/1992	--	f	38.18	21.74	--	16.44	--	--	--	--	--	--	--	--	--	--	--	--
	12/31/1992	--	--	38.18	19.09	--	19.09	<50	<0.5	<0.5	<0.5	<0.5	--	--	ANA	--	--	--	--
	4/21/1993	--	n	38.18	18.92	--	19.26	<50	<0.5	<0.5	<0.5	<0.5	--	--	PACE	--	--	--	--
	7/7/1993	--	n	38.18	17.76	--	20.42	<50	<0.5	<0.5	<0.5	<0.5	<5.0	--	PACE	--	--	--	--
	9/21/1993	--	n	38.18	19.71	--	18.47	<50	2.9	2.2	2.2	7.1	--	--	PACE	--	--	--	--
	12/17/1993	--	--	38.18	21.33	--	16.85	--	--	--	--	--	--	--	--	--	--	--	--
	12/23/1993	--	n	38.18	--	--	--	<50	<0.5	<0.5	<0.5	0.6	<5.0	--	PACE	--	--	--	--

Table 1

Groundwater Elevation and Analytical Data

Former BP Station #11109
4280 Foothill Blvd., Oakland, CA

Well No.	Date	P/ NP	Foot Note	TOC (ft MSL)	DTW (ft bgs)	Product Thickness (feet)	GWE (ft MSL)	GRO/ TPH-g (µg/L)	Benzene (µg/L)	Toluene (µg/L)	Ethyl-benzene (µg/L)	Total Xylenes (µg/L)	MTBE (µg/L)	DO (mg/L)	Lab	pH	DRO/ TPH-d (µg/L)	TOG (µg/L)	HVOC (µg/L)
MW-8	4/7/1994	--	n	38.18	21.51	--	16.67	<50	<0.5	<0.5	<0.5	<0.5	<5.0	6.6	PACE	--	--	--	--
	7/6/1994	--	n	38.18	17.41	--	20.77	<50	<0.5	<0.5	<0.5	<0.5	<5.0	4.4	PACE	--	--	--	--
	10/7/1994	--	n	38.18	19.20	--	18.98	<50	<0.5	<0.5	<0.5	<0.5	<5.0	3.7	PACE	--	--	--	--
	1/27/1995	--	--	38.18	12.25	--	25.93	<50	<0.5	<0.5	<0.5	<1	--	2.9	ATI	--	--	--	--
	3/30/1995	--	--	38.18	10.35	--	27.83	<50	<0.50	<0.50	<0.50	<1.0	--	8.3	ATI	--	--	--	--
	6/20/1995	--	--	38.18	13.37	--	24.81	<50	<0.50	<0.50	<0.50	<1.0	--	6.9	ATI	--	--	--	--
	10/3/1995	--	f	38.18	--	--	--	--	--	--	--	--	--	--	--	--	--	--	--
	12/6/1995	--	--	38.18	18.42	--	19.76	<50	<0.50	<0.50	<0.50	<1.0	47	5.3	ATI	--	--	--	--
	3/21/1996	--	f	38.18	--	--	--	--	--	--	--	--	--	--	--	--	--	--	--
	6/21/1996	--	--	38.18	13.03	--	25.15	<50	<0.5	<1	<1	<1	<10	7.0	SPL	--	--	--	--
	9/6/1996	--	--	38.18	13.70	--	24.48	--	--	--	--	--	--	--	--	--	--	--	--
	9/9/1996	--	--	38.18	--	--	--	<50	<0.5	<1.0	<1.0	<1.0	<10	7.0	SPL	--	--	--	--
	12/19/1996	--	--	38.18	11.93	--	26.25	<50	<0.5	<1.0	<1.0	<1.0	<10	7.6	SPL	--	--	--	--
	3/17/1997	--	--	38.18	11.29	--	26.89	--	--	--	--	--	--	--	--	--	--	--	--
	8/12/1997	--	--	38.18	13.73	--	24.45	--	--	--	--	--	--	--	--	--	--	--	--
	12/10/1997	--	--	38.18	11.88	--	26.30	--	--	--	--	--	--	--	--	--	--	--	--
	3/12/1998	--	--	38.18	11.89	--	26.29	--	--	--	--	--	--	--	--	--	--	--	--
	6/23/1998	--	--	38.18	11.33	--	26.85	--	--	--	--	--	--	--	--	--	--	--	--
	3/31/1999	--	--	38.18	12.68	--	25.50	--	--	--	--	--	--	--	--	--	--	--	--
	8/25/1999	--	--	38.18	14.93	--	23.25	--	--	--	--	--	--	--	--	--	--	--	--
	3/9/2000	--	--	38.18	9.14	--	29.04	--	--	--	--	--	--	--	--	--	--	--	--
	3/8/2001	--	--	38.18	8.41	--	29.77	--	--	--	--	--	--	--	--	--	--	--	--
	3/8/2002	--	--	38.18	11.18	--	27.00	--	--	--	--	--	--	--	--	--	--	--	--
	3/18/2002	--	--	38.18	10.72	--	27.46	--	--	--	--	--	--	--	--	--	--	--	--
	3/11/2003	--	--	38.18	10.46	--	27.72	--	--	--	--	--	--	--	--	--	--	--	--
	03/09/2004	P	--	38.18	9.79	--	28.39	<50	<0.50	<0.50	<0.50	<0.50	0.50	--	SEQM	7.2	--	--	--
	09/17/2004	--	--	38.18	15.35	--	22.83	--	--	--	--	--	--	--	--	--	--	--	--
	03/07/2005	P	--	38.18	7.94	--	30.24	<50	<0.50	<0.50	<0.50	<0.50	<0.50	--	SEQM	6.7	--	--	--
	09/06/2005	--	--	40.95	13.06	--	27.89	--	--	--	--	--	--	--	--	--	--	--	--
MW-9	10/3/1991	--	--	41.25	14.12	--	27.13	<50	<0.3	0.4	<0.3	<0.3	--	--	SUP	--	--	--	--
	10/15/1991	--	--	41.25	14.27	--	26.98	--	--	--	--	--	--	--	--	--	--	--	--
	12/4/1991	--	--	41.25	13.84	--	27.41	--	--	--	--	--	--	--	--	--	--	--	--
	12/16/1991	--	--	41.25	14.18	--	27.07	--	--	--	--	--	--	--	--	--	--	--	--
	1/6/1992	--	--	41.25	13.42	--	27.83	<50	<0.5	<0.5	<0.5	0.9	--	--	ANA	--	--	--	--

Table 1

Groundwater Elevation and Analytical Data

Former BP Station #11109
4280 Foothill Blvd., Oakland, CA

Well No.	Date	P/ NP	Foot Note	TOC (ft MSL)	DTW (ft bgs)	Product Thickness (feet)	GWE (ft MSL)	GRO/ TPH-g (µg/L)	Benzene (µg/L)	Toluene (µg/L)	Ethyl-benzene (µg/L)	Total Xylenes (µg/L)	MTBE (µg/L)	DO (mg/L)	Lab	pH	DRO/ TPH-d (µg/L)	TOG (µg/L)	HVOC (µg/L)
MW-9	1/22/1992	--	--	41.25	13.75	--	27.50	--	--	--	--	--	--	--	--	--	--	--	--
	1/28/1992	--	--	41.25	14.76	--	26.49	--	--	--	--	--	--	--	--	--	--	--	--
	2/5/1992	--	--	41.25	13.38	--	27.87	--	--	--	--	--	--	--	--	--	--	--	--
	2/12/1992	--	--	41.25	11.86	--	29.39	--	--	--	--	--	--	--	--	--	--	--	--
	2/17/1992	--	--	41.25	10.78	--	30.47	--	--	--	--	--	--	--	--	--	--	--	--
	4/3/1992	--	--	41.25	11.63	--	29.62	--	--	--	--	--	--	--	--	--	--	--	--
	4/8/1992	--	--	41.25	12.25	--	29.00	<50	<0.5	<0.5	<0.5	<0.5	--	--	ANA	--	--	--	--
	4/14/1992	--	--	41.25	12.32	--	28.93	--	--	--	--	--	--	--	--	--	--	--	--
	4/29/1992	--	--	41.25	13.07	--	28.18	--	--	--	--	--	--	--	--	--	--	--	--
	5/7/1992	--	--	41.25	14.43	--	26.82	--	--	--	--	--	--	--	--	--	--	--	--
	7/3/1992	--	--	41.25	13.85	--	27.40	<50	<0.5	<0.5	<0.5	<0.5	--	--	ANA	--	--	--	--
	10/8/1992	--	--	41.25	14.89	--	26.36	<50	<0.5	<0.5	<0.5	<0.5	--	--	ANA	--	--	--	--
	12/31/1992	--	--	41.25	11.90	--	29.35	<50	<0.5	<0.5	<0.5	<0.5	--	--	ANA	--	--	--	--
	4/21/1993	--	n	41.25	13.68	--	27.57	<50	<0.5	<0.5	<0.5	<0.5	--	--	PACE	--	--	--	--
	7/7/1993	--	n	41.25	13.12	--	28.13	<50	<0.5	<0.5	<0.5	<0.5	<5.0	--	PACE	--	--	--	--
	9/21/1993	--	n	41.25	14.00	--	27.25	<50	<0.5	<0.5	<0.5	0.9	--	--	PACE	--	--	--	--
	12/17/1993	--	--	41.25	12.98	--	28.27	--	--	--	--	--	--	--	--	--	--	--	--
	12/23/1993	--	n	41.25	--	--	--	<50	<0.5	<0.5	<0.5	0.9	<5.0	--	PACE	--	--	--	--
	4/7/1994	--	n	41.25	13.24	--	28.01	<50	<0.5	<0.5	<0.5	<0.5	<5.0	4.7	PACE	--	--	--	--
	7/6/1994	--	n	41.25	13.77	--	27.48	<50	<0.5	<0.5	<0.5	<0.5	--	3.9	PACE	--	--	--	--
	10/7/1994	--	n	41.25	14.60	--	26.65	<50	<0.5	<0.5	<0.5	<0.5	<5.0	3.0	PACE	--	--	--	--
	1/27/1995	--	--	41.25	8.47	--	32.78	<50	<0.5	<0.5	<0.5	<1	--	2.5	ATI	--	--	--	--
	3/30/1995	--	--	41.25	8.19	--	33.06	<50	<0.50	<0.50	<0.50	<1.0	--	8.4	ATI	--	--	--	--
	6/20/1995	--	--	41.25	11.25	--	30.00	<50	<0.50	<0.50	<0.50	<1.0	--	8.1	ATI	--	--	--	--
	10/3/1995	--	--	41.25	14.68	--	26.57	<50	<0.50	<0.50	<0.50	<1.0	<5.0	6.0	ATI	--	--	--	--
	12/6/1995	--	--	41.25	16.07	--	25.18	<50	<0.50	<0.50	<0.50	<1.0	46	5.4	ATI	--	--	--	--
	3/21/1996	--	--	41.25	9.60	--	31.65	<50	<0.5	<1	<1	<1	<10	8.0	SPL	--	--	--	--
	6/21/1996	--	--	41.25	10.86	--	30.39	<50	<0.5	<1	<1	<1	<10	7.8	SPL	--	--	--	--
	9/6/1996	--	--	41.25	11.52	--	29.73	--	--	--	--	--	--	--	--	--	--	--	--
	9/9/1996	--	k	41.25	--	--	--	<50	<0.5	<1.0	<1.0	<1.0	20/21	7.3	SPL	--	--	--	--
	12/19/1996	--	--	41.25	10.43	--	30.82	<50	<0.5	<1.0	<1.0	<1.0	<10	7.3	SPL	--	--	--	--
	3/17/1997	--	--	41.25	9.87	--	31.38	--	--	--	--	--	--	--	--	--	--	--	--
	8/12/1997	--	--	41.25	11.44	--	29.81	--	--	--	--	--	--	--	--	--	--	--	--
	12/10/1997	--	--	41.25	10.44	--	30.81	--	--	--	--	--	--	--	--	--	--	--	--
	3/12/1998	--	--	41.25	9.50	--	31.75	--	--	--	--	--	--	--	--	--	--	--	--

Table 1

Groundwater Elevation and Analytical Data

Former BP Station #11109
4280 Foothill Blvd., Oakland, CA

Well No.	Date	P/ NP	Foot Note	TOC (ft MSL)	DTW (ft bgs)	Product Thickness (feet)	GWE (ft MSL)	GRO/ TPH-g (µg/L)	Benzene (µg/L)	Toluene (µg/L)	Ethyl-benzene (µg/L)	Total Xylenes (µg/L)	MTBE (µg/L)	DO (mg/L)	Lab	pH	DRO/ TPH-d (µg/L)	TOG (µg/L)	HVOC (µg/L)	
MW-9	6/23/1998	--	--	41.25	10.06	--	31.19	--	--	--	--	--	--	--	--	--	--	--	--	
	3/31/1999	--	--	41.25	9.06	--	32.19	--	--	--	--	--	--	--	--	--	--	--	--	
	8/25/1999	--	--	41.25	12.00	--	29.25	--	--	--	--	--	--	--	--	--	--	--	--	
	3/9/2000	--	--	41.25	10.57	--	30.68	--	--	--	--	--	--	--	--	--	--	--	--	
	3/8/2001	--	--	41.25	9.73	--	31.52	--	--	--	--	--	--	--	--	--	--	--	--	
	3/8/2002	--	--	41.25	11.89	--	29.36	--	--	--	--	--	--	--	--	--	--	--	--	--
	3/18/2002	--	--	41.25	9.68	--	31.57	--	--	--	--	--	--	--	--	--	--	--	--	--
	3/11/2003	--	--	41.25	9.21	--	32.04	--	--	--	--	--	--	--	--	--	--	--	--	--
	03/09/2004	--	--	41.25	10.99	--	30.26	<50	<0.50	<0.50	<0.50	<0.50	<0.50	<0.50	--	SEQM	6.6	--	--	--
	09/17/2004	--	--	41.25	13.35	--	27.90	--	--	--	--	--	--	--	--	--	--	--	--	--
	03/07/2005	P	--	--	41.25	8.94	--	32.31	<50	<0.50	<0.50	<0.50	<0.50	<0.50	--	SEQM	6.9	--	--	--
	09/06/2005	--	--	--	44.06	11.99	--	32.07	--	--	--	--	--	--	--	--	--	--	--	--
	QC-2	10/8/1992	--		41.25	--	--	--	<50	<0.5	<0.5	<0.5	<0.5	--	--	ANA	--	--	--	--
12/31/1992		--		41.25	--	--	--	<50	<0.5	<0.5	<0.5	<0.5	--	--	ANA	--	--	--	--	
4/21/1993		--	l, n	41.25	--	--	--	--	--	--	--	--	--	--	PACE	--	--	--	ND	
7/7/1993		--	l, n	41.25	--	--	--	<50	<0.5	<0.5	<0.5	0.6	--	--	PACE	--	--	--	--	
9/21/1993		--	l, n	41.25	--	--	--	<50	<0.5	<0.5	<0.5	<0.5	--	--	PACE	--	--	--	--	
12/23/1993		--		41.25	--	--	--	<50	<0.5	<0.5	<0.5	<0.5	--	--	PACE	--	--	--	--	
4/7/1994		--		41.25	--	--	--	<50	<0.5	<0.5	<0.5	<0.5	--	--	PACE	--	--	--	--	
7/6/1994		--		41.25	--	--	--	<50	<0.5	<0.5	<0.5	<0.5	--	--	PACE	--	--	--	--	
10/7/1994		--		41.25	--	--	--	<50	<0.5	<0.5	<0.5	<0.5	--	--	PACE	--	--	--	--	
1/27/1995		--		41.25	--	--	--	<50	<0.5	0.5	<0.5	<1	--	--	ATI	--	--	--	--	
3/30/1995		--		41.25	--	--	--	<50	<0.50	<0.50	<0.50	<1.0	--	--	ATI	--	--	--	--	
6/20/1995		--		41.25	--	--	--	<50	<0.50	<0.50	<0.50	<1.0	--	--	ATI	--	--	--	--	
10/3/1995		--		41.25	--	--	--	<50	<0.50	<0.50	<0.50	<1.0	<5.0	--	ATI	--	--	--	--	
12/6/1995		--		41.25	--	--	--	<50	<0.50	<0.50	<0.50	<1.0	<5.0	--	ATI	--	--	--	--	
3/21/1996		--		41.25	--	--	--	<50	<0.5	<1	<1	<1	<10	--	SPL	--	--	--	--	
6/21/1996	--		41.25	--	--	--	<50	<0.5	<1	<1	<1	<10	--	SPL	--	--	--	--		

Table 1

Groundwater Elevation and Analytical Data

Former BP Station #11109
4280 Foothill Blvd., Oakland, CA

ABBREVIATIONS & SYMBOLS:

-- = Not analyzed/applicable/measured/available
< = Not detected at or above laboratory reporting limit
ND = Not detected at or above laboratory reporting limit
DO = Dissolved oxygen
DTW = Depth to water in ft bgs
ft bgs = feet below ground surface
ft MSL = feet above mean sea level
GRO = Gasoline Range Organics, range C4-C12
GWE = Groundwater elevation measured in ft MSL
mg/L = Milligrams per liter
MTBE = Methyl tert butyl ether
NP = Well not purged prior to sampling
P = Well purged prior to sampling
TOC = Top of casing measured in ft MSL
TPH-g = Total petroleum hydrocarbons as gasoline
ug/L = Micrograms per liter
ANA = Anametrix, Inc.
PACE = Pace, Inc.
ATI = Analytical Technologies, Inc.
CEI = Ceimic Corporation
SPL = Southern Petroleum Laboratories
SEQ/SEQM= Sequoia Analytical/Sequoia Morgan Hill Laboratories
SUP = Superior Analytical Laboratory

FOOTNOTES:

- (a) Free product in well.
- (c) Well destroyed during tank removal in November 1990.
- (d) Methylene chloride.
- (e) 1,2-Dichloroethane.
- (f) Well inaccessible.
- (g) Sample collected from MW-2 for TPH-D analysis received in laboratory 7 days after collection; sample exceeded EPA recommended holding time for TPH-D on a water matrix.
- (h) Blind duplicate.
- (i) Top of casing lowered.
- (j) A copy of the documentation for this data is included in Appendix C of Alisto report 10-014-07-001.
- (k) EPA Methods 8020/8260 used.
- (l) Travel blank.
- (n) A copy of the documentation for this data is included in the Blaine Tech Services, Inc. report 020308-DW-2. The data for samples taken on April 21, 1993, have been destroyed. No chromatograms could be located for the samples taken on:
July 7, 1993, for well MW-2 and TB; September 21, 1993, for all wells MW-3, MW-4, MW-6, MW-7, MW-8, MW-9,
the DUP and TB; December 23, 1993, for wells MW-2 and MW-3; and July 6, 1994, for wells MW-2, MW-4, MW-6, and MW-9.
- (p) Well not sampled due to damage during site construction.
- (q) Sheen in well.
- (r) Well dry
- (s) The hydrocarbon result for GRO was partly due to individual peaks in the quantification range.
- (t) MS and/or MSD were below the acceptance limits for MTBE. Matrix interference was suspected.

Table 1

Groundwater Elevation and Analytical Data

Former BP Station #11109
4280 Foothill Blvd., Oakland, CA

NOTES:

Groundwater elevations adjusted assuming a specific gravity of 0.75 for free product.

The data within this table collected prior to June 2002 was provided to URS by RM and their previous consultants. URS has not verified the accuracy of this information.

Beginning in the fourth quarter 2003, the laboratory modified the reported analyte list. TPH-g has been changed to GRO. The resulting data may be impacted by the potential inclusion of non-TPHg analytes within the requested fuel range resulting in a higher concentration being reported.

Table 2

Fuel Additives Analytical Data
Former BP Station #11109
4280 Foothill Blvd., Oakland, CA

Well Number	Date Sampled	Ethanol (µg/L)	TBA (µg/L)	MTBE (µg/L)	DIPE (µg/L)	ETBE (µg/L)	TAME (µg/L)	1,2-DCA (µg/L)	EDB (µg/L)	Footnotes/ Comments
MW-2	12/09/2003	<100	<20	24	<0.50	<0.50	<0.50	--	--	
	03/09/2004	<100	<20	27	<0.50	<0.50	<0.50	<0.50	<0.50	
	09/17/2004	<100	<20	21	<0.50	<0.50	<0.50	<0.50	<0.50	
MW-3	12/09/2003	<100	<20	6.4	<0.50	<0.50	<0.50	--	--	
	03/09/2004	<100	<20	6.9	<0.50	<0.50	<0.50	<0.50	<0.50	
	03/07/2005	<100	<20	5.1	<0.50	<0.50	<0.50	<0.50	<0.50	
MW-4	12/09/2003	<500	<100	130	<2.5	<2.5	2.7	--	--	
	03/09/2004	<100	<20	35	<0.50	<0.50	<0.50	<0.50	<0.50	
	09/17/2004	<500	<100	140	<2.5	<2.5	2.6	<2.5	<2.5	
	03/07/2005	<100	<20	42	<0.50	<0.50	0.56	<0.50	<0.50	
	09/06/2005	<150	<10	180	<0.50	<0.50	2.8	<0.50	<0.50	a
MW-5	03/09/2004	<10,000	<2,000	<50	<50	<50	<50	96	<50	
MW-6	12/09/2003	<100	<20	12	<0.50	<0.50	<0.50	--	--	
	03/09/2004	<100	<20	10	<0.50	<0.50	<0.50	0.58	<0.50	
	03/07/2005	<100	<20	5.8	<0.50	<0.50	<0.50	<0.50	<0.50	
MW-7	12/09/2003	<100	<20	8.7	<0.50	<0.50	<0.50	--	--	
	03/09/2004	<100	<20	6.9	<0.50	<0.50	<0.50	1.2	<0.50	
	09/17/2004	<100	<20	7.0	<0.50	<0.50	<0.50	<0.50	<0.50	
	03/07/2005	<100	<20	7.2	<0.50	<0.50	<0.50	<0.50	<0.50	
	09/06/2005	<150	30	16	0.60	<0.50	<0.50	<0.50	<0.50	
MW-8	03/09/2004	<100	<20	0.50	<0.50	<0.50	<0.50	<0.50	<0.50	
	03/07/2005	<100	<20	<0.50	<0.50	<0.50	<0.50	<0.50	<0.50	
MW-9	03/09/2004	<100	<20	<0.50	<0.50	<0.50	<0.50	<0.50	<0.50	
	03/07/2005	<100	<20	<0.50	<0.50	<0.50	<0.50	<0.50	<0.50	

Table 2

Fuel Additives Analytical Data

Former BP Station #11109
4280 Foothill Blvd., Oakland, CA

ABBREVIATIONS AND SYMBOLS:

TBA = tert-Butyl alcohol

MTBE = Methyl tert-butyl ether

DIPE = Di-isopropyl ether

ETBE = Ethyl tert butyl ether

TAME = tert-Amyl methyl ether

1,2-DCA = 1,2-Dichloroethane

EDB = 1,2-Dibromoethane

ug/L = micrograms per liter

< = Not detected at or above the laboratory reporting limit

— = Data not available, not analyzed, or not applicable

FOOTNOTES:

(a) MS and/or MSD below acceptance limits for MTBE. Matrix interference suspected.

NOTES:

The data within this table collected prior to July 2003 was provided to URS by RM and their previous consultants. URS has not verified the accuracy of this information.

All fuel oxygenate compounds analyzed using EPA Method 8260B

Table 3
Free Product Removal

Former BP Service Station #11109
4280 Foothill Boulevard,
Oakland, CA

WELL ID	DATE OF MONITORING EVENT	DEPTH TO WATER (feet)	PRODUCT THICKNESS (feet)	PRODUCT REMOVED (gallons)	CUMULATIVE PRODUCT REMOVED (gallons)
MW-5	08/25/1999	---	---	0.070	0.070
MW-5	03/09/2000	---	---	0.400	0.470
MW-5	07/14/2003	12.72	0.03	0.019	0.489
MW-5	08/25/2003	14.04	0.00	0.000	0.489
MW-5	09/25/2003	14.38	0.08	0.052	0.542
MW-5	10/03/2003	12.15	0.06	0.040	0.582
MW-5	11/12/2003	12.74	0.19	0.120	0.702
MW-5	12/09/2003	11.44	0.03	0.040	0.742
MW-5	02/02/2004	6.47	0.04	0.030	0.772
MW-5	02/09/2004	10.61	0.04	0.030	0.802
MW-5	03/09/2004	7.91	---	---	0.800
MW-5	04/13/2004	9.68	0.28	0.200	0.820
MW-5	05/05/2004	11.93	Sheen	---	0.820
MW-5	06/03/2004	12.60	Sheen	---	0.820
MW-5	07/02/2004	11.11	0.10	0.060	0.880
MW-5	08/31/2004	12.80	0.05	0.132	1.012
MW-5	09/17/2004	12.13	0.15	---	1.012
MW-5	10/25/2004	10.66	0.26	0.170	1.182
MW-5	11/08/2004	9.98	0.02	0.020	1.202
MW-5	12/15/2004	8.76	0.01	0.010	1.212
MW-5	01/13/2005	7.12	---	---	1.212
MW-5	02/01/2005	8.10	0.01	0.007	1.219
MW-5	03/07/2005	8.62	0.02	0.013	1.232
MW-5	04/29/2005	9.39	--	--	1.232
MW-5	05/12/2005	7.51	0.01	0.007	1.239
MW-5	06/23/2005	7.70	--	--	1.239
MW-5	07/02/2005	10.81	--	--	1.239
MW-5	08/24/2005	10.53	--	--	1.239
MW-5	09/06/2005	11.16	0.18	0.119	1.358
			FP Removed this Quarter:		0.119
<p>Source : The data within this table collected prior to July 2003 was provided to URS by RM and their previous consultants. URS has not verified the accuracy of this information.</p>					

ATTACHMENT A
FIELD PROCEDURES AND FIELD DATA SHEETS

FIELD PROCEDURES

Sampling Procedures

The sampling procedure for each well consists first of measuring the water level and depth to bottom, and checking for the presence of free phase petroleum product (free product), using either an electronic indicator and a clear Teflon™ bailer or an oil-water interface probe.

Wells not containing free product are purged approximately three casing volumes of water (or until dewatered) using a centrifugal pump, gas displacement pump, or bailer. Equipment and purging method used for the current sampling event is noted on the attached field data sheets. During purging, temperature, pH, and electrical conductivity are monitored to document that these parameters are stable prior to collecting samples. After purging, water levels are allowed to partially (approximately 80%) recover. Groundwater samples (both purge and no purge) are collected using a Teflon bailer, placed into appropriate Environmental Protection Agency- (EPA) approved containers, labeled, logged onto chain-of-custody records, and transported on ice to a California State-certified laboratory. Wells with free product are not sampled and free product is removed according to California Code of Regulation, Title 23, Div. 3, Chap. 16, Section 2655, UST Regulations.

WELL GAUGING DATA

Project # 050906-BAZ Date 9/6/05 Client #11109

Site 4280 Foothill, Oakland

Well ID	Well Size (in.)	Sheen / Odor	Depth to Immiscible Liquid (ft.)	Thickness of Immiscible Liquid (ft.)	Volume of Immiscibles Removed (ml)	Depth to water (ft.)	Depth to well bottom (ft.)	Survey Point: TOB or TOC		
MW-2	2					DRY	12.88	TOC		
MW-3	4					10.81	31.38	60		
MW-4	4					14.64	26.74			
MW-5	4		10.98	.18		11.16	—			
MW-6	4					14.23	34.50		60	
MW-7	6		<i>guessed by pump in well</i>			11.80	33.30			
MW-8	2					13.06	29.49		60	
MW-9	2					11.99	29.54		> 60	

ARCO / BP WELL MONITORING DATA SHEET

BTS #: 050906-BAZ	Station # 11109
Sampler: Brian Alcorn	Date: 9/6/05
Well I.D.: MW-2	Well Diameter: (2) 3 4 6 8
Total Well Depth: 12.88	Depth to Water: Dry
Depth to Free Product: —	Thickness of Free Product (feet): —
Referenced to: PVC Grade	D.O. Meter (if req'd): YSI HACH

Well Diameter	Multiplier	Well Diameter	Multiplier
1"	0.04	4"	0.65
2"	0.16	6"	1.47
3"	0.37	Other	radius ² * 0.163

Purge Method: Bailer Disposable Bailer Positive Air Displacement Electric Submersible Extraction Pump Other: _____	Sampling Method: Bailer Disposable Bailer Extraction Port Other: _____
--	--

Top of Screen: _____ If well is listed as a no-purge, confirm that water level is below the top of screen. Otherwise, the well must be purged.

_____	X	_____	=	_____
1 Case Volume (Gals.)		Specified Volumes		Gals. Calculated Volume

Time	Temp (°F)	pH	Conductivity (mS or μS)	Gals. Removed	Observations
					Well Dry - Unable to purge + Sample

Did well dewater? Yes <input type="checkbox"/> No <input checked="" type="checkbox"/>	Gallons actually evacuated: _____
Sampling Time: _____	Sampling Date: _____
Sample I.D.: _____	Laboratory: Pace Sequoia Other _____
Analyzed for: GRO BTEX MTBE DRO Oxy's 1,2-DCA EDB Ethanol Other: _____	
D.O. (if req'd): _____	Pre-purge: _____ mg/L Post-purge: _____ mg/L
O.R.P. (if req'd): _____	Pre-purge: _____ mV Post-purge: _____ mV

ARCO / BP WELL MONITORING DATA SHEET

BTS #: 050906-BA2	Station # 11109
Sampler: Brian Alcom	Date: 9/6/05
Well I.D.: MW-4	Well Diameter: 2 3 (4) 6 8
Total Well Depth: 26.74	Depth to Water: 14.64
Depth to Free Product: —	Thickness of Free Product (feet): —
Referenced to: (PVC) Grade	D.O. Meter (if req'd): YSI HACH

Well Diameter	Multiplier	Well Diameter	Multiplier
1"	0.04	4"	0.65
2"	0.16	6"	1.47
3"	0.37	Other	radius ² * 0.163

Purge Method: Bailer
 Disposable Bailer
 Positive Air Displacement
 Electric Submersible
 Extraction Pump
 Other: _____

Sampling Method: Bailer
 Disposable Bailer
 Extraction Port
 Other: _____

Top of Screen: _____ If well is listed as a no-purge, confirm that water level is below the top of screen. Otherwise, the well must be purged.

7.9	x	3	=	23.7	Gals.
1 Case Volume (Gals.)		Specified Volumes		Calculated Volume	

Time	Temp (°F)	pH	Conductivity (mS or µS)	Gals. Removed	Observations
1114	70.3	6.4	769	8.0	clear
Well Dewatered @ 12 gallons					
1145	70.5	6.7	755	12.0	clear

Did well dewater? Yes No Gallons actually evacuated: 12

Sampling Time: 1145 Sampling Date: 9/6/05

Sample I.D.: MW-4 Laboratory: Pace (Sequoia) Other _____

Analyzed for: GRO BTEX MTBE DRO Other: _____

D.O. (if req'd):	Pre-purge:	mg/L	Post-purge:	mg/L
	O.R.P. (if req'd):	Pre-purge:	mV	Post-purge:

ARCO / BP WELL MONITORING DATA SHEET

BTS #: 050906-BAZ	Station # 11109
Sampler: Brian Alcorn	Date: 9/6/05
Well I.D.: MW-5	Well Diameter: 2 3 <u>4</u> 6 8
Total Well Depth: —	Depth to Water: 11.16
Depth to Free Product: 10.98	Thickness of Free Product (feet): .18
Referenced to: PVC Grade	D.O. Meter (if req'd): YSI HACH

Well Diameter	Multiplier	Well Diameter	Multiplier
1"	0.04	4"	0.65
2"	0.16	6"	1.47
3"	0.37	Other	radius ² * 0.163

Purge Method: <u>Bailer</u> Disposable Bailer Positive Air Displacement Electric Submersible Extraction Pump Other: _____	Sampling Method: <u>Bailer</u> Disposable Bailer Extraction Port Other: _____
--	--

Top of Screen: _____ If well is listed as a no-purge, confirm that water level is below the top of screen. Otherwise, the well must be purged.

1 Case Volume (Gals.)	X	<u>BAIL SPH</u>	=	_____ Gals.
		Specified Volumes		Calculated Volume

Time	Temp (°F)	pH	Conductivity (mS or µS)	Gals. Removed	Observations
					<u>SPH Detected - Bailed 450ml of product</u>

Did well dewater? Yes <input checked="" type="checkbox"/> No <input type="checkbox"/>	Gallons actually evacuated: _____
Sampling Time: _____	Sampling Date: _____
Sample I.D.: _____	Laboratory: <u>Pace</u> Sequoia Other _____
Analyzed for: GRO BTEX MYBE DRO Oxy's 1,2-DCA EDB Ethanol	Other: _____
D.O. (if req'd):	Pre-purge: _____ mg/L Post-purge: _____ mg/L
O.R.P. (if req'd):	Pre-purge: _____ mV Post-purge: _____ mV

ARCO / BP WELL MONITORING DATA SHEET

BTS #: 050906-BA2	Station # 11109
Sampler: Brian Alcom	Date: 9/6/05
Well I.D.: MW-7	Well Diameter: 2 3 4 6 8
Total Well Depth: 33.30	Depth to Water: 11.80
Depth to Free Product: —	Thickness of Free Product (feet): —
Referenced to: PVC Grade	D.O. Meter (if req'd): YSI HACH

Well Diameter	Multiplier	Well Diameter	Multiplier
1"	0.04	4"	0.65
2"	0.16	6"	1.47
3"	0.37	Other	radius ² * 0.163

Purge Method: Bailer
 Disposable Bailer
 Positive Air Displacement
Electric Submersible
 Extraction Pump
 Other: _____

Sampling Method: Bailer
Disposable Bailer
 Extraction Port
 Other: _____

Top of Screen: _____ If well is listed as a no-purge, confirm that water level is below the top of screen. Otherwise, the well must be purged.

<u>31.6</u>	x	<u>3</u>	=	<u>94.8</u>	Gals.
1 Case Volume (Gals.)		Specified Volumes		Calculated Volume	

Time	Temp (°F)	pH	Conductivity (mS or <u>µS</u>)	Gals. Removed	Observations
1129	72.4	6.5	889	32.0	clear, odor
Well Dewatered @ 40 gallons					
1155	73.0	6.7	909	40.0	" "

Did well dewater? **Yes** No Gallons actually evacuated: 40

Sampling Time: 1155 Sampling Date: 9/6/05

Sample I.D.: MW-7 Laboratory: Pace **Sequoia** Other _____

Analyzed for: GRO BTEX MTBE DRO Other: _____

D.O. (if req'd):	Pre-purge:	mg/L	Post-purge:	mg/L
O.R.P. (if req'd):	Pre-purge:	mV	Post-purge:	mV

BP GEM OIL COMPANY TYPE A BILL OF LADING

SOURCE RECORD BILL OF LADING FOR NON-HAZARDOUS PURGEWATER RECOVERED FROM GROUNDWATER WELLS AT BP GEM OIL COMPANY FACILITIES IN THE STATE OF CALIFORNIA. THE NON-HAZARDOUS PURGE- WATER WHICH HAS BEEN RECOVERED FROM GROUND- WATER WELLS IS COLLECTED BY THE CONTRACTOR, MADE UP INTO LOADS OF APPROPRIATE SIZE AND HAULED BY DILLARD ENVIRONMENTAL TO THE ALTAMONT LANDFILL AND RESOURCE RECOVERY FACILITY IN LIVERMORE, CALIFORNIA.

The contractor performing this work is BLAINE TECH SERVICES, INC. (BTS), 1680 Rogers Avenue, San Jose, CA 95112 (phone [408] 573-0555). Blaine Tech Services, Inc. is authorized by BP GEM OIL COMPANY to recover, collect, apportion into loads the Non-Hazardous Well Purgewater that is drawn from wells at the BP GEM Oil Company facility indicated below and deliver that purgewater to BTS. Transport routing of the Non-Hazardous Well Purgewater may be direct from one BP GEM facility to the designated destination point; from one BP GEM facility to the designated destination point via another BP GEM facility; from a BP GEM facility to the designated destination point via the contractor's facility, or any combination thereof. The Non-Hazardous Well Purgewater is and remains the property of BP GEM Oil Company.

This Source Record BILL OF LADING was initiated to cover the recovery of Non-Hazardous Well Purgewater from wells at the BP GEM Oil Company facility described below:

11109

Station #

4280 Foothill, Oakland

Station Address

Total Gallons Collected From Groundwater Monitoring Wells:

added equip.
rinse water _____

any other
adjustments _____

TOTAL GALS.
RECOVERED 600

loaded onto
BTS vehicle # 604

BTS event #

time date

050906-BAZ

1200

9/6/05

signature

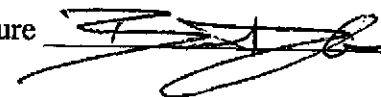

REC'D AT

time

date

unloaded by
signature _____

1/1

WELL GAUGING DATA

Project # 050824-553 Date 8/24/05 Client 1109

Site 4280 Foothill OAKLAND

Well ID	Well Size (in.)	Sheen / Odor	Depth to Immiscible Liquid (ft.)	Thickness of Immiscible Liquid (ft.)	Volume of Immiscibles Removed (ml)	Depth to water (ft.)	Depth to well bottom (ft.)	Survey Point: TQB or TOC
MW-5	4					10.53	—	TOC

ARCO / BP WELL MONITORING DATA SHEET

BTS #: <u>05D824-553</u>	Station # <u>11109</u>
Sampler: <u>sooch</u>	Date: <u>8/24/05</u>
Well I.D.: <u>MW-5</u>	Well Diameter: 2 3 4 6 8
Total Well Depth: _____	Depth to Water: <u>10.53</u>
Depth to Free Product: _____	Thickness of Free Product (feet): _____
Referenced to: <u>PVC</u> Grade _____	D.O. Meter (if req'd): YSI HACH

Well Diameter	Multiplier	Well Diameter	Multiplier
1"	0.04	4"	0.65
2"	0.16	6"	1.47
3"	0.37	Other	radius ² * 0.163

Purge Method: <u>Bailer</u> Disposable Bailer Positive Air Displacement Electric Submersible Extraction Pump Other: _____	Sampling Method: <u>Bailer</u> Disposable Bailer Extraction Port Other: _____
--	--

Top of Screen: _____ If well is listed as a no-purge, confirm that water level is below the top of screen. Otherwise, the well must be purged.

_____	X	_____	=	_____	Gals.
1 Case Volume (Gals.)		Specified Volumes		Calculated Volume	

Time	Temp (°F)	pH	Conductivity (mS or µS)	Gals. Removed	Observations
					NO SPIA DETECTED.

Did well dewater? Yes <input checked="" type="checkbox"/> No <input type="checkbox"/>	Gallons actually evacuated: _____	
Sampling Time: _____	Sampling Date: _____	
Sample I.D.: _____	Laboratory: <u>Pace</u> Sequoia Other _____	
Analyzed for: <u>GRG BTEX MTBE DRO Oxy's 1,2-DCA EDB Ethanol</u>	Other: _____	
D.O. (if req'd):	Pre-purge: _____ mg/L	Post-purge: _____ mg/L
O.R.P. (if req'd):	Pre-purge: _____ mV	Post-purge: _____ mV

WELL GAUGING DATA

Project # 050707-DAY Date 7/7/05 Client BP1109

Site 4280 Foothill Blvd Oakland, CA

Well ID	Well Size (in.)	Sheen / Odor	Depth to Immiscible Liquid (ft.)	Thickness of Immiscible Liquid (ft.)	Volume of Immiscibles Removed (ml)	Depth to water (ft.)	Depth to well bottom (ft.)	Survey Point: TOB or TOC
MW-5	4	S/O	-	-	-	10.81	-	TOC

ARCO / BP WELL MONITORING DATA SHEET

BTS #: <u>05 0709 - DA 4</u>	Station # <u>BP 11109</u>
Sampler: <u>PA</u>	Date: <u>7/7/05</u>
Well I.D.: <u>MW-5</u>	Well Diameter: 2 3 <u>4</u> 6 8
Total Well Depth: <u>-</u>	Depth to Water: <u>10.81</u>
Depth to Free Product: <u>-</u>	Thickness of Free Product (feet): <u>-</u>
Referenced to: <u>PVC</u> Grade	D.O. Meter (if req'd): YSI HACH

Well Diameter	Multiplier	Well Diameter	Multiplier
1"	0.04	4"	0.65
2"	0.16	6"	1.47
3"	0.37	Other	radius ² * 0.163

Purge Method: ~~Bailer~~
~~Disposable Bailer~~
~~Positive Air Displacement~~
~~Electric Submersible Extraction Pump~~
 Other: _____

Sampling Method: ~~Bailer~~
~~Disposable Bailer~~
~~Extraction Port~~
 Other: _____

Top of Screen: _____ If well is listed as a no-purge, confirm that water level is below the top of screen. Otherwise, the well must be purged.

_____	x	<u>Bail SPH</u>	=	_____	Gals.
1 Case Volume (Gals.)		Specified Volumes		Calculated Volume	

Time	Temp (°F)	pH	Conductivity (mS or µS)	Gals. Removed	Observations
			<u>No SPH detected</u>		

Did well dewater? Yes <input type="checkbox"/> No <input type="checkbox"/>	Gallons actually evacuated: _____
Sampling Time: _____	Sampling Date: _____
Sample I.D.: _____	Laboratory: Pace Sequoia Other _____
Analyzed for: GRO BTEX MTBE DRO Other: _____	
D.O. (if req'd): Pre-purge: _____ mg/L	Post-purge: _____ mg/L
O.R.P. (if req'd): Pre-purge: _____ mV	Post-purge: _____ mV

ATTACHMENT B
LABORATORY PROCEDURES,
CERTIFIED ANALYTICAL REPORTS,
AND CHAIN-OF-CUSTODY RECORDS

LABORATORY PROCEDURES

Laboratory Procedures

The groundwater samples were analyzed for the presence of the chemicals mentioned in the chain of custody using standard EPA methods. The methods of analysis for the groundwater samples are documented in the certified analytical report. The certified analytical reports and chain-of-custody record are presented in this attachment. The analytical data provided by the laboratory approved by RM have been reviewed and verified by that laboratory.



21 September, 2005

Lynelle Onishi
URS Corporation [Arco]
1333 Broadway, Suite 800
Oakland, CA 94612

RE: BP Heritage #11109, Oakland, CA
Work Order: MOI0258

Enclosed are the results of analyses for samples received by the laboratory on 09/07/05 16:15. If you have any questions concerning this report, please feel free to contact me.

Sincerely,

Lisa Race For Jamshid Kekobad
Project Manager

CA ELAP Certificate #1210

URS Corporation [Arco] 1333 Broadway, Suite 800 Oakland CA, 94612	Project:BP Heritage #11109, Oakland, CA Project Number:G07TD-0021 Project Manager:Lynelle Onishi	MOI0258 Reported: 09/21/05 19:05
---	--	---

ANALYTICAL REPORT FOR SAMPLES

Sample ID	Laboratory ID	Matrix	Date Sampled	Date Received
MW-4	MOI0258-01	Water	09/06/05 11:45	09/07/05 16:15
MW-7	MOI0258-02	Water	09/06/05 11:55	09/07/05 16:15
TB-11109-09062005	MOI0258-03	Water	09/06/05 10:30	09/07/05 16:15

The carbon range for the TPH-GRO has been changed from C6-C10 to C4-C12. The carbon range for TPH-DRO has been changed from C10-C28 to C10-C36. EPA 8015B has been modified to better meet the requirements of California regulatory agencies. These samples were received with intact custody seals.



URS Corporation [Arco]
1333 Broadway, Suite 800
Oakland CA, 94612

Project:BP Heritage #11109, Oakland, CA
Project Number:G07TD-0021
Project Manager:Lynelle Onishi

MOI0258
Reported:
09/21/05 19:05

**VOLATILE FUEL HYDROCARBONS (EPA 5030/8015M)
Del Mar Analytical, Irvine**

Analyte	Result	Reporting Limit	Units	Dilution	Batch	Prepared	Analyzed	Method	Notes
MW-4 (MOI0258-01) Water Sampled: 09/06/05 11:45 Received: 09/07/05 16:15									
GRO (C4 - C12)	81	50	ug/l	1	5I16111	09/16/05	09/17/05	EPA 8015B	PV
<i>Surrogate: 4-BFB (FID)</i>		<i>84 %</i>	<i>65-140</i>		<i>"</i>	<i>"</i>	<i>"</i>	<i>"</i>	
MW-7 (MOI0258-02) Water Sampled: 09/06/05 11:55 Received: 09/07/05 16:15									
GRO (C4 - C12)	1100	50	ug/l	1	5I16111	09/16/05	09/17/05	EPA 8015B	
<i>Surrogate: 4-BFB (FID)</i>		<i>105 %</i>	<i>65-140</i>		<i>"</i>	<i>"</i>	<i>"</i>	<i>"</i>	

URS Corporation [Arco]
 1333 Broadway, Suite 800
 Oakland CA, 94612

 Project:BP Heritage #11109, Oakland, CA
 Project Number:G07TD-0021
 Project Manager:Lynelle Onishi

 MOI0258
 Reported:
 09/21/05 19:05

VOLATILE ORGANICS by GC/MS (EPA 5030B/8260B)
Del Mar Analytical, Irvine

Analyte	Result	Reporting Limit	Units	Dilution	Batch	Prepared	Analyzed	Method	Notes
---------	--------	-----------------	-------	----------	-------	----------	----------	--------	-------

MW-4 (MOI0258-01) Water Sampled: 09/06/05 11:45 Received: 09/07/05 16:15

1,2-Dibromoethane (EDB)	ND	0.50	ug/l	1	5I16014	09/16/05	09/16/05 18:43	EPA 8260B	
1,2-Dichloroethane	ND	0.50	"	"	"	"	"	"	
Benzene	ND	0.50	"	"	"	"	"	"	
Ethylbenzene	ND	0.50	"	"	"	"	"	"	
Toluene	ND	0.50	"	"	"	"	"	"	
Xylenes, Total	ND	1.5	"	"	"	"	"	"	
Ethanol	ND	150	"	"	"	"	"	"	
tert-Butanol (TBA)	ND	10	"	"	"	"	"	"	
Di-isopropyl Ether (DIPE)	ND	0.50	"	"	"	"	"	"	
Ethyl tert-Butyl Ether (ETBE)	ND	0.50	"	"	"	"	"	"	
Methyl-tert-butyl Ether (MTBE)	180	0.50	"	"	"	"	"	"	
tert-Amyl Methyl Ether (TAME)	2.8	0.50	"	"	"	"	"	"	LN,AY

Surrogate: Dibromofluoromethane

117 % 80-120

Surrogate: Toluene-d8

115 % 80-120

Surrogate: 4-Bromofluorobenzene

110 % 80-120

MW-7 (MOI0258-02) Water Sampled: 09/06/05 11:55 Received: 09/07/05 16:15

1,2-Dibromoethane (EDB)	ND	0.50	ug/l	1	5I16014	09/16/05	09/16/05 20:08	EPA 8260B	
1,2-Dichloroethane	ND	0.50	"	"	"	"	"	"	
Benzene	130	0.50	"	"	"	"	"	"	
Ethylbenzene	1.8	0.50	"	"	"	"	"	"	
Toluene	1.2	0.50	"	"	"	"	"	"	
Xylenes, Total	ND	1.5	"	"	"	"	"	"	
Ethanol	ND	150	"	"	"	"	"	"	
tert-Butanol (TBA)	30	10	"	"	"	"	"	"	
Di-isopropyl Ether (DIPE)	0.60	0.50	"	"	"	"	"	"	
Ethyl tert-Butyl Ether (ETBE)	ND	0.50	"	"	"	"	"	"	
Methyl-tert-butyl Ether (MTBE)	16	0.50	"	"	"	"	"	"	
tert-Amyl Methyl Ether (TAME)	ND	0.50	"	"	"	"	"	"	

Surrogate: Dibromofluoromethane

113 % 80-120

Surrogate: Toluene-d8

113 % 80-120

Surrogate: 4-Bromofluorobenzene

112 % 80-120

URS Corporation [Arco] 1333 Broadway, Suite 800 Oakland CA, 94612	Project:BP Heritage #11109, Oakland, CA Project Number:G07TD-0021 Project Manager:Lynelle Onishi	MOI0258 Reported: 09/21/05 19:05
---	--	--

VOLATILE FUEL HYDROCARBONS (EPA 5030/8015M) - Quality Control
Del Mar Analytical, Irvine

Analyte	Result	Reporting Limit	Units	Spike Level	Source Result	%REC	%REC Limits	RPD	RPD Limit	Notes
Batch 5I16111 - EPA 5030B / EPA 8015B										
Blank (5I16111-BLK1)				Prepared & Analyzed: 09/16/05						
GRO (C4 - C12)	ND	50	ug/l							
Surrogate: 4-BFB (FID)	8.81		"	10.0		88	65-140			
Laboratory Control Sample (5I16111-BS1)				Prepared & Analyzed: 09/16/05						
GRO (C4 - C12)	622	50	ug/l	800		78	65-140			
Surrogate: 4-BFB (FID)	27.0		"	30.0		90	65-140			
Matrix Spike (5I16111-MS1)				Source: IOI1111-03 Prepared & Analyzed: 09/16/05						
GRO (C4 - C12)	219	50	ug/l	220	ND	100	60-145			
Surrogate: 4-BFB (FID)	9.14		"	10.0		91	65-140			
Matrix Spike Dup (5I16111-MSD1)				Source: IOI1111-03 Prepared & Analyzed: 09/16/05						
GRO (C4 - C12)	225	50	ug/l	220	ND	102	60-145	3	20	
Surrogate: 4-BFB (FID)	9.92		"	10.0		99	65-140			

URS Corporation [Arco]
 1333 Broadway, Suite 800
 Oakland CA, 94612

 Project:BP Heritage #11109, Oakland, CA
 Project Number:G07TD-0021
 Project Manager:Lynelle Onishi

 MOI0258
 Reported:
 09/21/05 19:05

VOLATILE ORGANICS by GC/MS (EPA 5030B/8260B) - Quality Control
Del Mar Analytical, Irvine

Analyte	Result	Reporting Limit	Units	Spike Level	Source Result	%REC	%REC Limits	RPD	RPD Limit	Notes
---------	--------	-----------------	-------	-------------	---------------	------	-------------	-----	-----------	-------

Batch 5I16014 - EPA 5030B GCMS / EPA 8260B
Blank (5I16014-BLK1)

Prepared & Analyzed: 09/16/05

1,2-Dibromoethane (EDB)	ND	0.50	ug/l							
1,2-Dichloroethane	ND	0.50	"							
Benzene	ND	0.50	"							
Ethylbenzene	ND	0.50	"							
Toluene	ND	0.50	"							
Xylenes, Total	ND	1.5	"							
Ethanol	ND	150	"							
tert-Butanol (TBA)	ND	10	"							
Di-isopropyl Ether (DIPE)	ND	0.50	"							
Ethyl tert-Butyl Ether (ETBE)	ND	0.50	"							
Methyl-tert-butyl Ether (MTBE)	ND	0.50	"							
tert-Amyl Methyl Ether (TAME)	ND	0.50	"							
<i>Surrogate: Dibromofluoromethane</i>	27.6		"	25.0		110	80-120			
<i>Surrogate: Toluene-d8</i>	28.0		"	25.0		112	80-120			
<i>Surrogate: 4-Bromofluorobenzene</i>	26.9		"	25.0		108	80-120			

Laboratory Control Sample (5I16014-BS1)

Prepared & Analyzed: 09/16/05

1,2-Dibromoethane (EDB)	28.2	0.50	ug/l	25.0		113	70-125			
1,2-Dichloroethane	29.6	0.50	"	25.0		118	60-140			
Benzene	26.6	0.50	"	25.0		106	65-120			
Ethylbenzene	26.8	0.50	"	25.0		107	70-125			
Toluene	25.4	0.50	"	25.0		102	70-125			
Xylenes, Total	81.1	1.5	"	75.0		108	70-125			
Ethanol	305	150	"	250		122	35-160			
tert-Butanol (TBA)	137	10	"	125		110	65-135			
Di-isopropyl Ether (DIPE)	29.6	0.50	"	25.0		118	60-135			
Ethyl tert-Butyl Ether (ETBE)	27.5	0.50	"	25.0		110	60-135			
Methyl-tert-butyl Ether (MTBE)	26.1	0.50	"	25.0		104	55-140			
tert-Amyl Methyl Ether (TAME)	27.1	0.50	"	25.0		108	60-135			
<i>Surrogate: Dibromofluoromethane</i>	29.0		"	25.0		116	80-120			
<i>Surrogate: Toluene-d8</i>	28.5		"	25.0		114	80-120			
<i>Surrogate: 4-Bromofluorobenzene</i>	29.1		"	25.0		116	80-120			

URS Corporation [Arco]
 1333 Broadway, Suite 800
 Oakland CA, 94612

 Project:BP Heritage #11109, Oakland, CA
 Project Number:G07TD-0021
 Project Manager:Lynelle Onishi

 MOI0258
 Reported:
 09/21/05 19:05

VOLATILE ORGANICS by GC/MS (EPA 5030B/8260B) - Quality Control
Del Mar Analytical, Irvine

Analyte	Result	Reporting Limit	Units	Spike Level	Source Result	%REC	%REC Limits	RPD	RPD Limit	Notes
---------	--------	-----------------	-------	-------------	---------------	------	-------------	-----	-----------	-------

Batch 5I16014 - EPA 5030B GCMS / EPA 8260B

Matrix Spike (5I16014-MS1)	Source: MOI0258-01			Prepared & Analyzed: 09/16/05						
1,2-Dibromoethane (EDB)	25.3	0.50	ug/l	25.0	ND	101	65-130			
1,2-Dichloroethane	27.6	0.50	"	25.0	ND	110	60-140			
Benzene	23.6	0.50	"	25.0	ND	94	60-125			
Ethylbenzene	23.8	0.50	"	25.0	ND	95	65-130			
Toluene	22.8	0.50	"	25.0	ND	91	65-125			
Xylenes, Total	71.6	1.5	"	75.0	ND	95	60-130			
Ethanol	307	150	"	250	ND	123	35-160			
tert-Butanol (TBA)	135	10	"	125	ND	108	60-145			
Di-isopropyl Ether (DIPE)	27.7	0.50	"	25.0	ND	111	60-140			
Ethyl tert-Butyl Ether (ETBE)	25.7	0.50	"	25.0	ND	103	55-135			
Methyl-tert-butyl Ether (MTBE)	189	0.50	"	25.0	180	36	50-150			
tert-Amyl Methyl Ether (TAME)	27.8	0.50	"	25.0	2.8	100	55-140			LN,AY
<i>Surrogate: Dibromofluoromethane</i>	<i>30.1</i>		<i>"</i>	<i>25.0</i>		<i>120</i>	<i>80-120</i>			
<i>Surrogate: Toluene-d8</i>	<i>28.6</i>		<i>"</i>	<i>25.0</i>		<i>114</i>	<i>80-120</i>			
<i>Surrogate: 4-Bromofluorobenzene</i>	<i>28.6</i>		<i>"</i>	<i>25.0</i>		<i>114</i>	<i>80-120</i>			

Matrix Spike Dup (5I16014-MSD1)	Source: MOI0258-01			Prepared & Analyzed: 09/16/05						
1,2-Dibromoethane (EDB)	29.6	0.50	ug/l	25.0	ND	118	65-130	16	25	
1,2-Dichloroethane	32.8	0.50	"	25.0	ND	131	60-140	17	20	
Benzene	29.3	0.50	"	25.0	ND	117	60-125	22	20	RA
Ethylbenzene	28.8	0.50	"	25.0	ND	115	65-130	19	20	
Toluene	27.8	0.50	"	25.0	ND	111	65-125	20	20	
Xylenes, Total	86.2	1.5	"	75.0	ND	115	60-130	19	20	
Ethanol	352	150	"	250	ND	141	35-160	14	30	
tert-Butanol (TBA)	150	10	"	125	ND	120	60-145	11	25	
Di-isopropyl Ether (DIPE)	32.6	0.50	"	25.0	ND	130	60-140	16	25	
Ethyl tert-Butyl Ether (ETBE)	30.4	0.50	"	25.0	ND	122	55-135	17	25	
Methyl-tert-butyl Ether (MTBE)	205	0.50	"	25.0	180	100	50-150	8	25	
tert-Amyl Methyl Ether (TAME)	32.3	0.50	"	25.0	2.8	118	55-140	15	30	
<i>Surrogate: Dibromofluoromethane</i>	<i>28.8</i>		<i>"</i>	<i>25.0</i>		<i>115</i>	<i>80-120</i>			
<i>Surrogate: Toluene-d8</i>	<i>28.3</i>		<i>"</i>	<i>25.0</i>		<i>113</i>	<i>80-120</i>			
<i>Surrogate: 4-Bromofluorobenzene</i>	<i>29.4</i>		<i>"</i>	<i>25.0</i>		<i>118</i>	<i>80-120</i>			

URS Corporation [Arco]
1333 Broadway, Suite 800
Oakland CA, 94612

Project:BP Heritage #11109, Oakland, CA
Project Number:G07TD-0021
Project Manager:Lynelle Onishi

MOI0258
Reported:
09/21/05 19:05

Notes and Definitions

RA RPD exceeds limit due to matrix interf.; % recovs. within limits
PV Hydrocarbon result partly due to individ. peak(s) in quant. range
LN,AY MS and/or MSD below acceptance limits. See Blank Spike(LCS). Matrix interference suspected.
DET Analyte DETECTED
ND Analyte NOT DETECTED at or above the reporting limit or MDL, if MDL is specified
NR Not Reported
dry Sample results reported on a dry weight basis
RPD Relative Percent Difference



Chain of Custody Record

Project Name: Analytical for QMR sampling
BP BU/AR Region/Enfos Segment: BP > Americas > West Coast > Retail > WCBU > CA > Central > 11109 > Historical/BI
State or Lead Regulatory Agency: California Regional Water Quality Control Board - San Francisco
Requested Due Date (mm/dd/yy): 10 Day TAT

On-site Time:	1030	Temp:	70
Off-site Time:	1200	Temp:	80
Sky Conditions:	clear		
Meteorological Events:			
Wind Speed:		Direction:	

Lab Name: Sequoia	BP/AR Facility No.: 11109	Consultant/Contractor: URS
Address: 885 Jarvis Drive Morgan Hill, CA 95037	BP/AR Facility Address: 4280 Foothill Blvd., Oakland, CA 94601	Address: 1333 Broadway, Suite 800 Oakland, CA 94612
Lab PM: Lisa Race / Jamshid Kekobad	California Global ID No.: T0600100217	Consultant/Contractor Project No.: 38487123
Tele/Fax: 408.782.8156 / 408.782.6308	Enfos Project No.: G07TD-0021	Consultant/Contractor PM: Lynelle Onishi
BP/AR PM Contact: Kyle Christie	Provision or RCOP: Provision	Tele/Fax: 510.874.1758 / 510.874.3268
Address: 4 Centerpointe Dr. La Palma, CA 90623	Phase/WBS: 04 - Mon/Remed by Natural Attenuation	Report Type & QC Level: Level 1 with EDF
Tele/Fax: (714) 670-5303 / (714) 670-5195	Sub Phase/Task: 03 - Analytical	E-mail EDD To: Donna_Cosper@urscorp.com
	Cost Element: 05 - Subcontracted Costs	Invoice to: Atlantic Richfield Company

Item No.	Sample Description	Time	Date	Matrix			Laboratory No.	No. of Containers	Preservative					Requested Analysis						Sample Point Lat/Long and Comments											
				Soil/Solid	Water/Liquid	Air			Unpreserved	H ₂ O ₄	HNO ₃	HCl	Methanol	GRO/BTEX (8260)	MTBE, TAME, ETBE	DIPE, TBA (8260)	EDB, 1,2-DCA (8260)	Ethanol (8260)													
1	MW-4	1145	9/6		X		01	3							X	X	X	X													
2	MW-7	1155	9/6		X		02	3							X	X	X	X													
3	TB-1109-09062005	1030	9/6		X		03	2																							
4																															
5																															
6																															
7																															
8																															
9																															
10																															

MW0258

Sampler's Name:	Relinquished By / Affiliation	Date	Time	Accepted By / Affiliation	Date	Time
Brian Alcorn	[Signature]	9/6	1147	[Signature]	9/6	1454
Blaine Tech Services	[Signature]	9/10	1014	[Signature]	9/16	1214
Shipment Date:	[Signature]	9/10	715	[Signature]	9/16	1615

Special Instructions:

Custody Seals In Place Yes No Temp Blank Yes No Cooler Temperature on Receipt 5.6 °F/C Trip Blank Yes No

SEQUOIA ANALYTICAL SAMPLE RECEIPT LOG

CLIENT NAME: <u>BP 11109</u>	DATE REC'D AT LAB: <u>9-7-05</u>	For Regulatory Purposes?
REC. BY (PRINT) <u>E. Fallin</u>	TIME REC'D AT LAB: <u>1615</u>	DRINKING WATER YES / NO
WORKORDER: <u>MD16258</u>	DATE LOGGED IN: <u>9-10-05</u>	WASTE WATER YES / NO

CIRCLE THE APPROPRIATE RESPONSE	LAB SAMPLE #	DASH #	CLIENT ID	CONTAINER DESCRIPTION	PRESERVATIVE	pH	SAMPLE MATRIX	DATE SAMPLED	REMARKS: CONDITION (ETC.)
1. Custody Seal(s) Present / Absent (X) Intact / Broken*	01	A.C	MW-4	wa (3)	HCl	-	L	9-6-05	
2. Chain-of-Custody Present / Absent*	03	A.B	TB 11109 09062005	wa (2)	↓	↓	↓	↓	
3. Traffic Reports or Packing List: Present / Absent									
4. Airbill: Airbill / Sticker Present / Absent									
5. Airbill #:									
6. Sample Labels: Present / Absent									
7. Sample IDs: Listed / Not Listed on Chain-of-Custody									
8. Sample Condition: Intact / Broken* / Leaking*									
9. Does information on chain-of-custody, traffic reports and sample labels agree? Yes / No*									
10. Sample received within hold time? Yes / No*									
11. Adequate sample volume received? Yes / No*									
12. Proper preservatives used? Yes / No*									
13. Trip Blank / Temp Blank Received? (circle which, if yes) Yes / No*									
14. Read Temp: <u>5.8°C</u> Corrected Temp: <u>5.8°C</u> Is corrected temp 4 +/-2°C? Yes / No**									
(Acceptance range for samples requiring thermal pres.) **Exception (if any): METALS / DFF ON ICE or Problem COC									

*IF CIRCLED, CONTACT PROJECT MANAGER AND ATTACH RECORD OF RESOLUTION.

ATTACHMENT C

**ERROR CHECK REPORTS AND EDF/GEOWELL SUBMITTAL
CONFIRMATIONS**

Electronic Submittal Information

[Main Menu](#) | [View/Add Facilities](#) | [Upload EDD](#) | [Check EDD](#)

SUCCESSFUL GEO_WELL CHECK - NO ERRORS

<u>ORGANIZATION NAME:</u>	URS Corporation-Oakland Office
<u>USER NAME:</u>	URSCORP-OAKLAND
<u>DATE CHECKED:</u>	10/12/2005 3:25:22 PM

Processing is complete. No errors were found!
You may now proceed to the [upload page](#).

[Back to Main Menu](#)

Logged in as URSCORP-OAKLAND
(CONTRACTOR)

[CONTACT SITE ADMINISTRATOR](#)

Electronic Submittal Information

[Main Menu](#) | [View/Add Facilities](#) | [Upload EDD](#) | [Check EDD](#)

UPLOADING A GEO_WELL FILE

Processing is complete. No errors were found!

Your file has been successfully submitted!

Submittal Title: 3Q05 QMR GeoWell BP/ARCO 11109

Submittal Date/Time: 10/12/2005 3:25:53 PM

Confirmation Number: 9377277970

[Back to Main Menu](#)

Logged in as URSCORP-OAKLAND
(CONTRACTOR)

[CONTACT SITE ADMINISTRATOR.](#)

Electronic Submittal Information

[Main Menu](#) |
 [View/Add Facilities](#) |
 [Upload EDD](#) |
 [Check EDD](#)

SUCCESSFUL EDF CHECK - NO ERRORS

<u>ORGANIZATION NAME:</u>	URS Corporation- Oakland Office
<u>USER NAME:</u>	URSCORP-OAKLAND
<u>DATE CHECKED:</u>	10/12/2005 3:22:20 PM
<u>GLOBAL ID:</u>	T0600100217
<u>FILE UPLOADED:</u>	BP#11109-EDF- MOI0258.zip

No errors were found in your EDF upload file.

If you want to submit this file to the SWRCB, choose the "Upload EDD" option in the above menu and follow the instructions.

When you complete the submittal process, you will be given a confirmation number for your submittal.

Click [here](#) to view the detections report for this upload.

BP 4280 FOOTHILL BLVD OAKLAND, CA 94601	<u>Regional Board - Case #: 01-0231</u> SAN FRANCISCO BAY RWQCB (REGION 2) - (BG) <u>Local Agency (lead agency) - Case #: 102</u> ALAMEDA COUNTY LOP - (RWS)
---	---

SAMPLE DETECTIONS REPORT

# FIELD POINTS SAMPLED	2
# FIELD POINTS WITH DETECTIONS	2
# FIELD POINTS WITH WATER SAMPLE DETECTIONS ABOVE MCL	2
SAMPLE MATRIX TYPES	WATER

METHOD QA/QC REPORT

* METHODS USED	SW8015B,SW8260B
* TESTED FOR REQUIRED ANALYTES?	Y
* LAB NOTE DATA QUALIFIERS	Y

QA/QC FOR 8021/8260 SERIES SAMPLES

TECHNICAL HOLDING TIME VIOLATIONS	0
METHOD HOLDING TIME VIOLATIONS	0
LAB BLANK DETECTIONS ABOVE REPORTING DETECTION LIMIT	0
LAB BLANK DETECTIONS	0
DO ALL BATCHES WITH THE 8021/8260 SERIES INCLUDE THE FOLLOWING?	
- LAB METHOD BLANK	Y
- MATRIX SPIKE	Y
- MATRIX SPIKE DUPLICATE	Y
- BLANK SPIKE	Y
- SURROGATE SPIKE	Y

WATER SAMPLES FOR 8021/8260 SERIES

MATRIX SPIKE / MATRIX SPIKE DUPLICATE(S) % RECOVERY BETWEEN 65-135%	N
MATRIX SPIKE / MATRIX SPIKE DUPLICATE(S) RPD LESS THAN 30%	Y
SURROGATE SPIKES % RECOVERY BETWEEN 85-115%	N
BLANK SPIKE / BLANK SPIKE DUPLICATES % RECOVERY BETWEEN 70-130%	Y

SOIL SAMPLES FOR 8021/8260 SERIES

MATRIX SPIKE / MATRIX SPIKE DUPLICATE(S) % RECOVERY BETWEEN 65-135%	n/a
MATRIX SPIKE / MATRIX SPIKE DUPLICATE(S) RPD LESS THAN 30%	n/a
SURROGATE SPIKES % RECOVERY BETWEEN 70-125%	n/a
BLANK SPIKE / BLANK SPIKE DUPLICATES % RECOVERY BETWEEN 70-130%	n/a

FIELD QC SAMPLES

<u>SAMPLE</u>	<u>COLLECTED</u>	<u>DETECTIONS > REPD</u>
QCTB SAMPLES	N	0
QCEB SAMPLES	N	0
QCAB SAMPLES	N	0

Logged in as URSCORP-OAKLAND
(CONTRACTOR)

CONTACT SITE ADMINISTRATOR.

Electronic Submittal Information

[Main Menu](#) | [View/Add Facilities](#) | [Upload EDD](#) | [Check EDD](#)

Your EDF file has been successfully uploaded!

Confirmation Number: 7391087710
Date/Time of Submittal: 10/12/2005 3:23:32 PM
Facility Global ID: T0600100217
Facility Name: BP
Submittal Title: 3Q05 QMR EDF BP/ARCO 11109
Submittal Type: GW Monitoring Report

[Click here to view the detections report for this upload.](#)

BP 4280 FOOTHILL BLVD OAKLAND, CA 94601	Regional Board - Case #: 01-0231 SAN FRANCISCO BAY RWQCB (REGION 2) - (BG) Local Agency (lead agency) - Case #: 102 ALAMEDA COUNTY LOP - (RWS)
--	---

CONF #	TITLE	QUARTER
7391087710	3Q05 QMR EDF BP/ARCO 11109	Q3 2005
SUBMITTED BY	SUBMIT DATE	STATUS
Srijesh Thapa	10/12/2005	PENDING REVIEW

SAMPLE DETECTIONS REPORT

# FIELD POINTS SAMPLED	2
# FIELD POINTS WITH DETECTIONS	2
# FIELD POINTS WITH WATER SAMPLE DETECTIONS ABOVE MCL	2
SAMPLE MATRIX TYPES	WATER

METHOD QA/QC REPORT

METHODS USED	SW8015B,SW8260B
TESTED FOR REQUIRED ANALYTES?	Y
LAB NOTE DATA QUALIFIERS	Y

QA/QC FOR 8021/8260 SERIES SAMPLES

TECHNICAL HOLDING TIME VIOLATIONS	0
METHOD HOLDING TIME VIOLATIONS	0
LAB BLANK DETECTIONS ABOVE REPORTING DETECTION LIMIT	0
LAB BLANK DETECTIONS	0
DO ALL BATCHES WITH THE 8021/8260 SERIES INCLUDE THE FOLLOWING?	
- LAB METHOD BLANK	Y
- MATRIX SPIKE	Y
- MATRIX SPIKE DUPLICATE	Y

- BLANK SPIKE Y
- SURROGATE SPIKE Y

WATER SAMPLES FOR 8021/8260 SERIES

- MATRIX SPIKE / MATRIX SPIKE DUPLICATE(S) % RECOVERY BETWEEN 65-135% N
- MATRIX SPIKE / MATRIX SPIKE DUPLICATE(S) RPD LESS THAN 30% Y
- SURROGATE SPIKES % RECOVERY BETWEEN 85-115% N
- BLANK SPIKE / BLANK SPIKE DUPLICATES % RECOVERY BETWEEN 70-130% Y

SOIL SAMPLES FOR 8021/8260 SERIES

- MATRIX SPIKE / MATRIX SPIKE DUPLICATE(S) % RECOVERY BETWEEN 65-135% n/a
- MATRIX SPIKE / MATRIX SPIKE DUPLICATE(S) RPD LESS THAN 30% n/a
- SURROGATE SPIKES % RECOVERY BETWEEN 70-125% n/a
- BLANK SPIKE / BLANK SPIKE DUPLICATES % RECOVERY BETWEEN 70-130% n/a

FIELD QC SAMPLES

<u>SAMPLE</u>	<u>COLLECTED</u>	<u>DETECTIONS > REPD</u>
QCTB SAMPLES	N	0
QCEB SAMPLES	N	0
QCAB SAMPLES	N	0

Logged in as URSCORP-OAKLAND (CONTRACTOR)

CONTACT SITE ADMINISTRATOR.

ATTACHMENT D

JOINT MONITORING DATA

Table 1
Groundwater Monitoring Data and Analytical Results
Chevron Service Station #9-0076
4265 Foothill Boulevard
Oakland, California

WELL ID/ DATE	TOC* (ft.)	GWE (msl)	DTW (ft.)	SPHT (ft.)	SPH REMOVED (gallons)	TPH-G (ppb)	B (ppb)	T (ppb)	E (ppb)	X (ppb)	MTBE (ppb)	ETHANOL (ppb)
C-1												
04/28/89	35.42	15.37	20.05	--	--	940	30	1.3	11	13	--	--
08/08/89	35.42	11.35	24.07	--	--	820	45	2.0	13	13	--	--
12/21/89	35.42	12.61	22.81	--	--	--	--	--	--	--	--	--
08/27/90	35.42	13.30	22.12	--	--	440	15	1.0	6.0	13	--	--
11/04/90	35.42	9.86	25.56	--	--	--	--	--	--	--	--	--
06/18/91	35.42	13.78	21.64	--	--	74	5.6	0.6	1.9	1.3	--	--
09/19/91	35.42	10.84	24.58	--	--	150	7.1	<0.5	2.3	3.0	--	--
12/20/91	35.42	9.25	26.17	--	--	250	10	<0.5	3.7	1.6	--	--
03/18/92	35.42	17.17	18.25	--	--	190	16	<0.5	8.5	3	--	--
07/14/92	35.42	7.81	27.61	--	--	20,000	480	2,200	510	2,900	--	--
10/08/92	35.42	10.98	24.44	--	--	360	34	4.6	19	12	--	--
01/08/93	35.42	15.74	19.68	--	--	120	9.1	0.5	5.1	1.8	--	--
04/14/93	35.42	19.04	16.38	--	--	190	74	0.6	1.0	2.0	--	--
07/16/93	35.42	--	--	--	--	--	--	--	--	--	--	--
07/27/93	35.42	26.03	9.39	--	--	300	12	<0.5	5.0	2.0	--	--
09/21/93	38.41	16.99	21.42	--	--	360	12	1.2	5.8	3.7	--	--
01/28/94	38.41	18.84	19.57	--	--	370	24	1.0	13	4.0	--	--
03/17/94	38.41	21.56	16.85	--	--	460	42	<0.5	6.7	3.7	--	--
06/16/94	38.41	20.58	17.83	--	--	320	20	0.7	8.7	3.0	--	--
09/22/94	38.41	18.15	20.26	--	--	380	24	0.6	8.8	1.9	--	--
12/15/94	38.41	22.59	15.82	--	--	280	23	7.6	7.8	13	--	--
03/30/95	38.41	26.39	12.02	--	--	2,200	890	8.9	15	<5.0	--	--
06/20/95	38.41	24.01	14.40	--	--	690	140	<2.0	9.4	2.8	--	--
09/20/95	38.41	24.59	13.82	--	--	730	27	78	26	130	--	--
12/06/95	38.41	17.81	20.60	--	--	220	16	<0.5	7.2	1.7	11	--
03/21/96	38.41	26.76	11.65	--	--	640	170	<2.0	6.7	<2.0	35	--
06/21/96	38.41	24.16	14.25	--	--	640	140	<1.2	8.7	2.0	23	--
09/06/96	38.41	21.66	16.75	--	--	460	24	0.56	10	2.4	43	--
12/19/96	38.41	24.43	13.98	--	--	790	120	22	13	19	<25	--
03/17/97	38.41	25.63	12.78	--	--	2,200	660	<10	15	<10	110	--
06/11/97	38.41	23.25	15.16	--	--	1,500	130	<2.0	16	3.4	130	--
09/17/97	38.41	21.47	16.94	--	--	910	160	23	13	49	180	--
12/11/97	38.41	25.23	13.18	--	--	2,000	270	7.0	53	7.4	460	--
03/12/98	38.41	28.92	9.49	--	--	3,100	1,300	<20	42	<20	760	--
06/23/98	38.41	28.19	10.22	--	--	1,300	650	6.9	22	6.5	290	--

Table 1
Groundwater Monitoring Data and Analytical Results
 Chevron Service Station #9-0076
 4265 Foothill Boulevard
 Oakland, California

WELL ID/ DATE	TOC* (ft.)	GWE (msl)	DTW (ft.)	SPHT (ft.)	SPH		TPH-G (ppb)	B (ppb)	T (ppb)	E (ppb)	X (ppb)	MTBE (ppb)	ETHANOL (ppb)
					REMOVED (gallons)								
C-1 (cont)													
09/01/98	38.41	21.43	16.98	--	--		270	6.0	<2.5	<2.5	<2.5	950	--
12/30/98	38.41	22.29	16.12	--	--		2,020	578	<5.0	<5.0	<5.0	1,720	--
03/31/99	38.41	24.53	13.88	--	--		2,140	776	5.89	<5.0	5.15	1,170	--
06/14/99	38.41	23.09	15.32	--	--		1,450	524	<5.0	<5.0	<5.0	1,150	--
06/14/99 ¹	38.41	23.09	15.32	--	--		--	--	--	--	--	1,360 ²	--
09/30/99	38.41	22.30	16.11	--	--		79	1.12	<0.5	1.07	<0.5	677	--
12/22/99	38.41	23.37	15.04	--	--		501	157	4.45	<2.5	4.81	744	--
03/09/00	38.41	31.28	7.13	--	--		3,300	2,500	28	37	<2.5	1,700	--
06/23/00 ³	38.41	25.86	12.55	0.00	0.00		2,200 ⁴	1,000	6.9	5.7	9.3	1,900	--
09/05/00 ³	38.41	21.28	17.13	0.00	0.00		<200	8.3	<2.0	<2.0	<2.0	1,000	--
12/04/00	38.41	21.48	16.93	0.00	0.00		1,400 ⁴	600	<5.0	<5.0	<5.0	1,500	--
03/08/01 ³	38.41	30.45	7.96	0.00	0.00		2,570	1,040	7.93	12.0	<5.00	1,470	--
06/07/01 ³	38.41	25.45	12.96	0.00	0.00		750 ⁴	220	5.6	4.8	2.6	2,500 ⁵	--
09/13/01 ³	38.41	19.91	18.50	0.00	0.00		670 ⁶	<5.0	<5.0	<5.0	<5.0	660	--
12/13/01 ³	38.41	23.02	15.39	0.00	0.00		1,100	340	2.1	0.95	7.9	630	--
03/08/02 ³	38.41	28.35	10.06	0.00	0.00		3,600	1,400	9.5	17	6.5	1,900	--
06/19/02 ³	38.41	24.92	13.49	0.00	0.00		1,300	220	3.4	2.7	<3.0	1,400	--
09/11/02 ³	38.41	21.18	17.23	0.00	0.00		400	22	<0.50	<0.50	<1.5	780	--
12/11/02 ³	38.41	19.81	18.60	0.00	0.00		180	4.2	<0.50	1.1	<1.5	350	--
03/11/03 ³	38.41	25.81	12.60	0.00	0.00		3,500	1,100	9.1	12	8.0	1,600	--
06/10/03 ^{3,7}	38.41	25.73	12.68	0.00	0.00		1,600	350	2	3	3	1,300	--
09/09/03 ^{3,7}	38.41	21.66	16.75	0.00	0.00		290	4	<1	1	1	710	<100
12/09/03 ^{7,9}	38.41	20.73	17.68	0.00	0.00		<50	<0.5	<0.5	<0.5	<0.5	200	<50
03/09/04 ⁷	38.41	30.61	7.80	0.00	0.00		7,100	2,000	15	23	10	1,100	<50
06/08/04 ⁷	38.41	27.29	11.12	0.00	0.00		2,300	840	6	5	4	1,100	<50
09/08/04 ⁷	38.41	24.11	14.30	0.00	0.00		150	110	2	0.5	1	730	<50
12/06/04 ⁷	38.41	25.15	13.26	0.00	0.00		2,100	480	4	2	2	530	<50
03/07/05 ⁷	38.41	31.93	6.48	0.00	0.00		4,100	1,200	9	10	5	1,100	<100
06/06/05 ⁷	38.41	29.56	8.85	0.00	0.00		3,400	990	8	9	5	1,100	<100
09/06/05 ⁷	38.41	26.99	11.42	0.00	0.00		1,100	83	2	0.9	1	810	<50
C-2													
04/28/89	35.18	8.74	26.44	--	--		120,000	30,000	22,000	3,000	17,000	--	--
08/08/89	35.18	5.29	29.90	0.01	--		--	--	--	--	--	--	--

Table 1
Groundwater Monitoring Data and Analytical Results
Chevron Service Station #9-0076
4265 Foothill Boulevard
Oakland, California

WELL ID/ DATE	TOC* (ft.)	GWE (msl)	DTW (ft.)	SPHT (ft.)	SPH		B (ppb)	T (ppb)	E (ppb)	X (ppb)	MTBE (ppb)	ETHANOL (ppb)
					REMOVED (gallons)	TPH-G (ppb)						
C-2 (cont)												
12/21/89	35.18	5.86	29.32	--	--	--	--	--	--	--	--	--
08/27/90	35.18	5.77	29.55	0.17	--	--	--	--	--	--	--	--
11/04/90	35.18	4.71	30.47	--	--	--	--	--	--	--	--	--
06/18/91	35.18	6.90	28.33	0.06	--	--	--	--	--	--	--	--
09/19/91	35.18	5.84	29.39	0.06	--	--	--	--	--	--	--	--
12/20/91	35.18	5.95	29.23	--	--	170,000	20,000	10,000	2,800	19,000	--	--
03/18/92	35.18	21.58	13.60	0.09	--	--	--	--	--	--	--	--
07/14/92	35.18	--	--	--	--	--	--	--	--	--	--	--
10/08/92	35.18	--	--	--	--	--	--	--	--	--	--	--
01/08/93	35.18	10.98	24.20	Sheen	--	79,000	14,000	7,200	3,500	16,000	--	--
04/14/93	35.18	--	--	--	--	--	--	--	--	--	--	--
07/16/93	35.18	5.03	30.15	--	--	2200	440	73	24	350	--	--
09/21/93	37.47	11.18	26.29	--	--	11,000	2,300	300	270	910	--	--
01/28/94	37.47	13.51	23.96	--	--	49,000	11,000	3,900	1,600	12,000	--	--
03/17/94	37.47	11.48	25.99	--	--	16,000	3,300	1,000	220	3,500	--	--
06/16/94	37.47	13.55	23.92	--	--	20,000	4,800	1,500	520	4,300	--	--
09/22/94	37.47	11.85	25.62	--	--	35,000	5,600	850	1,700	7,300	--	--
12/15/94	37.47	16.31	21.16	--	--	96,000	9,000	3,500	3,300	13,000	--	--
03/30/95	37.47	20.29	17.18	--	--	100,000	9,400	3,700	3,900	14,000	--	--
06/20/95	37.47	18.52	18.95	--	--	93,000	6,400	1,900	2,900	11,000	--	--
09/20/95	37.47	19.27	18.20	--	--	58,000	6,600	330	1,600	5,500	--	--
12/06/95	37.47	12.71	24.76	--	--	40,000	5,000	86	1,800	3,700	<500	--
03/21/96	37.47	21.30	16.17	0.00	0.13	--	--	--	--	--	--	--
06/21/96	37.47	19.34	18.15	0.02	0.03	--	--	--	--	--	--	--
09/06/96	37.47	16.36	21.14	0.04	0.08	--	--	--	--	--	--	--
12/19/96	37.47	19.94	17.55	0.03	0.05	--	--	--	--	--	--	--
03/17/97	37.47	18.88	18.59	--	--	58,000	4,800	1,200	1,800	6,300	3,400	--
06/11/97	37.47	16.17	21.30	--	--	40,000	5,500	720	1,400	4,100	3,100	--
09/17/97	37.47	14.33	23.14	--	--	30,000	4,800	220	1,200	1,800	3,200	--
12/11/97	37.47	20.26	17.21	--	--	76,000	6,100	1,300	2,200	8,000	3,800	--
03/12/98	37.47	23.30	14.17	--	--	45,000	6,000	1,400	1,800	5,900	2,700	--
06/23/98 ³	37.47	22.65	14.82	--	--	1,100,000	6,800	5,100	13,000	38,000	<1,000	--
09/01/98	37.47	15.69	21.78	--	--	9,700	300	8.2	6.2	250	3,700	--
12/30/98	37.47	15.61	21.86	--	--	110,000	4,790	1,300	841	5,570	2,420	--
03/31/99	37.47	20.57	16.90	--	--	48,000	4,800	1,110	1,520	5,450	2,160	--

Table 1
Groundwater Monitoring Data and Analytical Results
Chevron Service Station #9-0076
4265 Foothill Boulevard
Oakland, California

WELL ID/ DATE	TOC* (ft.)	GWE (msl)	DTW (ft.)	SPHT (ft.)	SPH REMOVED (gallons)	TPH-G (ppb)	B (ppb)	T (ppb)	E (ppb)	X (ppb)	MTBE (ppb)	ETHANOL (ppb)
C-2 (cont)												
06/14/99	37.47	17.32	20.15	Sheen	--	56,400	5,380	671	1,300	3,960	2,480	--
06/14/99 ¹	37.47	17.32	20.15	--	--	--	--	--	--	--	2,630 ²	--
09/30/99	37.47	14.50	22.97	--	--	22,100	623	<100	529	1,250	2,430	--
12/22/99	37.47	16.47	21.00	--	--	10,200	1,750	102	222	963	1,980	--
03/09/00	37.47	25.27	12.20	--	--	26,000	4,800	930	1,200	4,400	1,800	--
06/23/00 ³	37.47	18.53	18.94	0.00	0.00	29,000 ⁴	3,400	360	440	2,500	2,800	--
09/05/00 ³	37.47	17.01	20.46	0.00	0.00	35,000 ⁴	3,800	54	980	750	5,200	--
12/04/00	37.47	16.54	20.93	0.00	0.00	16,000 ⁴	2,500	120	360	1,100	2,100	--
03/08/01 ³	37.47	20.53	16.94	0.00	0.00	42,300	3,930	828	2,010	5,180	1,660	--
06/07/01 ³	37.47	18.13	19.34	0.00	0.00	15,000 ⁴	3,400	150	700	1,300	1,900	--
09/13/01 ³	37.47	15.28	22.19	0.00	0.00	9,600	1,200	<50	120	160	2,200	--
12/13/01 ³	37.47	19.87	17.60	0.00	0.00	33,000	3,200	430	1,300	3,700	1,400	--
03/08/02 ³	37.47	23.18	14.29	0.00	0.00	26,000	2,900	390	1,200	2,800	1,100	--
06/19/02 ³	37.47	18.36	19.11	0.00	0.00	19,000	3,000	100	720	1,100	1,400	--
09/11/02 ³	37.47	16.79	20.68	0.00	0.00	10,000	1,400	23	120	78	1,800	--
12/11/02 ³	37.47	15.36	22.11	0.00	0.00	8,700	1,300	24	100	250	1,900	--
03/11/03 ³	37.47	22.86	14.61	0.00	0.00	23,000	2,000	280	1,100	2,100	990	--
06/10/03 ^{3,7}	37.47	20.36	17.11	0.00	0.00	14,000	1,300	91	450	720	480	--
09/09/03 ^{3,7}	37.47	16.33	21.14	0.00	0.00	6,800	1,100	9	83	47	1,300	<200
12/09/03 ⁷	37.47	18.27	19.20	0.00	0.00	22,000	1,100	120	570	1,000	460	<250
03/09/04 ⁷	37.47	25.65	11.82	0.00	0.00	24,000	1,800	420	820	2,100	480	<250
06/08/04 ⁷	37.47	21.05	16.42	0.00	0.00	1,200	180	5	1	10	170	<50
09/08/04 ⁷	37.47	24.32**	13.16	0.01	0.00	16,000	340	13	290	200	170	<250
12/06/04 ⁷	37.47	23.36**	14.12	0.01	0.00	13,000	730	130	340	570	280	<100
03/07/05 ⁷	37.47	26.91**	10.57	0.01	0.00	18,000	2,200	470	770	2,000	420	<250
06/06/05 ⁷	37.47	24.78	12.69	0.00	0.00	9,800	940	79	300	490	200	<100
09/06/05⁷	37.47	22.69	14.78	0.00	0.00	9,300	380	8	89	76	170	<100
C-3												
04/28/89	35.28	7.28	28.00	--	--	<500	1.7	<0.5	<0.5	<0.5	--	--
08/08/89	35.28	5.28	30.00	--	--	<500	1.0	<0.5	<0.5	<0.5	--	--
12/21/89	35.28	4.75	30.53	--	--	--	--	--	--	--	--	--
08/27/90	35.28	5.60	29.68	--	--	<50	<0.3	<0.3	<0.3	<0.6	--	--
11/04/90	35.30	4.94	30.36	--	--	--	--	--	--	--	--	--

Table 1
Groundwater Monitoring Data and Analytical Results
Chevron Service Station #9-0076
4265 Foothill Boulevard
Oakland, California

WELL ID/ DATE	TOC* (ft.)	GWE (msl)	DTW (ft.)	SPHT (ft.)	SPH		B (ppb)	T (ppb)	E (ppb)	X (ppb)	MTBE (ppb)	ETHANOL (ppb)
					REMOVED (gallons)	TPH-G (ppb)						
C-3 (cont)												
06/18/91	35.30	6.84	28.46	--	--	52	1.1	<0.5	<0.5	1.2	--	--
09/19/91	35.30	5.97	29.33	--	--	73	1.2	<0.5	<0.5	<0.5	--	--
12/20/91	35.30	5.53	29.77	--	--	<50	0.7	<0.5	<0.5	<0.5	--	--
03/18/92	35.30	9.55	25.75	--	--	<50	<0.5	<0.5	<0.5	<0.5	--	--
07/14/92	35.30	7.43	27.87	--	--	<50	<0.5	<0.5	<0.5	<0.5	--	--
10/08/92	35.30	6.75	28.55	--	--	<50	<0.5	<0.5	<0.5	0.5	--	--
01/08/93	35.30	9.45	25.85	--	--	<50	<0.5	<0.5	<0.5	<0.5	--	--
04/14/93	35.30	11.34	23.96	--	--	<50	<0.5	<0.5	<0.5	<0.5	--	--
07/16/93	35.30	9.66	25.64	--	--	<50	<0.5	<0.5	<0.5	<0.5	--	--
09/21/93	38.37	12.15	26.22	--	--	<50	0.7	<0.5	<0.5	<0.8	--	--
01/28/94	38.37	12.71	25.66	--	--	<50	2.0	<0.5	<0.5	1.0	--	--
03/17/94	38.37	13.42	24.95	--	--	<50	2.8	<0.5	0.6	1.5	--	--
06/16/94	38.37	14.06	24.31	--	--	<50	1.4	<0.5	<0.5	<0.5	--	--
09/22/94	38.37	13.33	25.04	--	--	<50	0.6	<0.5	<0.5	<0.5	--	--
12/15/94	38.37	16.15	22.22	--	--	<50	2.6	1.7	0.82	4.5	--	--
03/30/95	38.37	19.95	18.42	--	--	<50	<0.5	<0.5	<0.5	<0.5	--	--
06/20/95	38.37	18.58	19.79	--	--	110	2.2	<0.5	<0.5	1.2	--	--
09/20/95	38.37	19.42	18.95	--	--	560	21	80	23	120	--	--
12/06/95	38.37	14.21	24.16	--	--	<50	0.73	<0.5	<0.5	0.67	<2.5	--
03/21/96	38.37	20.52	17.85	--	--	<50	<0.5	<0.5	<0.5	<0.5	<2.5	--
06/21/96	38.37	18.59	19.78	--	--	57	<0.5	<0.5	<0.5	<0.5	<2.5	--
09/06/96	38.37	16.74	21.63	--	--	<50	0.9	<0.5	<0.5	<0.5	<2.5	--
12/19/96	38.37	16.07	22.30	--	--	310	36	33	6.5	28	<2.5	--
03/17/97	38.37	19.42	18.95	--	--	54	1.1	<0.5	<0.5	0.76	<2.5	--
06/11/97	38.37	17.22	21.15	--	--	120	1.1	<0.5	<0.5	<0.5	<2.5	--
09/17/97	38.37	15.96	22.41	--	--	240	19	19	6.6	40	13	--
12/11/97	38.37	16.11	22.26	--	--	<50	1.8	<0.5	<0.5	0.5	<2.5	--
03/12/98	38.37	20.02	18.35	--	--	72	6.3	<0.5	0.64	3.1	2.6	--
06/23/98	38.37	19.33	19.04	--	--	<50	<0.5	<0.5	<0.5	<0.5	<2.5	--
09/01/98	38.37	18.40	19.97	--	--	200	6.8	0.31	0.52	2.0	<2.5	--
12/30/98	38.37	17.06	21.31	--	--	<50	<0.5	<0.5	<0.5	<0.5	<2.0	--
03/31/99	38.37	20.60	17.77	--	--	<50	<0.5	<0.5	<0.5	<0.5	12.6	--
06/14/99	38.37	20.12	18.25	--	--	<50	<0.5	<0.5	<0.5	<0.5	<2.5	--
09/30/99	38.37	17.18	21.19	--	--	79.2	3.04	0.794	<0.5	1.04	6.17	--
12/22/99	38.37	16.05	22.32	--	--	<50	1.53	1.08	<0.5	0.66	12	--

Table 1
Groundwater Monitoring Data and Analytical Results
Chevron Service Station #9-0076
4265 Foothill Boulevard
Oakland, California

WELL ID/ DATE	TOC* (ft.)	GWE (msl)	DTW (ft.)	SPHT (ft.)	SPH REMOVED (gallons)	TPH-G (ppb)	B (ppb)	T (ppb)	E (ppb)	X (ppb)	MTBE (ppb)	ETHANOL (ppb)
C-3 (cont)												
03/09/00	38.37	21.27	17.10	--	--	99	6.9	0.8	0.89	3.8	12	--
06/23/00	38.37	19.22	19.15	0.00	0.00	<50	<0.50	<0.50	<0.50	<0.50	<2.5	--
09/05/00	38.37	17.53	20.84	0.00	0.00	52 ⁴	4.3	<0.50	<0.50	0.93	29	--
12/04/00	38.37	17.17	21.20	0.00	0.00	70 ⁴	4.0	<0.50	<0.50	0.71	25	--
03/08/01	38.37	20.70	17.67	0.00	0.00	<50.0	0.873	<0.500	<0.500	<0.500	3.24	--
06/07/01	38.37	19.47	18.90	0.00	0.00	140 ⁴	16	0.67	1.4	3.8	30	--
09/13/01	38.37	17.36	21.01	0.00	0.00	<50	<0.50	<0.50	<0.50	<0.50	<2.5	--
12/13/01	38.37	18.57	19.80	0.00	0.00	<50	1.2	<0.50	<0.50	<1.5	15	--
03/08/02	38.37	20.59	17.78	0.00	0.00	82	5.4	<0.50	<0.50	<1.5	68	--
06/19/02	38.37	19.97	18.40	0.00	0.00	74	2.1	<0.50	<0.50	<1.5	77	--
09/11/02	38.37	18.20	20.17	0.00	0.00	110	4.7	<0.50	<0.50	<1.5	76	--
12/11/02	38.37	16.62	21.75	0.00	0.00	79	1.5	<0.50	<0.50	<1.5	96	--
03/11/03	38.37	19.30	19.07	0.00	0.00	<50	2.1	<0.50	<0.50	<1.5	18	--
06/10/03 ⁷	38.37	19.29	19.08	0.00	0.00	86	2	<0.5	<0.5	<0.5	93	--
09/09/03 ⁷	38.37	17.67	20.70	0.00	0.00	<50	2	<0.5	<0.5	<0.5	160	<50
12/09/03 ⁷	38.37	17.32	21.05	0.00	0.00	<50	<0.5	<0.5	<0.5	<0.5	0.9	<50
03/09/04 ⁷	38.37	22.12	16.25	0.00	0.00	<50	<0.5	<0.5	<0.5	<0.5	<0.5	<50
06/08/04 ⁷	38.37	19.87	18.50	0.00	0.00	<50	<0.5	<0.5	<0.5	<0.5	<0.5	<50
09/08/04 ⁷	38.37	18.36	20.01	0.00	0.00	<50	<0.5	<0.5	<0.5	<0.5	22	<50
12/06/04 ⁷	38.37	19.07	19.30	0.00	0.00	<50	<0.5	<0.5	<0.5	<0.5	<0.5	<50
03/07/05 ⁷	38.37	20.35	18.02	0.00	0.00	<50	<0.5	<0.5	<0.5	<0.5	<0.5	<50
06/06/05 ⁷	38.37	19.29	19.08	0.00	0.00	<50	<0.5	<0.5	<0.5	<0.5	<0.5	<50
09/06/05 ⁷	38.37	20.22	18.15	0.00	0.00	<50	<0.5	<0.5	<0.5	<0.5	<0.5	<50
C-4												
01/12/89	33.45	3.96	29.49	--	--	--	--	--	--	--	--	--
04/12/89	33.45	6.01	27.44	--	--	--	--	--	--	--	--	--
04/28/89	33.45	3.96	29.49	--	--	20,000	6,300	550	230	1,500	--	--
08/08/89	33.45	3.90	29.55	--	--	8,000	7,500	340	88	1,000	--	--
12/21/89	33.45	3.43	30.02	--	--	--	--	--	--	--	--	--
08/27/90	33.48	4.46	29.02	--	--	26,000	10,000	280	410	1,400	--	--
11/04/90	33.48	3.67	29.81	--	--	--	--	--	--	--	--	--
06/18/91	33.48	6.03	27.45	--	--	34,000	14,000	410	450	1,300	--	--
09/19/91	33.48	4.83	28.65	--	--	16,000	7,400	90	110	460	--	--

Table 1
Groundwater Monitoring Data and Analytical Results
Chevron Service Station #9-0076
4265 Foothill Boulevard
Oakland, California

WELL ID/ DATE	TOC* (ft.)	GWE (msl)	DTW (ft.)	SPHT (ft.)	SPH REMOVED (gallons)	TPH-G (ppb)	B (ppb)	T (ppb)	E (ppb)	X (ppb)	MTBE (ppb)	ETHANOL (ppb)
C-4 (cont)												
12/20/91	33.48	4.64	28.84	--	--	24,000	12,000	120	260	740	--	--
03/18/92	33.48	11.05	24.43	--	--	48,000	6,000	1,300	1,300	2,400	--	--
07/14/92	33.48	6.59	26.89	--	--	40,000	14,000	920	550	2,400	--	--
10/08/92	33.48	5.69	27.79	--	--	29,000	13,000	190	110	1,400	--	--
01/08/93	33.48	9.98	23.50	--	--	25,000	7,000	630	860	1,800	--	--
04/14/93	33.48	12.35	21.13	--	--	27,000	6,300	1,000	900	1,400	--	--
07/16/93	33.48	9.52	23.96	--	--	28,000	7,800	1,100	830	2,100	--	--
09/21/93	36.49	10.98	25.51	--	--	30,000	9,600	130	390	1,300	--	--
01/28/94	36.49	13.18	23.31	--	--	18,000	7,800	440	260	1,200	--	--
03/17/94	36.49	15.14	21.35	--	--	32,000	7,800	820	820	1,800	--	--
06/16/94	36.49	13.99	22.50	--	--	25,000	7,600	710	600	1,800	--	--
09/22/94	36.49	12.56	23.93	--	--	25,000	7,800	140	600	1,100	--	--
12/15/94	36.49	17.47	19.02	--	--	38,000	7,600	460	1,200	2,000	--	--
03/30/95	36.49	21.63	14.86	--	--	41,000	8,700	1,600	1,800	3,000	--	--
06/20/95	36.49	19.59	16.90	--	--	29,000	6,000	890	960	1,800	--	--
09/20/95	36.49	20.29	16.20	--	--	12,000	6,900	510	290	1,300	--	--
12/06/95	36.49	13.37	23.12	--	--	13,000	3,900	42	30	250	<250	--
03/21/96	36.49	22.39	14.10	--	--	39,000	4,800	640	1,000	1,800	<1,000	--
06/21/96	36.49	19.54	16.95	--	--	26,000	4,400	640	960	1,800	2,000	--
09/06/96	36.49	16.36	20.13	--	--	23,000	500	200	230	1,000	3,100	--
12/19/96	36.49	19.57	16.92	--	--	23,000	4,900	320	1,100	2,000	<250	--
03/17/97	36.49	19.09	17.40	--	--	30,000	5,800	700	1,400	2,200	1,700	--
06/11/97	36.49	18.15	18.34	--	--	29,000	4,400	520	790	1,800	2,000	--
09/17/97	36.49	15.03	21.46	--	--	17,000	4,300	140	940	1,100	4,600	--
12/11/97	36.49	19.84	16.65	--	--	12,000	2,500	130	300	1,000	1,400	--
03/12/98	36.49	19.90	16.59	--	--	46,000	11,000	1,500	2,300	5,000	3,400	--
06/23/98 ³	36.49	19.47	17.02	--	--	27,000	1,600	160	180	690	100	--
09/01/98	36.49	15.04	21.45	--	--	520	14	2.3	<0.5	4.8	61	--
12/30/98	36.49	15.07	21.42	--	--	122	14.1	1.86	<1.0	3.61	349	--
03/31/99	36.49	21.29	15.20	--	--	20,300	4,450	443	1,000	2,130	1,320	--
06/14/99	36.49	14.69	21.80	--	--	1,820	183	7.14	36.7	56.5	291	--
06/14/99 ¹	36.49	14.69	21.80	--	--	--	--	--	--	--	280 ²	--
09/30/99	36.49	16.68	19.81	--	--	1,030	11.6	2.14	29.2	68.7	91.5	--
12/22/99	36.49	16.22	20.27	--	--	217	4.45	0.765	2.82	8.21	70.2	--
03/09/00	36.49	23.13	13.36	--	--	8,300	2,600	270	510	1,400	650	--

Table 1
Groundwater Monitoring Data and Analytical Results
Chevron Service Station #9-0076
4265 Foothill Boulevard
Oakland, California

WELL ID/ DATE	TOC* (ft.)	GWE (msl)	DTW (ft.)	SPHT (ft.)	SPH REMOVED (gallons)	TPH-G (ppb)	B (ppb)	T (ppb)	E (ppb)	X (ppb)	MTBE (ppb)	ETHANOL (ppb)
C-4 (cont)												
06/23/00 ³	36.49	17.09	19.40	0.00	0.00	55 ⁴	1.2	<0.50	<0.50	<0.50	250	--
09/05/00 ³	36.49	15.06	21.43	0.00	0.00	110 ⁴	5.4	<0.50	<0.50	1.1	52	--
12/04/00	36.49	14.71	21.78	0.00	0.00	<50	<0.50	0.56	<0.50	1.1	22	--
03/08/01 ³	36.49	19.87	16.62	0.00	0.00	9,080	2,260	229	395	1,060	718	--
06/07/01 ³	36.49	16.89	19.60	0.00	0.00	800 ⁴	75	4.3	22	33	340	--
09/13/01 ³	36.49	14.78	21.71	0.00	0.00	<50	0.68	<0.50	<0.50	<0.50	18	--
12/13/01 ³	36.49	18.54	17.95	0.00	0.00	5,800	1,400	43	21	470	540	--
03/08/02 ³	36.49	19.71	16.78	0.00	0.00	7,000	1,300	67	280	390	610	--
06/19/02 ³	36.49	17.69	18.80	0.00	0.00	3,100	130	6.5	29	55	250	--
09/11/02 ³	36.49	16.19	20.30	0.00	0.00	820	6.2	1.0	2.2	2.5	26	--
12/11/02 ³	36.49	14.52	21.97	0.00	0.00	<50	0.74	<0.50	<0.50	<1.5	9.3	--
03/11/03 ³	36.49	18.10	18.39	0.00	0.00	5,500	490	12	100	210	330	--
06/10/03 ^{3,7}	36.49	17.74	18.75	0.00	0.00	3,300	370	15	120	200	200	--
09/09/03 ^{3,7}	36.49	15.70	20.79	0.00	0.00	690	8	0.8	5	5	30	<50
12/09/03 ^{7,9}	36.49	16.19	20.30	0.00	0.00	<50	<0.5	<0.5	<0.5	<0.5	57	<50
03/09/04 ⁷	36.49	23.03	13.46	0.00	0.00	15,000	1,600	73	520	460	230	<250
06/08/04 ⁷	36.49	19.47	17.02	0.00	0.00	550	120	2	0.7	5	93	<50
09/08/04 ⁷	36.49	18.91	17.58	0.00	0.00	<50	<0.5	<0.5	<0.5	<0.5	37	<50
12/06/04 ⁷	36.49	19.71	16.78	0.00	0.00	7,000	1,600	39	230	260	180	<50
03/07/05 ⁷	36.49	24.33	12.16	0.00	0.00	9,500	2,100	67	330	160	170	<250
06/06/05 ⁷	36.49	22.86	13.63	0.00	0.00	7,700	2,000	39	280	130	130	<250
09/06/05⁷	36.49	20.79	15.70	0.00	0.00	3,600	830	10	79	21	110	<50
C-5												
08/27/90	35.50	5.67	29.83	--	--	<50	<0.3	<0.3	<0.3	<0.6	--	--
11/14/90	35.50	4.94	30.56	--	--	--	--	--	--	--	--	--
06/18/91	35.50	6.98	28.52	--	--	<50	<0.5	<0.5	<0.5	--	--	--
09/19/91	35.50	5.99	29.51	--	--	<50	<0.5	<0.5	<0.5	<0.5	--	--
12/20/91	35.50	5.54	29.96	--	--	<50	<0.5	<0.5	<0.5	<0.5	--	--
03/18/92	35.50	9.58	25.92	--	--	<50	<0.5	<0.5	<0.5	<0.5	--	--
07/14/92	35.50	7.50	28.00	--	--	<50	<0.5	<0.5	<0.5	<0.5	--	--
10/08/92	35.50	6.85	28.65	--	--	<50	<0.5	<0.5	<0.5	<0.5	--	--
01/08/93	35.50	9.48	26.02	--	--	<50	<0.5	<0.5	<0.5	<0.5	--	--
04/14/93	35.50	11.46	24.04	--	--	<50	<0.5	<0.5	<0.5	<0.5	--	--

Table 1
Groundwater Monitoring Data and Analytical Results
Chevron Service Station #9-0076
4265 Foothill Boulevard
Oakland, California

WELL ID/ DATE	TOC* (ft.)	GWE (msl)	DTW (ft.)	SPHT (ft.)	SPH REMOVED (gallons)	TPH-G (ppb)	B (ppb)	T (ppb)	E (ppb)	X (ppb)	MTBE (ppb)	ETHANOL (ppb)
C-5 (cont)												
07/16/93	35.50	10.29	25.21	--	--	<50	<0.5	<0.5	<0.5	<0.5	--	--
09/21/93	38.50	12.14	26.36	--	--	60	10	8.1	1.9	9.4	--	--
01/28/94	38.50	12.60	25.90	--	--	<50	<0.5	<0.5	<0.5	<0.5	--	--
03/17/94	38.50	14.00	24.50	--	--	<50	<0.5	<0.5	<0.5	<0.5	--	--
06/16/94	38.50	14.10	24.40	--	--	<50	<0.5	<0.5	<0.5	<0.5	--	--
09/22/94	38.50	13.34	25.16	--	--	<50	<0.5	<0.5	<0.5	<0.5	--	--
12/15/94	38.50	15.61	22.89	--	--	<50	<0.5	<0.5	<0.5	<0.5	--	--
03/30/95	38.50	19.96	18.54	--	--	<50	<0.5	<0.5	<0.5	<0.5	--	--
06/20/95	38.50	18.37	20.13	--	--	<50	<0.5	<0.5	<0.5	<0.5	--	--
09/20/95	38.50	14.16	24.34	--	--	<50	<0.5	<0.5	<0.5	<0.5	--	--
12/06/95	38.50	14.40	24.10	--	--	<50	<0.5	<0.5	<0.5	<0.5	<2.5	--
03/21/96	38.50	20.10	18.40	--	--	<50	<0.5	<0.5	<0.5	<0.5	<2.5	--
06/21/96	38.50	18.23	20.27	--	--	<50	<0.5	<0.5	<0.5	<0.5	8.7	--
06/06/96	38.50	16.60	21.90	--	--	<50	<0.5	<0.5	<0.5	<0.5	<2.5	--
12/19/96	38.50	17.35	21.15	--	--	<50	<0.5	<0.5	<0.5	<0.5	<2.5	--
03/17/97	38.50	18.66	19.84	--	--	<50	<0.5	<0.5	<0.5	<0.5	<2.5	--
06/11/97	38.50	16.90	21.60	--	--	<50	<0.5	<0.5	<0.5	<0.5	<2.5	--
09/17/97	38.50	10.67	27.83	--	--	SAMPLED ANNUALLY		--	--	--	--	--
12/11/97	38.50	17.50	21.00	--	--	--	--	--	--	--	--	--
03/12/98	38.50	22.08	16.42	--	--	<50	<0.5	<0.5	<0.5	<0.5	<2.5	--
06/23/98	38.50	21.52	16.98	--	--	--	--	--	--	--	--	--
09/01/98	38.50	18.08	20.42	--	--	--	--	--	--	--	--	--
12/30/98	38.50	17.71	20.79	--	--	--	--	--	--	--	--	--
03/31/99	38.50	21.45	17.05	--	--	<50	<0.5	<0.5	<0.5	<0.5	15	--
06/14/99	38.50	21.02	17.48	--	--	--	--	--	--	--	--	--
09/30/99	38.50	19.77	18.73	--	--	--	--	--	--	--	--	--
12/22/99	38.50	16.32	22.18	--	--	--	--	--	--	--	--	--
03/09/00	38.50	21.52	16.98	--	--	<50	<0.5	<0.5	<0.5	0.87	3.5	--
06/23/00	38.50	18.85	19.65	0.00	0.00	SAMPLED ANNUALLY		--	--	--	--	--
09/05/00	38.50	18.03	20.47	0.00	0.00	--	--	--	--	--	--	--
12/04/00	38.50	17.04	21.46	0.00	0.00	--	--	--	--	--	--	--
03/08/01	38.50	20.97	17.53	0.00	0.00	<50.0	<0.500	<0.500	<0.500	<0.500	5.15	--
06/07/01	38.50	19.00	19.50	0.00	0.00	SAMPLED ANNUALLY		--	--	--	--	--
09/13/01	38.50	17.07	21.43	0.00	0.00	SAMPLED ANNUALLY		--	--	--	--	--
12/13/01	38.50	18.66	19.84	0.00	0.00	SAMPLED ANNUALLY		--	--	--	--	--

Table 1
Groundwater Monitoring Data and Analytical Results
Chevron Service Station #9-0076
4265 Foothill Boulevard
Oakland, California

WELL ID/ DATE	TOC* (ft.)	GWE (msl)	DTW (ft.)	SPHT (ft.)	SPH REMOVED (gallons)	TPH-G (ppb)	B (ppb)	T (ppb)	E (ppb)	X (ppb)	MTBE (ppb)	ETHANOL (ppb)
C-5 (cont)												
03/08/02	38.50	20.32	18.18	0.00	0.00	<50	<0.50	<0.50	<0.50	<1.5	3.5	--
06/19/02	38.50	19.62	18.88	0.00	0.00	SAMPLED ANNUALLY	--	--	--	--	--	--
09/11/02	38.50	17.94	20.56	0.00	0.00	SAMPLED ANNUALLY	--	--	--	--	--	--
12/11/02	38.50	16.68	21.82	0.00	0.00	SAMPLED ANNUALLY	--	--	--	--	--	--
03/11/03	38.50	19.54	18.96	0.00	0.00	<50	<0.50	<0.50	<0.50	<1.5	3.2	--
06/10/03	38.50	19.63	18.87	0.00	0.00	SAMPLED ANNUALLY	--	--	--	--	--	--
09/09/03	38.50	17.82	20.68	0.00	0.00	SAMPLED ANNUALLY	--	--	--	--	--	--
12/09/03	38.50	18.25	20.25	0.00	0.00	SAMPLED ANNUALLY	--	--	--	--	--	--
03/09/04 ⁷	38.50	21.82	16.68	0.00	0.00	<50	<0.5	<0.5	<0.5	<0.5	1	<50
06/08/04	38.50	19.16	19.34	0.00	0.00	SAMPLED ANNUALLY	--	--	--	--	--	--
09/08/04	38.50	18.40	20.10	0.00	0.00	SAMPLED ANNUALLY	--	--	--	--	--	--
12/06/04	38.50	18.75	19.75	0.00	0.00	SAMPLED ANNUALLY	--	--	--	--	--	--
03/07/05 ⁷	38.50	20.35	18.15	0.00	0.00	<50	<0.5	<0.5	<0.5	<0.5	<0.5	<50
06/06/05	38.50	19.14	19.36	0.00	0.00	SAMPLED ANNUALLY	--	--	--	--	--	--
09/06/05	38.50	20.24	18.26	0.00	0.00	SAMPLED ANNUALLY	--	--	--	--	--	--
C-6												
08/27/90	32.40	-11.71	44.11	--	--	7,200	2,100	6.0	41	300	--	--
11/14/90	32.40	-11.63	44.03	--	--	--	--	--	--	--	--	--
06/18/91	32.40	-11.09	43.49	--	--	4,400	2,500	18	160	77	--	--
09/19/91	32.40	-1.92	34.32	--	--	3,100	1,600	8.3	73	8.0	--	--
12/20/91	32.40	-8.95	41.35	--	--	4,400	1,300	3.2	74	10	--	--
03/18/92	32.40	-8.29	40.69	--	--	9,800	3,200	34	250	500	--	--
07/14/92	32.40	-6.49	38.89	--	--	6,500	2,200	100	96	240	--	--
10/08/92	32.40	-6.27	38.67	--	--	1,800	1,000	3.1	15	41	--	--
01/08/93	32.40	-5.41	37.81	--	--	5,200	1,600	6.8	63	120	--	--
04/14/93	32.40	-2.30	34.70	--	--	11,000	1,800	13	110	200	--	--
07/16/93	32.40	-1.47	33.87	--	--	4,800	820	10	41	57	--	--
09/21/93	35.40	1.42	33.98	--	--	4,100	1,200	<50	75	130	--	--
01/28/94	35.40	1.54	33.86	--	--	3,100	930	14	40	34	--	--
03/17/94	35.40	3.09	32.31	--	--	5,100	950	18	61	83	--	--
06/16/94	35.40	3.90	31.50	--	--	3,800	970	6.4	52	62	--	--
09/22/94	35.40	4.18	31.22	--	--	4,100	980	7.8	43	48	--	--
12/15/94	35.40	4.00	31.40	--	--	5,000	1,400	<20	73	61	--	--

Table 1
Groundwater Monitoring Data and Analytical Results
Chevron Service Station #9-0076
4265 Foothill Boulevard
Oakland, California

WELL ID/ DATE	TOC* (ft.)	GWE (msl)	DTW (ft.)	SPH		TPH-G (ppb)	B (ppb)	T (ppb)	E (ppb)	X (ppb)	MTBE (ppb)	ETHANOL (ppb)
				SPHT (ft.)	REMOVED (gallons)							
C-6 (cont)												
03/30/95	35.40	9.02	26.38	--	--	5,500	1,700	<13	120	97	--	--
06/20/95	35.40	10.39	25.01	--	--	1,700	470	<10	29	16	--	--
09/20/95	35.40	11.35	24.05	--	--	3,500	770	<5.0	45	17	--	--
12/06/95	35.40	7.28	28.12	--	--	3,100	710	<10	41	20	<50	--
03/21/96	35.40	12.28	23.12	--	--	1,400	330	<2.5	15	8.1	19	--
06/21/96	35.40	11.90	23.50	--	--	2,200	560	<5.0	18	<5.0	77	--
09/06/96	35.40	10.57	24.83	--	--	2,800	720	<10	13	<10	160	--
12/19/96	35.40	10.90	24.50	--	--	830	320	<2.5	<2.5	<2.5	14	--
03/17/97	35.40	12.81	22.59	--	--	2,200	500	<10	25	<10	<50	--
06/11/97	35.40	11.64	23.76	--	--	3,000	570	<5.0	29	10	220	--
09/17/97	35.40	10.66	24.74	--	--	1,400	330	<5.0	<5.0	<5.0	76	--
12/11/97	35.40	10.75	24.65	--	--	1,600	230	<5.0	7.3	6.4	46	--
03/12/98	35.40	8.28	27.12	--	--	980	300	<5.0	15	12	49	--
06/23/98 ³	35.40	7.48	27.92	--	--	220	35	<0.5	2.5	1.1	<2.5	--
09/01/98	35.40	3.80	31.60	--	--	1,800	370	2.8	19	5	44	--
12/30/98	35.40	3.58	31.82	--	--	1,600	244	<1.0	8.53	<1.0	54.9	--
03/31/99	35.40	9.34	26.06	--	--	741	92.2	<1.0	6.60	<1.0	27.9	--
06/14/99	35.40	5.72	29.68	--	--	434	110	<1.0	5.76	1.46	13	--
06/14/99 ¹	35.40	5.72	29.68	--	--	--	--	--	--	--	6.96 ²	--
09/30/99	35.40	12.34	23.06	--	--	481	92.7	<1.0	3.69	<1.0	32.9	--
12/22/99	35.40	12.85	22.55	--	--	1,310	158	2.16	5.5	1.41	113	--
03/09/00	35.40	15.37	20.03	--	--	470	120	0.74	5.0	2.5	36	--
06/23/00 ³	35.40	13.25	22.15	0.00	0.00	1,700 ⁴	210	<5.0	<5.0	5.8	64	--
09/05/00 ³	35.40	8.35	27.05	0.00	0.00	740 ⁴	99	0.60	5.1	2.2	80	--
12/04/00	35.40	10.25	25.15	0.00	0.00	450 ⁴	31	0.71	<0.50	<0.50	54	--
03/08/01 ³	35.40	11.56	23.84	0.00	0.00	1,550	228	3.93	19.9	32.5	46.2	--
06/07/01 ³	35.40	9.67	25.73	0.00	0.00	360 ⁴	21	1.8	2.4	3.8	100	--
09/13/01 ³	35.40	11.60	23.80	0.00	0.00	950	180	<5.0	5.9	<5.0	170	--
12/13/01 ³	35.40	10.21	25.19	0.00	0.00	2,000	170	0.86	6.4	4.1	77	--
03/08/02 ³	35.40	14.32	21.08	0.00	0.00	600	33	0.91	1.8	<1.5	90	--
06/19/02 ³	35.40	10.78	24.62	0.00	0.00	370	11	<0.50	<0.50	<1.5	88	--
09/11/02 ³	35.40	6.40	29.00	0.00	0.00	490	16	0.50	<0.50	<1.5	120	--
12/11/02 ³	35.40	11.22	24.18	0.00	0.00	430	17	<0.50	<0.50	<1.5	100	--
03/11/03 ³	35.40	7.70	27.70	0.00	0.00	410	8.8	0.88	<0.50	<1.5	120	--
06/10/03 ^{3,7}	35.40	13.80	21.60	0.00	0.00	460	10	<0.5	<0.5	<0.5	100	--

Table 1
Groundwater Monitoring Data and Analytical Results
Chevron Service Station #9-0076
4265 Foothill Boulevard
Oakland, California

WELL ID/ DATE	TOC* (ft.)	GWE (msl)	DTW (ft.)	SPHT (ft.)	SPH REMOVED (gallons)	TPH-G (ppb)	B (ppb)	T (ppb)	E (ppb)	X (ppb)	MTBE (ppb)	ETHANOL (ppb)
C-6 (cont)												
09/09/03	35.40	INACCESSIBLE - VEHICLE PARKED OVER WELL										
12/09/03 ^{7,9}	35.40	9.51	25.89	0.00	0.00	1,700	69	<0.5	3	0.6	83	<50
03/09/04 ⁷	35.40	15.89	19.51	0.00	0.00	6,800	280	1	10	4	96	<50
06/08/04 ⁷	35.40	14.57	20.83	0.00	0.00	560	13	<0.5	<0.5	0.5	68	<50
09/08/04 ⁷	35.40	13.52	21.88	0.00	0.00	290	16	<0.5	<0.5	<0.5	50	<50
12/06/04 ⁷	35.40	14.06	21.34	0.00	0.00	290	18	<0.5	0.5	<0.5	44	<50
03/07/05 ⁷	35.40	17.13	18.27	0.00	0.00	2,500	150	0.7	5	2	71	<50
06/06/05 ⁷	35.40	16.88	18.52	0.00	0.00	1,900	110	<1	3	2	59	<100
09/06/05 ⁷	35.40	15.02	20.38	0.00	0.00	800	16	<0.5	0.5	0.6	51	<50
C-7												
08/27/90	32.17	-12.06	44.23	--	--	110	26	0.8	4.0	6.0	--	--
11/14/90	32.17	-11.94	44.11	--	--	--	--	--	--	--	--	--
06/18/91	32.17	-9.88	42.05	--	--	23,000	5,700	420	1,000	2,800	--	--
09/19/91	32.17	-9.55	41.72	--	--	26,000	4,600	330	970	2,400	--	--
12/20/91	32.17	-9.50	41.67	--	--	33,000	5,500	270	1,000	2,100	--	--
03/18/92	32.17	-9.03	41.20	--	--	27,000	5,800	410	1,300	3,300	--	--
07/14/92	32.17	-7.60	39.77	--	--	46,000	12,000	720	1,700	4,600	--	--
10/08/92	32.17	-6.97	39.14	--	--	22,000	6,800	370	1,300	3,200	--	--
01/08/93	32.17	-6.33	38.50	--	--	36,000	7,600	540	1,700	4,200	--	--
04/14/93	32.17	-3.76	35.93	--	--	23,000	3,100	450	670	1,900	--	--
07/16/93	32.17	-3.21	35.38	--	--	19,000	3,200	330	550	1,800	--	--
09/21/93	35.19	-0.27	35.46	--	--	17,000	2,700	160	410	760	--	--
01/28/94	35.19	-0.26	35.45	--	--	14,000	1,800	210	390	1,000	--	--
03/17/94	35.19	1.95	33.24	--	--	17,000	1,600	210	410	1,200	--	--
06/16/94	35.19	2.12	33.07	--	--	12,000	1,600	180	410	1,200	--	--
09/22/94	35.19	2.45	32.74	--	--	10,000	1,700	110	320	580	--	--
12/15/94	35.19	3.27	31.92	--	--	10,000	1,200	120	280	710	--	--
03/30/95	35.19	7.59	27.60	--	--	4,600	460	73	160	460	--	--
06/20/95	35.19	7.32	27.87	--	--	26,000	4,400	450	900	2,400	--	--
09/20/95	35.19	7.11	28.08	--	--	9,400	610	81	250	800	--	--
12/06/95	35.19	4.57	30.62	--	--	1,200	110	12	25	71	34	--
03/21/96	35.19	7.34	27.85	--	--	17,000	1,300	160	410	1,300	<100	--

Table 1
Groundwater Monitoring Data and Analytical Results
Chevron Service Station #9-0076
4265 Foothill Boulevard
Oakland, California

WELL ID/ DATE	TOC* (ft.)	GWE (msl)	DTW (ft.)	SPHT (ft.)	SPH REMOVED (gallons)	TPH-G (ppb)	B (ppb)	T (ppb)	E (ppb)	X (ppb)	MTBE (ppb)	ETHANOL (ppb)
C-7 (cont)												
09/06/96	35.19	6.84	28.35	--	--	15,000	3,400	<50	460	850	<250	--
12/19/96	35.19	6.08	29.11	--	--	530	9	0.5	0.85	3.4	<2.5	--
03/17/97	35.19	8.05	27.14	--	--	4,600	310	46	110	310	98	--
06/11/97	35.19	7.14	28.05	--	--	420	15	<0.5	3.3	5.1	<2.5	--
09/17/97	35.19	6.19	29.00	--	--	1,400	120	11	31	84	54	--
12/11/97	35.19	5.93	29.26	--	--	210	10	<0.5	0.97	1.6	<2.5	--
03/12/98	35.19	10.27	24.92	--	--	68	<0.5	<0.5	<0.5	<0.5	<2.5	--
06/23/98	35.19	9.89	25.30	--	--	<50	<0.5	<0.5	<0.5	<0.5	<2.5	--
09/01/98	35.19	8.92	26.27	--	--	570	24	1.4	8.4	22	24	--
12/30/98	35.19	8.67	26.52	--	--	<50	4.85	1.26	<0.5	1.29	167	--
03/31/99	35.19	10.43	24.76	--	--	53.1	<0.5	<0.5	<0.5	<0.5	<2.0	--
06/14/99	35.19	9.75	25.44	--	--	109	4.43	<0.5	<0.5	<0.5	<2.5	--
06/14/99 ¹	35.19	9.75	25.44	--	--	--	--	--	--	--	<2.0 ²	--
09/30/99	35.19	8.32	26.87	--	--	2,400	282	26.3	120	236	126	--
12/22/99	35.19	7.42	27.77	--	--	3,840	162	18.1	44.7	85.3	141	--
03/09/00	35.19	9.62	25.57	--	--	13,000	2,700	110	700	1,500	<130	--
06/23/00	35.19	9.53	25.66	0.00	0.00	190 ⁴	3.4	<0.50	<0.50	1.6	7.3	--
09/05/00	35.19	8.44	26.75	0.00	0.00	4,200 ⁴	330	26	120	200	190	--
12/04/00	35.19	8.03	27.16	0.00	0.00	2,600 ⁴	550	<5.0	73	62	<25	--
03/08/01	35.19	9.76	25.43	0.00	0.00	1,180	39.2	2.41	15.5	30.8	10.3	--
06/07/01	35.19	9.80	25.39	0.00	0.00	2,600 ⁴	440	14	110	130	56	--
09/13/01	35.19	8.58	26.61	0.00	0.00	23,000 ⁶	670	<100	150	210	<500	--
12/13/01	35.19	8.50	26.69	0.00	0.00	2,400	160	5.8	42	54	<10	--
03/08/02	35.19	10.39	24.80	0.00	0.00	3,900	380	21	110	160	<20	--
06/19/02	35.19	7.78	27.41	0.00	0.00	3,600	440	8.5	87	73	<10	--
09/11/02	35.19	9.41	25.78	0.00	0.00	11,000	1,800	18	360	380	<10	--
12/11/02	35.19	4.44	30.75	0.00	0.00	6,000	1,100	9.3	190	190	<10	--
03/11/03	35.19	8.29	26.90	0.00	0.00	4,900	940	13	150	160	<25	--
06/10/03 ⁷	35.19	4.28	30.91	0.00	0.00	3,100	500	7	83	77	4	--
09/09/03 ⁷	35.19	3.38	31.81	0.00	0.00	3,900	310	9	110	130	5	<50
12/09/03 ⁷	35.19	6.74	28.45	0.00	0.00	170	0.8	<0.5	<0.5	<0.5	5	<50
03/09/04 ⁷	35.19	10.73	24.46	0.00	0.00	80	<0.5	<0.5	<0.5	<0.5	4	<50
06/08/04 ⁷	35.19	8.23	26.96	0.00	0.00	<50	<0.5	<0.5	<0.5	<0.5	6	<50
09/08/04 ⁷	35.19	9.99	25.20	0.00	0.00	<50	<0.5	<0.5	<0.5	<0.5	7	<50
12/06/04 ⁷	35.19	10.28	24.91	0.00	0.00	<50	<0.5	<0.5	<0.5	<0.5	7	<50

Table 1
Groundwater Monitoring Data and Analytical Results
Chevron Service Station #9-0076
4265 Foothill Boulevard
Oakland, California

WELL ID/ DATE	TOC* (fl)	GWE (mst)	DTW (fl)	SPHT (fl)	SPH REMOVED (gallons)	TPH-G (ppb)	B (ppb)	T (ppb)	E (ppb)	X (ppb)	MTBE (ppb)	ETHANOL (ppb)
C-7 (cont)												
03/07/05 ⁷	35.19	11.76	23.43	0.00	0.00	590	9	0.7	4	6	7	<50
06/06/05 ⁷	35.19	13.31	21.88	0.00	0.00	<50	<0.5	<0.5	<0.5	<0.5	6	<50
09/06/05 ⁷	35.19	11.60	23.59	0.00	0.00	<50	<0.5	<0.5	<0.5	<0.5	9	<50
C-8												
11/14/90	30.68	-12.61	43.29	--	--	<50	<0.3	<0.3	<0.3	<0.6	--	--
06/18/91	30.68	-11.94	42.62	--	--	<50	<0.5	<0.5	<0.5	<0.5	--	--
09/19/91	30.68	-11.04	41.72	--	--	<50	<0.5	<0.5	<0.5	<0.5	--	--
12/20/91	30.68	-10.30	40.98	--	--	<50	<0.5	<0.5	<0.5	<0.5	--	--
03/18/92	30.68	-9.34	40.02	--	--	<50	<0.5	<0.5	<0.5	<0.5	--	--
07/14/92	30.68	-8.34	39.02	--	--	<50	<0.5	<0.5	<0.5	<0.5	--	--
10/08/92	30.68	-8.00	38.68	--	--	<50	<0.5	<0.5	<0.5	1.1	--	--
01/08/93	30.68	-7.39	38.07	--	--	<50	<0.5	<0.5	<0.5	<0.5	--	--
04/14/93	30.68	-5.31	35.99	--	--	<50	<0.5	<0.5	<0.5	<0.5	--	--
07/16/93	30.68	-4.64	35.32	--	--	<50	<0.5	<0.5	<0.5	<0.5	--	--
09/21/93	34.68	-0.62	35.30	--	--	<50	<0.5	<0.5	<0.5	<0.8	--	--
01/28/94	34.68	-0.93	35.61	--	--	<50	<0.5	<0.5	<0.5	<0.5	--	--
03/17/94	34.68	0.31	34.37	--	--	<50	<0.5	<0.5	<0.5	<0.5	--	--
06/16/94	34.68	1.32	33.36	--	--	<50	<0.5	<0.5	<0.5	<0.5	--	--
09/22/94	34.68	1.86	32.82	--	--	<50	<0.5	<0.5	<0.5	<0.5	--	--
12/15/94	34.68	2.32	32.36	--	--	<50	<0.5	<0.5	<0.5	<0.5	--	--
03/30/95	34.68	5.44	29.24	--	--	<50	<0.5	<0.5	<0.5	<0.5	--	--
06/20/95	34.68	6.34	28.34	--	--	<50	<0.5	<0.5	<0.5	<0.5	--	--
09/20/95	34.68	5.20	29.48	--	--	<50	<0.5	<0.5	<0.5	<0.5	--	--
12/06/95	34.68	3.76	30.92	--	--	<50	<0.5	<0.5	<0.5	<0.5	<2.5	--
03/21/96	34.68	6.03	28.65	--	--	<50	<0.5	<0.5	<0.5	<0.5	<2.5	--
06/21/96	34.68	6.78	27.90	--	--	<50	<0.5	<0.5	<0.5	<0.5	<2.5	--
09/06/96	34.68	5.98	28.70	--	--	<50	<0.5	<0.5	<0.5	<0.5	<2.5	--
12/19/96	34.68	4.98	29.70	--	--	<50	<0.5	<0.5	<0.5	<0.5	<2.5	--
03/17/97	34.68	6.92	27.76	--	--	<50	<0.5	<0.5	<0.5	<0.5	<2.5	--
06/11/97	34.68	5.87	28.81	--	--	<50	<0.5	<0.5	<0.5	<0.5	<2.5	--
09/17/97	34.68	5.32	29.36	--	--	SAMPLED ANNUALLY		--	--	--	--	--
12/11/97	34.68	4.88	29.80	--	--	--	--	--	--	--	--	--
03/12/98	34.68	8.95	25.73	--	--	<50	<0.5	<0.5	<0.5	<0.5	2.6	--

Table 1
Groundwater Monitoring Data and Analytical Results
Chevron Service Station #9-0076
4265 Foothill Boulevard
Oakland, California

WELL ID/ DATE	TOC* (ft.)	GWE (msl)	DTW (ft.)	SPHT (ft.)	SPH REMOVED (gallons)	TPH-G (ppb)	B (ppb)	T (ppb)	E (ppb)	X (ppb)	MTBE (ppb)	ETHANOL (ppb)
C-8 (cont)												
06/23/98	34.68	8.38	26.30	--	--	--	--	--	--	--	--	--
09/01/98	34.68	8.17	26.51	--	--	--	--	--	--	--	--	--
12/30/98	34.68	7.79	26.89	--	--	--	--	--	--	--	--	--
03/31/99	34.68	8.32	26.36	--	--	<50	<0.5	<0.5	<0.5	<0.5	11.8	--
06/14/99	34.68	8.65	26.03	--	--	--	--	--	--	--	--	--
09/30/99	34.68	7.40	27.28	--	--	--	--	--	--	--	--	--
12/22/99	34.68	6.48	28.20	--	--	--	--	--	--	--	--	--
03/09/00	34.68	8.35	26.33	--	--	<50	<0.5	<0.5	<0.5	1.8	<2.5	--
06/23/00	34.68	8.49	26.19	0.00	0.00	SAMPLED ANNUALLY		--	--	--	--	--
09/05/00	34.68	7.71	26.97	0.00	0.00	--	--	--	--	--	--	--
12/04/00	34.68	7.26	27.42	0.00	0.00	--	--	--	--	--	--	--
03/08/01	34.68	8.58	26.10	0.00	0.00	<50.0	<0.500	<0.500	<0.500	<0.500	<2.50	--
06/07/01	34.68	8.89	25.79	0.00	0.00	SAMPLED ANNUALLY		--	--	--	--	--
09/13/01	34.68	7.87	26.81	0.00	0.00	SAMPLED ANNUALLY		--	--	--	--	--
12/13/01	34.68	7.52	27.16	0.00	0.00	SAMPLED ANNUALLY		--	--	--	--	--
03/08/02	34.68	9.38	25.30	0.00	0.00	<50	<0.50	<0.50	<0.50	<1.5	<2.5	--
06/19/02	34.68	9.75	24.93	0.00	0.00	SAMPLED ANNUALLY		--	--	--	--	--
09/11/02	34.68	8.76	25.92	0.00	0.00	SAMPLED ANNUALLY		--	--	--	--	--
12/11/02	34.68	7.37	27.31	0.00	0.00	SAMPLED ANNUALLY		--	--	--	--	--
03/11/03	34.68	8.89	25.79	0.00	0.00	<50	<0.50	<0.50	<0.50	<1.5	<2.5	--
06/10/03	34.68	9.40	25.28	0.00	0.00	SAMPLED ANNUALLY		--	--	--	--	--
09/09/03	34.68	8.57	26.11	0.00	0.00	SAMPLED ANNUALLY		--	--	--	--	--
12/09/03	34.68	6.17	28.51	0.00	0.00	SAMPLED ANNUALLY		--	--	--	--	--
03/09/04 ⁷	34.68	10.70	23.98	0.00	0.00	<50	<0.5	<0.5	<0.5	<0.5	<0.5	<50
06/08/04	34.68	9.41	25.27	0.00	0.00	SAMPLED ANNUALLY		--	--	--	--	--
09/08/04	34.68	8.85	25.83	0.00	0.00	SAMPLED ANNUALLY		--	--	--	--	--
12/06/04	34.68	9.62	25.06	0.00	0.00	SAMPLED ANNUALLY		--	--	--	--	--
03/07/05 ⁷	34.68	11.33	23.35	0.00	0.00	<50	<0.5	<0.5	<0.5	<0.5	<0.5	<50
06/06/05	34.68	11.84	22.84	0.00	0.00	SAMPLED ANNUALLY		--	--	--	--	--
09/06/05	34.68	9.77	24.91	0.00	0.00	SAMPLED ANNUALLY		--	--	--	--	--
C-9												
08/13/96	--	--	28.27	--	--	ND	ND	ND	ND	ND	ND	--
09/06/96	--	--	28.47	--	--	<50	<0.5	<0.5	<0.5	<0.5	<2.5	--

Table 1
Groundwater Monitoring Data and Analytical Results
Chevron Service Station #9-0076
4265 Foothill Boulevard
Oakland, California

WELL ID/ DATE	TOC* (ft.)	GWE (msl)	DTW (ft.)	SPHT (ft.)	SPH REMOVED (gallons)	TPH-G (ppb)	B (ppb)	T (ppb)	E (ppb)	X (ppb)	MTBE (ppb)	ETHANOL (ppb)
C-9 (cont)												
12/19/96	30.68	1.39	29.29	--	--	<50	<0.5	<0.5	<0.5	<0.5	<2.5	--
03/17/97	30.68	3.11	27.57	--	--	<50	<0.5	<0.5	<0.5	<0.5	<2.5	--
06/11/97	30.68	2.41	28.27	--	--	<50	<0.5	<0.5	<0.5	<0.5	<2.5	--
09/17/97	30.68	2.05	28.63	--	--	SAMPLED ANNUALLY		--	--	--	--	--
12/11/97	30.68	1.25	29.43	--	--	--	--	--	--	--	--	--
03/12/98	30.68	5.06	25.62	--	--	<50	<0.5	<0.5	<0.5	<0.5	<2.5	--
06/23/98	30.68	4.53	26.15	--	--	--	--	--	--	--	--	--
09/01/98	30.68	4.30	26.38	--	--	--	--	--	--	--	--	--
12/30/98	30.68	3.93	26.75	--	--	--	--	--	--	--	--	--
03/31/99	30.68	5.35	25.33	--	--	<50	<0.5	<0.5	<0.5	<0.5	12.5	--
06/14/99	30.68	4.16	26.52	--	--	--	--	--	--	--	--	--
09/30/99	30.68	3.89	26.79	--	--	--	--	--	--	--	--	--
12/22/99	30.68	2.99	27.69	--	--	--	--	--	--	--	--	--
03/09/00	30.68	4.64	26.04	--	--	<50	<0.5	<0.5	<0.5	0.75	<2.5	--
06/23/00	30.68	4.83	25.85	0.00	0.00	--	--	--	--	--	--	--
09/05/00	30.68	3.99	26.69	0.00	0.00	--	--	--	--	--	--	--
12/04/00	30.68	3.61	27.07	0.00	0.00	--	--	--	--	--	--	--
03/08/01	30.68	4.93	25.75	0.00	0.00	<50.0	<0.500	<0.500	<0.500	<0.500	<2.50	--
06/07/01	30.68	5.18	25.50	0.00	0.00	SAMPLED ANNUALLY		--	--	--	--	--
09/13/01	30.68	4.13	26.55	0.00	0.00	SAMPLED ANNUALLY		--	--	--	--	--
12/13/01	30.68	3.91	26.77	0.00	0.00	SAMPLED ANNUALLY		--	--	--	--	--
03/08/02	30.68	5.68	25.00	0.00	0.00	<50	<0.50	<0.50	<0.50	<1.5	<2.5	--
06/19/02	30.68	6.01	24.67	0.00	0.00	SAMPLED ANNUALLY		--	--	--	--	--
09/11/02	30.68	4.98	25.70	0.00	0.00	SAMPLED ANNUALLY		--	--	--	--	--
12/11/02	30.68	3.61	27.07	0.00	0.00	SAMPLED ANNUALLY		--	--	--	--	--
03/11/03	30.68	6.20	24.48	0.00	0.00	<50	<0.50	<0.50	<0.50	<1.5	<2.5	--
06/10/03	30.68	5.68	25.00	0.00	0.00	SAMPLED ANNUALLY		--	--	--	--	--
09/09/03	30.68	4.88	25.80	0.00	0.00	SAMPLED ANNUALLY		--	--	--	--	--
12/09/03	30.68	2.46	28.22	0.00	0.00	SAMPLED ANNUALLY		--	--	--	--	--
03/09/04 ⁷	30.68	6.82	23.86	0.00	0.00	<50	<0.5	<0.5	<0.5	<0.5	<0.5	<50
06/08/04	-- ¹⁰	-- ¹⁰	25.21	0.00	0.00	SAMPLED ANNUALLY		--	--	--	--	--
09/08/04	-- ¹⁰	-- ¹⁰	25.61	0.00	0.00	SAMPLED ANNUALLY		--	--	--	--	--
12/06/04	-- ¹⁰	-- ¹⁰	24.77	0.00	0.00	SAMPLED ANNUALLY		--	--	--	--	--
03/07/05 ⁷	-- ¹⁰	-- ¹⁰	23.18	0.00	0.00	<50	<0.5	<0.5	<0.5	<0.5	<0.5	<50
06/06/05	-- ¹⁰	-- ¹⁰	22.65	0.00	0.00	SAMPLED ANNUALLY		--	--	--	--	--

Table 1
Groundwater Monitoring Data and Analytical Results
Chevron Service Station #9-0076
4265 Foothill Boulevard
Oakland, California

WELL ID/ DATE	TOC* (ft.)	GWE (msl)	DTW (ft.)	SPHT (ft.)	SPH REMOVED (gallons)	TPH-G (ppb)	B (ppb)	T (ppb)	E (ppb)	X (ppb)	MTBE (ppb)	ETHANOL (ppb)
C-9 (cont)												
09/06/05	-- ¹⁰	-- ¹⁰	24.58	0.00	0.00	SAMPLED ANNUALLY	--	--	--	--	--	--
C-10												
09/09/03 ^{7,8}	--	--	17.18	0.00	0.00	<50	<0.5	<0.5	<0.5	0.5	14	<50
12/09/03 ⁷	--	--	14.24	0.00	0.00	<50	<0.5	<0.5	<0.5	<0.5	2	<50
03/09/04 ⁷	38.37	28.67	9.70	0.00	0.00	<50	<0.5	<0.5	<0.5	<0.5	15	<50
06/08/04 ⁷	38.37	26.67	11.70	0.00	0.00	<50	<0.5	<0.5	<0.5	<0.5	44	<50
09/08/04 ⁷	38.37	25.37	13.00	0.00	0.00	<50	<0.5	<0.5	<0.5	<0.5	2	<50
12/06/04 ⁷	38.37	25.84	12.53	0.00	0.00	<50	<0.5	<0.5	<0.5	<0.5	3	<50
03/07/05 ⁷	38.38	30.54	7.84	0.00	0.00	<50	<0.5	<0.5	<0.5	<0.5	140	<50
06/06/05 ⁷	38.38	28.76	9.62	0.00	0.00	<50	<0.5	<0.5	<0.5	<0.5	390	<50
09/06/05 ⁷	38.39	26.81	11.58	0.00	0.00	<50	<0.5	<0.5	<0.5	<0.5	190	<50
TRIP BLANK												
04/28/89	--	--	--	--	--	<500	<0.5	<0.5	<0.5	<0.5	--	--
08/08/89	--	--	--	--	--	<500	<0.5	<0.5	<0.5	<0.5	--	--
08/27/90	--	--	--	--	--	<50	<0.3	<0.3	<0.3	<0.6	--	--
11/14/90	--	--	--	--	--	<50	<0.3	<0.3	<0.3	<0.6	--	--
06/18/91	--	--	--	--	--	<50	<0.5	<0.5	<0.5	<0.5	--	--
09/19/91	--	--	--	--	--	<50	<0.5	<0.5	<0.5	<0.5	--	--
12/20/91	--	--	--	--	--	<50	<0.5	<0.5	<0.5	<0.5	--	--
03/18/92	--	--	--	--	--	<50	<0.5	<0.5	<0.5	<0.5	--	--
07/14/92	--	--	--	--	--	<50	<0.5	<0.5	<0.5	<0.5	--	--
10/08/92	--	--	--	--	--	<50	<0.5	<0.5	<0.5	<0.5	--	--
01/08/93	--	--	--	--	--	<50	<0.5	<0.5	<0.5	<0.5	--	--
04/14/93	--	--	--	--	--	<50	<0.5	<0.5	<0.5	<0.5	--	--
07/16/93	--	--	--	--	--	<50	<0.5	<0.5	<0.5	<0.5	--	--
09/21/93	--	--	--	--	--	<50	<0.5	<0.5	<0.5	<0.8	--	--
01/28/94	--	--	--	--	--	<50	<0.5	<0.5	<0.5	<0.5	--	--
03/17/94	--	--	--	--	--	<50	<0.5	<0.5	<0.5	<0.5	--	--
06/16/94	--	--	--	--	--	<50	<0.5	<0.5	<0.5	<0.5	--	--
09/22/94	--	--	--	--	--	<50	<0.5	<0.5	<0.5	<0.5	--	--
12/15/94	--	--	--	--	--	<50	<0.5	<0.5	<0.5	<0.5	--	--

Table 1
Groundwater Monitoring Data and Analytical Results
Chevron Service Station #9-0076
4265 Foothill Boulevard
Oakland, California

WELL ID/ DATE	TOC* (fl.)	GWE (msl)	DTW (fl.)	SPHT (fl.)	SPH REMOVED (gallons)	TPH-G (ppb)	B (ppb)	T (ppb)	E (ppb)	X (ppb)	MTBE (ppb)	ETHANOL (ppb)
TRIP BLANK (cont)												
03/30/95	--	--	--	--	--	<50	<0.5	<0.5	<0.5	<0.5	--	--
06/20/95	--	--	--	--	--	<50	<0.5	<0.5	<0.5	<0.5	--	--
09/20/95	--	--	--	--	--	<50	<0.5	<0.5	<0.5	<0.5	--	--
12/06/95	--	--	--	--	--	<50	<0.5	<0.5	<0.5	<0.5	--	--
03/21/96	--	--	--	--	--	<50	<0.5	<0.5	<0.5	<0.5	<2.5	--
06/21/96	--	--	--	--	--	<50	<0.5	<0.5	<0.5	<0.5	<2.5	--
09/06/96	--	--	--	--	--	<50	<0.5	<0.5	<0.5	<0.5	--	--
12/19/96	--	--	--	--	--	<50	<0.5	<0.5	<0.5	<0.5	<2.5	--
03/17/97	--	--	--	--	--	<50	<0.5	<0.5	<0.5	<0.5	<2.5	--
06/11/97	--	--	--	--	--	<50	<0.5	<0.5	<0.5	<0.5	<2.5	--
09/17/97	--	--	--	--	--	<50	<0.5	<0.5	<0.5	<0.5	<2.5	--
12/11/97	--	--	--	--	--	<50	<0.5	<0.5	<0.5	<0.5	<2.5	--
03/12/98	--	--	--	--	--	<50	<0.5	<0.5	<0.5	<0.5	<2.5	--
06/23/98	--	--	--	--	--	<50	<0.5	<0.5	<0.5	<0.5	<2.5	--
09/01/98	--	--	--	--	--	<50	<0.5	<0.5	<0.5	<0.5	<2.5	--
12/30/98	--	--	--	--	--	<50	<0.5	<0.5	<0.5	<0.5	<2.5	--
03/31/99	--	--	--	--	--	<50	<0.5	<0.5	<0.5	<0.5	<2.0	--
06/14/99	--	--	--	--	--	<50	<0.5	<0.5	<0.5	<0.5	<2.0	--
12/22/99	--	--	--	--	--	<50	<0.5	<0.5	<0.5	<0.5	<2.5	--
06/23/00	--	--	--	--	--	<50	<0.50	<0.50	<0.50	<0.50	<2.5	--
09/05/00	--	--	--	--	--	<50	<0.50	<0.50	<0.50	<0.50	<2.5	--
12/04/00	--	--	--	--	--	<50	<0.50	<0.50	<0.50	<0.50	<2.5	--
03/08/01	--	--	--	--	--	<50.0	<0.500	<0.500	<0.500	<0.500	<2.50	--
06/07/01	--	--	--	--	--	<50	<0.50	<0.50	<0.50	<0.50	<2.5	--
09/13/01	--	--	--	--	--	<50	<0.50	<0.50	<0.50	<0.50	<2.5	--
QA												
12/13/01	--	--	--	--	--	<50	<0.50	<0.50	<0.50	<1.5	<2.5	--
03/08/02	--	--	--	--	--	<50	<0.50	<0.50	<0.50	<1.5	<2.5	--
06/19/02	--	--	--	--	--	<50	<0.50	<0.50	<0.50	<1.5	<2.5	--
09/11/02	--	--	--	--	--	<50	<0.50	<0.50	<0.50	<1.5	<2.5	--
12/11/02	--	--	--	--	--	<50	<0.50	<0.50	<0.50	<1.5	<2.5	--
03/11/03	--	--	--	--	--	<50	<0.50	<0.50	<0.50	<1.5	<2.5	--
06/10/03 ⁷	--	--	--	--	--	<50	<0.5	<0.5	<0.5	<0.5	<0.5	--
09/09/03 ⁷	--	--	--	--	--	<50	<0.5	<0.5	<0.5	<0.5	<0.5	--
12/09/03 ⁷	--	--	--	--	--	<50	<0.5	<0.5	<0.5	<0.5	<0.5	--

Table 1
Groundwater Monitoring Data and Analytical Results
Chevron Service Station #9-0076
4265 Foothill Boulevard
Oakland, California

WELL ID/ DATE	TOC* (ft.)	GWE (msl)	DTW (ft.)	SPHT (ft.)	SPH REMOVED (gallons)	TPH-G (ppb)	B (ppb)	T (ppb)	E (ppb)	X (ppb)	MTBE (ppb)	ETHANOL (ppb)
QA (cont)												
03/09/04 ⁷	--	--	--	--	--	<50	<0.5	<0.5	<0.5	<0.5	<0.5	--
06/08/04 ⁷	--	--	--	--	--	<50	<0.5	<0.5	<0.5	<0.5	<0.5	--
09/08/04 ⁷	--	--	--	--	--	<50	<0.5	<0.5	<0.5	<0.5	<0.5	--
12/06/04 ⁷	--	--	--	--	--	<50	<0.5	<0.5	<0.5	<0.5	<0.5	--
03/07/05 ⁷	--	--	--	--	--	<50	<0.5	<0.5	<0.5	<0.5	<0.5	--
06/06/05 ⁷	--	--	--	--	--	<50	<0.5	<0.5	<0.5	<0.5	<0.5	--
09/06/05 ⁷	--	--	--	--	--	<50	<0.5	<0.5	<0.5	<0.5	<0.5	--

Table 1
Groundwater Monitoring Data and Analytical Results
Chevron Service Station #9-0076
4265 Foothill Boulevard
Oakland, California

EXPLANATIONS:

Groundwater monitoring data and laboratory analytical results prior to June 23, 2000, were compiled from reports prepared by Blaine Tech Services, Inc.

TOC = Top of Casing (ft.) = Feet	TPH-G = Total Petroleum Hydrocarbons as Gasoline B = Benzene	ND = Not Detected -- = Not Measured/Not Analyzed
GWE = Groundwater Elevation (msl) = Mean sea level	T = Toluene E = Ethylbenzene	QA = Quality Assurance/Trip Blank
DTW = Depth to Water	X = Xylenes	
SPHT = Separate Phase Hydrocarbons Thickness	MTBE = Methyl tertiary butyl ether	
SPH = Separate Phase Hydrocarbons	(ppb) = Parts per billion	

* TOC elevation for C-10 was surveyed on September 26, 2003, by Virgil Chavez Land Surveying. The benchmark for this survey was a City of Oakland No. 1589, a cut square in the sidewalk at the mid-return at the west corner of High Street and Foothill Blvd., (Benchmark Elevation = 38.54 feet, NGVD 29).

** GWE corrected for the presence of SPH; correction factor: $[(TOC - DTW) + (SPHT \times 0.80)]$.

- 1 Confirmation run.
- 2 Sample were analyzed past hold-time, the results should be considered as estimated.
- 3 ORC present in well.
- 4 Laboratory report indicates gasoline C6-C12.
- 5 Laboratory report indicates sample was originally analyzed within holding time. Re-analysis for confirmation or dilution was performed past the recommended holding time.
- 6 Laboratory report indicates hydrocarbon pattern is present in the requested fuel quantitation range but does not resemble the pattern of the requested fuel.
- 7 BTEX and MTBE by EPA Method 8260.
- 8 Well development performed.
- 9 ORC removed from well.
- 10 TOC has been altered; unable to determine an accurate GWE.

ATTACHMENT E

WELL SURVEY DATA

BP/ARCO Survey Sheet

Site: Former BP Service Station #11109
4280 Foothill Boulevard, Oakland, CA 94601

Well ID	X-coord (NAD'83)	Y-coord (NAD'83)	Top of Casing (NAVD'88)	Top of Lid (NAVD'88)	Ground Surface (NAVD'88)	Comments
MW-3	-122.2117934	37.7749953	42.92	43.84	43.84	
MW-4	-122.2120133	37.7750899	42.88	43.33	43.33	
MW-5	-122.2118449	37.7749016	41.98	43.00	43.00	
MW-6	-122.2117227	37.7751602	44.37	44.87	44.87	
MW-7	-122.2116265	37.7750180	43.10	44.04	44.04	
MW-8	-122.2124356	37.7751425	40.95	41.36	41.36	
MW-9	-122.2113884	37.7750952	44.06	44.39	44.39	

GLOBAL_ID	FIELD_PT_NAME	FIELD_PT_CLASS	X_TYPE	XY_SURVEY_DESC	SITE
	CP CHX	BM		0.0000000	BP 11109
	CP CHX	BM		0.0000000	BP 11109
	MW-9	MW		0.0000000	BP 11109
	MW-7	MW		0.0000000	BP 11109
	MW-6	MW		0.0000000	BP 11109
	MW-4	MW		0.0000000	BP 11109
	MW-8	MW		0.0000000	BP 11109
	MW-3	MW		0.0000000	BP 11109
	MW-5	MW		0.0000000	BP 11109