

bp



Scott T. Hooton
Portfolio Manager

BP Oil Company
Midwest Environmental Services
295 SW 41st Street
Bldg. 13, Suite N
Renton, WA 98055

Switchboard: 425/251-0667
Central Fax: 425/251-0736

RO 426

MAY 22 2001

May 11, 2001

Mr. Barney Chan
Alameda County Health Care Services
Agency
1131 Harbor Bay Parkway, Room 250
Alameda, CA 94502-6577

Re: Former BP Oil Site No. 11109
4280 Foothill Boulevard
Oakland, CA

Direct: 425/251-0689
Cell: 206/335-0689
hootonst@bp.com
www.bp.com

Dear Mr. Chan:

Enclosed please find 26 April 2001 *First Quarter 2001 Groundwater Monitoring* report prepared by Blaine Tech Services on behalf of BP. The report summarizes groundwater monitoring and sampling data obtained since 1990.

Upon review of the results reported this quarter, you will note that aromatic petroleum hydrocarbons were detected in a sample obtained from well MW-5 on 8 March 2001. Liquid petroleum hydrocarbon was removed by manual bailing.

Please contact me at (425) 251-0689 if you have questions about this site.

Sincerely,

A handwritten signature in black ink, appearing to read "Scott Hooton".
Scott Hooton

Attachment

cc: site file
Phil Briggs - Chevron Products Company, P.O. Box 5004, San Ramon, CA 94583-0804 (w/attachment)
David Camille - Tosco (w/attachment)
C. Jimmerson - (w/attachment)

BLAINE
TECH SERVICES, INC.



1680 ROGERS AVENUE
SAN JOSE, CA 95112-1105
(408) 573-7771 FAX
(408) 573-0555 PHONE
CONTRACTOR'S LICENSE #746684
www.blainetech.com

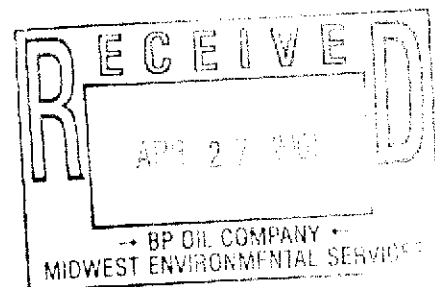

April 26, 2001

Scott Hooton
BP Oil Company
295 SW 41st Street, Bldg. 13, Suite N
Renton, WA 98055-4931

Ro 426

1st Quarter 2001 Monitoring at 11109

First Quarter 2001 Groundwater Monitoring
BP Service Station Number 11109
4280 Foothill Blvd.
Oakland, CA

Monitoring Performed on March 8, 2001

Groundwater Sampling Report 010308-A-2

This report covers the routine monitoring of groundwater wells at this BP facility. Blaine Tech Services, Inc.'s work at the site includes inspection, gauging, evacuation, purgewater containment, sample collection and sample handling in accordance with standard procedures that conform to Regional Water Quality Control Board requirements.

Routine field data collection includes depth to water, total well depth, thickness of any separate immiscible layer, water column volume, the appropriate calculated purge volume, elapsed evacuation time, total volume of water removed, and standard water parameter instrument readings. Sample material is collected, contained, stored, and transported to the laboratory in conformance with EPA standards. Purgewater is, likewise, collected and transported to Seaport Petroleum Corporation for disposal.

Basic field information is presented alongside analytical values excerpted from the laboratory report in the cumulative table of **WELL DATA AND ANALYTICAL RESULTS**. The full analytical report for the most recent samples is located in the **Analytical Appendix**. The **Professional Engineering Appendix** contains a **Groundwater Elevation Map** and a **Dissolved Petroleum Hydrocarbon Concentration Map**.

Professional Engineering Appendix

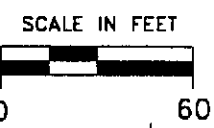

EXPLANATION

- ⊕ GROUNDWATER MONITORING WELL
- ⊞ GROUNDWATER RECOVERY WELL
- 29.77 GROUNDWATER ELEVATION (FT, MSL)
- 30 — GROUNDWATER ELEVATION CONTOUR (FT, MSL)
- NA DATA NOT AVAILABLE
- ↖ APPROXIMATE GROUNDWATER FLOW DIRECTION;
APPROXIMATE GRADIENT = 0.06

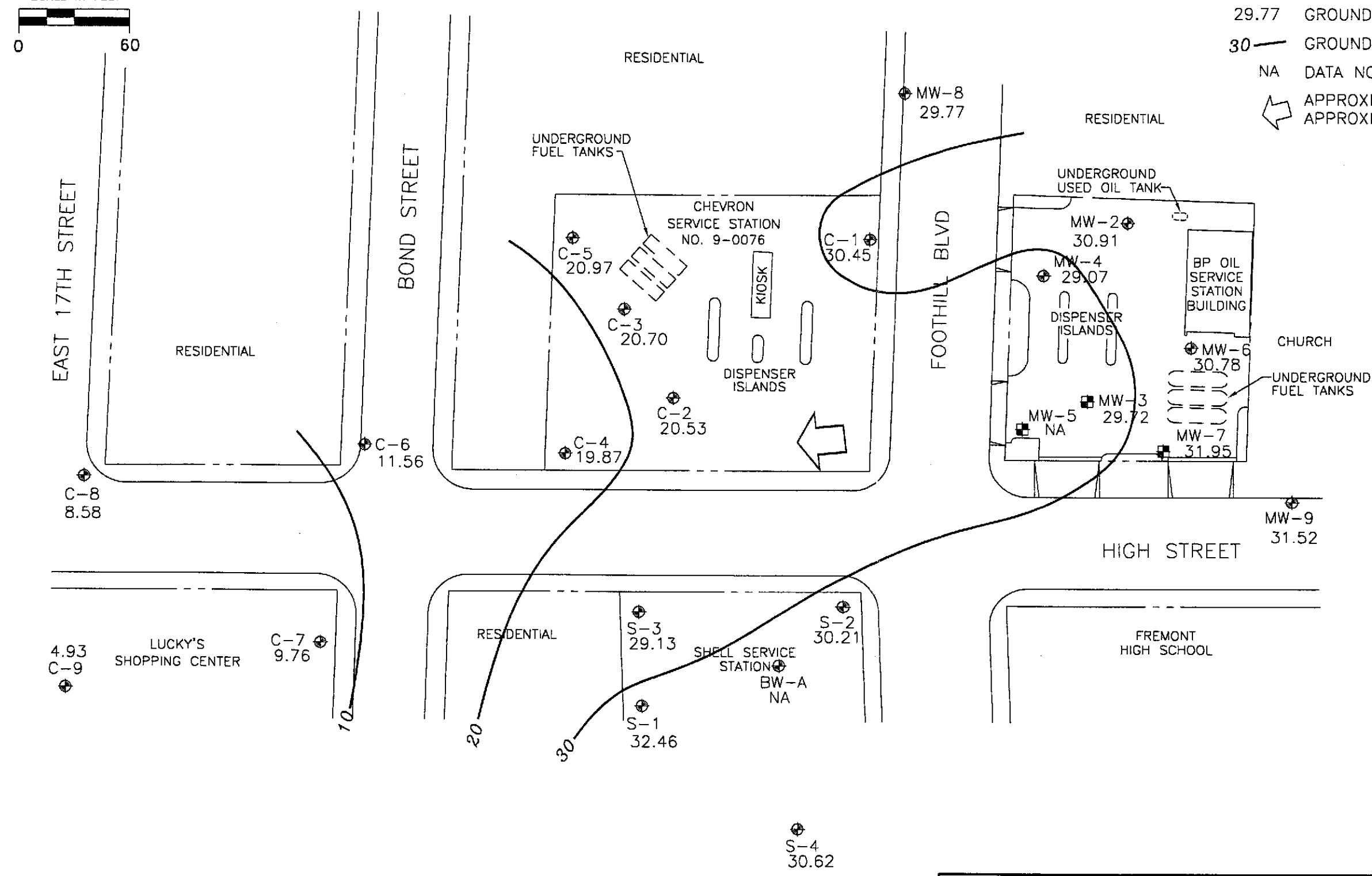

Ref. 11109bm1.dwg
Basemap from Alisto Engineering Group

PREPARED BY RRM engineering contracting firm	GROUNDWATER ELEVATION CONTOUR MAP, MARCH 8, 2001	FIGURE: 1 PROJECT: DAC04
	BP Oil Service Station No. 11109 4280 Foothill Boulevard Oakland, California	

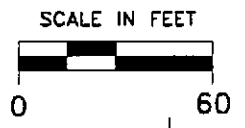

- EXPLANATION**
- ⊕ GROUNDWATER MONITORING WELL
 - ⊞ GROUNDWATER RECOVERY WELL
 - TPHg TOTAL PETROLEUM HYDROCARBON CALCULATED AS GASOLINE IN PARTS PER BILLION (ppb)
 - B BENZENE, ppb
 - T TOLUENE, ppb
 - E ETHYLBENZENE, ppb
 - X XYLENE, ppb
 - MTBE METHYL-TERT-BUTYL-ETHER, ppb
 - MTBE* MTBE BY 8260
 - NA DATA NOT AVAILABLE

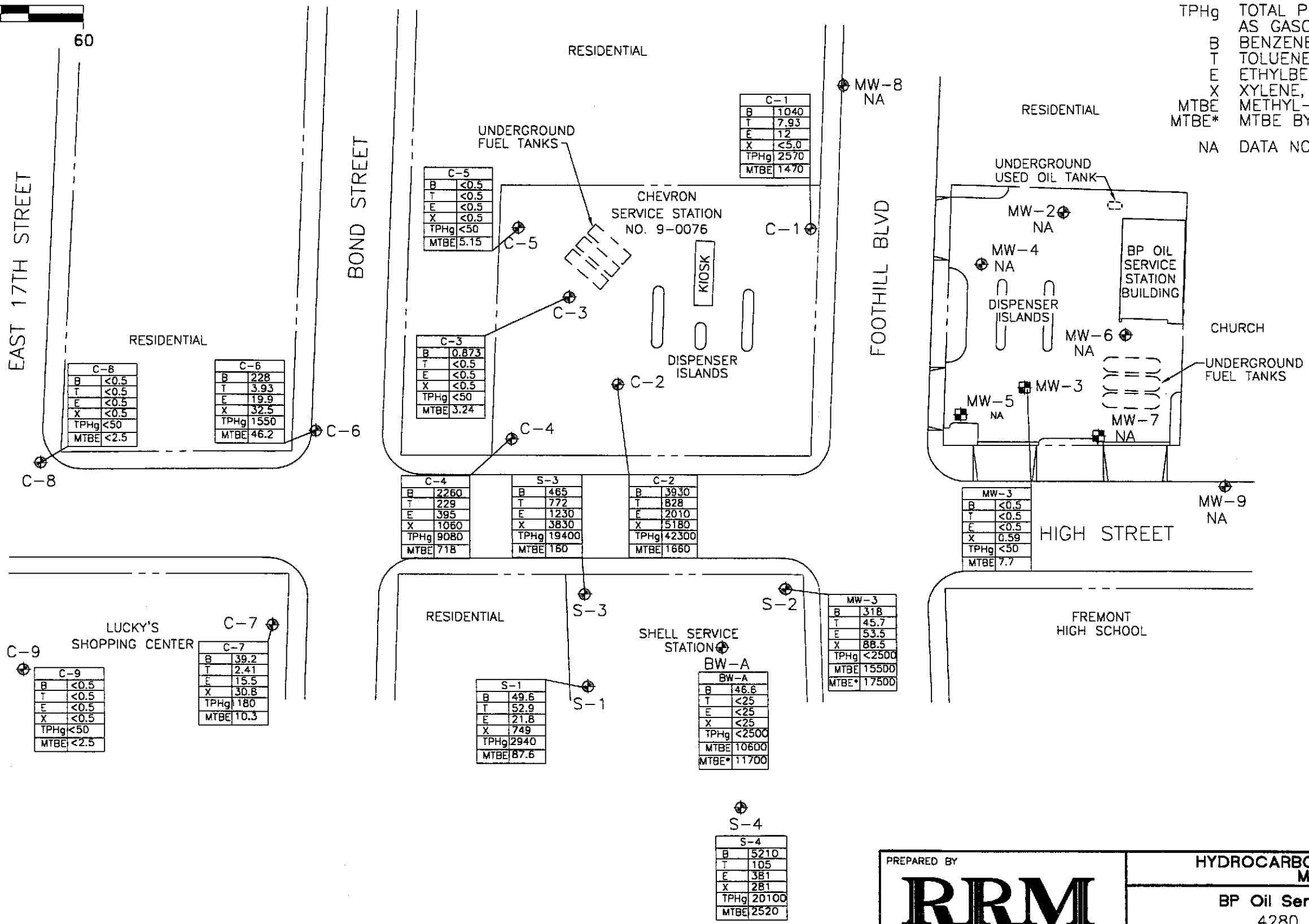

Ref. 11109btex.dwg
Base map from Alisto Engineering Group

PREPARED BY
RRM
engineering contracting firm

HYDROCARBON CONCENTRATION MAP,
MARCH 8, 2001

BP Oil Service Station No. 11109
4280 Foothill Boulevard
Oakland, California

FIGURE:
2
PROJECT:
DAC04

Table of Well Data and Analytical Results

TABLE 1 - SUMMARY OF RESULTS OF GROUNDWATER MONITORING

WELL ID	DATE OF SAMPLING/ MONITORING	CASING ELEVATION (a) (Feet)	DEPTH TO WATER (Feet)	PRODUCT THICKNESS (Feet)	GROUNDWATER ELEVATION (b) (Feet)	TPH-G (ug/l)	TPH-D (ug/l)	B (ug/l)	T (ug/l)	E (ug/l)	X (ug/l)	MTBE (ug/l)	TOG (ug/l)	HVOC (ug/l)	DO (ppm)	LAB
MW-1	01/31/90	38.19	15.41	---	22.78	---	---	---	---	---	---	---	---	---	---	---
MW-1 (c)	02/05/90	38.19	---	---	---	---	---	---	---	---	---	---	---	---	---	---
MW-2	02/05/90	41.22	21.90	---	19.31	1300	---	14	ND<0.1	9	13	---	---	---	---	SUP
MW-2	02/14/91	41.22	21.16	---	20.06	ND<50	ND<10000	ND<0.3	ND<0.3	ND<0.3	ND<0.3	---	ND<5000	51 (d)	---	SUP
MW-2	05/13/91	41.22	21.32	---	19.90	ND<50	ND<50	ND<0.3	ND<0.3	ND<0.3	ND<0.3	---	6000	0.5 (e)	---	SUP
MW-2	07/24/91	41.22	22.92	---	18.30	---	---	---	---	---	---	---	---	---	---	---
MW-2	10/03/91	41.22	24.90	---	16.32	ND<50	ND<50	ND<0.3	0.8	ND<0.3	ND<0.3	---	ND<5000	0.7 (e)	---	SUP
MW-2	10/15/91	41.22	24.10	---	17.12	---	---	---	---	---	---	---	---	---	---	---
MW-2 (f)	12/04/91	41.22	---	---	---	---	---	---	---	---	---	---	---	---	---	---
MW-2	12/16/91	41.22	23.95	---	17.27	---	---	---	---	---	---	---	---	---	---	---
MW-2	01/06/92	41.22	23.30	---	17.92	ND<50	ND<50	ND<0.3	ND<0.3	ND<0.3	ND<0.3	---	ND<5000	ND	---	ANA
MW-2	01/22/92	41.22	23.14	---	18.08	---	---	---	---	---	---	---	---	---	---	---
MW-2	01/28/92	41.22	22.99	---	18.23	---	---	---	---	---	---	---	---	---	---	---
MW-2	02/05/92	41.22	22.63	---	18.59	---	---	---	---	---	---	---	---	---	---	---
MW-2	02/12/92	41.22	22.04	---	19.18	---	---	---	---	---	---	---	---	---	---	---
MW-2	02/17/92	41.22	20.84	---	20.38	---	---	---	---	---	---	---	---	---	---	---
MW-2	04/03/92	41.22	18.29	---	22.93	---	---	---	---	---	---	---	---	---	---	---
MW-2	04/08/92	41.22	18.86	---	22.36	ND<50	63	ND<0.5	ND<0.5	ND<0.5	ND<0.5	---	ND<5000	ND	---	ANA
MW-2	04/14/92	41.22	19.45	---	21.77	---	---	---	---	---	---	---	---	---	---	---
MW-2	04/29/92	41.22	20.35	---	20.87	---	---	---	---	---	---	---	---	---	---	---
MW-2	05/07/92	41.22	20.84	---	20.38	---	---	---	---	---	---	---	---	---	---	---
MW-2	07/03/92	41.22	22.34	---	18.88	ND<50	---	ND<0.5	ND<0.5	ND<0.5	ND<0.5	---	---	---	---	ANA
MW-2	10/08/92	41.22	23.73	---	17.49	ND<50	---	ND<0.5	ND<0.5	ND<0.5	ND<0.5	---	---	---	---	ANA
MW-2	12/31/92	41.22	21.12	---	20.10	ND<50	---	ND<0.5	ND<0.5	ND<0.5	ND<0.5	---	---	---	---	ANA
MW-2	04/21/93	41.22	17.68	---	23.54	ND<50	ND<50 (g)	ND<0.5	ND<0.5	ND<0.5	ND<0.5	---	ND<5000	ND	---	PACE
MW-2	07/07/93	41.22	20.30	---	20.92	ND<50	---	ND<0.5	ND<0.5	ND<0.5	ND<0.5	---	---	1.0 (e)	---	PACE
MW-2	09/21/93	41.22	21.93	---	19.29	ND<50	---	0.9	0.7	1	2.6	---	---	---	---	PACE
MW-2	12/17/93	41.22	21.48	---	19.74	---	---	---	---	---	---	---	---	---	---	---
MW-2	12/23/93	41.22	---	---	---	ND<50	---	ND<0.5	ND<0.5	ND<0.5	0.7	---	---	---	---	PACE
MW-2	04/07/94	41.22	20.25	---	20.97	ND<50	---	ND<0.5	ND<0.5	ND<0.5	ND<0.5	---	---	---	5.9	PACE
MW-2	07/06/94	41.22	20.59	---	20.63	ND<50	---	ND<0.5	ND<0.5	ND<0.5	ND<0.5	---	---	---	3.1	PACE
MW-2	10/07/94	41.22	22.04	---	19.18	ND<50	---	ND<0.5	ND<0.5	ND<0.5	ND<0.5	---	---	---	2.8	PACE
MW-2	01/27/95	41.22	26.12	---	15.10	ND<50	440	ND<0.5	ND<0.5	ND<0.5	ND<1	---	ND<5000	---	4.8	ATI
MW-2	03/30/95	41.22	12.34	---	28.88	ND<50	---	ND<0.50	ND<0.50	ND<0.50	ND<1.0	---	---	---	7.2	ATI
MW-2	06/20/95	41.22	16.42	---	24.80	ND<50	---	ND<0.50	ND<0.50	ND<0.50	ND<1.0	---	---	---	6.0	ATI
MW-2	10/03/95	41.22	20.06	---	21.16	ND<50	---	ND<0.50	ND<0.50	ND<0.50	ND<1.0	ND<5.0	---	---	5.7	ATI

TABLE 1 - SUMMARY OF RESULTS OF GROUNDWATER MONITORING

WELL ID	DATE OF SAMPLING/ MONITORING	CASING ELEVATION (a) (Feet)	DEPTH TO WATER (Feet)	PRODUCT THICKNESS (Feet)	GROUNDWATER ELEVATION (b) (Feet)	TPH-G (ug/l)	TPH-D (ug/l)	B (ug/l)	T (ug/l)	E (ug/l)	X (ug/l)	MTBE (ug/l)	TOG (ug/l)	HVOC (ug/l)	DO (ppm)	LAB
MW-2	12/06/95	41.22	21.31	---	19.91	ND<50	---	ND<0.50	ND<0.50	ND<0.50	ND<1.0	46	---	---	5.4	ATI
MW-2	03/21/96	41.22	12.28	---	28.94	ND<50	---	ND<0.5	ND<1.0	ND<1.0	ND<1.0	ND<1.0	---	---	7.4	SPL
MW-2	06/21/96	41.22	13.28	---	27.94	ND<50	---	ND<0.5	ND<1	ND<1	ND<1	ND<10	---	---	7.3	SPL
MW-2	09/06/96	41.22	13.94	---	27.28	---	---	---	---	---	---	---	---	---	---	---
MW-2	09/09/96	41.22	---	---	---	ND<50	---	ND<0.5	ND<1.0	ND<1.0	ND<1.0	ND<10	---	---	7.4	SPL
MW-2	12/19/96	41.22	12.19	---	29.03	ND<50	---	ND<0.5	ND<1.0	ND<1.0	ND<1.0	ND<10	---	---	7.9	SPL
MW-2	03/17/97	41.22	11.59	---	29.63	---	---	---	---	---	---	---	---	---	---	---
MW-2	08/12/97	41.22	13.21	---	28.01	---	---	---	---	---	---	---	---	---	---	---
MW-2	12/10/97	41.22	12.34	---	28.88	---	---	---	---	---	---	---	---	---	---	---
MW-2	03/12/98	41.22	11.04	---	30.18	---	---	---	---	---	---	---	---	---	---	---
MW-2	06/23/98	41.22	11.77	---	29.45	---	---	---	---	---	---	---	---	---	---	---
MW-2	03/31/99	41.22	12.38	---	28.84	---	---	---	---	---	---	---	---	---	---	---
MW-2	08/25/99	41.22	17.72	---	23.50	---	---	---	---	---	---	---	---	---	---	---
MW-2	03/09/00	41.22	11.94	---	29.28	---	---	---	---	---	---	---	---	---	---	---
MW-2	03/08/01	41.22	10.31	---	30.91	---	---	---	---	---	---	---	---	---	---	---

TABLE 1 - SUMMARY OF RESULTS OF GROUNDWATER MONITORING

WELL ID	DATE OF SAMPLING/ MONITORING	CASING ELEVATION (a) (Feet)	DEPTH TO WATER (Feet)	PRODUCT THICKNESS (Feet)	GROUNDWATER ELEVATION (b) (Feet)	TPH-G (ug/l)	TPH-D (ug/l)	B (ug/l)	T (ug/l)	E (ug/l)	X (ug/l)	MTBE (ug/l)	TOG (ug/l)	HVOC (ug/l)	DO (ppm)	LAB
MW-3	02/05/90	40.74	17.45	---	23.29	1400	---	15	ND<2.5	11	8	---	---	---	---	SUP
MW-3	02/14/91	40.74	18.52	---	22.22	320	---	8	ND<0.3	8	1	---	---	---	---	SUP
MW-3	05/13/91	40.74	19.32	---	21.42	640	---	13	ND<0.3	18	1	---	---	---	---	SUP
MW-3	07/24/91	40.74	20.69	---	20.05	---	---	---	---	---	---	---	---	---	---	---
MW-3	10/03/91	40.74	19.47	---	21.27	940	---	21	ND<0.3	23	2.1	---	---	---	---	SUP
MW-3	10/15/91	40.74	20.46	---	20.28	---	---	---	---	---	---	---	---	---	---	---
MW-3	12/04/91	40.74	18.29	---	22.45	---	---	---	---	---	---	---	---	---	---	---
MW-3	12/16/91	40.74	18.34	---	22.40	---	---	---	---	---	---	---	---	---	---	---
MW-3	01/06/92	40.74	18.50	---	22.24	580	---	6.1	1	6	7.1	---	---	---	---	ANA
MW-3	01/22/92	40.74	17.86	---	22.88	---	---	---	---	---	---	---	---	---	---	---
MW-3	01/28/92	40.74	15.84	---	24.90	---	---	---	---	---	---	---	---	---	---	---
MW-3	02/05/92	40.74	17.53	---	23.21	---	---	---	---	---	---	---	---	---	---	---
MW-3	02/12/92	40.74	17.15	---	23.59	---	---	---	---	---	---	---	---	---	---	---
MW-3	02/17/92	40.74	16.18	---	24.56	---	---	---	---	---	---	---	---	---	---	---
MW-3	04/03/92	40.74	14.80	---	25.94	---	---	---	---	---	---	---	---	---	---	---
MW-3	04/08/92	40.74	17.06	---	23.68	1100	---	30	4.6	32	11	---	---	---	---	ANA
MW-3	04/14/92	40.74	15.22	---	25.52	---	---	---	---	---	---	---	---	---	---	---
MW-3	04/29/92	40.74	15.90	---	24.84	---	---	---	---	---	---	---	---	---	---	---
MW-3	05/07/92	40.74	16.35	---	24.39	---	---	---	---	---	---	---	---	---	---	---
MW-3	07/03/92	40.74	17.74	---	23.00	1200	---	38	ND<2.5	24	ND<2.5	---	---	---	---	ANA
MW-3	10/08/92	40.74	19.06	---	21.68	1400	---	31	ND<0.5	25	13	---	---	---	---	ANA
MW-3	12/31/92	40.74	16.61	---	24.13	820	---	12	4.1	13	5.9	---	---	---	---	ANA
QC-1 (h)	12/31/92	---	---	---	---	960	---	11	3.6	10	3.8	---	---	---	---	ANA
MW-3	04/21/93	40.74	14.24	---	26.50	420	---	5.6	ND<0.5	4	1.4	---	---	---	---	PACE
QC-1 (h)	04/21/93	---	---	---	---	390	---	5.0	ND<0.5	4	1.5	---	---	---	---	PACE
MW-3	07/07/93	40.13	(i) 15.19	---	24.94	54	---	0.6	0.6	ND<0.5	ND<0.5	---	---	---	---	PACE
MW-3	09/21/93	40.13	16.58	---	23.55	540	---	7.9	0.9	5	2.4	---	---	---	---	PACE
MW-3	12/17/93	40.13	15.82	---	24.31	---	---	---	---	---	---	---	---	---	---	---
MW-3	12/23/93	40.13	---	---	---	500	---	9.8	1.5	3	2.1	---	---	---	---	PACE
QC-1 (h)	12/23/93	---	---	---	---	480	---	9.2	ND<0.5	5	5.3	---	---	---	---	PACE
MW-3	04/07/94	40.13	28.50	---	11.63	460	---	20	7.4	9	11	---	---	---	---	PACE
QC-1 (h)	04/07/94	---	---	---	---	460	---	20	7.7	9	11	---	---	---	---	PACE
MW-3	07/06/94	40.13	---	---	---	300	---	10	0.6	2	6.4	---	---	---	4.8	PACE
MW-3	10/07/94	40.13	27.65	---	12.48	620	---	28	ND<0.5	2	12	---	31	(j)	4.4	PACE
MW-3	01/27/95	40.13	27.65	---	12.48	---	---	---	---	---	---	---	---	---	---	---
MW-3	03/30/95	40.13	26.05	---	14.08	300	---	10	6.0	3	18	---	---	---	7.6	ATI
MW-3	06/20/95	40.13	19.49	---	20.64	170	---	7.2	3.4	1	15	---	---	---	---	ATI

TABLE 1 - SUMMARY OF RESULTS OF GROUNDWATER MONITORING

WELL ID	DATE OF SAMPLING/ MONITORING	CASING ELEVATION (a) (Feet)	DEPTH TO WATER (Feet)	PRODUCT THICKNESS (Feet)	GROUNDWATER ELEVATION (b) (Feet)	TPH-G (ug/l)	TPH-D (ug/l)	B (ug/l)	T (ug/l)	E (ug/l)	X (ug/l)	MTBE (ug/l)	TOG (ug/l)	HVOC (ug/l)	DO (ppm)	LAB
MW-4	02/05/90	40.11	20.75	---	19.36	620	---	ND<0.5	9	ND<0.5	10	---	---	---	---	SUP
MW-4	02/14/91	40.11	21.73	---	18.38	180	---	ND<0.3	ND<0.3	0.4	2	---	---	---	---	SUP
MW-4	05/13/91	40.11	18.55	---	21.56	72	---	0.7	ND<0.3	ND<0.3	ND<0.3	---	---	---	---	SUP
MW-4	07/24/91	40.11	21.31	---	18.80	---	---	---	---	---	---	---	---	---	---	---
MW-4	10/03/91	40.11	22.57	---	17.54	57	---	ND<0.3	ND<0.3	ND<0.3	ND<0.3	---	---	---	---	SUP
MW-4	10/15/91	40.11	22.88	---	17.23	---	---	---	---	---	---	---	---	---	---	---
MW-4	12/04/91	40.11	22.54	---	17.57	---	---	---	---	---	---	---	---	---	---	---
MW-4	12/16/91	40.11	22.59	---	17.52	---	---	---	---	---	---	---	---	---	---	---
MW-4	01/06/92	40.11	22.00	---	18.11	480	---	0.8	3.2	2	7.7	---	---	---	---	ANA
MW-4	01/22/92	40.11	21.58	---	18.53	---	---	---	---	---	---	---	---	---	---	---
MW-4	01/28/92	40.11	21.42	---	18.69	---	---	---	---	---	---	---	---	---	---	---
MW-4	02/05/92	40.11	21.10	---	19.01	---	---	---	---	---	---	---	---	---	---	---
MW-4	02/12/92	40.11	20.74	---	19.37	---	---	---	---	---	---	---	---	---	---	---
MW-4	02/17/92	40.11	19.78	---	20.33	---	---	---	---	---	---	---	---	---	---	---
MW-4	04/03/92	40.11	16.80	---	23.31	---	---	---	---	---	---	---	---	---	---	---
MW-4	04/08/92	40.11	17.13	---	22.98	ND<50	---	ND<0.5	ND<0.5	ND<0.5	ND<0.5	---	---	---	---	ANA
MW-4	04/14/92	40.11	17.74	---	22.37	---	---	---	---	---	---	---	---	---	---	---
MW-4	04/29/92	40.11	18.56	---	21.55	---	---	---	---	---	---	---	---	---	---	---
MW-4	05/07/92	40.11	19.10	---	21.01	---	---	---	---	---	---	---	---	---	---	---
MW-4	07/03/92	40.11	20.71	---	19.40	ND<50	---	0.6	ND<0.5	ND<0.5	ND<0.5	---	---	---	---	ANA
MW-4	10/08/92	40.11	22.43	---	17.68	270	---	ND<0.5	2.1	3	3.2	---	---	---	---	ANA
MW-4	12/31/92	40.11	19.58	---	20.53	150	---	ND<0.5	ND<0.5	ND<0.5	1.3	---	---	---	---	ANA
MW-4	04/21/93	40.11	17.79	---	22.32	ND<50	---	ND<0.5	ND<0.5	ND<0.5	ND<0.5	---	---	---	---	PACE
MW-4	07/07/93	40.11	18.44	---	21.67	160	---	1.2	5.4	4	19	---	---	---	---	PACE
MW-4	09/21/93	40.11	20.14	---	19.97	71	---	ND<0.5	1.9	ND<0.5	2.1	---	---	---	---	PACE
MW-4	12/17/93	40.11	19.80	---	20.31	---	---	---	---	---	---	---	---	---	---	---
MW-4	12/23/93	40.11	---	---	---	ND<50	---	3.1	1.6	1	3.8	---	---	---	---	PACE
MW-4	04/07/94	40.11	19.12	---	20.99	ND<50	---	ND<0.5	ND<0.5	ND<0.5	ND<0.5	---	---	---	6.6	PACE
MW-4	07/06/94	40.11	19.90	---	20.21	62	---	ND<0.5	ND<0.5	ND<0.5	ND<0.5	---	---	---	4.1	PACE
MW-4	10/07/94	40.11	20.07	---	20.04	ND<50	---	ND<0.5	ND<0.5	ND<0.5	ND<0.5	---	---	---	3.6	PACE
MW-4	01/27/95	40.11	13.72	---	26.39	ND<50	---	ND<0.5	ND<0.5	ND<0.5	ND<1	---	---	---	2.7	ATI
MW-4	03/30/95	40.11	11.46	---	28.65	ND<50	---	ND<0.50	ND<0.50	ND<0.50	ND<1.0	---	---	---	8.3	ATI
MW-4	06/20/95	40.11	14.78	---	25.33	ND<50	---	ND<0.50	ND<0.50	ND<0.50	ND<1.0	---	---	---	---	ATI
MW-4	10/03/95	40.11	19.62	---	20.49	ND<50	---	ND<0.50	ND<0.50	ND<0.50	ND<1.0	5.0	---	---	5.8	ATI
MW-4	12/06/95	40.11	19.91	---	20.20	ND<50	---	ND<0.50	ND<0.50	ND<0.50	ND<1.0	47	---	---	5.7	ATI
MW-4	03/21/96	40.11	11.12	---	28.99	ND<50	---	ND<0.5	ND<1	ND<1	ND<1	ND<10	---	---	7.8	SPL
MW-4	06/21/96	40.11	12.21	---	27.90	ND<50	---	ND<0.5	ND<1	ND<1	ND<1	ND<10	---	---	7.9	SPL

TABLE 1 - SUMMARY OF RESULTS OF GROUNDWATER MONITORING

WELL ID	DATE OF SAMPLING/ MONITORING	CASING ELEVATION (a) (Feet)	DEPTH TO WATER (Feet)	PRODUCT THICKNESS (Feet)	GROUNDWATER ELEVATION (b) (Feet)	TPH-G (ug/l)	TPH-D (ug/l)	B (ug/l)	T (ug/l)	E (ug/l)	X (ug/l)	MTBE (ug/l)	TOG (ug/l)	HVOC (ug/l)	DO (ppm)	LAB
MW-4	09/06/96	40.11	12.89	--	27.22	--	--	--	--	--	--	--	--	--	--	--
MW-4	09/09/96	40.11	--	--	--	ND<50	--	ND<0.5	ND<1.0	ND<1.0	ND<1.0	ND<10	--	--	7.2	SPL
MW-4	12/19/96	40.11	11.01	--	29.10	ND<50	--	ND<0.5	ND<1.0	ND<1.0	ND<1.0	ND<10	--	--	8.4	SPL
MW-4	03/17/97	40.11	10.42	--	29.69	--	--	--	--	--	--	--	--	--	--	--
MW-4	08/12/97	40.11	12.77	--	27.34	--	--	--	--	--	--	--	--	--	--	--
MW-4	12/10/97	40.11	11.22	--	28.89	--	--	--	--	--	--	--	--	--	--	--
MW-4	03/12/98	40.11	10.81	--	29.30	--	--	--	--	--	--	--	--	--	--	--
MW-4	06/23/98	40.11	10.61	--	29.50	--	--	--	--	--	--	--	--	--	--	--
MW-4	03/31/99	40.11	11.46	--	28.65	--	--	--	--	--	--	--	--	--	--	--
MW-4	08/25/99	40.11	16.16	--	23.95	--	--	--	--	--	--	--	--	--	--	--
MW-4	03/09/00	40.11	12.23	--	27.88	--	--	--	--	--	--	--	--	--	--	--
MW-4	03/08/01	40.11	11.04	--	29.07	--	--	--	--	--	--	--	--	--	--	--

TABLE 1 - SUMMARY OF RESULTS OF GROUNDWATER MONITORING

WELL ID	DATE OF SAMPLING/ MONITORING	CASING ELEVATION (a) (Feet)	DEPTH TO WATER (Feet)	PRODUCT THICKNESS (Feet)	GROUNDWATER ELEVATION (b) (Feet)	TPH-G (ug/l)	TPH-D (ug/l)	B (ug/l)	T (ug/l)	E (ug/l)	X (ug/l)	MTBE (ug/l)	TOG (ug/l)	HVOC (ug/l)	DO (ppm)	LAB
MW-5	10/03/91	39.55	18.08	---	21.47	79000	---	13000	7400	1400	6200	---	---	---	---	SUP
MW-5	10/15/91	39.55	18.55	---	21.00	---	---	---	---	---	---	---	---	---	---	---
MW-5	12/04/91	39.55	18.44	0.13	21.21	---	---	---	---	---	---	---	---	---	---	---
MW-5	12/16/91	39.55	18.66	0.01	20.90	---	---	---	---	---	---	---	---	---	---	---
MW-5	01/06/92	39.55	19.12	0.11	20.51	---	---	---	---	---	---	---	---	---	---	---
MW-5	01/22/92	39.55	14.59	---	24.96	---	---	---	---	---	---	---	---	---	---	---
MW-5	01/28/92	39.55	15.25	---	24.30	---	---	---	---	---	---	---	---	---	---	---
MW-5	02/05/92	39.55	15.58	SHEEN	23.97	---	---	---	---	---	---	---	---	---	---	---
MW-5	02/12/92	39.55	15.54	0.01	24.02	---	---	---	---	---	---	---	---	---	---	---
MW-5	02/17/92	39.55	13.98	SHEEN	25.57	---	---	---	---	---	---	---	---	---	---	---
MW-5	04/03/92	39.55	13.63	0.04	25.95	---	---	---	---	---	---	---	---	---	---	---
MW-5	04/08/92	39.55	13.17	0.01	26.39	---	---	---	---	---	---	---	---	---	---	---
MW-5	04/14/92	39.55	13.45	0.01	26.11	---	---	---	---	---	---	---	---	---	---	---
MW-5	04/29/92	39.55	13.75	0.07	25.85	---	---	---	---	---	---	---	---	---	---	---
MW-5	05/07/92	39.55	16.15	0.04	23.43	---	---	---	---	---	---	---	---	---	---	---
MW-5	07/03/92	39.55	17.67	0.08	21.94	---	---	---	---	---	---	---	---	---	---	---
MW-5	09/01/92	39.55	17.83	0.50	22.10	---	---	---	---	---	---	---	---	---	---	---
MW-5	10/08/92	39.55	17.86	0.92	22.38	---	---	---	---	---	---	---	---	---	---	---
MW-5	12/31/92	39.55	15.20	SHEEN	24.35	---	---	---	---	---	---	---	---	---	---	---
MW-5	04/21/93	39.55	12.64	0.02	26.93	---	---	---	---	---	---	---	---	---	---	---
MW-5	07/07/93	39.14	(i) 12.68	0.82	27.08	---	---	---	---	---	---	---	---	---	---	---
MW-5	09/21/93	39.14	14.35	SHEEN	24.79	---	---	---	---	---	---	---	---	---	---	---
MW-5	12/17/93	39.14	12.61	0.41	26.84	---	---	---	---	---	---	---	---	---	---	---
MW-5	04/07/94	39.14	30.00	---	9.14	66000	---	3000	1700	250	6800	---	---	---	---	PACE
MW-5	07/06/94	39.14	---	---	---	29000	---	1900	330	63	2700	---	---	---	---	PACE
MW-5	10/07/94	39.14	28.70	---	10.44	250000	---	2600	660	830	5200	---	---	---	4.2	PACE
QC-1 (h)	10/07/94	---	---	---	---	45000	---	2900	540	260	2600	---	---	---	---	PACE
MW-5	01/27/95	39.14	28.70	---	10.44	---	---	---	---	---	---	---	---	---	---	---
MW-5	03/30/95	39.14	28.95	---	10.19	50000	---	7900	2600	520	6400	---	---	---	5.5	ATI
QC-1 (h)	03/30/95	---	---	---	---	43000	---	7900	2500	440	6200	---	---	---	---	ATI
MW-5	06/20/95	39.14	22.54	---	16.60	34000	---	5100	1900	300	3700	---	---	---	---	ATI
QC-1 (h)	06/20/95	---	---	---	---	26000	---	3500	290	ND<25	3300	---	---	---	---	ATI
MW-5	10/03/95	39.14	18.84	---	20.30	12000	---	68	42	11	1600	330	---	---	---	ATI
QC-1 (h)	10/03/95	---	---	---	---	12000	---	46	39	10	1600	320	---	---	---	ATI
MW-5	12/06/95	39.14	19.07	---	20.07	16000	---	1200	93	51	700	600	---	---	---	ATI
MW-5	03/21/96	39.14	7.43	---	31.71	1500	---	89	28	6	250	ND<10	---	---	7.2	SPL
QC-1 (h)	03/21/96	---	---	---	---	1900	---	92	30	7	270	ND<10	---	---	---	SPL

TABLE 1 - SUMMARY OF RESULTS OF GROUNDWATER MONITORING

WELL ID	DATE OF SAMPLING/ MONITORING	CASING ELEVATION (a) (Feet)	DEPTH TO WATER (Feet)	PRODUCT THICKNESS (Feet)	GROUNDWATER ELEVATION (b) (Feet)	TPH-G (ug/l)	TPH-D (ug/l)	B (ug/l)	T (ug/l)	E (ug/l)	X (ug/l)	MTBE (ug/l)	TOG (ug/l)	HVOC (ug/l)	DO (ppm)	LAB
MW-5	06/21/96	39.14	9.87	---	---	3500	---	740	150	19	400	ND<100	---	---	7.1	SPL
QC-1 (h)	06/21/96	---	---	---	---	2700	---	680	140	20	400	ND<50	---	---	---	SPL
MW-5	09/06/96	39.14	10.52	---	28.62	---	---	---	---	---	---	---	---	---	---	---
MW-5	09/09/96	39.14	---	---	---	82000	---	3100	1700	850	9100	ND<2500	---	---	7.5	SPL
QC-1 (h)	09/09/96	---	---	---	---	90000	---	2900	1600	670	6900	ND<2500	---	---	---	SPL
MW-5	12/19/96	39.14	8.62	---	30.52	41000	---	790	820	120	2040	ND<500	---	---	7.7	SPL
QC-1 (h)	12/19/96	---	---	---	---	26000	---	490	430	63	1140	ND<500	---	---	---	SPL
MW-5	03/17/97	39.14	8.22	---	30.92	5500	---	1.9	2.4	ND<1.0	ND<1.0	29	---	---	6.4	SPL
QC-1 (h)	03/17/97	---	---	---	---	6600	---	2.5	2.7	ND<1.0	ND<1.0	28	---	---	---	SPL
MW-5	08/12/97	39.14	12.18	0.22	27.13	33000	---	6400	2400	680	4400	ND<1000	---	---	6.8	SPL
QC-1 (h)	08/12/97	---	---	---	---	36000	---	6100	2500	720	4500	ND<500	---	---	---	SPL
MW-5	12/10/97	39.14	10.78	0.06	28.41	31000	---	3000	2500	560	5100	500	---	---	1.8	SPL
QC-1 (h)	12/10/97	---	---	---	---	37000	---	2900	2500	440	4800	---	---	---	---	SPL
MW-5	03/12/98	39.14	10.11	0.22	29.20	100000	---	1600	870	250	2600	ND<250	---	---	6.1	SPL
MW-5	06/23/98	39.14	10.20	0.02	28.96	27000	---	2500	840	370	2900	ND<250	---	---	2.1	SPL
QC-1 (h)	06/23/98	---	---	---	---	27000	---	2600	840	400	2950	ND<500	---	---	---	SPL
MW-5 (f)	03/31/99	---	---	---	---	---	---	---	---	---	---	---	---	---	---	---
MW-5	08/25/99	39.14	14.69	0.38	24.75	180000	---	2700	400	830	2800	26	---	---	---	SPL
MW-5	03/09/00	39.14	14.83	0.60	24.79	53000	---	12000	2600	1900	9100	ND<5.0	---	---	---	PACE
MW-5 (f)	03/08/01	39.14	---	---	---	---	---	---	---	---	---	---	---	---	---	---

TABLE 1 - SUMMARY OF RESULTS OF GROUNDWATER MONITORING

WELL ID	DATE OF SAMPLING/ MONITORING	CASING ELEVATION (a) (Feet)	DEPTH TO WATER (Feet)	PRODUCT THICKNESS (Feet)	GROUNDWATER ELEVATION (b) (Feet)	TPH-G (ug/l)	TPH-D (ug/l)	B (ug/l)	T (ug/l)	E (ug/l)	X (ug/l)	MTBE (ug/l)	TOG (ug/l)	HVOC (ug/l)	DO (ppm)	LAB
MW-6	10/03/91	41.59	20.73	---	20.86	ND<50	---	0.7	0.8	ND<0.3	1.3	---	---	---	---	SUP
MW-6	10/15/91	41.59	21.20	---	20.39	---	---	---	---	---	---	---	---	---	---	---
MW-6	12/04/91	41.59	21.26	---	20.33	---	---	---	---	---	---	---	---	---	---	---
MW-6	12/16/91	41.59	21.12	---	20.47	---	---	---	---	---	---	---	---	---	---	---
MW-6	01/06/92	41.59	20.29	---	21.30	ND<50	---	ND<0.5	ND<0.5	ND<0.5	1.6	---	---	---	---	ANA
MW-6	01/22/92	41.59	20.12	---	21.47	---	---	---	---	---	---	---	---	---	---	---
MW-6	01/28/92	41.59	20.20	---	21.39	---	---	---	---	---	---	---	---	---	---	---
MW-6	02/05/92	41.59	20.09	---	21.50	---	---	---	---	---	---	---	---	---	---	---
MW-6	02/12/92	41.59	19.15	---	22.44	---	---	---	---	---	---	---	---	---	---	---
MW-6	02/17/92	41.59	18.02	---	23.57	---	---	---	---	---	---	---	---	---	---	---
MW-6	04/03/92	41.59	16.62	---	24.97	---	---	---	---	---	---	---	---	---	---	---
MW-6	04/08/92	41.59	17.06	---	24.53	ND<50	---	0.6	ND<0.5	1	ND<0.5	---	---	---	---	ANA
MW-6	04/14/92	41.59	17.23	---	24.36	---	---	---	---	---	---	---	---	---	---	---
MW-6	04/29/92	41.59	18.12	---	23.47	---	---	---	---	---	---	---	---	---	---	---
MW-6	05/07/92	41.59	18.52	---	23.07	---	---	---	---	---	---	---	---	---	---	---
MW-6	07/03/92	41.59	19.71	---	21.88	ND<50	---	ND<0.5	ND<0.5	ND<0.5	ND<0.5	---	---	---	---	ANA
MW-6	10/08/92	41.59	21.22	---	20.37	ND<50	---	ND<0.5	ND<0.5	ND<0.5	ND<0.5	---	---	---	---	ANA
QC-1 (h)	10/08/92	---	---	---	---	ND<50	---	ND<0.5	ND<0.5	ND<0.5	ND<0.5	---	---	---	---	ANA
MW-6	12/31/92	41.59	21.33	---	20.26	ND<50	---	ND<0.5	ND<0.5	ND<0.5	ND<0.5	---	---	---	---	ANA
MW-6	04/21/93	41.59	16.45	---	25.14	ND<50	---	ND<0.5	ND<0.5	ND<0.5	ND<0.5	---	---	---	---	PACE
MW-6	07/07/93	41.59	18.68	---	22.91	ND<50	---	ND<0.5	ND<0.5	ND<0.5	ND<0.5	---	29	(j)	---	PACE
MW-6	09/21/93	41.59	19.64	---	21.95	ND<50	---	ND<0.5	ND<0.5	ND<0.5	1.6	---	---	---	---	PACE
MW-6	12/17/93	41.59	21.08	---	20.51	---	---	---	---	---	---	---	---	---	---	---
MW-6	12/23/93	41.59	---	---	---	ND<50	---	ND<0.5	0.5	ND<0.5	0.6	---	---	---	---	PACE
MW-6	04/07/94	41.59	21.27	---	20.32	ND<50	---	ND<0.5	ND<0.5	ND<0.5	ND<0.5	---	---	---	6.1	PACE
MW-6	07/06/94	41.59	19.81	---	21.78	ND<50	---	ND<0.5	ND<0.5	ND<0.5	ND<0.5	---	---	---	4.0	PACE
QC-1 (h)	07/06/94	---	---	---	---	ND<50	---	ND<0.5	ND<0.5	ND<0.5	ND<0.5	---	---	---	---	PACE
MW-6	10/07/94	41.59	21.25	---	20.34	ND<50	---	ND<0.5	ND<0.5	ND<0.5	ND<0.5	---	24	(j)	3.5	PACE
MW-6	01/27/95	41.59	12.39	---	29.20	ND<50	---	ND<0.5	ND<0.5	ND<0.5	ND<1	---	---	---	4.2	ATI
MW-6	03/30/95	41.59	11.34	---	30.25	ND<50	---	ND<0.50	ND<0.50	ND<0.50	ND<1.0	---	---	---	6.1	ATI
MW-6	06/20/95	41.59	15.12	---	26.47	ND<50	---	ND<0.50	ND<0.50	ND<0.50	ND<1.0	---	---	---	---	ATI
MW-6	10/03/95	41.59	20.68	---	20.91	ND<50	---	ND<0.50	ND<0.50	ND<0.50	ND<1.0	66	---	---	6.4	ATI
MW-6	12/06/95	41.59	23.77	---	17.82	ND<50	---	ND<0.50	ND<0.50	ND<0.50	ND<1.0	45	---	---	5.7	ATI
MW-6	03/21/96	41.59	11.55	---	30.04	ND<50	---	ND<0.5	ND<1	ND<1	ND<1	41	---	---	9.1	SPL
MW-6	06/21/96	41.59	12.60	---	28.99	ND<50	---	ND<0.5	ND<1	ND<1	ND<1	ND<10	---	---	8.6	SPL
MW-6	09/06/96	41.59	13.25	---	28.34	---	---	---	---	---	---	---	---	---	---	---
MW-6	09/09/96	41.59	---	---	---	ND<50	---	ND<0.5	ND<1.0	ND<1.0	ND<1.0	22/22 (k)	---	---	7.9	SPL

TABLE 1 - SUMMARY OF RESULTS OF GROUNDWATER MONITORING

WELL ID	DATE OF SAMPLING/ MONITORING	CASING ELEVATION (a) (Feet)	DEPTH TO WATER (Feet)	PRODUCT THICKNESS (Feet)	GROUNDWATER ELEVATION (b) (Feet)	TPH-G (ug/l)	TPH-D (ug/l)	B (ug/l)	T (ug/l)	E (ug/l)	X (ug/l)	MTBE (ug/l)	TOG (ug/l)	HVOC (ug/l)	DO (ppm)	LAB
MW-6	12/19/96	41.59	11.45	---	30.14	ND<50	---	ND<0.5	ND<1.0	ND<1.0	ND<1.0	ND<10	---	---	7.7	SPL
MW-6	03/17/97	41.59	10.80	---	30.79	---	---	---	---	---	---	---	---	---	---	---
MW-6	08/12/97	41.59	13.11	---	28.48	---	---	---	---	---	---	---	---	---	---	---
MW-6	12/10/97	41.59	13.84	---	27.75	---	---	---	---	---	---	---	---	---	---	---
MW-6	03/12/98	41.59	11.17	---	30.42	---	---	---	---	---	---	---	---	---	---	---
MW-6	06/23/98	41.59	13.27	---	28.32	---	---	---	---	---	---	---	---	---	---	---
MW-6	03/31/99	41.59	12.91	---	28.68	---	---	---	---	---	---	---	---	---	---	---
MW-6	08/25/99	41.59	15.93	---	25.66	---	---	---	---	---	---	---	---	---	---	---
MW-6	03/09/00	41.59	11.49	---	30.10	---	---	---	---	---	---	---	---	---	---	---
MW-6	03/08/01	41.59	10.81	---	30.78	---	---	---	---	---	---	---	---	---	---	---

TABLE 1 - SUMMARY OF RESULTS OF GROUNDWATER MONITORING

WELL ID	DATE OF SAMPLING/ MONITORING	CASING ELEVATION (a) (Feet)	DEPTH TO WATER (Feet)	PRODUCT THICKNESS (Feet)	GROUNDWATER ELEVATION (b) (Feet)	TPH-G (ug/l)	TPH-D (ug/l)	B (ug/l)	T (ug/l)	E (ug/l)	X (ug/l)	MTBE (ug/l)	TOG (ug/l)	HVOC (ug/l)	DO (ppm)	LAB
MW-7	10/03/91	40.64	14.93	---	25.71	360	---	62	13	3.4	20	---	---	---	---	SUP
MW-7	10/15/91	40.64	15.16	---	25.48	---	---	---	---	---	---	---	---	---	---	---
MW-7	12/04/91	40.64	15.41	---	25.23	---	---	---	---	---	---	---	---	---	---	---
MW-7	12/16/91	40.64	15.21	---	25.43	---	---	---	---	---	---	---	---	---	---	---
MW-7	01/06/92	40.64	14.56	---	26.08	1100	---	170	ND<0.5	24	23	---	---	---	---	ANA
MW-7	01/22/92	40.64	14.63	---	26.01	---	---	---	---	---	---	---	---	---	---	---
MW-7	01/28/92	40.64	14.73	---	25.91	---	---	---	---	---	---	---	---	---	---	---
MW-7	02/05/92	40.64	14.58	---	26.06	---	---	---	---	---	---	---	---	---	---	---
MW-7	02/12/92	40.64	13.94	---	26.70	---	---	---	---	---	---	---	---	---	---	---
MW-7	02/17/92	40.64	13.10	---	27.54	---	---	---	---	---	---	---	---	---	---	---
MW-7	04/03/92	40.64	12.66	---	27.98	---	---	---	---	---	---	---	---	---	---	---
MW-7	04/08/92	40.64	12.77	---	27.87	750	---	150	ND<0.5	23	9.9	---	---	---	---	ANA
MW-7	04/14/92	40.64	13.02	---	27.62	---	---	---	---	---	---	---	---	---	---	---
MW-7	04/29/92	40.64	13.59	---	27.05	---	---	---	---	---	---	---	---	---	---	---
MW-7	05/07/92	40.64	13.95	---	26.69	---	---	---	---	---	---	---	---	---	---	---
MW-7	07/03/92	40.64	14.73	---	25.91	660	---	210	ND<2.5	33	8	---	---	---	---	ANA
MW-7	10/08/92	40.64	15.75	---	24.89	320	---	49	1.4	13	6.2	---	---	---	---	ANA
MW-7	12/31/92	40.64	13.57	---	27.07	900	---	100	ND<2.5	28	4.3	---	---	---	---	ANA
MW-7	04/21/93	40.64	14.56	---	26.08	510	---	83	1.2	10	5.8	---	---	---	---	PACE
MW-7	07/07/93	40.32 (i)	13.40	---	26.92	1100	---	160	2.0	27	4.0	---	---	---	---	PACE
QC-1 (h)	07/07/93	---	---	---	---	1100	---	170	1.9	29	2.8	---	---	---	---	PACE
MW-7	09/21/93	40.32	14.40	---	25.92	690	---	150	3.1	26	5.7	---	---	---	---	PACE
QC-1 (h)	09/21/93	---	---	---	---	640	---	140	1.7	23	2.4	---	---	---	---	PACE
MW-7	12/17/93	40.32	13.65	---	26.67	---	---	---	---	---	---	---	---	---	---	---
MW-7	12/23/93	40.32	---	---	---	250	---	64	1.2	9	1.8	---	---	---	---	PACE
MW-7	04/07/94	40.32	30.62	---	9.70	140	---	32	1.4	ND<0.5	ND<0.5	---	---	---	---	PACE
MW-7	07/06/94	40.32	16.88	---	23.44	410	---	94	1.3	10	3.5	---	---	---	4.4	PACE
MW-7	10/07/94	40.32	25.59	---	14.73	ND<50	---	9.2	ND<0.5	ND<0.5	ND<0.5	---	---	---	4.9	PACE
MW-7	01/27/95	40.32	9.82	---	30.50	810	---	570	3	60	17	---	---	---	0	ATI
QC-1 (h)	01/27/95	---	---	---	---	930	---	620	4	77	21	---	---	---	---	ATI
MW-7	03/30/95	40.32	9.15	---	31.17	180	---	65	0.53	2	ND<1.0	---	---	---	7.8	ATI
MW-7	06/20/95	40.32	11.38	---	28.94	2800	---	980	ND<5.0	ND<5.0	43	---	---	---	---	ATI
MW-7	10/03/95	40.32	29.95	---	10.37	ND<50	---	ND<0.50	ND<0.50	ND<0.50	ND<1.0	ND<5.0	---	---	---	ATI
MW-7	12/06/95	40.32	29.85	---	10.47	ND<50	---	ND<0.50	ND<0.50	ND<0.50	ND<1.0	ND<5.0	---	---	---	ATI
MW-7	03/21/96	40.32	9.76	---	30.56	1000	---	390	2	40	13	ND<10	---	---	7.4	SPL
MW-7	06/21/96	40.32	11.01	---	29.31	ND<250	---	40	ND<5	ND<5	ND<5	ND<50	---	---	7.4	SPL
MW-7	09/06/96	40.32	11.68	---	28.64	---	---	---	---	---	---	---	---	---	---	---

TABLE 1 - SUMMARY OF RESULTS OF GROUNDWATER MONITORING

WELL ID	DATE OF SAMPLING/ MONITORING	CASING ELEVATION (a) (Feet)	DEPTH TO WATER (Feet)	PRODUCT THICKNESS (Feet)	GROUNDWATER ELEVATION (b) (Feet)	TPH-G (ug/l)	TPH-D (ug/l)	B (ug/l)	T (ug/l)	E (ug/l)	X (ug/l)	MTBE (ug/l)	TOG (ug/l)	HVOC (ug/l)	DO (ppm)	LAB
MW-7	09/09/96	40.32	---	---	---	ND<250	---	13	ND<5.0	ND<5.0	ND<5.0	ND<50	---	---	7.2	SPL
MW-7	12/19/96	40.32	10.78	---	29.54	70	---	1.2	ND<1.0	1	ND<1.0	ND<10	---	---	8.3	SPL
MW-7	03/17/97	40.32	9.96	---	30.36	---	---	---	---	---	---	---	---	---	---	---
MW-7	08/12/97	40.32	11.44	---	28.88	---	---	---	---	---	---	---	---	---	---	---
MW-7	12/10/97	40.32	10.42	---	29.90	---	---	---	---	---	---	---	---	---	---	---
MW-7	03/12/98	40.32	9.51	---	30.81	---	---	---	---	---	---	---	---	---	---	---
MW-7	06/23/98	40.32	9.98	---	30.34	---	---	---	---	---	---	---	---	---	---	---
MW-7	03/31/99	40.32	10.38	---	29.94	---	---	---	---	---	---	---	---	---	---	---
MW-7	08/25/99	40.32	12.38	---	27.94	---	---	---	---	---	---	---	---	---	---	---
MW-7	03/09/00	40.32	8.48	---	31.84	---	---	---	---	---	---	---	---	---	---	---
MW-7	03/08/01	40.32	8.37	---	31.95	---	---	---	---	---	---	---	---	---	---	---

TABLE 1 - SUMMARY OF RESULTS OF GROUNDWATER MONITORING

WELL ID	DATE OF SAMPLING/ MONITORING	CASING ELEVATION (a) (Feet)	DEPTH TO WATER (Feet)	PRODUCT THICKNESS (Feet)	GROUNDWATER ELEVATION (b) (Feet)	TPH-G (ug/l)	TPH-D (ug/l)	B (ug/l)	T (ug/l)	E (ug/l)	X (ug/l)	MTBE (ug/l)	TOG (ug/l)	HVOC (ug/l)	DO (ppm)	LAB
MW-8	10/03/91	38.18	22.37	---	15.81	ND<50	---	ND<0.3	0.6	ND<0.3	0.9	---	---	---	---	SUP
MW-8	10/15/91	38.18	22.70	---	15.48	---	---	---	---	---	---	---	---	---	---	---
MW-8	12/04/91	38.18	22.44	---	15.74	---	---	---	---	---	---	---	---	---	---	---
MW-8	12/16/91	38.18	22.47	---	15.71	---	---	---	---	---	---	---	---	---	---	---
MW-8	01/06/92	38.18	21.94	---	16.24	ND<50	---	ND<0.5	ND<0.5	ND<0.5	ND<0.5	---	---	---	---	ANA
MW-8	01/22/92	38.18	21.44	---	16.74	---	---	---	---	---	---	---	---	---	---	---
MW-8	01/28/92	38.18	21.20	---	16.98	---	---	---	---	---	---	---	---	---	---	---
MW-8	02/05/92	38.18	20.88	---	17.30	---	---	---	---	---	---	---	---	---	---	---
MW-8	02/12/92	38.18	20.54	---	17.64	---	---	---	---	---	---	---	---	---	---	---
MW-8	02/17/92	38.18	19.99	---	18.19	---	---	---	---	---	---	---	---	---	---	---
MW-8	04/03/92	38.18	16.75	---	21.43	---	---	---	---	---	---	---	---	---	---	---
MW-8	04/08/92	38.18	16.57	---	21.61	ND<50	---	ND<0.5	ND<0.5	ND<0.5	ND<0.5	---	---	---	---	ANA
MW-8 (f)	04/14/92	38.18	---	---	---	---	---	---	---	---	---	---	---	---	---	---
MW-8	04/29/92	38.18	18.61	---	19.57	---	---	---	---	---	---	---	---	---	---	---
MW-8	05/07/92	38.18	18.41	---	19.77	---	---	---	---	---	---	---	---	---	---	---
MW-8	07/03/92	38.18	20.35	---	17.83	ND<50	---	ND<0.5	ND<0.5	ND<0.5	ND<0.5	---	---	---	---	ANA
MW-8 (f)	10/08/92	38.18	21.74	---	16.44	---	---	---	---	---	---	---	---	---	---	---
MW-8	12/31/92	38.18	19.09	---	19.09	ND<50	---	ND<0.5	ND<0.5	ND<0.5	ND<0.5	---	---	---	---	ANA
MW-8	04/21/93	38.18	18.92	---	19.26	ND<50	---	ND<0.5	ND<0.5	ND<0.5	ND<0.5	---	---	---	---	PACE
MW-8	07/07/93	38.18	17.76	---	20.42	ND<50	---	ND<0.5	ND<0.5	ND<0.5	ND<0.5	---	---	---	---	PACE
MW-8	09/21/93	38.18	19.71	---	18.47	ND<50	---	2.9	2.2	2	7.1	---	---	---	---	PACE
MW-8	12/17/93	38.18	21.33	---	16.85	---	---	---	---	---	---	---	---	---	---	---
MW-8	12/23/93	38.18	---	---	---	ND<50	---	ND<0.5	ND<0.5	ND<0.5	0.6	---	---	---	---	PACE
MW-8	04/07/94	38.18	21.51	---	16.67	ND<50	---	ND<0.5	ND<0.5	ND<0.5	ND<0.5	---	---	---	6.6	PACE
MW-8	07/06/94	38.18	17.41	---	20.77	ND<50	---	ND<0.5	ND<0.5	ND<0.5	ND<0.5	---	---	---	4.4	PACE
MW-8	10/07/94	38.18	19.20	---	18.98	ND<50	---	ND<0.5	ND<0.5	ND<0.5	ND<0.5	---	---	---	3.7	PACE
MW-8	01/27/95	38.18	12.25	---	25.93	ND<50	---	ND<0.5	ND<0.5	ND<0.5	ND<1	---	---	---	2.9	ATI
MW-8	03/30/95	38.18	10.35	---	27.83	ND<50	---	ND<0.50	ND<0.50	ND<0.50	ND<1.0	---	---	---	8.3	ATI
MW-8	06/20/95	38.18	13.37	---	24.81	ND<50	---	ND<0.50	ND<0.50	ND<0.50	ND<1.0	---	---	---	6.9	ATI
MW-8 (f)	10/03/95	38.18	---	---	---	---	---	---	---	---	---	---	---	---	---	---
MW-8	12/06/95	38.18	18.42	---	19.76	ND<50	---	ND<0.50	ND<0.50	ND<0.50	ND<1.0	47	---	---	5.3	ATI
MW-8 (f)	03/21/96	38.18	---	---	---	---	---	---	---	---	---	---	---	---	---	---
MW-8	06/21/96	38.18	13.03	---	25.15	ND<50	---	ND<0.5	ND<1	ND<1	ND<1	ND<10	---	---	7.0	SPL
MW-8	09/06/96	38.18	13.70	---	24.48	---	---	---	---	---	---	---	---	---	---	---
MW-8	09/09/96	38.18	---	---	---	ND<50	---	ND<0.5	ND<1.0	ND<1.0	ND<1.0	ND<10	---	---	7.0	SPL
MW-8	12/19/96	38.18	11.93	---	26.25	ND<50	---	ND<0.5	ND<1.0	ND<1.0	ND<1.0	ND<10	---	---	7.6	SPL
MW-8	03/17/97	38.18	11.29	---	26.89	---	---	---	---	---	---	---	---	---	---	---

TABLE 1 - SUMMARY OF RESULTS OF GROUNDWATER MONITORING

WELL ID	DATE OF SAMPLING/ MONITORING	CASING ELEVATION (a) (Feet)	DEPTH TO WATER (Feet)	PRODUCT THICKNESS (Feet)	GROUNDWATER ELEVATION (b) (Feet)	TPH-G (ug/l)	TPH-D (ug/l)	B (ug/l)	T (ug/l)	E (ug/l)	X (ug/l)	MTBE (ug/l)	TOG (ug/l)	HVOC (ug/l)	DO (ppm)	LAB
MW-8	08/12/97	38.18	13.73	---	24.45	---	---	---	---	---	---	---	---	---	---	---
MW-8	12/10/97	38.18	11.88	---	26.30	---	---	---	---	---	---	---	---	---	---	---
MW-8	03/12/98	38.18	11.89	---	26.29	---	---	---	---	---	---	---	---	---	---	---
MW-8	06/23/98	38.18	11.33	---	26.85	---	---	---	---	---	---	---	---	---	---	---
MW-8	03/31/99	38.18	12.68	---	25.50	---	---	---	---	---	---	---	---	---	---	---
MW-8	08/25/99	38.18	14.93	---	23.25	---	---	---	---	---	---	---	---	---	---	---
MW-8	03/09/00	38.18	9.14	---	29.04	---	---	---	---	---	---	---	---	---	---	---
MW-8	03/08/01	38.18	8.41	---	29.77	---	---	---	---	---	---	---	---	---	---	---

TABLE 1 - SUMMARY OF RESULTS OF GROUNDWATER MONITORING

WELL ID	DATE OF SAMPLING/ MONITORING	CASING ELEVATION (a) (Feet)	DEPTH TO WATER (Feet)	PRODUCT THICKNESS (Feet)	GROUNDWATER ELEVATION (b) (Feet)	TPH-G (ug/l)	TPH-D (ug/l)	B (ug/l)	T (ug/l)	E (ug/l)	X (ug/l)	MTBE (ug/l)	TOG (ug/l)	HVOC (ug/l)	DO (ppm)	LAB
MW-9	10/03/91	41.25	14.12	--	27.13	ND<50	--	ND<0.3	0.4	ND<0.3	ND<0.3	--	--	--	--	SUP
MW-9	10/15/91	41.25	14.27	--	26.98	--	--	--	--	--	--	--	--	--	--	--
MW-9	12/04/91	41.25	13.84	--	27.41	--	--	--	--	--	--	--	--	--	--	--
MW-9	12/16/91	41.25	14.18	--	27.07	--	--	--	--	--	--	--	--	--	--	--
MW-9	01/06/92	41.25	13.42	--	27.83	ND<50	--	ND<0.5	ND<0.5	ND<0.5	0.9	--	--	--	--	ANA
MW-9	01/22/92	41.25	13.75	--	27.50	--	--	--	--	--	--	--	--	--	--	--
MW-9	01/28/92	41.25	14.76	--	26.49	--	--	--	--	--	--	--	--	--	--	--
MW-9	02/05/92	41.25	13.38	--	27.87	--	--	--	--	--	--	--	--	--	--	--
MW-9	02/12/92	41.25	11.86	--	29.39	--	--	--	--	--	--	--	--	--	--	--
MW-9	02/17/92	41.25	10.78	--	30.47	--	--	--	--	--	--	--	--	--	--	--
MW-9	04/03/92	41.25	11.63	--	29.62	--	--	--	--	--	--	--	--	--	--	--
MW-9	04/08/92	41.25	12.25	--	29.00	ND<50	--	ND<0.5	ND<0.5	ND<0.5	ND<0.5	--	--	--	--	ANA
MW-9	04/14/92	41.25	12.32	--	28.93	--	--	--	--	--	--	--	--	--	--	--
MW-9	04/29/92	41.25	13.07	--	28.18	--	--	--	--	--	--	--	--	--	--	--
MW-9	05/07/92	41.25	14.43	--	26.82	--	--	--	--	--	--	--	--	--	--	--
MW-9	07/03/92	41.25	13.85	--	27.40	ND<50	--	ND<0.5	ND<0.5	ND<0.5	ND<0.5	--	--	--	--	ANA
MW-9	10/08/92	41.25	14.89	--	26.36	ND<50	--	ND<0.5	ND<0.5	ND<0.5	ND<0.5	--	--	--	--	ANA
MW-9	12/31/92	41.25	11.90	--	29.35	ND<50	--	ND<0.5	ND<0.5	ND<0.5	ND<0.5	--	--	--	--	ANA
MW-9	04/21/93	41.25	13.68	--	27.57	ND<50	--	ND<0.5	ND<0.5	ND<0.5	ND<0.5	--	--	--	--	PACE
MW-9	07/07/93	41.25	13.12	--	28.13	ND<50	--	ND<0.5	ND<0.5	ND<0.5	ND<0.5	--	--	--	--	PACE
MW-9	09/21/93	41.25	14.00	--	27.25	ND<50	--	ND<0.5	ND<0.5	ND<0.5	0.9	--	--	--	--	PACE
MW-9	12/17/93	41.25	12.98	--	28.27	--	--	--	--	--	--	--	--	--	--	--
MW-9	12/23/93	41.25	--	--	--	ND<50	--	ND<0.5	ND<0.5	ND<0.5	0.9	--	--	--	--	PACE
MW-9	04/07/94	41.25	13.24	--	28.01	ND<50	--	ND<0.5	ND<0.5	ND<0.5	ND<0.5	--	--	--	4.7	PACE
MW-9	07/06/94	41.25	13.77	--	27.48	ND<50	--	ND<0.5	ND<0.5	ND<0.5	ND<0.5	--	--	--	3.9	PACE
MW-9	10/07/94	41.25	14.60	--	26.65	ND<50	--	ND<0.5	ND<0.5	ND<0.5	ND<0.5	--	--	--	3.0	PACE
MW-9	01/27/95	41.25	8.47	--	32.78	ND<50	--	ND<0.5	ND<0.5	ND<0.5	ND<1	--	--	--	2.5	ATI
MW-9	03/30/95	41.25	8.19	--	33.06	ND<50	--	ND<0.50	ND<0.50	ND<0.50	ND<1.0	--	--	--	8.4	ATI
MW-9	06/20/95	41.25	11.25	--	30.00	ND<50	--	ND<0.50	ND<0.50	ND<0.50	ND<1.0	--	--	--	8.1	ATI
MW-9	10/03/95	41.25	14.68	--	26.57	ND<50	--	ND<0.50	ND<0.50	ND<0.50	ND<1.0	ND<5.0	--	--	6.0	ATI
MW-9	12/06/95	41.25	16.07	--	25.18	ND<50	--	ND<0.50	ND<0.50	ND<0.50	ND<1.0	46	--	--	5.4	ATI
MW-9	03/21/96	41.25	9.60	--	31.65	ND<50	--	ND<0.5	ND<1	ND<1	ND<1	ND<10	--	--	8.0	SPL
MW-9	06/21/96	41.25	10.86	--	30.39	ND<50	--	ND<0.5	ND<1	ND<1	ND<1	ND<10	--	--	7.8	SPL
MW-9	09/06/96	41.25	11.52	--	29.73	--	--	--	--	--	--	--	--	--	--	--
MW-9	09/09/96	41.25	--	--	--	ND<50	--	ND<0.5	ND<1.0	ND<1.0	ND<1.0	20/21 (k)	--	--	7.3	SPL
MW-9	12/19/96	41.25	10.43	--	30.82	ND<50	--	ND<0.5	ND<1.0	ND<1.0	ND<1.0	ND<10	--	--	7.3	SPL
MW-9	03/17/97	41.25	9.87	--	31.38	--	--	--	--	--	--	--	--	--	--	--

TABLE 1 - SUMMARY OF RESULTS OF GROUNDWATER MONITORING

WELL ID	DATE OF SAMPLING/ MONITORING	CASING ELEVATION (a) (Feet)	DEPTH TO WATER (Feet)	PRODUCT THICKNESS (Feet)	GROUNDWATER ELEVATION (b) (Feet)	TPH-G (ug/l)	TPH-D (ug/l)	B (ug/l)	T (ug/l)	E (ug/l)	X (ug/l)	MTBE (ug/l)	TOG (ug/l)	HVOC (ug/l)	DO (ppm)	LAB
MW-9	08/12/97	41.25	11.44	---	29.81	---	---	---	---	---	---	---	---	---	---	---
MW-9	12/10/97	41.25	10.44	---	30.81	---	---	---	---	---	---	---	---	---	---	---
MW-9	03/12/98	41.25	9.50	---	31.75	---	---	---	---	---	---	---	---	---	---	---
MW-9	06/23/98	41.25	10.06	---	31.19	---	---	---	---	---	---	---	---	---	---	---
MW-9	03/31/99	41.25	9.06	---	32.19	---	---	---	---	---	---	---	---	---	---	---
MW-9	08/25/99	41.25	12.00	---	29.25	---	---	---	---	---	---	---	---	---	---	---
MW-9	03/09/00	41.25	10.57	---	30.68	---	---	---	---	---	---	---	---	---	---	---
MW-9	03/08/01	41.25	9.73	---	31.52	---	---	---	---	---	---	---	---	---	---	---

TABLE 1 - SUMMARY OF RESULTS OF GROUNDWATER MONITORING

WELL ID	DATE OF SAMPLING/ MONITORING	CASING ELEVATION (a) (Feet)	DEPTH TO WATER (Feet)	PRODUCT THICKNESS (Feet)	GROUNDWATER ELEVATION (b) (Feet)	TPH-G (ug/l)	TPH-D (ug/l)	B (ug/l)	T (ug/l)	E (ug/l)	X (ug/l)	MTBE (ug/l)	TOG (ug/l)	HVOC (ug/l)	DO (ppm)	LAB
QC-2 (I)	10/08/92	---	---	---	---	ND<50	---	ND<0.5	ND<0.5	ND<0.5	ND<0.5	---	---	---	---	ANA
QC-2 (I)	12/31/92	---	---	---	---	ND<50	---	ND<0.5	ND<0.5	ND<0.5	ND<0.5	---	---	---	---	ANA
QC-2 (I)	04/21/93	---	---	---	---	---	---	---	---	---	---	---	---	ND	---	PACE
QC-2 (I)	07/07/93	---	---	---	---	ND<50	---	ND<0.5	ND<0.5	ND<0.5	0.6	---	---	---	---	PACE
QC-2 (I)	09/21/93	---	---	---	---	ND<50	---	ND<0.5	ND<0.5	ND<0.5	ND<0.5	---	---	---	---	PACE
QC-2 (I)	12/23/93	---	---	---	---	ND<50	---	ND<0.5	ND<0.5	ND<0.5	ND<0.5	---	---	---	---	PACE
QC-2 (I)	04/07/94	---	---	---	---	ND<50	---	ND<0.5	ND<0.5	ND<0.5	ND<0.5	---	---	---	---	PACE
QC-2 (I)	07/06/94	---	---	---	---	ND<50	---	ND<0.5	ND<0.5	ND<0.5	ND<0.5	---	---	---	---	PACE
QC-2 (I)	10/07/94	---	---	---	---	ND<50	---	ND<0.5	ND<0.5	ND<0.5	ND<0.5	---	---	---	---	PACE
QC-2 (I)	01/27/95	---	---	---	---	ND<50	---	ND<0.5	0.5	ND<0.5	ND<1	---	---	---	---	ATI
QC-2 (I)	03/30/95	---	---	---	---	ND<50	---	ND<0.50	ND<0.50	ND<0.50	ND<1.0	---	---	---	---	ATI
QC-2 (I)	06/20/95	---	---	---	---	ND<50	---	ND<0.50	ND<0.50	ND<0.50	ND<1.0	---	---	---	---	ATI
QC-2 (I)	10/03/95	---	---	---	---	ND<50	---	ND<0.50	ND<0.50	ND<0.50	ND<1.0	ND<5.0	---	---	---	ATI
QC-2 (I)	12/06/95	---	---	---	---	ND<50	---	ND<0.50	ND<0.50	ND<0.50	ND<1.0	ND<5.0	---	---	---	ATI
QC-2 (I)	03/21/96	---	---	---	---	ND<50	---	ND<0.5	ND<1	ND<1	ND<1	ND<10	---	---	---	SPL
QC-2 (I)	06/21/96	---	---	---	---	ND<50	---	ND<0.5	ND<1	ND<1	ND<1	ND<10	---	---	---	SPL

TABLE 1 - SUMMARY OF RESULTS OF GROUNDWATER MONITORING

ABBREVIATIONS:

TPH-G	Total petroleum hydrocarbons as gasoline
TPH-D	Total petroleum hydrocarbons as diesel
B	Benzene
T	Toluene
E	Ethylbenzene
X	Total xylenes
MTBE	Methyl tert butyl ether
TOG	Total oil and grease
HVOC	Halogenated volatile organic compounds
DO	Dissolved oxygen
ug/l	Micrograms per liter
ppm	Parts per million
---	Not analyzed/measured/applicable
ND	Not detected above reported detection limit
SUP	Superior Analytical Laboratory
ANA	Anamatrix, Inc.
PACE	Pace, Inc.
ATI	Analytical Technologies, Inc.
SPL	Southern Petroleum Laboratories

NOTES:

- (a) Top of casing elevations surveyed in feet above mean sea level, relative to the NGVD (1929).
- (b) Groundwater elevations adjusted assuming a specific gravity of 0.75 for free product.
- (c) Well destroyed during tank removal in November 1990.
- (d) Methylene chloride.
- (e) 1,2-Dichloroethane.
- (f) Well inaccessible.
- (g) Sample collected from MW-2 for TPH-D analysis received in laboratory 7 days after collection; sample exceeded EPA recommended holding time for TPH-D on a water matrix.
- (h) Blind duplicate.
- (i) Top of casing lowered.
- (j) A copy of the documentation for this data is included in Appendix C of Alisto report 10-014-07-001.
- (k) EPA Methods 8020/8260 used.
- (l) Travel blank.

TABLE 1 - SUMMARY OF RESULTS OF GROUNDWATER MONITORING

WELL ID	DATE OF MONITORING	TOP OF BOX ELEVATION (Feet)	DEPTH TO WATER (Feet)	GROUNDWATER ELEVATION (Feet)	TPH-G (ug/l)	TPH-D (ug/l)	TPH-MO (ug/l)	B (ug/l)	T (ug/l)	E (ug/l)	X (ug/l)	MTBE (ug/l)	LAB
S-1	03/30/95	38.31	6.09	32.22	---	---	---	---	---	---	---	---	---
S-1	06/20/95	38.31	7.30	31.01	---	---	---	---	---	---	---	---	---
S-1	12/06/95	38.31	11.64	26.67	---	---	---	---	---	---	---	---	---
S-1	03/21/96	38.31	6.87	31.44	---	---	---	---	---	---	---	---	---
S-1	06/21/96	38.31	8.65	29.66	---	---	---	---	---	---	---	---	---
S-1	09/06/96	38.31	10.50	27.81	---	---	---	---	---	---	---	---	---
S-1	12/19/96	38.31	8.24	30.07	---	---	---	---	---	---	---	---	---
S-1	03/17/97	38.31	7.26	31.05	---	---	---	---	---	---	---	---	---
S-1	06/11/97	38.31	10.69	27.62	---	---	---	---	---	---	---	---	---
S-1	09/17/97	38.31	10.26	28.05	---	---	---	---	---	---	---	---	---
S-1	12/11/97	38.31	6.96	31.35	---	---	---	---	---	---	---	---	---
S-1	03/12/98	38.31	6.00	32.31	25000	2500	510	250	820	670	5000	ND<125	SEQ
DUP (c)	03/12/98	---	---	---	26000	---	---	250	840	720	5100	ND<125	SEQ
S-1	06/23/98	38.31	6.31	32.00	ND<1000	230	ND<500	280	14	23	15	6100/7800	(d) SEQ
S-1	09/01/99	38.31	9.17	29.14	26000	2300	ND<500	370	620	1300	33	1400/120	(d) SEQ
S-1	12/30/98	38.31	8.99	29.32	29900	1970	334	174	732	1680	5740	182	(d) SEQ
S-1	03/31/99	38.31	7.84	30.47	14200	1150	279	1360	260	1070	3580	ND<500/90	(d) SEQ
S-1	03/09/00	38.30	6.21	32.09	1230 (f)	1200	ND<250	21.2 (f)	115 (f)	116 (f)	411 (f)	45.1 (f)	(f) SEQ
S-1	03/08/01	38.30	5.84	32.46	2940	1390	---	49.6	52.9	21.8	749	87.6	SEQ

TABLE 1 - SUMMARY OF RESULTS OF GROUNDWATER MONITORING

WELL ID	DATE OF MONITORING	TOP OF BOX ELEVATION (Feet)	DEPTH TO WATER (a) (Feet)	GROUNDWATER ELEVATION (Feet)	TPH-G (ug/l) (b)	TPH-D (ug/l)	TPH-MO (ug/l)	B (ug/l)	T (ug/l)	E (ug/l)	X (ug/l)	MTBE (ug/l)	LAB
S-2	03/30/95	38.79	7.86	30.93	---	---	---	---	---	---	---	---	---
S-2	06/20/95	38.79	9.51	29.28	---	---	---	---	---	---	---	---	---
S-2	12/06/95	38.79	10.52	28.27	---	---	---	---	---	---	---	---	---
S-2	03/21/96	38.79	8.60	30.19	---	---	---	---	---	---	---	---	---
S-2	06/21/96	38.79	9.95	28.84	---	---	---	---	---	---	---	---	---
S-2	09/06/96	38.79	10.50	28.29	---	---	---	---	---	---	---	---	---
S-2	12/19/96	38.79	9.40	29.39	---	---	---	---	---	---	---	---	---
S-2	03/17/97	38.79	9.82	28.97	---	---	---	---	---	---	---	---	---
S-2	06/11/97	38.79	10.18	28.61	---	---	---	---	---	---	---	---	---
S-2	09/17/97	38.79	9.90	28.89	---	---	---	---	---	---	---	---	---
S-2	12/11/97	38.79	8.27	30.52	---	---	---	---	---	---	---	---	---
S-2	03/12/98	38.79	7.97	30.82	1100	---	---	830	48	ND<10	ND<10	4700/4800	(d) SEQ
S-2	06/23/98	38.79	8.20	30.59	720	---	---	46	6.8	50	68	50/8.8	(d) SEQ
DUP (c)	06/23/98	---	---	---	810	---	---	48	7.1	50	70	49/8.8	(d) SEQ
S-2	09/01/99	38.79	9.85	28.94	ND<2000	---	---	170	ND<20	ND<20	ND<20	9300/12000	(d) SEQ
S-2	12/30/98	38.79	9.84	28.95	ND<5000	---	---	369	ND<50	ND<50	ND<50	9300/12000	(d) SEQ
S-2	03/31/99	38.79	8.67	30.12	ND<2000	---	---	234	ND<20	27.4	36.9	49200/53000	(d) SEQ
S-2	03/09/00	38.78	7.88	30.90	2670	630	ND<250	1190	(f) 62.7	84.1	125	29200/31400	(d),(f) SEQ
S-2	03/08/01	38.78	8.57	30.21	ND<2500	ND<51.3	---	318	45.7	53.5	88.5	15500/17500	(d) SEQ

TABLE 1 - SUMMARY OF RESULTS OF GROUNDWATER MONITORING

WELL ID	DATE OF MONITORING	TOP OF BOX ELEVATION (Feet)	DEPTH TO WATER (Feet) (a)	GROUNDWATER ELEVATION (Feet) (b)	TPH-G (ug/l)	TPH-D (ug/l)	TPH-MO (ug/l)	B (ug/l)	T (ug/l)	E (ug/l)	X (ug/l)	MTBE (ug/l)	LAB
S-3	03/30/95	37.33	7.06	30.27	---	---	---	---	---	---	---	---	---
S-3	06/20/95	37.33	8.15	29.18	---	---	---	---	---	---	---	---	---
S-3	12/06/95	37.33	10.53	26.80	---	---	---	---	---	---	---	---	---
S-3	03/21/96	37.33	7.32	30.01	---	---	---	---	---	---	---	---	---
S-3	06/21/96	37.33	8.85	28.48	---	---	---	---	---	---	---	---	---
S-3	09/06/96	37.33	10.10	27.23	---	---	---	---	---	---	---	---	---
S-3	12/19/96	37.33	8.36	28.97	---	---	---	---	---	---	---	---	---
S-3	03/17/97	37.33	8.57	28.76	---	---	---	---	---	---	---	---	---
S-3	06/11/97	37.33	9.26	28.07	---	---	---	---	---	---	---	---	---
S-3	09/17/97	37.33	9.62	27.71	---	---	---	---	---	---	---	---	---
S-3	12/11/97	37.33	7.34	29.99	---	---	---	---	---	---	---	---	---
S-3	03/12/98	37.33	5.75	31.58	29000	---	---	840	810	1700	6000	ND<250	SEQ
S-3	06/23/98	37.33	5.98	31.35	3800	---	---	90	220	240	1400	ND<50	SEQ
S-3	09/01/99	---	---	---	9200	---	---	420	110	800	1700	110/ND<50	(d) SEQ
S-3	12/30/98	37.33	9.11	28.22	7660	---	---	240	103	410	834	64.9	SEQ
S-3	03/31/99	37.33	7.48	29.85	2070	---	---	195	10	ND<5.0	48.6	354/64.6	(d) SEQ
S-3	03/09/00	37.30	6.25	31.05	2290	(f) 1600	ND<250	84.5	(f) 17	(f) 104	(f) 105	(f) 29.3	(f) SEQ
S-3	03/08/01	37.30	8.17	29.13	19400	1720	---	465	772	1230	3830	160	SEQ
S-4	03/08/01	39.06	8.44	30.62	20100	5840	---	5210	105	381	281	2520	SEQ
BW-A	03/09/00	---	3.99	---	---	---	---	---	---	---	---	---	---
BW-A	03/08/01	---	6.38	---	ND<2500	1370	---	46.6	ND<25	ND<25	ND<25	10600/11700	(d) SEQ
EB (e)	03/12/98	---	---	---	ND<50	ND<50	---	ND<0.50	ND<0.50	ND<0.50	ND<0.50	ND<2.5	SEQ
EB (e)	06/23/98	---	---	---	ND<50	---	---	ND<0.50	ND<0.50	ND<0.50	ND<0.50	ND<2.5	SEQ

TABLE 1 - SUMMARY OF RESULTS OF GROUNDWATER MONITORING

ABBREVIATIONS:

TPH-G	Total petroleum hydrocarbons as gasoline
TPH-D	Total petroleum hydrocarbons as diesel
PH-MO	Total petroleum hydrocarbons as motor oil
B	Benzene
T	Toluene
E	Ethylbenzene
X	Total xylenes
MTBE	Methyl tert butyl ether
ug/l	Micrograms per liter
---	Not analyzed/measured/applicable
ND	Not detected above reported detection limit
SEQ	Sequoia Analytical

NOTES:

- (a) Top of box elevations surveyed relative to 1929 NGVD. Measured in feet above mean sea level.
- (b) Groundwater elevations in feet above mean sea level.
- (c) Blind duplicate.
- (d) EPA Methods 8020/8260 used for MTBE analysis.
- (e) Trip blank.
- (f) This sample was analyzed outside of EPA recommended hold time.

Site was resurveyed on February 3, 2000 by Virgil Chavez Land Surveying of Vallejo, CA.

TABLE 2 - SUMMARY OF RESULTS OF GROUNDWATER MONITORING

WELL ID	DATE OF MONITORING	CASING ELEVATION (Feet)	(a)	DEPTH TO WATER (Feet)	PRODUCT THICKNESS (Feet)	GROUNDWATER ELEVATION (Feet)	(b)	TPH-G (ug/l)	B (ug/l)	T (ug/l)	E (ug/l)	X (ug/l)	MTBE (ug/l)
C-1	07/14/92	38.41		27.61	---	10.80		---	---	---	---	---	---
C-1	10/08/92	38.41		24.44	---	13.97		---	---	---	---	---	---
C-1	09/21/93	38.41		21.42	---	16.99		---	---	---	---	---	---
C-1	03/30/95	38.41		12.02	---	26.39		---	---	---	---	---	---
C-1	06/20/95	38.41		14.40	---	24.01		---	---	---	---	---	---
C-1	03/21/96	38.41		11.65	---	26.76		---	---	---	---	---	---
C-1	09/06/96	38.41		16.75	---	21.66		---	---	---	---	---	---
C-1	12/19/96	38.41		13.98	---	24.43		---	---	---	---	---	---
C-1	03/17/97	38.41		12.78	---	25.63		---	---	---	---	---	---
C-1	06/11/97	38.41		15.16	---	23.25		---	---	---	---	---	---
C-1	09/17/97	38.41		16.94	---	21.47		---	---	---	---	---	---
C-1	12/10/97	38.41		13.18	---	25.23		---	---	---	---	---	---
C-1	03/12/98	38.41		9.49	---	28.92		---	---	---	---	---	---
C-1	06/23/98	38.41		10.22	---	28.19		1300	650	6.9	22	6.5	290
C-1	09/01/98	38.41		16.98	---	21.43		270	6.0	ND<2.5	ND<2.5	ND<2.5	950
C-1	12/30/98	38.41		16.12	---	22.29		2020	578	ND<5.0	ND<5.0	<5.0	1720
C-1	03/31/99	38.41		13.88	---	24.53		2140	776	5.89	ND<5.0	5.15	1170
C-1	03/09/00	38.41		7.13	---	31.28		3300	2500	28	37	ND<25	1700
C-1	03/08/01	38.41		7.96	---	30.45		2570	1040	7.93	12	ND<5.0	1470

TABLE 2 - SUMMARY OF RESULTS OF GROUNDWATER MONITORING

WELL ID	DATE OF MONITORING	CASING ELEVATION (Feet)	(a)	DEPTH TO WATER (Feet)	PRODUCT THICKNESS (Feet)	GROUNDWATER ELEVATION (Feet)	(b)	TPH-G (ug/l)	B (ug/l)	T (ug/l)	E (ug/l)	X (ug/l)	MTBE (ug/l)
C-2	07/14/92	37.47		---	---	---		---	---	---	---	---	---
C-2	10/08/92	37.47		---	---	---		---	---	---	---	---	---
C-2	09/21/93	37.47		26.29	---	11.18		---	---	---	---	---	---
C-2	03/30/95	37.47		17.18	---	20.29		---	---	---	---	---	---
C-2	06/20/95	37.47		18.95	---	18.52		---	---	---	---	---	---
C-2	03/21/96	37.47		16.17	---	21.30		---	---	---	---	---	---
C-2	09/06/96	37.47		21.14	0.04	16.36		---	---	---	---	---	---
C-2	12/19/96	37.47		17.55	0.03	19.94		---	---	---	---	---	---
C-2	03/17/97	37.47		18.59	---	18.88		---	---	---	---	---	---
C-2	06/11/97	37.47		21.30	---	16.17		---	---	---	---	---	---
C-2	09/17/97	37.47		23.14	---	14.33		---	---	---	---	---	---
C-2	12/10/97	37.47		17.21	---	20.26		---	---	---	---	---	---
C-2	03/12/98	37.47		14.17	---	23.30		---	---	---	---	---	---
C-2	06/23/98	37.47		14.82	---	22.65		1100000	6800	5100	13000	38000	ND<1000
C-2	09/01/98	37.47		21.78	---	15.69		9700	300	8.2	6.2	250	3700
C-2	12/30/98	37.47		21.86	---	15.61		110000	4790	1300	841	5570	2420
C-2	03/31/99	37.47		16.90	---	20.57		48000	4800	1110	1520	5450	2160
C-2	03/09/00	37.47		12.20	---	25.27		26000	4800	930	1200	4400	1800
C-2	03/08/01	37.47		16.94	---	20.53		42300	3930	828	2010	5180	1660

TABLE 2 - SUMMARY OF RESULTS OF GROUNDWATER MONITORING

WELL ID	DATE OF MONITORING	CASING ELEVATION (Feet)	(a)	DEPTH TO WATER (Feet)	PRODUCT THICKNESS (Feet)	GROUNDWATER ELEVATION (Feet)	(b)	TPH-G (ug/l)	B (ug/l)	T (ug/l)	E (ug/l)	X (ug/l)	MTBE (ug/l)
C-3	07/14/92	38.37		27.87	---	10.50		---	---	---	---	---	---
C-3	10/08/92	38.37		28.55	---	9.82		---	---	---	---	---	---
C-3	09/21/93	38.37		26.22	---	12.15		---	---	---	---	---	---
C-3	03/30/95	38.37		18.42	---	19.95		---	---	---	---	---	---
C-3	06/20/95	38.37		19.79	---	18.58		---	---	---	---	---	---
C-3	03/21/96	38.37		17.85	---	20.52		---	---	---	---	---	---
C-3	09/06/96	38.37		21.63	---	16.74		---	---	---	---	---	---
C-3	12/19/96	38.37		22.30	---	16.07		---	---	---	---	---	---
C-3	03/17/97	38.37		18.95	---	19.42		---	---	---	---	---	---
C-3	06/11/97	38.37		21.15	---	17.23		---	---	---	---	---	---
C-3	09/17/97	38.37		22.41	---	15.96		---	---	---	---	---	---
C-3	12/10/97	38.37		22.26	---	16.11		---	---	---	---	---	---
C-3	03/12/98	38.37		18.35	---	20.02		---	---	---	---	---	---
C-3	06/23/98	38.37		19.04	---	19.33		ND<50	ND<0.5	ND<0.5	ND<0.5	ND<0.5	ND<2.5
C-3	09/01/98	38.37		19.97	---	18.40		200	6.8	0.31	0.52	2.0	ND<2.5
C-3	12/30/98	38.37		21.31	---	17.06		ND<50	ND<0.5	ND<0.5	ND<0.5	ND<0.5	ND<2.0
C-3	03/31/99	38.37		17.77	---	20.60		ND<50	ND<0.5	ND<0.5	ND<0.5	ND<0.5	12.6
C-3	03/09/00	38.37		17.10	---	21.27		99	6.9	0.8	0.89	3.8	12
C-3	03/08/01	38.37		17.67	---	20.70		ND<50	0.873	<0.5	<0.5	<0.5	3.24

TABLE 2 - SUMMARY OF RESULTS OF GROUNDWATER MONITORING

WELL ID	DATE OF MONITORING	CASING ELEVATION (Feet)	(a)	DEPTH TO WATER (Feet)	PRODUCT THICKNESS (Feet)	GROUNDWATER ELEVATION (Feet)	(b)	TPH-G (ug/l)	B (ug/l)	T (ug/l)	E (ug/l)	X (ug/l)	MTBE (ug/l)
C-4	07/14/92	36.49		26.89	---	9.60		---	---	---	---	---	---
C-4	10/08/92	36.49		27.79	---	8.70		---	---	---	---	---	---
C-4	09/21/93	36.49		25.51	---	10.98		---	---	---	---	---	---
C-4	03/30/95	36.49		14.86	---	21.63		---	---	---	---	---	---
C-4	06/20/95	36.49		16.90	---	19.59		---	---	---	---	---	---
C-4	03/21/96	36.49		14.10	---	22.39		---	---	---	---	---	---
C-4	09/06/96	36.49		20.13	---	16.36		---	---	---	---	---	---
C-4	12/19/96	36.49		16.92	---	19.57		---	---	---	---	---	---
C-4	03/17/97	36.49		17.40	---	19.09		---	---	---	---	---	---
C-4	06/11/97	36.49		18.34	---	18.15		---	---	---	---	---	---
C-4	09/17/97	36.49		21.46	---	15.03		---	---	---	---	---	---
C-4	12/10/97	36.49		16.65	---	19.84		---	---	---	---	---	---
C-4	03/12/98	36.49		16.59	---	19.90		---	---	---	---	---	---
C-4	06/23/98	36.49		17.02	---	19.47		27000	1600	160	180	690	100
C-4	09/01/98	36.49		21.45	---	15.04		520	14	2.3	ND<0.50	4.8	61
C-4	12/30/98	36.49		21.42	---	15.07		122	14.1	1.86	ND<1.0	3.61	349
C-4	03/31/99	36.49		15.20	---	21.29		20300	4450	443	1000	2130	1320
C-4	03/09/00	36.49		13.36	---	23.13		8300	2600	270	510	1400	650
C-4	03/08/01	36.49		16.62	---	19.87		9080	2260	229	395	1060	718

TABLE 2 - SUMMARY OF RESULTS OF GROUNDWATER MONITORING

WELL ID	DATE OF MONITORING	CASING ELEVATION (Feet)	(a)	DEPTH TO WATER (Feet)	PRODUCT THICKNESS (Feet)	GROUNDWATER ELEVATION (Feet)	(b)	TPH-G (ug/l)	B (ug/l)	T (ug/l)	E (ug/l)	X (ug/l)	MTBE (ug/l)
C-5	07/14/92	38.50		28.00	---	10.50		---	---	---	---	---	---
C-5	10/08/92	38.50		28.65	---	9.85		---	---	---	---	---	---
C-5	09/21/93	38.50		26.36	---	12.14		---	---	---	---	---	---
C-5	03/30/95	38.50		18.54	---	19.96		---	---	---	---	---	---
C-5	06/20/95	38.50		20.13	---	18.37		---	---	---	---	---	---
C-5	03/21/96	38.50		18.40	---	20.10		---	---	---	---	---	---
C-5	09/06/96	38.50		21.90	---	16.60		---	---	---	---	---	---
C-5	12/19/96	38.50		21.15	---	17.35		---	---	---	---	---	---
C-5	03/17/97	38.50		19.84	---	18.66		---	---	---	---	---	---
C-5	06/11/97	38.50		21.60	---	16.90		---	---	---	---	---	---
C-5	09/17/97	38.50		27.83	---	10.67		---	---	---	---	---	---
C-5	12/10/97	38.50		21.00	---	17.50		---	---	---	---	---	---
C-5	03/12/98	38.50		16.42	---	22.08		---	---	---	---	---	---
C-5	06/23/98	38.50		16.98	---	21.52		---	---	---	---	---	---
C-5	09/01/98	38.50		20.42	---	18.08		---	---	---	---	---	---
C-5	12/30/98	38.50		20.79	---	17.71		---	---	---	---	---	---
C-5	03/31/99	38.50		17.05	---	21.45		ND<50	ND<0.5	ND<0.5	ND<0.5	ND<0.5	15
C-5	03/09/00	38.50		16.98	---	21.52		ND<50	ND<0.5	ND<0.5	ND<0.5	0.87	3.5
C-5	03/08/01	38.50		17.53	---	20.97		ND<50	ND<0.5	ND<0.5	ND<0.5	ND<0.5	5.15

TABLE 2 - SUMMARY OF RESULTS OF GROUNDWATER MONITORING

WELL ID	DATE OF MONITORING	CASING ELEVATION (Feet)	(a)	DEPTH TO WATER (Feet)	PRODUCT THICKNESS (Feet)	GROUNDWATER ELEVATION (Feet)	(b)	TPH-G (ug/l)	B (ug/l)	T (ug/l)	E (ug/l)	X (ug/l)	MTBE (ug/l)
C-6	07/14/92	35.40		38.89	---	-3.49		---	---	---	---	---	---
C-6	10/08/92	35.40		38.67	---	-3.27		---	---	---	---	---	---
C-6	09/21/93	35.40		33.98	---	1.42		---	---	---	---	---	---
C-6	03/30/95	35.40		26.38	---	9.02		---	---	---	---	---	---
C-6	06/20/95	35.40		25.01	---	10.39		---	---	---	---	---	---
C-6	03/21/96	35.40		23.12	---	12.28		---	---	---	---	---	---
C-6	09/06/96	35.40		24.83	---	10.57		---	---	---	---	---	---
C-6	12/19/96	35.40		24.50	---	10.90		---	---	---	---	---	---
C-6	03/17/97	35.40		22.59	---	12.81		---	---	---	---	---	---
C-6	06/11/97	35.40		23.76	---	11.64		---	---	---	---	---	---
C-6	09/17/97	35.40		24.74	---	10.66		---	---	---	---	---	---
C-6	12/10/97	35.40		24.65	---	10.75		---	---	---	---	---	---
C-6	03/12/98	35.40		27.12	---	8.28		---	---	---	---	---	---
C-6	06/23/98	35.40		27.92	---	7.48		220	35	ND<0.5	2.5	1.1	ND<2.5
C-6	09/01/98	35.40		31.60	---	3.80		1800	370	2.8	19	4.8	44
C-6	12/30/98	35.40		31.82	---	3.58		1600	244	ND<1.0	8.53	ND<1.0	54.9
C-6	03/31/99	35.40		26.06	---	9.34		741	92.2	ND<1.0	6.6	ND<1.0	27.9
C-6	03/09/00	35.40		20.03	---	15.37		470	120	0.74	5.0	2.5	36
C-6	03/08/01	35.40		23.84	---	11.56		1550	228	3.93	19.9	32.5	46.2

TABLE 2 - SUMMARY OF RESULTS OF GROUNDWATER MONITORING

WELL ID	DATE OF MONITORING	CASING ELEVATION (Feet)	(a)	DEPTH TO WATER (Feet)	PRODUCT THICKNESS (Feet)	GROUNDWATER ELEVATION (Feet)	(b)	TPH-G (ug/l)	B (ug/l)	T (ug/l)	E (ug/l)	X (ug/l)	MTBE (ug/l)
C-7	07/14/92	35.19		39.77	---	-4.58		---	---	---	---	---	---
C-7	10/08/92	35.19		39.14	---	-3.95		---	---	---	---	---	---
C-7	09/21/93	35.19		35.46	---	-0.27		---	---	---	---	---	---
C-7	03/30/95	35.19		27.60	---	7.59		---	---	---	---	---	---
C-7	06/20/95	35.19		27.87	---	7.32		---	---	---	---	---	---
C-7	03/21/96	35.19		27.85	---	7.34		---	---	---	---	---	---
C-7	09/06/96	35.19		28.35	---	6.84		---	---	---	---	---	---
C-7	12/19/96	35.19		29.11	---	6.08		---	---	---	---	---	---
C-7	03/17/97	35.19		27.14	---	8.05		---	---	---	---	---	---
C-7	06/11/97	35.19		28.05	---	7.14		---	---	---	---	---	---
C-7	09/17/97	35.19		29.00	---	6.19		---	---	---	---	---	---
C-7	12/10/97	35.19		29.26	---	5.93		---	---	---	---	---	---
C-7	03/12/98	35.19		24.92	---	10.27		---	---	---	---	---	---
C-7	06/23/98	35.19		25.30	---	9.89		ND<50	ND<0.5	ND<0.5	ND<0.5	ND<0.5	ND<2.5
C-7	09/01/98	35.19		26.27	---	8.92		570	24	1.4	8.4	22	24
C-7	12/30/98	35.19		26.52	---	8.67		ND<50	4.85	1.26	ND<0.5	1.29	167
C-7	03/31/99	35.19		24.76	---	10.43		53.1	ND<0.5	ND<0.5	ND<0.5	ND<0.5	ND<2.0
C-7	03/09/00	35.19		25.57	---	9.62		13000	2700	110	700	1500	ND<130
C-7	03/08/01	35.19		25.43	---	9.76		1180	39.2	2.41	15.5	30.8	10.3

TABLE 2 - SUMMARY OF RESULTS OF GROUNDWATER MONITORING

WELL ID	DATE OF MONITORING	CASING ELEVATION (Feet)	(a)	DEPTH TO WATER (Feet)	PRODUCT THICKNESS (Feet)	GROUNDWATER ELEVATION (Feet)	(b)	TPH-G (ug/l)	B (ug/l)	T (ug/l)	E (ug/l)	X (ug/l)	MTBE (ug/l)
C-8	07/14/92	34.68		39.02	---	-4.34		---	---	---	---	---	---
C-8	10/08/92	34.68		38.68	---	-4.00		---	---	---	---	---	---
C-8	09/21/93	34.68		35.30	---	-0.62		---	---	---	---	---	---
C-8	03/30/95	34.68		29.24	---	5.44		---	---	---	---	---	---
C-8	06/20/95	34.68		28.34	---	6.34		---	---	---	---	---	---
C-8	03/21/96	34.68		28.65	---	6.03		---	---	---	---	---	---
C-8	09/06/96	34.68		28.70	---	5.98		---	---	---	---	---	---
C-8	12/19/96	34.68		29.70	---	4.98		---	---	---	---	---	---
C-8	03/17/97	34.68		27.76	---	6.92		---	---	---	---	---	---
C-8	06/11/97	34.68		28.81	---	5.87		---	---	---	---	---	---
C-8	09/17/97	34.68		29.36	---	5.32		---	---	---	---	---	---
C-8	12/10/97	34.68		29.80	---	4.88		---	---	---	---	---	---
C-8	03/12/98	34.68		25.73	---	8.95		---	---	---	---	---	---
C-8	06/23/98	34.68		26.30	---	8.38		---	---	---	---	---	---
C-8	09/01/98	34.68		26.51	---	8.17		---	---	---	---	---	---
C-8	12/30/98	34.68		26.89	---	7.79		---	---	---	---	---	---
C-8	03/31/99	34.68		26.36	---	8.32		ND<50	ND<0.5	ND<0.5	ND<0.5	ND<0.5	11.8
C-8	03/09/00	34.68		26.33	---	8.35		ND<50	ND<0.5	ND<0.5	ND<0.5	1.8	<2.5
C-8	03/08/01	34.68		26.10	---	8.58		ND<50	ND<0.5	ND<0.5	ND<0.5	ND<0.5	<2.5

TABLE 2 - SUMMARY OF RESULTS OF GROUNDWATER MONITORING

WELL ID	DATE OF MONITORING	CASING ELEVATION (Feet)	(a)	DEPTH TO WATER (Feet)	PRODUCT THICKNESS (Feet)	GROUNDWATER ELEVATION (Feet)	(b)	TPH-G (ug/l)	B (ug/l)	T (ug/l)	E (ug/l)	X (ug/l)	MTBE (ug/l)
C-9	03/17/97	30.68		27.56	---	3.12		---	---	---	---	---	---
C-9	06/11/97	30.68		28.27	---	2.41		---	---	---	---	---	---
C-9	09/17/97	30.68		28.63	---	2.05		---	---	---	---	---	---
C-9	12/10/97	30.68		29.43	---	1.25		---	---	---	---	---	---
C-9	03/12/98	30.68		25.62	---	5.06		---	---	---	---	---	---
C-9	06/23/98	30.68		26.15	---	4.53		---	---	---	---	---	---
C-9	09/01/98	30.68		26.38	---	4.30		---	---	---	---	---	---
C-9	12/30/98	30.68		26.75	---	3.93		---	---	---	---	---	---
C-9	03/31/99	30.68		25.33	---	5.35		ND<50	ND<0.5	ND<0.5	ND<0.5	ND<0.5	12.5
C-9	03/09/00	30.68		26.04	---	4.64		ND<50	ND<0.5	ND<0.5	ND<0.5	0.75	<2.5
C-9	03/08/01	30.68		25.75	---	4.93		ND<50	ND<0.5	ND<0.5	ND<0.5	ND<0.5	<2.5
Trip Blank	06/23/98	---		---	---	---		ND<50	ND<0.5	ND<0.5	ND<0.5	ND<0.5	ND<2.5
Trip Blank	09/01/98	---		---	---	---		ND<50	ND<0.5	ND<0.5	ND<0.5	ND<0.5	ND<2.5
Trip Blank	03/08/01	---		---	---	---		ND<50	ND<0.5	ND<0.5	ND<0.5	ND<0.5	ND<2.5

ABBREVIATIONS:

TPH-G Total petroleum hydrocarbons as gasoline
 B Benzene
 T Toluene
 E Ethylbenzene
 X Total xylenes
 MTBE Methyl tert butyl ether
 ug/l Micrograms per liter
 --- Not analyzed/measured/applicable
 ND Not detected above reported detection limit
 SEQ Sequoia Analytical

NOTES:

(a) Top of casing elevations surveyed relative to 1929 NGVD.
 Measured in feet above mean sea level.
 (b) Groundwater elevations in feet above mean sea level.

Analytical Appendix



Pace Analytical Services, Inc.

900 Gemini Avenue
Houston, TX 77058

Phone: 281.488.1810

Fax: 281.488.4661

March 14, 2001

Mr. Aidan Metzger
Blaine Tech Services, Inc.
1680 Rogers Ave.
San Jose, CA 95112

RE: Lab Project Number: 8520252
Client Project ID: BP Site#11109

Dear Mr. Metzger:

Enclosed are the analytical results for sample(s) received by the laboratory on March 10, 2001. If you have any questions concerning this report, please feel free to contact me.

Sincerely,



Paula Kirtley
Project Manager

Enclosures

REPORT OF LABORATORY ANALYSIS

This report shall not be reproduced, except in full,
without the written consent of Pace Analytical Services, Inc.

Blaine Tech Services, Inc.
1680 Rogers Ave.
San Jose, CA 95112

Lab Project Number: 8520252
Client Project ID: BP Site#11109

Attn: Mr. Aidan Metzger
Phone:

Lab Sample No: 851681504 Project Sample Number: 8520252-001 Date Collected: 03/08/01 13:00
Client Sample ID: A (11109) 3/8 @1300 Matrix: Water Date Received: 03/10/01 10:05

Parameters	Results	Units	PRL	Dilution	Analyzed	Analyst	CAS#	Ftnote	Limit
------------	---------	-------	-----	----------	----------	---------	------	--------	-------

GC Volatiles

GAS by Mod 8015, Water		Method: EPA 8015 Modified			Prep Method: EPA 8015 Modified				
Gasoline Range Organics	ND	ug/l	50.	1.0	03/13/01 18:10	WRIC			
1,4-Difluorobenzene (S)	98	%		1.0	03/13/01 18:10	WRIC			
4-Bromofluorobenzene (S)	76	%		1.0	03/13/01 18:10	WRIC	460-00-4		

SW8021 Aromatics, Water		Method: EPA 8021			Prep Method: See analytical meth				
Benzene	ND	ug/l	0.500	1.0	03/14/01 11:03	WRIC	71-43-2		
Ethylbenzene	ND	ug/l	0.500	1.0	03/14/01 11:03	WRIC	100-41-4		
Toluene	ND	ug/l	0.500	1.0	03/14/01 11:03	WRIC	108-88-3		
Xylene (Total)	0.590	ug/l	0.500	1.0	03/14/01 11:03	WRIC	1330-20-7		
Methyl-tert-butyl ether	7.70	ug/l	0.500	1.0	03/14/01 11:03	WRIC	1634-04-4		
1,4-Difluorobenzene (S)	98	%		1.0	03/14/01 11:03	WRIC			
4-Bromofluorobenzene (S)	66	%		1.0	03/14/01 11:03	WRIC	460-00-4	1	

Date: 03/14/01

Page: 1

REPORT OF LABORATORY ANALYSIS

This report shall not be reproduced, except in full,
without the written consent of Pace Analytical Services, Inc.

Lab Project Number: 8520252

Client Project ID: BP Site#11109

PARAMETER FOOTNOTES

- ND Not Detected
- NC Not Calculable
- PRL Pace Reporting Limit
- (S) Surrogate
- [1] Surrogate recovery outside of control limits. The data was accepted based upon valid recovery of remaining surrogate.

REPORT OF LABORATORY ANALYSIS

This report shall not be reproduced, except in full,
without the written consent of Pace Analytical Services, Inc.

QC Batch: 49953
Analysis Method: EPA 8021
Associated Lab Samples: 851681504

Lab Project Number: 8520252
Client Project ID: BP Site#11109
QC Batch Method: See analytical meth
Analysis Description: SW8021 Aromatics. Water

METHOD BLANK: 851681400
Associated Lab Samples:

851681504

Parameter	Units	Method Blank Result	PRL	Footnotes
Benzene	ug/l	ND	0.5	
Ethylbenzene	ug/l	ND	0.5	
Toluene	ug/l	ND	0.5	
Xylene (Total)	ug/l	ND	0.5	
Methyl-tert-butyl ether	ug/l	ND	0.5	
1,4-Difluorobenzene (S)	%	97		
4-Bromofluorobenzene (S)	%	72		

MATRIX SPIKE & MATRIX SPIKE DUPLICATE: 851681591 851681592

Parameter	Units	851681496	851681592 Spike Conc.	Matrix Spike Result	Matrix Spike % Rec	Matrix Sp. Dup. Result	Spike Dup % Rec	RPD	Footnotes
Benzene	ug/l	0	50.00	51.62	103	46.17	92	11	
Ethylbenzene	ug/l	0	50.00	46.26	92	40.74	82	13	
Toluene	ug/l	0	50.00	51.22	102	45.14	90	13	
Xylene (Total)	ug/l	0	100.00	89.07	89	77.64	78	14	
Methyl-tert-butyl ether	ug/l	60.43	50.00	103.3	86	98.86	77	4	
1,4-Difluorobenzene (S)					102		102		
4-Bromofluorobenzene (S)					76		77		

LABORATORY CONTROL SAMPLE: 851681688

Parameter	Units	Spike Conc.	LCS Result	Spike % Rec	Footnotes
Benzene	ug/l	50	54.38	109	
Ethylbenzene	ug/l	50	49.65	99	
Toluene	ug/l	50	54.76	110	
Xylene (Total)	ug/l	100	98.02	98	

Date: 03/14/01

Page: 3

REPORT OF LABORATORY ANALYSIS

This report shall not be reproduced, except in full, without the written consent of Pace Analytical Services, Inc.

Lab Project Number: 8520252
Client Project ID: BP Site#11109

LABORATORY CONTROL SAMPLE: 851681688

Parameter	Units	Spike Conc.	LCS Result	Spike % Rec	Footnotes
Methyl-tert-butyl ether	ug/l	50	51.17	102	
1,4-Difluorobenzene (S)				103	
4-Bromofluorobenzene (S)				81	

Date: 03/14/01

Page: 4

REPORT OF LABORATORY ANALYSIS

This report shall not be reproduced, except in full,
without the written consent of Pace Analytical Services, Inc.

QC Batch: 49988
Analysis Method: EPA 8015 Modified
Associated Lab Samples: 851681504

Lab Project Number: 8520252
Client Project ID: BP Site#11109

QC Batch Method: EPA 8015 Modified
Analysis Description: GAS by Mod 8015, Water

METHOD BLANK: 851681593
Associated Lab Samples:

851681504

Parameter	Units	Method Blank Result	PRL	Footnotes
Gasoline Range Organics	ug/l	ND	50	
1,4-Difluorobenzene (S)	%	97		
4-Bromofluorobenzene (S)	%	72		

MATRIX SPIKE & MATRIX SPIKE DUPLICATE: 851681724 851681725

Parameter	Units	851681504	Spike Conc.	Matrix Spike Result	Spike % Rec	Matrix Sp. Dup. Result	Spike Dup % Rec	RPD	Footnotes
Gasoline Range Organics	ug/l	17.66	900.00	842.4	92	894.1	97	6	
1,4-Difluorobenzene (S)					94		94		
4-Bromofluorobenzene (S)					103		105		

LABORATORY CONTROL SAMPLE: 851681594

Parameter	Units	Spike Conc.	LCS Result	Spike % Rec	Footnotes
Gasoline Range Organics	ug/l	1000	1017	102	
1,4-Difluorobenzene (S)				96	
4-Bromofluorobenzene (S)				98	

REPORT OF LABORATORY ANALYSIS

This report shall not be reproduced, except in full,
without the written consent of Pace Analytical Services, Inc.

Lab Project Number: 8520252

Client Project ID: BP Site#11109

QUALITY CONTROL DATA PARAMETER FOOTNOTES

Consistent with EPA guidelines unrounded concentrations are displayed and have been used to calculate % Rec and RPD values.

ND Not Detected
NC Not Calculable
PRL Pace Reporting Limit
RPD Relative Percent Difference
(S) Surrogate

Date: 03/14/01

Page: 6

REPORT OF LABORATORY ANALYSIS

This report shall not be reproduced, except in full,
without the written consent of Pace Analytical Services, Inc.



CHAIN OF CUSTODY

CONSULTANT'S NAME Blaine Tech Services, Inc.		CONSULTANT'S ADDRESS 1680 Rogers Ave., San Jose CA 95112			
BP SITE NUMBER 11109	BP SITE / FACILITY ADDRESS 4280 Foothill, Oakland			CONSULTANT PROJECT NUMBER 010308-A2	
CONSULTANT PROJECT MANAGER Scott Boor		PHONE NUMBER (408) 573-0555 x 223	FAX NUMBER (408) 573-7771		CONSULTANT CONTRACT NUMBER J588494
BP CONTACT Scott Hooton	BP ADDRESS 295 SW 41st Street, Suite N, Renton WA		PHONE NUMBER (425) 251-0689	FAX NO. (425) 251-0736	
LAB CONTACT Pace - Paula Kirtley	LABORATORY ADDRESS 900 Gemini Ave., Houston, TX 77058		PHONE NUMBER (281) 488-1810	FAX NO. (281) 488-4661	
BP CONTACT REQUESTING RUSH TAT (Print BP Contact Name)	RUSH REQUESTED OF (Print Consultant Contact Name)	DATE/TIME	SHIPMENT DATE	SHIPMENT METHOD	

TAT: 24 HOURS 48 HOURS 72 HOURS Standard 7 or 14 Days

ANALYSIS REQUIRED

AIRBILL NUMBER

SAMPLE DESCRIPTION	COLLECTION DATE	COLLECTION TIME	MATRIX SOIL/WATER	CONTAINERS		PRESERVATIVE	TPH-G + BTEX / MTBE (8015M)	TPH-D (8015M)	FUEL OXYGENATES (8260)	1,2 DCA + EDB (8010)									COMMENTS	
				NO.	TYPE (VOL)	LAB SAMPLE #														
A	5/8/01	1300	w	3	90°	Hcl	X													851681504

SAMPLED BY (Please Print Name) <i>Oscar Angulo</i>			SAMPLED BY (Signature) <i>O. Angulo</i>			ADDITIONAL COMMENTS		
RELINQUISHED BY / AFFILIATION (Print Name / Signature)	DATE	TIME	ACCEPTED BY / AFFILIATION Name / Signature	(Print)	DATE	TIME		
<i>O. Angulo</i> AIR BORNE	5/8/01	1430	Airborne Express	<i>F. [Signature]</i>	3/10/01	1005 AM		

Field Data Sheets

