



1680 ROGERS AVENUE
SAN JOSE, CALIFORNIA 95112-1105
(408) 573-7771 FAX
(408) 573-0555 PHONE

July 19, 1999

Scott Hooton
BP Oil Company
295 SW 41st Street, Bldg. 13, Suite N
Renton, WA 98055-4931

2nd Quarter 1999 Monitoring at 11109

Second Quarter 1999 Groundwater Monitoring
BP Service Station Number 11109
4280 Foothill Blvd.
Oakland, CA

Monitoring Performed on March 13, 1999

Groundwater Sampling Report 990331-X-1

This report covers the routine monitoring of groundwater wells at this BP facility. Blaine Tech Services, Inc.'s work at the site includes inspection, gauging, evacuation, purgewater containment, sample collection and sample handling in accordance with standard procedures that conform to Regional Water Quality Control Board requirements.

Routine field data collection includes depth to water, total well depth, thickness of any separate immiscible layer, water column volume, the appropriate calculated purge volume, elapsed evacuation time, total volume of water removed, and standard water parameter instrument readings. Sample material is collected, contained, stored, and transported to the laboratory in conformance with EPA standards. Purgewater is, likewise, collected and transported to Seaport Petroleum Corporation for disposal.

Basic field information is presented alongside analytical values excerpted from the laboratory report in the cumulative table of **WELL DATA AND ANALYTICAL RESULTS**. The full analytical report for the most recent samples is located in the **Analytical Appendix**. The **Professional Engineering Appendix** contains a **Groundwater Elevation Map** and a **Dissolved Petroleum Hydrocarbon Concentration Map**.

At a minimum, Blaine Tech Services, Inc. field personnel are certified upon completion of a forty-hour Hazardous Materials and Emergency Response training course per 29 CFR 1910.120. Field personnel are also enrolled in annual eight hour refresher courses.

Blaine Tech Services, Inc. conducts sampling and documentation assignments of this type as an independent third party. In order to avoid compromising the objectivity necessary for the proper and disinterested performance of this work, Blaine Tech Services, Inc. concentrates on objective data collection and does not participate in the interpretation of analytical results, the definition of geological or hydrological conditions, the formulation of recommendations, or the marketing of remedial systems.

Please call if you have any questions.

Yours truly,

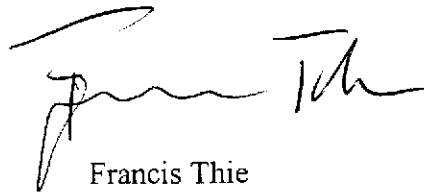
A handwritten signature in black ink, appearing to read 'Francis Thie', is written over a horizontal line.

Francis Thie
Vice President

FPT/ld

attachments: Professional Engineering Appendix
Cumulative Table of Well Data and Analytical Results
Analytical Appendix
Field Data Sheets

Professional Engineering Appendix

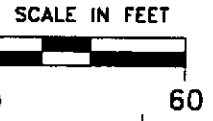

- EXPLANATION**
- ⊕ GROUNDWATER MONITORING WELL
 - ⊞ GROUNDWATER RECOVERY WELL
 - 28.84 GROUNDWATER ELEVATION (FT, MSL)
 - 30.00 — GROUNDWATER ELEVATION CONTOUR (FT, MSL)
 - NA DATA NOT AVAILABLE
 - ← APPROXIMATE GROUNDWATER FLOW DIRECTION;
APPROXIMATE GRADIENT = 0.04

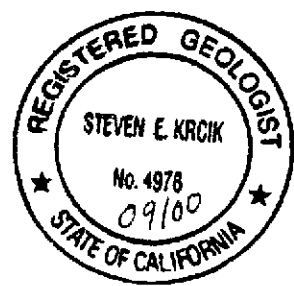
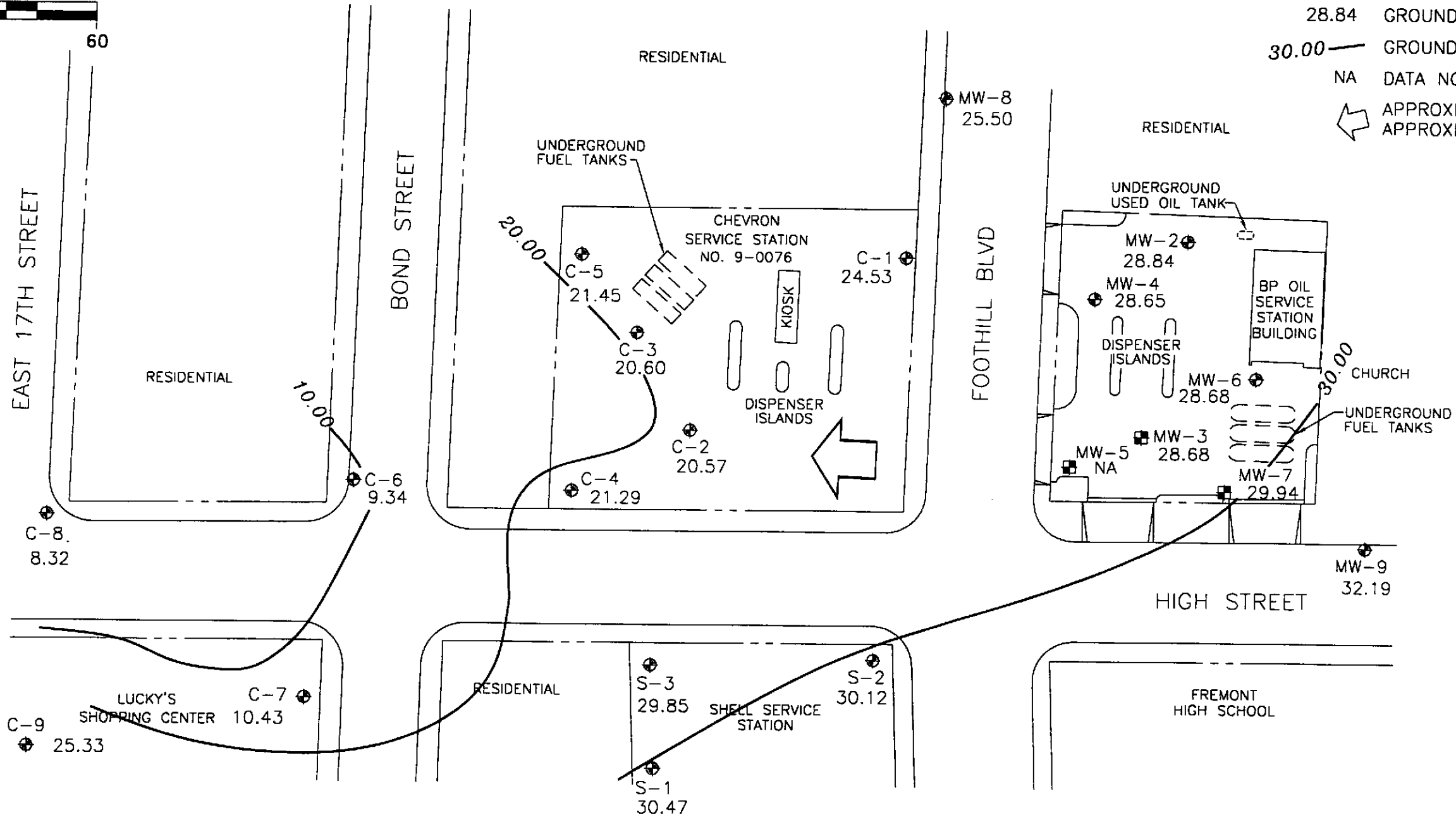

Ref. 11109bm1.dwg
Basemap from Aisto Engineering Group

PREPARED BY RRM engineering contracting firm	GROUNDWATER ELEVATION CONTOUR MAP, MARCH 31, 1999	FIGURE: 1 PROJECT: DAC04
	BP Oil Service Station No. 11109 4280 Foothill Boulevard Oakland, California	

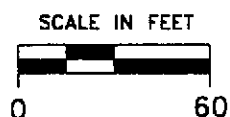

- EXPLANATION**
- ⊕ GROUNDWATER MONITORING WELL
 - ⊞ GROUNDWATER RECOVERY WELL
 - TPHg TOTAL PETROLEUM HYDROCARBON CALCULATED AS GASOLINE IN PARTS PER BILLION (ppb)
 - B BENZENE, ppb
 - T TOLUENE, ppb
 - E ETHYLBENZENE, ppb
 - X XYLENE, ppb
 - MTBE METHYL-TERT-BUTYL-ETHER, ppb
 - MTBE* MTBE BY 8260
 - NA DATA NOT AVAILABLE

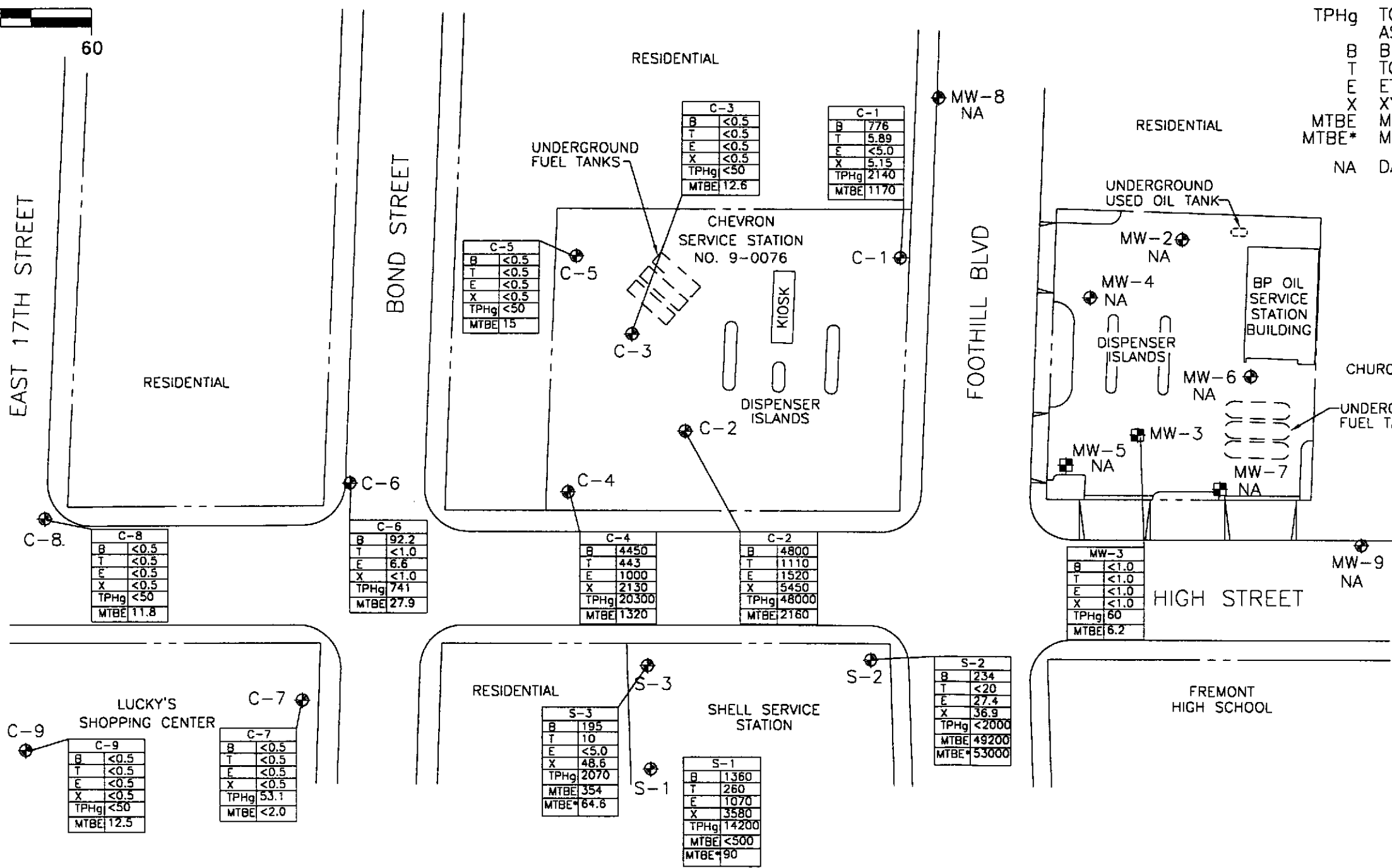

PREPARED BY

RRM

engineering contracting firm

HYDROCARBON CONCENTRATION MAP,
MARCH 31, 1999

BP Oil Service Station No. 11109
4280 Foothill Boulevard
Oakland, California

FIGURE:
2

PROJECT:
DAC04

Ref. 11109btex.dwg
Basemap from Afto Engineering Group

Table of Well Data and Analytical Results

TABLE 1 - SUMMARY OF RESULTS OF GROUNDWATER MONITORING

WELL ID	DATE OF SAMPLING/ MONITORING	CASING ELEVATION (Feet)	DEPTH TO WATER (Feet)	PRODUCT THICKNESS (Feet)	GROUNDWATER ELEVATION (Feet)	TPH-G (ug/l)	TPH-D (ug/l)	B (ug/l)	T (ug/l)	E (ug/l)	X (ug/l)	MTBE (ug/l)	TOG (ug/l)	HVOC (ug/l)	DO (ppm)	LAB
MW-1	01/31/90	38.19	15.41	---	22.78	---	---	---	---	---	---	---	---	---	---	---
MW-1 (c)	02/05/90	38.19	---	---	---	---	---	---	---	---	---	---	---	---	---	---
MW-2	02/05/90	41.22	21.90	---	19.31	1300	---	14	ND<0.1	9	13	---	---	---	---	SUP
MW-2	02/14/91	41.22	21.16	---	20.06	ND<50	ND<10000	ND<0.3	ND<0.3	ND<0.3	ND<0.3	---	ND<5000	51 (d)	---	SUP
MW-2	05/13/91	41.22	21.32	---	19.90	ND<50	ND<50	ND<0.3	ND<0.3	ND<0.3	ND<0.3	---	6000	0.5 (e)	---	SUP
MW-2	07/24/91	41.22	22.92	---	18.30	---	---	---	---	---	---	---	---	---	---	---
MW-2	10/03/91	41.22	24.90	---	16.32	ND<50	ND<50	ND<0.3	0.8	ND<0.3	ND<0.3	---	ND<5000	0.7 (e)	---	SUP
MW-2	10/15/91	41.22	24.10	---	17.12	---	---	---	---	---	---	---	---	---	---	---
MW-2 (f)	12/04/91	41.22	---	---	---	---	---	---	---	---	---	---	---	---	---	---
MW-2	12/16/91	41.22	23.95	---	17.27	---	---	---	---	---	---	---	---	---	---	---
MW-2	01/06/92	41.22	23.30	---	17.92	ND<50	ND<50	ND<0.3	ND<0.3	ND<0.3	ND<0.3	---	ND<5000	ND	---	ANA
MW-2	01/22/92	41.22	23.14	---	18.08	---	---	---	---	---	---	---	---	---	---	---
MW-2	01/28/92	41.22	22.99	---	18.23	---	---	---	---	---	---	---	---	---	---	---
MW-2	02/05/92	41.22	22.63	---	18.59	---	---	---	---	---	---	---	---	---	---	---
MW-2	02/12/92	41.22	22.04	---	19.18	---	---	---	---	---	---	---	---	---	---	---
MW-2	02/17/92	41.22	20.84	---	20.38	---	---	---	---	---	---	---	---	---	---	---
MW-2	04/03/92	41.22	18.29	---	22.93	---	---	---	---	---	---	---	---	---	---	---
MW-2	04/08/92	41.22	18.86	---	22.36	ND<50	63	ND<0.5	ND<0.5	ND<0.5	ND<0.5	---	ND<5000	ND	---	ANA
MW-2	04/14/92	41.22	19.45	---	21.77	---	---	---	---	---	---	---	---	---	---	---
MW-2	04/29/92	41.22	20.35	---	20.87	---	---	---	---	---	---	---	---	---	---	---
MW-2	05/07/92	41.22	20.84	---	20.38	---	---	---	---	---	---	---	---	---	---	---
MW-2	07/03/92	41.22	22.34	---	18.88	ND<50	---	ND<0.5	ND<0.5	ND<0.5	ND<0.5	---	---	---	---	ANA
MW-2	10/08/92	41.22	23.73	---	17.49	ND<50	---	ND<0.5	ND<0.5	ND<0.5	ND<0.5	---	---	---	---	ANA
MW-2	12/31/92	41.22	21.12	---	20.10	ND<50	---	ND<0.5	ND<0.5	ND<0.5	ND<0.5	---	---	---	---	ANA
MW-2	04/21/93	41.22	17.68	---	23.54	ND<50	ND<50 (g)	ND<0.5	ND<0.5	ND<0.5	ND<0.5	---	ND<5000	ND	---	PACE
MW-2	07/07/93	41.22	20.30	---	20.92	ND<50	---	ND<0.5	ND<0.5	ND<0.5	ND<0.5	---	---	1.0 (e)	---	PACE
MW-2	09/21/93	41.22	21.93	---	19.29	ND<50	---	0.9	0.7	1	2.6	---	---	---	---	PACE
MW-2	12/17/93	41.22	21.48	---	19.74	---	---	---	---	---	---	---	---	---	---	---
MW-2	12/23/93	41.22	---	---	---	ND<50	---	ND<0.5	ND<0.5	ND<0.5	0.7	---	---	---	---	PACE
MW-2	04/07/94	41.22	20.25	---	20.97	ND<50	---	ND<0.5	ND<0.5	ND<0.5	ND<0.5	---	---	---	5.9	PACE
MW-2	07/06/94	41.22	20.59	---	20.63	ND<50	---	ND<0.5	ND<0.5	ND<0.5	ND<0.5	---	---	---	3.1	PACE
MW-2	10/07/94	41.22	22.04	---	19.18	ND<50	---	ND<0.5	ND<0.5	ND<0.5	ND<0.5	---	---	---	2.8	PACE
MW-2	01/27/95	41.22	26.12	---	15.10	ND<50	440	ND<0.5	ND<0.5	ND<0.5	ND<1	---	ND<5000	---	4.8	ATI
MW-2	03/30/95	41.22	12.34	---	28.88	ND<50	---	ND<0.50	ND<0.50	ND<0.50	ND<1.0	---	---	---	7.2	ATI
MW-2	06/20/95	41.22	16.42	---	24.80	ND<50	---	ND<0.50	ND<0.50	ND<0.50	ND<1.0	---	---	---	6.0	ATI
MW-2	10/03/95	41.22	20.06	---	21.16	ND<50	---	ND<0.50	ND<0.50	ND<0.50	ND<1.0	ND<5.0	---	---	5.7	ATI
MW-2	12/06/95	41.22	21.31	---	19.91	ND<50	---	ND<0.50	ND<0.50	ND<0.50	ND<1.0	46	---	---	5.4	ATI
MW-2	03/21/96	41.22	12.28	---	28.94	ND<50	---	ND<0.5	ND<1	ND<1	ND<1	ND<10	---	---	7.4	SPL

TABLE 1 - SUMMARY OF RESULTS OF GROUNDWATER MONITORING

WELL ID	DATE OF SAMPLING/ MONITORING	CASING ELEVATION (a) (Feet)	DEPTH TO WATER (Feet)	PRODUCT THICKNESS (Feet)	GROUNDWATER ELEVATION (b) (Feet)	TPH-G (ug/l)	TPH-D (ug/l)	B (ug/l)	T (ug/l)	E (ug/l)	X (ug/l)	MTBE (ug/l)	TOG (ug/l)	HVOC (ug/l)	DO (ppm)	LAB
MW-2	06/21/96	41.22	13.28	---	27.94	ND<50	---	ND<0.5	ND<1	ND<1	ND<1	ND<10	---	---	7.3	SPL
MW-2	09/06/96	41.22	13.94	---	27.28	---	---	---	---	---	---	---	---	---	---	---
MW-2	09/09/96	41.22	---	---	---	ND<50	---	ND<0.5	ND<1.0	ND<1.0	ND<1.0	ND<10	---	---	7.4	SPL
MW-2	12/19/96	41.22	12.19	---	29.03	ND<50	---	ND<0.5	ND<1.0	ND<1.0	ND<1.0	ND<10	---	---	7.9	SPL
MW-2	03/17/97	41.22	11.59	---	29.63	---	---	---	---	---	---	---	---	---	---	---
MW-2	08/12/97	41.22	13.21	---	28.01	---	---	---	---	---	---	---	---	---	---	---
MW-2	12/10/97	41.22	12.34	---	28.88	---	---	---	---	---	---	---	---	---	---	---
MW-2	03/12/98	41.22	11.04	---	30.18	---	---	---	---	---	---	---	---	---	---	---
MW-2	06/23/98	41.22	11.77	---	29.45	---	---	---	---	---	---	---	---	---	---	---
MW-2	03/31/99	41.22	12.38	---	28.84	---	---	---	---	---	---	---	---	---	---	---

TABLE 1 - SUMMARY OF RESULTS OF GROUNDWATER MONITORING

WELL ID	DATE OF SAMPLING/ MONITORING	CASING ELEVATION (a) (Feet)	DEPTH TO WATER (Feet)	PRODUCT THICKNESS (Feet)	GROUNDWATER ELEVATION (b) (Feet)	TPH-G (ug/l)	TPH-D (ug/l)	B (ug/l)	T (ug/l)	E (ug/l)	X (ug/l)	MTBE (ug/l)	TOG (ug/l)	HVOC (ug/l)	DO (ppm)	LAB
MW-3	02/05/90	40.74	17.45	---	23.29	1400	---	15	ND<2.5	11	8	---	---	---	---	SUP
MW-3	02/14/91	40.74	18.52	---	22.22	320	---	8	ND<0.3	8	1	---	---	---	---	SUP
MW-3	05/13/91	40.74	19.32	---	21.42	640	---	13	ND<0.3	18	1	---	---	---	---	SUP
MW-3	07/24/91	40.74	20.69	---	20.05	---	---	---	---	---	---	---	---	---	---	---
MW-3	10/03/91	40.74	19.47	---	21.27	940	---	21	ND<0.3	23	2.1	---	---	---	---	SUP
MW-3	10/15/91	40.74	20.46	---	20.28	---	---	---	---	---	---	---	---	---	---	---
MW-3	12/04/91	40.74	18.29	---	22.45	---	---	---	---	---	---	---	---	---	---	---
MW-3	12/16/91	40.74	18.34	---	22.40	---	---	---	---	---	---	---	---	---	---	---
MW-3	01/06/92	40.74	18.50	---	22.24	580	---	6.1	1	6	7.1	---	---	---	---	ANA
MW-3	01/22/92	40.74	17.86	---	22.88	---	---	---	---	---	---	---	---	---	---	---
MW-3	01/28/92	40.74	15.84	---	24.90	---	---	---	---	---	---	---	---	---	---	---
MW-3	02/05/92	40.74	17.53	---	23.21	---	---	---	---	---	---	---	---	---	---	---
MW-3	02/12/92	40.74	17.15	---	23.59	---	---	---	---	---	---	---	---	---	---	---
MW-3	02/17/92	40.74	16.18	---	24.56	---	---	---	---	---	---	---	---	---	---	---
MW-3	04/03/92	40.74	14.80	---	25.94	---	---	---	---	---	---	---	---	---	---	---
MW-3	04/08/92	40.74	17.06	---	23.68	1100	---	30	4.6	32	11	---	---	---	---	ANA
MW-3	04/14/92	40.74	15.22	---	25.52	---	---	---	---	---	---	---	---	---	---	---
MW-3	04/29/92	40.74	15.90	---	24.84	---	---	---	---	---	---	---	---	---	---	---
MW-3	05/07/92	40.74	16.35	---	24.39	---	---	---	---	---	---	---	---	---	---	---
MW-3	07/03/92	40.74	17.74	---	23.00	1200	---	38	ND<2.5	24	ND<2.5	---	---	---	---	ANA
MW-3	10/08/92	40.74	19.06	---	21.68	1400	---	31	ND<0.5	25	13	---	---	---	---	ANA
MW-3	12/31/92	40.74	16.61	---	24.13	820	---	12	4.1	13	5.9	---	---	---	---	ANA
QC-1 (h)	12/31/92	---	---	---	---	960	---	11	3.6	10	3.8	---	---	---	---	ANA
MW-3	04/21/93	40.74	14.24	---	26.50	420	---	5.6	ND<0.5	4	1.4	---	---	---	---	PACE
QC-1 (h)	04/21/93	---	---	---	---	390	---	5.0	ND<0.5	4	1.5	---	---	---	---	PACE
MW-3	07/07/93	40.13	(i) 15.19	---	24.94	54	---	0.6	0.6	ND<0.5	ND<0.5	---	---	---	---	PACE
MW-3	09/21/93	40.13	16.58	---	23.55	540	---	7.9	0.9	5	2.4	---	---	---	---	PACE
MW-3	12/17/93	40.13	15.82	---	24.31	---	---	---	---	---	---	---	---	---	---	---
MW-3	12/23/93	40.13	---	---	---	500	---	9.8	1.5	3	2.1	---	---	---	---	PACE
QC-1 (h)	12/23/93	---	---	---	---	480	---	9.2	ND<0.5	5	5.3	---	---	---	---	PACE
MW-3	04/07/94	40.13	28.50	---	11.63	460	---	20	7.4	9	11	---	---	---	---	PACE
QC-1 (h)	04/07/94	---	---	---	---	460	---	20	7.7	9	11	---	---	---	---	PACE
MW-3	07/06/94	40.13	---	---	---	300	---	10	0.6	2	6.4	---	---	---	4.8	PACE
MW-3	10/07/94	40.13	27.65	---	12.48	620	---	28	ND<0.5	2	12	---	31	(j) ---	4.4	PACE
MW-3	01/27/95	40.13	27.65	---	12.48	---	---	---	---	---	---	---	---	---	---	---
MW-3	03/30/95	40.13	26.05	---	14.08	300	---	10	6.0	3	18	---	---	---	7.6	ATI
MW-3	06/20/95	40.13	19.49	---	20.64	170	---	7.2	3.4	1	15	---	---	---	---	ATI
MW-3	10/03/95	40.13	24.93	---	15.20	170	---	2.1	ND<0.50	1	8.0	6.7	---	---	---	ATI
MW-3	12/06/95	40.13	25.14	---	14.99	1700	---	6.7	3.1	3	210	64	---	---	---	ATI

TABLE 1 - SUMMARY OF RESULTS OF GROUNDWATER MONITORING

WELL ID	DATE OF SAMPLING/ MONITORING	CASING ELEVATION (a) (Feet)	DEPTH TO WATER (Feet)	PRODUCT THICKNESS (Feet)	GROUNDWATER ELEVATION (b) (Feet)	TPH-G (ug/l)	TPH-D (ug/l)	B (ug/l)	T (ug/l)	E (ug/l)	X (ug/l)	MTBE (ug/l)	TOG (ug/l)	HVOC (ug/l)	DO (ppm)	LAB
QC-1 (h)	12/06/95	---	---	---	---	1400	---	6.1	3.0	2	190	53	---	---	---	ATI
MW-3	03/21/96	40.13	9.48	---	30.65	ND<50	---	0.5	ND<1	ND<1	1	ND<10	---	---	7.3	SPL
MW-3	06/21/96	40.13	11.60	---	28.53	ND<50	---	13	ND<1	ND<1	ND<1	12	---	---	7.6	SPL
MW-3	09/06/96	40.13	12.23	---	27.90	---	---	---	---	---	---	---	---	---	---	---
MW-3	09/09/96	40.13	---	---	---	ND<250	---	6.5	ND<5.0	ND<5.0	ND<5.0	ND<50	---	---	7.6	SPL
MW-3	12/19/96	40.13	10.46	---	29.67	ND<50	---	4.1	ND<1.0	ND<1.0	ND<1.0	ND<10	---	---	8.4	SPL
MW-3	03/17/97	40.13	9.86	---	30.27	50	---	ND<5	ND<1.0	ND<1.0	ND<1.0	ND<10	---	---	7.4	SPL
MW-3	08/12/97	40.13	12.11	---	28.02	ND<50	---	0.79	ND<1.0	ND<1.0	ND<1.0	10	---	---	6.1	SPL
MW-3	12/10/97	40.13	10.90	---	29.23	ND<50	---	ND<0.5	ND<1.0	ND<1.0	ND<1.0	ND<10	---	---	3.2	SPL
MW-3	03/12/98	40.13	10.2	---	29.93	ND<50	---	ND<0.5	ND<1.0	ND<1.0	ND<1.0	ND<10	---	---	6.3	SPL
QC-1 (h)	03/12/98	---	---	---	---	ND<50	---	ND<0.5	ND<1.0	ND<1.0	ND<1.0	ND<10	---	---	---	SPL
MW-3	06/23/98	40.13	10.17	---	29.96	50	---	ND<0.5	ND<1.0	ND<1.0	ND<1.0	ND<10	---	---	3.4	SPL
MW-3	03/31/99	40.13	11.45	---	28.68	60	---	ND<1.0	ND<1.0	ND<1.0	ND<1.0	6.2	---	---	---	SPL

TABLE 1 - SUMMARY OF RESULTS OF GROUNDWATER MONITORING

WELL ID	DATE OF SAMPLING/ MONITORING	CASING ELEVATION (a) (Feet)	DEPTH TO WATER (Feet)	PRODUCT THICKNESS (Feet)	GROUNDWATER ELEVATION (b) (Feet)	TPH-G (ug/l)	TPH-D (ug/l)	B (ug/l)	T (ug/l)	E (ug/l)	X (ug/l)	MTBE (ug/l)	TOG (ug/l)	HVOC (ug/l)	DO (ppm)	LAB
MW-4	02/05/90	40.11	20.75	---	19.36	620	---	ND<0.5	9	ND<0.5	10	---	---	---	---	SUP
MW-4	02/14/91	40.11	21.73	---	18.38	180	---	ND<0.3	ND<0.3	0.4	2	---	---	---	---	SUP
MW-4	05/13/91	40.11	18.55	---	21.56	72	---	0.7	ND<0.3	ND<0.3	ND<0.3	---	---	---	---	SUP
MW-4	07/24/91	40.11	21.31	---	18.80	---	---	---	---	---	---	---	---	---	---	---
MW-4	10/03/91	40.11	22.57	---	17.54	57	---	ND<0.3	ND<0.3	ND<0.3	ND<0.3	---	---	---	---	SUP
MW-4	10/15/91	40.11	22.88	---	17.23	---	---	---	---	---	---	---	---	---	---	---
MW-4	12/04/91	40.11	22.54	---	17.57	---	---	---	---	---	---	---	---	---	---	---
MW-4	12/16/91	40.11	22.59	---	17.52	---	---	---	---	---	---	---	---	---	---	---
MW-4	01/06/92	40.11	22.00	---	18.11	480	---	0.8	3.2	2	7.7	---	---	---	---	ANA
MW-4	01/22/92	40.11	21.58	---	18.53	---	---	---	---	---	---	---	---	---	---	---
MW-4	01/28/92	40.11	21.42	---	18.69	---	---	---	---	---	---	---	---	---	---	---
MW-4	02/05/92	40.11	21.10	---	19.01	---	---	---	---	---	---	---	---	---	---	---
MW-4	02/12/92	40.11	20.74	---	19.37	---	---	---	---	---	---	---	---	---	---	---
MW-4	02/17/92	40.11	19.78	---	20.33	---	---	---	---	---	---	---	---	---	---	---
MW-4	04/03/92	40.11	16.80	---	23.31	---	---	---	---	---	---	---	---	---	---	---
MW-4	04/08/92	40.11	17.13	---	22.98	ND<50	---	ND<0.5	ND<0.5	ND<0.5	ND<0.5	---	---	---	---	ANA
MW-4	04/14/92	40.11	17.74	---	22.37	---	---	---	---	---	---	---	---	---	---	---
MW-4	04/29/92	40.11	18.56	---	21.55	---	---	---	---	---	---	---	---	---	---	---
MW-4	05/07/92	40.11	19.10	---	21.01	---	---	---	---	---	---	---	---	---	---	---
MW-4	07/03/92	40.11	20.71	---	19.40	ND<50	---	0.6	ND<0.5	ND<0.5	ND<0.5	---	---	---	---	ANA
MW-4	10/08/92	40.11	22.43	---	17.68	270	---	ND<0.5	2.1	3	3.2	---	---	---	---	ANA
MW-4	12/31/92	40.11	19.58	---	20.53	150	---	ND<0.5	ND<0.5	ND<0.5	1.3	---	---	---	---	ANA
MW-4	04/21/93	40.11	17.79	---	22.32	ND<50	---	ND<0.5	ND<0.5	ND<0.5	ND<0.5	---	---	---	---	PACE
MW-4	07/07/93	40.11	18.44	---	21.67	160	---	1.2	5.4	4	19	---	---	---	---	PACE
MW-4	09/21/93	40.11	20.14	---	19.97	71	---	ND<0.5	1.9	ND<0.5	2.1	---	---	---	---	PACE
MW-4	12/17/93	40.11	19.80	---	20.31	---	---	---	---	---	---	---	---	---	---	---
MW-4	12/23/93	40.11	---	---	---	ND<50	---	3.1	1.6	1	3.8	---	---	---	---	PACE
MW-4	04/07/94	40.11	19.12	---	20.99	ND<50	---	ND<0.5	ND<0.5	ND<0.5	ND<0.5	---	---	---	6.6	PACE
MW-4	07/06/94	40.11	19.90	---	20.21	62	---	ND<0.5	ND<0.5	ND<0.5	ND<0.5	---	---	---	4.1	PACE
MW-4	10/07/94	40.11	20.07	---	20.04	ND<50	---	ND<0.5	ND<0.5	ND<0.5	ND<0.5	---	---	---	3.6	PACE
MW-4	01/27/95	40.11	13.72	---	26.39	ND<50	---	ND<0.5	ND<0.5	ND<0.5	ND<1	---	---	---	2.7	ATI
MW-4	03/30/95	40.11	11.46	---	28.65	ND<50	---	ND<0.50	ND<0.50	ND<0.50	ND<1.0	---	---	---	8.3	ATI
MW-4	06/20/95	40.11	14.78	---	25.33	ND<50	---	ND<0.50	ND<0.50	ND<0.50	ND<1.0	---	---	---	---	ATI
MW-4	10/03/95	40.11	19.62	---	20.49	ND<50	---	ND<0.50	ND<0.50	ND<0.50	ND<1.0	5.0	---	---	5.8	ATI
MW-4	12/06/95	40.11	19.91	---	20.20	ND<50	---	ND<0.50	ND<0.50	ND<0.50	ND<1.0	47	---	---	5.7	ATI
MW-4	03/21/96	40.11	11.12	---	28.99	ND<50	---	ND<0.5	ND<1	ND<1	ND<1	ND<10	---	---	7.8	SPL
MW-4	06/21/96	40.11	12.21	---	27.90	ND<50	---	ND<0.5	ND<1	ND<1	ND<1	ND<10	---	---	7.9	SPL
MW-4	09/06/96	40.11	12.89	---	27.22	---	---	---	---	---	---	---	---	---	---	---
MW-4	09/09/96	40.11	---	---	---	ND<50	---	ND<0.5	ND<1.0	ND<1.0	ND<1.0	ND<10	---	---	7.2	SPL

TABLE 1 - SUMMARY OF RESULTS OF GROUNDWATER MONITORING

WELL ID	DATE OF SAMPLING/ MONITORING	CASING ELEVATION (a) (Feet)	DEPTH TO WATER (Feet)	PRODUCT THICKNESS (Feet)	GROUNDWATER ELEVATION (b) (Feet)	TPH-G (ug/l)	TPH-D (ug/l)	B (ug/l)	T (ug/l)	E (ug/l)	X (ug/l)	MTBE (ug/l)	TOG (ug/l)	HVOC (ug/l)	DO (ppm)	LAB
MW-4	12/19/96	40.11	11.01	---	29.10	ND<50	---	ND<0.5	ND<1.0	ND<1.0	ND<1.0	ND<10	---	---	8.4	SPL
MW-4	03/17/97	40.11	10.42	---	29.69	---	---	---	---	---	---	---	---	---	---	---
MW-4	08/12/97	40.11	12.77	---	27.34	---	---	---	---	---	---	---	---	---	---	---
MW-4	12/10/97	40.11	11.22	---	28.89	---	---	---	---	---	---	---	---	---	---	---
MW-4	03/12/98	40.11	10.81	---	29.30	---	---	---	---	---	---	---	---	---	---	---
MW-4	06/23/98	40.11	10.61	---	29.50	---	---	---	---	---	---	---	---	---	---	---
MW-4	03/31/99	40.11	11.46	---	28.65	---	---	---	---	---	---	---	---	---	---	---

TABLE 1 - SUMMARY OF RESULTS OF GROUNDWATER MONITORING

WELL ID	DATE OF SAMPLING/ MONITORING	CASING ELEVATION (Feet)	DEPTH TO WATER (Feet)	PRODUCT THICKNESS (Feet)	GROUNDWATER ELEVATION (Feet)	TPH-G (ug/l)	TPH-D (ug/l)	B (ug/l)	T (ug/l)	E (ug/l)	X (ug/l)	MTBE (ug/l)	TOG (ug/l)	HVOC (ug/l)	DO (ppm)	LAB
MW-5	10/03/91	39.55	18.08	---	21.47	79000	---	13000	7400	1400	6200	---	---	---	---	SUP
MW-5	10/15/91	39.55	18.55	---	21.00	---	---	---	---	---	---	---	---	---	---	---
MW-5	12/04/91	39.55	18.44	0.13	21.21	---	---	---	---	---	---	---	---	---	---	---
MW-5	12/16/91	39.55	18.66	0.01	20.90	---	---	---	---	---	---	---	---	---	---	---
MW-5	01/06/92	39.55	19.12	0.11	20.51	---	---	---	---	---	---	---	---	---	---	---
MW-5	01/22/92	39.55	14.59	---	24.96	---	---	---	---	---	---	---	---	---	---	---
MW-5	01/28/92	39.55	15.25	---	24.30	---	---	---	---	---	---	---	---	---	---	---
MW-5	02/05/92	39.55	15.58	SHEEN	23.97	---	---	---	---	---	---	---	---	---	---	---
MW-5	02/12/92	39.55	15.54	0.01	24.02	---	---	---	---	---	---	---	---	---	---	---
MW-5	02/17/92	39.55	13.98	SHEEN	25.57	---	---	---	---	---	---	---	---	---	---	---
MW-5	04/03/92	39.55	13.63	0.04	25.95	---	---	---	---	---	---	---	---	---	---	---
MW-5	04/08/92	39.55	13.17	0.01	26.39	---	---	---	---	---	---	---	---	---	---	---
MW-5	04/14/92	39.55	13.45	0.01	26.11	---	---	---	---	---	---	---	---	---	---	---
MW-5	04/29/92	39.55	13.75	0.07	25.85	---	---	---	---	---	---	---	---	---	---	---
MW-5	05/07/92	39.55	16.15	0.04	23.43	---	---	---	---	---	---	---	---	---	---	---
MW-5	07/03/92	39.55	17.67	0.08	21.94	---	---	---	---	---	---	---	---	---	---	---
MW-5	09/01/92	39.55	17.83	0.50	22.10	---	---	---	---	---	---	---	---	---	---	---
MW-5	10/08/92	39.55	17.86	0.92	22.38	---	---	---	---	---	---	---	---	---	---	---
MW-5	12/31/92	39.55	15.20	SHEEN	24.35	---	---	---	---	---	---	---	---	---	---	---
MW-5	04/21/93	39.55	12.64	0.02	26.93	---	---	---	---	---	---	---	---	---	---	---
MW-5	07/07/93	39.14	(i) 12.68	0.82	27.08	---	---	---	---	---	---	---	---	---	---	---
MW-5	09/21/93	39.14	14.35	SHEEN	24.79	---	---	---	---	---	---	---	---	---	---	---
MW-5	12/17/93	39.14	12.61	0.41	26.84	---	---	---	---	---	---	---	---	---	---	---
MW-5	04/07/94	39.14	30.00	---	9.14	66000	---	3000	1700	250	6800	---	---	---	---	PACE
MW-5	07/06/94	39.14	---	---	---	29000	---	1900	330	63	2700	---	---	---	---	PACE
MW-5	10/07/94	39.14	28.70	---	10.44	250000	---	2600	660	830	5200	---	---	---	4.2	PACE
QC-1 (h)	10/07/94	---	---	---	---	45000	---	2900	540	260	2600	---	---	---	---	PACE
MW-5	01/27/95	39.14	28.70	---	10.44	---	---	---	---	---	---	---	---	---	---	---
MW-5	03/30/95	39.14	28.95	---	10.19	50000	---	7900	2600	520	6400	---	---	---	5.5	ATI
QC-1 (h)	03/30/95	---	---	---	---	43000	---	7900	2500	440	6200	---	---	---	---	ATI
MW-5	06/20/95	39.14	22.54	---	16.60	34000	---	5100	1900	300	3700	---	---	---	---	ATI
QC-1 (h)	06/20/95	---	---	---	---	26000	---	3500	290	ND<25	3300	---	---	---	---	ATI
MW-5	10/03/95	39.14	18.84	---	20.30	12000	---	68	42	11	1600	330	---	---	---	ATI
QC-1 (h)	10/03/95	---	---	---	---	12000	---	46	39	10	1600	320	---	---	---	ATI
MW-5	12/06/95	39.14	19.07	---	20.07	16000	---	1200	93	51	700	600	---	---	---	ATI
MW-5	03/21/96	39.14	7.43	---	31.71	1500	---	89	28	6	250	ND<10	---	---	7.2	SPL
QC-1 (h)	03/21/96	---	---	---	---	1900	---	92	30	7	270	ND<10	---	---	---	SPL
MW-5	06/21/96	39.14	9.87	---	---	3500	---	740	150	19	400	ND<100	---	---	7.1	SPL
QC-1 (h)	06/21/96	---	---	---	---	2700	---	680	140	20	400	ND<50	---	---	---	SPL

TABLE 1 - SUMMARY OF RESULTS OF GROUNDWATER MONITORING

WELL ID	DATE OF SAMPLING/ MONITORING	CASING ELEVATION (a) (Feet)	DEPTH TO WATER (Feet)	PRODUCT THICKNESS (Feet)	GROUNDWATER ELEVATION (b) (Feet)	TPH-G (ug/l)	TPH-D (ug/l)	B (ug/l)	T (ug/l)	E (ug/l)	X (ug/l)	MTBE (ug/l)	TOG (ug/l)	HVOC (ug/l)	DO (ppm)	LAB
MW-5	09/06/96	39.14	10.52	---	28.62	---	---	---	---	---	---	---	---	---	---	---
MW-5	09/09/96	39.14	---	---	---	82000	---	3100	1700	850	9100	ND<2500	---	---	7.5	SPL
QC-1 (h)	09/09/96	---	---	---	---	90000	---	2900	1600	670	6900	ND<2500	---	---	---	SPL
MW-5	12/19/96	39.14	8.62	---	30.52	41000	---	790	820	120	2040	ND<500	---	---	7.7	SPL
QC-1 (h)	12/19/96	---	---	---	---	26000	---	490	430	63	1140	ND<500	---	---	---	SPL
MW-5	03/17/97	39.14	8.22	---	30.92	5500	---	1.9	2.4	ND<1.0	ND<1.0	29	---	---	6.4	SPL
QC-1 (h)	03/17/97	---	---	---	---	6600	---	2.5	2.7	ND<1.0	ND<1.0	28	---	---	---	SPL
MW-5	08/12/97	39.14	12.18	0.22	27.13	33000	---	6400	2400	680	4400	ND<1000	---	---	6.8	SPL
QC-1 (h)	08/12/97	---	---	---	---	36000	---	6100	2500	720	4500	ND<500	---	---	---	SPL
MW-5	12/10/97	39.14	10.78	0.06	28.41	31000	---	3000	2500	560	5100	500	---	---	1.8	SPL
QC-1 (h)	12/10/97	---	---	---	---	37000	---	2900	2500	440	4800	---	---	---	---	SPL
MW-5	03/12/98	39.14	10.11	0.22	29.20	100000	---	1600	870	250	2600	ND<250	---	---	6.1	SPL
MW-5	06/23/98	39.14	10.20	0.02	28.96	27000	---	2500	840	370	2900	ND<250	---	---	2.1	SPL
QC-1 (h)	06/23/98	---	---	---	---	27000	---	2600	840	400	2950	ND<500	---	---	---	SPL
MW-5 (f)	03/31/99	---	---	---	---	---	---	---	---	---	---	---	---	---	---	---

TABLE 1 - SUMMARY OF RESULTS OF GROUNDWATER MONITORING

WELL ID	DATE OF SAMPLING/ MONITORING	CASING ELEVATION (a) (Feet)	DEPTH TO WATER (Feet)	PRODUCT THICKNESS (Feet)	GROUNDWATER ELEVATION (b) (Feet)	TPH-G (ug/l)	TPH-D (ug/l)	B (ug/l)	T (ug/l)	E (ug/l)	X (ug/l)	MTBE (ug/l)	TOG (ug/l)	HVOC (ug/l)	DO (ppm)	LAB
MW-6	10/03/91	41.59	20.73	---	20.86	ND<50	---	0.7	0.8	ND<0.3	1.3	---	---	---	---	SUP
MW-6	10/15/91	41.59	21.20	---	20.39	---	---	---	---	---	---	---	---	---	---	---
MW-6	12/04/91	41.59	21.26	---	20.33	---	---	---	---	---	---	---	---	---	---	---
MW-6	12/16/91	41.59	21.12	---	20.47	---	---	---	---	---	---	---	---	---	---	---
MW-6	01/06/92	41.59	20.29	---	21.30	ND<50	---	ND<0.5	ND<0.5	ND<0.5	1.6	---	---	---	---	ANA
MW-6	01/22/92	41.59	20.12	---	21.47	---	---	---	---	---	---	---	---	---	---	---
MW-6	01/28/92	41.59	20.20	---	21.39	---	---	---	---	---	---	---	---	---	---	---
MW-6	02/05/92	41.59	20.09	---	21.50	---	---	---	---	---	---	---	---	---	---	---
MW-6	02/12/92	41.59	19.15	---	22.44	---	---	---	---	---	---	---	---	---	---	---
MW-6	02/17/92	41.59	18.02	---	23.57	---	---	---	---	---	---	---	---	---	---	---
MW-6	04/03/92	41.59	16.62	---	24.97	---	---	---	---	---	---	---	---	---	---	---
MW-6	04/08/92	41.59	17.06	---	24.53	ND<50	---	0.6	ND<0.5	1	ND<0.5	---	---	---	---	ANA
MW-6	04/14/92	41.59	17.23	---	24.36	---	---	---	---	---	---	---	---	---	---	---
MW-6	04/29/92	41.59	18.12	---	23.47	---	---	---	---	---	---	---	---	---	---	---
MW-6	05/07/92	41.59	18.52	---	23.07	---	---	---	---	---	---	---	---	---	---	---
MW-6	07/03/92	41.59	19.71	---	21.88	ND<50	---	ND<0.5	ND<0.5	ND<0.5	ND<0.5	---	---	---	---	ANA
MW-6	10/08/92	41.59	21.22	---	20.37	ND<50	---	ND<0.5	ND<0.5	ND<0.5	ND<0.5	---	---	---	---	ANA
QC-1 (h)	10/08/92	---	---	---	---	ND<50	---	ND<0.5	ND<0.5	ND<0.5	ND<0.5	---	---	---	---	ANA
MW-6	12/31/92	41.59	21.33	---	20.26	ND<50	---	ND<0.5	ND<0.5	ND<0.5	ND<0.5	---	---	---	---	ANA
MW-6	04/21/93	41.59	16.45	---	25.14	ND<50	---	ND<0.5	ND<0.5	ND<0.5	ND<0.5	---	---	---	---	PACE
MW-6	07/07/93	41.59	18.68	---	22.91	ND<50	---	ND<0.5	ND<0.5	ND<0.5	ND<0.5	---	29	(j)	---	PACE
MW-6	09/21/93	41.59	19.64	---	21.95	ND<50	---	ND<0.5	ND<0.5	ND<0.5	1.6	---	---	---	---	PACE
MW-6	12/17/93	41.59	21.08	---	20.51	---	---	---	---	---	---	---	---	---	---	---
MW-6	12/23/93	41.59	---	---	---	ND<50	---	ND<0.5	0.5	ND<0.5	0.6	---	---	---	---	PACE
MW-6	04/07/94	41.59	21.27	---	20.32	ND<50	---	ND<0.5	ND<0.5	ND<0.5	ND<0.5	---	---	---	6.1	PACE
MW-6	07/06/94	41.59	19.81	---	21.78	ND<50	---	ND<0.5	ND<0.5	ND<0.5	ND<0.5	---	---	---	4.0	PACE
QC-1 (h)	07/06/94	---	---	---	---	ND<50	---	ND<0.5	ND<0.5	ND<0.5	ND<0.5	---	---	---	---	PACE
MW-6	10/07/94	41.59	21.25	---	20.34	ND<50	---	ND<0.5	ND<0.5	ND<0.5	ND<0.5	---	24	(j)	---	3.5 PACE
MW-6	01/27/95	41.59	12.39	---	29.20	ND<50	---	ND<0.5	ND<0.5	ND<0.5	ND<1	---	---	---	4.2	ATI
MW-6	03/30/95	41.59	11.34	---	30.25	ND<50	---	ND<0.50	ND<0.50	ND<0.50	ND<1.0	---	---	---	6.1	ATI
MW-6	06/20/95	41.59	15.12	---	26.47	ND<50	---	ND<0.50	ND<0.50	ND<0.50	ND<1.0	---	---	---	---	ATI
MW-6	10/03/95	41.59	20.68	---	20.91	ND<50	---	ND<0.50	ND<0.50	ND<0.50	ND<1.0	66	---	---	6.4	ATI
MW-6	12/06/95	41.59	23.77	---	17.82	ND<50	---	ND<0.50	ND<0.50	ND<0.50	ND<1.0	45	---	---	5.7	ATI
MW-6	03/21/96	41.59	11.55	---	30.04	ND<50	---	ND<0.5	ND<1	ND<1	ND<1	41	---	---	9.1	SPL
MW-6	06/21/96	41.59	12.60	---	28.99	ND<50	---	ND<0.5	ND<1	ND<1	ND<1	ND<10	---	---	8.6	SPL
MW-6	09/06/96	41.59	13.25	---	28.34	---	---	---	---	---	---	---	---	---	---	---
MW-6	09/09/96	41.59	---	---	---	ND<50	---	ND<0.5	ND<1.0	ND<1.0	ND<1.0	22/22	(k)	---	7.9	SPL
MW-6	12/19/96	41.59	11.45	---	30.14	ND<50	---	ND<0.5	ND<1.0	ND<1.0	ND<1.0	ND<10	---	---	7.7	SPL
MW-6	03/17/97	41.59	10.80	---	30.79	---	---	---	---	---	---	---	---	---	---	---

TABLE 1 - SUMMARY OF RESULTS OF GROUNDWATER MONITORING

WELL ID	DATE OF SAMPLING/ MONITORING	CASING ELEVATION (a) (Feet)	DEPTH TO WATER (Feet)	PRODUCT THICKNESS (Feet)	GROUNDWATER ELEVATION (b) (Feet)	TPH-G (ug/l)	TPH-D (ug/l)	B (ug/l)	T (ug/l)	E (ug/l)	X (ug/l)	MTBE (ug/l)	TOG (ug/l)	HVOC (ug/l)	DO (ppm)	LAB
MW-6	08/12/97	41.59	13.11	---	28.48	---	---	---	---	---	---	---	---	---	---	---
MW-6	12/10/97	41.59	13.84	---	27.75	---	---	---	---	---	---	---	---	---	---	---
MW-6	03/12/98	41.59	11.17	---	30.42	---	---	---	---	---	---	---	---	---	---	---
MW-6	06/23/98	41.59	13.27	---	28.32	---	---	---	---	---	---	---	---	---	---	---
MW-6	03/31/99	41.59	12.91	---	28.68	---	---	---	---	---	---	---	---	---	---	---

TABLE 1 - SUMMARY OF RESULTS OF GROUNDWATER MONITORING

WELL ID	DATE OF SAMPLING/ MONITORING	CASING ELEVATION (a) (Feet)	DEPTH TO WATER (Feet)	PRODUCT THICKNESS (Feet)	GROUNDWATER ELEVATION (b) (Feet)	TPH-G (ug/l)	TPH-D (ug/l)	B (ug/l)	T (ug/l)	E (ug/l)	X (ug/l)	MTBE (ug/l)	TOG (ug/l)	HVOC (ug/l)	DO (ppm)	LAB
MW-7	10/03/91	40.64	14.93	---	25.71	360	---	62	13	3.4	20	---	---	---	---	SUP
MW-7	10/15/91	40.64	15.16	---	25.48	---	---	---	---	---	---	---	---	---	---	---
MW-7	12/04/91	40.64	15.41	---	25.23	---	---	---	---	---	---	---	---	---	---	---
MW-7	12/16/91	40.64	15.21	---	25.43	---	---	---	---	---	---	---	---	---	---	---
MW-7	01/06/92	40.64	14.56	---	26.08	1100	---	170	ND<0.5	24	23	---	---	---	---	ANA
MW-7	01/22/92	40.64	14.63	---	26.01	---	---	---	---	---	---	---	---	---	---	---
MW-7	01/28/92	40.64	14.73	---	25.91	---	---	---	---	---	---	---	---	---	---	---
MW-7	02/05/92	40.64	14.58	---	26.06	---	---	---	---	---	---	---	---	---	---	---
MW-7	02/12/92	40.64	13.94	---	26.70	---	---	---	---	---	---	---	---	---	---	---
MW-7	02/17/92	40.64	13.10	---	27.54	---	---	---	---	---	---	---	---	---	---	---
MW-7	04/03/92	40.64	12.66	---	27.98	---	---	---	---	---	---	---	---	---	---	---
MW-7	04/08/92	40.64	12.77	---	27.87	750	---	150	ND<0.5	23	9.9	---	---	---	---	ANA
MW-7	04/14/92	40.64	13.02	---	27.62	---	---	---	---	---	---	---	---	---	---	---
MW-7	04/29/92	40.64	13.59	---	27.05	---	---	---	---	---	---	---	---	---	---	---
MW-7	05/07/92	40.64	13.95	---	26.69	---	---	---	---	---	---	---	---	---	---	---
MW-7	07/03/92	40.64	14.73	---	25.91	660	---	210	ND<2.5	33	8	---	---	---	---	ANA
MW-7	10/08/92	40.64	15.75	---	24.89	320	---	49	1.4	13	6.2	---	---	---	---	ANA
MW-7	12/31/92	40.64	13.57	---	27.07	900	---	100	ND<2.5	28	4.3	---	---	---	---	ANA
MW-7	04/21/93	40.64	14.56	---	26.08	510	---	83	1.2	10	5.8	---	---	---	---	PACE
MW-7	07/07/93	40.32	(i) 13.40	---	26.92	1100	---	160	2.0	27	4.0	---	---	---	---	PACE
QC-1 (h)	07/07/93	---	---	---	---	1100	---	170	1.9	29	2.8	---	---	---	---	PACE
MW-7	09/21/93	40.32	14.40	---	25.92	690	---	150	3.1	26	5.7	---	---	---	---	PACE
QC-1 (h)	09/21/93	---	---	---	---	640	---	140	1.7	23	2.4	---	---	---	---	PACE
MW-7	12/17/93	40.32	13.65	---	26.67	---	---	---	---	---	---	---	---	---	---	---
MW-7	12/23/93	40.32	---	---	---	250	---	64	1.2	9	1.8	---	---	---	---	PACE
MW-7	04/07/94	40.32	30.62	---	9.70	140	---	32	1.4	ND<0.5	ND<0.5	---	---	---	---	PACE
MW-7	07/06/94	40.32	16.88	---	23.44	410	---	94	1.3	10	3.5	---	---	---	4.4	PACE
MW-7	10/07/94	40.32	25.59	---	14.73	ND<50	---	9.2	ND<0.5	ND<0.5	ND<0.5	---	---	---	4.9	PACE
MW-7	01/27/95	40.32	9.82	---	30.50	810	---	570	3	60	17	---	---	---	0	ATI
QC-1 (h)	01/27/95	---	---	---	---	930	---	620	4	77	21	---	---	---	---	ATI
MW-7	03/30/95	40.32	9.15	---	31.17	180	---	65	0.53	2	ND<1.0	---	---	---	7.8	ATI
MW-7	06/20/95	40.32	11.38	---	28.94	2800	---	980	ND<5.0	ND<5.0	43	---	---	---	---	ATI
MW-7	10/03/95	40.32	29.95	---	10.37	ND<50	---	ND<0.50	ND<0.50	ND<0.50	ND<1.0	ND<5.0	---	---	---	ATI
MW-7	12/06/95	40.32	29.85	---	10.47	ND<50	---	ND<0.50	ND<0.50	ND<0.50	ND<1.0	ND<5.0	---	---	---	ATI
MW-7	03/21/96	40.32	9.76	---	30.56	1000	---	390	2	40	13	ND<10	---	---	7.4	SPL
MW-7	06/21/96	40.32	11.01	---	29.31	ND<250	---	40	ND<5	ND<5	ND<5	ND<50	---	---	7.4	SPL
MW-7	09/06/96	40.32	11.68	---	28.64	---	---	---	---	---	---	---	---	---	---	---
MW-7	09/09/96	40.32	---	---	---	ND<250	---	13	ND<5.0	ND<5.0	ND<5.0	ND<50	---	---	7.2	SPL
MW-7	12/19/96	40.32	10.78	---	29.54	70	---	1.2	ND<1.0	1	ND<1.0	ND<10	---	---	8.3	SPL

TABLE 1 - SUMMARY OF RESULTS OF GROUNDWATER MONITORING

WELL ID	DATE OF SAMPLING/ MONITORING	CASING ELEVATION (a) (Feet)	DEPTH TO WATER (Feet)	PRODUCT THICKNESS (Feet)	GROUNDWATER ELEVATION (b) (Feet)	TPH-G (ug/l)	TPH-D (ug/l)	B (ug/l)	T (ug/l)	E (ug/l)	X (ug/l)	MTBE (ug/l)	TOG (ug/l)	HVOC (ug/l)	DO (ppm)	LAB
MW-7	03/17/97	40.32	9.96	---	30.36	---	---	---	---	---	---	---	---	---	---	---
MW-7	08/12/97	40.32	11.44	---	28.88	---	---	---	---	---	---	---	---	---	---	---
MW-7	12/10/97	40.32	10.42	---	29.90	---	---	---	---	---	---	---	---	---	---	---
MW-7	03/12/98	40.32	9.51	---	30.81	---	---	---	---	---	---	---	---	---	---	---
MW-7	06/23/98	40.32	9.98	---	30.34	---	---	---	---	---	---	---	---	---	---	---
MW-7	03/31/99	40.32	10.38	---	29.94	---	---	---	---	---	---	---	---	---	---	---

TABLE 1 - SUMMARY OF RESULTS OF GROUNDWATER MONITORING

WELL ID	DATE OF SAMPLING/ MONITORING	CASING ELEVATION (a) (Feet)	DEPTH TO WATER (Feet)	PRODUCT THICKNESS (Feet)	GROUNDWATER ELEVATION (b) (Feet)	TPH-G (ug/l)	TPH-D (ug/l)	B (ug/l)	T (ug/l)	E (ug/l)	X (ug/l)	MTBE (ug/l)	TOG (ug/l)	HVOC (ug/l)	DO (ppm)	LAB
MW-8	10/03/91	38.18	22.37	---	15.81	ND<50	---	ND<0.3	0.6	ND<0.3	0.9	---	---	---	---	SUP
MW-8	10/15/91	38.18	22.70	---	15.48	---	---	---	---	---	---	---	---	---	---	---
MW-8	12/04/91	38.18	22.44	---	15.74	---	---	---	---	---	---	---	---	---	---	---
MW-8	12/16/91	38.18	22.47	---	15.71	---	---	---	---	---	---	---	---	---	---	---
MW-8	01/06/92	38.18	21.94	---	16.24	ND<50	---	ND<0.5	ND<0.5	ND<0.5	ND<0.5	---	---	---	---	ANA
MW-8	01/22/92	38.18	21.44	---	16.74	---	---	---	---	---	---	---	---	---	---	---
MW-8	01/28/92	38.18	21.20	---	16.98	---	---	---	---	---	---	---	---	---	---	---
MW-8	02/05/92	38.18	20.88	---	17.30	---	---	---	---	---	---	---	---	---	---	---
MW-8	02/12/92	38.18	20.54	---	17.64	---	---	---	---	---	---	---	---	---	---	---
MW-8	02/17/92	38.18	19.99	---	18.19	---	---	---	---	---	---	---	---	---	---	---
MW-8	04/03/92	38.18	16.75	---	21.43	---	---	---	---	---	---	---	---	---	---	---
MW-8	04/08/92	38.18	16.57	---	21.61	ND<50	---	ND<0.5	ND<0.5	ND<0.5	ND<0.5	---	---	---	---	ANA
MW-8 (f)	04/14/92	38.18	---	---	---	---	---	---	---	---	---	---	---	---	---	---
MW-8	04/29/92	38.18	18.61	---	19.57	---	---	---	---	---	---	---	---	---	---	---
MW-8	05/07/92	38.18	18.41	---	19.77	---	---	---	---	---	---	---	---	---	---	---
MW-8	07/03/92	38.18	20.35	---	17.83	ND<50	---	ND<0.5	ND<0.5	ND<0.5	ND<0.5	---	---	---	---	ANA
MW-8 (f)	10/08/92	38.18	21.74	---	16.44	---	---	---	---	---	---	---	---	---	---	---
MW-8	12/31/92	38.18	19.09	---	19.09	ND<50	---	ND<0.5	ND<0.5	ND<0.5	ND<0.5	---	---	---	---	ANA
MW-8	04/21/93	38.18	18.92	---	19.26	ND<50	---	ND<0.5	ND<0.5	ND<0.5	ND<0.5	---	---	---	---	PACE
MW-8	07/07/93	38.18	17.76	---	20.42	ND<50	---	ND<0.5	ND<0.5	ND<0.5	ND<0.5	---	---	---	---	PACE
MW-8	09/21/93	38.18	19.71	---	18.47	ND<50	---	2.9	2.2	2	7.1	---	---	---	---	PACE
MW-8	12/17/93	38.18	21.33	---	16.85	---	---	---	---	---	---	---	---	---	---	---
MW-8	12/23/93	38.18	---	---	---	ND<50	---	ND<0.5	ND<0.5	ND<0.5	0.6	---	---	---	---	PACE
MW-8	04/07/94	38.18	21.51	---	16.67	ND<50	---	ND<0.5	ND<0.5	ND<0.5	ND<0.5	---	---	---	6.6	PACE
MW-8	07/06/94	38.18	17.41	---	20.77	ND<50	---	ND<0.5	ND<0.5	ND<0.5	ND<0.5	---	---	---	4.4	PACE
MW-8	10/07/94	38.18	19.20	---	18.98	ND<50	---	ND<0.5	ND<0.5	ND<0.5	ND<0.5	---	---	---	3.7	PACE
MW-8	01/27/95	38.18	12.25	---	25.93	ND<50	---	ND<0.5	ND<0.5	ND<0.5	ND<1	---	---	---	2.9	ATI
MW-8	03/30/95	38.18	10.35	---	27.83	ND<50	---	ND<0.50	ND<0.50	ND<0.50	ND<1.0	---	---	---	8.3	ATI
MW-8	06/20/95	38.18	13.37	---	24.81	ND<50	---	ND<0.50	ND<0.50	ND<0.50	ND<1.0	---	---	---	6.9	ATI
MW-8 (f)	10/03/95	38.18	---	---	---	---	---	---	---	---	---	---	---	---	---	---
MW-8	12/06/95	38.18	18.42	---	19.76	ND<50	---	ND<0.50	ND<0.50	ND<0.50	ND<1.0	---	---	---	5.3	ATI
MW-8 (f)	03/21/96	38.18	---	---	---	---	---	---	---	---	---	---	---	---	---	---
MW-8	06/21/96	38.18	13.03	---	25.15	ND<50	---	ND<0.5	ND<1	ND<1	ND<1	ND<10	---	---	7.0	SPL
MW-8	09/06/96	38.18	13.70	---	24.48	---	---	---	---	---	---	---	---	---	---	---
MW-8	09/09/96	38.18	---	---	---	ND<50	---	ND<0.5	ND<1.0	ND<1.0	ND<1.0	ND<10	---	---	7.0	SPL
MW-8	12/19/96	38.18	11.93	---	26.25	ND<50	---	ND<0.5	ND<1.0	ND<1.0	ND<1.0	ND<10	---	---	7.6	SPL
MW-8	03/17/97	38.18	11.29	---	26.89	---	---	---	---	---	---	---	---	---	---	---
MW-8	08/12/97	38.18	13.73	---	24.45	---	---	---	---	---	---	---	---	---	---	---
MW-8	12/10/97	38.18	11.88	---	26.30	---	---	---	---	---	---	---	---	---	---	---

TABLE 1 - SUMMARY OF RESULTS OF GROUNDWATER MONITORING

WELL ID	DATE OF SAMPLING/ MONITORING	CASING ELEVATION (Feet)	DEPTH TO WATER (Feet)	PRODUCT THICKNESS (Feet)	GROUNDWATER ELEVATION (Feet)	TPH-G (ug/l)	TPH-D (ug/l)	B (ug/l)	T (ug/l)	E (ug/l)	X (ug/l)	MTBE (ug/l)	TOG (ug/l)	HVOC (ug/l)	DO (ppm)	LAB
MW-8	03/12/98	38.18	11.89	---	26.29	---	---	---	---	---	---	---	---	---	---	---
MW-8	06/23/98	38.18	11.33	---	26.85	---	---	---	---	---	---	---	---	---	---	---
MW-8	03/31/99	38.18	12.68	---	25.50	---	---	---	---	---	---	---	---	---	---	---

TABLE 1 - SUMMARY OF RESULTS OF GROUNDWATER MONITORING

WELL ID	DATE OF SAMPLING/ MONITORING	CASING ELEVATION (a) (Feet)	DEPTH TO WATER (Feet)	PRODUCT THICKNESS (Feet)	GROUNDWATER ELEVATION (b) (Feet)	TPH-G (ug/l)	TPH-D (ug/l)	B (ug/l)	T (ug/l)	E (ug/l)	X (ug/l)	MTBE (ug/l)	TOG (ug/l)	HVOC (ug/l)	DO (ppm)	LAB
MW-9	10/03/91	41.25	14.12	---	27.13	ND<50	---	ND<0.3	0.4	ND<0.3	ND<0.3	---	---	---	---	SUP
MW-9	10/15/91	41.25	14.27	---	26.98	---	---	---	---	---	---	---	---	---	---	---
MW-9	12/04/91	41.25	13.84	---	27.41	---	---	---	---	---	---	---	---	---	---	---
MW-9	12/16/91	41.25	14.18	---	27.07	---	---	---	---	---	---	---	---	---	---	---
MW-9	01/06/92	41.25	13.42	---	27.83	ND<50	---	ND<0.5	ND<0.5	ND<0.5	0.9	---	---	---	---	ANA
MW-9	01/22/92	41.25	13.75	---	27.50	---	---	---	---	---	---	---	---	---	---	---
MW-9	01/28/92	41.25	14.76	---	26.49	---	---	---	---	---	---	---	---	---	---	---
MW-9	02/05/92	41.25	13.38	---	27.87	---	---	---	---	---	---	---	---	---	---	---
MW-9	02/12/92	41.25	11.86	---	29.39	---	---	---	---	---	---	---	---	---	---	---
MW-9	02/17/92	41.25	10.78	---	30.47	---	---	---	---	---	---	---	---	---	---	---
MW-9	04/03/92	41.25	11.63	---	29.62	---	---	---	---	---	---	---	---	---	---	---
MW-9	04/08/92	41.25	12.25	---	29.00	ND<50	---	ND<0.5	ND<0.5	ND<0.5	ND<0.5	---	---	---	---	ANA
MW-9	04/14/92	41.25	12.32	---	28.93	---	---	---	---	---	---	---	---	---	---	---
MW-9	04/29/92	41.25	13.07	---	28.18	---	---	---	---	---	---	---	---	---	---	---
MW-9	05/07/92	41.25	14.43	---	26.82	---	---	---	---	---	---	---	---	---	---	---
MW-9	07/03/92	41.25	13.85	---	27.40	ND<50	---	ND<0.5	ND<0.5	ND<0.5	ND<0.5	---	---	---	---	ANA
MW-9	10/08/92	41.25	14.89	---	26.36	ND<50	---	ND<0.5	ND<0.5	ND<0.5	ND<0.5	---	---	---	---	ANA
MW-9	12/31/92	41.25	11.90	---	29.35	ND<50	---	ND<0.5	ND<0.5	ND<0.5	ND<0.5	---	---	---	---	ANA
MW-9	04/21/93	41.25	13.68	---	27.57	ND<50	---	ND<0.5	ND<0.5	ND<0.5	ND<0.5	---	---	---	---	PACE
MW-9	07/07/93	41.25	13.12	---	28.13	ND<50	---	ND<0.5	ND<0.5	ND<0.5	ND<0.5	---	---	---	---	PACE
MW-9	09/21/93	41.25	14.00	---	27.25	ND<50	---	ND<0.5	ND<0.5	ND<0.5	0.9	---	---	---	---	PACE
MW-9	12/17/93	41.25	12.98	---	28.27	---	---	---	---	---	---	---	---	---	---	---
MW-9	12/23/93	41.25	---	---	---	ND<50	---	ND<0.5	ND<0.5	ND<0.5	0.9	---	---	---	---	PACE
MW-9	04/07/94	41.25	13.24	---	28.01	ND<50	---	ND<0.5	ND<0.5	ND<0.5	ND<0.5	---	---	---	4.7	PACE
MW-9	07/06/94	41.25	13.77	---	27.48	ND<50	---	ND<0.5	ND<0.5	ND<0.5	ND<0.5	---	---	---	3.9	PACE
MW-9	10/07/94	41.25	14.60	---	26.65	ND<50	---	ND<0.5	ND<0.5	ND<0.5	ND<0.5	---	---	---	3.0	PACE
MW-9	01/27/95	41.25	8.47	---	32.78	ND<50	---	ND<0.5	ND<0.5	ND<0.5	ND<1	---	---	---	2.5	ATI
MW-9	03/30/95	41.25	8.19	---	33.06	ND<50	---	ND<0.5	ND<0.50	ND<0.50	ND<1.0	---	---	---	8.4	ATI
MW-9	06/20/95	41.25	11.25	---	30.00	ND<50	---	ND<0.50	ND<0.50	ND<0.50	ND<1.0	---	---	---	8.1	ATI
MW-9	10/03/95	41.25	14.68	---	26.57	ND<50	---	ND<0.50	ND<0.50	ND<0.50	ND<1.0	ND<5.0	---	---	6.0	ATI
MW-9	12/06/95	41.25	16.07	---	25.18	ND<50	---	ND<0.50	ND<0.50	ND<0.50	ND<1.0	46	---	---	5.4	ATI
MW-9	03/21/96	41.25	9.60	---	31.65	ND<50	---	ND<0.5	ND<1	ND<1	ND<1	ND<10	---	---	8.0	SPL
MW-9	06/21/96	41.25	10.86	---	30.39	ND<50	---	ND<0.5	ND<1	ND<1	ND<1	ND<10	---	---	7.8	SPL
MW-9	09/06/96	41.25	11.52	---	29.73	---	---	---	---	---	---	---	---	---	---	---
MW-9	09/09/96	41.25	---	---	---	ND<50	---	ND<0.5	ND<1.0	ND<1.0	ND<1.0	20/21 (k)	---	---	7.3	SPL
MW-9	12/19/96	41.25	10.43	---	30.82	ND<50	---	ND<0.5	ND<1.0	ND<1.0	ND<1.0	ND<10	---	---	7.3	SPL
MW-9	03/17/97	41.25	9.87	---	31.38	---	---	---	---	---	---	---	---	---	---	---
MW-9	08/12/97	41.25	11.44	---	29.81	---	---	---	---	---	---	---	---	---	---	---
MW-9	12/10/97	41.25	10.44	---	30.81	---	---	---	---	---	---	---	---	---	---	---

TABLE 1 - SUMMARY OF RESULTS OF GROUNDWATER MONITORING

WELL ID	DATE OF SAMPLING/ MONITORING	CASING ELEVATION (Feet)	DEPTH TO WATER (Feet)	PRODUCT THICKNESS (Feet)	GROUNDWATER ELEVATION (Feet)	TPH-G (ug/l)	TPH-D (ug/l)	B (ug/l)	T (ug/l)	E (ug/l)	X (ug/l)	MTBE (ug/l)	TOG (ug/l)	HVOC (ug/l)	DO (ppm)	LAB
MW-9	03/12/98	41.25	9.50	---	31.75	---	---	---	---	---	---	---	---	---	---	---
MW-9	06/23/98	41.25	10.06	---	31.19	---	---	---	---	---	---	---	---	---	---	---
MW-9	03/31/99	41.25	9.06	---	32.19	---	---	---	---	---	---	---	---	---	---	---

TABLE 1 - SUMMARY OF RESULTS OF GROUNDWATER MONITORING

WELL ID	DATE OF SAMPLING/ MONITORING	CASING ELEVATION (a) (Feet)	DEPTH TO WATER (Feet)	PRODUCT THICKNESS (Feet)	GROUNDWATER ELEVATION (b) (Feet)	TPH-G (ug/l)	TPH-D (ug/l)	B (ug/l)	T (ug/l)	E (ug/l)	X (ug/l)	MTBE (ug/l)	TOG (ug/l)	HVOC (ug/l)	DO (ppm)	LAB
QC-2 (I)	10/08/92	---	---	---	---	ND<50	---	ND<0.5	ND<0.5	ND<0.5	ND<0.5	---	---	---	---	ANA
QC-2 (I)	12/31/92	---	---	---	---	ND<50	---	ND<0.5	ND<0.5	ND<0.5	ND<0.5	---	---	---	---	ANA
QC-2 (I)	04/21/93	---	---	---	---	---	---	---	---	---	---	---	---	ND	---	PACE
QC-2 (I)	07/07/93	---	---	---	---	ND<50	---	ND<0.5	ND<0.5	ND<0.5	0.6	---	---	---	---	PACE
QC-2 (I)	09/21/93	---	---	---	---	ND<50	---	ND<0.5	ND<0.5	ND<0.5	ND<0.5	---	---	---	---	PACE
QC-2 (I)	12/23/93	---	---	---	---	ND<50	---	ND<0.5	ND<0.5	ND<0.5	ND<0.5	---	---	---	---	PACE
QC-2 (I)	04/07/94	---	---	---	---	ND<50	---	ND<0.5	ND<0.5	ND<0.5	ND<0.5	---	---	---	---	PACE
QC-2 (I)	07/06/94	---	---	---	---	ND<50	---	ND<0.5	ND<0.5	ND<0.5	ND<0.5	---	---	---	---	PACE
QC-2 (I)	10/07/94	---	---	---	---	ND<50	---	ND<0.5	ND<0.5	ND<0.5	ND<0.5	---	---	---	---	PACE
QC-2 (I)	01/27/95	---	---	---	---	ND<50	---	ND<0.5	0.5	ND<0.5	ND<1	---	---	---	---	ATI
QC-2 (I)	03/30/95	---	---	---	---	ND<50	---	ND<0.50	ND<0.50	ND<0.50	ND<1.0	---	---	---	---	ATI
QC-2 (I)	06/20/95	---	---	---	---	ND<50	---	ND<0.50	ND<0.50	ND<0.50	ND<1.0	---	---	---	---	ATI
QC-2 (I)	10/03/95	---	---	---	---	ND<50	---	ND<0.50	ND<0.50	ND<0.50	ND<1.0	ND<5.0	---	---	---	ATI
QC-2 (I)	12/06/95	---	---	---	---	ND<50	---	ND<0.50	ND<0.50	ND<0.50	ND<1.0	ND<5.0	---	---	---	ATI
QC-2 (I)	03/21/96	---	---	---	---	ND<50	---	ND<0.5	ND<1	ND<1	ND<1	ND<10	---	---	---	SPL
QC-2 (I)	06/21/96	---	---	---	---	ND<50	---	ND<0.5	ND<1	ND<1	ND<1	ND<10	---	---	---	SPL

TABLE 1 - SUMMARY OF RESULTS OF GROUNDWATER MONITORING

ABBREVIATIONS:

TPH-G	Total petroleum hydrocarbons as gasoline
TPH-D	Total petroleum hydrocarbons as diesel
B	Benzene
T	Toluene
E	Ethylbenzene
X	Total xylenes
MTBE	Methyl tert butyl ether
TOG	Total oil and grease
HVOC	Halogenated volatile organic compounds
DO	Dissolved oxygen
ug/l	Micrograms per liter
ppm	Parts per million
---	Not analyzed/measured/applicable
ND	Not detected above reported detection limit
SUP	Superior Analytical Laboratory
ANA	Anamatrix, Inc.
PACE	Pace, Inc.
ATI	Analytical Technologies, Inc.
SPL	Southern Petroleum Laboratories

NOTES:

- (a) Top of casing elevations surveyed in feet above mean sea level, relative to the NGVD (1929).
- (b) Groundwater elevations adjusted assuming a specific gravity of 0.75 for free product.
- (c) Well destroyed during tank removal in November 1990.
- (d) Methylene chloride.
- (e) 1,2-Dichloroethane.
- (f) Well inaccessible.
- (g) Sample collected from MW-2 for TPH-D analysis received in laboratory 7 days after collection; sample exceeded EPA recommended holding time for TPH-D on a water matrix.
- (h) Blind duplicate.
- (i) Top of casing lowered.
- (j) A copy of the documentation for this data is included in Appendix C of Alisto report 10-014-07-001.
- (k) EPA Methods 8020/8260 used.
- (l) Travel blank.

TABLE 2 - SUMMARY OF RESULTS OF GROUNDWATER MONITORING

WELL ID	DATE OF MONITORING	CASING ELEVATION (Feet)	(a)	DEPTH TO WATER (Feet)	PRODUCT THICKNESS (Feet)	GROUNDWATER ELEVATION (Feet)	(b)	TPH-G (ug/l)	B (ug/l)	T (ug/l)	E (ug/l)	X (ug/l)	MTBE (ug/l)
C-1	07/14/92	38.41		27.61	---	10.80		---	---	---	---	---	---
C-1	10/08/92	38.41		24.44	---	13.97		---	---	---	---	---	---
C-1	09/21/93	38.41		21.42	---	16.99		---	---	---	---	---	---
C-1	03/30/95	38.41		12.02	---	26.39		---	---	---	---	---	---
C-1	06/20/95	38.41		14.40	---	24.01		---	---	---	---	---	---
C-1	03/21/96	38.41		11.65	---	26.76		---	---	---	---	---	---
C-1	09/06/96	38.41		16.75	---	21.66		---	---	---	---	---	---
C-1	12/19/96	38.41		13.98	---	24.43		---	---	---	---	---	---
C-1	03/17/97	38.41		12.78	---	25.63		---	---	---	---	---	---
C-1	06/11/97	38.41		15.16	---	23.25		---	---	---	---	---	---
C-1	09/17/97	38.41		16.94	---	21.47		---	---	---	---	---	---
C-1	12/10/97	38.41		13.18	---	25.23		---	---	---	---	---	---
C-1	03/12/98	38.41		9.49	---	28.92		---	---	---	---	---	---
C-1	06/23/98	38.41		10.22	---	28.19		1300	650	6.9	22	6.5	290
C-1	09/01/98	38.41		16.98	---	21.43		270	6.0	ND<2.5	ND<2.5	ND<2.5	950
C-1	12/30/98	38.41		16.12	---	22.29		2020	578	ND<5.0	ND<5.0	<5.0	1720
C-1	03/31/99	38.41		13.88	---	24.53		2140	776	5.89	ND<5.0	5.15	1170

TABLE 2 - SUMMARY OF RESULTS OF GROUNDWATER MONITORING

WELL ID	DATE OF MONITORING	CASING ELEVATION (Feet)	(a)	DEPTH TO WATER (Feet)	PRODUCT THICKNESS (Feet)	GROUNDWATER ELEVATION (Feet)	(b)	TPH-G (ug/l)	B (ug/l)	T (ug/l)	E (ug/l)	X (ug/l)	MTBE (ug/l)
C-2	07/14/92	37.47		---	---	---		---	---	---	---	---	---
C-2	10/08/92	37.47		---	---	---		---	---	---	---	---	---
C-2	09/21/93	37.47		26.29	---	11.18		---	---	---	---	---	---
C-2	03/30/95	37.47		17.18	---	20.29		---	---	---	---	---	---
C-2	06/20/95	37.47		18.95	---	18.52		---	---	---	---	---	---
C-2	03/21/96	37.47		16.17	---	21.30		---	---	---	---	---	---
C-2	09/06/96	37.47		21.14	0.04	16.36		---	---	---	---	---	---
C-2	12/19/96	37.47		17.55	0.03	19.94		---	---	---	---	---	---
C-2	03/17/97	37.47		18.59	---	18.88		---	---	---	---	---	---
C-2	06/11/97	37.47		21.30	---	16.17		---	---	---	---	---	---
C-2	09/17/97	37.47		23.14	---	14.33		---	---	---	---	---	---
C-2	12/10/97	37.47		17.21	---	20.26		---	---	---	---	---	---
C-2	03/12/98	37.47		14.17	---	23.30		---	---	---	---	---	---
C-2	06/23/98	37.47		14.82	---	22.65		1100000	6800	5100	13000	38000	ND<1000
C-2	09/01/98	37.47		21.78	---	15.69		9700	300	8.2	6.2	250	3700
C-2	12/30/98	37.47		21.86	---	15.61		110000	4790	1300	841	5570	2420
C-2	03/31/99	37.47		16.90	---	20.57		48000	4800	1110	1520	5450	2160

TABLE 2 - SUMMARY OF RESULTS OF GROUNDWATER MONITORING

WELL ID	DATE OF MONITORING	CASING ELEVATION (Feet)	(a)	DEPTH TO WATER (Feet)	PRODUCT THICKNESS (Feet)	GROUNDWATER ELEVATION (Feet)	(b)	TPH-G (ug/l)	B (ug/l)	T (ug/l)	E (ug/l)	X (ug/l)	MTBE (ug/l)
C-3	07/14/92	38.37		27.87	---	10.50		---	---	---	---	---	---
C-3	10/08/92	38.37		28.55	---	9.82		---	---	---	---	---	---
C-3	09/21/93	38.37		26.22	---	12.15		---	---	---	---	---	---
C-3	03/30/95	38.37		18.42	---	19.95		---	---	---	---	---	---
C-3	06/20/95	38.37		19.79	---	18.58		---	---	---	---	---	---
C-3	03/21/96	38.37		17.85	---	20.52		---	---	---	---	---	---
C-3	09/06/96	38.37		21.63	---	16.74		---	---	---	---	---	---
C-3	12/19/96	38.37		22.30	---	16.07		---	---	---	---	---	---
C-3	03/17/97	38.37		18.95	---	19.42		---	---	---	---	---	---
C-3	06/11/97	38.37		21.15	---	17.23		---	---	---	---	---	---
C-3	09/17/97	38.37		22.41	---	15.96		---	---	---	---	---	---
C-3	12/10/97	38.37		22.26	---	16.11		---	---	---	---	---	---
C-3	03/12/98	38.37		18.35	---	20.02		---	---	---	---	---	---
C-3	06/23/98	38.37		19.04	---	19.33		ND<50	ND<0.5	ND<0.5	ND<0.5	ND<0.5	ND<2.5
C-3	09/01/98	38.37		19.97	---	18.40		200	6.8	0.31	0.52	2.0	ND<2.5
C-3	12/30/98	38.37		21.31	---	17.06		ND<50	ND<0.5	ND<0.5	ND<0.5	ND<0.5	ND<2.0
C-3	03/31/99	38.37		17.77	---	20.60		ND<50	ND<0.5	ND<0.5	ND<0.5	ND<0.5	12.6

TABLE 2 - SUMMARY OF RESULTS OF GROUNDWATER MONITORING

WELL ID	DATE OF MONITORING	CASING ELEVATION (Feet)	(a)	DEPTH TO WATER (Feet)	PRODUCT THICKNESS (Feet)	GROUNDWATER ELEVATION (Feet)	(b)	TPH-G (ug/l)	B (ug/l)	T (ug/l)	E (ug/l)	X (ug/l)	MTBE (ug/l)
C-4	07/14/92	36.49		26.89	---	9.60		---	---	---	---	---	---
C-4	10/08/92	36.49		27.79	---	8.70		---	---	---	---	---	---
C-4	09/21/93	36.49		25.51	---	10.98		---	---	---	---	---	---
C-4	03/30/95	36.49		14.86	---	21.63		---	---	---	---	---	---
C-4	06/20/95	36.49		16.90	---	19.59		---	---	---	---	---	---
C-4	03/21/96	36.49		14.10	---	22.39		---	---	---	---	---	---
C-4	09/06/96	36.49		20.13	---	16.36		---	---	---	---	---	---
C-4	12/19/96	36.49		16.92	---	19.57		---	---	---	---	---	---
C-4	03/17/97	36.49		17.40	---	19.09		---	---	---	---	---	---
C-4	06/11/97	36.49		18.34	---	18.15		---	---	---	---	---	---
C-4	09/17/97	36.49		21.46	---	15.03		---	---	---	---	---	---
C-4	12/10/97	36.49		16.65	---	19.84		---	---	---	---	---	---
C-4	03/12/98	36.49		16.59	---	19.90		---	---	---	---	---	---
C-4	06/23/98	36.49		17.02	---	19.47		27000	1600	160	180	690	100
C-4	09/01/98	36.49		21.45	---	15.04		520	14	2.3	ND<0.50	4.8	61
C-4	12/30/98	36.49		21.42	---	15.07		122	14.1	1.86	ND<1.0	3.61	349
C-4	03/31/99	36.49		15.20	---	21.29		20300	4450	443	1000	2130	1320

TABLE 2 - SUMMARY OF RESULTS OF GROUNDWATER MONITORING

WELL ID	DATE OF MONITORING	CASING ELEVATION (Feet)	(a)	DEPTH TO WATER (Feet)	PRODUCT THICKNESS (Feet)	GROUNDWATER ELEVATION (Feet)	(b)	TPH-G (ug/l)	B (ug/l)	T (ug/l)	E (ug/l)	X (ug/l)	MTBE (ug/l)
C-6	07/14/92	35.40		38.89	---	-3.49		---	---	---	---	---	---
C-6	10/08/92	35.40		38.67	---	-3.27		---	---	---	---	---	---
C-6	09/21/93	35.40		33.98	---	1.42		---	---	---	---	---	---
C-6	03/30/95	35.40		26.38	---	9.02		---	---	---	---	---	---
C-6	06/20/95	35.40		25.01	---	10.39		---	---	---	---	---	---
C-6	03/21/96	35.40		23.12	---	12.28		---	---	---	---	---	---
C-6	09/06/96	35.40		24.83	---	10.57		---	---	---	---	---	---
C-6	12/19/96	35.40		24.50	---	10.90		---	---	---	---	---	---
C-6	03/17/97	35.40		22.59	---	12.81		---	---	---	---	---	---
C-6	06/11/97	35.40		23.76	---	11.64		---	---	---	---	---	---
C-6	09/17/97	35.40		24.74	---	10.66		---	---	---	---	---	---
C-6	12/10/97	35.40		24.65	---	10.75		---	---	---	---	---	---
C-6	03/12/98	35.40		27.12	---	8.28		---	---	---	---	---	---
C-6	06/23/98	35.40		27.92	---	7.48		220	35	ND<0.5	2.5	1.1	ND<2.5
C-6	09/01/98	35.40		31.60	---	3.80		1800	370	2.8	19	4.8	44
C-6	12/30/98	35.40		31.82	---	3.58		1600	244	ND<1.0	8.53	ND<1.0	54.9
C-6	03/31/99	35.40		26.06	---	9.34		741	92.2	ND<1.0	6.6	ND<1.0	27.9

TABLE 2 - SUMMARY OF RESULTS OF GROUNDWATER MONITORING

WELL ID	DATE OF MONITORING	CASING ELEVATION (Feet)	(a)	DEPTH TO WATER (Feet)	PRODUCT THICKNESS (Feet)	GROUNDWATER ELEVATION (Feet)	(b)	TPH-G (ug/l)	B (ug/l)	T (ug/l)	E (ug/l)	X (ug/l)	MTBE (ug/l)
C-7	07/14/92	35.19		39.77	---	-4.58		---	---	---	---	---	---
C-7	10/08/92	35.19		39.14	---	-3.95		---	---	---	---	---	---
C-7	09/21/93	35.19		35.46	---	-0.27		---	---	---	---	---	---
C-7	03/30/95	35.19		27.60	---	7.59		---	---	---	---	---	---
C-7	06/20/95	35.19		27.87	---	7.32		---	---	---	---	---	---
C-7	03/21/96	35.19		27.85	---	7.34		---	---	---	---	---	---
C-7	09/06/96	35.19		28.35	---	6.84		---	---	---	---	---	---
C-7	12/19/96	35.19		29.11	---	6.08		---	---	---	---	---	---
C-7	03/17/97	35.19		27.14	---	8.05		---	---	---	---	---	---
C-7	06/11/97	35.19		28.05	---	7.14		---	---	---	---	---	---
C-7	09/17/97	35.19		29.00	---	6.19		---	---	---	---	---	---
C-7	12/10/97	35.19		29.26	---	5.93		---	---	---	---	---	---
C-7	03/12/98	35.19		24.92	---	10.27		---	---	---	---	---	---
C-7	06/23/98	35.19		25.30	---	9.89		ND<50	ND<0.5	ND<0.5	ND<0.5	ND<0.5	ND<2.5
C-7	09/01/98	35.19		26.27	---	8.92		570	24	1.4	8.4	22	24
C-7	12/30/98	35.19		26.52	---	8.67		ND<50	4.85	1.26	ND<0.5	1.29	167
C-7	03/31/99	35.19		24.76	---	10.43		53.1	ND<0.5	ND<0.5	ND<0.5	ND<0.5	ND<2.0

TABLE 2 - SUMMARY OF RESULTS OF GROUNDWATER MONITORING

WELL ID	DATE OF MONITORING	CASING ELEVATION (Feet)	(a)	DEPTH TO WATER (Feet)	PRODUCT THICKNESS (Feet)	GROUNDWATER ELEVATION (Feet)	(b)	TPH-G (ug/l)	B (ug/l)	T (ug/l)	E (ug/l)	X (ug/l)	MTBE (ug/l)
C-8	07/14/92	34.68		39.02	---	-4.34		---	---	---	---	---	---
C-8	10/08/92	34.68		38.68	---	-4.00		---	---	---	---	---	---
C-8	09/21/93	34.68		35.30	---	-0.62		---	---	---	---	---	---
C-8	03/30/95	34.68		29.24	---	5.44		---	---	---	---	---	---
C-8	06/20/95	34.68		28.34	---	6.34		---	---	---	---	---	---
C-8	03/21/96	34.68		28.65	---	6.03		---	---	---	---	---	---
C-8	09/06/96	34.68		28.70	---	5.98		---	---	---	---	---	---
C-8	12/19/96	34.68		29.70	---	4.98		---	---	---	---	---	---
C-8	03/17/97	34.68		27.76	---	6.92		---	---	---	---	---	---
C-8	06/11/97	34.68		28.81	---	5.87		---	---	---	---	---	---
C-8	09/17/97	34.68		29.36	---	5.32		---	---	---	---	---	---
C-8	12/10/97	34.68		29.80	---	4.88		---	---	---	---	---	---
C-8	03/12/98	34.68		25.73	---	8.95		---	---	---	---	---	---
C-8	06/23/98	34.68		26.30	---	8.38		---	---	---	---	---	---
C-8	09/01/98	34.68		26.51	---	8.17		---	---	---	---	---	---
C-8	12/30/98	34.68		26.89	---	7.79		---	---	---	---	---	---
C-8	03/31/99	34.68		26.36	---	8.32		ND<50	ND<0.5	ND<0.5	ND<0.5	ND<0.5	11.8

TABLE 2 - SUMMARY OF RESULTS OF GROUNDWATER MONITORING

WELL ID	DATE OF MONITORING	CASING ELEVATION (Feet)	DEPTH TO WATER (Feet)	PRODUCT THICKNESS (Feet)	GROUNDWATER ELEVATION (Feet)	TPH-G (ug/l)	B (ug/l)	T (ug/l)	E (ug/l)	X (ug/l)	MTBE (ug/l)
C-9	03/17/97	30.68	27.56	---	3.12	---	---	---	---	---	---
C-9	06/11/97	30.68	28.27	---	2.41	---	---	---	---	---	---
C-9	09/17/97	30.68	28.63	---	2.05	---	---	---	---	---	---
C-9	12/10/97	30.68	29.43	---	1.25	---	---	---	---	---	---
C-9	03/12/98	30.68	25.62	---	5.06	---	---	---	---	---	---
C-9	06/23/98	30.68	26.15	---	4.53	---	---	---	---	---	---
C-9	09/01/98	30.68	26.38	---	4.30	---	---	---	---	---	---
C-9	12/30/98	30.68	26.75	---	3.93	---	---	---	---	---	---
C-9	03/31/99	30.68	25.33	---	5.35	ND<50	ND<0.5	ND<0.5	ND<0.5	ND<0.5	12.5
Trip Blank	06/23/98	---	---	---	---	ND<50	ND<0.5	ND<0.5	ND<0.5	ND<0.5	ND<2.5
Trip Blank	09/01/98	---	---	---	---	ND<50	ND<0.5	ND<0.5	ND<0.5	ND<0.5	ND<2.5

ABBREVIATIONS:

TPH-G Total petroleum hydrocarbons as gasoline
 B Benzene
 T Toluene
 E Ethylbenzene
 X Total xylenes
 MTBE Methyl tert butyl ether
 ug/l Micrograms per liter
 --- Not analyzed/measured/applicable
 ND Not detected above reported detection limit
 SEQ Sequoia Analytical

NOTES:

(a) Top of casing elevations surveyed relative to 1929 NGVD. Measured in feet above mean sea level.

(b) Groundwater elevations in feet above mean sea level.

TABLE 1 - SUMMARY OF RESULTS OF GROUNDWATER MONITORING

WELL ID	DATE OF MONITORING	CASING ELEVATION (Feet)	DEPTH TO WATER (Feet)	GROUNDWATER ELEVATION (Feet)	TPH-G (ug/l)	TPH-D (ug/l)	TPH-MO (ug/l)	B (ug/l)	T (ug/l)	E (ug/l)	X (ug/l)	MTBE (ug/l)	LAB
S-1	03/30/95	38.31	6.09	32.22	---	---	---	---	---	---	---	---	---
S-1	06/20/95	38.31	7.30	31.01	---	---	---	---	---	---	---	---	---
S-1	12/06/95	38.31	11.64	26.67	---	---	---	---	---	---	---	---	---
S-1	03/21/96	38.31	6.87	31.44	---	---	---	---	---	---	---	---	---
S-1	06/21/96	38.31	8.65	29.66	---	---	---	---	---	---	---	---	---
S-1	09/06/96	38.31	10.50	27.81	---	---	---	---	---	---	---	---	---
S-1	12/19/96	38.31	8.24	30.07	---	---	---	---	---	---	---	---	---
S-1	03/17/97	38.31	7.26	31.05	---	---	---	---	---	---	---	---	---
S-1	06/11/97	38.31	10.69	27.62	---	---	---	---	---	---	---	---	---
S-1	09/17/97	38.31	10.26	28.05	---	---	---	---	---	---	---	---	---
S-1	12/11/97	38.31	6.96	31.35	---	---	---	---	---	---	---	---	---
S-1	03/12/98	38.31	6.00	32.31	25000	2500	510	250	820	670	5000	ND<125	SEQ
DUP (c)	03/12/98	---	---	---	26000	---	---	250	840	720	5100	ND<125	SEQ
S-1	06/23/98	38.31	6.31	32.00	ND<1000	230	ND<500	280	14	23	15	6100/7800	(d) SEQ
S-1	09/01/99	38.31	9.17	29.14	26000	2300	ND<500	370	620	1300	33	1400/120	(d) SEQ
S-1	12/30/98	38.31	8.99	29.32	29900	1970	334	174	732	1680	5740	182	(d) SEQ
S-1	03/31/99	38.31	7.84	30.47	14200	1150	279	1360	260	1070	3580	ND<500/90	(d) SEQ

TABLE 1 - SUMMARY OF RESULTS OF GROUNDWATER MONITORING

WELL ID	DATE OF MONITORING	CASING ELEVATION (a) (Feet)	DEPTH TO WATER (Feet)	GROUNDWATER ELEVATION (Feet)	TPH-G (ug/l)	TPH-D (ug/l)	TPH-MO (ug/l)	B (ug/l)	T (ug/l)	E (ug/l)	X (ug/l)	MTBE (ug/l)	LAB
S-2	03/30/95	38.79	7.86	30.93	---	---	---	---	---	---	---	---	---
S-2	06/20/95	38.79	9.51	29.28	---	---	---	---	---	---	---	---	---
S-2	12/06/95	38.79	10.52	28.27	---	---	---	---	---	---	---	---	---
S-2	03/21/96	38.79	8.60	30.19	---	---	---	---	---	---	---	---	---
S-2	06/21/96	38.79	9.95	28.84	---	---	---	---	---	---	---	---	---
S-2	09/06/96	38.79	10.50	28.29	---	---	---	---	---	---	---	---	---
S-2	12/19/96	38.79	9.40	29.39	---	---	---	---	---	---	---	---	---
S-2	03/17/97	38.79	9.82	28.97	---	---	---	---	---	---	---	---	---
S-2	06/11/97	38.79	10.18	28.61	---	---	---	---	---	---	---	---	---
S-2	09/17/97	38.79	9.90	28.89	---	---	---	---	---	---	---	---	---
S-2	12/11/97	38.79	8.27	30.52	---	---	---	---	---	---	---	---	---
S-2	03/12/98	38.79	7.97	30.82	1100	---	---	830	48	ND<10	ND<10	4700/4800	(d) SEQ
S-2	06/23/98	38.79	8.20	30.59	720	---	---	46	6.8	50	68	50/8.8	(d) SEQ
DUP (c)	06/23/98	---	---	---	810	---	---	48	7.1	50	70	49/8.8	(d) SEQ
S-2	09/01/99	38.79	9.85	28.94	ND<2000	---	---	170	ND<20	ND<20	ND<20	9300/12000	(d) SEQ
S-2	12/30/98	38.79	9.84	28.95	ND<5000	---	---	369	ND<50	ND<50	ND<50	9300/12000	(d) SEQ
S-2	03/31/99	38.79	8.67	30.12	ND<2000	---	---	234	ND<20	27.4	36.9	49200/53000	(d) SEQ

TABLE 1 - SUMMARY OF RESULTS OF GROUNDWATER MONITORING

WELL ID	DATE OF MONITORING	CASING ELEVATION (Feet)	DEPTH TO WATER (Feet)	GROUNDWATER ELEVATION (Feet)	TPH-G (ug/l)	TPH-D (ug/l)	TPH-MO (ug/l)	B (ug/l)	T (ug/l)	E (ug/l)	X (ug/l)	MTBE (ug/l)	LAB
S-3	03/30/95	37.33	7.06	30.27	---	---	---	---	---	---	---	---	---
S-3	06/20/95	37.33	8.15	29.18	---	---	---	---	---	---	---	---	---
S-3	12/06/95	37.33	10.53	26.80	---	---	---	---	---	---	---	---	---
S-3	03/21/96	37.33	7.32	30.01	---	---	---	---	---	---	---	---	---
S-3	06/21/96	37.33	8.85	28.48	---	---	---	---	---	---	---	---	---
S-3	09/06/96	37.33	10.10	27.23	---	---	---	---	---	---	---	---	---
S-3	12/19/96	37.33	8.36	28.97	---	---	---	---	---	---	---	---	---
S-3	03/17/97	37.33	8.57	28.76	---	---	---	---	---	---	---	---	---
S-3	06/11/97	37.33	9.26	28.07	---	---	---	---	---	---	---	---	---
S-3	09/17/97	37.33	9.62	27.71	---	---	---	---	---	---	---	---	---
S-3	12/11/97	37.33	7.34	29.99	---	---	---	---	---	---	---	---	---
S-3	03/12/98	37.33	5.75	31.58	29000	---	---	840	810	1700	6000	ND<250	SEQ
S-3	06/23/98	37.33	5.98	31.35	3800	---	---	90	220	240	1400	ND<50	SEQ
S-3	09/01/99	---	---	---	9200	---	---	420	110	800	1700	110/ND<50	(d) SEQ
S-3	12/30/98	37.33	9.11	28.22	7660	---	---	240	103	410	834	64.9	SEQ
S-3	03/31/99	37.33	7.48	29.85	2070	---	---	195	10	ND<5.0	48.6	354/64.6	(d) SEQ
EB (e)	03/12/98	---	---	---	ND<50	ND<50	---	ND<0.50	ND<0.50	ND<0.50	ND<0.50	ND<2.5	SEQ
EB (e)	06/23/98	---	---	---	ND<50	---	---	ND<0.50	ND<0.50	ND<0.50	ND<0.50	ND<2.5	SEQ

ABBREVIATIONS:

TPH-G Total petroleum hydrocarbons as gasoline
 TPH-D Total petroleum hydrocarbons as diesel
 TPH-MO Total petroleum hydrocarbons as motor oil
 B Benzene
 T Toluene
 E Ethylbenzene
 X Total xylenes
 MTBE Methyl tert butyl ether
 ug/l Micrograms per liter
 --- Not analyzed/measured/applicable
 ND Not detected above reported detection limit
 SEQ Sequoia Analytical

NOTES:

- (a) Top of casing elevations surveyed relative to 1929 NGVD. Measured in feet above mean sea level.
- (b) Groundwater elevations in feet above mean sea level.
- (c) Blind duplicate.
- (d) EPA Methods 8020/8260 used for MTBE analysis.
- (e) Trip blank.

Analytical Appendix



HOUSTON LABORATORY
8880 INTERCHANGE DRIVE
HOUSTON, TEXAS 77054
PHONE (713) 660-0901

April 8, 1999

Mr. Scott Hooton
BP OIL COMPANY
295 SW 41 Street Bldg 13 Ste N
Renton, WA 98055

The following report contains analytical results for the sample(s) received at Southern Petroleum Laboratories (SPL) on April 2, 1999. The sample(s) was assigned to Certificate of Analysis No. (s) 9904092 and analyzed for all parameters as listed on the chain of custody.

Any data flags or quality control exceptions associated with this report will be footnoted in the analytical result page(s) or the quality control summary page(s).

If you have any questions or comments pertaining to this data report, please do not hesitate to contact me. Please reference the above Certificate of Analysis No. during any inquiries.

Again, SPL is pleased to be of service to you. We anticipate working with you in fulfilling all your current and future analytical needs.

Southern Petroleum Laboratories

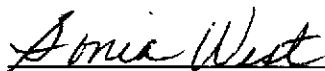

Sonia West
Senior Project Manager



HOUSTON LABORATORY
 8880 INTERCHANGE DRIVE
 HOUSTON, TEXAS 77054
 PHONE (713) 660-0901

Certificate of Analysis No. H9-9904092-01

BP Oil Company
 295 SW 41 Street Bldg.13, Ste N
 Renton, WA 98055
 ATTN: Scott Hooton

P.O.#
 NA, COC#118682
 DATE: 04/08/99

PROJECT: #11109, 4280 Foothill
 SITE: Oakland, CA
 SAMPLED BY: Blaine Tech Services
 SAMPLE ID: A

PROJECT NO: 990331-X1
 MATRIX: WATER
 DATE SAMPLED: 03/31/99 10:55:00
 DATE RECEIVED: 04/02/99

ANALYTICAL DATA

PARAMETER	RESULTS	DETECTION LIMIT	UNITS
MTBE	6.2	1.0 P	ug/L
BENZENE	ND	1.0 P	ug/L
TOLUENE	ND	1.0 P	ug/L
ETHYLBENZENE	ND	1.0 P	ug/L
TOTAL XYLENE	ND	1.0 P	ug/L
TOTAL VOLATILE AROMATIC HYDROCARBONS	ND		ug/L

Surrogate % Recovery
 1,4-Difluorobenzene 97
 4-Bromofluorobenzene 100
 Method 8020A ***
 Analyzed by: TB
 Date: 04/07/99

Gasoline Range Organics 0.060 0.050 P mg/L

Surrogate % Recovery
 1,4-Difluorobenzene 120
 4-Bromofluorobenzene 110
 California LUFT Manual for Gasoline
 Analyzed by: TB
 Date: 04/07/99 11:41:00

(P) - Practical Quantitation Limit ND - Not detected.

Notes: *Ref: Methods for Chemical Analysis of Water and Wastes, 1983, EPA
 **Ref: Standard Methods for Examination of Water & Wastewater, 18th ed.
 ***Ref: Test Methods for Evaluating Solid Waste, EPA SW846, 3rd Ed.

QUALITY ASSURANCE: These analyses are performed in accordance with EPA guidelines for quality assurance.
 SPL California License # 1903



** SPL BATCH QUALITY CONTROL REPORT **
METHOD 8020

HOUSTON LABORATORY
8880 INTERCHANGE DRIVE
HOUSTON, TEXAS 77054
PHONE (713) 660-0901

Matrix: Aqueous
Units: ug/L

Batch Id: HP_R990406215700

LABORATORY CONTROL SAMPLE

S P I K E C O M P O U N D S	Method Blank Result <2>	Spike Added <3>	Blank Spike		QC Limits(**) (Mandatory) % Recovery Range
			Result <1>	Recovery %	
MTBE	ND	50	43	86.0	72 - 128
Benzene	ND	50	45	90.0	61 - 119
Toluene	ND	50	46	92.0	65 - 125
EthylBenzene	ND	50	46	92.0	70 - 118
O Xylene	ND	50	47	94.0	72 - 117
M & P Xylene	ND	100	94	94.0	72 - 116

M A T R I X S P I K E S

S P I K E C O M P O U N D S	Sample Results <2>	Spike Added <3>	Matrix Spike		Matrix Spike Duplicate		MS/MSD Relative % Difference	QC Limits(***) (Advisory)	
			Result <1>	Recovery <4>	Result <1>	Recovery <5>		RPD Max.	Recovery Range
			MTBE	ND	20	24	120	23	115
BENZENE	ND	20	20	100	20	100	0	21	32 - 164
TOLUENE	ND	20	19	95.0	19	95.0	0	20	38 - 159
ETHYLBENZENE	ND	20	19	95.0	19	95.0	0	19	52 - 142
O XYLENE	ND	20	19	95.0	19	95.0	0	18	53 - 143
M & P XYLENE	ND	40	36	90.0	35	87.5	2.82	17	53 - 144

* = Values outside QC Range due to Matrix Interference (except RPD)

* = Data outside Method Specification limits.

NC = Not Calculated (Sample exceeds spike by factor of 4 or more)

ND = Not Detected/Below Detection Limit

% Recovery = $[(<1> - <2>) / <3>] \times 100$

LCS % Recovery = $(<1> / <3>) \times 100$

Relative Percent Difference = $|(<4> - <5> | / [(<4> + <5>) \times 0.5] \times 100$

(**) = Source: SPL-Houston Historical Data (1st Q '97)

(***) = Source: SPL-Houston Historical Data (1st Q '97)

Analyst: TB

Sequence Date: 04/06/99

SPL ID of sample spiked: 9904085-04A

Sample File ID: R_D1091.TX0

Method Blank File ID:

Blank Spike File ID: R_D1079.TX0

Matrix Spike File ID: R_D1082.TX0

Matrix Spike Duplicate File ID: R_D1083.TX0

SAMPLES IN BATCH(SPL ID):

9904085-05A 9904085-06A 9904085-07A 9904085-11A
 9904085-10A 9904143-06A 9904143-07A 9904088-09A
 9904085-12A 9904085-13A 9904092-01A 9903D04-03A
 9904085-03A 9904085-04A 9904043-10A



** SPL BATCH QUALITY CONTROL REPORT **

California LUFT Manual for Gasoline

HOUSTON LABORATORY

8880 INTERCHANGE DRIVE

HOUSTON, TEXAS 77054

PHONE (713) 660-0901

Matrix: Aqueous

Batch Id: HP_R990406222300

Units: mg/L

LABORATORY CONTROL SAMPLE

SPIKE COMPOUNDS	Method Blank Result <2>	Spike Added <3>	Blank Spike		QC Limits(**) (Mandatory) % Recovery Range
			Result <1>	Recovery %	
Gasoline Range Organics	ND	1.0	0.95	95.0	64 - 131

MATRIX SPIKES

SPIKE COMPOUNDS	Sample Results <2>	Spike Added <3>	Matrix Spike		Matrix Spike Duplicate		MS/MSD Relative % Difference	QC Limits(***) (Advisory)	
			Result <1>	Recovery <4>	Result <1>	Recovery <5>		RPD Max.	Recovery Range
			GASOLINE RANGE ORGANICS	ND	0.90	0.72		80.0	0.72

Analyst: TB

Sequence Date: 04/07/99

SPL ID of sample spiked: 9904085-03A

Sample File ID: RRD1090.TX0

Method Blank File ID:

Blank Spike File ID: RRD1080.TX0

Matrix Spike File ID: RRD1084.TX0

Matrix Spike Duplicate File ID: RRD1085.TX0

* = Values outside QC Range due to Matrix Interference (except RPD)

< = Data outside Method Specification limits.

NC = Not Calculated (Sample exceeds spike by factor of 4 or more)

ND = Not Detected/Below Detection Limit

% Recovery = [(<1> - <2>) / <3>] x 100

LCS % Recovery = (<1> / <3>) x 100

Relative Percent Difference = [(<4> - <5>) / [(<4> + <5>) x 0.5]] x 100

(**) = Source: SPL-Houston Historical data (1st Q '97)

(***) = Source: SPL-Houston Historical Data (1st Q '97)

SAMPLES IN BATCH(SPL ID):

9904085-07A 9904085-11A 9904092-01A 9904085-03A
9904085-04A 9904085-05A 9904085-06A

CHAIN OF CUSTODY
AND
SAMPLE RECEIPT CHECKLIST



9904092

CHAIN OF CUSTODY

No. 118682

CONSULTANT'S NAME Blain Tech Services, Inc.		CONSULTANT'S ADDRESS 1680 Rogers Ave., San Jose, CA 95112		CONSULTANT PROJECT NUMBER 990331-X1	
BP SITE NUMBER 11109	BP SITE / FACILITY ADDRESS 4280 Foothill, Oakland			CONSULTANT CONTRACT NUMBER	
CONSULTANT PROJECT MANGER Doug Sanders		PHONE NUMBER (408) 573-0555 X218	FAX NUMBER (408) 573-7771		
BP CONTACT Scott Hooton	BP ADDRESS 295 SW 41st St., Renton, WA		PHONE NUMBER (425) 251-0689		FAX NO. (425) 251-0736
LAB CONTACT SPL - Sonia West	LABORATORY ADDRESS P.O. Box 20807, Houston, TX		PHONE NUMBER (800) 969-6775		FAX NO. (713) 660-8975
BP CONTACT REQUESTING RUSH TAT (Print BP Contact Name)		RUSH REQUESTED OF (Print Consultant Contact Name)	DATE/TIME	SHIPMENT DATE	

TAT: 24 Hours 48 Hours 72 Hours Standard 7 or 14 Days

ANALYSIS REQUIRED

INVOICE NUMBER
804039489632

SAMPLE DESCRIPTION	COLLECTION DATE	COLLECTION TIME	MATRIX SOIL/WATER	CONTAINERS		PRESERVATIVE			TPHG	BTEX	MTBE									COMMENTS	
				NO.	TYPE (VOL.)	LAB SAMPLE #															
A	3-31-99	10:55	Water	3	VOL.	HCL				X											

SAMPLED BY (Please Print Name) Kevin Carlin		SAMPLED BY (Signature) <i>[Signature]</i>		ADDITIONAL COMMENTS			
RELINQUISHED BY / AFFILIATION (Print Name / Signature)	DATE	TIME	ACCEPTED BY / AFFILIATION (Print Name / Signature)	DATE	TIME		
Kevin Carlin	4/1/99	1505	<i>[Signature]</i>				
			Dianne Steles	4/7/99	1000	40	

SPL Houston Environmental Laboratory

Sample Login Checklist

Date: 4/2/99	Time: 1000
---	---

SPL Sample ID:

9904092

		Yes	No								
1	Chain-of-Custody (COC) form is present.	<input checked="" type="checkbox"/>									
2	COC is properly completed.	<input checked="" type="checkbox"/>									
3	If no, Non-Conformance Worksheet has been completed.										
4	Custody seals are present on the shipping container.	<input checked="" type="checkbox"/>									
5	If yes, custody seals are intact.	<input checked="" type="checkbox"/>									
6	All samples are tagged or labeled.	<input checked="" type="checkbox"/>									
7	If no, Non-Conformance Worksheet has been completed.										
8	Sample containers arrived intact	<input checked="" type="checkbox"/>									
9	Temperature of samples upon arrival:		4 C								
10	Method of sample delivery to SPL:	<table border="1" style="width: 100%; border-collapse: collapse;"> <tr> <td style="width: 40%; padding: 5px;">SPL Delivery</td> <td></td> </tr> <tr> <td style="padding: 5px;">Client Delivery</td> <td></td> </tr> <tr> <td style="padding: 5px;">FedEx Delivery (airbill #)</td> <td style="font-size: 1.2em; font-family: cursive;">804039489632</td> </tr> <tr> <td style="padding: 5px;">Other:</td> <td></td> </tr> </table>		SPL Delivery		Client Delivery		FedEx Delivery (airbill #)	804039489632	Other:	
SPL Delivery											
Client Delivery											
FedEx Delivery (airbill #)	804039489632										
Other:											
11	Method of sample disposal:	<table border="1" style="width: 100%; border-collapse: collapse;"> <tr> <td style="width: 40%; padding: 5px;">SPL Disposal</td> <td style="text-align: center;"><input checked="" type="checkbox"/></td> </tr> <tr> <td style="padding: 5px;">HOLD</td> <td></td> </tr> <tr> <td style="padding: 5px;">Return to Client</td> <td></td> </tr> </table>		SPL Disposal	<input checked="" type="checkbox"/>	HOLD		Return to Client			
SPL Disposal	<input checked="" type="checkbox"/>										
HOLD											
Return to Client											

Name: Ruben Sth	Date: 3 4/2/99
--	---

WELL MONITORING DATA SHEET

Project #: <u>9903.31-X1</u>	Client: <u>BP</u>
Sampler: <u>LC</u>	Start Date: <u>03-31-99</u>
Well I.D.: <u>MW-3</u>	Well Diameter: 2 3 <u>(4)</u> 6 8
Total Well Depth: <u>31.38</u>	Depth to Water: <u>11.45</u>
Before: _____ After: _____	Before: _____ After: _____
Depth to Free Product: _____	Thickness of Free Product (feet): _____
Referenced to: <u>(PVC)</u> Grade	D.O. Meter (if req'd): YSI HACH

Purge Method: Bailer
 Disposable Bailer
 Middleburg
 Electric Submersible
 Extraction Pump

Sampling Method: Bailer
 Disposable Bailer
 Extraction Port
 Other: _____

Other: _____

Well Diameter	Multiplier	Well Diameter	Multiplier
2"	0.16	5"	1.02
3"	0.37	6"	1.47
4"	0.65	Other	radius ² * 0.163

<u>129</u> (Gals.) X <u>3</u> = <u>387</u> Gals.
1 Case Volume Specified Volumes Calculated Volume

Time	Temp (°F)	pH	Cond.	Turbidity	Gals. Removed	Observations
10:45	68.6	7.4	1800		13	
10:47	68.8	7.5	1600		26	
10:49	70.0	7.5	1600		39	

Did well dewater? Yes No Gallons actually evacuated: 39

Sampling Time: 10:55 Sampling Date: 3-31-99

Sample I.D.: A Laboratory: SP1

Analyzed for: (TPH-G) (BTEX) (MTBE) TPH-D Other: _____

Equipment Blank I.D.: _____ @ _____ Time Duplicate I.D.: _____

Analyzed for: TPH-G BTEX MTBE TPH-D Other: _____

D.O. (if req'd):	Pre-purge:	mg/L	Post-purge:	mg/L
ORP (if req'd):	Pre-purge:	mV	Post-purge:	mV

WELL MONITORING DATA SHEET

Project #: <u>990.331-X1</u>	Client: <u>BP</u>
Sampler: <u>100</u>	Start Date: <u>3-31-99</u>
Well I.D.: <u>MW-5</u>	Well Diameter: 2 3 <u>(4)</u> 6 8 _____
Total Well Depth:	Depth to Water:
Before: After:	Before: After:
Depth to Free Product:	Thickness of Free Product (feet):
Referenced to: <u>(PVC)</u> Grade	D.O. Meter (if req'd): YSI HACH

Purge Method: Bailer Sampling Method: Bailer

Disposable Bailer Disposable Bailer X

Middleburg Extraction Port

Electric Submersible Other: _____

Extraction Pump

Other: _____

Well Diameter	Multiplier	Well Diameter	Multiplier
2"	0.16	5"	1.02
3"	0.37	6"	1.47
4"	0.65	Other	radius ² * 0.163

	(Gals.) X <u>3</u>	=	_____ Gals.
1 Case Volume	Specified Volumes	Calculated Volume	

Time	Temp (°F)	pH	Cond.	Turbidity	Gals. Removed	Observations
						<u>Inaccessible. Extraction Pump stuck in well</u>
						<u>unable to remove.</u>
				<u>SA.</u>		

Did well dewater? Yes No Gallons actually evacuated: _____

Sampling Time: _____ Sampling Date: _____

Sample I.D.: _____ Laboratory: _____

Analyzed for: TPH-G BTEX MTBE TPH-D Other: _____

Equipment Blank I.D.: _____ @ _____ Time Duplicate I.D.: _____

Analyzed for: TPH-G BTEX MTBE TPH-D Other: _____

D.O. (if req'd):	Pre-purge:	mg/L	Post-purge:	mg/L
------------------	------------	------	-------------	------

ORP (if req'd):	Pre-purge:	mV	Post-purge:	mV
-----------------	------------	----	-------------	----