

EXHIBIT
10-014-05-003

GROUNDWATER MONITORING AND SAMPLING REPORT

**BP Oil Company Service Station No. 11109
4280 Foothill Boulevard
Oakland, California**

Project No. 10-014-05-003

Prepared for:

**BP Oil Company
Environmental Resources Management
295 S.W. 41st Street
Building 13, Suite N
Renton, Washington**

Prepared by:

**Alisto Engineering Group
1575 Treat Boulevard, Suite 201
Walnut Creek, California**

February 12, 1996

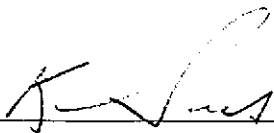

**Ken Simas
Project Manager**



**Al Sevilla, P.E.
Principal**



GROUNDWATER MONITORING AND SAMPLING REPORT

BP Oil Company Service Station No. 11109
4280 Foothill Boulevard
Oakland, California

Project No. 10-014-05-003

February 12, 1996

INTRODUCTION

This report presents the results and findings of the December 6, 1995 groundwater monitoring and sampling conducted by Alisto Engineering Group at BP Oil Company Service Station No. 11109, 4280 Foothill Boulevard, Oakland, California. A site vicinity map is shown on Figure 1.

FIELD PROCEDURES

Field activities were performed in accordance with the procedures and guidelines of the Alameda County Health Care Services Agency and the California Regional Water Quality Control Board, San Francisco Bay Region.

Before purging and sampling, the groundwater level in each well was measured from a permanent mark on top of the casing to the nearest 0.01 foot using an electronic sounder. The depth to groundwater and top of casing elevation data were used to calculate the groundwater elevation in each well relative to mean sea level. The survey data and groundwater elevation measurements collected to date are presented in Table 1.

Before sample collection, each well was purged of 3 casing volumes, while recording field readings of pH, temperature, electrical conductivity, and dissolved oxygen. Groundwater samples were collected for laboratory analysis by lowering a bottom-fill, disposable bailer to just below the water level in the well. The samples were transferred from the bailer into laboratory-supplied containers. The water sampling field survey forms are presented in Appendix A.

Groundwater monitoring was performed concurrently at the neighboring Shell service station, 4411 Foothill Boulevard. The monitoring data for this site are presented in Table 2.

SAMPLING AND ANALYTICAL RESULTS

The results of monitoring and laboratory analysis of the groundwater samples for this and previous quarters are summarized in Table 1. The potentiometric groundwater elevations as interpreted from the results of this monitoring event are shown on Figure 2. The results of groundwater analysis are shown on Figure 3. The laboratory report and chain of custody record are presented in Appendix B.



TABLE 1 - SUMMARY OF RESULTS OF GROUNDWATER SAMPLING
 BP OIL COMPANY SERVICE STATION NO. 11109
 4280 FOOTHILL BOULEVARD, OAKLAND, CALIFORNIA

ALISTO PROJECT NO. 10-014

WELL ID	DATE OF SAMPLING/ MONITORING	CASING ELEVATION (a) (Feet)	DEPTH TO WATER (Feet)	PRODUCT THICKNESS (Feet)	GROUNDWATER ELEVATION (b) (Feet)	TPH-G (ug/l)	TPH-D (ug/l)	B (ug/l)	T (ug/l)	E (ug/l)	X (ug/l)	MTBE (ug/l)	TOG (ug/l)	HVOC (ug/l)	DO (ppm)	LAB
MW-1	01/31/90	38.19	15.41	---	22.78	---	---	---	---	---	---	---	---	---	---	---
MW-1 (c)	02/05/90	38.19	---	---	---	---	---	---	---	---	---	---	---	---	---	---
MW-2	02/05/90	41.22	21.90	---	19.31	1300	---	14	ND<0.1	9	13	---	---	---	---	SUP
MW-2	02/14/91	41.22	21.16	---	20.06	ND<50	ND<10000	ND<0.3	ND<0.3	ND<0.3	ND<0.3	---	ND<5000	51 (d)	---	SUP
MW-2	05/13/91	41.22	21.32	---	19.90	ND<50	ND<50	ND<0.3	ND<0.3	ND<0.3	ND<0.3	---	6000	0.5 (e)	---	SUP
MW-2	07/24/91	41.22	22.92	---	18.30	---	---	---	---	---	---	---	---	---	---	---
MW-2	10/03/91	41.22	24.90	---	16.32	ND<50	ND<50	ND<0.3	0.8	ND<0.3	ND<0.3	---	ND<5000	0.7 (e)	---	SUP
MW-2	10/15/91	41.22	24.10	---	17.12	---	---	---	---	---	---	---	---	---	---	---
MW-2 (f)	12/04/91	41.22	---	---	---	---	---	---	---	---	---	---	---	---	---	---
MW-2	12/16/91	41.22	23.95	---	17.27	---	---	---	---	---	---	---	---	---	---	---
MW-2	01/06/92	41.22	23.30	---	17.92	ND<50	ND<50	ND<0.3	ND<0.3	ND<0.3	ND<0.3	---	ND<5000	ND	---	ANA
MW-2	01/22/92	41.22	23.14	---	18.08	---	---	---	---	---	---	---	---	---	---	---
MW-2	01/28/92	41.22	22.99	---	18.23	---	---	---	---	---	---	---	---	---	---	---
MW-2	02/05/92	41.22	22.63	---	18.59	---	---	---	---	---	---	---	---	---	---	---
MW-2	02/12/92	41.22	22.04	---	19.18	---	---	---	---	---	---	---	---	---	---	---
MW-2	02/17/92	41.22	20.84	---	20.38	---	---	---	---	---	---	---	---	---	---	---
MW-2	04/03/92	41.22	18.29	---	22.93	---	---	---	---	---	---	---	---	---	---	---
MW-2	04/08/92	41.22	18.86	---	22.36	ND<50	63	ND<0.5	ND<0.5	ND<0.5	ND<0.5	---	ND<5000	ND	---	ANA
MW-2	04/14/92	41.22	19.45	---	21.77	---	---	---	---	---	---	---	---	---	---	---
MW-2	04/29/92	41.22	20.35	---	20.87	---	---	---	---	---	---	---	---	---	---	---
MW-2	05/07/92	41.22	20.84	---	20.38	---	---	---	---	---	---	---	---	---	---	---
MW-2	07/03/92	41.22	22.34	---	18.88	ND<50	---	ND<0.5	ND<0.5	ND<0.5	ND<0.5	---	---	---	---	ANA
MW-2	10/08/92	41.22	23.73	---	17.49	ND<50	---	ND<0.5	ND<0.5	ND<0.5	ND<0.5	---	---	---	---	ANA
MW-2	12/31/92	41.22	21.12	---	20.10	ND<50	---	ND<0.5	ND<0.5	ND<0.5	ND<0.5	---	---	---	---	ANA
MW-2	04/21/93	41.22	17.68	---	23.54	ND<50	ND<50 (g)	ND<0.5	ND<0.5	ND<0.5	ND<0.5	---	ND<5000	ND	---	PACE
MW-2	07/07/93	41.22	20.30	---	20.92	ND<50	---	ND<0.5	ND<0.5	ND<0.5	ND<0.5	---	---	1.0 (e)	---	PACE
MW-2	09/21/93	41.22	21.93	---	19.29	ND<50	---	0.9	0.7	0.7	2.6	---	---	---	---	PACE
MW-2	12/17/93	41.22	21.48	---	19.74	---	---	---	---	---	---	---	---	---	---	---
MW-2	12/23/93	41.22	---	---	---	ND<50	---	ND<0.5	ND<0.5	ND<0.5	0.7	---	---	---	---	PACE
MW-2	04/07/94	41.22	20.25	---	20.97	ND<50	---	ND<0.5	ND<0.5	ND<0.5	ND<0.5	---	---	---	5.9	PACE
MW-2	07/06/94	41.22	20.59	---	20.63	ND<50	---	ND<0.5	ND<0.5	ND<0.5	ND<0.5	---	---	---	3.1	PACE
MW-2	10/07/94	41.22	22.04	---	19.18	ND<50	---	ND<0.5	ND<0.5	ND<0.5	ND<0.5	---	---	---	2.8	PACE
MW-2	01/27/95	41.22	26.12	---	15.10	ND<50	440	ND<0.5	ND<0.5	ND<0.5	ND<1	---	ND<5000	---	4.8	ATI
MW-2	03/30/95	41.22	12.34	---	28.88	ND<50	---	ND<0.50	ND<0.50	ND<0.50	ND<1.0	---	---	---	7.2	ATI
MW-2	06/20/95	41.22	16.42	---	24.80	ND<50	---	ND<0.50	ND<0.50	ND<0.50	ND<1.0	---	---	---	6.0	ATI
MW-2	10/03/95	41.22	20.06	---	21.16	ND<50	---	ND<0.50	ND<0.50	ND<0.50	ND<1.0	ND<5.0	---	---	5.7	ATI
MW-2	12/06/95	41.22	21.31	---	19.91	ND<50	---	ND<0.50	ND<0.50	ND<0.50	ND<1.0	46	---	---	5.4	ATI

TABLE 1 - SUMMARY OF RESULTS OF GROUNDWATER SAMPLING
 BP OIL COMPANY SERVICE STATION NO. 11109
 4280 FOOTHILL BOULEVARD, OAKLAND, CALIFORNIA

ALISTO PROJECT NO. 10-014

WELL ID	DATE OF SAMPLING/ MONITORING	CASING ELEVATION (Feet)	DEPTH TO WATER (Feet)	PRODUCT THICKNESS (Feet)	GROUNDWATER ELEVATION (Feet)	TPH-G (ug/l)	TPH-D (ug/l)	B (ug/l)	T (ug/l)	E (ug/l)	X (ug/l)	MTBE (ug/l)	TOG (ug/l)	HVOC (ug/l)	DO (ppm)	LAB
MW-3	02/05/90	40.74	17.45	---	23.29	1400	---	15	ND<2.5	11	8	---	---	---	---	SUP
MW-3	02/14/91	40.74	18.52	---	22.22	320	---	8	ND<0.3	8	1	---	---	---	---	SUP
MW-3	05/13/91	40.74	19.32	---	21.42	640	---	13	ND<0.3	18	1	---	---	---	---	SUP
MW-3	07/24/91	40.74	20.69	---	20.05	---	---	---	---	---	---	---	---	---	---	---
MW-3	10/03/91	40.74	19.47	---	21.27	940	---	21	ND<0.3	23	2.1	---	---	---	---	SUP
MW-3	10/15/91	40.74	20.46	---	20.28	---	---	---	---	---	---	---	---	---	---	---
MW-3	12/04/91	40.74	18.29	---	22.45	---	---	---	---	---	---	---	---	---	---	---
MW-3	12/16/91	40.74	18.34	---	22.40	---	---	---	---	---	---	---	---	---	---	---
MW-3	01/06/92	40.74	18.50	---	22.24	580	---	6.1	1	6.1	7.1	---	---	---	---	ANA
MW-3	01/22/92	40.74	17.86	---	22.88	---	---	---	---	---	---	---	---	---	---	---
MW-3	01/28/92	40.74	15.84	---	24.90	---	---	---	---	---	---	---	---	---	---	---
MW-3	02/05/92	40.74	17.53	---	23.21	---	---	---	---	---	---	---	---	---	---	---
MW-3	02/12/92	40.74	17.15	---	23.59	---	---	---	---	---	---	---	---	---	---	---
MW-3	02/17/92	40.74	16.18	---	24.56	---	---	---	---	---	---	---	---	---	---	---
MW-3	04/03/92	40.74	14.80	---	25.94	---	---	---	---	---	---	---	---	---	---	---
MW-3	04/08/92	40.74	17.06	---	23.68	1100	---	30	4.6	32	11	---	---	---	---	ANA
MW-3	04/14/92	40.74	15.22	---	25.52	---	---	---	---	---	---	---	---	---	---	---
MW-3	04/29/92	40.74	15.90	---	24.84	---	---	---	---	---	---	---	---	---	---	---
MW-3	05/07/92	40.74	16.35	---	24.39	---	---	---	---	---	---	---	---	---	---	---
MW-3	07/03/92	40.74	17.74	---	23.00	1200	---	38	ND<2.5	24	ND<2.5	---	---	---	---	ANA
MW-3	10/08/92	40.74	19.06	---	21.68	1400	---	31	ND<0.5	25	13	---	---	---	---	ANA
MW-3	12/31/92	40.74	16.61	---	24.13	820	---	12	4.1	13	5.9	---	---	---	---	ANA
QC-1	(h) 12/31/92	40.74	---	---	---	960	---	11	3.6	10	3.8	---	---	---	---	ANA
MW-3	04/21/93	40.74	14.24	---	26.50	420	---	5.6	ND<0.5	3.9	1.4	---	---	---	---	PACE
QC-1	(h) 04/21/93	40.74	---	---	---	390	---	5.0	ND<0.5	3.7	1.5	---	---	---	---	PACE
MW-3	07/07/93	40.13	(i) 15.19	---	24.94	54	---	0.6	0.6	ND<0.5	ND<0.5	---	---	---	---	PACE
MW-3	09/21/93	40.13	16.58	---	23.55	540	---	7.9	0.9	4.7	2.4	---	---	---	---	PACE
MW-3	12/17/93	40.13	15.82	---	24.31	---	---	---	---	---	---	---	---	---	---	---
MW-3	12/23/93	40.13	---	---	---	500	---	9.8	1.5	3.3	2.1	---	---	---	---	PACE
QC-1	(h) 12/23/93	40.13	---	---	---	480	---	9.2	ND<0.5	5.4	5.3	---	---	---	---	PACE
MW-3	04/07/94	40.13	28.50	---	11.63	460	---	20	7.4	8.9	11	---	---	---	---	PACE
QC-1	(h) 04/07/94	40.13	---	---	---	460	---	20	7.7	9.0	11	---	---	---	---	PACE
MW-3	07/06/94	40.13	---	---	---	300	---	10	0.6	1.7	6.4	---	---	---	4.8	PACE
MW-3	10/07/94	40.13	27.65	---	12.48	620	---	28	ND<0.5	2.2	12	---	---	---	4.4	PACE
MW-3	01/27/95	40.13	27.65	---	12.48	---	---	---	---	---	---	---	---	---	---	---
MW-3	03/30/95	40.13	26.05	---	14.08	300	---	10	6.0	3.4	18	---	---	---	7.6	ATI
MW-3	06/20/95	40.13	19.49	---	20.64	170	---	7.2	3.4	0.85	15	---	---	---	---	ATI
MW-3	10/03/95	40.13	24.93	---	15.20	170	---	2.1	ND<0.50	0.81	8.0	6.7	---	---	---	ATI
MW-3	12/06/95	40.13	25.14	---	14.99	1700	---	6.7	3.1	2.8	210	64	---	---	---	ATI
QC-1	(h) 12/06/95	40.13	---	---	---	1400	---	6.1	3.0	1.7	190	53	---	---	---	ATI

TABLE 1 - SUMMARY OF RESULTS OF GROUNDWATER SAMPLING
 BP OIL COMPANY SERVICE STATION NO. 11109
 4280 FOOTHILL BOULEVARD, OAKLAND, CALIFORNIA

ALISTO PROJECT NO. 10-014

WELL ID	DATE OF SAMPLING/ MONITORING	CASING ELEVATION (a) (Feet)	DEPTH TO WATER (Feet)	PRODUCT THICKNESS (Feet)	GROUNDWATER ELEVATION (b) (Feet)	TPH-G (ug/l)	TPH-D (ug/l)	B (ug/l)	T (ug/l)	E (ug/l)	X (ug/l)	MTBE (ug/l)	TOG (ug/l)	HVOC (ug/l)	DO (ppm)	LAB
MW-4	02/05/90	40.11	20.75	---	19.36	620	---	ND<0.5	9	ND<0.5	10	---	---	---	---	SUP
MW-4	02/14/91	40.11	21.73	---	18.38	180	---	ND<0.3	ND<0.3	0.4	2	---	---	---	---	SUP
MW-4	05/13/91	40.11	18.55	---	21.56	72	---	0.7	ND<0.3	ND<0.3	ND<0.3	---	---	---	---	SUP
MW-4	07/24/91	40.11	21.31	---	18.80	---	---	---	---	---	---	---	---	---	---	---
MW-4	10/03/91	40.11	22.57	---	17.54	57	---	ND<0.3	ND<0.3	ND<0.3	ND<0.3	---	---	---	---	SUP
MW-4	10/15/91	40.11	22.88	---	17.23	---	---	---	---	---	---	---	---	---	---	---
MW-4	12/04/91	40.11	22.54	---	17.57	---	---	---	---	---	---	---	---	---	---	---
MW-4	12/16/91	40.11	22.59	---	17.52	---	---	---	---	---	---	---	---	---	---	---
MW-4	01/06/92	40.11	22.00	---	18.11	480	---	0.8	3.2	1.9	7.7	---	---	---	---	ANA
MW-4	01/22/92	40.11	21.58	---	18.53	---	---	---	---	---	---	---	---	---	---	---
MW-4	01/28/92	40.11	21.42	---	18.69	---	---	---	---	---	---	---	---	---	---	---
MW-4	02/05/92	40.11	21.10	---	19.01	---	---	---	---	---	---	---	---	---	---	---
MW-4	02/12/92	40.11	20.74	---	19.37	---	---	---	---	---	---	---	---	---	---	---
MW-4	02/17/92	40.11	19.78	---	20.33	---	---	---	---	---	---	---	---	---	---	---
MW-4	04/03/92	40.11	16.80	---	23.31	---	---	---	---	---	---	---	---	---	---	---
MW-4	04/08/92	40.11	17.13	---	22.98	ND<50	---	ND<0.5	ND<0.5	ND<0.5	ND<0.5	---	---	---	---	ANA
MW-4	04/14/92	40.11	17.74	---	22.37	---	---	---	---	---	---	---	---	---	---	---
MW-4	04/29/92	40.11	18.56	---	21.55	---	---	---	---	---	---	---	---	---	---	---
MW-4	05/07/92	40.11	19.10	---	21.01	---	---	---	---	---	---	---	---	---	---	---
MW-4	07/03/92	40.11	20.71	---	19.40	ND<50	---	0.6	ND<0.5	ND<0.5	ND<0.5	---	---	---	---	ANA
MW-4	10/08/92	40.11	22.43	---	17.68	270	---	ND<0.5	2.1	2.5	3.2	---	---	---	---	ANA
MW-4	12/31/92	40.11	19.58	---	20.53	150	---	ND<0.5	ND<0.5	ND<0.5	1.3	---	---	---	---	ANA
MW-4	04/21/93	40.11	17.79	---	22.32	ND<50	---	ND<0.5	ND<0.5	ND<0.5	ND<0.5	---	---	---	---	PACE
MW-4	07/07/93	40.11	18.44	---	21.67	160	---	1.2	5.4	3.8	19	---	---	---	---	PACE
MW-4	09/21/93	40.11	20.14	---	19.97	71	---	ND<0.5	1.9	ND<0.5	2.1	---	---	---	---	PACE
MW-4	12/17/93	40.11	19.80	---	20.31	---	---	---	---	---	---	---	---	---	---	---
MW-4	12/23/93	40.11	---	---	---	ND<50	---	3.1	1.6	0.8	3.8	---	---	---	---	PACE
MW-4	04/07/94	40.11	19.12	---	20.99	ND<50	---	ND<0.5	ND<0.5	ND<0.5	ND<0.5	---	---	---	6.6	PACE
MW-4	07/06/94	40.11	19.90	---	20.21	62	---	ND<0.5	ND<0.5	ND<0.5	ND<0.5	---	---	---	4.1	PACE
MW-4	10/07/94	40.11	20.07	---	20.04	ND<50	---	ND<0.5	ND<0.5	ND<0.5	ND<0.5	---	---	---	3.6	PACE
MW-4	01/27/95	40.11	13.72	---	26.39	ND<50	---	ND<0.5	ND<0.5	ND<0.5	ND<1	---	---	---	2.7	ATI
MW-4	03/30/95	40.11	11.46	---	28.65	ND<50	---	ND<0.50	ND<0.50	ND<0.50	ND<1.0	---	---	---	8.3	ATI
MW-4	06/20/95	40.11	14.78	---	25.33	ND<50	---	ND<0.50	ND<0.50	ND<0.50	ND<1.0	---	---	---	---	ATI
MW-4	10/03/95	40.11	19.62	---	20.49	ND<50	---	ND<0.50	ND<0.50	ND<0.50	ND<1.0	5.0	---	---	5.8	ATI
MW-4	12/06/95	40.11	19.91	---	20.20	ND<50	---	ND<0.50	ND<0.50	ND<0.50	ND<1.0	47	---	---	5.7	ATI

TABLE 1 - SUMMARY OF RESULTS OF GROUNDWATER SAMPLING
 BP OIL COMPANY SERVICE STATION NO. 11109
 4280 FOOTHILL BOULEVARD, OAKLAND, CALIFORNIA

ALISTO PROJECT NO. 10-014

WELL ID	DATE OF SAMPLING/ MONITORING	CASING ELEVATION (Feet) (a)	DEPTH TO WATER (Feet)	PRODUCT THICKNESS (Feet)	GROUNDWATER ELEVATION (Feet) (b)	TPH-G (ug/l)	TPH-D (ug/l)	B (ug/l)	T (ug/l)	E (ug/l)	X (ug/l)	MTBE (ug/l)	TOG (ug/l)	HVOC (ug/l)	DO (ppm)	LAB
MW-5	10/03/91	39.55	18.08	---	21.47	79000	---	13000	7400	1400	6200	---	---	---	---	SUP
MW-5	10/15/91	39.55	18.55	---	21.00	---	---	---	---	---	---	---	---	---	---	---
MW-5	12/04/91	39.55	18.44	0.13	21.21	---	---	---	---	---	---	---	---	---	---	---
MW-5	12/16/91	39.55	18.66	0.01	20.90	---	---	---	---	---	---	---	---	---	---	---
MW-5	01/06/92	39.55	19.12	0.11	20.51	---	---	---	---	---	---	---	---	---	---	---
MW-5	01/22/92	39.55	14.59	---	24.96	---	---	---	---	---	---	---	---	---	---	---
MW-5	01/28/92	39.55	15.25	---	24.30	---	---	---	---	---	---	---	---	---	---	---
MW-5	02/05/92	39.55	15.58	SHEEN	23.97	---	---	---	---	---	---	---	---	---	---	---
MW-5	02/12/92	39.55	15.54	0.01	24.02	---	---	---	---	---	---	---	---	---	---	---
MW-5	02/17/92	39.55	13.98	SHEEN	25.57	---	---	---	---	---	---	---	---	---	---	---
MW-5	04/03/92	39.55	13.63	0.04	25.95	---	---	---	---	---	---	---	---	---	---	---
MW-5	04/08/92	39.55	13.17	0.01	26.39	---	---	---	---	---	---	---	---	---	---	---
MW-5	04/14/92	39.55	13.45	0.01	26.11	---	---	---	---	---	---	---	---	---	---	---
MW-5	04/29/92	39.55	13.75	0.07	25.85	---	---	---	---	---	---	---	---	---	---	---
MW-5	05/07/92	39.55	16.15	0.04	23.43	---	---	---	---	---	---	---	---	---	---	---
MW-5	07/03/92	39.55	17.67	0.08	21.94	---	---	---	---	---	---	---	---	---	---	---
MW-5	09/01/92	39.55	17.83	0.50	22.10	---	---	---	---	---	---	---	---	---	---	---
MW-5	10/08/92	39.55	17.86	0.92	22.38	---	---	---	---	---	---	---	---	---	---	---
MW-5	12/31/92	39.55	15.20	SHEEN	24.35	---	---	---	---	---	---	---	---	---	---	---
MW-5	04/21/93	39.55	12.64	0.02	26.93	---	---	---	---	---	---	---	---	---	---	---
MW-5	07/07/93	39.14	(i) 12.68	0.82	27.08	---	---	---	---	---	---	---	---	---	---	---
MW-5	09/21/93	39.14	14.35	SHEEN	24.79	---	---	---	---	---	---	---	---	---	---	---
MW-5	12/17/93	39.14	12.61	0.41	26.84	---	---	---	---	---	---	---	---	---	---	---
MW-5	04/07/94	39.14	30.00	---	9.14	66000	---	3000	1700	250	6800	---	---	---	---	PACE
MW-5	07/06/94	39.14	---	---	---	29000	---	1900	330	63	2700	---	---	---	---	PACE
MW-5	10/07/94	39.14	28.70	---	10.44	250000	---	2600	660	830	5200	---	---	---	4.2	PACE
QC-1	(h) 10/07/94	39.14	---	---	---	45000	---	2900	540	260	2600	---	---	---	---	PACE
MW-5	01/27/95	39.14	28.70	---	10.44	---	---	---	---	---	---	---	---	---	---	---
MW-5	03/30/95	39.14	28.95	---	10.19	50000	---	7900	2600	520	6400	---	---	---	5.5	ATI
QC-1	(h) 03/30/95	39.14	---	---	---	43000	---	7900	2500	440	6200	---	---	---	---	ATI
MW-5	06/20/95	39.14	22.54	---	16.60	34000	---	5100	1900	300	3700	---	---	---	---	ATI
QC-1	(h) 06/20/95	39.14	---	---	---	26000	---	3500	290	ND<25	3300	---	---	---	---	ATI
MW-5	10/03/95	39.14	18.84	---	20.30	12000	---	68	42	11	1600	330	---	---	---	ATI
QC-1	(h) 10/03/95	39.14	---	---	---	12000	---	46	39	10	1600	320	---	---	---	ATI
MW-5	12/06/95	39.14	19.07	---	20.07	16000	---	1200	93	51	700	600	---	---	---	ATI

TABLE 1 - SUMMARY OF RESULTS OF GROUNDWATER SAMPLING
 BP OIL COMPANY SERVICE STATION NO. 11109
 4280 FOOTHILL BOULEVARD, OAKLAND, CALIFORNIA

ALISTO PROJECT NO. 10-014

WELL ID	DATE OF SAMPLING/ MONITORING	CASING ELEVATION (Feet) (a)	DEPTH TO WATER (Feet)	PRODUCT THICKNESS (Feet)	GROUNDWATER ELEVATION (Feet) (b)	TPH-G (ug/l)	TPH-D (ug/l)	B (ug/l)	T (ug/l)	E (ug/l)	X (ug/l)	MTBE (ug/l)	TOG (ug/l)	HVOC (ug/l)	DO (ppm)	LAB
MW-6	10/03/91	41.59	20.73	---	20.86	ND<50	---	0.7	0.8	ND<0.3	1.3	---	---	---	---	SUP
MW-6	10/15/91	41.59	21.20	---	20.39	---	---	---	---	---	---	---	---	---	---	---
MW-6	12/04/91	41.59	21.26	---	20.33	---	---	---	---	---	---	---	---	---	---	---
MW-6	12/16/91	41.59	21.12	---	20.47	---	---	---	---	---	---	---	---	---	---	---
MW-6	01/06/92	41.59	20.29	---	21.30	ND<50	---	ND<0.5	ND<0.5	ND<0.5	1.6	---	---	---	---	ANA
MW-6	01/22/92	41.59	20.12	---	21.47	---	---	---	---	---	---	---	---	---	---	---
MW-6	01/28/92	41.59	20.20	---	21.39	---	---	---	---	---	---	---	---	---	---	---
MW-6	02/05/92	41.59	20.09	---	21.50	---	---	---	---	---	---	---	---	---	---	---
MW-6	02/12/92	41.59	19.15	---	22.44	---	---	---	---	---	---	---	---	---	---	---
MW-6	02/17/92	41.59	18.02	---	23.57	---	---	---	---	---	---	---	---	---	---	---
MW-6	04/03/92	41.59	16.62	---	24.97	---	---	---	---	---	---	---	---	---	---	---
MW-6	04/08/92	41.59	17.06	---	24.53	ND<50	---	0.6	ND<0.5	0.8	ND<0.5	---	---	---	---	ANA
MW-6	04/14/92	41.59	17.23	---	24.36	---	---	---	---	---	---	---	---	---	---	---
MW-6	04/29/92	41.59	18.12	---	23.47	---	---	---	---	---	---	---	---	---	---	---
MW-6	05/07/92	41.59	18.52	---	23.07	---	---	---	---	---	---	---	---	---	---	---
MW-6	07/03/92	41.59	19.71	---	21.88	ND<50	---	ND<0.5	ND<0.5	ND<0.5	ND<0.5	---	---	---	---	ANA
MW-6	10/08/92	41.59	21.22	---	20.37	ND<50	---	ND<0.5	ND<0.5	ND<0.5	ND<0.5	---	---	---	---	ANA
QC-1 (h)	10/08/92	41.59	21.22	---	20.37	ND<50	---	ND<0.5	ND<0.5	ND<0.5	ND<0.5	---	---	---	---	ANA
MW-6	12/31/92	41.59	21.33	---	20.26	ND<50	---	ND<0.5	ND<0.5	ND<0.5	ND<0.5	---	---	---	---	ANA
MW-6	04/21/93	41.59	16.45	---	25.14	ND<50	---	ND<0.5	ND<0.5	ND<0.5	ND<0.5	---	---	---	---	PACE
MW-6	07/07/93	41.59	18.68	---	22.91	ND<50	---	ND<0.5	ND<0.5	ND<0.5	ND<0.5	---	---	---	---	PACE
MW-6	09/21/93	41.59	19.64	---	21.95	ND<50	---	ND<0.5	ND<0.5	ND<0.5	1.6	---	---	---	---	PACE
MW-6	12/17/93	41.59	21.08	---	20.51	---	---	---	---	---	---	---	---	---	---	---
MW-6	12/23/93	41.59	---	---	---	ND<50	---	ND<0.5	0.5	ND<0.5	0.6	---	---	---	---	PACE
MW-6	04/07/94	41.59	21.27	---	20.32	ND<50	---	ND<0.5	ND<0.5	ND<0.5	ND<0.5	---	---	---	6.1	PACE
MW-6	07/06/94	41.59	19.81	---	21.78	ND<50	---	ND<0.5	ND<0.5	ND<0.5	ND<0.5	---	---	---	4.0	PACE
QC-1 (h)	07/06/94	41.59	---	---	---	ND<50	---	ND<0.5	ND<0.5	ND<0.5	ND<0.5	---	---	---	---	PACE
MW-6	10/07/94	41.59	21.25	---	20.34	ND<50	---	ND<0.5	ND<0.5	ND<0.5	ND<0.5	---	---	---	3.5	PACE
MW-6	01/27/95	41.59	12.39	---	29.20	ND<50	---	ND<0.5	ND<0.5	ND<0.5	ND<1	---	---	---	4.2	ATI
MW-6	03/30/95	41.59	11.34	---	30.25	ND<50	---	ND<0.50	ND<0.50	ND<0.50	ND<1.0	---	---	---	6.1	ATI
MW-6	06/20/95	41.59	15.12	---	26.47	ND<50	---	ND<0.50	ND<0.50	ND<0.50	ND<1.0	---	---	---	---	ATI
MW-6	10/03/95	41.59	20.68	---	20.91	ND<50	---	ND<0.50	ND<0.50	ND<0.50	ND<1.0	66	---	---	6.4	ATI
MW-6	12/06/95	41.59	23.77	---	17.82	ND<50	---	ND<0.50	ND<0.50	ND<0.50	ND<1.0	45	---	---	5.7	ATI

TABLE 1 - SUMMARY OF RESULTS OF GROUNDWATER SAMPLING
 BP OIL COMPANY SERVICE STATION NO. 11109
 4280 FOOTHILL BOULEVARD, OAKLAND, CALIFORNIA

ALISTO PROJECT NO. 10-014

WELL ID	DATE OF SAMPLING/ MONITORING	CASING ELEVATION (Feet)	DEPTH TO WATER (Feet)	PRODUCT THICKNESS (Feet)	GROUNDWATER ELEVATION (Feet)	TPH-G (ug/l)	TPH-D (ug/l)	B (ug/l)	T (ug/l)	E (ug/l)	X (ug/l)	MTBE (ug/l)	TOG (ug/l)	HVOC (ug/l)	DO (ppm)	LAB
MW-7	10/03/91	40.64	14.93	---	25.71	360	---	62	13	3.4	20	---	---	---	---	SUP
MW-7	10/15/91	40.64	15.16	---	25.48	---	---	---	---	---	---	---	---	---	---	---
MW-7	12/04/91	40.64	15.41	---	25.23	---	---	---	---	---	---	---	---	---	---	---
MW-7	12/16/91	40.64	15.21	---	25.43	---	---	---	---	---	---	---	---	---	---	---
MW-7	01/06/92	40.64	14.56	---	26.08	1100	---	170	ND<0.5	24	23	---	---	---	---	ANA
MW-7	01/22/92	40.64	14.63	---	26.01	---	---	---	---	---	---	---	---	---	---	---
MW-7	01/28/92	40.64	14.73	---	25.91	---	---	---	---	---	---	---	---	---	---	---
MW-7	02/05/92	40.64	14.58	---	26.06	---	---	---	---	---	---	---	---	---	---	---
MW-7	02/12/92	40.64	13.94	---	26.70	---	---	---	---	---	---	---	---	---	---	---
MW-7	02/17/92	40.64	13.10	---	27.54	---	---	---	---	---	---	---	---	---	---	---
MW-7	04/03/92	40.64	12.68	---	27.98	---	---	---	---	---	---	---	---	---	---	---
MW-7	04/08/92	40.64	12.77	---	27.87	750	---	150	ND<0.5	23	9.9	---	---	---	---	ANA
MW-7	04/14/92	40.64	13.02	---	27.62	---	---	---	---	---	---	---	---	---	---	---
MW-7	04/29/92	40.64	13.59	---	27.05	---	---	---	---	---	---	---	---	---	---	---
MW-7	05/07/92	40.64	13.95	---	26.69	---	---	---	---	---	---	---	---	---	---	---
MW-7	07/03/92	40.64	14.73	---	25.91	660	---	210	ND<2.5	33	8	---	---	---	---	ANA
MW-7	10/08/92	40.64	15.75	---	24.89	320	---	49	1.4	13	6.2	---	---	---	---	ANA
MW-7	12/31/92	40.64	13.57	---	27.07	900	---	100	ND<2.5	28	4.3	---	---	---	---	ANA
MW-7	04/21/93	40.64	14.56	---	26.08	510	---	83	1.2	10	5.8	---	---	---	---	PACE
MW-7	07/07/93	40.32	(i) 13.40	---	26.92	1100	---	160	2.0	27	4.0	---	---	---	---	PACE
QC-1	(h) 07/07/93	40.32	---	---	---	1100	---	170	1.9	29	2.8	---	---	---	---	PACE
MW-7	09/21/93	40.32	14.40	---	25.92	690	---	150	3.1	26	5.7	---	---	---	---	PACE
QC-1	(h) 09/21/93	40.32	---	---	---	640	---	140	1.7	23	2.4	---	---	---	---	PACE
MW-7	12/17/93	40.32	13.65	---	26.67	---	---	---	---	---	---	---	---	---	---	---
MW-7	12/23/93	40.32	---	---	---	250	---	64	1.2	9.0	1.8	---	---	---	---	PACE
MW-7	04/07/94	40.32	30.62	---	9.70	140	---	32	1.4	ND<0.5	ND<0.5	---	---	---	---	PACE
MW-7	07/06/94	40.32	16.88	---	23.44	410	---	94	1.3	10	3.5	---	---	---	4.4	PACE
MW-7	10/07/94	40.32	25.59	---	14.73	ND<50	---	9.2	ND<0.5	ND<0.5	ND<0.5	---	---	---	4.9	PACE
MW-7	01/27/95	40.32	9.82	---	30.50	810	---	570	3	60	17	---	---	---	0	ATI
QC-1	(h) 01/27/95	---	---	---	---	930	---	620	4	77	21	---	---	---	---	ATI
MW-7	03/30/95	40.32	9.15	---	31.17	180	---	65	0.53	2.0	ND<1.0	---	---	---	7.8	ATI
MW-7	06/20/95	40.32	11.38	---	28.94	2800	---	980	ND<5.0	ND<5.0	43	---	---	---	---	ATI
MW-7	10/03/95	40.32	29.95	---	10.37	ND<50	---	ND<0.50	ND<0.50	ND<0.50	ND<1.0	ND<5.0	---	---	---	ATI
MW-7	12/06/95	40.32	29.85	---	10.47	ND<50	---	ND<0.50	ND<0.50	ND<0.50	ND<1.0	ND<5.0	---	---	---	ATI

TABLE 1 - SUMMARY OF RESULTS OF GROUNDWATER SAMPLING
 BP OIL COMPANY SERVICE STATION NO. 11109
 4280 FOOTHILL BOULEVARD, OAKLAND, CALIFORNIA

ALISTO PROJECT NO. 10-014

WELL ID	DATE OF SAMPLING/ MONITORING	CASING ELEVATION (Feet) (a)	DEPTH TO WATER (Feet)	PRODUCT THICKNESS (Feet)	GROUNDWATER ELEVATION (Feet) (b)	TPH-G (ug/l)	TPH-D (ug/l)	B (ug/l)	T (ug/l)	E (ug/l)	X (ug/l)	MTBE (ug/l)	TOG (ug/l)	HVOC (ug/l)	DO (ppm)	LAB
MW-8	10/03/91	38.18	22.37	---	15.81	ND<50	---	ND<0.3	0.6	ND<0.3	0.9	---	---	---	---	SUP
MW-8	10/15/91	38.18	22.70	---	15.48	---	---	---	---	---	---	---	---	---	---	---
MW-8	12/04/91	38.18	22.44	---	15.74	---	---	---	---	---	---	---	---	---	---	---
MW-8	12/16/91	38.18	22.47	---	15.71	---	---	---	---	---	---	---	---	---	---	---
MW-8	01/06/92	38.18	21.94	---	16.24	ND<50	---	ND<0.5	ND<0.5	ND<0.5	ND<0.5	---	---	---	---	ANA
MW-8	01/22/92	38.18	21.44	---	16.74	---	---	---	---	---	---	---	---	---	---	---
MW-8	01/28/92	38.18	21.20	---	16.98	---	---	---	---	---	---	---	---	---	---	---
MW-8	02/05/92	38.18	20.88	---	17.30	---	---	---	---	---	---	---	---	---	---	---
MW-8	02/12/92	38.18	20.54	---	17.64	---	---	---	---	---	---	---	---	---	---	---
MW-8	02/17/92	38.18	19.99	---	18.19	---	---	---	---	---	---	---	---	---	---	---
MW-8	04/03/92	38.18	16.75	---	21.43	---	---	---	---	---	---	---	---	---	---	---
MW-8	04/08/92	38.18	16.57	---	21.61	ND<50	---	ND<0.5	ND<0.5	ND<0.5	ND<0.5	---	---	---	---	ANA
MW-8	(f) 04/14/92	38.18	---	---	---	---	---	---	---	---	---	---	---	---	---	---
MW-8	04/29/92	38.18	18.61	---	19.57	---	---	---	---	---	---	---	---	---	---	---
MW-8	05/07/92	38.18	18.41	---	19.77	---	---	---	---	---	---	---	---	---	---	---
MW-8	07/03/92	38.18	20.35	---	17.83	ND<50	---	ND<0.5	ND<0.5	ND<0.5	ND<0.5	---	---	---	---	ANA
MW-8	(f) 10/08/92	38.18	21.74	---	16.44	---	---	---	---	---	---	---	---	---	---	---
MW-8	12/31/92	38.18	19.09	---	19.09	ND<50	---	ND<0.5	ND<0.5	ND<0.5	ND<0.5	---	---	---	---	ANA
MW-8	04/21/93	38.18	18.92	---	19.26	ND<50	---	ND<0.5	ND<0.5	ND<0.5	ND<0.5	---	---	---	---	PACE
MW-8	07/07/93	38.18	17.76	---	20.42	ND<50	---	ND<0.5	ND<0.5	ND<0.5	ND<0.5	---	---	---	---	PACE
MW-8	09/21/93	38.18	19.71	---	18.47	ND<50	---	2.9	2.2	2.2	7.1	---	---	---	---	PACE
MW-8	12/17/93	38.18	21.33	---	16.85	---	---	---	---	---	---	---	---	---	---	---
MW-8	12/23/93	38.18	---	---	---	ND<50	---	ND<0.5	ND<0.5	ND<0.5	0.6	---	---	---	---	PACE
MW-8	04/07/94	38.18	21.51	---	16.67	ND<50	---	ND<0.5	ND<0.5	ND<0.5	ND<0.5	---	---	---	6.6	PACE
MW-8	07/06/94	38.18	17.41	---	20.77	ND<50	---	ND<0.5	ND<0.5	ND<0.5	ND<0.5	---	---	---	4.4	PACE
MW-8	10/07/94	38.18	19.20	---	18.98	ND<50	---	ND<0.5	ND<0.5	ND<0.5	ND<0.5	---	---	---	3.7	PACE
MW-8	01/27/95	38.18	12.25	---	25.93	ND<50	---	ND<0.5	ND<0.5	ND<0.5	ND<1	---	---	---	2.9	ATI
MW-8	03/30/95	38.18	10.35	---	27.83	ND<50	---	ND<0.50	ND<0.50	ND<0.50	ND<1.0	---	---	---	8.3	ATI
MW-8	06/20/95	38.18	13.37	---	24.81	ND<50	---	ND<0.50	ND<0.50	ND<0.50	ND<1.0	---	---	---	6.9	ATI
MW-8	(f) 10/03/95	38.18	---	---	---	---	---	---	---	---	---	---	---	---	---	---
MW-8	12/06/95	38.18	18.42	---	19.76	ND<50	---	ND<0.50	ND<0.50	ND<0.50	ND<1.0	47	---	---	5.3	ATI

TABLE 1 - SUMMARY OF RESULTS OF GROUNDWATER SAMPLING
 BP OIL COMPANY SERVICE STATION NO. 11109
 4280 FOOTHILL BOULEVARD, OAKLAND, CALIFORNIA

ALISTO PROJECT NO. 10-014

WELL ID	DATE OF SAMPLING/ MONITORING	CASING ELEVATION (Feet) (a)	DEPTH TO WATER (Feet)	PRODUCT THICKNESS (Feet)	GROUNDWATER ELEVATION (Feet) (b)	TPH-G (ug/l)	TPH-D (ug/l)	B (ug/l)	T (ug/l)	E (ug/l)	X (ug/l)	MTBE (ug/l)	TOG (ug/l)	HVOC (ug/l)	DO (ppm)	LAB
MW-9	10/03/91	41.25	14.12	---	27.13	ND<50	---	ND<0.3	0.4	ND<0.3	ND<0.3	---	---	---	---	SUP
MW-9	10/15/91	41.25	14.27	---	26.98	---	---	---	---	---	---	---	---	---	---	---
MW-9	12/04/91	41.25	13.84	---	27.41	---	---	---	---	---	---	---	---	---	---	---
MW-9	12/16/91	41.25	14.18	---	27.07	---	---	---	---	---	---	---	---	---	---	---
MW-9	01/06/92	41.25	13.42	---	27.83	ND<50	---	ND<0.5	ND<0.5	ND<0.5	0.9	---	---	---	---	ANA
MW-9	01/22/92	41.25	13.75	---	27.50	---	---	---	---	---	---	---	---	---	---	---
MW-9	01/28/92	41.25	14.76	---	26.49	---	---	---	---	---	---	---	---	---	---	---
MW-9	02/05/92	41.25	13.38	---	27.87	---	---	---	---	---	---	---	---	---	---	---
MW-9	02/12/92	41.25	11.86	---	29.39	---	---	---	---	---	---	---	---	---	---	---
MW-9	02/17/92	41.25	10.78	---	30.47	---	---	---	---	---	---	---	---	---	---	---
MW-9	04/03/92	41.25	11.63	---	29.62	---	---	---	---	---	---	---	---	---	---	---
MW-9	04/08/92	41.25	12.25	---	29.00	ND<50	---	ND<0.5	ND<0.5	ND<0.5	ND<0.5	---	---	---	---	ANA
MW-9	04/14/92	41.25	12.32	---	28.93	---	---	---	---	---	---	---	---	---	---	---
MW-9	04/29/92	41.25	13.07	---	28.18	---	---	---	---	---	---	---	---	---	---	---
MW-9	05/07/92	41.25	14.43	---	26.82	---	---	---	---	---	---	---	---	---	---	---
MW-9	07/03/92	41.25	13.85	---	27.40	ND<50	---	ND<0.5	ND<0.5	ND<0.5	ND<0.5	---	---	---	---	ANA
MW-9	10/08/92	41.25	14.89	---	26.36	ND<50	---	ND<0.5	ND<0.5	ND<0.5	ND<0.5	---	---	---	---	ANA
MW-9	12/31/92	41.25	11.90	---	29.35	ND<50	---	ND<0.5	ND<0.5	ND<0.5	ND<0.5	---	---	---	---	ANA
MW-9	04/21/93	41.25	13.68	---	27.57	ND<50	---	ND<0.5	ND<0.5	ND<0.5	ND<0.5	---	---	---	---	PACE
MW-9	07/07/93	41.25	13.12	---	28.13	ND<50	---	ND<0.5	ND<0.5	ND<0.5	ND<0.5	---	---	---	---	PACE
MW-9	09/21/93	41.25	14.00	---	27.25	ND<50	---	ND<0.5	ND<0.5	ND<0.5	0.9	---	---	---	---	PACE
MW-9	12/17/93	41.25	12.98	---	28.27	---	---	---	---	---	---	---	---	---	---	---
MW-9	12/23/93	41.25	---	---	---	ND<50	---	ND<0.5	ND<0.5	ND<0.5	0.9	---	---	---	---	PACE
MW-9	04/07/94	41.25	13.24	---	28.01	ND<50	---	ND<0.5	ND<0.5	ND<0.5	ND<0.5	---	---	---	4.7	PACE
MW-9	07/06/94	41.25	13.77	---	27.48	ND<50	---	ND<0.5	ND<0.5	ND<0.5	ND<0.5	---	---	---	3.9	PACE
MW-9	10/07/94	41.25	14.60	---	26.65	ND<50	---	ND<0.5	ND<0.5	ND<0.5	ND<0.5	---	---	---	3.0	PACE
MW-9	01/27/95	41.25	8.47	---	32.78	ND<50	---	ND<0.5	ND<0.5	ND<0.5	ND<1	---	---	---	2.5	ATI
MW-9	03/30/95	41.25	8.19	---	33.08	ND<50	---	ND<0.50	ND<0.50	ND<0.50	ND<1.0	---	---	---	8.4	ATI
MW-9	06/20/95	41.25	11.25	---	30.00	ND<50	---	ND<0.50	ND<0.50	ND<0.50	ND<1.0	---	---	---	8.1	ATI
MW-9	10/03/95	41.25	14.68	---	26.57	ND<50	---	ND<0.50	ND<0.50	ND<0.50	ND<1.0	ND<5.0	---	---	6.0	ATI
MW-9	12/06/95	41.25	16.07	---	25.18	ND<50	---	ND<0.50	ND<0.50	ND<0.50	ND<1.0	46	---	---	5.4	ATI

TABLE 1 - SUMMARY OF RESULTS OF GROUNDWATER SAMPLING
 BP OIL COMPANY SERVICE STATION NO. 11109
 4280 FOOTHILL BOULEVARD, OAKLAND, CALIFORNIA

ALISTO PROJECT NO. 10-014

WELL ID	DATE OF SAMPLING/ MONITORING	CASING ELEVATION (a) (Feet)	DEPTH TO WATER (Feet)	PRODUCT THICKNESS (Feet)	GROUNDWATER ELEVATION (b) (Feet)	TPH-G (ug/l)	TPH-D (ug/l)	B (ug/l)	T (ug/l)	E (ug/l)	X (ug/l)	MTBE (ug/l)	TOG (ug/l)	HVOC (ug/l)	DO (ppm)	LAB
QC-2	(j)	10/08/92	---	---	---	ND<50	---	ND<0.5	ND<0.5	ND<0.5	ND<0.5	---	---	---	---	ANA
QC-2	(j)	12/31/92	---	---	---	ND<50	---	ND<0.5	ND<0.5	ND<0.5	ND<0.5	---	---	---	---	ANA
QC-2	(j)	04/21/93	---	---	---	---	---	---	---	---	---	---	---	ND	---	PACE
QC-2	(j)	07/07/93	---	---	---	ND<50	---	ND<0.5	ND<0.5	ND<0.5	0.6	---	---	---	---	PACE
QC-2	(j)	09/21/93	---	---	---	ND<50	---	ND<0.5	ND<0.5	ND<0.5	ND<0.5	---	---	---	---	PACE
QC-2	(j)	12/23/93	---	---	---	ND<50	---	ND<0.5	ND<0.5	ND<0.5	ND<0.5	---	---	---	---	PACE
QC-2	(j)	04/07/94	---	---	---	ND<50	---	ND<0.5	ND<0.5	ND<0.5	ND<0.5	---	---	---	---	PACE
QC-2	(j)	07/06/94	---	---	---	ND<50	---	ND<0.5	ND<0.5	ND<0.5	ND<0.5	---	---	---	---	PACE
QC-2	(j)	10/07/94	---	---	---	ND<50	---	ND<0.5	ND<0.5	ND<0.5	ND<0.5	---	---	---	---	PACE
QC-2	(j)	01/27/95	---	---	---	ND<50	---	ND<0.5	0.5	ND<0.5	ND<1	---	---	---	---	ATI
QC-2	(j)	03/30/95	---	---	---	ND<50	---	ND<0.50	ND<0.50	ND<0.50	ND<1.0	---	---	---	---	ATI
QC-2	(j)	06/20/95	---	---	---	ND<50	---	ND<0.50	ND<0.50	ND<0.50	ND<1.0	---	---	---	---	ATI
QC-2	(j)	10/03/95	---	---	---	ND<50	---	ND<0.50	ND<0.50	ND<0.50	ND<1.0	ND<5.0	---	---	---	ATI
QC-2	(j)	12/06/95	---	---	---	ND<50	---	ND<0.50	ND<0.50	ND<0.50	ND<1.0	ND<5.0	---	---	---	ATI

ABBREVIATIONS:

TPH-G Total petroleum hydrocarbons as gasoline
 TPH-D Total petroleum hydrocarbons as diesel
 B Benzene
 T Toluene
 E Ethylbenzene
 X Total xylenes
 MTBE Methyl tert butyl ether
 TOG Total oil and grease
 HVOC Halogenated volatile organic compounds
 DO Dissolved oxygen
 ug/l Micrograms per liter
 ppm Parts per million
 --- Not analyzed/measured/applicable
 ND Not detected above reported detection limit
 SUP Superior Analytical Laboratory
 ANA Anametrix, Inc.
 PACE Pace, Inc.
 ATI Analytical Technologies, Inc.

NOTES:

(a) Top of casing elevations surveyed in feet above mean sea level, relative to the NGVD (1929)
 (b) Groundwater elevations adjusted assuming a specific gravity of 0.75 for free product.
 (c) Well destroyed during tank removal in November 1990.
 (d) Methylene chloride.
 (e) 1,2-Dichloroethane.
 (f) Well inaccessible.
 (g) Sample collected from MW-2 for TPH-D analysis received in laboratory 7 days after collection; sample exceeded EPA recommended holding time for TPH-D on a water matrix.
 (h) Blind duplicate.
 (i) Top of casing lowered.
 (j) Travel blank.

TABLE 2 - SUMMARY OF RESULTS OF GROUNDWATER MONITORING
SHELL SERVICE STATION
4411 FOOTHILL BOULEVARD, OAKLAND, CALIFORNIA

ALISTO PROJECT NO. 10-014

S-1	03/30/95	38.31	6.09	32.22
S-1	06/20/95	38.31	7.30	31.01
S-1	12/06/95	38.31	11.64	26.67
S-2	03/30/95	38.79	7.86	30.93
S-2	06/20/95	38.79	9.51	29.28
S-2	12/06/95	38.79	10.52	28.27
S-3	03/30/95	37.33	7.06	30.27
S-3	06/20/95	37.33	8.15	29.18
S-3	12/06/95	37.33	10.53	26.80

NOTES:

- (a) Top of casing elevations surveyed relative to 1929 NGVD.
Measured in feet above mean sea level.
- (b) Groundwater elevations in feet above mean sea level.

SOURCE:

Groundwater data collected by Groundwater Technology, Inc.

F:\010-014\014-5-3B.WQ2

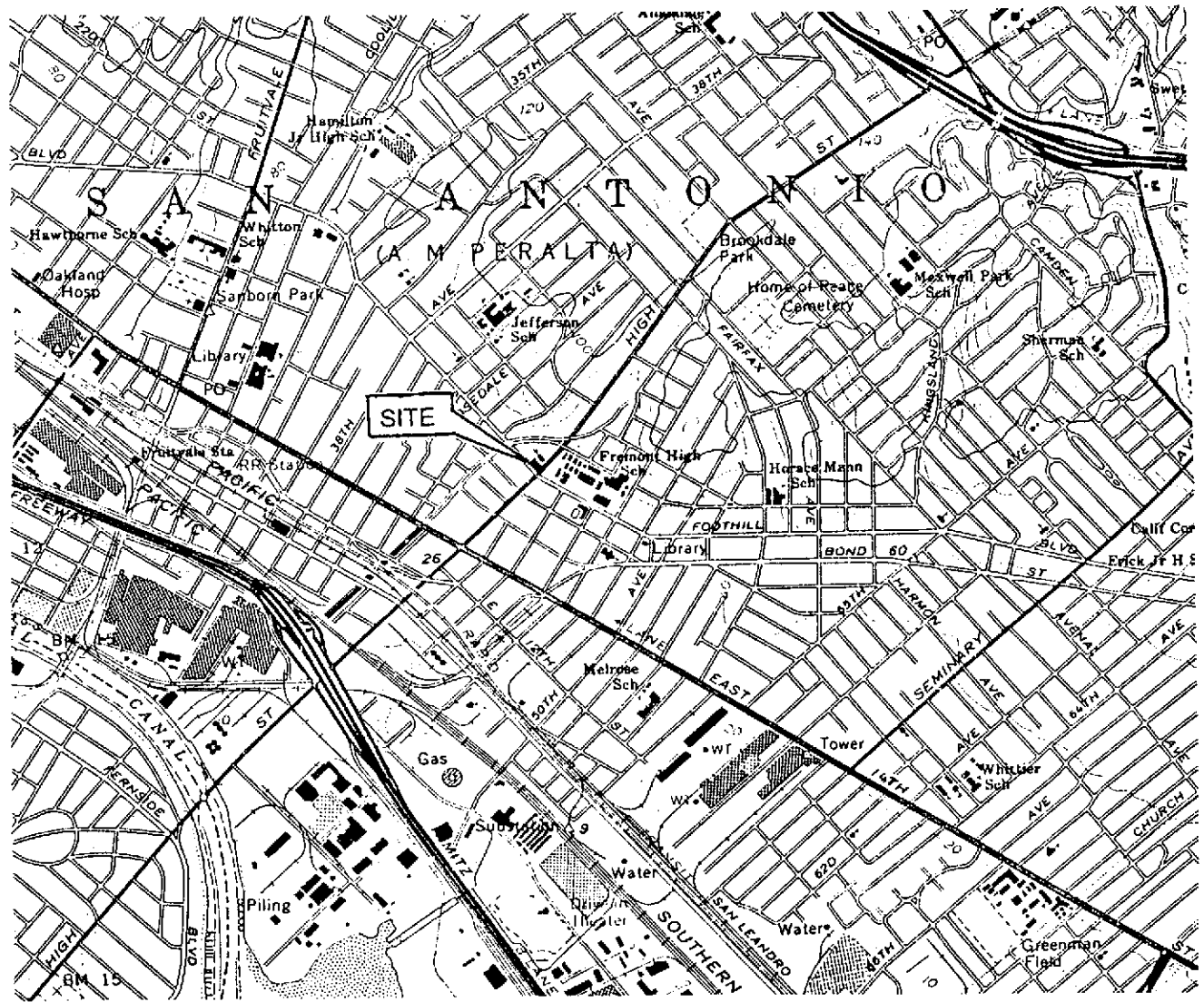

SOURCE:
 USGS MAP, OAKLAND EAST QUADRANGLE,
 CALIFORNIA, 7.5 MINUTE SERIES, 1959.
 PHOTOREVISED 1980.

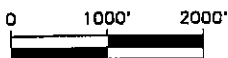
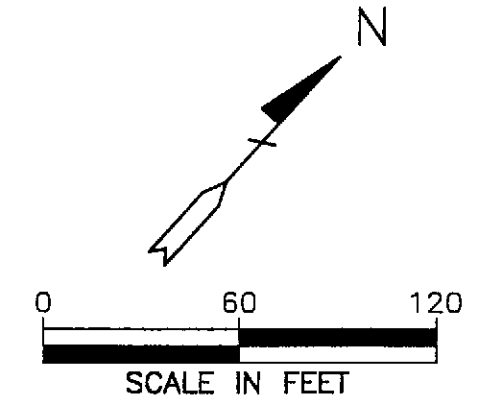
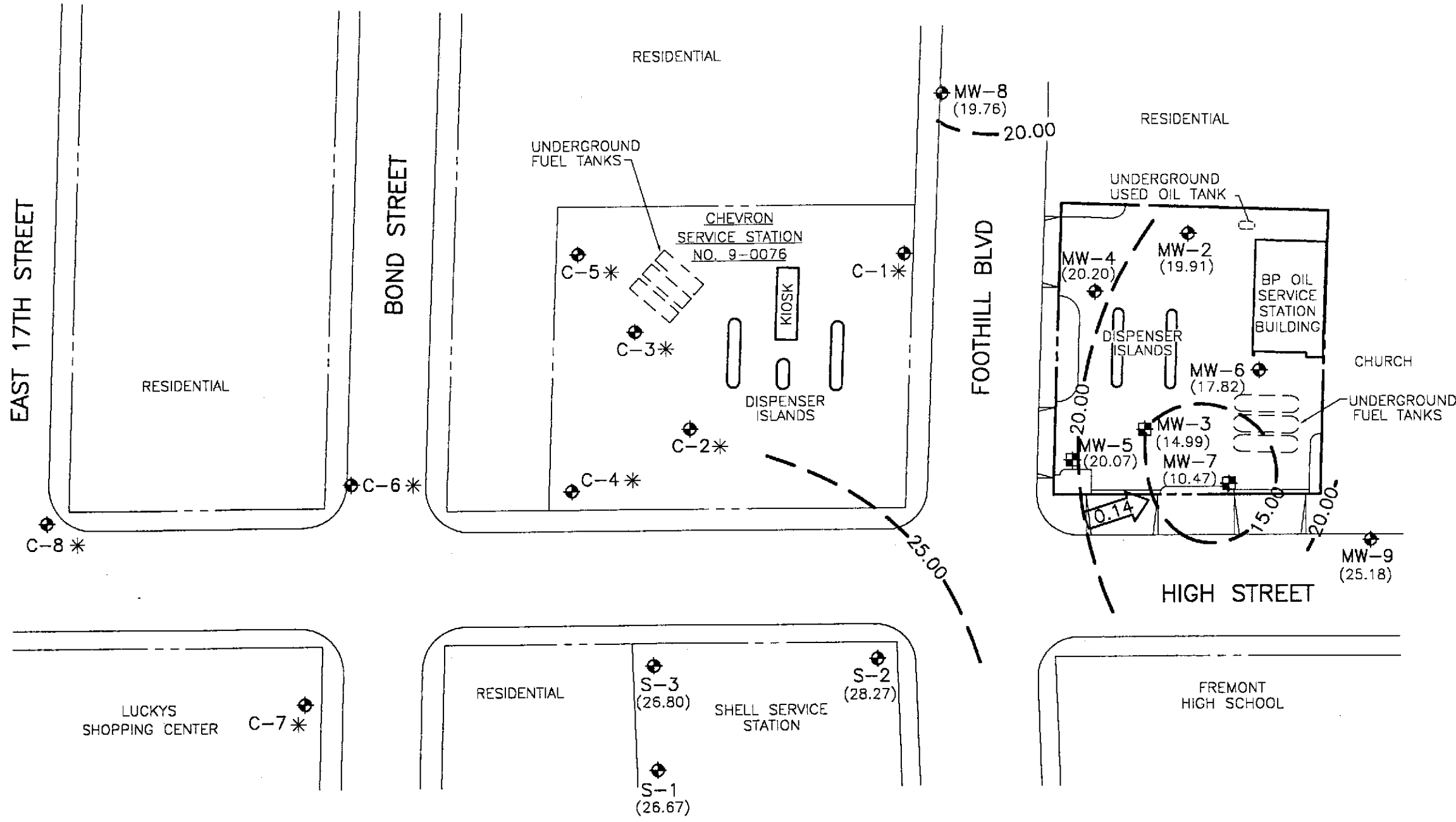

FIGURE 1
SITE VICINITY MAP

BP OIL SERVICE STATION NO. 11109
 4280 FOOTHILL BOULEVARD
 OAKLAND, CALIFORNIA
 PROJECT NO. 10-014



ALISTO ENGINEERING GROUP
 WALNUT CREEK, CALIFORNIA



- LEGEND**
- ◆ GROUNDWATER MONITORING WELL
 - ⊕ GROUNDWATER RECOVERY WELL
 - (19.76) GROUNDWATER ELEVATION IN FEET ABOVE MEAN SEA LEVEL
 - 20.00 - GROUNDWATER ELEVATION CONTOUR IN FEET ABOVE MEAN SEA LEVEL (CONTOUR INTERVAL-5.00 FEET)
 - ← 0.14 → CALCULATED GROUNDWATER GRADIENT DIRECTION AND MAGNITUDE IN FOOT PER FOOT
 - * MONITORING DATA NOT AVAILABLE

FIGURE 2
POTENTIOMETRIC GROUNDWATER ELEVATION CONTOUR MAP
DECEMBER 6, 1995
 BP OIL SERVICE STATION NO. 11109
 4280 FOOTHILL BOULEVARD
 OAKLAND, CALIFORNIA
 PROJECT NO. 10-014



1001ADP.DWG 1-31-88 RW 1=80

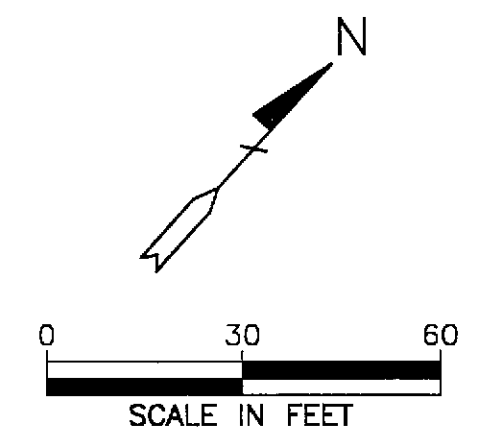
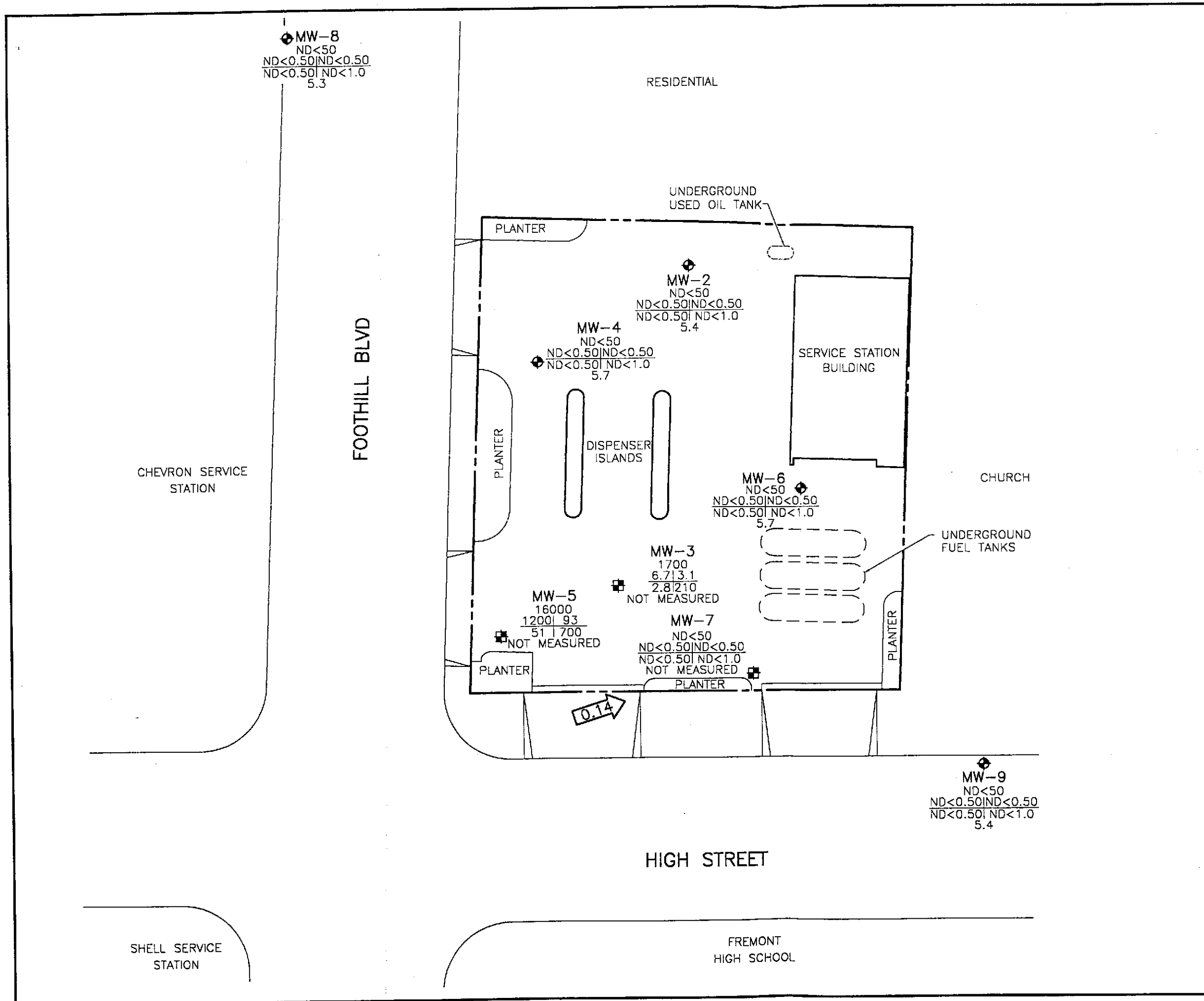

LEGEND

- ◆ GROUNDWATER MONITORING WELL
- GROUNDWATER RECOVERY WELL
- TPH-G
B | T
E | X
DO
CONCENTRATION OF CONSTITUENTS IN MICROGRAMS PER LITER, EXCEPT DISSOLVED OXYGEN, WHICH IS IN PARTS PER MILLION
- TPH-G
TOTAL PETROLEUM HYDROCARBONS AS GASOLINE
- B BENZENE
- T TOLUENE
- E ETHYLBENZENE
- X TOTAL XYLENES
- DO DISSOLVED OXYGEN
- ND NOT DETECTED ABOVE REPORTED DETECTION LIMIT
- ←0.14→ CALCULATED GROUNDWATER GRADIENT DIRECTION AND MAGNITUDE IN FOOT PER FOOT

FIGURE 3
CONCENTRATIONS OF PETROLEUM HYDROCARBONS IN GROUNDWATER
DECEMBER 6, 1995
BP OIL SERVICE STATION NO. 11109
4280 FOOTHILL BOULEVARD
OAKLAND, CALIFORNIA
PROJECT NO. 10-014

APPENDIX A
WATER SAMPLING FIELD SURVEY FORMS

ALISTO

Field Report / Sampling Data Sheet

ENGINEERING
GROUP
1575 TREAT BOULEVARD, SUITE 201

Project No. 10-014-05-003 Date: 12/6/95
Address 4280 Foothill Blvd Day: M T W T H F
Contract No. G602076 City: Oakland
Station No. BP 11109 Sampler: WS

DEPTH TO GROUNDWATER SUMMARY

WELL ID	SAMPLE ID	WELL DIAM	TOTAL DEPTH	DEPTH TO WATER	PRODUCT THICKNESS	TIME SAMPLED	COMMENTS:
MW-2	S-5	2"	30.10	21.31	∅	1430	
* MW-3	S-6	4"	31.80	25.14		1450	QC - 1 S-9 taken from this well
MW-4	S-4	↓	34.28	19.91		1528	
* MW-5	S-8	↓	NJM	19.07		1520	
MW-6	S-2	↓	34.28	23.77		1230	
* MW-7	S-7	6"	33.48	29.85		1506	
MW-8	S-3		21.74	18.42		1339	
MW-9	S-1	2"	29.31	16.07	↓	1137	

FIELD INSTRUMENT CALIBRATION DATA

pH METER Icm 4.00 4 7.00 7 10.00 TEMPERATURE COMPENSATED ∅ N TIME 0920
D.O. METER Icm ZERO d.O. SOLUTION 0 BAROMETRIC PRESSURE 760 TEMP 64 WEATHER clear
CONDUCTIVITY METER Icm 10,000 ^{ocean} TURBIDITY METER _____ 5.0 NTU OTHER _____

Well ID	Depth to Water	Diam	Cap/Lock	Product	Dept	Iridescence	Gal.	Time	Temp *F	pH	E.C.	D.O.	
MW-9	16.07	2"	OK	∅	Y	(N)	7	1117	65.7	7.13	493µs	4.9	<input type="checkbox"/> EPA 601 <input checked="" type="checkbox"/> TPH-G/BTEX HCL <input type="checkbox"/> TPH Diesel <input type="checkbox"/> TOG 5520 TIME/SAMPLE ID 1137 / S-1
Total Depth - Water Level = x Well Vol. Factor = x#vol. to Purge PurgeVol.							4		64.3	7.03	516µs		
29.31 - 16.07 = 13.24 x 1.6 = 21.2 x 3 = 6.36							6.5	1131	63.7	6.96	520µs	5.4	
Purge Method: <input checked="" type="checkbox"/> Surface Pump <input type="checkbox"/> ODisp. Tube <input type="checkbox"/> OWinch <input type="checkbox"/> ODisp. Bailer(s) <input type="checkbox"/> OSys Port													
Comments:													
Well ID	Depth to Water	Diam	Cap/Lock	Product	Dept	Iridescence	Gal.	Time	Temp *F	pH	E.C.	D.O.	
MW-6	23.77	4"	OK	∅	Y	(N)	7	1152	66.2	7.04	913µs	5.8	<input type="checkbox"/> EPA 601 <input checked="" type="checkbox"/> TPH-G/BTEX HCL <input type="checkbox"/> TPH Diesel <input type="checkbox"/> TOG 5520 TIME/SAMPLE ID 1230 / S-2
Total Depth - Water Level = x Well Vol. Factor = x#vol. to Purge PurgeVol.							14		64.9	6.92	926µs		
34.28 - 23.77 = 10.51 x 1.5 = 6.83 x 3 = 20.49							20.5	1224	64.4	6.87	929µs	5.7	
Purge Method: <input type="checkbox"/> Surface Pump <input type="checkbox"/> ODisp. Tube <input type="checkbox"/> OWinch <input checked="" type="checkbox"/> ODisp. Bailer(s) <input type="checkbox"/> OSys Port													
Comments:													

PAGE 1 OF 3

* Tied to P&T System
System is in operation (Running)

ALISTO

Field Report / Sampling Data Sheet

ENGINEERING

GROUP

1575 TREAT BOULEVARD, SUITE 201

WALNUT CREEK CA 94598 (510) 295-1650 FAX 295-1823

Project No.

10-014-05-003

Address

4280 Foothill Blvd

Contract No.

G602076

Station No.

BP 11109

Sampler:

Date:

12/6/95

Day:

M T W T H F

City:

Oakland

Well ID	Depth to Water	Diam	Cap/Lock	Product Dept	Iridescence	Gal.	Time	Temp *F	pH	E.C.	D.O.		
MW-8	18.42	2"	OK	Ø	Y ⊕	.75	1310	64.7	7.71	817µs	4.7	<input type="radio"/> EPA 601 _____	
Total Depth - Water Level=						x Well Vol. Factor=	x#vol. to Purge	Purge Vol.					<input checked="" type="radio"/> TPH-G/BTEX HCL
21.74 - 18.42 = 3.32						x .16 = .53	x 3 = 1.59	1.5	63.8	7.42	797µs	<input type="radio"/> TPH Diesel _____	
Purge Method: <input checked="" type="checkbox"/> Surface Pump						<input type="checkbox"/> ODisp. Tube	<input type="checkbox"/> OWinch	<input type="checkbox"/> ODisp. Bailer(s)	<input type="checkbox"/> OSys Port				<input type="radio"/> TOG 5520 _____
Comments:												TIME/SAMPLE ID	
												1339 / S-3	
MW-4	19.91	4"	OK	Ø	Y ⊕	9	1352	64.7	7.47	613µs	5.3	<input type="radio"/> EPA 601 _____	
Total Depth - Water Level=						x Well Vol. Factor=	x#vol. to Purge	Purge Vol.					<input checked="" type="radio"/> TPH-G/BTEX HCL
34.28 - 19.91 = 14.37						x .65 = 9.34	x 3 = 28.02	19	63.3	7.36	631µs	<input type="radio"/> TPH Diesel _____	
Purge Method: <input checked="" type="checkbox"/> Surface Pump						<input type="checkbox"/> ODisp. Tube	<input type="checkbox"/> OWinch	<input type="checkbox"/> ODisp. Bailer(s)	<input type="checkbox"/> OSys Port				<input type="radio"/> TOG 5520 _____
Comments: Well dry @ 16 gal let feelings be purged												TIME/SAMPLE ID	
												1528 / S-4	
MW-2	21.31	2"	OK	Ø	Y ⊕	2	1420	65.3	7.41	720µs	5.2	<input type="radio"/> EPA 601 _____	
Total Depth - Water Level=						x Well Vol. Factor=	x#vol. to Purge	Purge Vol.					<input checked="" type="radio"/> TPH-G/BTEX HCL
30.10 - 21.31 = 8.79						x .16 = 1.41	x 3 = 4.23	3.5	64.1	7.17	736µs	<input type="radio"/> TPH Diesel _____	
Purge Method: <input type="checkbox"/> Surface Pump						<input type="checkbox"/> ODisp. Tube	<input type="checkbox"/> OWinch	<input checked="" type="checkbox"/> ODisp. Bailer(s)	<input type="checkbox"/> OSys Port				<input type="radio"/> TOG 5520 _____
Comments:												TIME/SAMPLE ID	
												430 / S-5	
* MW-3	25.14	4"	OK	Ø	Y ⊕	8						<input type="radio"/> EPA 601 _____	
Total Depth - Water Level=						x Well Vol. Factor=	x#vol. to Purge	Purge Vol.					<input checked="" type="radio"/> TPH-G/BTEX HCL
31.80 - 25.14 = 6.66						x .65 = 4.33	x 3 = 12.99	8				<input type="radio"/> TPH Diesel _____	
Purge Method: <input type="checkbox"/> Surface Pump						<input type="checkbox"/> ODisp. Tube	<input type="checkbox"/> OWinch	<input type="checkbox"/> ODisp. Bailer(s)	<input checked="" type="checkbox"/> OSys Port				<input type="radio"/> TOG 5520 _____
Comments: QC-1 / S-9 taken from this well												TIME/SAMPLE ID	
												1450 / S-6	
* MW-7	29.85	6"	OK	Ø	Y ⊕							<input type="radio"/> EPA 601 _____	
Total Depth - Water Level=						x Well Vol. Factor=	x#vol. to Purge	Purge Vol.					<input checked="" type="radio"/> TPH-G/BTEX HCL
33.48 - 29.85 = 3.63												<input type="radio"/> TPH Diesel _____	
Purge Method: <input type="checkbox"/> Surface Pump						<input type="checkbox"/> ODisp. Tube	<input type="checkbox"/> OWinch	<input type="checkbox"/> ODisp. Bailer(s)	<input checked="" type="checkbox"/> OSys Port				<input type="radio"/> TOG 5520 _____
Comments:												TIME/SAMPLE ID	
												1506 / S-7	

* System is operating
Sample from port

ALISTO

Field Report / Sampling Data Sheet

ENGINEERING

GROUP

1575 TREAT BOULEVARD, SUITE 201

WALNUT CREEK CA 94598 (510) 295-1650 FAX 295-1823

Project No.

10-014-05-003

Address

4280 Foothill Blvd

Contract No.

G602076

Station No.

BP 11109

Sampler:

Date:

12/6/95

Day:

M TH F

City:

Oakland

Sampler:

LB

Well ID	Depth to Water	Diam	Cap/Lock	Product Dept	Iridescence	Gal.	Time	Temp *F	pH	E.C.	D.O.	
* MW-5	19.07	4"	OK	Ø	Y (N)							
Total Depth - Water Level=						x Well Vol. Factor=		x#vol. to Purge		PurgeVol.		
N/A - 19.07												
Purge Method: OSurface Pump ODisp.Tube OWinch ODisp. Bailor(s) <input checked="" type="checkbox"/> Sys Port												
Comments:												
											1520 15-8	

- EPA 601 _____
- TPH-G/BTEX HCL
- TPH Diesel _____
- TOG 5520 _____
- TIME/SAMPLE ID

* System is operating, Sample from port

APPENDIX B

LABORATORY REPORT AND CHAIN OF CUSTODY RECORD



Analytical **Technologies, Inc.**

Corporate Offices: 5550 Morehouse Drive San Diego, CA 92121 (619) 458-9141

ATI I.D.: 512088

December 15, 1995

ALISTO ENGINEERING
1575 TREAT BOULEVARD, SUITE 201
WALNUT CREEK, CA 94598

Project Name: BP SITE #11109/OAKLAND, CA
Project # : G602112/10-014-5-3

Attention: BRADY NAGLE

Analytical Technologies, Inc. has received the following sample(s):

<u>Date Received</u>	<u>Quantity</u>	<u>Matrix</u>
December 08, 1995	10	WATER

The sample(s) were analyzed with EPA methodology or equivalent methods as specified in the enclosed analytical schedule. The symbol for "less than" indicates a value below the reportable detection limit. If any flags appear next to the analytical data in this report, please see the attached list of flag definitions.

The results of these analyses and the quality control data are enclosed. Please note that the Sample Condition Upon Receipt Checklist is included at the end of this report.

GARY STEWART
VOLATILES SUPERVISOR

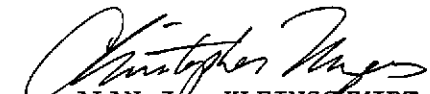
ALAN J. KLEINSCHMIDT
FOR LABORATORY MANAGER

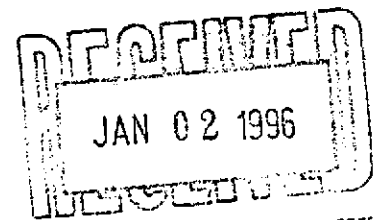

SAMPLE CROSS REFERENCE

Client : ALISTO ENGINEERING
 Project # : G602112/10-014-5-3
 Project Name: BP SITE #11109/OAKLAND, CA

Report Date: December 15, 1995
 ATI I.D. : S12088

ATI #	Client Description	Matrix	Date Collected
1	S-1	WATER	06-DEC-95
2	S-2	WATER	06-DEC-95
3	S-3	WATER	06-DEC-95
4	S-4	WATER	06-DEC-95
5	S-5	WATER	06-DEC-95
6	S-6	WATER	06-DEC-95
7	S-7	WATER	06-DEC-95
8	S-8	WATER	06-DEC-95
9	S-9	WATER	06-DEC-95
10	S-10	WATER	06-DEC-95

---TOTALS---

<u>Matrix</u>	<u># Samples</u>
WATER	10

ATI STANDARD DISPOSAL PRACTICE

The sample(s) from this project will be disposed of in twenty-one (21) days from the date of this report. If an extended storage period is required, please contact our sample control department before the scheduled disposal date.

ANALYTICAL SCHEDULE

Client : ALISTO ENGINEERING
Project # : G602112/10-014-5-3
Project Name: BP SITE #11109/OAKLAND, CA

ATI I.D.: 512088

Analysis	Technique/Description
MOD EPA 8015-CDOHS/8020 (HYDROCARBONS C6-C12/BTXE)	GC/FLAME ION./PHOTO IONIZATION DETECTOR

GAS CHROMATOGRAPHY RESULTS

Test : MOD EPA 8015-CDOHS/8020 (HYDROCARBONS C6-C12/BTXE)
 Client : ALISTO ENGINEERING
 Project # : G602112/10-014-5-3
 Project Name: BP SITE #11109/OAKLAND, CA

ATI I.D. : 512088

Sample #	Client ID	Matrix	Date Sampled	Date Extracted	Date Analyzed	Dil. Factor
1	S-1	WATER	06-DEC-95	N/A	11-DEC-95	1.00
2	S-2	WATER	06-DEC-95	N/A	12-DEC-95	1.00
3	S-3	WATER	06-DEC-95	N/A	11-DEC-95	1.00

Parameter	Units	1	2	3
METHYL T-BUTYL ETHER	UG/L	46	45	47
BENZENE	UG/L	<0.50	<0.50	<0.50
TOLUENE	UG/L	<0.50	<0.50	<0.50
ETHYLBENZENE	UG/L	<0.50	<0.50	<0.50
XYLENES (TOTAL)	UG/L	<1.0	<1.0	<1.0
FUEL HYDROCARBONS	UG/L	<50	<50	<50
HYDROCARBON RANGE		C6-C12	C6-C12	C6-C12
HYDROCARBONS QUANTITATED USING		GASOLINE	GASOLINE	GASOLINE

SURROGATES

TRIFLUOROTOLUENE	%	96	97	95
------------------	---	----	----	----

GAS CHROMATOGRAPHY RESULTS

Test : MOD EPA 8015-CDOHS/8020 (HYDROCARBONS C6-C12/BTXE)
 Client : ALISTO ENGINEERING ATI I.D. : 512088
 Project # : G602112/10-014-5-3
 Project Name: BP SITE #11109/OAKLAND, CA

Sample #	Client ID	Matrix	Date Sampled	Date Extracted	Date Analyzed	Dil. Factor
4	S-4	WATER	06-DEC-95	N/A	11-DEC-95	1.00
5	S-5	WATER	06-DEC-95	N/A	12-DEC-95	1.00
6	S-6	WATER	06-DEC-95	N/A	12-DEC-95	2.00

Parameter	Units	4	5	6
METHYL T-BUTYL ETHER	UG/L	47	46	64@E
BENZENE	UG/L	<0.50	<0.50	6.7@E
TOLUENE	UG/L	<0.50	<0.50	3.1
ETHYLBENZENE	UG/L	<0.50	<0.50	2.8@E
XYLENES (TOTAL)	UG/L	<1.0	<1.0	210
FUEL HYDROCARBONS	UG/L	<50	<50	1700
HYDROCARBON RANGE		C6-C12	C6-C12	C6-C12
HYDROCARBONS QUANTITATED USING		GASOLINE	GASOLINE	GASOLINE
<u>SURROGATES</u>				
TRIFLUOROTOLUENE	%	92	91	130*H

GAS CHROMATOGRAPHY RESULTS

Test : MOD EPA 8015-CDOHS/8020 (HYDROCARBONS C6-C12/BTXE)
 Client : ALISTO ENGINEERING
 Project # : G602112/10-014-5-3
 Project Name: BP SITE #11109/OAKLAND, CA
 ATI I.D. : 512088

Sample #	Client ID	Matrix	Date Sampled	Date Extracted	Date Analyzed	Dil. Factor
7	S-7	WATER	06-DEC-95	N/A	13-DEC-95	1.00
8	S-8	WATER	06-DEC-95	N/A	12-DEC-95	20.00
9	S-9	WATER	06-DEC-95	N/A	12-DEC-95	2.00

Parameter	Units	7	8	9
METHYL T-BUTYL ETHER	UG/L	<5.0	600	53@E
BENZENE	UG/L	<0.50	1200	6.1@E
TOLUENE	UG/L	<0.50	93@E	3.0
ETHYLBENZENE	UG/L	<0.50	51	1.7@E
XYLENES (TOTAL)	UG/L	<1.0	700	190
FUEL HYDROCARBONS	UG/L	<50	16000	1400
HYDROCARBON RANGE		C6-C12	C6-C12	C6-C12
HYDROCARBONS QUANTITATED USING		GASOLINE	GASOLINE	GASOLINE
<u>SURROGATES</u>				
TRIFLUOROTOLUENE	%	99	148*H	117*H

GAS CHROMATOGRAPHY RESULTS

Test : MOD EPA 8015-CDOHS/8020 (HYDROCARBONS C6-C12/BTXE)
 Client : ALISTO ENGINEERING ATI I.D. : 512088
 Project # : G602112/10-014-5-3
 Project Name: BP SITE #11109/OAKLAND, CA

Sample #	Client ID	Matrix	Date Sampled	Date Extracted	Date Analyzed	Dil. Factor
10	S-10	WATER	06-DEC-95	N/A	12-DEC-95	1.00

Parameter	Units	10
METHYL T-BUTYL ETHER	UG/L	<5.0
BENZENE	UG/L	<0.50
TOLUENE	UG/L	<0.50
ETHYLBENZENE	UG/L	<0.50
XYLENES (TOTAL)	UG/L	<1.0
FUEL HYDROCARBONS	UG/L	<50
HYDROCARBON RANGE		C6-C12
HYDROCARBONS QUANTITATED USING		GASOLINE
<u>SURROGATES</u>		
TRIFLUOROTOLUENE	%	93

GAS CHROMATOGRAPHY - QUALITY CONTROL

REAGENT BLANK

Test : MOD EPA 8015-CDOHS (FUEL HYDROCARBONS/BTXE)
 Blank I.D. : 37587
 Client : ALISTO ENGINEERING
 Project # : G602112/10-014-5-3
 Project Name: BP SITE #11109/OAKLAND, CA

ATI I.D. : 512088
 Date Extracted: N/A
 Date Analyzed : 11-DEC-95
 Dil. Factor : 1.00

Parameters	Units	Results
METHYL T-BUTYL ETHER	UG/L	<5.0
BENZENE	UG/L	<0.50
TOLUENE	UG/L	<0.50
ETHYLBENZENE	UG/L	<0.50
XYLENES (TOTAL)	UG/L	<1.0
FUEL HYDROCARBONS	UG/L	<50
HYDROCARBON RANGE		C6-C12
HYDROCARBONS QUANTITATED USING		GASOLINE
<u>SURROGATES</u>		
TRIFLUOROTOLUENE	%	102

GAS CHROMATOGRAPHY - QUALITY CONTROL

REAGENT BLANK

Test : MOD EPA 8015-CDOHS (FUEL HYDROCARBONS/BTXE)
 Blank I.D. : 37611
 Client : ALISTO ENGINEERING
 Project # : G602112/10-014-5-3
 Project Name: BP SITE #11109/OAKLAND, CA

ATI I.D. : 512088
 Date Extracted: N/A
 Date Analyzed : 13-DEC-95
 Dil. Factor : 1.00

Parameters	Units	Results
METHYL T-BUTYL ETHER	UG/L	<5.0
BENZENE	UG/L	<0.50
TOLUENE	UG/L	<0.50
ETHYLBENZENE	UG/L	<0.50
KYLENES (TOTAL)	UG/L	<1.0
FUEL HYDROCARBONS	UG/L	<50
HYDROCARBON RANGE		C6-C12
HYDROCARBONS QUANTITATED USING		GASOLINE
<u>SURROGATES</u>		
TRIFLUOROTOLUENE	%	96

GAS CHROMATOGRAPHY - QUALITY CONTROL

MSMSD

Test : MOD EPA 8015-CDOHS (FUEL HYDROCARBONS/BTXE)
 MSMSD # : 80541
 Client : ALISTO ENGINEERING
 Project # : G602112/10-014-5-3
 Project Name: BP SITE #11109/OAKLAND, CA

ATI I.D. : 512088
 Date Extracted: N/A
 Date Analyzed : 08-DEC-95
 Sample Matrix : WATER
 REF I.D. : 512050-10

Parameters	Units	Sample Result	Conc Spike	Spiked Sample	% Rec	Dup Spike	Dup % Rec	RPD
BENZENE	UG/L	<0.50	5.0	4.5	90	5.0	100	11
TOLUENE	UG/L	<0.50	5.0	4.6	92	5.2	104	12

% Recovery = (Spike Sample Result - Sample Result)*100/Spike Concentration

RPD (Relative % Difference) = (Spiked Sample Result - Duplicate Spike Result)*100/Average Result

GAS CHROMATOGRAPHY - QUALITY CONTROL

BLANK SPIKE

Test : MOD EPA 8015-CDOHS (FUEL HYDROCARBONS/BTXE)
 Blank Spike #: 60471
 Client : ALISTO ENGINEERING
 Project # : G602112/10-014-5-3
 Project Name : BP SITE #11109/OAKLAND, CA

ATI I.D. : 512088
 Date Extracted: N/A
 Date Analyzed : 11-DEC-95
 Sample Matrix : WATER

Parameters	Units	Blank Result	Spiked Sample	Spike Conc.	% Rec
BENZENE	UG/L	<0.50	4.6	5.0	92
TOLUENE	UG/L	<0.50	4.9	5.0	98

% Recovery = (Spike Sample Result - Sample Result)*100/Spike Concentration

RPD (Relative % Difference) = (Spiked Sample - Blank Result)*100/Average Result

GAS CHROMATOGRAPHY - QUALITY CONTROL

BLANK SPIKE

Test : MOD EPA 8015-CDOHS (FUEL HYDROCARBONS/BTXE)
 Blank Spike #: 60520
 Client : ALISTO ENGINEERING
 Project # : G602112/10-014-5-3
 Project Name : BP SITE #11109/OAKLAND, CA

ATI I.D. : 512088
 Date Extracted: N/A
 Date Analyzed : 13-DEC-95
 Sample Matrix : WATER

Parameters	Units	Blank Result	Spiked Sample	Spike Conc.	% Rec
BENZENE	UG/L	<0.50	5.1	5.0	102
TOLUENE	UG/L	<0.50	5.2	5.0	104

% Recovery = (Spike Sample Result - Sample Result)*100/Spike Concentration
 RPD (Relative % Difference) = (Spiked Sample - Blank Result)*100/Average Result

ANALYTICAL TECHNOLOGIES, INC.
SAN DIEGO
FLAGS

ORGANICS

FLAG MESSAGE DESCRIPTION

A A TIC IS A SUSPECTED ALDOL-CONDENSATION PRODUCT
B ANALYTE FOUND IN THE ASSOCIATED REAGENT BLANK
C PESTICIDE, WHERE THE IDENTIFICATION WAS CONFIRMED BY GC/MS
CO THESE COMPOUNDS CO-ELUTE AND ARE QUANTITATED AS ONE PEAK
D COMPOUND IDENTIFIED IN AN ANALYSIS AT SECONDARY DILUTION
E ANALYTE AMOUNT EXCEEDS THE CALIBRATION RANGE
J ESTIMATED VALUE
H QUANTIFIED AS DIESEL BUT CHROMATOGRAPHIC PATTERN DOES NOT MATCH
THAT OF DIESEL
K QUANTIFIED AS KEROSENE BUT CHROMATOGRAPHIC PATTERN DOES NOT MATCH
THAT OF KEROSENE
L QUANTIFIED AS GASOLINE BUT CHROMATOGRAPHIC PATTERN DOES NOT MATCH
THAT OF GASOLINE
N PRESUMPTIVE EVIDENCE OF A COMPOUND
P PESTICIDE/AROCLOR TARGET ANALYTE, WHERE THERE IS GREATER THAN 25%
DIFFERENCE FOR DETECTED CONCENTRATION BETWEEN 2 GC COLUMNS
TR COMPOUND DETECTED AT AN UNQUANTIFIABLE TRACE LEVEL
U COMPOUND WAS ANALYZED FOR BUT NOT DETECTED
X SEE CASE NARRATIVE
Y SEE CASE NARRATIVE
Z SEE CASE NARRATIVE
* OUTSIDE OF QUALITY CONTROL LIMITS
*D COMPOUND ANALYZED FROM A SECONDARY ANALYSIS
*F RESULT OUTSIDE OF ATI'S QUALITY CONTROL LIMITS
*G RESULT OUTSIDE QUALITY CONTROL LIMITS. INSUFFICIENT SAMPLE FOR RE-
EXTRACTION/ANALYSIS
*H RESULT OUTSIDE OF LIMITS DUE TO SAMPLE MATRIX INTERFERENCE
*I BECAUSE OF NECESSARY SAMPLE DILUTION, VALUE WAS OUTSIDE QC LIMITS
*K DUE TO THE NECESSARY DILUTION OF THE SAMPLE, RESULT WAS NOT ATTAINABLE
*L ANALYTE IS A SUSPECTED LAB CONTAMINANT
*P A STANDARD WAS USED TO QUANTITATE THIS VALUE
*R DATA IS NOT USABLE
*T SURROGATE RECOVERY IS OUTSIDE QC CONTROL LIMITS. NO CORRECTIVE
ACTION INDICATED BY METHOD
*V SAMPLE RESULT IS >4X SPIKED CONCENTRATION, THEREFORE SPIKE IS NOT DETECTABLE
*Y RESULT NOT ATTAINABLE DUE TO SAMPLE MATRIX INTERFERENCE
@A RESULTS OUT OF LIMITS DUE TO SAMPLE NON-HOMOGENEITY
@C VARIABLE MESSAGE
@D RESULT COULD NOT BE CONFIRMED DUE TO MATRIX INTERFERENCE ON THE
CONFIRMATION COLUMN
@E RESULT MAY BE FALSELY ELEVATED DUE TO SAMPLE MATRIX INTERFERENCE
@F RESULT OUTSIDE OF CONTRACT SPECIFIED QUALITY CONTROL LIMITS
@G RESULT OUTSIDE OF CONTRACT SPECIFIED ADVISORY LIMITS
@H DETECTION LIMIT ELEVATED DUE TO MATRIX INTERFERENCE
@M RESULT NOT CONFIRMED BY U.V. DUE TO SAMPLE MATRIX INTERFERENCE
@N RESULT NOT CONFIRMED BY FLUORESCENCE DUE TO SAMPLE MATRIX INTERFERENCE
@P RESULT QUANTITATED USING FLUORESCENCE ONLY DUE TO THE LOW CONCENTRATION
@Q DETECTION LIMIT ELEVATED DUE TO LIMITED SAMPLE FOR ANALYSIS
@T RESULT DUE TO TCLP EXTRACTION MATRIX INTERFERENCE. NO QC LIMITS
HAVE BEEN ESTABLISHED
@U SAMPLE CHROMATOGRAM DOES NOT RESEMBLE COMMON FUEL HYDROCARBON
FINGERPRINTS
@Z SAMPLE CHROMATOGRAM DOES NOT RESEMBLE A FUEL HYDROCARBON

ACCESSION #: 512088

INITIALS: LQ

ATI-San Diego
SAMPLE CONDITION UPON RECEIPT CHECKLIST
(FOR RE-ACCESSIONS, COMPLETE #7 THRU #9)

1	Does this project require special handling according to NFESC Levels C, D, AFCEE or CLP protocols? If yes, complete a) and b) a) pH sample aliquoted: yes /no /na b) Either 1) Record Bottle Lot #'s: Or 2) Attach Sample Kit Request Form(s)	YES	<u>NO</u>
2	Number of Coolers Received If more than one cooler received attach Multiple Cooler Documentation Form (MCD) Indicate "see MCD" on Item 11 below		<u>1</u>
3	Are custody seals required for this project ?	YES	<u>N/A</u>
	a) are Custody Seals present on Cooler(s) ?	YES	<u>NO</u>
	If yes, are seals intact ?	YES	<u>NO</u>
	b) are Custody Seals present on the sample ?	YES	<u>NO</u>
	If yes, are seals intact ?	YES	<u>NO</u>
4	Is there a Chain-Of-Custody (COC)* per cooler ? if not, if a problem is found indicate which samples/test were in the affected cooler on the MCD.	<u>YES</u>	<u>NO</u>
5	Is the COC* complete per cooler ? Relinquished: <u>yes</u> /no Requested analysis: <u>yes</u> /no	<u>YES</u>	<u>NO</u>
6*	Is the COC* in agreement with the samples received? # Samples: <u>yes</u> /no Sample ID's: <u>yes</u> /no Date sampled: <u>yes</u> /no Matrix: <u>yes</u> /no # containers: <u>yes</u> /no	<u>YES</u>	<u>NO</u>
7	Are the samples preserved correctly?	<u>YES</u>	<u>NO</u>
8	Is there enough sample for all the requested analyses?	<u>YES</u>	<u>NO</u>
9	Are all samples within holding times for the requested analyses?	<u>YES</u>	<u>NO</u>
10	Record cooler temperature. Contact PM if temperature is not 4°C ± 2°C.		<u>2.0 °c</u>
	Is ice present in cooler?	<u>YES</u>	<u>NO</u>
11	Were all sample containers received intact (ie. not broken, leaking, etc.)?	<u>YES</u>	<u>NO</u>
12	Are samples requiring no headspace, headspace free? N/A	<u>YES</u>	<u>NO</u>
13	Are VOA 1st stickers required?	YES	<u>NO</u>
14	Are there special comments on the Chain of Custody which require client contact?	YES	<u>N/A</u>
15	If yes, was ATI Project Manager notified?	YES	<u>NO</u>

Describe "no" items: *b) Date taken from C.O.C.

Was client contacted? yes / no

If yes, Date: _____ Name of Person contacted: _____

Describe actions taken or client instructions: _____

*Or other representative documents, letters, and/or shipping memos



CHAIN OF CUSTODY

No. 066946 Page 1 of 1

CONSULTANT'S NAME <i>Alisto Engineering</i>		ADDRESS <i>1575 Trent Blvd # 201 W. C</i>		CITY <i>Ca</i>	STATE <i>Ca</i>	ZIP CODE <i>94512</i>
BP SITE NUMBER <i>1109 1133</i>	BP CORNER ADDRESS/CITY <i>Oakland, Ca</i>				CONSULTANT PROJECT NUMBER <i>10-025-09 10-014-5-</i>	
CONSULTANT PROJECT MANAGER <i>Brady Natch</i>		PHONE NUMBER <i>(510) 295-1150</i>		FAX NUMBER <i>295-1825</i>		CONSULTANT CONTRACT NUMBER <i>6602112</i>
BP CONTACT <i>Scott Hooton</i>	BP ADDRESS <i>Kenton, Ca</i>		PHONE NUMBER		FAX NO.	
LAB CONTACT <i>ATT</i>	LABORATORY ADDRESS <i>San Diego</i>		PHONE NUMBER		FAX NO.	
SAMPLED BY (Please Print Name) <i>Larry Buenavente</i>		SAMPLED BY (Signature) <i>[Signature]</i>		SHIPMENT DATE		SHIPMENT METHOD <i>Fed Express</i>

TAT: 24 Hours 48 Hours 1 Week Standard 2 Weeks

ANALYSIS REQUIRED

AIRBILL NUMBER *660235273*

SAMPLE DESCRIPTION	COLLECTION DATE	MATRIX SOIL/WATER	CONTAINERS		PRESERVATIVE	T-01	T-02	T-03	T-04	T-05	T-06	T-07	T-08	T-09	T-10	COMMENTS
	COLLECTION TIME		NO.	TYPE (VOL.)	LAB SAMPLE #											
S-1	12/6/95	W	2	2	01	X	X									
S-2					02											
S-3					03											
S-4					04											
S-5					05											
S-6					06											
S-7					07											
S-8					08											
S-9					09											
S-10					10											

RELINQUISHED BY / AFFILIATION	DATE	TIME	ACCEPTED BY / AFFILIATION	DATE	TIME	ADDITIONAL COMMENTS
<i>[Signature]</i>	12/7/95	1300	<i>Jawad Alisto</i>	12/7/95	1302	LAB ID 512088
<i>[Signature]</i>	12/7/95	1302	<i>[Signature]</i>	12/5/95	9:15 AM	Temp. 2.0°C