



BP OIL

ENVIRONMENTAL
SECTION

OCT 25 9 27 AM '95

BP Oil Company
Environmental Resources Management
Building 13, Suite N
295 SW 41st Street
Renton, Washington 98055-4931
(206) 251-0667
Fax No: (206) 251-0736

October 25, 1995

Mr. Ed So
California Regional Water Quality Control Board
San Francisco Bay Region
2101 Webster Street, Suite 500
Oakland CA 94612

**RE: BP OIL FACILITY #11109
4280 Foothill Blvd
Oakland CA**

Dear Mr. So:

Attached please find our **GROUNDWATER MONITORING AND SAMPLING REPORT DATED August 24, 1995** for the above referenced facility.

If you should have any questions regarding this site, I may be reached at (206) 251-0689.

Respectfully,

Scott T. Hooton
Environmental Resources Management
Group Leader

STH:aa msword\ERM11109

cc: Mr. Barney Chan, Alameda County Health Care Services Agency
1131 Harbour Bay Parkway, Room 250, Alameda CA 94502-6577

Mr. Mark Miller, Chevron U.S.A., 6001 Bollinger, San Ramon, CA 94583

Mr. Brady Nagle, Alisto Engineering Group, 1575 Treat Blvd, Ste 201, Walnut Creek, CA 94598

Mr. Larry Silva, TOSCO Northwest, 601 Union Street, Suite 2500, Seattle WA 98101

Site File

GROUNDWATER MONITORING AND SAMPLING REPORT

**BP Oil Company Service Station No. 11109
4280 Foothill Boulevard
Oakland, California**

Project No. 10-014-04-001

Prepared for:

**BP Oil Company
Environmental Resources Management
295 S.W. 41st Street
Building 13, Suite N
Renton, Washington**

Prepared by:

**Alisto Engineering Group
1575 Treat Boulevard, Suite 201
Walnut Creek, California**

August 24, 1995

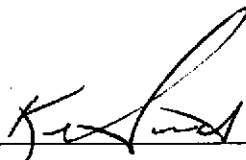

**Ken Simas
Project Manager**



**Al Sevilla, P.E.
Principal**

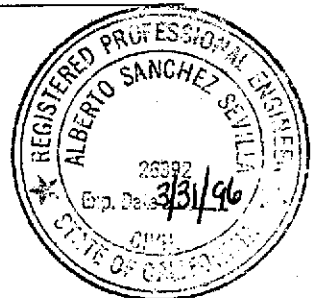

GROUNDWATER MONITORING AND SAMPLING REPORT

BP Oil Company Service Station No. 11109
4280 Foothill Boulevard
Oakland, California

Project No. 10-014-04-001

August 24, 1995

INTRODUCTION

This report presents the results and findings of the June 20, 1995 groundwater monitoring and sampling conducted by Alisto Engineering Group at BP Oil Company Service Station No. 11109, 4280 Foothill Boulevard, Oakland, California. A site vicinity map is shown in Figure 1.

FIELD PROCEDURES

Field activities were performed in accordance with the procedures and guidelines of the Alameda County Health Care Services Agency and the California Regional Water Quality Control Board, San Francisco Bay Region.

Before purging and sampling, the groundwater level in each well was measured from a permanent mark on top of the casing to the nearest 0.01 foot using an electronic sounder. The depth to groundwater and top of casing elevation data were used to calculate the groundwater elevation in each well relative to mean sea level. The survey data and groundwater elevation measurements collected to date are presented in Table 1.

Depth to groundwater was measured concurrently at the Chevron U.S.A. service station, 4625 Foothill Boulevard, and the Shell service station, 4411 Foothill Boulevard. The monitoring data for these sites are presented in Tables 2 and 3.

Before sample collection, each well was purged of 3 casing volumes, while recording field readings of pH, temperature, electrical conductivity, and dissolved oxygen. Groundwater samples were collected for laboratory analysis by lowering a bottom-fill, disposable bailer to just below the water level in the well. The samples were transferred from the bailer into laboratory-supplied containers. The water sampling field survey forms are presented in Appendix A.



SAMPLING AND ANALYTICAL RESULTS

The results of monitoring and laboratory analysis of the groundwater samples for this and previous quarters are summarized in Table 1. The potentiometric groundwater elevations as interpreted from the results of this monitoring event are shown in Figure 2. The results of groundwater analysis are shown in Figure 3. The laboratory report and chain of custody record are presented in Appendix B.



TABLE 1 - SUMMARY OF RESULTS OF GROUNDWATER SAMPLING
 BP OIL COMPANY SERVICE STATION NO. 11109
 4280 FOOTHILL BOULEVARD, OAKLAND, CALIFORNIA

ALISTO PROJECT NO. 10-014

| WELL ID | DATE OF SAMPLING/ MONITORING | CASING ELEVATION (a) (Feet) | DEPTH TO WATER (Feet) | PRODUCT THICKNESS (Feet) | GROUNDWATER ELEVATION (b) (Feet) | TPH-G (ug/l) | TPH-D (ug/l) | B (ug/l) | T (ug/l) | E (ug/l) | X (ug/l) | TOG (ug/l) | HVOC (ug/l) | DO (ppm) | LAB |
|---------|------------------------------|-----------------------------|-----------------------|--------------------------|----------------------------------|--------------|--------------|----------|----------|----------|----------|------------|-------------|----------|----------|
| MW-1 | 01/31/90 | 38.19 | 15.41 | 0.00 | 22.78 | --- | --- | --- | --- | --- | --- | --- | --- | --- | --- |
| MW-1 | (c) 02/05/90 | 38.19 | --- | 0.00 | --- | --- | --- | --- | --- | --- | --- | --- | --- | --- | --- |
| MW-2 | 02/05/90 | 41.22 | 21.90 | 0.00 | 19.31 | 1300 | --- | 14 | ND<0.1 | 9 | 13 | --- | --- | --- | SUP |
| MW-2 | 02/14/91 | 41.22 | 21.16 | 0.00 | 20.06 | ND<50 | ND<10000 | ND<0.3 | ND<0.3 | ND<0.3 | ND<0.3 | ND<5000 | 51 (d) | --- | SUP |
| MW-2 | 05/13/91 | 41.22 | 21.32 | 0.00 | 19.90 | ND<50 | ND<50 | ND<0.3 | ND<0.3 | ND<0.3 | ND<0.3 | 6000 | 0.5 (e) | --- | SUP |
| MW-2 | 07/24/91 | 41.22 | 22.92 | 0.00 | 18.30 | --- | --- | --- | --- | --- | --- | --- | --- | --- | --- |
| MW-2 | 10/03/91 | 41.22 | 24.90 | 0.00 | 16.32 | ND<50 | ND<50 | ND<0.3 | 0.8 | ND<0.3 | ND<0.3 | ND<5000 | 0.7 (e) | --- | SUP |
| MW-2 | 10/15/91 | 41.22 | 24.10 | 0.00 | 17.12 | --- | --- | --- | --- | --- | --- | --- | --- | --- | --- |
| MW-2 | 12/04/91 | 41.22 | INACCESSIBLE | --- | --- | --- | --- | --- | --- | --- | --- | --- | --- | --- | --- |
| MW-2 | 12/16/91 | 41.22 | 23.95 | 0.00 | 17.27 | --- | --- | --- | --- | --- | --- | --- | --- | --- | --- |
| MW-2 | 01/06/92 | 41.22 | 23.30 | 0.00 | 17.92 | ND<50 | ND<50 | ND<0.3 | ND<0.3 | ND<0.3 | ND<0.3 | ND<5000 | ND | --- | ANA |
| MW-2 | 01/22/92 | 41.22 | 23.14 | 0.00 | 18.08 | --- | --- | --- | --- | --- | --- | --- | --- | --- | --- |
| MW-2 | 01/28/92 | 41.22 | 22.99 | 0.00 | 18.23 | --- | --- | --- | --- | --- | --- | --- | --- | --- | --- |
| MW-2 | 02/05/92 | 41.22 | 22.63 | 0.00 | 18.59 | --- | --- | --- | --- | --- | --- | --- | --- | --- | --- |
| MW-2 | 02/12/92 | 41.22 | 22.04 | 0.00 | 19.18 | --- | --- | --- | --- | --- | --- | --- | --- | --- | --- |
| MW-2 | 02/17/92 | 41.22 | 20.84 | 0.00 | 20.38 | --- | --- | --- | --- | --- | --- | --- | --- | --- | --- |
| MW-2 | 04/03/92 | 41.22 | 18.29 | 0.00 | 22.93 | --- | --- | --- | --- | --- | --- | --- | --- | --- | --- |
| MW-2 | 04/08/92 | 41.22 | 18.86 | 0.00 | 22.36 | ND<50 | 63 | ND<0.5 | ND<0.5 | ND<0.5 | ND<0.5 | ND<5000 | ND | --- | ANA |
| MW-2 | 04/14/92 | 41.22 | 19.45 | 0.00 | 21.77 | --- | --- | --- | --- | --- | --- | --- | --- | --- | --- |
| MW-2 | 04/29/92 | 41.22 | 20.35 | 0.00 | 20.87 | --- | --- | --- | --- | --- | --- | --- | --- | --- | --- |
| MW-2 | 05/07/92 | 41.22 | 20.84 | 0.00 | 20.38 | --- | --- | --- | --- | --- | --- | --- | --- | --- | --- |
| MW-2 | 07/03/92 | 41.22 | 22.34 | 0.00 | 18.88 | ND<50 | --- | ND<0.5 | ND<0.5 | ND<0.5 | ND<0.5 | --- | --- | --- | ANA |
| MW-2 | 10/08/92 | 41.22 | 23.73 | 0.00 | 17.49 | ND<50 | --- | ND<0.5 | ND<0.5 | ND<0.5 | ND<0.5 | --- | --- | --- | ANA |
| MW-2 | 12/31/92 | 41.22 | 21.12 | 0.00 | 20.10 | ND<50 | --- | ND<0.5 | ND<0.5 | ND<0.5 | ND<0.5 | --- | --- | --- | ANA |
| MW-2 | 04/21/93 | 41.22 | 17.68 | 0.00 | 23.54 | ND<50 | ND<50 (f) | ND<0.5 | ND<0.5 | ND<0.5 | ND<0.5 | ND<5000 | ND | --- | PACE |
| MW-2 | 07/07/93 | 41.22 | 20.30 | 0.00 | 20.92 | ND<50 | --- | ND<0.5 | ND<0.5 | ND<0.5 | ND<0.5 | --- | 1.0 (e) | --- | PACE |
| MW-2 | 09/21/93 | 41.22 | 21.93 | 0.00 | 19.29 | ND<50 | --- | 0.9 | 0.7 | 0.7 | 2.6 | --- | --- | --- | PACE |
| MW-2 | 12/17/93 | 41.22 | 21.48 | --- | 19.74 | --- | --- | --- | --- | --- | --- | --- | --- | --- | --- |
| MW-2 | 12/23/93 | 41.22 | --- | --- | --- | ND<50 | --- | ND<0.5 | ND<0.5 | ND<0.5 | 0.7 | --- | --- | --- | PACE |
| MW-2 | 04/07/94 | 41.22 | 20.25 | --- | 20.97 | ND<50 | --- | ND<0.5 | ND<0.5 | ND<0.5 | ND<0.5 | --- | --- | --- | 5.9 PACE |
| MW-2 | 07/06/94 | 41.22 | 20.59 | --- | 20.63 | ND<50 | --- | ND<0.5 | ND<0.5 | ND<0.5 | ND<0.5 | --- | --- | --- | 3.1 PACE |
| MW-2 | 10/07/94 | 41.22 | 22.04 | --- | 19.18 | ND<50 | --- | ND<0.5 | ND<0.5 | ND<0.5 | ND<0.5 | --- | --- | --- | 2.8 PACE |
| MW-2 | 01/27/95 | 41.22 | 26.12 | --- | 15.10 | ND<50 | 440 | ND<0.5 | ND<0.5 | ND<0.5 | ND<1 | ND<5000 | --- | --- | 4.8 ATI |
| MW-2 | 03/30/95 | 41.22 | 12.34 | --- | 28.88 | ND<50 | --- | ND<0.50 | ND<0.50 | ND<0.50 | ND<1.0 | --- | --- | --- | 7.2 ATI |
| MW-2 | 06/20/95 | 41.22 | 16.42 | --- | 24.80 | ND<50 | --- | ND<0.50 | ND<0.50 | ND<0.50 | ND<1.0 | --- | --- | --- | 6.0 ATI |

TABLE 1 - SUMMARY OF RESULTS OF GROUNDWATER SAMPLING
 BP OIL COMPANY SERVICE STATION NO. 11109
 4280 FOOTHILL BOULEVARD, OAKLAND, CALIFORNIA

ALISTO PROJECT NO. 10-014

| WELL ID | DATE OF SAMPLING/ MONITORING | CASING ELEVATION (a) (Feet) | DEPTH TO WATER (Feet) | PRODUCT THICKNESS (Feet) | GROUNDWATER ELEVATION (b) (Feet) | TPH-G (ug/l) | TPH-D (ug/l) | B (ug/l) | T (ug/l) | E (ug/l) | X (ug/l) | TOG (ug/l) | HVOC (ug/l) | DO (ppm) | LAB |
|----------|------------------------------|-----------------------------|-----------------------|--------------------------|----------------------------------|--------------|--------------|----------|----------|----------|----------|------------|-------------|----------|------|
| MW-3 | 02/05/90 | 40.74 | 17.45 | 0.00 | 23.29 | 1400 | -- | 15 | ND<2.5 | 11 | 8 | -- | -- | -- | SUP |
| MW-3 | 02/14/91 | 40.74 | 18.52 | 0.00 | 22.22 | 320 | -- | 8 | ND<0.3 | 8 | 1 | -- | -- | -- | SUP |
| MW-3 | 05/13/91 | 40.74 | 19.32 | 0.00 | 21.42 | 640 | -- | 13 | ND<0.3 | 18 | 1 | -- | -- | -- | SUP |
| MW-3 | 07/24/91 | 40.74 | 20.69 | 0.00 | 20.05 | -- | -- | -- | -- | -- | -- | -- | -- | -- | -- |
| MW-3 | 10/03/91 | 40.74 | 19.47 | 0.00 | 21.27 | 940 | -- | 21 | ND<0.3 | 23 | 2.1 | -- | -- | -- | SUP |
| MW-3 | 10/15/91 | 40.74 | 20.46 | 0.00 | 20.28 | -- | -- | -- | -- | -- | -- | -- | -- | -- | -- |
| MW-3 | 12/04/91 | 40.74 | 18.29 | 0.00 | 22.45 | -- | -- | -- | -- | -- | -- | -- | -- | -- | -- |
| MW-3 | 12/16/91 | 40.74 | 18.34 | 0.00 | 22.40 | -- | -- | -- | -- | -- | -- | -- | -- | -- | -- |
| MW-3 | 01/06/92 | 40.74 | 18.50 | 0.00 | 22.24 | 580 | -- | 6.1 | 1 | 6.1 | 7.1 | -- | -- | -- | ANA |
| MW-3 | 01/22/92 | 40.74 | 17.86 | 0.00 | 22.88 | -- | -- | -- | -- | -- | -- | -- | -- | -- | -- |
| MW-3 | 01/28/92 | 40.74 | 15.84 | 0.00 | 24.90 | -- | -- | -- | -- | -- | -- | -- | -- | -- | -- |
| MW-3 | 02/05/92 | 40.74 | 17.53 | 0.00 | 23.21 | -- | -- | -- | -- | -- | -- | -- | -- | -- | -- |
| MW-3 | 02/12/92 | 40.74 | 17.15 | 0.00 | 23.59 | -- | -- | -- | -- | -- | -- | -- | -- | -- | -- |
| MW-3 | 02/17/92 | 40.74 | 16.18 | 0.00 | 24.56 | -- | -- | -- | -- | -- | -- | -- | -- | -- | -- |
| MW-3 | 04/03/92 | 40.74 | 14.80 | 0.00 | 25.94 | -- | -- | -- | -- | -- | -- | -- | -- | -- | -- |
| MW-3 | 04/08/92 | 40.74 | 17.06 | 0.00 | 23.68 | 1100 | -- | 30 | 4.6 | 32 | 11 | -- | -- | -- | ANA |
| MW-3 | 04/14/92 | 40.74 | 15.22 | 0.00 | 25.52 | -- | -- | -- | -- | -- | -- | -- | -- | -- | -- |
| MW-3 | 04/29/92 | 40.74 | 15.90 | 0.00 | 24.84 | -- | -- | -- | -- | -- | -- | -- | -- | -- | -- |
| MW-3 | 05/07/92 | 40.74 | 16.35 | 0.00 | 24.39 | -- | -- | -- | -- | -- | -- | -- | -- | -- | -- |
| MW-3 | 07/03/92 | 40.74 | 17.74 | 0.00 | 23.00 | 1200 | -- | 38 | ND<2.5 | 24 | ND<2.5 | -- | -- | -- | ANA |
| MW-3 | 10/08/92 | 40.74 | 19.06 | 0.00 | 21.68 | 1400 | -- | 31 | ND<0.5 | 25 | 13 | -- | -- | -- | ANA |
| MW-3 | 12/31/92 | 40.74 | 16.61 | 0.00 | 24.13 | 820 | -- | 12 | 4.1 | 13 | 5.9 | -- | -- | -- | ANA |
| QC-1 (g) | 12/31/92 | 40.74 | -- | -- | -- | 960 | -- | 11 | 3.6 | 10 | 3.8 | -- | -- | -- | ANA |
| MW-3 | 04/21/93 | 40.74 | 14.24 | 0.00 | 26.50 | 420 | -- | 5.6 | ND<0.5 | 3.9 | 1.4 | -- | -- | -- | PACE |
| QC-1 (g) | 04/21/93 | 40.74 | -- | -- | -- | 390 | -- | 5.0 | ND<0.5 | 3.7 | 1.5 | -- | -- | -- | PACE |
| MW-3 | 07/07/93 | 40.13 (h) | 15.19 | 0.00 | 24.94 | 54 | -- | 0.6 | 0.6 | ND<0.5 | ND<0.5 | -- | -- | -- | PACE |
| MW-3 | 09/21/93 | 40.13 | 16.58 | 0.00 | 23.55 | 540 | -- | 7.9 | 0.9 | 4.7 | 2.4 | -- | -- | -- | PACE |
| MW-3 | 12/17/93 | 40.13 | 15.82 | -- | 24.31 | -- | -- | -- | -- | -- | -- | -- | -- | -- | -- |
| MW-3 | 12/23/93 | 40.13 | -- | -- | -- | 500 | -- | 9.8 | 1.5 | 3.3 | 2.1 | -- | -- | -- | PACE |
| QC-1 (g) | 12/23/93 | 40.13 | -- | -- | -- | 480 | -- | 9.2 | ND<0.5 | 5.4 | 5.3 | -- | -- | -- | PACE |
| MW-3 | 04/07/94 | 40.13 | 28.50 | -- | 11.63 | 460 | -- | 20 | 7.4 | 8.9 | 11 | -- | -- | -- | PACE |
| QC-1 (g) | 04/07/94 | 40.13 | -- | -- | -- | 460 | -- | 20 | 7.7 | 9.0 | 11 | -- | -- | -- | PACE |
| MW-3 | 07/06/94 | 40.13 | -- | -- | -- | 300 | -- | 10 | 0.6 | 1.7 | 6.4 | -- | -- | 4.8 | PACE |
| MW-3 | 10/07/94 | 40.13 | 27.65 | -- | 12.48 | 620 | -- | 28 | ND<0.5 | 2.2 | 12 | -- | -- | 4.4 | PACE |
| MW-3 | 01/27/95 | 40.13 | 27.65 | -- | 12.48 | -- | -- | -- | -- | -- | -- | -- | -- | -- | -- |
| MW-3 | 03/30/95 | 40.13 | 26.05 | -- | 14.08 | 300 | -- | 10 | 6.0 | 3.4 | 18 | -- | -- | 7.6 | ATI |
| MW-3 | 06/20/95 | 40.13 | 19.49 | -- | 20.64 | 170 | -- | 7.2 | 3.4 | 0.85 | 15 | -- | -- | -- | ATI |

TABLE 1 - SUMMARY OF RESULTS OF GROUNDWATER SAMPLING
 BP OIL COMPANY SERVICE STATION NO. 11109
 4280 FOOTHILL BOULEVARD, OAKLAND, CALIFORNIA

ALISTO PROJECT NO. 10-014

| WELL ID | DATE OF SAMPLING/ MONITORING | CASING ELEVATION (a) (Feet) | DEPTH TO WATER (Feet) | PRODUCT THICKNESS (Feet) | GROUNDWATER ELEVATION (b) (Feet) | TPH-G (ug/l) | TPH-D (ug/l) | B (ug/l) | T (ug/l) | E (ug/l) | X (ug/l) | TOG (ug/l) | HVOC (ug/l) | DO (ppm) | LAB |
|---------|------------------------------|-----------------------------|-----------------------|--------------------------|----------------------------------|--------------|--------------|----------|----------|----------|----------|------------|-------------|----------|------|
| MW-4 | 02/05/90 | 40.11 | 20.75 | --- | 19.36 | 620 | --- | ND<0.5 | 9 | ND<0.5 | 10 | --- | --- | --- | SUP |
| MW-4 | 02/14/91 | 40.11 | 21.73 | --- | 18.38 | 180 | --- | ND<0.3 | ND<0.3 | 0.4 | 2 | --- | --- | --- | SUP |
| MW-4 | 05/13/91 | 40.11 | 18.55 | --- | 21.56 | 72 | --- | 0.7 | ND<0.3 | ND<0.3 | ND<0.3 | --- | --- | --- | SUP |
| MW-4 | 07/24/91 | 40.11 | 21.31 | --- | 18.80 | --- | --- | --- | --- | --- | --- | --- | --- | --- | --- |
| MW-4 | 10/03/91 | 40.11 | 22.57 | --- | 17.54 | 57 | --- | ND<0.3 | ND<0.3 | ND<0.3 | ND<0.3 | --- | --- | --- | SUP |
| MW-4 | 10/15/91 | 40.11 | 22.88 | --- | 17.23 | --- | --- | --- | --- | --- | --- | --- | --- | --- | --- |
| MW-4 | 12/04/91 | 40.11 | 22.54 | --- | 17.57 | --- | --- | --- | --- | --- | --- | --- | --- | --- | --- |
| MW-4 | 12/16/91 | 40.11 | 22.59 | --- | 17.52 | --- | --- | --- | --- | --- | --- | --- | --- | --- | --- |
| MW-4 | 01/06/92 | 40.11 | 22.00 | --- | 18.11 | 480 | --- | 0.8 | 3.2 | 1.9 | 7.7 | --- | --- | --- | ANA |
| MW-4 | 01/22/92 | 40.11 | 21.58 | --- | 18.53 | --- | --- | --- | --- | --- | --- | --- | --- | --- | --- |
| MW-4 | 01/28/92 | 40.11 | 21.42 | --- | 18.69 | --- | --- | --- | --- | --- | --- | --- | --- | --- | --- |
| MW-4 | 02/05/92 | 40.11 | 21.10 | --- | 19.01 | --- | --- | --- | --- | --- | --- | --- | --- | --- | --- |
| MW-4 | 02/12/92 | 40.11 | 20.74 | --- | 19.37 | --- | --- | --- | --- | --- | --- | --- | --- | --- | --- |
| MW-4 | 02/17/92 | 40.11 | 19.78 | --- | 20.33 | --- | --- | --- | --- | --- | --- | --- | --- | --- | --- |
| MW-4 | 04/03/92 | 40.11 | 16.80 | --- | 23.31 | --- | --- | --- | --- | --- | --- | --- | --- | --- | --- |
| MW-4 | 04/08/92 | 40.11 | 17.13 | --- | 22.98 | ND<50 | --- | ND<0.5 | ND<0.5 | ND<0.5 | ND<0.5 | --- | --- | --- | ANA |
| MW-4 | 04/14/92 | 40.11 | 17.74 | --- | 22.37 | --- | --- | --- | --- | --- | --- | --- | --- | --- | --- |
| MW-4 | 04/29/92 | 40.11 | 18.56 | --- | 21.55 | --- | --- | --- | --- | --- | --- | --- | --- | --- | --- |
| MW-4 | 05/07/92 | 40.11 | 19.10 | --- | 21.01 | --- | --- | --- | --- | --- | --- | --- | --- | --- | --- |
| MW-4 | 07/03/92 | 40.11 | 20.71 | --- | 19.40 | ND<50 | --- | 0.6 | ND<0.5 | ND<0.5 | ND<0.5 | --- | --- | --- | ANA |
| MW-4 | 10/08/92 | 40.11 | 22.43 | --- | 17.68 | 270 | --- | ND<0.5 | 2.1 | 2.5 | 3.2 | --- | --- | --- | ANA |
| MW-4 | 12/31/92 | 40.11 | 19.58 | --- | 20.53 | 150 | --- | ND<0.5 | ND<0.5 | ND<0.5 | 1.3 | --- | --- | --- | ANA |
| MW-4 | 04/21/93 | 40.11 | 17.79 | --- | 22.32 | ND<50 | --- | ND<0.5 | ND<0.5 | ND<0.5 | ND<0.5 | --- | --- | --- | PACE |
| MW-4 | 07/07/93 | 40.11 | 18.44 | --- | 21.67 | 160 | --- | 1.2 | 5.4 | 3.8 | 19 | --- | --- | --- | PACE |
| MW-4 | 09/21/93 | 40.11 | 20.14 | --- | 19.97 | 71 | --- | ND<0.5 | 1.9 | ND<0.5 | 2.1 | --- | --- | --- | PACE |
| MW-4 | 12/17/93 | 40.11 | 19.80 | --- | 20.31 | --- | --- | --- | --- | --- | --- | --- | --- | --- | --- |
| MW-4 | 12/23/93 | 40.11 | --- | --- | --- | ND<50 | --- | 3.1 | 1.6 | 0.8 | 3.8 | --- | --- | --- | PACE |
| MW-4 | 04/07/94 | 40.11 | 19.12 | --- | 20.99 | ND<50 | --- | ND<0.5 | ND<0.5 | ND<0.5 | ND<0.5 | --- | --- | 6.6 | PACE |
| MW-4 | 07/06/94 | 40.11 | 19.90 | --- | 20.21 | 62 | --- | ND<0.5 | ND<0.5 | ND<0.5 | ND<0.5 | --- | --- | 4.1 | PACE |
| MW-4 | 10/07/94 | 40.11 | 20.07 | --- | 20.04 | ND<50 | --- | ND<0.5 | ND<0.5 | ND<0.5 | ND<0.5 | --- | --- | 3.6 | PACE |
| MW-4 | 01/27/95 | 40.11 | 13.72 | --- | 26.39 | ND<50 | --- | ND<0.5 | ND<0.5 | ND<0.5 | ND<1 | --- | --- | 2.7 | ATI |
| MW-4 | 03/30/95 | 40.11 | 11.46 | --- | 28.65 | ND<50 | --- | ND<0.50 | ND<0.50 | ND<0.50 | ND<1.0 | --- | --- | 8.3 | ATI |
| MW-4 | 06/20/95 | 40.11 | 14.78 | --- | 25.33 | ND<50 | --- | ND<0.50 | ND<0.50 | ND<0.50 | ND<1.0 | --- | --- | --- | ATI |

TABLE 1 - SUMMARY OF RESULTS OF GROUNDWATER SAMPLING
 BP OIL COMPANY SERVICE STATION NO. 11109
 4280 FOOTHILL BOULEVARD, OAKLAND, CALIFORNIA

ALISTO PROJECT NO. 10-014

| WELL ID | DATE OF SAMPLING/ MONITORING | CASING ELEVATION (a) (Feet) | DEPTH TO WATER (Feet) | PRODUCT THICKNESS (Feet) | GROUNDWATER ELEVATION (b) (Feet) | TPH-G (ug/l) | TPH-D (ug/l) | B (ug/l) | T (ug/l) | E (ug/l) | X (ug/l) | TOG (ug/l) | HVOC (ug/l) | DO (ppm) | LAB |
|---------|------------------------------|-----------------------------|-----------------------|--------------------------|----------------------------------|--------------|--------------|----------|----------|----------|----------|------------|-------------|----------|------|
| MW-5 | 10/03/91 | 39.55 | 18.08 | 0.00 | 21.47 | 79000 | --- | 13000 | 7400 | 1400 | 6200 | --- | --- | --- | SUP |
| MW-5 | 10/15/91 | 39.55 | 18.55 | 0.00 | 21.00 | --- | --- | --- | --- | --- | --- | --- | --- | --- | --- |
| MW-5 | 12/04/91 | 39.55 | 18.44 | 0.13 | 21.21 | --- | --- | --- | --- | --- | --- | --- | --- | --- | --- |
| MW-5 | 12/16/91 | 39.55 | 18.66 | 0.01 | 20.90 | --- | --- | --- | --- | --- | --- | --- | --- | --- | --- |
| MW-5 | 01/06/92 | 39.55 | 19.12 | 0.11 | 20.51 | --- | --- | --- | --- | --- | --- | --- | --- | --- | --- |
| MW-5 | 01/22/92 | 39.55 | 14.59 | 0.00 | 24.96 | --- | --- | --- | --- | --- | --- | --- | --- | --- | --- |
| MW-5 | 01/28/92 | 39.55 | 15.25 | 0.00 | 24.30 | --- | --- | --- | --- | --- | --- | --- | --- | --- | --- |
| MW-5 | 02/05/92 | 39.55 | 15.58 | SHEEN | 23.97 | --- | --- | --- | --- | --- | --- | --- | --- | --- | --- |
| MW-5 | 02/12/92 | 39.55 | 15.54 | 0.01 | 24.02 | --- | --- | --- | --- | --- | --- | --- | --- | --- | --- |
| MW-5 | 02/17/92 | 39.55 | 13.98 | SHEEN | 25.57 | --- | --- | --- | --- | --- | --- | --- | --- | --- | --- |
| MW-5 | 04/03/92 | 39.55 | 13.63 | 0.04 | 25.95 | --- | --- | --- | --- | --- | --- | --- | --- | --- | --- |
| MW-5 | 04/08/92 | 39.55 | 13.17 | 0.01 | 26.39 | --- | --- | --- | --- | --- | --- | --- | --- | --- | --- |
| MW-5 | 04/14/92 | 39.55 | 13.45 | 0.01 | 26.11 | --- | --- | --- | --- | --- | --- | --- | --- | --- | --- |
| MW-5 | 04/29/92 | 39.55 | 13.75 | 0.07 | 25.85 | --- | --- | --- | --- | --- | --- | --- | --- | --- | --- |
| MW-5 | 05/07/92 | 39.55 | 16.15 | 0.04 | 23.43 | --- | --- | --- | --- | --- | --- | --- | --- | --- | --- |
| MW-5 | 07/03/92 | 39.55 | 17.67 | 0.08 | 21.94 | --- | --- | --- | --- | --- | --- | --- | --- | --- | --- |
| MW-5 | 09/01/92 | 39.55 | 17.83 | 0.50 | 22.10 | --- | --- | --- | --- | --- | --- | --- | --- | --- | --- |
| MW-5 | 10/08/92 | 39.55 | 17.86 | 0.92 | 22.38 | --- | --- | --- | --- | --- | --- | --- | --- | --- | --- |
| MW-5 | 12/31/92 | 39.55 | 15.20 | SHEEN | 24.35 | --- | --- | --- | --- | --- | --- | --- | --- | --- | --- |
| MW-5 | 04/21/93 | 39.55 | 12.64 | 0.02 | 26.93 | --- | --- | --- | --- | --- | --- | --- | --- | --- | --- |
| MW-5 | 07/07/93 | 39.14 | (h) 12.68 | 0.82 | 27.08 | --- | --- | --- | --- | --- | --- | --- | --- | --- | --- |
| MW-5 | 09/21/93 | 39.14 | 14.35 | SHEEN | 24.79 | --- | --- | --- | --- | --- | --- | --- | --- | --- | --- |
| MW-5 | 12/17/93 | 39.14 | 12.61 | 0.41 | 26.84 | --- | --- | --- | --- | --- | --- | --- | --- | --- | --- |
| MW-5 | 04/07/94 | 39.14 | 30.00 | --- | 9.14 | 66000 | --- | 3000 | 1700 | 250 | 6800 | --- | --- | --- | PACE |
| MW-5 | 07/06/94 | 39.14 | --- | --- | --- | 29000 | --- | 1900 | 330 | 63 | 2700 | --- | --- | --- | PACE |
| MW-5 | 10/07/94 | 39.14 | 28.70 | --- | 10.44 | 250000 | --- | 2600 | 660 | 830 | 5200 | --- | --- | 4.2 | PACE |
| QC-1 | (g) 10/07/94 | 39.14 | --- | --- | --- | 45000 | --- | 2900 | 540 | 260 | 2600 | --- | --- | --- | PACE |
| MW-5 | 01/27/95 | 39.14 | 28.70 | --- | 10.44 | --- | --- | --- | --- | --- | --- | --- | --- | --- | --- |
| MW-5 | 03/30/95 | 39.14 | 28.95 | --- | 10.19 | 50000 | --- | 7900 | 2600 | 520 | 6400 | --- | --- | 5.5 | ATI |
| QC-1 | (g) 03/30/95 | 39.14 | --- | --- | --- | 43000 | --- | 7900 | 2500 | 440 | 6200 | --- | --- | --- | ATI |
| MW-5 | 06/20/95 | 39.14 | 22.54 | --- | 16.60 | 34000 | --- | 5100 | 1900 | 300 | 3700 | --- | --- | --- | ATI |
| QC-1 | (g) 06/20/95 | 39.14 | --- | --- | --- | 26000 | --- | 3500 | 290 | ND<25 | 3300 | --- | --- | --- | ATI |

TABLE 1 - SUMMARY OF RESULTS OF GROUNDWATER SAMPLING
 BP OIL COMPANY SERVICE STATION NO. 11109
 4280 FOOTHILL BOULEVARD, OAKLAND, CALIFORNIA

ALISTO PROJECT NO. 10-014

| WELL ID | DATE OF SAMPLING/ MONITORING | CASING ELEVATION (a) (Feet) | DEPTH TO WATER (Feet) | PRODUCT THICKNESS (Feet) | GROUNDWATER ELEVATION (b) (Feet) | TPH-G (ug/l) | TPH-D (ug/l) | B (ug/l) | T (ug/l) | E (ug/l) | X (ug/l) | TOG (ug/l) | HVOC (ug/l) | DO (ppm) | LAB |
|----------|------------------------------|-----------------------------|-----------------------|--------------------------|----------------------------------|--------------|--------------|----------|----------|----------|----------|------------|-------------|----------|------|
| MW-6 | 10/03/91 | 41.59 | 20.73 | 0.00 | 20.86 | ND<50 | --- | 0.7 | 0.8 | ND<0.3 | 1.3 | --- | --- | --- | SUP |
| MW-6 | 10/15/91 | 41.59 | 21.20 | 0.00 | 20.39 | --- | --- | --- | --- | --- | --- | --- | --- | --- | --- |
| MW-6 | 12/04/91 | 41.59 | 21.26 | 0.00 | 20.33 | --- | --- | --- | --- | --- | --- | --- | --- | --- | --- |
| MW-6 | 12/16/91 | 41.59 | 21.12 | 0.00 | 20.47 | --- | --- | --- | --- | --- | --- | --- | --- | --- | --- |
| MW-6 | 01/06/92 | 41.59 | 20.29 | 0.00 | 21.30 | ND<50 | --- | ND<0.5 | ND<0.5 | ND<0.5 | 1.6 | --- | --- | --- | ANA |
| MW-6 | 01/22/92 | 41.59 | 20.12 | 0.00 | 21.47 | --- | --- | --- | --- | --- | --- | --- | --- | --- | --- |
| MW-6 | 01/28/92 | 41.59 | 20.20 | 0.00 | 21.39 | --- | --- | --- | --- | --- | --- | --- | --- | --- | --- |
| MW-6 | 02/05/92 | 41.59 | 20.09 | 0.00 | 21.50 | --- | --- | --- | --- | --- | --- | --- | --- | --- | --- |
| MW-6 | 02/12/92 | 41.59 | 19.15 | 0.00 | 22.44 | --- | --- | --- | --- | --- | --- | --- | --- | --- | --- |
| MW-6 | 02/17/92 | 41.59 | 18.02 | 0.00 | 23.57 | --- | --- | --- | --- | --- | --- | --- | --- | --- | --- |
| MW-6 | 04/03/92 | 41.59 | 16.62 | 0.00 | 24.97 | --- | --- | --- | --- | --- | --- | --- | --- | --- | --- |
| MW-6 | 04/08/92 | 41.59 | 17.06 | 0.00 | 24.53 | ND<50 | --- | 0.6 | ND<0.5 | 0.8 | ND<0.5 | --- | --- | --- | ANA |
| MW-6 | 04/14/92 | 41.59 | 17.23 | 0.00 | 24.36 | --- | --- | --- | --- | --- | --- | --- | --- | --- | --- |
| MW-6 | 04/29/92 | 41.59 | 18.12 | 0.00 | 23.47 | --- | --- | --- | --- | --- | --- | --- | --- | --- | --- |
| MW-6 | 05/07/92 | 41.59 | 18.52 | 0.00 | 23.07 | --- | --- | --- | --- | --- | --- | --- | --- | --- | --- |
| MW-6 | 07/03/92 | 41.59 | 19.71 | 0.00 | 21.88 | ND<50 | --- | ND<0.5 | ND<0.5 | ND<0.5 | ND<0.5 | --- | --- | --- | ANA |
| MW-6 | 10/08/92 | 41.59 | 21.22 | 0.00 | 20.37 | ND<50 | --- | ND<0.5 | ND<0.5 | ND<0.5 | ND<0.5 | --- | --- | --- | ANA |
| QC-1 (g) | 10/08/92 | 41.59 | 21.22 | 0.00 | 20.37 | ND<50 | --- | ND<0.5 | ND<0.5 | ND<0.5 | ND<0.5 | --- | --- | --- | ANA |
| MW-6 | 12/31/92 | 41.59 | 21.33 | 0.00 | 20.26 | ND<50 | --- | ND<0.5 | ND<0.5 | ND<0.5 | ND<0.5 | --- | --- | --- | ANA |
| MW-6 | 04/21/93 | 41.59 | 16.45 | 0.00 | 25.14 | ND<50 | --- | ND<0.5 | ND<0.5 | ND<0.5 | ND<0.5 | --- | --- | --- | PACE |
| MW-6 | 07/07/93 | 41.59 | 18.68 | 0.00 | 22.91 | ND<50 | --- | ND<0.5 | ND<0.5 | ND<0.5 | ND<0.5 | --- | --- | --- | PACE |
| MW-6 | 09/21/93 | 41.59 | 19.64 | 0.00 | 21.95 | ND<50 | --- | ND<0.5 | ND<0.5 | ND<0.5 | 1.6 | --- | --- | --- | PACE |
| MW-6 | 12/17/93 | 41.59 | 21.08 | --- | 20.51 | --- | --- | --- | --- | --- | --- | --- | --- | --- | --- |
| MW-6 | 12/23/93 | 41.59 | --- | --- | --- | ND<50 | --- | ND<0.5 | 0.5 | ND<0.5 | 0.6 | --- | --- | --- | PACE |
| MW-6 | 04/07/94 | 41.59 | 21.27 | --- | 20.32 | ND<50 | --- | ND<0.5 | ND<0.5 | ND<0.5 | ND<0.5 | --- | --- | 6.1 | PACE |
| MW-6 | 07/06/94 | 41.59 | 19.81 | --- | 21.78 | ND<50 | --- | ND<0.5 | ND<0.5 | ND<0.5 | ND<0.5 | --- | --- | 4.0 | PACE |
| QC-1 (g) | 07/06/94 | 41.59 | --- | --- | --- | ND<50 | --- | ND<0.5 | ND<0.5 | ND<0.5 | ND<0.5 | --- | --- | --- | PACE |
| MW-6 | 10/07/94 | 41.59 | 21.25 | --- | 20.34 | ND<50 | --- | ND<0.5 | ND<0.5 | ND<0.5 | ND<0.5 | --- | --- | 3.5 | PACE |
| MW-6 | 01/27/95 | 41.59 | 12.39 | --- | 29.20 | ND<50 | --- | ND<0.5 | ND<0.5 | ND<0.5 | ND<1 | --- | --- | 4.2 | ATI |
| MW-6 | 03/30/95 | 41.59 | 11.34 | --- | 30.25 | ND<50 | --- | ND<0.50 | ND<0.50 | ND<0.50 | ND<1.0 | --- | --- | 6.1 | ATI |
| MW-6 | 06/20/95 | 41.59 | 15.12 | --- | 26.47 | ND<50 | --- | ND<0.50 | ND<0.50 | ND<0.50 | ND<1.0 | --- | --- | --- | ATI |

TABLE 1 - SUMMARY OF RESULTS OF GROUNDWATER SAMPLING
 BP OIL COMPANY SERVICE STATION NO. 11109
 4280 FOOTHILL BOULEVARD, OAKLAND, CALIFORNIA

ALISTO PROJECT NO. 10-014

| WELL ID | DATE OF SAMPLING/ MONITORING | CASING ELEVATION (a) (Feet) | DEPTH TO WATER (Feet) | PRODUCT THICKNESS (Feet) | GROUNDWATER ELEVATION (b) (Feet) | TPH-G (ug/l) | TPH-D (ug/l) | B (ug/l) | T (ug/l) | E (ug/l) | X (ug/l) | TOG (ug/l) | HVOC (ug/l) | DO (ppm) | LAB |
|----------|------------------------------|-----------------------------|-----------------------|--------------------------|----------------------------------|--------------|--------------|----------|----------|----------|----------|------------|-------------|----------|----------|
| MW-7 | 10/03/91 | 40.64 | 14.93 | 0.00 | 25.71 | 360 | --- | 62 | 13 | 3.4 | 20 | --- | --- | --- | SUP |
| MW-7 | 10/15/91 | 40.64 | 15.16 | 0.00 | 25.48 | --- | --- | --- | --- | --- | --- | --- | --- | --- | --- |
| MW-7 | 12/04/91 | 40.64 | 15.41 | 0.00 | 25.23 | --- | --- | --- | --- | --- | --- | --- | --- | --- | --- |
| MW-7 | 12/16/91 | 40.64 | 15.21 | 0.00 | 25.43 | --- | --- | --- | --- | --- | --- | --- | --- | --- | --- |
| MW-7 | 01/06/92 | 40.64 | 14.56 | 0.00 | 26.08 | 1100 | --- | 170 | ND<0.5 | 24 | 23 | --- | --- | --- | ANA |
| MW-7 | 01/22/92 | 40.64 | 14.63 | 0.00 | 26.01 | --- | --- | --- | --- | --- | --- | --- | --- | --- | --- |
| MW-7 | 01/28/92 | 40.64 | 14.73 | 0.00 | 25.91 | --- | --- | --- | --- | --- | --- | --- | --- | --- | --- |
| MW-7 | 02/05/92 | 40.64 | 14.58 | 0.00 | 26.06 | --- | --- | --- | --- | --- | --- | --- | --- | --- | --- |
| MW-7 | 02/12/92 | 40.64 | 13.94 | 0.00 | 26.70 | --- | --- | --- | --- | --- | --- | --- | --- | --- | --- |
| MW-7 | 02/17/92 | 40.64 | 13.10 | 0.00 | 27.54 | --- | --- | --- | --- | --- | --- | --- | --- | --- | --- |
| MW-7 | 04/03/92 | 40.64 | 12.66 | 0.00 | 27.98 | --- | --- | --- | --- | --- | --- | --- | --- | --- | --- |
| MW-7 | 04/08/92 | 40.64 | 12.77 | 0.00 | 27.87 | 750 | --- | 150 | ND<0.5 | 23 | 9.9 | --- | --- | --- | ANA |
| MW-7 | 04/14/92 | 40.64 | 13.02 | 0.00 | 27.62 | --- | --- | --- | --- | --- | --- | --- | --- | --- | --- |
| MW-7 | 04/29/92 | 40.64 | 13.59 | 0.00 | 27.05 | --- | --- | --- | --- | --- | --- | --- | --- | --- | --- |
| MW-7 | 05/07/92 | 40.64 | 13.95 | 0.00 | 26.69 | --- | --- | --- | --- | --- | --- | --- | --- | --- | --- |
| MW-7 | 07/03/92 | 40.64 | 14.73 | 0.00 | 25.91 | 660 | --- | 210 | ND<2.5 | 33 | 8 | --- | --- | --- | ANA |
| MW-7 | 10/08/92 | 40.64 | 15.75 | 0.00 | 24.89 | 320 | --- | 49 | 1.4 | 13 | 6.2 | --- | --- | --- | ANA |
| MW-7 | 12/31/92 | 40.64 | 13.57 | 0.00 | 27.07 | 900 | --- | 100 | ND<2.5 | 28 | 4.3 | --- | --- | --- | ANA |
| MW-7 | 04/21/93 | 40.64 | 14.56 | 0.00 | 26.08 | 510 | --- | 83 | 1.2 | 10 | 5.8 | --- | --- | --- | PACE |
| MW-7 | 07/07/93 | 40.32 (h) | 13.40 | 0.00 | 26.92 | 1100 | --- | 160 | 2.0 | 27 | 4.0 | --- | --- | --- | PACE |
| QC-1 (g) | 07/07/93 | 40.32 | --- | --- | --- | 1100 | --- | 170 | 1.9 | 29 | 2.8 | --- | --- | --- | PACE |
| MW-7 | 09/21/93 | 40.32 | 14.40 | 0.00 | 25.92 | 690 | --- | 150 | 3.1 | 26 | 5.7 | --- | --- | --- | PACE |
| QC-1 (g) | 09/21/93 | 40.32 | --- | --- | --- | 640 | --- | 140 | 1.7 | 23 | 2.4 | --- | --- | --- | PACE |
| MW-7 | 12/17/93 | 40.32 | 13.65 | --- | 26.67 | --- | --- | --- | --- | --- | --- | --- | --- | --- | --- |
| MW-7 | 12/23/93 | 40.32 | --- | --- | --- | 250 | --- | 64 | 1.2 | 9.0 | 1.8 | --- | --- | --- | PACE |
| MW-7 | 04/07/94 | 40.32 | 30.62 | --- | 9.70 | 140 | --- | 32 | 1.4 | ND<0.5 | ND<0.5 | --- | --- | --- | PACE |
| MW-7 | 07/06/94 | 40.32 | 16.88 | --- | 23.44 | 410 | --- | 94 | 1.3 | 10 | 3.5 | --- | --- | --- | 4.4 PACE |
| MW-7 | 10/07/94 | 40.32 | 25.59 | --- | 14.73 | ND<50 | --- | 9.2 | ND<0.5 | ND<0.5 | ND<0.5 | --- | --- | --- | 4.9 PACE |
| MW-7 | 01/27/95 | 40.32 | 9.82 | --- | 30.50 | 810 | --- | 570 | 3 | 60 | 17 | --- | --- | --- | 0 ATI |
| QC-1 (g) | 01/27/95 | --- | --- | --- | --- | 930 | --- | 620 | 4 | 77 | 21 | --- | --- | --- | ATI |
| MW-7 | 03/30/95 | 40.32 | 9.15 | --- | 31.17 | 180 | --- | 65 | 0.53 | 2.0 | ND<1.0 | --- | --- | --- | 7.8 ATI |
| MW-7 | 06/20/95 | 40.32 | 11.38 | --- | 28.94 | 2800 | --- | 980 | ND<5.0 | ND<5.0 | 43 | --- | --- | --- | ATI |

TABLE 1 - SUMMARY OF RESULTS OF GROUNDWATER SAMPLING
 BP OIL COMPANY SERVICE STATION NO. 11109
 4280 FOOTHILL BOULEVARD, OAKLAND, CALIFORNIA

ALISTO PROJECT NO. 10-014

| WELL ID | DATE OF SAMPLING/ MONITORING | CASING ELEVATION (a) (Feet) | DEPTH TO WATER (Feet) | PRODUCT THICKNESS (Feet) | GROUNDWATER ELEVATION (b) (Feet) | TPH-G (ug/l) | TPH-D (ug/l) | B (ug/l) | T (ug/l) | E (ug/l) | X (ug/l) | TOG (ug/l) | HVOC (ug/l) | DO (ppm) | LAB |
|---------|---------------------------------|--------------------------------|--------------------------|-----------------------------|-------------------------------------|-----------------|-----------------|-------------|-------------|-------------|-------------|---------------|----------------|-------------|------|
| MW-8 | 10/03/91 | 38.18 | 22.37 | 0.00 | 15.81 | ND<50 | -- | ND<0.3 | 0.6 | ND<0.3 | 0.9 | -- | -- | -- | SUP |
| MW-8 | 10/15/91 | 38.18 | 22.70 | 0.00 | 15.48 | -- | -- | -- | -- | -- | -- | -- | -- | -- | -- |
| MW-8 | 12/04/91 | 38.18 | 22.44 | 0.00 | 15.74 | -- | -- | -- | -- | -- | -- | -- | -- | -- | -- |
| MW-8 | 12/16/91 | 38.18 | 22.47 | 0.00 | 15.71 | -- | -- | -- | -- | -- | -- | -- | -- | -- | -- |
| MW-8 | 01/06/92 | 38.18 | 21.94 | 0.00 | 16.24 | ND<50 | -- | ND<0.5 | ND<0.5 | ND<0.5 | ND<0.5 | -- | -- | -- | ANA |
| MW-8 | 01/22/92 | 38.18 | 21.44 | 0.00 | 16.74 | -- | -- | -- | -- | -- | -- | -- | -- | -- | -- |
| MW-8 | 01/28/92 | 38.18 | 21.20 | 0.00 | 16.98 | -- | -- | -- | -- | -- | -- | -- | -- | -- | -- |
| MW-8 | 02/05/92 | 38.18 | 20.88 | 0.00 | 17.30 | -- | -- | -- | -- | -- | -- | -- | -- | -- | -- |
| MW-8 | 02/12/92 | 38.18 | 20.54 | 0.00 | 17.64 | -- | -- | -- | -- | -- | -- | -- | -- | -- | -- |
| MW-8 | 02/17/92 | 38.18 | 19.99 | 0.00 | 18.19 | -- | -- | -- | -- | -- | -- | -- | -- | -- | -- |
| MW-8 | 04/03/92 | 38.18 | 16.75 | 0.00 | 21.43 | -- | -- | -- | -- | -- | -- | -- | -- | -- | -- |
| MW-8 | 04/08/92 | 38.18 | 16.57 | 0.00 | 21.61 | ND<50 | -- | ND<0.5 | ND<0.5 | ND<0.5 | ND<0.5 | -- | -- | -- | ANA |
| MW-8 | 04/14/92 | 38.18 | INACCESSIBLE | -- | -- | -- | -- | -- | -- | -- | -- | -- | -- | -- | -- |
| MW-8 | 04/29/92 | 38.18 | 18.61 | 0.00 | 19.57 | -- | -- | -- | -- | -- | -- | -- | -- | -- | -- |
| MW-8 | 05/07/92 | 38.18 | 18.41 | 0.00 | 19.77 | -- | -- | -- | -- | -- | -- | -- | -- | -- | -- |
| MW-8 | 07/03/92 | 38.18 | 20.35 | 0.00 | 17.83 | ND<50 | -- | ND<0.5 | ND<0.5 | ND<0.5 | ND<0.5 | -- | -- | -- | ANA |
| MW-8 | (i) 10/08/92 | 38.18 | 21.74 | 0.00 | 16.44 | -- | -- | -- | -- | -- | -- | -- | -- | -- | -- |
| MW-8 | 12/31/92 | 38.18 | 19.09 | 0.00 | 19.09 | ND<50 | -- | ND<0.5 | ND<0.5 | ND<0.5 | ND<0.5 | -- | -- | -- | ANA |
| MW-8 | 04/21/93 | 38.18 | 18.92 | 0.00 | 19.26 | ND<50 | -- | ND<0.5 | ND<0.5 | ND<0.5 | ND<0.5 | -- | -- | -- | PACE |
| MW-8 | 07/07/93 | 38.18 | 17.76 | 0.00 | 20.42 | ND<50 | -- | ND<0.5 | ND<0.5 | ND<0.5 | ND<0.5 | -- | -- | -- | PACE |
| MW-8 | 09/21/93 | 38.18 | 19.71 | 0.00 | 18.47 | ND<50 | -- | 2.9 | 2.2 | 2.2 | 7.1 | -- | -- | -- | PACE |
| MW-8 | 12/17/93 | 38.18 | 21.33 | -- | 16.85 | -- | -- | -- | -- | -- | -- | -- | -- | -- | -- |
| MW-8 | 12/23/93 | 38.18 | -- | -- | -- | ND<50 | -- | ND<0.5 | ND<0.5 | ND<0.5 | 0.6 | -- | -- | -- | PACE |
| MW-8 | 04/07/94 | 38.18 | 21.51 | -- | 16.67 | ND<50 | -- | ND<0.5 | ND<0.5 | ND<0.5 | ND<0.5 | -- | -- | 6.6 | PACE |
| MW-8 | 07/06/94 | 38.18 | 17.41 | -- | 20.77 | ND<50 | -- | ND<0.5 | ND<0.5 | ND<0.5 | ND<0.5 | -- | -- | 4.4 | PACE |
| MW-8 | 10/07/94 | 38.18 | 19.20 | -- | 18.98 | ND<50 | -- | ND<0.5 | ND<0.5 | ND<0.5 | ND<0.5 | -- | -- | 3.7 | PACE |
| MW-8 | 01/27/95 | 38.18 | 12.25 | -- | 25.93 | ND<50 | -- | ND<0.5 | ND<0.5 | ND<0.5 | ND<1 | -- | -- | 2.9 | ATI |
| MW-8 | 03/30/95 | 38.18 | 10.35 | -- | 27.83 | ND<50 | -- | ND<0.50 | ND<0.50 | ND<0.50 | ND<1.0 | -- | -- | 8.3 | ATI |
| MW-8 | 06/20/95 | 38.18 | 13.37 | -- | 24.81 | ND<50 | -- | ND<0.50 | ND<0.50 | ND<0.50 | ND<1.0 | -- | -- | 6.9 | ATI |

TABLE 1 - SUMMARY OF RESULTS OF GROUNDWATER SAMPLING
 BP OIL COMPANY SERVICE STATION NO. 11109
 4280 FOOTHILL BOULEVARD, OAKLAND, CALIFORNIA

ALISTO PROJECT NO. 10-014

| WELL ID | DATE OF SAMPLING/ MONITORING | CASING ELEVATION (a) (Feet) | DEPTH TO WATER (Feet) | PRODUCT THICKNESS (Feet) | GROUNDWATER ELEVATION (b) (Feet) | TPH-G (ug/l) | TPH-D (ug/l) | B (ug/l) | T (ug/l) | E (ug/l) | X (ug/l) | TOG (ug/l) | HVOC (ug/l) | DO (ppm) | LAB |
|---------|------------------------------|-----------------------------|-----------------------|--------------------------|----------------------------------|--------------|--------------|----------|----------|----------|----------|------------|-------------|----------|------|
| MW-9 | 10/03/91 | 41.25 | 14.12 | --- | 27.13 | ND<50 | --- | ND<0.3 | 0.4 | ND<0.3 | ND<0.3 | --- | --- | --- | SUP |
| MW-9 | 10/15/91 | 41.25 | 14.27 | --- | 26.98 | --- | --- | --- | --- | --- | --- | --- | --- | --- | --- |
| MW-9 | 12/04/91 | 41.25 | 13.84 | --- | 27.41 | --- | --- | --- | --- | --- | --- | --- | --- | --- | --- |
| MW-9 | 12/16/91 | 41.25 | 14.18 | --- | 27.07 | --- | --- | --- | --- | --- | --- | --- | --- | --- | --- |
| MW-9 | 01/06/92 | 41.25 | 13.42 | --- | 27.83 | ND<50 | --- | ND<0.5 | ND<0.5 | ND<0.5 | 0.9 | --- | --- | --- | ANA |
| MW-9 | 01/22/92 | 41.25 | 13.75 | --- | 27.50 | --- | --- | --- | --- | --- | --- | --- | --- | --- | --- |
| MW-9 | 01/28/92 | 41.25 | 14.76 | --- | 26.49 | --- | --- | --- | --- | --- | --- | --- | --- | --- | --- |
| MW-9 | 02/05/92 | 41.25 | 13.38 | --- | 27.87 | --- | --- | --- | --- | --- | --- | --- | --- | --- | --- |
| MW-9 | 02/12/92 | 41.25 | 11.86 | --- | 29.39 | --- | --- | --- | --- | --- | --- | --- | --- | --- | --- |
| MW-9 | 02/17/92 | 41.25 | 10.78 | --- | 30.47 | --- | --- | --- | --- | --- | --- | --- | --- | --- | --- |
| MW-9 | 04/03/92 | 41.25 | 11.63 | --- | 29.62 | --- | --- | --- | --- | --- | --- | --- | --- | --- | --- |
| MW-9 | 04/08/92 | 41.25 | 12.25 | --- | 29.00 | ND<50 | --- | ND<0.5 | ND<0.5 | ND<0.5 | ND<0.5 | --- | --- | --- | ANA |
| MW-9 | 04/14/92 | 41.25 | 12.32 | --- | 28.93 | --- | --- | --- | --- | --- | --- | --- | --- | --- | --- |
| MW-9 | 04/29/92 | 41.25 | 13.07 | --- | 28.18 | --- | --- | --- | --- | --- | --- | --- | --- | --- | --- |
| MW-9 | 05/07/92 | 41.25 | 14.43 | --- | 26.82 | --- | --- | --- | --- | --- | --- | --- | --- | --- | --- |
| MW-9 | 07/03/92 | 41.25 | 13.85 | --- | 27.40 | ND<50 | --- | ND<0.5 | ND<0.5 | ND<0.5 | ND<0.5 | --- | --- | --- | ANA |
| MW-9 | 10/08/92 | 41.25 | 14.89 | --- | 26.36 | ND<50 | --- | ND<0.5 | ND<0.5 | ND<0.5 | ND<0.5 | --- | --- | --- | ANA |
| MW-9 | 12/31/92 | 41.25 | 11.90 | --- | 29.35 | ND<50 | --- | ND<0.5 | ND<0.5 | ND<0.5 | ND<0.5 | --- | --- | --- | ANA |
| MW-9 | 04/21/93 | 41.25 | 13.68 | --- | 27.57 | ND<50 | --- | ND<0.5 | ND<0.5 | ND<0.5 | ND<0.5 | --- | --- | --- | PACE |
| MW-9 | 07/07/93 | 41.25 | 13.12 | --- | 28.13 | ND<50 | --- | ND<0.5 | ND<0.5 | ND<0.5 | ND<0.5 | --- | --- | --- | PACE |
| MW-9 | 09/21/93 | 41.25 | 14.00 | --- | 27.25 | ND<50 | --- | ND<0.5 | ND<0.5 | ND<0.5 | 0.9 | --- | --- | --- | PACE |
| MW-9 | 12/17/93 | 41.25 | 12.98 | --- | 28.27 | --- | --- | --- | --- | --- | --- | --- | --- | --- | --- |
| MW-9 | 12/23/93 | 41.25 | --- | --- | --- | ND<50 | --- | ND<0.5 | ND<0.5 | ND<0.5 | 0.9 | --- | --- | --- | PACE |
| MW-9 | 04/07/94 | 41.25 | 13.24 | --- | 28.01 | ND<50 | --- | ND<0.5 | ND<0.5 | ND<0.5 | ND<0.5 | --- | --- | 4.7 | PACE |
| MW-9 | 07/06/94 | 41.25 | 13.77 | --- | 27.48 | ND<50 | --- | ND<0.5 | ND<0.5 | ND<0.5 | ND<0.5 | --- | --- | 3.9 | PACE |
| MW-9 | 10/07/94 | 41.25 | 14.60 | --- | 26.65 | ND<50 | --- | ND<0.5 | ND<0.5 | ND<0.5 | ND<0.5 | --- | --- | 3.0 | PACE |
| MW-9 | 01/27/95 | 41.25 | 8.47 | --- | 32.78 | ND<50 | --- | ND<0.5 | ND<0.5 | ND<0.5 | ND<1 | --- | --- | 2.5 | ATI |
| MW-9 | 03/30/95 | 41.25 | 8.19 | --- | 33.06 | ND<50 | --- | ND<0.50 | ND<0.50 | ND<0.50 | ND<1.0 | --- | --- | 8.4 | ATI |
| MW-9 | 06/20/95 | 41.25 | 11.25 | --- | 30.00 | ND<50 | --- | ND<0.50 | ND<0.50 | ND<0.50 | ND<1.0 | --- | --- | 8.1 | ATI |

TABLE 1 - SUMMARY OF RESULTS OF GROUNDWATER SAMPLING
 BP OIL COMPANY SERVICE STATION NO. 11109
 4280 FOOTHILL BOULEVARD, OAKLAND, CALIFORNIA

ALISTO PROJECT NO. 10-014

| WELL ID | DATE OF SAMPLING/ MONITORING | CASING ELEVATION (a) (Feet) | DEPTH TO WATER (Feet) | PRODUCT THICKNESS (Feet) | GROUNDWATER ELEVATION (b) (Feet) | TPH-G (ug/l) | TPH-D (ug/l) | B (ug/l) | T (ug/l) | E (ug/l) | X (ug/l) | TOG (ug/l) | HVOC (ug/l) | DO (ppm) | LAB |
|---------|------------------------------|-----------------------------|-----------------------|--------------------------|----------------------------------|--------------|--------------|----------|----------|----------|----------|------------|-------------|----------|------|
| QC-2 | (k) | 10/08/92 | --- | --- | --- | ND<50 | --- | ND<0.5 | ND<0.5 | ND<0.5 | ND<0.5 | --- | --- | --- | ANA |
| QC-2 | (k) | 12/31/92 | --- | --- | --- | ND<50 | --- | ND<0.5 | ND<0.5 | ND<0.5 | ND<0.5 | --- | --- | --- | ANA |
| QC-2 | (k) | 04/21/93 | --- | --- | --- | --- | --- | --- | --- | --- | --- | --- | ND | --- | PACE |
| QC-2 | (k) | 07/07/93 | --- | --- | --- | ND<50 | --- | ND<0.5 | ND<0.5 | ND<0.5 | 0.6 | --- | --- | --- | PACE |
| QC-2 | (k) | 09/21/93 | --- | --- | --- | ND<50 | --- | ND<0.5 | ND<0.5 | ND<0.5 | ND<0.5 | --- | --- | --- | PACE |
| QC-2 | (k) | 12/23/93 | --- | --- | --- | ND<50 | --- | ND<0.5 | ND<0.5 | ND<0.5 | ND<0.5 | --- | --- | --- | PACE |
| QC-2 | (k) | 04/07/94 | --- | --- | --- | ND<50 | --- | ND<0.5 | ND<0.5 | ND<0.5 | ND<0.5 | --- | --- | --- | PACE |
| QC-2 | (k) | 07/06/94 | --- | --- | --- | ND<50 | --- | ND<0.5 | ND<0.5 | ND<0.5 | ND<0.5 | --- | --- | --- | PACE |
| QC-2 | (k) | 10/07/94 | --- | --- | --- | ND<50 | --- | ND<0.5 | ND<0.5 | ND<0.5 | ND<0.5 | --- | --- | --- | PACE |
| QC-2 | (k) | 01/27/95 | --- | --- | --- | ND<50 | --- | ND<0.5 | 0.5 | ND<0.5 | ND<1 | --- | --- | --- | ATI |
| QC-2 | (k) | 03/30/95 | --- | --- | --- | ND<50 | --- | ND<0.50 | ND<0.50 | ND<0.50 | ND<1.0 | --- | --- | --- | ATI |
| QC-2 | (k) | 06/20/95 | --- | --- | --- | ND<50 | --- | ND<0.50 | ND<0.50 | ND<0.50 | ND<1.0 | --- | --- | --- | ATI |

ABBREVIATIONS:

| | |
|-------|---|
| TPH-G | Total petroleum hydrocarbons as gasoline |
| TPH-D | Total petroleum hydrocarbons as diesel |
| B | Benzene |
| T | Toluene |
| E | Ethylbenzene |
| X | Total xylenes |
| TOG | Total oil and grease |
| HVOC | Halogenated volatile organic compounds |
| DO | Dissolved oxygen |
| ug/l | Micrograms per liter |
| ppm | Parts per million |
| --- | Not analyzed/measured/applicable |
| ND | Not detected above reported detection limit |
| SUP | Superior Analytical Laboratory |
| ANA | Anametrix, Inc. |
| PACE | Pace, Inc. |
| ATI | Analytical Technologies, Inc. |

NOTES:

- (a) Top of casing elevations surveyed in feet above mean sea level, relative to the NGVD (1929).
- (b) Groundwater elevations adjusted assuming a specific gravity of 0.75 for free product.
- (c) Well destroyed during tank removal in November 1990.
- (d) Methylene chloride.
- (e) 1,2-Dichloroethane.
- (f) Sample collected from MW-2 for TPH-D analysis received in laboratory 7 days after collection; sample exceeded EPA recommended holding time for TPH-D on a water matrix.
- (g) Blind duplicate.
- (h) Top of casing lowered.
- (i) Depth to top of pump.
- (j) Not sampled due to abandoned vehicle parked over well.
- (k) Travel blank.

TABLE 2 - SUMMARY OF RESULTS OF GROUNDWATER MONITORING
 CHEVRON U.S.A. SERVICE STATION NO. 9-0076
 4625 FOOTHILL BOULEVARD, OAKLAND, CALIFORNIA

ALISTO PROJECT NO. 10-014

| WELL ID | DATE OF MONITORING | CASING ELEVATION (a) (Feet) | DEPTH TO WATER (Feet) | PRODUCT THICKNESS (Feet) | GROUNDWATER ELEVATION (b) (Feet) |
|---------|--------------------|--------------------------------|--------------------------|-----------------------------|-------------------------------------|
| C-1 | 07/14/92 | 38.41 | 27.61 | 0.00 | 10.80 |
| C-1 | 10/08/92 | 38.41 | 24.44 | 0.00 | 13.97 |
| C-1 | 09/21/93 | 38.41 | 21.42 | 0.00 | 16.99 |
| C-1 | 03/30/95 | 38.41 | 12.02 | 0.00 | 26.39 |
| C-1 | 06/20/95 | 38.41 | 14.40 | 0.00 | 24.01 |
| C-2 | 07/14/92 | 37.47 | -- | -- | -- |
| C-2 | 10/08/92 | 37.47 | -- | -- | -- |
| C-2 | 09/21/93 | 37.47 | 26.29 | 0.00 | 11.18 |
| C-2 | 03/30/95 | 37.47 | 17.18 | 0.00 | 20.29 |
| C-2 | 06/20/95 | 37.47 | 18.95 | 0.00 | 18.52 |
| C-3 | 07/14/92 | 38.37 | 27.87 | 0.00 | 10.50 |
| C-3 | 10/08/92 | 38.37 | 28.55 | 0.00 | 9.82 |
| C-3 | 09/21/93 | 38.37 | 26.22 | 0.00 | 12.15 |
| C-3 | 03/30/95 | 38.37 | 18.42 | 0.00 | 19.95 |
| C-3 | 06/20/95 | 38.37 | 19.79 | 0.00 | 18.58 |
| C-4 | 07/14/92 | 36.49 | 26.89 | 0.00 | 9.60 |
| C-4 | 10/08/92 | 36.49 | 27.79 | 0.00 | 8.70 |
| C-4 | 09/21/93 | 36.49 | 25.51 | 0.00 | 10.98 |
| C-4 | 03/30/95 | 36.49 | 14.86 | 0.00 | 21.63 |
| C-4 | 06/20/95 | 36.49 | 16.90 | 0.00 | 19.59 |
| C-5 | 07/14/92 | 38.50 | 28 | 0.00 | 10.50 |
| C-5 | 10/08/92 | 38.50 | 28.65 | 0.00 | 9.85 |
| C-5 | 09/21/93 | 38.50 | 26.36 | 0.00 | 12.14 |
| C-5 | 03/30/95 | 38.50 | 18.54 | 0.00 | 19.96 |
| C-5 | 06/20/95 | 38.50 | 20.13 | 0.00 | 18.37 |
| C-6 | 07/14/92 | 35.40 | 38.89 | 0.00 | -3.49 |
| C-6 | 10/08/92 | 35.40 | 38.67 | 0.00 | -3.27 |
| C-6 | 09/21/93 | 35.40 | 33.98 | 0.00 | 1.42 |
| C-6 | 03/30/95 | 35.40 | 26.38 | 0.00 | 9.02 |
| C-6 | 06/20/95 | 35.40 | 25.01 | 0.00 | 10.39 |
| C-7 | 07/14/92 | 35.19 | 39.77 | 0.00 | -4.58 |
| C-7 | 10/08/92 | 35.19 | 39.14 | 0.00 | -3.95 |
| C-7 | 09/21/93 | 35.19 | 35.46 | 0.00 | -0.27 |
| C-7 | 03/30/95 | 35.19 | 27.60 | 0.00 | 7.59 |
| C-7 | 06/20/95 | 35.19 | 27.87 | 0.00 | 7.32 |
| C-8 | 07/14/92 | 34.68 | 39.02 | 0.00 | -4.34 |
| C-8 | 10/08/92 | 34.68 | 38.68 | 0.00 | -4.00 |
| C-8 | 09/21/93 | 34.68 | 35.30 | 0.00 | -0.62 |
| C-8 | 03/30/95 | 34.68 | 29.24 | 0.00 | 5.44 |
| C-8 | 06/20/95 | 34.68 | 28.34 | 0.00 | 6.34 |

NOTES:

- (a) Top of casing elevations surveyed relative to 1929 NGVD.
Measured in feet above mean sea level.
- (b) Groundwater elevations in feet above mean sea level.
- Not measured.

Source: Groundwater data collected by Groundwater Technology, Inc.

TABLE 3 - SUMMARY OF RESULTS OF GROUNDWATER MONITORING
SHELL SERVICE STATION
4411 FOOTHILL BOULEVARD, OAKLAND, CALIFORNIA

ALISTO PROJECT NO. 10-014

| WELL ID | DATE OF MONITORING | CASING ELEVATION (a) (Feet) | DEPTH TO WATER (Feet) | PRODUCT THICKNESS (Feet) | GROUNDWATER ELEVATION (b) (Feet) |
|---------|--------------------|--------------------------------|--------------------------|-----------------------------|-------------------------------------|
| S-1 | 03/30/95 | 38.31 | 6.09 | 0.00 | 32.22 |
| S-1 | 06/20/95 | 38.31 | 7.30 | 0.00 | 31.01 |
| S-2 | 03/30/95 | 38.79 | 7.86 | 0.00 | 30.93 |
| S-2 | 06/20/95 | 38.79 | 9.51 | 0.00 | 29.28 |
| S-3 | 03/30/95 | 37.33 | 7.06 | 0.00 | 30.27 |
| S-3 | 06/20/95 | 37.33 | 8.15 | 0.00 | 29.18 |

NOTES:

(a) Top of casing elevations surveyed relative to 1929 NGVD.
Measured in feet above mean sea level.

(b) Groundwater elevations in feet above mean sea level.

-- Not measured.

Source: Groundwater data collected by Groundwater Technology, Inc.

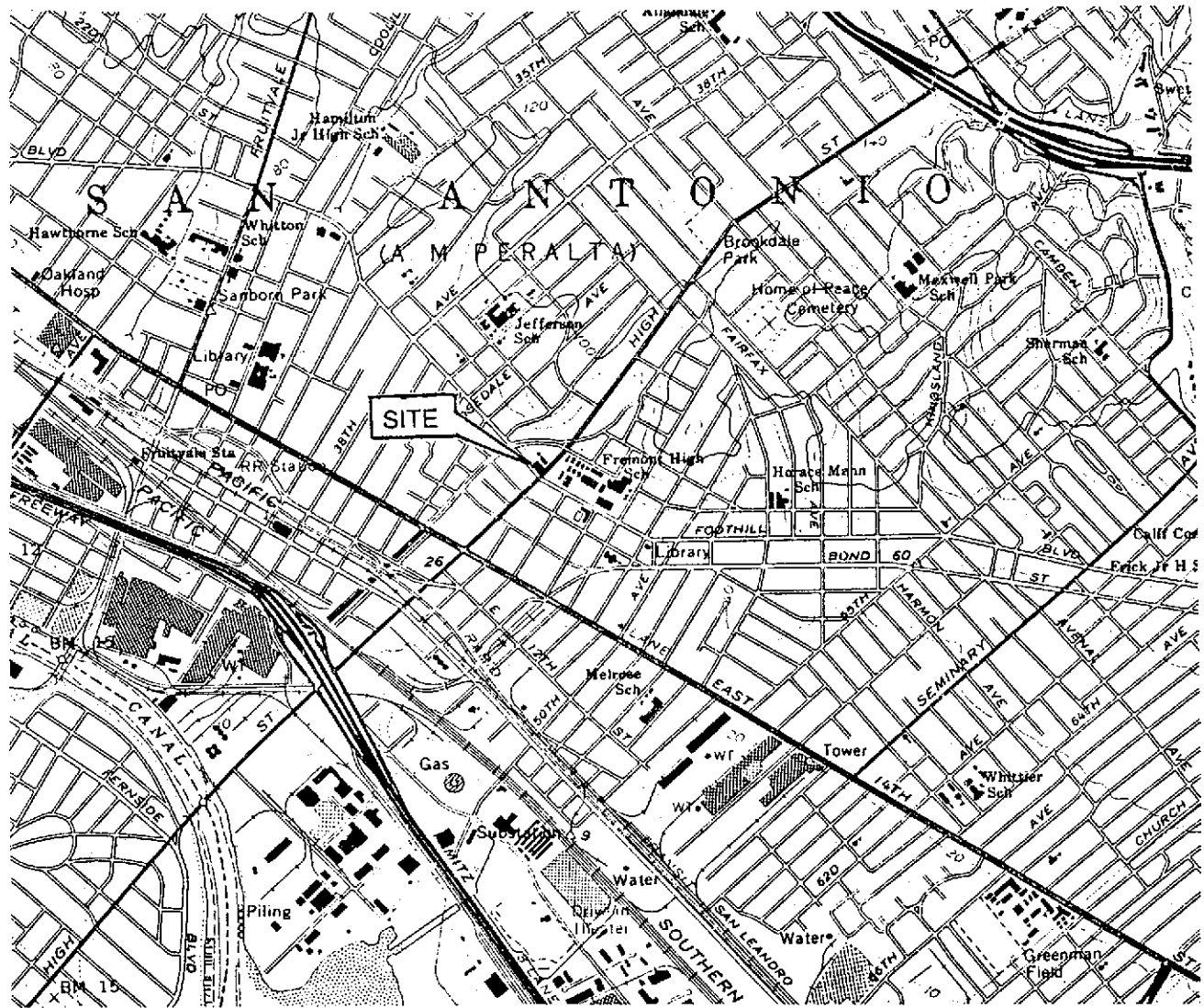

SOURCE:
 USGS MAP, OAKLAND EAST QUADRANGLE,
 CALIFORNIA, 7.5 MINUTE SERIES, 1959.
 PHOTOREVISED 1980.

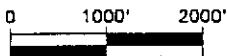
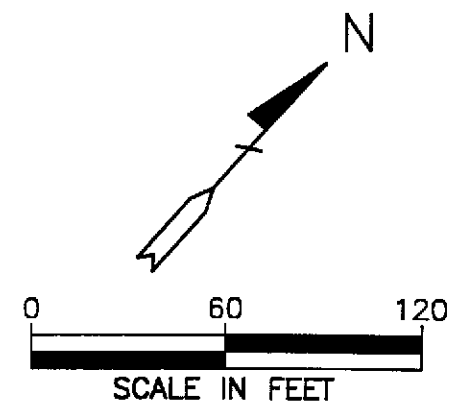
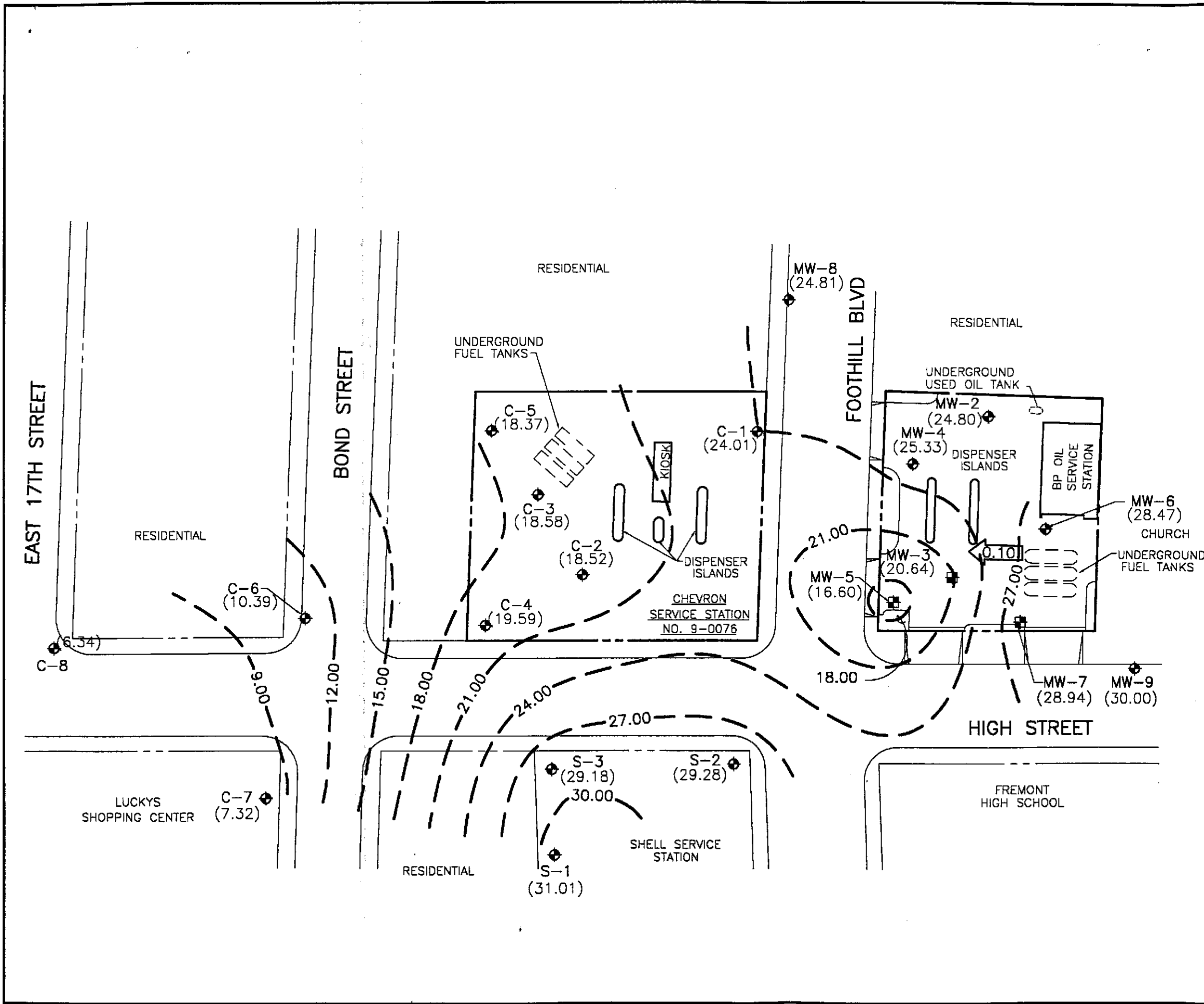

FIGURE 1
SITE VICINITY MAP

BP OIL SERVICE STATION NO. 11109
 4280 FOOTHILL BOULEVARD
 OAKLAND, CALIFORNIA
 PROJECT NO. 10-014



ALISTO ENGINEERING GROUP
 WALNUT CREEK, CALIFORNIA



- LEGEND**
- ◆ GROUNDWATER MONITORING WELL
 - ⊕ GROUNDWATER RECOVERY WELL
 - (28.47) GROUNDWATER ELEVATION IN FEET ABOVE MEAN SEA LEVEL
 - 27.00 - GROUNDWATER ELEVATION CONTOUR IN FEET ABOVE MEAN SEA LEVEL (CONTOUR INTERVAL-3.00 FEET)
 - ← 0.10 → CALCULATED GROUNDWATER GRADIENT DIRECTION AND MAGNITUDE IN FOOT PER FOOT

FIGURE 2
POTENTIOMETRIC GROUNDWATER ELEVATION CONTOUR MAP
JUNE 20, 1995
 BP OIL SERVICE STATION NO. 11109
 4280 FOOTHILL BOULEVARD
 OAKLAND, CALIFORNIA
 PROJECT NO. 10-014

10010-NLWC 8-10-95 REV 1-90

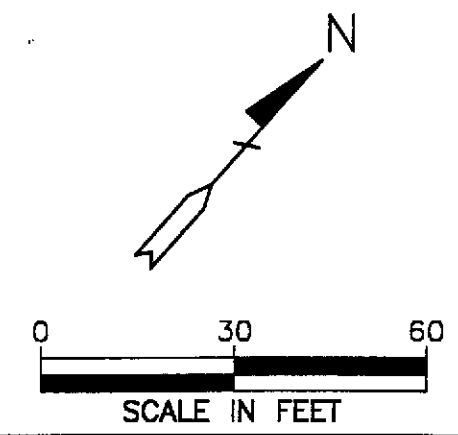
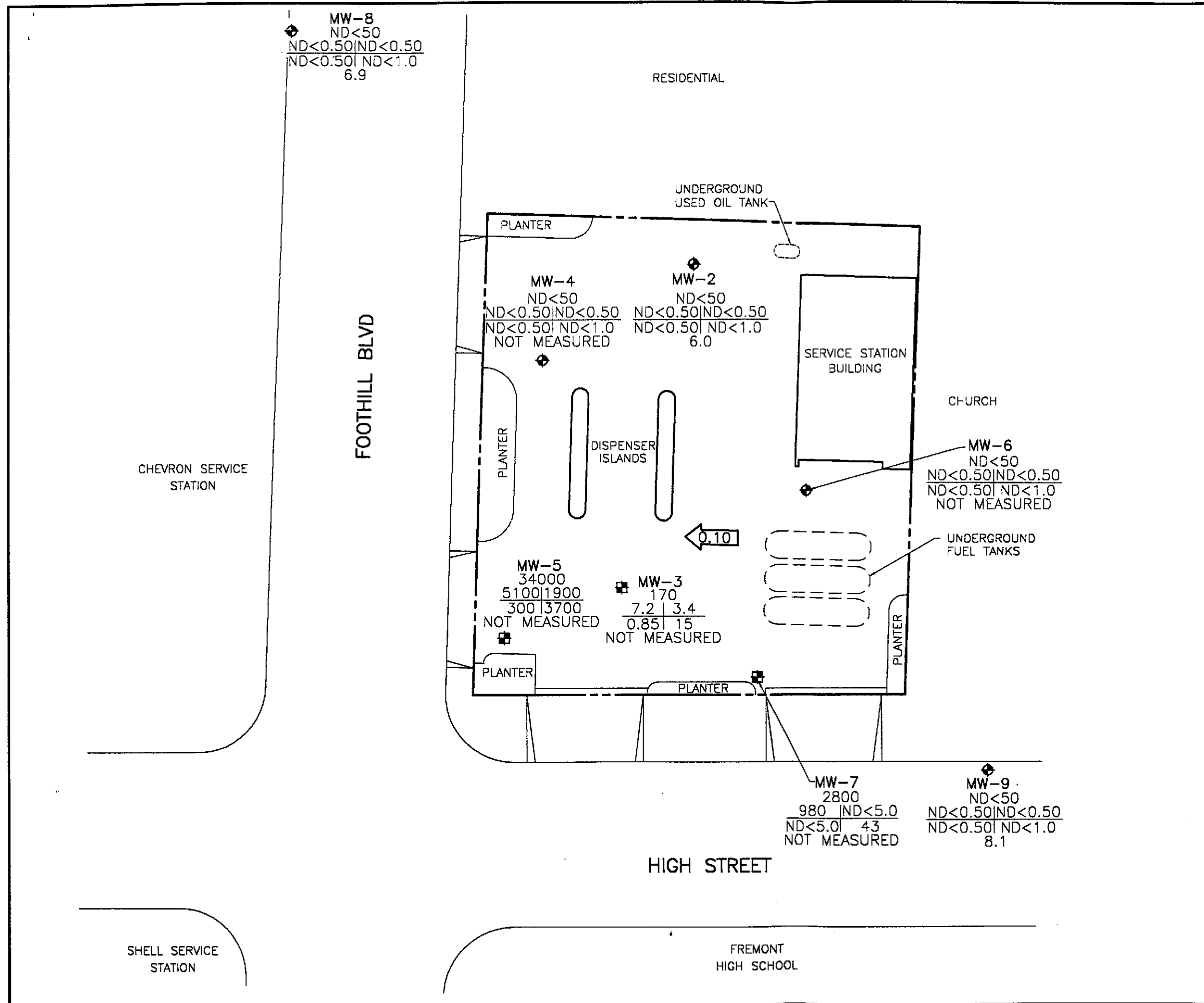

LEGEND

- ◆ GROUNDWATER MONITORING WELL
- ⊕ GROUNDWATER RECOVERY WELL
- TPH-G CONCENTRATION OF CONSTITUENTS IN MICROGRAMS PER LITER, EXCEPT DISSOLVED OXYGEN, WHICH IS IN PARTS PER MILLION
- B | T
- E | X
- DO
- TPH-G TOTAL PETROLEUM HYDROCARBONS AS GASOLINE
- B BENZENE
- T TOLUENE
- E ETHYLBENZENE
- X TOTAL XYLENES
- DO DISSOLVED OXYGEN
- ND NOT DETECTED ABOVE REPORTED DETECTION LIMIT
- ←0.10 CALCULATED GROUNDWATER GRADIENT DIRECTION AND MAGNITUDE IN FOOT PER FOOT

FIGURE 3
CONCENTRATIONS OF PETROLEUM HYDROCARBONS IN GROUNDWATER
JUNE 20, 1995
 BP OIL SERVICE STATION NO. 11109
 4280 FOOTHILL BOULEVARD
 OAKLAND, CALIFORNIA
 PROJECT NO. 10-014

APPENDIX A
WATER SAMPLING FIELD SURVEY FORMS

ALISTO

Field Report / Sampling Data Sheet

ENGINEERING
GROUP

1575 TREAT BOULEVARD, SUITE 201
WALNUT CREEK CA 94596 (510) 295-1650 FAX 295-1823

Project No.
Address
Contract No.
Station No.

10-014-04-001
4280 Foothill Blvd.
Pending
BP 11109

Date: 4/20/95
Day: M T W T F
City: Oakland
Sampler: DC

| WELL ID | SAMPLE ID | DEPTH TO WATER | TIME | COMMENTS: |
|---------|-----------|----------------|------|-----------|
| MW-2 | S-3 | 16.42 | 1050 | |
| MW-3 | S-7 | 19.49 | 1107 | |
| MW-4 | S-4 | 14.78 | 1053 | |
| MW-5 | S-8 | 22.54 | 1111 | |
| MW-6 | S-5 | 15.12 | 1057 | |
| MW-7 | S-6 | 11.38 | 1101 | |
| MW-8 | S-2 | 13.37 | 1047 | |
| MW-9 | S-1 | 11.25 | 1042 | |

FIELD INSTRUMENT CALIBRATION DATA

Ph METER Hydra 4.00 7.00 10.00 _____ TEMPERATURE COMPENSATED N TIME 1145

D.O. METER Icon ZERO d.O. SOLUTION BAROMETRIC PRESSURE 766 TEMP 76°F WEATHER Sunny hot

CONDUCTIVITY METER Hydra 10,000 TURBIDITY METER _____ 5.0 NTU _____ OTHER _____

| Well ID | Depth to Water | Diam | Cap/Lock | Product | Dept | Irridensence | Gal. | Time | Temp *F | pH | E.C. | D.O. | |
|---|----------------|------|----------|---------|------|--------------|------|------|---------|------|------|------|---|
| MW-9 | 11.25 | 2" | OK | Φ | Y | (N) | 3 | 1152 | 77.3 | 7.01 | 1.22 | 7.9 | <input type="radio"/> EPA 601 _____ |
| Total Depth - Water Level= | | | | | | | 6 | 1157 | 74.7 | 7.38 | 1.10 | | <input checked="" type="radio"/> TPH-G/BTEX <u>Hy</u> |
| x Well Vol. Factor= | | | | | | | 9.75 | 1202 | 74.0 | 7.42 | 1.08 | 8.1 | <input type="radio"/> TPH Diesel _____ |
| x#vol. to Purge PurgeVol. | | | | | | | | | | | | | <input type="radio"/> TOG 5520 _____ |
| Purge Method: <input checked="" type="checkbox"/> Surface Pump <input type="checkbox"/> Disp. Tube <input type="checkbox"/> Winch <input type="checkbox"/> Disp. Baller(s) <input type="checkbox"/> OSys Port | | | | | | | | | | | | | TIME/SAMPLE ID |
| Comments: | | | | | | | | | | | | | 1210 / 5-1 |
| MW-8 | 13.37 | 2" | OK | Φ | Y | (N) | 1.5 | 1225 | 74.2 | 7.60 | 1.04 | 6.8 | <input type="radio"/> EPA 601 _____ |
| Total Depth - Water Level= | | | | | | | 3 | 1230 | 70.6 | 7.57 | 0.77 | | <input checked="" type="radio"/> TPH-G/BTEX <u>Hy</u> |
| x Well Vol. Factor= | | | | | | | 4.0 | 1234 | 71.0 | 7.48 | 0.72 | 6.9 | <input type="radio"/> TPH Diesel _____ |
| x#vol. to Purge PurgeVol. | | | | | | | | | | | | | <input type="radio"/> TOG 5520 _____ |
| Purge Method: <input type="checkbox"/> Surface Pump <input type="checkbox"/> Disp. Tube <input checked="" type="checkbox"/> Winch <input type="checkbox"/> Disp. Baller(s) <input type="checkbox"/> OSys Port | | | | | | | | | | | | | TIME/SAMPLE ID |
| Comments: | | | | | | | | | | | | | 1242 / 5-2 |

ALISTO

Field Report / Sampling Data Sheet

ENGINEERING
GROUP

1575 TREAT BOULEVARD, SUITE 201
WALNUT CREEK CA 94596 (510) 295-1650 FAX 295-1823

Project No. 10-014-04-001

Address 4280 Foothill Blvd.
Contract No. Pending
Station No. BP 11109

Date: 6/20/95
Day: M T W T H F
City: Oakland
Sampler: DC

| Well ID | Depth to Water | Diam | Cap/Lock | Product Dept | Irridensece | Gal. | Time | Temp *F | pH | E.C. | D.O. |
|--|----------------|--------|----------|--------------|-------------|------|------|---------|------|------|------|
| MW-2 | 16.42 | 2 1/2" | OK | Φ | Y (N) | 2 | 1253 | 73.7 | 7.25 | 0.80 | 5.9 |
| Total Depth - Water Level = | | | | | | 4 | 1259 | 72.4 | 7.17 | 0.72 | |
| 30.10 - 16.42 = 13.68 x .16 = 2.19 x 3 = 6.57 | | | | | | 6.5 | 1304 | 71.7 | 7.04 | 0.71 | 6.0 |
| Purge Method: <input type="checkbox"/> Surface Pump <input type="checkbox"/> Disp. Tube <input type="checkbox"/> Winch <input checked="" type="checkbox"/> Disp. Baller(s) <input type="checkbox"/> Sys Port | | | | | | | | | | | |
| Comments: | | | | | | | | | | | |

| | |
|---|-------------|
| <input type="radio"/> EPA 601 | |
| <input checked="" type="radio"/> TPH-G/BTEX | Handwritten |
| <input type="radio"/> TPH Diesel | |
| <input type="radio"/> TOG 5520 | |
| TIME/SAMPLE ID | 1310 / 5-3 |

| Well ID | Depth to Water | Diam | Cap/Lock | Product Dept | Irridensece | Gal. | Time | Temp *F | pH | E.C. | D.O. |
|--|----------------|------|----------|--------------|-------------|------|------|---------|------|------|------|
| MW-4 | 14.78 | 4" | OK | Φ | Y (N) | 15 | 1325 | 78.4 | 7.96 | 0.93 | 8.0 |
| Total Depth - Water Level = | | | | | | 25 | 1332 | 75.6 | 7.79 | 0.76 | |
| 34.28 - 14.78 = 19.50 x .65 = 12.67 x 3 = 38.01 | | | | | | | | | | | |
| Purge Method: <input checked="" type="checkbox"/> Surface Pump <input type="checkbox"/> Disp. Tube <input type="checkbox"/> Winch <input type="checkbox"/> Disp. Baller(s) <input type="checkbox"/> Sys Port | | | | | | | | | | | |
| Comments: dry @ 27 galls | | | | | | | | | | | |

| | |
|---|-------------|
| <input type="radio"/> EPA 601 | |
| <input checked="" type="radio"/> TPH-G/BTEX | Handwritten |
| <input type="radio"/> TPH Diesel | |
| <input type="radio"/> TOG 5520 | |
| TIME/SAMPLE ID | 1350 / 5-4 |

| Well ID | Depth to Water | Diam | Cap/Lock | Product Dept | Irridensece | Gal. | Time | Temp *F | pH | E.C. | D.O. |
|--|----------------|------|----------|--------------|-------------|------|------|---------|------|------|------|
| MW-6 | 15.12 | 4" | OK | Φ | Y (N) | 15 | 1409 | 73.0 | 7.27 | 1.02 | 6.2 |
| Total Depth - Water Level = | | | | | | 25 | 1416 | 71.9 | 6.89 | 0.84 | |
| 34.28 - 15.12 = 19.16 x .65 = 12.45 x 3 = 37.35 | | | | | | | | | | | |
| Purge Method: <input type="checkbox"/> Surface Pump <input type="checkbox"/> Disp. Tube <input type="checkbox"/> Winch <input checked="" type="checkbox"/> Disp. Baller(s) <input type="checkbox"/> Sys Port | | | | | | | | | | | |
| Comments: dry @ 27 galls | | | | | | | | | | | |

| | |
|----------------------------------|------------|
| <input type="radio"/> EPA 601 | |
| <input type="radio"/> TPH-G/BTEX | |
| <input type="radio"/> TPH Diesel | |
| <input type="radio"/> TOG 5520 | |
| TIME/SAMPLE ID | 1430 / 5-5 |

| Well ID | Depth to Water | Diam | Cap/Lock | Product Dept | Irridensece | Gal. | Time | Temp *F | pH | E.C. | D.O. |
|--|----------------|------|----------|--------------|-------------|------|------|---------|----|------|------|
| MW-7 | 11.38 | 6" | OK | Φ | Y (N) | | | | | | |
| Total Depth - Water Level = | | | | | | | | | | | |
| 33.48 | | | | | | | | | | | |
| Purge Method: <input type="checkbox"/> Surface Pump <input type="checkbox"/> Disp. Tube <input type="checkbox"/> Winch <input type="checkbox"/> Disp. Baller(s) <input checked="" type="checkbox"/> Sys Port | | | | | | | | | | | |
| Comments: | | | | | | | | | | | |

| | |
|----------------------------------|------------|
| <input type="radio"/> EPA 601 | |
| <input type="radio"/> TPH-G/BTEX | |
| <input type="radio"/> TPH Diesel | |
| <input type="radio"/> TOG 5520 | |
| TIME/SAMPLE ID | 1447 / 5-6 |

| Well ID | Depth to Water | Diam | Cap/Lock | Product Dept | Irridensece | Gal. | Time | Temp *F | pH | E.C. | D.O. |
|--|----------------|------|----------|--------------|-------------|------|------|---------|----|------|------|
| MW-3 | 19.49 | 4" | OK | Φ | Y (N) | | | | | | |
| Total Depth - Water Level = | | | | | | | | | | | |
| 31.80 - 19.49 | | | | | | | | | | | |
| Purge Method: <input type="checkbox"/> Surface Pump <input type="checkbox"/> Disp. Tube <input type="checkbox"/> Winch <input type="checkbox"/> Disp. Baller(s) <input checked="" type="checkbox"/> Sys Port | | | | | | | | | | | |
| Comments: | | | | | | | | | | | |

| | |
|----------------------------------|------------|
| <input type="radio"/> EPA 601 | |
| <input type="radio"/> TPH-G/BTEX | |
| <input type="radio"/> TPH Diesel | |
| <input type="radio"/> TOG 5520 | |
| TIME/SAMPLE ID | 1452 / 5-7 |

ALISTO

Field Report / Sampling Data Sheet

ENGINEERING

GROUP

1575 TREAT BOULEVARD, SUITE 201

WALNUT CREEK CA 94596 (510) 295-1650 FAX 295-1823

Project No.

10-014-04-001

Address

4280 Foothill Blvd.

Contract No.

Pending

Station No.

BP 11109

Sampler:

Date:

6/20/95

Day:

MON TH F

City:

Oakland

| Well ID | Depth to Water | Diam | Cap/Lock | Product Dept | Irridensece | Gal. | Time | Temp °F | pH | E.C. | D.O. | |
|---|----------------|------|----------|--------------|-------------|---------------------|------|---------|----|------|------|----------------------------|
| MW-5 | 22.54 | 4" | OK | Φ | Y (N) | | | | | | | |
| Total Depth - Water Level= | | | | | | x Well Vol. Factor= | | | | | | x#vol. to Purge: PurgeVol. |
| Nm - 22.54 | | | | | | | | | | | | |
| Purge Method: OSurface Pump ODisp.Tube OWinch ODisp. Baller(s) <input checked="" type="checkbox"/> Sys Port | | | | | | | | | | | | |
| Comments: QC-1 from this well (59) | | | | | | | | | | | | |

- EPA 601 _____
- TPH-G/BTEX _____
- TPH Diesel _____
- TOG 5520 _____

TIME/SAMPLE ID

1957 / 5-8

* MW-6 => when I unscrewed well lid, cap & lock were sitting on top of the casing, looks like it was pried off - well cap & lock were still intact

** System is operating

APPENDIX B

LABORATORY REPORT AND CHAIN OF CUSTODY RECORD



Analytical **Technologies, Inc.**

Corporate Offices: 5550 Morehouse Drive San Diego, CA 92121 (619) 458-9141

ATI I.D.: 506270

July 21, 1995

ALISTO ENGINEERING
1575 TREAT BOULEVARD, SUITE 201
WALNUT CREEK, CA 94598

Project Name: BP SITE#11109/4280 FOOTHILL BLVD. OAKLAND, CA
Project # : G519095/10-014-~~04~~⁰⁵-001

Attention: BILL HOWELL *CWA*

Analytical Technologies, Inc. has received the following sample(s):

| <u>Date Received</u> | <u>Quantity</u> | <u>Matrix</u> |
|----------------------|-----------------|---------------|
| June 22, 1995 | 10 | WATER |

The sample(s) were analyzed with EPA methodology or equivalent methods as specified in the enclosed analytical schedule. The symbol for "less than" indicates a value below the reportable detection limit. If any flags appear next to the analytical data in this report, please see the attached list of flag definitions.

The results of these analyses and the quality control data are enclosed. Please note that the Sample Condition Upon Receipt Checklist is included at the end of this report.

GARY STEWART
VOLATILES SUPERVISOR

ALAN J. KLEINSCHMIDT
LABORATORY MANAGER

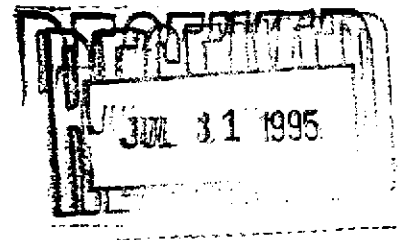



SAMPLE CROSS REFERENCE

Client : ALISTO ENGINEERING
Project # : G519095/10-014-04-001
Project Name: BP SITE#111109/4280 FOOTHILL BLVD. OAKLAND, CA

Report Date: July 21, 1995
ATI I.D. : 506270

Table with 4 columns: ATI #, Client Description, Matrix, Date Collected. Contains 10 rows of sample data.

---TOTALS---

Summary table with 2 columns: Matrix, # Samples. Shows WATER with 10 samples.

ATI STANDARD DISPOSAL PRACTICE

The sample(s) from this project will be disposed of in twenty-one (21) days from the date of this report. If an extended storage period is required, please contact our sample control department before the scheduled disposal date.



ANALYTICAL SCHEDULE

Client : ALISTO ENGINEERING
Project # : G519095/10-014-04-001
Project Name: BP SITE#11109/4280 FOOTHILL BLVD. OAKLAND, CA

ATI I.D.: 506270

| Analysis | Technique/Description |
|--|---|
| MOD EPA 8015-CDOHS/8020 (HYDROCARBONS C6-C12/BTXE) | GC/FLAME ION./PHOTO IONIZATION DETECTOR |



GAS CHROMATOGRAPHY RESULTS

Test : MOD EPA 8015-CDOHS/8020 (HYDROCARBONS C6-C12/BTXE)
 Client : ALISTO ENGINEERING ATI I.D. : 506270
 Project # : G519095/10-014-04-001
 Project Name: BP SITE#11109/4280 FOOTHILL BLVD. OAKLAND, CA

| Sample # | Client ID | Matrix | Date Sampled | Date Extracted | Date Analyzed | Dil. Factor |
|----------|-----------|--------|--------------|----------------|---------------|-------------|
| 1 | S-1 1210 | WATER | 20-JUN-95 | N/A | 02-JUL-95 | 1.00 |
| 2 | S-2 1242 | WATER | 20-JUN-95 | N/A | 02-JUL-95 | 1.00 |
| 3 | S-3 1310 | WATER | 20-JUN-95 | N/A | 02-JUL-95 | 1.00 |

| Parameter | Units | 1 | 2 | 3 |
|--------------------------------|-------|----------|----------|----------|
| BENZENE | UG/L | <0.50 | <0.50 | <0.50 |
| TOLUENE | UG/L | <0.50 | <0.50 | <0.50 |
| ETHYLBENZENE | UG/L | <0.50 | <0.50 | <0.50 |
| XYLENES (TOTAL) | UG/L | <1.0 | <1.0 | <1.0 |
| FUEL HYDROCARBONS | UG/L | <50 | <50 | <50 |
| HYDROCARBON RANGE | | C6-C12 | C6-C12 | C6-C12 |
| HYDROCARBONS QUANTITATED USING | | GASOLINE | GASOLINE | GASOLINE |
| <u>SURROGATES</u> | | | | |
| TRIFLUOROTOLUENE | % | 108 | 108 | 108 |



GAS CHROMATOGRAPHY RESULTS

Test : MOD EPA 8015-CDOHS/8020 (HYDROCARBONS C6-C12/BTXE)
 Client : ALISTO ENGINEERING ATI I.D. : 506270
 Project # : G519095/10-014-04-001
 Project Name: BP SITE#11109/4280 FOOTHILL BLVD. OAKLAND, CA

| Sample # | Client ID | Matrix | Date Sampled | Date Extracted | Date Analyzed | Dil. Factor |
|----------|-----------|--------|--------------|----------------|---------------|-------------|
| 4 | S-4 1350 | WATER | 20-JUN-95 | N/A | 02-JUL-95 | 1.00 |
| 5 | S-5 1430 | WATER | 20-JUN-95 | N/A | 02-JUL-95 | 1.00 |
| 6 | S-6 1447 | WATER | 20-JUN-95 | N/A | 02-JUL-95 | 10.00 |

| Parameter | Units | 4 | 5 | 6 |
|--------------------------------|-------|----------|----------|----------|
| BENZENE | UG/L | <0.50 | <0.50 | 980 |
| TOLUENE | UG/L | <0.50 | <0.50 | <5.0 |
| ETHYLBENZENE | UG/L | <0.50 | <0.50 | <5.0 |
| XYLENES (TOTAL) | UG/L | <1.0 | <1.0 | 43 |
| FUEL HYDROCARBONS | UG/L | <50 | <50 | 2800 |
| HYDROCARBON RANGE | | C6-C12 | C6-C12 | C6-C12 |
| HYDROCARBONS QUANTITATED USING | | GASOLINE | GASOLINE | GASOLINE |

SURROGATES

| | | | | |
|------------------|---|-----|-----|-----|
| TRIFLUOROTOLUENE | % | 107 | 101 | 107 |
|------------------|---|-----|-----|-----|



GAS CHROMATOGRAPHY RESULTS

Test : MOD EPA 8015-CDOHS/8020 (HYDROCARBONS C6-C12/BTXE)
 Client : ALISTO ENGINEERING ATI I.D. : 506270
 Project # : G519095/10-014-04-001
 Project Name: BP SITE#111109/4280 FOOTHILL BLVD. OAKLAND, CA

| Sample # | Client ID | Matrix | Date Sampled | Date Extracted | Date Analyzed | Dil. Factor |
|----------|-----------|--------|--------------|----------------|---------------|-------------|
| 7 | S-7 1452 | WATER | 20-JUN-95 | N/A | 02-JUL-95 | 1.00 |
| 8 | S-8 1457 | WATER | 20-JUN-95 | N/A | 02-JUL-95 | 50.00 |
| 9 | S-9 | WATER | 20-JUN-95 | N/A | 02-JUL-95 | 50.00 |

| Parameter | Units | 7 | 8 | 9 |
|--------------------------------|-------|----------|----------|----------|
| BENZENE | UG/L | 7.2 | 5100 | 3500 |
| TOLUENE | UG/L | 3.4 | 1900 | 290 |
| ETHYLBENZENE | UG/L | 0.85 | 300 | <25 |
| XYLENES (TOTAL) | UG/L | 15 | 3700 | 3300 |
| FUEL HYDROCARBONS | UG/L | 170 | 34000 | 26000 |
| HYDROCARBON RANGE | | C6-C12 | C6-C12 | C6-C12 |
| HYDROCARBONS QUANTITATED USING | | GASOLINE | GASOLINE | GASOLINE |
| <u>SURROGATES</u> | | | | |
| TRIFLUOROTOLUENE | % | 108 | 125 | 118 |



GAS CHROMATOGRAPHY RESULTS

Test : MOD EPA 8015-CDOHS/8020 (HYDROCARBONS C6-C12/BTXE)
Client : ALISTO ENGINEERING
Project # : G519095/10-014-04-001
Project Name: BP SITE#11109/4280 FOOTHILL BLVD. OAKLAND, CA

ATI I.D. : 506270

Table with 6 columns: Sample #, Client ID, Matrix, Date Sampled, Date Extracted, Date Analyzed, Dil. Factor. Row 1: 10, S-10, WATER, 20-JUN-95, N/A, 03-JUL-95, 1.00

Table with 3 columns: Parameter, Units, Value. Lists parameters like BENZENE, TOLUENE, ETHYLBENZENE, XYLENES (TOTAL), FUEL HYDROCARBONS, HYDROCARBON RANGE, HYDROCARBONS QUANTITATED USING, SURROGATES, TRIFLUOROTOLUENE with their respective units and values.

GAS CHROMATOGRAPHY - QUALITY CONTROL

REAGENT BLANK

Page 7

Test : MOD EPA 8015-CDOHS (FUEL HYDROCARBONS/BTXE)
Blank I.D. : 35918
Client : ALISTO ENGINEERING
Project # : G519095/10-014-04-001
Project Name: BP SITE#11109/4280 FOOTHILL BLVD. OAKLAND, CA

ATI I.D. : 506270
Date Extracted: N/A
Date Analyzed : 02-JUL-95
Dil. Factor : 1.00

| Parameters | Units | Results |
|--------------------------------|-------|----------|
| BENZENE | UG/L | <0.50 |
| TOLUENE | UG/L | <0.50 |
| ETHYLBENZENE | UG/L | <0.50 |
| XYLENES (TOTAL) | UG/L | <1.0 |
| FUEL HYDROCARBONS | UG/L | <50 |
| HYDROCARBON RANGE | | C6-C12 |
| HYDROCARBONS QUANTITATED USING | | GASOLINE |
| <u>SURROGATES</u> | | |
| TRIFLUOROTOLUENE | % | 97 |



GAS CHROMATOGRAPHY - QUALITY CONTROL

REAGENT BLANK

Test : MOD EPA 8015-CDOHS (FUEL HYDROCARBONS/BTXE)
Blank I.D. : 35923
Client : ALISTO ENGINEERING
Project # : G519095/10-014-04-001
Project Name: BP SITE#11109/4280 FOOTHILL BLVD. OAKLAND, CA

ATI I.D. : 506270
Date Extracted: N/A
Date Analyzed : 03-JUL-95
Dil. Factor : 1.00

| Parameters | Units | Results |
|--------------------------------|-------|----------|
| BENZENE | UG/L | <0.50 |
| TOLUENE | UG/L | <0.50 |
| ETHYLBENZENE | UG/L | <0.50 |
| XYLENES (TOTAL) | UG/L | <1.0 |
| FUEL HYDROCARBONS | UG/L | <50 |
| HYDROCARBON RANGE | | C6-C12 |
| HYDROCARBONS QUANTITATED USING | | GASOLINE |
| <u>SURROGATES</u> | | |
| TRIFLUOROTOLUENE | % | 100 |

GAS CHROMATOGRAPHY - QUALITY CONTROL

MSMSD

| | | | |
|---------------|---|-----------------|-------------|
| Test | : MOD EPA 8015-CDOHS (FUEL HYDROCARBONS/BTXE) | ATI I.D. | : 506270 |
| MSMSD # | : 76842 | Date Extracted: | N/A |
| Client | : ALISTO ENGINEERING | Date Analyzed: | 02-JUL-95 |
| | | Sample Matrix: | WATER |
| Project # | : G519095/10-014-04-001 | REF I.D. | : 506270-01 |
| Project Name: | BP SITE#11109/4280 FOOTHILL BLVD. OAKLAND, CA | | |

| Parameters | Units | Sample Result | Conc Spike | Spiked Sample | % Rec | Dup Spike | Dup % Rec | RPD |
|------------|-------|---------------|------------|---------------|-------|-----------|-----------|-----|
| BENZENE | UG/L | <0.50 | 5.0 | 4.4 | 88 | 4.6 | 92 | 4 |
| TOLUENE | UG/L | <0.50 | 5.0 | 4.7 | 94 | 4.9 | 98 | 4 |

% Recovery = (Spike Sample Result - Sample Result)*100/Spike Concentration
 RPD (Relative % Difference) = (Spiked Sample Result - Duplicate Spike Result)*100/Average Result



GAS CHROMATOGRAPHY - QUALITY CONTROL

BLANK SPIKE

Test : MOD EPA 8015-CDOHS (FUEL HYDROCARBONS/BTXE)
Blank Spike #: 57430
Client : ALISTO ENGINEERING
Project #: G519095/10-014-04-001
Project Name : BP SITE#11109/4280 FOOTHILL BLVD. OAKLAND, CA

ATI I.D. : 506270
Date Extracted: N/A
Date Analyzed : 02-JUL-95
Sample Matrix : WATER

| Parameters | Units | Blank Result | Spiked Sample | Spike Conc. | % Rec |
|------------|-------|--------------|---------------|-------------|-------|
| BENZENE | UG/L | <0.50 | 4.4 | 5.0 | 88 |
| TOLUENE | UG/L | <0.50 | 4.8 | 5.0 | 96 |

% Recovery = (Spike Sample Result - Sample Result)*100/Spike Concentration
RPD (Relative % Difference) = (Spiked Sample - Blank Result)*100/Average Result

GAS CHROMATOGRAPHY - QUALITY CONTROL

BLANK SPIKE

Test : MOD EPA 8015-CDOHS (FUEL HYDROCARBONS/BTXE)
 Blank Spike #: 57434
 Client : ALISTO ENGINEERING
 Project # : G519095/10-014-04-001
 Project Name : BP SITE#11109/4280 FOOTHILL BLVD. OAKLAND, CA

ATI I.D. : 506270
 Date Extracted: N/A
 Date Analyzed : 03-JUL-95
 Sample Matrix : WATER

| Parameters | Units | Blank Result | Spiked Sample | Spike Conc. | % Rec |
|------------|-------|--------------|---------------|-------------|-------|
| BENZENE | UG/L | <0.50 | 4.7 | 5.0 | 94 |
| TOLUENE | UG/L | <0.50 | 4.9 | 5.0 | 98 |

% Recovery = (Spike Sample Result - Sample Result)*100/Spike Concentration
 RPD (Relative % Difference) = (Spiked Sample - Blank Result)*100/Average Result



ATI # 506270

CHAIN OF CUSTODY

No 052545

Page 1 of 1

| | | | | | | |
|--|---|--|-------------------------------------|-----------------------|---|--|
| CONSULTANT'S NAME <i>Alisto Engineering</i> | | ADDRESS <i>1575 Trent Blvd</i> | | CITY <i>Wauwat</i> | STATE <i>CA</i> | ZIP CODE <i>94598</i> |
| BP SITE NUMBER <i>11109</i> | BP CORNER ADDRESS/CITY <i>4280 Foothill Blvd, Oakland CA</i> | | | | CONSULTANT PROJECT NUMBER <i>10-014-04-001</i> | |
| CONSULTANT PROJECT MANAGER <i>Bill Howell</i> | | PHONE NUMBER <i>(510) 295 1650</i> | FAX NUMBER <i>(510) 295 1823</i> | | CONSULTANT CONTRACT NUMBER <i>Pending??</i> | |
| BP CONTACT <i>Scott Houston</i> | BP ADDRESS <i>Renton WA</i> | | PHONE NUMBER | FAX NO. | | |
| LAB CONTACT <i>ATI Inc</i> | LABORATORY ADDRESS <i>San Diego CA</i> | | PHONE NUMBER | FAX NO. | | |
| SAMPLED BY (Please Print Name) <i>Dave Lussac</i> | | SAMPLED BY (Signature) <i>[Signature]</i> | | SHIPMENT DATE | | SHIPMENT METHOD <i>FedEx Ballaw</i> |

TAT: 24 Hours 48 Hours 1 Week Standard 2 Weeks

ANALYSIS REQUIRED

AIRBILL NUMBER *774148*

| SAMPLE DESCRIPTION | COLLECTION DATE | COLLECTION TIME | MATRIX SOIL/WATER | CONTAINERS | | PRESERVATIVE | LAB SAMPLE # | TPH Gas Box | | | | | | | | | | | | COMMENTS | |
|--------------------|-----------------|-----------------|-------------------|------------|-------------|--------------|--------------|-------------|--|--|--|--|--|--|--|--|--|--|--|----------|--|
| | | | | NO. | TYPE (VOL.) | | | | | | | | | | | | | | | | |
| S-1 | 1210 | 6/20/95 | H2O | 2 | Van | | 01 | X | | | | | | | | | | | | | |
| S-2 | 1242 | | | | | | 02 | | | | | | | | | | | | | | |
| S-3 | 1310 | | | | | | 03 | | | | | | | | | | | | | | |
| S-4 | 1350 | | | | | | 04 | | | | | | | | | | | | | | |
| S-5 | 1430 | | | | | | 05 | | | | | | | | | | | | | | |
| S-6 | 1447 | | | | | | 06 | | | | | | | | | | | | | | |
| S-7 | 1452 | | | | | | 07 | | | | | | | | | | | | | | |
| S-8 | 1457 | | | | | | 08 | | | | | | | | | | | | | | |
| S-9 | — | | | | | | 09 | | | | | | | | | | | | | | |
| S-10 | — | | | | | | 10 | | | | | | | | | | | | | | |

| RELINQUISHED BY / AFFILIATION | DATE | TIME | ACCEPTED BY / AFFILIATION | DATE | TIME | ADDITIONAL COMMENTS |
|-------------------------------|------|------|---------------------------|---------|-------|----------------------|
| <i>[Signature]</i> A1.340 | | | <i>[Signature]</i> (ATI) | 6/22/95 | 08:30 | Cooler # 471 = 3.9°C |

Distribution: White - Original (with Data) Pink - Lab
Yellow - BP Blue - Consultant Field Staff