

KAPREALIAN ENGINEERING
INCORPORATED

April 13, 1994

Unocal Corporation
2000 Crow Canyon Place, Suite 400
P.O. Box 5155
San Ramon, CA 94583

Attention: Mr. Edward C. Ralston

RE: Unocal Service Station #3292
15008 E. 14th Street
San Leandro, California

Dear Mr. Ralston:

Kaprealian Engineering, Inc. (KEI) has received MPDS Services, Inc's. (MPDS) Quarterly Data Report (MPDS-UN3292-02) dated March 30, 1994, for the above referenced site. MPDS conducted a joint monitoring and sampling event on February 24, 1994, with the consultants (Alisto Engineering Group) for the nearby former Mobil service station site.

Analytical results of the ground water samples collected from the Mobil wells are provided on the attached Table 1. In addition, the concentrations of TPH as gasoline and benzene detected in the Unocal and Mobil wells on February 14, 1994, are shown on the attached Figure 1.

If you have any questions, please do not hesitate to call me at (510) 602-5104.

Sincerely,

Kaprealian Engineering, Inc.



Robert H. Kezerian
Project Manager

RHK:jad\ECR0413

Attachments: Table 1
Figure 1

cc: Scott Seery, Alameda County Health Care Services Agency

ALCO
HAZMAT
94 APR 15 PM 2:03

TABLE 1

SUMMARY OF LABORATORY ANALYSES
WATER

Former Mobil Service Station Wells
(Provided by Alisto Engineering Group)

<u>Date</u>	<u>Well #</u>	<u>TPH as Diesel</u>	<u>TPH as Gasoline</u>	<u>Benzene</u>	<u>Toluene</u>	<u>Ethyl-benzene</u>	<u>Xylenes</u>
2/24/94	MW-1	2,500	11,000	70	ND	260	180
	MW-2	4,500	6,400	31	ND	58	42
	MW-3	10,000	19,000	52	30	690	290
1/31/89	MW-1	--	11,200	260	ND	500	500
3/31/88	MW-1	ND	29,000	ND	ND	550	640

ND = Non-detectable.

-- Indicates analysis was not performed.

Results are in parts per billion (ppb), unless otherwise indicated.

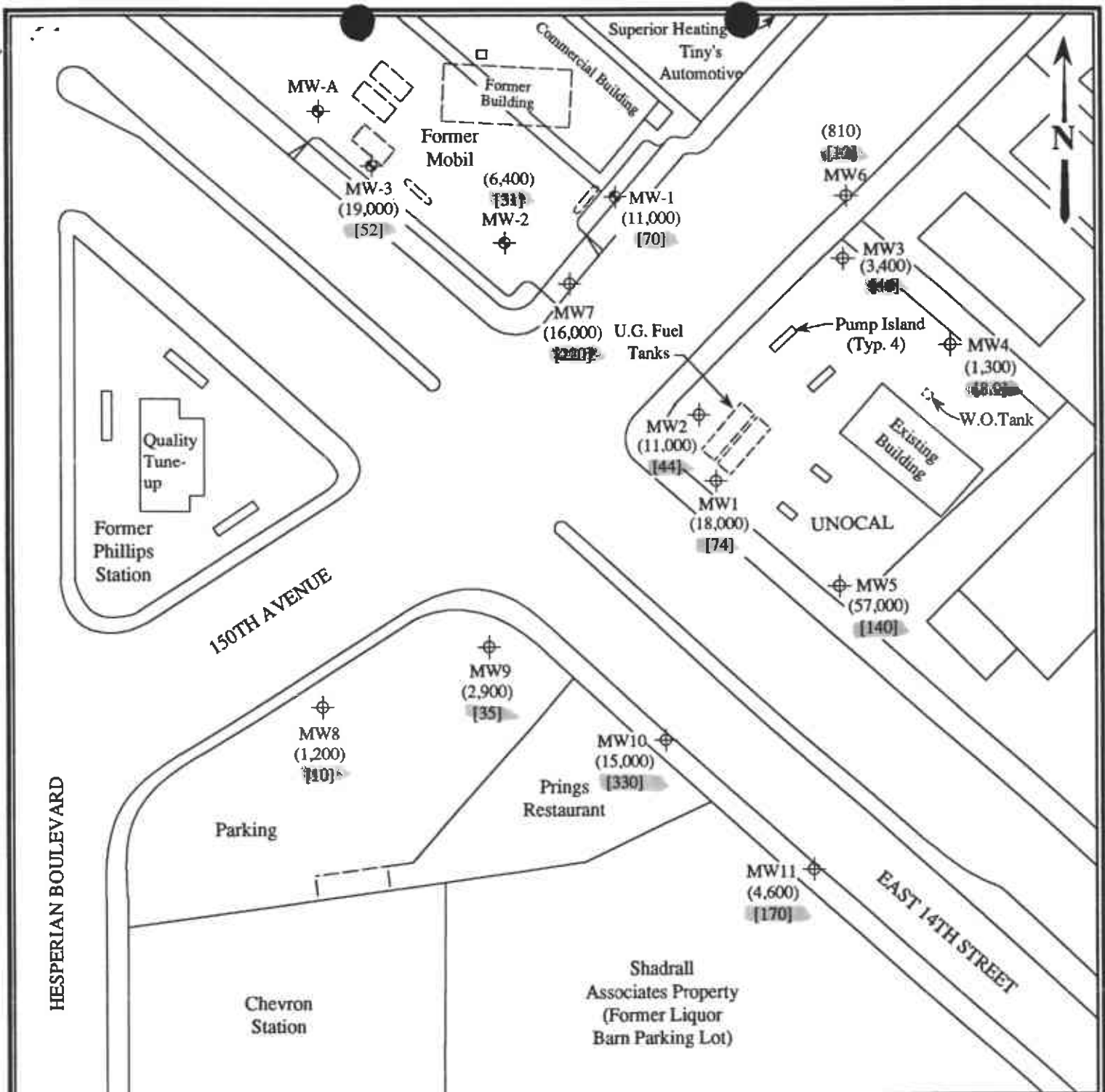

LEGEND

- ⊕ Monitoring well (Unocal)
- ⊕ Monitoring well (Former Mobil)
- () Concentration of TPH as gasoline in µg/L
- [] Concentration of benzene in µg/L

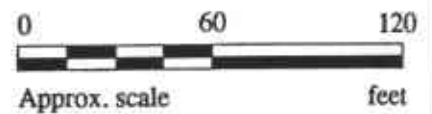

PETROLEUM HYDROCARBON CONCENTRATIONS IN GROUND WATER ON FEBRUARY 24, 1994

**KAPREALIAN ENGINEERING
INCORPORATED**

**UNOCAL SERVICE STATION #3292
15008 E. 14TH STREET
SAN LEANDRO, CALIFORNIA**

**FIGURE
1**