



ENVIRONMENTAL HEALTH SERVICES
ENVIRONMENTAL PROTECTION
1131 Harbor Bay Parkway, Suite 250
Alameda, CA 94502-6577
(510) 567-6700
FAX (510) 337-9335

October 22, 2014

Jasleen and Kamaljit Assi
6562 Graham Avenue
Newark, CA 94560-3713

Subject: Fuel Leak Case No. RO0000415 and GeoTracker Global ID T0600101065, 4411 Foothill Boulevard, Oakland, CA 94601

Dear Jasleen and Kamaljit Assi:

Under the direction of this office, Shell Oil Products US is conducting an environmental investigation for a property located at 4411 Foothill Boulevard in Oakland. A fuel leak from a former service station at 4411 Foothill Boulevard has resulted in soil and groundwater contamination in the area of the site. The extent of the soil and groundwater contamination is not fully defined but may extend to your property at 1724-1728 High Street in Oakland.

Alameda County Environmental Health (ACEH) is requiring Shell Oil Products US to characterize the extent of contamination from their site. In order to do this, soil vapor sampling has been proposed on your property at 1724-1728 High Street. We understand that Conestoga-Rovers & Associates (on behalf of Shell Oil Products US) sent you a Request for Access on October 10, 2014 (see attachment). It is important to complete the investigation as part of the current fuel leak case. We request that you resolve this access agreement promptly and reasonably in order to define the extent of contamination.

ACEH requests you complete negotiations with Conestoga-Rovers & Associates, on behalf of Shell Oil Products US, by November 24, 2014. This request is made pursuant to Water Code Section 13267, which allows ACEH to require technical reports from persons whose activities may have an impact on water quality.

If you have any questions, please call me at 510-567-6791 or send me an electronic mail message at jerry.wickham@acgov.org. Online case files can be viewed over the Internet on the Alameda County Environmental Health website (<http://www.acgov.org/aceh/lop/ust.htm>) or the State of California Water Resources Control Board GeoTracker website (<http://geotracker.swrcb.ca.gov>).

Sincerely,

Jerry Wickham, California PG 3766, CEG 1177, and CHG 297
Senior Hazardous Materials Specialist

Attachment: Request for Access to Property Located at 1724/1726/1728 High Street, Oakland, California dated October 10, 2014 from Shell Oil Products and Conestoga-Rovers & Associates

Property Owners
RO0000415
October 22, 2014
Page 2

cc: Leroy Griffin, Oakland Fire Department, 250 Frank H. Ogawa Plaza, Ste. 3341, Oakland, CA 94612-2032 2032 (*Sent via E-mail to: lgriffin@oaklandnet.com*)

Perry Pineda, Shell Oil Products US, 20945 S. Wilmington Ave., Carson, CA 90810-1039 (*Sent via E-mail to: perry.pineda@shell.com*)

Foothill Blvd. LLC, c/o Linli Lee, 141 Woodland Way, Piedmont, CA 94611-3839

Walter Watters, 101 Jasmine Creek Drive, Corona Del Mar, CA 92625-1420

Peter Schaefer, Conestoga-Rovers & Associates, 5900 Hollis Street, Suite A Emeryville, CA 94608 (*Sent via E-mail to: pschaefer@croworld.com*)

Bill Phua c/o Jay Phares, 10700 MacArthur Boulevard, Suite 200, Oakland, CA 94605-5260

Jerry Wickham, ACEH (*Sent via E-mail to: jerry.wickham@acgov.org*)

GeoTracker, eFile



**CONESTOGA-ROVERS
& ASSOCIATES**

5900 Hollis Street, Suite A
Emeryville, California 94608
Telephone: (510) 420-0700 Fax: (510) 420-9170
www.CRAworld.com

TRANSMITTAL

DATE: September 10, 2014 REFERENCE NO.: 240897
PROJECT NAME: 4411 Foothill Boulevard, Oakland
To: Jasleen and Kamaljit Assi
6562 Graham Avenue
Newark, California 94560-3713

Please find enclosed: Draft Final
 Originals Other
 Prints

Sent via: Mail Same Day Courier
 Overnight Courier Other

QUANTITY	DESCRIPTION
1	Request for Access to Property

As Requested For Review and Comment
 For Your Use Please sign and return one copy

COMMENTS:

We appreciate your cooperation in this matter and would appreciate your timely response. If you have any questions, please call the CRA project manager Peter Schaefer at (510) 420-3319 or the Shell program manager Perry Pineda at (425) 413-1164.

Copy to: Perry Pineda, Shell Oil Products US (electronic copy)
Jerry Wickham, Alameda County Environmental Health (electronic copy)

Completed by: Peter Schaefer Signed: 

Filing: Correspondence File



Shell Oil Products US

Environmental Services
20945 S. Wilmington Avenue
Carson, CA 90810

Tel (714) 731 1050

fax (714) 713 1038

Email: perry.pineda@shell.com

Internet <http://www.shell.com>

October 10, 2014

Jasleen and Kamaljit Assi
6562 Graham Avenue
Newark, California 94560-3713

**Re: Request for Access to Property Located at
1724/1726/1728 High Street, Oakland, California**

Dear Jasleen and Kamaljit Assi:

As a result of an ongoing environmental assessment at the former Shell service station located at 4411 Foothill Boulevard, Oakland, California, Shell Oil Products US ("SOP US") has been advised that there may be hydrocarbons (gasoline, oil, etc.) in or about your property located at 1724/1726/1728 High Street, in the vicinity of the former service station. Therefore, on behalf of SOP US we request permission to enter your property and perform the work outlined below to determine if hydrocarbons originating from the Shell service station are present and remediate such hydrocarbons as may be required by applicable law.

The work to be performed may include the installation of monitoring well(s) and periodic monitoring of such wells, tests, inspections, borings, engineering studies, surveys, appraisals, environmental studies, remediation operations and/or other activities that SOP US deems necessary to comply with all applicable federal, state and local statutes, regulations, ordinances, directives, orders and standards governing underground storage tank systems and the assessment or remediation of petroleum hydrocarbons. The proposed locations for the borings are indicated on the attached site map.

A licensed contractor retained by SOP US will perform the above work. This work is being performed on behalf of SOP US to comply with the environmental requirements of the State of California.

The work may result in minor disruptions of the normal use of your property. The property will be restored to its approximate former condition as soon as possible after we have ascertained if hydrocarbons from the Shell service station are present and, to the extent required, such hydrocarbons have been remediated. SOP US agrees to indemnify you from any and all claims by third parties arising out of the work performed by SOP US under this agreement.

Please sign below to signify your consent and return this letter in the enclosed stamped envelope.

We appreciate your cooperation in this matter and would appreciate your timely response. If you have any questions, please call Peter Schaefer at (510) 420-3319.

Very truly yours,

SOP US

By:

I have reviewed your request and I hereby consent to the entry by SOP US upon my property for the purpose of performing the work described herein. I understand that I may be prevented from using a portion of my property and I agree to the minor disruption of the normal use of my premises as described.

I further represent and warrant that I am the owner of the property located at 1724/1726/1728 High Street, Oakland, California, with full authority to provide the consent given above.

Jasleen and Kamaljit Assi

By: _____

Date: _____

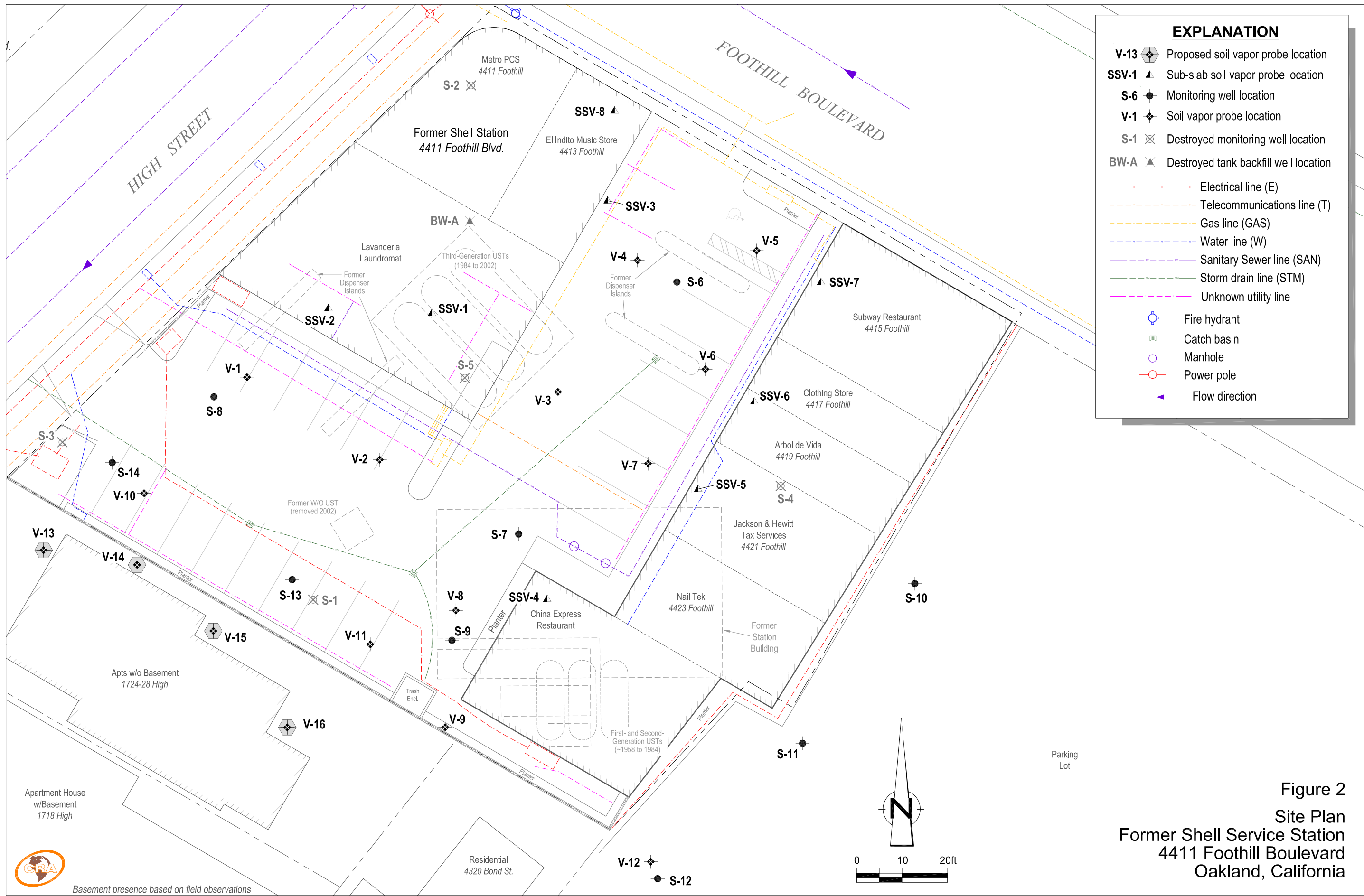

Basement presence based on field observations