



# PORT OF OAKLAND

ENVIRONMENTAL  
PROTECTION  
9 JAN -9 PM 2:21

January 4, 1996

Mr. Barney Chan  
Hazardous Materials Division  
Alameda County Health  
Care Services Agency  
1131 Harbor bay Parkway  
Alameda, CA 94502-6577

**SUBJECT: SITE INVESTIGATION REPORT FOR THE SITE OF FORMER TANK  
NUMBERS MF-23 AND MF-24, METROPOLITAN OAKLAND  
INTERNATIONAL AIRPORT, UNITED AIRLINES HANGER AREA,  
1100 AIRPORT DRIVE, OAKLAND, CALIFORNIA**

Dear Mr. Chan:

Enclosed, you will find a copy of the Site Investigation Report for the Port of Oakland Metropolitan International Airport, United Airlines Hanger Area, 1100 Airport Drive, Oakland, California (former tanks MF-23 and MF-24).

If you have any questions or need additional information, please call me at 272-1118. Thank you for your assistance on this project.

Sincerely,

Susa Gates  
Environmental Department

SG/jb

Enclosure

cc: Eddie So, San Francisco Regional Water Quality Control Board, 2101 Webster Street, Suite 500, Oakland, CA 94612  
Neil Werner (Environmental Department)  
Brady Nagel (Alisto)

pc\wp51\files\susa\1995\Chan.ltr

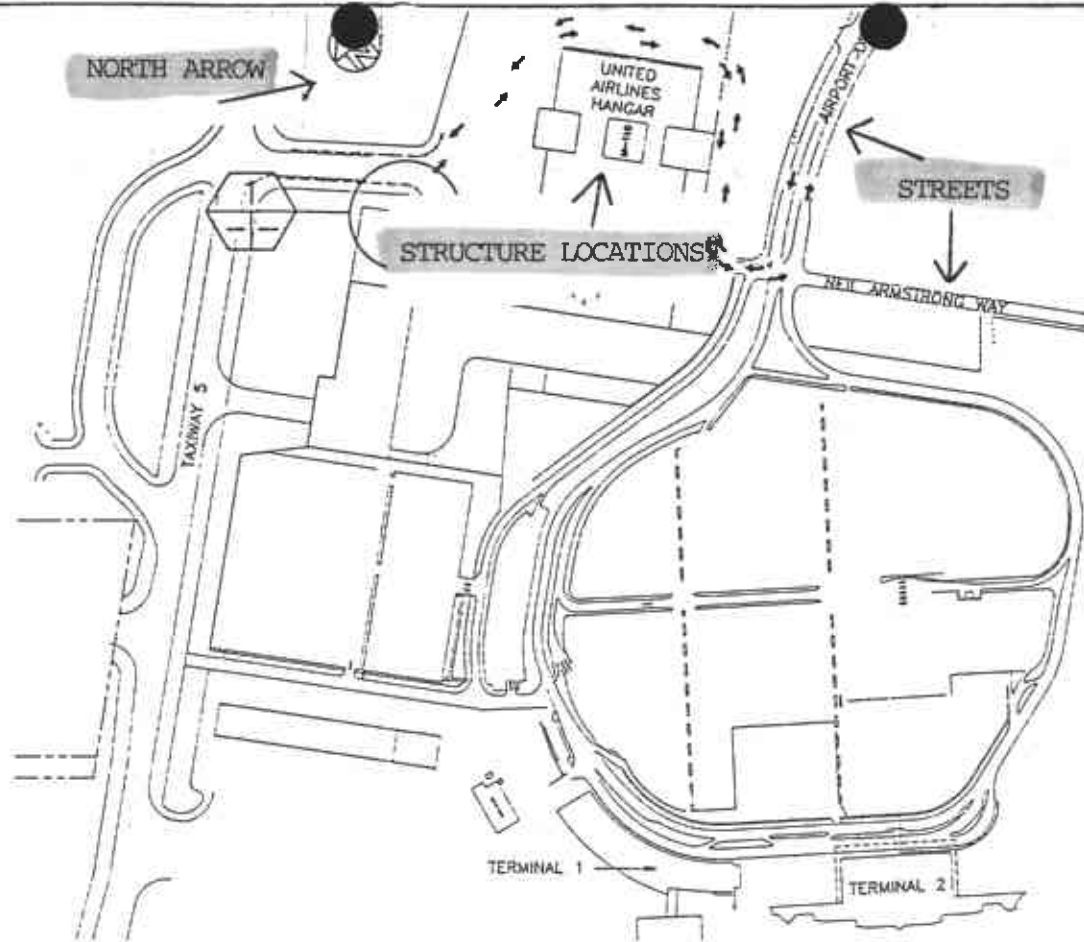

PLAN - (SHOWING ROUTE TO TANKS)

SCALE: 1" = 300'

- DEPTH TO GROUNDWATER - APPROX 10'
- THERE WILL BE NO REMAINING TANKS OR PIPING
- THERE ARE NO EXISTING WELLS
- UNDERGROUND FACILITIES UN-KNOWN

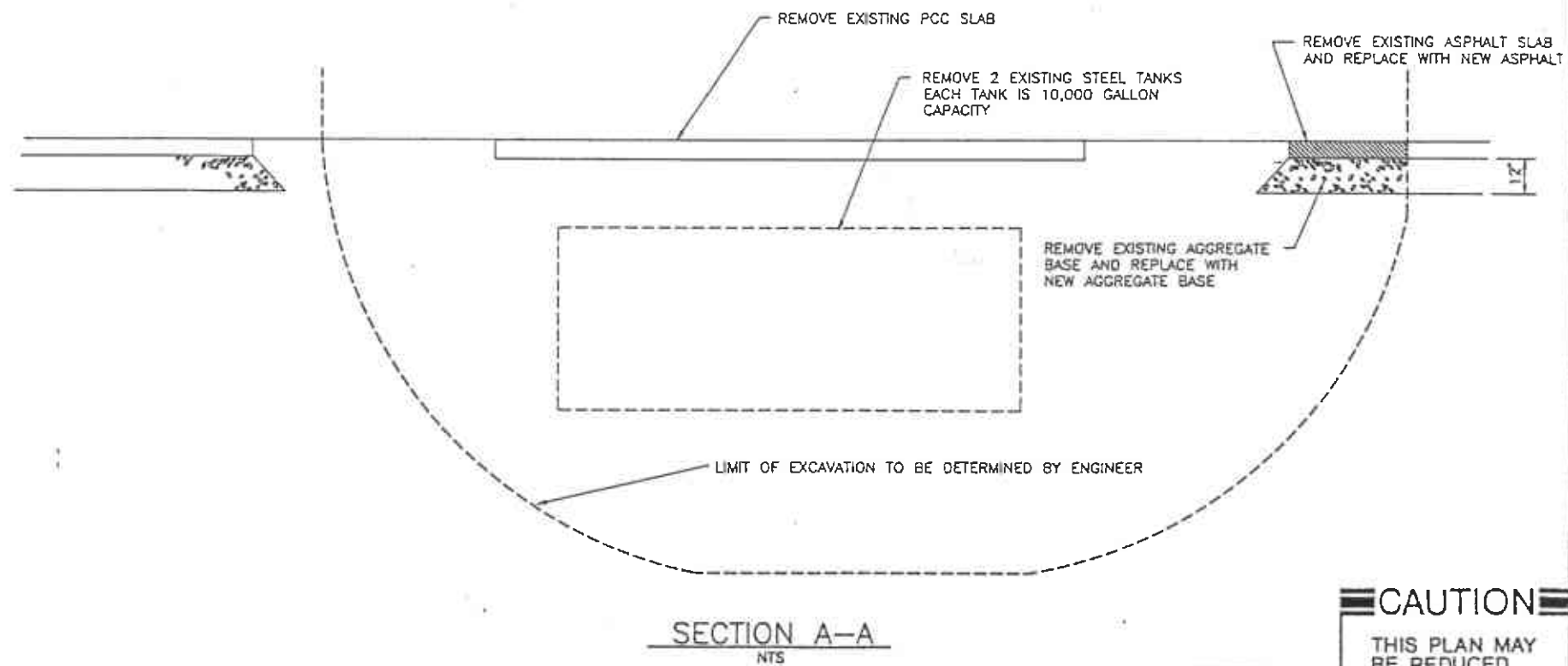
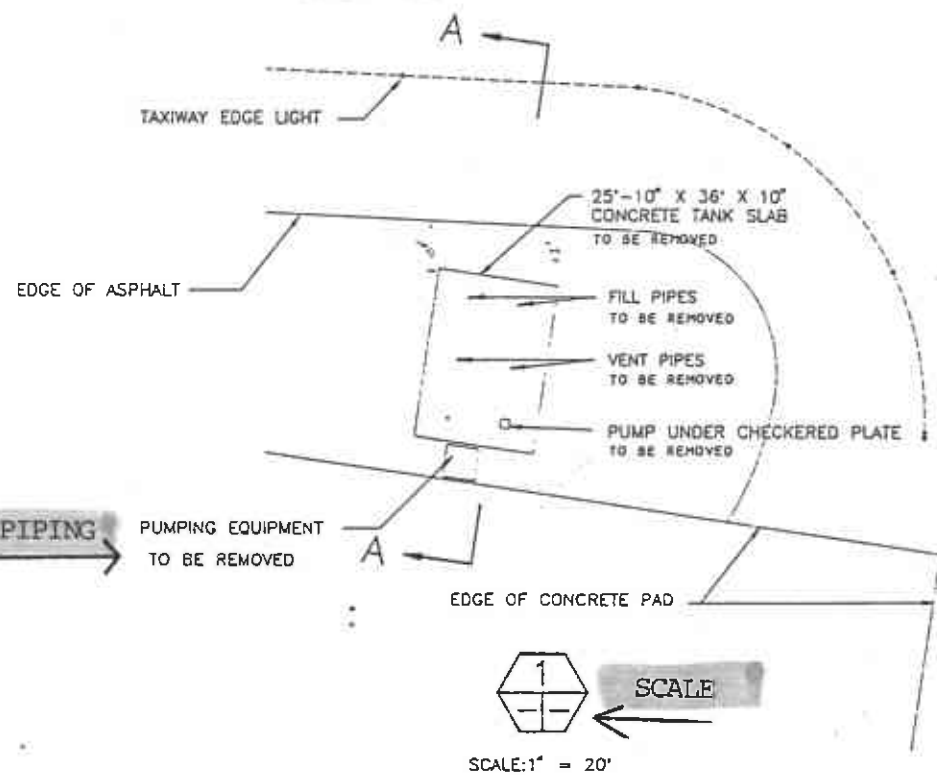
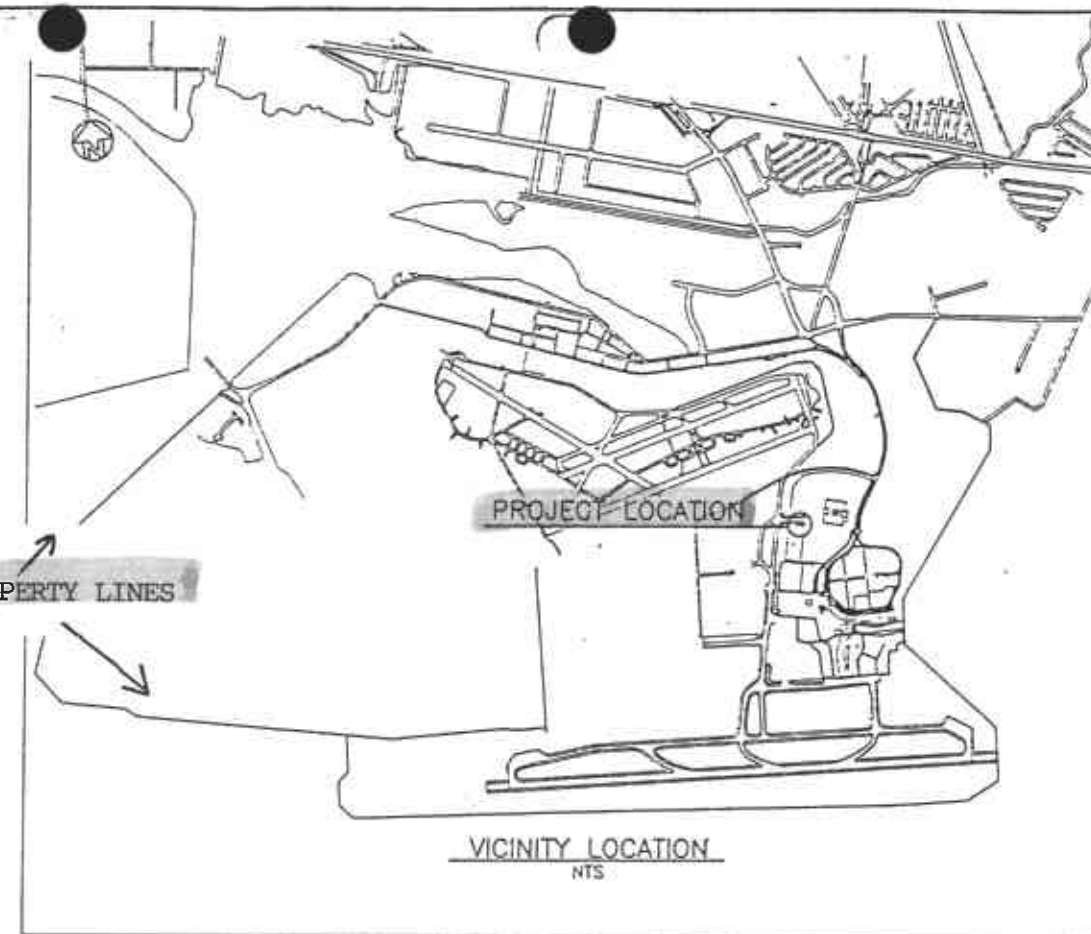

**CAUTION**  
THIS PLAN MAY BE REDUCED  
**DO NOT SCALE**  
ORIGINAL SCALE

REVISIONS PLANS FIELD BOOKS "PORT OF OAKLAND DATUM" IS 8.30' BELOW MEAN SEA LEVEL.	NO.	REVISIONS	DATE	APP'D	DRAWN: S.Y. SAITO DESIGNED: <i>[Signature]</i> CHECKED: REVIEWED:	<b>PORT OF OAKLAND</b> 66 JACK LONDON SQ. OAKLAND, CALIFORNIA	CHIEF ENGINEER <i>[Signature]</i> C 22138 APPROVED: <i>[Signature]</i> C 13202 RECOMMENDED: <i>[Signature]</i> M 13336	METROPOLITAN OAKLAND INTERNATIONAL AIRPORT SOUTH FIELD REMOVAL OF JET FUEL TANKS MF-23 AND MF-24	DATE: AS SHOWN SCALE: AS SHOWN SHEET 1 OF 1 SHEETS FILE: AA-2984

CAUTION: CHECK TRACINGS FOR LATEST REVISIONS

May 3, 1991

**RAMCON  
SITE HEALTH AND SAFETY PLAN**

**Contractor:** RAMCON - 1401 HALYARD DRIVE, #130 WEST SAC, CA 95691  
**Site Name:** METROPOLITAN OAKLAND INTERNATIONAL AIRPORT  
**Site Address:** 300 FEET NORTH OF GEORGE P. MILLER AVIATION HANGER  
BUILDING M-110 AIRPORT DRIVE AT JOHN GLEN DRIVE  
**Job No:** 288001

**ON SITE ORGANIZATION AND COORDINATION** - Police or Fire Call 911

**Site Manager:** John Pile **Pager:** 440-3826 **Phone:** 372-7535  
**Responsibilities:** Oversee tank removal operations, air monitoring, determining when site level will be changed and arrange for all necessary inspections.

**HAZARD EVALUATION**

1. Be aware of area where work is performed. Stay clear of excavation equipment during operations to avoid physical injury.
2. Be aware of any airplanes in the vicinity of the work area. Workers are to wear ear plugs for hearing protection.
3. Set up a perimeter around work area with "No Smoking" signs posted to avoid fire hazards and unwanted personnel.
4. Have respirators, Tyveks suits and gloves readily available for personal protection when needed.
5. Have (2) 20Lb A:120 B-C dry chemical fire extinguisher available at all times.
6. Monitor air around excavation for any hazardous vapors.
7. All employees are to wear hard hats to avoid injuries to head area.
8. Personal will be excavating Jet A fuel tanks that contain TPH as Jet Fuel, Benzene, Toluene, Ethyl Benzene and Xylene which can be hazardous to your health.

### DAILY BRIEFINGS

1. Inform each employee of what work needs to be accomplished during the work day.
2. Review any problems that may have occurred the prior day.
3. Inform employees on the status of air quality. Review respirator donning procedure if applicable.
4. Inform employees on visitors to site that day.
5. Review heat stress conditions and what signs to watch our for. If heat is going to be abnormal, take necessary breaks.
6. Review airport policy for work at facility.
7. Reiterate the fact, that safety comes first.
8. Have open discussion with employees to answer any questions or problems.

### AIR AND PERSONAL MONITORING DEVICES

We will be using the Gastechtor 1314 and the LEL 02 Meter to monitor the concentrations of oxygen in the air and in the dirt. This will be done every 15 minutes. The Gastechtor is calibrated weekly with Hexane.

### PERSONNEL PROTECTIVE EQUIPMENT

Employees will work at Level D until air monitoring indicates a need for a change. Level D protection will consists of hard hats, steel toed boots, ear and eye protection and normal work clothes (Blue jeans and company shirts). When air monitoring indicates TPH levels above 50 PPM or Benzene levels above .5 PPM respirators will be donned along with Tyvek suits and gloves. Filter cartridge will be changed when break through is achieved. At Level C air monitoring will be changed from every 15 minutes to every 5 minutes. When employees reach immediate break through on filter cartridge then level B site procedure will be taken.

### DECONTAMINATION PROCEDURES

Personnel will be decontaminated in Hazmat Decontamination Pool. Employees will also have an extra supply of Tyvek suits and spare change of clothes.

### SECURING THE SITE

Securing the site will consist of barricading the excavation with lighted barricades and barricade tape. All stockpiled soil will be covered with visqueen. The visqueen will be secured with tires and rope to hold it in place.

**EMERGENCY CONTACTS AND PHONE NUMBERS:**  
**POLICE OR FIRE CALL 911**

**Site Manager:** John Pile - 916/372-7535 Office, 440-3826 Pager  
916/765-1746 Mobile

**Project Manager:** Thom Murray - 916/372-7535 Office, 440-3823 Pager  
916/761-3291

**Client Contact:** Jill Warner Brown - 415/577-4162

**Environmental Agency:** Alameda County Environmental Health  
415/271-4320

**Hospital:** Humana - 13855 East 14th Street, San Leandro  
415/357-6500 (See attached map for directions)

**Site Phone Number:** 916/761-3289

**Ramcon's occupational Doctor:** Dr. David E. Root  
1 Scripps Drive  
Sacramento, Ca 95825  
(916) 924-9263

Dr. Root should be notified in the event of any occupational injury  
or exposure.

**Workman's Compensation Carrier:** State Compensation Insurance Fund  
Policy Number: 571-90-2206  
Expires: 10/91

**Poison:** 415/476-2845 **EPA:** 800/424-8802 **Envirologic:** 207/773-3020

**OSHA TRAINING**

Attached are the certificates for the OSHA Hazardous Waste Training  
(29 CFR 1910.120) as required.

This form shall be filled out by the Project Manager along with the  
client, master and copies forwarded to the Health and Safety  
Director. The H & S Director will review, sign and return  
expeditiously if no exception is taken. Employees shall not visit  
a site without a copy of this Site Safety Plan in their possession.

Reviewed by: \_\_\_\_\_ Date: \_\_\_\_\_

Reviewed by: \_\_\_\_\_ Date: \_\_\_\_\_

Reviewed by: \_\_\_\_\_ Date: \_\_\_\_\_

**STATE  
COMPENSATION  
INSURANCE  
FUND**

P.O. BOX 807, SAN FRANCISCO, CA 94101-0807

**CERTIFICATE OF WORKERS' COMPENSATION INSURANCE**

SEPTEMBER 10, 1990

POLICY NUMBER: 571-90 UNIT 0000196  
CERTIFICATE EXPIRES: 10-1-91

COUNTY ALAMEDA  
HAZARDOUS MATERIALS DIVISION  
80 SWAN WAY, ROOM 200  
OAKLAND  
CA 94621

This is to certify that we have issued a valid Workers' Compensation insurance policy in a form approved by the California Insurance Commissioner to the employer named below for the policy period indicated.

This policy is not subject to cancellation by the Fund except upon <sup>30</sup>ten days' advance written notice to the employer.  
XX

We will also give you <sup>30</sup>TEN days' advance notice should this policy be cancelled prior to its normal expiration.  
XX

This certificate of insurance is not an insurance policy and does not amend, extend or alter the coverage afforded by the policies listed herein. Notwithstanding any requirement, term, or condition of any contract or other document with respect to which this certificate of insurance may be issued or may pertain, the insurance afforded by the policies described herein is subject to all the terms, exclusions and conditions of such policies.

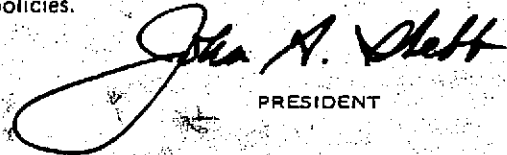
  
PRESIDENT

ENDORSEMENT #2065 ENTITLED CERTIFICATE HOLDERS' NOTICE EFFECTIVE  
10/01/90 IS ATTACHED TO AND FORMS A PART OF THIS POLICY.

EMPLOYER

MICHAEL S RAMOS  
DEA: RAMCON  
P.O. BOX 1024  
WEST SACRAMENTO  
CA 95691

# *Certificate*

This is to certify that:

**MARK ANDREWS**

has received the following training  
as specified in the  
OSHA Hazardous Waste Operations and  
Emergency Response Standard  
[29 CFR 1910.120(e)]:

**8 Hours of  
Annual Refresher Training**

**APRIL 20, 1990**

Date

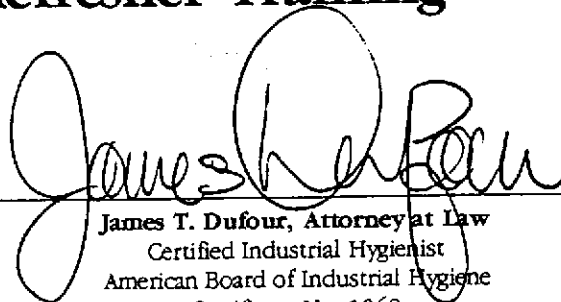
  
James T. Dufour, Attorney at Law  
Certified Industrial Hygienist  
American Board of Industrial Hygiene  
Certificate No. 1068

# *Certificate*

This is to certify that:

**BOB WHITE**

has received training as specified in the OSHA Hazardous Waste Operations and Emergency Response Standard [29 CFR 1910.120(e)] consistent with the function and responsibilities of:

## **Investigation and Remedial Actions at Hazardous Waste Sites**

This training level has been achieved by a combination of on-the-job training, work experience, prior safety training, and satisfactory completion of a comprehensive training program under my direction. This is the equivalent of 40 hours of initial and three days of supervised, actual field experience.

**APRIL 5, 1990**

Date

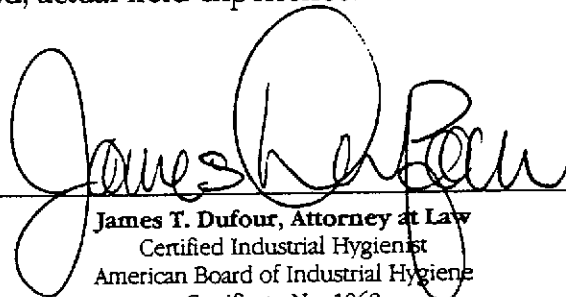
  
James T. Dufour, Attorney at Law  
Certified Industrial Hygienist  
American Board of Industrial Hygiene  
Certificate No. 1068



# *Certificate*

This is to certify that:

**JOHN PILE**

has received the following training  
as specified in the  
OSHA Hazardous Waste Operations and  
Emergency Response Standard  
[29 CFR 1910.120(e)]:

**8 Hours of  
Annual Refresher Training**

APRIL 20, 1990

\_\_\_\_\_  
Date

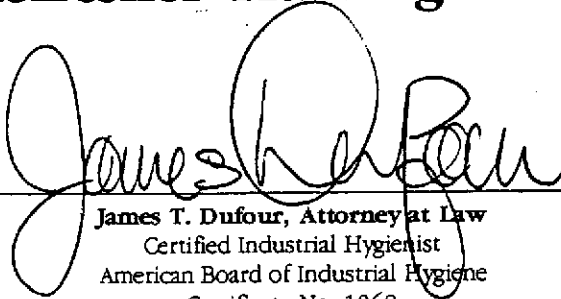
  
\_\_\_\_\_  
James T. Dufour, Attorney at Law  
Certified Industrial Hygienist  
American Board of Industrial Hygiene  
Certificate No. 1068

# *Certificate*

This is to certify that:  
**FRANK THOMAS PILE**

has received training as specified in the OSHA Hazardous Waste Operations and Emergency Response Standard [29 CFR 1910.120(e)] consistent with the function and responsibilities of:

## **Investigation and Remedial Actions at Hazardous Waste Sites**

This training level has been achieved by a combination of on-the-job training, work experience, prior safety training, and satisfactory completion of a comprehensive training program under my direction. This is the equivalent of 40 hours of initial and three days of supervised, actual field experience.

**APRIL 5, 1990**

Date

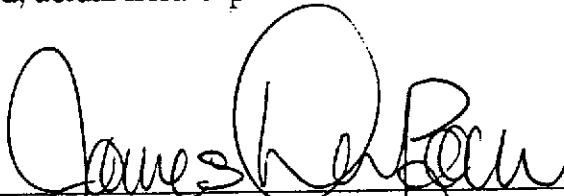
  
James T. Dufour, Attorney at Law  
Certified Industrial Hygienist  
American Board of Industrial Hygiene  
Certificate No. 1068

# *Certificate*

This is to certify that:

**MICHAEL BURGAN**

has received the following training  
as specified in the  
OSHA Hazardous Waste Operations and  
Emergency Response Standard  
[29 CFR 1910.120(e)]:

**8 Hours of  
Annual Refresher Training**

**APRIL 20, 1990**

Date

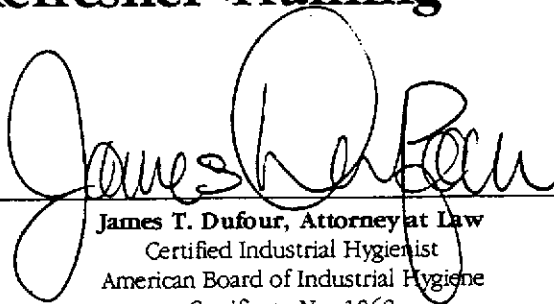
  
James T. Dufour, Attorney at Law  
Certified Industrial Hygienist  
American Board of Industrial Hygiene  
Certificate No. 1068



1100 Airport Drive

ST10 1049

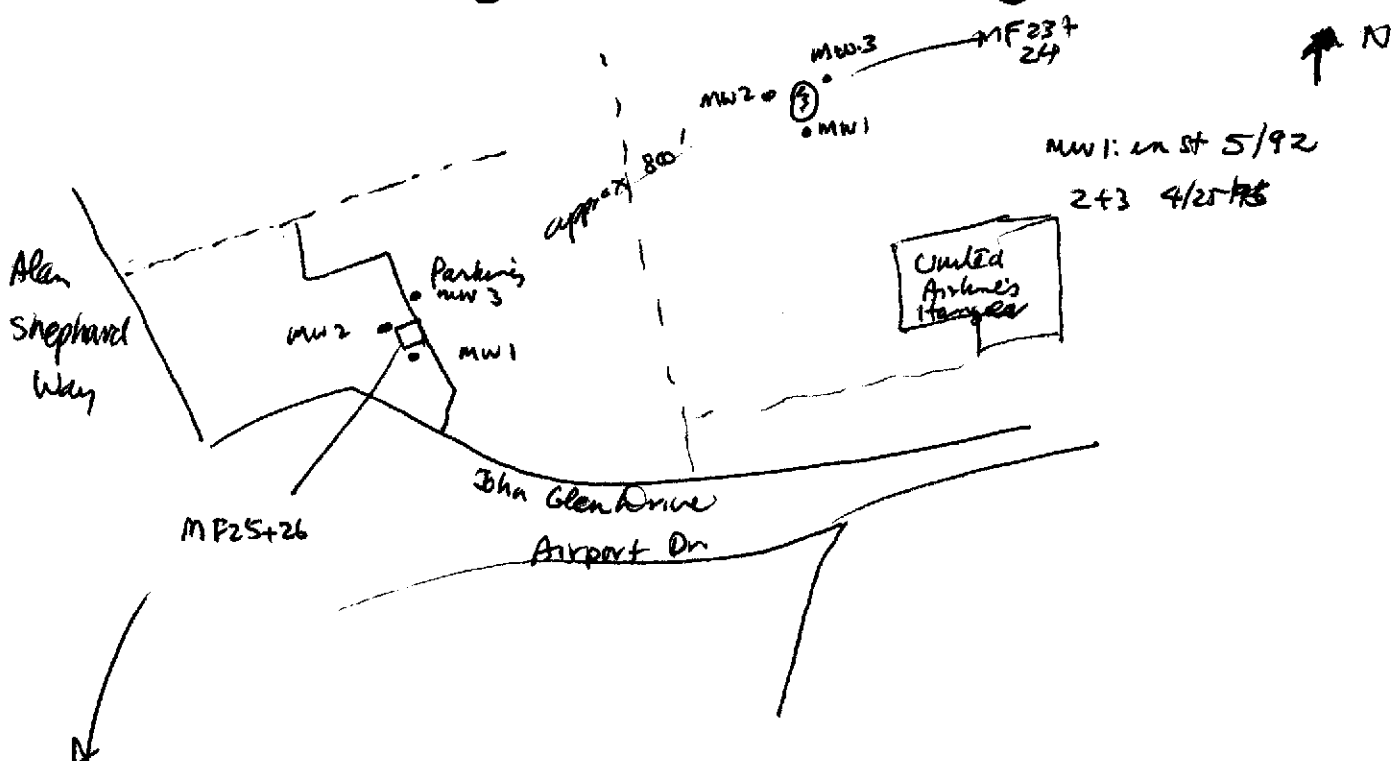

MW1: installed 5/92  
2+3 4/25/95

MW1: installed 5/15/92  
2+3: installed 4/25/95  
mgl (5.2g, 13<sup>JP</sup> mgl, 17no, 34B)

- 1) Treat both UST releases under 1 ST10 1049
- 2) For MF23+24, ok to monitor wells semi-annually
- 3) Gradient (23+24) ~~Eastward~~, gradient 24+25 (MW)
 

.006	.005
essentially flat 1/96	flat. 4/95
- 4) Need 4/15/96 mw report for mw 25+26.

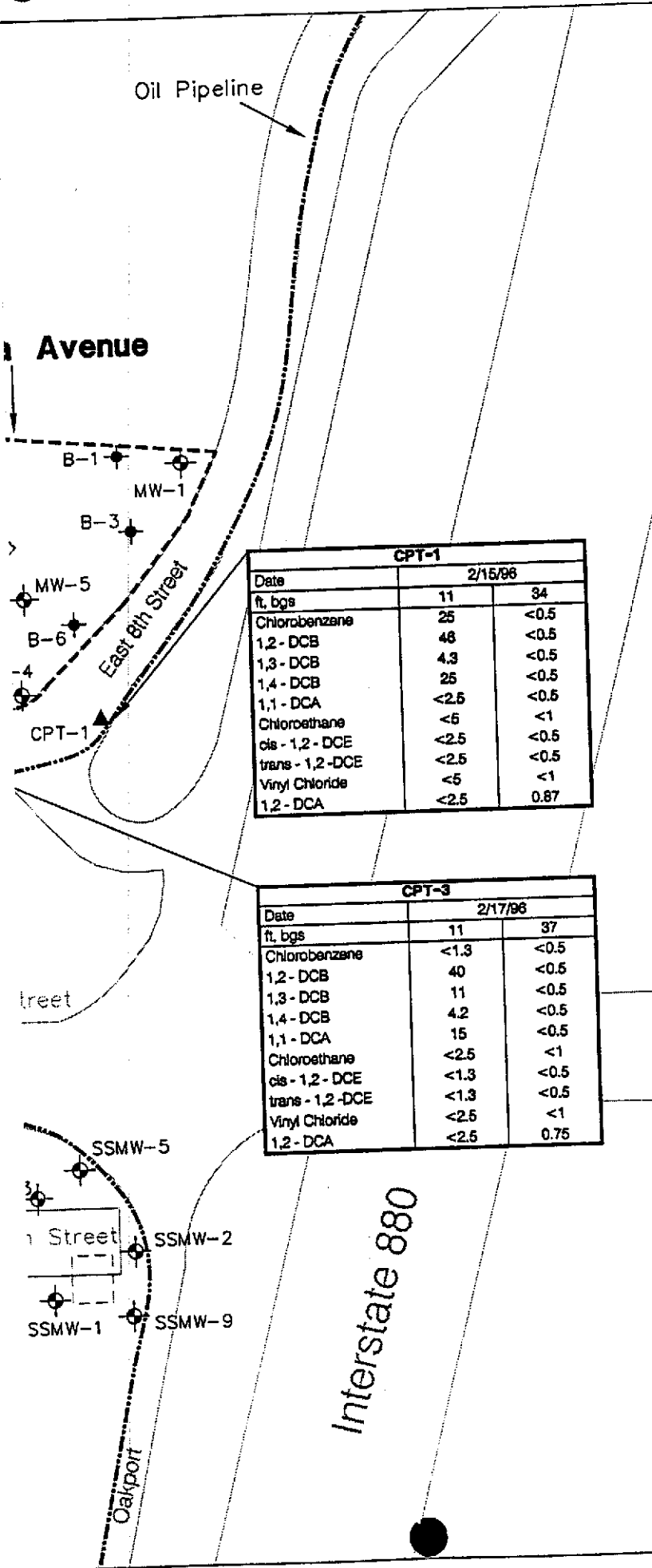

CPT-1		
Date	2/15/96	
ft. bgs	11	34
Chlorobenzene	25	<0.5
1,2-DCB	48	<0.5
1,3-DCB	4.3	<0.5
1,4-DCB	25	<0.5
1,1-DCA	<2.5	<0.5
Chloroethane	<5	<1
cis-1,2-DCE	<2.5	<0.5
trans-1,2-DCE	<2.5	<0.5
Vinyl Chloride	<5	<1
1,2-DCA	<2.5	0.87

CPT-3		
Date	2/17/96	
ft. bgs	11	37
Chlorobenzene	<1.3	<0.5
1,2-DCB	40	<0.5
1,3-DCB	11	<0.5
1,4-DCB	4.2	<0.5
1,1-DCA	15	<0.5
Chloroethane	<2.5	<1
cis-1,2-DCE	<1.3	<0.5
trans-1,2-DCE	<1.3	<0.5
Vinyl Chloride	<2.5	<1
1,2-DCA	<2.5	0.75

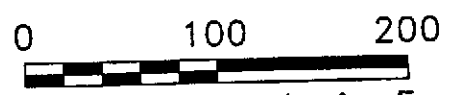

(Approximate Scale in Feet)

**LEGEND**

- Site Boundary
- ⊕ Monitoring Well
- ⊙ Soil Boring
- ▲ CPT/PIPP Sampling Location
- ⌊ Approximate Location of Former Underground Storage Tanks

Abbreviations

- 1,2-DCB = 1,2-Dichlorobenzene
- 1,3-DCB = 1,3-Dichlorobenzene
- 1,4-DCB = 1,4-Dichlorobenzene
- 1,1-DCA = 1,1-Dichloroethane
- cis-1,2-DCE = cis-1,2-Dichloroethene
- trans-1,2-DCE = trans-1,2-Dichloroethene
- 1,2-DCA = 1,2-Dichloroethane

Notes:

1. All locations are approximate.
2. Basemap from 1993 Pacific Aerial Survey photograph.
3. Concentrations in ug/L (ppb).
4. Insufficient groundwater to allow sample collection.

**Erler & Kalinowski, Inc.**

Halogenated Volatile Organic Compounds in Groundwater

4200 Alameda Avenue  
 Oakland, CA  
 May 1996  
 EKI 930040.02  
 Figure 7