

R0911

ENVIRONMENTAL  
PROTECTION

**FINAL CLOSURE PLAN FOR UNDERGROUND STORAGE  
TANK REMOVAL**

APR 12 PM 3:37

March 14, 1995

for

Pacific Electric Motor Co.  
1009 66th Ave.  
Oakland, California 94621-3535  
contact person:  
Mr. Terry Knox  
510-569-7621

property owner:

Pacific Electric Motor Co.  
1009 66th Ave.  
Oakland, California 94621-3535

primary contact / project manager:

Leland Yialelis

Contractor:  
W. A. Craig, Inc.  
P. O. Box 448  
Napa, California 94559  
510-525-2780

Contractor License: 455752 A, B, and Hazardous Materials  
(copies attached)

Workman's Compensation: Policy #NWC 254067  
(exp. date March 29, 1995)  
(copies attached)



## TANK REMOVAL INFORMATION

Date: February 16, 1995

Reason for removal: Tank was no longer in use.

Tank Transporter:

Dexanna, Ltd.  
3104 Athene Court  
Concord, Ca. 9451  
Phone: 510-687-1292  
EPA#: CAD 982438566  
Haz. Hauler Lic.#: 2883

Disposal of tank: Tank shipped to:

Erickson, Inc. 255 Parr Blvd.  
Richmond, California 94801  
Phone: 510-235-1393  
EPA #: CAD 009466392

This is a licensed T. S. D. F. facility. (see attached for documentation of disposal)

Soil sample processing: Soil samples were analyzed by:

McCampbell Analytical  
110 2nd Ave. South  
Pacheco, Ca. 94553  
State Certification #: 1644

(note: sample processing and associated method preparation numbers are noted on the lab results which are attached.)

Location of the tank: A map is attached which shows the location of the tank and associated underground piping as well as, streets, north direction, and buildings on site.

Sampling: Soil sampling was performed by W. A. Craig, Inc., personnel. As requested by Inspector Chan, 2 samples of the native soil, one from the productline trench and one from the dispenser area, were taken. A four (4) point composite sample of the stockpile was also taken.

Sampling methodology: The soil samples were obtained by driving a clean brass tube (2 x 6) into native soil which was excavated from

the pipe line and beneath the dispenser area and the soil in the stockpile. The tubes were driven by using a wooden mallet. The tubes were then sealed with aluminum foil, plastic end caps, and the tubes were placed in a zip lock plastic bag. The samples were labeled, placed on ice, and were transported to a state certified lab for processing. A chain of custody form was maintained for the samples, a copy of which is attached.

Soil Sample Analyses: The soil samples were labeled

TP1           beneath dispenser/pump area  
TP2           pipe line  
SP1 A-D      sample of stockpile

Summary of analyses of soil samples: soil is ppm, water is ppb

Analyses	TPH(g)	Benzene	Toluene	Ethyl Benzene	Xylenes
TP1	33	0.045	0.039	0.22	0.74
TP2	500	0.54	6.6	7.3	33
SP1 A-D	10,000	73	770	250	1400

Disposal of stockpile: It is recommended that the soil be disposed of to a recycling facility.

### SPECIFIC INFORMATION REGARDING THE TANK

Tank # 1:

Size/capacity: 2,000 gallons

Former contents of the tank: gasoline

Construction of the tank: single walled steel.

Age of the tank: approximately 20 years.

Condition of the tank upon removal: This tank was in good condition no holes were found.

Material sampled: soil - The soil had some staining in the area along the product line and the tank pit had a very marked odor and floating product was noted on the water in the pit.

CONCLUSIONS AND RECOMMENDATIONS:

The soil samples from the product line trench, the dispenser area, and the stock pile were tested for TPH gasoline and BTEX. The laboratory results show that there were detectable levels of contamination from gasoline and its constituents in the soil samples. The results of the analyses of the sample from the stockpile indicate that there was very high levels of contamination from gasoline.

It is recommended on the basis of these analytical results that the stockpile be disposed of to a permitted recycling facility. Clean import fill should be used to backfill the tank pit.

From the results of the soil sample analyses it can be concluded that contamination from gasoline or its constituents exist in soil and ground water in the former tank pit.

It is recommended that the contaminated water from the pit be pumped and disposed of by a licensed disposal facility. Further soil and ground water remediation is recommended.

---

I Declare under penalty of perjury that the foregoing information is true and correct.

Executed this day of March 14, 1995.

Nature of Business: Industrial and Environmental Construction

Name of Business W. A. Craig, Inc.

Address of Business: P. O. Box 448,  
Napa, California 94559

Printed name and title of applicant:

W. A. Craig, II  
Owner/ R.E.A. #01414 (exp. 6-1995)

Signature of applicant: *W. A. Craig, II*

Date: 4-7-95



## Reportage

Copies of the sampling report, the chain of custody, and the certified analysis data sheets will be submitted to the appropriate agencies as follows:

Alameda County  
Department of Environmental Health  
Hazardous Materials Division  
1131 harbor Bay Parkway - 2nd Floor  
Alameda, CA 94502  
510-567-6700  
Fax-337-9335  
Attn.: Mr. Barney Chan

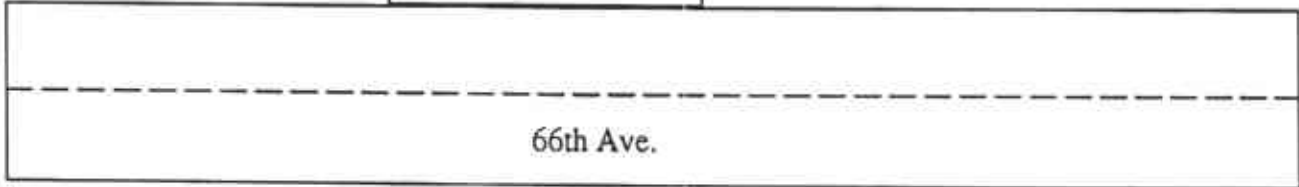
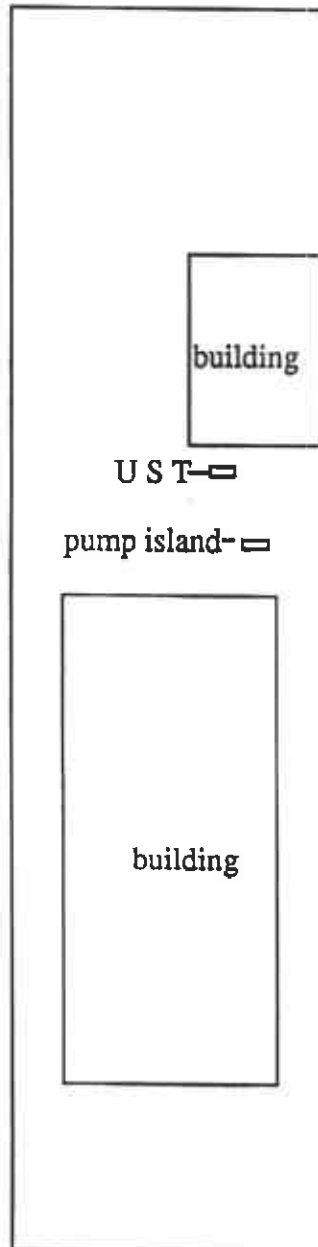

Date: January 16, 1995	W. A. Craig, Inc.	707-252-3353
Job # : 3471		
Scale: 1" = 100'	Pacific Electric Motor Co. 1009 66th Ave. Oakland, CA 94621-3535	Figure No. <b>3</b>
Drawn: LY		
Checked:		
Approved:	Site Map	

P.E.M  
1009 66th Ave.  
Oakland, CA  
#3471 Sampling Map

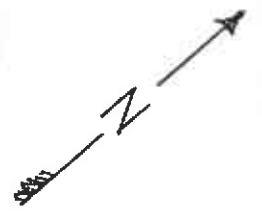

Tank: 2000 gal  
75.5" x 10.1"  
Excavation: 9' x 14' x 10'  
Water: 7' B.G.

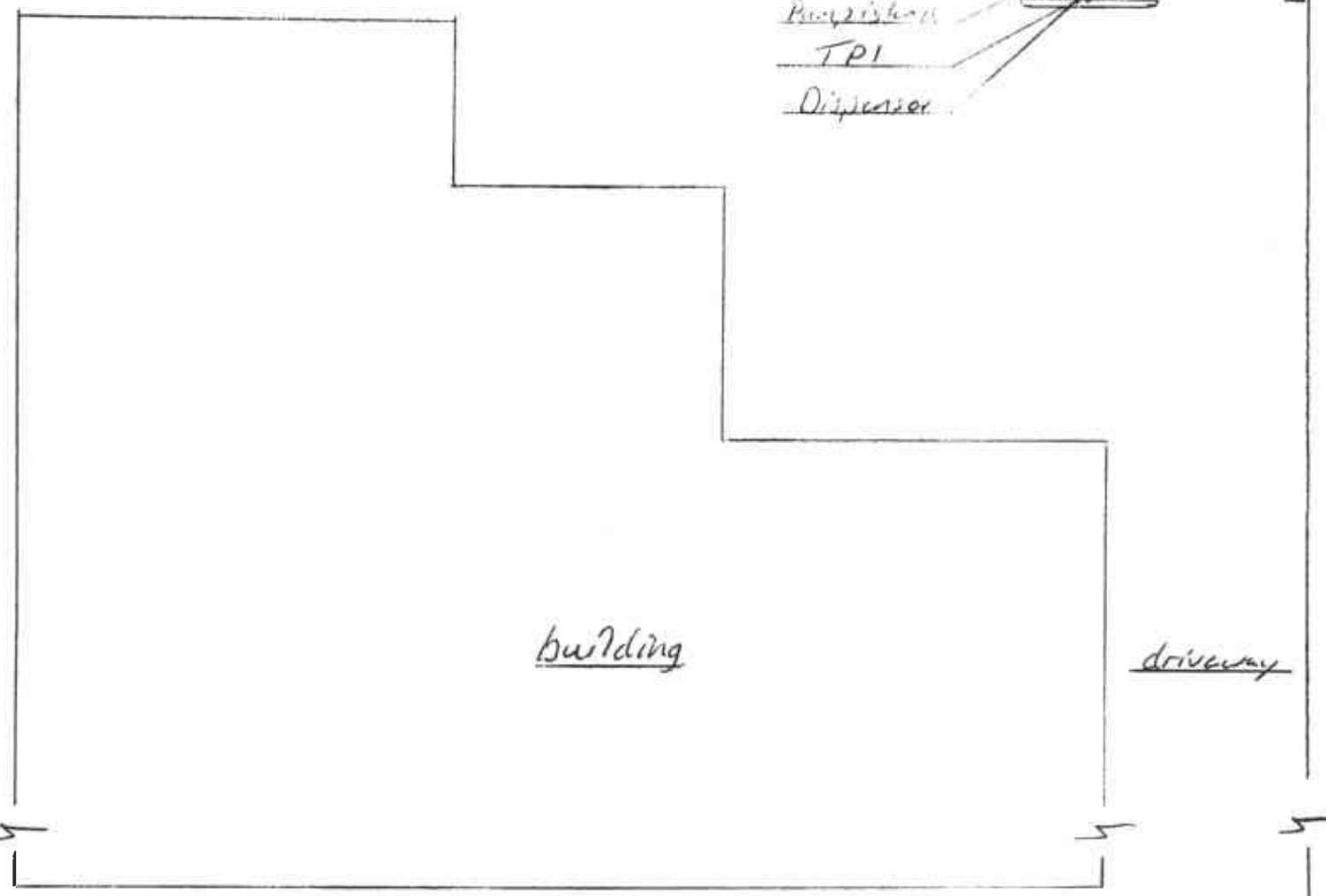
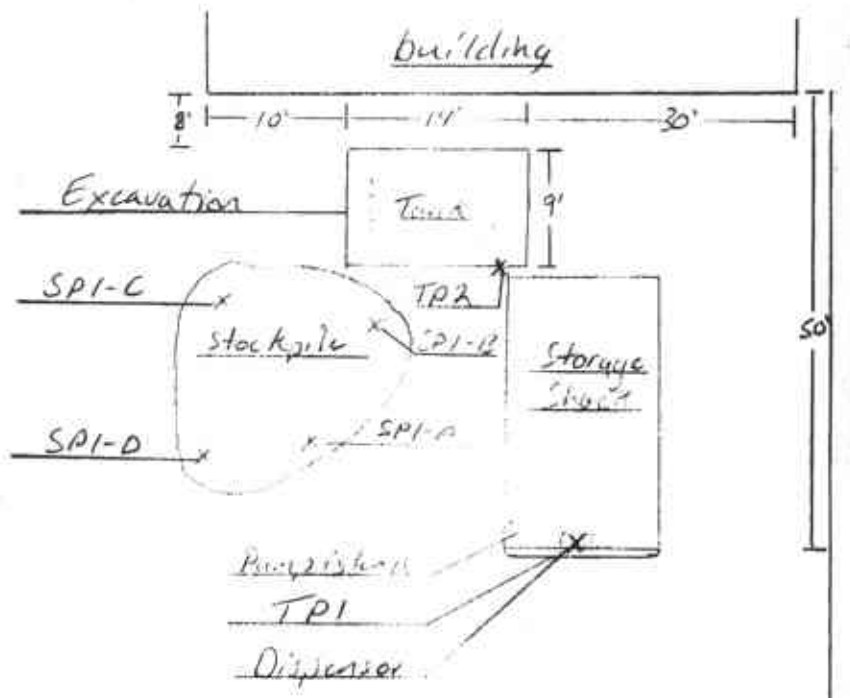

Parking Lot

66th Ave

**ANALYSES /  
CHAIN-OF-CUSTODY**



W.A. Craig, Inc. P.O. Box 448 Napa, CA 94559	Client Project ID: # 3471; Pacific Electric Motor Co.	Date Sampled: 02/16/95
		Date Received: 02/17/95
	Client Contact: Bill Craig	Date Extracted: 02/17/95
	Client P.O.:	Date Analyzed: 02/18/95

**Gasoline Range (C6-C12) Volatile Hydrocarbons as Gasoline\*, with BTEX\***

EPA methods 5030, modified 8015, and 8020 or 602; California RWQCB (SF Bay Region) method GCFID(5030)

Lab ID	Client ID	Matrix	TPH(g) <sup>+</sup>	Benzene	Toluene	Ethylbenzene	Xylenes	% Rec. Surrogate
50359	TP1	S	33,b,d	0.045	0.039	0.22	0.74	90
50360	TP2	S	500,a	0.54	6.6	7.3	33	93
50361	SP1A-D	S	10,000,a	73	770	250	1400	93
Detection Limit unless otherwise stated; ND means Not Detected	W	50 ug/L	0.5	0.5	0.5	0.5	0.5	
	S	1.0 mg/kg	0.005	0.005	0.005	0.005	0.005	

\*water samples are reported in ug/L, soil samples in mg/kg, and all TCLP extracts in mg/L

# cluttered chromatogram; sample peak co-elutes with surrogate peak

+ The following descriptions of the TPH chromatogram are cursory in nature and McCampbell Analytical is not responsible for their interpretation: a) unmodified or weakly modified gasoline is significant; b) heavier gasoline range compounds are significant(aged gasoline?); c) lighter gasoline range compounds (the most mobile fraction) are significant; d) gasoline range compounds are significant; no recognizable pattern; e) TPH pattern that does not appear to be derived from gasoline (?); f) one to a few isolated peaks present; g) strongly aged gasoline or diesel range compounds are significant; h) lighter than water immiscible phase is present.

## QC REPORT FOR HYDROCARBON ANALYSES

Date: 02/18/95

Matrix: Soil

Analyte	Concentration (mg/kg)			Amount Spiked	% Recovery		
	Sample	MS	MSD		MS	MSD	RPD
TPH (gas)	0.000	1.977	1.964	2.03	97	97	0.7
Benzene	0.000	0.176	0.178	0.2	88	89	1.1
Toluene	0.000	0.180	0.184	0.2	90	92	2.2
Ethylbenzene	0.000	0.184	0.188	0.2	92	94	2.2
Xylenes	0.000	0.566	0.560	0.6	94	93	1.1
TPH (diesel)	0	310	318	300	103	106	2.6
TRPH (oil & grease)	N/A	N/A	N/A	N/A	N/A	N/A	N/A

$$\% \text{ Rec.} = (\text{MS} - \text{Sample}) / \text{amount spiked} \times 100$$

$$\text{RPD} = (\text{MS} - \text{MSD}) / (\text{MS} + \text{MSD}) \times 2 \times 100$$



# PERMITS

BARNEY CHAN

2/7/95 OK Belan

Needs:

- ✓ ① Complete Refund Receipt form
  - ✓ ② Correct signature page (Contractor must sign)
  - ③ Add. Checklist
- Pls notify at least 72 working hours prior to removal.

ALAMEDA COUNTY HEALTH CARE SERVICES AGENCY  
 DEPARTMENT OF ENVIRONMENTAL HEALTH  
 HAZARDOUS MATERIALS DIVISION

1131 HARBOR BAY PARKWAY, STE 250  
 ALAMEDA, CA 94502-6577  
 TELE: (510) 567-6700  
 FAX: (510) 337-9335

ACCEPTED  
 DEPARTMENT OF ENVIRONMENTAL HEALTH  
 470 - 27th Street, Third Floor  
 Oakland, CA 94612  
 Telephone: (415) 874-7237

These plans have been reviewed and found to be acceptable and essentially meet the requirements of State and local health laws. Changes to your plans indicated by this Department are to assure compliance with State and local laws. The project proposed herein is now released for issuance of any required building permits for construction.

Any change or alterations of these plans and specifications must be submitted to this Department and to the Fire and Building Safety Department to determine if such changes are acceptable.

Approval of Tank and Piping  
 Sampling  
 Final Inspection

It is the responsibility of the contractor to comply with all applicable laws and regulations. THIS IS A FINANCIAL PENALTY FOR NOT OBTAINING THESE PERMITS.

UNDERGROUND TANK CLOSURE PLAN

\*\*\* Complete according to attached instructions \*\*\*

1. Business Name Pacific Electric Motor Co.  
 Business Owner \_\_\_\_\_

2. Site Address 1009 - 66th Avenue  
 City Oakland Zip 94621 Phone 510/569-7621

3. Mailing Address SAME  
 City \_\_\_\_\_ Zip \_\_\_\_\_ Phone \_\_\_\_\_

4. Land Owner \_\_\_\_\_  
 Address \_\_\_\_\_ City, State \_\_\_\_\_ Zip \_\_\_\_\_

5. Generator name under which tank will be manifested \_\_\_\_\_  
Pacific Electric Motor Co.

EPA I.D. No. under which tank will be manifested CAC 001007720

**PERMIT**

**Permit Issued To**

(Insert Employer's Name, Address and Telephone No.)

W. A. Craig, Inc.  
 PO Box 448  
 Napa, CA 94559  
 (707) 252-3353

No. HO

Date 12/4/94

Region 1

District 5

Tel. (707) 576-2388

Type of Permit T1 Annual - Trench and/or Excavation

Pursuant to Labor Code Sections 6500 and 6502, this Permit is issued to the above-named employer for the projects described below.

State Contractor's License Number <u>455752</u>		Permit Valid through <u>12/31/95</u>		
Description of Project	Location Address	City and County	Anticipated Dates	
			Starting	Completion
Various	Statewide		1/1/95	12/31/95

**This Permit is issued upon the following conditions:**

1. That the work is performed by the same employer. If this is an annual permit the appropriate District Office shall be notified, in writing, of dates and location of job site prior to commencement.
2. That employer will comply with all occupational safety and health standards or orders applicable to the above projects, and any other lawful orders of the Division.
3. That if any unforeseen condition causes deviation from the plans or statements contained in the Permit Application Form the employer will notify the Division immediately.
4. Any variation from the specification and assertions of the Permit Application Form or violation of safety orders may be cause to revoke the permit.
5. This permit shall be posted at or near each place of employment as provided in 8 CAC 341.4.

Received From <u>Leland Yialelis</u>		Received By <u>R. Low</u>	
<input type="checkbox"/> Cash	Amount	Date	
<input checked="" type="checkbox"/> Check 933	<u>\$100.00</u>	<u>12/4/94</u>	

Investigated by \_\_\_\_\_  
Safety Engr. Date

Approved by [Signature]  
Dist. Manager Date 12-5-94

Excavation Permit Granted \_\_\_\_\_ No. \_\_\_\_\_

# CITY OF OAKLAND

Tank Permit

## Permit to Excavate and Install, Repair, or Remove Inflammable Liquid Tanks. No. 9903

Oakland, California, February 17, 19 95

PERMISSION IS HEREBY GRANTED TO ~~XXXXX~~ remove ~~XXXXX~~ Gasoline tank and excavate commencing \_\_\_\_\_ feet inside property line

on the \_\_\_\_\_ side of \_\_\_\_\_ Street Avenue \_\_\_\_\_ feet \_\_\_\_\_ of \_\_\_\_\_ Street Avenue

House No. 1009 - 66th Avenue Street Avenue Present Storage \_\_\_\_\_

Owner Pacific Electric Motor Company Address same Phone 569-7621

Applicant W. A. Craig, Inc. Address P. O. Box 448 Napa 94559-0448 Phone 707-252-3353

Dimensions of street (sidewalk) surface to be disturbed \_\_\_\_\_ X \_\_\_\_\_ Number of Tanks 1 Capacity 2000 Gallons, each.

Remarks: \_\_\_\_\_

This Permit is granted in accordance with existing City Ordinances.  
 Owner hereby agrees to remove tanks on discontinuance of use or when notified by the City Authorities.  
 When installing, removing or repairing tanks, no open flame to be on or near premises.

Approved \_\_\_\_\_ Fire Marshal

Approved \_\_\_\_\_ Drainage Division Engineering Dept.

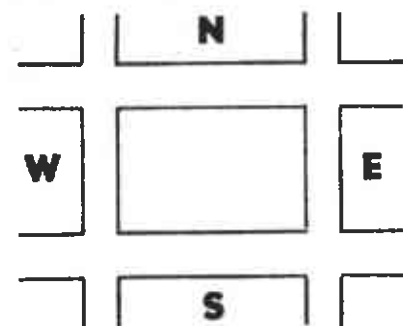

### EXCAVATING PERMIT

Issued in accordance with Ord. No. 278 CMS, Sec. 6-2.04

\_\_\_\_\_ square feet of digging or removal granted.

The receipt of \$ \_\_\_\_\_ special deposit is hereby acknowledged.

**GENERAL DEPOSIT.**

**BUREAU OF PERMITS AND LICENSES.**

### CERTIFICATE OF TANK AND EQUIPMENT INSPECTION

Inspected and passed on \_\_\_\_\_ 19 \_\_\_\_\_

By \_\_\_\_\_ Fire Marshal

Inspection Fee Paid - - - - - \$ 150.00 ck#5776 rec#713887

Received by D. Clemons  
FIRE PREVENTION BUREAU

### NOTICE

**Before Covering Tanks, Above Certificate Must Be Signed.**

When ready for inspection notify Fire Prevention Bureau. 273-3851

**THIS PERMIT MUST BE LEFT ON THE WORK AS AUTHORITY THEREFOR.**



# BAY AREA AIR QUALITY MANAGEMENT DISTRICT

939 ELLIS STREET  
SAN FRANCISCO CALIFORNIA 94109  
(415) 771-6000

REGULATION 8, RULE 40  
Aeration of Contaminated Soil and  
Removal of Underground Storage Tanks

## NOTIFICATION FORM

Removal or Replacement of Tanks  
 Excavation of Contaminated Soil

### SITE INFORMATION

SITE ADDRESS 1009 - 66th Avenue  
CITY, STATE Oakland, California ZIP 94621-3535

OWNER NAME \_\_\_\_\_

SPECIFIC LOCATION OF PROJECT See following site map

#### TANK REMOVAL

#### CONTAMINATED SOIL EXCAVATION

SCHEDULED STARTUP DATE 2/14/95

SCHEDULED STARTUP DATE ~~2/22/95~~ 4/4/95

*NEW START DATE*

VAPORS REMOVED BY:

STOCKPILES WILL BE COVERED? YES \_\_\_\_\_ NO \_\_\_\_\_

WATER WASH

ALTERNATIVE METHOD OF AERATION (DESCRIBE BELOW):  
\_\_\_\_\_

VAPOR FREEING (CO<sup>2</sup>)

VENTILATION

(MAY REQUIRE PERMIT)

### CONTRACTOR INFORMATION

NAME W. A. Craig, Inc. CONTACT Leland Yialelis  
ADDRESS P. O. Box 448 PHONE (707) 252-3353  
CITY, STATE, ZIP Napa, California 94559

### CONSULTANT INFORMATION

(IF APPLICABLE)

NAME \_\_\_\_\_ CONTACT \_\_\_\_\_  
ADDRESS \_\_\_\_\_ PHONE ( ) \_\_\_\_\_  
CITY, STATE, ZIP \_\_\_\_\_

### FOR OFFICE USE ONLY

DATE RECEIVED FAX \_\_\_\_\_ BY \_\_\_\_\_

(init.)

DATE POSTMARKED \_\_\_\_\_ BY \_\_\_\_\_

(init.)

CC: INSPECTOR NO. \_\_\_\_\_ DATE \_\_\_\_\_ BY \_\_\_\_\_

(init.)

UPDATE: CONTACT NAME \_\_\_\_\_ DATE \_\_\_\_\_ BY \_\_\_\_\_

(init.)

BAAQMD N # \_\_\_\_\_ DATA ENTRY \_\_\_\_\_





STATE OF CALIFORNIA  
STATE WATER RESOURCES CONTROL BOARD  
**UNDERGROUND STORAGE TANK PERMIT APPLICATION - FORM B**



COMPLETE A SEPARATE FORM FOR EACH TANK SYSTEM

MARK ONLY ONE ITEM	<input type="checkbox"/> 1 NEW PERMIT	<input type="checkbox"/> 3 RENEWAL PERMIT	<input type="checkbox"/> 5 CHANGE OF INFORMATION	<input type="checkbox"/> 7 PERMANENTLY CLOSED ON SITE
	<input type="checkbox"/> 2 INTERIM PERMIT	<input type="checkbox"/> 4 AMENDED PERMIT	<input type="checkbox"/> 6 TEMPORARY TANK CLOSURE	<input checked="" type="checkbox"/> 8 TANK REMOVED

DBA OR FACILITY NAME WHERE TANK IS INSTALLED: PACIFIC ELECTRIC MOTOR CO.

**I. TANK DESCRIPTION** COMPLETE ALL ITEMS - SPECIFY IF UNKNOWN

A. OWNER'S TANK I.D. # <u>#1</u>	B. MANUFACTURED BY: <u>unknown</u>
C. DATE INSTALLED (MO/DAY/YEAR) <u>approx. 1974</u>	D. TANK CAPACITY IN GALLONS: <u>2,000</u>

**II. TANK CONTENTS** IF A-1 IS MARKED, COMPLETE ITEM C.

A. <input checked="" type="checkbox"/> 1 MOTOR VEHICLE FUEL	4 OIL	B. <input checked="" type="checkbox"/> 1 PRODUCT	C. <input checked="" type="checkbox"/> 1a REGULAR UNLEADED	3 DIESEL	8 AVIATION GAS
<input type="checkbox"/> 2 PETROLEUM	<input type="checkbox"/> 80 EMPTY	<input type="checkbox"/> 2 WASTE	<input type="checkbox"/> 1b PREMIUM UNLEADED	<input type="checkbox"/> 4 GASAHOL	<input type="checkbox"/> 7 METHANOL
<input type="checkbox"/> 3 CHEMICAL PRODUCT	<input type="checkbox"/> 95 UNKNOWN		<input type="checkbox"/> 2 LEADED	<input type="checkbox"/> 5 JET FUEL	
D. IF (A 1) IS NOT MARKED, ENTER NAME OF SUBSTANCE STORED _____ C. A. S. #: _____					

**III. TANK CONSTRUCTION** MARK ONE ITEM ONLY IN BOXES A, B, AND C, AND ALL THAT APPLIES IN BOX D AND E

A. TYPE OF SYSTEM	3 SINGLE WALL WITH EXTERIOR LINER	95 UNKNOWN
<input checked="" type="checkbox"/> 2 SINGLE WALL	<input type="checkbox"/> 4 SECONDARY CONTAINMENT (VAULTED TANK)	<input type="checkbox"/> 99 OTHER
B. TANK MATERIAL (Primary Tank)	2 STAINLESS STEEL	3 FIBERGLASS
<input checked="" type="checkbox"/> 1 BARE STEEL	<input type="checkbox"/> 6 POLYVINYL CHLORIDE	<input type="checkbox"/> 7 ALUMINUM
<input type="checkbox"/> 5 CONCRETE	<input type="checkbox"/> 10 GALVANIZED STEEL	<input type="checkbox"/> 95 UNKNOWN
<input type="checkbox"/> 9 BRONZE		<input type="checkbox"/> 99 OTHER
C. INTERIOR LINING	2 ALKYD LINING	3 EPOXY LINING
<input type="checkbox"/> 1 RUBBER LINED	<input type="checkbox"/> 6 UNLINED	<input checked="" type="checkbox"/> 95 UNKNOWN
<input type="checkbox"/> 5 GLASS LINING		<input type="checkbox"/> 99 OTHER
IS LINING MATERIAL COMPATIBLE WITH 100% METHANOL? YES ___ NO ___		
D. CORROSION PROTECTION	2 COATING	3 VINYL WRAP
<input type="checkbox"/> 1 POLYETHYLENE WRAP	<input type="checkbox"/> 91 NONE	<input checked="" type="checkbox"/> 95 UNKNOWN
<input type="checkbox"/> 5 CATHODIC PROTECTION		<input type="checkbox"/> 99 OTHER
E. SPILL AND OVERFILL	SPILL CONTAINMENT INSTALLED (YEAR) <u>unknown</u>	OVERFILL PREVENTION EQUIPMENT INSTALLED (YEAR) <u>unknown</u>

**IV. PIPING INFORMATION** CIRCLE A IF ABOVE GROUND OR U IF UNDERGROUND, BOTH IF APPLICABLE

A. SYSTEM TYPE	2 PRESSURE	3 GRAVITY	99 OTHER <u>unknown</u>
<input type="checkbox"/> 1 SUCTION	<input type="checkbox"/> 4 LINED TRENCH	<input type="checkbox"/> 95 UNKNOWN	<input type="checkbox"/> 99 OTHER
B. CONSTRUCTION	2 DOUBLE WALL	3 LINED TRENCH	95 UNKNOWN
<input type="checkbox"/> 1 SINGLE WALL	<input type="checkbox"/> 6 CONCRETE	<input type="checkbox"/> 7 STEEL W/ COATING	<input type="checkbox"/> 8 100% METHANOL COMPATIBLE W/FRP
C. MATERIAL AND CORROSION PROTECTION	6 CONCRETE	7 STEEL W/ COATING	8 100% METHANOL COMPATIBLE W/FRP
<input type="checkbox"/> 1 BARE STEEL	<input type="checkbox"/> 10 CATHODIC PROTECTION	<input checked="" type="checkbox"/> 95 UNKNOWN	<input type="checkbox"/> 99 OTHER
<input type="checkbox"/> 5 ALUMINUM			
<input type="checkbox"/> 9 GALVANIZED STEEL			
D. LEAK DETECTION	2 LINE TIGHTNESS TESTING	3 INTERSTITIAL MONITORING	99 OTHER <u>unknown</u>
<input type="checkbox"/> 1 AUTOMATIC LINE LEAK DETECTOR		<input checked="" type="checkbox"/> 99 OTHER	

**V. TANK LEAK DETECTION**

1 VISUAL CHECK	2 INVENTORY RECONCILIATION	3 VADOZE MONITORING	4 AUTOMATIC TANK GAUGING
<input type="checkbox"/>	<input type="checkbox"/>	<input type="checkbox"/>	<input type="checkbox"/>
5 GROUND WATER MONITORING	6 TANK TESTING	7 INTERSTITIAL MONITORING	91 NONE
<input type="checkbox"/>	<input type="checkbox"/>	<input type="checkbox"/>	<input checked="" type="checkbox"/> 95 UNKNOWN
			<input type="checkbox"/> 99 OTHER

**VI. TANK CLOSURE INFORMATION**

1. ESTIMATED DATE LAST USED (MO/DAY/YR) <u>Dec. 31, 1994</u>	2. ESTIMATED QUANTITY OF SUBSTANCE REMAINING <u>unknown</u> GALLONS	3. WAS TANK FILLED WITH INERT MATERIAL? YES <input type="checkbox"/> NO <input checked="" type="checkbox"/>
---	---	---

THIS FORM HAS BEEN COMPLETED UNDER PENALTY OF PERJURY, AND TO THE BEST OF MY KNOWLEDGE, IS TRUE AND CORRECT

APPLICANT'S NAME (PRINTED & SIGNATURE) Lebond Yalchis Lebond Yalchis DATE 1-16-95

**LOCAL AGENCY USE ONLY** THE STATE I.D. NUMBER IS COMPOSED OF THE FOUR NUMBERS BELOW

STATE I.D.#	COUNTY #	JURISDICTION #	FACILITY #	TANK #
<input type="text"/>	<input type="text"/>	<input type="text"/>	<input type="text"/>	<input type="text"/>
PERMIT NUMBER	PERMIT APPROVED BY/DATE		PERMIT EXPIRATION DATE	

**MANIFESTS/CERTIFICATES OF  
DISPOSAL**

# ENVIRONMENTAL WEST CORPORATION

13331 N. Hwy 33 / P.O. Box 1167  
 Patterson, CA 95363  
 (209) 892-6742 / (800) 874-4444

93605863  
 STATE MANIFEST # \_\_\_\_\_  
 USED OIL HAULER # 86-050  
 EPA # CAD083166728  
 HAZARDOUS WASTE  
 HAULER REG # 2591



72.75

[ ]

INTERVAL

2 - 14 - 95

DATE

INV. # 87754

CUSTOMER	NAME <u>WA CRAIG</u>	BILLING ADDRESS IF DIFFERENT	DRIVER <u>RS</u>	TRUCK # <u>50</u>
	ADDRESS <u>1009 66th</u>	CITY STATE ZIP <u>SAME</u>	CASH	
	CITY STATE ZIP <u>OAKLAND</u>		NET 10 DAY	
	PHONE <u>707 252-3353</u>		PO #	

• PLEASE PAY FROM THIS INVOICE •

PRODUCT	GALLONS	HOURS	RATE	AMOUNT
HAZARDOUS WASTE OIL	<u>215</u>			
TEST FEE				
HAZARDOUS WASTE				
HOURLY CHARGES				
certify amount shown above to be correct				
<u>[Signature]</u> (Customer Signature)		<u>[Signature]</u> (Driver Signature)		
PAYMENT DUE UPON RECEIPT OF INVOICE. A service charge of 1½% per month shall be charged on all past due accounts. In the event this account becomes delinquent and it is necessary to institute legal proceedings, purchaser agrees to pay reasonable attorney's fee and court costs.				TOTAL CHARGES

RSINVMMP91      WHITE: Customer      CANARY: Alphabetical      PINK: Numeric      GOLDENROD: File

IN CASE OF EMERGENCY OR SPILL, CALL THE NATIONAL RESPONSE CENTER 1-800-424-8802; WITHIN CALIFORNIA, CALL 1-800-852-7550  
 92481064  
 GENERATOR  
 TRANSPORTER  
 FACILITY

<b>UNIFORM HAZARDOUS WASTE MANIFEST</b>		Generator's US EPA ID No. <u>CAE00V1007720000757</u>		Manifest Document 2. Page 1 of 1		Information in the shaded areas is not required by Federal law.									
3. Generator's Name and Mailing Address <u>Pac: Pac Electric Motor Co 1009-66th Avenue - Oakland, California</u>				A. State Manifest Document Number <u>93481064</u>											
4. Generator's Phone <u>(510) 569-7621</u>				B. State Generator's ID											
5. Transporter 1 Company Name <u>Dexanna, Ltd.</u>				C. State Transporter's ID <u>428262</u>											
6. US EPA ID Number <u>C A D 9 3 2 4 3 3 5 5 5</u>				D. Transporter's Phone <u>(510) 687-1292</u>											
7. Transporter 2 Company Name				E. State Transporter's ID											
8. US EPA ID Number				F. Transporter's Phone											
9. Designated Facility Name and Site Address <u>Erickson, Inc. - 255 Parr Blvd. Richmond, California 94801</u>				G. State Facility's ID <u>C A D 0 0 9 4 6 6 3 9 2</u>											
10. US EPA ID Number <u>C A D 0 0 9 4 5 5 3 9 2</u>				H. Facility's Phone <u>(510) 235-1393</u>											
11. US DOT Description (including Proper Shipping Name, Hazard Class, and ID Number)						12. Containers	13. Total Quantity	14. Unit Wt./Vol	I. Waste Number						
a. Waste Empty Storage Tank NON-RCRA Hazardous Waste Solid.						No.	Type			State					
															EPA/Other
															State
															EPA/Other
															State
										EPA/Other					
17. Additional Descriptions for Materials Listed Above <u>Qty. 1 Empty Storage Tank # 15344. Tank has been inerted with 15 lbs. DRY ICE per 1000 gallons capacity.</u>						K. Handling Codes for Wastes Listed Above									
						a.	b.								
						c.	d.								
15. Special Handling Instructions and Additional Information Keep away from sources of ignition. Always wear hardhats when working around U.S.T.'s. - Site Location: <u>1009-66th Ave - Oakland California</u> 24 Hr. Contact Name: <u>Terry Knox</u> & Phone # <u>(510) 569-7621</u>															
16. GENERATOR'S CERTIFICATION: I hereby declare that the contents of this consignment are fully and accurately described above by proper shipping name and are classified, packed, marked, and labeled, and are in all respects in proper condition for transport by highway according to applicable international and national government regulations.  If I am a large quantity generator, I certify that I have a program in place to reduce the volume and toxicity of waste generated to the degree I have determined to be economically practicable and that I have selected the practicable method of treatment, storage, or disposal currently available to me which minimizes the present and future threat to human health and the environment; OR, if I am a small quantity generator, I have made a good faith effort to minimize my waste generation and select the best waste management method that is available to me and that I can afford.															
Printed/Typed Name <u>TERRY M. KNOX</u>				Signature <u>Terry M. Knox</u>				Month Day Year <u>02/16/95</u>							
17. Transporter 1 Acknowledgement of Receipt of Materials															
Printed/Typed Name <u>James R. Cox</u>				Signature <u>James R. Cox</u>				Month Day Year <u>02/16/95</u>							
18. Transporter 2 Acknowledgement of Receipt of Materials															
Printed/Typed Name				Signature				Month Day Year							
19. Discrepancy Indication Space															
20. Facility Owner or Operator Certification of receipt of hazardous materials covered by this manifest except as noted in Item 19.															
Printed/Typed Name <u>DAVE SATO</u>				Signature <u>DAVE SATO</u>				Month Day Year <u>02/16/95</u>							

DO NOT WRITE BELOW THIS LINE.

DAY OR NIGHT  
TELEPHONE  
(510) 235-1393

# CERTIFICATE CERTIFIED SERVICES COMPANY

255 Parr Boulevard • Richmond, California 94801

## NO. 19400

CUSTOMER
DEXANNA
JOB NO.
165150

FOR: ERICKSON, INC. TANK NO. 15344

LOCATION: RICHMOND DATE: 05/02/21 TIME: 11:17

TEST METHOD VISUAL GASTECH/1314 SMPN LAST PRODUCT UG

This is to certify that I have personally determined that this tank is in accordance with the American Petroleum Institute and have found the condition to be in accordance with its assigned designation. This certificate is based on conditions existing at the time the inspection herein set forth was completed and is issued subject to compliance with all qualifications and instructions.

TANK SIZE 1000 GALLON TANK CONDITION SAFE FOR FIRE

REMARKS: OXYGEN 20.9% LOWER EXPLOSIVE LIMIT LESS THAN 10.1%  
ERICKSON, INC. HEREBY CERTIFIES THAT THE ABOVE NUMBERED TANK HAS BEEN  
CUT OPEN, PROCESSED, AND THEREFORE DESTROYED AT OUR PERMITTED HAZARDOUS  
WASTE FACILITY.  
ERICKSON, INC. HAS THE APPROPRIATE PERMITS FOR, AND HAS ACCEPTED THE TANK  
SHIPPED TO US FOR PROCESSING.

In the event of any physical or atmospheric changes affecting the gas-free conditions of the above tanks, or if in any doubt, immediately stop all hot work and contact the undersigned. This permit is valid for 24 hours if no physical or atmospheric changes occur.

### STANDARD SAFETY DESIGNATION

**SAFE FOR MEN:** Means that in the compartment or space so designated (a) The oxygen content of the atmosphere is at least 19.5 percent by volume, and that (b) Toxic materials in the atmosphere are within permissible concentrations; and (c) In the judgment of the Inspector, the residues are not capable of producing toxic materials under existing atmospheric conditions while maintained as directed on the Inspector's certificate.

**SAFE FOR FIRE:** Means that in the compartment so designated (a) The concentration of flammable materials in the atmosphere is below 10 percent of the lower explosive limit; and that (b) In the judgment of the Inspector, the residues are not capable of producing a higher concentration that permitted under existing atmospheric conditions in the presence of fire and while maintained as directed on the Inspector's certificate, and further, (c) All adjacent spaces have either been cleaned sufficiently to prevent the spread of fire, are satisfactorily inerted, or in the case of fuel tanks, have been treated as deemed necessary by the Inspector.

The undersigned representative acknowledges receipt of this certificate and understands the conditions and limitations under which it was issued.

REPRESENTATIVE

TITLE

INSPECTOR

# LICENSES / INSURANCE

CONTRACTORS STATE LICENSE BOARD

No. 455742

*Building Quality*

ISSUED 04-24-84

This license is the property of the Registrar of Contractors, is not transferable, and shall be returned to the Registrar upon demand when suspended, revoked, or invalidated for any reason. It becomes void if not renewed.

# Contractor's License

Pursuant to the provisions of Chapter 9 of Division 3 of the Business and Professions Code and the Rules and Regulations of the Contractors State License Board, the Registrar of Contractors does hereby issue this license to:

CRAIG W A INC

to engage in the business or act in the capacity of a contractor in the following classification(s):  
A GENERAL ENGINEERING CONTRACTOR

WITNESS my hand and sealed this  
1ST day of MAY 1984.



STATE AND CONSUMER SERVICES AGENCY  
DEPARTMENT OF CONSUMER AFFAIRS

*J. H. Mabrey*  
Registrar of Contractors

*[Signature]*  
Signature of Licensee  
*[Signature]*  
Signature of person who qualified  
on behalf of the licensee



STATE OF CALIFORNIA  
STATE AND CONSUMER SERVICES AGENCY CONTRACTORS STATE LICENSE BOARD

DEPARTMENT OF  
**Consumer  
Affairs**

*Building Quality*



## HAZARDOUS SUBSTANCES REMOVAL AND REMEDIAL ACTIONS CERTIFICATION

Pursuant to the provisions of Section 7058.7 of the Business and Professions Code, the Registrar of Contractors does hereby certify that the following qualifying person has successfully completed the hazardous substances removal and remedial actions examination.



Qualifier: WILLIAM ALEXANDER CRAIG II

License No.: 455752

Namestyle: W. A. CRAIG, INC.

WITNESS my hand and official seal this  
6 day of SEPTEMBER, 1988

*J. M. Aloney*  
Registrar of Contractors

13L-36 (1/88)

This certification is the property of the Registrar of Contractors, is not transferable, and shall be returned to the Registrar upon demand when suspended, revoked, or invalidated for any reason.

A1571



State of California  
CONTRACTORS STATE LICENSE BOARD  
ACTIVE LICENSE



License Number **455752**

Entity **CORP**

Business Name **W A CRAIG INC**

Classification **A HAZ B**

Expiration Date **04/30/96**



State of California  
California Environmental Protection Agency  
P. O. Box 2815  
Sacramento, CA 95812

REGISTERED ENVIRONMENTAL ASSESSOR



Issued to: *William A. Craig II*

Expires on: *June 30, 1995*

Signature

*William A. Craig II*

# ACORD. CERTIFICATE OF INSURANCE

ISSUE DATE (MM/DD/YY)  
3/24/1995

PRODUCER  
**Loggers & Young Insurance**  
58 Round Barn Blvd. Ste.#203  
Santa Rosa, CA 95403  
(707) 579-5200

THIS CERTIFICATE IS ISSUED AS A MATTER OF INFORMATION ONLY AND CONFERS NO RIGHTS UPON THE CERTIFICATE HOLDER. THIS CERTIFICATE DOES NOT AMEND, EXTEND OR ALTER THE COVERAGE AFFORDED BY THE POLICIES BELOW.

### COMPANIES AFFORDING COVERAGE

- COMPANY LETTER **A** Allied Insurance Company
- COMPANY LETTER **B** Admiral Insurance Company
- COMPANY LETTER **C** Golden Eagle
- COMPANY LETTER **D**
- COMPANY LETTER **E**

INSURED  
**W. A. Craig, Inc.**  
P. O. Box 448  
Eureka CA 95402-3100

COVERAGE  
THIS IS TO CERTIFY THAT THE POLICIES OF INSURANCE LISTED BELOW HAVE BEEN ISSUED TO THE INSURED NAMED ABOVE FOR THE POLICY PERIOD INDICATED, NOTWITHSTANDING ANY REQUIREMENT, TERM OR CONDITION OF ANY CONTRACT OR OTHER DOCUMENT WITH RESPECT TO WHICH THIS CERTIFICATE MAY BE ISSUED OR MAY PERTAIN, THE INSURANCE AFFORDED BY THE POLICIES DESCRIBED HEREIN IS SUBJECT TO ALL THE TERMS, EXCLUSIONS AND CONDITIONS OF SUCH POLICIES. LIMITS SHOWN MAY HAVE BEEN REDUCED BY PAID CLAIMS.

TYPE OF INSURANCE	POLICY NUMBER	POLICY EFFECTIVE DATE (MM/DD/YY)	POLICY EXPIRATION DATE (MM/DD/YY)	LIMITS
<b>GENERAL LIABILITY</b> <input checked="" type="checkbox"/> COMMERCIAL GENERAL LIABILITY CLAIMS MADE <input checked="" type="checkbox"/> OCCUR <input checked="" type="checkbox"/> OWNERS & CONTRACTOR'S PROT <input checked="" type="checkbox"/> \$2500 Ded/Clm	A04EG22273	07/29/94	07/29/95	GENERAL AGGREGATE \$ 1,000,000 PRODUCTS-COMP/OP AGG. \$ 1,000,000 PERSONAL <del>INJURY</del> INJURY \$ 1,000,000 EACH OCCURRENCE \$ 1,000,000 FIRE DAMAGE (Any one fire) \$ MED. EXPENSE (Any one person) \$
<b>AUTOMOBILE LIABILITY</b> <input checked="" type="checkbox"/> ANY AUTO <input checked="" type="checkbox"/> ALL OWNED AUTOS <input checked="" type="checkbox"/> SCHEDULED AUTOS <input checked="" type="checkbox"/> HIRED AUTOS <input checked="" type="checkbox"/> NON-OWNED AUTOS <input type="checkbox"/> GARAGE LIABILITY	ACP 78 0 0111258	07/25/94	07/25/95	COMBINED SINGLE LIMIT \$ 1,000,000 BODILY INJURY (Per person) \$ BODILY INJURY (Per accident) \$ PROPERTY DAMAGE \$
<b>CESS LIABILITY</b> <input type="checkbox"/> UMBRELLA FORM <input type="checkbox"/> OTHER THAN UMBRELLA FORM				EACH OCCURRENCE \$ AGGREGATE \$
<b>WORKER'S COMPENSATION AND EMPLOYERS' LIABILITY</b>	NWC254067-01	03/29/95	03/29/96	<input checked="" type="checkbox"/> STATUTORY LIMITS EACH ACCIDENT \$ 1,000,000 DISEASE - POLICY LIMIT \$ 1,000,000 DISEASE - EACH EMPLOYEE \$ 1,000,000

DESCRIPTION OF OPERATIONS/LOCATIONS/VEHICLES/SPECIAL ITEMS  
**Re: All California Operations.**

**CANCELLATION: EXCEPT FOR 10 DAY NOTICE FOR NON-PAYMENT OF PREMIUM OR NON-REPORT OF PAYROLL.**

CERTIFICATE HOLDER  
**W. A. Craig, Inc.**  
P. O. Box 448  
Eureka CA 94559

CANCELLATION  
SHOULD ANY OF THE ABOVE DESCRIBED POLICIES BE CANCELLED BEFORE THE EXPIRATION DATE THEREOF, THE ISSUING COMPANY WILL ENDEAVOR TO MAIL 30 DAYS WRITTEN NOTICE TO THE CERTIFICATE HOLDER NAMED TO THE LEFT, BUT FAILURE TO MAIL SUCH NOTICE SHALL IMPOSE NO OBLIGATION OR LIABILITY OF ANY KIND UPON THE COMPANY, ITS AGENTS OR REPRESENTATIVES.

AUTHORIZED REPRESENTATIVE  
*[Signature]*  
ACORD CORPORATION 1990