

## Khatri, Paresh, Env. Health

---

**From:** Goloubow, Ron [Ron.Goloubow@arcadis-us.com]  
**Sent:** Monday, March 01, 2010 3:19 PM  
**To:** Santos.Carmen@epamail.epa.gov; Wilson.Patrick@epamail.epa.gov; Khatri, Paresh, Env. Health  
**Cc:** Gibbs, Alan; Goldberg Day, Amy; Steph Wilson; Charles Robitaille; Goloubow, Ron  
**Subject:** Aspire Maps and Tables for Conference Call  
**Attachments:** Copy of Tables 2-9 Exc Conf sample results Jan10.pdf; Figures 1-4 1009 66th Ave.pdf

Carmen per our conversation last week I indicated that I would revised the site maps and summary tables to include data for samples that represents soil that is "in place" or not excavated. The attached map and tables provide that information. Please let me know if you have any questions or need any more information before our call Tuesday March 2 (tomorrow) at 10:30 AM.

Ron.

**Ron Goloubow, PG** | Senior Associate Geologist | [ron.goloubow@arcadis-us.com](mailto:ron.goloubow@arcadis-us.com)

**ARCADIS U.S., Inc.** | 1900 Powell Street, Suite 1200 | Emeryville, CA 94608  
T. 510.596.9550 | M. 510.501-1789 | F. 510.652.2246  
[www.arcadis-us.com](http://www.arcadis-us.com)

---

NOTICE: This e-mail and any files transmitted with it are the property of ARCADIS U.S., Inc. and its affiliates. All rights, including without limitation copyright, are reserved. The proprietary information contained in this e-mail message, and any files transmitted with it, is intended for the use of the recipient(s) named above. If the reader of this e-mail is not the intended recipient, you are hereby notified that you have received this e-mail in error and that any review, distribution or copying of this e-mail or any files transmitted with it is strictly prohibited. If you have received this e-mail in error, please notify the sender immediately and delete the original message and any files transmitted. The unauthorized use of this e-mail or any files transmitted with it is prohibited and disclaimed by ARCADIS U.S., Inc. and its affiliates. Nothing herein is intended to constitute the offering or performance of services where otherwise restricted by law.

**Table 1**  
**Analytical Results for Confirmation Soil Samples Collected**  
**from Excavation PCB1, PCBs and TPH**  
**Former Pacific Electric Motors Site**  
**1009 66th Avenue, Oakland, California**  
*concentrations in milligrams per kilogram (mg/kg)*

## PCB Excavation 1

Sample ID	Date	PCBs	TPHd	TPHmo
<i>EXC-PCB-1 W-SIDEWALL 2' NORTH 2</i>	<i>11/10/2009</i>	<i>&lt; 0.050</i>	NA	NA
<i>EXC-PCB-1 N-SIDEWALL 2' WEST 2</i>	<i>11/10/2009</i>	<i>0.069</i>	NA	NA
EXC-PCB-1 S-SIDEWALL 2' EAST	11/4/2009	<0.050	NA	NA
EXC-PCB-1 S-SIDEWALL 2' WEST	11/4/2009	<0.050	NA	NA
EXC-PCB-1 N-SIDEWALL 2' WEST	11/6/2009	<0.050	NA	NA
<i>EXC-PCB1 N-SDWALL-2'-EAST2</i>	<i>11/11/2009</i>	<i>&lt; 0.050</i>	NA	NA
EXC-PCB-1 E-SIDEWALL 2' NORTH	11/6/2009	<0.050	NA	NA
EXC-PCB-1 E-SIDEWALL 2' SOUTH	11/6/2009	<0.050	NA	NA
<i>EXC-PCB1 E-SDWALL-2'-NORTH2</i>	<i>11/11/2009</i>	<i>&lt; 0.050</i>	NA	NA
<i>EXC-PCB-1 NW2 BOTTOM 4'</i>	<i>11/10/2009</i>	<i>&lt; 0.050</i>	NA	NA
<i>EXC PCB1-NW-BOTTOM4'-R2</i>	<i>11/23/2009</i>	<i>&lt; 0.050</i>	NA	NA
EXC-PCB-1 NE BOTTOM 4'	11/6/2009	<0.050	NA	NA
<i>EXC-PCB1E-NE2-BOTTOM 4'</i>	<i>11/11/2009</i>	<i>&lt; 0.050</i>	NA	NA
<i>EXC-PCB1E-NE3-BOTTOM 4'</i>	<i>11/11/2009</i>	<i>&lt; 0.050</i>	NA	NA
EXC-PCB-1 CENTER BOTTOM 4'	11/6/2009	0.074	NA	NA
EXC-PCB-1 SW BOTTOM 4'	11/6/2009	0.058	NA	NA
EXC-PCB-1 SE BOTTOM 4'	11/6/2009	<0.050	NA	NA
<i>EXC TPH/PCB1-SW-BOTTOM6'-R2</i>	<i>11/23/2009</i>	<i>0.720</i>	NA	NA
<i>EXC TPH/PCB1 SE-BOTTOM 4'-R</i>	<i>11/17/2009</i>	<i>&lt; 0.050</i>	NA	NA
EXC TPH/PCB1 NW-BOTTOM 4'	11/17/2009	<0.050	NA	NA
EXC TPH/PCB1W-BOTTOM4'-R	11/24/2009	<0.050	NA	NA
<i>EXC TPH/PCB1 S-SDWALL2'-EAST-R</i>	<i>11/18/2009</i>	<i>&lt; 0.050</i>	NA	NA
<i>EXC TPH/PCB1 N-SDWALL2'-WEST-R</i>	<i>11/21/2009</i>	<i>&lt; 0.049</i>	<i>&lt; 1.0</i>	<i>&lt; 50</i>
<i>EXC TPH/PCB1 S-SDWALL2'-WEST-R</i>	<i>11/18/2009</i>	<i>&lt; 0.050</i>	<i>&lt; 0.99</i>	<i>&lt; 50</i>
<i>EXC TPH/PCB1 W-SDWALL2'-SOUTH-R2</i>	<i>11/24/2009</i>	<i>&lt; 0.050</i>	<i>0.99</i>	<i>&lt; 50</i>
<i>EXC TPH/PCB1W-SDWALL2'-NORTH-R</i>	<i>11/24/2009</i>	<i>&lt; 0.050</i>	<i>0.99</i>	<i>&lt; 50</i>
<b>REGULATORY CONCENTRATIONS</b>				
Soil Cleanup Goal		0.130	450	800

**Table 1**  
**Analytical Results for Confirmation Soil Samples Collected**  
**from Excavation PCB1, PCBs and TPH**  
**Former Pacific Electric Motors Site**  
**1009 66th Avenue, Oakland, California**  
*concentrations in milligrams per kilogram (mg/kg)*

**PCB Excavation 1**

Sample ID	Date	PCBs	TPHd	TPHmo
-----------	------	------	------	-------

**Notes:**

PCBs = polychlorinated biphenyls

NA = parameter not analyzed

Samples analyzed by TestAmerica Laboratories Inc. for PCBs using EPA Test method 8082.

Bold font denotes results above soil cleanup goal.

Italic font denotes results of sample collected at the location of "over-excavation" where analytical results were above cleanup goals.

\* Denotes the soil sample was collected approximately 3 feet below grade.

\*\* Sample mislabeled in the field; Sample actually collected from EXC-PCB1.

**Table 2**  
**Analytical Results for Confirmation Soil Samples Collected**  
**from Excavation PCB2, PCBs**  
**Former Pacific Electric Motors Site**  
**1009 66th Avenue, Oakland, California**  
*concentrations in milligrams per kilogram (mg/kg)*

**PCB Excavation 2**

Sample ID	Date	PCBs
EXC-PCB-2 W-SIDEWALL 2'	11/4/2009	<0.050
<i>EXC-PCB-2 E2-SIDEWALL 2'</i>	<i>11/10/2009</i>	<i>&lt;0.050</i>
EXC-PCB-2 SO-SIDEWALL 2'	11/4/2009	<0.050
EXC-PCB-2 N-SIDEWALL 2'	11/4/2009	<0.050
EXC-PCB-2 CENTER BOTTOM 4'	11/5/2009	<0.050
<b>REGULATORY CONCENTRATIONS</b>		
Soil Cleanup Goal		0.130

**Notes:**

PCBs = polychlorinated biphenyls

Samples analyzed by TestAmerica Laboratories Inc. for PCBs using EPA Test method 8160-PCB.

Bold font denotes results above soil cleanup goal.

Italic font denotes results of sample collected at the location of "over-excavation" where analytical results were above cleanup goals.

\* Denotes the soil sample was collected approximately 3 feet below grade.

**Table 3**  
**Analytical Results for Confirmation Soil Samples Collected**  
**from Excavation PCB3, PCBs, SVOCs, and Metals**  
**Former Pacific Electric Motors Site**  
**1009 66th Avenue, Oakland, California**  
*concentrations in milligrams per kilogram (mg/kg)*

**PCB Excavation 3**

Sample ID	Notes	Date	PCBs	benzo(a)pyrene	benzo(a)anthracene	benzo(k)fluoranthene	chrysene	naphthalene	Arsenic	Lead
EXC PCB3 N-BOTTOM4'		11/21/2009	<0.050	NA	NA	NA	NA	NA	NA	NA
EXC PCB3 S-BOTTOM4'		11/21/2009	<0.050	NA	NA	NA	NA	NA	NA	NA
EXC PCB3-SE-CORNER4'		11/23/2009	<0.049	<0.067	<0.33	<0.067	<0.067	<0.067	4.3	5.4
<i>EXC PCB3-NE-CORNER3'R1</i>		<i>12/8/2009</i>	<i>0.270</i>	NA	NA	NA	NA	NA	<b>7.1</b>	NA
EXC PCB3-E1-SDWALL2'R1		<i>12/8/2009</i>	<0.050	NA	NA	NA	NA	NA	<b>100</b>	NA
EXC PCB3-E2-SDWALL2'		11/23/2009	<0.050	<0.067	<0.33	<0.067	<0.067	<0.067	<3.8	5.4
EXC PCB3-NW-Corner 3'	1	11/23/2009	<b>0.550</b>	<0.067	<0.33	0.11	0.19	<0.067	<b>41</b>	12
EXC PCB3-SW-CORNER4'		11/23/2009	<0.050	<0.067	<0.33	<0.067	<0.067	<0.067	5.4	6.1
EXC PCB3-W1-SDWALL2'		11/23/2009	<b>0.210</b>	<0.066	<0.33	<0.066	<0.066	<0.066	<b>160</b>	12
EXC PCB3-W2-SDWALL2'	2	11/23/2009	<b>8.700</b>	<0.066	<0.33	<0.066	<0.066	<0.066	<b>61</b>	13
EXC PCB3-W3-SDWALL2'		11/23/2009	<0.050	<0.066	<0.33	<0.066	<0.066	<0.066	<b>9.2</b>	7.4
EXC PCB3-N-SDWALL2'		11/23/2009	<0.050	<0.067	<0.33	<0.067	<0.067	<0.067	<b>87</b>	48
EXC PCB3-N-SDWALL2'R1		<i>12/8/2009</i>	<0.050	NA	NA	NA	NA	NA	<b>27</b>	NA
EXC PCB3-S-SDWALL2'		11/23/2009	<0.049	<0.067	<0.33	<0.067	<0.067	<0.067	<b>62</b>	4.5
<b>REGULATORY CONCENTRATIONS</b>										
Soil Cleanup Goal			0.130	0.13	1.3	1.3	21	2.8	7	80

**Notes:**

Samples analyzed by TestAmerica Laboratories Inc. for PCBs using EPA Test method 8082.

Bold font denotes results above soil cleanup goal.

Italic font denotes results of sample collected at the location of "over-excavation" where analytical results were above cleanup goals.

PCBs = polychlorinated biphenyls

1 - Sample contained phenanthrene 0.088; fluoranthene 0.28; pyrene 0.28; benzo[b]fluoranthene 0.18; and benzo[a]pyrene 0.15

2 - Sample contained: pyrene 0.079; benzo(b) fluoranthene 0.013; and benzo[g,h,i]perylene 0.10

NA = parameter not analyzed

**Table 4**  
**Analytical Results for Confirmation Soil Samples Collected**  
**from Excavation PCB3, TPH and VOCs**  
**Former Pacific Electric Motors Site**  
**1009 66th Avenue, Oakland, California**  
*concentrations in milligrams per kilogram (mg/kg)*

**Excavation PCB3**

Sample ID	Date	TPHg	TPHmo	TPHd	Benzene	Toluene	Ethyl benzene	Total Xylenes	Ethylene Dibromid	1,2-DCA
EXC PCB3-NW-CORNER3'	11/23/2009	< 250	68	37	<0.0049	<0.0049	<0.0049	<0.0099	<0.0049	<0.0049
EXC PCB3-S-SDWALL2'	11/23/2009	< 250	< 50	16	<0.005	<0.005	<0.005	22	<0.005	<0.005
EXC PCB3-SE-CORNER4'	11/23/2009	< 240	< 50	4.6	<0.0048	<0.0048	<0.0048	<0.0098	<0.0048	<0.0048
EXC PCB3-NE-CORNER3'	11/23/2009	< 250	< 49	9.3	<0.0049	<0.0049	<0.0049	<0.0099	<0.0049	<0.0049
EXC PCB3-E1-SDWALL2'	11/23/2009	< 250	59	31	<0.0049	<0.0049	<0.0049	<0.0098	<0.0049	<0.0049
EXC PCB3-E2-SDWALL2'	11/23/2009	< 240	< 50	15	<0.0049	<0.0049	<0.0049	<0.0097	<0.0049	<0.0049
EXC PCB3-SW-CORNER4'	11/23/2009	< 240	< 49	<0.99	<0.0049	<0.0049	<0.0049	<0.0097	<0.0049	<0.0049
EXC PCB3-W1-SDWALL2'	11/23/2009	< 250	< 49	1.7	<0.005	<0.005	<0.005	<0.0099	<0.005	<0.005
EXC PCB3-W2-SDWALL2'	11/23/2009	< 250	< 50	12	<0.005	<0.005	<0.005	<0.010	<0.005	<0.005
EXC PCB3-N-SDWALL2'	11/23/2009	< 250	< 50	16	<0.005	<0.005	<0.005	<0.010	<0.005	<0.005
EXC PCB3-W3-SDWALL2'	11/23/2009	< 250	< 49	<0.99	<0.005	<0.005	<0.005	<0.010	<0.005	<0.005
<b>REGULATORY CONCENTRATIONS</b>										
Soil Cleanup Goal		450	800	450	0.27	NE	NE	NE	0.13	1.3

**Notes:**

TPHg = total petroleum hydrocarbons in the gasoline-range (C5-C12)

TPHd = total petroleum hydrocarbons in the diesel-range (C10-C28)

TPHmo = total petroleum hydrocarbons in the motor oil-range (C24-C36)

1,2-DCA = 1,2-dichloroethane, commonly known as ethylene dichloride (EDC)

NE = none established

Samples analyzed by TestAmerica Laboratories Inc. for TPHg, TPHd, and TPHmo by EPA test method 8015B; benzene, toluene, ethylbenzene, and total xylenes analyzed by EPA test method 8260A.

Bold font denotes results above soil cleanup goal.

Italic font denotes results of sample collected at the location of "over-excavation" where analytical results were above cleanup goals.

**Table 5**  
**Analytical Results for Confirmation Soil Samples Collected**  
**from Excavation PCB4, PCBs**  
**Former Pacific Electric Motors Site**  
**1009 66th Avenue, Oakland, California**  
*concentrations in milligrams per kilogram (mg/kg)*

**PCB Excavation 4**

Sample ID	Date	PCBs
EXC PCB4-N-SDWALL2'	11/21/2009	0.084
EXC-PCB4-N2-SDWALL2'	11/21/2009	<0.050
<i>EXC PCB4-S1-SDWALL2' R1</i>	<i>12/8/2009</i>	<i>0.230</i>
EXC-PCB4-S2-SDWALL2'	11/21/2009	<b>0.200</b>
<i>EXC PCB4-W-SDWALL2' R1</i>	<i>12/8/2009</i>	<i>0.066</i>
EXC PCB4-E-SDWALL2'	11/21/2009	0.120
EXC-PCB4-W-BOTTOM4'	11/21/2009	<b>0.170</b>
<i>EXC-PCB4-W-BOTTOM6' R1</i>	<i>12/8/2009</i>	<i>&lt;0.049</i>
EXC-PCB4-E-BOTTOM4'	11/21/2009	<0.049
<b>REGULATORY CONCENTRATIONS</b>		
Soil Cleanup Goal		0.130

**Notes:**

Samples analyzed by TestAmerica Laboratories Inc. for PCBs using EPA Test method 8160.

Bold font denotes results above soil cleanup goal.

Italic font denotes results of sample collected at the location of "over-excavation" where analytical results were above cleanup goals.

PCBs = polychlorinated biphenyls

**Table 6**  
**Analytical Results for Confirmation Soil Samples Collected**  
**from Excavation 4, TPH and VOCs**  
**Former Pacific Electric Motors Site**  
**1009 66th Avenue Oakland, California**  
*concentrations in milligrams per kilogram (mg/kg)*

**Excavation 4**

Sample ID	Date	TPHg	TPHmo	TPHd	Benzene	Toluene	Ethyl benzene	Total Xylenes	Ethylene Dibromid	1,2-DCA
EXC4-NORTH1-SDWALL1'	11/20/09	<0.240	<b>1,200</b>	320	<0.0049	<0.0049	<0.0049	<0.0097	<0.0049	<0.0049
<i>EXC4-25'NORTH1-SDWALL1</i>	<i>11/27/09</i>	<i>&lt;0.250</i>	<i>5.1</i>	<i>&lt;50</i>	<i>&lt;0.005</i>	<i>&lt;0.005</i>	<i>&lt;0.005</i>	<i>&lt;0.0099</i>	<i>&lt;0.005</i>	<i>&lt;0.005</i>
<i>EXC4-25'NORTH7-SDWALL1</i>	<i>11/27/09</i>	<i>&lt;0.250</i>	<i>990</i>	<i>&lt;250</i>	<i>9</i>	<i>9</i>	<i>9</i>	<i>&lt;0.0099</i>	<i>&lt;0.0049</i>	<i>&lt;0.0049</i>
EXC4-SOUTH2-SDWALL1'	11/20/09	1.3	<b>4,200</b>	<b>850</b>	0.012	0.0092	0.019	0.170	<0.0049	<0.0049
EXC4-SOUTH4-SDWALL1'	11/21/09	<0.250	15	150	<0.005	<0.005	<0.005	<0.010	<0.005	<0.005
EXC4-SOUTH5-SDWALL1'	11/21/09	<0.240	230	<b>2,400</b>	<0.0049	<0.0049	<0.0049	<0.0098	<0.0049	<0.0049
EXC4-SOUTH6-SDWALL1'	11/21/09	<0.250	53	490	<0.0049	<0.0049	<0.0049	<0.0098	<0.0049	<0.0049
EXC4-SOUTH7-SDWALL1'	11/21/09	<0.250	42	450	<0.0049	<0.0049	<0.0049	<0.0099	<0.0049	<0.0049
<i>EXC-4-SOUTH-4A-SDWALL</i>	<i>11/27/09</i>	<i>&lt;0.250</i>	<i>&lt;0.99</i>	<i>&lt;50</i>	<i>&lt;0.0049</i>	<i>&lt;0.0049</i>	<i>&lt;0.0049</i>	<i>&lt;0.0098</i>	<i>&lt;0.0049</i>	<i>&lt;0.0049</i>
<i>EXC-4-SOUTH-4B-SDWALL</i>	<i>11/27/09</i>	<i>&lt;0.240</i>	<i>&lt;0.99</i>	<i>&lt;49</i>	<i>&lt;0.0049</i>	<i>&lt;0.0049</i>	<i>&lt;0.0049</i>	<i>&lt;0.0097</i>	<i>&lt;0.0049</i>	<i>&lt;0.0049</i>
<i>EXC-4-SOUTH-4C-SDWALL</i>	<i>11/27/09</i>	<i>&lt;0.240</i>	<i>32</i>	<i>120</i>	<i>&lt;0.0049</i>	<i>&lt;0.0049</i>	<i>&lt;0.0049</i>	<i>&lt;0.0097</i>	<i>&lt;0.0049</i>	<i>&lt;0.0049</i>
EXC4-EAST1-SDWALL1'	11/21/09	<0.250	250	430	<0.005	<0.005	<0.005	<0.010	<0.005	<0.005
EXC4-EAST6-SDWALL1'	11/21/09	<0.240	350	<b>3,000</b>	<0.0047	<0.0047	<0.0047	<0.0094	<0.0047	<0.0047
EXC4-EAST7-SDWALL1'	11/21/09	<0.240	590	<b>3,100</b>	<0.0047	<0.0047	<0.0047	<0.0094	<0.0047	<0.0047
EXC4-EAST8-SDWALL1'	11/21/09	<0.250	17	<99	<0.005	<0.005	<0.005	<0.010	<0.005	<0.005
EXC4-EAST2--SDWALL1'	11/19/09	<0.250	64	17	<0.005	<0.005	<0.005	<0.010	<0.005	<0.005
EXC4-EAST3--SDWALL1'	11/19/09	<0.240	<50	<1.0	<0.0048	<0.0048	<0.0048	<0.0095	<0.0048	<0.0048
EXC4-EAST4--SDWALL1'	11/19/09	<0.250	190	54	<0.005	<0.005	<0.005	0.014	<0.005	<0.005
EXC4-EAST5--SDWALL1'	11/19/09	<0.240	<50	3.2	<0.0047	<0.0047	<0.0047	<0.0095	<0.0047	<0.0047
<b>REGULATORY CONCENTRATIONS</b>										
Soil Cleanup Goal		450	800	450	0.27	NE	NE	NE	0.13	1.3

**Notes:**

TPHg = total petroleum hydrocarbons in the gasoline-range (C5-C12)

TPHd = total petroleum hydrocarbons in the diesel-range (C10-C28)

TPHmo = total petroleum hydrocarbons in the motor oil-range (C24-C36)

1,2-DCA = 1,2-dichloroethane, commonly known as ethylene dichloride (EDC)

NE = none established

Samples analyzed by TestAmerica Laboratories Inc. for TPHg, TPHd, and TPHmo by EPA test method 8015B; benzene, toluene, ethylbenzene, and total xylenes analyzed by EPA test method 8260A.

Bold font denotes above soil cleanup goal.

Italic font denotes results of sample collected at the location of "over-excavation" where analytical results were above cleanup goals.



**Table 7**  
**Analytical Results for Confirmation Soil Samples Collected**  
**from Excavation 4, PCBs, SVOCs, and Metals**  
**Former Pacific Electric Motors Site**  
**1009 66th Avenue, Oakland, California**  
*concentrations in milligrams per kilogram (mg/kg)*

Sample ID	Date	PCBs	benzo(a)pyrene	benzo(a)anthracene	benzo(k)fluoranthene	chrysene	naphthalene	Arsenic	Lead
EXC4-N1-SDWALL1'-R	01/05/10	<b>0.470</b>	NA	NA	NA	NA	NA	NA	8.7
EXC4-NORTH2-SDWALL1'	11/20/09	<b>0.290</b>	<0.33	<1.6	<0.33	<0.33	<0.33	<b>16</b>	53
EXC4-NORTH3-SDWALL1'	11/20/09	<0.050	<0.066	<0.33	<0.066	<0.066	<0.066	6.7	17
EXC4-NORTH4-SDWALL1'	11/20/09	<0.050	<0.066	<0.33	<0.066	<0.066	<0.066	<b>110</b>	27
EXC4-NORTH5-SDWALL1'	11/20/09	<0.050	<0.067	<0.33	<0.067	<0.067	<0.067	<b>49</b>	20
EXC4-NORTH6-SDWALL1'	11/20/09	<0.050	<0.33	<1.6	<0.33	<0.33	<0.33	<b>47</b>	29
EXC4-50'NORTH1-SDWALL1'	11/30/09	<b>0.360</b>	NA	NA	NA	NA	NA	4.1	NA
EXC4-50'NORTH2-SDWALL1'	11/30/09	<b>0.730</b>	NA	NA	NA	NA	NA	4.7	NA
EXC4-50'NORTH3-SDWALL1'	11/30/09	<b>0.250</b>	NA	NA	NA	NA	NA	<b>39</b>	NA
EXC4-50'NORTH3-SDWALL1'-	11/30/09	<b>0.250</b>	NA	NA	NA	NA	NA	<b>4.3</b>	NA
EXC4-50'NORTH4-SDWALL1'	01/05/10	NA	NA	NA	NA	NA	NA	<b>13</b>	67
EXC4-SOUTH2-SDWALL1'	11/20/09	0.059	<6.7	<33	<6.7	<6.7	<6.7	5.3	15
EXC4-SOUTH3-SDWALL1'	11/21/09	<0.050	<3.3	<16	<3.3	<3.3	<3.3	4.4	15
EXC4-SOUTH4-SDWALL1'	11/21/09	<0.048	<0.67	<3.3	<0.67	<0.67	<0.67	4.6	4.1
EXC4-SOUTH5-SDWALL1'	11/21/09	<0.049	<6.6	<33	<6.6	<6.6	<6.6	<4.1	4.0
EXC4-SOUTH6-SDWALL1'	11/21/09	<0.049	<1.7	<8.2	<1.7	<1.7	<1.7	6.3	6.2
EXC4-SOUTH7-SDWALL1'	11/21/09	<0.050	<3.3	<16	<3.3	<3.3	<3.3	5.5	6.2
EXC-4-South-4A-SDWALL1'	11/30/09	<0.050	NA	NA	NA	NA	NA	5.2	11
EXC-4-South-4B-SDWALL1'	11/30/09	<0.050	NA	NA	NA	NA	NA	5.5	9.7
EXC-4-South-4C-SDWALL1'	11/30/09	<0.050	NA	NA	NA	NA	NA	<b>56</b>	<b>100</b>
EXC-4-South-4C-SDWALL2'*	12/21/09	NA	NA	NA	NA	NA	NA	<b>30</b>	<b>8.1</b>
EXC4-EAST1-SDWALL1'	11/21/09	<0.490	<0.067	<0.33	<0.067	<0.067	<0.067	<b>150</b>	34
EXC4-EAST6-SDWALL1'	11/21/09	<0.049	<6.6	<33	<6.6	<6.6	<6.6	<b>11</b>	78
EXC4-EAST7-SDWALL1'	11/21/09	<0.050	<3.3	<16	<3.3	<3.3	<3.3	<b>11</b>	61
EXC4-EAST8-SDWALL1'	11/21/09	<0.050	<1.7	<8.2	<1.7	<1.7	<1.7	<b>13</b>	48
EXC4-EAST2--SDWALL1'	11/19/09	<0.050	<0.33	<1.6	<0.33	<0.33	<0.33	<b>120</b>	64

**Table 7**  
**Analytical Results for Confirmation Soil Samples Collected**  
**from Excavation 4, PCBs, SVOCs, and Metals**  
**Former Pacific Electric Motors Site**  
**1009 66th Avenue, Oakland, California**  
*concentrations in milligrams per kilogram (mg/kg)*

Sample ID	Date	PCBs	benzo(a)pyrene	benzo(a)anthracene	benzo(k)fluoranthene	chrysene	napthalene	Arsenic	Lead
EXC4-EAST3--SDWALL1'	11/19/09	<0.050	<0.067	<0.33	<0.067	<0.067	<0.067	<b>80</b>	14
EXC4-EAST4--SDWALL1'	11/19/09	<0.050	<0.33	<1.6	<0.33	<0.33	<0.33	<b>58</b>	37
EXC4-EAST5--SDWALL1'	11/19/09	<0.050	<0.067	<0.33	<0.067	<0.067	<0.067	<b>170</b>	75
<b>REGULATORY CONCENTRATIONS</b>									
Soil Clean-Up Goal		0.130	0.13	1.3	1.3	21	2.8	7	80

**Notes:**

PCBs = polychlorinated biphenyls

TPHd = total petroleum hydrocarbons in the diesel-range (C10-C28)

TPHmo = total petroleum hydrocarbons in the motor oil-range (C24-C36)

Samples analyzed by TestAmerica Laboratories Inc. for PCBs using EPA test method 8082; semivolatile organic compounds by EPA test method 8270C; metals by EPA Test method 6010 series.

Bold font denotes results above soil cleanup goal.

Italic font denotes results of sample collected at the location of "over-excavation" where analytical results were above cleanup goals.

\*EXC-4-South-4C-SDWALL2' was originally mislabeled as EXC-4-South-46-SDWALL2' and is titled as such in the lab reports.

NA = parameter not analyzed

**Table 8**  
**Analytical Results for Confirmation Soil Samples Collected**  
**from Excavations 1 and 2, Metals**  
**Former Pacific Electric Motors Site**  
**1009 66th Avenue, Oakland, California**  
*concentrations in milligrams per kilogram (mg/kg)*

<b>Excavation 1</b>			
<b>Sample ID</b>	<b>Date</b>	<b>Arsenic</b>	<b>Lead</b>
EXC1-FINAL-NW	02/11/10	<b>8.2</b>	<b>120</b>
EXC1-FINAL-NE	02/11/10	<b>8.0</b>	<b>310</b>
EXC1-FINAL-EAST	02/11/10	5.0	32
EXC1-FINAL-SE	02/11/10	<b>9.7</b>	<b>520</b>
EXC1-FINAL-SW	02/11/10	<b>9.9</b>	34
EXC1-FINAL-WEST	02/11/10	6.3	78
<b>Excavation 2</b>			
EXC2-FINAL-EAST	02/11/10	<b>11</b>	44
EXC2-FINAL-SE	02/11/10	<b>7.5</b>	64
EXC2-FINAL-SW	02/11/10	<b>9.6</b>	35
EXC2-FINAL-WEST	02/11/10	<b>10</b>	<b>170</b>
EXC2-FINAL-NW	02/11/10	<b>8.6</b>	<b>160</b>
EXC2-FINAL-NE	02/11/10	<b>7.6</b>	<b>110</b>
<b>REGULATORY CONCENTRATIONS</b>			
Cleanup goal		7	80

**Notes:**

Samples analyzed by TestAmerica Laboratories Inc. for metals by EPA Test method 6010 series.

Bold font denotes results above soil cleanup goal.

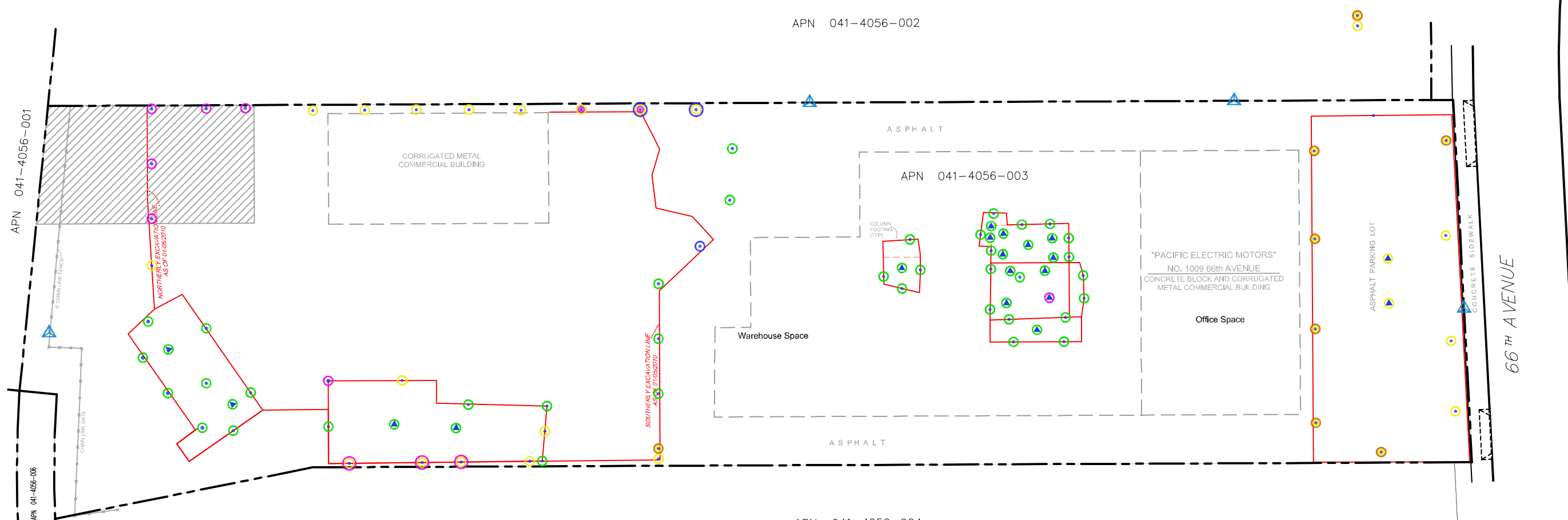

- EXPLANATION:**
- Property Line
  - Former Warehouse Building
  - Excavation
  - Reported Area of Excavation of PCB-Affected Soil in 1992
  - Air Monitoring Station
  - Sidewalk Confirmation Sample Location and ID
  - Bottom Confirmation Sample Location and ID
  - Passed All Criteria
  - Failed Polychlorinated Biphenyls
  - Failed Arsenic
  - Failed Lead
  - Failed Total Petroleum Hydrocarbons

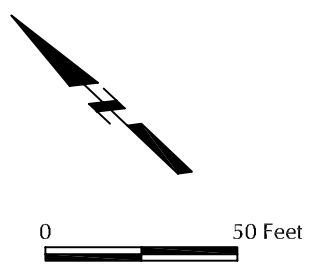

**DRAFT**

PROPOSED CHARTER SCHOOL SITE  
1009 66TH AVENUE, OAKLAND, CALIFORNIA

**SITE PLAN SHOWING  
EXCAVATION AREAS AND  
CONFIRMATION SAMPLE LOCATIONS**

FIGURE  
**1**



CITY: (Read) D:\GROUPO\F\Repl\ DB\Repl\ LD\Op\ PIC\Op\ PM\Repl\ TMS\Repl\ LYS\Option\OFF\REF\*  
 PCDesign\003\0915504\dwg\Aggie\_Site\_Plan\_December 2009.dwg LAYOUT: EXC4\_PCB4\_SAVED: 3/7/2010 2:20 PM ACADVER: 17.1S (LMS TECH) PAGESETUP: PLOTSTYLETABLE: STANDARD.CTB PLOTTED: 3/7/2010 2:28 PM BY: REYES, ALEC  
 XREFS: IMAGES: PROJECTNAME: 7311-2\_112009\Survey\_Plan.dwg  
 7311-2\_112009  
 7311-2\_112009

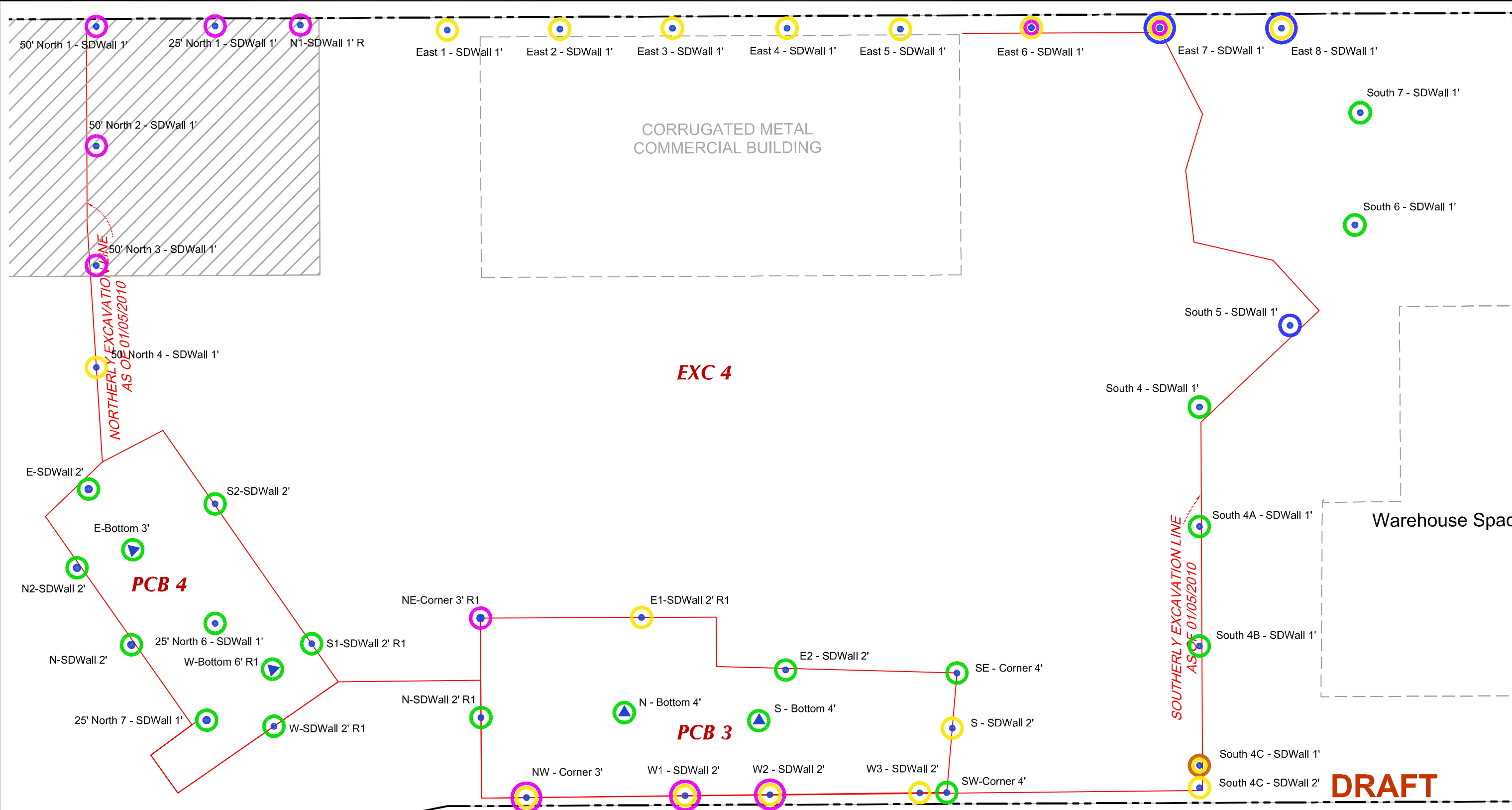

**DRAFT**

**EXPLANATION:**

- Property Line
- Former Warehouse Building
- Excavation
- Reported Area of Excavation of PCB-Affected Soil in 1992
- Air Monitoring Station

- Sidewall Confirmation Sample Location and ID
- Bottom Confirmation Sample Location and ID
- Passed All Criteria
- Failed Polychlorinated Biphenyls
- Failed Arsenic
- Failed Lead
- Failed Total Petroleum Hydrocarbons

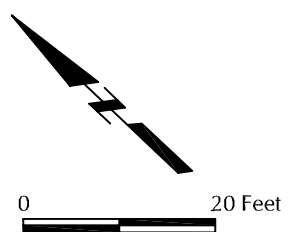

PROPOSED CHARTER SCHOOL SITE  
1009 66TH AVENUE, OAKLAND, CALIFORNIA

**EXCAVATIONS EXC 4, PCB 3, AND PCB 4**

**ARCADIS**

FIGURE  
**3**

CITY:\Redd\DW\GROUP\Redd\DW\Redd\LD\Redd\PC\Opt\PM\Redd\TMS\Opt\LYR\Option\OFF\REF  
 P:\Design\003\09\5504\dwg\Asst\Site Plan December 2009.dwg LAYOUT: EXC1: EXC2 SAVER: 3/1/2010 2:207 PM ACADVER: 17.1S (LMS TECH) PAGES: 17.1S (LMS TECH) PLOTSETUP: STANDARD.DWTB PLOTTED: 3/1/2010 2:28 PM BY: REYES, ALEC  
 XREFS: IMAGES: PROJECTNAME: 7311-2\_112009\Survey Plan.dwg 7311-2\_112009b 7311-2\_112009c

"PACIFIC ELECTRIC MOTORS"  
 NO. 1009 66th AVENUE  
 CONCRETE BLOCK AND CORRUGATED  
 METAL COMMERCIAL BUILDING

Office Space

ASPHALT PARKING LOT

CONCRETE SIDEWALK

66 TH AVENUE

EXC1-FINAL NE	
Lead	310
Arsenic	8.0

EXC1-FINAL EAST	
Lead	32
Arsenic	5.0

EXC1-FINAL SE	
Lead	520
Arsenic	9.7

EXC1-FINAL NW	
Lead	120
Arsenic	8.2

EXC1-FINAL SW	
Lead	34
Arsenic	9.9

EXC1-FINAL WEST	
Lead	78
Arsenic	6.3

EXC2-FINAL EAST	
Lead	44
Arsenic	11

EXC2-FINAL NE	
Lead	110
Arsenic	7.6

EXC2-FINAL SE	
Lead	64
Arsenic	7.5









EXC2-FINAL SW	
Lead	35
Arsenic	9.6

EXC2-FINAL NW	
Lead	160
Arsenic	8.6

EXC2-FINAL WEST	
Lead	170
Arsenic	10

EXC2-FINAL SW	
Lead	35
Arsenic	9.6

EXPLANATION:

-  Property Line
-  Former Warehouse Building
-  Excavation
-  Air Monitoring Station
-  Sidewall Confirmation Sample Location
-  Bottom Confirmation Sample Location
-  Failed Arsenic
-  Failed Lead

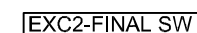
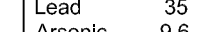
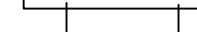
-  Sample ID
-  Concentration in milligrams per kilogram
-  Analyte

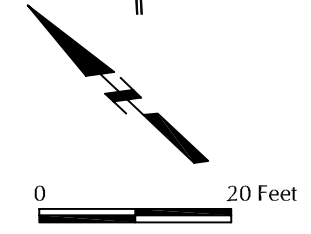

**DRAFT**

PROPOSED CHARTER SCHOOL SITE  
1009 66TH AVENUE, OAKLAND, CALIFORNIA

**EXCAVATIONS EXC1 AND EXC2**

