

ASSESSOR'S MAP 30

Code Area Nos. 17-001

FREMONT TRACT (Bk. 26 Pg. 14) LOCKE TRACT (Bk. 24 Pg. 77) KEY ROUTE HEIGHTS (Bk. 25 Pg. 171)
POTTERS ADDITION TO VALLEY VIEW (Bk. 25 Pg. 20) SUTER TRACT (Bk. 13 Pg. 51)
QUIGLEY-SUBDIVISION OF PORTION (Bk. 4 Pg. 36) P.M. 3407 125/47

1981

Scale: 1"=100'

Drawn: 3-20-70 H.N. Revised: 3-26-80 R.M.
7-27-81 ST
6-28-86 JCR
5-7-92 JT
3-31-94 JT

Formerly: Bk. 30-Bks. 1916, 1919 B. Bk. 31-Bks. 1933, 1934, 1936, 1937, 1939, 2005, 2006
(Rev.)

A.C.M.

Reference:

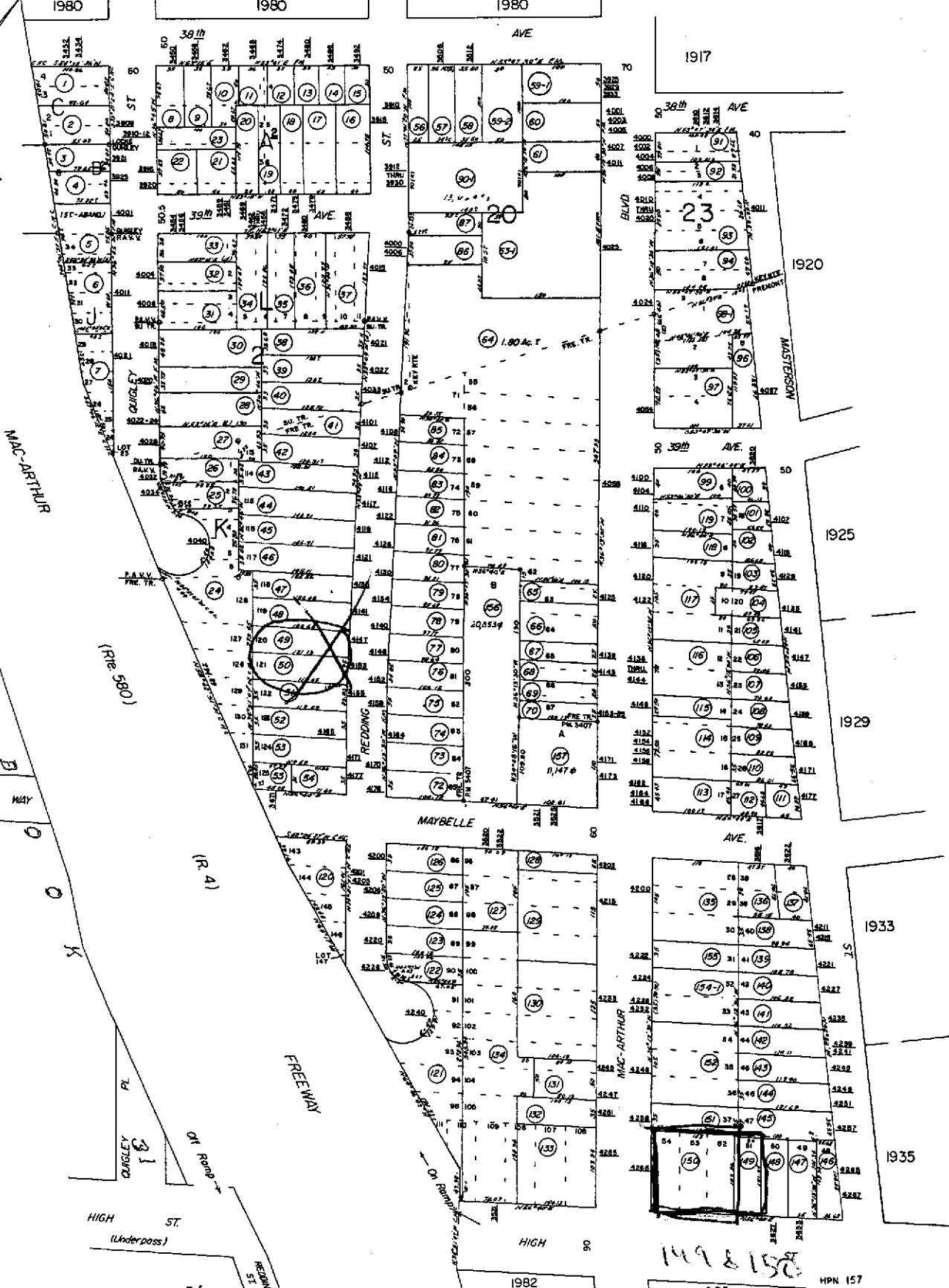

149 & 150

HPN 157



COUNTY OF ALAMEDA

Assessor's Office

Property Value System

History

Value

Transfer

New Query

Parcel Number: 30-1981-149 Inactive: N Lien Date: 01/01/2006 Owner: QUICK CAROLE M & MUDGET LORRAINE M
 Property Address: 4276 MACARTHUR BLVD , OAKLAND, CA 94619-1908

Current Mailing Address as of 07/27/2004: QUICK CAROLE M & MUDGET LORRAINE M, c/o CONOCOPHILLIPS,
 P.O. BOX 1539 , PASO ROBLES, CA 93447-1539

Mailing Name	Historical Mailing Address	Document Date	Document Number	Value From Trans Tax	Parcel Count	Use
QUICK CAROLE M & MUDGET LORRAINE M	240 LINCOLN , ASTORIA, OR 97103	04/16/2004	2004-162341		2	8500
MUDGET LORRAINE M & MUNICH FREDERICK W ETAL	1075 LONGRIDGE RD , OAKLAND, CA 94610	04/16/2004	2004-162340		2	8500
MUNICH FREDERICK W TR	1075 LONGRIDGE RD , OAKLAND, CA 94610	04/16/2004	2004-162338		2	8500
MUNICH WILLIAM & CAROLA G & FREDERICK W TRS c/o MUNICH FREDERICK W	1075 LONGRIDGE RD , OAKLAND, CA 94610	12/24/2002	TRAN-242650		2	8500
MUNICH WILLIAM & CAROLA G & FREDERICK W TRS c/o MUNICH FREDERICK W	1075 LONGRIDGE RD , OAKLAND, CA 94610	10/27/2002	TRAN-242648		2	8500
MUNICH WILLIAM & CAROLA G & FREDERICK W TRS c/o TOSCO CORPORATION	PO BOX 52085 , PHOENIX, AZ 85072	09/14/2001	TRAN-32282		1	8500
MUNICH WILLIAM & CAROLA G & FREDERICK W TRS c/o TOSCO/PROP TX DC-17	PO BOX 52085 , PHOENIX, AZ 85072	10/30/1989	1989-293688		2	8500
MUNICH WILLIAM & CAROLA G c/o UNION OIL CO OF CAL	PO BOX 7600 , LOS ANGELES, CA 90051-0600	04/15/1975	1975-48694		2	8500
MUNICH WILLIAM + CAROLA G	4276 MACARTHUR BLVD , OAKLAND, CA 94619-1908	05/01/1962	AT-58089		2	8500



COUNTY OF ALAMEDA

Assessor's Office**Property Value System****History****Value****Transfer**

New Query

Parcel Number: 30-1981-150 Inactive: N Lien Date: 01/01/2006 Owner: QUICK CAROLE M & MUDGET
 LORRAINE M ETAL
 Property Address: 4276 MACARTHUR BLVD , OAKLAND, CA 94619-1908

Current Mailing Address as of 05/05/2005: QUICK CAROLE M & MUDGET LORRAINE M ETAL, P.O. BOX 2165 ,
 GEARHEART, OR 97138

Mailing Name	Historical Mailing Address	Document Date	Document Number	Value From Trans Tax	Parcel Count	Use
QUICK CAROLE M & MUDGET LORRAINE M ETAL	240 LINCOLN , ASTORIA, OR 97103	04/16/2004	2004-162341		2	<u>8500</u>
MUDGET LORRAINE M & MUNICH FREDERICK W ETAL	List Owners 1075 LONGRIDGE RD , OAKLAND, CA 94610	04/16/2004	2004-162340		2	<u>8500</u>
MUNICH FREDERICK W TR	1075 LONGRIDGE RD , OAKLAND, CA 94610	04/16/2004	2004-162338		2	<u>8500</u>
MUNICH WILLIAM & CAROLA G & FREDERICK W TRS c/o MUNICH FREDERICK W	1075 LONGRIDGE RD , OAKLAND, CA 94610	12/24/2002	TRAN-242650		2	<u>8500</u>
MUNICH WILLIAM & CAROLA G & FREDERICK W TRS c/o MUNICH FREDERICK W	1075 LONGRIDGE RD , OAKLAND, CA 94610	10/27/2002	TRAN-242648		2	<u>8500</u>
MUNICH WILLIAM & CAROLA G & FREDERICK W TRS c/o TOSCO CORPORATION	PO BOX 52085 , PHOENIX, AZ 85072	09/14/2001	TRAN-32284		1	<u>8500</u>
MUNICH WILLIAM & CAROLA G & FREDERICK W TRS	4425 CARSON ST , OAKLAND, CA 94619-2954	10/06/2000	2000-302565		1	<u>8500</u>
RENOUD ERNA G TR ETAL c/o ROBERT W RENOUD	2551 RIVA RD , ANNAPOLIS, MD 21401	10/06/2000	2000-302564		1	<u>8500</u>
RENOUD ERNA G TR ETAL c/o ROBERT W RENOUD	2551 RIVA RD , ANNAPOLIS, MD 21401	05/07/2000	TRAN-32283		1	<u>8500</u>
RENOUD ERNA G TR ETAL c/o TOSCO MARKETING	PO BOX 52085 , PHOENIX, AZ 85072	11/08/1995	1995-263231		1	<u>8500</u>
RENOUD ERNA G & MUNICH WILLIAM & C G & F W TRS c/o UNION OIL CO	4425 CARSON ST , OAKLAND, CA 94619-2954	10/30/1989	1989-293686		1	<u>8500</u>

RENOUD ERNA G & MUNICH CAROLA G c/o UNION OIL CO	PO BOX 7600 , LOS ANGELES, CA 90051- 0600	05/30/1980	1980-93116	1	<u>8500</u>
GERDES KATHERINE S	4276 MACARTHUR BLVD , OAKLAND, CA 94619-1908	05/28/1969	1969-59958	1	<u>8500</u>

All information on this site is to be assumed accurate for property assessment purposes only, and is based upon the Assessor's knowledge of each property. Caution is advised for use other than its intended purpose.

The Alameda County Intranet site is best viewed in Internet Explorer Version 5.5 or later.
Click [here](#) for more information regarding supported browsers.

Copyright © 2001 Alameda County

Property Detail

Alameda, CA RON THOMSEN, ASSESSOR

Parcel # (APN): 030 -1981-149-00 Use Description:

Parcel Status:

Owner Name: MUNICH WILLIAM & FREDERICK W

Mailing Address: PO BOX 52085 DC-17 PHOENIX AZ 85072

Situs Address: 4276 MACARTHUR BL OAKLAND CA 94619

Legal

Description:

ASSESSMENT

Total Value: \$23,870	Use Code: 850	Zoning:
Land Value: \$23,870	Tax Rate Area: 17001	
Impr Value:	Year Assd: 2003	Improve Type:
Other Value:	Property Tax:	Price/SqFt:
% Improved	Delinquent Yr	
Exempt Amt:	HO Exempt?: N	

SALES HISTORY

	<u>Sale 1</u>	<u>Sale 2</u>	<u>Sale 3</u>	<u>Transfer</u>
Recording Date:	09/14/2001			
Recorded Doc #:	01 999999			
Recorded Doc Type:				
Transfer Amount:				
Sale 1 Seller (Grantor):				
1st Trst Dd Amt:	Code1:	2nd Trst Dd Amt:	Code2:	

PROPERTY CHARACTERISTICS

Lot Acres: 0.080	Year Built:	Fireplace:
Lot SqFt: 3,551	Effective Yr:	A/C:
Bldg/Liv Area:		Heating:
Units:	Total Rooms:	Pool:
Buildings:	Bedrooms:	
Stories:	Baths (Full):	Park Type:
Style:	Baths (Half):	Spaces:
Construct:		Site Infnce:
Quality:	Garage SqFt:	
Building Class:		Timber Preserve:
Condition:		Ag Preserve:
Other Rooms:		

*** The information provided here is deemed reliable, but is not guaranteed.

Property Detail

Alameda, CA RON THOMSEN, ASSESSOR

Parcel # (APN): 030 -1981-150-00 Use Description:

Parcel Status:

Owner Name: MUNICH WILLIAM & FREDERICK W

Mailing Address: PO BOX 52085 DC - 17 PHOENIX AZ 85072

Situs Address: 4276 MACARTHUR BL OAKLAND CA 94619

Legal

Description:

ASSESSMENT

Total Value: \$242,424	Use Code: 850	Zoning:
Land Value: \$242,424	Tax Rate Area: 17001	
Impr Value:	Year Assd: 2003	Improve Type:
Other Value:	Property Tax:	Price/SqFt:
% Improved	Delinquent Yr	
Exempt Amt:	HO Exempt?: N	

SALES HISTORY

	<u>Sale 1</u>	<u>Sale 2</u>	<u>Sale 3</u>	<u>Transfer</u>
Recording Date:	10/06/2000	03/24/1980		
Recorded Doc #:	00 302565	80 999999		
Recorded Doc Type:				
Transfer Amount:				
Sale 1 Seller (Grantor):				
1st Trst Dd Amt:	Code1:	2nd Trst Dd Amt:	Code2:	

PROPERTY CHARACTERISTICS

Lot Acres: 0.250	Year Built:	Fireplace:
Lot SqFt: 10,837	Effective Yr:	A/C:
Bldg/Liv Area:		Heating:
Units:	Total Rooms:	Pool:
Buildings:	Bedrooms:	
Stories:	Baths (Full):	Park Type:
Style:	Baths (Half):	Spaces:
Construct:		Site Infnce:
Quality:	Garage SqFt:	
Building Class:		Timber Preserve:
Condition:		Ag Preserve:
Other Rooms:		

*** The information provided here is deemed reliable, but is not guaranteed.