



Nicole M. Arceneaux
Project Manager
Marketing Business Unit

**Chevron Environmental
Management Company**
6101 Bollinger Canyon Road
San Ramon, CA 94583
Tel (925) 790-6912
Nicole.arceneaux@chevron.com

August 27, 2014

Alameda County Health Care Services Agency
Environmental Health Services
Environmental Protection
1131 Harbor Bay Parkway, Suite 250
Alameda, California 94502-6577

RECEIVED

By Alameda County Environmental Health at 10:24 am, Sep 11, 2014

**Re: Chevron Facility No. 351643 (Former Unocal Service Station No. 3135)
845 66th Avenue (6535 San Leandro Street), Oakland, California**

I have reviewed the attached report dated August 27, 2014.

I agree with the conclusions and recommendations presented in the referenced report. The information in this report is accurate to the best of my knowledge and all local Agency/Regional Board guidelines have been followed. This report was prepared by AECOM, upon whose assistance and advice I have relied.

This letter is submitted pursuant to the requirements of California Water Code Section 13257(b)(1) and the regulating implementation entitled Appendix A pertaining thereto.

I declare under penalty of perjury that the foregoing is true and correct to the best of my knowledge.

Sincerely,

A handwritten signature in blue ink, appearing to read "Nicole Arceneaux".

Nicole Arceneaux
Project Manager

Attachment: *Well Destruction Report* by AECOM

August 27, 2014

Mr. Keith Nowell
Alameda County Health Care Services Agency (ACEH)
Environmental Health Services
Environmental Protection
1131 Harbor Bay Parkway, Suite 250
Alameda, California 94502

Subject: Well Destruction Report
Unocal No. 3135 (351643)
845 66th Avenue (6535 San Leandro Street), Oakland, California
ACEH Case No. RO0000408
GeoTracker Site No. T0600101488

Dear Mr. Nowell:

On behalf of Chevron Environmental Management Company's (EMC's) affiliate, Union Oil Company of California ("Union Oil"), AECOM is pleased to submit this well destruction report for the above-referenced site (**Figure 1**). Well destruction was approved by Alameda County Health Care Services Agency (ACEH) as the final condition for closure of the environmental case in a letter issued on April 10, 2014 (**Attachment A**).

Pre-field Activities

AECOM prepared a site-specific health and safety plan (HASP) to address potential physical and chemical hazards associated with the scope of work performed at the site. All work conducted by AECOM and any subcontractors was performed in general accordance with the HASP. AECOM contacted Underground Service Alert of Northern California (USA North) prior to the commencement of fieldwork to mark underground utility locations serving the site vicinity. On June 30, 2014, AECOM oversaw Cruz Brothers Locators, Inc. of Santa Cruz, California, a private utility survey company, provided additional underground utility location and clearance services prior to well destruction, and verify markings associated with the USA North notification.

A well destruction permit was required by and obtained from the Alameda County Public Works Agency (ACPWA) for all wells that were destroyed (**Attachment B**). Encroachment and excavation permits were required and obtained from the City of Oakland and the approved traffic control plan was followed during field activities. Additionally, AECOM submitted permit and plan review to the San Francisco Bay Area Rapid Transit District (BART) for monitoring wells located in the City of Oakland right-of-way adjacent to the elevated BART track. AECOM notified the ACEH, ACPWA, City of Oakland and the property owner prior to conducting fieldwork.

Field Activities

On August 11 through 13, 2014, AECOM oversaw ABC Liovin Drilling, Inc. (ABC Liovin) destroy all 11 site wells (**Figure 2**). ABC Liovin properly destroyed the wells in general accordance with California Department of Water Resources (DWR) and ACPWA regulations. ACPWA was given prior notice of schedule for the well destruction activities. Steve Miller from ACPWA was on site during each day of the well destruction activities to perform a grout inspection.

Prior to destroying the wells, ABC Liovin removed each well box and apron using a pneumatic jackhammer and/or pry bar. An one-inch diameter tremie pipe was placed at the bottom of each well or a funnel was placed at the well head and cement grout was poured from the base of the well to the top of the casing. The cement grout mixture consisted of 95 percent Portland cement and 5 percent bentonite powder. The grout was allowed to settle for 30 minutes and was topped off to the top of the well casing. The ACPWA inspector did not require the grout to be pressurized due to the amount of grout each well was taking (3 to 4 times the well casing volume) and the fact that almost no settling of the grout was observed. Each abandoned location was backfilled to match the existing grade in the area. Per the City of Oakland, MW-10 required hot patch asphalt at the surface which was completed on August 11, 2014, MW-8 and MW-9 required high strength reinforced concrete which was completed on August 12, 2014. The upper five feet of the four off site wells(MW-8 through MW-11) was over drilled and then backfilled with native type material (along with the over drilled clean soil) per ACPWA requirements. No waste was generated during well abandonment activities.

DWR well destruction reports are included in **Attachment C** and will be sent to ACPWA per well permit requirements.

Conclusion

The well destruction activities were the final requirement to satisfy site closure. A letter of no further action letter is anticipated, pending the final upload of this report documenting well destruction activities.

If you have any questions about the information contained in this report, please call Jim Harms at (916) 919-9210 or email James.Harms@aecom.com.

Sincerely,

James Harms
Project Manager

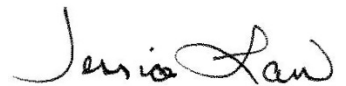
Jessica Law, P.G. No. 8840
Project Geologist
Stamped: August 27, 2014



cc: Ms. Nicole Arceneaux, EMC (via electronic copy)
Tom Huynh, property owner (via paper copy)
Presley Properties LLC & Marks Redwood LLC, property owner (via paper copy)

Enclosures:

Figures

Figure 1 – Site Location Map
Figure 2 – Site Plan

Attachments

Attachment A – Well Destruction Directive
Attachment B – Well Destruction Permit
Attachment C – DWR Well Destruction Reports

FIGURES

P:\ENV\01231-Chevron\76Products_transfer_sites\351643_3135_Oakland\7.0 Deliverables\7.2 CADD\Well Abandonment WP_June2014\Figure 1_SITE_LDC_351643.dwg

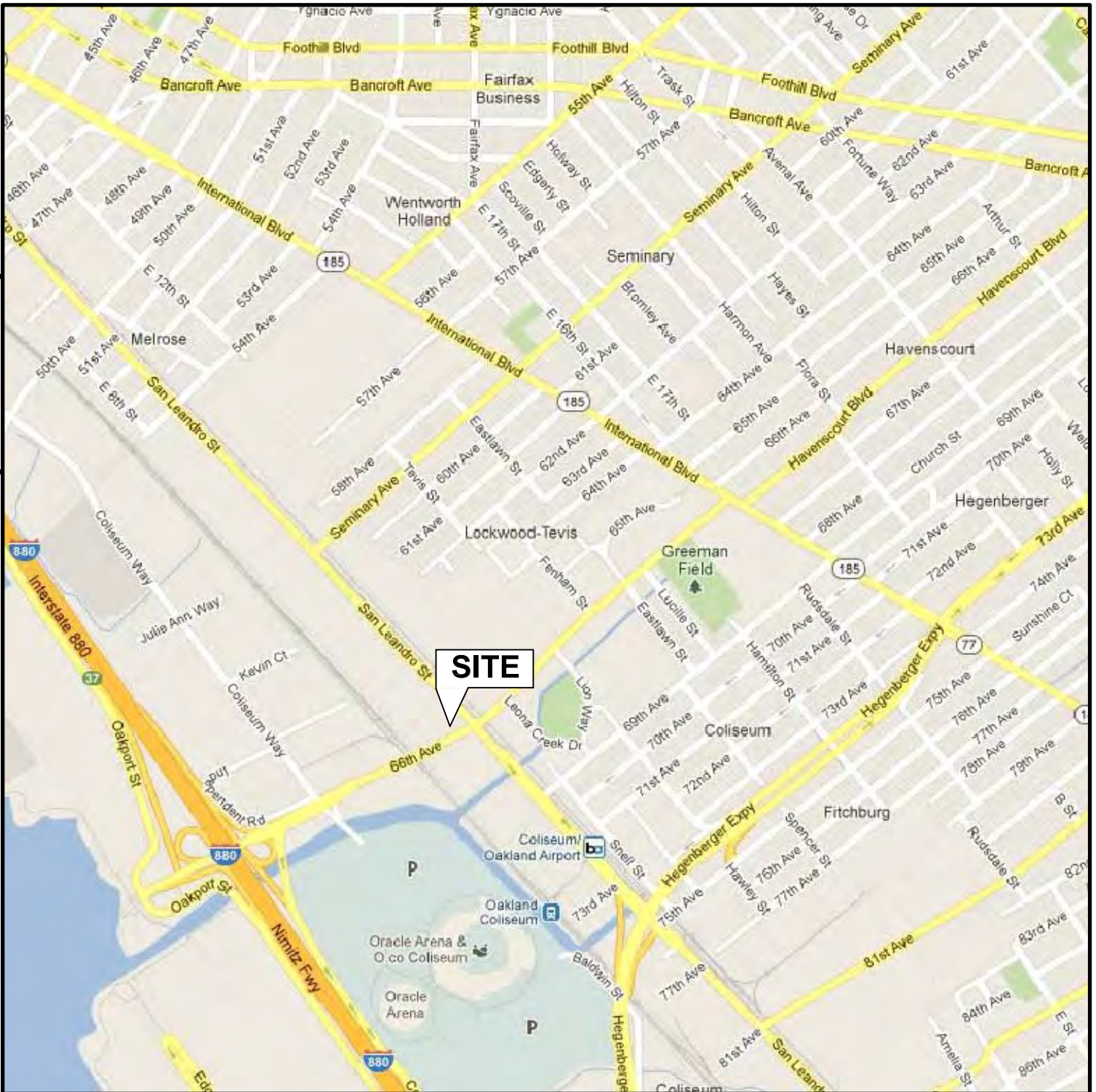

North

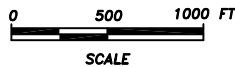

FIGURE 1
SITE LOCATION MAP
UNOCAL NO. 3135 (351643)
6535 SAN LEANDRO STREET/845 66th AVENUE
OAKLAND, CALIFORNIA

| | |
|-------------------------|-------------------------|
| PROJECT NO. 60314293 | DRAWN BY JMB 6/24/14 |
| FILE NO. 351643 | PREPARED BY JMB |
| REVISION NO. | REVIEWED BY JH |



SOURCE: Google Maps (R) dated September 19, 2012

P:\ENV\01231-Chevron\76Products_transfer_sites\351643_3135_Oakland\7.0 Deliverables\7.2 CADD\Well Abandonment WP_June2014\Figure 2_site_map.dwg

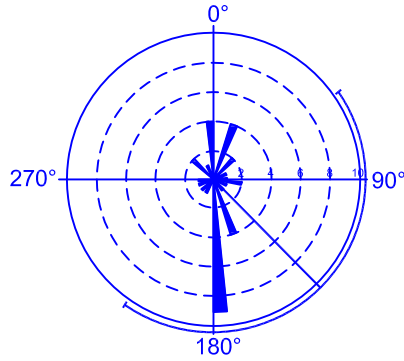

APPROXIMATE GROUNDWATER FLOW DIRECTION 3Q1990 TO 3Q2012

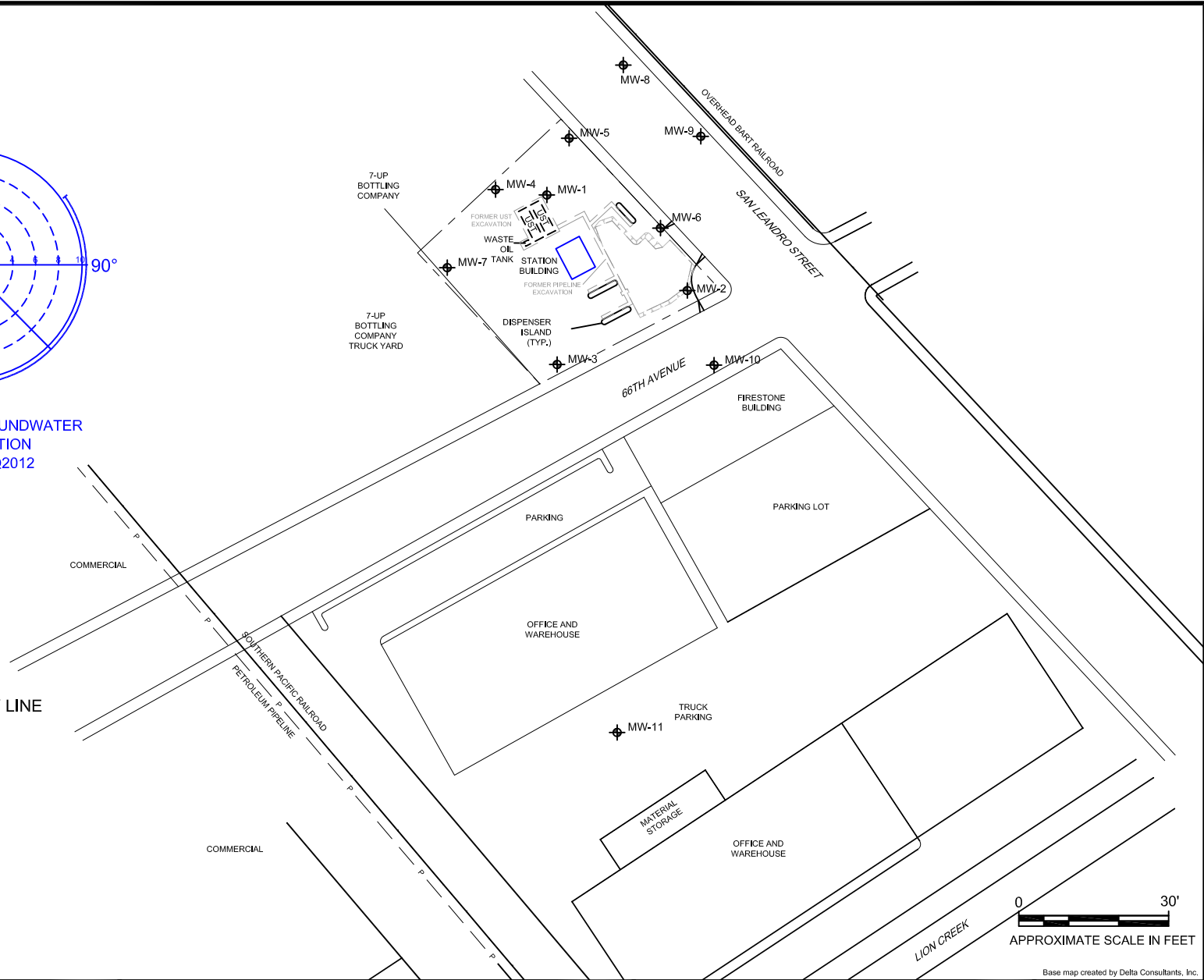

LEGEND:

- APPROXIMATE PROPERTY LINE
- MW-8 MONITORING WELL

Notes:
UST = underground storage tank

Base map created by Delta Consultants, Inc.

| | | | | | | | | | | | | | |
|--|-----------|-----------------|---|--|--|---|--|--|--|------------------|--|---|--|
| <p>SITE MAP</p> <p>Unocal No. 3135 (351643) 6535 San Leandro Street/845 66th Avenue Oakland, California</p> | | | <p>AECOM 2020 L STREET, SUITE 400 SACRAMENTO, CALIFORNIA 95811 PHONE: (916) 414-5800 FAX: (916) 414-5850 WEB: HTTP://WWW.AECOM.COM</p> | | | <p>DESIGNED BY:</p> <p>NO.: DESCRIPTION: DATE: BY:</p> <p>DRAWN BY:</p> <p>JMB</p> <p>CHECKED BY:</p> <p>JH</p> <p>APPROVED BY:</p> <p>JH</p> | | | | <p>REVISIONS</p> | | <p>FIGURE NUMBER:</p> <p style="font-size: 2em; font-weight: bold;">2</p> | |
| SCALE: | DATE: | PROJECT NUMBER: | | | | | | | | | | | |
| 1" = 30' | 6/24/2014 | 60314293 | | | | | | | | | | | |

ATTACHMENT A

Well Destruction Directive



ENVIRONMENTAL HEALTH SERVICES
ENVIRONMENTAL PROTECTION
1131 Harbor Bay Parkway, Suite 250
Alameda, CA 94502-6577
(510) 567-6700
FAX (510) 337-9335

April 10, 2014

Ms. Roya Kambin
Chevron Environmental Management Company
6101 Bollinger Canyon Road
San Ramon, CA 94583
(Sent via electronic mail to:
RKambin@chevron.com)

Mr. Ed Ralston
ConocoPhillips
76 Broadway
Sacramento, CA 95818
(Sent via electronic mail to:
Ed.C.Ralston@66.com)

Subject: Well Decommissioning for Fuel Leak Case No. RO0000408 and GeoTracker Global ID T0600101488, UNOCAL #3135, 845 66th Avenue, Oakland CA 94621

Dear Responsible Parties:

Alameda County Environmental Health (ACEH) has reviewed the fuel leak case file and is considering the above referenced site for case closure. Site investigation and groundwater monitoring for underground storage tank leaks have been performed at the subject property to which you are named as the primary or active responsible party.

Well Decommissioning

No comments were received on the proposed case closure during a public comment period that ended February 19, 2014. Please decommission the monitoring wells and provide documentation of the well decommissioning and waste disposal to this office no later than June 10, 2014. Remedial action completion certification will be issued following receipt of the documentation.

Well destruction permits may be obtained from Alameda County Public Works (<https://www.acgov.org/pwa/>).

Technical Report Request

Please upload technical reports to the ACEH ftp site (Attention: Dilan Roe), and to the State Water Resources Control Board's GeoTracker website in accordance with Attachment 1 and the following specified file naming convention and schedule:

- **June 10, 2014** – Well Decommissioning and Disposal
File to be named: WELL_DCM_R_yyyy-mm-dd_RO408

This report is being requested pursuant to California Health and Safety Code Section 25296.10. 23 CCR Sections 2652 through 2654, and 2721 through 2728 outline the responsibilities of a responsible party in response to an unauthorized release from a petroleum UST system, and require your compliance with this request.

Thank you for your cooperation. Should you have any questions or concerns regarding this correspondence or your case, please call me at (510) 567-6772 or send me an electronic mail message at teena.le@acgov.org.

Responsible Parties
RO0000408
April 10, 2014, Page 2

Sincerely,



Teena Lee
Hazardous Materials Technician

Enclosures: Attachment 1 – Responsible Party(ies) Legal Requirements/Obligations & ACEH
Electronic Report Upload (ftp) Instructions

cc: James Harms, AECOM, 10461 Old Placerville Toad, Suite 170, Sacramento, CA 95827
(sent via electronic mail to james.harms@aecom.com)

James Yoo, Alameda County Public Works, 399 Elmhurst St, Hayward, CA 94544, (sent via electronic mail
to jamesy@acpwa.org)

Dilan Roe, (sent via electronic mail to dilan.roe@acgov.org)

Electronic File, GeoTracker

Harms, James

From: Le, Teena, Env. Health <teena.lekhan@acgov.org>
Sent: Thursday, July 31, 2014 3:31 PM
To: Harms, James; Nicole Arceneaux
Cc: Roe, Dilan, Env. Health
Subject: RE: RO408 - 6535 San Leandro Street, Oakland - Well Destruction Extension Request
Attachments: Teena Le.vcf

Good afternoon,

Your extension request for submittal of the Well Destruction Report by August 29, 2014 is acceptable.

Thank you,



From: Nowell, Keith, Env. Health
Sent: Friday, July 25, 2014 8:11 AM
To: Le, Teena, Env. Health
Subject: FW: RO408 - 6535 San Leandro Street, Oakland - Well Destruction Extension Request

Teena,

I think this may be your site- 845 66th Ave @ San Leandro St.

Thx,
Keith

From: Arceneaux, Nicole Marie [<mailto:Nicole.Arceneaux@chevron.com>]
Sent: Thursday, July 24, 2014 3:53 PM
To: Nowell, Keith, Env. Health
Cc: Roe, Dilan, Env. Health; Harms, James (James.Harms@aecom.com)
Subject: RO408 - 6535 San Leandro Street, Oakland - Well Destruction Extension Request

Keith,

As we discussed on the phone, due to delays receiving permits from the City of Oakland, we are hereby requesting another extension for the well destructions at the site referenced above. AECOM has been working with the City of Oakland to expedite the permits, with little success. AECOM was also required to submit an unforeseen permit to BART due to the proximity of two wells to the overhead light rail.

The site work is currently scheduled for August 11 to August 14, 2014 and no additional permit delays are anticipated. I would like to extend the Well Destruction Report from July 25th to August 29th.

Please let me know if you have any questions.

Thanks,

Nicole Arceneaux
Project Manager
Chevron Environmental Management Company
6101 Bollinger Canyon Road, Room 5119
San Ramon, CA 94583
Tel 925 790 6912
Cell 510 363 7354
nicole.arceneaux@chevron.com

ATTACHMENT B

Well Destruction Permits

Alameda County Public Works Agency - Water Resources Well Permit

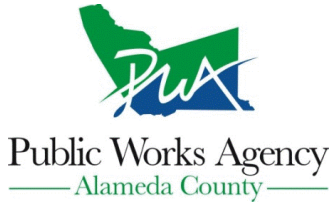

399 Elmhurst Street
Hayward, CA 94544-1395
Telephone: (510)670-6633 Fax:(510)782-1939

Application Approved on: 07/23/2014 By jamesy

Permit Numbers: W2014-0683 to W2014-0693
Permits Valid from 08/11/2014 to 08/14/2014

Application Id: 1405641623743
Site Location: 6535 San Leandro Street

City of Project Site:Oakland

Project Start Date: 08/11/2014
Assigned Inspector: Contact Steve Miller at (510) 670-5517 or stevem@acpwa.org

Completion Date:08/14/2014

Applicant: AECOM - James Harms
2020 L Street, suite 400, Sacramento, CA 95811

Phone: 916-414-5800

Property Owner: Tom Huynh
6535 San Leandro Street, Oakland, CA 94621

Phone: 510-301-1371

Client: Nicole Arceneaux
6101 Bollinger Canyon Road, room 5119, San Ramon, CA 94583

Phone: 925-790-6912

Contact: James Harms

Phone: --
Cell: 916-919-9210

| | | |
|------------------------------------|---------------------------|---------------------|
| Receipt Number: WR2014-0296 | Total Due: | \$4367.00 |
| Payer Name : James D Harms | Total Amount Paid: | \$4367.00 |
| | Paid By: VISA | PAID IN FULL |

Works Requesting Permits:

Well Destruction-Monitoring - 11 Wells

Driller: ABC Liovin Drilling, Inc. - Lic #: 422904 - Method: OP

Work Total: \$4367.00

Specifications

| Permit # | Issued Date | Expire Date | Owner Well Id | Hole Diam. | Casing Diam. | Seal Depth | Max. Depth | State Well # | Orig. Permit # | DWR # |
|------------|-------------|-------------|---------------|------------|--------------|------------|------------|--------------|----------------|------------|
| W2014-0683 | 07/23/2014 | 11/09/2014 | MW-1 | 9.00 in. | 2.00 in. | 4.00 ft | 23.00 ft | No Records | No Records | No Records |
| W2014-0684 | 07/23/2014 | 11/09/2014 | MW-10 | 9.00 in. | 2.00 in. | 4.00 ft | 23.00 ft | No Records | No Records | No Records |
| W2014-0685 | 07/23/2014 | 11/09/2014 | MW-11 | 8.00 in. | 2.00 in. | 4.00 ft | 21.50 ft | No Records | No Records | No Records |
| W2014-0686 | 07/23/2014 | 11/09/2014 | MW-2 | 9.00 in. | 2.00 in. | 4.00 ft | 23.00 ft | No Records | No Records | No Records |
| W2014-0687 | 07/23/2014 | 11/09/2014 | MW-3 | 9.00 in. | 2.00 in. | 3.00 ft | 25.00 ft | No Records | No Records | No Records |
| W2014-0688 | 07/23/2014 | 11/09/2014 | MW-4 | 9.00 in. | 2.00 in. | 4.00 ft | 26.00 ft | No Records | No Records | No Records |
| W2014-0689 | 07/23/2014 | 11/09/2014 | MW-5 | 9.00 in. | 2.00 in. | 5.00 ft | 26.00 ft | No Records | No Records | No Records |
| W2014-0690 | 07/23/2014 | 11/09/2014 | MW-6 | 9.00 in. | 2.00 in. | 5.00 ft | 26.00 ft | No Records | No Records | No Records |
| W2014-0691 | 07/23/2014 | 11/09/2014 | MW-7 | 8.50 in. | 2.00 in. | 3.00 ft | 20.00 ft | No Records | No Records | No Records |
| W2014-0692 | 07/23/2014 | 11/09/2014 | MW-8 | 9.00 in. | 2.00 in. | 5.00 ft | 23.00 ft | No Records | No Records | No Records |
| W2014-0693 | 07/23/2014 | 11/09/2014 | MW-9 | 9.00 in. | 2.00 in. | 5.00 ft | 23.00 ft | No Records | No Records | No Records |

Specific Work Permit Conditions

1. Drilling Permit(s) can be voided/ cancelled only in writing. It is the applicant's responsibility to notify Alameda County Public Works Agency, Water Resources Section in writing for an extension or to cancel the drilling permit application. No

Alameda County Public Works Agency - Water Resources Well Permit

drilling permit application(s) shall be extended beyond ninety (90) days from the original start date. Applicants may not cancel a drilling permit application after the completion date of the permit issued has passed.

2. Prior to any drilling activities, it shall be the applicant's responsibility to contact and coordinate an Underground Service Alert (USA), obtain encroachment permit(s), excavation permit(s) or any other permits or agreements required for that Federal, State, County or City, and follow all City or County Ordinances. No work shall begin until all the permits and requirements have been approved or obtained. It shall also be the applicants responsibilities to provide to the Cities or to Alameda County an Traffic Safety Plan for any lane closures or detours planned. No work shall begin until all the permits and requirements have been approved or obtained.
 3. Compliance with the well-sealing specifications shall not exempt the well-sealing contractor from complying with appropriate State reporting-requirements related to well construction or destruction (Sections 13750 through 13755 (Division 7, Chapter 10, Article 3) of the California Water Code). Contractor must complete State DWR Form 188 and mail original to the Alameda County Public Works Agency, Water Resources Section, within 60 days. Include permit number and site map.
 4. Applicant shall submit the copies of the approved encroachment permit to this office within 60 days.
 5. Permittee shall assume entire responsibility for all activities and uses under this permit and shall indemnify, defend and save the Alameda County Public Works Agency, its officers, agents, and employees free and harmless from any and all expense, cost and liability in connection with or resulting from the exercise of this Permit including, but not limited to, property damage, personal injury and wrongful death.
 6. Applicant shall contact assigned inspector listed on the top of the permit at least five (5) working days prior to starting, once the permit has been approved. Confirm the scheduled date(s) at least 24 hours prior to drilling.
 7. Permittee, permittee's contractors, consultants or agents shall be responsible to assure that all material or waters generated during drilling, boring destruction, and/or other activities associated with this Permit will be safely handled, properly managed, and disposed of according to all applicable federal, state, and local statutes regulating such. In no case shall these materials and/or waters be allowed to enter, or potentially enter, on or off-site storm sewers, dry wells, or waterways or be allowed to move off the property where work is being completed.
 8. Remove the Christy box or similar structure. Destroy wells MW-8, MW-9 and MW-10 by overdrilling the upper 5ft.BGS & Tremie Grouting with Cement. After the seal has set, backfill the remaining hole with concrete or compacted material to match existing.
 9. Remove the Christy box or similar structure. Destroy wells MW-1, MW-2, MW-3, MW-4, MW-5, MW-6, MW-7, MW-11 by grouting neat cement with a tremie pipe or pressure grouting (25 psi for 5min.) to the bottom of the well and by filling with neat cement to three (3-5) feet below surface grade. Allow the sealing material to spill over the top of the casing to fill any annular space between casing and soil. After the seal has set, backfill the remaining hole with concrete or compacted material to match existing conditions.
 10. Copy of approved drilling permit must be on site at all times. Failure to present or show proof of the approved permit application on site shall result in a fine of \$500.00.
-

ATTACHMENT C

DWR Well Destruction Reports

File Original with DWR

State of California
Well Completion Report
Refer to Instruction Pamphlet
No. e0227131

Page 1 of 1

Owner's Well Number MW-1

Date Work Began 08/11/2014 Date Work Ended 8/13/2014

Local Permit Agency Public Works Agency

Permit Number W2014-0683 Permit Date 7/23/14

DWR Use Only - Do Not Fill In
State Well Number/Site Number
Latitude Longitude
APN/TRS/Other

Geologic Log table with columns: Orientation, Drilling Method, Depth from Surface (Feet to Feet), Description. Includes entry: Abandon a 2" well at 23ft by pressure grout and Removed the top 5ft.

Well Owner
Name Tom Huynh
Mailing Address 6535 San Leandro Street
City Oakland State CA Zip 94621

Well Location
Address 6535 San Leandro
City Oakland County Alameda
Latitude Longitude
Datum Dec. Lat. Dec. Long.
APN Book Page Parcel
Township Range Section

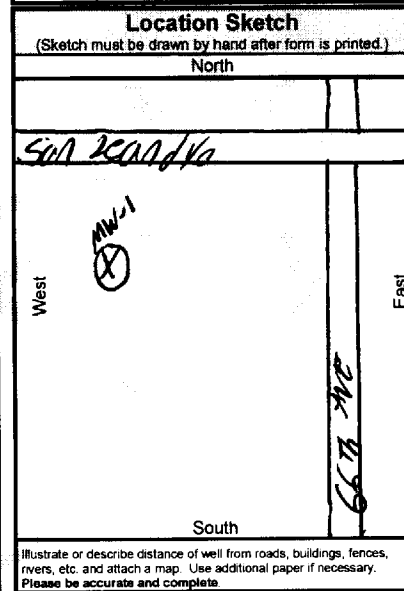

Activity
New Well
Modification/Repair
Deepen
Other
Destroy
Describe procedures and materials under 'GEOLOGIC LOG'

Planned Uses
Water Supply
Domestic Public
Irrigation Industrial
Cathodic Protection
Dewatering
Heat Exchange
Injection
Monitoring
Remediation
Sparging
Test Well
Vapor Extraction
Other

Water Level and Yield of Completed Well
Depth to first water (Feet below surface)
Depth to Static
Water Level (Feet) Date Measured
Estimated Yield * (GPM) Test Type
Test Length (Hours) Total Drawdown (Feet)
*May not be representative of a well's long term yield.

Casings table with columns: Depth from Surface, Borehole Diameter, Type, Material, Wall Thickness, Outside Diameter, Screen Type, Slot Size. Includes entry: 23 0 8

Annular Material table with columns: Depth from Surface, Fill, Description. Includes entry: Cement

Attachments
Geologic Log
Well Construction Diagram
Geophysical Log(s)
Soil/Water Chemical Analyses
Other

Certification Statement
I, the undersigned, certify that this report is complete and accurate to the best of my knowledge and belief
Name ABC LIOVIN DRILLING
Person, Firm or Corporation
1180 E BURNETT SIGNAL HILL CA 90755
Address City State Zip
Signed Date Signed 8-14-2014
C-57 Licensed Water Well Contractor Date Signed C-57 License Number

File Original with DWR

State of California

Well Completion Report

Refer to Instruction Pamphlet

No. e0227129

Page 1 of 1

Owner's Well Number MW-6

Date Work Began 08/11/2014

Date Work Ended 8/13/2014

Local Permit Agency Public Works Agency

Permit Number W2014-0690

Permit Date 7/23/14

DWR Use Only - Do Not Fill In

State Well Number/Site Number, Latitude, Longitude, APN/TRS/Other

Geologic Log

Table with columns: Orientation, Drilling Method, Depth from Surface, Description. Contains entry: Abandon a 2" well at 26ft by pressure grout and Removed the top 5ft.

Well Owner

Name Tom Huynh, Mailing Address 6535 San Leandro Street, City Oakland, State CA, Zip 94621

Well Location

Address 6535 San Leandro, City Oakland, County Alameda, Latitude, Longitude, Datum, Dec. Lat., Dec. Long., APN Book, Page, Parcel, Township, Range, Section

Location Sketch

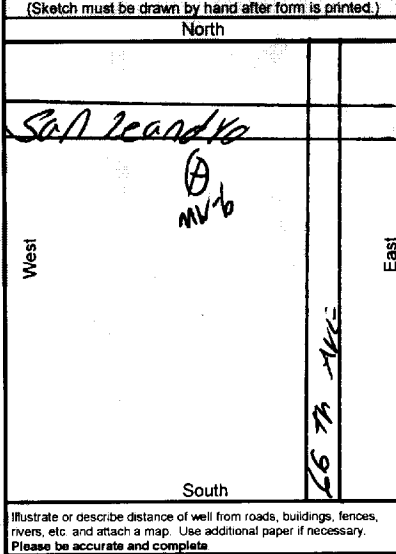

Activity

- Activity options: New Well, Modification/Repair, Deepen, Other, Destroy (selected).

Planned Uses

- Planned Uses options: Water Supply (Domestic, Public, Irrigation, Industrial), Cathodic Protection, Dewatering, Heat Exchange, Injection, Monitoring (selected), Remediation, Sparging, Test Well, Vapor Extraction, Other.

Water Level and Yield of Completed Well

Depth to first water, Depth to Static, Water Level, Estimated Yield, Test Length, Total Drawdown

Casings

Table with columns: Depth from Surface, Borehole Diameter, Type, Material, Wall Thickness, Outside Diameter, Screen Type, Slot Size

Annular Material

Table with columns: Depth from Surface, Fill, Description

Attachments

- Attachment checkboxes: Geologic Log, Well Construction Diagram, Geophysical Log(s), Soil/Water Chemical Analyses, Other

Certification Statement

I, the undersigned, certify that this report is complete and accurate to the best of my knowledge and belief. Name ABC LIOVIN DRILLING, 1180 E BURNETT, SIGNAL HILL, CA 90755. Signed [Signature], Date Signed 8-14-2014, C-57 License Number 422904

*The free Adobe Reader may be used to view and complete this form. However, software must be purchased to complete, save, and reuse a saved form.

File Original with DWR

State of California Well Completion Report

Refer to Instruction Pamphlet
No. **e0227121**

Page 1 of 1

Owner's Well Number MW-10

Date Work Began 08/11/2014

Date Work Ended 8/13/2014

Local Permit Agency Public Works Agency

Permit Number W2014-0684

Permit Date 7/23/14

DWR Use Only - Do Not Fill In

State Well Number/Site Number

Latitude Longitude

APN/TRS/Other

Geologic Log

Orientation Vertical Horizontal Angle Specify _____

Drilling Method _____ Drilling Fluid _____

| Depth from Surface | | Description |
|---|---------|--|
| Feet | to Feet | |
| 23 | 0 | Abandon a 2" well at 23ft by pressure grout and Removed the top 5ft. |
| | | |
| | | |
| | | |
| | | |
| | | |
| | | |
| | | |
| | | |
| | | |
| | | |
| | | |
| | | |
| | | |
| | | |
| | | |
| | | |
| | | |
| | | |
| | | |
| | | |
| | | |
| | | |
| | | |
| | | |
| | | |
| | | |
| | | |
| Total Depth of Boring <u>23</u> | | Feet |
| Total Depth of Completed Well <u>23</u> | | Feet |

Well Owner

Name Tom Huynh

Mailing Address 6535 San Leandro Street

City Oakland State CA Zip 94621

Well Location

Address 6535 San Leandro

City Oakland County Alameda

Latitude _____ N Longitude _____ W
Dec. Min. Sec. Dec. Min. Sec.

Datum _____ Dec. Lat. _____ Dec. Long. _____

APN Book _____ Page _____ Parcel _____

Township _____ Range _____ Section _____

Location Sketch
(Sketch must be drawn by hand after form is printed.)

North

San Leandro

West

East

South

Illustrate or describe distance of well from roads, buildings, fences, rivers, etc. and attach a map. Use additional paper if necessary. Please be accurate and complete.

Activity

New Well

Modification/Repair

Deepen

Other _____

Destroy
Describe procedures and materials under 'GEOLOGIC LOG'

Planned Uses

Water Supply

Domestic Public

Irrigation Industrial

Cathodic Protection

Dewatering

Heat Exchange

Injection

Monitoring

Remediation

Sparging

Test Well

Vapor Extraction

Other _____

Water Level and Yield of Completed Well

Depth to first water _____ (Feet below surface)

Depth to Static _____

Water Level _____ (Feet) Date Measured _____

Estimated Yield * _____ (GPM) Test Type _____

Test Length _____ (Hours) Total Drawdown _____ (Feet)

*May not be representative of a well's long term yield.

| Casings | | | | | | | | Annular Material | | |
|--------------------|-------------------|------|----------|----------------|------------------|-------------|------------------|--------------------|--------|-------------|
| Depth from Surface | Borehole Diameter | Type | Material | Wall Thickness | Outside Diameter | Screen Type | Slot Size if Any | Depth from Surface | Fill | Description |
| Feet to Feet | (Inches) | | | (Inches) | (Inches) | | (Inches) | Feet to Feet | | |
| 23 | 0 | 8 | | | | | | | Cement | |
| | | | | | | | | | | |
| | | | | | | | | | | |
| | | | | | | | | | | |
| | | | | | | | | | | |
| | | | | | | | | | | |
| | | | | | | | | | | |

Attachments

Geologic Log

Well Construction Diagram

Geophysical Log(s)

Soil/Water Chemical Analyses

Other _____

Attach additional information, if it exists.

Certification Statement

I, the undersigned, certify that this report is complete and accurate to the best of my knowledge and belief

Name ABC LIOVIN DRILLING

Person, Firm or Corporation

1180 E BURNETT SIGNAL HILL CA 90755

Address City State Zip

Signed J. Liovin 8-14-2014 422904

C-57 Licensed Water Well Contractor Date Signed C-57 License Number

*The free Adobe Reader may be used to view and complete this form. However, software must be purchased to complete, save, and reuse a saved form.
 File Original with DWR

State of California Well Completion Report

Page 1 of 1
 Owner's Well Number MW-11
 Date Work Began 08/11/2014 Date Work Ended 8/13/2014
 Local Permit Agency Public Works Agency
 Permit Number W2014-0685 Permit Date 7/23/14

Refer to Instruction Pamphlet
 No. **e0227125**

| | |
|-------------------------------|-----------|
| DWR Use Only - Do Not Fill In | |
| State Well Number/Site Number | |
| Latitude | Longitude |
| APN/TRS/Other | |

| Geologic Log | | |
|--|---|--|
| Orientation <input checked="" type="radio"/> Vertical <input type="radio"/> Horizontal <input type="radio"/> Angle Specify _____ | | |
| Drilling Method _____ Drilling Fluid _____ | | |
| Depth from Surface | | Description |
| Feet to Feet | | Describe material, grain size, color, etc |
| 22 | 0 | Abandon a 2" well at 22ft by pressure grout and Removed the top 5ft. |
| | | |
| | | |
| | | |
| | | |
| | | |
| | | |
| | | |
| | | |
| | | |
| | | |
| | | |
| | | |
| | | |
| | | |
| | | |
| | | |
| | | |
| | | |
| | | |
| | | |
| Total Depth of Boring <u>22</u> Feet | | |
| Total Depth of Completed Well <u>22</u> Feet | | |

| Well Owner | |
|-----------------|---|
| Name | <u>Tom Huynh</u> |
| Mailing Address | <u>6535 San Leandro Street</u> |
| City | <u>Oakland</u> State <u>CA</u> Zip <u>94621</u> |

| Well Location | |
|---------------|---|
| Address | <u>6535 San Leandro</u> |
| City | <u>Oakland</u> County <u>Alameda</u> |
| Latitude | Dec. Min. Sec. N Longitude Dec. Min. Sec. W |
| Datum | Dec. Lat. Dec. Long. |
| APN Book | Page Parcel |
| Township | Range Section |

| Location Sketch | Activity | |
|---|---|--------------|
| (Sketch must be drawn by hand after form is printed.) | <input type="radio"/> New Well <input type="radio"/> Modification/Repair <input type="radio"/> Deepen <input type="radio"/> Other <input checked="" type="radio"/> Destroy <small>Describe procedures and materials under "GEOLOGIC LOG"</small> | |
| | <th>Planned Uses</th> | Planned Uses |
| | <input type="radio"/> Water Supply <input type="checkbox"/> Domestic <input type="checkbox"/> Public <input type="checkbox"/> Irrigation <input type="checkbox"/> Industrial <input type="radio"/> Cathodic Protection <input type="radio"/> Dewatering <input type="radio"/> Heat Exchange <input type="radio"/> Injection <input checked="" type="radio"/> Monitoring <input type="radio"/> Remediation <input type="radio"/> Sparging <input type="radio"/> Test Well <input type="radio"/> Vapor Extraction <input type="radio"/> Other | |

| Water Level and Yield of Completed Well | |
|---|---|
| Depth to first water | _____ (Feet below surface) |
| Depth to Static | _____ |
| Water Level | _____ (Feet) Date Measured _____ |
| Estimated Yield * | _____ (GPM) Test Type _____ |
| Test Length | _____ (Hours) Total Drawdown _____ (Feet) |
| *May not be representative of a well's long term yield. | |

| Casings | | | | | | | | Annular Material | | |
|--------------------|-------------------|------|----------|----------------|------------------|-------------|------------------|--------------------|--------|-------------|
| Depth from Surface | Borehole Diameter | Type | Material | Wall Thickness | Outside Diameter | Screen Type | Slot Size if Any | Depth from Surface | Fill | Description |
| Feet to Feet | (Inches) | | | (Inches) | (Inches) | | (Inches) | Feet to Feet | | |
| 22 | 0 | 8 | | | | | | | Cement | |
| | | | | | | | | | | |
| | | | | | | | | | | |
| | | | | | | | | | | |

| Attachments | |
|---|--|
| <input type="checkbox"/> Geologic Log | |
| <input type="checkbox"/> Well Construction Diagram | |
| <input type="checkbox"/> Geophysical Log(s) | |
| <input type="checkbox"/> Soil/Water Chemical Analyses | |
| <input type="checkbox"/> Other | |

| Certification Statement | | | |
|--|---------------------------|---------------------|-----------------|
| I, the undersigned, certify that this report is complete and accurate to the best of my knowledge and belief | | | |
| Name | <u>ABC LOVIN DRILLING</u> | | |
| Person, Firm or Corporation | <u>1180 E BURNETT</u> | <u>SIGNAL HILL</u> | <u>CA 90755</u> |
| Address | City | State | Zip |
| Signed <u>J. K...</u> | 8-14-2014 | 422904 | |
| C-57 Licensed Water Well Contractor | Date Signed | C-57 License Number | |

P:\ENV01231-Chevron\76Products_transfer_sites\351643_3135_Oakland\7.0 Deliverables\7.2 CADD\Well Abandonment WP_June2014\Figure 2_site_map.dwg

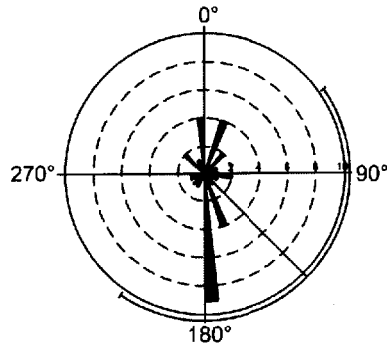

APPROXIMATE GROUNDWATER FLOW DIRECTION 3Q1990 TO 3Q2012

LEGEND:

- APPROXIMATE PROPERTY LINE
- MW-8 MONITORING WELL

Notes:
UST = underground storage tank

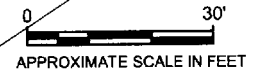
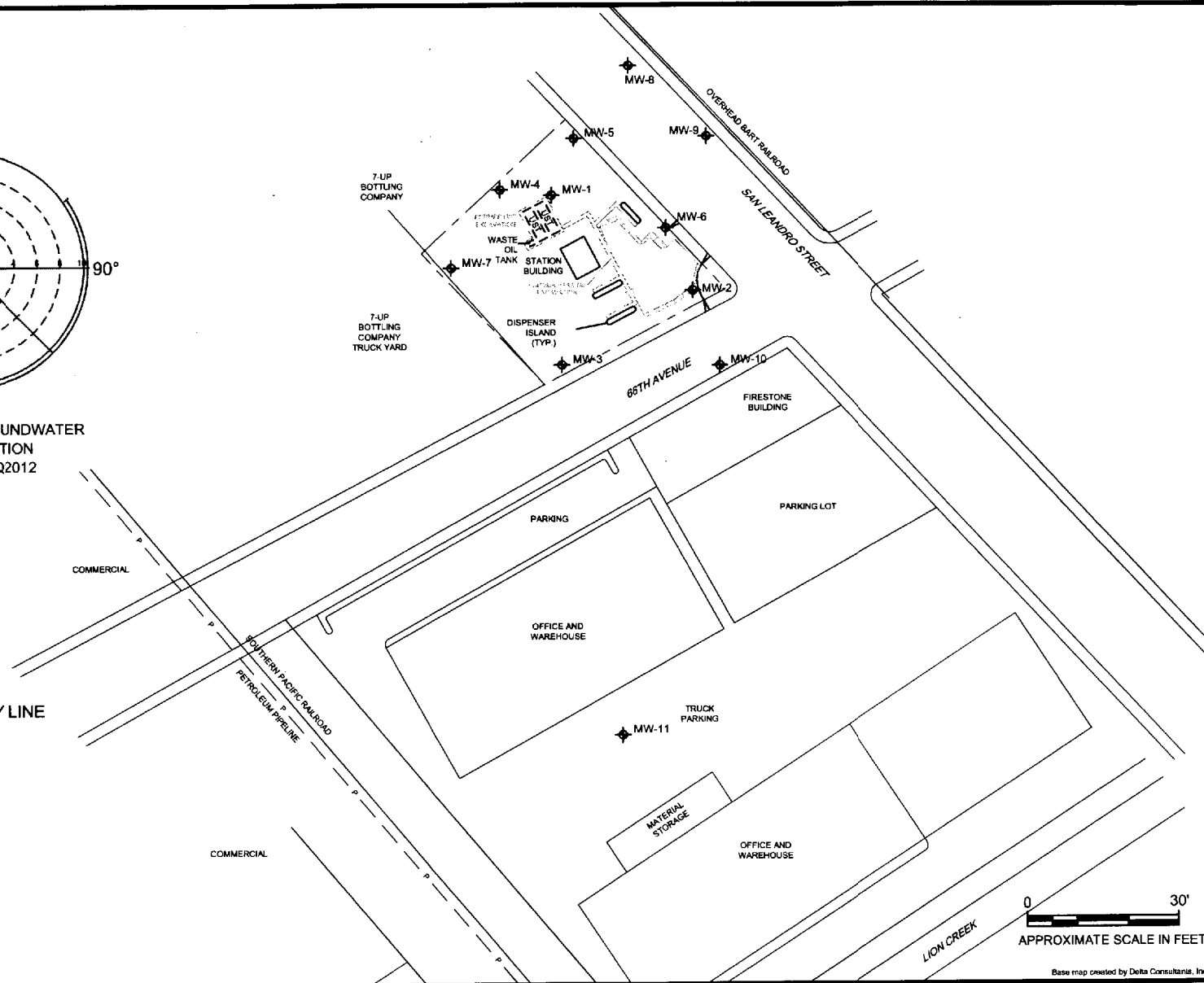

Base map created by Delta Consultants, Inc.

SITE MAP

Unocal No. 3135 (351643)
6535 San Leandro Street/845 66th Avenue
Oakland, California

AECOM
2020 L STREET, SUITE 400
SACRAMENTO, CALIFORNIA 95811
PHONE: (916) 414-5800
FAX: (916) 414-5850
WEB: [HTTP://WWW.AECOM.COM](http://www.aecom.com)



| DESIGNED BY: | REVISIONS | | | |
|---------------------------|-----------|--------------|-------|-----|
| | NO.: | DESCRIPTION: | DATE: | BY: |
| DRAWN BY: JMB | | | | |
| CHECKED BY: JH | | | | |
| APPROVED BY: JH | | | | |

FIGURE NUMBER.

2

| | | |
|---------------------------|---------------------------|------------------------------------|
| SCALE: 1" = 30' | DATE: 6/24/2014 | PROJECT NUMBER: 60314293 |
|---------------------------|---------------------------|------------------------------------|